

FMD-150W-US

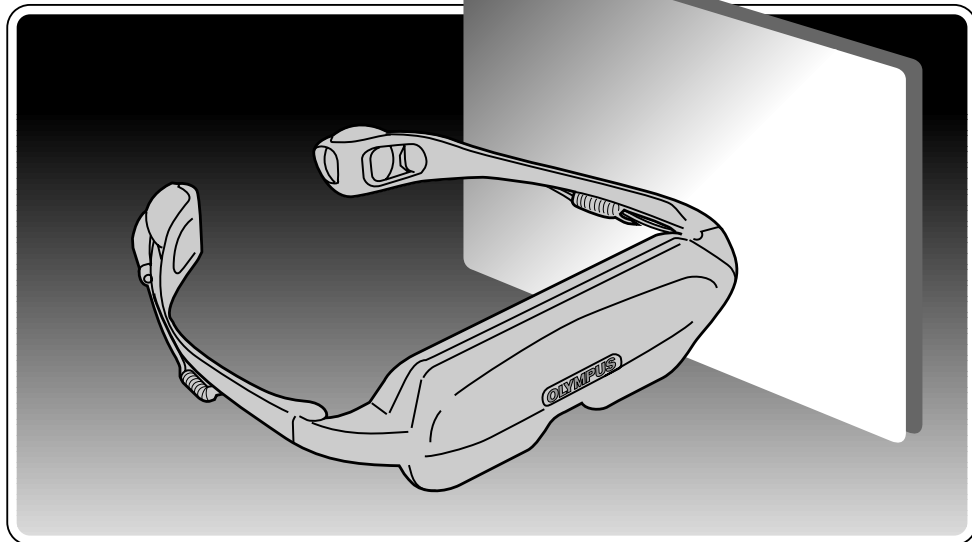

ENGLISH

INSTRUCTION MANUAL

Thank you very much for purchasing an OLYMPUS product.
Please keep this manual handy for future use.

Contents

| | | | |
|--|------|--|------|
| MAIN FEATURES OF Eye-Trek..... | E-2 | TURNING ON THE POWER..... | E-17 |
| ADDITIONAL INFORMATION..... | E-2 | WATCHING VIDEO..... | E-19 |
| WARNING..... | E-3 | SELECTING THE DISPLAY MODE..... | E-21 |
| IMPORTANT SAFETY INSTRUCTIONS AND REGULATORY NOTICE | E-7 | ADJUSTING THE AUDIO/VIDEO..... | E-23 |
| CHECKING THE CONTENTS | E-10 | SAVING, LOADING AND CANCELING AUDIO/VIDEO SETTINGS..... | E-27 |
| NOMENCLATURE | E-10 | REGISTERING, CHANGING OR CANCELING THE PASSWORD..... | E-28 |
| CONNECTIONS | E-11 | SPECIFICATIONS..... | E-29 |
| USING THE BATTERY PACK | E-14 | TROUBLESHOOTING | E-30 |
| WEARING THE DISPLAY UNIT | E-15 | | |
| REMOVING THE DISPLAY UNIT..... | E-16 | | |

MAIN FEATURES OF Eye-Trek

- New type of personal display that uses a unique optical system to enlarge images generated by small LCDs.
- Can be connected to a variety of video components, including a VCR, Video CD player, LD player, DVD player, video camera and TV, using audio/video output jacks (pin jacks).
- Compact, lightweight eyeglass design that is easy to carry.
- Powerful image equivalent to viewing a 62" wide screen TV at 2 meters.
- Can be used with the optional battery pack when there is no power outlet available.
- As easy to wear as eyeglasses. The user can adjust the nose pad to fit the display unit in the optimum viewing position.
- Can be worn over eyeglasses.
- Image can be adjusted by selecting "CONTRAST", "TINT" and "COLOR" in the menu.
- "SURROUND" and "BASS CONTROL" modes can be turned ON/OFF.
- Password protection provided to keep children under 16 from using this display unit.
- Variety of display modes available for a more dynamic audio/video effect and a more "live" atmosphere.

ADDITIONAL INFORMATION

- Do not use the display unit if the image cannot be properly focused.
- The display unit may become warm after long periods of use, but this is not a malfunction.
- A black or white spot, or a red, green or blue point may be observed, but this is not a malfunction. More than 99.99% of this product's effective pixels are guaranteed.
- A vague striped pattern may appear, depending on the type of image displayed. This is due to the optical filter built into the product for smoothing the image and is not a malfunction.
- Lines (straight/slanted/curved) on the display may sometimes look notched. This is due to the characteristics of the LCD monitor and is not a malfunction.
- Depending on the shape of your glasses, you may not be able to use this display unit.
- This display unit provides various display modes for viewing.
Note that if you select a mode with a non-standard image ratio when viewing a TV program on the display, the image will appear different from that viewed on a TV.
- Violation of Copyright Law
The acts of placing the display unit in areas such as a hotel or coffee shop for commercial use, letting people use the product in public or changing the size of the image by using the display mode functions (wide/zoom/cinema zoom mode) may be in violation of copyright law.
- When a standard image (4:3 aspect ratio) is viewed in the wide, zoom, or cinema zoom mode, and when the image is adjusted to fill up the wide screen, the peripheral parts of the image are sometimes cut off or distorted. For the best results, select the normal mode to view the original image as intended.



WARNING

Some people should not use this product:



Prohibited

Children under 16 years of age

This product may interfere with development of their eyes and visual system.

Anyone who has ever experienced convulsive or epileptic fits or loss of consciousness from light flashes or oscillations.

This product could cause the same symptoms for those people.

Anyone who cannot see the whole image clearly, or who wears glasses that make it hard to see the whole screen clearly, or who has an eye movement disorder or visual field disorder.

Under those conditions, using this product for a long time could damage their eyes.



Anyone with a heart disorder, high blood pressure, a visual field impairment, or an eye movement or alignment disorder.

If you have any of these conditions, consult a doctor before using this product, and stop using it immediately if you feel ill.



WARNING

Improper use of this product may cause serious injury:

| | |
|---|--|
|  | <p>Under some conditions, viewing with the Eye-Trek may cause:</p> <ul style="list-style-type: none"> ● Nausea ● Headache ● Motion sickness ● Eye pain or eye fatigue ● Neck or shoulder pain ● Disturbance of hand-eye coordination ● Dizziness ● Feeling ill <p>If you experience any of these symptoms, stop viewing and rest until you recover. These symptoms could temporarily disturb your vision or balance. Do not try to operate a vehicle, walk, or move around until you feel better.</p> |
|  <p>Prohibited</p> | <p>Do not use this product while you are actively moving, such as walking, skating, riding a bicycle, or operating a motor vehicle. This could interfere with your vision or balance, and cause a serious or fatal accident.</p> <p>Do not use this product when you are subject to strong vibrations, such as in a car on a bumpy road. This may cause dizziness, nausea, headaches, or motion sickness.</p> <p>Do not use this product continuously for long periods. Continuous use for long periods may damage your eyes. This product will turn off automatically after 2 1/2 hours; when that happens, do not use it again for at least 15 minutes.</p> <p>Do not use this product if the image does not appear clear and stable in both eyes. If the product is malfunctioning or you are not wearing it properly, viewing it could be hazardous.</p> <p>Do not listen to the sound at high volume. This could contribute to a loss of hearing. It could also interfere with your ability to hear important sounds around you, such as alarms, horns and sirens, especially in a public place.</p> |



WARNING

To prevent electrical shock or fire with this product:



Do not use this product if there is thunder or lightning. Do not touch the control unit or power cord until after the storm has passed.

Beware of moisture. Do not use this product or leave it in very moist or humid places, such as in the rain, snow, fog, or a steamy bathroom. Do not use it if it has condensation inside, or if your hands are wet.

Do not use it near flammable gas, liquid, or vapor.

Do not expose it to very dusty environments.

Do not disassemble.



Do not use any AC adapter or batteries except the AC adapter or batteries provided or specified by Olympus.

Follow the appropriate cautions for electrical devices.



WARNING

For your safety:

| | |
|--|---|
|  <p>Prohibited</p> | <p>Do not use this product in situations that are potentially dangerous, such as on a bus or train where you may fall down, or in places where you cannot guarantee your personal safety.</p> <p>Using this product in such a situation may result in an unexpected accident or injury.</p> <p>Do not leave this product in a closed automobile or in other places under direct sunlight for long periods.</p> <p>Doing so may cause the product to be deformed by heat, resulting in a malfunction and an electric shock hazard.</p> |
|  | <p>Note the following points when plugging the AC adapter into a power outlet.</p> <p>When the AC adapter of this product is plugged in adjacent to another power plug, insert each plug into the power outlet paying attention not to apply excessive force to either.</p> <p>Insert the AC adapter completely and securely into the power outlet. Leave enough slack for the power cord so that the AC adapter or cord is not subjected to excessive force.</p> |

IMPORTANT SAFETY INSTRUCTIONS AND REGULATORY NOTICE

SAFETY NOTICE

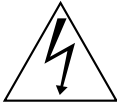

The lightning flash with arrowhead symbol, within an equilateral triangle, is intended to alert the user to the presence of uninsulated “dangerous voltage” within the product’s enclosure that may be of sufficient magnitude to constitute a risk of electric shock to persons.



The exclamation point within an equilateral triangle is intended to alert the user to the presence of important operating and maintenance (servicing) instructions in the literature accompanying the product.



CAUTION

RISK OF ELECTRIC SHOCK
DO NOT OPEN



CAUTION: TO REDUCE THE RISK OF ELECTRIC SHOCK,
DO NOT OPEN THE CONTROL UNIT OR DISPLAY UNIT.
NO USER-SERVICEABLE PARTS INSIDE.



WARNING

TO REDUCE THE RISK
OF FIRE OR ELECTRIC SHOCK,
DO NOT EXPOSE THIS PRODUCT
TO RAIN OR MOISTURE.



OPTIONAL BATTERY PACK SAFETY NOTICE

CAUTION: Do not expose to high temperatures (60°C/140°F).
Do not disassemble.
Do not incinerate.

Replace battery pack with Olympus Co., Ltd. part no. OL-BT7201A only.

Use of another battery may present a risk of fire or explosion.

Dispose of used battery promptly. Keep away from children.

SAFETY INSTRUCTIONS

- 1 Read Instructions** — All the safety and operating instructions should be read before the product is operated.
- 2 Retain Instructions** — The instruction manual should be retained for future reference.
- 3 Heed Warnings** — All warnings on the product and in the operating instructions should be adhered to.
- 4 Follow Instructions** — All operating and use instructions should be followed.
- 5 Cleaning** — Unplug this product from the wall outlet before cleaning. Do not use liquid cleaners or aerosol cleaners. Use a damp cloth for cleaning.
- 6 Attachments** — Do not use attachments that are not recommended by the product manufacturer as they may cause hazards.
- 7 Water and Moisture** — Do not use this product near water – for example, near a bath tub, wash bowl, kitchen sink, or laundry tub; in a wet basement; or near a swimming pool; or in the rain.
- 8 Accessories** — Do not place this product on an unstable cart, stand, tripod, bracket, or table. The product may fall, causing serious injury to a child or adult, and serious damage to the product.
- 9 Power Sources** — This product should be operated only from the type of power source indicated on the marking label. If you are not sure of the type of power supply to your home, consult your product dealer or local power company. For products intended to operate from battery power or other sources, refer to the instruction manual.
- 10 Grounding or Polarization** — This product may be equipped with a polarized alternating-current line plug (a plug having one blade wider than the other). This plug will fit into the power outlet only one way. This is a safety feature. If you are unable to insert the plug fully into the outlet, try reversing the plug. If the plug should still fail to fit, contact your electrician to replace your obsolete outlet. Do not defeat the safety purpose of the polarized plug.
- 11 Power-Cord Protection** — Power-supply cords should be routed so that they are not likely to be walked on or pinched by items placed upon or against them, paying particular attention to cords at plugs, convenience receptacles, and the point where they exit from the product.
- 12 Lightning** — For added protection for this product during a lightning storm, or when it is left unattended and unused for long periods of time, unplug it from the wall outlet and disconnect the antenna or cable system. This will prevent damage to the product due to lightning and power-line surges.
- 13 Overloading** — Do not overload wall outlets, extension cords, or integral convenience receptacles as this can result in a risk of fire or electric shock.
- 14 Object and Liquid Entry** — Never push objects of any kind into this product through openings as they may touch dangerous voltage points or short-out parts that could result in a fire or electric shock. Never spill liquid of any kind on the product.
- 15 Servicing** — Do not attempt to service this product yourself as opening or removing covers may expose you to dangerous voltage or other hazards. Refer all servicing to qualified service personnel.

- 16 Damage Requiring Service** — Unplug this product from the wall outlet and refer servicing to qualified service personnel under the following conditions:
- (a) When the power-supply cord or plug is damaged,
 - (b) If liquid has been spilled, or objects have fallen into the product,
 - (c) If the product has been exposed to rain or water,
 - (d) If the product does not operate normally by following the operating instructions. Adjust only those controls that are covered by the operating instructions as improper adjustment of other controls may result in damage and will often require extensive work by a qualified technician to restore the product to its normal operation,
 - (e) If the product has been dropped or damaged in any way, and
 - (f) When the product exhibits a distinct change in performance – this indicates a need for service.
- 17 Replacement Parts** — When replacement parts are required, be sure the service technician has used replacement parts specified by the manufacturer or have the same characteristics as the original part. Unauthorized substitutions may result in fire, electric shock, or other hazards.
- 18 Safety Check** — Upon completion of any service or repairs to this product, ask the service technician to perform safety checks to determine that the product is in proper operating condition.
- 19 Wall or Ceiling Mounting** — The product should be mounted to a wall or ceiling only as recommended by the manufacturer.
- 20 Heat** — The product should be situated away from heat sources such as radiators, heat registers, stoves, or other products (including amplifiers) that produce heat.

FCC NOTICE

This equipment has been tested and found to comply with the limits for a Class B digital device, pursuant to Part 15 of the FCC Rules. These limits are designed to provide reasonable protection against harmful interference in a residential installation. This equipment generates, uses, and can radiate radio frequency energy and, if not installed and used in accordance with the instructions, may cause harmful interference to radio communications. However, there is no guarantee that interference will not occur in a particular installation. If this equipment does cause harmful interference to radio or television reception, which can be determined by turning the equipment off and on, the user is encouraged to try to correct the interference by one or more of the following measures;

- Reorient or relocate the receiving antenna.
- Increase the separation between the equipment and the receiver.
- Connect the equipment into an outlet on a circuit different from that to which the receiver is connected.
- Consult the dealer or an experienced radio or television technician for help.

FCC Warning: Changes or modifications not expressly approved by the party responsible for compliance could void the user's authority to operate the equipment.

INDUSTRY CANADA RADIO FREQUENCY INTERFERENCE NOTICE

This Class B digital apparatus meets all requirements of the Canadian Interference-Causing Equipment Regulations.

CHECKING THE CONTENTS

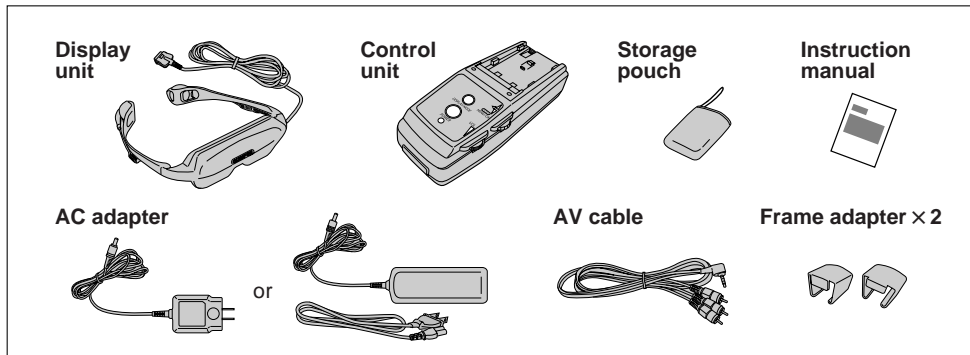

NOMENCLATURE

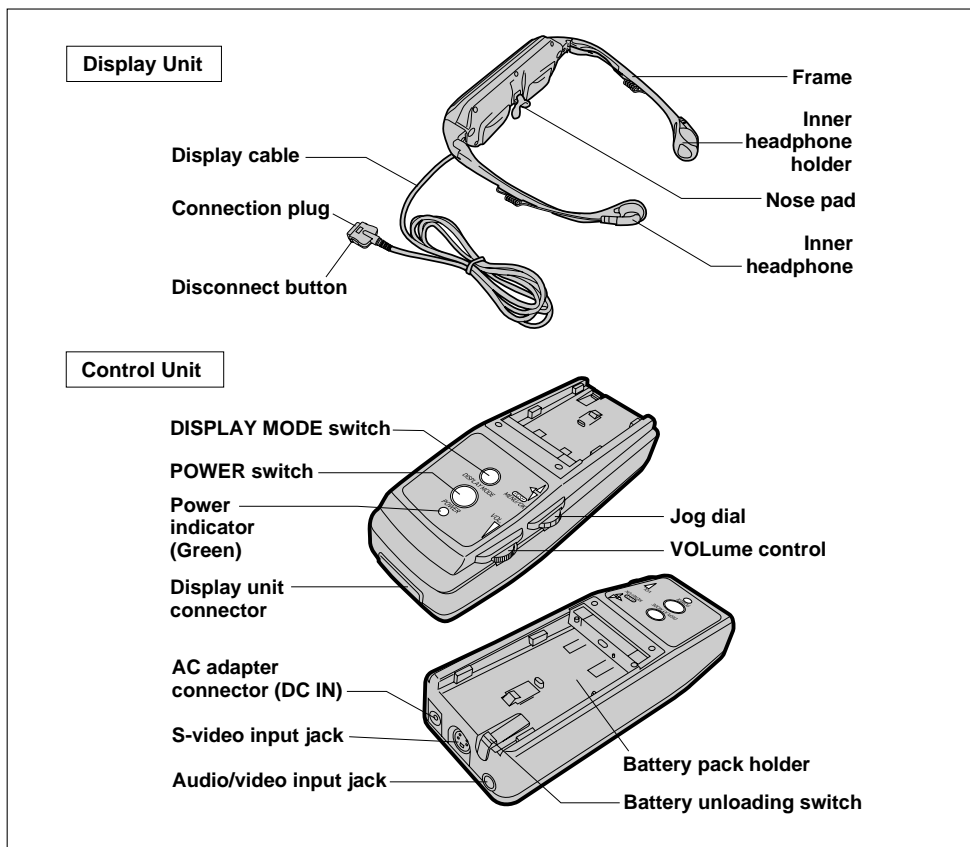

CONNECTIONS

- 1** Hold the cable of the display unit with the connection plug facing up, and insert the plug into the display unit connector of the control unit.

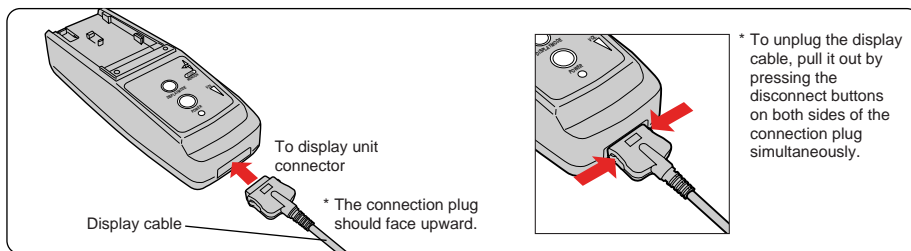

ENGLISH

- 2** Plug the AC adapter into the AC adapter (DC IN) connector of the control unit and into a power outlet.

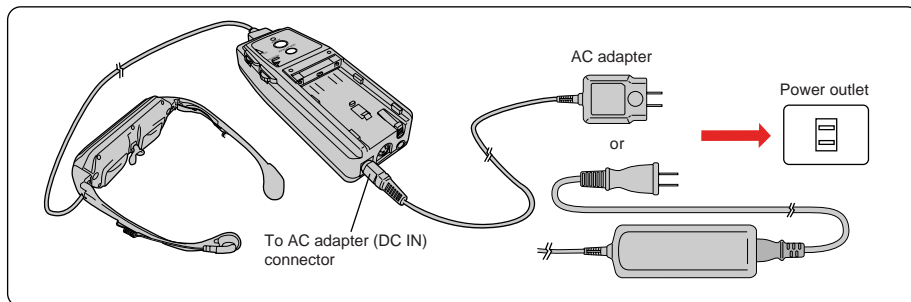

- 3** Make sure to set the POWER switches of the control unit and connected video component to OFF, then connect the AV cable to the audio/video input jack of the control unit and to the output jacks of the video component as shown in the figure.

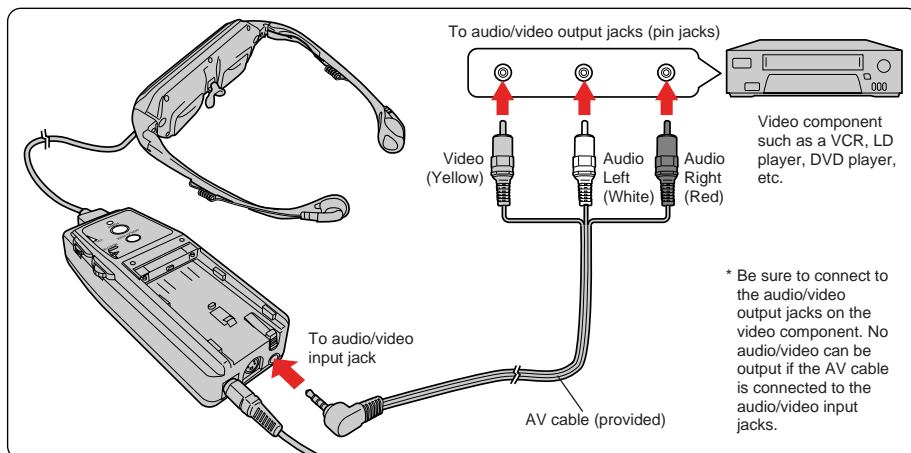

Note: If your video component is monaural, you will hear the audio only through one earphone.

CONNECTIONS (continued)

Basic Connections

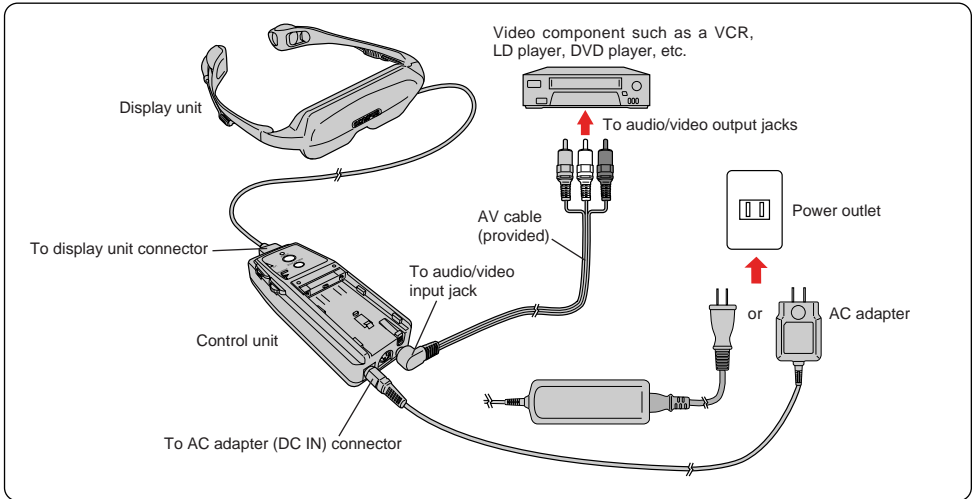

Connections Using S-Video Jack

If the connected video component has an S-video output jack, clearer video can be viewed by connecting it through an S-video cable. When the S-video jack and video jack (pin jack) are simultaneously connected, the S-video input has priority.

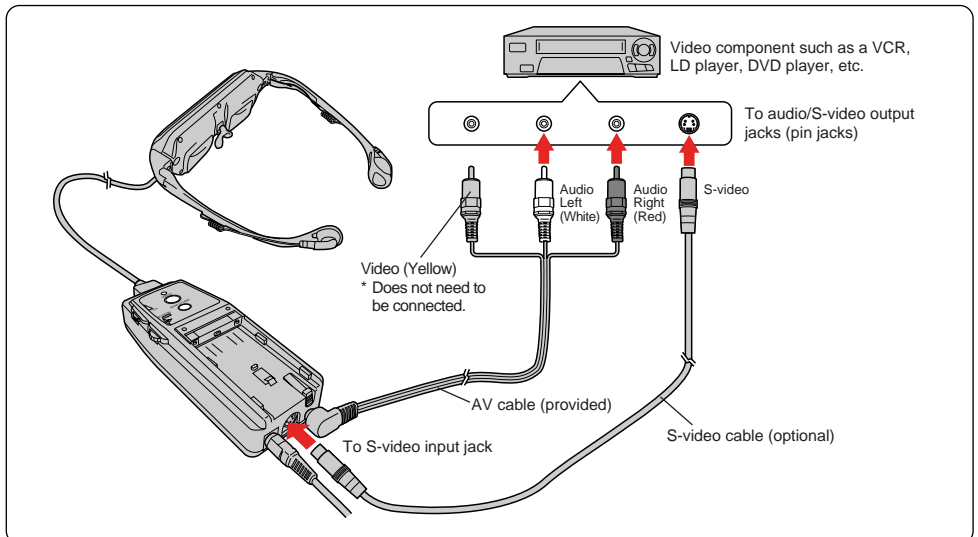

- When the video component has more than one type of output jack, it can be connected with more than one Eye-Trek unit.

CONNECTIONS (continued)

Connection to Mini Jacks

If the connected video component uses a mini-jack, and cannot be directly connected with the AV cable, use plug adapters.

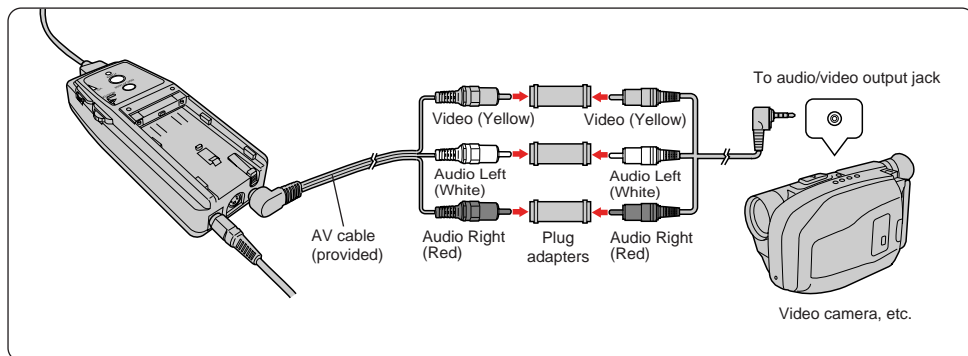

USING THE BATTERY PACK

CAUTION: Do not expose to high temperatures (60°C/140°F).
Do not disassemble.
Do not incinerate.
There is a danger of explosion if the battery is incorrectly replaced.

Replace battery pack with Olympus Co., Ltd. part no. OL-BT7201A only.
Use of another battery may present a risk of fire or explosion.
Dispose of used battery promptly. Keep away from children.

Using the Battery Pack (Optional) OL-BT7201A

- Load the battery pack onto the battery pack holder on the control unit in the direction shown.
- The battery pack will last approximately one and a half hours. (The time varies depending on the remaining battery power and the operating environment.)
- When the battery is nearly exhausted, the battery remaining power indicator blinks in the lower right corner of the screen. The green indicator on the control unit starts blinking at the same time.
- After the battery remaining power indicator blinks for about 30 seconds, the message LOW BATTERY, AUTOMATIC POWER OFF. appears on the screen and the power turns off automatically.
- You cannot charge the battery pack using the control unit of this product. Use the optional battery charger. Read the battery pack instructions for details.
- When AC power is used with the battery pack loaded, the power is supplied from the AC adapter. (Power will not be supplied from the battery pack when the AC adapter is connected to the control unit.)
- When the battery pack is not to be used for a long period of time, remove it from the control unit.
- When power is on and the battery is running out, the image may not appear on either the right or left screen. This is not a malfunction; charge the battery before using the unit.

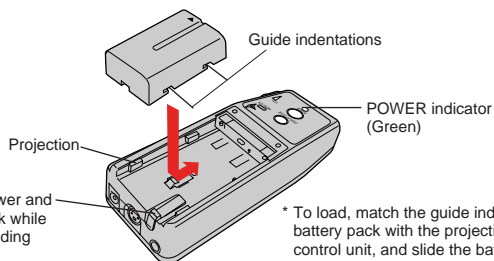

* To unload, turn off the power and slide the battery pack back while pressing the battery unloading switch.

* To load, match the guide indentations on the battery pack with the projections on the control unit, and slide the battery pack in.

WEARING THE DISPLAY UNIT

1 Remove the inner headphone from each inner headphone holder by turning the headphone as shown in the figure.

- * First, minimize the volume level by turning the VOLUME control fully clockwise.
- * When attaching the inner headphones to the inner headphone holders, simply reverse the order of removal for each.
- * If you want to replace the ear pads, purchase a pair of 16.5 mm ear pads.

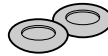
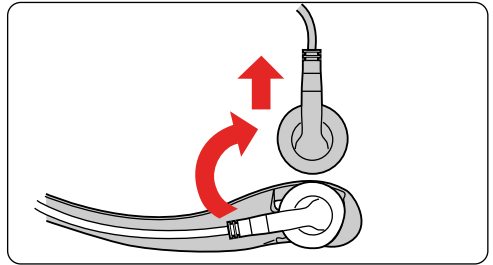

2 Wear the display unit just like wearing eyeglasses and attach the inner headphones to your ears.

- * Adjust the nose pad so that the top and bottom edges of the video image are at the easiest-to-view positions. If this adjustment is not performed, the video image may appear dim.
- * When wearing the display unit over eyeglasses, pull the nose pad slightly more than usual.
- * If you cannot wear the display unit securely because there is too much space between the frame arms, reduce the space using the frame adapters.

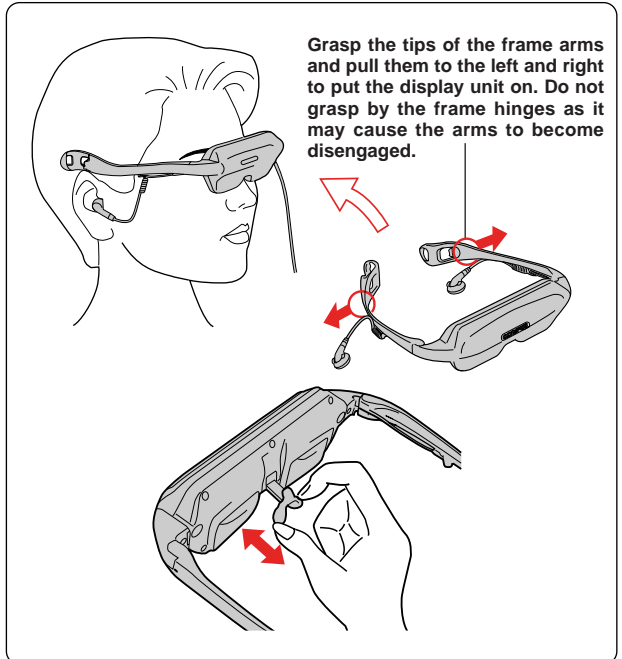

NOTICE

- Be sure to wear it properly so that the image appears clear and stable in both eyes.
- If you are wearing eyeglasses, be careful that they do not fall off when removing the display unit.

REMOVING THE DISPLAY UNIT

When removing the display unit, first remove the inner headphones from your ears.

If you are also wearing eyeglasses, remove the display unit by holding the left and right arms of the display unit frame with your fingers while pushing the frame arms of your eyeglasses upward with your thumbs.

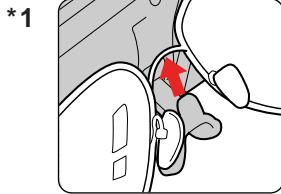

*1 With certain eyeglass designs, the nose pad may catch the bridge of the eyeglasses and cause them to come out together with the display unit. To avoid this, remove the display unit as described above.

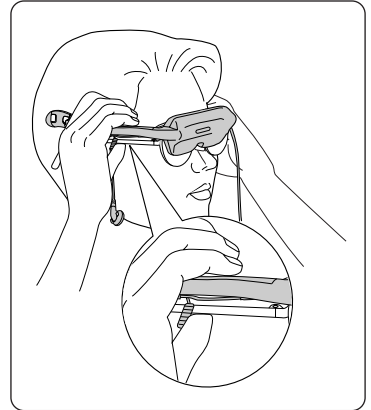

NOTICE

• If the display unit is removed without removing the inner headphones from your ears, the inner headphone cords will be pulled excessively and may be disconnected.

Frame adapters

The display unit may not fit your head due to excessive distance between the frames. If this is the case, use the frame adapters.

The frame adapters allow the distance between frames to be reduced.

Always use both the left and right frame adapters together.

How to attach

- Take out the 2 frame adapters from the bag.
- As shown in the illustration, attach one of the frame adapters to position ①, then slide it to position ②.
- Attach the other frame adapter to the other frame.
- To remove, push the inner tab in the direction ③ as shown in the illustration.

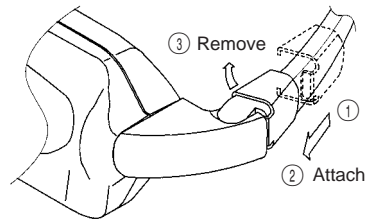

Product Care

- To clean the display unit and control unit, wipe with a soft, dry cloth. If they are extremely dirty, wipe with a soft cloth moistened with a solution of neutral detergent. Do not use chemicals such as thinner, benzene and alcohol.
- Use the provided storage pouch to store the display unit when not in use.
- Do not wrap the display cable around the display unit or apply excessive force to the display cable, as it may cause the wire in the cable to break.
- Protect the display unit frame from contact with hair liquids, cosmetic products or other chemicals. If any gets on the frame, wipe it clean with a soft cloth moistened with a solution of neutral detergent. If the frame is left with these types of chemicals on it, surface cracks may appear.

TURNING ON THE POWER

* The password is set to "0.0.0" at the factory.

1 Turn the power on and select the desired language.

1. Turn on the power of the connected video component.
2. Press the POWER switch on the control unit. The power indicator lights in green, then the language selection screen appears. Rotate the jog dial to select the desired language, then press it to select OK.

* The screen remains black until a video signal is input. If no signal is present, check the power and connection to the video component.

* The  mark appears next to the selected language.

* The language selection screen will not appear the next time the power is turned on. Refer to Resetting (pg. 27) to change the language displayed.

3. A warning appears on the screen.

Jog Dial

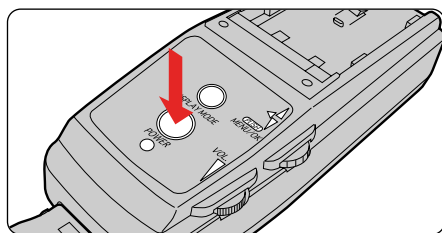
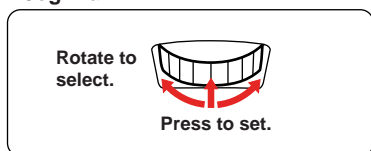

On-Screen Display

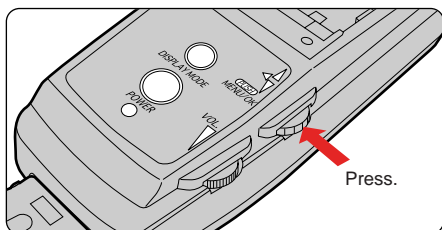

- Depending on the video component connected, the screen may remain black until playback starts.
- The power will be turned off if a video signal is not input to this unit for 5 minutes.

TURNING ON THE POWER (continued)

2 Acknowledge warning.

1. Press the jog dial to acknowledge the warning on the screen.
2. When the password entry screen appears, rotate the jog dial to select each number (0, 0, 0) and press the jog dial to select OK. The password is entered.

* The password is set to 0, 0, 0 when this product is used for the first time or after it is reset (refer to page 27). After entering this password, the password change screen appears.

* Refer to Registering, Changing or Canceling the Password on pg. 28 to change your password.

On-Screen Display

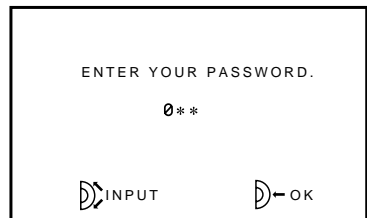
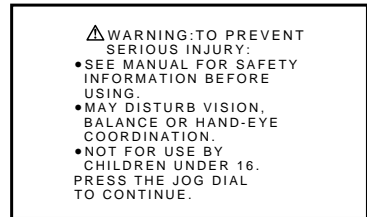

- If the jog dial is not pressed on the warning screen, the password entry screen will not appear. The power will be turned off if no operation is performed for one minute.

WATCHING VIDEO

1 Turn the power on.

1. Press the POWER switch on the control unit. The power indicator lights in green and the warning appears on the screen.
2. Press the jog dial to acknowledge the warning.

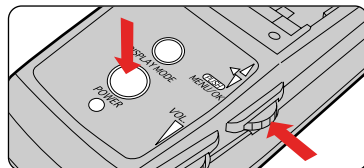

2 Display video.

1. When the password has been registered...
When the password entry screen appears, rotate the jog dial to select each number (0.0.0) and press the jog dial to select OK.

* When the wrong password is entered...
If you enter the wrong password, the password entry screen appears again after INCORRECT PASSWORD. is displayed. If you enter the wrong password 3 times in a row, the power automatically turns off.

2. When the password registration has been canceled...
The password entry screen will not appear when the password registration has been canceled (see pg. 28).

On-Screen Display

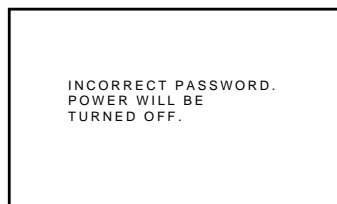

3 Adjust the listening volume.

1. Adjust the listening volume with the VOLUME control.
2. The volume level is displayed on the screen when the VOLUME control is adjusted.

* The higher the number, the greater the volume.

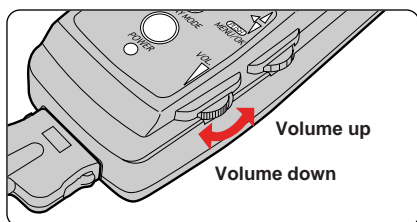

WATCHING VIDEO (continued)

4 Adjust the contrast.

1. When the jog dial is rotated while a video image is being displayed, the contrast adjustment level is displayed on the screen.
2. Rotate the jog dial to adjust the contrast.
3. Press the jog dial to return the screen to the normal view.

On-Screen Display

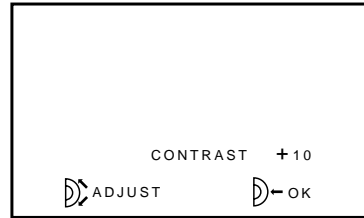

5 When you are finished...

When you are finished, remove the inner headphones before taking the display unit off*. Press the POWER switch on the control unit to turn the power off (the indicator goes off).

* Refer to Wearing/Removing the Display Unit on pgs. 15-16.

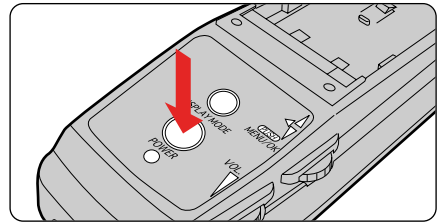

Note

A health warning is displayed about 2-1/2 hours after the POWER switch is set to ON*1. The power automatically turns off 5 minutes after the warning is displayed*2.

*1 The warning remains on the screen until the jog dial is pressed.

*2 The power automatically turns off after the warning is displayed.

*1

THE UNIT HAS BEEN ON
FOR 2.5 HOURS
AND WILL TURN OFF
AUTOMATICALLY
IN 5 MINUTES.
FOR YOUR HEALTH,
PLEASE REST YOUR EYES.
PRESS THE JOG DIAL
TO CONFIRM.

*2

THE UNIT HAS BEEN ON
FOR 2.5 HOURS.
FOR YOUR HEALTH,
PLEASE REST YOUR EYES.
THE UNIT WILL TURN OFF
AUTOMATICALLY
IN 15 SECONDS.

SELECTING THE DISPLAY MODE

You can select the desired display mode.

1 Select the display mode.

Each press of the DISPLAY MODE switch changes the screen size to 4 different modes, from NORMAL to WIDE, ZOOM, and CINEMA ZOOM, in that order.

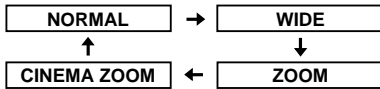

Press the jog dial to select the desired mode and complete the adjustment.

* When the power is turned on, the previously selected mode is used.

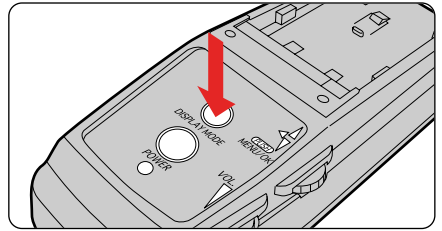

NORMAL

Standard image with an aspect ratio of 4:3. Black bands are inserted at the right and left of the screen.

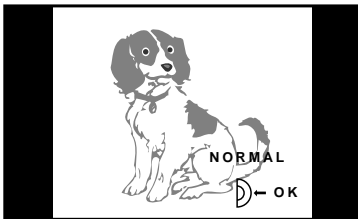

WIDE

Wide screen with the top and bottom unchanged but the right and left expanded. Suitable for viewing vertically-elongated images (called Squeeze images) recorded on a video camera, or Hi-Vision images played back through a MUSE-NTSC converter.

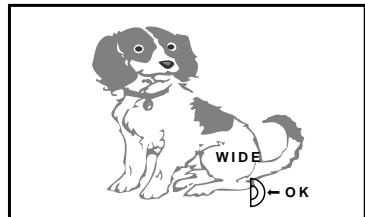

CINEMA ZOOM

Image is expanded as much as possible to fit into the right and left sides of the screen. Suitable for viewing Cinemascope- or Vista-sized images.

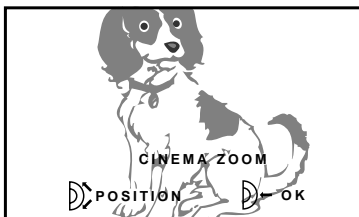

ZOOM

Image is expanded to the right and left or top and bottom. Suitable for viewing Vista-sized images or regular TV programs such as sports or variety shows.

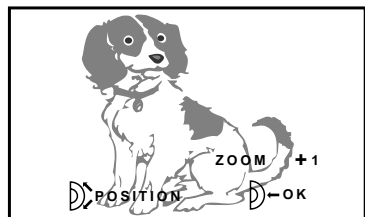

SELECTING THE DISPLAY MODE (continued)

■ Selecting the display mode

When a standard image (4:3 aspect ratio) is viewed in the WIDE, ZOOM or CINEMA ZOOM mode, and when the image is adjusted to fill up the width of the screen, the peripheral parts of the image may be cut off or distorted. For best results, select the normal mode to view the image as originally intended.

■ Displaying the image

Various display modes are provided for viewing. Note that if you select a mode with a non-standard image ratio when viewing a TV program on the display, the image will be different from that viewed on a TV.

■ Violating copyright law

Note that if this display unit is placed in areas such as a hotel or coffee shop for the purpose of making a profit or letting the public use it, and if the image is either compressed or enlarged using one of the display modes (WIDE/ZOOM/CINEMA ZOOM), it may be in violation of copyright law.

When Subtitles or Images Extend Beyond the Screen

If the images or titles are cut off in the ZOOM or CINEMA ZOOM mode, move the screen up or down to view it in the desired position.

1. Rotate the jog dial to move the image up or down in the ZOOM or CINEMA ZOOM mode.
2. Press the jog dial to complete the adjustment.

* The screen cannot be moved up or down in the NORMAL/WIDE mode.

* Rotate the jog dial to 0 to return the screen to the standard position.

On-Screen Display

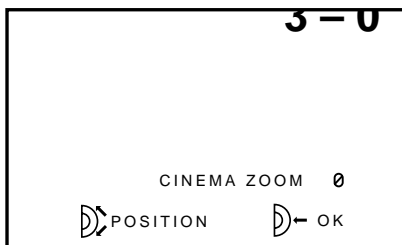

Screen moves up when + is displayed.



0 is the standard position.

Screen moves down when - is displayed.

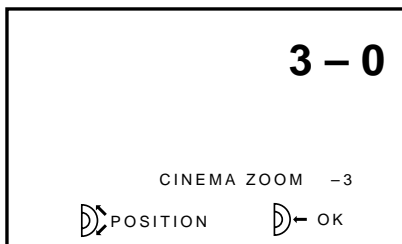

ADJUSTING THE AUDIO/VIDEO

You can adjust the audio and video, and can register your preferred settings (Refer to Saving, Loading and Canceling Audio/Video Settings on pg. 27).

Adjusting Video Image

1 Select VIDEO SETTINGS on the MENU screen.

1. Press the jog dial to display the MENU screen.
 2. Rotate the jog dial to select VIDEO SETTINGS and press it to select OK.
- * The menu disappears from the screen when EXIT is selected and the adjustment is complete.

On-Screen Display

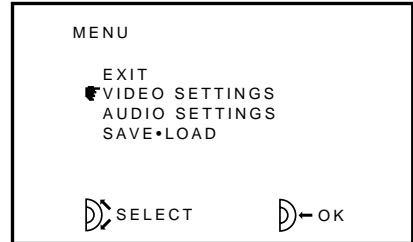

2 Select any item from the VIDEO MENU.

1. Rotate the jog dial to select the item you want to adjust and press it to select OK. When the adjustment screen appears, select the desired level.
2. After the level has been set, the VIDEO MENU screen appears again. Select EXIT and press the jog dial after each setting has been adjusted as desired.
3. The MENU screen reappears.



- If the jog dial isn't moved for 10 seconds while selecting or adjusting settings, the current level is set and the adjustment is complete.
- If the VOLUME control is rotated or the DISPLAY MODE switch is pressed while the jog dial is being rotated, the current level is set.
- The  mark appears next to the selected item.

ADJUSTING THE AUDIO/VIDEO(continued)

CONTRAST (Adjusts the contrast between black and white)

Rotate the jog dial to adjust the contrast to the desired level and press it to select OK.

1. The higher the number, the greater the contrast.
2. The lower the number, the lesser the contrast.

* Contrast adjustment is also available by rotating the jog dial while viewing a video image (Refer to pg. 20).

On-Screen Display

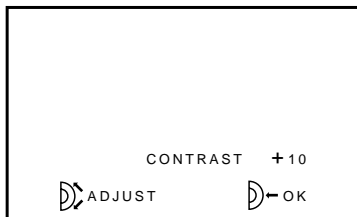

TINT (Adjusts the tint of the video image)

Rotate the jog dial to adjust the tint to the desired level and press it to select OK.

1. The higher the number, the greener the image.
2. The lower the number, the redder the image.

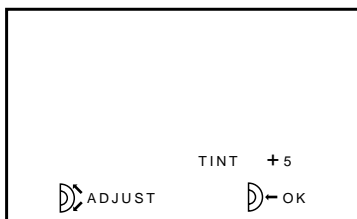

COLOR (Adjusts the density of the video image)

Rotate the jog dial to adjust the color density to the desired level and press it to select OK.

1. The higher the number, the darker the color.
2. The lower the number, the brighter the color.



SHARPNESS (Adjusts the contours of the video image)

Rotate the jog dial to adjust the sharpness to the desired level and press it to select OK.

1. The higher the number, the sharper the image.
2. The lower the number, the softer the image.

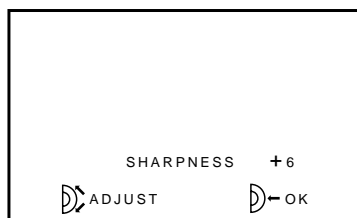

ADJUSTING THE AUDIO/VIDEO(continued)

EXPERT SETTINGS

(Brightness, White Balance Red and White Balance Blue)

When the EXPERT MENU is selected, the following 3 items are displayed:

BRIGHTNESS

WHITE-BALANCE RED

WHITE-BALANCE BLUE

1. Rotate the jog dial to select the desired item to adjust.
2. Rotate the jog dial to select EXIT after adjustment is complete, then press it.
3. The VIDEO MENU screen reappears.

■ BRIGHTNESS

Adjusts the brightness of the entire screen. Select this mainly to enhance the blackness of the image.

■ WHITE-BALANCE RED/BLUE

Adjusts the white balance (white color reproduction under various lighting). The white balance is easier to adjust when a white shirt or cloudy sky is displayed in the center of the screen.

On-Screen Display



↓ After selecting, perform adjustment.



ORIGINAL SETTINGS

Select this to return to the factory default settings.

(The function parameters registered in SAVE and settings registered in AUDIO SETTINGS and DISPLAY MODE cannot be changed. Perform a reset if you want to cancel all the settings (See pg. 27)).

ADJUSTING THE AUDIO/VIDEO(continued)

Adjusting Audio

1 Select AUDIO SETTINGS in the MENU screen.

1. Press the jog dial to display the MENU screen.
2. Rotate the jog dial to select AUDIO SETTINGS and press it to select OK.

* Select EXIT to return to complete the adjustment.

On-Screen Display



SURROUND (Adds a more “live” atmosphere to the sound)

1. Rotate the jog dial to select SURROUND, select either ON or OFF then press it.
2. Select EXIT to return to the MENU screen.



BASS CONTROL

(Adjusts low frequencies to make the sound more dynamic)

1. Rotate the jog dial to select BASS CONTROL, select either ON or OFF then press it.
2. Select EXIT to return to the MENU screen.



SAVING, LOADING AND CANCELING AUDIO/VIDEO SETTINGS

You can register 2 sets of audio, video and display mode settings.

Registering

1 Select SAVE•LOAD in the MENU screen.

After adjusting the audio/video settings and selecting the display mode, rotate the jog dial to select SAVE•LOAD and press it to select OK.

* The display mode can be registered as well.

On-Screen Display

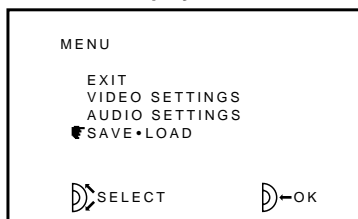

2 Select SAVE.

1. Rotate the jog dial to select either SAVE 1 or SAVE 2 and press it to select OK.

2. The settings are registered.

* Select EXIT to return to the MENU screen.

* The new settings are saved over the previous ones.

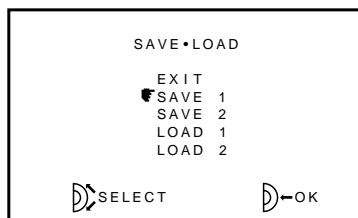

Loading

1 Select SAVE•LOAD in the MENU screen.

2 Select LOAD.

Rotate the jog dial to select either LOAD 1 or LOAD 2 and press it to select OK.

* The settings will change to those loaded.

* Select LOAD 1 when loading the settings for SAVE 1, and select LOAD 2 when loading the settings for SAVE 2.

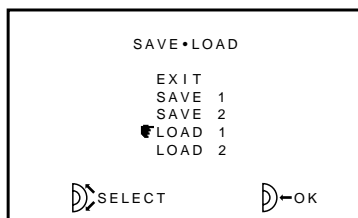

Resetting (For canceling all the registered settings)

Press the POWER switch for more than 5 seconds with the jog dial pressed. The power will be turned off once the POWER switch is released. When the power is turned on again, all the settings will return to the factory default settings.

The password setting returns to 0, 0, 0. Refer to Registering, Changing or Canceling the Password on pg. 28.

REGISTERING, CHANGING OR CANCELING THE PASSWORD

You can register a 3-digit password to keep children from using it.

If you forget the password, register a new one.

You can cancel the password registration if you don't have any children under 16, or if you do not wish to use this feature.

* The password is set to 0, 0, 0 at the factory.

1 Register, change or cancel the password.

1. Press the POWER switch for more than 5 seconds.
2. The power will be turned off once the POWER switch is released. When the power is turned on again, the password registration screen appears after the warning is displayed.

Registering/changing the password

Rotate the jog dial to select YES and press it to select OK. The password entry screen appears.

On-Screen Display



2 Enter a password.

1. Rotate the jog dial to select 3 numbers and press it to select OK.
2. The password confirmation screen appears.
3. Enter the same password again.

* If you fail to re-enter the password, the password is not registered and you will have to start over from the password registration screen.

(The power will automatically turn off if you fail to enter the password 3 times in a row.)

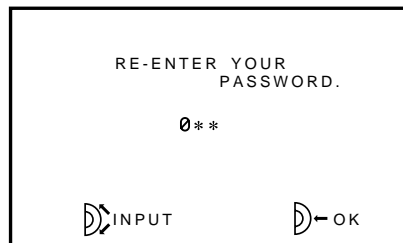

3 Cancel the password registration.

1. To cancel the password registration, rotate the jog dial to select NO in the step **1**, and press it to select OK.

SPECIFICATIONS

Product

| | |
|--------------|------------------------|
| Type | : Personal LCD Display |
| Product name | : Eye-Trek |
| Model name | : FMD-150W |

Power Supply Ratings

| | |
|------------------------------|----------------------------|
| AC adapter (DC IN) connector | : Rated 7.5 V DC |
| AC adapter (provided) | : AC 100 – 120 V, 50/60 Hz |
| Power consumption | : Approx. 5.2 W |

Video

| | |
|-----------------------|--|
| Video signal | : NTSC format |
| Video display devices | : TFT LCD panel x 2 |
| Number of pixels | : 240,000 |
| Angle of view | : 37.5 degrees horizontal, 21.7 degrees vertical |

Input Jacks

| | |
|------------------------|--|
| Audio/video input jack | : 4-pole mini-jack, 3.5 mm dia. Video : 1 V _{p-p} /75 Ω (unbalanced) Audio : 200 mV _{rms} /20 kΩ |
| S-video input jack | : 4-pin mini-DIN connector |

Ambient Temperatures

| | |
|-----------|----------------|
| Operation | : 5° to 35°C |
| Storage | : -10° to 60°C |

Dimensions

| | |
|--------------|---|
| Display unit | : Approx. 170 (W) x 50 (H) x 30 (D) mm (not including display cable and frame) : Approx. 170 (W) x 50 (H) x 55 (D) mm (not including display cable/when frame is folded) |
| Control unit | : Approx. 56 (W) x 35 (H) x 150 (D) mm (not including projections) |

Weight

| | |
|--------------|--|
| Display unit | : Approx. 110 g (not including cables) |
| Control unit | : Approx. 180 g (not including battery pack) |

* Design and specifications are subject to change without notice.

TROUBLESHOOTING

| Symptom | Possible Cause | Solution | Ref. Page |
|--|--|---|---------------------|
| Video is not displayed. | Connections are incorrect. | Connect the video cables properly. | P.11 ~ 13 |
| | A video signal is not input or the power is not turned on. | Turn on the power of the video component and play back video. | P. 17 |
| Video is hard to view. | The display unit is being worn improperly. | Adjust the position with the nose pad. | P. 15 ~ 16 |
| | Video settings (CONTRAST, TINT) are adjusted improperly. | Adjust video settings with the jog dial. | P. 20 P. 23 ~ 25 |
| Video disappears suddenly. | About 2-1/2 hours have elapsed since the POWER switch was set to ON. (Power turns off automatically.) | Rest your eyes. Set the POWER switch to ON when you want to use again. | P. 4 P. 20 |
| | The battery pack has run out. | Charge it or use an AC adapter. | P. 11 P. 14 |
| A black, white, red, green or blue dot is observed on the screen. | The LCD screens are manufactured to precise specifications, but colored dots may be observed. This is not a malfunction. | | P. 2 |
| A striped pattern is observed with the video image. | This is due to the built-in optical filter which smoothes the image and is not a malfunction. | | P. 2 |
| Audio is not heard. | The volume is set to minimum. | Adjust the VOLume control. | P. 19 |
| | The AV cable is not connected. | Connect the AV cable. | P. 11 |
| The battery power runs out very quickly. | The battery pack is approaching the end of its life. | Replace the battery pack with a new one. | P. 14 |
| You forgot your password. | | Re-register the password. | P. 28 |
| You want to change the language to display. | | Perform a reset. | P. 17 P. 27 |

OLYMPUS[®]

OLYMPUS AMERICA INC.

Two Corporate Center Drive, Melville, NY 11747-3157, U.S.A. Tel. 516-844-5000

Free Manuals Download Website

<http://myh66.com>

<http://usermanuals.us>

<http://www.somanuals.com>

<http://www.4manuals.cc>

<http://www.manual-lib.com>

<http://www.404manual.com>

<http://www.luxmanual.com>

<http://aubethermostatmanual.com>

Golf course search by state

<http://golfingnear.com>

Email search by domain

<http://emailbydomain.com>

Auto manuals search

<http://auto.somanuals.com>

TV manuals search

<http://tv.somanuals.com>