



Eat well, drink well and live well with Omega [www.omegajucers.com](http://www.omegajucers.com)

# BL600 SERIES BLENDER

## INSTRUCTION MANUAL



PLEASE READ THESE INSTRUCTIONS CAREFULLY BEFORE USING YOUR BLENDER

Download from [Www.Somanuals.com](http://Www.Somanuals.com). All Manuals Search And Download.

# BLENDER SAFETY

 **DANGER** Electricity





 **GENERAL** Caution

 **DANGER** Risk of Electrical Shock

 **DANGER** Keep Hands Clear



**IMPORTANT:** Please adhere to all safety guidelines contained in this manual.  
**DANGER:** You can be seriously injured if you do not follow these instructions.

 <b>WARNING</b> 	 <b>WARNING</b> 
<p style="text-align: center;"><b>Electrical Shock Hazard</b></p> <p>Plug into a grounded outlet.</p> <p>Do not remove ground.</p> <p>Do not use an adapter.</p> <p>Do not use an extension cord.</p> <p>Failure to follow these instructions can result in death, fire or electrical shock.</p>	<p style="text-align: center;"><b>Moving Parts!</b></p> <p>Always cover the lid on the container when blending.</p> <p>Do not put hands, spoons or other utensils in container when blending.</p> <p>Failure to follow these instructions can result in broken bones, cuts or other injuries.</p>

**FAILURE TO ADHERE TO THESE WARNINGS CAN RESULT IN FIRE,  
SERIOUS INJURY, ELECTRICAL SHOCK AND/OR DEATH**

## Technical Services

For assistance or replacement parts, call  
Technical Service  
24 Hours a Day, 7 Days a Week at  
Toll Free: # 1-877-368-2797

# IMPORTANT SAFEGUARDS

**When using electrical appliances, basic safety precautions should always be followed, including the following:**

1. Read all the instructions before using the blender.
2. Plug into a grounded outlet.
3. Do not remove ground.
4. Do not use an adapter.
5. Do not use an extension cord.
6. To protect against risk of electrical shock, do not put the blender in water or other liquid.
7. Close supervision is necessary when any appliance is used near children.
8. Unplug from outlet when not in use, before putting on or taking off parts, and before cleaning.
9. Avoid contact with moving parts, especially blades.
10. Do not operate any appliance with a damaged cord or plug or after the appliance malfunctions, or is dropped or damaged in any manner. Return appliance to the nearest authorized service facility for examination /repair /electrical or mechanical adjustment, or contact your Omega Distributor.
11. Caution: Keep hands and utensils out of container while blending to reduce the risk of severe injury to persons or damage to the blender. If scraping, folding, etc. is necessary, turn off and unplug the blender, and use a rubber spatula only.
12. Warning: Blades are sharp. Handle carefully.
13. To reduce the personal injury, never place cutting blades on base without jar properly attached.
14. Screw on locking ring firmly. Injury can result if moving blades accidentally become exposed.
15. Always operate blender with lid in place.
16. When blending hot liquids, place a hand towel over the cover. Do not fill blender container beyond 2-3 full. Always begin processing at the lowest speed setting. Keep hands, arms and face away from the feeder cup opening to prevent possible burns.
17. Do not use outdoors.
18. Do not let cord hang over edge of table or counter, or touch hot surfaces.
19. Do not leave blender unattended while it is operating.
20. The use of attachments not approved by Omega may cause injuries.
21. The capacity can be substantially less than normal with thick mixtures.
22. Inspect the container assembly daily. Do not use a broken, chipped or cracked container. Check cutter for wear, nicks or broken blades.
23. This appliance is intended for short period of operation, with a average rated operating time of approximately 3 minutes.
24. This appliance is not intended for use by persons (including Children) with reduced physical, sensory or mental capabilities or lack of experience and knowledge, unless they have been given supervision or instruction concerning the use of the appliance by a person responsible for their safety. Children should be supervised to ensure they do not play with the appliance.

# BLENDER OPERATION

To operate the blender, proceed as follows

1. For the first time user, wash the container assembly, including the lid, before using it. (Refer to "Cleaning Instruction") Do not put the container assembly & blender base assembly in the dishwasher.
2. Place the blender on a dry, clean, level surface, and press OFF.
3. Place the container onto the blender base. Make sure it rests securely on the base.
4. Plug the blender into an electric outlet.
5. Place the ingredients into the container.
4. Place the lid and feeder cap tightly on the container.
7. Press On (On/Off Switch).
8. Select desired speed and time by rotating dials.
9. Press Start.

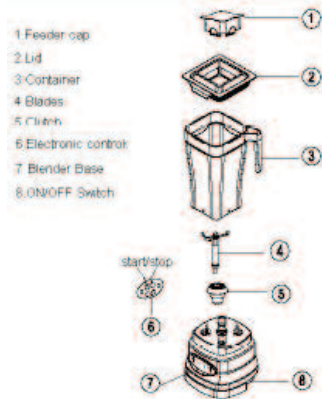

## NOTES

**Pulse Button** – Pressing the pulse button will cause the motor to run for as long as the button is depressed. Removing your finger from the button will cause the motor to stop running and the knife to stop turning.

**Infinity Button** – Pressing this button will cause the motor to run at alternating RPM until the timer expires to thoroughly blend most mixtures.

## PROFESSIONAL BLENDER TIP

### 1. Processing hot liquid

- Always cover the lid and feeder cap before blending hot liquid or mixture.
- Use the feeder cap to add liquids to the container while the unit is running.
- Never stand with your face directly over the container when you are putting ingredient through the feeder cap.

### 2. Blending Icy mixtures

#### ○ Steps for blending ice:

Pour in liquid, and then add ice.

Place the lid.

Set to desired speed

Chunks of frozen fruit can be added to milk or fruit juice to produce a sherbet or slush.

Use the feeder cap to add liquids or ingredients to the container while the unit is running.

# CLEANING INSTRUCTION

**Omega blender container parts are corrosion resistant, sanitary and easily cleaned. Do not put the container assembly & blender base assembly in the dishwasher.**

1. Before first use and after every use, separate container parts from the base.
2. Add cleaning solution to the container. Use washing solution of tepid water (less than 115°F/46°C) and a non-sudsing detergent. Use the recommended amount of detergent.
3. Scrub and flush out the container interior lid and feeder cap to remove food residue. Empty container.
4. Fill container 1 /4 full with fresh washing solution and place it on the base.
5. Replace the lid on the container and run the blender on high speed for 2 minutes.
6. Repeat step 4 using clean rinse water (95°F/35°C).
7. Wipe down the container, feeder cap, and lid with a soft cloth or sponge, dampened with fresh washing solution.
8. Wipe the exterior of the base with a damp cloth or sponge. The base contains electrical components: do not immerse, use a high-pressure washer, or use a dishwasher to clean the base.

# CARING TIPS

**To care for your blender, please read the tips as follows:**

1. Periodically check all parts before reassembly. As use of damaged or non-recommended parts could result in a severe personal injury and/or damage to the blender
2. Blades:  
If the processing blades are stuck or difficult to turn, **DO NOT USE BLENDER** (Check by carefully turning the blades in a counterclockwise direction, where the opposite edges are sharp. Blades should turn freely.)
3. Container:  
If the EASTMAN TRITAN container is cracked, **DO NOT USE BLENDER**, further use could result in the container breakage during use.
4. Blender Base:  
Never immerse the blender base in water. Unplug unit. The housing can be cleaned with a damp cloth.
5. Motor:  
The motor is permanently lubricated and does not require any additional lubrication.
6. Start / Stop:  
When pressing stop do not open the lid and touch the blade, it is dangerous.

# TROUBLESHOOTING

Problem	Solution
1. Blender fails to start.	<ol style="list-style-type: none"><li>1. Place container properly on the base</li><li>2. Check to ensure controls are clean and moving freely.</li><li>3. Double-check to ensure power cord is securely plugged into the electric outlet.</li><li>4. Check to see if the circuit breaker has tripped or if the fuse for the electric outlet has blown.</li><li>4. Check the onboard reset switch located at the rear of the blender base.</li></ol>
2. Stopped	<ol style="list-style-type: none"><li>1. Check the onboard reset switch located at the rear of the blender base.</li><li>2. Unplug blender and wait 5 minutes. Plug the blender back in and resume operation.</li></ol>
3. Ingredients do not mix properly	<ol style="list-style-type: none"><li>1. Container is too full.</li><li>2. Cutter unit blades are not sharp enough or are damaged.</li><li>3. Solid pieces are bigger than 1" (25mm) cubes.</li><li>4. Check the speed to create a fluid blend.</li><li>5. Check to see if enough liquid has been added to the ingredients. Mixture should be fluid and free-running at all times.</li></ol>

# MAINTENANCE

**Inspect the blender and its various parts and replace as follows:**

<b>Daily</b>	<ol style="list-style-type: none"><li>1. Unplug the blender and remove the container from the base.</li><li>2. Inspect the container blades for wear, nicks, and broken or loose blades. Replace if necessary.</li></ol>
<b>Weekly</b>	<ol style="list-style-type: none"><li>1. Unplug the blender.</li><li>2. Inspect the power cord insulation and power plug for cracks. Refer to "Technical Service" for repair or replacement.</li></ol>
<b>Quarterly</b>	<ol style="list-style-type: none"><li>1. Review the condition of the container assembly and Mushroom Clutch Set at least every 90 days.<ol style="list-style-type: none"><li>1. Replace if necessary.</li></ol></li></ol>

## Replacement Parts

For replacement parts, call toll free: #1-877-368-2797



Omega Products, Inc.  
6291 Lyters Lane  
Harrisburg, PA 17111-4523, U.S.A  
PH: (717) 561-1105  
FAX: (717) 561-1298

OMEGA BL600 3 2011 Rev A



## Free Manuals Download Website

<http://myh66.com>

<http://usermanuals.us>

<http://www.somanuals.com>

<http://www.4manuals.cc>

<http://www.manual-lib.com>

<http://www.404manual.com>

<http://www.luxmanual.com>

<http://aubethermostatmanual.com>

Golf course search by state

<http://golfingnear.com>

Email search by domain

<http://emailbydomain.com>

Auto manuals search

<http://auto.somanuals.com>

TV manuals search

<http://tv.somanuals.com>