

QUICK SETUP

Model: HT-S8400

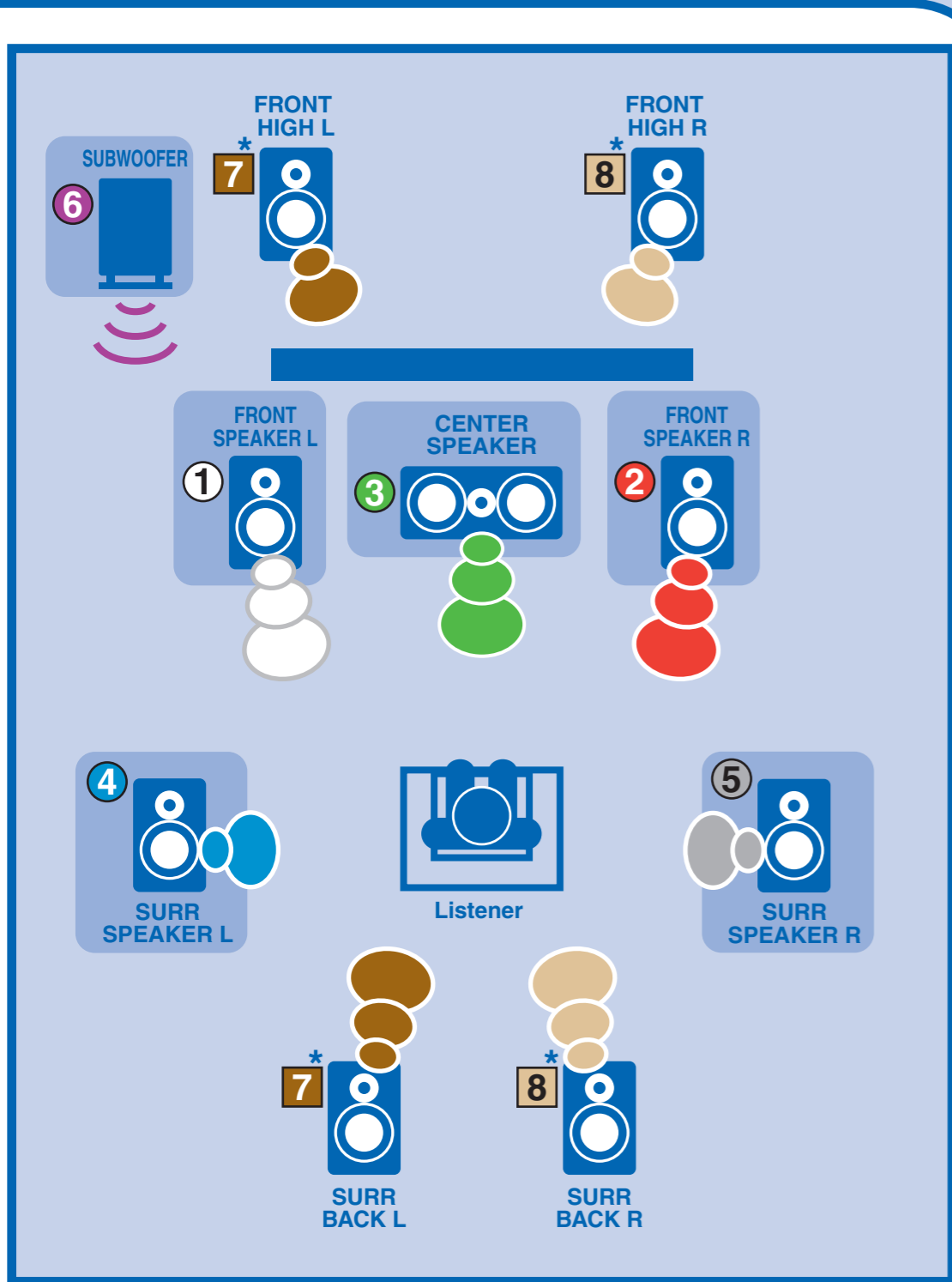

Speaker Configuration

5.1-channel: ① ② ③ ④ ⑤ ⑥
 7.1-channel: ① ② ③ ④ ⑤ ⑥ + ⑦ ⑧

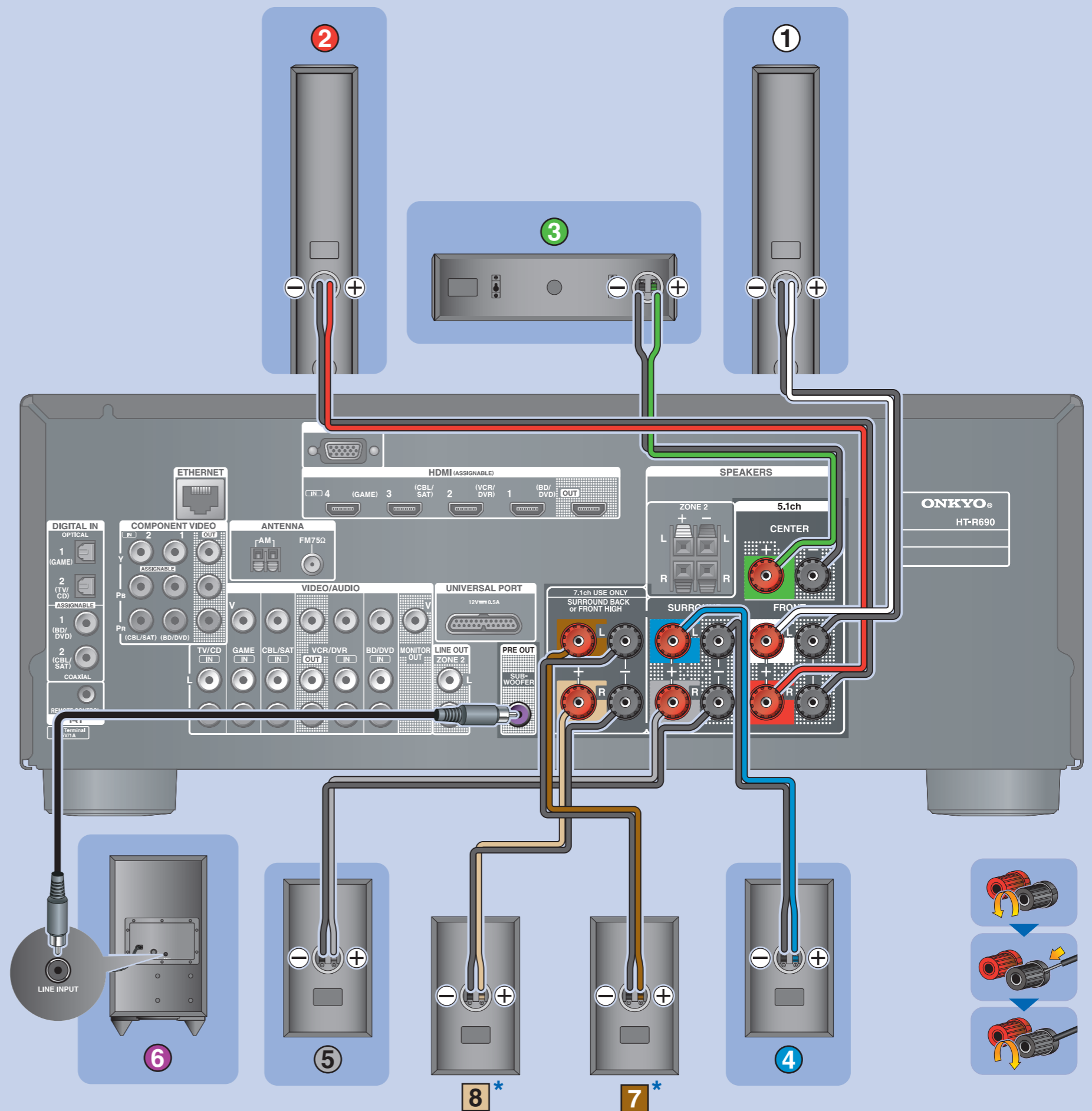

• Please connect ①, ②, ③, ④, ⑤ and ⑥, when connecting 5.1-channel surround.

* Either the SURROUND BACK or FRONT HIGH speakers can be connected to ⑦ and ⑧. Change the settings in accordance with the connected speakers.





Connecting a TV with Audio Return Channel

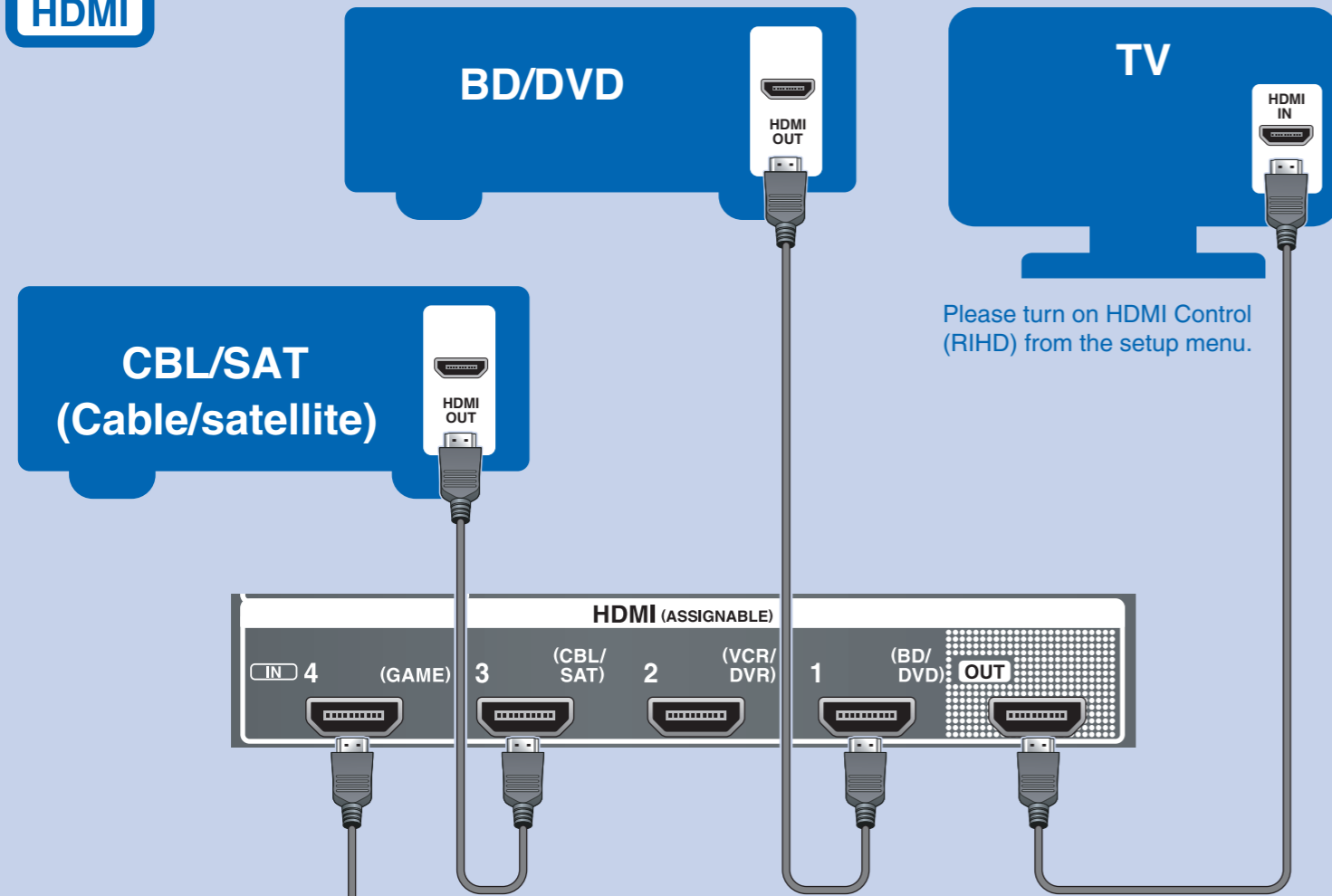

GAME

TV

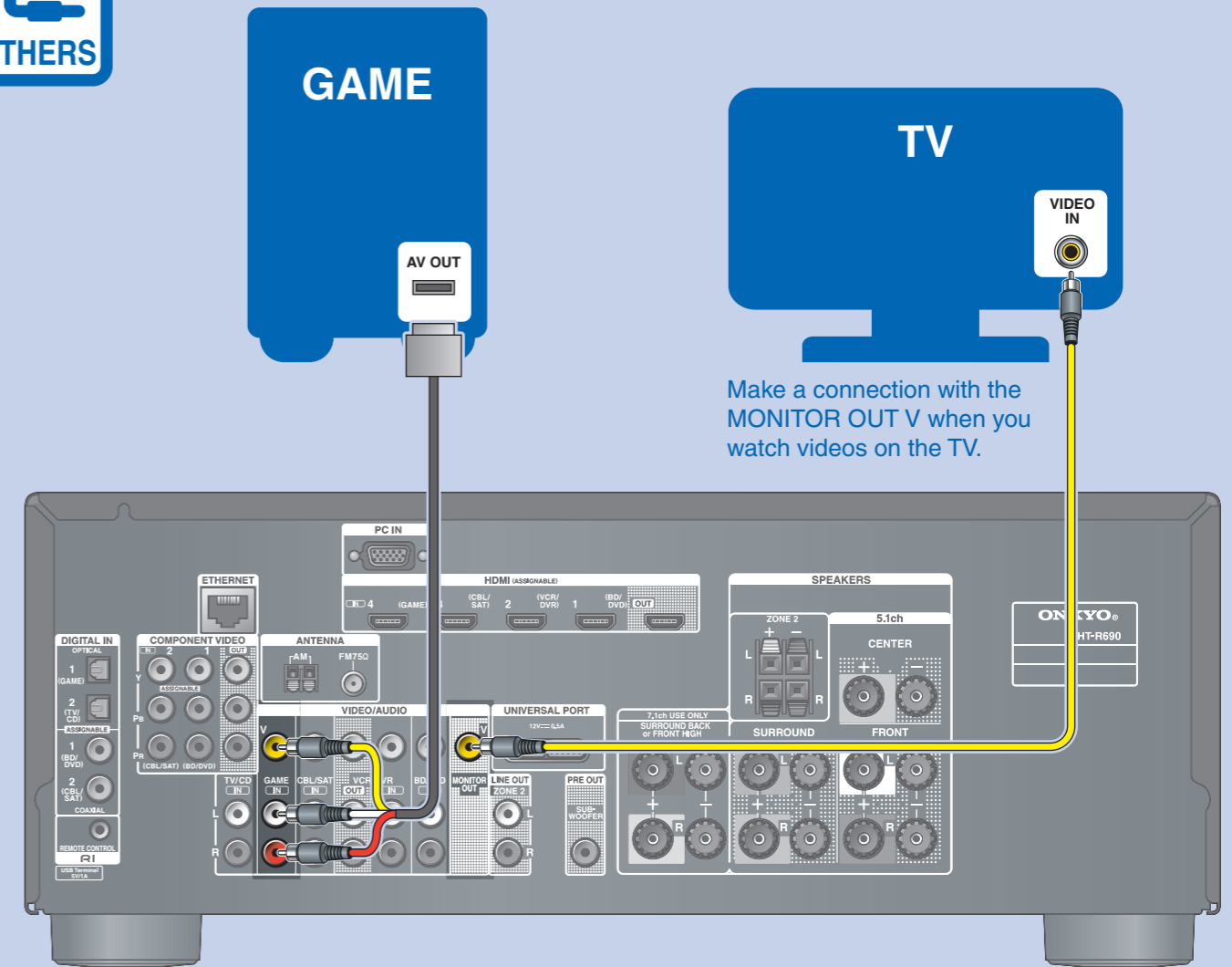

Connecting a TV without Audio Return Channel

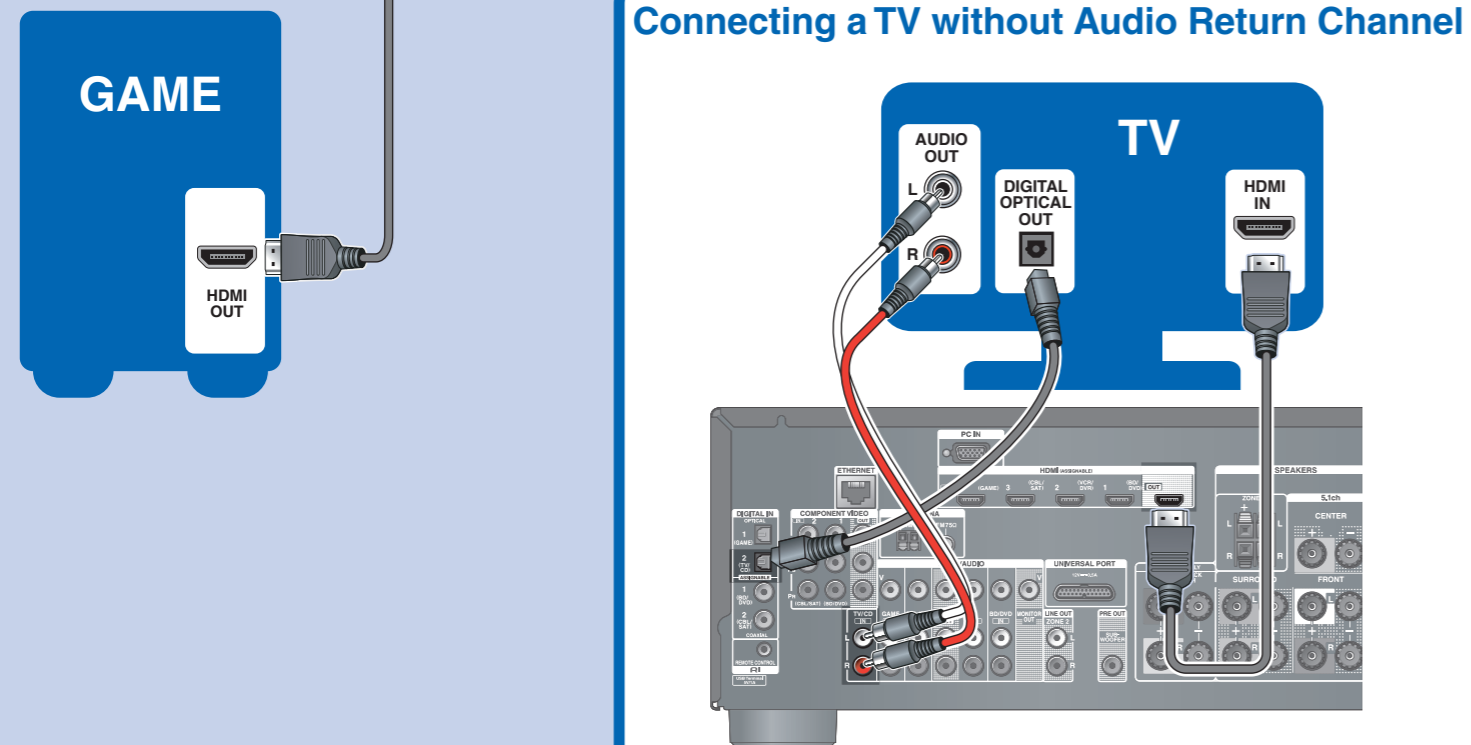

When there is no OPTICAL output in the TV, connect the analog output. The function of HDMI THRU can be used by turning on HDMI Control (RIHD) from the setup menu.

Connecting a UP-A1 with the Port connector

Make a connection with the MONITOR OUT V when you watch videos on the TV.

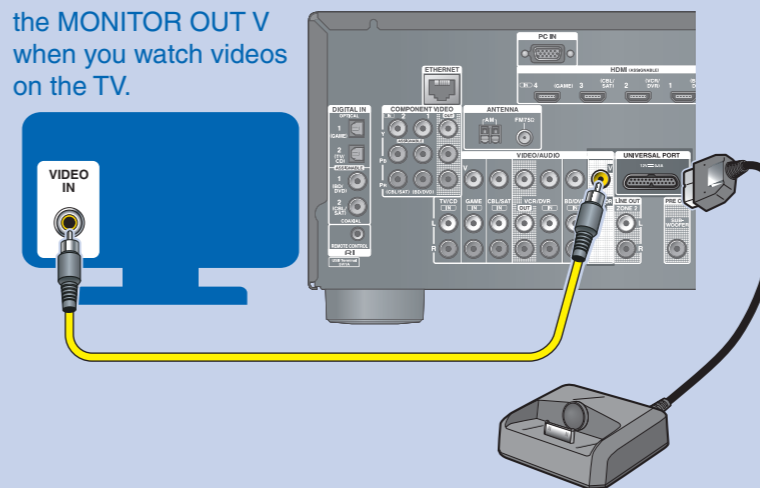

Connecting a Portable Player

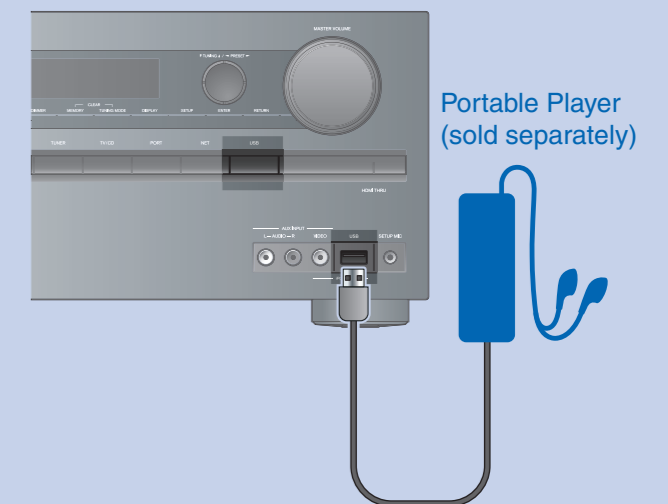

Free Manuals Download Website

<http://myh66.com>

<http://usermanuals.us>

<http://www.somanuals.com>

<http://www.4manuals.cc>

<http://www.manual-lib.com>

<http://www.404manual.com>

<http://www.luxmanual.com>

<http://aubethermostatmanual.com>

Golf course search by state

<http://golfingnear.com>

Email search by domain

<http://emailbydomain.com>

Auto manuals search

<http://auto.somanuals.com>

TV manuals search

<http://tv.somanuals.com>