

QUICK SETUP

Model: HT-S5300

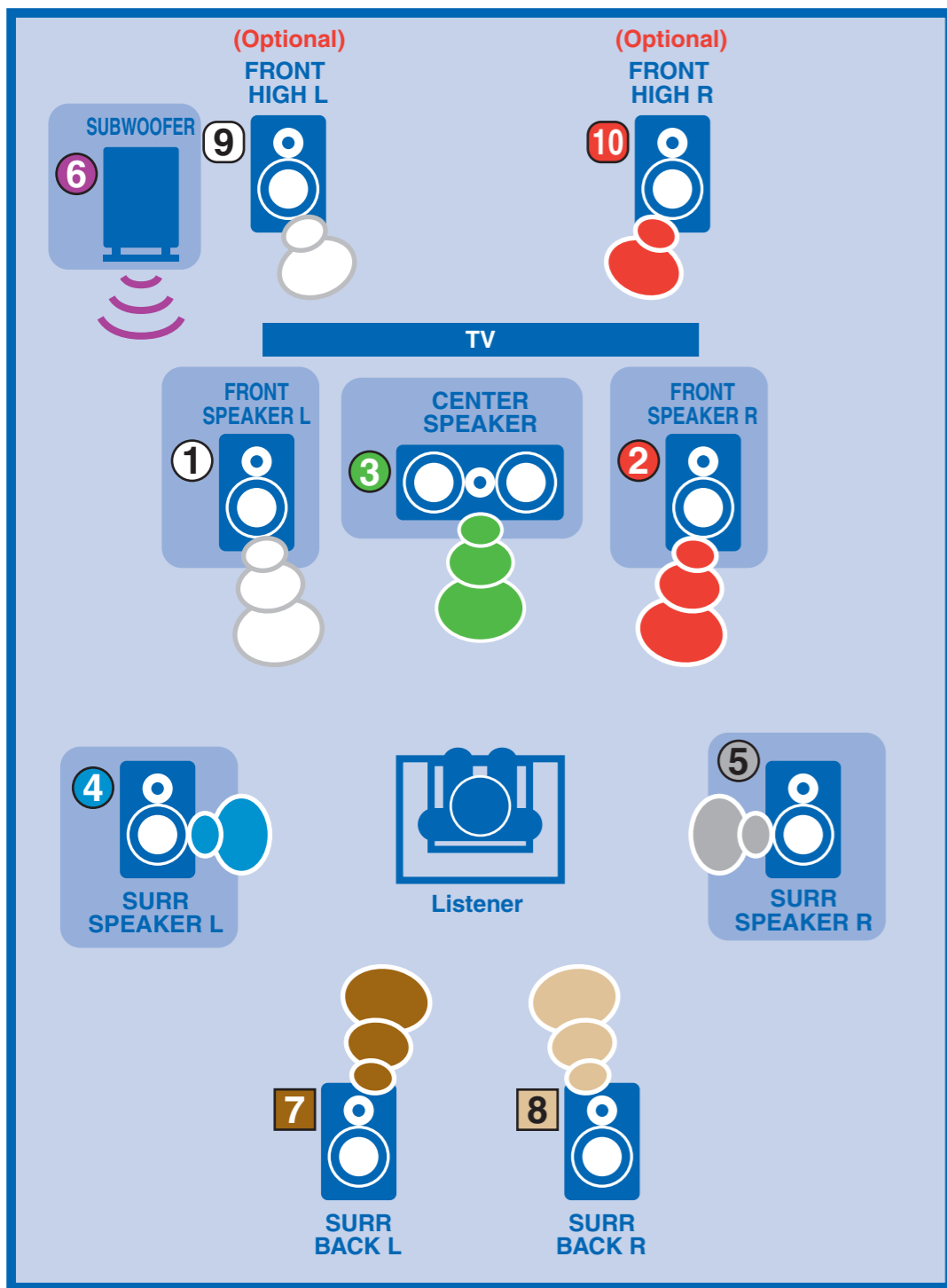

Speaker Configuration

- 5.1-channel: ① ② ③ ④ ⑤ ⑥
- 7.1-channel: ① ② ③ ④ ⑤ ⑥ + ⑦ ⑧
- 7.1-channel: ① ② ③ ④ ⑤ ⑥ + ⑨ ⑩

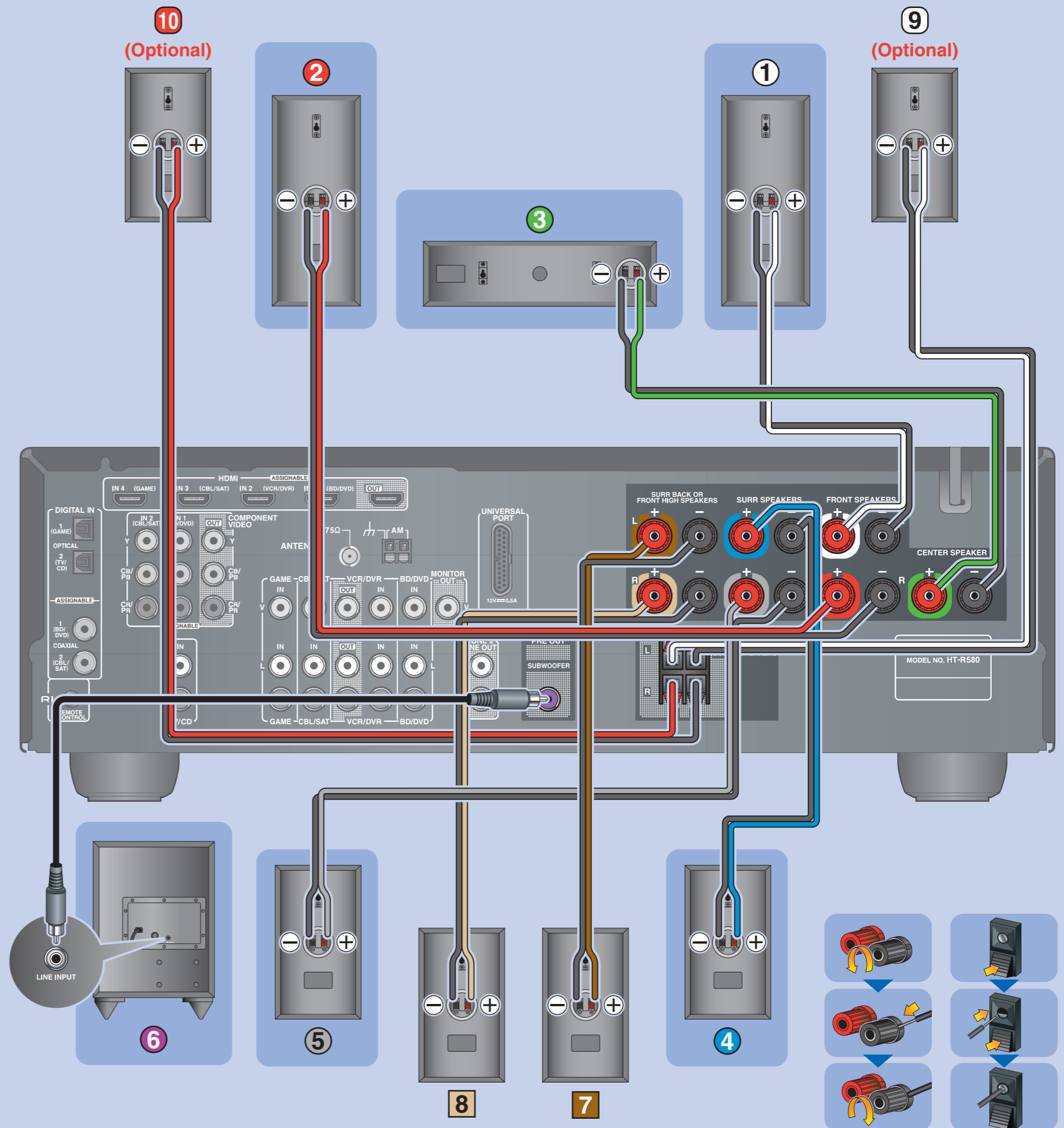

- Please connect ①, ②, ③, ④, ⑤ and ⑥, when connecting 5.1-channel surround.
- When you connect the front high left and right speakers, prepare for it separately, or use the surround back left and right speakers.

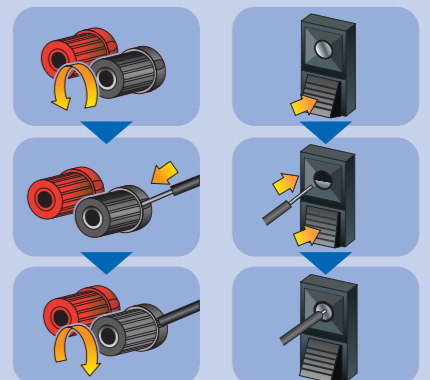



Connecting a TV with Audio Return Channel

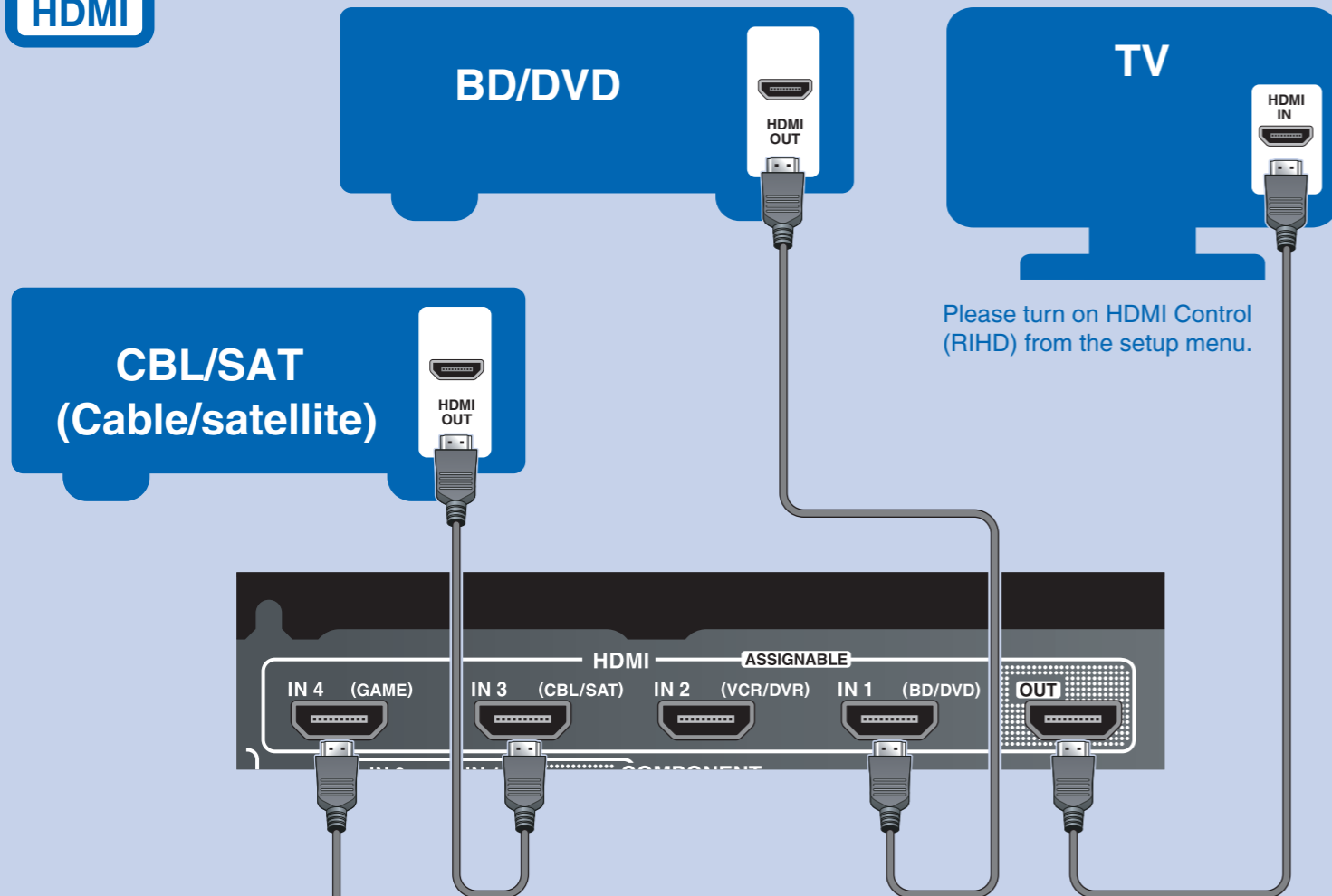

Connecting a TV without Audio Return Channel

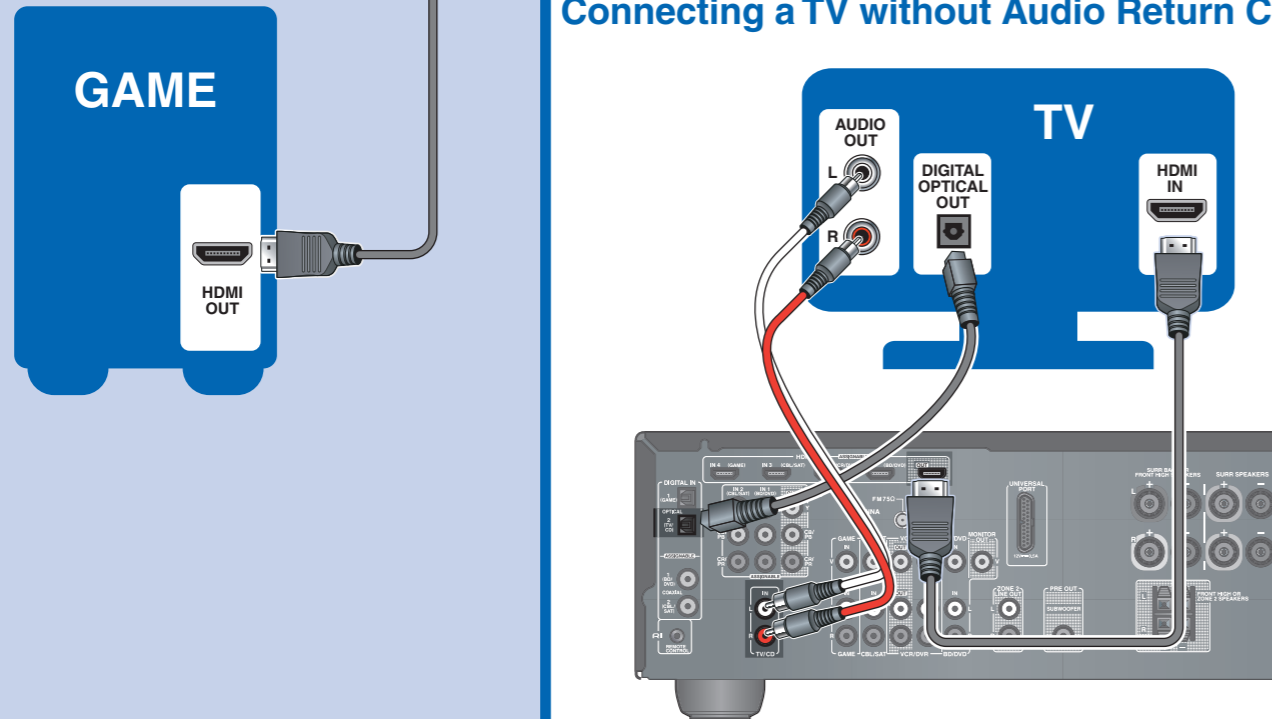

When there is no OPTICAL output in the TV, connect the analog output. The function of HDMI THRU, Power Control and TV Control can be used by turning on HDMI Control (RIHD) from the setup menu.

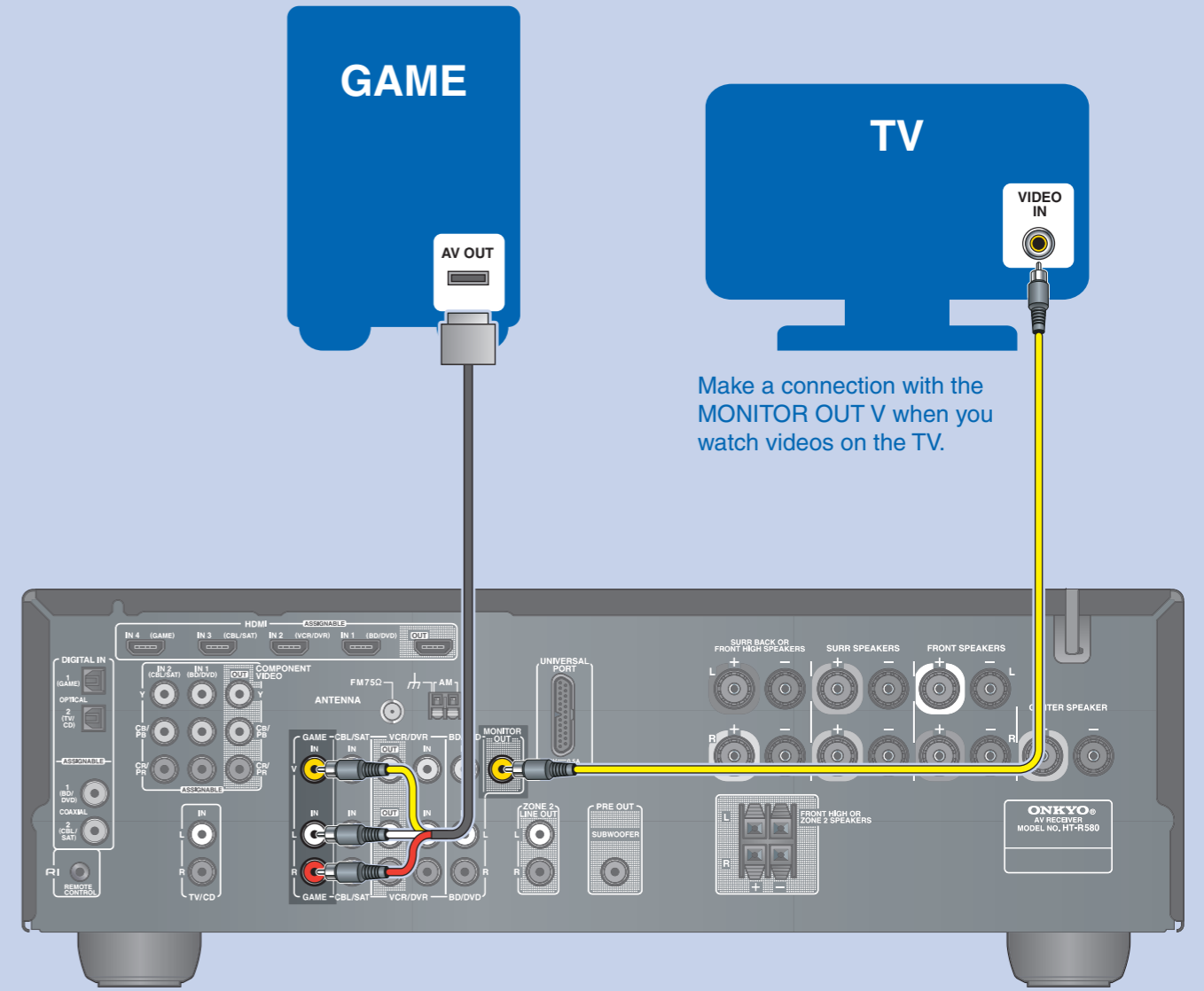

Connecting a UP-A1 with the Port connector

Make a connection with the MONITOR OUT V when you watch videos on the TV.

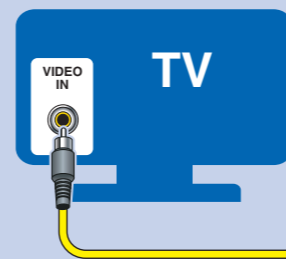

Connecting a Portable Player

iPod (sold separately)

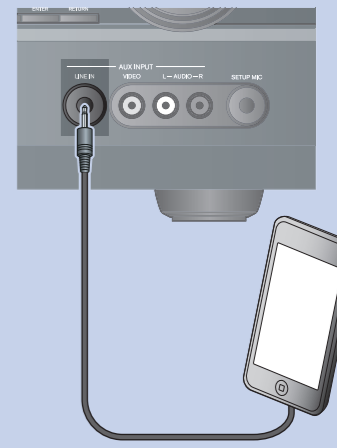
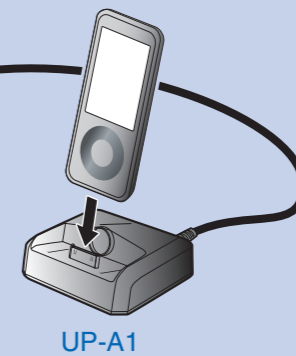

* iPod is a trademark of Apple Inc., registered in the U.S. and other countries.

Free Manuals Download Website

<http://myh66.com>

<http://usermanuals.us>

<http://www.somanuals.com>

<http://www.4manuals.cc>

<http://www.manual-lib.com>

<http://www.404manual.com>

<http://www.luxmanual.com>

<http://aubethermostatmanual.com>

Golf course search by state

<http://golfingnear.com>

Email search by domain

<http://emailbydomain.com>

Auto manuals search

<http://auto.somanuals.com>

TV manuals search

<http://tv.somanuals.com>