

ORECK[®] XL[®]

SIMPLY AMAZING[®]

USER'S GUIDE

Air-7[™]

TABLE TOP AIR PURIFIER

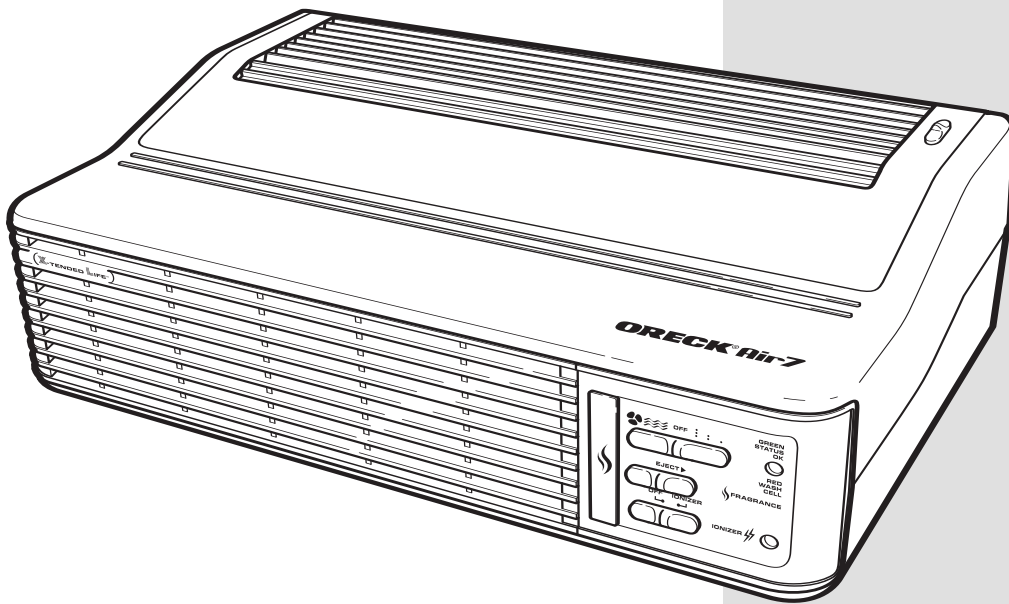

AIR7 Series

• **IMPORTANT** •

SAVE THIS BOOKLET!

Includes:

- Warranty
- Safety Warnings
- Parts List
- Operating Instructions
- Accessories List
- Trouble Diagnosis

BEFORE OPERATING AIR PURIFIER, READ ALL INSTRUCTIONS IN THIS MANUAL CAREFULLY.

Table of Contents

Important Safety Instructions, Polarized Plug Notice, Warranty, Maintenance and Customer Service, Introduction	page 2
How Your Electronic Air Purifier Works, Operation, Instructions	page 3
Cleaning, Replacing the Charcoal Odor Absorber (Optional) , Replacing Cell After Cleaning, Replacing Fragrance Cartridge, Troubleshooting Guide, Accessories	page 4

IMPORTANT SAFETY INSTRUCTIONS

When using an electrical appliance, basic precautions should always be followed, including the following:

READ ALL INSTRUCTIONS BEFORE USING THIS AIR PURIFIER



WARNING

**To reduce the risk of fire,
electric shock, or injury:**

- Do not use outdoors or on wet surfaces.
- Use only as described in this manual.
- Do not use with damaged cord or plug. If appliance is not working as it should, has been dropped, damaged, left outdoors, or dropped into water, return it to a service center or call customer service at:
US: 1-800-989-3535 Canada: 1-888-676-7325
- Do not unplug by pulling on cord. To unplug, grasp the plug, not the cord.
- Do not handle plug or appliance with wet hands.
- Do not put any object into openings. Do not use with any opening blocked; keep free of dust, lint, hair and anything that may reduce air flow.
- Keep hair, loose clothing, fingers and all parts of body away from openings and moving parts.
- Turn off all controls before unplugging.
- Do not use appliance in an enclosed space where oxygen, flammable, explosive or toxic vapors are given off by oil base paint, paint thinner, some mothproofing substances, or in an area where flammable dust is present.

SAVE THESE INSTRUCTIONS

Household Use Only

CAUTION

Installing a wet or even damp collection cell into the air purifier may cause melting of internal components during use.

- DO NOT place a wet or damp collection cell in the air purifier.
- DO NOT wash the charcoal odor absorber. Replace, if necessary.
- Dry the collection cell thoroughly outside of the air purifier before reinstalling it into the air purifier. Ensure that all areas including corners and areas that may trap water are dry before reinstalling into the air purifier.

FOR COMMERCIAL USE:

High voltage from collection cell may cause ignition of flammable or explosive gases/particles in the circulation air.

- DO NOT use in an area that contains flammable or explosive gases/particles in the circulating air.

Polarized Plug Notice

This product is equipped with a polarized alternating current line plug (a plug having one blade wider than the other). This plug will fit into the power outlet only one way. This is a safety feature. If you are unable to insert the plug fully into the outlet, try reversing the plug. If the plug should still fail to fit, contact an electrician to replace the obsolete outlet. Do not defeat the purpose of the polarized plug.

Warranty

ORECK MANUFACTURING COMPANY: (Oreck Manufacturing Company gives you the following limited warranty for this product only if it was originally purchased for residential use, not resale, from Oreck or an Oreck Authorized Retail Dealer.)

Oreck will repair or replace, free of charge, to the original purchaser, any part that is found to be defective in material or workmanship within one (1) year of the date of purchase.

This limited warranty does not cover the replacement of expendable or consumable parts such as filters, cells, cartridges, and other parts subject to normal wear unless they are defective in material or workmanship.

This limited warranty does not apply to any part subjected to accident, abuse, commercial use, alteration, misuse, damage caused by act of God, the use of voltages other than indicated on the serial number displayed on this product or service of this product by other than Oreck or a participating Factory Authorized Service Center.

Oreck does not authorize any person or representative to assume or grant any other warranty obligation with the sale of this product.

Oreck's limited warranty is valid only if you retain proof of purchase from Oreck or an Oreck Authorized Retail Dealer for this product. If you purchase this product from any other source, your purchase is "AS IS," which means Oreck grants you no warranty, and that you, not Oreck, assume the entire risk of the quality and performance of this product, including the entire cost of any necessary servicing or repairs of any defects.

Oreck's liability for damages to you for any costs whatsoever arising out of this statement of limited warranty shall be limited to the amount paid for this product at the time of original purchase, and Oreck shall not be liable for any direct, indirect, consequential or incidental damages arising out of the use or inability to use this product.

Some states do not allow the exclusion or limitation of incidental or consequential damages, so the above limitation or exclusion may not apply to you.

ALL EXPRESS AND IMPLIED WARRANTIES FOR THIS PRODUCT, INCLUDING IMPLIED WARRANTIES OF MERCHANTABILITY AND FITNESS FOR A PARTICULAR PURPOSE, ARE LIMITED IN DURATION TO THE WARRANTY PERIOD, AND NO WARRANTIES, WHETHER EXPRESS OR IMPLIED, WILL APPLY AFTER THIS PERIOD.

Some states do not allow limitations on the duration of implied warranties, so the above limitation may not apply to you.

This warranty gives you specific legal rights, and you may also have other rights which vary from state to state.

Maintenance and Customer Service

Your Oreck Air Purifier is a product of precise engineering. If you require additional information or have problems with your Oreck appliance, you may call ORECK customer service at:

US: 1-800-989-3535 Canada: 1-888-676-7325

Please specify the model number and serial/code number which can be found on the data plate on the back of the Air Purifier.

Save your sales or purchase slip. Should your Oreck appliance require warranty service in the U.S.A., present this slip to the Authorized Service Center as your proof of purchase date or, in Canada, call customer service.

Introduction

The air you breathe is filled with thousands of particles of air pollution. Some of the pollutants like dust and lint are large enough to be visible to the naked eye, but pollutants such as pollen, smoke, germs, bacteria, etc., are microscopic in size. Your electronic air purifier has been designed to trap and remove visible and invisible pollutants and provide your home or office with the luxury of clean air living.

Airborne particles and odors are removed from air passing through the unit by the process of electrostatic precipitation and an activated charcoal odor absorber. The fragrance feature releases a pleasant aroma with the newly cleaned air.

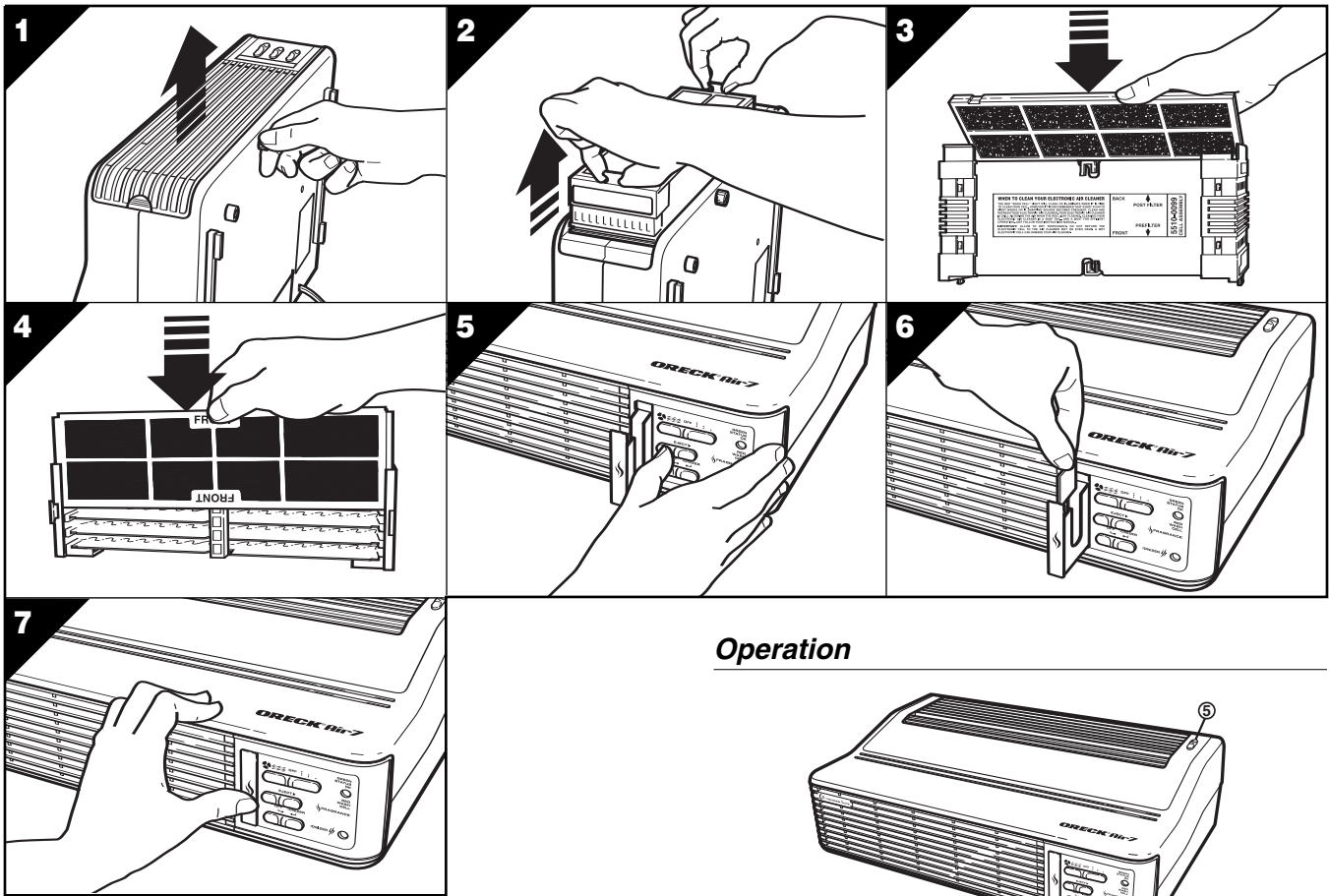

How Your Electronic Air Purifier Works

Polluted air enters the air purifier through the front grill. As the air is pulled through, a pre-filter helps trap large particles (hair, lint, etc.). Then an electronic ionizer electrostatically charges smaller particles (dust, smoke, pollen). The positive charged particles then enter the negatively charged electronic cell, where the aluminum plates attract and retain the particles. It works like a powerful magnet and the particles remain until the electronic cell is cleaned. The air then passes through a charcoal odor absorber that helps remove household odors. Next, the negative ion generator releases negative ions to freshen the air. Finally, electronically cleaned air passes back into the room through the top grill.

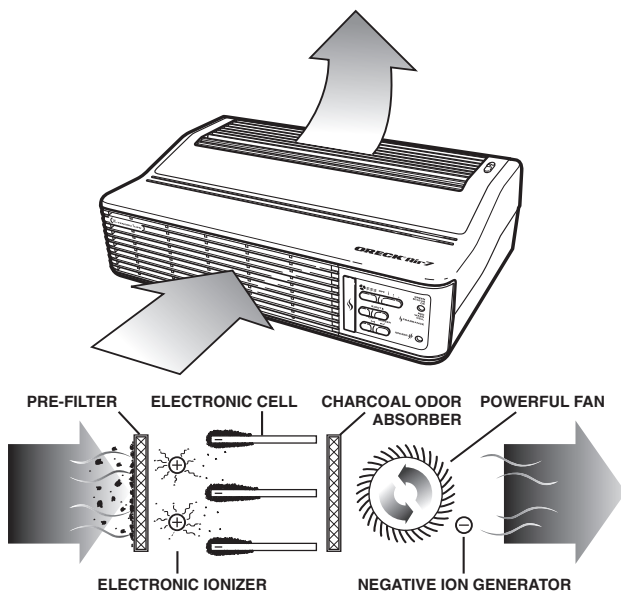

Operation

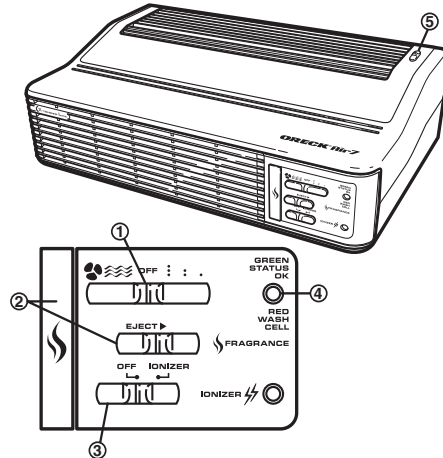

- 1. MAIN POWER SWITCH:** Turn the unit on by sliding the power switch to the blower speed you prefer: High (⦿) for maximum cleaning - Medium (⦿) for normal use - Low (⦿) for quiet operation.
- 2. FRAGRANCE CARTRIDGE:** Fragrance compartment switch ejects drawer for access to fragrance cartridge. Insert fragrance cartridge and close drawer. One fragrance cartridge included.
- 3. IONIZER POWER SWITCH:** Turns the ionizer ON or OFF. The indicator light will glow green when ON and functioning properly.
- 4. POWER INDICATOR LIGHT:** The indicator light will glow green when the unit is operating normally. It will flash red when the collector cell requires cleaning. **NOTE: The light will glow red for a moment when unit is first turned on. This is normal and only a test of the system.**
- 5. AIR DIRECTION CONTROL:** Slide switch on top of unit controls the louvers and enables you to direct airflow to desired areas.

NOTE: You may notice an occasional infrequent sharp snapping sound coming from your unit. This is a normal occurrence called "arcing" and results as large particles of dust are collected in the ionizing-collecting cell. Should prolonged or continuous arcing occur, the ionizing-collecting cell should be thoroughly cleaned and dried completely (See "Cleaning Collector Cell").

Instructions

WARNING: DO NOT USE THIS ELECTRONIC AIR PURIFIER WHEN OXYGEN TANKS ARE BEING USED OR IN THE PRESENCE OF COMBUSTIBLE GASES.

IMPORTANT NOTES:

- Your air purifier works best if you leave it in operation all the time.
- Place or mount the air purifier near a standard electrical outlet. Do not block either the air intake or outlet grill.
- Never place your air purifier on soft surfaces (such as bed, sofas or carpet), near computers or next to sources of heat (such as stove tops, ovens, etc.)
- Make sure the front grill is securely locked in place.
- A safety switch is installed behind the grill of your electronic air purifier. If the grill is not properly secured in place, the unit will not operate. If your unit fails to operate, remove the front grill and reinstall it, being sure that the lower right-hand side of the grill (next to the control panel) is firmly locked in place.
- Plug the power cord into the nearest available standard electrical outlet. (See data label on bottom of your air purifier for electrical specifications and power consumption.)
- Do not use an extension cord to supply power to your air purifier.

Cleaning

The Cabinet

You can clean the air purifier cabinet with mild, non-abrasive cleanser and a soft cloth. **IMPORTANT: Unplug the unit from its electrical power source. Do not spray cleansers or furniture polish into the louver or grill areas.**

Collector Cell

Indicator light is green under normal operation and flashes red when the cell requires cleaning. To clean, proceed as follows:



The red "WASH CELL" light will flash or illuminate when it is time to clean your cell. However, it is recommended that every four to eight weeks or if snapping sounds become frequent, clean your electronic air purifier. Your electronic air purifier is still filtering the air when the red light illuminates. Cleaning your electronic air purifier is a snap too... and a must for efficient operation.

1. Turn the unit off and unplug it from the electric power source. If wall mounted, remove unit from wall.
2. Remove front grill by unscrewing the retainer screw under the grill on the cabinet bottom. (fig. 1)
3. Pull the cell out of the cabinet by using the two small handles on the front of the cell. (fig. 2)
4. Snap off the charcoal odor absorber from the back of the cell. Change as necessary for continued odor removal. (fig. 3)
5. Slide off pre-filter. This can be cleaned with the cell and reused. (fig. 4)

NOTE: Handle the electronic cell with care. Damaged metal plates and/or broken wires will cause the air purifier to malfunction. (Do not wash charcoal odor absorber; it is disposable.)

Cleaning with Assail-A-Cell® Cell Cleaner:

6. Using Assail-A-Cell® Cleaner, thoroughly saturate the cell and pre-filter. Be sure to spray between each cell plate and cover every surface. Allow product to soak for a few minutes, not allowing it to dry. Rinse thoroughly with water. For extremely heavy deposits, repeat the process.

IMPORTANT: Dry the collection cell thoroughly outside of the air purifier before reinstalling it into the air purifier. Ensure that all areas including corners and areas that may trap water are dry before reinstalling into the air purifier. DO NOT place a wet or damp collection cell in the air purifier.

Replacing the Charcoal Odor Absorber (Optional)

In addition to air purification, your Oreck provides the additional benefit of odor removal. The odor removal function is optional. Your Oreck Air Purifier will continue to remove harmful airborne particles with its permanent electronic collector cell even if you choose not to use the optional charcoal odor absorber.

Odor absorption effectiveness will gradually deteriorate over time unless the charcoal odor absorber is replaced. While every environment is different, Oreck suggests that the charcoal odor absorber be replaced

every two months or as needed. **IMPORTANT: DO NOT** wash the charcoal odor absorber. Replace, if necessary.

Replacing Cell After Cleaning

1. Snap in the charcoal odor absorber. (fig. 3)
2. Slide in the pre-filter. (fig. 4)
3. Slide cell into cabinet, using handles. (fig. 2)
4. Replace front grill. Unit is now ready for operation. (fig. 1)

NOTE: An occasional "arcing" sound is normal when operating the unit immediately after cleaning the cell and should stop after a few minutes of operation.

Replacing Fragrance Cartridge

1. Open cartridge compartment by sliding the compartment release switch. (fig. 5)
2. Remove fragrance disk from center of cartridge and replace with a new one. (fig. 6)
3. Close compartment until it locks. (fig. 7)

NOTE: One fragrance cartridge is included.

Troubleshooting Guide

Service problems that appear to be major can often be solved easily. You can be your own troubleshooter by reviewing the chart below. It pinpoints problems and how to correct them. Remember, check the simple things first.

PROBLEM	CHECK	WHAT TO DO
UNIT DOES NOT TURN ON	1. Power Cord	1. Plug in power cord
	2. Selector Switch	2. Set selector switch for desired blower speed.
	3. Front Grill	3. Reinsert front grill until it is flush with cabinet front. Tap grill lightly, if necessary, to fully insert.
INDICATOR LIGHT ON UNIT IS FLASHING RED OR HAS TURNED RED	Ionizer/collector cell	Wash ionizer/collector cell. Make sure it is thoroughly clean & dry before re-installing it.
UNIT DOES NOT REMOVE POLLUTANTS	Ionizer/collector cell	Wash cell
UNIT SPARKS, CRACKLES AND POPS	Ionizer/collector cell	A little is normal. Make sure the cell is thoroughly dry before re-installing it. If it persists, clean cell. If that doesn't help, cell may be damaged and needs replacing.
DOES NOT REMOVE ODOR	Old Charcoal Odor Absorber	Replace Charcoal Odor Absorber.
UNIT STILL DOES NOT OPERATE PROPERLY	Check all the above points	Return unit to the Service Center.

ALL OTHER SERVICING SHOULD BE DONE BY AN ORECK AUTHORIZED SERVICE CENTER.

**CALL CUSTOMER SERVICE HOT LINE
US: 1-800-989-3535 Canada: 1-888-676-7325**

Whenever calling, please be sure to have your model and serial number from data plate.

Accessories

ITEM	PART #
1. Pre-Filter	7780-8041
2. Ionizer/Collector Cell	09-5510-7065
3. Charcoal Odor Absorber (Set of 4)	AT4PK7
4. Wall Mounting Kit	8660-0201
5. Oreck Fresh Air® Scent Cartridges	
Spring Mulberries®, 8pk.	FA2PK
Blooming Jasmine®, 8pk.	FA3PK

Free Manuals Download Website

<http://myh66.com>

<http://usermanuals.us>

<http://www.somanuals.com>

<http://www.4manuals.cc>

<http://www.manual-lib.com>

<http://www.404manual.com>

<http://www.luxmanual.com>

<http://aubethermostatmanual.com>

Golf course search by state

<http://golfingnear.com>

Email search by domain

<http://emailbydomain.com>

Auto manuals search

<http://auto.somanuals.com>

TV manuals search

<http://tv.somanuals.com>