

Operating Instructions



(CQ-C1121W)



Matsushita Electric Industrial Co., Ltd.
Web Site: <http://www.panasonic.co.jp/global/>

YFM284C450ZB TAMACO1104-1124 Printed in China

Before Reading These Instructions

Panasonic welcomes you to our constantly growing family of electronic products owners. We endeavor to give you the advantages of precise electronic and mechanical engineering, manufactured with carefully selected components, and assembled by people who are proud of the reputation their work has built for our company. We know this product will bring you many hours of enjoyment, and after you discover the quality, value and reliability we have built into it, you too will be proud to be a member of our family.

Differences between 3 models

This operating instruction manual is for 3 models CQ-C1121W, CQ-C1101W and CQ-C1001W. All illustrations throughout this manual represent model CQ-C1121W unless otherwise specified. The following table describes the differences among 3 models.

Features	Models	CQ-C1121W	CQ-C1101W	CQ-C1001W
Volume control		Rotary knob	Rotary knob	Button
Remote control function		Yes (Included)	No	No
Pre-amp. output connector		Rear/Front	Rear	Rear

Accessories

	Operating Instructions (English: YFM284C450ZA) (Русский: YFM284C451ZA) (한국어: YFM284C452ZA) (YFM284C453ZA: عربي)		Remote Control Unit (include a battery, only for CQ-C1121W) (EUR7641020)		Mounting Collar * (FX0214C384ZA)
	Installation Instructions (YFM284C449ZA)		Lock Cancel Plate (FX0214C385ZA)		Trim Plate * (YFC054C081ZA: CQ-C1121/1101W) (YFC054C079ZA: CQ-C1001W)
	Q'ty: 1 set		Mounting Bolt (YEJV014C002N)		Power Connector (YEAJ02877)
	Q'ty: 1		Rubber Bushing (YFS014C095ZA)		Q'ty: 1

Notes:

- The number in parentheses underneath each accessory part name is the part number for maintenance and service.
- Accessories and their part numbers are subject to modification without prior notice due to improvements.
- Mounting Collar and Trim Plate are mounted on the main unit at shipment. *

Preparation

Battery Installation

Pull the insulation film out from the backside of the remote control gently.

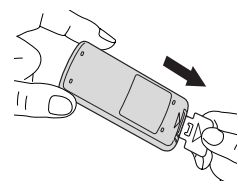

Note: Battery Information:
Battery Type: Panasonic lithium battery (CR2025) (Included in the remote control)
Battery Life: Approximately 6 months under normal use (at room temperature)

The 24-hour system is used for the clock.

1 Turn the ignition switch until the accessory indicator lights.



2 Press [SRC] (PWR: Power).

3 Press [DISP] (CLOCK).
Adj FM

4 Hold down [DISP] (CLOCK) for more than 2 seconds.
000 FM

5 Adjust the hour.

000 FM

[>]: sets the hour ahead.
[<]: sets the hour back.

6 Press [DISP] (CLOCK).

000 FM

7 Adjust the minute.

0:15 FM

[>]: sets the minute ahead.
[<]: sets the minute back.

8 Press [DISP] (CLOCK).

0:15 FM

Notes:

- "Adj" is displayed before adjusting the clock.
- Hold down [<] or [>] to change numbers rapidly.

Clock Display at Power Off

Press [DISP] (Display) to change the display.

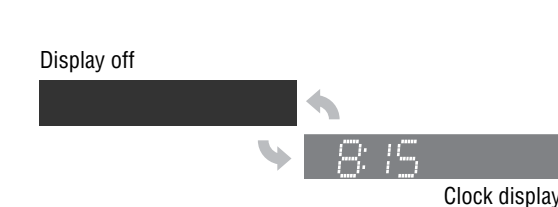

Clock Setting

Maintenance

Cleaning the Unit

Your product is designed and manufactured to ensure the minimum of maintenance. Use a soft cloth for routine exterior cleaning. Never use benzine, thinner, or other solvents.

Fuse

If the replaced fuse fails, contact your nearest authorized Panasonic Service center.

Warning

- Use fuses of the same specified rating (15 A). Using substitutes or fuses with higher ratings, or connecting the unit directly without a fuse could cause fire or damage to the unit. If the replaced fuse fails, contact your nearest authorized Panasonic Service Center.

Anti-Theft System

This unit is equipped with a removable face plate. Removing this face plate makes the unit totally inoperable.

Face Plate Removing/Mounting (Anti-Theft System)

Caution

- This face plate is not waterproof. Do not expose it to water or excessive moisture.
- Do not remove the face plate while driving your car.
- Do not place the face plate on the dashboard or nearby areas where the temperature rises high.
- Do not touch the contacts on the face plate and the main unit, since this may result in poor electrical contact.
- If dirt or other foreign substances get on the contacts, wipe them off with a clean and dry cloth.

Removing

- Turn off the power.
- Press [↑]. The removable face plate will open.
- Pull it out toward you.

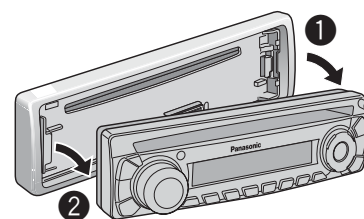

Mounting

- Slide the left side of the removable face plate in place.
- Press the right end of removable face plate until a "click" is heard.

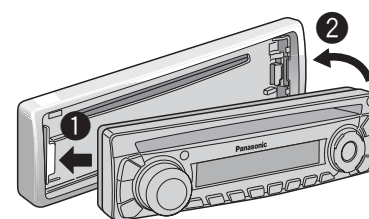

Safety Information

Read the operating instructions for the unit and all other components of your car audio system carefully before using the system. They contain instructions about how to use the system in a safe and effective manner. Panasonic assumes no responsibility for any problems resulting from failure to observe the instructions given in this manual.

This manual uses pictographs to show you how to use the product safely and to alert you to potential dangers resulting from improper connections and operations. The meanings of the pictographs are explained below. It is important that you fully understand the meanings of the pictographs in order to use this manual and the system properly.



This pictograph intends to alert you to the presence of important operating instructions and installation instructions. Failure to heed the instructions may result in severe injury or death.



This pictograph intends to alert you to the presence of important operating instructions and installation instructions. Failure to heed the instructions may result in injury or material damage.

Warning

Observe the following warnings when using this unit.

- The driver should neither watch the display nor operate the system while driving. Watching the display or operating the system will distract the driver from looking ahead of the vehicle and can cause accidents. Always stop the vehicle in a safe location and use the parking brake before watching the display or operating the system.
- Use the proper power supply. This product is designed for operation with a negative grounded 12 V DC battery system. Never operate this product with other battery systems, especially a 24 V DC battery system.
- Keep batteries and insulation film out of reach of infants. Batteries and insulation film can be ingested, so keep them out of the reach of infants. If an infant ingests a battery or insulation film, please seek immediate medical attention.
- Protect the Deck Mechanism. Do not insert any foreign objects into the slot of this unit.
- Do not disassemble or modify the unit. Do not disassemble, modify the unit or attempt to repair the product yourself. If the product needs to be repaired, consult your dealer or an authorized Panasonic Service Center.
- Do not use the unit when it is out of order. If the unit is out of order (no power, no sound) or in an abnormal state (has foreign objects in it, is exposed to water, is smoking, or smells), turn it off immediately and consult your dealer.
- The remote control unit should not be about in the car. If the remote control unit lies about, it could fall on the floor while driving, get wedged under the brake pedal, and lead to a traffic accident.
- Refer fuse replacement to qualified service personnel. When the fuse blows out, eliminate the cause and have it replaced with the fuse prescribed for this unit by a qualified service engineer. Incorrect replacement of the fuse may lead to smoke, fire, and damage to the product.
- This manual uses pictographs to show you how to use the product safely and to alert you to potential dangers resulting from improper connections and operations. The meanings of the pictographs are explained below. It is important that you fully understand the meanings of the pictographs in order to use this manual and the system properly.
- Disconnect the lead from the negative (-) battery terminal before installation. Wiring and installation with the negative (-) battery terminal connected may cause electrical shock and injury due to a short circuit. Some cars equipped with the electrical safety system have specific procedures of battery terminal disconnection. FAILURE TO FOLLOW THE PROCEDURE MAY LEAD TO THE UNINTENDED ACTIVATION OF THE ELECTRICAL SAFETY SYSTEM RESULTING IN DAMAGE TO THE VEHICLE AND PERSONAL INJURY OR DEATH.
- Never use safety-related components for installation, grounding, and other such functions. Do not use safety-related vehicle components (fuel tank, brake, suspension, steering wheel, pedals, airbag, etc.) for wiring or fixing the product or its accessories.
- Installing the product on the air bag cover or in a location where it interferes with airbag operation is prohibited.
- Check for piping, gasoline tank, electric wiring, and other items before installing the product. If you need to open a hole in the vehicle chassis to attach or wire the product, first check where the wire harness, gasoline tank, and electric wiring are located. Then open the hole from outside if possible.
- Never install the product in a location where it interferes with field of vision.
- Never have the power cord branched to supply other equipment with power.
- After installation and wiring, you should check the normal operation of other electrical equipment. The continuation of their using in abnormal conditions may cause fire, electrical shock or a traffic accident.
- In the case of installation to an airbag-equipping car, confirm warnings and cautions of the vehicle manufacturer before installation.
- Make sure the leads do not interfere with driving or getting in and out of the vehicle.
- Insulate all exposed wires to prevent short circuiting.

Specifications

General

Power supply	:12 V DC (11 - 16 V DC), negative ground
Current consumption	:Less than 2.2 A (CD mode; 0.5 W 4 channels)
Maximum power output	:50 W x 4 (at 1 kHz), volume control maximum (for CQ-C1121/C1101W) :45 W x 4 (at 1 kHz), volume control maximum (for CQ-C1001W)
Tone adjustment range	:Bass: ±12 dB at 100 Hz, Treble: ±12 dB at 10 kHz :4 - 8 Ω
Speaker impedance	:2.5 V (CD mode, 1 kHz, 0 dB)
Pre-amp output voltage	:200 Ω
Pre-amp output impedance	:178 x 50 x 160 mm
Dimensions (W x H x D)	:1.3 kg
Weight	

CD Player

Sampling frequency	:8 times oversampling
DA converter	:1 bit DAC System
Pick-up type	:Astigma 3-beam
Light source	:Semiconductor laser
Wave length	:790 nm
Frequency response	:20 Hz - 20 kHz (±1 dB)
Signal to noise ratio	:96 dB
Total harmonic distortion	:0.01 % (1 kHz)
Wow and flutter	:Below measurable limits
Channel separation	:75 dB

FM Stereo Radio

Frequency range	:87.5 MHz - 108 MHz
Usable sensitivity	:6 dB(μV (75 Ω))
Frequency response	:30 Hz - 15 kHz (±3 dB)
Alternate channel selectivity	:75 dB
Stereo separation	:35 dB (1 kHz)
Image rejection ratio	:75 dB
IF rejection ratio	:100 dB
Signal to noise ratio	:62 dB

AM Radio

Frequency range	:531 kHz - 1 602 kHz
Usable sensitivity	:28 dB(μV (S/N 20 dB))

Note:

- Specifications and design are subject to modification without notice due to improvements.
- Some figures and illustrations in this manual may be different from your product.

Caution

Observe the following cautions when using this unit.

- Keep the sound volume at an appropriate level. Keep the volume level low enough to be aware of road and traffic conditions while driving.
- This unit is designed for use exclusively in automobiles.
- Do not operate the unit for a prolonged period with the engine turned off. Operating the audio system for a long period of time with the engine turned off will drain the battery.
- Do not expose the unit to direct sunlight or excessive heat. Otherwise these will raise the interior temperature of the unit, and it may lead to smoke, fire, or other damage to the unit.
- Do not use the product where it is exposed to water, moisture, or dust. Exposure of the unit to water, moisture, or dust may lead to smoke, fire, or other damage to the unit. Make especially sure that the unit does not get wet in car washes or on rainy days.

Observe the following cautions when installing.

- Refer wiring and installation to qualified service personnel. Installation of this unit requires special skills and experience. For maximum safety, have it installed by your dealer. Panasonic is not liable for any problems resulting from your own installation of the unit.
- Follow the instructions to install and wire the product. Not following the instructions to properly install and wire the product could cause an accident or fire.
- Take care not to damage the leads. When wiring, take care not to damage the leads. Prevent them from getting caught in the vehicle chassis, screws, and moving parts such as seat rails. Do not scratch, pull, bend or twist the leads. Do not run them near heat sources or place heavy objects on them. If leads must be run over sharp metal edges, protect the leads by winding them with vinyl tape or similar protection.
- Use the designated parts and tools for installation. Use the supplied or designated parts and appropriate tools to install the product. The use of parts other than those supplied or designated may result in internal damage to the unit. Faulty installation may lead to an accident, a malfunction or fire.
- Do not block the air vent or the cooling plate of the unit. Blocking these parts will cause the interior of the unit to over-heat and will result in fire or other damage.

Caution

THIS PRODUCT UTILIZES A CLASS I LASER. USE OF CONTROLS OR ADJUSTMENTS OR PERFORMANCE OF PROCEDURES OTHER THAN THOSE SPECIFIED HEREIN MAY RESULT IN HAZARDOUS RADIATION EXPOSURE. DO NOT OPEN COVERS AND DO NOT REPAIR YOURSELF. REFER SERVICING TO QUALIFIED PERSONNEL.

General

CO-C1121W **CO-C1101W**
[VOL] (Volume) (Turn)

CO-C1001W
[VOLUME▲] **[VOLUME▼]** (Press)
 adjusts the volume.

Remote Control Sensor
 (only for CQ-C1121W)

[D•M] (Direct Memory)
 tunes into the station memorized in D•M.
 (Hold it down for more than 2 seconds to
 memorize the current station.)

[SRC] (Source)
 selects a source.
(PWR) (Power)
 toggles power on/off.

[MUTE]
 toggles mute on/off.

lights when mute is on.

[SQ] (Sound Quality)
 selects a sound type (SQ).

Power On/Off
 Turn your car's ignition switch to the ACC or ON position.
Power on: Press **[SRC]** (**PWR**).
Power off: Hold down **[SRC]** (**PWR**) for
 more than 1 second.

Source Selection
 Press **[SRC]** to change the source.
Radio → **Disc Player**

Volume Adjustment
 (Setting Range: 0 to 40, Default: 18)
CO-C1121W **CO-C1101W**
 Turn **[VOL]**.
CO-C1001W
 Press **[VOLUME▲]** or **[VOLUME▼]**.

Mute
ON: Press **[MUTE]**. (**MUTE** lights.)
OFF: Press **[MUTE]** again.

SQ (Sound Quality)
 SQ is a function that can call up various sound types at
 the touch of button in accordance with your listening
 music type.
 Press **[SQ]** to select the sound type as follows:

(FLAT) flat frequency response:
 does not emphasize any part. (Default)

(ROCK) speedy and heavy sound:
 exaggerates bass and treble.

(POP) wide-ranged and deep sound:
 slightly emphasizes bass and treble.

(VOCAL) clear sound:
 emphasizes middle tone and slightly empha-
 sizes treble.

Note: Settings of SQ, bass and treble are influenced
 one another. If such an influence causes distortion to
 the audio signal, readjust bass/treble or volume.

Remote Control Unit (only for CQ-C1121W)

Note: This operating instruction manual explains operations for use with the buttons on the main unit. (Different operations excluded)

[PWR] (POWER)
 toggles power on/off.

[MODE]
 selects a mode. (source)

[MUTE]
 toggles mute on/off.

[VOL▲] [VOL▼]
 adjust the volume.

[BAND]
 selects a band in the radio source,
 toggles pause/play in the player source,
 and executes APM in the radio source.
 (Hold it down for more than 2 seconds.)

[TUNE<] [TUNE>]
 down/up the frequency. (Hold it down for
 more than 2 seconds for seek tuning.)
[TRACK◀] [TRACK▶]
 skip to the previous/next track in the
 player mode.
 Hold it down for fast reverse/fast forward.

Battery Replacement

Warning
 • Keep batteries away from children to avoid the risk of
 accidents. If an infant ingests a battery, please seek
 immediate medical attention.

Caution
 • Remove and dispose of the old battery immediately.
 • Do not disassemble, heat or short a battery. Do not
 throw a battery into a fire or water.
 • Follow local regulations when disposing of a battery.
 • Improper use of batteries may cause overheating, an
 explosion or ignition, resulting in injury or a fire.

Note: Battery Information:
 Battery Type: Panasonic lithium battery (CR2025) (Included
 in the remote control)
 Battery Life: Approximately 6 months under normal use (at
 room temperature)

1 Remove the battery holder
 with the remote control unit
 placed on a flat surface.
 1 Stick your thumbnail into
 the groove, and push the
 holder in the direction of
 the arrow at the same
 time.
 2 Pull it out in the direction
 of the arrow using a
 tough pointed object.

2 Put a battery in the case
 with (+) -side facing up.
 3 Put the case back.

Radio (FM/AM)

[BAND]
 selects a band in the radio source.
(APM) (Auto Preset Memory)
 executes APM in the radio source. (Hold it
 down for more than 2 seconds.)

[D•M] (Direct Memory)
 tunes into the station memorized in D•M.
 (Hold it down for more than 2 seconds to
 memorize the current station.)

[DISP] (Display)
 switches the information on
 the display.

[SRC] (Source)
 selects a source.

Preset buttons [1] to [6]
 selects a preset station in the radio source,
 and presets the current station. (Hold it down
 for more than 2 seconds.)

[TUNE<] [TUNE>]
 down/up the frequency. (Hold it down for
 more than 2 seconds for seek tuning.)

Operation Flow

1 Press **[SRC]** to select the radio source.
 2 Press **[BAND]** to select a band.
 3 Select a station.

Frequency adjustment
[TUNE<]: Lower
[TUNE>]: Higher
Note: Hold down either of them for more than 0.5
 seconds and release it for station search.

Preset station selection
 Press the corresponding preset button from **[1]** to **[6]** to
 tune in a preset station.

Radio Source Display

lights while receiving an FM stereo signal.

Frequency Band Preset Number

lights while receiving the D•M station.

Display change
 Press **[DISP]** to change the display.

Radio source display (Default)

Clock display

Station Preset

Up to 6 stations can be preset in AM, FM1, FM2, and FM3
 respectively.
 Preset stations can be simply called up by pressing one of the
 preset buttons from **[1]** to **[6]**.

Auto Preset Memory (APM)
 With this operation, stations with good receiving conditions can
 be automatically stored in the preset memory.

1 Select a band.
 2 Hold down **[BAND]** (**APM**) for more than 2
 seconds.

The preset stations under best receiving conditions are
 received for 5 seconds each after presetting the stations
 (SCAN). To stop scanning, press one of the preset but-
 tons from **[1]** to **[6]**.

Note: New stations overwrite existing saved stations.

Manual station preset
 1 Tune into a station.
 2 Hold down one of the preset buttons from
[1] to **[6]** for more than 2 seconds.

Note: New stations overwrite existing saved stations.

Direct Memory

You can assign your favorite broadcasting station to the
[D•M] (Direct Memory) button. As the result of doing that,
 your favorite broadcasting station can be received even if the
 unit is turned off, or the CD mode is activated.

D•M station writing
 1 Select a station you would like to preset.
 2 Hold down **[D•M]** for more than 2 seconds.

D•M station calling
 1 Press **[D•M]**.
 Press again to cancel.

Audio Settings

CO-C1121W **CO-C1101W**
[VOL]
 selects a value in the audio menu.
(PUSH SEL) (Push to Select)
 selects items in the audio menu.

CO-C1001W
[▲] or **[▼]**
 selects a value in the audio menu.
[SEL] (Select)
 selects items in the audio menu.

[DISP] (Display)
 exits from the audio menu.

Audio menu

1 Display the audio menu.
CO-C1121W **CO-C1101W**
 Press **[VOL]** (**PUSH SEL**).
CO-C1001W
 Press **[SEL]**.

2 Select a mode to be adjusted.
CO-C1121W **CO-C1101W**
 Press **[VOL]** (**PUSH SEL**).
CO-C1001W
 Press **[SEL]**.

3 Adjust.
CO-C1121W **CO-C1101W**
 Turn **[VOL]**.
CO-C1001W
 Press **[▲]** or **[▼]**.

Volume
 (Setting Range: 0 to 40, Default: 18)

Bass
 (Setting Range: -12 dB to +12 dB by 2 dB,
 Default: 0 dB)

Treble
 (Setting Range: -12 dB to +12 dB by 2 dB,
 Default: 0 dB)

Balance
 (Setting Range: 15 levels each and 0 (center),
 Default 0)

Fader
 (Setting Range: 15 levels each and 0 (center),
 Default 0)

Note: If the fader is set to front, the pre-amp. output
 (rear) is decreased.

Disc Player

Disc slot
 takes a disc in with the label-side facing up.
Note: The power will be turned on automatically
 when a disc is loaded.

[TRACK◀] [TRACK▶]
 skip to the previous/next track in the player
 mode.
 Hold down either of them for fast reverse/fast
 forward.

[Eject]
 ejects the disc.

[DISP] (Display)
 switches the information on
 the display.

[SRC] (Source)
 selects a source.

[1] to [6]
(7) to (12) (Hold down one of them for
 more than 2 seconds.)
 select a track directly.

[REP] (Repeat)
 toggles on/off the repeat play.
(RANDOM)
 toggles on/off the random play. (Hold it down
 for more than 2 seconds.)

(SCAN)
 toggles on/off the scan play. (Hold it down for
 more than 2
 seconds.)

Caution

- Do not insert a disc when the indicator lights.
- Refer to the section of "Notes on Discs".
- This unit does not support 8 cm discs.
- If you insert an 8 cm disc and cannot eject it, turn ACC of your car off once and turn it on again, then press **[Eject]**.
- This unit does not support MP3 and WMA disc playback.
- This unit does not support CD text display.
- Do not insert foreign matter into the disc slot.

Operation Flow

1 Press **[SRC]** to select the Disc Player
 source.
 2 Select a desired portion.

Track selection
 Press **[TRACK◀] / [TRACK▶]**.

Note: To perform fast forward/reverse, hold down either
 of them.

Pause
 Press **[BAND]** (**II / ▶**).
 Press again to cancel.

Direct track selection
 Press a track number button from **[1]** to **[6]**.
 • The corresponding track (1-6) starts playing.
 Hold down a track number button from **[1]**
 to **[6]** (**(7) to (12)**) for more than 2 seconds.
 • The corresponding track (7-12) starts playing.

Player Source Display

Random indicator
 Play time
 Track number
 Repeat indicator

lights when a disc is in the player.

Display change
 Press **[DISP]** to change the display.

Player source display (Default)

Clock display

Random play
 All the available tracks are played in a random sequence.
 Hold down **[REP]** (**RANDOM**) for more than 2
 seconds.
 Hold down again to cancel.

Repeat play
 The current track is repeated.
 Press **[REP]**.
 Press again to cancel.

Scan play
 The first 10 seconds of each track is played in sequence.
 Hold down **[SQ]** (**SCAN**) for more than 2
 seconds.
 (blinks during scanning.)
 Hold down again to cancel.

Notes on CD/CD Media

If you use commercial CDs, they must
 have the label shown at right.
 Some copy-protected music CDs are not
 playable.

How to hold a disc

- Do not touch the underside of a disc.
- Do not scratch on a disc.
- Do not bend a disc.
- When not in use, keep a disc in a case.

Do not use irregularly shaped discs.
Do not leave discs in the following places:

- In direct sunlight
- Near car heaters
- Dirty, dusty and damp areas
- Seats and dashboards

Disc cleaning
 Use a dry, soft cloth to wipe from the center outward.
Do not attach any seals or labels to your discs.
**Do not write on the disc label with a ballpoint pen
 or other hard-point pens.**

Notes on CD-Rs/RWs

- You may have trouble playing back some CD-R/W discs
 recorded using CD recorders (CD-R/W drives), either due
 to their recording characteristics or dirt, fingerprints,
 scratches, etc. on the disc surface.
- CD-R/W discs are less resistant to high temperatures and
 high humidity than ordinary music CDs. Leaving them
 inside a car for extended periods may damage and make
 playback impossible.
- Some CD-R/Ws cannot be played back successfully due
 to incompatibility among writing software, a CD recorder
 (CD-R/W drive) and the discs.
- This player cannot play the CD-R/W discs if the session is
 not closed.
- This player cannot play the CD-R/W discs which contain
 other than CD-DA data (MP3/WMA, Video CD, etc.).
- Be sure to observe the instructions of the CD-R/W disc
 for handling it.

Troubleshooting

If You Suspect Something Wrong
 Check and take steps as described below.
 If the described suggestions do not solve the problem, it is recom-
 mended to take the unit to your nearest authorized Panasonic Service
 Center. The product should be serviced only by qualified personnel.
 Please refer the checking and the repair to professionals. Panasonic
 shall not be liable for any accidents arising out of neglect of checking
 the unit or your own repair after your checking.

Warning

- Do not use the unit in an irregular condition, for example, with-
 out sound, or with smoke or a foul smell, which can cause
 ignition or electric shock. Immediately stop using the unit and
 consult your dealer.
- Never try to repair the unit by yourself because it is dangerous
 to do so.

Trouble	Check point	Trouble	Check point
Common			
No power	Start the engine. (Or turn the ignition switch to the ACC position.)	No sound, or disc is automatically ejected	Load the disc correctly.
	Verify the wiring. (Ex. battery lead, power lead, ground lead, etc.)		Clean the disc.
	Fuse blown (Contact the nearest Panasonic Service Center.)	Sound skip, poor sound quality	Clean the disc.
No sound	Disable the mute function.	Sound skip due to vibration	The maximum permissible tilt angle is 30°.
	Verify the wiring.		Secure the unit.
Noise	Wait until the dew disappears before turning on the unit.	Disc not ejectable	Press [▲] . If the disc is still not ejected, contact the nearest Panasonic Service Center.
	Make sure that grounding is established properly.		
No sound from left, right, front, or rear speaker	Adjust the balance and fader.	Error Display Messages	
Left and right sounds are reversed	Verify the wiring.	E1	(The disc is ejected automatically.) The disc is dirty, or is upside down. The disc has scratches.
	Connect the speaker lead correctly.	E2	Check the disc.
Radio			
Frequent noise	Tune in to another station of high-intensity waves.	E3	No operation by some cause.
	Make sure that the antenna mounted point is grounded properly.		If normal operation is not restored, call the store where you purchased the unit or the nearest Service Center to ask for repairs.
Preset data deleted	The preset memory is cleared to return to the original factory setting when the power connector or battery is disconnected.		

Free Manuals Download Website

<http://myh66.com>

<http://usermanuals.us>

<http://www.somanuals.com>

<http://www.4manuals.cc>

<http://www.manual-lib.com>

<http://www.404manual.com>

<http://www.luxmanual.com>

<http://aubethermostatmanual.com>

Golf course search by state

<http://golfingnear.com>

Email search by domain

<http://emailbydomain.com>

Auto manuals search

<http://auto.somanuals.com>

TV manuals search

<http://tv.somanuals.com>