

■ Read the operating instructions for the unit and all other components of your car audio system carefully before using the system. They contain instructions about how to use the system in a safe and effective manner. Panasonic assumes no responsibility for any problems resulting from failure to observe the instructions given in this manual.

■ This manual uses pictographs to show you how to use the product safely and to alert you to potential dangers resulting from improper connections and operations. The meanings of the pictographs are explained below. It is important that you fully understand the meanings of the pictographs in order to use this manual and the system properly.



**Warning**

This pictograph intends to alert you to the presence of important operating instructions and installation instructions. Failure to heed the instructions may result in severe injury or death.



**Caution**

This pictograph intends to alert you to the presence of important operating instructions and installation instructions. Failure to heed the instructions may result in injury or material damage.

## Warning

Observe the following warnings when using this unit.

- ❑ **The driver should neither watch the display nor operate the system while driving.**  
Watching the display or operating the system will distract the driver from looking ahead of the vehicle and can cause accidents. Always stop the vehicle in a safe location and use the parking brake before watching the display or operating the system.
- ❑ **Use the proper power supply.**  
This product is designed for operation with a negative grounded 12 V DC battery system. Never operate this product with other battery systems, especially a 24 V DC battery system.
- ❑ **Keep batteries and insulation film out of reach of infants.**  
Batteries and insulation film can be ingested, so keep them out of the reach of infants. If an infant ingests a battery or insulation film, please seek immediate medical attention.
- ❑ **Protect the Deck Mechanism.**  
Do not insert any foreign objects into the slot of this unit.
- ❑ **Do not disassemble or modify the unit.**  
Do not disassemble, modify the unit or attempt to repair the product yourself. If the product needs to be repaired, consult your dealer or an authorized Panasonic Service Center.
- ❑ **Do not use the unit when it is out of order.**  
If the unit is out of order (no power, no sound) or in an abnormal state (has foreign objects in it, is exposed to water, is smoking, or smells), turn it off immediately and consult your dealer.
- ❑ **The remote control unit should not lie about in the car.**  
If the remote control unit lies about, it could fall on the floor while driving, get wedged under the brake pedal, and lead to a traffic accident.
- ❑ **Refer fuse replacement to qualified service personnel.**  
When the fuse blows out, eliminate the cause and have it replaced with the fuse prescribed for this unit by a qualified service engineer. Incorrect replacement of the fuse may lead to smoke, fire, and damage to the product.

Observe the following warnings when installing.

- ❑ **Disconnect the lead from the negative (-) battery terminal before installation.**  
Wiring and installation with the negative (-) battery terminal connected may cause electrical shock and injury due to a short circuit.  
Some cars equipped with the electrical safety system have specific procedures of battery terminal disconnection.  
**FAILURE TO FOLLOW THE PROCEDURE MAY LEAD TO THE UNINTENDED ACTIVATION OF THE ELECTRICAL SAFETY SYSTEM RESULTING IN DAMAGE TO THE VEHICLE AND PERSONAL INJURY OR DEATH.**
- ❑ **Never use safety-related components for installation, grounding, and other such functions.**  
Do not use safety-related vehicle components (fuel tank, brake, suspension, steering wheel, pedals, airbag, etc.) for wiring or fixing the product or its accessories.
- ❑ **Installing the product on the air bag cover or in a location where it interferes with airbag operation is prohibited.**
- ❑ **Check for piping, gasoline tank, electric wiring, and other items before installing the product.**  
If you need to open a hole in the vehicle chassis to attach or wire the product, first check where the wire harness, gasoline tank, and electric wiring are located. Then open the hole from outside if possible.
- ❑ **Never install the product in a location where it interferes with your field of vision.**
- ❑ **Never have the power cord branched to supply other equipment with power.**
- ❑ **After installation and wiring, you should check the normal operation of other electrical equipment.**  
The continuation of their using in abnormal conditions may cause fire, electrical shock or a traffic accident.
- ❑ **In the case of installation to an airbag-equipping car, confirm warnings and cautions of the vehicle manufacturer before installation.**
- ❑ **Make sure the leads do not interfere with driving or getting in and out of the vehicle.**
- ❑ **Insulate all exposed wires to prevent short circuiting.**



## Caution

Observe the following cautions when using this unit.

- ❑ **Keep the sound volume at an appropriate level.**  
Keep the volume level low enough to be aware of road and traffic conditions while driving.
- ❑ **This unit is designed for use exclusively in automobiles.**
- ❑ **Do not operate the unit for a prolonged period with the engine turned off.**  
Operating the audio system for a long period of time with the engine turned off will drain the battery.
- ❑ **Do not expose the unit to direct sunlight or excessive heat.**  
Otherwise these will raise the interior temperature of the unit, and it may lead to smoke, fire, or other damage to the unit.
- ❑ **Do not use the product where it is exposed to water, moisture, or dust.**  
Exposure of the unit to water, moisture, or dust may lead to smoke, fire, or other damage to the unit. Make especially sure that the unit does not get wet in car washes or on rainy days.

Observe the following cautions when installing.

- ❑ **Refer wiring and installation to qualified service personnel.**  
Installation of this unit requires special skills and experience. For maximum safety, have it installed by your dealer. Panasonic is not liable for any problems resulting from your own installation of the unit.
- ❑ **Follow the instructions to install and wire the product.**  
Not following the instructions to properly install and wire the product could cause an accident or fire.
- ❑ **Take care not to damage the leads.**  
When wiring, take care not to damage the leads. Prevent them from getting caught in the vehicle chassis, screws, and moving parts such as seat rails. Do not scratch, pull, bend or twist the leads. Do not run them near heat sources or place heavy objects on them. If leads must be run over sharp metal edges, protect the leads by winding them with vinyl tape or similar protection.
- ❑ **Use the designated parts and tools for installation.**  
Use the supplied or designated parts and appropriate tools to install the product. The use of parts other than those supplied or designated may result in internal damage to the unit. Faulty installation may lead to an accident, a malfunction or fire.
- ❑ **Do not block the air vent or the cooling plate of the unit.**  
Blocking these parts will cause the interior of the unit to overheat and will result in fire or other damage.
- ❑ **Do not install the product where it is exposed to strong vibrations or is unstable.**  
Avoid slanted or strongly curved surfaces for installation. If the installation is not stable, the unit may fall down while driving and this can lead to an accident or injury.

## Installation Angle

The product should be installed in a horizontal position with the front end up at a convenient angle, but not more than 30°. The user should bear in mind that in some areas there may be restrictions on how and where this unit must be installed. Consult your dealer for further details.

- ❑ **Wear gloves for safety. Make sure that wiring is completed before installation.**
- ❑ **To prevent damage to the unit, do not connect the power connector until the whole wiring is completed.**
- ❑ **Do not connect more than one speaker to one set of speaker leads. (except for connecting to a tweeter)**

Observe the following cautions when handling the battery for the remote control unit.

- Use only specified battery (CR2025).
- Match the polarity of the battery with the (+) and (-) marks in the battery case.
- Replace dead battery as soon as possible.
- Remove the battery from the remote control unit when not using it for an extended period of time.
- Insulate the battery (by placing them in a plastic bag or covering them with vinyl tape) before disposal or storage.
- Dispose of the battery according to the local regulations.
- Do not disassemble, recharge, heat or short the battery. Do not throw a battery into a fire or water.

## In case of battery leakage

- Thoroughly wipe the battery liquid off the battery case and insert new battery.
- If any part of your body or clothing comes into contact with battery liquid, wash it with plenty of water.
- If battery liquid comes into contact with your eyes, wash them with plenty of water and get immediate medical attention.

# Safety Information (continued)

## Caution

THIS PRODUCT IS A CLASS 1 LASER PRODUCT. USE OF CONTROLS OR ADJUSTMENTS OR PERFORMANCE OF PROCEDURES OTHER THAN THOSE SPECIFIED HEREIN MAY RESULT IN HAZARDOUS RADIATION EXPOSURE. DO NOT OPEN COVERS AND DO NOT REPAIR BY YOURSELF. REFER SERVICING TO QUALIFIED PERSONNEL.

Panasonic welcomes you to our constantly growing family of electronic products owners. We endeavor to give you the advantages of precise electronic and mechanical engineering, manufactured with carefully selected components, and assembled by people who are proud of the reputation their work has built for our company. We know this product will bring you many hours of enjoyment, and after you discover the quality, value and reliability we have built into it, you too will be proud to be a member of our family.

## Features

### Large-sized volume control

A large-sized rotary volume control that looks like one belonging to a Hi-Fi audio system is featured.

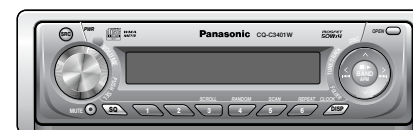

### SQ (Sound Quality)

SQ is a function that can call up various sound types at the touch of button in accordance with your listening music type.



### MP3/WMA Playback from CD-R/RW

(MP3/WMA Player → Page 14)

### CD Changer Option

You can connect the optional Panasonic CD changer unit (CX-DP880). For details, refer to the operating instructions for the CD changer unit.

## Contents

### Common

Safety Information .....	2
Features .....	5
Contents .....	5
Accessories .....	6
Remote Control Unit .....	6
Preparation .....	7
General .....	8

### Each source

Radio .....	10
Before Disc Playback .....	12
CD Player .....	13
MP3/WMA Player .....	14
Notes on MP3/WMA .....	16
CD Changer Control .....	18

### As needed

Audio Settings .....	20
Function Settings .....	22
Anti-Theft System .....	24
Fuse .....	25
Maintenance .....	25
Notes on Discs .....	25
Troubleshooting .....	26
Specifications .....	31

# Accessories

<b>Operating Instructions</b> (YEFM285617) Q'ty: 1	<b>Installation Instructions</b> (YEFM293960) (YEFM293961) Q'ty: 2	<b>Lock Cancel Plate</b> Q'ty: 2	<b>Mounting Bolt</b> Q'ty: 1	<b>Rubber Bushing</b> Q'ty: 1	<b>Power Connector</b> (YEAJ02877) Q'ty: 1
<b>Instruction kit</b>		<b>Installation kit (YEPOFZ5698)</b>			
<b>Trim Plate</b> (YEFM051003) Q'ty: 1	<b>Mounting Collar</b> (YEFM0217263) Q'ty: 1	<b>Removable Face Plate Case</b> (YEFM131839) Q'ty: 1	<b>Remote Control Unit</b> (includes a battery) (EUR7641010) Q'ty: 1		

**Note:**

- The number in parentheses underneath each accessory part name is the part number for maintenance and service.
- Accessories and their parts numbers are subject to modification without prior notice due to improvements.
- Trim Plate and Mounting Collar are mounted on the main unit at shipment.

# Remote Control Unit

- This instruction manual explains operations for use with the buttons on the main unit. (Different operations excluded)

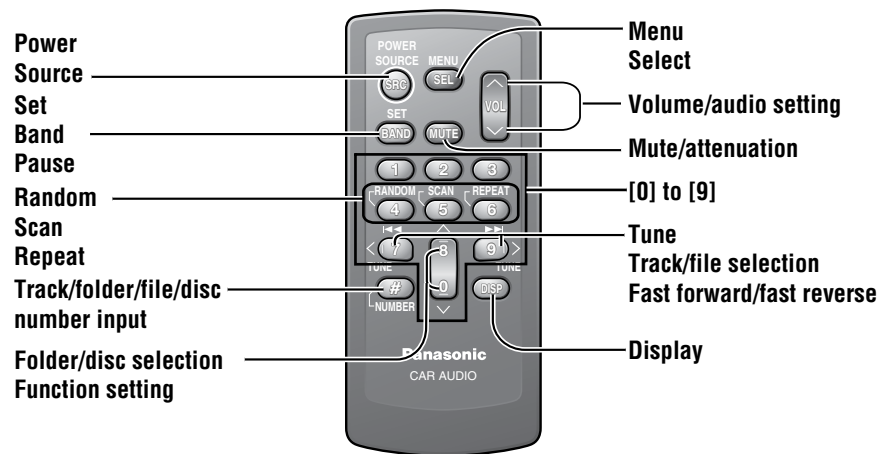

# Preparation

## Remote Control Unit

### Preparation Before Initial Use

Pull the insulation film out from the backside of the remote control gently.

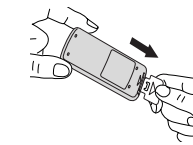

### Battery Replacement

- Remove the battery holder with the remote control unit placed on a flat surface.
  - Stick your thumbnail into the groove and push the holder in the direction of the arrow at the same time.
  - Pull it out in the direction of the arrow using a tough pointed object.
- Put a battery in the case with (+) side facing up.
- Put the case back.

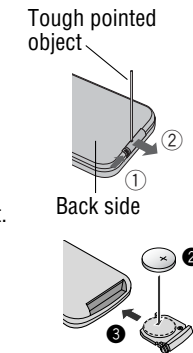

**Warning**

- Keep batteries away from children to avoid the risk of accidents. If an infant ingests a battery, please seek immediate medical attention.

**Caution**

- Remove and dispose of an old battery immediately.
- Do not disassemble, heat or short a battery. Do not throw a battery into a fire or water.
- Follow local regulations when disposing of a battery.
- Improper use of a battery may cause overheating, an explosion or ignition, resulting in injury or a fire.

**Note:**

- **Battery Information:**  
 Battery Type: Panasonic lithium battery (CR2025)  
 (Included in the remote control)  
 Battery Life: Approximately 6 months under normal use (at room temperature)

## Main Unit

### Cancellation of demonstration

The demonstration message appears for initial use.

- Set your car's ignition switch to the ACC or ON position. The demonstration screen appears.
- Press [DISP]. The demonstration screen is canceled, and no more appears.

**Note:**

- If you would like to turn on the power and make the demonstration message appear, press and hold [SRC] (PWR) for more than 4 seconds.



[SRC] (PWR: Power) | [DISP] (Display) | [ $\leftarrow$ ] [ $\rightarrow$ ] (Hour/minute adjustment)

### Clock Setting

The 24-hour system is used for the clock.

- Press [SRC] (PWR) to turn on the power.
- Press [DISP].
 Clock display
- Press and hold [DISP] for more than 2 seconds.
 Hour blinks
- Adjust the hour.
 Hour entered
  - [>]: put forward hour.
  - [<]: put back hour.
- Press [DISP].
 Minute blinks
- Adjust the minute.
 Minute entered
  - [>]: put forward minute.
  - [<]: put back minute.
- Press [DISP].
 Completed

**Note:**

- "ADJUST" is displayed before adjusting the clock.
- Press and hold [>] or [<] to change numbers rapidly.

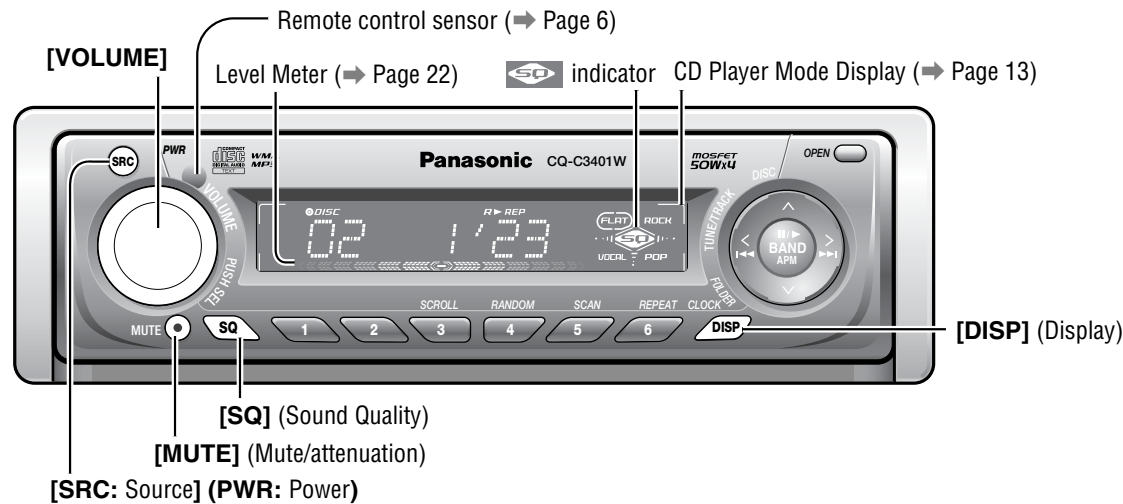

## Power

Set your car's ignition switch to the ACC or ON position.

**ON:** Press **[SRC]** (**PWR**).



**OFF:** Press and hold **[SRC]** (**PWR**) for more than 1 second.

### Note:

- If you turn the key to the ACC OFF position during the security function is active, the security message appears with a warning alarm. (Default: SLED ON) (→ Page 22 about security function setting)

## Source

Press **[SRC]** to change the source.

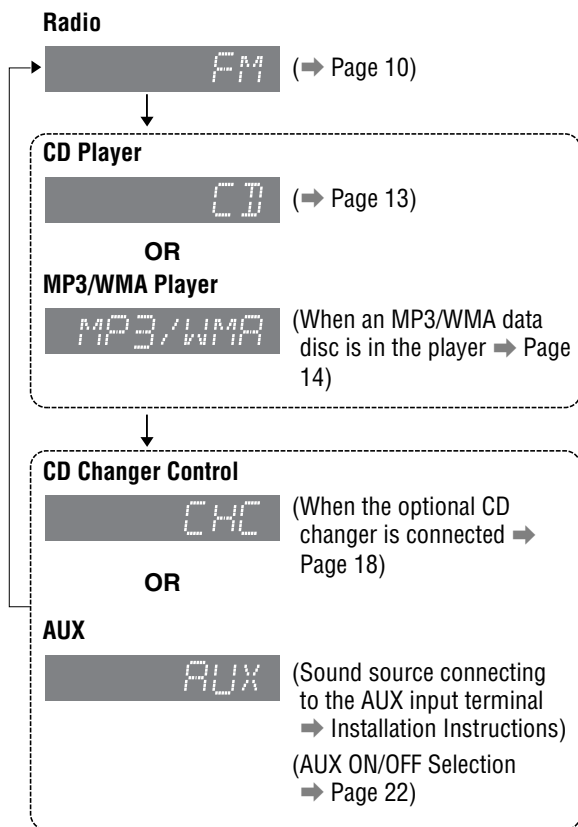

### Note:

- AUX cannot be used when the CD changer is connected to the DIN connector.

## Volume



### Note:

- The volume level can be set independently for each source. (For radio, one volume setting for AM, one volume setting for all FMs)

## Mute/Attenuation **[MUTE]**

**ON** : Press **[MUTE]**.

**OFF** : Press **[MUTE]** again.

You can select mute or attenuation. (→ Page 20)



## Clock Display at Power Off

When the power of the unit is set to OFF, press **[DISP]**.



When the power is set to ON, refer to the description for each source mode.

## SQ (Sound Quality)

SQ is a function that can call up various sound types at the touch of button in accordance with your listening music type.

Press **[SQ]** to select the sound type as follows:

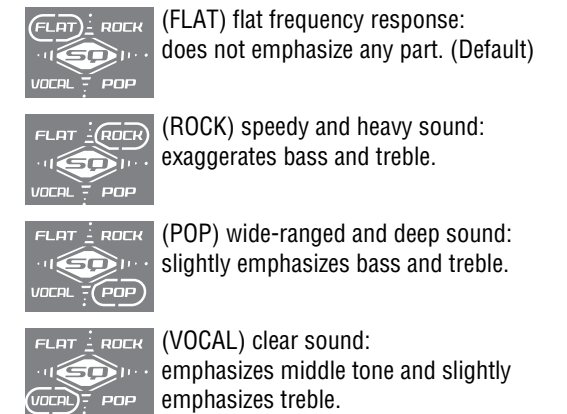

Press **[DISP]** to return to the regular mode.

### Note:

- Settings of SQ, bass/treble and volume are influenced one another. If such an influence causes distortion to the audio signal, readjust bass/treble or volume. (→ Page 20)

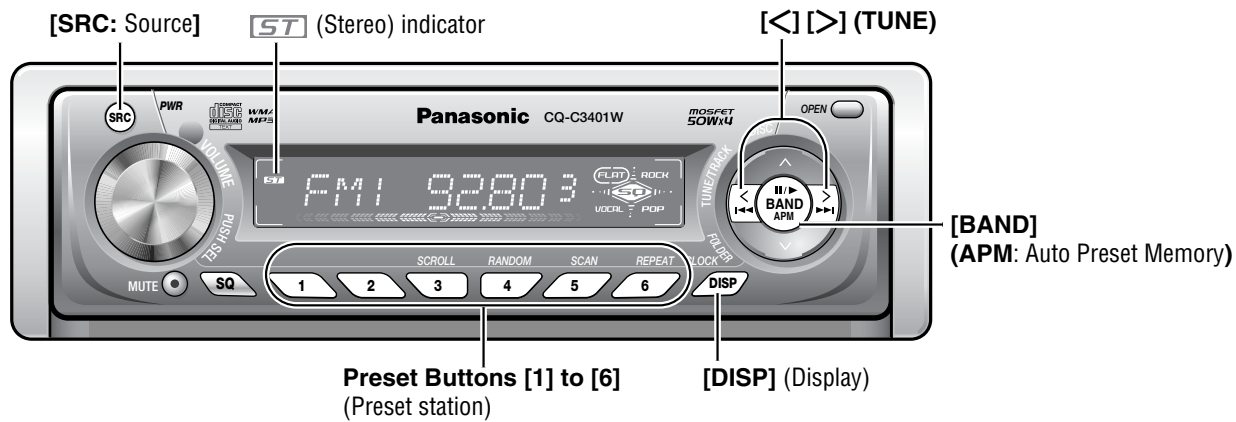

## 1 Radio Mode

Press **[SRC]** to select the radio mode.



## 2 Band

Press **[BAND]**.

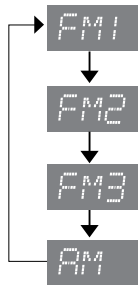

## 3 Tuning

**[>]**: Higher frequency  
**[<]**: Lower frequency  
 Press and hold **[>]** or **[<]** for more than 0.5 seconds, then release it. Seeking will start.

## Display Change

Press **[DISP]** to change the display as follows.

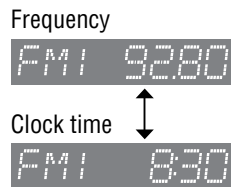

## Station Preset

Up to 6 stations can be stored in each of the FM1, FM2, FM3 and AM band selections.

### Note:

- New stations overwrite existing saved stations after these procedures.

### Warning

- To ensure safety, never attempt to preset stations while you are driving.

## Auto Preset Memory (APM)

With this operation, stations with good receiving conditions can be automatically stored in the preset memory.

- ① Select a band. (→ Previous page)
- ② Press and hold **[BAND] (APM)** for more than 2 seconds.

6 stations with first to 6th highest in signal strength will be preset to each band.

Once set, the preset stations are sequentially scanned for 5 seconds each. (scanning)



### Note:

- To stop scanning, press one of the buttons from **[1]** to **[6]**.

## Manual Preset Memory

With this operation, a station can be manually stored in the preset memory.

- ① Select a band and frequency. (→ Previous page)
- ② Press and hold one of the preset buttons from **[1]** to **[6]** until the display blinks once.

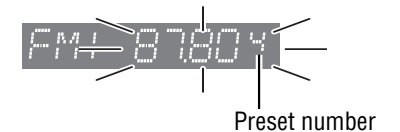

## Preset Station Calling

- ① Select a band. (→ Previous page)
- ② Press one of the preset buttons from **[1]** to **[6]**.

# Before Disc Playback

## Caution

- Do not insert a disc when **DISC** indicator lights because a disc is already loaded.
- 8 cm discs are not available for this unit, therefore, do not insert them.
- Do not use irregularly shaped discs.
- Do not use discs that have a seal or label attached.
- To avoid damaging the face plate, do not push it down or place objects on it while it is open.
- Do not pinch your finger or hand in the face plate.
- Do not insert foreign objects into the disc slot.

## Available Discs

CD-R	CD-RW	CD-TEXT	CD-ROM
CD-DA	CD-DA	CD-DA	-
MP3/WMA	MP3/WMA	-	MP3/WMA

### Note:

- Refer to the section on "Notes on MP3/WMA" (→ Page 16) and "Notes on Discs" (→ Page 25).
- The power will be turned on automatically when a disc is loaded.
- A disc which has both CD-DA data and MP3/WMA data on it may not be reproduced normally.

## Disc Insert

① Press [OPEN].

② Insert a disc.

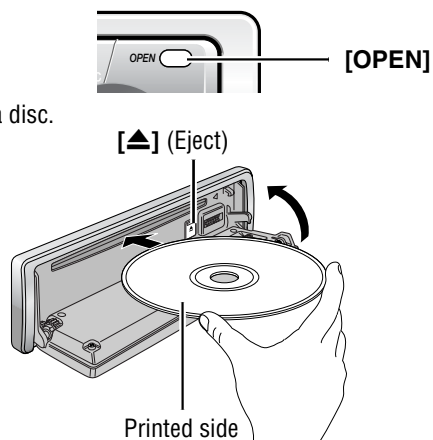

Disc Indicator



### Note:

- It may take some time to start playing.
- ③ Close the face plate manually.  
④ Playback will start automatically after recognizing the data of the loading disc.

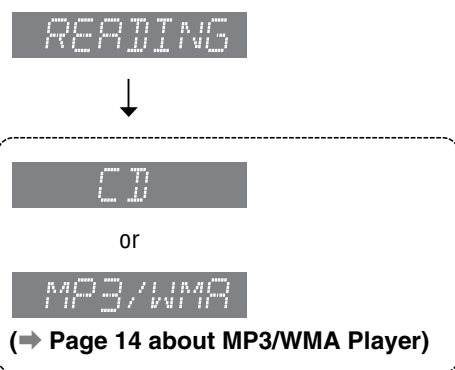

## Disc Eject

- Press [OPEN].
- Press [Eject] and take the disc out.
- Close the face plate manually.

# CD Player

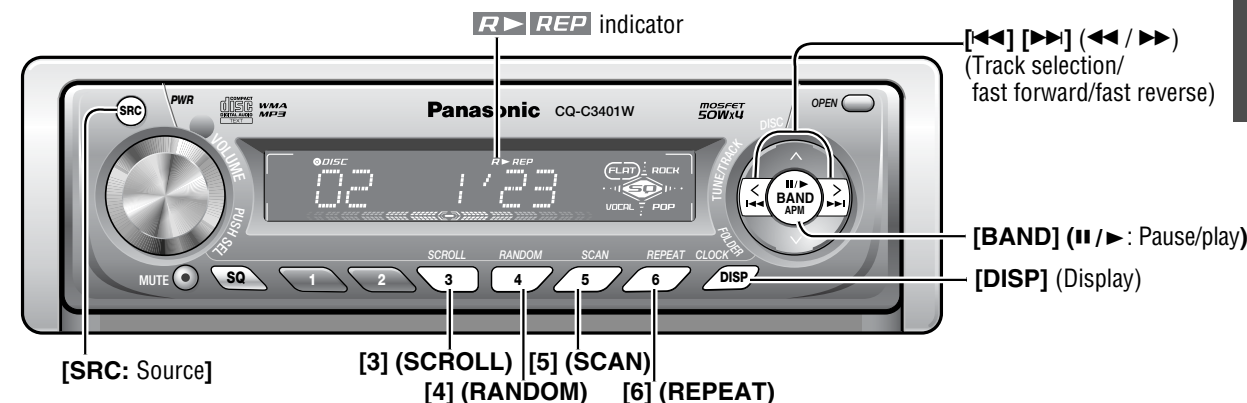

## When CD is in the player

Press [SRC] to select the CD player mode and playback starts.

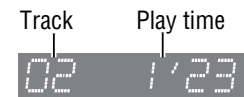

## Pause (II / >)

Press [BAND] (II / >).  
Press [BAND] (II / >) again to cancel.

## Random Play R

All the available tracks are played in a random sequence.  
Press [4] (RANDOM). R lights.  
Press [4] (RANDOM) again to cancel.

## Scan Play

The first 10 seconds of each track is played in sequence.  
Press [5] (SCAN).



Press [5] (SCAN) again to cancel.

## Repeat Play REP

The current track is repeated.  
Press [6] (REPEAT). REP lights.  
Press [6] (REPEAT) again to cancel.

## Direct Track Selection

(Only for remote control unit)

Example: Track number 10



- Press [#].
- Press [1] [0].
- Press [BAND] (SET).

### Note:

- To suspend direct selection, press [DISP].
- Random, Scan and Repeat plays are canceled once [#] is pressed.

## Display Change

Press [DISP].

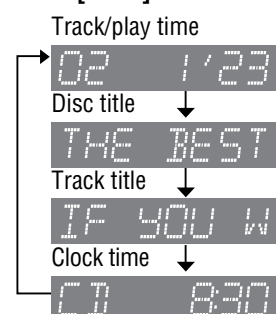

### Note:

- "NO TITLE" is displayed when there is no information on the disc.
- To have another circle scroll while a title is displayed, press [3] (SCROLL).

## Track Selection

- [>>>]: Next track
- [<<<]: Beginning of the current track  
For the previous track, press twice.

## Fast Forward/Fast Reverse

Press and hold  
[>>>] (>>>): Fast forward  
[<<<] (<<<): Fast reverse  
Release them to resume normal playback.

# MP3/WMA Player

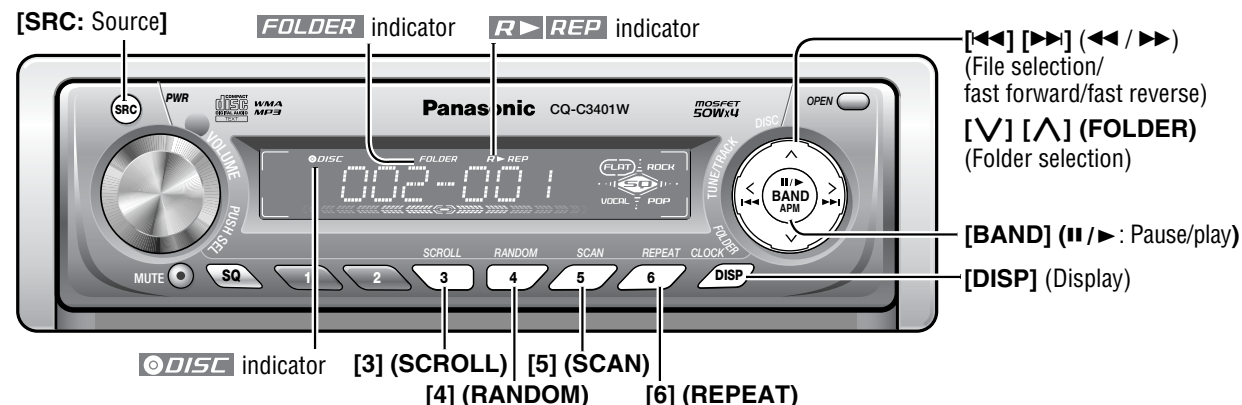

## When a disc is in the player

Press [SRC] to select the MP3/WMA player mode and playback starts.

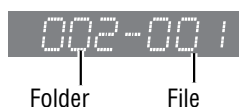

## Display Change

Press [DISP].

Folder/file



Play time



Folder name/album name\*



File name/title and artist name\*



Clock time



### Note:

- "NO NAME" is displayed when there is no information on the disc.
- To have another circle scroll while a title is displayed, press [3] (SCROLL).

## \*ID3/WMA Tag Setting

Press and hold [3] (SCROLL) for more than 2 seconds.



When a folder name is displayed:

TAG ON: The album title is displayed.

TAG OFF: The folder name is displayed.

When a file name is displayed:

TAG ON: The title/artist name is displayed.

TAG OFF: The file name is displayed.

## Folder Selection

[∧]: Next folder

[∨]: Previous folder

## File Selection

[▶▶]: Next file

[◀◀]: Beginning of the current file

For the previous file, press twice.

## Fast Forward/Fast Reverse

Press and hold

[▶▶] (▶▶): Fast forward

[◀◀] (◀◀): Fast reverse

Release them to resume normal playback.

## Pause (||▶)

Press [BAND] (||▶).

Press [BAND] (||▶) again to cancel.

## Random Play

All the available files are played in a random sequence.

Press [4] (RANDOM). lights.

Press [4] (RANDOM) again to cancel.

## Folder Random Play

All the files in the current folder are played in a random sequence.

Press and hold [4] (RANDOM) for more than 2 seconds.

light.

Press and hold [4] (RANDOM) again for more than 2 seconds to cancel.

## Scan Play

The first 10 seconds of each file is played in sequence.

Press [5] (SCAN).



Press [5] (SCAN) again to cancel.

## Folder Scan Play

From the next folder, the first 10 seconds of the first file in each folder is played in sequence.

Press and hold [5] (SCAN) for more than 2 seconds.

lights.



Press and hold [5] (SCAN) again for more than 2 seconds to cancel.

## Repeat Play

The current file is repeated.

Press [6] (REPEAT). lights.

Press [6] (REPEAT) again to cancel.

## Folder Repeat Play

The current folder is repeated.

Press and hold [6] (REPEAT) for more than 2 seconds.

light.

Press and hold [6] (REPEAT) again for more than 2 seconds to cancel.

## Direct Selection

(Only for remote control)

### Direct Folder Selection

Example: Folder number 5 (→ Page 17)



① Press [#] twice.

② Press [5].

③ Press [BAND] (SET).

### Direct File Selection

Example: File number 10



① Press [#].

② Press [1] [0].

③ Press [BAND] (SET).

### Note:

- To suspend direct selection, press [DISP].
- Random, Folder Random, Scan, Folder Scan, Repeat and Folder Repeat plays are canceled once [#] is pressed.

# Notes on MP3/WMA

## What is MP3/WMA?

MP3 (MPEG Audio Layer-3) and WMA (Windows Media™ Audio) are the compression formats of digital audio. The former is developed by MPEG (Motion Picture Experts Group), and the latter is developed by Microsoft Corporation. Using these compression formats, you can record the contents of about 10 music CDs on a single CD (This figure refers to data recorded on a 650 MB CD-R or CD-RW at a fixed bit rate of 128 kbps and a sampling frequency of 44.1 kHz).

### Note:

- MP3/WMA encoding and CD writing software programs are not supplied with this unit.

## Points to remember when making MP3/WMA files

### Common

- High bit rate and high sampling frequency are recommended for high quality sound.
- Selecting VBR (Variable Bit Rate) is not recommended because playing time is not displayed properly and sound may be skipped.
- The playback sound quality differs depending on the encoding circumstances. For details, refer to the instructions of your own encoding software and writing software.

### MP3

- It is recommended to set the bit rate to “128 kbps or more” and “fixed”.

### WMA

- It is recommended to set the bit rate to “64 kbps or more” and “fixed”.
- Do not set the copy protection on the WMA file to enable this unit to play back.

### Caution

- Never assign the “.mp3”, or “.wma” file name extension to a file that is not in the MP3/WMA format. This may not only produce noise from the speaker damage, but also damage your hearing.

## Display Information

### Displayed items

- |   |  |
|---|--|
| <ul style="list-style-type: none"> <li><b>CD-TEXT</b><br/>Disc title<br/>Track title</li> <li><b>MP3/WMA</b><br/>Folder name<br/>File name</li> </ul> | <ul style="list-style-type: none"> <li><b>MP3 (ID3 tag)</b><br/>Album name<br/>Title and artist name</li> <li><b>WMA (WMA tag)</b><br/>Album name<br/>Title and artist name</li> </ul> |
|---|--|

### Displayable characters

- Displayable length of file name/folder name: within 128 characters.
- Name files and folders in accordance with the standard of each file system. Refer to the instructions of writing software for details.
- ASCII character set and special characters in each language can be displayed.

### ASCII character set

A to Z, a to z, digits 0 to 9, and the following symbols:  
(space) ! " # \$ % & ' ( ) \* + , - . / : ; < = > ? @ [ \ ] ^ \_ ` { | } ~

### Special characters

À Á Â Ã Ä Å à á â ã ä å  
 Ä ä  
 Ò Ó Ô Õ Ö ò ó ô õ ö  
 Ù Ú Û Ü ù ú û ü

### Note:

- With some software in which MP3/WMA format files have been encoded, the character information may not be displayed properly.
- Undisplayable characters and symbols will be converted into an asterisk (\*).
- It is recommended that the length of the file name is less than 8 (excluding the file extension).

Windows Media, and the Windows logo are trademarks, or registered trademarks of Microsoft Corporation in the United States and/or other countries.



## Recording MP3/WMA files on a CD-media

- You are recommended to minimize the chances of making a disc that contains both CD-DA files and MP3/WMA files.
- If CD-DA files are on the same disc as MP3 or WMA files, the songs may not play in the intended order, or some songs may not play at all.
- When storing MP3 data and WMA data on the same disc, use different folders for each data.
- Do not record files other than MP3/WMA files and unnecessary folder on a disc.
- The name of an MP3/WMA file should be added by rules as shown in the following descriptions and also comply with the rules of each file system.
- The file extension “.mp3” or “.wma” should be assigned to each file depending on the file format.

- You may encounter trouble in playing MP3/WMA files or displaying the information of MP3/WMA files recorded with certain writing software or CD recorders.
- This unit does not have a play list function.
- Although Multi-session recording is supported, the use of Disc-at-Once is recommended.

### Supported file systems

ISO 9660 Level 1/Level 2, Apple Extension to ISO 9660, Joliet, Romeo

### Note:

- Apple HFS, UDF 1.50, Mix CD and CD Extra are not supported.

## Compression formats (Recommendation: “Points to remember when making MP3/WMA files” on the previous page)

Compression method	Bit rate	VBR	Sampling frequency
MPEG 1 audio layer 3 (MP3)	32 k – 320 kbps	Yes	32, 44.1, 48 kHz
MPEG 2 audio layer 3 (MP3)	8 k – 160 kbps	Yes	16, 22.05, 24 kHz
Windows Media Audio Ver. 2, 8	64 k – 192 kbps	No	32, 44.1, 48 kHz

## Folder selection order/file playback order

### Maximum number of files/folders

- Maximum number of files: 999
- Maximum number of files in one folder: 255
- Maximum depth of trees: 8
- Maximum number of folders: 255 (Root folder is included.)

### Note:

- This unit counts the number of folders irrespective of the presence or absence of an MP3/WMA file.
- If the selected folder does not contain any MP3/WMA files, the nearest MP3/WMA files in the order of playback will be played.
- Playback order may be different from other MP3/WMA players even if the same disc is used.
- “ROOT” appears when displaying the root folder name.

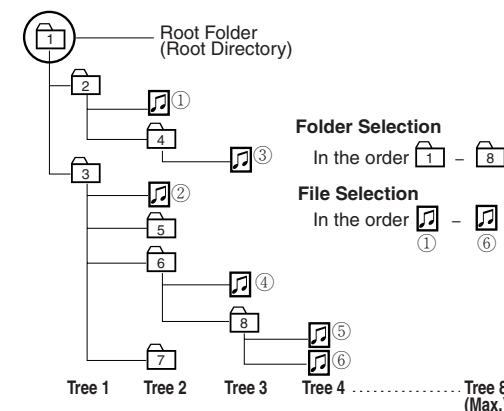

### Copyright

It is prohibited by copyright laws to copy, distribute and deliver copyrighted materials such as music without the approval of copyright holder except enjoying yourself personally.

### No warranty

Above description complies with our investigations as of December 2004. It has no warranty for reproducibility and displayability of MP3/WMA.



# CD Changer Control

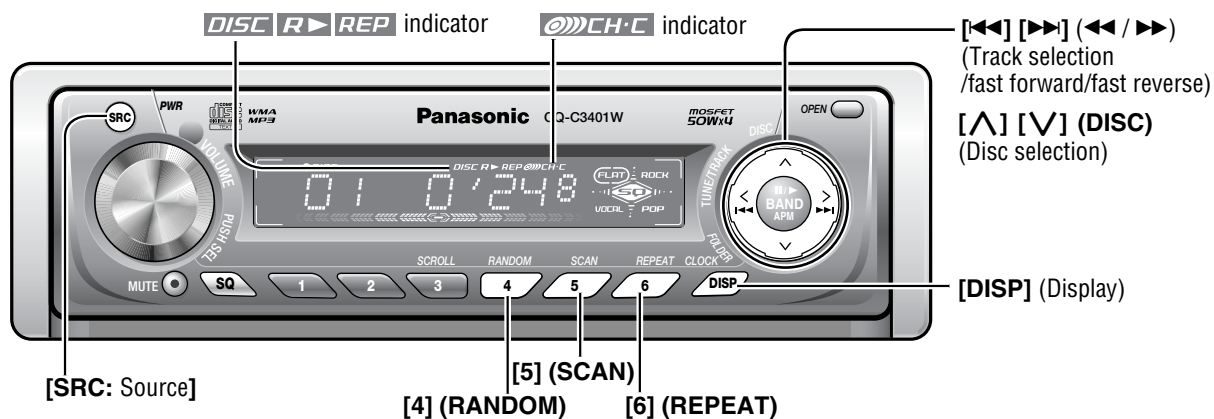

- CD changer functions are designed for optional Panasonic CD changer unit (CX-DP880).
- Preparation:**
- Connect the CD changer, and load a magazine (CDs).

## CD Changer Mode

Press [SRC] to select the CD changer mode and playback starts.



- Note:**
- Load a magazine with CDs when "NO DISC" is displayed.
- The power will be turned on automatically when a magazine is loaded.

## Display Change

Press [DISP].  
Track/play time/disc



## Disc Selection

[▲]: Next disc  
[▼]: Previous disc

## Track Selection

[▶▶]: Next track  
[◀◀]: Beginning of the current track  
For the previous track, press twice.

## Fast Forward/Fast Reverse

Press and hold  
[▶▶] (▶▶): Fast forward  
[◀◀] (◀◀): Fast reverse  
Release them to resume the playback.

### Note:

- Trouble may occur while playing CD-Rs. Refer to the section on "Notes on CD/CD Media (CD-R, CD-RW, CD-ROM)" (→ Page 25)
- This unit does not support the following through the CD changer.
  - CD-RW playback. (except when CX-DP880 is connected)
  - MP3/WMA playback.
  - CD text display.
- Pausing does not function in the CD changer mode.

## Random Play R▶

All the available tracks are played in a random sequence.

Press [4] (RANDOM). R▶ lights.  
Press [4] (RANDOM) again to cancel.

## Disc Random Play DISC R▶

All the available tracks in the current disc are played in a random sequence.

Press and hold [4] (RANDOM) for more than 2 seconds.  
DISC R▶ light.  
Press and hold [4] (RANDOM) again for more than 2 seconds to cancel.

## Scan Play

The first 10 seconds of each track is played in sequence.

Press [5] (SCAN).



Press [5] (SCAN) again to cancel.

## Disc Scan Play DISC

From the next disc, the first 10 seconds of the first track of all the discs is played in sequence.

Press and hold [5] (SCAN) for more than 2 seconds.  
DISC lights.



Press and hold [5] (SCAN) again for more than 2 seconds to cancel.

## Repeat Play REP

The current track is repeated.

Press [6] (REPEAT). REP lights.  
Press [6] (REPEAT) again to cancel.

## Disc Repeat Play DISC REP

The current disc is repeated.

Press and hold [6] (REPEAT) for more than 2 seconds.  
DISC REP light.  
Press and hold [6] (REPEAT) again for more than 2 seconds to cancel.

## Direct Disc Selection

(Only for remote control unit)

**Example:** Disc number 5



- ① Press [#].
- ② Press [5].
- ③ Press [BAND] (SET).

### Note:

- To suspend direct selection, press [DISP].
- Random, Disc Random, Scan, Disc Scan, Repeat and Disc Repeat plays are canceled once [#] is pressed.

# Audio Settings

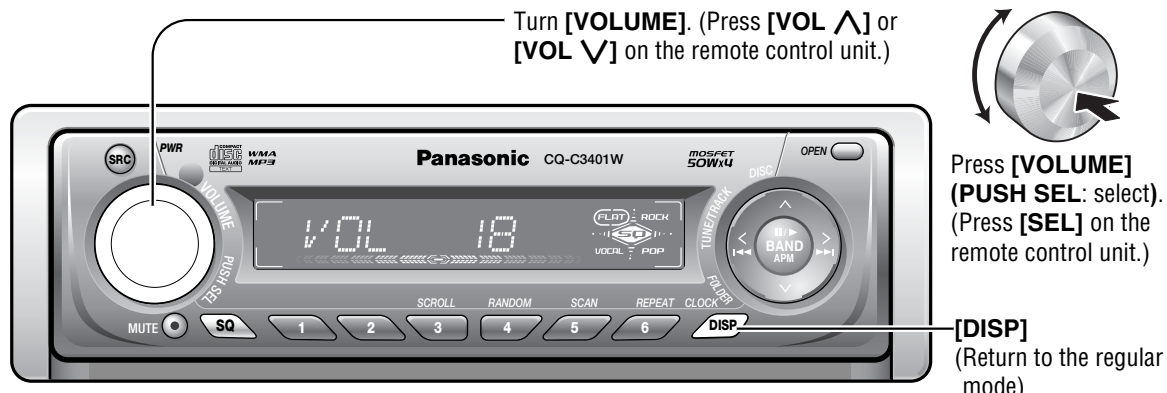

## Volume

Default: 18  
Setting range: 0 to 40

## Bass/Treble

You can adjust the bass and treble sound.  
Default: BAS (bass) 0 dB  
TRE (treble) 0 dB  
Setting range: -12 dB to +12 dB (by 2 dB)

## Balance/Fader

You can adjust the sound level among the right, left, front and rear speakers.  
Default: BAL (balance) CNT (center)  
FAD (fader) CNT (center)  
Setting range: 15 levels each and CNT (center)

## Sub-Woofer Level

You can change the subwoofer volume level.  
Default: 0  
Setting range: MUTE (-∞), -6 dB to +6 dB (by 2 dB)

## Mute/Attenuation

You can select mute or attenuation. (→ Page 9)  
Default: MUTE

Press [VOLUME] (PUSH SEL) to open the menu.

VOL 18

Press [VOLUME] (PUSH SEL).

BASS

Press [VOLUME] (PUSH SEL).

TREBLE

Press [VOLUME] (PUSH SEL).

BALANCE

Press [VOLUME] (PUSH SEL).

FADER

Press [VOLUME] (PUSH SEL).

SUB-W

Press [VOLUME] (PUSH SEL).

MUTE KEY

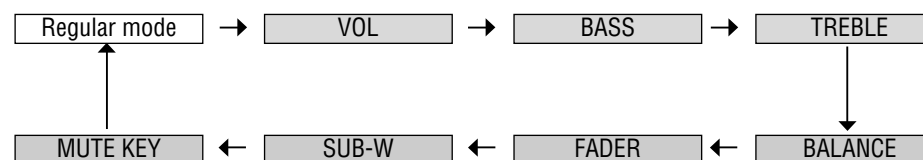

### Note:

- To return to the regular mode, press [DISP].
- If no operation takes place for more than 7 seconds in audio setting (2 seconds in the volume adjustment), the display returns to the regular mode.
- The volume can also be adjusted directly using [VOLUME] on the main unit. (→ Page 9)

	Turn [VOLUME]. ① : Up ② : Down	
	Turn [VOLUME]. ① : Up ② : Down	
	Turn [VOLUME]. ① : Up ② : Down	
	Turn [VOLUME]. ① : Right enhanced ② : Left enhanced	
	Turn [VOLUME]. ① : Front enhanced ② : Rear enhanced	
	Turn [VOLUME]. ① : Up ② : Down	
	Turn [VOLUME]. ① KEY ATT : 10 steps decrease (Attenuation) ② KEY MUTE : No sound (Mute) (Default)	

# Function Settings

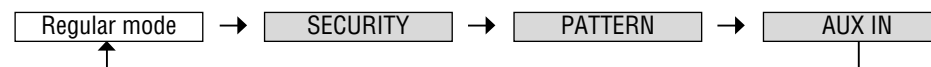
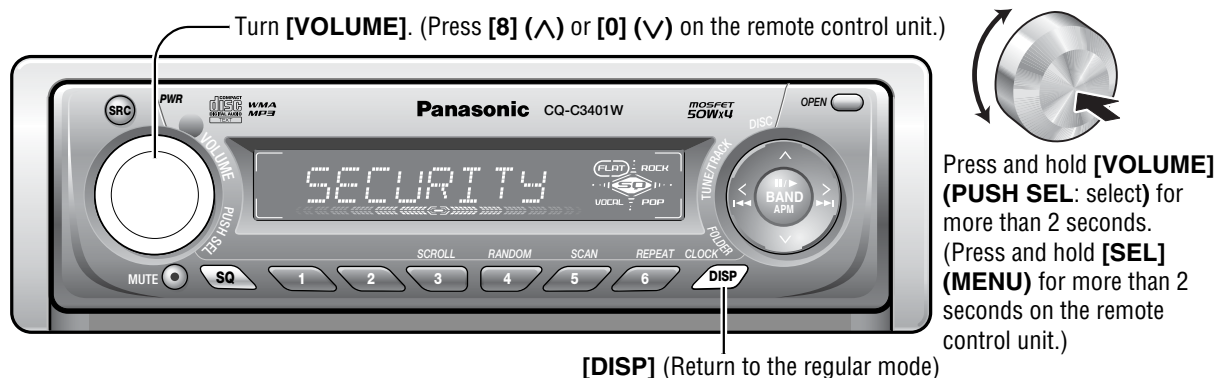

**Note:**

- To return to the regular mode, press [DISP].
- If no operation takes place for more than 7 seconds in function setting, the display returns to the regular mode.

**Security Function**  
Allows you to activate the anti-theft function when leaving your car.  
Default: ON

Press and hold [VOLUME] (PUSH SEL) for more than 2 seconds to open the menu.  
SECURITY

Turn [VOLUME].

① SLED ON : Security function is activated. (Default)

② SLED OFF : Security function is not activated.

**SLED (Security Light Emitted Diode) ON**  
When the ignition switch is turned OFF...  
• The security message will be displayed.  
• The face plate removal alarm will be activated. (⇒ Page 24)

When the removable face plate is removed...  
• The security indicator (SLED) blinks. (⇒ Page 24)

**Level Meter Display Patterns**  
Default: Pattern 1  
Variety: 4 types, OFF

Press [VOLUME] (PUSH SEL).  
PATTERN

Turn [VOLUME].

① PATTERN 1 : Pattern 1 (Default)

⋮

② PATTERN 4 : Pattern 4

OFF : Off

**AUX ON/OFF Selection**  
You can enable or disable audio output from the external input (AUX).  
Default: ON

Press [VOLUME] (PUSH SEL).  
AUX IN

Turn [VOLUME].

① AUX ON : You can select AUX at source selection (⇒“Source”, Page 8), and consequently listen to the sound from the external device.

② AUX OFF : You cannot select AUX at source selection (⇒“Source”, Page 8).

**Note:**

- Be sure to set to ON when connecting a device other than a CD changer to AUX.
- You cannot select AUX at source selection when connecting a DIN cord between a CD changer and this unit even if AUX ON is selected.

# Anti-Theft System

This unit is equipped with a removable face plate. Removing this face plate makes the unit totally inoperable. SLED will blink.

## Remove the Face Plate

- 1 Switch off the power of the unit. (→ Page 8)
- 2 Press [OPEN]. The face plate will be opened.
- 3 Push the face plate to either the right or left.
- 4 Pull it out toward you.
- 5 Gently press the bottom of the case and open the cover.
- 6 Place the face plate into the case and take it with you when you leave the car.

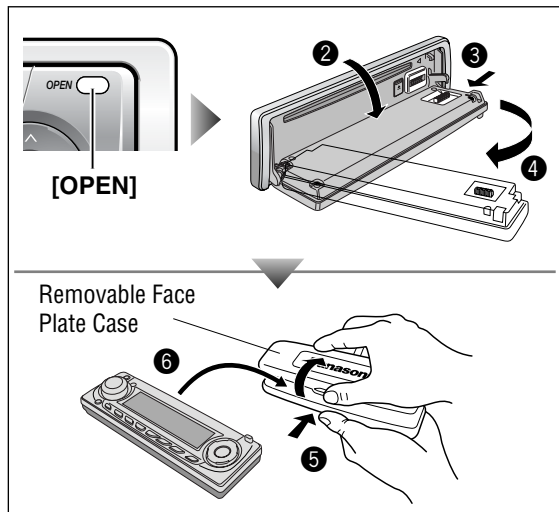

## Install the Face Plate

- 1 Fit the face plate with its left hole on the left pin provided on the main unit.
- 2 Fit the other hole on the other pin applying slight pressure.
- 3 Move the face plate up and down a few times to make sure it is secure. Then close the face plate and press down the right side of the face plate until it clicks into place.

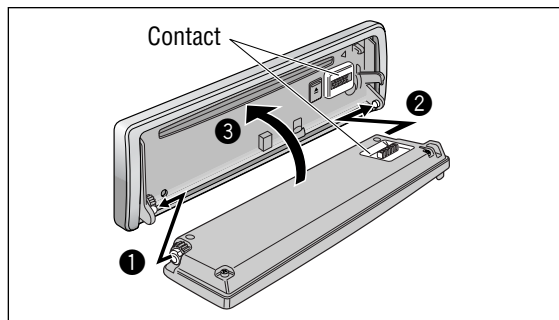

## Security Indicator (SLED)

SLED blinks when the face plate is removed from the unit. This function is activated when the Security Function is ON. (→ Page 22)

## Face Plate Removal Alarm

This alarm sounds to warn you not to forget to remove the face plate before leaving your car. This function is activated when the Security Function is ON. (→ Page 22)

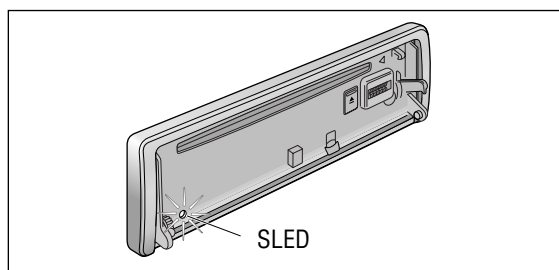

### ⚠ Caution

- This face plate is not waterproof. Do not expose it to water or excessive moisture.
- Do not remove the face plate while driving your car.
- Do not place the face plate on the dashboard or nearby areas where the temperature rises high.
- Do not touch the contacts on the face plate and on the main unit, since this may result in poor electrical contact.
- If dirt or other foreign substances get on the contacts, wipe them off with a clean and dry cloth.
- To avoid damaging the face plate, do not push it down or place objects on it while it is open.

# Fuse

If the fuse blows out, consult your dealer, or your nearest authorized Panasonic Service Center.

### ⚠ Warning

- Use fuses of the same specified rating (15 A). Using substitutes or fuses with higher ratings, or connecting the unit directly without a fuse could cause fire or damage to the unit. **If the replaced fuse fails, contact your nearest authorized Panasonic Service Center.**

# Maintenance

This unit is designed and manufactured to ensure the minimum of maintenance. Use a dry, soft cloth for routine exterior cleaning. Never use benzine, thinner, or other solvents.

# Notes on Discs

## Notes on CD/CD Media (CD-R, CD-RW, CD-ROM)

If you use commercial CDs, they must have either of these labels shown at right. Some copy-protected music CDs are not playable.



### How to hold a disc

- Do not touch the underside of a disc.
- Do not scratch a disc.
- Do not bend a disc.
- When not in use, keep a disc in a case.

Printed side



### Do not use irregularly shaped discs.

### Do not leave discs in the following places:

- Direct sunlight
- Near car heaters
- Dirty, dusty and damp areas
- Seats and dashboards

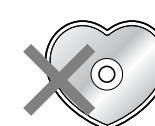

Do not use irregularly shaped discs.

### Disc cleaning

Use a dry, soft cloth to wipe from the center outward.

### Do not attach any seals or labels to your discs.

### Do not write on the disc label with a ballpoint pen or other hard-point pens.

<Correct>

<Wrong>

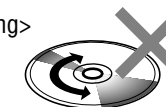

## Notes on CD-Rs/RWs

- You may have trouble playing back some CD-R/RW discs recorded using CD recorders (CD-R/RW drives), either due to their recording characteristics or dirt, fingerprints, scratches, etc. on the disc surface.
- CD-R/RW discs are less resistant to high temperatures and high humidity than ordinary music CDs. Leaving them inside a car for extended periods may damage and make playback impossible.
- Some CD-R/RWs cannot be played back successfully due to incompatibility among writing software, a CD recorder (CD-R/RW drive) and the discs.
- This player cannot play the CD-R/RW discs if the session is not closed.
- This player cannot play the CD-R/RW discs which contain other than CD-DA or MP3/WMA data.
- Be sure to observe the instructions of the CD-R/RW disc for handling it.

## If You Suspect Something Wrong

Check and take steps as described below.

If the described suggestions do not solve the problem, it is recommended to take the unit to your nearest authorized Panasonic Service Center. The product should be serviced only by qualified personnel. Please refer the checking and the repair to professionals. Panasonic shall not be liable for any accidents arising out of neglect of checking the unit or your own repair after your checking.

### Warning

- Do not use the unit in an irregular condition, for example, without sound, or with smoke or a foul smell, which can cause ignition or electric shock. Immediately stop using the unit and consult your dealer.
- Never try to repair the unit by yourself because it is dangerous to do so.

## Common

Problem	Possible cause → Possible solution
No power to the unit	The power cord (battery, power and ground) is connected in the wrong way. → <b>Check the wiring.</b> Fuse blows out. → <b>Eliminate the cause of fuse blowout and replace the fuse with new one. Consult your dealer.</b>
Sound is not generated.	MUTE is set to ON. → <b>Set MUTE to OFF.</b> The wiring of speaker lines is not correct, or a break or poor contact arises. → <b>Check the wiring in accordance with the wiring diagram. (→ Installation Instructions)</b>
The demonstration screen displayed and no operable	You cannot operate the unit while the demonstration screen appears. → <b>Press [DISP] to end the demonstration screen.</b> If the demonstration screen appears frequently, there is a possibility that poor contact or wrong wiring arises between the battery lead of the unit and the battery cable of the car. (The battery lead should be always powered.) → <b>Check the battery wiring in accordance with the wiring diagram.</b>
Noise	There is an electromagnetic-wave generator such as a cellular phone near the unit or its electrical lines. → <b>Keep the electromagnetic-wave generator such as a cellular phone away from the unit and the wiring of the unit. If noise cannot be eliminated due to the wiring harness of the car, consult your dealer.</b> The contact of the ground lead is poor. → <b>Make sure that the ground lead is connected to an unpainted part of the chassis securely.</b>
Noise is made in step with engine revolutions.	Alternator noise comes from the car. → <b>Change the wiring position of the ground lead.</b> → <b>Mount a noise filter on the power supply.</b>
Some operations are not executable.	Some operations are not executable in particular modes such as menu mode. → <b>Read the operating instructions carefully and cancel the mode. If the unit is still out of order, consult your dealer.</b>
No sound from speaker(s)	Balance/fader setting is not appropriate. → <b>Readjust Balance/fader.</b> There is a break, a short circuit, poor contact or wrong wiring regarding the speaker wiring. → <b>Check the speaker wiring.</b>
The speaker channels are reversed between right and left.	The speaker wiring is reversed between right and left. → <b>Perform the speaker wiring in accordance with the wiring diagram.</b>

## Common (continued)

Problem	Possible cause → Possible solution
The sound field is not clear in the stereo mode. Central sound is not settled.	The plus and minus terminals at right and left channels of speakers are connected reversely. → <b>Perform the speaker wiring in accordance with the wiring diagram.</b>
The power of the unit fails unintentionally.	The safety device works. → <b>Consult your dealer, or your nearest Panasonic Service Center.</b>

## Radio

Problem	Possible cause → Possible solution
Poor reception or noise	Antenna installation or wiring of antenna cable is faulty. → <b>Check whether the antenna mounting position and its wiring are correct. In addition, check to see whether the antenna ground is securely connected to the chassis.</b> No power is supplied to the antenna amplifier (when using a film antenna, etc.). → <b>Check the wiring of the antenna battery lead.</b>
The number of auto preset stations is less than 6.	The number of receivable stations is less than 6. → <b>Move to an area where receivable stations number is maximum, and try presetting.</b>
Preset stations cannot be stored.	The contact of the battery lead is poor, or the battery lead is not always powered. → <b>Make sure that the battery lead is connected securely, and preset stations again.</b>

## CD

Problem	Possible cause → Possible solution
No playback or disc ejected	The disc is inserted upside down. → <b>Insert a disc correctly.</b> There is a flaw or foreign object on the disc. → <b>Remove the foreign object, or use a flawless disc.</b>
Sound skipping or noise	There is a flaw or foreign object on the disc. → <b>Remove the foreign object, or use a flawless disc.</b>
Sound skipping due to vibration	The unit is not sufficiently secured. → <b>Secure the unit to the console box.</b> The unit is tilted at over 30° in the front-to-end direction. → <b>Make the angle 30° or less.</b>
Disc unejectable	Something such as a peeled label obstructs the disc coming out. → <b>Consult your dealer.</b> The microcontroller in the unit operates abnormally due to noise or other factors. → <b>Unplug the power cord and plug it again. In case the unit is still out of order, consult your dealer.</b>

## MP3/WMA

Problem	Possible cause → Possible solution
No playback or disc ejected	The disc has unplayable formatted data. → Refer to the description about MP3/WMA for playable sound data except CD-DA (i.e. music CD).
The CD-R/RWs that are playable on other devices are not playable on this unit.	The playability of some CD-R/RWs may depend on the combination of media, recording software and recorder to be used even if these CD-R/RWs are playable on other devices such as a PC. → Make CD-R/RWs in a different combination of media, recording software and recorder after referring to the description about MP3/WMA.
Sound skipping or noise	There is a flaw or foreign objects on the disc. → Remove the foreign objects, or use a flawless disc. For MP3/WMA, refer to the description about MP3/WMA. Playing VBR (Variable Bit Rate) files may cause sound skipping. → Play Non-VBR files.

### Note:

- Refer to "Notes on MP3/WMA" (→ Page 16)

## Remote control unit

Problem	Possible cause → Possible solution
No response to pressing buttons	The battery is inserted in the wrong direction. A wrong battery is inserted. → Insert a correct battery in the correct direction.
	The battery is weak. → Replace the battery with new one.
	The aiming direction of the remote control unit is wrong. → Aim the remote control unit at the sensor of the unit and press buttons.
	The sensor is exposed to direct sunlight. (The remote control unit may not be operable when the sensor is exposed to direct sunlight. In such a case, the system is not faulty.) → Block off sunlight to the sensor.

## Error Display Messages

### CD/MP3/WMA

Display	Possible cause → Possible solution
<p>After 5 seconds</p>	The disc is dirty or upside down. → Check the disc. The disc has scratches. → Check the disc. No operation by some cause. → Unplug the power cord and plug it again. In case the unit is still out of order, consult your dealer.
<p>After 5 seconds</p> <p>To next track/file automatically</p>	The player for some reason cannot read the file you are trying to play. (File recorded in an unsupported file system, compression scheme, data format, file name extension, damaged data, etc.) → Select a file that the player can read. Check the type of data recorded on the disc. Create a new disc if necessary.
<p>After 5 seconds</p> <p>To next track/file automatically</p>	A WMA file can be copyrighted. → The file protected by copyright is not playable.

# Troubleshooting (continued)

## Error Display Messages

### CD Changer Option

Display	Possible cause → Possible solution
<p>After 5 seconds ↓ To next disc automatically</p>	<p>The disc is dirty or upside down.</p> <p>The disc has scratches.</p> <p>→ <b>Eject the magazine.</b></p> <ul style="list-style-type: none"> <li>• Check the disc.</li> <li>• Load the disc again.</li> </ul>
	<p>No operation by some cause.</p> <p>→ <b>Eject the magazine. If the failure persists, press the reset switch on the CD changer. If normal operation is not restored, consult your dealer or the nearest Panasonic Service Center to ask for repairs.</b></p>
	<p>No disc is in the CD Changer (magazine).</p> <p>→ <b>Insert discs into the changer (magazine).</b></p>
	<p>The changer has become disconnected from the unit in the changer mode.</p> <p>→ <b>Verify the wiring.</b></p>

**Note:**

- Messages in the action and display sections of the error chart vary with changer. Refer to the operating instructions for the CD changer for details.

# Specifications

General		FM Stereo Radio	
Power supply	: DC 12 V (11 V – 16 V), test voltage 14.4 V, negative ground	Frequency range	: 87.50 MHz – 108.00 MHz
Current consumption	: Less than 2.2 A (CD mode, 0.5 W 4-channels)	Usable sensitivity	: 6 dB/μV (S/N 30 dB)
Maximum power output	: 50 W x 4 (at 1 kHz) volume control maximum	Frequency response	: 30 Hz – 15 kHz (±3 dB)
Tone adjustment range	: Bass: ± 12 dB (at 100 Hz) Treble: ± 12 dB (at 10 kHz)	Alternate channel selectivity	: 75 dB
Speaker impedance	: 4 – 8 Ω	Stereo separation	: 35 dB (1 kHz)
Pre-amp output voltage	: 2.5 V (CD mode, 1 kHz, 0 dB)	Image rejection ratio	: 70 dB
Pre-amp output impedance	: 200 Ω	IF rejection ratio	: 100 dB
Subwoofer output voltage	: 2.5 V	Signal to noise ratio	: 62 dB
Subwoofer output impedance	: 200 Ω	<b>AM Radio</b>	
Dimensions (W x H x D)	: 178 x 50 x 160 mm	Frequency range	: 531 kHz – 1 602 kHz
Weight	: 1.4 kg	Usable sensitivity	: 28 dB/μV (S/N 20 dB)
		<b>CD Player</b>	
		Sampling frequency	: 8 times oversampling
		DA converter	: 1 bit DAC system
		Pick-up type	: Astigma 3-beam
		Light source	: Semiconductor laser
		Wave length	: 790 nm
		Frequency response	: 20 Hz – 20 kHz (±1 dB)
		Signal to noise ratio	: 96 dB
		Total harmonic distortion	: 0.01 % (1 kHz)
		Wow and flutter	: Below measurable limits
		Channel separation	: 75 dB

**Note:**

- Specifications and design are subject to modification without notice due to improvements.
- Some figures and illustrations in this manual may be different from your product.

## Free Manuals Download Website

<http://myh66.com>

<http://usermanuals.us>

<http://www.somanuals.com>

<http://www.4manuals.cc>

<http://www.manual-lib.com>

<http://www.404manual.com>

<http://www.luxmanual.com>

<http://aubethermostatmanual.com>

Golf course search by state

<http://golfingnear.com>

Email search by domain

<http://emailbydomain.com>

Auto manuals search

<http://auto.somanuals.com>

TV manuals search

<http://tv.somanuals.com>