

Panasonic

Operating Instructions
Digital Cellular Telephone

EB-GD93



Before operating this equipment please read these instructions completely.

Quick Reference

This Quick Reference guide is intended to enable the user to utilize the most basic features of the phone instantly without having to search through the extra details which are incorporated into this manual.

Power On/Off

Press and hold 

Enter Pin Code

Use the keypad to enter the PIN supplied by your Service Provider, then press 

Make a Call

Use the keypad to enter the area code and telephone number, then press 

Correcting an Error

Press  once to erase the previous character

Press and hold  to remove all characters entered

Redial Last Number

Press  

End a Call

Press  to end a call

Answer a Call

Press any key except  or 



Adjust Ear Volume

Press  during a call

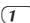
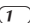
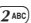

Access WAP Browser

Press and hold 

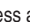

Make Emergency Call

Press    



International Dialling

Press and hold , use  to select the appropriate country code, then press 



Add Phonebook Entry to SIM

Enter phone number and press . Press , enter name and press  twice

Dial SIM Phonebook Entry

Press , then use  to select the desired number, then press 

What is My Number ?

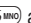
Press    and the number of your phone will be displayed (SIM dependent)

Set Key Guard

Press  three times and the keys will be locked to avoid accidental presses

Disable Key Guard

Press  twice (when **Free** is displayed) to remove the Key Guard

Contents

Getting Started	1	Changing the Language	19
Fitting the SIM	1	Restoring the Default Phone Settings	20
Fitting the Battery	1	Phone Security	21
Charging the Battery	2	Using Key Guard	21
Getting to Know Your Phone	3	Changing the Security Codes	21
Basic Operation	6	Restricting Calls	22
Switching the Phone On/Off	6	Applications	23
Making a Call	6	Clock	23
Automatic Redial	7	Calculator	25
Ending a Call	7	Currency Convertor	25
Answering a Call	7	Short Text Messages	27
Earpiece Volume Control	7	Setting the Phone for Text Messages	27
Locking the Phone	8	Sending a Text Message	27
Using the PIN	8	Receiving Text Messages	28
Setting Vibration Alert	9	Message Options	28
Setting Ring and Key Volume	9	Using Pre-defined Messages	28
Phonebook	10	Manage Messages Lists	29
Store a Number	10	Message Parameters	30
Browsing Phonebook	11	Cell Broadcasts	30
Retrieve a Number	11	Call Information	32
Editing Phonebook Entries	11	Recent Numbers	32
Grouping Phonebook Entries	12	Call Duration	32
Using Alert Profiles	13	Call Charges	33
Personal Dial	13	Call Identification	33
Hot Key Phone Numbers	14	Advanced Operation	34
Service Dial Numbers	14	Diverting Calls	34
Review the Phonebook	14	Holding Calls and Call Waiting	34
My Numbers	15	Call Transfer	35
Personalising Your Phone	16	Multi-party Calls	35
Add a Start-up Greeting	16	Changing to a New Network	37
Displaying Animations	16	WAP Browser	38
Changing the Ring Tone	16	Server Settings	38
Disabling all Tones	18	Activating the Browser	38
Setting the Backlight Colour	18	Navigating Content	39
Disabling Key Backlight	18	The Browser Menu	39
Disabling Back Case Light	18	Using Bookmarks	40
Using Voice Commands	18		
Selecting Vibration Alert Type	19		

Deactivating the Browser	40
Setting the Linger Time	40
Last Error	40
Internet E-mail	41
E-mail Setup.	41
Create a New Message	41
Send/Receive Messages . . .	42
Read Messages	42
Store an Address	43
Add a Signature	43
Manage Message Stores . . .	43
Additional Features	44
Desktop Handsfree	44
Voice Memo	44
Dicta Phone	45
DTMF Tones	46
Note Pad	46
Second Clock	47
Accessory Related Features .	47
Text Entry	48
Menu Structure	50
Trouble Shooting	51
Important Error Messages. . .	52
Important Information.	54
Safety Considerations. . . .	54
Care and Maintenance	56
Glossary of Terms.	57
Specifications	58

Getting Started

Thank you for purchasing this Panasonic digital cellular phone. This phone is designed to operate on the Global System for Mobile Communications (GSM), GSM900 or GSM1800. Ensure the battery is fully charged before use.

Before operating this phone please read the "Important Information" section - see page 54.

These operating instructions detail use of the equipment contained in the Main Kit. Some services detailed herein are network dependent or may only be available on a subscription basis. Some functions are SIM dependent. For more information contact your Service Provider.

Fitting the SIM

The SIM is inserted into the back of the phone underneath the battery.

Place the SIM in the recess at the rear of the phone (1) ensuring the bevelled corner is positioned in the top right corner. Slide the SIM to the left (2) using light pressure until it is located under the lugs and the SIM retaining clip has clicked into position (3).

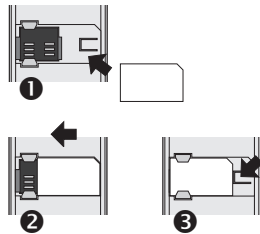

Removing the SIM

Ensure the SIM retaining clip is pressed down (1) and while holding this down slide the SIM to the right (2). Once clear of the lugs the SIM can be lifted out of the recess.

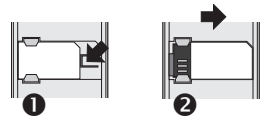

Fitting the Battery

Fit a fully charged battery pack. If the battery pack is not fully charged then it must be charged as described in the "Charging the Battery" section.

Locate the top of the battery into the rear of the phone (1). Push the bottom of the battery into place until it locks into position (2).

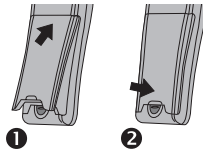

Getting Started

Removing the Battery

Push the battery release latch down (1). The base of the battery will raise out of the recess (2). The battery can now be removed from the phone (3).

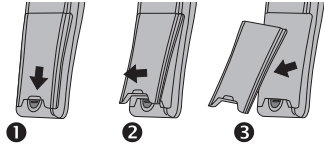

Charging the Battery

Connecting the AC Adaptor

The battery pack must be attached to the phone before the AC Adaptor is connected. Insert the AC Adaptor plug into the base of the phone (1).

Note: DO NOT force the connector as this may damage the phone and/or the AC Adaptor.

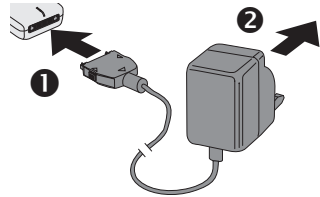

Connect the AC Adaptor to the mains power supply (2). Indicator will light and charging starts.

Operation of Battery Level Indicator

	While charging	Charging complete
Telephone on		
Telephone off		Indicator off

When charging is complete remove the AC Adaptor.

Disconnecting the AC Adaptor

Disconnect the AC Adaptor from the mains power supply (1).

Squeeze together the two buttons on the plug of the AC Adaptor (2) and while maintaining pressure extract the plug from the base of the phone (3).

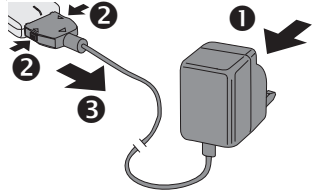

Low Battery Warning









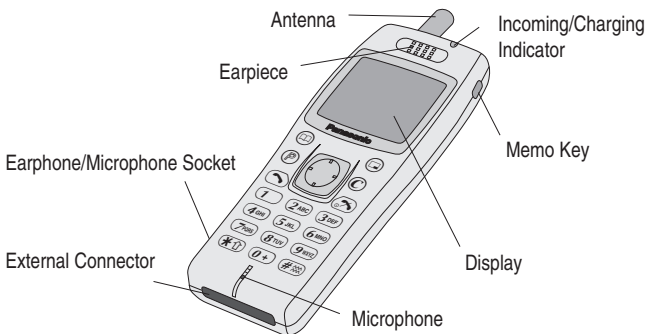



When the battery power is low a warning tone will sound and a blinking **LOW BATTERY** message will be displayed. If this occurs during conversation finish your call immediately. The power will be automatically shut off shortly after the warning tone. Fully charge the battery pack or replace it with a fully charged one.



Getting to Know Your Phone

Location of Controls





-  **Navigation key** – pressing up/down/left/right scrolls through options in the main area of the display. Pressing left/right scrolls through options in the option area of the display
-  **Select key** – selects an option in the option area of the display
-  accesses **Phonebook** or **switches character types**
-  provides instant access to one phone number (**Personal Dial**). Also provides shortcut to WAP Browser.
-  **makes a call** or recalls recently dialed phone numbers
-  **clears** the last digit entered, clears all digits when pressed and held or returns to the previous display
-  **ends a call** or **switches the phone on/off** when pressed and held
-  **Records** and **plays back** recorded memos
- Digit keys**  to ,  and  – the  key will switch on and off vibration alert

Getting Started

The Menu System

The menu system provides the means for accessing all the functions which do not have their own dedicated buttons on the keypad.

The menu functions can be selected using a combination of the **Navigation key**  and the menu **Select key** .

During a call a restricted menu will be available.

Shortcuts

In addition, once you are familiar with the layout of the menu you can use the keypad to enter the Menu Number to quickly obtain the required function. For example, pressing  to enter the menu and then (5 JKL) (2 ABC) will take you directly to the menu for changing the ring tone. Examples in these instructions use the shortcuts to gain access to the relevant functions or to the sub-menu under which other functions are located.



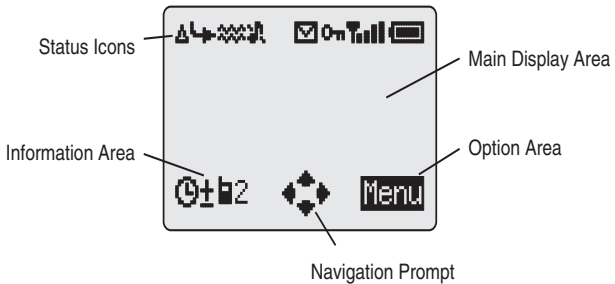



Display Icons









Following some operations the display will automatically clear after three seconds or after pressing any key.

Status Icons

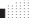

The status icons are displayed according to the currently activated functions. The Antenna, Signal and Battery icons are always displayed when the handset is switched on and connected to a network.

-  lights when you are registered to a non-home network - **roaming**
-  lights when **call divert** is enabled
-  lights when **vibration alert** is enabled
-  lights when **all tones** or **ring volume** is off
-  blinks when an **unread message** is stored or lights when **message area is full**
-  lights when **phone lock** is enabled

-  indicates that it is **possible to make emergency calls**
-  indicates the received **signal strength**:  - weak signal,  - strong signal
-  indicates the **battery level**:  - full,  (blinking) - low battery

Information Area

This area is used to indicate the current top level menu, the sub-menu number, text entry mode, Phonebook source, Phonebook location number, or the alarm set icon depending on the current mode of operation.

-  indicates **alarm** is set
-  indicates current Phonebook entry is sourced from **Mobile Phonebook**
-  indicates current Phonebook entry is sourced from **SIM Phonebook**

Navigation Prompt

-  This area indicates the available directions in which the **Navigation Key** can be pressed according to the current mode of operation.

Option Area

The Option Area displays the options which can be selected by pressing the **Select key** ().

Basic Operation

Switching the Phone On/Off

To switch the phone on or off.

Press and hold  to switch power on

A greeting animation will be displayed and then the phone will go into **Idle** mode.

Press and hold  to switch power off

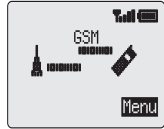

Making a Call

Ensure that the phone is switched on, the network operator logo is displayed and the signal strength meter shows network coverage is available in the current area.





- 1 Enter area code and phone number
- 2 Press 

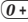

International Dialling

Using the automatic international access code (+) you will be able to dial international numbers without having to know the code for the international exchange.

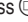
If the international number is known then it can be entered in the normal fashion followed by the area code and phone number.

- 1 Press and hold  until + is displayed
- 2 Press  to cycle through the abbreviated international names and press  to select the required code
- 3 Enter area code and phone number
- 4 Press 



Note: Many countries include an initial "0" in the area code. This should, in most cases, be left out when dialling international numbers. If you have difficulties making international calls, contact your Service Provider.

Emergency Calls

To make an emergency call the antenna symbol () must be present.

Enter     or press  when **SOS** is displayed in the option area

Automatic Redial

When a call is unsuccessful the phone may ask if you want to redial the phone number again automatically.

Press  when **Ok** is displayed in the option area and the display will countdown in seconds to the next redial.

To stop redialling, press  when **Cancel** is displayed in the option area or press .



When a call is connected a beep will be emitted.

If a call is repeatedly unsuccessful you will not be able to automatically redial the phone number. In this case you must redial the phone number manually.

Ending a Call

Press .

Answering a Call

To receive a call the phone must be switched on and the signal strength meter must be displayed.

Press any key except  or .

Press  to reject the call

If a call is not answered, or is rejected, the number of unanswered calls will be displayed.

Press any key to clear the display

Caller Identification

This feature allows you to identify incoming calls and accept or reject them. The caller's phone number, and name if stored in Phonebook, will be displayed.

Note: *Caller Identification may not always be available.*



Earpiece Volume Control

The volume level may be adjusted during a call:

Press  to decrease the volume

Press  to increase the volume

Volume control for Personal Handsfree accessory is adjusted in the same manner.



Basic Operation

Locking the Phone

With the Phone Lock enabled you will be restricted to answer incoming calls and make emergency calls only. The Phone Lock Code is factory set to "0000".

- 1 From **Idle** mode press to enter the **Phone Lock** menu
- 2 Press
- 3 Enter the 4-digit code and press

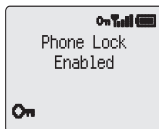

The phone will be locked and the lock icon () will be displayed.

Unlocking the Phone

To restore normal operation, enter your Lock Code and press . The lock icon will be removed from the display. However, once you turn the phone off and on again you will need to re-enter the Lock Code, and when the correct code has been entered **Ok** will be displayed. Press .

Disabling Phone Lock

- 1 From **Idle** mode press to enter the **Security** menu.
- 2 Press until **Disable** is displayed in the option area
- 3 Press
- 4 Enter the Lock Code and press

Using the PIN

The PIN (Personal Identification Number) protects your SIM against unauthorized use. If you enable the PIN, every time the phone is turned on you will be prompted to enter the PIN.

The PIN2 controls security for the Fixed Dial Store and Call Charge metering.

Enabling/Disabling the PIN

- 1 From **Idle** mode press to enter the **PIN** menu
- 2 Press to enable/disable the PIN
- 3 Enter PIN number

Setting Vibration Alert

When vibration alert is switched on the phone will vibrate when a call is received. Switching on vibration alert will silence the ring volume. However, when the ring volume is adjusted after the vibration alert is switched on, the phone will ring and vibrate when a call is received.

From **Idle** mode:

Press and hold (#) to switch on or off. When switched on, the phone will vibrate briefly.



Setting Ring and Key Volume

Changing either the ring volume and key volume is done in the same manner. If you increase the ring volume above maximum it will set an escalating ring tone. If you turn the ring volume off, the silent indicator icon (🔇) will be displayed.

- 1 From **Idle** mode press (☰) (5 JKL) (2 ABC) to enter the **Tones** menu
- 2 Use (⏪) to select **Ring Volume** or **Key Volume** and press (☰)
- 3 Use (⏪) to set the volume level and press (☰)





Phonebook

Phone numbers can be stored in two locations. You can store numbers in the SIM Phonebook (therefore the number of locations, length of name and number of phone numbers are SIM dependent). Alternatively you can store phone numbers in the Mobile Phonebook, this means that if you change the SIM the numbers in the phone are not lost.

The Mobile Phonebook has the advantage that you can group your phonebook entries together.

Store a Number





To Store a Number in the SIM Phonebook



- 1 From **Idle** mode enter the phone number and press 
- 2 Press  to select the SIM Phonebook
- 3 Enter the name – see “Text Entry” page 48, and press 
- 4 Confirm phone number and press 
- 5 Enter location number and press 





You can choose not to enter a location number and the entry will be placed in the next available location. Simply press  when **Any** is displayed in the option area.

To Store a Number in the Mobile Phonebook

- 1 From **Idle** mode enter the phone number and press 
- 2 Use  to select the Mobile Phonebook and press 
- 3 Enter the name - see “Text Entry” page 48, and press 
- 4 Confirm phone number and press 

If you wish to store an e-mail address with the current number then after confirming the number press , enter the mail address and press .

- 5 Use  to select a group - see “Grouping Phonebook Entries” page 12 - into which to place the entry and press 
- 6 Enter location number and press 

You can choose not to enter a location number and the entry will be placed in the next available location. Simply press  when **Any** is displayed in the option area.

Overwrite Protection







If a location is occupied you will be prompted to confirm that you wish to overwrite the current information.

Press  to overwrite the selected location

Press  to choose another location number



Browsing Phonebook

You can search the Phonebook by either Name or Location. The default setting for browsing is by name. When browsing by name pressing a lettered key will take you to the first entry starting with that letter.

- 1 From **Idle** mode press   to enter the **Phonebook** menu
- 2 Use  to toggle between **Names** or **Loc'ns** display mode and press 
- 3 Use  to select the Phonebook you wish to browse and press 

Retrieve a Number



From **Idle** mode:

- 1 Press 
- 2 Use  to browse through the Phonebook

Once you have selected a phone number or name, there are a number of actions that you can perform. To dial the selected number press .



Note: *The Phonebook you last viewed will be the default when you next press . To change the default, use the Phonebook menu to select a particular phonebook.*

Speed Dial a Number Stored in SIM Phonebook

- 1 Enter location number – leading zeros may be left out
- 2 Press 
- 3 Press 



Editing Phonebook Entries

You can Detail, View, Recall, Edit, Delete or Create in the Phonebook. To access any of these functions you follow the same procedure. With a phone number or name displayed:

- 1 Use  to cycle through **Detail**, **View**, **Recall**, **Edit**, **Delete** or **Create**
- 2 Press  to select an option

Phonebook

Detail

Displays each element of the selected Phonebook entry. Use  to display the next/previous element of the entry. Each element may be edited - use  until **Edit** is displayed in the option area and press .

View

Displays an individual name and phone number in the names list.

If an e-mail address is present in the Mobile Phonebook this will be displayed along with the name and number.

Recall

Displays the phone number, enabling you to either change it or call the number.

Edit

Displays the entry allowing you to make changes as required. Press  to save any changes.

Delete

Deletes the entry from the Phonebook.

Create

Creates a new entry in the Phonebook







Grouping Phonebook Entries

The ability to group phonebook entries together is an extra function of the Mobile Phonebook.







Retrieving a Number from a Group

Groups are used to collect together types of Phonebook entries, for example business and personal. Each group can be suitably titled for quick access to the entries contained within.

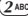
An alert profile can be attributed to groups, or a phone number, thus allowing incoming calls to be tailored to indicate the type of caller.

- 1 From **Idle** mode press   to enter the **Group Settings** menu
- 2 Use  to select the group and press 
- 3 Use  to select the entry required and press  to recall the number.















Retitling Group Names

- 1 From **Idle** mode press    to enter the **Group Settings** menu
- 2 Use  to select the group
- 3 Use  until **Edit** is displayed in the option area and press 
- 4 Clear the current title and re-enter - see "Text Entry" page 48
- 5 Press 

Using Alert Profiles

Alert Profile enables you to identify callers with a particular ring tone, display picture and backlight colour, making it easier to distinguish between callers or groups of callers.





Creating an Alert Profile

- 1 From **Idle** mode press    to enter the **Alert Profile** menu
- 2 Press  to insert a new profile
- 3 Use  to select **Personal** or **Group** and press 
- 4 Recall the phone number / select group from the Phonebook – see "Retrieve a Number" page 11 and press 
- 5 Press 
- 6 Use  to select the ring tone that you wish to use for this profile and press 
- 7 Use  to select the picture and press 
- 8 Use  to select the backlight colour and press 

Personal Dial



The  key can be defined to recall your favourite phone number in preparation for initiating a call.

Setting the Personal Dial Number

- 1 From **Idle** mode press    to enter the **Personal Dial** menu
- 2 Enter the name - see "Text Entry" page 48, and press 
- 3 Enter the phone number and press 

Using Personal Dial

From **Idle** mode:

Press  to recall the number, then press  to initiate a call

Hot Key Phone Numbers

It is possible to dial phone numbers from the Phonebook or Service Dial part of Phonebook very quickly. Some Hot Key Phone numbers may be reserved by the Service Provider, for example the first three Hot Key Phone numbers may be linked to Service Dial (network dependent).

- 1 Press and hold a Digit key (1) to (9 WXYZ)
- 2 Press (↶)

Setting the Hot Key Dial Source

- 1 From **Idle** mode press (☰) (2 ABC) (7 PQRS) to enter the **Hot Key Dial** menu
- 2 Use (↓) to select **SIM Phonebook** or **Mobile Phonebook** and press (☰)

Service Dial Numbers

Your Service Provider may program some special phone numbers into your SIM (network dependent). It is not possible to modify the Service Dial numbers.

- 1 Press and hold (☰)
- 2 Press (↓) to browse through the Service Dial list of phone numbers

The phone number pointed to can only be recalled or dialled.

Review the Phonebook

The **Review** function in the Phonebook menu shows how many locations are available in the Phonebook.

- 1 From **Idle** mode press (☰) (2 ABC) (5 JKLM) to enter the **Review** menu
- 2 Use (↓) to select **SIM Phonebook** or **Mobile Phonebook** and press (☰)







A summary of the selected Phonebook will be displayed.

- 3 Use (↓) to gain a detailed view of the Phonebook locations. Occupied locations are shown with "■".



My Numbers

My Numbers is a convenient part of Phonebook where your voice, fax and data phone number(s) can be stored and viewed. This function is SIM dependent.

Adding Numbers

- 1 From **Idle** mode press   to enter the **My Numbers** menu
- 2 Use  until **Create** is displayed in the option area and press 
- 3 Enter the name - see "Text Entry" page 48, and press 
- 4 Enter the phone number and press 
- 5 Enter location number and press 

Viewing Stored Numbers

- 1 From **Idle** mode press   to enter the **My Numbers** menu
- 2 If more than one number is available then use  to cycle through the listed numbers

Personalising Your Phone

Add a Start-up Greeting

A personalised greeting can be programmed for when the phone is switched on.

- 1 From **Idle** mode press **5** **JKL** **4** **GHI** **1** to enter the **Greeting** menu
- 2 Use the text entry facility to add your greeting and press - see "Text Entry" page 48

Displaying Animations

Animations can be displayed when the phone is switched on.

- 1 From **Idle** mode press **5** **JKL** **4** **GHI** **4** **GHI** to enter the **Animation** menu
- 2 Use to cycle through the animated themes available
- 3 Press to select either the desired theme, or disable the animation



Changing the Ring Tone

The ring tones of the phone can be changed to one of many pre-defined sounds or to a voice ringer (a voice recording used as a ring tone).

Each of voice, fax, data and message can have a different ring tone.

Alternatively you can use the **Melody Composer** to generate your own ring tone.

Setting up a Pre-defined Ring Tone

You can choose from a selection of tones and melodies.

- 1 From **Idle** mode press **5** **JKL** **2** **ABC** **3** **DEF** to enter the **Ring Type** menu
- 2 Use to select the appropriate call type to be changed and press
- 3 Press to select the desired ring tone and press

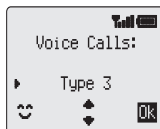







Recording a Voice Ringer

- 1 From **Idle** mode press **5** **JKL** **2** **ABC** **5** **JKL** to enter the **Voice Ringer** menu
- 2 Press **1** and start speaking into the microphone to record your voice. The recording will stop automatically after 5 seconds, or before if is pressed.
- 3 To playback the recording press **2** **ABC**

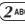
Composing a Melody





Up to 3 user-defined melodies can be created.

- 1 From **Idle** mode press     to enter the **Melody Composer** menu
- 2 Use  to cycle through the melodies
- 3 Press  to edit the chosen melody

Using the following table as reference, enter the notes (from the choice of low, middle and high), rests, and the durations of each, to generate your composition.

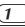
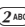
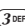
At any time during composing press  to play back the current melody.

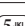
Once the composition is complete press  to save it.

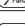
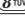
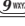
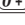
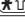
Key	1st press	2nd press	3rd press	4th press	5th press	6th press
	C	C#	low C	low C#	high C	high C#
	D	D#	low D	low D#	high D	high D#
	E	low E	high E			
	F	F#	low F	low F#	high F	high F#
	G	G#	low G	low G#	high G	high G#
	A	A#	low A	low A#	high A	high A#
	B	low B				
						
						
	rest					
 (duration)	1/8	1/16	1/1	1/2	1/4	
 (duration)	1/2	1/1	1/16	1/8	1/4	

Editing your Melody

Once the melody has been saved the following operations can be used for re-editing purposes:



Press  to delete the character to the left of the cursor

Use  to navigate the cursor around the screen

Use the relevant keys to insert new notes/rests

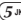
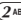
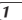

Personalising Your Phone

Disabling all Tones

- 1 From **Idle** mode press     to enter the **All Tones** menu
- 2 Press  to disable all tones and the silent indicator icon () will be displayed.

Repeat the process to enable all tones.

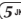
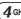
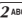
Setting the Backlight Colour

- 1 From **Idle** mode press     to enter the **Backlight Colour** menu
- 2 Use  to cycle through the colours available
- 3 Press  to select the desired colour

Disabling Key Backlight

The keypad has a green backlight which can be enabled/disabled as follows:

- 1 From **Idle** mode press     to enter the **Key Backlight** menu
- 2 Press  to disable the backlight

Repeat the process to enable the key backlight.

Disabling Back Case Light

The back case of the phone has an LED which is lit continuously during a call. This may be enabled/disabled as follows:

- 1 From **Idle** mode press     to enter the **Back Case Light** menu
- 2 Press  to disable the back case light







Repeat the process to enable the back case light.

Using Voice Commands

Before you can use any of the phone's voice activated functions you will need to configure the phone so that it will recognize your own voice and intonation.

Voice Dial Setup

This function allows you to recall numbers from your Phonebook using voice commands.

- 1 From **Idle** mode press     to enter the **Voice Dial** menu
- 2 Press  to create a new command
- 3 Browse through the Phonebook to select an entry which you wish to attribute a voice command to, and press 



Note: Each recording is short in length, so be prepared to speak once you have initiated the recording.





- 4 When ready, hold the phone approximately 7" (178mm) from your mouth, press  and speak clearly into the microphone to record the name of the selected Phonebook entry

When the recording has stopped, you will be prompted to repeat the name

- 5 Press  and repeat the name

Once recording is complete for a second time, the display will indicate if the recording was successful or not. If unsuccessful, repeat from step 4.

Dialling Using Voice Command

From **Idle** mode press and hold the navigation key () in any one of the four directions , ,  or . Speak clearly the name you wish to dial (exactly as recorded) and wait

The above procedure will recall the phone number and the requested Voice Dial is repeated; to initiate the call press .

Editing the Voice Commands

You can add, play or delete any of the Voice Dial commands. With a Voice Dial entry displayed:

Use  to cycle through **Add**, **Play** or **Delete** and press  to select an option

Add

To record the voice command again

Play





To listen to your recording

Delete

To delete an entry







Selecting Vibration Alert Type

The vibration alert facility may be set to vibrate continuously or intermittently.

- 1 From **Idle** mode press    to enter the **Vibration Alert** menu
- 2 Use  to select the type of vibration desired and press 



Changing the Language

It is possible to change the language that the phone uses for either the display messages and/or for text entry.

- 1 From **Idle** mode press    to enter the **Language** menu
- 2 Use  to select **Display Language** or **Tegic Language** (text entry) that you wish to change and press 
- 3 Use  to select the desired language and press 

Restoring the Default Phone Settings

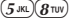
Any personal settings can be returned to their factory default, with the exceptions of the Phone Lock code and the Language.

- 1 From **Idle** mode press   to enter the **Defaults** menu
- 2 Press  to restore the default settings

Phone Security

The phone features a number of security functions that protect against unauthorized use, and enable you to restrict access to certain features - see "Using the PIN" page 8. It is recommended that you memorize your security codes. If you need to make a note of your security codes, never write them in a way that they can be recognized by another person. If you forget them contact your dealer for the Phone Lock Code or your Service Provider for PIN and PIN2.

Using Key Guard

The **Key Guard** function is used to prevent any keys from being accidentally pressed e.g. when the phone is being carried.

From **Idle** mode press  three times to enable Key Guard











When a call is received Key Guard will be disabled temporarily, allowing you to press any key to answer the call. Emergency calls can still be made.

Disabling Key Guard

When **Free** is displayed in the option area press  twice









Changing the Security Codes

- 1 From **Idle** mode press   to enter the **Security** menu
- 2 Use  to select **Phone Lock**, **PIN** or **PIN2**
- 3 Use  until **Change** is displayed in the option area and press 
- 4 Enter the current code and press 
- 5 Enter the new code and press 
- 6 Verify the new code and press 

Restricting Calls





Call Barring

The **Call Bar** function is used to restrict certain outgoing and/or incoming calls. Call Bar is controlled by a security password that is supplied by your Service Provider. When updating or checking the status of Call Bar the phone must be registered with a network. Different Call Bar restrictions can be used for voice, fax and data calls. Any combination of call restrictions can be set.

- 1 From **Idle** mode press    to enter the **Call Bar** menu
- 2 Use  to select **Bar Voice**, **Bar Fax** or **Bar Data** and press 
- 3 Use  to select level of call barring that you wish to apply and press 
- 4 Enter Call Bar password and press 

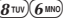
Barred Dialling

The **Barred Dial** function enables you to bar all phone numbers pre-programmed in the SIM from being dialled on the phone. To use this function PIN2 is required.

From **Idle** mode press    and press  to enable **Barred Dial**, enter PIN2 and press 

Fixed Dial

The Fixed Dial Store is part of Phonebook, but with additional security. When the security feature **Fixed Dial** is enabled it is only possible to make calls with phone numbers that are in the Fixed Dial Store.

When **Fixed Dial** is enabled any manually dialled phone numbers must match a phone number in the Fixed Dial Store.

To store, edit or delete a phone number in the Fixed Dial Store the **Fixed Dial** function must be enabled. With **Fixed Dial** enabled, all phone numbers can be added, edited or deleted as normal, but you will be prompted for PIN2.

“Wild” Numbers

Wild numbers are spaces that can be stored in a phone number. The “wild” numbers must be filled before the phone number is dialled. Used in conjunction with Fixed Dial calls can be restricted, for example, to a specific area by storing the area code of a phone and when recalled the remainder can be added. The “wild” numbers can be anywhere within a stored phone number.

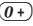
- 1 Press and hold  until _ is displayed to enter a wild number
- 2 When the phone number is recalled pressing a numeric key will fill in a “wild” number.

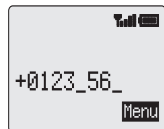

Applications

Clock

This phone incorporates a clock with date/time, an alarm and a power on/off feature. A second clock for dual time is also included - see "Second Clock" page 47.

Initially Setting the Home Time

- 1 From **Idle** mode press to enter the **Time Set** menu and press
- 2 Use to select whether you require Summer Time setting on or off and press
- 3 Enter the digits for the date in the format day/month/year and press
- 4 Enter the digits for the time using 24 hour clock and press



Setting the Clock Format

- 1 From **Idle** mode press to enter the **Display Format** menu
- 2 Press to cycle through the different clock and/or date formats
- 3 Press to select the desired clock display type

Altering the Time/Date

- 1 From **Idle** mode press to enter the **Time Set** menu and press
- 2 Press and hold to remove the current date
- 3 Enter the digits in the format day/month/year
- 4 Press to accept the date
- 5 Press and hold to remove the current time
- 6 Enter the digits using 24 hour clock and press

Setting the Clock for Summer Time

- 1 From **Idle** mode press to enter the **Summer Time** menu
- 2 Press to set Summer Time on.

If Summer Time setting is on then press to turn it off

Applications

Setting the Alarm

If you have not already set the clock, you will be prompted to do so prior to setting the alarm.

There are four separate alarms, each of which may be set independently.

- 1 From **Idle** mode press to enter the **Alarm Set** menu and press
- 2 Use to select the alarm to be set and press
- 3 Enter the digits for the time and press
- 4 Use to select the frequency of the alarm and press
- 5 Use to select the ring type and press

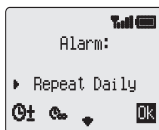

Once the alarm has been set, will be displayed in the information area when the phone is in **Idle** mode.

The alarm is activated in accordance with the current clock (Home or Visitor)

Muting the Alarm

When the set time is reached the alarm will sound and the display will flash with an alarm message. The alarm will sound for 30 seconds. If the alarm is due during a call, it will activate vibration alert.

To end the alarm:

Press any key

Disabling the Alarm

- 1 From **Idle** mode press to enter the **Alarm Set** menu and press
- 2 Use to select the alarm to be disabled and press twice
- 3 Use until **Disabled** is displayed and press

Once disabled, following the same procedure will re-enable the alarm.

Adjusting the Alarm Time

- 1 From **Idle** mode press to enter the **Alarm Set** menu and press
- 2 Use to select the alarm to be adjusted and press
- 3 Press and hold to remove the current alarm time
- 4 Enter the digits for the time and press
- 5 Press to select the frequency of the alarm and press
- 6 Use to select the ring type and press

Setting a Power On/Off Time

You can set your phone to turn itself on or off automatically at a specified time using the Power On/Off feature. The procedure for setting/adjusting the Power On/Off automatically is similar to that for setting the time on the clock. For either setting or adjusting the time you need to select **Power On Time** or **Power Off Time** in the **Clock Function** menu.

Caution: Ensure that the setting of the Power On function will not contravene any regulations whereby it may automatically power on when in an aircraft or medical facility etc. - see "Important Information" page 54.

Calculator

The four function calculator will enable you to perform simple arithmetic calculations (addition/subtraction/multiplication and division).

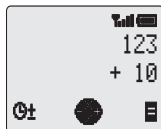

- 1 From **Idle** mode press to enter the **Calculator** menu
- 2 Enter a number (maximum 10 digits) and it will be displayed on the lower line
- 3 Use to select the arithmetic operation you wish to perform (to multiply, to add, to divide, to subtract)
- 4 Enter a number (maximum 10 digits) and it will be displayed next to the operation symbol
- 5 If you use to select another arithmetic operation to perform, an intermediate calculation will be performed and the result displayed on the upper line
- 6 Press to complete the calculation when is displayed in the option area

Note: Press and hold to add a decimal point.

Currency Converter

The currency converter enables you to convert from/to a home currency using a conversion rate that you enter.

From **Idle** mode press to enter the **Currency** menu

Entering an Initial Conversion Rate

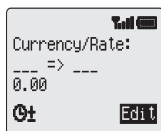

- 1 Press
- 2 Enter a country code for the home currency (up to 3 characters) and press
- 3 Enter a country code for the foreign currency (up to 3 characters) and press
- 4 Enter the currency conversion rate and press





Applications

Note: Press and hold **1** to add a decimal point.



Converting a Value

- 1 Check the conversion rate is the one you require and press 
- 2 Enter the value to be converted and press 

The country code and currency rate will be retained in the phone once entered. The next time you use the convertor you can edit the conversion rate/country codes while in the Currency/Rate display. Use  until **Edit** is displayed in the option area and press .

Swapping the Currency Conversion

When you have accepted the conversion rate and are ready to enter the value to be converted, you can swap the currencies to convert from the foreign currency into the home currency.

- 1 Use  until **Swap** is displayed in the option area and press 
- 2 Enter the value for conversion and press 

Short Text Messages



You can receive, display, edit and/or send short text messages, of up to 160 characters to mobile phones on the same network or any network that has a roaming agreement.

Setting the Phone for Text Messages

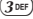
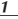

Before you can send a message you must enter the Message Centre number into Parameters (your Service Provider will supply the Message Centre number).

The Message Centre number may have been preprogrammed, on your SIM card.

Setting the Message Centre Number



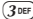
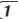
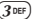

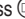

- 1 From **Idle** mode press      to enter the **Message Centre** menu.
- 2 Enter message centre number in international dial format – see “International Dialling” page 6

Sending a Text Message



- 1 From **Idle** mode press     to enter the **Create** menu and press 
- 2 Enter the message (up to 160 characters) – see “Text Entry” page 48 and press 



You will be prompted if you wish to send the message, if you do not wish to send the message press , the message will be stored.

- 3 Press  and enter the destination phone number (or recall a number from the Phonebook) - see “Retrieve a Number” page 11 and press 
- 4 Press 
- 5 You may be asked if you wish to have delivery confirmation, if you do not want confirmation press . If you do, use  until **Yes** is displayed in the option area, then press 

The default setting for delivery confirmation can be enabled/disabled using the **Report** parameter in the **Short Message** menu.

- 6 Use  to select a melody type, if required, and press 

Receiving Text Messages

When a Short Text Message is sent to your phone the message indicator (☑) will blink in the display, with an audible tone or vibration. This indicates that a new message has been received.

When **Read** is displayed in the option area press (☑) to read the message. Use (⬅) to navigate through the message and to identify the sender of the message.

Note: If the message indicator is displayed constantly (does not blink) this indicates that the message area is full and you will need to delete old messages in order to be able to receive new messages in the future.



Message Options

Reply to a Message

When you have received and read a message you may wish to reply to the sender. This is the default setting in the option area and pressing (☑) will allow you to create a reply message.

Delete a Message

While reading a message use (⬅) until **Delete** is displayed in the option area. Press (☑) twice to delete the message. To enable the auto-deletion of messages - see "Message Parameters" page 30.

Edit a message

While reading a message use (⬅) until **Edit** is displayed in the option area. Press (☑) and make any amendments. Pressing (☑) will give you the option to send the edited message - see "Sending a Short Text Message" page 27. Press (C) if you do not wish to send the message and it will be stored in the **Send List**.

Using Pre-defined Messages

Pre-defined messages can be sent immediately or they can be used as a basis for a longer message and edited accordingly.

- 1 From **Idle** mode press (☑) (3 DEF) (1) (3 DEF) to enter the **Create** menu
- 2 Use (⬅) to point to the pre-defined message you wish to use and press (☑)
- 3 Use (⬅) to navigate through the message and add any extra text – see "Text Entry" page 48

When complete the message can be sent - see "Sending a Text Message" page 27

User Defined Message

Creating a User Defined Message

It is possible to create a user defined message which, once generated, can be used as any other pre-defined message.

From **Idle** mode press    . Edit the message as required and press .

Selecting the User Defined Message







From **Idle** mode press    .

The user defined message will be displayed at the top of the list of pre-defined messages.

Use  until the  prompt is adjacent to the message and press .

Changing the Pre-defined Message Language

With the pre-defined message highlighted:

- 1 Use  to select **Lang** in the option area and press .
- 2 Use  to select a language and press .
- 3 Use  until **Select** is displayed in the option area and press  twice to send the message

Manage Messages Lists

All messages, whether sent or received, will be stored on the SIM until they are deleted. Selecting a stored message allows it to be replied to, edited or deleted.

Receive List

Messages received will be stored in the **Receive List**. A blinking “*” indicates an unread message.

When reading a message the sender's information is displayed below the text indicating the time the message was sent and the message centre number. Pressing  allows you to reply to the message.

Send List

When a message has been sent or edited it will be stored in the **Send List**.

Review

Review allows you to check usage of the message area.

Message Parameters

From **Idle** mode press     to enter the **Parameters** menu. The following parameters can be set:

Auto Delete

When set will erase messages automatically:

Received Read - will overwrite the oldest read message

Received Any - will overwrite the oldest message even though it may not have been read.

Lifetime

This is the duration that your message is stored at the Message Centre. Delivery attempts will be repeated until the message has been delivered or the Lifetime expires.

Message Centre

Allows the Message Centre phone number to be edited - see "Setting the Phone for Short Text Messages" page 27.

Report

When your message has been delivered a confirmation will be received if **Report** is set to **Yes**.

Protocol







The Message Centre may be able to convert the message to the format specified by the selected protocol.

Cell Broadcasts

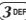
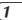



Cell broadcasts are general information that is sent to your phone by a network operator. The information can include topics like local traffic reports, weather etc.

Setting Broadcast Topics

You need to specify the topic(s) of information that you wish to receive as broadcasts before you can receive them.

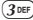
- 1 From **Idle** mode press      to enter the **Topics** menu
- 2 When **Insert** is displayed in the option area press 
- 3 Use  to cycle through the available topics and press  to insert the currently displayed topic into your broadcast list

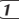
Enabling/Disabling Broadcasts

- 1 From **Idle** mode press      to enter the **Receive** menu
- 2 Press 

Once enabled, following the same procedure will disable broadcasts.

Message List

This is a store for the last received broadcast messages. Messages can be deleted from here.

Language

The **Language** in which broadcast messages are displayed can be changed (network dependent).

Call Information





Recent Numbers

Recently dialed phone numbers will be stored in **Last Dialed**.

If Caller Identification is available the caller's phone number for an answered call will be stored in **Answered** and an unanswered call will be stored in **Unanswered**.

If Caller Identification is not available then calls will still be stored but will have the date and time attributed to them.

When the store is full the next phone number will overwrite the oldest.

- 1 Press 
- 2 Use  to select **Last Dialed**, **Answered** or **Unanswered** and press 
- 3 Use  to select the phone number (or name) you wish to redial and press 

You can edit or delete the phone number before dialling – see “Editing Phonebook Entries” page 11.

If you wish to store the selected number in Phonebook, press  while the number is displayed – see “Store a Number” page 10.





Calling the Last Dialed Number





To redial your last called phone number press  

Returning an Unanswered Call

When the display shows that you have received calls but not answered them.

- 1 Press 
- 2 The last caller's phone number will be displayed if it is available
- 3 Press  to select the phone number you wish to dial
- 4 Press 

Call Duration

- 1 From **Idle** mode press   to enter the **Call Service** menu
- 2 Use  to select one of the functions described below, and press 

The **Last Call** function will display the duration and call charge, if available, of the last call during **Idle** mode or the current call during a call. Times are indicated as: hours (0-99), minutes (0-59), seconds (0-59) - HH:MM:SS.

The **All Calls** function displays the accumulated duration and call charge, if available, of incoming and outgoing calls. The lock code or PIN2 is required to reset the timer and call charge.

Call Charges



To maintain control over the cost of calls that are made, the phone can be set to restrict use to a finite number of units overall.

Setting the Unit Price

Firstly, a price per unit must be entered. This is the cost that the Service Provider charges for one unit of call time.

- 1 From **Idle** mode press     to enter the **Price/Unit** menu
- 2 Press  to edit the values

At this point you will be asked to enter your PIN2.

- 3 Enter a currency unit (up to three characters) and press 
- 4 Enter a price and press 

Setting the Maximum Unit Level

- 1 From **Idle** mode press     to enter the **Max Cost** menu
- 2 Press  to edit the values







At this point you will be asked to enter your PIN2.

- 3 Enter a value (number of units) which is to be the maximum permitted, and the corresponding cost will be displayed
- 4 Press  to accept

***Note:** The duration of one unit may vary during the day, peak and off-peak times. Therefore, the call charge can be calculated accordingly. However, call charge information may not give an accurate reflection of the tariffs charged by your Service Provider.*

Setting a Warning Level

A warning can be set as an indication that the maximum cost is about to be reached.

- 1 From **Idle** mode press     to enter the **Warning at** menu
- 2 Press  to edit the value
- 3 Enter a value (in units) at which time you would like the warning to sound and press 

Call Identification







In the **Call Service** menu, the **Caller's ID** and **Withhold ID** functions allow you to check the status of whether a Caller's Identification is sent or can be received.

***Note:** When checking the status the phone must be registered with a network.*

Advanced Operation

Diverting Calls

Voice, fax and data calls can be diverted using different circumstances and to different numbers. For example you may wish voice calls to be diverted to Voicemail in the event that the phone is switched off.



- 1 From **Idle** mode press   to enter the **Call Divert** menu
- 2 Use  to select the type of calls to divert and press 
- 3 Use  to select the circumstances to initiate the divert and press 
- 4 Enter phone number to divert to and press 

When a divert situation is enabled the divert icon () is displayed.

When updating or checking the status of **Call Divert** the phone must be registered with a network.

Holding Calls and Call Waiting

Holding/Resuming a Call

- 1 Press  when **Hold** is displayed in the option area
- 2 Press  when **Resume** is displayed in the option area

Making a Second Call

- 1 Enter phone number (or recall from Phonebook – see “Retrieve a Number” page 11)
- 2 Press 

The first call will be placed on hold.

Receiving a Second Call

A second call can be received, if **Call waiting** is switched on. This is enabled from the **Call Service** menu. It is not possible to have more than one fax or data call. All voice calls must be ended before you can make or receive a fax or data call.

Accept a Second Call



Press  when **Accept** is displayed in the option area

The current call will be placed on hold.

Reject a Second Call

- 1 Press  to display **Reject** in the option area
- 2 Press 

End Current Call and Receive Second Call

- 1 Press  with a waiting call
- 2 Press any key except  or 

Operation During Two Calls

Swapping Between Calls

The  prompt indicates the current call

Press  when **Swap** is displayed in the option area

End Current Call

- 1 Press  to display **End** in the option area
- 2 Press 

The held call will remain held.

End Both Calls

Press 

Call Transfer

With two calls connected, Call Transfer enables you to connect them together ending your connection, leaving the other parties to talk together without you.

When you have two calls:

- 1 Press  to display **Trans.** in the option area
- 2 Press 

The two calls will be connected to each other and your call will be ended.

Note: Two call transfer cannot be utilized while in Multi-party mode.

Multi-party Calls

A Multi-party call enables three to five people to be in conversation at the same time. It is possible to swap between a Multi-party call and another call in the same way as with two separate calls.

Enabling Multi-party

With two calls connected (one active, one on hold):

- 1 Press  to display **Merge** in the option area
- 2 Press 

A Multi-party call has been enabled, all three people will be able to talk to each other.

Advanced Operation

Adding to Multi-party





You can add to the Multi-party call (up to a maximum of five). Either by making a call or accepting an incoming call. The call can then be merged into the Multi-party.

Note: When making a call or accepting an incoming call the Multi-party call will be placed on hold. The callers in the Multi-party call can continue to communicate with each other while on hold.

Splitting a Multi-party

You can select an individual from the Multi-party and remove their connection. This enables you to talk privately without the participation of the rest of the Multi-party.

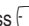
During a Multi-party call:

- 1 Use  until **Option** is displayed in the option area and press 
- 2 Press  to select a caller in the Multi-party
- 3 Press  to display **Split** in the option area
- 4 Press 





The selected caller will be split from the Multi-party call and the Multi-party call will be placed on hold (the remaining Multi-party call callers can still communicate).

Ending Multi-party Calls

You can either select an individual in the Multi-party and end the call or end the entire Multi-party call. If a call is held, or an other call is incoming then an individual call cannot be ended.

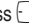
Ending a Single Connection

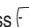
During a Multi-party call

- 1 Press  to display **Option** in the option area and press 
- 2 Press  to select a caller in the Multi-party
- 3 Press  to display **End** in the option area
- 4 Press 

Ending a Multi-party Call

During a Multi-party call:

- Press  to end all the calls at once

Changing to a New Network

When not in your home country you may use a network that you do not directly subscribe to, this is called ROAMING. National Law may not permit roaming in your home country.

The **New Network** function is used to manually select a network that is available in your current location.

- 1 From **Idle** mode press    to enter the **New Network** menu
- 2 Use  to select one from the list of available networks and press 

An **X** will be displayed in the information area if you cannot register with the selected network.

When the **Search Mode** is set to **Automatic** the phone will automatically reselect a new network in order to maintain optimum network availability. With the **Search Mode** set to **Manual** the phone will only use a selected network. If coverage is lost another network should be selected.

The **Network List** is used when the Search Mode has been set to **Automatic**. The location numbers in the Preferred Network List show the search priority.

Selecting **Insert** stores a new network in the currently displayed location and then moves other networks down, **Edit** overwrites the old network with a new one, and **Add** stores a new network at the end of the list.

WAP Browser







The phone's WAP (Wireless Application Protocol) Browser enables you to access internet services supported by the network, such as news, weather reports, sport etc.

Server Settings



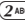





Before you can access internet services, your SIM must be data enabled and the relevant configuration information, entered into the phone.

These settings may have been pre-programmed for you by the network operator.

Note: Modifying previously entered settings can cause failure of the Browser.

- 1 From **Idle** mode press     to enter the **Server Setting** menu
- 2 Two servers may be setup on the phone. Use  to select one or other of the server settings
- 3 Use  until **Edit** is displayed in the option area and press 

A list of configuration parameters will be displayed. The parameter **Name** will be highlighted and **Edit** will be displayed in the option area

- 4 Press 
- 5 Enter the name of the WAP server and press 
- 6 Use  to select each of the other parameters in turn and press  in order to enter the information
- 7 Press  and select the next parameter in the list
- 8 After all parameters have been entered, press  to return to the previous menu level
- 9 Use  until **Set** is displayed in the option area and press  to store the settings

Record your WAP settings in the table at the rear of this booklet for easy reference.

Activating the Browser

The Browser can be activated either by:

From **Idle** mode pressing and holding the  key

or

From **Idle** mode press   

The first time that the browser is activated there will be no content stored so the Home URL content will be displayed (as defined by the network operator). From the second time onwards, the last displayed page will be recalled from cache (Cache is the phone's memory that stores content downloaded in the past). When recalling content from cache the phone remains off-line (not connected to a WAP server).

Navigating Content

Use the Navigation key (⏪) to scroll through the content on the screen as follows:

Press ⏪ to scroll up/down on the current page

Press ⏪ to return to the previous page

Press ⏪ to return to the next page (only applicable if returned to previous page)

When linked text (underlined text) is highlighted press ⏪ to load the page represented by the link.

⏪ indicates a table - when highlighted press ⏪ to view contents of table

⏪ Indicates an image which cannot be displayed

⏪ Indicates on-line browsing

⏪ Indicates off-line browsing

The Browser Menu

The Browser also contains its own menu which is applicable when content is currently being displayed (either on-line or off-line).

The Browser menu is accessed by pressing the Phonebook key (☎) when **Menu** is displayed at the bottom left of the display.



This menu is used as follows:

- | | |
|------------------|--|
| Home Deck | Displays the Home URL content as defined by the network operator |
| Bookmark | Use, add, delete and rename bookmarks |
| Enter URL | Type in a URL directly to go to a known site |
| Reload | Will reload and update the current page |
| Reset | Deletes the content in cache and displays the Home URL content |





Using Bookmarks

Frequently accessed pages may be bookmarked to save time. This prevents the need to re-enter the URL each time.









Adding a Bookmark

While viewing content press     to register a bookmark

Recalling Pages Using Bookmarks

- 1 With content displayed press   
- 2 Use  to select the relevant bookmark from the list, and press 

Renaming a Bookmark

- 1 With content displayed press   
- 2 Use  to select the relevant bookmark from the list, and press  
- 3 Press and hold  to remove the bookmark name, then re-type the name required and press 

Deleting Bookmarks

- 1 With content displayed press   
- 2 Use  to select the relevant bookmark from the list, and press    

Deactivating the Browser

The Browser can be deactivated as follows:







When browsing on-line press  once to resume browsing off-line

When browsing off-line press  once to exit Browser

When browsing on-line or off-line press and hold  to exit Browser

Setting the Linger Time

The phone will be automatically disconnected from the WAP server after a set period of non-interaction. This period is defined in seconds by the **Linger Time** setting.

- 1 From **Idle** mode press     to enter the **Linger Time** menu
- 2 Press and hold  to remove the current linger time, then re-enter the value required and press 

Last Error

If an error should occur when using the Browser, use this function to inform the network operator of the last error which occurred with the phone to assist with a diagnosis of the problem.







From **Idle** mode press     to display the error

Internet E-mail

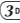
The E-mail function will send and receive internet e-mail messages to the mail server of an Internet Service Provider that supports POP3/SMTP protocols.

E-mail Setup







Before you can send and receive e-mail messages, your SIM must be data enabled and a contract must be set up with an Internet Service Provider and the relevant configuration information, supplied by the provider, entered into the phone.

- 1 From **Idle** mode press    to enter the **E-mail** menu
- 2 Use  to select **Parameters** and press 
- 3 Use  to select **Server Settings** and press 

Up to three Internet Service Providers may be setup





- 4 Use  until **Create** is displayed in the option area and press 

A list of configuration parameters will be displayed. The parameter **Profile Name** will be highlighted and **Edit** will be displayed in the option area

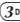

- 5 Press 
- 6 Enter the name of the Internet Service Provider and press 
- 7 Use  to select each of the other parameters in turn and press  in order to enter the information
- 8 Press  and select the next parameter in the list
- 9 After all parameters which have been supplied by the Internet Service Provider have been entered, use  until **Save** is displayed in the option area and press  to store the settings

Record your e-mail settings in the table at the rear of this booklet for easy reference. For additional information about setting up the Internet E-mail see <http://www.user.mci.co.uk>

Create a New Message



- 1 From **Idle** mode press    to enter the **E-mail** menu
- 2 Use  to select **Create** and press 
- 3 Enter the relevant details in the *To*, *CC*, *Subject* and *Message* fields, using  to navigate between them.

Note: *The To and CC fields must be entered using previously saved mail addresses in the Phonebook, retrieved in the normal fashion.*

- 4 After entering the necessary information press 
- 5 Use  until **Save** is displayed in the option area and press 

Send/Receive Messages

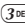
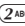
The **Send/Receive** function is used to both send messages created on the phone to the server of the Internet Service Provider, and to check your mailbox on the server for incoming messages and download them to the phone at the same time.

- 1 From **Idle** mode press    to enter the **E-mail** menu
- 2 Use  until the **Send/Receive** function is highlighted and press 

If there are unsent messages in the **Outbox** you will be prompted to send them.

- 3 Press  to send any unsent messages.

If there are new messages to download to the phone then you will be prompted to receive them.

- 4 Press  to receive new messages.



If no action is taken the connection will time out after one minute and return to the **E-mail** menu.

If any messages are downloaded then, when finished, the phone will display the new messages allowing them to be viewed, replied to etc.

If no messages are downloaded the phone will display the **Inbox** menu, unless there are no messages in this list, then it will return to the **E-mail** menu.



Read Messages



From **Idle** mode press    and press  to enter the **Inbox** menu

The header fields of the most recent messages will be displayed. Use  to scroll through previous message headers and press  to read the current message.

Message Status

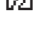
A message can be in one of four states. The current state of each message is indicated by an appropriate icon:

-  Indicates a message which has been read or sent.
-  Indicates an unread or unsent message
-  Indicates that the message has been locked
-  Indicates a broken message (either a message too long for the phone or a message which contains an attachment)

While reading a message any of the following operations may be performed by using the  key until the relevant operation is displayed in the option area and pressing :

Reply

Compose a reply to the sender of the current message

Forward

Send the current message to a different person other than the sender

Delete

Remove the current message from the list

Lock

Apply a lock to the message so that it cannot be overwritten when receiving further messages. A locked message can still be deleted manually.







Store an Address

An e-mail address can be stored in the Mobile Phonebook - see "Store a Number" page 10

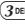
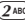
Add a Signature

This **Signature** function enables a pre-defined signature to be added to your outgoing e-mails. Once the signature has been setup, each time a new e-mail is created it will have the signature automatically inserted.

Setup Signature

- 1 From **Idle** mode press    to enter the **E-mail** menu
- 2 Use  until the **Parameters** function is highlighted and press 
- 3 Use  until the **Signature** function is highlighted and press 
- 4 Enter the text for your required signature – see "Text Entry" page 48 and press 

Manage Message Stores

Once the **Inbox** and/or **Outbox** store are full any new messages received or created will overwrite existing messages from the oldest first. To prevent messages being overwritten each list should be maintained deleting any messages which are no longer required. Important messages can have a lock applied to them so that they cannot be overwritten when the **Send/Receive** process is activated.

Additional Features

Desktop Handsfree

Desktop Handsfree enables you to hold a conversation without having to hold the phone to your ear.

Note: Do NOT hold the phone to your ear in Handsfree mode.

Swapping Between Handsfree and Handheld Calls

During a Handheld call:

- 1 Use  to until **H'free** is displayed in the option area
- 2 Press 

During a Handsfree call:

Press  to revert to Handheld operation

Answering a Call Handsfree

Pressing and holding  will allow the call to be answered Handsfree.

Voice Memo



You can record a two-way conversation for up to 18 seconds during a call. There are two separate areas for voice memo messages (Voice Memo 1, Voice Memo 2) allowing you to record two separate voice calls. If a different SIM is installed any voice memos will be lost.

Caution: Security of a recorded message is your responsibility. You **MUST** ask for the other party's consent before recording.

Record a Voice Memo

Press  during a call

A tone will sound when recording starts. When the recording stops a tone will sound to you.

If you press  while recording a voice memo, recording to the current voice memo area will stop. Pressing  again will start recording in the other voice memo area.

If  is pressed when the two voice memo areas are occupied, the older recording will be overwritten by the new memo.

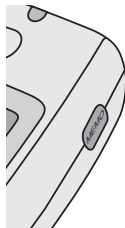

Play Back a Voice Memo

Press **(MEMO)** from **Idle** mode:

If there are two voice memos recorded they will both be played back continuously. To swap playback between the two voice memos areas press **(MEMO)** during playback.

If there is no recording two tones will sound.

To stop playing, press **(⏏)**

The Note Pad function is available during playback - see "Note Pad" page 46.

Volume Control During Playback

While playing back:

Press **(V)** to adjust the volume of the voice memo

Delete Memo

Press **(⏏)** twice during playback

Dicta Phone

The dicta phone facility allows two voice messages (of up to 10 seconds each) to be recorded, for later playback. If a different SIM is installed any voice messages will be lost.

Recording a Message

- 1 Press and hold **(MEMO)** key when in **Idle** mode
- 2 When ready, press **(⏏)** and speak clearly into the microphone to record your message.

Play Back a Message

- 1 Press and hold **(MEMO)** key when in **Idle** mode
- 2 Use **(V)** to select **Playback** and press **(⏏)**
- 3 To play the most recent message press **(⏏)**
- 4 To play the other message use **(V)** to select the second message in the list and press **(⏏)**

Delete a Message

While the message is playing or message list is displayed press **(⏏)** twice

Additional Features

DTMF Tones

DTMF tones can be sent during conversation. These are often used to access voice mail, paging and computerized home banking. For example, you may need to input a number to remotely access voice mail messages. A phone number may be stored in the Phonebook with DTMF tones, allowing the number to be dialled upon recall and the DTMF number to be sent automatically.

Send DTMF Tones During a Call

Enter digits (0 to 9, # and *)

Pause Dial

Using pauses allows you to send DTMF tones automatically.

- 1 Enter phone number
- 2 Press and hold **0+** until a **P** is displayed
- 3 Enter DTMF digits after the pause, e.g. enter the number to access voice mail messages.
- 4 Press **↶**

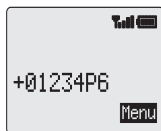

When the call is successful DTMF tones will be sent after 3 seconds or when **↶** is pressed.

If the DTMF tones are unsuccessful then the destination of your call may require that the length of the tones be increased.

- 5 From **Idle** mode press **☰** **5 JKL** **7 PQRS** to enter the **DTMF Length** menu
- 6 Use **↵** to set to **Long** and press **☰**

Note Pad

During a call you can enter numbers which you may wish to dial when the call has ended.

During a call:

- 1 Enter phone number
- 2 When the call has ended press **↶** to call that number

To store in Phonebook, press **⊕** while the number is displayed – see “Store a Number” page 10.

Second Clock

The Second Clock can either be set to auto-adjusting, whereby the second time will be automatically set from the country code of the current network, or a specified time difference can be set manually.

Setting Clock Display

From **Idle** mode press  4GHI 3DEF 2ABC 1 to enter the **Display Pattern** menu.

Use  to select either **Second Time** or **Home Time** and press .

Setting Auto Adjustment

If you travel to a country which has a roaming agreement with your home network, your Second Clock will be automatically adjusted. However, for countries which have several time zones in the same country manual adjustment is required.



- 1 From **Idle** mode press  4GHI 3DEF 1 2ABC 3DEF 2ABC to enter the **Auto Adjustment** menu.
- 2 Use  to select home country and press .

Enabling Auto Adjustment

From **Idle** mode press  4GHI 3DEF 1 2ABC 3DEF 1 to enter the **Auto Adjustment** menu and press .



Repeat to disable Auto Adjustment.

Setting Manual Adjustment

- 1 From **Idle** mode press  4GHI 3DEF 1 2ABC 1 to enter the **Time Difference** menu.
- 2 Use  to select the time difference required and press  to set the value



Setting Summer Time

- 1 From **Idle** mode press  4GHI 3DEF 1 2ABC 2ABC to enter the **Summer Time** menu.
- 2 Press  to set Summer Time on

Once enabled, following the same procedure will disable Summer Time.

Accessory Related Features

When **Auto Answer** is switched on, and Personal Handsfree is connected, a call will be answered without pressing any keys.

This is also applicable to the Handsfree Car Kit accessory.

See the documentation provided with the relevant Accessory for operational details.

Text Entry

The phone provides a means for entering alphanumeric characters to enter details into the Phonebook, to create text and e-mail messages etc. This section details the characters that can be entered and the relevant keys to press.

Text Mode					
Key	T9®	Normal (ABC)	Greek (ABΓ)	Extended (AĂÄ)	Numeric (0-9)
0 +	Alternatives				0+P_
1	Punctuation	space.@/;+~",!;?¿()[]{}'&%\^~ <>=€£\$¥¤§			1
2 ABC	abc	ABCabc	ABΓ	AĂÄ/ÆBCÇaăääæàbc	2
3 DEF	def	DEFdef	ΔEZ	DEÉFdeèèf	3
4 GHI	ghi	GHIghi	HΘI	GHIghiï	4
5 JKL	jkl	JKLjkl	KΛM	JKLjkl	5
6 MNO	mno	MNOmno	ΝΞΟ	MNŃOŃOmnñõøò	6
7 PQRS	pqrs	PQRSpqrs	ΠΡΣ	PQRSpqrsß	7
8 TUV	tuv	TUVtuv	ΤΥΦ	TUÜVtuüv	8
9 WXYZ	wxyz	WXYZwxyz	XΨΩ	WXYZwxyz	9
* (Shift)	Shift/Lock*	*	*	*	*
# (Space)	Space	#	#	#	#

* Press **(Shift)** once to enter a single capital letter (subsequent characters will be lower case). Pressing **(Shift)** twice acts as a keyboard CAPS LOCK function and subsequent characters will be uppercase, until **(Shift)** is pressed for a third time returning to lowercase character entry.

T9® Text Input

Using this mode of text entry dramatically reduces the number of key presses required:

Press a key once for any letter you require on that key. **The desired letter may not be displayed.** Continue pressing other keys until the end of a word is reached; then check that the word has been typed correctly before continuing on to the next word.

If the combination of letters typed has produced a word which is not the one you require, press **(0+)** repeatedly until the correct word is displayed. Continue to the next word.

If the word you require is not in the internal dictionary (i.e. It is a proper noun or a rarely used word) then it should be entered using the Normal (ABC) mode.

Other Text Modes



To access any of the other text entry modes use **(☰)** to cycle through until the desired mode is displayed in the Information Area.



When using Normal (ABC), Greek (ΑΒΓ) or Extended (ÅÄÏ) text entry modes, each time a key is pressed in quick succession it will display the next character available on that key (or if the key is pressed and held down it will cycle through the available characters). Releasing the key, or pressing another key will enter the currently displayed character and the cursor will move to the next position.

Editing Text

Pressing **(↑)** will move you up or down one text line (or field in Phonebook). Pressing **(←)** will move you left or right one character (or to the first character of the previous or next word when using T9® text entry mode). When the cursor is moved over a character and another key pressed this will insert the new character immediately before the selected character. Pressing **(C)** will delete the character to the left of the cursor or delete the current line when pressed and held.

Menu Structure

From **Idle** mode pressing  will display a menu of phone features. To select a feature press  so that the pointer is showing next to the feature that you require then press .

To exit the current menu and return to the previous level press . To exit completely out of the menu structure, press and hold , or  (except during a call).

1 Key Guard

2 Phonebook

- Browse
- Create
- Alert Profile
- Group Setting
- Review
- My Numbers
- Service Dial *
- Hot Key Dial
- Personal Dial

- Receive List
- Send List
- Create
- User Defined Msg
- Review
- Parameters
- Broadcasts

3 Messages

- Short Message
- E-mail

- Inbox
- Outbox
- Create
- Send/Receive
- Review
- Parameters

4 Applications

- Start Browser
- Browser Setting
- Clock Function
- Calculator
- Currency

- Clock Set
- Clock Format
- Alarm Set
- Power On Time
- Power Off Time

- Home
- Second

5 Personalise

- Language
- Tones
- Voice Command
- Display Setting
- Vibration Alert
- Auto Answer
- DTMF Length
- Defaults

- Display Language
- Tegic language

- Display Pattern
- Display Format

- Voice Dial
- Greeting
- Backlight Colour
- Contrast
- Animation
- Key Backlight
- Back Case Light

- All Tones
- Ring Volume
- Ring Type
- Melody Composer
- Voice Ringer
- Key Volume
- Warning Tone

6 Call Service

7 Call Divert

8 Security

- Phone Lock
- Call Bar
- PIN
- PIN2
- Fixed Dial
- Barred Dial

- Voice Calls
- Fax Calls
- Data Calls
- Cancel All
- Status

- Last Call
- All Calls
- Call Waiting
- Caller's ID
- Withhold ID
- Call Charge

- Bar Voice
- Bar Fax
- Bar Data
- Cancel All
- Status
- Password

- Cost Left *
- Price/Unit *
- Max Cost *
- Warning at *

9 Network

- New Network
- Search Mode
- Network List

* Function is SIM/network dependent

Trouble Shooting

Should any problem persist contact your dealer.

Problem	Cause	Remedy
Telephone will not switch on		Check that the Battery Pack is fully charged and correctly connected to the phone
Extremely short battery life for a new battery pack	The network you are using and the condition of the battery pack can affect battery life	
Short battery life for an old battery pack	The battery pack has worn out	Replace with a new one
The charging indicator does not light and the phone cannot be switched on when charging	When the Battery Pack has been deeply discharged the phone will take a short time until the indicator lights	Leave the phone charging the Battery Pack for a few minutes before the indicator is lit and attempting to switch it on
Calls cannot be made	The phone is locked	Unlock the phone
	Outgoing calls are barred	Disable the outgoing call barring, or barred dial
	The phone is not registered to a network	Move to a coverage area and operate your phone after it has registered with a network.
Calls cannot be made from Fixed Dial Store		<p>Check your SIM supports Fixed Dial</p> <p>Check if the Fixed Dial is switched on</p> <p>Check the phone number is stored in the Fixed Dial</p>

Trouble Shooting

Calls cannot be received	The phone is not switched on	Switch the phone on
	Incoming calls are barred	Disable the incoming call barring
	The phone is not registered to a network	Move to a coverage area and operate your phone after it has registered with a network.
Emergency calls cannot be made	You are not in a GSM coverage area	Check that the antenna symbol  is displayed - move to a coverage area and operate your phone when the antenna symbol is displayed
Telephone numbers cannot be recalled from Phonebook	The phone is locked	Unlock the phone
	Phone number has been restricted	Switch off restriction

Important Error Messages

These are some of the most important error messages which may be displayed:

Area Not Allowed	Roaming in the selected area is not allowed
Network Not Allowed	Roaming with the selected network is not allowed
Security Failure	The network has detected an authentication failure because your SIM is not registered with that network - contact your Service Provider
SIM Blocked / Contact Service provider	The SIM is blocked because one of the PIN/PIN2 unblocking keys (PUK/PUK2) has been entered incorrectly ten times - contact your Service Provider
SIM Error	The phone has detected a problem with the SIM - switch the phone off and then back on; if the message is still displayed contact your Service Provider
SIM Invalid	The SIM has failed one or more of the SIM personalisation checks - contact your Service Provider
Function Unavailable	The selected feature is either not supported by the SIM or is not available with the current subscription - contact your Service Provider
PIN2 Invalidated	The PIN2 is blocked permanently because the wrong PUK2 has been entered ten times, services controlled by PIN2 cannot be used - contact your Service Provider

Trouble Shooting

Message Rejected Store Full	A message has been received but the message store is full - to receive messages, delete some of the currently stored messages or set messages to Auto Delete
Number Too Long (Max:20)	The edited or newly created Phonebook number is too long for the SIM
Warning Store Full Continue?	The message area is full. Your messages cannot be stored until some of the currently stored messages are deleted
Verification Failure	On changing the phone lock code, verification of the new code is incorrect - retry changing the lock code with correct verification
Incorrect Lock Code	Disabling or enabling the lock code has failed due to incorrect entry of the lock code - re-enter lock code
Incorrect PIN / PIN2 / PUK / PUK2	The entered code is incorrect - re-enter code correctly
Auto Redial List Full	Redial list of unsuccessfully dialled numbers is full - switch the phone off and then on again

Important Information

Safety Considerations

The following information should be read and understood as it provides details which will enable you to operate your phone in a manner which is both safe to you and your environment, and conforms to any legal requirements regarding the use of cellular phones.



This equipment should only be charged with approved charging equipment. Other usage will invalidate any approval given to this apparatus and may be dangerous. The use of approved charging equipment is recommended to ensure optimum performance and avoid damage to your phone. Ensure the voltage rating of the AC Adaptor is compatible with the country of use when travelling abroad.

An AC Adaptor (EB-CAD92xx*) is supplied with the Main Kit. Other recommended equipment for charging - DC Adaptor (EB-CDD92), Handsfree Car Kit (EB-HFD93Z).

** Where xx identifies the specific AC Adaptor region, e.g. CN, EU, HK, TW, UK.*



Switch off your cellular phone when in an aircraft. The use of cellular phones in an aircraft may be dangerous to the operation of the aircraft, disrupt the cellular network and may be illegal. Failure to observe this instruction may lead to the suspension or denial of cellular phone services to the offender, or legal action or both.



You are advised not to use the equipment at a refuelling point. You are reminded to observe restrictions on the use of radio equipment in fuel depots, chemical plants or where blasting operations are in progress. Never expose the battery pack to extreme temperatures (in excess of 60°C) or charge the battery pack for much longer than recommended.



You **MUST** exercise proper control of your vehicle at all times. Do not hold a phone while you are driving; find a safe place to stop first. Do not speak into a handsfree microphone if it will take your mind off the road. Always acquaint yourself thoroughly with restrictions concerning the use of cellular phones within the country you are driving and observe them at all times.



Care must be taken when using the phone in close proximity to personal medical devices, such as pacemakers and hearing aids.

Important Information



For most efficient use hold the phone as you would any normal telephone. Keep the antenna pointed over your shoulder while in use. Use only the supplied or approved replacement antenna. Unauthorized antennas, modifications or attachments may damage the phone and violate applicable regulations. The use of an unapproved antenna, modification or attachment may result in the invalidation of your guarantee – this does not affect your statutory rights.

This Panasonic mobile phone is designed, manufactured and tested to ensure that it complies with the following specifications covering RF exposure guidelines;

1999/519 EC, ICNIRP 1998, in accordance with ES59005 1998

ANSI C95.1-1992 (USA, Asia-Pacific), in accordance with FCC Guidelines (FCC 1997)

AS/NZS 2772.1 (Int)-1998 (Australia), in accordance with ACA RS1999

Care and Maintenance



Pressing any of the keys may produce a loud tone. Avoid holding the phone close to the ear while pressing the keys.



Extreme temperatures may have a temporary effect on the operation of your phone. This is normal and does not indicate a fault.



Do not modify or disassemble the equipment. There are no user serviceable parts.



Do not subject the equipment to excessive vibration or shock.



Avoid contact with liquids. If the equipment becomes wet immediately remove the power and contact your dealer.



Do not leave the equipment in direct sunlight or a humid, dusty or hot area.



Keep metallic items that may accidentally touch the terminals away from the equipment.



Always charge the Battery Pack in a well ventilated area, not in direct sunlight, between +5°C and +35°C. It is not possible to recharge the battery pack if it is outside this temperature range.



Avoid recharging battery packs for longer than recommended.



Do not incinerate or dispose of the battery packs as ordinary rubbish. The battery packs must be disposed of in accordance with local legislation and may be recycled.



When disposing of any packing materials or old equipment check with your local authorities for information on recycling.

Glossary of Terms

DTMF Tones	Dual Tone Multi-Frequency tones allow you to communicate with computerized phone systems, voice mailboxes etc.
GSM	Global System for Mobile Communications. The name given to the advanced digital technology that your phone uses.
Home Country	The country where your home network operates.
Home Network	The GSM network on which your subscription details are held.
Network Operator	The organization responsible for operating a GSM network.
Password	Used for the control of the Call Bar. Supplied by your Service Provider.
PIN	Personal Identification Number used for SIM security. Supplied by your Service Provider. If the PIN is entered incorrectly 3 times, the PIN will be blocked.
PIN2	Personal Identification Number used for the control of Fixed Dial Store and Call Charge metering. Supplied by your Service Provider. If the PIN2 is entered incorrectly 3 times, the PIN2 will be blocked.
PUK/PUK2	PIN/PIN2 Unblocking Key. Used to unblock the PIN/PIN2. Supplied by your Service Provider. If the PUK/PUK2 is entered incorrectly 10 times, the PUK/PUK2 will be blocked.
Registration	The act of locking on to a GSM network. This is usually performed automatically by your phone.
Roaming	The ability to use your phone on networks other than your Home network.
Service Provider	The organization responsible for providing access to the GSM network.
SIM	Subscriber Identity Module. A small smart-card which stores unique subscriber and user-entered information such as Phonebook and Short Messages. Supplied by your Service Provider.

Specifications

Telephone

Type	GSM900 Class 4 GSM1800 Class 1
Temperature range	
Charging	+5°C to +35°C
Storage	-20°C to +60°C

Battery – Attached to phone

	Battery Pack (S)
Weight	80 g
Dimensions	
Height x Width x Depth	120 x 45 x 16.4mm
Supply Voltage	3.7V DC, 650mAh Li-Ion
Standby Time - Idle Mode (h)	Up to 170
Talk Time (h)	3.5
Charge Time (min)	100

Note: Charge time will be longer when the phone is turned on. Battery life is affected by the network you are using and the condition of the battery pack.

Notes

Notes

Declaration of Conformity

We, Matsushita Communication Industrial UK LTD
Daytona Drive,
Colthrop,
Thatcham,
Berkshire,
RG19 4ZD,
UK

declare under our sole responsibility that the product

GSM Telephone Cellular Radio, Model number EB-GD93
Trade name: Panasonic GD93

to which this declaration relates is in conformity with the following standard(s) or other normative documents

TBR 19, TBR 31, ETS 300 342-1, EN60950,
European Council Recommendation (1999 519 EC)

following the provisions of EC Council Directive(s)

99/5/EEC, on the basis of Technical Construction File:

number T00-MCUK-D018-1 issue 1 and dated 15 August 2000

Issued on: 18 August 2000

Signed by the manufacturer;

(Signature):



M. Yamamoto
Managing Director

D00-MCUK-D018-1

E-mail Settings

Use the table below to record your E-mail settings. The list may vary depending on the Internet Service Provider.

Item	Hint	Current Setting
Profile Name	Service Provider Name	
Mail Account	Your E-mail Address	
SMTP Server	Domain Name or IP Address	
POP3 Server	Domain Name or IP Address	
POP3 Account		
Password	Reminder of Password	
Mail Delivery	Leave/Delete Message*	
Access Point	Phone Number	
Circuit Type	Analog or Digital	
User ID	Your name (or alias)	
User Password	Reminder of Password	
Primary DNS	IP Address	
Secondary DNS	IP Address	

* This function allows e-mail messages to either be removed from the server when they have been downloaded to the phone, or they can be left on the server.

WAP Settings

Use the table below to record your WAP settings.

Item	Hint	Current Setting
Name	WAP Server Name	
Home URL	URL of Server	
Security	On or Off	
Circuit Type	Analog or Digital	
Digital Dial #	Phone Number	
Analog Dial #	Phone Number	
PPP ID	Name	
PPP Password	Password	
Gateway IP	IP Address	

The Serial Number can be found on the outside of the phone under the battery. For your convenience we recommend that you note the following details as a record of your purchase.

Part Number	
Serial Number	
Dealer Name	
Purchase Date	



BULL CP8 PATENT

© Matsushita Communication Industrial UK Limited 2000

Information in this document is subject to change without notice. No part of these instructions may be reproduced or transmitted in any form or by any means without obtaining express permission from Matsushita Communication Industrial UK Limited

Printed in UK
www.mcuk.panasonic.co.uk



7LC061A

00.285

Free Manuals Download Website

<http://myh66.com>

<http://usermanuals.us>

<http://www.somanuals.com>

<http://www.4manuals.cc>

<http://www.manual-lib.com>

<http://www.404manual.com>

<http://www.luxmanual.com>

<http://aubethermostatmanual.com>

Golf course search by state

<http://golfingnear.com>

Email search by domain

<http://emailbydomain.com>

Auto manuals search

<http://auto.somanuals.com>

TV manuals search

<http://tv.somanuals.com>