

# Panasonic®

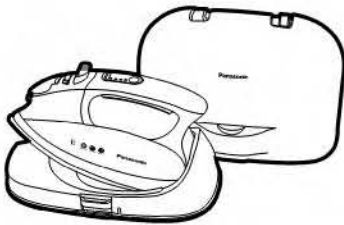

## Electric Cordless Steam Iron Operating Instructions

Model No. NI-L70SR/L71SR

### Safety Information

SAFE USE OF THE IRON .....	2
IMPORTANT SAFETY INSTRUCTIONS .....	2-3

### Operation

COMPONENTS IDENTIFICATION BECOMING FAMILIAR WITH YOUR .....	4
CORDLESS IRON .....	5
TIPS AND HINTS BEFORE USING YOUR IRON .....	5
HOW TO REMOVE THE COVER CASE .....	6
HOW TO FILL WITH WATER .....	6-7
HOW TO SUPPLY ELECTRICITY .....	7
HOW TO CONTROL TEMPERATURE .....	7
HOW TO USE AS A STEAM IRON .....	7-8
HOW TO USE AS A DRY IRON .....	8
SPECIAL FUNCTIONS .....	8-10

### Maintenance

HOW TO CARE FOR YOUR IRON .....	10
---------------------------------	----

### General Information

SPECIFICATIONS .....	11
FABRIC IRONING CHART .....	12

## **READ ALL INSTRUCTIONS CAREFULLY BEFORE USING THE IRON**

For assistance, please call : 1-800-211-PANA(7262)  
or contact us at <http://www.panasonic.com/contactinfo>  
or visit us at <http://www.panasonic.com/consumersupport> (U.S.A)  
For assistance, please call : 787-750-4300  
or visit us at <http://www.panasonic.com/consumersupport> (Puerto Rico)

# SAFE USE OF THE IRON

## Your safety and the safety of others is very important

We have provided important safety messages in this manual and on your appliance. Always read and obey all safety messages.



This is the safety alert symbol. It is used to alert you to potential hazards that can kill or injure you and others. The safety messages will follow the safety alert symbol and either the word "WARNING" or "CAUTION".

These words mean:

**! WARNING**

**You can be killed or seriously injured if you don't follow these instructions.**

**! CAUTION**

**You can be exposed to a potentially hazardous situation which, if not avoided, may result in minor or moderate injury.**

The safety messages will tell you what the potential hazard is, how to reduce the chance of injury, and what can happen if the instructions are not followed.

## Thank you for purchasing a Panasonic Iron

Your Iron is an appliance to be used only for ironing fabrics.

# IMPORTANT SAFETY INSTRUCTIONS

**! WARNING**

**To reduce the risk of burns, electric shock, fire, or injury during the usage of this iron, basic safety precautions should always be followed, including the following:**

### READ ALL INSTRUCTIONS BEFORE USING THE IRON

1. Use the iron only for its intended purpose, for ironing fabrics on board.  
To protect against burns or injury to persons, do not iron or steam fabrics while being worn on the body.
2. To protect against the risk of electric shock, do not immerse the iron or cord in water or other liquids.
3. The iron should always be turned to "OFF" before plugging or unplugging AC Power Cord from outlet. Never yank Cord to disconnect from outlet; instead, grasp Plug and pull to disconnect.
4. Do not allow Cord to touch hot surfaces. Let iron cool completely before putting away. Bundle up AC Power Cord band when storing.
5. Always disconnect AC Power Cord from electrical outlet when filling iron with water and when not in use. Be careful to avoid spilling water over iron when filling.
6. Do not operate iron with a damaged Cord or if the iron or Power Base has been dropped or damaged. To avoid a risk of electric shock, do not disassemble the iron or Power Base, take it to an authorized service depot for examination and repair. Incorrect reassembly can cause a risk of electric shock when the iron is used.

7. Close supervision is necessary for any appliance being used by or near children. Do not leave iron unattended while connected to an electrical outlet or on an ironing board. Always position iron carefully to prevent it from falling if ironing board is accidentally bumped or if Cord is pulled. When not in use, always place iron securely into Power Base.
8. Burns can occur from touching hot metal parts, the hot surface of the Power Base, hot water, or steam. Use caution when you turn a steam iron upside down-there may be hot water in the Water Tank.
9. To protect against burns or injury to persons, do not direct steam toward the body when ironing or self-cleaning.
10. The iron must be used and rested on a stable surface. When placing the iron into Power Base, ensure that the surface on which the Power Base is placed is stable.
11. The AC Power Cord and Plug may present a risk of personal injury when the cord is allowed to retract freely. Always hold the plug and cord with one hand while it is retracting, and retract the cord slowly to reduce the risk of the cord "WHIPPING", which has the potential risk of causing injury to the face, eyes, etc..

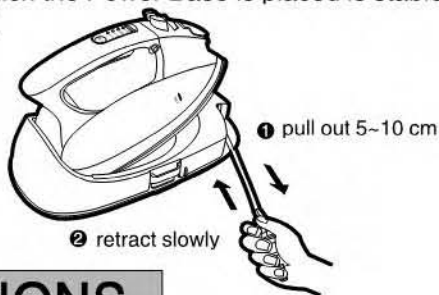

## SPECIAL INSTRUCTIONS

### **! WARNING**

To reduce the risk of electric shock or fire:

1. Do not operate another high wattage appliance in the same circuit, to avoid a circuit overload.
2. If an extension cord is absolutely necessary, use a cord rated a minimum of 13 amperes.

Cords rated for less amperage may overheat, and should not be used.

Care should be taken to arrange the cord so that it cannot be accidentally pulled or tripped over.

### **! CAUTION**

To reduce the risk of personal injury and damage to your iron:

1. Never use steam iron cleaning products in the iron, as they may damage working parts of the iron.
  2. Do not use water additives or substitute water such as linen or scented water in the steam iron. They can stain fabrics.
  3. If the Steam/Dry Selector is not at Dry position after using, remaining water will move into the Soleplate and can result in burns when you next use the iron.
  4. Don't use the Steam or Jet of Steam, while AC Power Cord is unplugged. Water will remain inside the soleplate which will cause staining.
- Please do not use Steam or Jet of Steam while Temperature Control Pad is set to "OFF".

# SAVE THESE INSTRUCTIONS

For proper use of your iron, read remaining safety cautions and operating instructions.

## COMPONENTS IDENTIFICATION

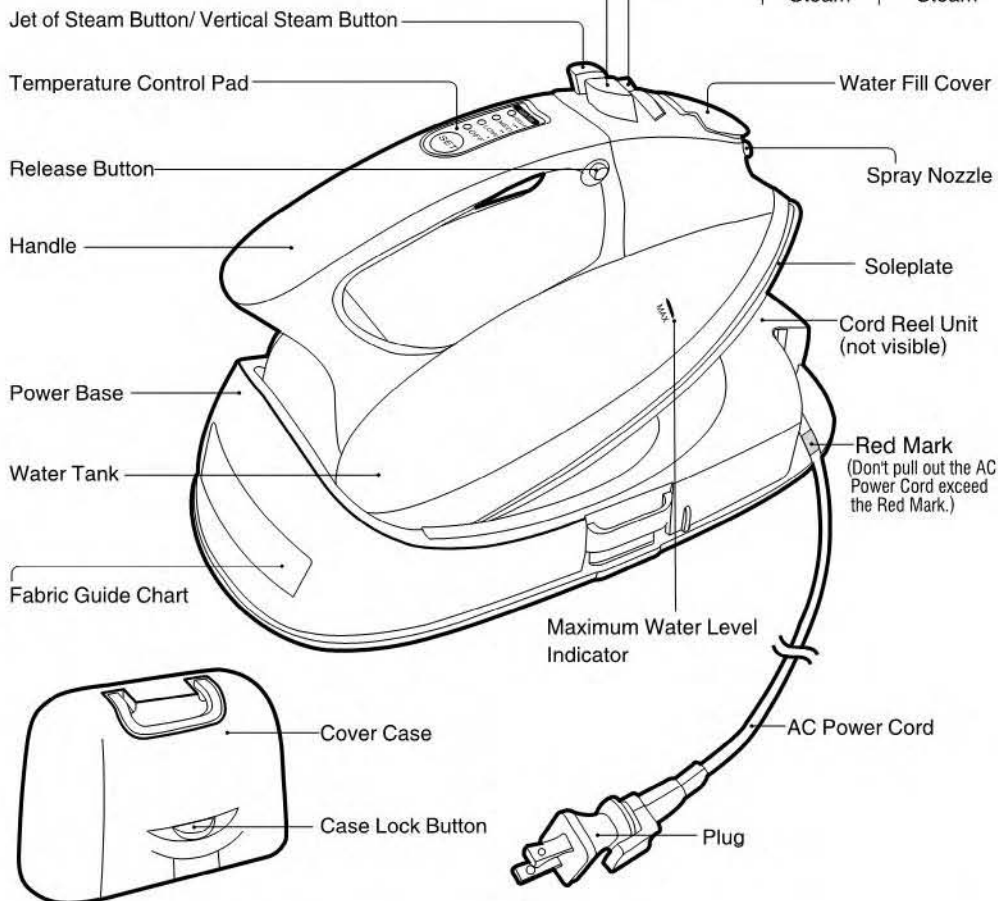
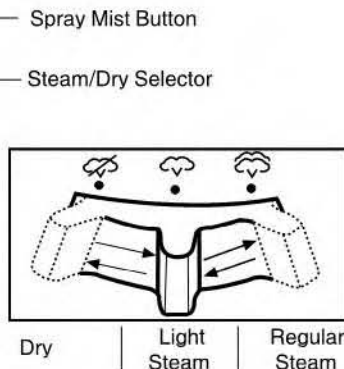
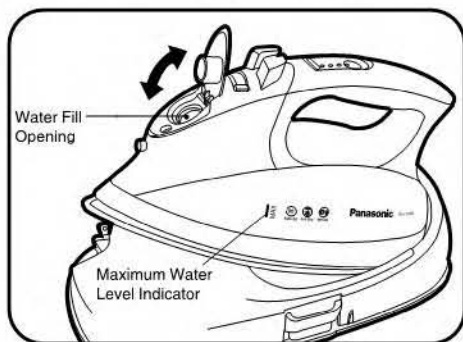

READ THIS INSTRUCTION BOOK THOROUGHLY BEFORE USING YOUR Panasonic IRON TO BECOME FAMILIAR WITH THE IRON FEATURES

## BECOMING FAMILIAR WITH YOUR CORDLESS IRON

### How does it work?

A cordless iron has no electrical cord directly attached to itself, therefore, you might wonder how the heat will be maintained.

If you think back on how you've been ironing, you'll remember that you've always placed the iron somewhere that enables you to have two hands free, so that you can move the garment on your ironing board.

Since the remaining heat of the Soleplate is used for ironing with a cordless iron, the iron must be placed on its Power Base and nowhere else.

The iron will re-heat quickly every time it is placed on the Power Base and maintains its temperature.

### NOTE:

A cordless iron is NOT a rechargeable device. You cannot continuously use this iron without placing it on the Power Base.

## TIPS AND HINTS BEFORE USING YOUR IRON

1. Most ordinary tap water can be used in this iron. However, in extremely hard water areas, distilled or demineralized water should be used. Do not use water processed through home water softening systems, since this water contains minerals that may be harmful to the iron.
2. It is best to start ironing with garments which require lower temperature settings. Wrong temperature setting may damage the fabric. If you are not sure of the fabric content, try the temperature of the iron on a hidden area of the garment.
3. Before ironing, sort the garments according to the different heat settings required. Do not touch plastic buttons with a hot iron, as this may damage the buttons. Caution is also required when ironing around zippers and similar items which might scratch the Soleplate.

As a guide to the international Textile Care Labeling code, the following symbols are noted for your information.

### INTERNATIONAL TEXTILE CARE & LABELING CODES



Washing



Bleaching



Ironing



Dry Cleaning

A symbol crossed out indicates that the article of clothing must not be subjected to the particular treatment.

EXAMPLE: (DO NOT BLEACH)

## HOW TO REMOVE THE COVER CASE

1. Place the unit on a firm and stable surface.
2. While pressing the Case Lock Button, lift the Cover Case to open.

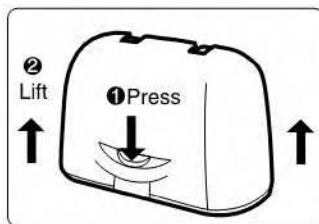
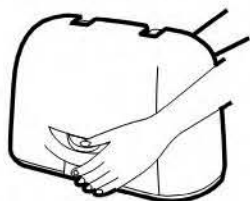

### NOTE:

1. The Cover Case cannot be unlocked when you lift the Cover Case with the Power Base.
2. Please detach the Shock Absorber and Film before ironing.

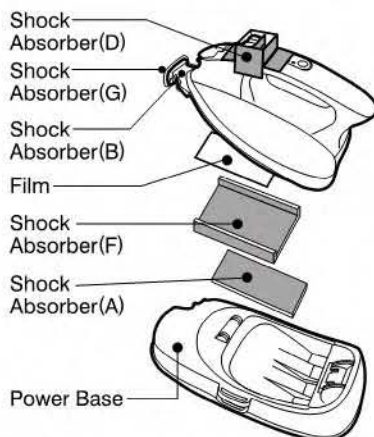

## HOW TO FILL WITH WATER

Make sure the iron is turned off and the AC Power Cord is unplugged from the electrical outlet. The iron can be filled with the Water Tank in place or removed. Confirm that the Steam/Dry Selector is moved to the Dry ironing position when installing or removing the Tank.

1. Remove the Water Tank by pressing the Release Button.
2. Open the Water Fill Cover.
3. Fill the Water Tank up to the "MAX" line.  
DO NOT OVERFILL. Check the water level with the Water Tank held in its vertical position.
4. Close the Water Fill Cover.
5. Re-install the Water Tank into the main unit. Push it until a click sound is heard.

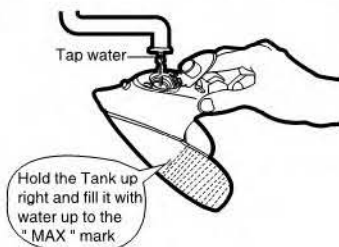

**NOTE:** Most tap water can be used in this iron. If water is very hard, distilled or demineralized water should be used. Do not use water processed through home water softening systems because this water contains minerals that may be harmful to the iron. Do not use water additives or substitute water such as linen or scented water in the steam iron. They can stain fabrics or damage the iron.

## HOW TO SUPPLY ELECTRICITY

The iron must be set securely on the Power Base in order to supply electricity. Electricity will only be provided while the iron is placed on the Power Base. If you desire to set the iron down while moving a garment on your ironing board, the iron must only be placed on the Power Base. The Power Base will keep the temperature of the iron at the selected level.

## HOW TO CONTROL TEMPERATURE

### → How to operate the Temperature Control Pad("SET " Pad)

1. Every time you push the " SET " Pad, the Temperature Indicator Light moves to the next position, a higher temperature.
2. Desired temperature can be chosen by pushing the " SET " Pad until it lights at the appropriate position.

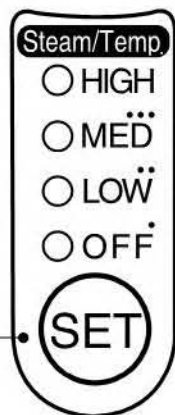

#### TEMPERATURE INDICATOR LIGHT ( RED ):

- \* Continuously blinks until the iron reaches its selected temperature.
- \* Turn on continuously when the iron has reached its selected temperature to let you know that you can start ironing.

#### "OFF" LIGHT ( GREEN ):

- This light turns on when:
- \* The cord is plugged into the outlet.
  - \* The iron has automatically shut itself off.
  - \* The iron has been manually turned off.

**NOTE:** All the lights will turn off once the iron leaves the Power Base. They will turn on again when the iron is re-placed.



## HOW TO USE AS A STEAM IRON

1. Fill iron with water. See section " HOW TO FILL WITH WATER " .
2. Plug the cord into a standard 120V- 60Hz electrical outlet.
3. Set the iron on the Power Base securely. The green " OFF " light will turn on.

**NOTE:** If the green light does not turn on, replace the iron on the Power Base again, otherwise the Temperature Control Pad cannot function.

4. Push the " SET " Pad to the corresponding temperature level. The red light starts blinking.

See section " HOW TO CONTROL TEMPERATURE " and the following charts:

Temperature Level	Steam/Dry Selector Position
LOW	
MED	
HIGH	
	

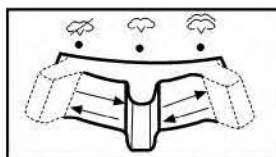

Dry (Non-Steam) | Light Steam | Regular Steam

5. Hold the iron horizontally and move the Steam/Dry Selector into the desired steam position after the Temperature Control light turns on continuously. You can then start ironing.

**Note:** Anti-Drip System will activate when the temperature of the Soleplate's surface drops. At the same time, the steam will stop; it is not a sign of malfunction when you hear a clicking sound. In this situation, you have to put your iron back on the Power Base to reheat.

## HOW TO USE AS A DRY IRON

1. Move the Steam/Dry Selector to the Dry position.
2. Plug the cord into a standard 120V-60Hz electrical outlet.
3. Set the iron on the Power Base securely. The green " OFF " light will turn on.

NOTE: If the green light does not turn on, replace the iron on the Power Base again, or the Temperature Control Pad cannot function.

4. Push the " SET " Pad until the red blinking light reaches your desired temperature level. Wait until the Temperature Control light turns on continuously. You can then start ironing.

## SPECIAL FUNCTIONS

### 1. Jet of Steam

The "Jet of Steam" feature provides extra steam which goes deep into the garment and is helpful for removing stubborn wrinkles. The "Jet of Steam" feature operates properly only in the "HIGH" indication area of the "SET" Pad when steam or dry ironing (If used at lower setting, water spotting will occur because the iron is not hot enough to change water to steam ). If you have not used the " Jet of Steam " feature for a long time, it is necessary to clean the inside of the iron before using this feature on any clothes to be ironed. Simply test the "Jet of Steam" feature several times away from the ironing board and clothes to be ironed. This will prevent brown spotting or water spotting on the clothes.

1. Fill iron with water. See section " HOW TO FILL WITH WATER " .
2. Plug the cord into a standard 120V- 60Hz electrical outlet.
3. Set the iron on the Power Base securely. The green " OFF " light will turn on.
4. Push the " SET " Pad to the "HIGH" temperature level. The red light starts blinking.
5. Preheat the iron until the light turns on continuously, usually about 1-2 minutes.
6. Simply pump the " Jet of Steam Button " when steam is desired. Pump the " Jet of Steam Button " several times at the beginning of each ironing session.
7. Allow at least 5 seconds between uses of "Jet of Steam Button " to prevent water spotting. Use a press cloth if necessary.



**NOTE:** Do not touch the fabric with the iron. Keep the iron slightly over the fabric to prevent burns or disfiguring.

Jet of Steam can be provided by pumping the " Jet of Steam Button ".

Set temperature at " HIGH " level.

To avoid hot water from dripping out of the Soleplate, please give 5 seconds of interval time before re-pumping

## 2. Vertical Steam

To get better results when using vertical steam, hang the garment on a clothes hanger. Curtains and drapes may also be steamed once they're hung. Hold the iron away from your body, close to but not touching the fabric. Pull the fabric tight with your free hand and pump the Vertical Steam Button (Jet of Steam Button) at 5 seconds intervals as you pass the iron over the wrinkled fabric.



Never iron clothes on the body or point your iron at anyone when steaming.  
Keep hands and body away from steam areas while using vertical steam feature.

## 3. Anti-Drip System ( Automatic Water Seal )

This model has an Anti-Drip System. When the temperature of the Soleplate's surface drops below 250°F(121°C), the valve for the vaporizing chamber in the iron automatically closes and stops the water from going in further. This prevents hot unvaporized water from spitting out from the soleplate when the iron has cooled down. With this System, it is unnecessary for you to wait until the inside of the vaporizing chamber dries completely when you store the iron.

**NOTE:** It is not a sign of malfunction when you hear a clicking sound.  
This sound can be heard whenever this System is activated.

## 4. Automatic Shut-Off

The Automatic Shut-Off System provides you with a visible warning signal before the iron automatically shuts off. The iron will automatically shut itself off if the iron has been left on the Power Base longer than 10 minutes. 10 seconds before the actual shut-off, the " OFF " indicator will start blinking rapidly.

If the iron is not moved during the warning, the heater in the iron's Soleplate will automatically shut off.

The Automatic Shut-Off System activates only after the temperature reaches its selected level. To reheat your iron after it automatically shuts off, simply push " SET " Pad until the red light appears at the desired temperature indicator.

" OFF " light(green) remains on after your iron automatically shuts off .

This light indicates that the iron is still plugged into the electrical outlet and voltage is being supplied to the Power Base.

## 5. Spray

Note: Before using the spray feature, check the fabric label for ironing instructions because some fabrics may be spotted or stained with moisture.

The spray feature is particularly helpful for removing stubborn wrinkles and where extra dampening is needed.

The spray may be used with steam or dry ironing.

1. Simply pump the Spray Mist Button  whenever spray is desired.  
If the spray doesn't come out immediately, keep pumping until it does.
2. To get a finer spray, pump the Button vigorously.  
To get a more powerful spray, pump the Button more slowly.  
For best results, use a quick, full stroke.

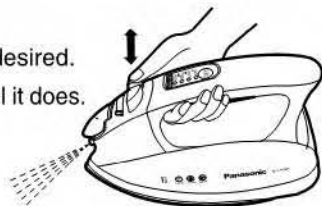

## HOW TO CARE FOR YOUR IRON

### AFTER EACH USE

1. Press the " SET " Pad until the " OFF " light turns on.
2. Move the Steam/Dry Selector to Dry Position.
3. Unplug the iron, retract the cord slowly. Always hold the plug and cord with one hand while it is retracting.
4. Empty the water from the Water Tank. DO NOT store the iron with water inside.
5. Push the Cover Case until it clicks to lock.

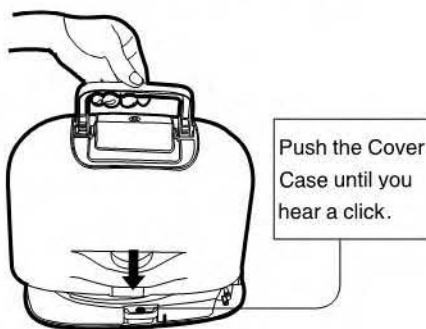
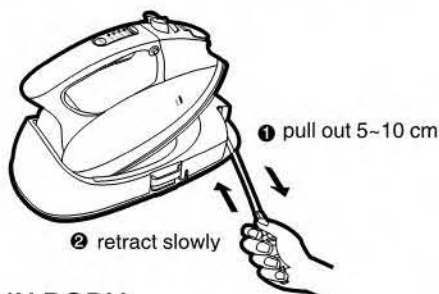

### MAIN BODY

1. When cleaning the main body of the iron, make sure that iron has cooled down.
2. Wipe the iron with a damp cloth. If necessary, use a mild detergent.  
NEVER USE ANY HARSH CLEANERS.

### SOLEPLATE

- \* Starch and other residue can be easily removed from the Soleplate with a damp cloth.
- \* To avoid scratching the finish, never use a metallic pad to clean the Soleplate, and never place the iron on a rough surface.
- \* If synthetics are being ironed on a higher temperature level than instructed, not only will the fabric be ruined, but the Soleplate will often be covered with the melted remains of the synthetic fabric.
- \* The best way to remove synthetic residue from the Soleplate is to iron over an old cotton rag after heating the iron.

# CAUTION

Never use steam iron cleaners in the iron since it may cause damage to the inside of the iron.  
If the Power Cord is damaged, it must only be replaced by a special cord.  
The iron must only be used with the Power Base provided.

## SPECIFICATIONS

Model	NI-L70SR	NI-L71SR
Power Source	120 V~ 60 Hz	120 V~ 60 Hz
Power Consumption	12.5 A, 1500 W	12.5 A, 1500 W
Net Weight	5.1 lb (2.3 kg)	5.1 lb (2.3 kg)

## FABRIC IRONING CHART

- NOTES: 1. Check garment for specific ironing instructions. Always follow manufacturer's instructions.  
 2. Iron blended fabrics at setting for lower-temperature fiber.  
 3. Use caution, some synthetics may melt at high temperature.

Temperature Control Pad Setting	Fabric	Ironing Recommendations
<b>LOW</b>	ACRYLIC * ACRILAN * CRESLAN * ORLON ACETATE METALLICS SUEDE	Dry iron on reverse side, or use a press cloth on top of fabric. Don't sprinkle water directly on fabric to avoid spots. To iron suede, cover ironing board with brown paper and use it as a press cloth.
	NYLON * ANTORON * CAPROLAN SILK	Dry iron on reverse side.
<b>MED</b>	PERM. PRESS RAYONS POLYESTER * DACRON * FORTREL * KODEL TRIACETATE * ARNEL W'n W COTTON	Dry iron on reverse side. To touch-up collars, cuffs, pockets, etc..., lightly iron the surface.
	WOOL VELVET	Steam ironing is suggested. Never iron until completely dry, but leave it with a little moisture. To iron velvet, use steam but do not let the iron touch the fabric. Hold it slightly above the surface.
<b>HIGH</b>	COTTON	Steam ironing is suggested. Sprinkle water on the fabric, depending on its thickness. Iron dark fabrics on reverse side to avoid unwanted sheen.
	LINEN	Steam ironing is suggested. Iron dark fabrics on reverse side to avoid unwanted sheen.

\* Trademarks of Fiber Manufacturers.

Panasonic Consumer Electronics  
 Company, Division of Panasonic  
 Corporation of North America  
 One Panasonic Way, Secaucus,  
 New Jersey 07094

<http://www.panasonic.com/contactinfo>

Panasonic Puerto Rico, Inc.  
 Ave.65 de Infanteria. Km. 9.5  
 San Gabriel Industrial Park, Carolina,  
 Puerto Rico 00985

<http://www.panasonic.com/consumersupport>

## Free Manuals Download Website

<http://myh66.com>

<http://usermanuals.us>

<http://www.somanuals.com>

<http://www.4manuals.cc>

<http://www.manual-lib.com>

<http://www.404manual.com>

<http://www.luxmanual.com>

<http://aubethermostatmanual.com>

Golf course search by state

<http://golfingnear.com>

Email search by domain

<http://emailbydomain.com>

Auto manuals search

<http://auto.somanuals.com>

TV manuals search

<http://tv.somanuals.com>