

# MOBILE AUDIO SYSTEM

Instruction Manual

## CD PLAYER

# PYLE®

[WWW.PYLEAUDIO.COM](http://WWW.PYLEAUDIO.COM)

PLCD21

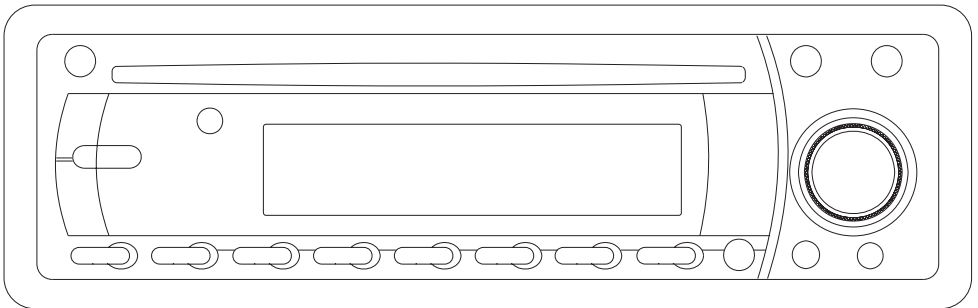

- AM/FM 2 Band Radio
- Anti-Shock Mechanism
- LCD Digital Display
- Semi-Detachable Front Panel
- Auto Power On
- RCA Line Out

# CONTENTS

|                                  |   |
|----------------------------------|---|
| Installation                     | 1 |
| 1. DIN FRONT-MOUNT (Method A)    | 1 |
| 2. DIN REAR-MOUNT (Method B)     | 2 |
| Using The Detachable Front Panel | 2 |
| Wiring Diagram                   | 3 |
| Operation                        | 4 |
| General Operation                | 4 |
| Radio Operation                  | 5 |
| CD Operation                     | 6 |
| Aux In Operation                 | 6 |
| Disc Notes                       | 6 |
| Specification                    | 8 |
| Troubleshooting                  | 9 |

## Installation

### Notes:

- Choose the mounting location where the unit will not interfere with the normal driving function of the driver.
- Before finally installing the unit, connect the wiring temporarily and make sure it is all connected up properly and the unit and the system work properly.
- Use only the parts included with the unit to ensure proper installation. The use of unauthorized parts can cause malfunctions.
- Consult with your nearest dealer if installation requires the drilling of holes or other modifications of the vehicle.
- Install the unit where it does not get in the driver's way and cannot injure the passenger if there is a sudden stop, like an emergency stop.
- If installation angle exceeds 30° from horizontal, the unit might not give its optimum performance
- Avoid installing the unit where it would be subject to high temperature, such as from direct sunlight, or from hot air, from the heater, or where it would be subject to dust, dirt or excessive vibration.

### Din Front/Rear-Mount

This unit can be properly installed either from 'Front' (conventional DIN Front-mount) or 'Rear' (DIN Rear-mount installation, utilizing threaded screw Holes at the sides of the unit chassis). For details, refer to the following illustrated installation methods.

### Take Out Screw Before Installation

Before install the unit, please remove the two screws.

Take out screws  
before installation

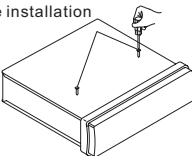

### 1. DIN Front-Mount(Method A) Installing the unit

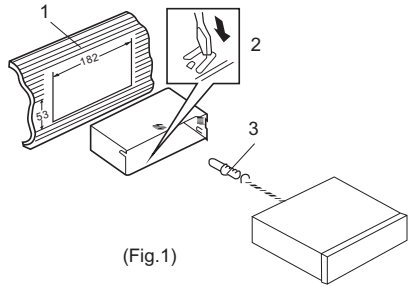

(Fig.1)

#### 1. Dashboard

#### 2. Holder

After inserting the holder into the dashboard, select the appropriate tab according to the thickness of the dashboard material and bend them inwards to secure the holder in place.

#### 3. Screw

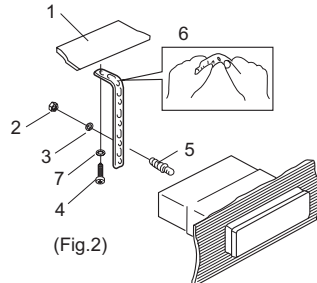

(Fig.2)

#### 1. Dashboard

#### 2. Nut (5mm)

#### 3. Spring washer

#### 4. Screw (5X25mm)

#### 5. Screw

#### 6. Strap

Be sure to use the strap to secure the back of the unit in place. The strap can be bent by hand to the desired angle.

#### 7. Plain washer

### Removing the unit

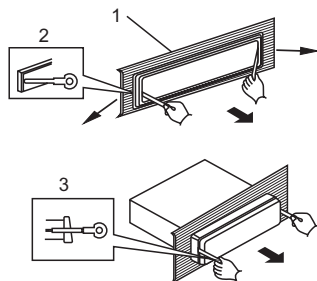

1. Frame
2. Release Frame Key  
Insert the release frame key into the groove at the right side of the frame, then prize out to remove the frame (You can also use the key to remove the frame from the left side.)
3. Release Unit Key  
After releasing the frame, insert the release unit keys supplied with the accessory into the grooves at both sides of the unit as shown in figure until they click. Pulling the keys makes it possible to remove the unit from the dashboard.

### 1. DIN Rear-Mount(Method B)

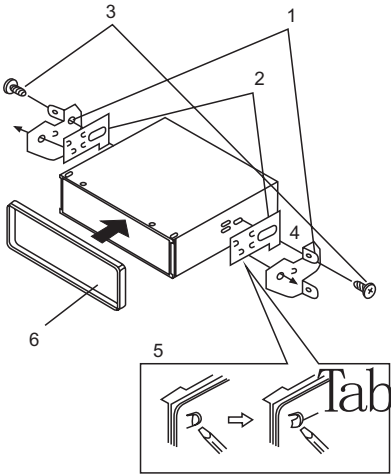

1. Factory-installed radio bracket
2. Car radio mounting bracket
3. Screw
4. After aligning the car radio mounting bracket with the factory-installed radio bracket, tighten the screws (M5X4mm) at 2 places on each side.
5. When fixing factory-installed radio bracket with the screws, use a standard-tipped screwdriver to pry the tabs of the car radio mounting bracket to make them fit into holes in the factory-installed radio bracket.
6. Movable panel frame.

### Using The Detachable Front Panel

#### Removing the front panel

1. Press the release **REL** button (1) on the front panel.

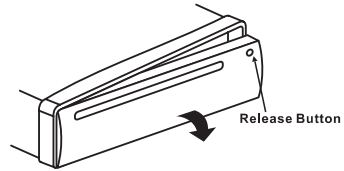

2. Pull off the front panel.

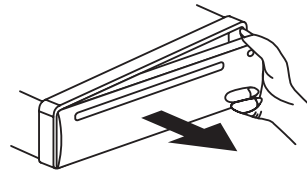

3. Keep front panel into the case.

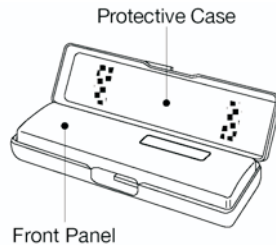

#### INSTALLING THE FRONT PANEL

To install the front panel, insert the panel into the housing and make sure the panel is properly installed. Otherwise, abnormality occurs on the display or some keys will not function properly.

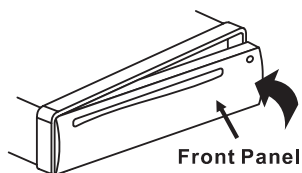

## Precautions when handling

1. Do not drop the front panel.
2. Do not put pressure on the display or control buttons when removing or installing the front panel.
3. Do not touch the contacts on the front panel or on the main unit body. It may result in poor electrical contact.
4. If any dirt or foreign substances adhered on the contacts, they can be removed with a clean and dry cloth.

5. Do not expose the front panel to high temperatures or direct sunlight in anywhere.
6. Keep away any volatile agents (e.g. benzene, thinner, or insecticides) from touching the surface of the front panel
7. Do not attempt to disassemble the front panel.

---

---

## Wiring Diagram

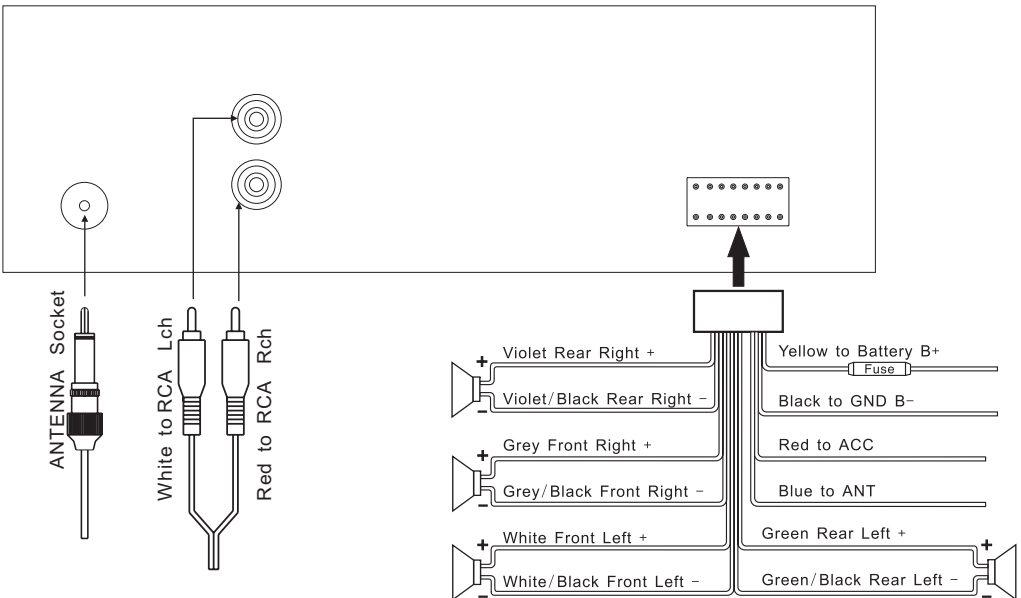

# Operation

## General Operation

### Front panel:

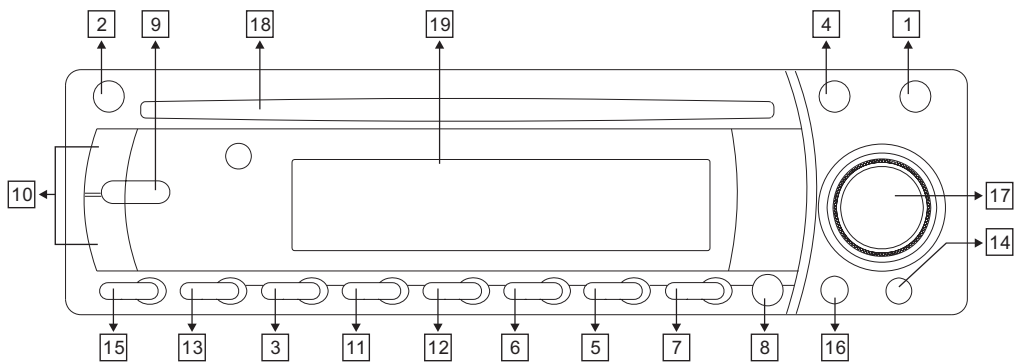

### When you remove the front panel:

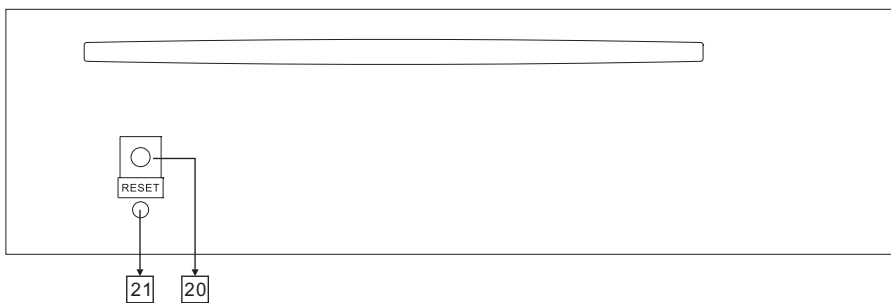

## SWITCHING ON/OFF THE UNIT

Switch on the unit by pressing any button (except **REL** button (1) and **▲** button (4)) or inserting a disc to disc slot (18).

When system is on, press **⏻** button (2) to turn off the unit.

## SOUND ADJUSTMENT

- Press **VOL+ / VOL-** button (10) to adjust volume level.
- Press **SEL** button (9) continually will changing in the following order:



Press **VOL+ / VOL-** button (10) to adjust the desired sound quality.

- Press **SEL** button (9) for several seconds to enter into the **MENU** mode, Press it continually, it is activated as cyclical mode of following functions for user's selection.  
BEEP ON/OFF → P-VOL → CLK ON/OFF → FREQ/CLK/NO PRI → 12/24 HOUR  
Select the desired item by press **VOL+ / VOL-** button (10).

## LOUDNESS FUNCTION

Press **BND/LOU** (8) for several seconds to reinforce the bass output. Press it for several seconds again to release this function.

## DISPLAYING/ADJUSTING TIME

### 1. Displaying time:

Press **DISP** button (15) to show current information and time on the LCD, and it returns to original status after 5 seconds.

### 2. Adjusting time:

Press and hold **DISP** button (15) until the clock blinking, you can press **VOL +** button (10) to adjust hour, and **VOL -** button (10) to adjust minute.

## MUTE FUNCTION

Press **MUTE** button (3) to mute down the sound instantly, press it again to recover previous volume level.

## LCD DISPLAY (19)

Exhibit current frequency and activated functions on the LCD display (19).

## FLASHING LED (21)

The led display will flash if the front panel is not inserted into the main unit.

## RESET FUNCTION

**RESET** button (20) must be activated with either a ballpoint pen or thin metal object. The **RESET** button is to be activated for the following reasons:

- Initial installation of the unit when all wiring is completed.
- All the function buttons do not operate.
- Error symbol on the display.

Note: if press **RESET** button, the unit can't work yet, please use a cotton swab soaked in isopropyl alcohol to clean the socket on the front panel.

## Radio Operation

### SWITCHING TO RADIO MODE

Press **MODE** button (13) to select radio mode, the radio mode appears in the display together with the memory band and frequency.

### SELECTING THE FREQUENCY BAND

Press **BND** button (8) to select the desired band.

The reception band will change between FM and AM.

### STEREO/MONO

Press **MON** button (16) to select mono or stereo mode.

## **TUNE BUTTON**

Rotate **TUNE** button (17) to get your desired broadcasting station.

## **CD Operation**

### **SWITCHING TO CD MODE**

1. If there is no CD disc inserted in the driver:

Gently insert a CD with the printed side uppermost into the Disc Slot (18) until you feel some resistance. The disc is drawn into the driver automatically. The CD playback begins.

2. If a CD disc is already inserted in the driver:

Press **MODE** button (13) to switch to CD mode.

### **LOADING A DISC**

Insert the disc into the disc slot (18) with the printed side facing up; the player will play the disc automatically.

### **REMOVING A DISC**

Whenever press **▲** button (4) to stop CD playing and eject the disc from the Disc Slot (18).

### **SELECTING TRACKS IN SINGLE STEP**

- Press **◀** button (11) or **▶** button (12) to skip to the previous track or the following track. Track number shows on display.

- Press and Hold **◀** button (11) or **▶** button (12) to fast reverse or fast forward. Play starts from when you release the button.

### **PAUSE PLAYBACK**

Press **⏸** button (3) to pause CD playing. Press it again to resume playback.

### **PREVIEWING ALL TRACKS**

Press **SCN** button (5) to play first several

seconds of each track on the current disc. Press it again to stop intro and listen to track.

### **REPEATING THE SAME TRACK**

Press **RPT** button (6) to continuously repeat the same track. Press it again to stop repeat.

### **PLAYING ALL TRACKS IN RANDOM**

Press **SHF** button (7) to play all tracks on disc in random order. Press it again to cancel the function.

## **Aux In Operation**

This system has an external input jack (14), so you can listen to music from external devices connected to this unit. Press the **MODE** button (13) to switch to the **AUX** mode on or off.

## **Disc Notes**

### **A. Notes on discs:**

1. Attempting to use non-standard shape discs (e.g. square, star, and heart) may damage the unit. Be sure to use round shape CD discs only for this unit.

2. Do not stick paper or tape, etc, onto the label side or the recording side of any discs, as it may cause a malfunction.

Dirt, dust, scratches and warping discs will cause desperation.

### **B. Notes on CD-Rs (recordable CDs)/CD-RWs (rewritable CDs):**

1. Be sure to use discs with following marks only for the unit to play:





2. The unit cannot play a CD-R and CD-RW that is not finalized. (Please refer to the manual of your CD-R/CD-RW recorder or CD-R/CD-RW software for more information on finalization process).

3. Depending on the recording status, conditions of the disc and the equipment used for the recording, some CD-Rs/CD-RWs may not be played on this unit. (see \*1)

\*1: To have more reliable play back, please see following recommendations:

- A. Use CD-RWs with speed 1x to 4x and write with speed 1x to 2x.
- B. Use CD-Rs with speed 1x to 8x and write with speed 1x to 2x.
- C. Do not play a CD-RW which has been written for more than 5 times.

### **C. Handling and Cleaning**

- Dirt, dust, scratches and warping discs will cause disoperation.
- Do not place stickers or make scratches on discs.
- Do not warp discs.
- A disc should always be kept in its case when not in use to prevent from damage.
- Do not place discs in the following

Places:

1. Direct sunlight.
2. Dirty, dusty and damp areas.
3. Near car heaters.
4. On the seats or dashboard.

### **Disc Cleaning**

Use a dry soft cloth to wipe the surface. If the disc is quite dirty, Use a soft cloth slightly moistures with isopropyl (rubbing) alcohol. Never use solvents such as benzene, thinner or conventional record cleaners as they may mar the surface of the disc.

### **Note:**

A disc may become somewhat scratched (although not enough to make it unusable) depending on the way it is handled and conditions in the usage environment. Note these scratches are not an indication of any problem with the player.

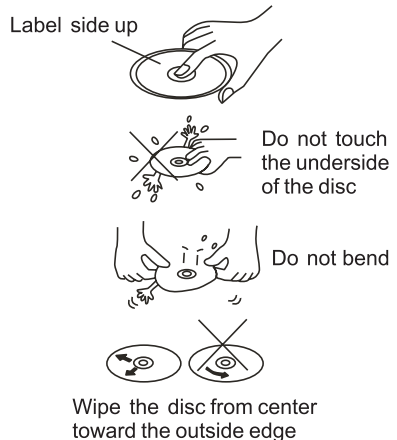

### **D. Preparing New Discs with Rough Spots**

A new disc may have rough edges on its inside and outside edges. If a disc with rough edges is used, the proper setting will not be performed and the player will not play the disc. Therefore, remove the rough edges in advance by using a ballpoint pen or pencil as shown on the right. To remove the rough edges, press the side of the pen or pencil against the inside and outside edges of the disc.

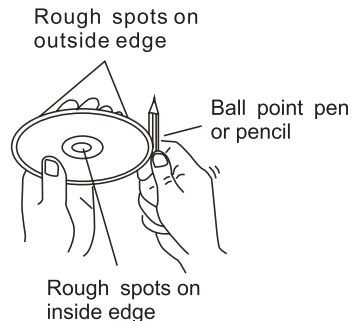

## Specification

### 1. GENERAL

#### Power Supply Requirements

DC 12 Volts, Negative Ground

#### Chassis Dimensions

178(W)x160(D)x 50(H)

#### Tone Controls

- Bass (at 100 Hz)  $\pm 14$  dB

- Treble (at 10 kHz)  $\pm 14$  dB

#### Maximum Output Power

4x40 watts

#### Current Drain

10 Ampere (max.)

### 2. CD PLAYER

#### Signal to Noise Ratio

> 55 dB

#### Channel Separation

> 40 dB

#### Frequency Response

40Hz- 18 kHz

### 3. RADIO

#### FM

##### Frequency Coverage

87.5 – 107. 9 MHz

##### IF

10.7 MHz

##### Sensitivity (S/N=30dB)

4  $\mu$  V

##### Stereo Separation

>20dB

#### AM

##### Frequency Coverage

530 – 1710 kHz

##### IF

450 kHz

## Troubleshooting

Before go through the checklist, check wiring connection. If any of the problems persist after checklist has been made, consult your nearest service dealer.

### No power

- The car ignition switch is not on.
  - If the power supply is connected to the car accessory circuits, but the engine is not moving, switch the ignition key to "ACC".
- The fuse is blown.
  - Replace the fuse.

### Disc cannot be loaded or ejected

- Presence of CD disc inside the player.
  - Remove the disc in the player, and then put a new one.
- Inserting the disc in reverse direction.
  - Insert the compact disc with the label facing upward.
- Compact disc is extremely dirty or defective disc.
  - Clean the disc or try to play a new one.
- Temperature inside the car is too high.
  - Cool off or until the ambient temperature return to normal.
- Condensation.
  - Leave the player off for an hour or so, and then try again.

### No sound

- Volume is in minimum.
  - Adjust volume to a desired level.
- Wiring is not properly connected.
  - Check wiring connection.

### Sound skips

- The installation angle is more than 30 degree.
  - Adjust the installation angle less than 30 degree.
- The disc is extremely dirty or defective disc.
  - Clean the compact disc, and then try to play a new one.

### The operation keys do not work

- The built-in microcomputer is not operating properly due to noise.
  - Press the RESET button.
- Front panel is not properly fixed into its place.

### The radio does not Work.

#### The radio station automatic selection does not work.

- The antenna cable is not connected.
  - Insert the antenna cable firmly.
- The signals are too weak.
  - Select a station manually.

## Free Manuals Download Website

<http://myh66.com>

<http://usermanuals.us>

<http://www.somanuals.com>

<http://www.4manuals.cc>

<http://www.manual-lib.com>

<http://www.404manual.com>

<http://www.luxmanual.com>

<http://aubethermostatmanual.com>

Golf course search by state

<http://golfingnear.com>

Email search by domain

<http://emailbydomain.com>

Auto manuals search

<http://auto.somanuals.com>

TV manuals search

<http://tv.somanuals.com>