

740 SERIES SINGLE-FUNCTION TIMERS



Model 740-T2



Model 740-T2HW



Model 740-T4

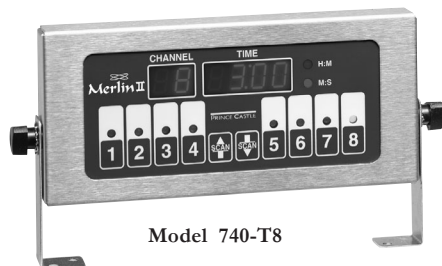

Model 740-T8

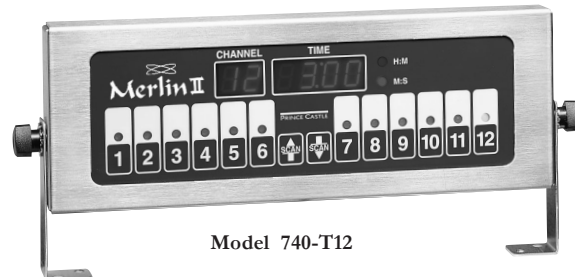

Model 740-T12

The next generation of timing systems is here. 740-Series Single Function Timers are designed to be easier to use, give you more flexibility, and ensure utmost accuracy. These 740-Series timers feature an ultra-slim design with a “fat plug” transformer. Two, four, eight and twelve channel units are available.

Ideal for many kitchen applications, including monitoring frying, grilling and prep stations, and tracking coffee-making and employee handwashing. Quite simply, if a kitchen task needs to be timed or monitored, Prince Castle timers can help manage these tasks.

These simple-to-use timers countdown in hours and minutes or minutes and seconds. Up and down scan buttons make each channel easy to program, and each channel is activated with a push of a button. A digital channel display shows the active channel.

LED channel indicators change colors during the timing cycle depending on the stage of the countdown: the light is green during the first 70% of the cycle, then turns yellow during the remaining 20% of the cycle, and finally turns red during the last 10% of the cycle. A dual tone volume alarm and flashing channel indicators alert the operator when timing is complete.

The 740-T2HW handwashing timer is pre-programmed for a one-hour cycle.

STANDARD FEATURES

- Digital channel display shows the active channel
- New multi-colored LED channel indicators show the status of the timing cycle and provide early warning as the countdown expires.
- Lightweight ultra-slim 1-inch (2.5cm) depth design and an extra long 10-ft. (3m) line cord lets you mount these units virtually anywhere
- Each channel can be programmed independently, and all channels can be used simultaneously
- Two-tone alarm is adjustable for either high or low sound levels
- Includes menu labels to identify channels: Burgers, Steak, Chicken, Fish, Fries and Blank Stickers
- Includes set of 3-1/2-inch (8.9cm) mounting brackets. For increased mounting flexibility, flush mount brackets are available.
- One-year warranty

740-SERIES SINGLE-FUNCTION TIMERS





PRINCE CASTLE INC. 
WORLDWIDE

SPECIFICATIONS

DIMENSIONS

MODEL NUMBER	WIDTH IN. (CM)	HEIGHT IN. (CM)	DEPTH IN. (CM)	NET WT. LB. (KG.)	SHIPPING WT. LB. (KG.)
740-T2	7.87 (19.99)	4.0 (10.16)	1.0 (2.5)	2.8 (1.2)	3.7 (1.6)
740-T2HW	7.87 (19.99)	4.0 (10.16)	1.0 (2.5)	2.8 (1.2)	3.7 (1.6)
740-T4	8.93 (22.68)	4.0 (10.16)	1.0 (2.5)	2.9 (1.3)	3.8 (1.7)
740-T8	10.43 (26.49)	4.0 (10.16)	1.0 (2.5)	3.1 (1.4)	4.1 (1.9)
740-T12	12.93 (32.84)	4.0 (10.16)	1.0 (2.5)	3.5 (1.6)	4.4 (2.0)

ELECTRICAL

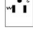
MODEL NUMBER	DESCRIPTION	VOLTS*	HZ.	WATTS	AMPS	PLUG NUMBER	PLUG CONFIG.
740-T2	2-Channel Timer	120	60	10 max	.083 max	NEMA 5-15P	
740-T2HW	2-Channel Handwashing Timer	120	60	10 max	.083 max	NEMA 5-15P	
740-T4	4-Channel Timer	120	60	10 max	.083 max	NEMA 5-15P	
740-T8	8-Channel horizontal	120	60	10 max	.083 max	NEMA 5-15P	
740-T12	12-Channel Timer	120	60	10 max	.083 max	NEMA 5-15P	

*Single phase.

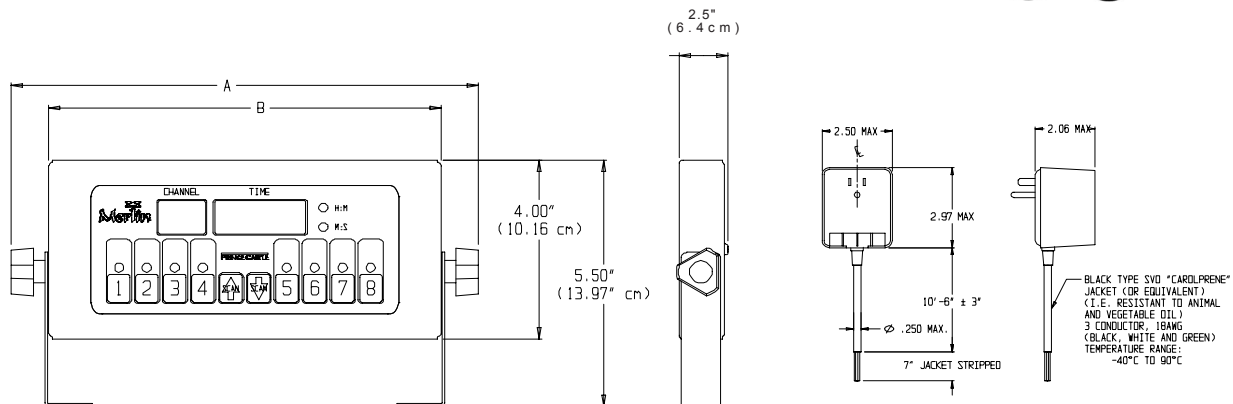

740-T12	12.93" (32.84 cm)	11.25" (28.58 cm)
740-T8	10.43" (26.49 cm)	8.75" (22.23 cm)
740-T4	8.93" (22.68 cm)	7.25" (18.42 cm)
740-T2	7.87" (19.99 cm)	6.19" (15.72 cm)
MODEL NUMBER	DIMENSION "A"	DIMENSION "B"

*Designs and specifications are subject to change without notice.



SINGLE-FUNCTION TIMERS

740 SERIES

Free Manuals Download Website

<http://myh66.com>

<http://usermanuals.us>

<http://www.somanuals.com>

<http://www.4manuals.cc>

<http://www.manual-lib.com>

<http://www.404manual.com>

<http://www.luxmanual.com>

<http://aubethermostatmanual.com>

Golf course search by state

<http://golfingnear.com>

Email search by domain

<http://emailbydomain.com>

Auto manuals search

<http://auto.somanuals.com>

TV manuals search

<http://tv.somanuals.com>