

Installation Manual for



For Right and Left Hinged Doors

Durable. Reliable. Attractive.
For door openings up to 36" (914 mm) wide
and 80 9/16" (2,047 mm) high

Quick and
Easy to Size
and **Install**



Congratulations and thank you for purchasing Viewpoint!

The Viewpoint Screen is designed and manufactured by Seiki Screen Systems, the world's largest manufacturer of retractable screens. Phantom Screens, North America's leading brand of retractable solutions, is proud to bring you these innovative products. Thanks to rigorous design and product testing, the Viewpoint Screen will provide years of dependable operation. Plus, it comes with a factory-supplied limited lifetime warranty on all parts against manufacturer's defects.

Viewpoint was designed for easy sizing and installation. This Installation Manual provides a step by step guide through the entire process.

Any questions? Contact
our Help Line, Toll Free at
1-877-446-7180.



Index

Getting to Know the Viewpoint Screen	4
Parts and Tools	5
Measuring the Door Opening	6
Cutting the Horizontal and Vertical Parts	7
Installing the Bottom Rail and Preparing the Screen Housing Assembly	8
Installing the Mounting Bracket	9
Installing the Top Rail and Catch Frame	10
Adjusting the Latch and Tension Wires	11
Attaching the Fixing Strip and Installing the Clips	12
Service and Maintenance Hints	13

For installation on a double hinged door (French Doors), you will need: two Viewpoint Screens and one Double Door Kit. Please refer to the Installation Manual within the “Double Door Kit” prior to starting.

The Viewpoint Screen is not intended for installation on a Sliding Patio Door.

Getting to Know the Viewpoint Screen

Before beginning, become familiar with the Viewpoint Screen and the door on which it will be installed.

The Viewpoint Screen accommodates both in-swing and out-swing doors. In-swing doors open to the inside of the home and require the Viewpoint Screen to be installed on the outside of the home. Out-swing doors open to the outside of the home and require the Viewpoint Screen to be installed on the inside of the home.

Does the Viewpoint Screen fit the Door Opening?

Make sure that the Viewpoint Screen will fit the door. This application will accommodate an opening of up to 36" (914 mm) wide, and between 76 9/16" (1,947 mm) and 80 9/16" (2,047 mm) high. If the door opening is larger than that, the Viewpoint Screen can still be installed by attaching a filler strip under the door frame to reduce the height of the door opening. Refer to page 6 for details.

NOTE: The Viewpoint Screen can only be shortened by 4" (100 mm) to a minimum height of 76 9/16" (1,947 mm). If the door opening is smaller than this, the Viewpoint Screen will not accommodate the door.

Is the Door Opening Square?

For the Viewpoint Screen to operate effectively, the door opening must be perfectly square. Using a Carpenter Square, check to ensure that the door frame is square. If not, use shims to bring the door frame to square before beginning installation.

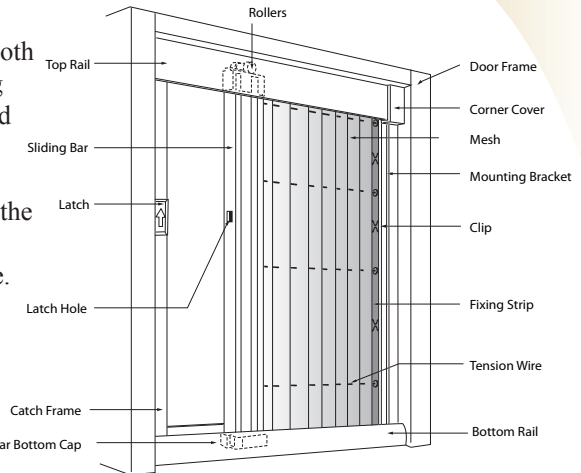

Is there enough Mounting Surface?

The Viewpoint Screen is a recess mount screen that installs on the inside surface of the door frame. A minimum Mounting Surface of 1 3/4" (45 mm) is required. This Mounting Surface must be flat and flush, and at a right angle (90°) to the door.

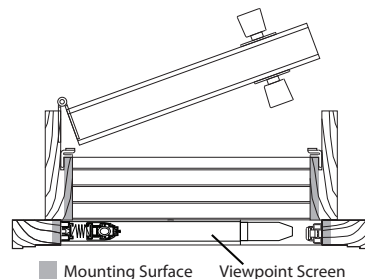

Parts and Tools

Before beginning, make sure that all these parts are included with the Viewpoint Screen package.

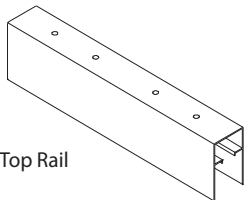

Top Rail

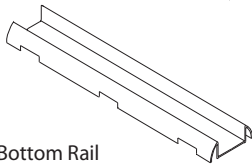

Bottom Rail

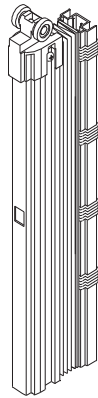

Screen Housing Assembly



Catch Frame
(not required for a double door application)



5/8" (16 mm)
Pan Head Screws
(12 pcs.)



1/2" (12 mm)
Flat Head Screws
(2 pcs.)

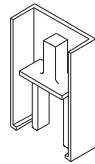

Corner Cover

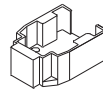

Sliding Bar
Bottom Cap

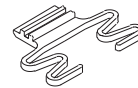

Clips (5 pcs.)

Required Tools

Hack saw

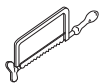

Measuring tape



Carpenter square



Philips screwdriver

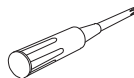

Electric drill



Level

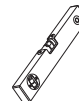

Pen



Viewpoint Screens can be sized and installed using common household tools. Make sure all necessary tools are available before beginning.

NOTE: A chop saw can be used in place of a hacksaw provided that a bi-metal blade has been properly installed

Measuring the Door Opening

The Viewpoint Screen requires a minimum Mounting Surface of 1 3/4" (45 mm). This mounting surface must be flat and flush, and at a right angle (90°) to the door.

For the Width - Measure the width of the opening between the right and left surfaces of the door frame, record this dimension in the box below labeled "W".

For the Height – Measure the height of the opening between the underside of the top of the door frame (or filler strip), and the top of the door sill at a point 1 3/4" (45 mm) from the front surface of the frame. Record this dimension in the box below labeled "H".

W	=	
H	=	

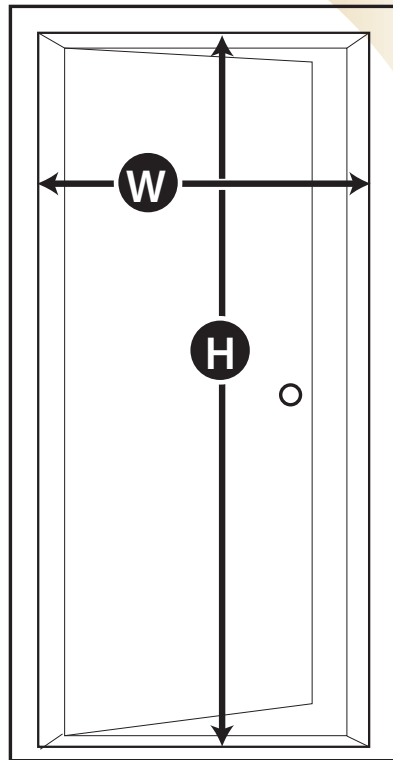

NOTE: If the height of the door opening is greater than the maximum height requirement it is still possible to install the Viewpoint Screen. Simply attach a filler strip under the top of door frame to reduce the height of the opening to at least 80 9/16" (2,047 mm). Be sure to attach the filler strip before taking the height measurement.

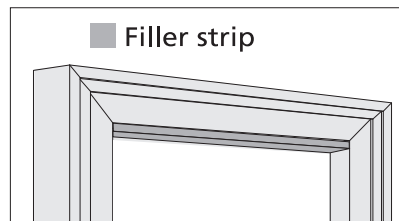
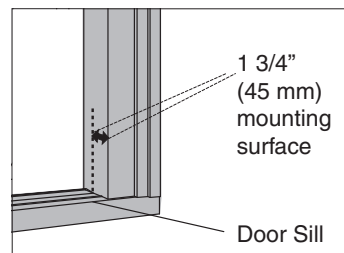

Cutting the Horizontal and Vertical Parts

Cutting the Horizontal Parts

Calculate the correct cut off Lengths.

Maximum Opening Width	Subtract inside door frame width "W"	Enter Cut off Length Below
36" (914 mm)	-	=

Cut from each part the cut off length provided by the calculation performed above.

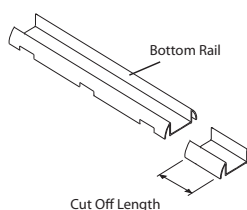
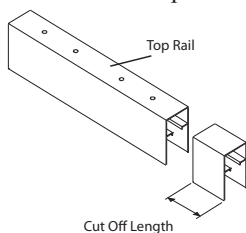

After cutting any part of the Viewpoint Screen, use a file to remove any burrs from the surfaces.

Cutting the Vertical Parts

Calculate the correct cut off Lengths.

NOTE: Cutting of the Screen Housing Assembly must take place from the bottom of the unit, note the "Cut" / "No Cut" labels. No more than 4" (100 mm) can be cut from the Screen Housing Assembly.

Maximum Opening Height	Subtract inside door frame height "H"	Enter Cut off Length Below
80 9/16" (2,047 mm)	-	=

Cut from each part the cut off length provided by the calculation performed above.

Do **NOT** remove the tape that keeps the components of the Screen Housing Assembly secure until all cutting is complete.

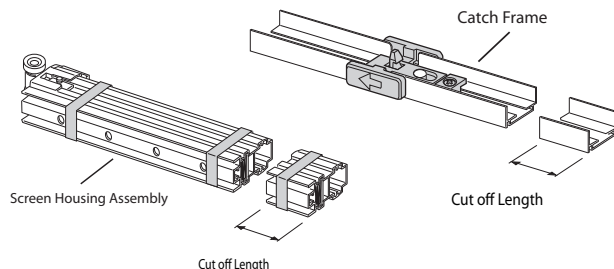

After cutting any part of the Viewpoint Screen, use a file to remove any burrs from the surfaces.

NOTE: Safety glasses should be worn at all times during the cutting process.

Installing the Bottom Rail and Preparing the Screen Housing Assembly

Installing the Bottom Rail

Remove the backing from the double sided tape on the bottom of the Bottom Rail. Attach the Bottom Rail onto the door sill, placing the front edge of the Bottom Rail even with the face or front edge of the door frame on both sides of the opening.

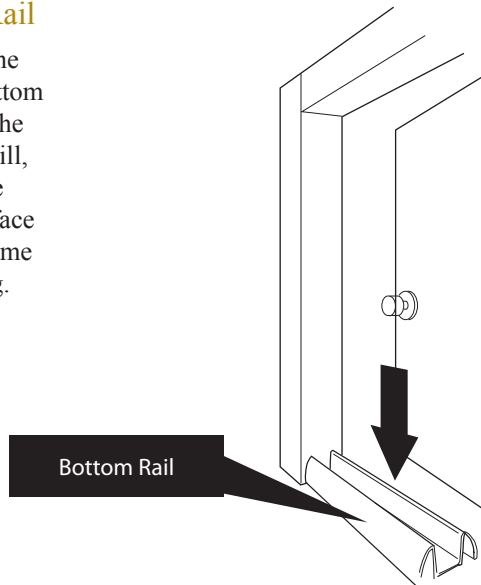

Preparing the Screen Housing Assembly

1. Before installing the Screen Housing Assembly, rotate the Mounting Bracket so that the Tension Wires are no longer wound around it. Failing to do so prior to installing the Mounting Bracket will restrict the motion of the Tension Wires and prevent the screen from operating.
2. Attach the Sliding Bar Bottom Cap to the bottom of the Sliding Bar using the two screws provided.
3. Insert the Corner Cover onto the top of the Mounting Bracket.

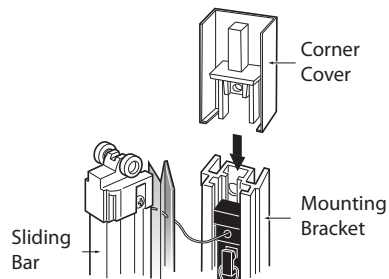
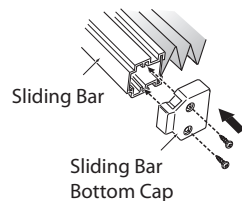

Installing the Mounting Bracket

1. Remove the backing of the adhesive strip on the back of the Mounting Bracket.
2. Insert the bottom of the Mounting Bracket into the track of the Bottom Rail on the hinge side of the door.
3. Push the Mounting Bracket upwards, ensuring that the top of the Corner Cover is tight against the upper portion of the door frame.
4. Using a level, ensure that the Mounting Bracket is positioned plumb. Then press the Mounting Bracket firmly against the door frame, allowing the adhesive tape to temporarily hold it in place.
5. Move the Sliding Bar and Mesh off to the side as indicated in the illustration.
6. Using the provided screws, secure the Mounting Bracket to the door frame.
7. Return the Sliding Bar and Mesh back to its original position, in front of the Mounting Bracket.

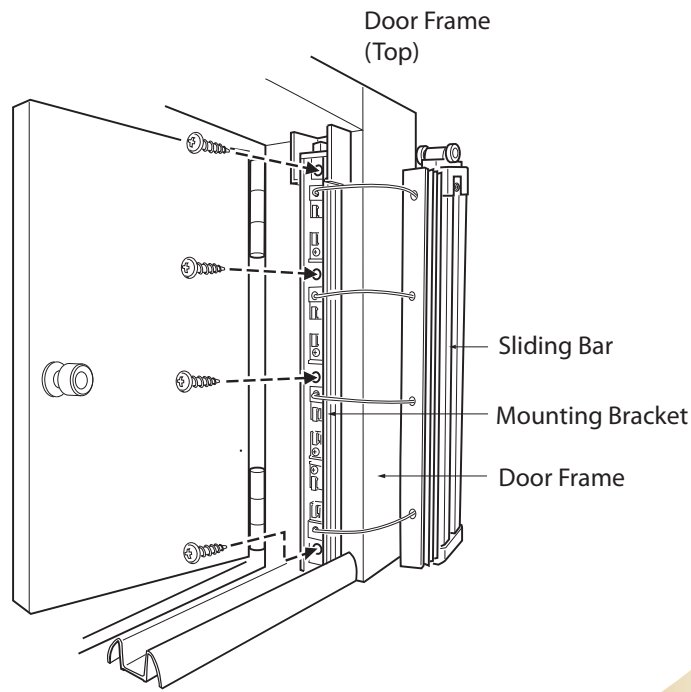

Installing the Top Rail and Catch Frame

Installing the Top Rail

1. Remove the backing of the adhesive tape on the top of the Top Rail.
2. Insert the Rollers at the top of the Sliding Bar into the Top Rail, then push the Top Rail into the Corner Cover on the top of the Mounting Bracket.
3. Position the Top Rail along the top of the door frame at a 90° angle to the side mounting surfaces.
4. Making sure that the Top Rail is tight against the side of the door frame opposite the Mounting Bracket, press firmly in place, allowing the adhesive tape to temporarily hold it in place.
5. Using the 5/8" (16mm) screws provided, secure the Top Rail to the door frame.

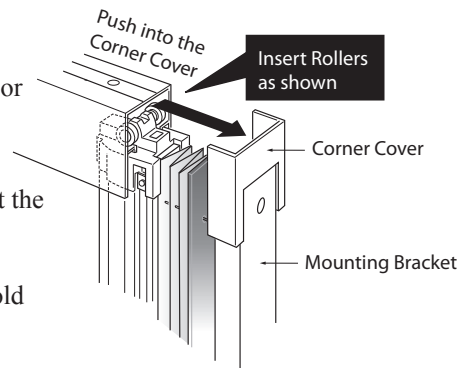

Installing the Catch Frame

1. Insert the bottom of the Catch Frame inside the Bottom Rail and the top of the Catch frame into the Top Rail. Position it against the door frame on the opposite side of the Screen Housing Assembly.
2. Lift the Catch Frame upward into the Top Rail as far as it will go, and secure to the door frame using the provided wood screws.

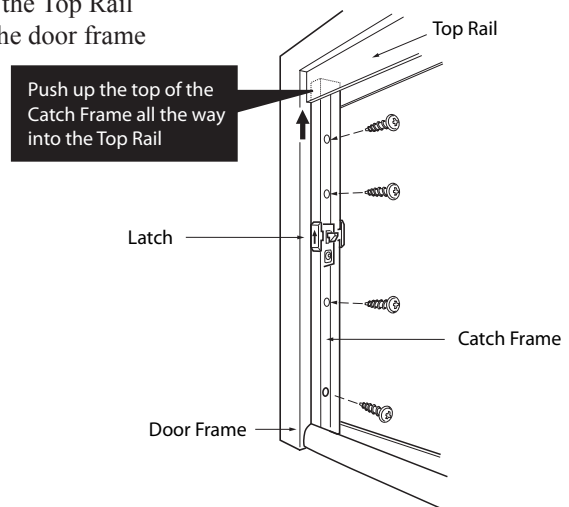

Adjusting the Latch and Tension Wires

Adjusting the Latch

Pull the Sliding Bar over to the Catch Frame and ensure that the Latch can be engaged. If the Latch cannot be engaged, adjust it by following the procedure shown in the diagram. Loosen the screw, adjust the height of the Latch until it engages with the Sliding Bar. Tighten the screw, careful not to over tighten.

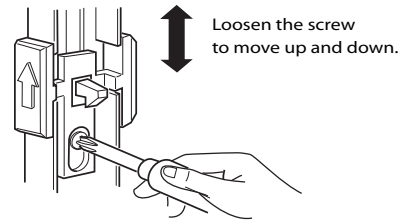

Adjusting the Tension Wires



- Slide the Sliding Bar to the opposite end to engage the Latch. Push the entire mesh over to the Sliding Bar so that only the Tension Wires are visible in the opening of the door. Loosen the screw of the top most Tension Wire Adjuster. Slide it up or down until snug, without any sag in the Tension Wire. Tighten the screw to secure it.

NOTE: do not over tighten the tension on the Tension Wire.

- If any of the other Tension Wires are sagging, perform the same procedure with each adjuster. If any of the situations below occur, follow the appropriate procedure to correct the situation.

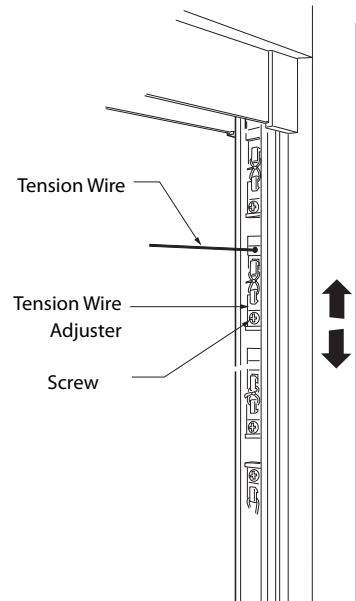
After adjusting the tension, move the Sliding Bar two or three times to check the operation of the Viewpoint Screen.

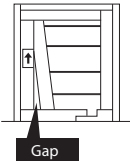

Situation #1	Situation #2	Situation #3
		
Solution #1	Solution #2	Solution #3
Keep the topmost Tension Wire Adjuster fixed, loosen the remaining Adjusters. Starting from the bottom Adjuster, adjust the tension of each wire to remove the gap as well as any sag in the Tension Wires.	To correct this situation, reverse the steps in Situation #1 starting from the top Adjuster.	Tighten the tension of the loose Tension Wire to the same tension as the other Tension Wires.

Attaching the Fixing Strip and Installing the Clips

Attach the Fixing Strip

Insert one edge of the Fixing Strip into the Mounting Bracket on an angle, beginning at the top, and working toward the bottom. Again from the top, press the other edge of the Fixing Strip into the Mounting Bracket, working it into position all the way to the bottom so that it is now fully inserted into the Mounting Bracket.

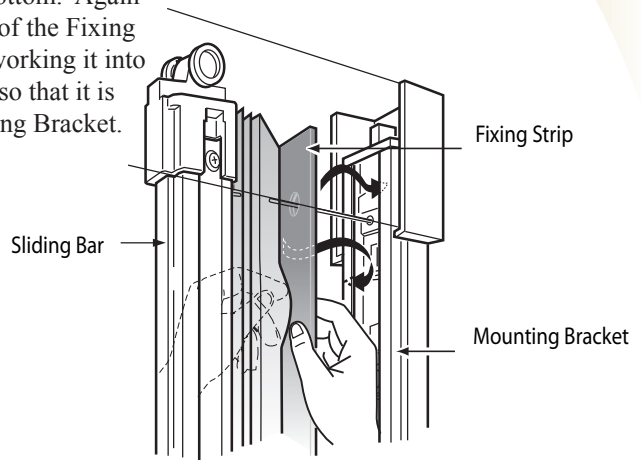

Installing the Clips

Install the Clips into the Mounting Bracket evenly between the Tension Wires keeping the ribbed face of the Clip facing outward. (Refer to the diagram.)

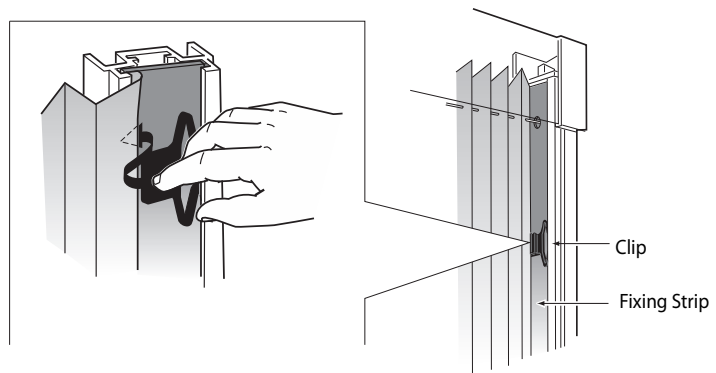

*The Viewpoint Screen Installation
is Now Complete!*

Service and Maintenance Hints

The Viewpoint Screen is designed and engineered to be maintenance free. The following are some helpful hints to ensure the smooth operation of the Viewpoint Screen for years to come.

- All moving components used in the Viewpoint Screen are manufactured from a mixture of nylon and other materials. This combination of compounds is strong, impact resistant, and self-lubricating. Do not use oil, grease, oil based sprays or lubricants on any of the components on the Viewpoint Screen. These products attract dirt and debris, and may cause the Viewpoint Screen to react abnormally. However, the periodic application of a dry silicon lubricant to the moving parts is permissible.
 - We recommend that while not in use, the Viewpoint Screen be kept in the retracted position. This will help extend the life of the screen mesh. In the retracted position, the mesh is protected and kept clean.
 - The Screen Mesh and Bottom Rail should be kept free of dirt and debris. Lightly vacuum to remove any obstructions from the Screen Mesh and Bottom Rail.
- * Before installing the Viewpoint Screen, please take the time to read the installation instructions thoroughly.

Help **Hotline**

The Viewpoint Screen was designed for easy sizing and installation. This Installation Manual provides a step by step guide through the entire process.

If there are any questions during the installation of the Viewpoint Screen, please call toll free:

1-877-446-7180



Viewpoint Screen

Limited Lifetime/Non-transferable Manufacturer's Warranty

The Viewpoint Screen is warranted by Seiki Screen Systems to be free of manufacturer's defects in materials or workmanship, for as long as the original purchaser owns and or resides at that residence and that the product remains at its original point of installation. Seiki Screen Systems will repair or replace at its discretion any component, within the terms and conditions of this warranty, which is deemed as being defective from the manufacturing process upon proof of purchase. This warranty excludes the screen mesh. Furthermore this warranty does not cover components damaged through improper use or installation, or if components have been altered from their original state in a manner not otherwise prescribed in the Viewpoint Screen Installation Instructions. This warranty is strictly limited to defective components only. This non-transferable, limited warranty excludes labor, breakage or damage due to normal wear and tear, lack of maintenance (as illustrated in our Installation Instructions), or use for other than residential applications, accidents and "acts of god". Replacements or repairs made subject to this limited warranty are otherwise warranted for the balance of the original warranty period. Seiki Screen Systems' liability under this limited warranty is restricted to the corrective actions as set forth herein and contrarily repudiates all incidental and consequential damage. It is the responsibility of the consumer to notify Seiki Screen Systems of missing components, within 30 days of the purchase of the Viewpoint Screen.

The Viewpoint Screen is designed to assist in keeping unwanted insects from the home; it is in no way intended as a safety or security device to prevent access by individuals, animals or small children. Liability for any damages, including but not limited to general, special, indirect, incidental, consequential, aggravated, punitive or exemplary damages, and economic loss, as well as for breach of any expressed or implied warranties, including but not limited to implied warranties of merchantability, quality and fitness for any purpose other than as prescribed herein, is disavowed and omitted here from, to the extent that such a disclaimer and preclusions are permitted by the laws of any particular jurisdiction.

Maintenance: Keep Bottom Rail clean and free of debris. Periodic use of silicone spray to the rollers on the top of the Sliding Bar is recommended, do not use petroleum based lubricants.

Viewpoint Screen
Designed and Manufactured by
Seiki Screen Systems
INSTALLATION INSTRUCTION MANUAL
For warranty claims
Call 1-877-446-7180
Or email: info@seikiscreensystems.com

Designed & Manufactured by Seiki Screen Systems TM
Marketed and Distributed by Phantom Screens [®]



Seiki Screen Systems
Call 1-877-446-7180
Or email: info@seikiscreensystems.com

www.seikiscreensystems.com



True to you. Pure Phantom.

Phantom Mfg. (Int'l) Ltd.
Call 1-888-PHANTOM
Or email: phantom@phantomscreens.com

www.phantomscreens.com

© 2008 Phantom Mfg. (Int'l) Ltd. & Seiki Screen Systems
VI0508

Free Manuals Download Website

<http://myh66.com>

<http://usermanuals.us>

<http://www.somanuals.com>

<http://www.4manuals.cc>

<http://www.manual-lib.com>

<http://www.404manual.com>

<http://www.luxmanual.com>

<http://aubethermostatmanual.com>

Golf course search by state

<http://golfingnear.com>

Email search by domain

<http://emailbydomain.com>

Auto manuals search

<http://auto.somanuals.com>

TV manuals search

<http://tv.somanuals.com>