

CI-1.5

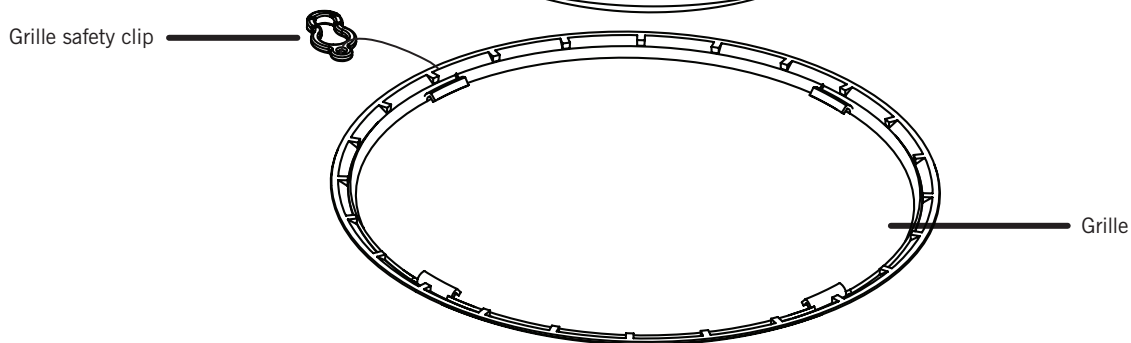
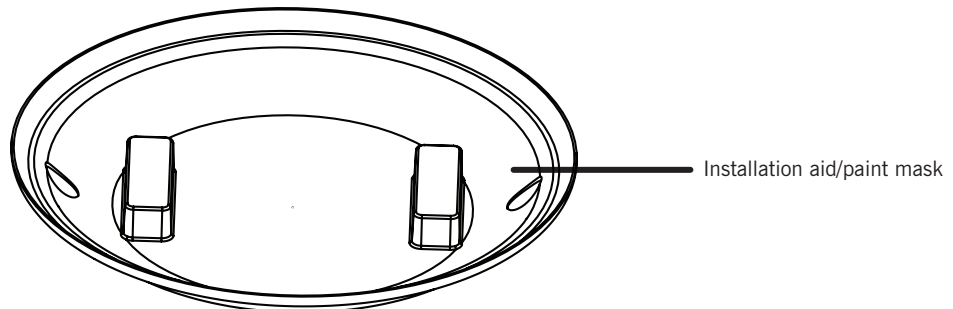
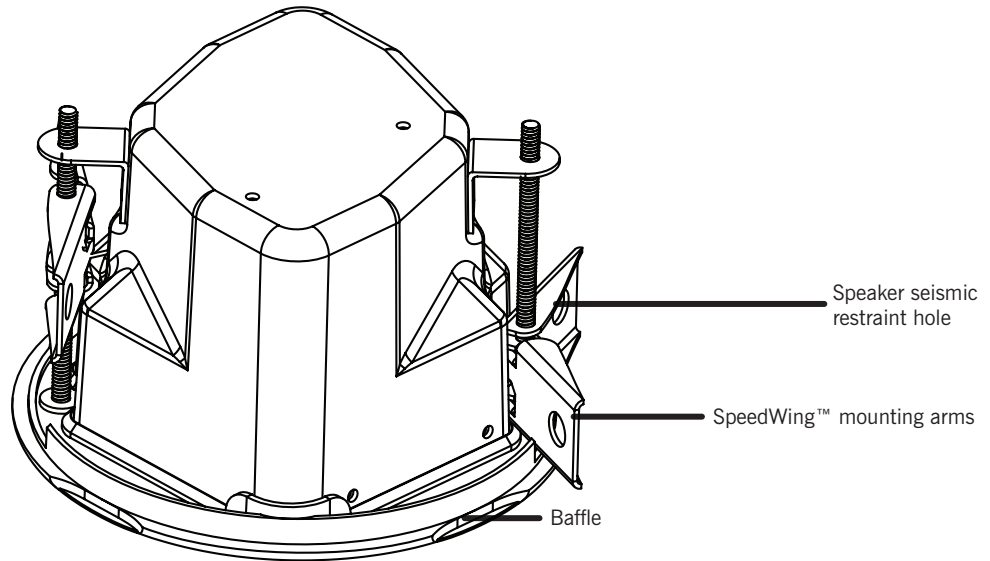

Box contents

- 1 Speaker
- 1 Grille
- 1 Paint mask
- 1 Hole template
- 1 Euroblock connector

MSE Audio Group 8650 College Boulevard Overland Park, Kansas 66210 (866) 663-9770
www.mseaudio.com www.phasetech.com

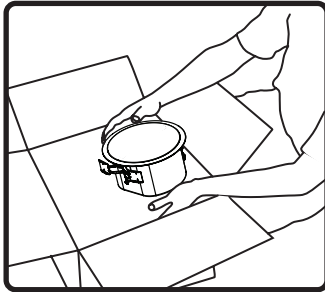

1. Unpack speaker. Leave paint mask in place until after speaker is installed or painting is complete.

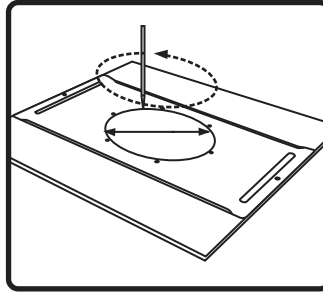

2. Use hole template to mark cutout on sheetrock.

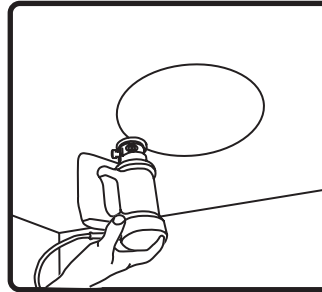

3. Use RotoZip or other tool to cut hole. Hole diameter: 5.6 in. (142 mm).

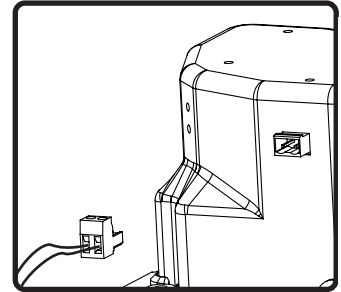

4. Connect Euroblock to speaker wires, and connect to speakers.

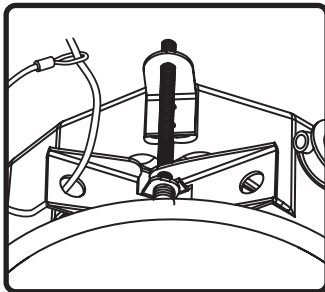

5. If required, attach seismic restraint system to hole in clamping arm, then to reinforced structure (safety cable not included)

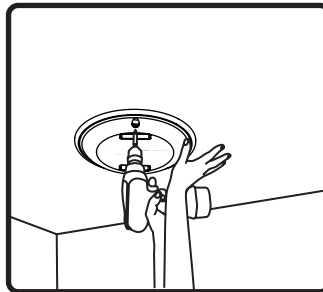

6. Insert speaker into mounting hole with paint mask in place. Tighten both screws on the baffle face to actuate the mounting wings. Firmly secure both screws, **DO NOT OVERTIGHTEN.**

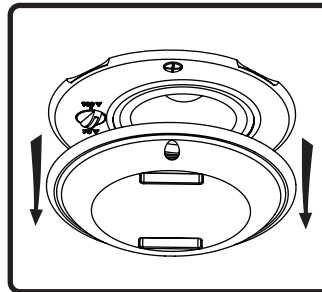

7. Remove paint mask unless painting is required. In that case, follow steps 8-11 when painting is complete.

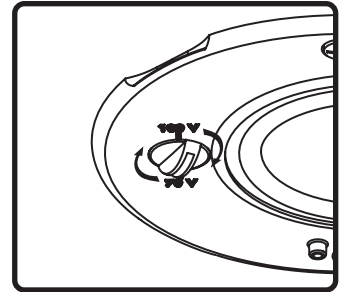

8. Adjust tap switch to proper setting. Switch is preset to 8-ohm mode.

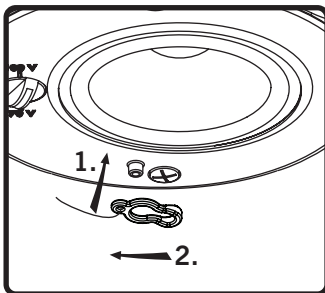

9. Attach grille safety clip by placing the large end of the clip over snap-fit post (1), then sliding clip until small end snaps into place around post (2).

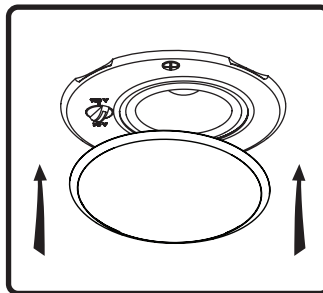

10. Align tabs on snap-fit grille with slots in baffle, gently press grille into place.

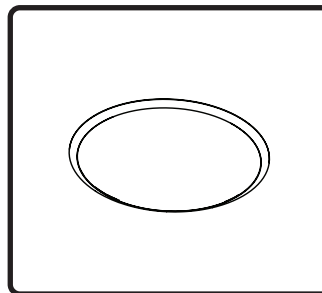

11. Done!

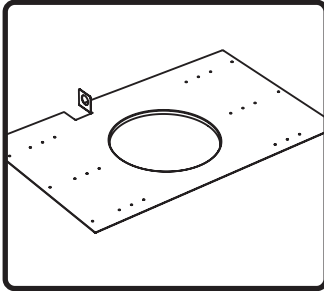

1. Nail or screw bracket to joists.

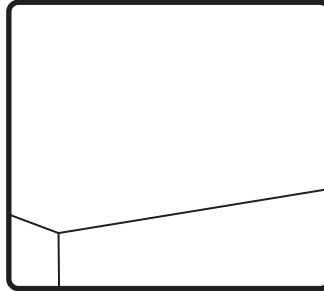

2. Finish installing ceiling.

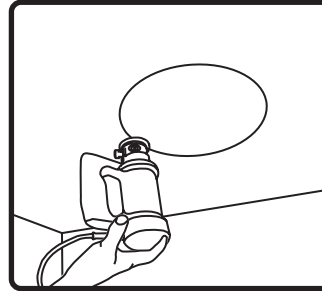

3. Use RotoZip or other tool to cut hole.

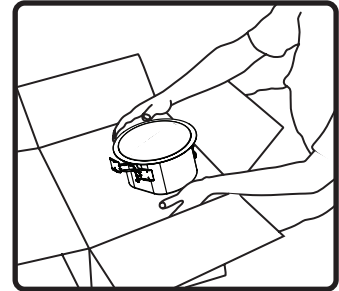

4. Unpack speaker. Leave paint mask in place until after speaker is installed or painting is complete.

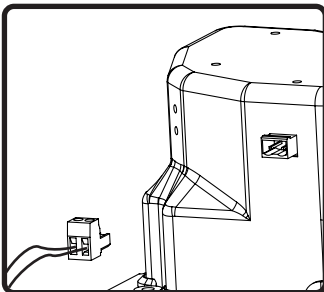

5. Connect euroblock to speaker wires, and connect to speakers.

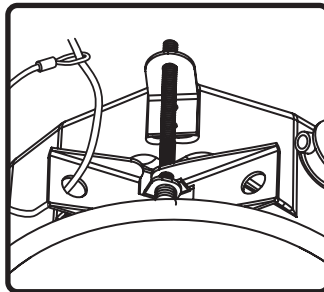

6. If required, attach seismic restraint system to the sheet-metal tab on the rear panel of the speaker, then to reinforced structure (safety cable not included).

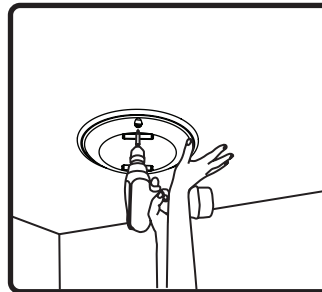

7. Insert speaker into mounting hole. Tighten both screws on the baffle face to actuate the mounting wings. **DO NOT OVERTIGHTEN.**

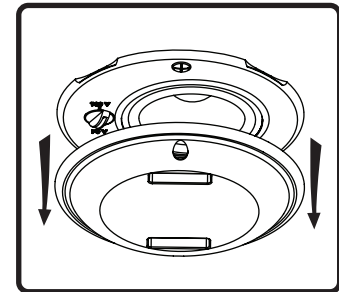

8. Remove paint mask unless painting is required. In that case, follow steps 9-12 when painting is complete.

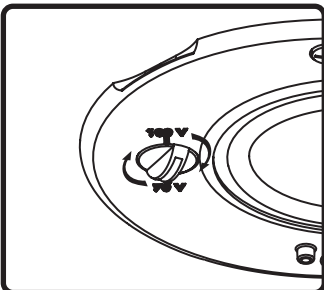

9. Adjust tap switch to proper setting. Switch is preset to the 8ohm mode

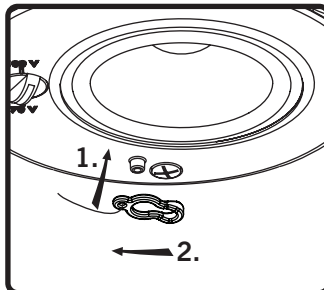

10. Attach grille safety clip by placing the large end of the clip over snap-fit post (1), then sliding clip until small end snaps into place around post (2).

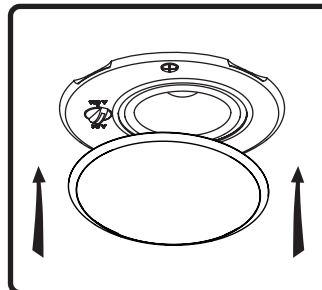

11. Align tabs on snap-fit grille with slots in baffle, gently press grille into place.

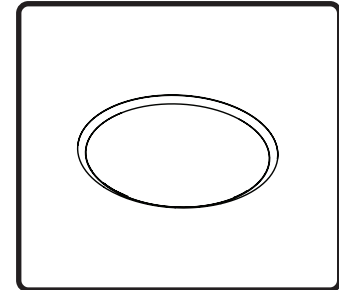

12. Done!

Free Manuals Download Website

<http://myh66.com>

<http://usermanuals.us>

<http://www.somanuals.com>

<http://www.4manuals.cc>

<http://www.manual-lib.com>

<http://www.404manual.com>

<http://www.luxmanual.com>

<http://aubethermostatmanual.com>

Golf course search by state

<http://golfingnear.com>

Email search by domain

<http://emailbydomain.com>

Auto manuals search

<http://auto.somanuals.com>

TV manuals search

<http://tv.somanuals.com>