

# baby monitor

## SBC SC484 DECT

Instructions for use  
**English 4**

Instructions pour l'utilisation  
**Français 16**

Modo de empleo  
**Español 28**

Bedienungsanleitung  
**Deutsch 40**

Gebruiksaanwijzing  
**Nederlands 52**

Istruzioni per l'uso  
**Italiano 64**

Instruções de uso  
**Português 76**

Οδηγίες χρήσης  
**Ελληνικά 88**

Bruksanvisning  
**Svenska 100**

Vejledning  
**Dansk 112**

Bruksanvisning  
**Norsk 124**

Käyttöohje  
**Suomi 136**



# PHILIPS

---

 **Helpline (www.p4c.philips.com)**

**België & Luxemburg/  
Belgien & Luxemburg/  
Belgique & Luxembourg  
(Belgium & Luxembourg)**  
Tel: 070 222303

**Danmark (Denmark)**  
Tlf: 808 82814

**Deutschland (Germany)**  
Phone: 0180 53 56 767

**España (Spain)**  
Phone: 902 11 33 84

**France**  
Phone: 08 25 88 97 89

**Ελλάνας (Greece)**  
Phone: 00800 3122 1280

**Ireland**  
Phone: 01 764 0292

**Italia (Italy)**  
Phone: 199118899

**Nederland (Netherlands)**  
Phone: 0900 8406

**Norge (Norway)**  
Phone: 2274 8250

**Österreich (Austria)**  
Phone: 0810 001203

**Portugal**  
Phone: 2416 3033

**Schweiz/ Suisse/ Svizzera  
(Switzerland)**  
Tel.: 0844 800 544

**Suomi (Finland)**  
puh. 09 615 80 250

**Sverige**  
Phone: 08 598 522 50

**UK (United Kingdom)**  
Phone: 0870 9009070

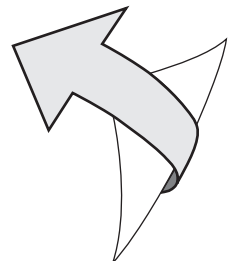

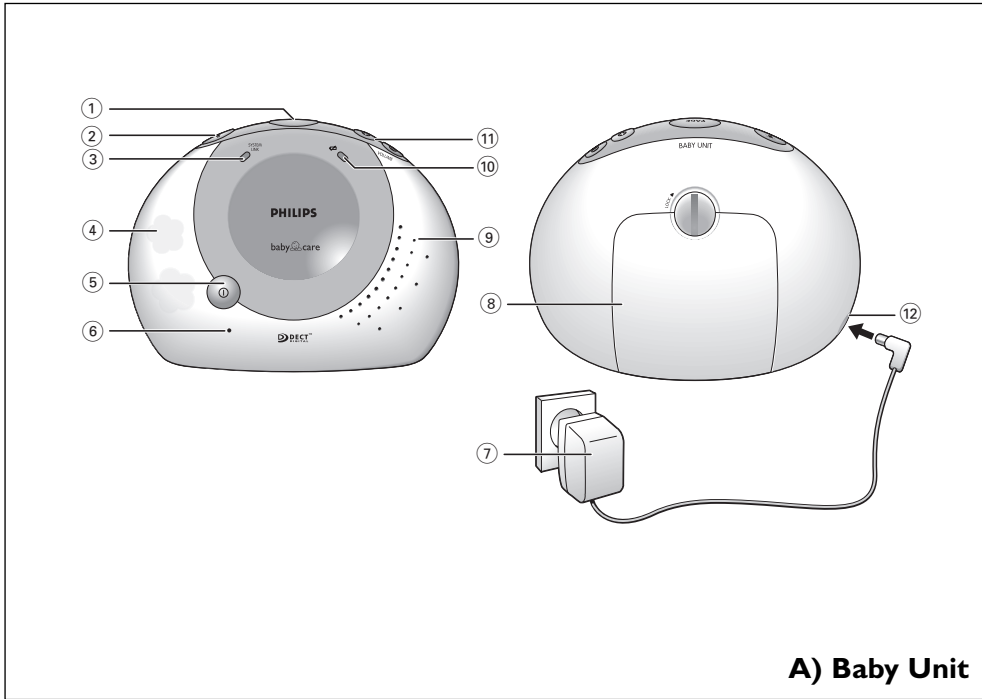

**A) Baby Unit**

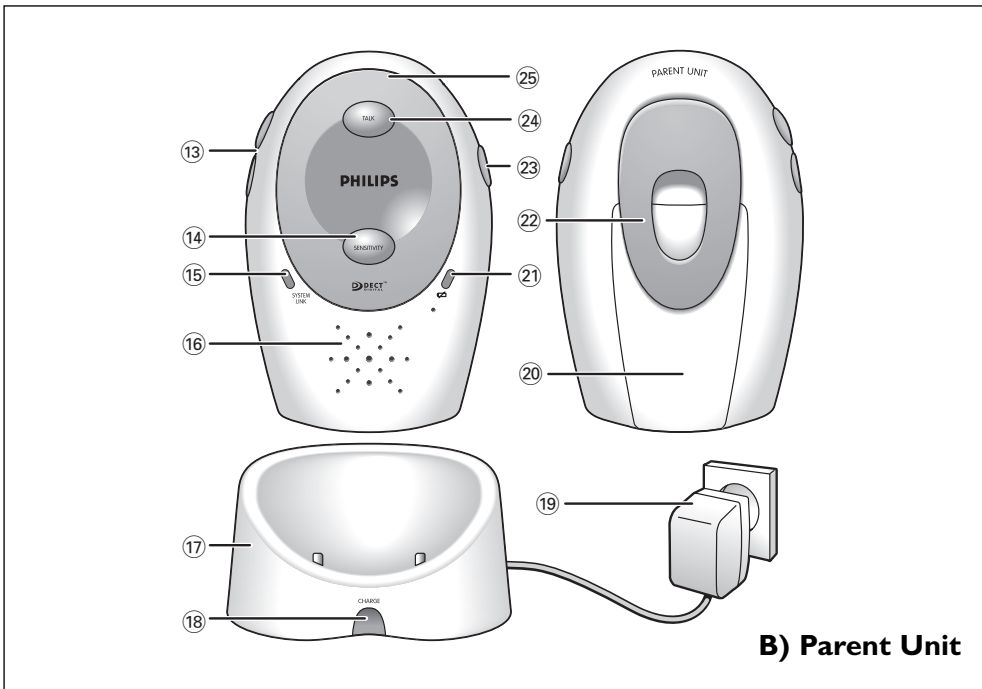

**B) Parent Unit**

# Your baby monitor

## SBC SC484

Philips is dedicated to producing caring, reliable products that new moms and dads really need. Products whose reliability and operating quality bring reassurance. You can trust this Philips baby monitor to provide round-the-clock support by ensuring you can always hear your baby clearly, no matter where you are in the house. The 100% Digital DECT 'cordless telephone technology' guarantees you hear only your own baby without any distracting noise.

### Philips Baby Care, Taking care together

#### Important information

Please read this guide carefully before using the baby monitor, and keep it for future reference. This baby monitor is intended as an aid. It is not a substitute for responsible and proper adult supervision and should not be used as such.

- Make sure the Baby Unit and adapter cable are always out of reach of the baby, at least one metre away.
- Never place the Baby Unit inside the baby's bed or playpen!
- Never cover the baby monitor (with a towel, blanket, etc.).
- Clean the baby monitor with a damp cloth.
- Never use the baby monitor near water.
- Dispose of used batteries in an environmentally friendly manner.

#### Safety precautions

- Check if the voltage indicated on the type plate of the adapters correspond to the local mains voltage before connecting to the mains power supply.
- Do not use the set in moist places or close to water.
- Do not expose the set to extreme heat or light (eg. direct sunlight).
- To prevent electric shock, do not open the cabinets of the Baby Unit, Parent Unit and charger.
- Avoid metallic contact (e.g. metal clips, keys) between the battery contacts and the contacts in the charging base.
- Risk of explosion if battery is replaced by an incorrect type. Never use non-rechargeable batteries for the parent unit.
- NiMH batteries must be disposed of in accordance with applicable waste disposal regulations.

## Environmental information

No unnecessary packaging material has been used. We have tried to make the packaging easy to separate into two mono-materials cardboard (box), and polyethylene.

**Please observe the local regulations regarding the disposal of packing materials, exhausted batteries and old equipment.**

## Contents

Help line	2
General	4
Important information	4-5
Functional overview	5-6
Getting the baby monitor ready	7-9
Monitoring your baby	9-11
Explanation of features	11-12
Problem solving	13
Technical specifications	14
Resetting to default factory settings	14-15

## Functional overview

### A) Baby Unit

#### 1 Page button

pages the Parent Unit in case you need to locate it.

#### 2 Night light button (☾)

switches on the nightlight.

#### 3 DECT SYSTEM LINK light

lights orange:	unit switched on
blinks red:	no connection for more than 30 seconds, the system check alarm on the Parent Unit beeps
blinks green slowly:	searching for connection
blinks green fast:	transmitting sound when TALK button pressed
lights green:	connection OK

#### 4 Night lights

#### 5 ON/OFF button (Ⓜ)

switches the Baby Unit On and Off.

#### 6 Microphone (MIC)

#### 7 AC power adapter

#### 8 Battery compartment cover

#### 9 Loudspeaker

#### 10 Battery check light (🔋)

lights up red when battery power is low.

#### 11 VOLUME Up/Down buttons (⊕ ⊖)

adjust the Baby Unit volume.

#### 12 DC power supply socket

*Legend of product  
illustration on inside flap.*

## 6 ENGLISH

### B) Parent Unit

#### 13 Volume Up/Down buttons (▲ ▼)

adjust the Parent Unit volume.

#### 14 Sensitivity button

adjusts the sensitivity of the Baby Unit speaker.

#### 15 DECT SYSTEM LINK light

lights orange:	unit switched on
blinks red:	no connection for more than 30 seconds, the system check alarm on the Parent Unit beeps
blinks green slowly:	searching for connection
blinks green fast:	transmitting sound when TALK button pressed
lights green:	connection OK

#### 16 Loudspeaker

#### 17 Charging base

#### 18 Charging light

#### 19 AC power adapter

#### 20 Battery compartment cover

#### 21 Battery check light (🔋)

lights up red when battery power is low.

#### 22 Belt clip

#### 23 ON/OFF button (Ⓜ)

switches the Parent Unit On and Off.

#### 24 TALK button

talks to your baby via the Baby Unit.

#### 25 Sound-level lights

- indicate that sound is detected by the Baby Unit.
- indicate the sensitivity level of the Baby Unit microphone.
- indicate the volume level of both Baby Unit and Parent Unit loudspeaker.

## Getting the baby monitor ready

### Baby Unit

For your convenience the Baby Unit can be mains or battery operated.

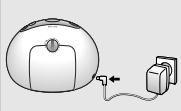

#### Mains operated use

- Connect the AC power adapter (7) to a mains socket and the cord to the DC power supply socket (12) of the Baby Unit.
  - > The Baby Unit is now ready for mains operated use.

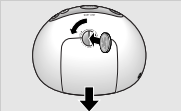

#### Battery operated use

##### 1 Remove the battery compartment cover (8).

Turn the Battery Lock knob to the left (for this use a coin) and slide the cover downwards.

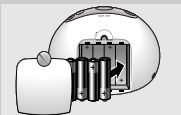

##### 2 Insert four 1.5V,AA size batteries noting the + and - configuration inside the battery compartment. (The batteries are not included; we recommend non-rechargeable Philips Alkaline batteries).

> When rechargeable batteries are used in the Baby Unit, these will be not charged.



##### 3 Put the battery compartment cover back in place.

- Slide the cover upward until it clicks in position.
- Turn the Battery Lock knob to the right (for this use a coin).
  - > The Baby Unit is now ready for battery operated use.
  - The Baby Unit operates for a minimum of 25 hours on fresh batteries
  - > When the battery check light (10) flashes red, the battery power is low. The Baby Unit should now still operate for 15 minutes. After that you should install new batteries.

#### Tips:

- Switch off the Baby night light to save battery power, when the Baby Unit is battery operated.
- Remove empty batteries from the Baby Unit.

#### Battery back-up

As soon as the batteries are inserted battery back-up will be activated.

In case of mains failure during mains operated use, the unit will automatically switch to battery operated use. As soon as the mains supply is back on the unit switches to mains operated use again.

## 8 ENGLISH

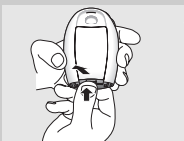

### Parent Unit

**1** Remove the battery compartment cover (20) by lifting the cover outward from the bottom.



**2** Insert the two enclosed AA rechargeable batteries, noting the + and - configuration inside the battery compartment.

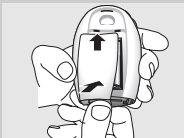

**3** Put the battery compartment cover back in place.

First slide the upperside of the cover into the recesses in the battery compartment. Then press the underside downwards until it clicks in position.



**5** Place the Parent Unit inside the charging base (17).

- > The red charging light (18) lights up.
- > The Parent Unit can be operated now, but you should leave it in the charging base until the batteries are fully charged (at least 16 hours). When the batteries are fully charged, the Parent Unit can be taken out of the charging base and used cordlessly for up to 16 hours.
- > When the battery check light (21) lights up red, the battery power is low. Place the Parent Unit inside the charging base to recharge the batteries.
- > If the rechargeable batteries begin to lose their effectiveness, replace them with two new rechargeable batteries.

*Note: For the parent unit, use rechargeable batteries only!*

*Never operate the Parent Unit with other types of batteries!*



### Disposal of batteries

- Dispose of used batteries in an environmentally friendly manner.
- Do not mix old and new batteries, or different types of batteries.
- Remove Baby Unit batteries if the baby monitor is not to be used for long periods.



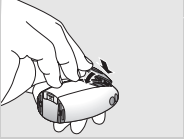

## Beltclip

### Connecting to the Parent Unit

- 1 Slide the wider side of the clip into the small rectangular recess on the back of the Parent Unit. Make sure the pins on the underside are above the circular recess.
- 2 Press the clip downwards until it clicks in position.



### Disconnecting from the Parent Unit

- 1 Place a flat screwdriver under the belt clip as indicated.
- 2 Gently press the screwdriver's point against the visible pin (1) in the circular recess.
- 3 Press the pin until the clip comes off.

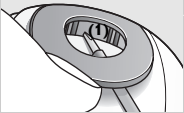

*Note: Do not use excessive force when pressing the pin! This could damage the clip and you might injure yourself with the screwdriver.*

## Monitoring your baby

### Switching on the units

- 1 Position the Baby Unit at least one metre away from your baby. Never place the Baby Unit inside the baby's bed or playpen.
  - 2 Press and hold the **Ⓛ** button (5) on the Baby Unit to switch on the Baby Unit.
  - 3 Press and hold the **Ⓛ** button (23) on the Parent Unit to switch on the Parent Unit.
    - > All lights light up for 2 seconds and then turn off again.
    - > The DECT SYSTEM LINK lights (3 and 15) of both units light up orange then start blinking (green). The units now search for connection.
    - > The DECT SYSTEM LINK lights (3 and 15) of both units light continuously (green) when the units have established connection. You can now monitor your baby.
- To switch off the units again press and hold the **Ⓛ** buttons (5 and 23).
    - > The units will beep when they are switched off.

*Note: The Parent Unit beeps when it is (accidentally) switched off while monitoring.*



## 10 ENGLISH

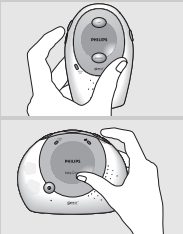

---

### Adjusting loudspeaker volume

- Use the ▲▲ buttons (13) on the Parent Unit to increase/decrease the loudspeaker volume of the Parent Unit.
- Use the ⊕⊖ buttons (11) on the Baby Unit to increase/decrease the loudspeaker volume of the Baby Unit.
  - > The sound-level lights (25) on the Parent Unit give visual feedback on the volume settings on both units for approximately 2 seconds:
    - 0 lights = Parent Unit volume switched off;
    - 1 light = monitoring baby silently;
    - 5 lights = maximum.

**Notes:**

- The volume of the Parent Unit can be switched off (0 lights).  
The volume of the Baby Unit cannot be switched off.
- A high pitched noise may occur in case the units are too close to each other. To avoid this you should switch the Parent Unit volume off before placing the units close to each other.
- You can only change the Baby Unit volume if the connection between the Baby Unit and Parent Unit is established.



---

### Adjusting microphone sensitivity

- 1 Press the SENSITIVITY button (14) on the Parent Unit.
  - > The sound-level lights (25) give visual feedback about the current sensitivity level for approximately 2 seconds.
- 2 Use the ▲▲ buttons (13) on the Parent Unit to increase/decrease the microphone sensitivity of the Baby Unit.
  - > The sound-level lights (25) on the Parent Unit give visual feedback about the setting for approximately 2 seconds.
    - 1 light = minimum level / lowest sensitivity
    - All 8 lights (5 green and 3 red) = maximum level (continuous transmission) / highest sensitivity

**Notes:**

- When set to maximum level (continuous transmission), the Baby Unit monitors continuously and all sounds, regardless of level, can be heard on the Parent Unit. Battery operating time may decrease to approximately 12 hours during continuous transmission.
- You can only change the Baby Unit microphone sensitivity if the connection between the Baby Unit and Parent Unit is established.





### Talking back to comfort your baby

- 1 On the Parent Unit, press and hold the TALK button (24) until the DECT SYSTEM LINK lights (3 and 15) of both units blink (green). Then talk clearly into the loudspeaker grill.
  - > While the TALK button on the Parent Unit is being pressed, no sounds from the Baby Unit can be heard on the loudspeaker of the Parent Unit.
- 2 Release the TALK button when finished or when you wish to hear your baby again.

## Explanation of features



### Monitoring baby silently

- Adjust the volume of the Parent Unit to the lowest level, using the   buttons (13).
  - > The sound-level lights (25) visually alert you to baby's sounds. The more sound your baby makes, the more lights light.
  - > When no sound is detected, all lights will be off.
  - > If the volume of the Parent Unit is set to Off, the Parent Unit will beep as soon as the second sound-level-light (25) lights red.

### Checking that the units have established a connection



- Check that the DECT SYSTEM LINK light (15) on the Parent Unit lights continuously (green) to confirm that the connection between both units is reliable.
  - > When losing the link it will take about 8 seconds before the system link led starts blinking. After another 30 seconds, the led blinks red and the alarm sound is heard on the parent unit. When re-establishing the link it takes maximally 30 seconds to confirm the link again.

## 12 ENGLISH



---

### Switching the night lights on and off

- Press the  button (2) on the Baby Unit to switch on the night lights.
- Press the  button again to switch off the night lights.
  - > The nightlights dim and gradually switches off.

*Note: Switch off the night lights when operating the Baby Unit on batteries to conserve power.*

---

### Paging the Parent Unit

If the Parent Unit is misplaced and the volume is switched off, you can use the Page button on the Baby Unit to locate the Parent Unit.

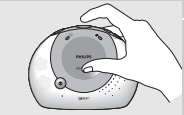

- Press the page button (1) on the Baby Unit.
  - > The Parent Unit will automatically reset to medium volume level and paging alert will sound.
- To stop the paging alert, press the Page button again or any button on the Parent Unit.

---

### Operating range

- The SBC SC484 baby monitor has an open air operating range of up to 300 metres. Walls, ceilings, large objects and even glass will decrease the operating range. Depending on your local circumstances, the operating range can decrease down to approximately 50 metres (maximum). When approaching the outer range boundary, the Parent Unit may produce a scratching or interrupting sound. The system check function (lights 4, 15 and beeping sound on the Parent unit) will in principle indicate to you the reliability of the connection between the Parent unit and Baby unit and whether you are out of range.

## Problem solving

If a fault occurs, first check the points listed below. If you are unable to remedy a problem by following these hints, contact the helpline or consult your dealer.

Under no circumstances should you try to repair the set yourself as this will invalidate the guarantee.

Problem	Possible cause	Solution
<b>DECT SYSTEM LINK light does not light</b>	Parent Unit: unit is not turned on. Baby Unit: unit is not turned on. Batteries are low. Power adapter is not plugged in or batteries are exhausted. Rechargeable batteries not inserted into Parent Unit.	Press the <b>Ⓛ</b> button (23). Press the <b>Ⓛ</b> button (5) Replace/recharge batteries. Plug in power adapter or replace batteries. Place rechargeable batteries.
<b>High pitched noise</b>	Units are too close to each other: Volume too high.	Move Parent Unit away from Baby Unit. Decrease the Parent Unit volume.
<b>Parent Unit batteries do not charge</b>	Battery life is at an end.  Battery polarity misfitted. Poor contact between Unit and Charger:	Replace rechargeable batteries, using only NiMH rechargeable batteries. Fit battery in correct polarity position. Clean Charger contact with soft dry cloth.
<b>No sound/ Cry of baby is not heard</b>	Volume on Parent Unit is set too low. Sensitivity setting on Parent Unit too low. Units are out of range.	Increase Parent Unit volume. Adjust sensitivity level of Parent Unit. Move Parent Unit closer to Baby Unit.
<b>Parent unit reacts on other ambient sounds</b>	Ambient sounds other than the baby, trigger the transmission.	Move the Baby Unit closer to the baby and try lowering the sensitivity on the Parent Unit.
<b>Battery check light lights (Baby Unit) or blinks (Parent Unit)</b>	Batteries are low or empty. Parent Unit: Baby Unit:	Recharge or replace batteries. Replace or remove battery.
<b>DECT SYSTEM LINK light (flashing red)/ System check alarm beeps on Parent Unit</b>	Units too far away from each other: Batteries are low. Units cannot establish a connection, even when close to each other.  No power to one of both units.	Decrease distance between units. Replace/recharge batteries. Try solving the problem by using the factory initialisation mode. For this see chapter 'Factory Initialisation mode'. Check <b>Ⓛ</b> button (23) on Parent Unit and <b>Ⓛ</b> button (5) on Baby Unit.

## 14 ENGLISH

## Technical specifications

<b>Power supply:</b>	<ul style="list-style-type: none"> <li>– 2x AA rechargeable batteries (1.5V, NiMH) for Parent Unit (included)</li> <li>– Optional batteries 4x 1.5V; AA for Baby Unit (not included)</li> <li>– AC power adapter 230V AC, 50 Hz. Only use the 9 Volt DC/ 300 mA AC power adapter included.</li> </ul>
<b>Operating range:</b>	<p>Up to 300 metres in ideal conditions. Range will be affected by walls, doors, etc. Indoors the range may decrease to 50 meters (maximum)</p>
<b>Operating temperature:</b>	0 °C to 40 °C
<b>Standard:</b>	Digital Enhanced Cordless Telecommunications (DECT)

## Resetting to default factory settings

### Factory Initialisation mode

With this mode both units can be reset to the default factory settings. Factory Initialisation can be used if problems occur which can not be solved by following the suggestions in chapter 'Problem solving'. Resetting must be done separately for each unit.

- 1 Press and hold the  button (5 and 23) to switch on the unit.

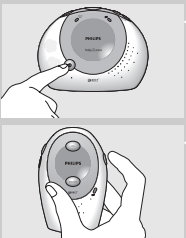



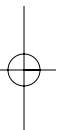



**Guarantuee certificate  
Garantiebewijs  
Certificado de garantia  
Garantibevis**

**Certificat de garantie  
Certificado de garantia  
Εγγύηση  
Garantibevis**

**Garantieschein  
Certificato di garanzia  
Garanticertifikat  
Takuutodistus**

# 1

year warranty  
année garantie  
Jahr Garantie  
jaar garantie  
año garantia  
anno garanzia

χρόνος εγγύηση  
år garanti  
år garanti  
år garanti  
vuosi takuu  
año garantia

Type: **SBC SC484**

Serial nr: \_\_\_\_\_

Date of purchase - Date de la vente - Verkaufsdatum - Aankoopdatum - Fecha de compra - Date d'acquisto -  
Data da aquisição - Ημερομηνία αγοράς - Inköpsdatum - Anskaffelsesdato - Kjøpedato - Oatopäivä -

Dealer's name, address and signature  
Nom, adresse et signature du revendeur  
Name, Anschrift und Unterschrift des Händlers  
Naam, adres en handtekening v.d. handelaar  
Nombre, dirección y firma del distribuidor  
Nome, indirizzo e firma del fornitore

Όνοματεπώνυμο, διεύθυνση και υπογραφή του εμπ. προμηθευτή  
Återförsäljarens namn, adress och signatur  
Forhandlerens navn, adresse og underskrift  
Forhandlerens navn, adresse og underskrift  
Jälleenmyyjän nimi, osoite ja allekirjoitus  
Nome, morada e assinatura da loja

6 month guarantee on rechargeable batteries  
6 mois de garantie sur les piles rechargeables  
6 meses de garantía para las pilas recargables  
6 Monate Garantie auf wiederaufladbare Batterien  
6 maanden garantie op oplaadbare batterijen  
Garanzia di 6 mesi sulle batterie ricaricabili

Pilhas recarregáveis com 6 meses de garantia  
Εγγύηση 6 μηνών σε επαναφορτιζόμενες μπαταρίες  
6 månaders garanti på laddningsbara batterier  
6 månaders garanti på genopladelige batterier  
6 månaders garanti på de opladbare batteriene  
Ladattavilla akuilla on 6 kuukauden takuu

**www.philips.com**

This document is printed on chlorine free produced paper  
Data subject to change without notice  
Printed in China

**CE 0682 ①**



## Free Manuals Download Website

<http://myh66.com>

<http://usermanuals.us>

<http://www.somanuals.com>

<http://www.4manuals.cc>

<http://www.manual-lib.com>

<http://www.404manual.com>

<http://www.luxmanual.com>

<http://aubethermostatmanual.com>

Golf course search by state

<http://golfingnear.com>

Email search by domain

<http://emailbydomain.com>

Auto manuals search

<http://auto.somanuals.com>

TV manuals search

<http://tv.somanuals.com>