

Register your product and get support at  
[www.philips.com/welcome](http://www.philips.com/welcome)

MCM169



---

EN User manual

---

## 1 Important

---

### Safety

- ① Read these instructions.
- ② Keep these instructions.
- ③ Heed all warnings.
- ④ Follow all instructions.
- ⑤ Do not use this apparatus near water.
- ⑥ Clean only with dry cloth.
- ⑦ Do not block any ventilation openings. Install in accordance with the manufacturer's instructions.
- ⑧ Do not install near any heat sources such as radiators, heat registers, stoves, or other apparatus (including amplifiers) that produce heat.
- ⑨ Protect the power cord from being walked on or pinched, particularly at plugs, convenience receptacles, and the point where they exit from the apparatus.
- ⑩ Only use attachments/accessories specified by the manufacturer.
- ⑪ Use only with the cart, stand, tripod, bracket, or table specified by the manufacturer or sold with the apparatus. When a cart is used, use caution when moving the cart/apparatus combination to avoid injury from tip-over.
- ⑫ Unplug this apparatus during lightning storms or when unused for long periods of time.



- ⑬ Refer all servicing to qualified service personnel. Servicing is required when the apparatus has been damaged in any way, such as power-supply cord or plug is damaged, liquid has been spilled or objects have fallen into the apparatus, the apparatus has been exposed to rain or moisture, does not operate normally, or has been dropped.
- ⑭ **Battery usage CAUTION** – To prevent battery leakage which may result in bodily injury, property damage, or damage to the unit:
- Install all batteries correctly, + and - as marked on the unit.
  - Do not mix batteries (old and new or carbon and alkaline, etc.).
  - Remove batteries when the unit is not used for a long time.
- ⑮ Apparatus shall not be exposed to dripping or splashing.
- ⑯ Do not place any sources of danger on the apparatus (e.g. liquid filled objects, lighted candles).
- ⑰ This product may contain lead and mercury. Disposal of these materials may be regulated due to environmental considerations. For disposal or recycling information, please contact your local authorities or the Electronic Industries Alliance: [www.eiae.org](http://www.eiae.org).
- ⑱ Where the MAINS plug or an appliance coupler is used as the disconnect device, the disconnect device shall remain readily operable.



## Warning

- Never remove the casing of this Micro Hi-Fi.
- Never lubricate any part of this Micro Hi-Fi.
- Never place this Micro Hi-Fi on other electrical equipment.
- Keep this Micro Hi-Fi away from direct sunlight, naked flames or heat.
- Never look into the laser beam inside the Micro Hi-Fi.
- Ensure that you always have easy access to the power cord, plug or adaptor to disconnect the Micro Hi-Fi from the power.



## Caution

- Use of controls or adjustments or performance of procedures other than herein may result in hazardous radiation exposure or other unsafe operation.

---

## Hearing safety

### Listen at a moderate volume.

- Using headphones at a high volume can impair your hearing. This product can produce sounds in decibel ranges that may cause hearing loss for a normal person, even for exposure less than a minute. The higher decibel ranges are offered for those that may have already experienced some hearing loss.
- Sound can be deceiving. Over time your hearing 'comfort level' adapts to higher volumes of sound. So after prolonged listening, what sounds 'normal' can actually be loud and harmful to your hearing. To guard against this, set your volume to a safe level before your hearing adapts and leave it there.

### To establish a safe volume level:

- Set your volume control at a low setting.
- Slowly increase the sound until you can hear it comfortably and clearly without distortion.

- Prolonged exposure to sound, even at normally 'safe' levels, can also cause hearing loss.
- Be sure to use your equipment reasonably and take appropriate breaks.

### **Be sure to observe the following guidelines when using your headphones.**

- Listen at reasonable volumes for reasonable periods of time.
- Be careful not to adjust the volume as your hearing adapts.
- Do not turn up the volume so high that you can't hear what's around you.
- You should use caution or temporarily discontinue use in potentially hazardous situations. Do not use headphones while operating a motorized vehicle, cycling, skateboarding, etc.; it may create a traffic hazard and is illegal in many areas.

---

## Notice

This product complies with the radio interference requirements of the European Community.



This product complies with the requirements of the following directives and guidelines: 2004/108/EC + 2006/95/EC

Any changes or modifications made to this device that are not expressly approved by Philips Consumer Lifestyle may void the user's authority to operate the equipment.

The making of unauthorized copies of copy-protected material, including computer programs, files, broadcasts and sound recordings, may be an infringement of copyrights and constitute a criminal offence. This equipment should not be used for such purposes.



**Be responsible  
Respect copyrights**

---

## Recycling

Your product is designed and manufactured with high quality materials and components, which can be recycled and reused.



When you see the crossed-out wheel bin symbol attached to a product, it means the product is covered by the European Directive 2002/96/EC:

Never dispose of your product with other household waste. Please inform yourself about the local rules on the separate collection of electrical and electronic products. The correct disposal of your old product helps prevent potentially negative consequences on the environment and human health.



Your product contains batteries covered by the European Directive 2006/66/EC, which cannot be disposed of with normal household waste.

When you see the crossed-out wheel bin symbol with the chemical symbol 'Pb', it means that the batteries comply with the requirement set by the directive for lead:



Pb

Please inform yourself about the local rules on separate collection of batteries. The correct disposal of batteries helps prevent potentially negative consequences on the environment and human health.

### Environmental information

All unnecessary packaging has been omitted. We have tried to make the packaging easy to separate into three materials: cardboard (box), polystyrene foam (buffer) and polyethylene (bags, protective foam sheet.)

Your system consists of materials which can be recycled and reused if disassembled by a specialized company. Please observe the local regulations regarding the disposal of packaging materials, exhausted batteries and old equipment.

Windows Media and the Windows logo are trademarks, or registered trademarks of Microsoft Corporation in the United States and/or other countries.



This Micro Hi-Fi includes this label:



## Norge

Typeskilt finnes på apparatens underside.

Observer: Nettbryteren er sekundert innkopleet. Den innebygde nettdelen er derfor ikke frakopleet nettet så lenge apparatet er tilsluttet nettkontakten.

For å redusere faren for brann eller elektrisk støt, skal apparatet ikke utsettes for regn eller fuktighet.

## 2 Your Micro Hi-Fi

Congratulations on your purchase, and welcome to Philips! To fully benefit from the support that Philips offers, register your product at [www.Philips.com/welcome](http://www.Philips.com/welcome).

---

### Introduction

With this Micro Hi-Fi, you can enjoy audio discs, USB devices, external devices, or radio stations.

The Micro Hi-Fi offers you multiple sound effect settings that enrich sound with Digital Sound Control (DSC) and Dynamic Bass Boost (DBB).

The Micro Hi-Fi supports the following media formats:



---

## What's in the box



Check and identify the contents of your package:

- Main unit
- Loudspeaker boxes x 2
- Remote control
- MP3 link cable
- AC power cable

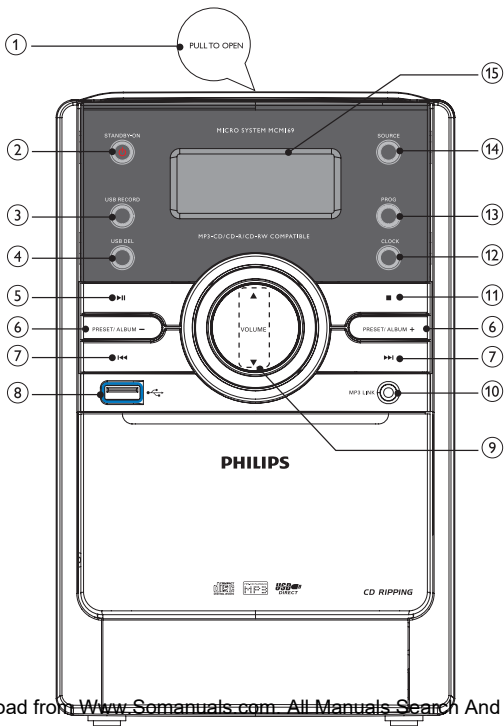

# Overview of the main unit



- ① **PULL TO OPEN**
  - Open or close the disc tray.
- ② **STANDBY-ON** 
  - Turn on the unit or switch to standby mode.
- ③ **USB RECORD**
  - Record from a disc to a USB device.
- ④ **USB DEL**
  - Delete audio files stored on a USB device.
- ⑤ **▶ ||**
  - Start or pause play.
- ⑥ **PRESET/ALBUM+/-**
  - Select a preset radio station.
  - Skip to the previous/next album.
- ⑦ **⏮ ⏪ ⏩ ⏭**
  - Skip to the previous/next track.
  - Search within a track/ disc/USB.
  - Tune to a radio station.
  - Adjust time.
- ⑧ ****
  - Jack for a USB mass storage device.
- ⑨ **VOLUME▲▼**
  - Adjust volume.
- ⑩ **MP3 LINK**
  - Audio input jack (3.5mm ) for an external audio device.
- ⑪ **■**
  - Stop play or erase a program.
- ⑫ **CLOCK**
  - Set the clock.
  - View the clock.
  - During play, select display information.



- ⑬ **PROG**
- Program tracks.
  - Program radio stations.
  - Select 12 hour or 24 hour format.

- ⑭ **SOURCE**
- Select a source: Disc, tuner, USB or MP3 link.

- ⑮ **Display panel**
- Show current status.

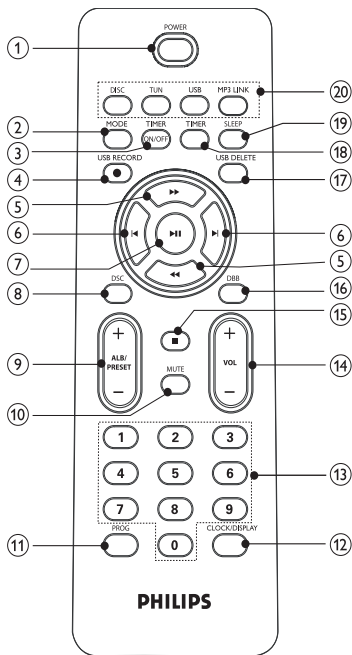
# Overview of the remote control



- ① **POWER**
  - Turn on the unit or switch to standby mode.
- ② **MODE**
  - Select repeat play or random play.
- ③ **TIMER ON/OFF**
  - Turn on or off alarm timer.
- ④ **USB RECORD**
  - Record from a disc to a USB device.
- ⑤ 
  - Search within a track/ disc/USB.
  - Tune to a radio station.
  - Adjust time.
- ⑥ 
  - Skip to the previous/next track.
- ⑦ 
  - Start or pause play.
- ⑧ **DSC**
  - Select a preset sound setting: POP, JAZZ, CLASSIC or ROCK.
- ⑨ **ALB/PRESET +/-**
  - Skip to the previous/next album.
  - Select a preset radio station.
- ⑩ **MUTE**
  - Mute volume.
- ⑪ **PROG**
  - Program tracks.
  - Program radio stations.
  - Select 12 hour or 24 hour format.
- ⑫ **CLOCK/DISPLAY**
  - Set the clock.
  - View the clock.
  - During play, select display information.

- ⑬ **Numeric keypad**
- Select a track from a disc directly.
- ⑭ **VOL +/-**
- Adjust volume.
- ⑮ **■**
- Stop play or erase a program.
- ⑯ **DBB**
- Turn on or off dynamic bass enhancement.
- ⑰ **USB DELETE**
- Delete audio files stored on a USB device.
- ⑱ **TIMER**
- Set the alarm timer.
- ⑲ **SLEEP**
- Set the sleep timer.
- ⑳ **Source selection keys (DISC, TUN, USB, MP3 LINK)**
- Select a source: CD, tuner, USB or MP3 link.

## 3 Connect

### Connect speakers

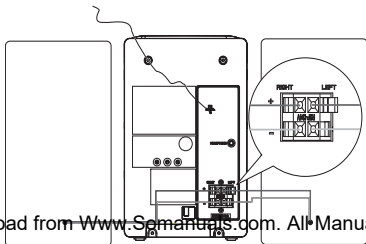



## Note

- Insert the stripped portion of each speaker wire into the socket completely.
- For optimal sound, use the supplied speakers only.
- Connect only speakers with impedance that is the same or higher than the supplied speakers. Refer to the Specifications section of this manual.

- 1 For the right speaker, find the sockets on the main unit marked 'RIGHT'.
- 2 Insert the red wire to the red (+) socket. To insert each speaker wire:
  - ① Hold down the socket flap.
  - ② Insert the speaker wire fully.
  - ③ Release the socket flap.

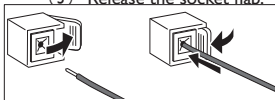

- 3 Insert the black wire into the black (-) socket.
- 4 For the left speaker, find the sockets on the main unit marked 'LEFT'.
- 5 Repeat steps 2-3.

## Connect power

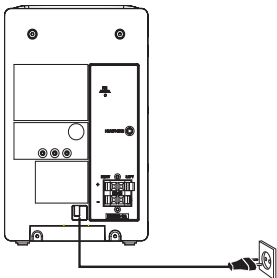

### Caution

- Risk of product damage! Ensure that the power supply voltage corresponds to the voltage printed on the back or the underside of the Micro Hi-Fi.
- Before connecting the AC power cord, ensure you have completed all other connections.

- 1 Connect the AC power cable to:
  - the main unit.
  - the wall socket.



# 4 Get started



## Caution

- Use the controls only as stated in this user manual.

Always follow the instructions in this chapter in sequence. If you contact Philips, you will be asked for the model and serial number of your Micro Hi-Fi. The model number and serial number are on the back of your Micro Hi-Fi. Write the numbers here:

Model No. \_\_\_\_\_

Serial No. \_\_\_\_\_

---

## Prepare the remote control



## Caution

- Risk of explosion! Keep batteries away from heat, sunshine or fire. Never discard batteries in fire.

To replace the remote control battery:

- 1 Open the battery compartment.
- 2 Insert 2 AAA batteries with correct polarity (+/-) as indicated.

- 3 Close the battery compartment.

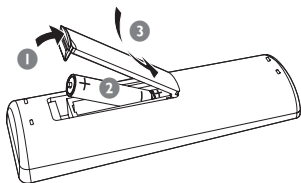

#### Note

- If you are not going to use the remote control for a long time, remove the batteries.

## Auto install radio stations

When you connect power and no radio stations are stored, the Micro Hi-Fi automatically begins to store radio stations.

- 1 Connect the Micro Hi-Fi to the power supply.
  - ↳ [AUTO INSTALL - PRESS PLAY] (auto install - press the PLAY button) is displayed.
- 2 Press **▶||** on the main unit to start installation.
  - ↳ [AUTO] (auto) is displayed.
  - ↳ The Micro Hi-Fi automatically stores radio stations with sufficient signal strength.
  - ↳ When all the available radio stations are stored, the first preset radio station is broadcast automatically.

## Set clock

- 1 Press and hold **CLOCK/DISPLAY** to activate the clock setting mode.  
↳ The 12 hour or 24 hour format is displayed.
- 2 Press **ALB/PRESET+/-** repeatedly to select 12 hour or 24 hour format.
- 3 Press **CLOCK/DISPLAY** to confirm.  
↳ The hour digits are displayed and begin to blink.
- 4 Press **◀◀/▶▶** to set the hour.
- 5 Press **CLOCK/DISPLAY** to confirm.  
↳ The minute digits are displayed and begin to blink.
- 6 Press **◀◀/▶▶** to set the minute.
- 7 Press **CLOCK/DISPLAY** to confirm.



### Tip

- To view the clock during play, press **CLOCK/DISPLAY** repeatedly until the clock is displayed.

---

## Turn on

- 1 Press **POWER**.  
↳ The Micro Hi-Fi switches to the last selected source.

---

## Switch to standby

- 1 Press **POWER** to switch the Micro Hi-Fi to standby mode.  
↳ The backlight on the display panel is dimmed.  
↳ The clock (if set) appears on the display panel.

# 5 Play

## Play disc

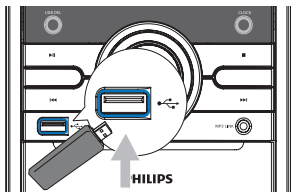

- 1 Press **DISC** to select the disc source.
- 2 Lift the lid of the CD compartment.
- 3 Insert a disc with the printed side facing up, then close the disc tray.
- 4 Press **▶||** to start play.
  - To pause/resume play, press **▶||**.
  - To stop play, press **■**.

## Play from USB



### Note

- Ensure that the USB device contains playable audio contents for supported formats.

- 1 Insert the USB plug of a USB device into  the socket.
- 2 Press **USB** to select the USB source.
  - ↳ The total number of tracks is displayed.
- 3 Press **ALB/PRESET**  to select a folder.

4 Press **◀▶** to select a file.

5 Press **▶||** to start play.

## 6 Play options

---

### Skip to a track

For CD:

1 Press **◀▶** to select another track.

- To select a track, you can also press a numeric button.

For MP3 disc and USB:

1 Press **ALB/PRESET+/-** to select an album or folder.

2 Press **◀▶** to select a track or file.

---

### Search within a track

1 During play, press and hold **◀◀▶▶**.

2 Release to resume normal play.

---

### Display play information

1 During play, press **CLOCK/DISPLAY** repeatedly to select different play information.

---

### Repeat and random play

1 Press **MODE** repeatedly to select:

- [REP] (repeat): the current track is played repeatedly.
- [REP ALL] (repeat all): all tracks are played repeatedly.
- [SHUF] (shuffle): all tracks are played randomly.

2 To return to normal play, press **MODE** repeatedly until play mode is no longer displayed.



## Tip

- Shuffle play cannot be selected when you play programmed tracks.

---

## Program tracks

You can program a maximum of 40 tracks.

- 1 At CD/USB mode, in the stop position, press **PROG** to activate the program mode.  
↳ [PROG] (program) blinks on the display.
- 2 For MP3/WMA tracks, press **ALB/PRESET+/-** to select an album.
- 3 Press **◀▶** to select a track number, then press **PROG** to confirm.
- 4 Repeat steps 2 to 3 to select and store all tracks to program.
- 5 Press **▶||** to play the programmed tracks.  
↳ During play, [PROG] (program) is displayed.
  - To erase the program, in the stop position, press **■**.

## 7 Adjust volume level and sound effect

---

### Adjust volume level

- 1 During play, press **VOL +/-** to increase/decrease the volume level.

---

### Select a preset sound effect

- 1 During play, press **DSC** repeatedly to select:
  - [POP] (pop)
  - [JAZZ] (jazz)
  - [CLASSIC] (classic)
  - [ROCK] (rock)

---

## Enhance bass

- 1 During play, press **DBB** to turn on or off dynamic bass enhancement.  
↳ If DBB is activated, DBB is displayed.
- 

## Mute sound

- 1 During play, press **MUTE** to mute/unmute sound.

# 8 Listen to radio

---

## Tune to a radio station

- 1 Press **TUN** repeatedly to select FM or MW.
  - 2 Press and hold **◀◀/▶▶** for more than 2 seconds.  
↳ [SEARCH] (search) is displayed.  
↳ The radio tunes to a station with strong reception automatically.
  - 3 Repeat step 2 to tune to more stations.
    - To tune to a weak station, press **◀◀/▶▶** repeatedly until you find optimal reception.
- 

## Program radio stations automatically

You can program a maximum of 40 preset radio stations.

- 1 In the tuner mode, press and hold **PROG** for 2 seconds to activate automatic program mode.  
↳ [AUTO] (auto) is displayed.  
↳ All available stations are programmed in the order of waveband reception strength.  
↳ The first programmed radio station is broadcast automatically.

## Program radio stations manually

You can program a maximum of 40 preset radio stations.

- 1 Tune to a radio station.
- 2 Press **PROG** to activate program mode.  
↳ [PROG] (program) blinks on the display.
- 3 Press **ALB/PRESET+/-** to allocate a number to this radio station, then press **PROG** to confirm.  
↳ The preset number and the frequency of the preset station are displayed.
- 4 Repeat the above steps to program other stations.



Tip

- To overwrite a programmed station, store another station in its place.

---

## Select a preset radio station

- 1 In tuner mode, press **ALB/PRESET+/-** to select a preset number.



Tip

- Position the antenna as far as possible from TV, VCR or other radiation source.
- For optimal reception, fully extend and adjust the position of the antenna.



## 9 USB record

You can record the audio files on a disc into a USB device. Audio CD tracks and MP3 files are recorded in .mp3 format, and WMA files are recorded in .wma format.

The first time you record to USB, a folder called 'PHILIPS' is automatically created in the USB device. Each time you record to USB, the recorded files are stored in a sub-folder in the 'PHILIPS' folder. Files and sub-folders are named numerically in the order in which they are created.

---

### Auto record from CD to USB

- 1 Press **DISC** to select the disc source.
- 2 Load a disc.
  - To select a track from which a recording starts, press the numeric buttons.
- 3 Plug the USB device into  socket of this Micro Hi-Fi.
- 4 Press **USB RECORD** repeatedly to select:
  - [RECORD ONE] (record one): the first/current track is recorded.
  - [RECORD ALL] (record all): all tracks/the remaining tracks are recorded.

↳ Disc play starts automatically from the beginning of the disc/ the selected track, and the recording starts.

  - To stop recording, press .



#### Note

- If the USB device does not have enough memory to store the CD track, [MEMORY FULL] (memory full) is displayed.

# 10 Other features

---

## Set the alarm timer

This Micro Hi-Fi can be used as an alarm clock. The DISC, TUNER or USB is activated to play at a preset time.

- 1 Ensure that you have set the clock correctly.
- 2 Press and hold **TIMER**.
- 3 Press **DISC**, **TUN** or **USB** to select a source.
- 4 Press **TIMER** to confirm.  
↳ The hour digits are displayed and begin to blink.
- 5 Press ◀◀/▶▶ to set the hour.
- 6 Press **TIMER** to confirm.  
↳ The minute digits are displayed and begin to blink.
- 7 Press ◀◀/▶▶ to set the minute.
- 8 Press **TIMER** to confirm.  
↳ The timer is set and activated.

---

## Activate and deactivate the alarm timer

- 1 Press **TIMER ON/OFF** repeatedly to activate or deactivate the timer:  
↳ If the timer is activated, the display shows 🕒.  
↳ If the timer is deactivated, 🕒 disappears on the display.



### Note

- In MP3 link mode, the alarm timer cannot be set.
- If disc source is selected and the track cannot be played, tuner is activated automatically.

## Set the sleep timer

This Micro Hi-Fi can switch to standby automatically after a set period of time.

- 1 When the Micro Hi-Fi is turned on, press **SLEEP** repeatedly to select a set period of time (in minutes).

↳ When sleep timer is activated, the display shows **zzz**.

### To deactivate sleep timer

- 1 Press **SLEEP** repeatedly until "0" is displayed.

↳ When sleep timer is deactivated, **zzz** disappears on the display.

---

## Listen to an external device

You can listen to an MP3 player through this Micro Hi-Fi.

- 1 Press **MP3 LINK** to select MP3 link source.

- 2 Use an MP3 link cable (supplied) to connect **MP3 LINK** jack (3.5mm) on this Micro Hi-Fi and the headphone jack on an MP3 player.

---

## Delete files in the USB device

- 1 During USB play, press **◀▶** to select a track.

- 2 Press **USB DELETE**.

↳ A confirmation message is displayed.

- 3 When the above confirmation message is displayed, press **USB DELETE** again to confirm.

- To cancel, press **■**.

↳ After you delete the file, the USB play stops.

# 11 Product information



## Note

- Product information is subject to change without prior notice.

---

## Specifications

---

### Amplifier

---

Rated Output Power	2X5W RMS
Frequency Response	60 - 16kHz, $\pm 3$ dB
Signal to Noise Ratio	>65dB
Aux Input	0.5 V RMS 20kohm

---

### Disc

---

Laser Type	Semiconductor
Disc Diameter	12cm/8cm
Support Disc	CD-DA, CD-R, CD-RW, MP3-CD, WMA-CD
Audio DAC	24Bits / 44.1kHz
Total Harmonic Distortion	<1%
Frequency Response	60Hz -16kHz (44.1kHz)
S/N Ratio	>65dBA

---

## Tuner

Tuning Range	FM: 87.5 - 108MHz; MW: 531 - 1602kHz
Tuning grid	50KHz (FM); 9KHz (MW)
<b>FM</b>	
Sensitivity	
- Mono, 26dB S/N Ratio	<22 dBf
- Stereo, 46dB S/N Ratio	<43 dBf
Search Selectivity	>28dBf
Total Harmonic Distortion	<3%
Signal to Noise Ratio	>55dB

## Speakers

Speaker Impedance	4ohm
Speaker Driver	3.5"woofer+0.8" tweeter
Sensitivity	>82dB/m/W

## General information

AC power	220 - 230V, 50Hz
Operation Power Consumption	20W
Standby Power Consumption	<2W
USB Direct	Version 2.0/1.1
Dimensions	
- Main Unit (W x H x D)	147 x 231 x 209 mm
- Speaker Box (W x H x D)	124 x 233 x 153 mm

---

**Weight**

- With Packing	4.75 kg
- Main Unit	1.95 kg
- Speaker Box	2 x 1.2 kg

---

---

## USB playability information

### Compatible USB devices:

- USB flash memory (USB 2.0 or USB1.1)
- USB flash players (USB 2.0 or USB1.1)
- memory cards (requires an additional card reader to work with this Micro Hi-Fi)

### Supported formats:

- USB or memory file format FAT12, FAT16, FAT32 (sector size: 512 bytes)
- MP3 bit rate (data rate): 32-320 Kbps and variable bit rate
- WMA v9 or earlier
- Directory nesting up to a maximum of 8 levels
- Number of albums/ folders: maximum 99
- Number of tracks/titles: maximum 999
- ID3 tag v2.0 or later
- File name in Unicode UTF8 (maximum length: 128 bytes)

### Unsupported formats:

- Empty albums: an empty album is an album that does not contain MP3/WMA files, and is not be shown in the display.
- Unsupported file formats are skipped. For example, Word documents (.doc) or MP3 files with extension .dlf are ignored and not played.
- AAC, WAV, PCM audio files
- DRM protected WMA files (.wav, .m4a, .m4p, .mp4, .aac)
- WMA files in Lossless format

## Supported MP3 disc formats

- ISO9660, Joliet
  - Maximum title number: 999 (depending on file name length)
  - Maximum album number: 99
  - Supported sampling frequencies: 32 kHz, 44.1kHz, 48 kHz
  - Supported Bit-rates: 32-320 (kbps), variable bit rates
  - ID3 tag v2.0 or later
  - Directory nesting up to a maximum of 8 levels
- 

## Maintenance

### Clean the cabinet

- Use a soft cloth slightly moistened with a mild detergent solution. Do not use a solution containing alcohol, spirits, ammonia or abrasives.

### Clean discs

- When a disc becomes dirty, clean it with a cleaning cloth. Wipe the disc from the centre out.
- Do not use solvents such as benzene, thinner, commercially available cleaners, or antistatic spray intended for analogue records.



### Clean the disc lens

- After prolonged use, dirt or dust may accumulate at the disc lens. To ensure good play quality, clean the disc lens with Philips CD lens cleaner or any commercially available cleaner. Follow the instructions supplied with cleaner.

# 12 Troubleshooting



## Caution

- Never remove the casing of this Micro Hi-Fi.

To keep the warranty valid, never try to repair the system yourself. If you encounter problems when using this Micro Hi-Fi, check the following points before requesting service. If the problem remains unsolved, go to the Philips web site ([www.Philips.com/support](http://www.Philips.com/support)). When you contact Philips, ensure that your Micro Hi-Fi is nearby and the model number and serial number are available.

### No power

- Ensure that the AC power plug of the Micro Hi-Fi is connected properly.
- Ensure that there is power at the AC outlet.
- As a power-saving feature, the Micro Hi-Fi switches to standby automatically 15 minutes after disc/USB play reaches the end and no control is operated.

### No sound or poor sound

- Adjust the volume.
- Disconnect the headphones.
- Check that the speakers are connected correctly.
- Check if the stripped speaker wires are clamped.

### Left and right sound outputs reversed

- Check the speaker connections and location.

### No response from the Micro Hi-Fi

- Disconnect and reconnect the AC power plug, then turn on the system again.

### Remote control does not work

Before pressing any function button, first select the correct source with the remote control instead of the main unit.



- Reduce the distance between the remote control and the Micro Hi-Fi.
- Insert the batteries with its polarities (+/- signs) aligned as indicated.
- Replace the batteries.
- Aim the remote control directly at the sensor on the front of the Micro Hi-Fi.

### **No disc detected**

- Insert a disc.
- Check if the disc is inserted upside down.
- Wait until the moisture condensation at the lens has cleared.
- Replace or clean the disc.
- Use a finalized CD or correct format disc.

### **Cannot display some files in USB device**

- The number of folders or files in the USB device has exceeded a certain limit. This phenomenon is not a malfunction.
- The formats of these files are not supported.

### **USB device not supported**

- The USB device is incompatible with the Micro Hi-Fi. Try another one.

### **Poor radio reception**

- Increase the distance between the Micro Hi-Fi and your TV or VCR.
- Fully extend the FM antenna.

### **Timer does not work**

- Set the clock correctly.
- Switch on the timer.

### **Clock/timer setting erased**

- Power has been interrupted or the power cord has been disconnected.
- Reset the clock/timer.



© 2009 Koninklijke Philips Electronics N.V.

All rights reserved.

load from [www.Somanuals.com](http://www.Somanuals.com). All Manuals Search And Down  
MCM169\_12\_UM\_V2.0\_934



## Free Manuals Download Website

<http://myh66.com>

<http://usermanuals.us>

<http://www.somanuals.com>

<http://www.4manuals.cc>

<http://www.manual-lib.com>

<http://www.404manual.com>

<http://www.luxmanual.com>

<http://aubethermostatmanual.com>

Golf course search by state

<http://golfingnear.com>

Email search by domain

<http://emailbydomain.com>

Auto manuals search

<http://auto.somanuals.com>

TV manuals search

<http://tv.somanuals.com>