

Register your product and get support at  
[www.philips.com/welcome](http://www.philips.com/welcome)

Clock Radio

AJ4200



---

EN User manual

---

1

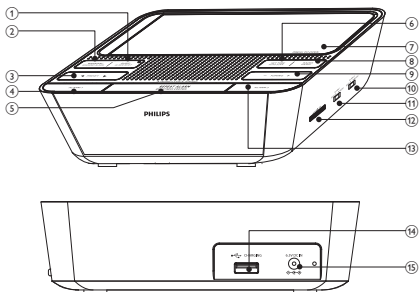

2

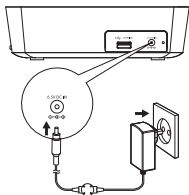

3

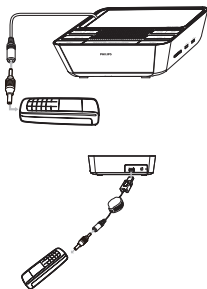

# 1 Important

---

## Safety

- ① Read these instructions.
- ② Keep these instructions.
- ③ Heed all warnings.
- ④ Follow all instructions.
- ⑤ Do not use this apparatus near water.
- ⑥ Clean only with dry cloth.
- ⑦ Do not block any ventilation openings. Install in accordance with the manufacturer's instructions.
- ⑧ Do not install near any heat sources such as radiators, heat registers, stoves, or other apparatus (including amplifiers) that produce heat.
- ⑨ Protect the power cord from being walked on or pinched, particularly at plugs, convenience receptacles, and the point where they exit from the apparatus.
- ⑩ Only use attachments/accessories specified by the manufacturer.
- ⑪ Use only with the cart, stand, tripod, bracket, or table specified by the manufacturer or sold with the apparatus. When a cart is used, use caution when moving the cart/apparatus combination to avoid injury from tip-over.



- ⑫ Unplug this apparatus during lightning storms or when unused for long periods of time.
- ⑬ Refer all servicing to qualified service personnel. Servicing is required when the apparatus has been damaged in any way, such as power-supply cord or plug is damaged, liquid has been spilled or objects have fallen into the apparatus, the apparatus has been exposed to rain or moisture, does not operate normally, or has been dropped.
- ⑭ Apparatus shall not be exposed to dripping or splashing.
- ⑮ Do not place any sources of danger on the apparatus (e.g. liquid filled objects, lighted candles).
- ⑯ This product may contain lead and mercury. Disposal of these materials may be regulated due to environmental considerations. For disposal or recycling information, please contact your local authorities or the Electronic Industries Alliance: [www.eiae.org](http://www.eiae.org).
- ⑰ Where the plug is used as the disconnect device, the disconnect device shall remain readily operable.

### **!** Warning

- Never remove the casing of this apparatus.
- Never lubricate any part of this apparatus.
- Never place this apparatus on other electrical equipment.
- Keep this apparatus away from direct sunlight, naked flames or heat.
- Ensure that you always have easy access to the power cord, plug or adaptor to disconnect the apparatus from the power.

---

## Notice



This product complies with the radio interference requirements of the European Community.

This product complies with the requirements of the following directives and guidelines: 2004/108/EC + 2006/95/EC

Any changes or modifications made to this device that are not expressly approved by Philips Consumer Lifestyle may void the user's authority to operate the equipment.

---

## Recycling

Your product is designed and manufactured with high quality materials and components, which can be recycled and reused.



When you see the crossed-out wheel bin symbol attached to a product, it means the product is covered by the European Directive 2002/96/EC:



Never dispose of your product with other household waste. Please inform yourself about the local rules on the separate collection of electrical and electronic products. The correct disposal of your old product helps prevent potentially negative consequences on the environment and human health.

### Environmental information

All unnecessary packaging has been omitted. We have tried to make the packaging easy to separate into three materials: cardboard (box), polystyrene foam (buffer) and polyethylene (bags, protective foam sheet.)

Your system consists of materials which can be recycled and reused if disassembled by a specialized company. Please observe the local regulations regarding the disposal of packaging materials, exhausted batteries and old equipment.

 **Note**

- The type plate is located on the bottom of the apparatus.

## 2 Your clock radio

Congratulations on your purchase, and welcome to Philips! To fully benefit from the support that Philips offers, register your product at [www.philips.com/welcome](http://www.philips.com/welcome).

---

### Introduction

With this clock radio with mobile phone charger, you can:

- enjoy the FM radio
  - know the time
  - wake up to favourite radio tone
  - set two alarms to ring at different time
  - charge a mobile phone of major brands.
- 

### What's in the box

Check and identify the contents of your package:

- Main unit
  - AC power adapter
  - User manual
  - Quick start guide
  - Compatibility sheet
- 

### Overview of the main unit (See 1)

#### ① SLEEP/ALARM RESET

- Set sleep timer.
- Reset alarm setting.

#### ② WEEKDAY/WEEKEND ALARM

- Switch between weekday alarm and weekend alarm.

- ③ ◀ **PRESET** ▶
  - Select a preset radio station.
- ④ **ALARM 1**
  - Set the alarm timer.
  - View the alarm time.
  - Turn on/off the alarm.
- ⑤ **REPEAT ALARM/BRIGHTNESS CONTROL**
  - Repeat the alarm.
  - Adjust the display brightness.
- ⑥ **SET TIME/AUTO SCAN**
  - Set the time and date.
  - Scan radio stations.
- ⑦ **PRESS TO OPEN**
  - Press to open the compartment.
- ⑧ **RADIO ON/OFF**
  - Switch radio on or off.
- ⑨ **TUNING+/-**
  - Tune to a radio station.
  - Adjust time and date.
  - Select time format.
- ⑩ **ALARM 2 BUZZ/RADIO**
  - Select alarm tone for alarm 2.
- ⑪ **ALARM 1 BUZZ/RADIO**
  - Select alarm tone for alarm 1.



- ⑫ **VOL**
  - Adjust volume.
  
- ⑬ **ALARM 2**
  - Set the alarm timer.
  - View the alarm time.
  - Turn on/off the alarm.
  
- ⑭ **USB charging socket**
  
- ⑮ **DC IN jack**

## 3 Get started

### Tip

- Use of controls or adjustments or performance of procedures other than herein may result in hazardous radiation exposure or other unsafe operation.

Always follow the instructions in this chapter in sequence. If you contact Philips, you will be asked for the model and serial number of this apparatus. The model number and serial number are on the bottom of the apparatus. Write the numbers here:

Model No. \_\_\_\_\_

Serial No. \_\_\_\_\_

---

## Connect power (See 2)

### Caution

- Risk of product damage! Ensure that the power supply voltage corresponds to the voltage printed on the back or the underside of the apparatus.
- Risk of electric shock! When you unplug the AC power cord, always pull the plug from the socket. Never pull the cord.
- Before connecting the AC power cord, ensure you have completed all other connections.

1 Connect the power adapter to

- the **DC IN** jack on the rear of the main unit
- the power socket.

---

## Adjust the volume level

- 1 Turn **VOL** to increase/decrease the volume level.
- 

## Adjust display brightness

- 1 Press **REPEAT ALARM/BRIGHTNESS CONTROL** repeatedly to select different brightness levels of the display.
- 

## Set time and date

- 1 Press **RADIO ON/OFF** repeatedly to turn off radio.
- 2 Press and hold **SET TIME/AUTO SCAN** for 2 seconds.  
↳ Year digits begin to blink.
- 3 Press **TUNING+/-** to set year.
- 4 Press **SET TIME/AUTO SCAN** to confirm.
- 5 Repeat steps 3-4 to set the month.
- 6 Repeat steps 3-4 to set the date.
- 7 Repeat steps 3-4 to set the hour.
- 8 Repeat steps 3-4 to set minute.  
↳ Time format begins to blink.
- 9 Repeat steps 3-4 to select 12 hour or 24 hour format.

## 4 Listen to radio

---

### Tune to a radio station

- 1 Press **RADIO ON/OFF** repeatedly to turn on radio.
  - 2 Press **TUNING+/-** repeatedly to tune to a radio station.
- 

### Program radio stations automatically

#### **Note**

- You can program a maximum of 20 preset radio stations
- 1 Press **RADIO ON/OFF** repeatedly to turn on radio.
  - 2 Press and hold **SET TIME/AUTO SCAN** for 2 seconds.
    - ↳ All available stations are programmed in the order of waveband reception strength.
    - ↳ The first programed radio station broadcasts automatically.
    - ↳ To interrupt scan, press **SET TIME/AUTO SCAN**.
- 

### Program radio stations manually

#### **Note**

- You can program a maximum of 20 preset radio stations.
- 1 Press **RADIO ON/OFF** repeatedly to turn on radio.
  - 2 Press **TUNING+/-** repeatedly to tune to a radio station.
  - 3 Press and hold **◀ PRESET ▶** for 2 seconds.
    - ↳ "CH" begins to blink.
  - 4 Press **◀ PRESET ▶** repeatedly to select a preset number.
  - 5 Press and hold **◀ PRESET ▶** for 2 seconds to confirm.
  - 6 Repeat steps 2-5 to program more stations.

## **Tip**

- To overwrite a programmed station, program another station in its place.
- 

## Select a preset radio station

- 1 Press **RADIO ON/OFF** repeatedly to turn on radio.
- 2 Press **◀ PRESET ▶** to select a radio station.

## 5 Set the alarm timer

You can set two separate alarms. For the alarm tone, you can select the FM radio, or the buzzer.

- 1 Before you start, ensure that the time is set correctly.
- 2 Press and hold **ALARM 1/ALARM 2** for two seconds.  
↳ **AL1** or **AL2** is displayed and the hour digits and days begin to blink.
- 3 Switch **ALARM 1 BUZZ/RADIO** or **ALARM 2 BUZZ/RADIO** to buzz or radio to select alarm sound for alarm 1 and 2 respectively.
- 4 Press **TUNING+/-** repeatedly to set the hour.  
↳  appears and **AL1** or **AL2** begins to blink.
- 5 Press **ALARM 1/ALARM 2** to confirm.  
↳ The minute digits begin to blink.
- 6 Press **TUNING+/-** to set the minute.
- 7 Press **ALARM 1/ALARM 2** to confirm.  
↳ The weekdays begin to blink.
- 8 Press **WEEKDAY/WEEKEND ALARM** to select whether to ring alarm on weekdays or at weekend.
- 9 Press **ALARM 1/ALARM 2** to confirm.  
↳  **AL1** or  **AL2** is displayed.  
↳ The apparatus turns on automatically at the set time and rings with radio or buzz.

---

### Turn on/off the alarm timer

#### Note

- Ensure that you already set the alarms successfully.

- 1 Press **ALARM 1** or **ALARM 2** repeatedly to turn on or off the alarm timer:
    - ↳ If the alarm timer is turned on, **AL1** or **AL2** appears.
    - ↳ If the alarm timer is turned off, **AL1** or **AL2** disappears.
- 

## Repeat alarm

- 1 When the alarm rings, press **REPEAT ALARM/BRIGHTNESS CONTROL**.
  - ↳ The alarm repeats ringing minutes later.

### Tip

- You can press **TUNING+/-** to adjust interval (5-15 minutes) to repeat alarm.
- 

## Reset alarm

- 1 When the alarm rings, press **SLEEP/ALARM RESET**.
    - ↳ The alarm stops but the alarm settings remain.
- 

## Stop alarm ring

- 1 When the alarm rings, press the corresponding **ALARM 1** or **ALARM 2**.
    - ↳ The alarm stops but the alarm settings remain.
- 

## View the alarm settings

- 1 Press **ALARM 1** or **ALARM 2** to view the alarming setting time.
  - ↳ [**AL1**] or [**AL2**] appears.

## 6 Other features

---

### Set the sleep timer

You can set the clock radio to turn off automatically after a certain period of time.

- 1 Press **SLEEP/ALARM RESET** repeatedly to select time (in minutes).
  - ↳ The apparatus turns off automatically after the set period of time.

**To turn off the sleep timer:**

- 1 Press **SLEEP/ALARM RESET** repeatedly until **[OFF]** (off) appears or press **RADIO ON/OFF**.
  - ↳ **zzZ** is displayed when sleep timer is on and disappears when it is off.

---

### Charge a mobile phone (See 3)

#### **Note**

- The accompanied charging adapters do not support all types of mobile phones. Refer to the appended compatibility sheet to see if your phone is supported.

- 1 Press **PRESS TO OPEN** to open the compartment.
- 2 Select a charger adapter that matches your mobile phone.
- 3 Take out the cable with a connector.
- 4 Connect the charger adapter to .
  - the connector or the USB charging cable (not supplied)
  - your mobile phone.

After charging finishes,

- 1 Disconnect the device from the charge adapter.



- 2 Disconnect the charger adapter and save it in the compartment.  
(See 3)

## 7 Product information

### Tip

- Product information is subject to change without prior notice.

---

## Specifications

---

### Tuner (FM)

---

Tuning Range	87.5 - 108MHz
Tuning grid	50KHz
Sensitivity - Mono, 26dB S/N Ratio	<22 dBf
Search Selectivity	>28dBf
Total Harmonic Distortion	<3%
Signal to Noise Ratio	>50dB

---

---

## General information

---

Power adapter	Model: AS150-065-AN Philips Input: 100-240V~50/60 Hz, 0.7A Output: 6.5V DC, 2.3A
---------------	-------------------------------------------------------------------------------------------

---

Operation Power Consumption	20W
-----------------------------	-----

---

Standby Power Consumption	0.5W
---------------------------	------

---

### Dimensions

- Main Unit (W x H x D)	180 x 50 x 133 mm
-------------------------	-------------------

---

### Weight

- With Packing	0.725 kg
- Main Unit	0.435 kg

---

# 8 Troubleshooting

## **Caution**

- Never remove the casing of this apparatus.

To keep the warranty valid, never try to repair the system yourself. If you encounter problems when using this apparatus, check the following points before requesting service. If the problem remains unsolved, go to the Philips web site ([www.philips.com/support](http://www.philips.com/support)). When you contact Philips, ensure that your apparatus is nearby and the model number and serial number are available.

### **No power**

- Ensure that the AC power plug of the apparatus is connected properly.
- Ensure that there is power at the AC outlet.

### **No sound**

- Adjust the volume.

### **No response from the apparatus**

- Disconnect and reconnect the AC power plug, then turn on the apparatus again.
- Use a ball pen to press the reset button on the rear of the apparatus to restore factory settings. This operation resets all settings except the clock.

### **Poor radio reception**

- Increase the distance between the apparatus and your TV or VCR.
- Fully extend the antenna.
- Connect an outdoor antenna instead.

### **Timer does not work**

- Set the clock correctly.

### **Clock/timer setting erased**

- Power has been interrupted or the power plug has been disconnected.
- Reset the clock/timer.

### **Charger does not charge the connected device**

- Make sure the USB cable is properly inserted into the device and the charger.
- Make sure the adapter suits the connected device well.
- Damaged USB cable or connector tip. Replace USB cable and/or connector tip.
- Wrong connector tip used. Check connector tip and replace if necessary.
- Non supplied USB cable/connector tip used. Replace with supplied USB cable/connector tip.
- Problems with electrical circuit of the apparatus. Take the apparatus to your local distributor.

# AUSTRALIA - Philips Manufacturers Warranty for Australia only

These warranty conditions are valid for the following consumer electronics products: Colour Televisions, Projection TV, Plasma & LCD TV, Video Cassette Recorders, CD Recorders & Players, DVD Players, DVD Recorders, DVD Recorders with HDD, Audio Systems, Home Theatre systems, Digital Set Top Box & Portable Audio products.

The benefits given to the purchaser by this warranty are in addition to all other rights and remedies which the purchaser has in respect of the product under the Trade Practices Act or other Commonwealth or State Law.

Philips Consumer Electronics warrants its products to the purchaser as follows and subject to the stated conditions.

## 1 Year Free Repair Service - at Philips ASC

Colour Television, Plasma Television, LCD Television, Projection Television, DVDR/VCR Combo, DVD Recorders with Hard Drive, LCD Projectors, Wireless Audio Systems, Audio Systems, Home Theatre Systems & Digital Set-Top-Box.

## 1 Year free Replacement - at your Retailer

Portable Audio, MP3 Infotainment products, Video Cassette recorders, DVD Player, DVD/VCR Combo Player, DVD Recorder without HDD & Portable DVD/LCD players.

## Conditions of Repair Warranty

1. All claims for warranty service should be made to your nearest Philips Authorised Service Centre or the Philips Technology Care Centre. Reasonable evidence of date of purchase must be provided.
2. This warranty extends only to defects in material or workmanship occurring under normal use of the product when operated in accordance with the instructions.
3. If a replacement product is supplied under the repair policy it is warranted, under this warranty, for the remainder of the warranty of the original purchased product only.
4. Home service is provided only within the normal service area of one of our recommended Authorised Service Centres (ASC). It will be provided for television receivers only with a screen side of 67cms or above (product includes CRT, LCD TV, PTV, and Plasma TV). Televisions with screen side less than 67cms and all other products types are to be taken or sent by the consumer to the workshop of your nearest Authorised Service Centre, at the Consumer's expense.
5. This Manufacturers Warranty is limited to 3 months for the above listed Consumer Electronics products if used in commercial applications.
6. Philips may, at its discretion choose to replace rather than repair any product covered by this warranty.
7. Product accessories are covered by the same warranty period. Please contact the Philips Technology

Care Centre for free replacement of faulty accessories.

8. This Manufacturers Warranty is neither transferable nor valid in countries other than Australia.

## This warranty does not cover:

- a) Mileage or travel outside the normal service area covered by selected Authorised Service Centre.
- b) Service costs arising from failure to correctly adjust the controls of the product or to observe the instructions, or inspections that reveal that the product is in normal working order.
- c) Product failures caused by misuse, neglect, accidental breakage, transit damage, inexpert repairs or modification by un-authorised persons, external fires, lightning strikes, floods, vermin infestation or liquid spillage.
- d) Cleaning of video or audio heads.
- e) Inadequate receiving antennae.
- f) Replacement of worn or used batteries or other consumables.
- g) Consumer products used in commercial applications (This warranty is limited to 3 months only).
- h) Second hand products.

**The conditions contained in this warranty card replace and override the provision of the Philips World-Wide Guarantee for products purchased in Australia and used in Australia.**

Service is provided through more than 100 accredited Authorised Service Centres throughout Australia. For direct contact with the nearest recommended Authorised Service Centre in capital & regional cities/towns

## Authorised Service Centre Network

**1300 361 392**

Customer support is provided in Australia by our trained call centre staff. For assistance with product features and specifications, please call

## Technology Care Centre

**1300 363 391**

**Please record the following information for your records and keep in a safe place. We recommend retaining your purchase receipt to assist with any warranty claim.**

Model number:.....

Serial number:.....

Date of purchase:.....

Retailer:.....

## **Philips Consumer Electronics**

a division of **Philips Electronics Australia Limited**  
ABN 24 008 445 743,  
Level 1, 65 Epping Road NORTH RYDE NSW 2113.

## **NEW ZEALAND - Guarantee and Service for New Zealand**

---

Thank-you for purchasing this quality Philips product.

Philips New Zealand Ltd guarantees this product against defective components and faulty workmanship for a period of 12 months. Any defect in materials or workmanship occurring within 12 months from the date of purchase subject to the following conditions will be rectified free of charge by the retailer from whom this product was purchased.

### **Conditions**

1. The product must have been purchased in New Zealand. As proof of purchase, retain the original sales docket indicating the date of purchase.
2. The guarantee applies only to faults caused by defective components, or faulty workmanship on the part of the manufacturer.
3. The guarantee does not cover failures caused by misuse, neglect, normal wear and tear, accidental breakage, use on the incorrect voltage, use contrary to operating instructions, or unauthorised modification to the product or repair by an unauthorised technician.
4. Reasonable evidence (in the form of a sales docket) must be supplied to indicate that the product was purchased no more than 12 months prior to the date of your claim.
5. In the event of a failure, Philips shall be under no liability for any injury, or any loss or damage caused to property or products other than the product under guarantee.

This guarantee does not prejudice your rights under common law and statute, and is in addition to the normal responsibilities of the retailer and Philips.

### **How to claim**

Should your Philips product fail within the guarantee period, please return it to the retailer from whom it was purchased. In most cases the retailer will be able to satisfactorily repair or replace the product.

However, should the retailer not be able to conclude the matter satisfactorily, or if you have other difficulties claiming under this guarantee, please contact

**The Guarantee Controller**  
**Philips New Zealand Ltd.**

✉ P.O. Box 41.021

**Auckland**

☎ (09) 84 94 160

fax ☎ (09) 84 97 858



© Royal Philips Electronics N.V. 2009  
All rights reserved.

Specifications are subject to change  
without notice. Trademarks are the  
property of Koninklijke Philips Electronics  
N.V. or their respective owners.



100% recycled paper

100% paper recycled



## Free Manuals Download Website

<http://myh66.com>

<http://usermanuals.us>

<http://www.somanuals.com>

<http://www.4manuals.cc>

<http://www.manual-lib.com>

<http://www.404manual.com>

<http://www.luxmanual.com>

<http://aubethermostatmanual.com>

Golf course search by state

<http://golfingnear.com>

Email search by domain

<http://emailbydomain.com>

Auto manuals search

<http://auto.somanuals.com>

TV manuals search

<http://tv.somanuals.com>