

Philips
PhotoFrame

7" LCD display

7FF1AW



Every picture tells your story

How many digital pictures are hidden on your PC? See, share and relive your memories with Philips PhotoFrame™, the easiest way to display your digital photos in print quality - without a PC.

High quality, print-like picture display

- High pixel density for sharp and detailed photo display
- Full color display to show photos in print-like quality
- Adjustable brightness to match ambient light conditions

Easily display your digital photos

- View photos directly from memory cards - no PC required
- Create a slideshow for all stored photos
- Play slideshows, single photo, thumbnails or show clock
- Smart storage allows more photos to be stored
- Read photos from cameras or download them from your PC

Great convenience

- Automatically turn on and off display at preset times daily
- Simple, intuitive operation - no programming needed
- Your choice of landscape or portrait display
- Operate on AC power or cordlessly with rechargeable battery



reddot design award
winner 2006

PHILIPS
sense and simplicity

Specifications

Picture/Display

- Effective viewing area: 137 x 91 mm
- Dot Pitch (horizontal): 0.1905 mm
- Dot Pitch (vertical): 0.1905 mm
- Resolution: 720 x 480 pixels
- Viewing angle: @ C/R > 5
- Viewing angle (H / V): 170 / 170 degree
- Lifetime, to 50% brightness: 20000 hr

Connectivity

- USB: To digital camera, To PC

Storage Media

- Memory Card Types: Compact Flash type I, Memory Stick, Memory Stick Pro, Multimedia Card, Secure Digital (SD)

Convenience

- Card Reader: Built-in (1x)
- Photo format supported: JPEG photo (in DCF structure), Up to 12 Megapixels
- Photo storage size: 50 photos or more
- Placement supported: Landscape, Portrait
- Buttons and controls: 6 buttons
- Playback mode: Full screen browse, Slideshow, Thumbnail browse
- Setup function: Brightness adjustment, Language, Slideshow, Status, Auto on/off daily

- Photo edit: Copy, Delete, Rotate, Show in slideshow
- Plug & Play Compatibility: Windows 2000/XP or later, Mac OS X, Linux
- Regulatory Approvals: BSMI, C-Tick, CCC, CE, FCC, GOST, PSB, UL, VCCI

Accessories

- Included Accessories: AC-DC Adapter, Quick start guide, Stand, USB cable
- User Guide on CD-ROM

Dimensions

- Set dimensions with stand (W x H x D): 212 x 164 x 105 mm
- Weight: 0.73 kg
- Temperature range (operation): 0°C to 45°C
- Temperature range (storage): -20°C to 60°C

Power

- Power consumption: (System on and battery charging) 12 W
- Operating time on battery: 0.8 hr
- Battery LED indicator: Charging - Amber, Not charging - Off
- Power LED indicator: Operation - green
- Power mode supported: AC powered, Battery powered



Highlights

High pixel density display

The very best high density screen in the industry displays 88 percent more pixels per square inch than even a high end 17-inch LCD monitor -- showing off your treasured photos with the same 'real life' rich detail and vibrant colors as high quality prints.

Adjustable brightness

Adjustable display brightness delivers a better viewing experience by giving you the ability to match display brightness to ambient lighting conditions regardless of whether you're viewing treasured photos in daylight or at night.

Memory card slots

Two memory card readers are built-in for easy viewing and sharing of photos stored in memory cards. One memory card slot accepts Compact Flash I (CF) cards while the second accommodates Memory Stick (MS), SD Card and Multi Media Cards (MMC).

Multiple viewing modes

Flexible display modes give you the freedom to display your photos one image at a time, in thumbnail mode for quick, easy searches, or to create a slideshow of your most treasured photos.

Intelligent photo storage

Intelligent photo storage employs smart software that minimizes required storage space without compromising photo display quality.

USB port

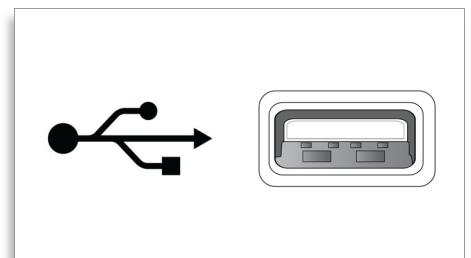

A USB connector built into the device, for easy and quick reading or downloading photos from most cameras or PCs. Please visit Philips web site to check your camera's compatibility with Philips Digital Photo Display.



Issue date 2009-05-07

Version: 7.0.12

12 NC: 8639 000 16479
EAN: 87 10895 91206 8

© 2009 Koninklijke Philips Electronics N.V.
All Rights reserved.

Specifications are subject to change without notice.
Trademarks are the property of Koninklijke Philips Electronics N.V. or their respective owners.

www.philips.com

Free Manuals Download Website

<http://myh66.com>

<http://usermanuals.us>

<http://www.somanuals.com>

<http://www.4manuals.cc>

<http://www.manual-lib.com>

<http://www.404manual.com>

<http://www.luxmanual.com>

<http://aubethermostatmanual.com>

Golf course search by state

<http://golfingnear.com>

Email search by domain

<http://emailbydomain.com>

Auto manuals search

<http://auto.somanuals.com>

TV manuals search

<http://tv.somanuals.com>