

PHILIPS

NORELCO

SensoTouch**3D**



(Model 1290X Shown)

1290X
1280X
1280XCC
1260X
1250X
1250XCC

**Rechargeable Cordless
Tripleheader Razor**

Register your product and get support at

www.philips.com/norelco Manuals Search And Download.

I290X/I280X/I280XCC/I260X/I250X/I250XCC

ENGLISH 4

Congratulations on your purchase and welcome to Philips Norelco!

To fully benefit from the support that Philips Norelco offers, register your product at www.philips.com/norelco

IMPORTANT SAFETY INSTRUCTIONS

When using an electric appliance, basic precautions should always be followed, including the following:

Read all instructions before using this appliance.

DANGER

To reduce the risk of electric shock:

1. Do not reach for a corded Jet Clean System/charging stand that has fallen into water. Unplug immediately.
2. Charging stand is not for immersion or for use in shower.
3. Do not use an extension cord with this appliance.
4. Do not place or store a Jet Clean System/charging stand where it can fall or be pulled into a tub or sink. Do not place or drop a Jet Clean System/charging stand into water or other liquid.
5. Always unplug this Jet Clean System/charging stand from the electrical outlet immediately after use, except when razor is (re)charging.
6. Unplug and remove power supply cord from Jet Clean System/charging stand before cleaning.

WARNING

To reduce the risk of burns, fire, electric shock, or injury to persons:

1. Close supervision is necessary when this razor/Jet Clean System/charging stand is used by, on, or near children or invalids.
2. Use this razor/Jet Clean System/charging stand for its intended household use as described in this manual. Do not use attachments or a cleaning solution not recommended by Philips Electronics North America Corporation.
3. Never operate this razor/Jet Clean System/charging stand if it has a damaged cord or charging plug, if it is not working properly, if it has been dropped or damaged, or dropped into

- water while plugged in. For assistance call 1-800-243-3050.
4. Keep the razor, Jet Clean System, charging stand, cord and charging plug away from heated surfaces.
 5. Never drop or insert any object into any opening.
 6. Do not clean, charge or plug in razor/Jet Clean System outdoors or operate where aerosol (spray) products are being used or where oxygen is being administered.
 7. Do not use this razor with a damaged or broken comb, as facial injury may occur.
 8. Always put razor in Jet Clean System/charging stand first, attach cord to Jet Clean System/charging stand, then plug into outlet. Be certain plug is inserted firmly into Jet Clean System/charging stand, up to mark indicated on plug. To disconnect, turn Jet Clean System/charging stand off then remove charging plug from outlet.
 9. Never put the razor/Jet Clean System/charging stand in direct sunlight or store at a temperature above 140°F.
 10. Keep the Jet Clean System, charging stand and cord dry at all times. Do not handle with wet hands. Do not store in a damp environment.
 11. To prevent possible damage to the cord, do not wrap cord around the razor or Jet Clean System/charging stand.

SAVE THESE INSTRUCTIONS

IMPORTANT: The power plug contains a transformer. Do not cut off the power plug to replace it with another plug, as this will cause a hazardous condition.

- Only use power plug supplied with the razor.
- Only use Jet Clean System supplied with the razor.

PHILIPS



45 - DAY MONEY-BACK GUARANTEE

To enjoy the closest and most comfortable shave from your new Philips Norelco Men's Razor, the razor should be used exclusively for 3 weeks. This allows your hair and skin enough time to adapt to the Philips Norelco Shaving System. If, after that period of time, you are not fully satisfied with your Philips Norelco Men's Razor, send the product back along with dated sales receipt and we'll refund you the full purchase price. **The razor must be shipped prepaid by insured mail, insurance prepaid, and have the original sales receipt, indicating purchase price and the date of purchase, enclosed. We cannot be responsible for lost mail.** The razor must be postmarked no later than 45 days from the date of purchase. Philips Norelco reserves the right to verify the purchase price of the razor and limit refunds not to exceed suggested retail price.

To obtain money-back guarantee return authorization form, call 1-800-243-3050 for assistance. Please allow 4-6 weeks for delivery of check.

Table of Contents

| | |
|--|-------|
| Features..... | 8-11 |
| Multi-Level Display | 12-16 |
| Charge Meter | 16 |
| Before First Use..... | 16-17 |
| Charging..... | 17-20 |
| Recharging | 20 |
| Quick Charge | 20 |
| Put It To The Test & Shaving Tips..... | 21 |
| How to Shave With An Electric Razor | 21-23 |
| Trimming | 23-24 |
| Travel Lock | 24-25 |
| Cleaning..... | 25-37 |
| Replacing the Shaving Unit..... | 38 |
| Maintenance | 38-39 |
| Storage..... | 39 |
| Assistance | 40 |
| Battery Removal | 40-41 |
| Accessories | 41 |
| Warranty..... | 43 |

Features

GyroFlex 3D Contour-Following System

Shaving Unit

- Hair Chamber captures shaven hair

SkinGlide System

Protective Razor Head Cap

Electronic On/Off Button

Multi-Level Display

- Shows remaining power level in batteries (1260X/1250X/1250XCC) or actual remaining shaving minutes (1290X/1280X/1280XCC)
- Battery Charge, Full & Low Indicators

Cleaning Indicator

Blocked Shaving Heads Indicator

Replacement Shaving Unit Indicator

Travel Lock

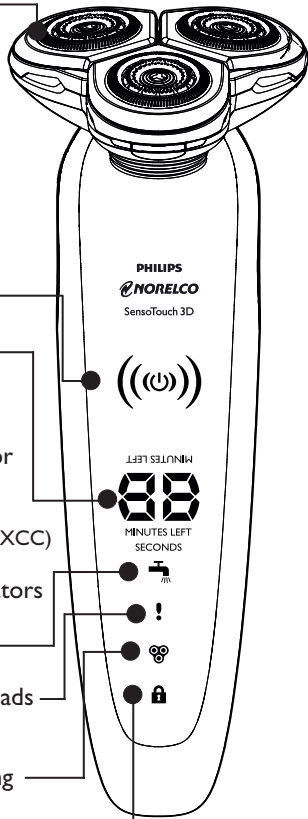

Model 1290X
Model 1280X
Model 1280XCC



Model 1260X

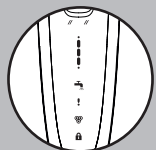

Model 1250X
Model 1250XCC

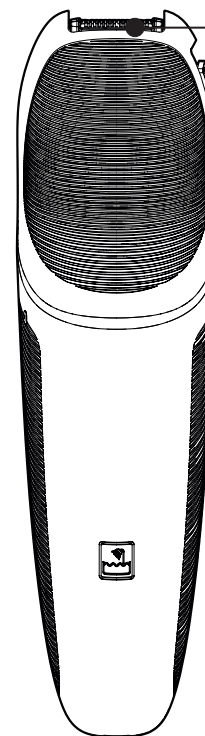

Precision Trimmer

Automatic Worldwide Voltage 100V to 240V AC

Cleaning Brush

Storage Pouch

Charging Stand

Rechargeable 1-hour Full Charge for up to 60 min. (1290X/1280X/1280XCC/1260X) or 50 min. (1250X/1250XCC)

Quick Charge

Cordless - To shave without a cord

Full 2-Year Warranty

45-Day Money-Back Guarantee

Smooth: UltraTrack heads catch every hair with just a few strokes

3 specialized shaving tracks:

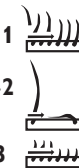

1 Slots for normal hairs

2 Channels for long hairs

3 Holes for short stubbles

Features

Jet Clean System
(1280XCC/1250XCC)

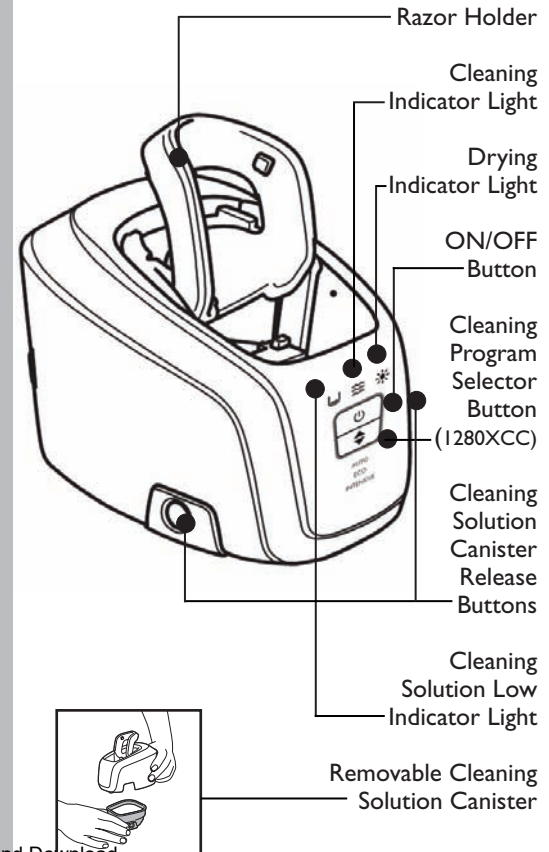

Multi-Level Display

- ▶ Remove any sticker or protective foil from the display before using razor.
- ▶ Depending on the razor model, there are 3 different types of displays:

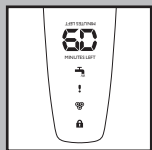

Display for Models I290X, I280X and I280XCC

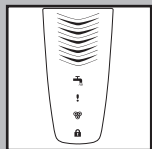

Display for Model I260X

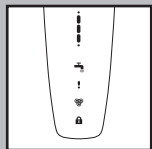

Display for Models I250X and I250XCC

The display provides the following information:

▶ Charging Indicator Models I290X, I280X and I280XCC

-As soon as you connect the power cord to an electrical outlet, the display goes on and the minutes indication will start blinking. The display shows an increase in shaving minutes from 0 to 60.

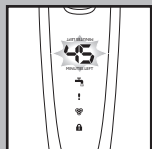

-Quick charge: When the razor contains enough energy for one shave, the display shows 5 minutes in white.

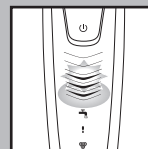

Models I260X, I250X and I250XCC

-As soon as you connect the power cord to an electrical outlet, the bottom charging light blinks, then the second charging light, and so on.
-Quick charge: When the razor contains enough energy for one shave, the bottom charging light blinks white.

NOTE: The displays of models I260X, I250X and I250XCC look different, but work the same way.

▶ Full Charge Indicator Models I290X, I280X and I280XCC

-When the battery has been fully charged, the minutes indication lights up continuously. After approximately 30 minutes the display automatically switches off again.

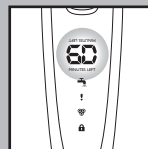

Models I260X, I250X and I250XCC

-When the battery has been fully charged, all charging lights light up continuously. After approximately 30 minutes the display automatically switches off again.

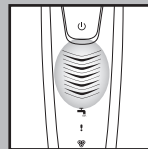

NOTE: The displays of models I260X, I250X and I250XCC look different, but work the same way.



► Remaining Battery Capacity

Models 1290X, 1280X and 1280XCC

-The remaining battery capacity is indicated by the number of shaving minutes shown on the display.

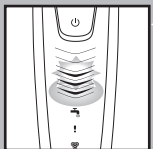

Models 1260X, 1250X and 1250XCC

-The remaining battery capacity is indicated by the blinking charging lights.

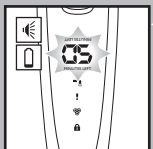

► Low Battery Indicator

Models 1290X, 1280X and 1280XCC

-When the battery is almost empty (5 or less shaving minutes left), the minutes indication blinks. When you turn the razor OFF the minutes indication continues to blink for a few seconds. You will hear a beep when there are no minutes left.

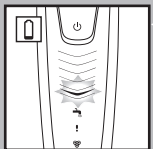

Models 1260X, 1250X and 1250XCC

-When the battery is almost empty (5 or less shaving minutes left), the bottom charging light blinks orange. When you turn the razor OFF the bottom charging light continues to blink orange for a few seconds.

NOTE: The displays of models 1260X, 1250X and 1250XCC look different, but work the same way.



► Replacement Shaving Unit Indicator

Every year, depending on your shaving behavior, after turning the razor OFF, the replacement

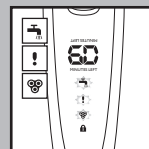

► Blocked Shaving Heads Indicator

If the display shows a blinking replacement shaving unit symbol and faucet symbol with exclamation mark, clean the razor thoroughly before continuing to shave (see 'Cleaning'). After cleaning, if the blinking replacement shaving unit symbol and faucet symbol with exclamation mark remain on the display, immediately replace the shaving unit (see 'Replacing the Shaving Unit').

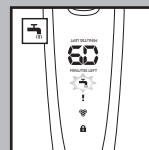

► Cleaning Indicator

For optimal shaving performance, we recommend cleaning the razor after EACH use. The blinking faucet symbol will remind you the shaving unit needs to be cleaned. This happens after each shave.

NOTE: The displays of models 1290X, 1280X, 1280XCC, 1260X, 1250X and 1250XCC look different, but work the same way.

► Power-saving mode (1290X only)

The razor is equipped with an automatic power-saving mode. When the razor enters the power-saving mode, the light in the on/off button goes out to save energy.

-This will occur when the appliance is moved for 5 minutes without switching it on. The razor will automatically go into power-saving mode.



- ▶ The lock symbol blinks on the display to indicate the appliance is in power-saving mode.

-To deactivate the power-saving mode, simply press the on/off button.

Charge Meter

- ▶ Charge Meter monitors amount of remaining battery power (Models I260X, I250X and I250XCC) and actual shaving 'minutes left' (Models I290X, I280X and I280XCC). 'Minutes left' or remaining battery capacity is based on the amount of power consumed shaving per minute and is dependent upon your skin and beard type, whether you use pre-shave lotion, and how often the trimmer is used.
- ▶ Initially your razor may need to go through 2 or 3 full charge/recharge cycles before 'minutes left' (Models I290X, I280X and I280XCC) or remaining battery capacity indicators (Models I260X, I250X and I250XCC) begins to display your accurate shaving minutes or battery power left.

Before First Use

- ▶ Charge the razor before you start using it (see 'Charging'). Make sure the razor is

- switched off before you start charging it.
- ▶ Remove any sticker or protective foil from the Display before using razor.

Important

- ▶ Only use the power cord and charging stand or Jet Clean System (models I280XCC and I250XCC only) provided to charge the razor.
- ▶ The power plug transforms 100-240V AC to less than 24V DC.

Travel Lock (I280X, I280XCC, I260X, I250X and I250XCC)

The razor is equipped with a travel lock function. You can use the travel lock function when you are going to store the razor for a longer period or if you are going to take the razor with you when traveling. See 'Travel Lock' section for instructions on how to use this function.

Charging

- ▶ Charging, recharging or storing at temperatures below 40°F or higher than 95°F adversely affects lifetime of batteries.
- ▶ Always unplug this charging stand/Jet Clean System from the electrical outlet immediately after use, except when razor is (re)charging. You can store the razor in the charging stand or Jet Clean System.

- ▶ Charging or recharging requires one full hour.
- ▶ A fully charged razor has a shaving time of up to 60 minutes (models I290X, I280X, I280XCC and I260X) or 50 minutes (models I250X and I250XCC).
- ▶ You may recharge when the minutes indication blinks (models I290X, I280X and I280XCC) or the bottom charging light blinks orange (models I260X, I250X and I250XCC).
- ▶ Do not charge razor in a pouch.

Charging in the Charging Stand

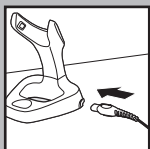

- 1** Connect the small plug of cord to charging stand. Connect the power plug into any 100V to 240V AC outlet. Use only the power cord provided.

- ▶ An adaptor plug may be necessary for power cord usage in some foreign countries. Use an attachment plug adaptor of the proper configuration for the power outlet.

The power cord will automatically convert to work on 100V to 240V AC systems.



- 2** Place razor in stand in an upright position. Press the razor tightly into the holder making sure the charging contacts on each side of the razor fit into the holder.

- 3** The display on the razor will indicate razor is charging.
- 4** Charging requires one full hour. A fully charged razor has a cordless shaving time of up to 60 minutes (models I290X, I280X, I280XCC and I260X) or 50 minutes (models I250X and I250XCC).

Charging Razor with Jet Clean System (I280XCC and I250XCC)

- 1** Connect the small plug to the Jet Clean System. Connect the charging plug into any 100V to 240V AC outlet. Use only the charging plug provided.

The razor holder automatically moves up to the highest position.

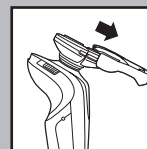

- 2** Remove protective razor head cap from razor.

NOTE: The razor cannot be placed in the Jet Clean System when the protective razor head cap is placed on the razor.

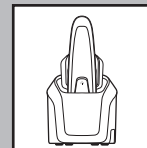

- 3** Place the razor head side down in the razor holder with the display facing the front of the Jet Clean System.

NOTE: The minutes indication (model I280XCC) and charging lights (model I250XCC) on the display will turn upside down so you can see what level the battery is charged.

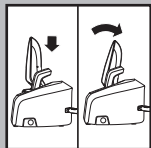

- 4** Press the razor tightly into the holder to lock it into place.
- 5** The display on the razor will indicate razor is charging.
- 6** Charging requires one full hour. A fully charged razor has a cordless shaving time of up to 60 minutes (models 1290X, 1280X, 1280XCC and 1260X) or 50 minutes (models 1250X and 1250XCC).

Recharging

- 1** Recharging requires one full hour. Recharge when the minutes indication blinks (models 1290X, 1280X and 1280XCC) or the bottom charging light blinks orange (models 1260X, 1250X and 1250XCC).

Always unplug charging stand/Jet Clean System from the electrical outlet immediately after use, except when razor is (re)charging.

Quick Charge

When batteries are totally depleted, recharging the razor for approximately 3-5 minutes gives enough energy for a 3-minute cordless shave.

Put It To The Test & Shaving Tips

- ▶ 21 Day Trial and Conversion Process. It is a fact that your skin and beard need time to adjust to a new shaving system.
- ▶ Use your new razor exclusively for 3 weeks to fully enjoy the closeness of a Philips Norelco shave.
- ▶ At first you may not get as close a shave as you expect, or your face may even become slightly irritated. This is normal since your beard and skin will need time to adjust. Invest 3 weeks and you'll soon experience the full joy of your new razor.
- ▶ Stick with it! If you alternate shaving methods during the adjustment period, it may make it more difficult to adapt to the Philips Norelco shaving system.
- ▶ If you are still not convinced after 21 days, Philips Norelco will refund you the full purchase price as long as the request is received within 45 days of purchase.

How To Shave With An Electric Razor

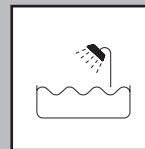

- ▶ This symbol on the razor indicates that the razor can be used in the bath or shower.
- ▶ Make sure the charging stand/Jet Clean System does not get wet or near water.
- ▶ Shaving with a clean face gives the best results.
- ▶ Use this razor for its intended household use as described in this manual.

Shaving



- 1 Turn razor ON by pressing the on/off button once. Shave against the direction of beard growth using both straight and circular movements.

The razor display will light up briefly.

- 2 Stretch your skin with your free hand so blades can lift and cut whiskers. Gently press razor to skin so the floating heads can follow the contours of your face. **DO NOT** press too hard. Too much pressure can pinch the skin into the combs.

- 3 Turn razor OFF by pressing the on/off button once.

The display lights up for a few seconds and then shows the remaining battery capacity.

- 4 Clean the razor after each use (see chapter 'Cleaning').

- 5 Put the Protective Razor Head Cap on the razor to protect razor heads.

Wet Shaving

You can also use the razor on a wet face with shaving foam.

- 1 Apply some water to your skin.



- 2 Apply shaving foam to your skin.
- 3 Rinse the shaving unit under the tap to ensure that the shaving unit glides smoothly over your skin.
- 4 Press the on/off button once to switch on the razor.
- 5 Move the shaving heads in circular movements over your skin.

NOTE: Rinse the razor under the tap regularly to ensure that it continues to glide smoothly over your skin.

- 6 Dry your face and thoroughly clean the razor after each use (see chapter 'Cleaning').

NOTE: Make sure you rinse all foam off the razor.

- 7 Put the Protective Razor Head Cap on the razor to protect heads.

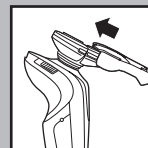

Trimming

To Groom Sideburns and Moustache:

- 1 Turn razor ON.
The display lights up for a few seconds.
- 2 Press the trimmer slide forward to slide out the trimmer.

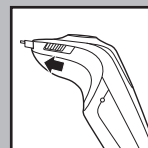

- 3** Hold trimmer to exact hairline desired. Move trimmer downward with gentle pressure.
- 4** Trim beard, moustache or sideburns using the trimmer.
- 5** Turn razor OFF when finished. The display lights up for a few seconds and then shows the remaining battery capacity.
- 6** Thoroughly clean the trimmer after using (see 'Cleaning').
- 7** Press the trimmer slide backwards to retract the trimmer.
- 8** Put the Protective Razor Head Cap on the razor.

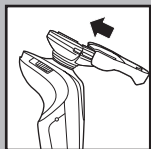

Travel Lock (I280X, I280XCC, I260X, I250X and I250XCC)

If you are going to store the razor for a longer time period or if traveling, it is possible to lock the razor. The travel lock prevents the razor from being switched on by accident.

Activating the travel lock

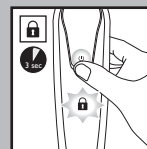

- 1** Press the ON/OFF button for 3 seconds.
 - ▶ Models I280X and I280XCC, the display starts to count down from 3. At 1, the razor beeps to indicate it is locked.
 - ▶ Model I250XCC, the top charging light blinks, then the second charging light and so on.
 - ▶ The lock symbol appears on the display.
- NOTE: The displays of models I280X, I280XCC, I260X, I250X and I250XCC look different, but show the same symbol.
- 2** The travel lock has now been activated.

Deactivating the travel lock

- 1** Press the ON/OFF button for 3 seconds.
- 2** The lock symbol goes out and the razor turns ON to indicate that the razor has been unlocked. The razor is now ready for use.

▶ The razor unlocks automatically when charging in the charging stand or Jet Clean System.

Cleaning

- ▶ Always clean your razor after each use.
- ▶ Regular cleaning guarantees better shaving results.

- ▶ Never clean, remove or replace shaving unit while motor is on.
- ▶ Do not apply pressure to shaving head combs. Do not touch razor heads with hard objects as this may dent or damage precision-made slotted combs.
- ▶ Do not use razor if shaving head combs are damaged or broken. Facial injury may occur.
- ▶ Do not use abrasives, scourers or aggressive liquids such as gasoline or acetone to clean the razor or Jet Clean System.

Cleaning the Shaving Unit

The razor heads may be quickly cleaned after each use by rinsing with hot water. Water from the tap should be on a hot setting, **BUT BE CAREFUL TO TEST WATER FIRST SO AS NOT TO BURN OR SCALD HANDS.**

- ▶ Regular cleaning guarantees better shaving results.
- ▶ While rinsing razor heads, water may drip out of the base of razor. This is a normal occurrence.

- 1** Always turn razor OFF; remove from charging stand/Jet Clean System before cleaning.
- 2** Rinse the shaving unit by running under hot water for a few minutes.

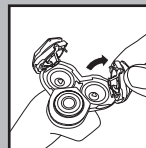
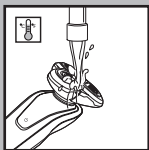

- 3** Using your thumb and forefinger, grasp the sides of the shaving head near the center of the shaving unit and pull each individual shaving head open.



- 4** Rinse all three shaving heads and three hair chambers under hot tap water by letting the water run in and around all the openings for at least 30 seconds.

BE CAREFUL TO TEST WATER FIRST SO AS NOT TO BURN OR SCALD HANDS.

- 5** You can also brush the shaving heads and hair chambers with the brush supplied.
- 6** Carefully shake off excess water and leave the shaving heads open to dry the shaving unit completely.

NOTE: Do not wipe or dry the shaving unit with a towel or tissue. This could damage the shaving heads.

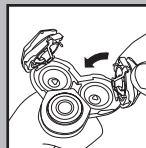

- 7** Press each shaving head back onto the shaving unit. You will hear a 'click'.

Cleaning the Shaving Unit in the Jet Clean System (I280XCC and I250XCC)

CAUTION: Keep cleaning solution out of reach of children. Do not take internally. Avoid contact with eyes. In case of eye contact, thoroughly flush with cold water. If irritation persists, get medical attention.

Important

- ▶ Only use this razor, charging stand, Jet Clean System and HQ200 cleaning solution provided to charge or clean razor.
- ▶ Other Philips Norelco razors **DO NOT** work with this Jet Clean System.
- ▶ Empty the cleaning solution canister and thoroughly rinse the canister clean with warm water **every 2 weeks**.
- ▶ The Jet Clean System thoroughly cleans but does not disinfect your razor; therefore, do not share razor with others.
- ▶ The charging plug converts 100-240V AC to less than 24V DC.
- ▶ Place the Jet Clean System on a flat, stable and fluid-resistant surface to avoid any leakage. Be careful not to tip or move the Jet Clean System if it is filled with the cleaning solution.
- ▶ To avoid evaporation, do not expose cleaning solution to direct sunlight.
- ▶ Remove the protective razor head cap from the razor before charging or cleaning the razor in the Jet Clean System.

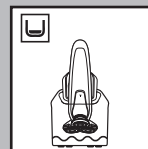
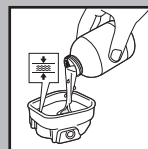

▶ Use this appliance for its intended household use as described in this manual.

- 1** Place the Jet Clean System on a flat, level surface.
- 2** Simultaneously press the buttons located on both sides of the Jet Clean System (1) and lift the appliance off the Jet Clean canister (2).

Always remove appliance from canister by lifting straight up. Do not tilt Jet Clean System.

- 3** Unscrew the lid on the Jet Clean Solution bottle (Model HQ200) provided with the razor. Remove the airtight seal by lifting up the tabs on the seal.
- 4** Pour the Jet Clean Solution into the canister up to a level between the two lines located inside the canister.

NOTE: ONLY USE PHILIPS NORELCO JET CLEAN SOLUTION (MODEL HQ200) WITH THE JET CLEAN SYSTEM. ANY OTHER SOLUTION MAY CAUSE DAMAGE TO YOUR RAZOR.

- ▶ When the cleaning solution level drops below the minimum level, the 'cleaning chamber empty' symbol will blink and the razor holder will move to the starting position.



- ▶ If you clean your razor every day, you should clean and refill the canister approximately every 15 days.

- 5** Carefully lower the appliance back onto the Jet Clean canister making sure the release buttons snap back into place.

When the canister is filled with cleaning solution, do not move appliance to prevent leakage.

Jet Cleaning the Razor

- ▶ If the razor does not contain enough power for one (1) shave, the Jet Clean Cleaning System may not work properly. Charge the razor in the Jet Clean System before using the Jet Clean System to clean your razor.
- ▶ If you use the razor with shaving foam, quickly rinse under hot water before cleaning in the Jet Clean System.

- 1** Connect the small plug to the Jet Clean System. Connect the charging plug into any 100V to 240V AC outlet. Use only the charging plug provided.
- 2** Place the Jet Clean System on a flat, level surface. Fill the canister with cleaning solution (see 'Preparing Jet Clean System For Use').

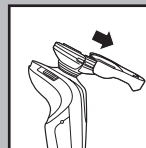

- 3** Remove protective razor head cap from razor.

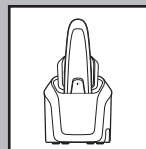

- 4** Place the razor head side down in the razor holder with the display facing the front of the Jet Clean System.

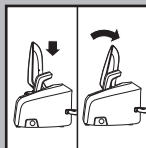

- 5** Press the razor tightly into the holder of the Jet Clean System to lock into cleaning cycle position.

The display on the razor will indicate razor is charging.

- 6** Model I280XCC only, press the up/down button to select a cleaning program.

You can choose from 3 cleaning programs: eco program, auto program and intensive program.

NOTE: The eco program has a shorter drying time and the intensive program is a more thorough cleaning program.

- 7** Press the ON/OFF button to start the cleaning cycle.

Model I250XCC only, the system begins the automatic cleaning program.



- 8** The cleaning light starts to blink and the razor is automatically lowered into the cleaning solution.

The razor stops charging while it is being cleaned.

- ▶ The cleaning cycle takes 4 to 6 minutes. For model I280XCC only, the intensive program takes approximately 35 minutes.
- ▶ During the first phase of the cleaning cycle, the razor will automatically turn on and off several times while the razor holder lowers and raises the razor's position in the cleaning solution, removing all debris. The cleaning light will blink continuously throughout the cleaning program.
- ▶ During the second phase of the cleaning cycle, the razor holder moves the razor to the drying position and the drying light will blink. This phase will take approximately 2 hours. Model I280XCC only, the drying phase takes 1 hour when the eco program is selected. The razor will stay in one position until the end of the drying program.
- ▶ Do not press the ON/OFF button while the cleaning cycle is running. If this does occur, the cleaning cycle will stop and the razor holder will automatically move to the starting position. The cleaning cycle can be re-started by pressing the ON/OFF button once.
- ▶ If the power plug is disconnected before the cleaning cycle is complete, the razor holder will remain in its current position. Reconnect the plug into the outlet or Jet Clean System and the

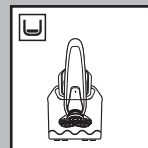
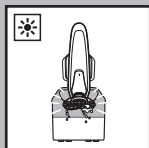

razor holder will automatically move to the highest position. The cleaning cycle can be re-started by pressing the ON/OFF button once.

NOTE: If the cleaning solution level drops below the minimum level during the cleaning cycle, the 'cleaning chamber empty' symbol will blink and razor holder returns the razor to the starting position, stopping the cleaning cycle. Unplug Jet Clean System from the outlet, remove razor and refill canister (see "Preparing Jet Clean System for Use").

- 8** When the entire cleaning cycle is complete and the razor is hygienically clean, the razor will be raised to the starting position and the display on the razor will turn on indicating that the razor is (re)charging.

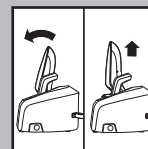

- 9** Pull the razor forward and lift razor from Jet Clean System.
- ▶ If the razor needs to be recharged, you can simply leave it in the Jet Clean System after cleaning and the razor will automatically recharge. The display on the razor will indicate the razor is recharging.
 - ▶ You may store your razor in the Jet Clean System. Unplug from the outlet when charging/cleaning is complete.

Extra-thorough cleaning method

Do not mix up the cutters and combs as the shaving performance may be adversely affected for several weeks before optimal shaving performance is restored.

1 Turn razor OFF.

2 Pull the shaving unit straight off the razor.
Do not turn the shaving unit when you pull it off the razor.

3 Using your thumb and forefinger, grasp the sides of the shaving head near the center of the shaving unit and pull each individual shaving head open.

4 Press the retainer release tab (1) until the retainer opens (2).

5 Remove the cutter from the comb.
Do not clean more than one cutter and comb at a time, since they are all matching sets. If you accidentally put a cutter in the wrong comb, it may take several weeks before optimal shaving performance is restored.

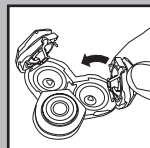
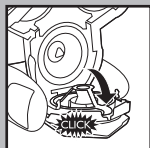
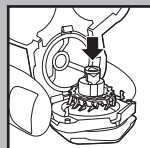
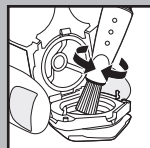
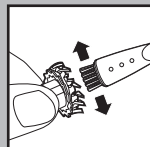
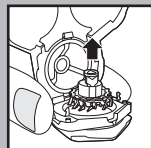
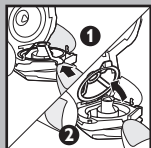
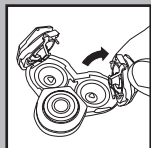
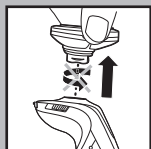

6 Clean the cutter with the cleaning brush supplied.

7 Clean the inside of the comb.

8 After cleaning, place the cutter back into the comb with the cutter legs pointing downwards.

9 Repeat the process for the other two cutters and combs.

10 Press down the retainer over the cutter.

11 Close the shaving heads.



- 12** Insert the notch of the shaving unit into the slot in the top of the razor (1). Then press the shaving unit down (2) to attach it to the razor. You will hear a 'click'.

Cleaning the Trimmer

Clean the trimmer after each use.

- 1** Press the trimmer slide forward to slide out the trimmer.
- 2** Rinse the trimmer under hot water. BUT BE CAREFUL TO TEST WATER FIRST SO AS NOT TO BURN OR SCALD HANDS.
- 3** Allow trimmer to air dry.

Tip: For optimal trimmer performance, lubricate the trimmer teeth with one drop of mineral oil every 6 months.

Cleaning the Jet Clean Canister (I280XCC and I250XCC)

For optimal performance of the Jet Clean System, it is recommended that you empty the cleaning solution canister and thoroughly rinse the canister clean every 2 weeks.

- 1** Place the Jet Clean System on a flat, level surface.

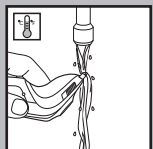

- 2** Simultaneously press the buttons located on both sides of the Jet Clean System (1) and lift the appliance off the Jet Clean canister (2).

Always remove appliance from canister by lifting straight up. Do not tilt Jet Clean System.

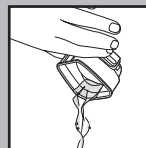

- 3** Discard any remaining cleaning solution in the canister.

The cleaning solution can be safely poured down the sink as there are no harmful ingredients.

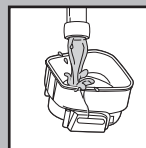

- 4** Simply rinse the canister with warm water. Wipe the canister with a towel or tissue to remove excess water.

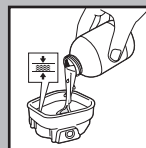

- 5** Pour the Jet Clean Solution into the canister up to a level between the two lines located inside the canister.



- 6** Carefully lower the Jet Clean System over the canister making sure the release buttons snap back into position.

Replacing the Shaving Unit

- ▶ Replace the shaving unit once a year for optimal shaving results.
- ▶ Replace damaged or worn razor heads with model RQ12 Philips Norelco razor heads only.
- ▶ The individual shaving heads (cutters and combs) are NOT replaceable. Only the one-piece shaving unit can be replaced.

Replacement Razor Head Assembly Indication

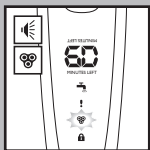

- ▶ The replacement head indicator symbol starts to blink and you will hear a beep (models I290X, I280X and I280XCC) to remind you to check if it's time to replace your shaving unit to obtain optimal shaving results.

This razor/charging stand/Jet Clean System has no other user-serviceable parts. For assistance call 1-800-243-3050.

Maintenance

- ▶ Always remove razor from the charging stand/Jet Clean System before cleaning appliance.
- ▶ Unplug the charging stand/Jet Clean System after charging/recharging or cleaning razor. The charging stand/Jet Clean System and razor may be wiped clean using a damp cloth.

- ▶ Water from the tap should be on a warm setting to clean any washable parts.

Note: DO NOT place or clean any parts of the charging stand/Jet Clean System in a dishwasher.

Storage

- ▶ The razor can be placed in the charging stand/Jet Clean System for safe storage. Remove the plug from outlet as soon as the razor is fully charged or cleaned.
- ▶ If appliance will not be used for an extended period of time, it is recommended that the cleaning solution in the Jet Clean canister be emptied out before storing.
- ▶ Be sure razor is turned off. Remove cord from outlet and charging stand or Jet Clean System before storing in a safe, dry location where it will not be crushed, banded, or subject to damage.
- ▶ Do not wrap cord around razor/charging stand or Jet Clean System when storing.
- ▶ Store cord in a safe location where it will not be cut or damaged.
- ▶ Do not keep charging stand or Jet Clean System permanently plugged into outlet.
- ▶ Do not place or store charging stand/Jet Clean System where it can fall or be pulled into a tub or sink, water or other liquid while plugged in.
- ▶ If storing razor in the charging stand, put the Protective Razor Head Cap on razor to protect heads.

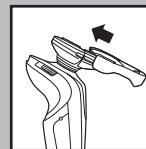

Assistance

- ▶ For assistance, visit our website: www.philips.com/support or call 1-800-243-3050.
- ▶ Information is available 24 hours a day, 7 days a week.

Battery Removal



- ▶ This Philips Norelco razor contains a rechargeable Lithium-Ion battery which must be disposed of properly.
- ▶ Battery should only be removed when razor is to be discarded.
- ▶ For assistance, visit our website, www.philips.com/support or call toll free: 1-800-243-3050.

- 1** Turn razor ON.
- 2** Allow razor to run until the battery is empty/depleted.
- 3** Turn razor OFF.
- 4** Use a screwdriver to remove the back panel of the razor.
- 5** Remove the rechargeable battery.
- 6** Do not attempt to replace battery. Insulate battery ends by covering with tape and/or place battery in a small plastic bag.

- 7** Discard your razor. Do not attempt to plug electrical cord into the outlet or recharge the razor after the battery has been removed.
- 8** Contact your local town or city officials for battery disposal information or call 1-800-8-BATTERY or www.rbc.com for battery drop-off locations.

Accessories

- ▶ **Replacement Shaving Unit**
Model RQ12 - For maximum razor performance, replace your Philips Norelco razor heads once a year.
- ▶ **Shaving Head Cleaning Spray**
HQ110 - Philips Norelco Shaving Head Cleaning Spray
- ▶ **Cleaning Solution**
HQ200 - Philips Norelco Jet Clean Solution, 10 fl. oz. /300 ml.
- ▶ **Philips Norelco Razor Accessories** may be purchased at a store near you, or on our website www.philips.com/store

FULL TWO YEAR WARRANTY

Philips Electronics North America Corporation warrants each new Philips Norelco Product, Models 1290X/1280X/1280XCC/1260X/1250X/1250XCC (except cutters and combs) against defects in materials or workmanship for a period of two years from the date of purchase, and agrees to repair or replace any defective product without charge.

IMPORTANT: This warranty does not cover damage resulting from accident, misuse or abuse, lack of reasonable care, the affixing of any attachment not provided with the product or loss of parts or subjecting the product to any but the specified voltage.* Use of unauthorized replacement parts will void this warranty.

PHILIPS ELECTRONICS NORTH AMERICA CORPORATION WILL NOT PAY FOR WARRANTY SERVICE PERFORMED BY A NON-AUTHORIZED REPAIR SERVICE AND WILL NOT REIMBURSE THE CONSUMER FOR DAMAGE RESULTING FROM WARRANTY SERVICE PERFORMED BY A NON-AUTHORIZED REPAIR SERVICE. NO RESPONSIBILITY IS ASSUMED FOR ANY SPECIAL, INCIDENTAL OR CONSEQUENTIAL DAMAGES.

In order to obtain warranty service, simply go to www.philips.com/norelco or call 1-800-243-3050 for assistance. It is suggested that for your protection you return shipments of product by insured mail, insurance prepaid. Damage occurring during shipment is not covered by this warranty.

NOTE: No other warranty, written or oral, is authorized by Philips Electronics North America Corporation.

This warranty gives you specific legal rights, and you may also have other rights which vary from state to state. Some states do not allow the exclusion or limitation of incidental or consequential damages, so the above exclusion and limitations may not apply to you.

* Read enclosed instructions carefully.

Manufactured for:

Philips Consumer Lifestyle
A Division of Philips Electronics North America Corporation
P.O.Box 10313, Stamford, CT 06904



This symbol on the product's nameplate means it is listed by Underwriters' Laboratories, Inc.

Norelco, Tripleheader, Lift and Cut, and  are Registered Trademarks of Philips Electronics North America Corporation.



is a Trademark of Philips Electronics North America Corporation.

PHILIPS is a Registered Trademark of Koninklijke Philips Electronics N.V.

Free Manuals Download Website

<http://myh66.com>

<http://usermanuals.us>

<http://www.somanuals.com>

<http://www.4manuals.cc>

<http://www.manual-lib.com>

<http://www.404manual.com>

<http://www.luxmanual.com>

<http://aubethermostatmanual.com>

Golf course search by state

<http://golfingnear.com>

Email search by domain

<http://emailbydomain.com>

Auto manuals search

<http://auto.somanuals.com>

TV manuals search

<http://tv.somanuals.com>