

Always there to help you

Register your product and get support at
www.philips.com/welcome

SHB7000



User manual

PHILIPS

Contents

1 Important	2	5 Technical data	9
Hearing Safety	2		
Electric-, Magnetic- and Electromagnetic Fields (EMF)	2		
General information	2		
Disposal of your old product	3		
Remove the integrated battery	3		
Notice for the European Union	3		
Trademarks	3		
2 Your bluetooth stereo headset	4	6 Frequently asked questions	10
Introduction	4	Bluetooth headset does not switch on.	10
What's in the box	4	Fail to pair with a mobile phone.	10
What else you'll need	4	Pairing does not work.	10
Compatibility	4	The mobile phone cannot find the headset.	10
Overview of your Bluetooth stereo headset	5	Voice dialing or redialing does not work.	10
		The other side cannot hear me.	10
		The headset is connected to a Bluetooth stereo enabled mobile phone, but music will play on the mobile phone's speaker only.	10
		Audio quality is poor and crackling noises can be heard.	10
		Audio quality is poor when streaming from the mobile phone is very slow, or audio streaming does not work at all.	11
3 Get started	6	I hear but cannot control music on my device (e.g. skip forward/backward).	11
Charge the headset	6	Headset does not work when audio cable is connected.	11
Pair the headset with your mobile phone	6	Restore the factory setting	11
4 Use the headset	7		
Connect the headset to a mobile phone	7		
Automatic power saving	7		
Use your headset	7		
Wear your headset	8		
Use with an audio cable	8		

1 Important

Hearing Safety



Danger

- To avoid hearing damage, limit the time you use the headphones at high volume and set the volume to a safe level. The louder the volume, the shorter is the safe listening time.

Be sure to observe the following guidelines when using your headphones.

- Listen at reasonable volumes for reasonable periods of time.
- Be careful not to adjust the volume continuously upwards as your hearing adapts.
- Do not turn up the volume so high that you can't hear what's around you.
- You should use caution or temporarily discontinue use in potentially hazardous situations.
- Excessive sound pressure from earphones and headphones can cause hearing loss.
- Using this headset with both ears covered while driving is not recommended and may be illegal in some areas while driving.
- For your safety, avoid distractions from music or phone calls while in traffic or other potentially dangerous environments.

Electric-, Magnetic- and Electromagnetic Fields (EMF)

1. Royal Philips Electronics manufactures and sells many products targeted at consumers,

which, like any electronic apparatus, in general have the ability to emit and receive electromagnetic signals.

2. One of Philips' leading Business Principles is to take all necessary health and safety measures for our products, to comply with all applicable legal requirements and to stay well within the EMF standards applicable at the time of producing products.
3. Philips is committed to develop, produce and market products that cause no adverse health effects.
4. Philips confirms that if its products are handled properly for their intended use, they are safe to use according to scientific evidence available today.
5. Philips plays an active role in the development of international EMF and safety standards, enabling Philips to anticipate further developments in standardization for early integration in its products.

General information

To avoid damage or malfunction:

- Do not expose the headset to excessive heat.
- Do not drop your headset.
- Apparatus shall not be exposed to dripping or splashing.
- Do not allow your headset to be submerged in water.
- Do not use any cleaning agents containing alcohol, ammonia, benzene, or abrasives.
- If cleaning is required use a soft cloth, if necessary dampened with a minimum amount of water or diluted mild soap, to clean the product.

About operating and storage temperatures

- Do not operate or store in a place where temperature is below -15°C (5°F) or above 55°C (131°F) as this may shorten your battery life.
- The integrated battery shall not be exposed to excessive heat such as sunshine, fire or the like.

Disposal of your old product

Your product is designed and manufactured with high quality materials and components, which can be recycled and reused.



When this crossed-out wheeled bin symbol is attached to a product it means that the product is covered by the European Directive 2002/96/EC.

Please inform yourself about the local separate collection system for electrical and electronic products.

Please act according to your local rules and do not dispose of your old products with your normal household waste. Correct disposal of your old product helps to prevent potential negative consequences for the environment and human health.

Battery disposal

Your product contains batteries covered by the European Directive 2006/66/EC, which cannot be disposed of with normal household waste.



Please inform yourself about the local rules on separate collection of batteries. The correct disposal of batteries helps prevent potentially negative consequences on the environment and human health.

Remove the integrated battery



Warning

- Make sure the headset is disconnected from the USB charging cable before removing the battery.

If there is no collection/recycling system for electronic products in your country, you can protect the environment by removing and recycling the battery before disposing of the headset.

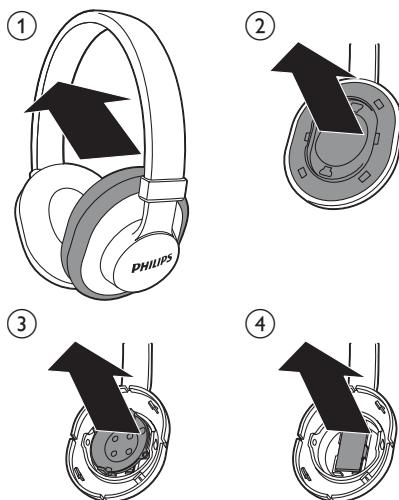

Notice for the European Union



Hereby, Philips Consumer Lifestyle, BG Communications, Headphones & Accessories, declares that this Philips **Bluetooth** stereo headset SHB7000/SHB7000WT is in compliance with the essential requirements and other relevant provisions of Directive 1999/5/EC.

Trademarks

Trademarks are the property of Koninklijke Philips Electronics N.V. or their respective owners. The **Bluetooth** word mark and logos are owned by the Bluetooth SIG, Inc. and any use of such marks by Koninklijke Philips Electronics N.V. is under license.

2 Your bluetooth stereo headset

Congratulations on your purchase, and welcome to Philips! To fully benefit from the support that Philips offers, register your product at www.philips.com/welcome.

Introduction

With this Philips Bluetooth stereo headset, you can:

- Enjoy convenient wireless hands-free call
- Enjoy and control wireless music
- Switch between calls and music
- Enjoy music on non-Bluetooth devices with audio cable

What's in the box



- Headset

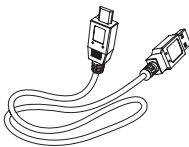

- USB charging cable



- Audio cable

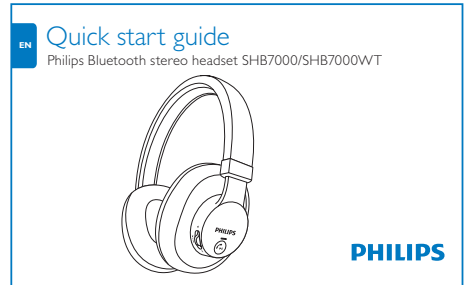

- Quick start guide

What else you'll need

A mobile phone that is capable of Bluetooth stereo streaming is compatible with the Bluetooth A2DP profile.

Other devices (Notebooks, PDA's, Bluetooth adapters, MP3 players etc.) are also compatible if they share the Bluetooth profiles supported by the headsets. These profiles are:

For wireless Hands-Free communication:

- The Bluetooth Headset profiles (HSP) or the Bluetooth Hands-Free profile (HFP).

For wireless stereo listening:

- The Bluetooth Advanced Audio Distribution profile (A2DP).

For wireless music control:

- The Bluetooth Audio Video Remote Control profile (AVRCP).

Compatibility

Your headset is compatible with Bluetooth enabled mobile phones. It features Bluetooth version 3.0. It also works with devices featuring other Bluetooth versions that support the Headset profile (HSP), Hands-Free profile (HFP), Advanced Audio Distribution profile (A2DP) and Audio/Video Remote Control profile (AVRCP).

Overview of your Bluetooth stereo headset

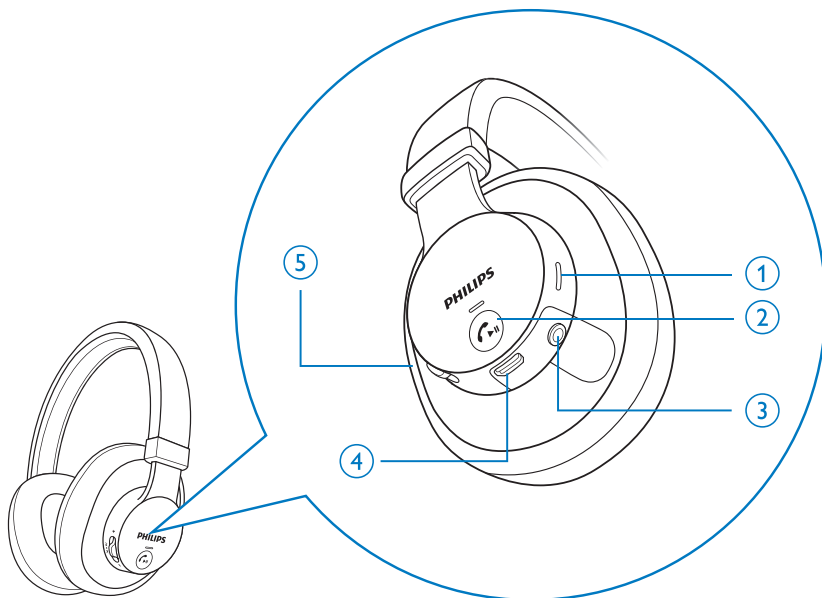

- ① Mic
- ② 
 - Turn the headset on or off
 - Play/Pause/Pick up call/Hang up/Redial/Reject call
- ③ Audio input jack
- ④ Volume/Track control
- ⑤ Charging slot

3 Get started

Charge the headset

Warning

- Before you use your headset for the first time, charge the battery for four hours for optimum battery capacity and lifetime.
- Use only the original USB charging cable to avoid any damage.
- End a call before charging the headset, as connecting the headset for charging will power off the unit.

Plug the headset into a powered USB port with an USB charging cable.

- ↳ LED turns white during charging and turns off when the headset is fully charged.

Tip

- Normally, a full charge takes three hours.

Pair the headset with your mobile phone

Before you use the headset with your mobile phone for the first time, pair it with the mobile phone. A successful pairing establishes a unique encrypted link between the headset and the mobile phone. The headset stores the last eight links in the memory. If you try to pair more than eight devices, the link for the earliest paired devices is replaced by the new link.

- 1 Make sure that the mobile phone is turned on and its Bluetooth feature is activated.
- 2 Make sure that the headset is charged and turned off.

- 3 Press and hold  until the LED starts flashing white and blue alternately.
 - ↳ The headset is in pairing mode, which lasts five minutes.

- 4 Pair the headset with the mobile phone. For details, refer to the user manual of your mobile phone.

A sample pairing is shown below.

- 1 Activate the Bluetooth feature of your mobile phone, search for the model number of the headset.
- 2 On mobile phones featuring Bluetooth 2.1+EDR or higher; you do not need to enter a pass code.
- 3 From the found devices, select **Philips SHB7000**.
 - Enter "0000" (4 zeros) if prompted to enter the pin code of the headset.

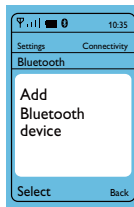

4 Use the headset

Connect the headset to a mobile phone

- 1 Turn on your mobile phone.
- 2 Press and hold  to turn the headset on.
 - ↳ The blue LED flashes.
 - ↳ The headset is reconnected to the last connected device automatically. If the last one is not available, the headset tries to reconnect to the second last connected device.





Tip









- If you turn on the mobile phone or its **Bluetooth** feature **after** turning on the headset, connect the headset from the **Bluetooth** menu on your mobile phone.

Automatic power saving

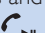
If the headset fails to connect any **Bluetooth** device within range in five minutes, it powers down automatically to save the battery life.

Use your headset

Task	Operation	Sound or LED Indicator
Turn the headset on.	Press and hold  for more than 1 second	<ul style="list-style-type: none"> • 1 short beep • 1 blue flash: Battery level > 50% • 1 white flash: Battery level < 50%
Turn the headset off.	Press and hold  for more than 4 seconds	<ul style="list-style-type: none"> • 1 long beep • 1 long white flash

Play or pause music.	Press 	1 short beep
Pick up or terminate a call.	Press 	1 short beep
Reject a call.	Press and hold 	1 short beep
Redial the last number.	Press  twice	1 short beep
Switch caller in a call.	Press  twice	1 long beep
Adjust volume.	Slide up and down +/-	1 short beep
Skip forward.	Press 	1 short beep
Skip backward.	Press  twice	1 short beep
Mute/unmute the mic while in a call	Press  twice	1 short beep

Other status and indicators

Headset status	Indicator
The headset is connected to a Bluetooth device, while the headset is in standby mode or while you are listening to music.	Blue LED flashes every 6 seconds.
The headset is ready for pairing.	LED flashes white and blue alternately.
The headset is on but not connected to a Bluetooth device.	Blue LED flashes fast.
There is an incoming call.	Blue LED flashes twice per second.
Low battery.	White LED flashes.
Battery is fully charged.	White LED is off.

Wear your headset

Adjust the headband for the best fit.

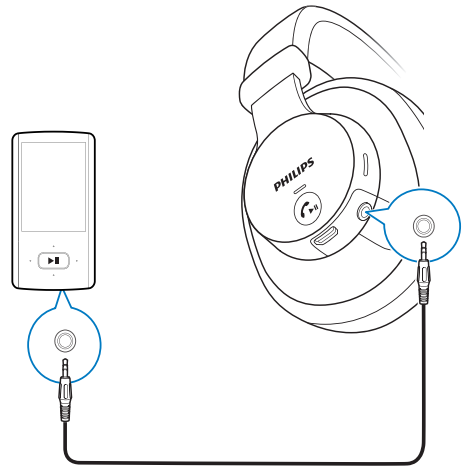
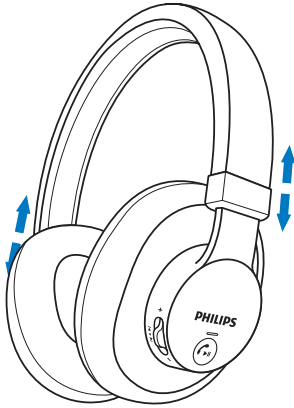

Use with an audio cable

With the supplied audio cable, you can use the headset with non-**Bluetooth** enabled devices or use the headset on airplane. No battery power is required when you use the headset with an audio cable.



Caution

- Finish your call before connecting the audio cable, as this will switch off battery power and end an incoming call.

Connect the supplied audio cable to

- the headset and;
- an external audio device.

5 Technical data

- Up to 9 hours of play time or talk time
- Up to 200 hours of standby time
- Normal time for a full charge: 3 hours
- Rechargeable Lithium-Polymer battery (200 mAh)
- Bluetooth 3.0, Bluetooth mono support (Headset Profile - HSP, Hands-Free Profile - HFP), Bluetooth stereo supported (Advanced Audio Distribution Profile - A2DP; Audio Video Remote Control Profile - AVRCP)
- Operating range: Up to 15 meters (50 feet)
- Adjustable, flat-folding headband
- Noise isolating slow recovery foam
- Digital echo & noise reduction
- Auto power off
- Battery status check

Specifications are subject to change without notice.

6 Frequently asked questions

Bluetooth headset does not switch on.

Battery is low.

- Charge the headset.

The audio cable is connected to the headset.

- Disconnect the audio cable.
-

Fail to pair with a mobile phone.

Bluetooth disabled.

- Enable the **Bluetooth** feature on your mobile phone and turn on the mobile phone **before** you turn on the headset.
-

Pairing does not work.

The headset is not in pairing mode.

- Follow the steps described in this user manual.
 - Make sure that the LED light flashes white and blue alternately before you release **↶**. Do not stop holding the button after seeing the blue LED only.
-

The mobile phone cannot find the headset.

The headset may be connected to another previously paired device.

- Turn the connected device off or move it out of range.

Pairings may have been reset or headset has been previously paired with other device.

- Pair the headset with the mobile phone again as described in the user manual.
-

Voice dialing or redialing does not work.

Your mobile phone may not support this feature.

The other side cannot hear me.

The microphone is muted.

- Press **⏮** • **⏭** to enable the microphone.
-

The headset is connected to a Bluetooth stereo enabled mobile phone, but music will play on the mobile phone's speaker only.

The mobile phone may have the option to listen to music via speaker or headset.

- Refer to the user manual of your mobile phone on how to transfer the music to the headset.
-

Audio quality is poor and crackling noises can be heard.

The Bluetooth audio source is out of range.

- Reduce the distance between the headset and the **Bluetooth** audio source, or remove obstacles between them.

Audio quality is poor when streaming from the mobile phone is very slow, or audio streaming does not work at all.

The mobile phone may only support (mono) HSP/HFP but not support A2DP.

- Refer to the user manual of the mobile phone for detailed information on compatibility.

I hear but cannot control music on my device (e.g. skip forward/backward).

The Bluetooth audio source does not support AVRCP.

- Refer to the user manual of the audio source for detailed information on compatibility.

Headset does not work when audio cable is connected.

Mic function will be deactivated if 3.5mm audio cable is connected to the headphone.

- In such case, the headphone is only for music enjoyment.

Restore the factory setting

Restore all original headset setting.

- Press **◀ • ▶** and **↻** until the LED flashing white for 5 times sequentially.

Please visit www.philips.com/support for further support.



Specifications are subject to change without notice
© 2013 Koninklijke Philips Electronics N.V.
All rights reserved.

SHB7000_UM_00_EN

CE 0168



Free Manuals Download Website

<http://myh66.com>

<http://usermanuals.us>

<http://www.somanuals.com>

<http://www.4manuals.cc>

<http://www.manual-lib.com>

<http://www.404manual.com>

<http://www.luxmanual.com>

<http://aubethermostatmanual.com>

Golf course search by state

<http://golfingnear.com>

Email search by domain

<http://emailbydomain.com>

Auto manuals search

<http://auto.somanuals.com>

TV manuals search

<http://tv.somanuals.com>