

Cleaning and Maintenance

Before cleaning, remove the Power Adapter from the wall socket. The LivingColors and Power Adapter should only be cleaned with a soft dry cloth. Be careful for possible scratches. Do not use cleaning agents.

Warranty and Service

For information or in case of a problem, please visit the Philips web site at www.philips.com/livingcolors or call 1-800-555-0050.

Battery Disposal

To dispose of old batteries, please remove from Remote Control. All old batteries should be discarded per state and local recycling rules and regulations.

Specifications

- AC Plug: Model ADP-15GH / Input 100-240 V ~ 0.5A 50-60Hz / Output 5V ~ 2.68A
- LivingColors system: 120V 9W 60Hz

Limited Warranty

When installed and operated in accordance with package and product instructions, if any component of this product fails within one (1) year from date of purchase of product, Philips will send you a replacement component upon receipt of the returned component, register receipt and proof-of-purchase. Please write (to Attn: LLG) or call our toll free number on how to return the component. The warranty and remedy set forth herein do not apply to any products or parts thereof which have been subject to misuse, failure to follow Philips' instructions, neglect, acts of God or accident, inadequate maintenance or incorrect installation. This replacement is the sole remedy available, and LIABILITY FOR INCIDENTAL OR CONSEQUENTIAL DAMAGE IS HEREBY EXPRESSLY EXCLUDED. Some states do not allow exclusion of incidental or consequential damages, so the above limitation or exclusion may not apply to you. This warranty gives you specific legal rights, and you may also have other rights which vary from state to state.

FCC Compliance Statement

This device complies with part 15 of the FCC Rules. Operation is subject to the following two conditions: (1) This device may not cause harmful interference, and (2) this device must accept any interference received, including interference that may cause undesired operation.

NOTE: This equipment has been tested and found to comply with the limits for a Class B digital device, pursuant to part 15 of the FCC Rules. These limits are designed to provide reasonable protection against harmful interference in a residential installation. This equipment generates, uses and can radiate radio frequency energy and, if not installed and used in accordance with the instructions, may cause harmful interference to radio communications. However, there is no guarantee that interference will not occur in a particular installation. If this equipment does cause harmful interference to radio or television reception, which can be determined by turning the equipment off and on, the user is encouraged to try to correct the interference by one or more of the following measures:

- Reorient or relocate the receiving antenna.
- Increase the separation between the equipment and receiver.
- Connect the equipment into an outlet on a circuit different from that to which the receiver is connected.
- Consult the dealer or an experienced radio/TV technician for help.

Changes or modifications to the equipment not expressly approved by the party responsible for compliance could void the user's authority to operate the equipment.

Ordering code: LivingColors Clear 120V 2/1
816732



Philips Lighting
281 Hillmount Road
Markham, ON Canada L6C 2S3

Philips Lighting Company
200 Franklin Square Drive
Somerset, NJ 08875-6800

Made in Poland

Questions or Comments:
1-800-555-0050
www.philips.com

LivingColors™

User Manual



Introduction

Thank you for buying Philips LivingColors.

LivingColors has been specially designed to enable you to create your own ambience, through color and light. Before first use please read these instructions carefully. By following our guidelines you can enjoy the full functionality of Philips LivingColors.

Visit our website at www.philips.com/livingcolors for more information about this product and to see a demonstration on the possible ambiances you can create at your home.

Important

Read these instructions carefully before you use LivingColors for the first time and save them for future reference.

- Open packaging and check that all components have been received (see next page for components).
- Carefully remove the parts from the packaging.
- Check to see if Power Adapter is connected to Lamp Unit.

PHILIPS

Unpack LivingColors

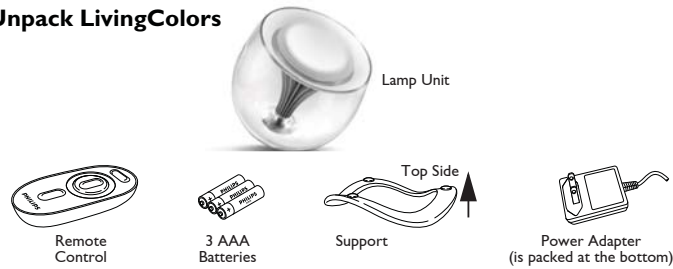

LivingColors



Safety Instructions

- Keep the Power Adapter and LivingColors away from liquids and humidity.
- LivingColors is for indoor use only. Do not use in wet locations, e.g. bathrooms or outdoors.
 - LivingColors is not a toy designed to be played with by children.
 - Do not tamper with Power Adapter.
 - For safety reasons the LivingColors and Power Adapter must not be opened.
 - Only use the Power Adapter supplied with LivingColors: using a Power Adapter with the wrong polarity or current can damage your LivingColors.

Getting Started

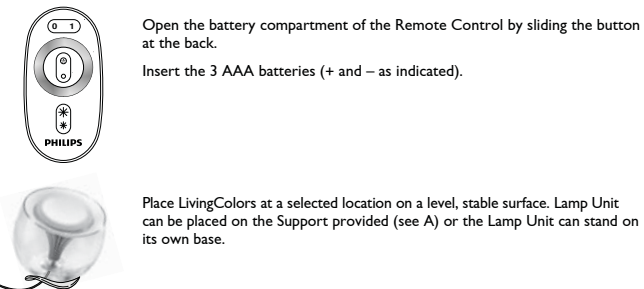

Connect Power Adapter cord to Lamp Unit. Plug Power Adapter into wall socket. Living Colors will show a short introduction to the color possibilities (this is normal).



Switch LivingColors on by pushing the **1** (on) on the on/off button.

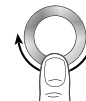

Create your own ambience by:
1. Touching the desired color on the touch ring.
Move a finger over the touch ring for refining the color.



2. Deep full color through to white
Push the white balance button, for a shorter or longer time, on **A** (☉) for a deep color or on **B** (○) for more pastel through to white.



3. Dimming
Increase (☼) or decrease (☾) the amount of light via the Dimming Button.



Switch off LivingColors by pushing the **0** (off) on the On/Off button. LivingColors will remember the last setting.

Extend the LivingColors Possibilities



- Up to 6 LivingColors Lamp Units can be operated by one Remote Control. Independently:
- 1) Use more LivingColors independently with it's own Remote Control. They will show different colors each.
- Together:
- 2) Operate 2 (or more) LivingColors with one Remote Control. They will show similar colors.
 - Hold the Remote Control with a finger on the "On" button, close to the front of LivingColors.
 - LivingColors will flash 3 times, as a confirmation for being connected.

Problem Solving

The LivingColors will bring you a colorful world of opportunities.

1. If, however, you face one of the exceptional situations where: LivingColors is not providing light,
 - check your batteries in the Remote Control
 - check the connections
 - check the Power Adapter connections
2. If there still is no light being emitted from the LivingColors, call PLC Customer Service at 1-800-555-0050.

Free Manuals Download Website

<http://myh66.com>

<http://usermanuals.us>

<http://www.somanuals.com>

<http://www.4manuals.cc>

<http://www.manual-lib.com>

<http://www.404manual.com>

<http://www.luxmanual.com>

<http://aubethermostatmanual.com>

Golf course search by state

<http://golfingnear.com>

Email search by domain

<http://emailbydomain.com>

Auto manuals search

<http://auto.somanuals.com>

TV manuals search

<http://tv.somanuals.com>