



Docking Entertainment System

DCM250



# Quick start guide

- 1** Connect
- 2** Setup
- 3** Enjoy

## What's in the box



FM antenna



MW antenna

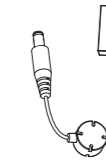

AC adaptor

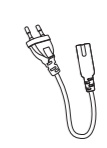

Power cord



Video cable



MP3 link cable



Back plate



Remote Control



Quick Start Guide



User manual

## 1 Connect

### A Remove the protective tab

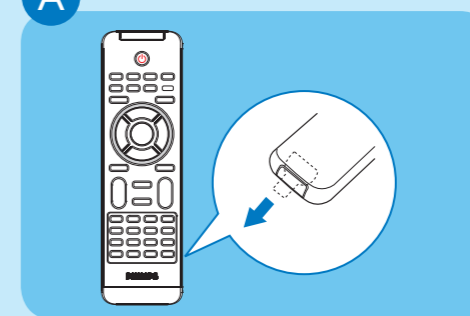

1 Remove the protective tab to activate the remote control battery.

### B Connect power

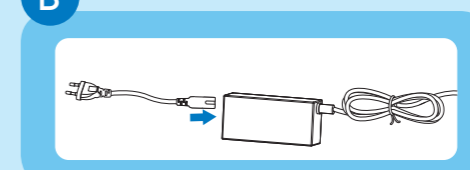

1 Connect the power cord to the AC adaptor.

© Royal Philips Electronics N.V. 2009  
All rights reserved.

Specifications are subject to change without notice.  
Trademarks are the property of Koninklijke Philips  
Electronics N.V. or their respective owners.

Printed in China PDCC-2009

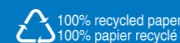

100% recycled paper  
100% papier recyclé



# 1 Connect

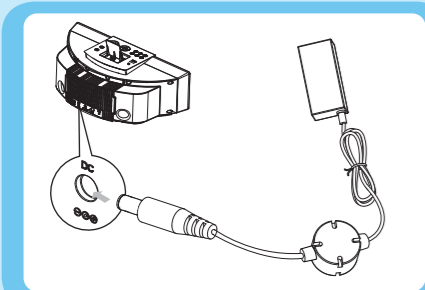

- 2 Connect one end to the DC socket on the main unit.

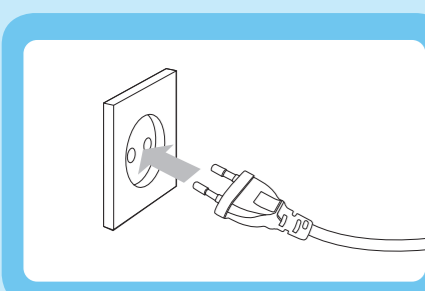

- 3 Connect the other end to the wall socket.

- \* Tip
- See the User Manual for how to connect other equipment to this system.

# 2 Setup

## A Set the clock

- 1 In standby mode, press **PROG** to activate the clock setting mode.
  - ↳ The 12 hour or 24 hour format is displayed.
- 2 Press **◀/▶** to select 12 hour or 24 hour format.
- 3 Press **PROG**.
  - ↳ The hour digits are displayed and begin to blink.
- 4 Press **◀/▶** to set the hour.
- 5 Press **PROG**.
  - ↳ The minute digits are displayed and begin to blink.

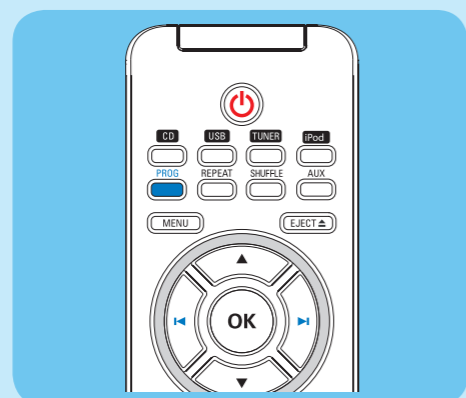

# 2 Setup

- 6 Press **◀/▶** to set the minute.
- 7 Press **PROG** to confirm.

# 3 Enjoy

## A Play disc

- 1 Press **CD** to select the disc source.
- 2 Insert a disc into the disc compartment with the printed side facing up.
- 3 Press **▶||** to start play.
  - To stop play, press **■**.

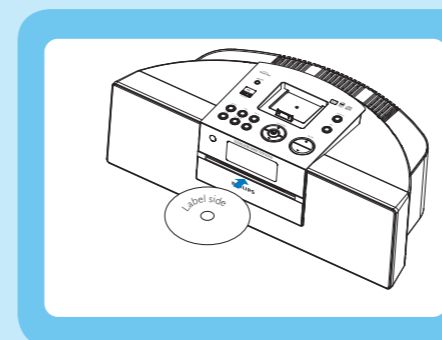

## B Play from USB

- Note
- Ensure that the USB device contains playable audio content.

- 1 Connect the USB device into the **↔** socket.
- 2 Press **USB** to select the USB source.
  - ↳ The total number of tracks is displayed.
- 3 Press **▲▼** to select a folder.
- 4 Press **◀/▶** to select a file.
- 5 Press **▶||** to start play.

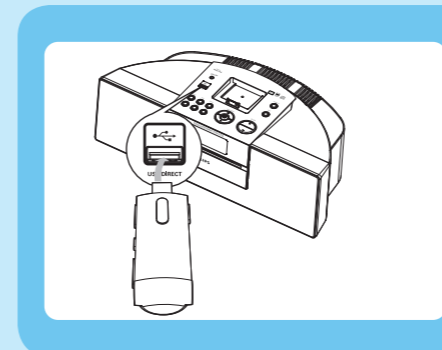

# 3 Enjoy

## C Program and tune to radio stations

- 1 Press **TUNER** to select the tuner source.
- 2 Press and hold **PROG** for 2 seconds to activate automatic program mode.
  - ↳ [AUTO] (auto) is displayed.
  - ↳ All available stations are programmed in the order of waveband reception strength.
- 3 Press **◀/▶** to select a preset number.

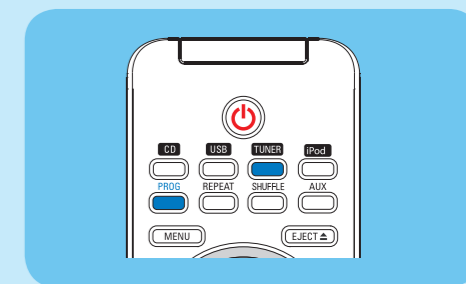

## D Play iPod/iPhone

- 1 Install the supplied back plate, and load the iPod/iPhone in the dock.
- 2 Press **iPod** to select iPod/iPhone source.
  - ↳ The connected iPod/iPhone plays automatically.
  - To pause/resume play, press **▶||**.
  - To skip to a track, press **◀/▶**.
  - To search during play: press and hold **◀/▶**, then release to resume normal play.
  - To navigate the menu: press **MENU**, and press **▲▼◀/▶** to select, then press **OK** to confirm.

- \* Tip
- Detailed features and additional functions are described in the user manual.

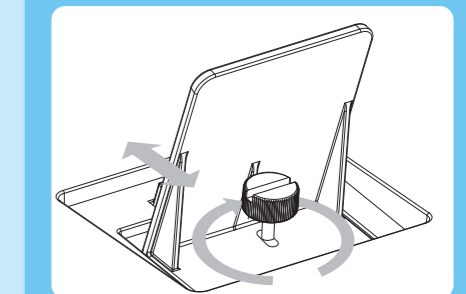
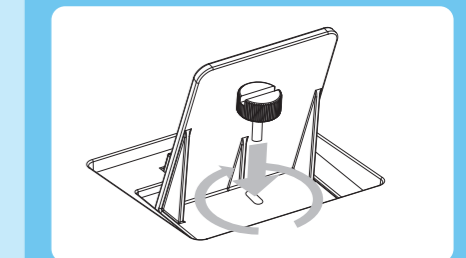
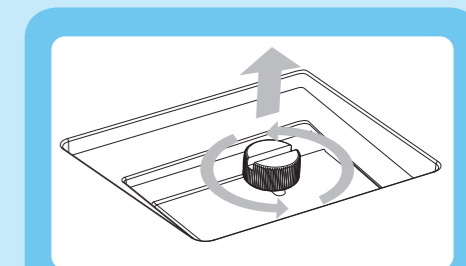

## Free Manuals Download Website

<http://myh66.com>

<http://usermanuals.us>

<http://www.somanuals.com>

<http://www.4manuals.cc>

<http://www.manual-lib.com>

<http://www.404manual.com>

<http://www.luxmanual.com>

<http://aubethermostatmanual.com>

Golf course search by state

<http://golfingnear.com>

Email search by domain

<http://emailbydomain.com>

Auto manuals search

<http://auto.somanuals.com>

TV manuals search

<http://tv.somanuals.com>