

Register your product and get support at
www.philips.com/welcome

PD7042



EN **User manual**

FR **Mode d'emploi**

DA **Brugervejledning**

IT **Manuale utente**

DE **Benutzerhandbuch**

NL **Gebruiksaanwijzing**

ES **Manual del usuario**

SV **Användarhandbok**

PHILIPS

Contents

1	Important	4
	Important Safety Instructions	4
	Notice	7
<hr/>		
2	Your portable DVD player	10
	Introduction	10
	What's in the box	10
	Overview of the main unit	11
<hr/>		
3	Get started	13
	Preparation	13
	Connect a main unit as the second screen	15
	Connect power	16
<hr/>		
4	Use your player	17
	Turn on	17
	Select OSD language	17
	Play discs	17
	Play options	18
<hr/>		
5	Adjust settings	18
	Set the main unit	18
<hr/>		
6	Use more of your player	19
	Connect additional equipment	19
	Connect power from household source	20
<hr/>		
7	Product information	21
<hr/>		
8	Troubleshooting	22

1 Important

Important Safety Instructions

- ① Read these instructions.
- ② Keep these instructions.
- ③ Heed all warnings.
- ④ Follow all instructions.
- ⑤ Do not use this apparatus near water.
- ⑥ Clean only with dry cloth.
- ⑦ Do not block any ventilation openings. Install in accordance with the manufacturer's instructions.
- ⑧ Do not install near any heat sources such as radiators, heat registers, stoves, or other apparatus (including amplifiers) that produce heat.
- ⑨ For countries with a polarized mains, do not defeat the safety purpose of the polarized or grounding-type plug. A polarized plug has two blades with one wider than the other. A grounding type plug has two blades and a third grounding prong. The wide blade or the third prong are provided for your safety. If the provided plug does not fit into your outlet, consult an electrician for replacement of the obsolete outlet.
Caution: To prevent electric shock, match the wide blade of the plug to the wide slot, fully insert.



- ⑩ Protect the power cord from being walked on or pinched, particularly at plugs, convenience receptacles, and the point where they exit from the apparatus.
- ⑪ Only use attachments/accessories specified by the manufacturer.
- ⑫ Use only with the cart, stand, tripod, bracket, or table specified by the manufacturer or sold with the apparatus. When a cart is used, use caution when moving the cart/apparatus combination to avoid injury from tip-over.



- ⑬ Unplug this apparatus during lightning storms or when unused for long periods of time.
- ⑭ Refer all servicing to qualified service personnel. Servicing is required when the apparatus has been damaged in any way, such as power-supply cord or plug is damaged, liquid has been spilled or objects have fallen into the apparatus, the apparatus has been exposed to rain or moisture, does not operate normally, or has been dropped.
- ⑮ Battery usage CAUTION – To prevent battery leakage which may result in bodily injury, property damage, or damage to the unit:
 - Install all batteries correctly, + and - as marked on the unit.
 - Do not mix batteries (old and new or carbon and alkaline, etc.).
 - Remove batteries when the unit is not used for a long time.
- ⑯ Batteries (battery pack or batteries installed) shall not be exposed to excessive heat such as sunshine, fire or the like.
- ⑰ Apparatus shall not be exposed to dripping or splashing.
- ⑱ Do not place any sources of danger on the apparatus (e.g. liquid filled objects, lighted candles).
- ⑲ This product may contain lead and mercury. Disposal of these materials may be regulated due to environmental considerations. For disposal or recycling information, please contact your local authorities or the Electronic Industries Alliance: www.eiae.org.
- ⑳ Where the MAINS plug or an appliance coupler is used as the disconnect device, the disconnect device shall remain readily operable.



Warning

- Never remove the casing of this apparatus.
- Never lubricate any part of this apparatus.
- Never place this apparatus on other electrical equipment.
- Keep this apparatus away from direct sunlight, naked flames or heat.
- Never look into the laser beam inside this apparatus.
- Ensure that you always have easy access to the power cord, plug or adaptor to disconnect this apparatus from the power.

Hearing safety

Listen at a moderate volume.

- Using headphones at a high volume can impair your hearing. This product can produce sounds in decibel ranges that may cause hearing loss for a normal person, even for exposure less than a minute. The higher decibel ranges are offered for those that may have already experienced some hearing loss.
- Sound can be deceiving. Over time your hearing 'comfort level' adapts to higher volumes of sound. So after prolonged listening, what sounds 'normal' can actually be loud and harmful to your hearing. To guard against this, set your volume to a safe level before your hearing adapts and leave it there.

To establish a safe volume level:

- Set your volume control at a low setting.
- Slowly increase the sound until you can hear it comfortably and clearly, without distortion.

Listen for reasonable periods of time:

- Prolonged exposure to sound, even at normally 'safe' levels, can also cause hearing loss.
- Be sure to use your equipment reasonably and take appropriate breaks.

Be sure to observe the following guidelines when using your headphones.

- Listen at reasonable volumes for reasonable periods of time.
- Be careful not to adjust the volume as your hearing adapts.

- Do not turn up the volume so high that you can't hear what's around you.
- You should use caution or temporarily discontinue use in potentially hazardous situations. Do not use headphones while operating a motorized vehicle, cycling, skateboarding, etc.; it may create a traffic hazard and is illegal in many areas.



Caution

- Use of controls or adjustments or performance of procedures other than herein may result in hazardous radiation exposure or other unsafe operation.

Notice

Any changes or modifications made to this device that are not expressly approved by Philips Consumer Lifestyle may void the user's authority to operate the equipment.



This product complies with the radio interference requirements of the European Community.

Environmental information

All unnecessary packaging has been omitted. We have tried to make the packaging easy to separate into three materials: cardboard (box), polystyrene foam (buffer) and polyethylene (bags, protective foam sheet.) Your system consists of materials which can be recycled and reused if disassembled by a specialized company. Please observe the local regulations regarding the disposal of packaging materials, exhausted batteries and old equipment.

Recycling



Your product is designed and manufactured with high quality materials and components, which can be recycled and reused.

When you see the crossed-out wheel bin symbol attached to a product, it means the product is covered by the European Directive 2002/96/EC:



Never dispose of your product with other household waste. Please inform yourself about the local rules on the separate collection of electrical and electronic products. The correct disposal of your old product helps prevent potentially negative consequences on the environment and human health.

Your product contains batteries covered by the European Directive 2006/66/EC, which cannot be disposed of with normal household waste. Please inform yourself about the local rules on separate collection of batteries. The correct disposal of batteries helps prevent potentially negative consequences on the environment and human health.



The making of unauthorized copies of copy-protected material, including computer programs, files, broadcasts and sound recordings, may be an infringement of copyrights and constitute a criminal offence. This equipment should not be used for such purposes.

Recording and playback of material might require consent. See Copyright Act 1956 and The Performer's Protection Acts 1958 to 1972.

This product incorporates copyright protection technology that is protected by method claims of certain U.S. patents and other intellectual property rights owned by Macrovision Corporation and other rights owners. Use of this copyright protection technology must be authorized by Macrovision Corporation, and is intended for home and other limited viewing uses only unless otherwise authorized by Macrovision Corporation. Reverse engineering or disassembly is prohibited.



Manufactured under license from Dolby Laboratories.
"Dolby" and the double-D symbol are trademarks of Dolby Laboratories.



"DivX, DivX" Certified, and associated logos are trademarks of DivX, Inc. and are used under license.

Norge

Typeskilt finnes på apparatens underside.

Observer: Nettbryteren er sekundert innkopleet. Den innebygde nettdelen er derfor ikke frakopleet nettet så lenge apparatet er tilsluttet nettkontakten.

For å redusere faren for brann eller elektrisk støt, skal apparatet ikke utsettes for regn eller fuktighet.

This apparatus includes this label:



2 Your portable DVD player

Congratulations on your purchase, and welcome to Philips! To fully benefit from the support that Philips offers, register your product at www.philips.com/welcome.

Introduction

Your portable DVD player plays digital video discs that conform to the universal DVD Video standard. With it, you can play movies with true cinema picture quality and stereo or multi-channel sound (depending on disc and playback set-up).

You can also select sound track, subtitle languages, and different angle of view (again depending on DVD disc). Besides, you can restrict the play of discs that are not suitable for children.

You can play the following discs on the DVD player (including CD-R, CD-RW, DVD±R and DVD±RW):

- DVD-Video
- Video CD
- Audio CD
- MP3 CD
- DivX
- Discs with JPEG files

What's in the box



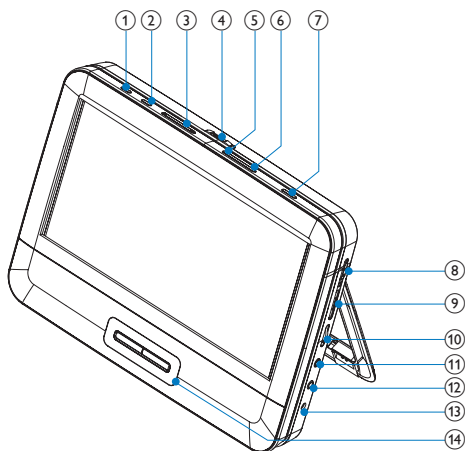

Check and identify the contents of your package:

- Main unit x 2
- AC power adaptor x 2, ASUC12E-090080(Philips)
- Car adaptor x 1
- AV cable x 2
- Car mounting bracket x 2 (AY4246)
- Carry bag x 1
- Headphone x 2 (3822)
- User Manual x 1
- Quick Start Guide x 1

Overview of the main unit



- ① **BRIGHTNESS**
 - Adjusts screen brightness.
- ② **SETUP**
 - Accesses or exits the setup menu.
- ③ **◀ ▶**
 - Skips to the previous or next title, chapter, or track.
- ④ **OPEN ▶**
 - Opens the disc compartment.
- ⑤ **DISC MENU**
 - For DVD, accesses or exits disc menu.
 - For VCD, turns on or off PBC (Playback Control) mode.
 - For VCD version 2.0 or SVCD with PBC turned on, returns to the menu.
- ⑥ **OPTIONS**
 - Accesses options relating to the current activity or selection.

- ⑦ **AV MODE**
 - Turns off the front panel display when the player is connected to TV.
- ⑧ **DVD/AV IN**
 - Switch to DVD/AV IN mode.
- ⑨ **ON/OFF**
 - Turns on/off DVD player.
- ⑩ **VOL +/-**
 - Increases or decreases volume.
- ⑪ 
 - Headphone jack.
- ⑫ **AV OUT**
 - Audio/video output jack.
- ⑬ **DC IN**
 - Power supply socket.
- ⑭ 
 - Navigates menus.
 - Searches backward/forward at different speeds.
- **OK**
 - Confirms an entry or selection.
 - Starts, pauses or resumes disc play.
- 
 - Stops disc play.

3 Get started



Caution

- Use the controls only as stated in this user manual.
- Always follow the instructions in this chapter in sequence.

If you contact Philips, you will be asked for the model and serial number of your apparatus. The model number and serial number are on the back of the apparatus. Write the numbers here:

Model No. _____

Serial No. _____

Preparation



Warning

- Remove the mounting kit and the DVD player from the seat when the DVD player is not in use.

To use the player in a car, attach the main unit and the second screen to the back of the front seat headrests.

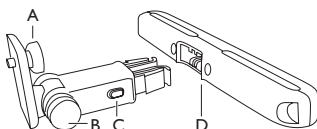

- A. DVD player fastening screw node
- B. Viewing angle adjustment node
- C. Buckle release button
- D. Headrest mount bracket

- 1 Fix the headrest mount bracket on to the front seat headrest.

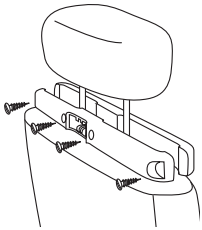

- ① Position the bracket on the bars of the headrest.
 - ② Fasten the screw to fix the bracket firmly on the bars.
- 2 Fix the DVD mount bracket to the portable DVD player.



Note

- There are three holes on the bracket. Use any one as you like.

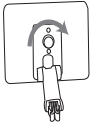

- 3 Aim the screw of the bracket to the screw nut on the back of the DVD player.
 - Screw tight the bracket onto the DVD player.
- 4 Install the DVD player to the headrest.

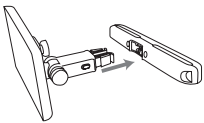

- 5 Buckle DVD bracket into the headrest mount bracket.
Adjust the viewing angle.

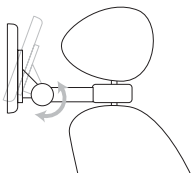

- ① Release the node.
 - ② Adjust the viewing angle as desired.
 - ③ Fasten the node.
- 6 Press the release button to release the DVD player from headrest.

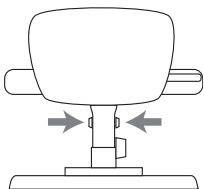

- To attach the second screen, repeat the above steps.

Connect a main unit as the second screen



Caution

- Turn off the main units before you connect a main unit as the second screen.

You can either watch movies individually on each portable DVD player or connect the DVD players together to watch one movie simultaneously on both players.

To view the same display on both DVD players.

- 1 Connect the supplied AV cable to the **AV OUT** jack of each DVD player.
- 2 Slide the **DVD/AV IN** switch on a main unit to **AV IN**.

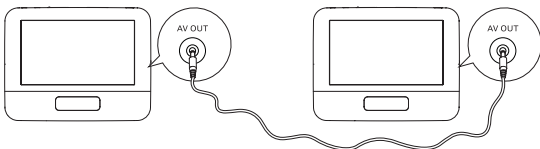

Connect power



Caution

- Risk of product damage! Ensure that the power supply voltage corresponds to the voltage pointed on the back or the underside of the player.
- Risk of electric shock! When you unplug the AC adapter, always pull the plug from the socket. Never pull the cable.

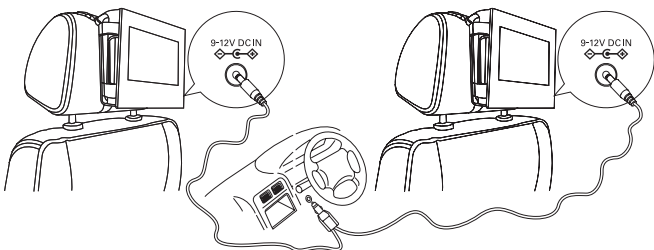

- 1 Connect one end of the double-connector end of the AC cable to the **DC IN** jacks on the main units.
- 2 Connect the one-connector end to the car cigarette lighter socket.

4 Use your player

Turn on

- 1 Slide the **POWER ON/OFF** switch on the main units to the **ON** position.

Select OSD language

You can choose a different language for the on-screen display text.

- 1 Slide the **DVD/AV IN** switch to **DVD**.
- 2 Press **SETUP**.
 - ↳ The setup menu appears.

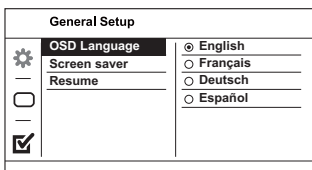

- 3 Select **[General Setup] > [OSD Language]**.
- 4 Press **▶** to select an option.
- 5 Press **▶||/OK** to confirm.
- 6 Press **SETUP** to exit.

Play discs

- 1 Slide the **DVD/AV IN** switch to **DVD**.
- 2 Slide **OPEN▶** on the main unit.
- 3 Insert the disc with label side facing you.
- 4 Push down to close the disc compartment.
 - ↳ Play starts automatically. If not, press **▶||/OK**.
 - ↳ If a menu appears, select an item, then press **▶||/OK** to start play.
 - ↳ To pause, press **▶||/OK**. Press again to resume play.
 - ↳ To stop, press **■** twice.

- ↳ To select the previous/next item, press ◀ or ▶.
- ↳ To start search within video/audio, press ◀ or ▶ once or more.

Play options

- 1 During play, press **OPTIONS** to select some play options.
- 2 Follow the on-screen instructions.

5 Adjust settings

Set the main unit

To maximize your play experience, use **SETUP** to fine tune your settings.

- 1 In DVD mode, press **SETUP**.
 - ↳ The setup menu is displayed.
- 2 Press ▲▼ to select an option and press ►||/OK to confirm.

[General Setup]	
[OSD Language]	Select on-screen display language.
[Screen Saver]	Activate/deactivate screen saver.
[Resume]	Select whether to start play from the point where it was last stopped.
[DivX(R) VOD Code] (DivX(R) VOD Code)	Display the DivX® registration code and deregistration code.
[DivX Deactivation] (DivX Deactivation)	Cancel the DivX® registration code on this product.
[Video Setup]	
[Screen Display]	Select display ratio.
[Brightness]	Adjust screen brightness.
[Contrast]	Adjust screen contrast.
[Preferences]	
[Audio]	Select audio language.
[Subtitle]	Select subtitle language.
[Disc Menu]	Select disc menu language.

[Parental Control]	Select parental level.
[Password]	Change password (3308 by default).
[Version Info]	Check the version information.
[Default]	Restore original settings.

- 3 Press ◀ to go back to previous menu level.
- 4 Press **SETUP** to exit.

6 Use more of your player

Connect additional equipment



Caution

- Turn off your player before connecting to any additional equipment.

You can connect the player to a TV or an amplifier to enjoy DVDs or Karaoke.

Match the color of the AV cables (the AV cable connected to TV is not supplied) with the jacks: the yellow cable is for the yellow video jack, the red/white cable is for the red/white audio jacks.

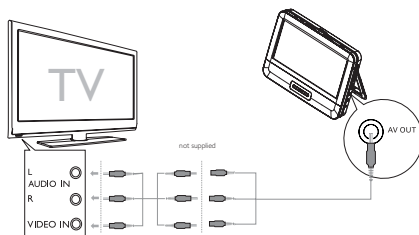



Tip

- To conserve energy, press **AV MODE** to turn off the front panel display.

Connect power from household source



Caution

- Risk of product damage! Ensure that the power supply voltage corresponds to the voltage pointed on the back or the underside of the player.
- Risk of electric shock! When you unplug the AC adaptor, always pull the plug from the socket. Never pull the cable.

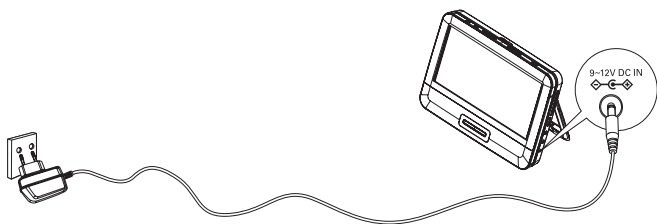

- 1 Connect the AC adaptor to:
 - the **DC IN** jack on the main unit.
 - the power outlet.

7 Product information



Note

- Product information is subject to change without prior notice.

Dimensions	240 x 183 x 38 mm
- Main unit (each)	
Weight	
- Main unit (each)	2 kg
Power supply	Input: 100-240V~ 50/60Hz 0.3A Output: DC 9V=== 0.8A minimum
Power consumption	9 W
Operating temperature range	0-45°C
Laser wavelength	650 nm
Video output	
Format	PAL & NTSC
Output level	1Vp - p ± 20%
Load impedance	75 Ω
Audio line out	
Audio out (analog audio)	Output level: 2V ± 10%
Load impedance	10 KΩ
Audio distortion + noise	≤ -80 (1KHz)
Frequency response	20Hz-20KHz ± 1dB
Signal/noise ratio	≥ 80 dB
Channel separation	≥ 80 dB
Dynamic range	≥ 80 dB

8 Troubleshooting



Warning

- Risk of electric shock. Never remove the casing of the player.

To keep the warranty valid, never try to repair the system yourself. If you encounter problems when using the player, check the following points before requesting service. If the problem remains unsolved, register your player and get support at www.philips.com/welcome.

No power

- Ensure that both plugs of the mains cord are properly connected.
- Ensure that there is power at the car cigarette lighter or AC outlet.

No sound

- Adjust the volume.
- Ensure that the AV cable is connected correctly.

Distorted picture

- Clean the disc. With a clean, soft, lint-free cloth, wipe the disc outwards from the center.
- Make sure that the video output format of the disc is compatible with the TV.
- Change the video output format to match your TV or program.
- The LCD is manufactured using high precision technology. You may, however, see tiny black points and/or bright points (red, blue, green) that continuously appear on the LCD. This is a normal result of the manufacturing process and does not indicate a malfunction.

Cannot play disc

- Ensure the disc label is upwards.
- Clean the disc. With a clean, soft, lint-free cloth, wipe the disc outwards from the center.
- Check if the disc is defective by trying another disc.

The player feels warm

- When the player is in use for a long period of time, its surface will be heated. This is normal.



© 2010 Koninklijke Philips Electronics N.V.

All rights reserved.

PD7042_12_UM_V1.0



Free Manuals Download Website

<http://myh66.com>

<http://usermanuals.us>

<http://www.somanuals.com>

<http://www.4manuals.cc>

<http://www.manual-lib.com>

<http://www.404manual.com>

<http://www.luxmanual.com>

<http://aubethermostatmanual.com>

Golf course search by state

<http://golfingnear.com>

Email search by domain

<http://emailbydomain.com>

Auto manuals search

<http://auto.somanuals.com>

TV manuals search

<http://tv.somanuals.com>