

Portable DVD Player

PET706

PET707

User manual
Manuel d'utilisation
Manual del usuario
Benutzerhandbuch



PHILIPS

1

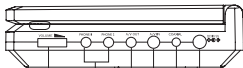
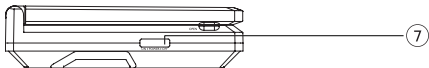
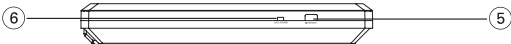
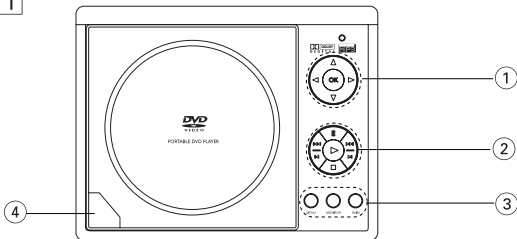

2

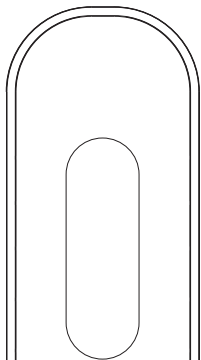
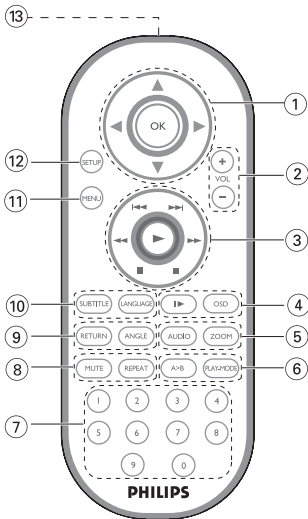

Main unit controls (see figure 1)

- ① ▲, ▼, ◀, ▶Up / down / left / right cursor
OKConfirm selection
- ② **II**Pause playback
 ▶Start / resume playback
 ■Press twice to stop playback
 ◀◀ / ▶▶For previous (◀◀) or next (▶▶) chapters, tracks or titles
 ◀ / ▶Search backward (◀) or search forward (▶)
- ③ **MENU**Display MENU page
MONITORSelection display
 ⚙ To adjust the brightness with ◀ ▶
 🎨 To adjust the color with ◀ ▶
 □ To adjust the screen of 16:9 or 4:3 with ◀ ▶
- AV-IN**A/V IN (AUX)
- ④ ▲ **OPEN**Open disc door to insert or remove disc

Front of player (see figure 1)

- ⑤ **IR REMOTE**Remote sensor
- ⑥ **CHG/POWER**Power and charging indicator

FUNCTIONAL OVERVIEW

Left of player (see figure 1)

⑦ **ON . POWER . OFF**Switch the player on / off

Right of player (see figure 1)

⑧ **VOLUME**  Volume control.

⑨ **PHONE 1 & 2**..... Headphones jack

⑩ **AV/OUT** Audio/Video output jack

⑪ **AV/IN**..... Audio/Video input jack

⑫ **COAXIAL**.....Digital audio output jack

⑬ **DC IN 9V**Power supply socket

CAUTION

Use of controls or adjustments or performance of procedures other than herein may result in hazardous radiation exposure or other unsafe operation.

REMOTE CONTROL

Remote controls (see figure 2)

- ① ▲, ▼, ◀, ▶ Up / down / left / right cursor
OK Confirms selection
- ② **VOL+** / - Volume control
- ③ ◀◀ / ▶▶ For previous (◀◀) or next (▶▶) chapters, tracks or titles
II Pauses playback
▶ Starts / resumes playback
■ Press twice to stop playback
◀◀ / ▶▶ Search backward (◀◀) or search forward (▶▶)
- ④ **OSD** **O**n **S**creen **D**isplay on / off
▶ Slow motion
- ⑤ **AUDIO** Audio language selector
ZOOM Enlarges video image
- ⑥ **A > B** To repeat or loop a sequence in a title
PLAY-MODE Selects play order options
- ⑦ **0 - 9** Numeric keypad
- ⑧ **MUTE** Muting player volume
REPEAT Repeats chapter / title / disc
- ⑨ **RETURN** For VCD menu page
ANGLE Selects DVD camera angle
- ⑩ **SUBTITLE** Subtitle language selector
LANGUAGE Language selector
- ⑪ **MENU** Displays MENU page
- ⑫ **SETUP** Enters SETUP menu
- ⑬ **Infra Red port**
- ⑭ **BATTERY COMPARTMENT**

INTRODUCTION

Your portable DVD player

Your portable DVD player plays digital video discs conforming to the universal DVD Video standard. With it, you will be able to enjoy full-length movies with true cinema picture quality, and stereo or multichannel sound (depending on the disc and on your playback set-up).

The unique features of DVD-Video, such as selection of soundtrack and subtitle languages, and of different camera angles (again depending on the disc), are all included.

What's more, parental lock lets you decide which discs your children will be able to see. You will find your player remarkably easy to use with the On-Screen Display and player display in combination with the remote control.

Unpacking

First check and identify the contents of your package, as listed below:

- Portable DVD player
- Car adaptor (12V)
- Rechargeable battery pack
- Warranty
- Remote Control
- AC power adaptor
- User Manual
- Audio / Video cable

Placement

- Place the player on a firm, flat surface.
- Keep away from domestic heating equipment and direct sunlight.
- If the player cannot read CDs/DVDs correctly, try using a commonly available cleaning CD/DVD to clean the lens before taking the player to be repaired. Other cleaning methods may destroy the lens.
- Always keep the disc door closed to avoid dust on the lens.
- The lens may cloud over when the player is suddenly moved from cold to warm surroundings. It is then not possible to play a CD/DVD. Leave the player in a warm

INTRODUCTION

Playable disc formats

In addition to DVD-Video disc, you will also be able to play all Video CDs and audio CDs (including CDR, CDRW, DVD±R and DVD±RW).

DVD-Video

Depending on the material on the disc (a movie, video clips, a drama series, etc.) these discs may have one or more Titles, and each Title may have one or more Chapters. To make access easy and convenient, your player lets you move between Titles, and also between Chapters.



Video CD

Depending on the material on the disc (a movie, video clips, a drama series, etc.) these discs may have one or more Tracks, and tracks may have one or more indexes, as indicated on the disc case. To make access easy and convenient, your player lets you move between tracks and between indexes.



Audio CD / MP3 CD

Audio CDs / MP3 CD contain music tracks only. You can play them in the conventional way through a stereo system using the keys on the remote control and/or main unit, or via the TV using the On Screen Display (OSD).



CD with JPEG files

You can also view JPEG still photos on this player.

GENERAL INFORMATION

Power Sources

This unit operates on a supplied AC adaptor, car adapter, or a rechargeable battery pack.

- Make sure that the input voltage of the AC adaptor is in line with the local voltage. Otherwise, the AC adaptor and unit may be damaged.
- Do not touch the AC adaptor with wet hands to prevent electric shock.
- When connecting with car power (cigarette lighter) adaptor, be sure the input voltage of the adaptor is identical with car voltage.
- Unplug the AC adaptor from the outlet or remove the battery pack when the unit is not used for long periods of time.
- Hold the plug to disconnect the AC adaptor. Do not pull the power cord.

Safety and maintenance

- Do not disassemble the unit for laser rays are dangerous to eyes. Any service should be done by qualified service personnel.
- Unplug the AC adaptor to cut the power if liquid or objects get inside the unit.
- Take care not to drop the unit or subject it to strong shocks, which may cause malfunction.
- Hearing safety: listen at a moderate volume. Using headphones at high volume can impair your hearing.
- Important (for models with by-packed headphones): Philips guarantees compliance with the maximum sound power of its audio players as determined by relevant regulatory bodies only with the original model of provided headphones. In case this one needs replacement, we recommend that you contact your retailer to order a model identical to that of the original provided by Philips.
- Traffic safety: do not use while driving or cycling as you may cause an accident.
- Do not expose to excessive heat caused by heating equipment or direct sunlight.
- This product is not waterproof: do not allow your player to be submersed in water. Water entering the player may cause major damage.
- Do not use any cleaning agents containing alcohol, ammonia, benzene, or abrasives as these may harm the player.
- Apparatus shall not be exposed to dripping or splashing. Do not place any sources of danger on the apparatus (e.g. liquid filled objects, lighted candles)
- Do not touch the lens!



Note: When the player is in use for a long period of time, the surface will be

GENERAL INFORMATION

Handling discs

- Do not attach paper or tape to the disc.
- Keep the disc away from direct sunlight or heat sources.
- Store the disc in a disc case after playback.
- To clean, wipe the disc outwards from the center with a soft, lint-free clean cloth.



On handling the LCD screen

The LCD is manufactured using high precision technology. You may, however, see tiny black points and/or bright points (red, blue, green) that continuously appear on the LCD. This is a normal result of the manufacturing process and does not indicate a malfunction.

Environmental information

We have reduced the packaging to its minimum and made it easy to separate into mono materials: cardboard, PS, PE and PET.

Your set consists of material which can be recycled if disassembled by a specialized company. Please observe the local regulations to dispose of packaging, exhausted batteries and old equipment.

Copyright information

All other brand and product names are trademarks of their respective companies or organizations.

Unauthorized duplication of any recordings downloaded from the internet or made from CDs / VCDs / DVDs is a violation of copyright laws and international treaties.

Windows Media and the Windows logo are trademarks, or registered trademarks of Microsoft Corporation in the United States and/or other countries.

PREPARATIONS

Power supply

Using the AC / DC adaptor

Connect the supplied adaptor to the set and the main power supply (as shown).

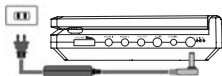

TIP

To avoid damage to the player, switch off before plugging or unplugging the AC adaptor.

Using the car adapter

Connect the supplied car adapter to the set and the car cigarette lighter outlet.



TIP

- To avoid damage to the player, switch off before plugging or unplugging the car adaptor.
- When connecting with car power (cigarette lighter) adaptor, be sure the input voltage of the adaptor is identical with car voltage.

Powering your remote control

- 1 Open the battery compartment.
Remove the protective plastic tab (first time users only).
- 2 Insert 1 x lithium 3V battery, type CR2025, then close the compartment.

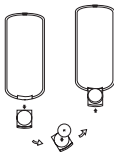

CAUTION

- Batteries contain chemical substances, so they should be disposed of properly.
 - Danger of explosion if battery is incorrectly replaced. Replace only with the same or equivalent type.
 - Incorrect use of batteries can cause electrolyte leakage and will corrode the compartment or cause the batteries to burst.
- Remove the batteries if the set is not to be used for a long time.

PREPARATIONS

Attaching and charging the battery pack*

- 1 Switch off the set. Attach the battery pack as shown.
- 2 Connect the supplied adapter to the set and the main power supply (as shown). Charge until the red indicator turns off (approximately 4.5 - 6.5 hours when unit is charged from power off).



TIP

- It is normal for the battery pack to become warm during charging.
-  is shown on the screen when battery power is running low.

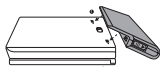

Detaching the battery pack

- 1 Switch off the set.
- 2 Unplug the AC adapter.
- 3 Turn the player upside down.
- 4 Press down the battery pack lock switch ①.
- 5 Slide off the battery pack as shown ② ③.

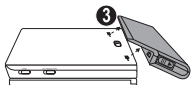
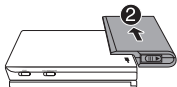

* **Rechargeable batteries have a limited number of charge cycles and may eventually need to be replaced. Battery life and number of charge cycles vary by use and settings.**

PREPARATIONS

Connections

Connecting headphones

Connect the headphones into the **PHONE 1** or the **PHONE 2** jack of your set.

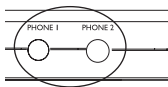

Connecting additional equipment

- Turn off your set before connecting to any additional equipment.
- You can connect the player to a TV or an amplifier to enjoy DVDs or karaoke.

AV OUT

You can connect the player to a TV.

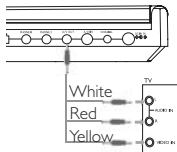

AV IN

On the DVD player panel, press **AV-IN** to select A/V IN (AUX).

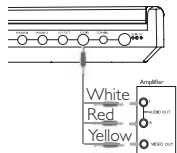

Connection	Video	Audio (Left)	Audio (right)
Color	Yellow	White	Red

PREPARATIONS

Digital Audio Out

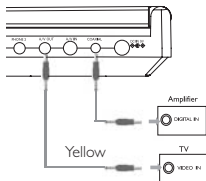

TIP

- You can also make use of the COAXIAL jack for digital audio output.
- Please refer to the user manuals of your additional equipment for more information about connection.
- Players support NTSC/PAL/AUTO television sets.

GENERAL EXPLANATION





About this manual

This manual gives the basic instructions for operating this DVD player. Some DVD discs however are produced in a way that requires specific operation or allows only limited operation during playback. In these cases the player may not respond to all operating commands. When this occurs, please refer to the instructions in the disc inlay. When a  appears on the screen, the operation is not permitted by the player or the disc.

Remote control operation

- Unless otherwise stated, all operations can be carried out with the remote control. Always point the remote control directly at the player, making sure there are no obstructions in the path of the infrared beam.
- When there are corresponding keys on the main unit, they can also be used.

Menu navigation

- Your player has an intuitive menu navigation system to guide you through various settings and operations.
- Use the function keys to activate / disable relevant operations.
- Use , , ,  to browse through menus.
- Press **OK** key to confirm your selection.

BASIC FUNCTIONS

Switching on for OSD language setup

English is the default language of your player's on screen display. You may choose to use English, French, Spanish, German, Simplified Chinese or Traditional Chinese for your player's on screen display.

Countries	OSD Language Options
European	English, French, German
American	English, French, Spanish
Asia Pacific	English, Traditional Chinese, Simplified Chinese

- 1 Slide the **POWER** switch to **ON** to switch on the player.
- 2 Press **SET UP** for the set up menu.
- 3 Select **GENERAL SETUP** and press **OK**.
- 4 Scroll and select **OSD LANG** and press **▶** to select from OSD language options.
- 5 Select your preferred language and press **OK**.



Loading discs and switching on

- 1 Press **OPEN** to open the disc door.
- 2 Insert your chosen disc, label side up (also when a double sided DVD disc is inserted). Make sure it is sitting properly in the correct recess.
- 3 Gently push to close the door.
- 4 Slide the **POWER** switch to **ON** to switch on the player.



TIP

BASIC FUNCTIONS

Playing a DVD disc

After switching on, inserting the disc and closing the door, playback starts automatically. The screen shows the type of disc loaded. The disc may invite you to select an item from a menu. Use the ▲, ▼, ◀, ▶ keys to highlight your selection, and press **OK**.

Note: Since it is usual for DVD movies to be released at different times in different regions of the world, all players have region codes and discs can have an optional region code. If you load a disc of a different region code to your player, you will see the region code notice on the screen. The disc will not play, and should be unloaded.

Playing an audio or video CD disc

- After switching on, inserting the disc and closing the door, the screen shows the type of disc loaded as well as information about the disc's contents. Press ▶ to start playback.
- While playing VCD with MTV/Karaoke, press number keys(0-9) to select the track and press ▶ or **OK** to play the track. Press **RETURN** to go back to menu of the selection.

BASIC FUNCTIONS

Playing a MP3-CD

The following playback features are available for MP3-CDs. Please refer to the corresponding sections for more information.

Volume control, skipping tracks, searching, repeat, shuffle, etc.

Use the ▲, ▼, ◀, ▶ keys to highlight your selected music folder. Press **OK** to play.

Playing a JPEG discs

Use the ▲, ▼, ◀, ▶ keys to highlight your selected picture folder. Press **OK**. The player will then automatically enter the slide show mode.

Using the full display screen, this shows the rest of the JPEG files, one-by-one, located in the selected current folder.

- Use the ◀, ▶ to rotate the picture.
- Use the ▲ to flip up/down.
- Use the ▼ to flip left/right.
- During the slide show, press **MENU** to go back to folder screen.
- Press ■ to go to group preview.
- Use the ▲, ▼, ◀, ▶ to highlight the preview picture and access the on-screen functions.

Note: Unless stated otherwise, all operations described are based on remote control operation.

GENERAL FEATURES

Moving to another title / track / chapter

When a disc has more than one title or track, you can move to another title/track/chapter as follows:

- Press **▶▶** briefly during play to select the next title/track / chapter.
- Press **◀◀** briefly during play to step back to the previous title/track/chapter.
- To go directly to any title, track or chapter, enter the corresponding number using the numerical keys (0-9).



Still picture and step frame

Press **||** once or more for the following still picture and step frame options:

 x 1	Pause / Still picture
 x 2	screen shows ▶



After the icon **||▶** is displayed, press **||** repeatedly to play frame by frame.

Press **OK** to resume normal playback.

Search

Press **▶** repeatedly for the following forward search options:

Press **◀** repeatedly for the following backward search options:

◀	▶
2 X backwards	2 X forward
4 X backwards	4 X forward
8 X backwards	8 X forward
16 X backwards	16 X forward
32 X backwards	32 X forward
normal speed	normal speed

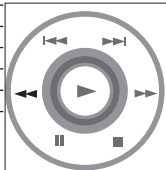

Press **OK** or **▶** to resume normal playback.

GENERAL FEATURES

Slow motion

Press **▶** once or more for the following slow play options:

x 1	1/2	x 5*	1/2 x backward
x 2	1/4	x 6*	1/4 x backward
x 3	1/8	x 7*	1/8 x backward
x 4	1/16	x 8*	1/16 x backward



Press **OK** or **▶** to resume normal playback.

**for DVDs only*

Changing the audio output

Press **AUDIO** repeatedly for the following audio options.

x 1	Mono left	x 2	Mono right
x 3	Mixed mono	x 4	Stereo



ZOOM

The Zoom function allows you to enlarge the video image and to pan through the enlarged image. Press **ZOOM** repeatedly to select the following zooming options.

Zoom x 1	2X	Zoom x 2	3X
Zoom x 3	4X	Zoom x 4	1/2
Zoom x 5	1/3	Zoom x 6	1/4
Zoom x 7	normal		



MUTE

Press **MUTE** once to mute player volume.

Press **MUTE** again to disable.



REPEAT

Press **REPEAT** repeatedly for the following repeat options:

	DVD actions	VCD actions
x 1	repeats chapter	repeats track
x 2	repeats title	repeats all
x 3	repeats all	cancel repeat
x 4	cancel repeat	



GENERAL FEATURES

Repeat A > B

To repeat or loop a sequence in a title:

- Press **A > B** at your chosen starting point;
↻ **A** appears on the screen.
- Press **A > B** again at your chosen end point;
↻ **AB** appears on the display, and the repeat sequence begins.
- To exit the sequence, press **A > B**.

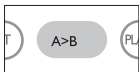

Play modes

Press **PLAY-MODE** repeatedly for the following play order options:

x 1	Shuffle	x 2	Random
x 3	Program		



Use **(0-9)** and **OK** to key in specific settings.

Volume Control

- Press + / - to increase or decrease playback volume in the Remote Control or
- Use the rotatory switch on the right side of the unit.



Monitor (on the main unit)

Press **MONITOR** repeatedly and use ◀ / ▶ to adjust brightness, color and display mode (normal or full screen).

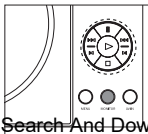

SPECIAL DVD FEATURES

Checking the contents of DVD-Video discs: **Menus**.

For titles and chapters, selection menus may be included on the disc. The DVD's menu feature allows you to make selections from these menus. Press the appropriate numerical key; or use the ▲, ▼, ◀, ▶ keys to highlight your selection, and press **OK**.

Disc menu

Press **MENU**. The menu may list, for example, camera angles, spoken language and subtitle options, and chapters for the title.



Camera angle

If the disc contains sequences recorded from different camera angles, the angle icon appears, showing the number of available angles, and the angle being shown. You can then change the camera angle if you wish.



Press **ANGLE** repeatedly until you have reached your desired viewing angle.



To resume to normal viewing angle, press **ANGLE** repeatedly until no angle related message is shown on the screen.

Changing the language

Press **LANGUAGE**. If the current disc has different language options, this now appears on the screen.



Press **LANGUAGE** repeatedly until you have reached your desired language option.

Subtitles

Press **SUBTITLES**. If the current disc has different subtitles options, this now appears on the screen.



Press **SUBTITLES** repeatedly until you have reached your desired subtitle option.

OSD OPERATIONS

In addition to using remote control keys, you can also change disc playback options from OSD.

- 1 Press **OSD** during disc playback. A list of features is shown.
- 2 Use the **▲ ▼** keys to highlight your selection.

When the cursor highlights these settings, press **OK** to:

FILE	key in desired file number
------	----------------------------

TITLE	key in desired title number
-------	-----------------------------

CHAPTER	key in desired chapter number
---------	-------------------------------

AUDIO	select audio options
-------	----------------------

SUBTITLE	select subtitle options
----------	-------------------------

ANGLE	select camera angle options
-------	-----------------------------

FILE TIME	key in starting point for file play time
-----------	--

TT TIME	key in starting point for title play time
---------	---

CH TIME	key in starting point for chapter play time
---------	---

REPEAT	select repeat options
--------	-----------------------

TIME DISP.	select time display options
------------	-----------------------------

- 3 Use **(0-9)** to key in specific settings.
- 4 Press **◀** to abort current setting or go back to previous menu level.
- 5 Press **OSD** to exit.

SETUP OPERATIONS

To maximize your playback experience, use **SETUP** to fine tune your settings. Use the ▲, ▼, ◀, ▶ keys to highlight your selection, and press **OK**.

- 1 Press **SETUP**. A list of features is shown.
- 2 Use the ▲ ▼ keys to highlight your selection.

When the cursor highlights these settings, press **OK** to:

GENERAL SETUP	select display and other options
AUDIO SETUP	select audio options
PREFERENCES	select playback preferences
PASSWORD SETUP	select password options

- 3 Press ◀ to abort current setting or go back to previous menu level.
- 4 Press **SETUP** to exit.

General Setup

When the cursor highlights these settings, press **OK** to:

TV DISPLAY	select display ratio
TV TYPE	select video standard of external TV set
OSD LANG	select on screen display language
SPDIF	select digital audio options
CAPTIONS	select captions options
SCREEN SAVER	select screen saver options

Press ◀ to abort current setting or go back to previous menu level

SETUP OPERATIONS

Audio Setup

When the cursor highlights these settings, press **OK** to:

SPEAKER SETUP	select speaker options
DOLBY DIGITAL SETUP	select Dolby sound options
CHANNEL EQUALIZER	select equalizer options
3D PROCESSING	select surround sound options

Press ◀ to abort current setting or go back to previous menu level

Preferences

When the cursor highlights these settings, press **OK** to:

AUDIO	select audio language options
SUBTITLE	select subtitle language options
DISC MENU	select disc menu language options
PARENTAL	select parental options
DEFAULT	Restore factory settings

Press ◀ to abort current setting or go back to previous menu level

Note: Parental options are only selectable when password mode is deactivated.

Password Setup

When the cursor highlights these settings, press **OK** to:

PW MODE	switch password on / off
PASSWORD	change existing password (default: 99999)

Press ◀ to abort current setting or go back to previous menu level

TROUBLESHOOTING

If it appears that the DVD-Video player is faulty, first consult this checklist. It may be that something has been overlooked.

WARNING

Under no circumstances should you try to repair the set yourself as this will invalidate the guarantee.

If a fault occurs, first check the points listed, before taking the set for repair. If you are unable to solve a problem by following these hints, consult your dealer or service centre.

Symptom

Remedy

No power

- Check if both plugs of the mains cord are properly connected.
- Check if there is power at the AC outlet by plugging in another appliance.
- Check if battery pack is inserted appropriately.
- Check if car adaptor is connected appropriately.

Distorted picture

- Check the disc for fingerprints and clean with a soft cloth, wiping from centre to edge.
- Sometimes a small amount of picture distortion may appear. This is not a malfunction.

Completely distorted picture / no colour in the TV screen

- The NTSC/PAL setting may be in the wrong status. Match your TV's setting with the player's setting.

No sound

- Check audio connections. If using a HiFi amplifier, try another sound source.

TROUBLESHOOTING

Disc can't be played

- Ensure the disc label is upwards.
- Clean the disc.
- Check if the disc is defective by trying another disc.

The player does not respond to the remote control

- Aim the remote control directly at the sensor on the front of the player. Avoid all obstacles that may interfere with the signal path. Inspect or replace the batteries.

Distorted or B/W picture with DVD

- Use only discs formatted according to the TV-set used (PAL/NTSC).

No audio at digital output

- Check the digital connections.
- Check the SETUP menu to make sure that the digital output is set to on.

Player does not respond to all operating commands during playback

- Operations are not permitted by the disc.
- Refer to the instructions in the disc inlay.

Player feels warm

- When the player is in use for a long period of time, the surface will be heated. This is normal.

Display goes dimmer when AC is unplugged

- The unit is saving power to ensure longer playtime with battery. It is normal. Adjust the brightness using MONITOR function.

This set complies with the radio interference requirements of the

European Union

TECHNICAL DATA

Dimensions	18.9 x 14.7 x 3.7 cm 7.5 x 5.75 x 1.5 inches
Weight	0.86 kg / 1.89 lb
Power supply	DC 9V 1.8A
Operating temperature range	0 - 50°C (32 ~ 122°F)
Laser wavelength	650nm
Video system	NTSC / PAL / AUTO
Frequency response	20Hz ~ 20KHz \pm 1dB
Signal/noise ratio	\geq 85dB
Audio distortion + noise	\leq -80(1KHz)
Channel separation	\geq 85dB
Dynamic range	\geq 80dB
Output	
Audio out (analog audio)	Output level: 2V \pm 10%
Load impedance:	10K Ω
Video out Output level:	1V _p - p \pm 20%
Load impedance:	75 Ω

PHILIPS reserves the right to make design and specification changes for product improvement without prior notice.

Modifications not authorized by the manufacturer may void users authority to operate this device.

All rights reserved.

Important notes for users in the UK (for /05 version only)

Mains plug

This apparatus is fitted with an approved 13 Amp plug. To change a fuse in this type of plug proceed as follows:

1. Remove fuse cover and fuse.
2. Fix new fuse which should be a BS1362 5 Amp, A.S.T.A. or BSI approved type.
3. Refit the fuse cover.

If the fitted plug is not suitable for your socket outlets, it should be cut off and an appropriate plug fitted in its place. If the mains plug contains a fuse, this should have a value of 5 Amp. If a plug without a fuse is used, the fuse at the distribution board should not be greater than 5 Amp.

Note: The severed plug must be disposed of to avoid a possible shock hazard should it be inserted into a 13 Amp socket elsewhere.

How to connect a plug

The wires in the mains lead are coloured with the following code: blue = neutral (N), brown = live (L). As these colours may not correspond with the colour markings identifying the terminals in your plug, proceed as follows:

- Connect the blue wire to the terminal marked N or coloured black.
- Connect the brown wire to the terminal marked L or coloured red.
- Do not connect either wire to the earth terminal in the plug, marked E (or e) or coloured green (or green and yellow).
- Before replacing the plug cover, make certain that the cord grip is clamped over the sheath of the lead - not simply over the two wires.

Copyright in the U.K.

Recording and playback of material may require consent. See Copyright Act 1956 and The Performer's Protection Acts 1958 to 1972.

COPYRIGHT INFORMATION

The making of unauthorized copies of copy-protected material, including computer programmes, files, broadcasts and sound recordings, may be an infringement of copyrights and constitute a criminal offence. This equipment should not be used for such purposes.

DISPOSAL OF YOUR OLD PRODUCT

Your product is designed and manufactured with high quality materials and components, which can be recycled and reused.



When this crossed-out wheeled bin symbol is attached to a product it means the product is covered by the European Directive 2002/96/EC.

Please inform yourself about the local separate collection system for electrical and electronic products.

Please act according to your local rules and do not dispose of your old products with your normal household waste. The correct disposal of your old product will help prevent potential negative consequences for the environment and human health.

INFORMATION SUR LE DROIT D'AUTEUR

Toute copie d'une oeuvre protégée par un droit d'auteur, ce incluant les programmes informatiques, les enregistrements d'images et de sons, peut être une contrefaçon d'un droit d'auteur et constituer un délit. Cet appareil ne doit pas être utilisé à cette fin.

MISE AU REBUT DE VOTRE ANCIEN PRODUIT

Votre produit a été conçu et fabriqué à l'aide de matériaux et composants de haute qualité, recyclables et réutilisables.



Le symbole de poubelle barrée sur un produit indique que ce dernier est conforme à la directive européenne 2002/96/EC.

Veillez vous renseigner sur les systèmes locaux de collecte des produits électriques ou électroniques.

Veillez à respecter les réglementations locales ; ne mettez pas au rebut vos anciens produits comme des déchets ménagers. La mise au rebut citoyenne de

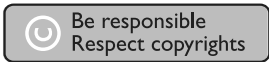

Specifications are subject to change without notice.

Trademarks are the property of Koninklijke Philips Electronics N.V.
or their respective owners

2005 © Koninklijke Philips Electronics N.V. All rights reserved.

<http://www.philips.com>



Second LCD screen

PAC130
PAC131

Register your product and get support at
www.philips.com/welcome

User manual



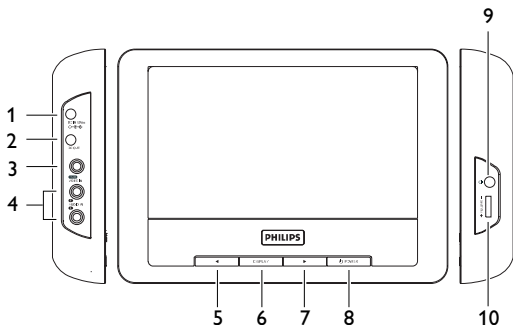

English

Congratulations on your purchase and welcome to Philips!
To fully benefit from the support that Philips offers, register your product at www.philips.com/welcome.

Content

- | | | | |
|------------|---|------------|----------------------------|
| 1 | Control elements and functional components | 2 | General information |
| 3 | Connection | 3.1 | Use in a car |
| 1.1 | Left side of the player | 3.2 | Use at home |
| 1.2 | Front of the player | 3.3 | Connect to headphone |
| 1.3 | Right side of the player | | |

3.4 Connect to camcorder

4.3 Screen brightness and contrast

4 Enjoyment

4.1 Power on

5 Troubleshooting

4.2 Volume control

6 Technical data

1 Control elements and functional components

1.1 Left side of the player (see figure 1)

- 1 **DC IN** DC power input jack
- 2 **DC OUT** DC power output jack
- 3 **VIDEO IN** Video input
- 4 **AUDIO IN** Audio input

1.2 Front of the player (see figure 1)

- 5,7 ◀ / ▶ Left/right navigation keys
- 6 **DISPLAY** Adjust the display settings of the system
- 8 **POWER** Switch the player on / off

1.3 Right side of the player (see figure 1)

- 9 **Headphone jack**
- 10 **+ VOLUME** - Volume control

2 General information

Power Sources

This unit operates on the supplied AC adaptor or car adapter.

- Make sure that the input voltage of the AC adaptor is in line with the local voltage. Otherwise, the AC adaptor and unit may be damaged.
- Do not touch the AC adaptor with wet hands to prevent electric shock.
- When connecting with car power (cigarette lighter) adaptor, be

- Unplug the AC adaptor from the outlet or remove the battery pack when the unit is not used for long periods of time.
- Hold the plug to disconnect the AC adaptor. Do not pull the power cord.

Please always use supplied AC/DC adaptor (AY4130)

Safety and maintenance

- Do not disassemble the unit for laser rays are dangerous to eyes. Any service should be done by qualified service personnel.
- Unplug the AC adaptor to cut the power if liquid or objects get inside the unit.
- Take care not to drop the unit or subject it to strong shocks, which may cause malfunction.

Hearing Safety

Listen at a moderate volume.

- Using headphones at a high volume can impair your hearing. This product can produce sounds in decibel ranges that may cause hearing loss for a normal person, even for exposure less than a minute. The higher decibel ranges are offered for those that may have already experienced some hearing loss.
- Sound can be deceiving. Over time your hearing “comfort level” adapts to higher volumes of sound. So after prolonged listening, what sounds “normal” can actually be loud and harmful to your hearing. To guard against this, set your volume to a safe level before your hearing adapts and leave it there.



To establish a safe volume level:

- Set your volume control at a low setting.
- Slowly increase the sound until you can hear it comfortably and

Listen for reasonable periods of time:

- Prolonged exposure to sound, even at normally “safe” levels, can also cause hearing loss.
- Be sure to use your equipment reasonably and take appropriate breaks.

Be sure to observe the following guidelines when using your headphones.

- Listen at reasonable volumes for reasonable periods of time.
- Be careful not to adjust the volume as your hearing adapts.
- Do not turn up the volume so high that you can't hear what's around you.
- You should use caution or temporarily discontinue use in potentially hazardous situations.
- Do not use headphones while operating a motorized vehicle, cycling, skateboarding, etc.; it may create a traffic hazard and is illegal in many areas.
- Important (for models with by-packed headphones): Philips guarantees compliance with the maximum sound power of its audio players as determined by relevant regulatory bodies only with the original model of provided headphones. In case this one needs replacement, we recommend that you contact your retailer to order a model identical to that of the original provided by Philips.
- Traffic safety: do not use while driving or cycling as you may cause an accident.
- Do not expose to excessive heat caused by heating equipment or direct sunlight.
- This product is not waterproof: do not allow your player to be submersed in water. Water entering the player may cause major damage.
- Do not use any cleaning agents containing alcohol, ammonia, benzene, or abrasives as these may harm the player.

- Apparatus shall not be exposed to dripping or splashing. Do not place any sources of danger on the apparatus (e.g. liquid filled objects, lighted candles)
- Do not touch the lens!

When the player is in use for a long period of time, the surface will be heated. This is normal.

On handling the LCD screen

The LCD is manufactured using high precision technology. You may, however, see tiny black points and/or bright points (red, blue, green) that continuously appear on the LCD. This is a normal result of the manufacturing process and does not indicate a malfunction.

Environmental information

We have reduced the packaging to its minimum and made it easy to separate into mono materials: cardboard, PS, PE and PET.

Your set consists of material which can be recycled if disassembled by a specialized company. Please observe the local regulations to dispose of packaging, exhausted batteries and old equipment.

Copyright information

All other brand and product names are trademarks of their respective companies or organizations.

3 Connection

Make sure that the primary DVD player, secondary LCD screen and any other electrical equipment are switched off before connection.

3.1 Use in a car

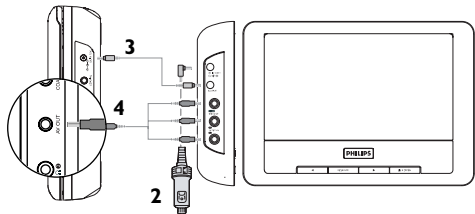

Primary DVD player

PAC13X

- 1 Mount the devices to the headrest with the mounting kits
- 2 Connect the power plug of the car adaptor to PAC13X
- 3 Connect the power source to the primary DVD player using the power cord
- 4 Connect the audio/visual cables to the devices

3.2 Use at home

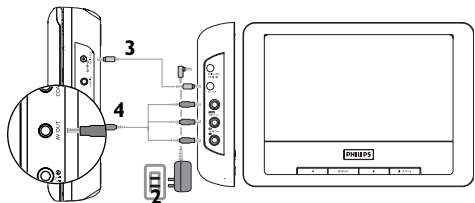

Primary DVD player

PAC13X

- 1 Connect the AC/DC power adaptor to PAC13X
 - 2 Connect the power source to the primary DVD player using the power cord
- Download from www.Somanuals.com. All Manuals Search And Download

3 Connect the audio/visual cables to the devices

3.3 Connect to headphone

Connect the headphones to the right side of the player for private listening.



3.4 Connect to camcorder

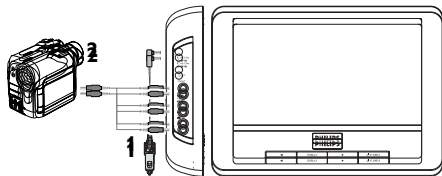

You can connect the player to your camcorder to view video on a bigger screen.

- 1 Connect PAC13X to the power source
- 2 Connect the camcorder to PAC13X using the audio/video cables

4 Enjoyment

You can adjust the volume and the brightness of the display screen during video playback.

4.1 Power on

- 1 Power on the connected device, such as the primary DVD player, camcorder etc.

- 3 PAC13X will automatically playback the video content
- 4 Power off all the devices after viewing

4.2 Volume control

Adjust the volume control on the right side of the player.

4.3 Screen brightness and contrast

- 1 Press **DISPLAY** repeatedly to set brightness or contrast.
- 2 Press ◀ or ▶ key to adjust the settings.

5 Troubleshooting

If it appears that the DVD-Video player is faulty, first consult this checklist. It may be that something has been overlooked.

WARNING Under no circumstances should you try to repair the set yourself as this will invalidate the guarantee. If a fault occurs, first check the points listed, before taking the set for repair. If you are unable to solve a problem by following these hints, consult your dealer or service centre.

Symptom	Remedy
No sound	<ul style="list-style-type: none">• Make sure that the system is properly connected.• Make sure the speakers are switched on.• Make sure the audio source is correct.
No sound	<ul style="list-style-type: none">• Make sure that the LCD screen is switched on and is in the correct video mode.• Make sure that your system connection is properly connected.• Make sure the video source is correct.

Symptom	Remedy
No video	<ul style="list-style-type: none"> • Make sure all the connected devices are switched on. • Make sure that the system is properly connected. • Make sure that video playback has already started on the primary device, such as DVD player, camcorder. • Make sure that the video out function on the primary device has been activated.

6 Technical data

TFT screen size	7 inches
Weight	0.37 kg / 0.81 lb
Power supply	DC 9~12V 2A (AY4130)
Power Consumption	≤ 20W
Operating temperature range	0 - 50°C (32 - 122°F)
Video system	NTSC / PAL / AUTO

PHILIPS reserves the right to make design and specification changes for product improvement without prior notice. Modifications not authorized by the manufacturer may void users authority to operate this device. All rights reserved.

Copyright information

The making of unauthorized copies of copy-protected material, including computer programmes, files, broadcasts and sound recordings, may be an infringement of copyrights and constitute a criminal offence. This equipment should not be used for such purposes.

Disposal of your old product



Your product is designed and manufactured with high quality materials and components, which can be recycled and reused.

When this crossed-out wheeled bin symbol is attached  to a product, it means the product is covered by the European Directive 2002/96/EC.

Please be informed about the local separate collection system for electrical and electronic products.

Please act according to your local rules and do not dispose of your old product with your normal household waste. The correct disposal of your old product will help prevent potential negative consequences to the environment and human health.



Be responsible
Respect copyrights

Specifications are subject to change without notice.

Trademarks are the property of Koninklijke Philips Electronics N.V.
or their respective owners

2008 © Koninklijke Philips Electronics N.V. All rights reserved.



Free Manuals Download Website

<http://myh66.com>

<http://usermanuals.us>

<http://www.somanuals.com>

<http://www.4manuals.cc>

<http://www.manual-lib.com>

<http://www.404manual.com>

<http://www.luxmanual.com>

<http://aubethermostatmanual.com>

Golf course search by state

<http://golfingnear.com>

Email search by domain

<http://emailbydomain.com>

Auto manuals search

<http://auto.somanuals.com>

TV manuals search

<http://tv.somanuals.com>