



Thank you for choosing Philips.

Need help fast?

Read your Quick Use Guide and/or Owner's Manual first for quick tips that make using your Philips product more enjoyable.

If you have read your instructions and still need assistance, you may access our online help at

www.philips.com/support
or call

1-888-PHILIPS (744-5477)
while with your product.



Philips vous remercie de votre confiance.

Besoin d'une aide rapide?

Les Guide d'utilisation rapide et Manuel de l'utilisateur regorgent d'astuces destinées à simplifier l'utilisation de votre produit Philips.

Toutefois, si vous ne parvenez pas à résoudre votre problème, vous pouvez accéder à notre aide en ligne à l'adresse

www.philips.com/support
ou formez le

1-800-661-6162 (Francophone)
1-888-PHILIPS (744-5477) (English speaking)

Veillez à avoir votre produit à portée de main.



Gracias por escoger Philips

Necesita ayuda inmediata?

Lea primero la Guía de uso rápido o el Manual del usuario, en donde encontrará consejos que le ayudarán a disfrutar plenamente de su producto Philips.

Si después de leerlo aún necesita ayuda, consulte nuestro servicio de asistencia en línea en

www.philips.com/support
o llame al teléfono

1-888-PHILIPS (744-5477)
y tenga a mano el producto.



PHILIPS

DEMO MODE

To turn ON

Press & HOLD



button

for 5 seconds

To turn OFF

Press & HOLD



button

for 5 seconds

PLUG & PLAY

(for tuner installation)

1



Plug in the unit

2



Follow instructions
in the display

3



Press "PLAY"

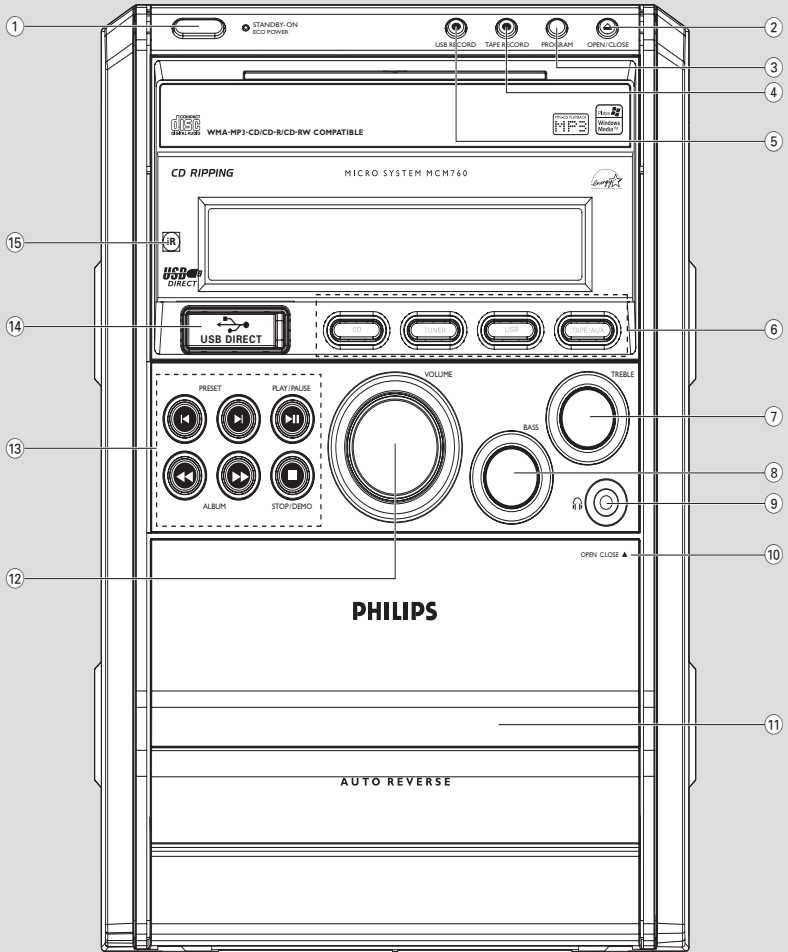



Philips
MCM760

Note : *This equipment has been tested and found to comply with the limits for a Class B digital device, pursuant to part 15 of the FCC Rules. These limits are designed to provide reasonable protection against harmful interference in a residential installation. This equipment generates, uses, and can radiate radio frequency energy and, if not installed and used in accordance with the instruction manual, may cause harmful interference to radio communications. However, there is no guarantee that interference will not occur in a particular installation. If this equipment does cause harmful interference to radio or television reception, which can be determined by turning the equipment off and on, the user is encouraged to try to correct the interference by one or more of the following measures :*

- Relocate the receiving antenna.
- Increase the separation between the equipment and receiver
- Connect the equipment into an outlet on a circuit different from that to which the receiver is connected.
- Consult the dealer or an experienced radio/TV technician for help.

IMPORTANT !

modifications not authorized by the manufacturer may void users authority to operate this device.

Remarque : *Cet équipement a été testé et a été certifié conforme aux limites imposées pour un appareil numérique de Classe B, conformément à la partie 15 des règlements FCC. Ces limites sont définies aux fins d'assurer une protection raisonnable contre les interférences nuisibles dans une installation résidentielle. Cet équipement génère, utilise et émet des fréquences radio qui, en cas d'une mauvaise installation ou d'une utilisation non-conforme aux instructions de ce manuel d'utilisation peuvent causer des interférences nuisibles aux communications radio. Il n'y a toutefois aucune garantie que des interférences nuisibles ne se produiront pas dans une installation donnée. Si cet équipement cause des interférences nuisibles avec votre poste radio ou de télévision, ce que vous pouvez déterminer en éteignant et en rallumant votre équipement, il est conseillé à l'utilisateur d'essayer de pallier à ces interférences nuisibles en prenant l'une ou l'autre des mesures suivantes:*

- Changez la position de l'antenne de réception.
- Augmentez la séparation entre l'équipement et le récepteur.
- Branchez l'équipement sur une source d'alimentation différente de celle sur laquelle le récepteur est branché.
- Consultez votre distributeur ou un technicien qualifié en la matière pour assistance.

IMPORTANTE !

las modificaciones no autorizadas por el fabricante pueden anular la autoridad de los usuarios para utilizar este aparato.

Nota : *Este aparato ha sido probado y cumple con los límites correspondientes a un aparato digital de Clase B, según la parte 15 de las Normas FCC. Estos límites han sido diseñados para facilitar suficiente protección frente a interferencias perjudiciales en una instalación residencial. Este aparato genera, utiliza y puede emitir energía de frecuencias de radio y, si no se instala y utiliza según el manual de instrucciones, puede provocar interferencias perjudiciales en las comunicaciones de radio. Sin embargo, no existe garantía de que las interferencias no ocurrirán en una instalación particular. Si este aparato provoca interferencias perjudiciales en la recepción de radio o televisión, que se puede identificar encendiendo y apagando el aparato, recomendamos al usuario que intente solucionar las interferencias siguiendo una o más de las siguientes medidas:*

- Cambie la posición de la antena receptora.
- Aumente la separación entre el aparato y el receptor.
- Conecte el aparato a una toma de un circuito diferente al que está conectado el receptor.
- Consulte con el distribuidor o un técnico de radio/TV con experiencia para que le ayuden.

¡IMPORTANTE!

modificações não autorizadas pelo fabricante, podem causar danos na operação deste aparelho.

Return your Product Registration Card today to get the very most from your purchase.

Registering your model with PHILIPS makes you eligible for all of the valuable benefits listed below, so don't miss out. Complete and return your Product Registration Card at once to ensure:

*Proof of Purchase

Returning the enclosed card guarantees that your date of purchase will be on file, so no additional paperwork will be required from you to obtain warranty service.

*Product Safety Notification

By registering your product, you'll receive notification - directly from the manufacturer - in the rare case of a product recall or safety defect.

*Additional Benefits of Product Ownership

Registering your product guarantees that you'll receive all of the privileges to which you're entitled, including special money-saving offers.

Know these safety symbols



 This “bolt of lightning” indicates uninsulated material within your unit may cause an electrical shock. For the safety of everyone in your household, please do not remove product covering.

 The “exclamation point” calls attention to features for which you should read the enclosed literature closely to prevent operating and maintenance problems.

For Customer Use

Enter below the Serial No. which is located on the rear of the cabinet. Retain this information for future reference.

Model No. _____

Serial No. _____

WARNING: TO PREVENT FIRE OR SHOCK HAZARD, DO NOT EXPOSE THIS EQUIPMENT TO RAIN OR MOISTURE.

CAUTION: To prevent electric shock, match wide blade of plug to wide slot, fully insert.

PHILIPS

***Congratulations on your purchase,
and welcome to the “family!”***

Dear PHILIPS product owner:

Thank you for your confidence in PHILIPS. You've selected one of the best-built, best-backed products available today. We'll do everything in our power to keep you happy with your purchase for many years to come.

As a member of the PHILIPS “family,” you're entitled to protection by one of the most comprehensive warranties and outstanding service networks in the industry. What's more, your purchase guarantees you'll receive all the information and special offers for which you qualify, plus easy access to accessories from our convenient home shopping network.

Most importantly, you can count on our uncompromising commitment to your total satisfaction.

All of this is our way of saying welcome - and thanks for investing in a PHILIPS product.

P.S. To get the most from your PHILIPS purchase, be sure to complete and return your Product Registration Card at once.

English 8

Français 37

Español 68

English

Français

Español

Canada

English:

This digital apparatus does not exceed the Class B limits for radio noise emissions from digital apparatus as set out in the Radio Interference Regulations of the Canadian Department of Communications.

Français:

Cet appareil numérique n'émet pas de bruits radioélectriques dépassant les limites applicables aux appareils numériques de Class B prescrites dans le Règlement sur le Brouillage Radioélectrique édicté par le Ministère des Communications du Canada.

IMPORTANT SAFETY INSTRUCTIONS

1. **Read these instructions.**
2. **Keep these instructions.**
3. **Heed all warnings.**
4. **Follow all instructions.**
5. **Do not use this apparatus near water.**
6. **Clean only with a piece of dry cloth.**
7. **Do not block any ventilation openings. Install in accordance with the manufacturer's instructions.**
8. **Do not install near any heat sources** such as radiators, heat registers, stoves, or other apparatus (including amplifiers) that produce heat.

9. **Do not defeat the safety**

purpose of the polarized or

grounding-type plug. A polarized plug has two blades with one wider than the other. A grounding type plug has two blades and a third grounding prong. The wide blade or the third prong are provided for your safety. If the provided plug does not fit into your outlet, consult an electrician for replacement of the obsolete outlet.

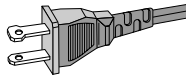

AC Polarized Plug

10. **Protect the power cord** from being walked on or pinched, particularly at plugs, convenience receptacles, and the point where they exit from the apparatus.
11. **Only use attachments/accessories** specified by the manufacturer.

12. **Use only with the cart**, stand, tripod, bracket, or table specified by the manufacturer or sold with the apparatus. When a cart is used, use caution when moving the cart /apparatus combination to avoid injury from tip-over.



13. **Unplug this apparatus** during lightning storms or when unused for long periods of time.
14. **Refer all servicing** to qualified service personnel. Servicing is required when the apparatus has been damaged in any way, such as power-supply cord or plug is damaged, liquid has been spilled or objects have fallen into the apparatus, the apparatus has been exposed to rain or moisture, does not operate normally, or has been dropped.

15. **Battery usage CAUTION** – To prevent battery leakage which may result in bodily injury, property damage, or damage to the unit:

Install **all** batteries correctly, + and - as marked on the unit.

Do not mix batteries (**old** and **new** or **carbon** and **alkaline**, etc.).

Remove batteries when the unit is not used for a long time.

16. **Apparatus shall not be exposed to dripping or splashing.**
17. **Do not place any sources of danger on the apparatus** (e.g. liquid filled objects, lighted candles).
18. This product may contain lead and mercury. Disposal of these materials may be regulated due to environment considerations.
For disposal or recycling information, please contact your local authorities or the Electronic Industries Alliance: www.eiae.org.

EL 6475-S004: 03/12

Class II equipment symbol



This symbol indicates that the unit has a double insulation system

General Information

Supplied accessories	10
Environmental information	10
Safety information	10

Controls

Controls on the set	11
Remote control	12-13

Installation

Rear connections	14-15
Speaker connections	
Antenna connections	
Connecting an additional appliance	15-16
Connecting a USB device or memory card	
Connecting a non-USB device	
Using AC power	16

Preparations

Using the remote control	17
Setting the clock	17

Basic Functions

Switching on/off the set	18
Displaying the clock	18
Display adjustment	18
Volume control	19
Volume adjustment	
MUTE	
Sound control	19
Incredible surround	
Bass/Treble	

CD

Discs for playback	20
Playing discs	20-21
Selecting and searching	21
Selecting a different track	
Finding a passage within a track during playback	
Programming tracks	22
Erasing the program	
Different play modes: REPEAT, SHUFFLE	23
Display track information	
(MP3/WMA only)	23

Tuner

Tuning to radio stations	24
Programming radio stations	24-25
Plug & Play	
Autostore: Automatic programming	
Manual programming	
To listen to a preset station	
Deleting a preset radio station	

USB

Using a USB mass storage device	26
Playing a USB mass storage device	27
Recording to a USB mass storage device	
.....	27-28

TAPE

Playing a tape	29
Recording to a tape	
.....	29-30

AUX

AUX (Listening to an external source)	31
---	----

Timer

Setting the timer	31-32
Activating and deactivating TIMER	32
Temporarily deactivating TIMER	32

SLEEP

.....	32
-------	----

Demonstration mode

.....	32
-------	----

Specifications

.....	33
-------	----

Maintenance

.....	33
-------	----

Troubleshooting

.....	34-35
-------	-------

Supplied accessories

- 2 speaker boxes including 2 speaker cables
- remote control and two AA batteries
- AM loop antenna
- FM wire antenna
- AC power cord

Environmental Information

All unnecessary packaging has been omitted. We have tried to make the packaging easy to separate into three materials: cardboard (box), polystyrene foam (buffer) and polyethylene (bags, protective foam sheet).

Your system consists of materials which can be recycled and reused if disassembled by a specialized company. Please observe the local regulations regarding the disposal of packaging materials, exhausted batteries and old equipment.

The set complies with the FCC-Rules, Part 15 and with RSS-210 of Industry Canada.

Operation is subject to the following two conditions:

- 1. this device may not cause harmful interference, and**
- 2. this device must accept any interference received, including interference that may cause undesired operation.**

The set complies with the FDA/DHHS Rule 21 CFR Subchapter J in effect at Date of Manufacture

Safety Information

- Place the system on a flat, hard and stable surface.
- Place the system in a location with adequate ventilation to prevent internal heat build-up in your system. Allow at least 10 cm (4 inches) clearance from the rear and the top of the unit and 5 cm (2 inches) from each side.
- The ventilation should not be impeded by covering the ventilation openings with items, such as newspapers, table-cloths, curtains, etc.
- Do not expose the system, batteries or discs to excessive moisture, rain, sand or heat sources caused by heating equipment or direct sunlight.
- No naked flame sources, such as lighted candles, should be placed on the apparatus.
- No objects filled with liquids, such as vases, shall be placed on the apparatus.
- If the system is brought directly from a cold to a warm location, or is placed in a very damp room, moisture may condense on the lens of the disc unit inside the system. Should this occur, the CD player would not operate normally. Leave the power on for about one hour with no disc in the system until normal playback is possible.
- The mechanical parts of the set contain self-lubricating bearings and must not be oiled or lubricated.
- **When the system is switched to Standby mode, it is still consuming some power. To disconnect the system from the power supply completely, remove the AC power plug from the wall socket.**

Controls on the set (illustrations on page 3)

① STANDBY-ON/ECO POWER

- press briefly to switch the set on or to ECO POWER (power-saving mode);
- press and hold to switch the set to standby mode
- **Red indicator:** lights up red when the set is switched to ECO POWER mode

② OPEN/CLOSE ▲

- opens/closes the CD door

③ PROGRAM

- **CD/USB:** programs tracks
- **Tuner:** programs preset radio stations

④ TAPE RECORD

- starts recording to a tape

⑤ USB RECORD

- starts recording to a USB mass storage device

⑥ Source buttons CD

- selects **CD** source
- **In standby or Eco Power mode:** switches the set on and selects **CD** source

TUNER

- selects **TUNER** source and toggles between the wavebands: FM and AM
- **In standby or Eco Power mode:** switches the set on and selects **TUNER** source

USB

- selects **USB** source
- **In standby or Eco Power mode:** switches the set on and selects **USB** source

TAPE/AUX

- selects **TAPE** source or the audio input from an additional connected appliance
- **In standby or Eco Power mode:** switches the set on and selects **TAPE** source or the audio input from an additional connected appliance

⑦ TREBLE

- selects a desired TREBLE (high tone) level

⑧ BASS

- selects a desired BASS (low tone)

⑨

- 3.5 mm headphone socket

Helpful hints:

- *Adjust the volume to a moderate level before you plug in the headphones.*
- *Connecting headphones will switch off the speakers.*

⑩ OPEN/CLOSE ▲

- opens/closes the tape deck door

⑪ Tape deck

⑫ VOLUME

- adjusts the volume level

⑬ PRESET ◀|▶

- **CD/USB:** skips CD tracks backwards/forwards
- **TUNER:** selects a preset radio station.
- **TAPE:** selects other side of the tape

ALBUM ◀◀ ▶▶

- **CD/USB:** selects albums (for MP3/WMA only)
- **CD:** searches backward/forward
- **TUNER:** tunes to radio stations
- **TAPE:** rewind or fast forward
- **CLOCK:** sets the hours or minutes

PLAY/ PAUSE ▶ II

- **CD/USB:** starts or pauses playback
- **TAPE:** starts playback
- **CLOCK:** toggles between hour and minutes setting
- **TUNER:** enters Plug & Play mode and/or starts preset radio station installation

STOP/DEMO ■

- **CD/USB:** stops playback or recording; erase a program
- **TUNER:** press and hold to erase a preset radio station
- **TAPE:** stops playback or recording
- **In standby or Eco Power mode:** press and hold to turn on/off the demonstration mode

⑭

- jack for the external USB mass storage device

⑮ IR

- sensor for the infrared remote control
- **Helpful hints:** *Always point the remote control towards this sensor.*

Remote control

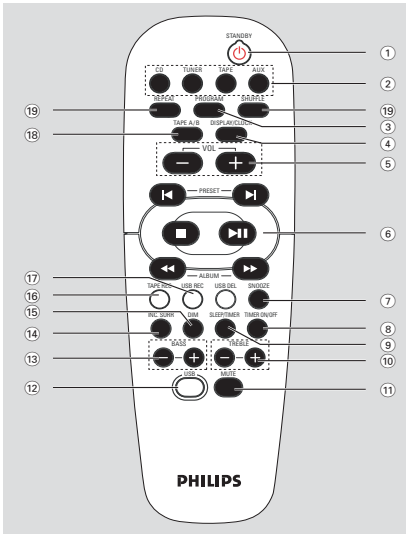

Notes for remote control:

- First select the source you wish to control by pressing one of the source select keys on the remote control (for example **CD, TUNER**).
- Then select the desired function (for example **▶ II**, **◀**, **▶**).

① **STANDBY**

- press briefly to switch the set to **ECO POWER** (power-saving mode);
- press and hold to switch the set to standby mode

② **Source buttons**

CD

- selects **CD** source
- **In standby or Eco Power mode:** switches the set on and selects **CD** source

TUNER

- selects **TUNER** source and toggles between the wavebands: FM and AM
- **In standby or Eco Power mode:** switches the set on and selects **TUNER** source

TAPE

- selects **TAPE** source
- **In standby or Eco Power mode:** switches the set on and selects **TAPE** source

AUX

- selects the audio input from an additional connected appliance
 - **In standby or Eco Power mode:** switches the set on and selects the audio input from an additional connected appliance
- ### ③ **PROGRAM**
- **CD/USB:** programs tracks
 - **Tuner:** programs preset radio stations
- ### ④ **DISPLAY/CLOCK**
- **Clock:** - displays the set time
 - enters the clock setting mode (press and hold for more than 2 seconds)
 - **TUNER/Audio CD:** switches between clock display and playback display
 - **MP3/WMA files:** displays disc information during playback

⑤ **VOLUME**

- adjusts the volume level

⑥ **PRESET ◀ / ▶**

- **CD/USB:** skips CD tracks backwards/forwards
- **TUNER:** selects a preset radio station.
- **TAPE:** selects other side of the tape
- **■**
- **CD/USB:** stops playback or recording; erase a program
- **TUNER:** press and hold to erase a preset radio station
- **TAPE:** stops playback or recording
- **▶ II**
- **CD/USB:** starts or pauses playback
- **TAPE:** starts playback
- **CLOCK:** toggles between hour and minutes setting
- **ALBUM ◀◀ / ▶▶**
- **CD/USB:** selects albums (for MP3/WMA only)
- **CD:** searches backward/forward
- **TUNER:** tunes to radio stations
- **TAPE:** rewind or fast forward
- **CLOCK:** sets the hours or minutes

- ⑦ **SNOOZE**
 - Temporarily deactivate the timer
- ⑧ **TIMER ON/OFF**
 - turns the timer on/off
- ⑨ **SLEEP/TIMER**
 - set the sleep timer
 - displays the timer setting
 - enters the timer setting mode (press and hold for more than 2 seconds)
- ⑩ **TREBLE (+ -)**
 - Selects a desired TREBLE (high tone) level
- ⑪ **MUTE**
 - switches the sound off temporarily
- ⑫ **USB**
 - selects **USB** source
 - **In standby or Eco Power mode:** switches the set on and selects **USB** source
- ⑬ **BASS (+ -)**
 - Selects a desired BASS (low tone) level
- ⑭ **INC. SURR.**
 - Turns on/off the incredible surround sound effect
- ⑮ **DIM**
 - Selects different levels of brightness for display panel
- ⑯ **TAPE REC**
 - starts recording to a tape
- ⑰ **USB REC**
 - starts recording to a USB mass storage device
- USB DEL**
 - delete files from a USB mass storage device
- ⑱ **TAPE A/B**
 - selects the desired tape playback modes : one side, both sides or auto replay
- ⑲ **REPEAT**
 - selects continuous playback
- SHUFFLE**
 - selects random playback

The making of unauthorized copies of copy-protected material, including computer programs, files, broadcasts and sound recordings, may be an infringement of copyrights and constitute a criminal offence. This equipment should not be used for such purposes.

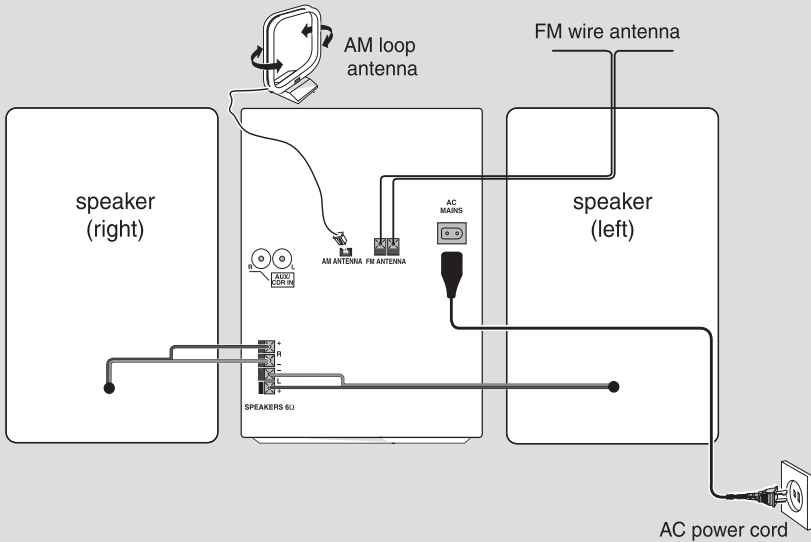

Rear connections

Warning:

- Never make or change connections with the mains supply switched on.
- Install your set near the AC outlet and where the AC power plug can be reached easily.

A Speaker connections

Use the supplied speakers only. Using other speakers can damage the set or the sound quality will be negatively affected.

- Connect the cable of the left speaker to **L +/-** (red and black) and the cable of the right speaker to **R +/-** (red and black) as follows:
 - a. Press the clip of the red terminal and fully insert the stripped portion of the colored (or marked) speaker cable into the socket, then release the clip
 - b. Press the clip of the black terminal and fully insert the stripped portion of the black (or unmarked) speaker cable into the socket, then release the clip

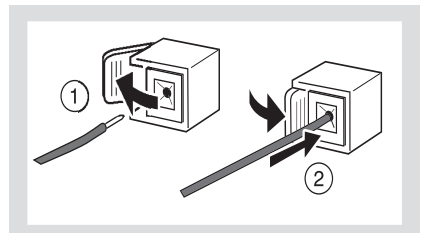

B Antenna connections AM antenna

- 1 Assemble the loop antenna as shown:

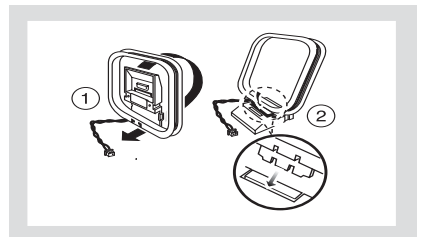

- 2 Fit the plug of the loop antenna to AM ANTENNA as shown below
- 3 Adjust the position of the antenna for optimal reception (as far away as possible from the TV, VCR or other radiation sources)

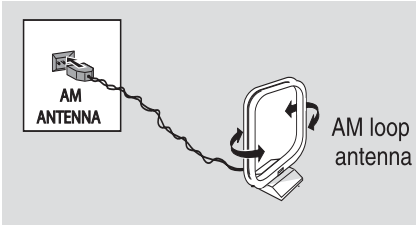

FM antenna

The wire antenna supplied can only be used to receive nearby stations. For better reception we recommend using a cable antenna system or an outdoor antenna.

- 1 Extend the wire antenna and fit it to FM ANTENNA as shown below

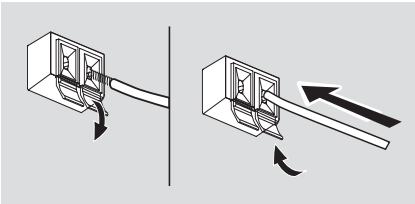

Note: If you are using a cable antenna system or an outdoor antenna, fit the antenna plug, instead of the wire antenna, to FM ANTENNA .

- 2 Move the antenna in different positions for optimal reception (as far away as possible from the TV, VCR or other radiation sources)
- 3 Fix the antenna's end to the wall

Connecting an additional appliance

Connecting a USB device or memory card

On MCM760, you can playback music from a USB mass storage device and also record music to such a device.

- 1 Insert the USB device's USB plug into the socket  on MCM760

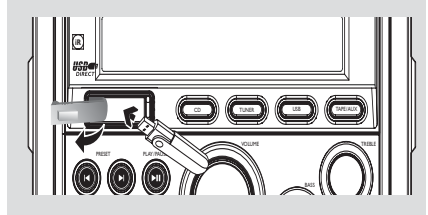

or

for the devices with USB cable:

- a. Insert one plug of the USB cable (not supplied) to the socket  on MCM760
- b. Insert the other plug of the USB cable to the USB output terminal of the USB device

or

for the memory card:

- a. Insert the memory card into a card reader (not supplied)
- b. Use a USB cable (not supplied) to connect the card reader to the socket  on MCM760

Connecting a non-USB device

It is possible to use an additional appliance, e.g. TV, VCR or CD recorder with the set. On MCM760, you can playback music from an external source.

- 1 Insert the red plug of the red/white audio cables (not supplied) to the red socket **AUX/CDR IN R** and the white plug to the white socket **AUX/CDR IN L**
- 2 Connect the other end of the audio cables to the **AUDIO OUT** terminals of the additional appliance

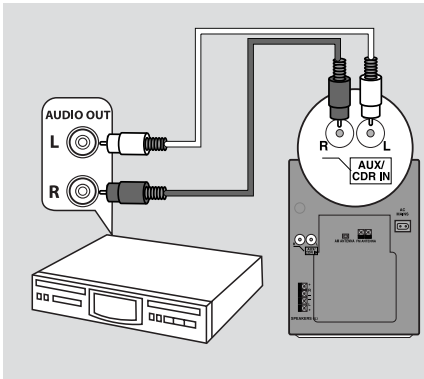

- 3 Select **AUX** mode on MCM760

Helpful hints:

– Always refer to the owner's manual of other equipment for complete connection.

Using AC power

- 1 Make sure all the connections have been made before switching on the power supply
- 2 Connect the AC power cord to the wall socket. This switches on the power supply
→ **AUTO INSTALL – PRESS PLAY** appears the first time you power up MCM760
 - Press **▶||** on the set to store all available radio stations
 - Press **■** to exit (See **Tuner**)

When MCM760 is switched to standby, it is still consuming some power: **To disconnect the system from the power supply completely, remove the power plug from the wall socket.**

The type plate is located on the rear of the set.

CAUTION

Visible and invisible laser radiation. If the cover is open, do not look at the beam.

High voltage! Do not open. You run the risk of getting an electric shock.

The machine does not contain any user-serviceable parts.

Modification of the product could result in hazardous radiation of EMC or other unsafe operation.

If you disconnect the product from the mains, make sure to take the plug out of the wall socket completely.

Children could seriously injure themselves as the free end of the cable may still be live if only the connector is removed from the MAINS socket at the back of the unit.

Using the remote control

IMPORTANT!

- Always point the remote control directly towards IR area.

Notes for remote control:

- First select the source you wish to control by pressing one of the source select keys on the remote control (for example CD, TUNER).
- Then select the desired function (for example ►||, ◀◀, ▶▶).

Inserting batteries into the remote control

- 1 Open the battery compartment
- 2 Insert 2 batteries type R06 or AA into the battery compartment with the correct polarity as indicated by the "+" and "-" symbols inside the battery compartment
- 3 Put back the compartment door

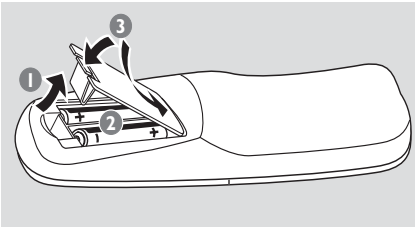

CAUTION!

- Remove batteries if they are exhausted or will not be used for a long time.
- Do not use old and new or different types of batteries in combination.
- Batteries contain chemical substances, so they should be disposed of properly.

Setting the clock

After connecting MCM760 to the power supply, set the clock first.

- 1 On the remote control, press and hold **DISPLAY/CLOCK** until the clock time starts flashing
 → The display shows the set time
 → 12:00 AM appears by default if you have not set the clock
- 2 Press **PROGRAM** repeatedly to change between 12-hour and 24-hour clock mode
- 3 Press ◀◀ or ▶▶ repeatedly to set the hour
- 4 Press ►|| to change to minutes setting, then press ◀◀ or ▶▶ repeatedly to set the minutes
- 5 Press **DISPLAY/CLOCK** again to store the setting.
 → The clock will start working.

Helpful hints:

- The clock setting will be erased when the system is disconnected from the power supply.
- The set will exit from the clock setting mode if no button is pressed within 90 seconds.

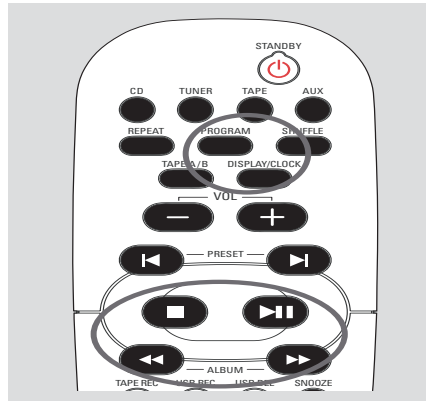

Basic Functions

Switching on/ off the set

- 1 To switch on, press the source button **CD**, **TUNER**, **USB** or **TAPE/AUX** on the set (or on the remote control, **CD**, **TUNER**, **TAPE**, **AUX**, **USB**)
→ The selected source lights up blue
- 2 Press **STANDBY-ON/ ECO POWER** briefly to switch the set to ECO POWER (power-saving mode) (or Φ on the remote control)
→ **ECO PWR** scrolls on the display
→ The display is switched off
→ The **Red** indicator lights up

OR

Press and hold **STANDBY-ON/ ECO POWER** to switch the set to standby mode (or Φ on the remote control)
→ The clock is displayed

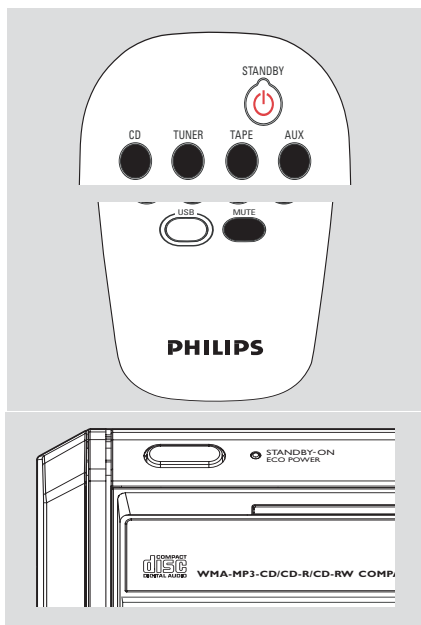

Helpful hints:

– In standby mode, pressing **DISPLAY/CLOCK** button will switch the system to **ECO POWER** mode.

Displaying the clock

- During playback, press **DISPLAY/CLOCK** on the remote control repeatedly to switch between the clock display and the playback display

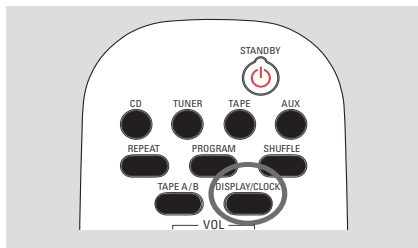

Helpful hints:

– When playing **MP3** files, you will get track information by pressing **DISPLAY/CLOCK**.

Display adjustment

You can select the desired brightness for the display panel.

- On the remote control, press **DIM** repeatedly to select DIM 1, DIM 2, DIM 3 or DIM OFF
→ **DIM** appears if DIM is activated

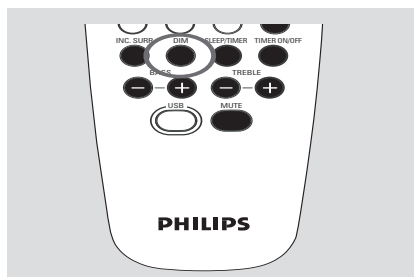

Volume control

Volume adjustment

- Adjust the volume by using the **VOLUME** rotary on the set or by pressing **VOL +/-** on the remote control
 - **VOL MUTE** is the minimum volume level
 - **0 dB** is the maximum volume level

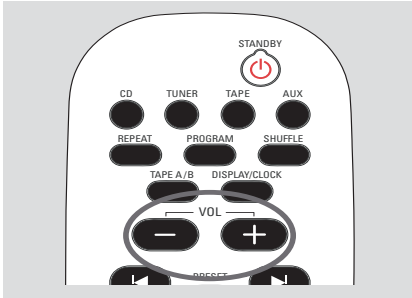

MUTE

You can temporarily switch off the sound without switching off the set.

- Press **MUTE** on the remote control to switch off the sound
 - **MUTE** appears. Playback continues without sound
- To switch on the sound, you can:
 - press **MUTE** again;
 - adjust the volume controls

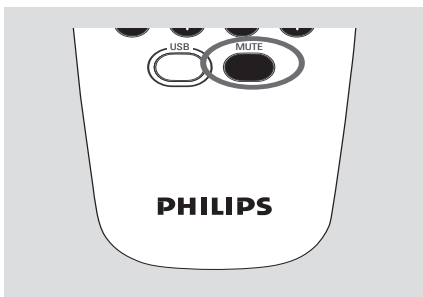

Sound control

Incredible surround

- Press **INC. SURR.** once or more to turn the surround sound effect on or off
 - **INCREDIBLE SURROUND** appears if activated
 - **IS OFF** appears if deactivated

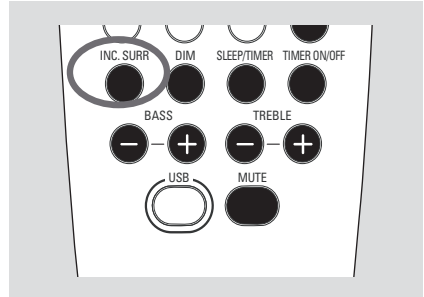

Bass/Treble

The **BASS** (low tone) and **TREBLE** (high tone) feature enables you to define the sound-processor settings.

- Adjust **BASS** or **TREBLE** (or press **BASS +/-** / **TREBLE +/-** on the remote control) repeatedly to select the desired Bass or Treble level
 - "**BASS xx**" or "**TREBLE xx**" appears, where "xx" denotes the level as follows:
Min → -2 ... → 0 → 1... → +2 → Max ...

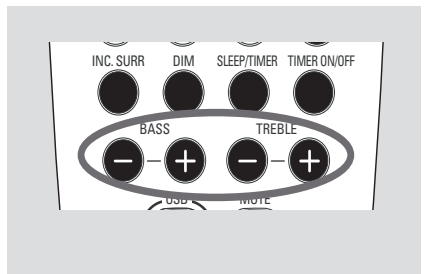

Discs for playback

With this system, you can play

- all pre-recorded audio CDs (CDDA)
- all finalized audio CD-Rs and CD-RWs
- MP3/WMA-CDs (CD-Rs/CD-RWs with MP3/WMA files)



IMPORTANT!

– **This system is designed for regular discs. Therefore, do not use any accessories such as disc stabilizer rings or disc treatment sheets, etc.**

About MP3/WMA

The music compression technology MP3 (MPEG1 Audio Layer 3) and WMA (Windows Media Audio) significantly reduces the digital data of an audio CD while maintaining CD quality sound.

Windows Media Audio® is a registered trademark of Microsoft Corporation.

Supported formats:

- Disc format ISO9660, Joliet, UDF 1.5 and multi-session CDs
- MP3 bit rate (data rate): 32-256 Kbps and variable bit rate
- Directory nesting up to a maximum of 8 levels
- Supported sampling frequencies: 32 kHz, 44.1 kHz, 48 kHz
- Maximum title number : 400 (depending on filename length)
- Maximum album number : 40
- WMA v9 or earlier



The system will not play or support the following:

- Empty albums: an empty album is an album that does not contain MP3/WMA files, and will not be shown in the display.
- Non-supported file formats are skipped. This means that e.g.: Word documents .doc or MP3 files with extension .dlf are ignored and will not be played.
- DRM protected WMA files
- WMA files in Lossless or VBR format

IMPORTANT!

- Make sure that the file names of MP3 files end with .mp3.
- For DRM protected WMA files, use Windows Media Player 10 (or later) for CD burning/conversion. Visit www.microsoft.com for details about Windows Media Player and WM DRM (Windows Media Digital Rights Management).

Playing discs

- 1 Press **CD** to select **CD** source
 - The CD icon  appears
 - The selected CD source lights up blue
- 2 Press **OPEN/CLOSE**  to open the CD compartment
 - **OPEN** is displayed

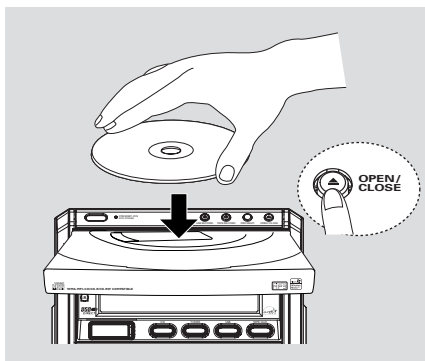

- 3 Insert a disc with the printed side facing up. Press **OPEN/CLOSE**  again to close the compartment
 - **READING** is displayed as the CD player scans the contents of a disc
 - **Audio CD**: the total number of tracks and playing time are shown
 - MP3/WMA**: Display shows current album number "R x x" and current track number "T x xx"

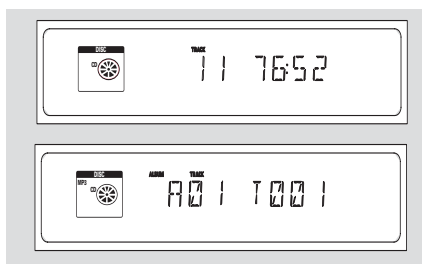

Helpful hints:

– If you have not organized MP3/WMA files into any albums on your disc, an album "01" will be automatically assigned for all those files.

- 4 Press ► || to start playback
→ Display shows current track number and elapsed playing time

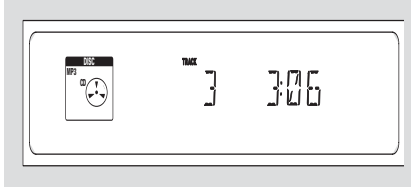

- 5 To pause playback, press ► ||. To resume playback, press the button again
- 6 To stop playback, press **STOP** ■

Helpful hints:

CD play will also stop when

- the CD door is opened
- the disc has reached the end
- you select another source: **TUNER, USB or TAPE/AUX**

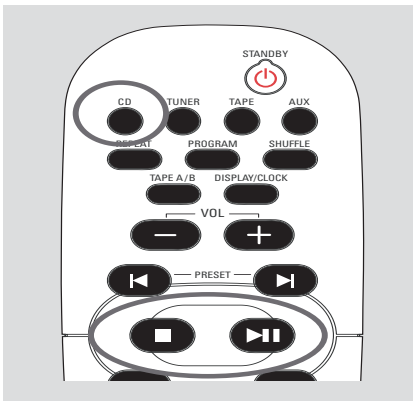

Selecting and searching

Selecting a different track

- Press ◀ or ▶ once or repeatedly until the desired track number appears in the display
MP3/WMA: → Track information scrolls briefly

MP3/WMA:

- Press **ALBUM** ◀ / ▶ once or more to select the next or previous album (or ◀ / ▶ on the remote control)
→ Track information scrolls briefly
or
- In the stop position, press ◀ / ▶ and ◀ or ▶ to select the desired album and track
→ **MP3/WMA:** Display shows current album/ track number

Finding a passage within a track during playback

- 1 During playback, press and hold ◀ or ▶
→ The CD plays at a high speed
- 2 When you recognize the passage you want, release ◀ or ▶
→ Normal playback resumes

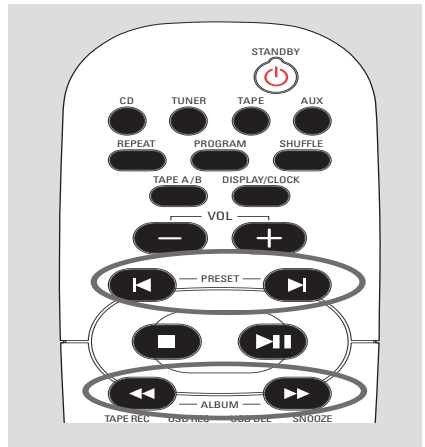

Programming tracks

You may store up to 99 tracks in the desired sequence. If you like, store any track more than once.

- In the stop position, press **PROGRAM** to start programming
 - **PROG** flashes
 - **Audio CD**: Display shows current track number
 - **MP3/WMA**: Display shows current album/ track number

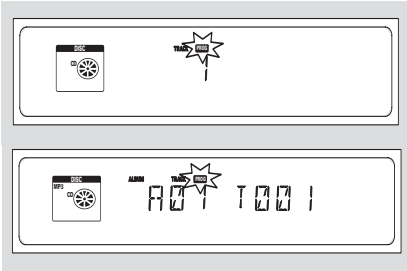

- Press **◀** or **▶** once or repeatedly until the desired track number appears in the display
- MP3/WMA**: Press **◀◀**/**▶▶** and **◀**/**▶** to select the desired album and track
- Press **PROGRAM** to confirm
 - **Audio CD**: Display shows briefly the number and playing time of tracks programmed; Then, the display shows **PROG** and the track number you just stored
 - **MP3/WMA**: Display shows briefly the number of tracks programmed; Then, the display shows the album/ track number you just stored

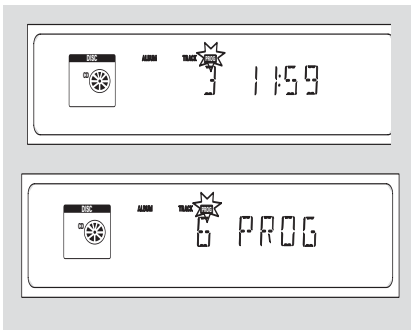

- Repeat steps 2-3 to select and store all desired tracks.
 - **PROGRAM FULL** is displayed if you attempt to program more than 99 tracks
- Press **■** to stop programming
 - **PROG** stops flashing
 - **Audio CD**: Display shows the number and playing time of tracks programmed
 - **MP3/WMA**: Display shows the album/ track number you just stored
- Press **▶▶** **||** play the program

Helpful hints:

- The set will return to the stop position if no button is pressed within 20 seconds.
- PROG** stops flashing. To resume programming, press **PROGRAM**.
- MP3/WMA**: When playing a program, use of **◀◀** or **▶▶** are void.

Erasing the program

You can erase the contents of the memory by:

- Press **■**
 - once if in the stop position (after you stop programming);
 - twice during playback;
- Press **STANDBY-ON/ECO POWER** **⏻**
- Select another sound source
- Open the CD door
 - **PROG** disappears. **PROGRAM CLEARED** scrolls

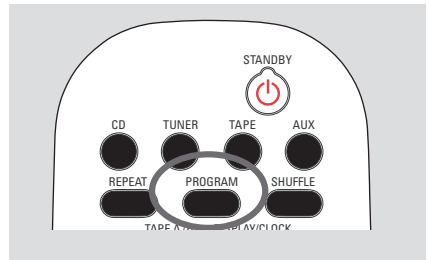

Different play modes: REPEAT, SHUFFLE

REP(*REPEAT TRACK/REPEAT PROGRAM*) – plays the current track/program continuously

REP ALL(*REPEAT DISC*) – plays the entire disc continuously

SHUFFLE – plays all the tracks of the disc/program in random order

SHUFFLE REP - plays all the tracks of the program continuously in random order

SHUFFLE REP ALL – plays all the tracks of the disc continuously in random order

- 1 Press once or more **REPEAT** or **SHUFFLE** to select play modes
- 2 To return to normal playback, press **REPEAT** or **SHUFFLE** repeatedly until the various modes are no longer displayed
– You will also cancel the play modes by pressing **USB RECORD**

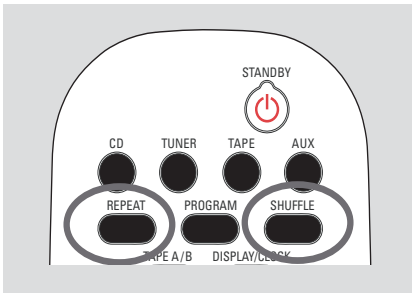

Helpful hints:

- In the shuffle mode, press **▶|** to select tracks.

Display track information (MP3/WMA only)

- During playback, press **DISPLAY/CLOCK** repeatedly on the remote control
→ Display show title name and album name

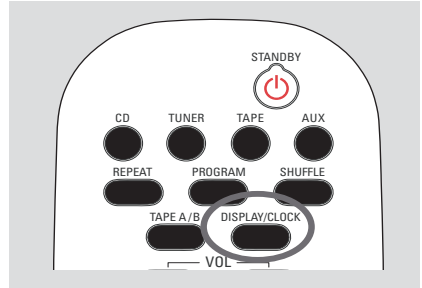

Tuning to radio stations

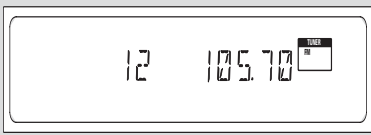
- 1 Press **TUNER** to select **TUNER** source
- 2 Press **TUNER** repeatedly to select your desired waveband, FM or AM
 → Display shows:  , radio station frequency, waveband and if programmed, a preset number

- 3 Press and hold **◀** or **▶** until **SEARCH** appears
 → The radio automatically tunes to a station with sufficient reception. Display shows **SEARCH** during automatic tuning
 → **FM**: If a station is received in stereo, **st** is shown
- 4 Repeat step 3 if necessary until you find the desired station.
- To tune to a weak station, press **◀** or **▶** briefly and repeatedly until you have found optimal reception

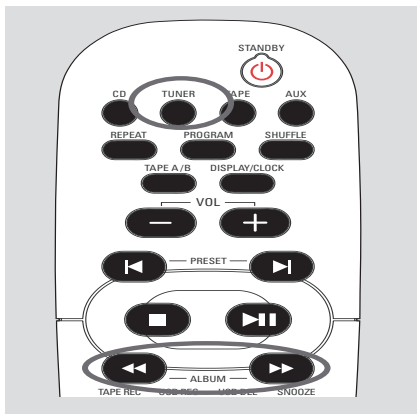

Programming radio stations

You can store up to a total of 40 radio stations (FM and AM) in the memory, manually or automatically (Autostore).

Plug & Play

Plug & Play allows you to store all available radio stations automatically.

- 1 Connect the system to the power supply
 → "AUTO INSTALL - PRESS PLAY" appears.
Or
 In Eco Power standby/standby mode, press and hold **▶▶** on the set until "AUTO INSTALL - PRESS PLAY" appears
- 2 Press **▶▶** on the set to start installation
 → "INSTALL TUNER AUTO" appears
 → All previously stored radio stations will be replaced
 → After all stations are stored, the last preset station will then be played

Autostore: Automatic programming

Automatic programming will start from preset 1 or a chosen preset number. From this preset number upwards, former programmed tuner stations will be erased. The set will only program stations which are not in the memory already.

- 1 Press the **◀** or **▶** buttons once or more to select the preset number where programming should start.
Note:
 – If no tuner preset number is selected, default is preset 1 and all your presets will be erased.
- 2 Press and hold **PROGRAM** until **AUTO** appears
 → **PROG** flashes
 → Available stations are programmed: FM stations followed by AM stations
 → After all stations are stored, the last preset station will then be played

Manual programming

- 1 Tune to your desired station (see **Tuning to radio stations**)
- 2 Press **PROGRAM** to activate programming
→ The preset number starts flashing
- 3 Press **◀** or **▶** to allocate a number from 1 to 40 to this station
- 4 Press **PROGRAM** to confirm
→ Display shows the preset number, waveband and the frequency of the preset station
- 5 Repeat steps 1-4 to store other stations
- You can erase a preset station by storing another frequency in its place

To listen to a preset station

- Press the **◀** or **▶** buttons once or more until the desired preset station is displayed

Deleting a preset radio station

- Press and hold **■** until "PRESET DELETED" appears.
→ The current preset radio station will be deleted
→ The preset radio stations behind it move forward by one number

Using a USB mass storage device

On MCM760, you can playback music from a USB mass storage device and also, record music to such a device.

By connecting a USB mass storage device to the Hi-Fi system, you can enjoy the device's stored music through the powerful speakers of Hi-Fi system.

Compatible USB mass storage devices

With the Hi-Fi system, you can use

- USB flash memory (USB 2.0 or USB1.1)
- USB flash players (USB 2.0 or USB1.1)
- memory cards (requires an additional card reader to work with this Hi-Fi system)

Note:

- In some USB flash players (or memory devices), the stored contents are recorded using copyright protection technology. Such protected contents will be unplayable on any other devices (such as this Hi-Fi system).
- MTP (Media Transfer Protocol) USB devices are not supported.

Supported formats:

- USB or memory file format FAT12, FAT16, FAT32 (sector size: 512 - 65,536 bytes)
- MP3 bit rate (data rate): 32-320 Kbps and variable bit rate
- WMA v9 or earlier
- Directory nesting up to a maximum of 8 levels
- Number of albums/ folders: maximum 99
- Number of tracks/titles: maximum 999
- ID3 tag v2.0 or later
- File name in Unicode UTF8 (maximum length: 128 bytes)

The system will not play or support the following:

- Empty albums: an empty album is an album that does not contain MP3/WMA files, and will not be shown in the display.
- Non-supported file formats are skipped. This means that e.g.: Word documents .doc or MP3 files with extension .dlf are ignored and will not be played.
- AAC, WAV, PCM audio files
- DRM protected WMA files
- WMA files in Lossless format

How to transfer music files from PC to a USB mass storage device

By dragging and dropping music files, you can easily transfer your favorite music from PC to a USB mass storage device.

For the flash player, you can also use its music management software for the music transfer:

However, those WMA files may be unplayable for compatibility reasons.

How to organize your MP3/WMA files on the USB mass storage device

This Hi-Fi system will browse the MP3/WMA files in the folders/sub-folders/titles order.

Example:

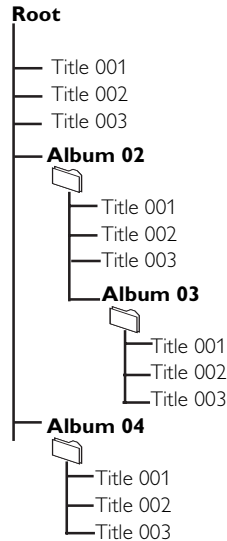

Organize your MP3/WMA files in different folders or subfolders as required.

Helpful hints:

- If you have not organized MP3/WMA files into any albums on your disc, an album "01" will be automatically assigned for all those files.
- Make sure that the file names of MP3 files end with .mp3. and the file names of WMA files end with .wma.
- For DRM protected WMA files, use Windows Media Player 10 (or later) for conversion. Visit www.microsoft.com for details about Windows Media Player and WM DRM (Windows Media Digital Rights Management).

Playing a USB mass storage device

- 1 Check the USB device has been properly connected. (See **Installation: Connecting an additional appliance**)
- 2 Press **USB** to select **USB** source
 - The icon **USB DIRECT** appears
 - **DEVICE NOT SUPPORTED** appears if the USB device is not supported by MCM760
 - **FILE SYSTEM ERROR** appears if unsupported file formats are used on the USB device

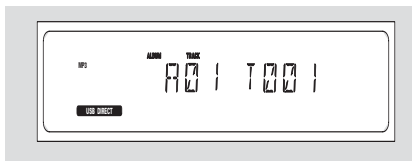

– **NO AUDIO** appears if no audio file is found in the USB device

- 3 Play the USB's audio files as you do with the albums/tracks on a CD (See **CD**)

Helpful hints:

– For compatibility reasons, the album/track information may differ from what it is displayed through flash players' music management software.



Recording to a USB mass storage device

With MCM760, you can record your favorite CD music to a USB mass storage device. Carry your favorite songs wherever you go.

IMPORTANT!

- **Recording is permissible if copyright or other rights of third parties are not infringed upon.**
- **For CDs encoded with copyright protection technologies by some record companies, recording is restricted.**

- 1 Check the USB device has been properly connected (See **Installation: Connecting an additional appliance**)
- 2 Press **CD** to select **CD** source
- 3 Insert a disc with the printed side facing up. Press **OPEN/CLOSE**  again to close the compartment

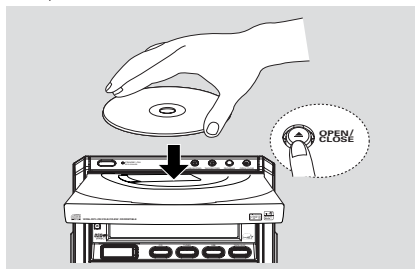

- 4 Press **◀** or **▶** once or repeatedly until the desired track number appears in the display
- **MP3/WMA:** Press **◀/▶** and **◀** or **▶** to select the desired album and track
- Or**
- Program your desired tracks (see **CD: Programming tracks**)
 - Make sure you press **■** after finishing programming

- Press **USB RECORD** once or more to select your recording options:

RECORD TRACK – record the selected track to the USB mass storage device

RECORD ALL – record the whole disc/program to the USB mass storage device

- Playback and recording start from the beginning
- **USB FULL** appears if the storage space on the USB device is full
- **NUMBER FULL** appears if the number of folders exceeds 99 or the number of titles exceeds 999

- Press **■** to stop recording
→ Display shows **RECORD STOP**

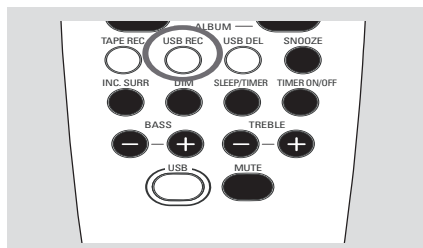

To record a disc during playback

- During playback, press **USB RECORD**
 - **Audio CD**: Recording starts from current playback point. Playback continues
 - **MP3/WMA**: Recording and playback start from the beginning of current track

Helpful hints:

- **SLOW USB** appears and CD playback pauses if the USB device is slow and the recording cannot be as fast as playback. However, the playback pause will not affect recording.
- **FILE EXIST** appears and recording stops if the track being recorded already exists in the USB device.

To find your ripped tracks

You can find and playback the ripped tracks in the album **_PHILIPS**

- Press **USB** on the set to select **USB**
- Press **◀/▶** and **◀** or **▶** to select the desired album and track
 - The audio CD files have been converted to MP3 format and named as **TRXXXXXX.MP3**
 - For MP3/WMA files, the track information are retained (the set only supports the file names in English)
 - Only the completely ripped MP3/WMA file can be found and played by MCM760

To delete tracks from the USB device

- Press **USB** to select **USB** source
- Press **◀** or **▶** once or repeatedly until the desired track number appears in the display
- Press **USB DEL** on the remote control
→ Display shows **"DEL TRACK?"**
- Press **USB DEL** again to confirm

To delete an album from the USB device (MP3/WMA only)

- In the stop position, press **◀/▶** to select the desired album
- Press and hold **USB DEL** until the display shows **"DEL ALBUM?"**
- Press **USB DEL** again to confirm

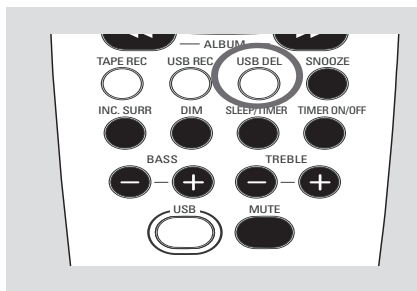

Note:

- On MCM760, the tracks of some USB devices may be indelible.

IMPORTANT!

- Before playing a tape, check and tighten slack tape with a pencil. Slack tape may get jammed or may burst in the mechanism.
- C-120 tape is extremely thin and is easily deformed or damaged. It is not recommended for use in this system.
- Store the tapes at room temperature and do not put them too close to a magnetic field (for example, a transformer, TV or speaker).

Playing a tape

- 1 Press **TAPE/AUX** once or more to select **TAPE** (or **TAPE** on the remote control)
- 2 Press **OPEN/CLOSE**  to open the tape deck door

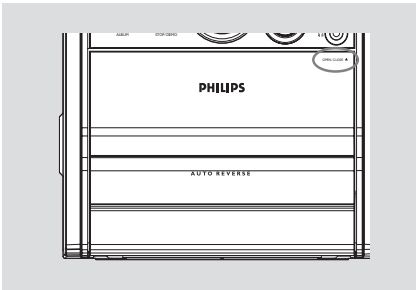

- 3 Insert a recorded tape and close the tape deck door.
→ Load the tape with the open side downward and full spool to the left

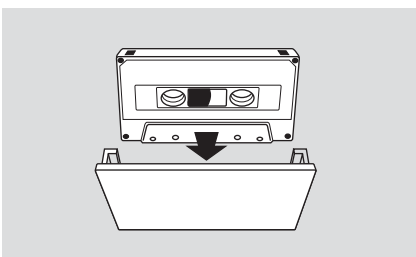



- 4 Press **▶||** to start playback
→ At the end of one side, the tape playback will be automatically reversed and start from the beginning of the other side
→ **◀** (BACK) or **▶** (FRONT) appears

To change the playback side

- On the remote control, press **◀** or **▶**
→ **◀** (BACK) or **▶** (FRONT) appears on the display, depending on the tape side selected

To change the playback mode

- Press **TAPE A/B** on the remote control repeatedly to select the different playback modes
 -  : plays one side of the tape
 -  : plays both sides once
 -  : plays both sides repeatedly (up to 10 times)

To rewind or fast forward

- 1 Press **◀◀** or **▶▶** on the remote control
- 2 Press **■** when you reached the desired passage
→ The tape will stop automatically at the end of rewinding or fast forwarding.

To stop playback

- Press **■**

Helpful hints:

- During rewinding or fast forwarding of a tape, it is also possible to select another source (CD or TUNER, for example).

Recording to a tape

General information on recording

- For recording, use only tape of IEC type I (normal tape).
- The recording level is set automatically, regardless of the position of the Volume, Incredible Surround, BASS/TREBLE and so forth.
- The tape is secured at both ends with leader tape. At the beginning and end of the tape, nothing will be recorded for six to seven seconds.
- To prevent accidental recording, break out the tab on the left shoulder of the tape side you want to protect.
- If "CHECK TAPE" is displayed, the protection tab has been broken. Put a piece of clear adhesive tape over the opening.

IMPORTANT!

Recording is permissible if copyright or other rights of third parties are not infringed upon.

Preparation

- 1 Press **TAPE/AUX** once or more to select **TAPE** (or **TAPE** on the remote control)
- 2 Load a recordable tape into the tape deck.
- 3 Press **◀** or **▶** on the remote control to select the recording tape side.
 - **◀** appears on the display for the reverse side
 - **▶** appears on the display for the forward side
- 4 Press **TAPE A/B** repeatedly on the remote control to select a recording mode.
 - **☐** for recording on one side only.
 - **☐☐** for recording on both sides.
- 5 Prepare the source to be recorded.
 - CD** – load the disc
 - TUNER** – tune to the desired radio station
 - USB** – connect a USB device
 - AUX** – connect external equipment

Helpful hints:

When recording is in progress, it is not possible:

- to change tape side;
- to listen to another source;
- to activate the timer function.

– One Touch Recording is not possible in TAPE mode, "SELECT SOURCE" will appear.

Tape recording

One touch recording

- 1 Select the recording source: **CD, TUNER, USB** or **AUX**
- 2 Start playback of the selected source
- 3 Press **TAPE RECORD**
 - **REC** starts flashing
- 4 To stop recording, press **■** on the set

CD/USB Synchro start recording

- 1 Select the recording source: **CD** or **USB**
- 2 If necessary, press **◀** or **▶** once or repeatedly until the desired track number appears in the display
 - **MP3/WMA:** Press **◀◀ / ▶▶** and **◀** or **▶** to select the desired album and track
 - **Or**
 - Program your desired tracks (see **CD: Programming tracks**)
 - Make sure you press **■** after finishing programming
- 2 Press **TAPE RECORD**
 - The playback and recording start automatically
- 3 For brief interruption, press **▶||**. To resume recording, press **▶||** again
- 4 To stop recording, press **■**
 - Recording and playback will stop simultaneously

AUX (Listening to an external source)

You can listen to the sound of the connected external device through your MCM760



- 1 Check the external device has been properly connected (See **Installation, Connecting an additional appliance**)
- 2 Press **TAPE/AUX** once or more to select **AUX** (or **AUX** on the remote control)
- 3 To avoid noise distortion, turn down the volume on your external device
- 4 Press the **PLAY** key on the connected device to start playback
- 5 To adjust the sound and volume, use the sound controls on your external device and the MCM760

Setting the timer

The set can be used as an alarm clock, whereby the selected source (CD, TUNER, USB or TAPE) starts playback at a preset time. **Make sure the clock is set before using the timer.**

IMPORTANT!

- if recording is in progress, the timer function will not be activated.
- The volume of the timer will increase gradually to the last tuned volume level. If the last tuned volume level is too low, the set will then increase to a predetermined minimum audible level (-29dB).

- 1 On the remote control, press and hold **SLEEP/TIMER**
→  icon starts flashing
- 2 Select the timer source: **CD, TUNER, USB** or **TAPE**
→ The selected source lights up
- 3 Press **◀▶** repeatedly to set the hour
- 4 Press **▶||** to change to minutes setting, then press **◀▶** repeatedly to set the minutes
- 5 Press **SLEEP/TIMER** to store the setting
→  icon stops flashing. The timer is now set and activated
→ At the set alarm time, the CD, TUNER, USB or TAPE will switch on and after 30 minutes switch to ECO POWER automatically

Note:

- The set will exit from the timer setting mode if no button is pressed within 90 seconds.

Helpful hints:

The timer will not work at the set time if

- the set is switched on
- the timer is deactivated

The set will switch to Tuner source automatically if:

- no CD is inserted when the selected source is CD;
- no USB device is connected when the selected source is USB

Activating and deactivating TIMER

- Press **TIMER ON/OFF** on the remote control to turn off the timer or turn on to the last setting again.
 - If activated, the timer information are displayed
 - If deactivated, "OFF" appears

Temporarily deactivating TIMER

- ① Within 30 seconds after the timer is activated, press **SNOOZE** on the remote control
 - The set will switch to standby mode for 5 minutes. And then, the timer will be re-activated
- ② To cancel the snooze function, press **SNOOZE** again

SLEEP

You can set a certain period of time after which the set will switch to ECO POWER.

- ① On the remote control, press **SLEEP/TIMER** repeatedly to select the desired time period options (in minutes):
 - Display shows in sequence: **SLEEP 15, 30, 45, 60, 90, 120, SLEEP OFF**
 - Display shows the selected option briefly and returns to its previous status. The icon **SLEEP** appears
- ② To view the time countdown to ECO POWER, press **SLEEP/TIMER** again

To deactivate the sleep timer, press **SLEEP/TIMER** until **SLEEP OFF** is displayed

or

Press **STANDBY-ON/ ECO POWER** to switch off the set (or ϕ on the remote control)

Demonstration mode

The demonstration mode displays various features of MCM760.

To activate the demonstration

- When the set is switched off, press and hold \blacksquare on the set until "DEMO ON" appears
 - The demonstration mode will be activated when the set is switched off

To deactivate the demonstration

- Press and hold \blacksquare on the set until "DEMO OFF" appears

AMPLIFIER

Output power	
.....	2 x 150 W MPO
.....	2 x 75 W RMS ⁽¹⁾
.....	2 x 60 W FTC ⁽¹⁾
Signal-to-noise ratio ≥ 75 dBA (IEC)
Frequency response 50 – 20000 Hz, –3 dB
Input sensitivity	
AUX 500 mV
Output	
Speakers ≥ 6 Ω
Headphones 32 Ω – 1000 Ω
(1) (6 Ω, 1 kHz, 10% THD)	

DISC PLAYER

Programmable tracks 99
Frequency response 20 – 20000 Hz, –3 dB
Signal-to-noise ratio ≥ 76 dBA
Channel separation ≥ 55 dB (1 kHz)
MPEG 1 Layer 3 (MP3-CD) MPEG AUDIO
MP3/WMA-CD bit rate 32-256 kbps
.....	(128 kbps advised)
Sampling frequencies 32, 44.1, 48 kHz

TUNER

FM wave range 87.5 – 108 MHz
MW wave range 530 – 1700 kHz
Number of presets 40
Antenna	
FM 300 Ω wire
MW Loop antenna

TAPE PLAYER

Frequency response
CrO ₂ tape (type II) 80 – 12500 Hz, –8 dB
Normal tape (type I) 80 – 12500 Hz, –8 dB
Signal-to-noise ratio	
CrO ₂ tape (type II) ≥ 50 dBA
Normal tape (type I) ≥ 47 dBA
Wow and flutter ≤ 0.4% DIN

SPEAKERS

System 2 way, Bass reflex
Impedance 6 Ω
Woofer 1 x 5.25" Aluminium
.....	con woofer
Tweeter (MCM11) Ribbon tweeter
Dimensions (w x h x d)
.....	175 x 252 x 196 (mm)
Weight	
.....	3.1 kg each
.....	6.82 pounds each

GENERAL

Material/finish Polystyrene/Metal
AC Power 120 V /60 Hz
Power Consumption	
Active 105 W
Standby < 15 W
Eco Power Standby < 1 W
Dimensions (w x h x d) 179 x 252 x 340 (mm)
Weight (without speakers) 5.53 kg

Specifications and external appearance are subject to change without notice.

Maintenance

Cleaning the Cabinet

- Use a soft cloth slightly moistened with a mild detergent solution. Do not use a solution containing alcohol, spirits, ammonia or abrasives.

Cleaning Discs

- When a disc becomes dirty, clean it with a cleaning cloth. Wipe the disc from the centre out.

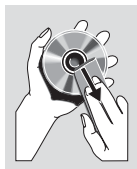

- Do not use solvents such as benzene, thinner, commercially available cleaners, or antistatic spray intended for analogue records.

Cleaning the disc lens

- After prolonged use, dirt or dust may accumulate at the disc lens. To ensure good playback quality, clean the disc lens with Philips CD Lens Cleaner or any commercially available cleaner. Follow the instructions supplied with cleaner.

Troubleshooting

WARNING

Under no circumstances should you try to repair the system yourself, as this will invalidate the warranty. Do not open the system as there is a risk of electric shock.

If a fault occurs, first check the points listed below before taking the system for repair. If you are unable to remedy a problem by following these hints, consult your dealer or Philips for help.

Problem	Solution
"NO DISC" is displayed.	<ul style="list-style-type: none">✓ Insert a disc.✓ Wait until the moisture condensation at the lens has cleared.✓ Replace or clean the disc, see "Maintenance".✓ Use a finalised CD-RW or a correct MP3/WMA-CD format disc.
Some files on the USB device are not displayed.	<ul style="list-style-type: none">✓ Check if the number of folders exceeds 99 or the number of titles exceeds 999.✓ Only the completely ripped MP3/WMA file can be found and played by MCM760. Check if the file has been completely ripped.
"POWER NOT ENOUGH" is displayed.	<ul style="list-style-type: none">✓ Check if the USB device needs extra power supply.
Radio reception is poor.	<ul style="list-style-type: none">✓ If the signal is too weak, adjust the antenna or connect an external antenna for better reception.✓ Increase the distance between the Micro HiFi System and your TV or VCR.
Tape recording or playback cannot be made.	<ul style="list-style-type: none">✓ Use only NORMAL (IEC I) tape.✓ Apply a piece of adhesive tape over the missing tab space.
The tape deck door cannot open.	<ul style="list-style-type: none">✓ Remove and reconnect the AC power plug and switch on the system again.
The system does not react when buttons are pressed.	<ul style="list-style-type: none">✓ Remove and reconnect the AC power plug and switch on the system again.
Sound cannot be heard or is of poor quality.	<ul style="list-style-type: none">✓ Adjust the volume.✓ Disconnect the headphones.✓ Check that the speakers are connected correctly.✓ Check if the stripped speaker wire is clamped.

The left and right sound outputs are reversed.

- ✓ Check the speaker connections and location.

The remote control does not function properly.

- ✓ Select the source (CD or TUNER, for example) before pressing the function button (▶||, ◀, ▶|).
- ✓ Reduce the distance between the remote control and the system.
- ✓ Insert the battery with its polarities (+/- signs) aligned as indicated.
- ✓ Replace the battery.
- ✓ Point the remote control directly toward IR sensor on the front of the system.

The timer is not working.

- ✓ Check the set is switched off
- ✓ Set the clock correctly.
- ✓ Press TIMER to switch on the timer.

The Clock/Timer setting is erased.

- ✓ Power has been interrupted or the power cord has been disconnected. Reset the clock/timer.

PHILIPS LIMITED WARRANTY ONE (1) YEAR

WARRANTY COVERAGE:

PHILIPS warranty obligation is limited to the terms set forth below.

WHO IS COVERED:

Philips warrants the product to the original purchaser or the person receiving the product as a gift against defects in materials and workmanship as based on the date of original purchase ("Warranty Period") from an Authorized Dealer. The original sales receipt showing the product name and the purchase date from an authorized retailer is considered such proof.

WHAT IS COVERED:

The Philips warranty covers new products if a defect arises and a valid claim is received by Philips within the Warranty Period. At its option, Philips will either (1) repair the product at no charge, using new or refurbished replacement parts, or (2) exchange the product with a product that is new or which has been manufactured from new, or serviceable used parts and is at least functionally equivalent or most comparable to the original product in Philips current inventory, or (3) refund the original purchase price of the product.

Philips warrants replacement products or parts provided under this warranty against defects in materials and workmanship from the date of the replacement or repair for ninety (90) days or for the remaining portion of the original product's warranty, whichever provides longer coverage for you. When a product or part is exchanged, any replacement item becomes your property and the replaced item becomes Philips' property. When a refund is given, your product becomes Philips' property.

Note: Any product sold and identified as refurbished or renewed carries a ninety (90) day limited warranty.

Replacement product can only be sent if all warranty requirements are met. Failure to follow all requirements can result in delay.

WHAT IS NOT COVERED - EXCLUSIONS AND LIMITATIONS:

This Limited Warranty applies only to the new products manufactured by or for Philips that can be identified by the trademark, trade name, or logo affixed to it. This Limited Warranty does not apply to any non-Philips hardware product or any software, even if packaged or sold with the product. Non-Philips manufacturers, suppliers, or publishers may provide a separate warranty for their own products packaged with the bundled product.

Philips is not liable for any damage to or loss of any programs, data, or other information stored on any media contained within the product, or any non-Philips product or part not covered by this warranty. Recovery or reinstallation of programs, data or other information is not covered under this Limited Warranty.

This warranty does not apply (a) to damage caused by accident, abuse, misuse, misapplication, or non-Philips product, (b) to damage caused by service performed by anyone other than Philips or Philips Authorized Service Location, (c) to a product or a part that has been modified without the written permission of Philips, or (d) if any Philips serial number has been removed or defaced, or (e) product, accessories or consumables sold "AS IS" without warranty of any kind by including refurbished Philips product sold "AS IS" by some retailers.

This Limited Warranty does not cover:

- Shipping charges to return defective product to Philips.
- Labor charges for installation or setup of the product, adjustment of customer controls on the product, and installation or repair of antenna systems outside of the product.
- Product repair and/or part replacement because of improper installation, connections to improper voltage supply, abuse, neglect, misuse, accident, unauthorized repair or other cause not within the control of Philips.
- Damage or claims for products not being available for use, or for lost data or lost software.
- Damage occurring to product during shipping.
- A product that requires modification or adaptation to enable it to operate in any country other than the country for which it was designed, manufactured, approved and/or authorized, or repair of products damaged by these modifications.
- A product used for commercial or institutional purposes (including but not limited to rental purposes).
- Product lost in shipment and no signature verification receipt can be provided.
- Failure to operate per Owner's Manual.

TO OBTAIN ASSISTANCE IN THE U.S.A., PUERTO RICO, OR U.S. VIRGIN ISLANDS...

Contact Philips Customer Care Center at:
1-888-PHILIPS (1-888-744-5477)

TO OBTAIN ASSISTANCE IN CANADA...

1-800-661-6162 (French Speaking)
1-888-PHILIPS (1-888-744-5477) - (English or Spanish Speaking)

REPAIR OR REPLACEMENT AS PROVIDED UNDER THIS WARRANTY IS THE EXCLUSIVE REMEDY FOR THE CONSUMER. PHILIPS SHALL NOT BE LIABLE FOR ANY INCIDENTAL OR CONSEQUENTIAL DAMAGES FOR BREACH OF ANY EXPRESS OR IMPLIED WARRANTY ON THIS PRODUCT. EXCEPT TO THE EXTENT PROHIBITED BY APPLICABLE LAW, ANY IMPLIED WARRANTY OF MERCHANTABILITY OR FITNESS FOR A PARTICULAR PURPOSE ON THIS PRODUCT IS LIMITED IN DURATION TO THE DURATION OF THIS WARRANTY.

Some states do not allow the exclusions or limitation of incidental or consequential damages, or allow limitations on how long an implied warranty lasts, so the above limitations or exclusions may not apply to you.

This warranty gives you specific legal rights. You may have other rights which vary from state/province to state/province.

Philips, P.O. Box 671539, Marietta, GA. 30006-0026

3121 233 48801

Free Manuals Download Website

<http://myh66.com>

<http://usermanuals.us>

<http://www.somanuals.com>

<http://www.4manuals.cc>

<http://www.manual-lib.com>

<http://www.404manual.com>

<http://www.luxmanual.com>

<http://aubethermostatmanual.com>

Golf course search by state

<http://golfingnear.com>

Email search by domain

<http://emailbydomain.com>

Auto manuals search

<http://auto.somanuals.com>

TV manuals search

<http://tv.somanuals.com>