

5. You and your baby can use the clacker and rattle that fit into slots on side of drum to add to the music-making fun!

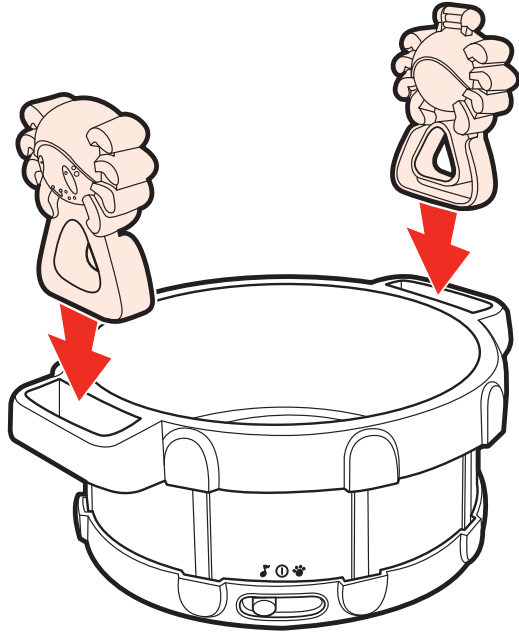

NOTE: When playtime is over, store toy in the off position to avoid unintentional triggering of music and preserve battery life.

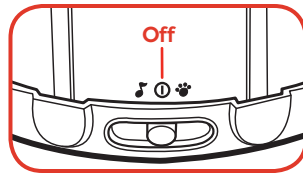

FCC STATEMENT

This equipment has been tested and found to comply with the limits for a Class B digital device, pursuant to part 15 of the FCC Rules. These limits are designed to provide reasonable protection against harmful interference in a residential installation. This equipment generates, uses and can radiate radio frequency energy, and, if not installed and used in accordance with the instructions, may cause harmful interference to radio communications. However, there is no guarantee that interference will not occur in a particular installation. If this equipment does cause harmful interference to radio or television reception, which can be determined by turning the equipment off and on, the user is encouraged to try to correct the interference by one or more of the following measures:

- Reorient or relocate the receiving antenna.
- Increase the separation between the equipment and the receiver.
- Consult the dealer or an experienced radio/TV technician for help.

Changes or modifications to this unit not expressly approved by the party responsible for compliance could void the user's authority to operate the equipment.

Visit us at
playskool.com



© 2006 Hasbro. All Rights Reserved.
TM & © denote U.S. Trademarks
08979 P/N 6627050000

Download from www.Somanuals.com. All Manuals Search And Download.

OVER 6 Months
08979

PLAYSKOOL

Let's Play Together

Melody Mixin' Drum™

INCLUDES musical drum, 3 cushy bags, clacker, rattle and LET'S PLAY TOGETHER tip card.

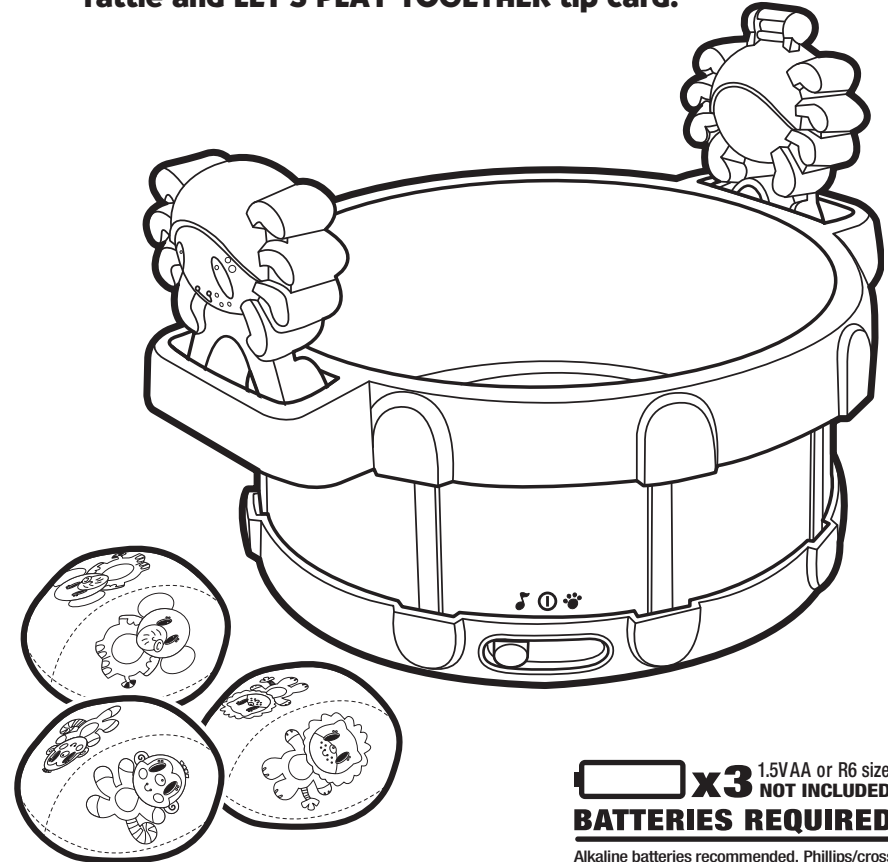

x3 1.5V AA or R6 size
BATTERIES REQUIRED
NOT INCLUDED

Alkaline batteries recommended. Phillips/cross head screwdriver (not included) needed to insert batteries.

Thank you for choosing this PLAYSKOOL toy!

TO INSERT BATTERIES

Use a Phillips/cross head screwdriver (not included) to loosen screw in battery compartment door (screw remains attached to door). Remove door. Insert 3 x 1.5V "AA" or R6 size batteries. Alkaline batteries recommended. Fit door onto unit, then close door. Tighten screw.

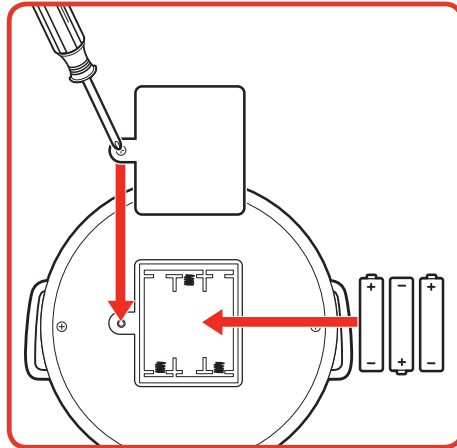

⚠ CAUTION: TO AVOID BATTERY LEAKAGE

1. Be sure to insert the batteries correctly and always follow the toy and battery manufacturers' instructions;
2. Do not mix old and new batteries or alkaline, standard (carbon-zinc) or rechargeable (nickel-cadmium) batteries;
3. Always remove weak or dead batteries from the product.

IMPORTANT: BATTERY INFORMATION

Please retain this information for future reference.
Batteries should be replaced by an adult.

⚠ CAUTION:

1. Always follow the instructions carefully. Use only batteries specified and be sure to insert item correctly by matching the + and - polarity markings.
2. Do not mix old batteries and new batteries or standard (carbon-zinc) with alkaline batteries.
3. Remove exhausted or dead batteries from the product.
4. Remove batteries if product is not to be played with for a long time.
5. Do not short circuit the supply terminals.
6. Should this product cause, or be affected by, local electrical interference, move it away from other electrical equipment. Reset (switching off and back on again or removing and re-inserting batteries) if necessary.
7. RECHARGEABLE BATTERIES: Do not mix these with any other types of battery. Always remove from the product before recharging. Recharge batteries under adult supervision. DO NOT RECHARGE OTHER TYPES OF BATTERIES.

PLAY FEATURES

With the MELODY MIXIN' DRUM, you and your baby can create a playroom concert together. See your LET'S PLAY TOGETHER tip card (included) for even more play activities and ideas!

To Play

1. To turn the toy on, slide the switch on side of drum to Band or Animal sound mode. (See icons.)
2. To start background tune, gently rock the drum. The rocking motion will activate the tune.
3. The three cushy bags show instruments and animals. These correspond with the sounds you'll hear when they are placed in the drum.

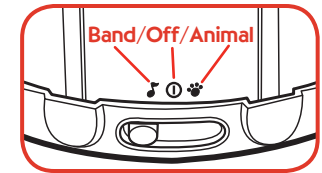

4.



Simply drop a cushy bag into the drum to hear the sound associated with the picture. The new sound will be added to the background tune. Each cushy bag adds a different sound, themed to your selected mode, for countless musical combos! When you remove a cushy bag from the drum, the sound associated with it stops.

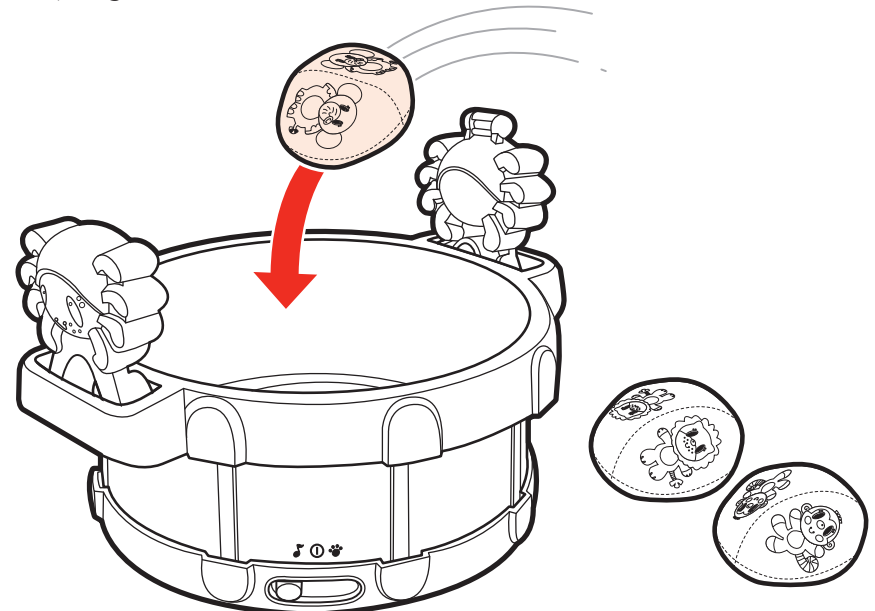

Free Manuals Download Website

<http://myh66.com>

<http://usermanuals.us>

<http://www.somanuals.com>

<http://www.4manuals.cc>

<http://www.manual-lib.com>

<http://www.404manual.com>

<http://www.luxmanual.com>

<http://aubethermostatmanual.com>

Golf course search by state

<http://golfingnear.com>

Email search by domain

<http://emailbydomain.com>

Auto manuals search

<http://auto.somanuals.com>

TV manuals search

<http://tv.somanuals.com>