

TAKING CARE OF YOUR CSi SERIES LOUDSPEAKER

Your new CSi Series Loudspeaker are constructed of a rugged material that can be dusted or cleaned with a damp cloth. Avoid harsh detergents and cleaning fluids, as they can permanently damage your speakers' finish [figure 4]. Vacuum the grilles to remove dust.

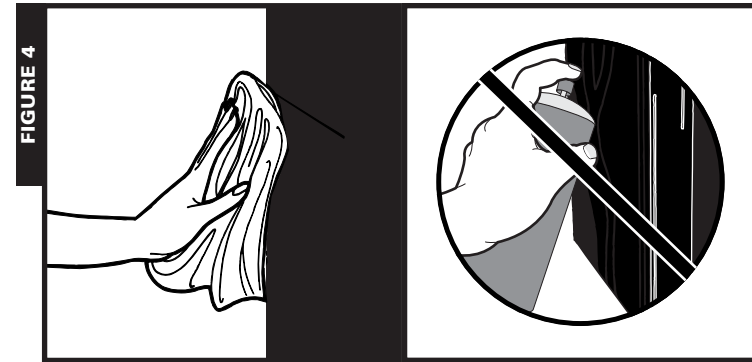

FIGURE 4

*Do not use furniture polish on veneer.
Clean veneer with a damp cloth.*

Cuidado del acabado de madera natural.

Entretien de la finition en bois véritable.

Pflege der Holzappretur.

PRODUCT SPECIFICATIONS

CSi25

DRIVER COMPLEMENT:
2 - 5 1/4"(133mm) drivers
3/4"(19mm) tweeter

OVERALL

FREQUENCY RESPONSE:
55Hz-22kHz

-3DB LIMITS:
60Hz-20kHz

RECOMMENDED

AMPLIFICATION:
10-100 watts/channel

EFFICIENCY (1M,1W):
90dB

IMPEDANCE:

Nominal 4 Ohms
Compatible with 8ohm outputs

CROSSOVER FREQUENCY:

2.3kHz

CROSSOVER SLOPE:

2nd Order HP,
2nd Order LP

ENCLOSURE TYPE:

Ported

DIMENSIONS:

6.5" H x 19" W x 8" D
(165mm H x 483mm W x 203mm D)

SHIPPING WEIGHT:

20 lbs. (9.1kg.)

LIMITED FIVE YEAR WARRANTY

Polk Audio, Inc. warrants to the original purchaser only that this Polk Audio Loudspeaker Product (the "Product") will be free from defects in materials and workmanship for a period of five (5) years from the date of original retail purchase from a Polk Audio Authorized Dealer. However, this Warranty will automatically terminate prior to the expiration of the five (5) years if the original retail purchaser sells or otherwise transfers the Product to any other party. The original retail purchaser shall hereinafter be referred to as "you." To allow Polk Audio to offer the best possible warranty service, please fill out the Product Registration Card(s) and send it to the Factory, at the address provided on the Product Cards(s) within ten (10) days of the date of purchase.

Defective Products must be shipped, together with proof of purchase, prepaid insured to the Polk Audio Authorized Dealer from whom you purchased the Product, or to the Factory at 2550 Britannia Boulevard, Suite D, San Diego, California 92154. Products must be shipped in the original shipping container or its equivalent; in any case the risk of loss or damage in transit is to be borne by you. If upon examination at the Factory or Polk Audio Authorized Dealer it is determined that the unit was defective in materials or workmanship at any time during this Warranty period, Polk Audio or the Polk Audio Authorized Dealer will, at its option, repair or replace this Product at no additional charge, except as set forth below. All replaced parts and Products become the property of Polk Audio. Products replaced or repaired under this warranty will be returned to you, within a reasonable time, freight prepaid.

This warranty does not include service or parts to repair damage caused by accident, disaster, misuse, abuse, negligence, inadequate packing or shipping procedures, commercial use, voltage inputs in excess of the rated maximum of the unit, cosmetic appearance of cabinetry not directly attributable to defect in materials or workmanship, or service, repair, or modification of the Product which has not been authorized or approved by Polk Audio. This warranty shall terminate if the Serial number on the Product has been removed, tampered with or defaced.

This warranty is in lieu of all other expressed Warranties. If this Product is defective in materials or workmanship as warranted above, your sole remedy shall be repair or replacement as provided above. In no event will Polk Audio, Inc. be liable to you for any incidental or consequential damages arising out of the use or inability to use the Product, even if Polk Audio, Inc. or a Polk Audio Authorized Dealer has been advised of the possibility of such damages, or for any claim by any other party. Some states do not allow the exclusion or limitation of consequential damages, so the above limitation and exclusion may not apply to you.

All implied warranties on this Product are limited to the duration of this expressed Warranty. Some states do not allow limitation on how long an implied Warranty lasts, so the above limitations may not apply to you. This Warranty gives you specific legal rights, and you also may have other rights which vary from state to state.

This Warranty applies only to Products purchased in the United States of America, its possessions, and U.S. and NATO armed forces exchanges and audio clubs. The Warranty terms and conditions applicable to Products purchased in other countries are available from the Polk Audio Authorized Distributors in such countries.

CSi25 Center Channel Loudspeaker

Owner's Manual

polkaudio®

POLK AUDIO, INC. • 5601 METRO DRIVE, BALTIMORE, MD 21215 USA
800.377.7655 • SALES DEPT. FAX: 410.358.2870
WWW.POLKAUDIO.COM



RM2515-1

polkaudio®

POLK AUDIO HISTORY—A PASSION FOR SOUND

Polk Audio was founded in Baltimore in 1972 by Johns Hopkins University graduates Matthew Polk and George Klopfer. Today, Polk Audio is a leading international manufacturer of high quality home, car and multimedia loudspeakers. Polk products emphasize superior sound and build quality, and feature many patented and award-winning innovations. Polk Audio has built a reputation as “The Speaker Specialists.” Polk products are sold throughout the USA, Canada and in over 50 countries around the world. Polk Audio’s mission has always been to build high quality, great sounding speakers at affordable prices. For the people of Polk Audio, building speakers is not just a job; it’s a *passion*.

PLACEMENT RECOMMENDATIONS FOR THE CSi SERIES CENTER CHANNEL LOUDSPEAKER

The CSi Series Center Channel Loudspeaker incorporates the most effective magnetic shielding available so it can be placed safely on or near your TV or video monitor. If you notice video distortion or discoloration, immediately move the speaker away from the TV and call Polk Audio Customer Service 800-377-7655 (9AM to 6PM EST, US or Canada) or polkcs@polkaudio.com. The most popular placement for a center channel speaker is on top of your TV, anchoring the dialogue and effects to the screen [figure 1]. An alternate placement is on a shelf below your TV [figure 1]. If you are using a front projection TV system, place the center channel speaker on a small stand or table immediately below the bottom of the projection screen, or at ear level behind the screen if your screen is acoustically transparent. Consult the owner’s manual for your screen. Adhesive rubber feet are included with your CSi Center Channel Loudspeaker and may be attached to the bottom of the speaker to protect your furniture and keep the speaker in place.

PROCESSOR MODE CONFIGURATION FOR THE CSi SERIES CENTER CHANNEL LOUDSPEAKER

The “bass management” or “speaker configuration” menus of most surround receivers offer the choice of “normal” or “wide” modes for center channel operation. In discrete channel digital processors these modes are referred to as “small” and “large.” Normal (small) mode filters bass frequencies from the center channel speaker and sends them instead to the front left & right main speakers or to the subwoofer output (LFE) jack. Wide (large) mode sends an unfiltered, full range signal to the center channel speaker. Use the Small (normal) mode for optimum center (and surround) channel performance and reliability.

CONNECTING YOUR CSi SERIES LOUDSPEAKER [FIGURE 2]

We recommend 16-gauge or larger speaker wire. Follow the hookup directions included with your receiver. Strip 1/2 inch (12.7mm) of insulation from each of the two conductors of the wire to expose the bare metal and twist each of the individual conductors into single unfrayed strands. Note that one of the terminals on the rear of each speaker is red (+) and the other is black (-). Make certain that you connect the wire from the red (+) terminal of your amplifier or receiver to the red (+) terminal on your speaker and the wire from the black (-) terminal of your amplifier or receiver to the black (-) terminal on your speaker. Most wire has some indicator (such as color-coding, ribbing or writing) on one of the two conductors to help you maintain consistency.

To connect wire to the binding post [figure 3], unscrew the hex nut and insert the bare wire into the hole near the base of the binding post. Do not insert the insulated part of the wire into the hole as this will not give you a good connection. Twist the hex nut back down the binding post until it firmly meets the wire. Do not over tighten.

To use Banana Plugs (US only): Unscrew the binding post lug nuts completely to expose the binding post plugs (plastic plugs inserted into the binding posts). Carefully pry out the binding post plugs to expose banana plug holes. Screw the lug nuts back on the binding posts and insert banana plugs. (This is for US owners only.)

SAFE LIMITS OF OPERATION

Your Polk loudspeakers are made with the highest quality materials for years of trouble-free performance. However, damage to loudspeakers can occur when an amplifier, regardless of its wattage, is made to play at higher listening levels than its power can clearly produce (usually beyond the “1 to 2 o’clock” position on the volume control). This results in very high levels of audible distortion, originating in the amplifier, that can add a harsh, gritty sound to music. Contrary to popular belief, a speaker is more likely to be damaged by trying to get too much volume from a low-powered amp or receiver than from a high powered one.

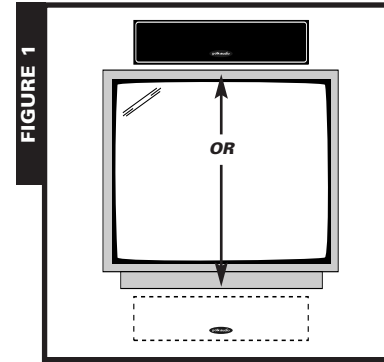

FIGURE 1

Most popular placement, above the TV screen. CSi Series Center Speakers are magnetically shielded for safe placement near TV or video monitors. If you notice video distortion or discoloration, immediately move the speakers away from the video source and call Polk Audio Customer Service 800.377.7655 (US and Canada) or polkcs@polkaudio.com.

La ubicación más común es encima de la pantalla del televisor. Los altavoces centrales de la serie CSi tienen blindaje magnético para poder ubicarlos con seguridad cerca de monitores de televisión o de video. Si nota que hay distorsión o descoloración de la imagen, aleje inmediatamente los altavoces de la fuente de video y comuníquese con el servicio al cliente de Polk Audio.

Disposition la plus courante, au-dessus de l’écran. Les enceintes de la série CSi sont blindées magnétiquement et peuvent être disposées à proximité d’une télé ou d’un moniteur vidéo. Si vous percevez de la distorsion ou de la décoloration vidéo, éloignez immédiatement les enceintes de l’écran et communiquez avec le service à la clientèle de Polk.

Häufigste Platzierung – über dem Fernsehbildschirm. CSi-Mittenlautsprecher sind für eine Platzierung in der Nähe von Fernsehgeräten oder Videomonitoren magnetisch abgeschirmt. Wenn Sie eine Verzerrung oder Verfärbung des Videobildes bemerken, sind die Lautsprecher umgehend von der Videoquelle zu entfernen. Setzen Sie sich in diesem Fall mit dem Kundendienst von Polk Audio in Verbindung.

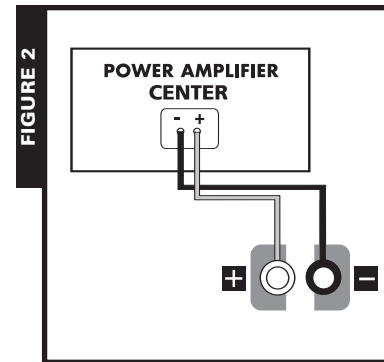

FIGURE 2

Basic Center Channel Speaker hookup diagram. Set Center Channel to “small” in your receiver’s Bass Management settings.

Diagrama básico de conexión.

Diagramme de branchement rudimentaire.

Grundlegendes Anschlussdiagramm.

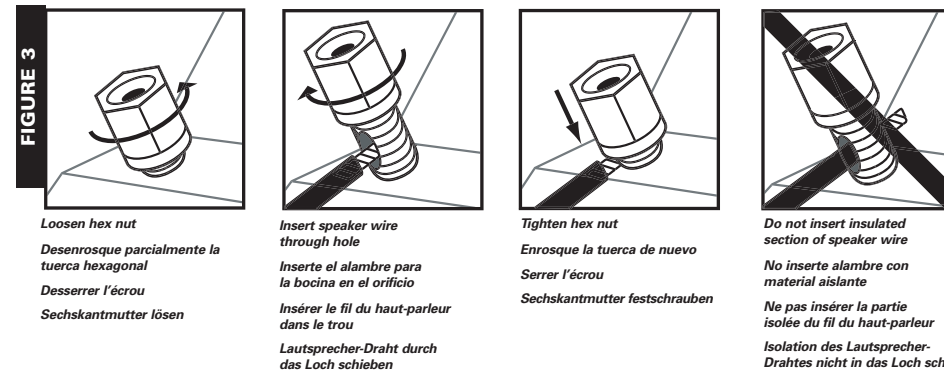

FIGURE 3

Loosen hex nut

Desenrosque parcialmente la tuerca hexagonal
Desserrer l’écrou
Sechskantmutter lösen

Insert speaker wire through hole

Inserte el alambre para la bocina en el orificio
Insérer le fil du haut-parleur dans le trou
Lautsprecher-Draht durch das Loch schieben

Tighten hex nut

Enrosque la tuerca de nuevo
Serrer l’écrou
Sechskantmutter festschrauben

Do not insert insulated section of speaker wire

No inserte alambre con material aislante
Ne pas insérer la partie isolée du fil du haut-parleur
Isolation des Lautsprecher-Drahtes nicht in das Loch schieben

FIGURE 3

Using binding post connections.

Uso de conexiones con tornillos de presión.

Utilisation des bornes de branchement.

Verwendung von Anschlussklemmen.

To use Banana Plugs (US only): Unscrew the binding post lug nuts completely to expose the binding post plugs (plastic plugs inserted into the binding posts). Carefully pry out the binding post plugs to expose banana plug holes. Screw the lug nuts back on the binding posts and insert banana plugs. (This is for US owners only.)

FOR MANUAL UPDATES, VISIT

<http://www.polkaudio.com/home/products/center/csi>

FOR MORE DETAILED HOOK UP AND PLACEMENT INFORMATION, VISIT

<http://www.polkaudio.com/home/faqad/>

FOR RECOMMENDED ACCESSORIES (INCLUDING SPEAKER STANDS, BRACKETS

AND EXCLUSIVE POLK AUDIO LOGOWEAR), VISIT OUR WEBSTORE:

<http://shop.polkaudio.com/>

Free Manuals Download Website

<http://myh66.com>

<http://usermanuals.us>

<http://www.somanuals.com>

<http://www.4manuals.cc>

<http://www.manual-lib.com>

<http://www.404manual.com>

<http://www.luxmanual.com>

<http://aubethermostatmanual.com>

Golf course search by state

<http://golfingnear.com>

Email search by domain

<http://emailbydomain.com>

Auto manuals search

<http://auto.somanuals.com>

TV manuals search

<http://tv.somanuals.com>