



MODEL: **PHST90ICW**
PHST90IBK
PHST90IBGL

2.1 CHANNEL MUSIC CENTER

OWNER'S MANUAL

Please read the manual first before operation

www.pyleaudio.com

Operating Instruction

Dear customers:

Thank you for purchasing the 2.1 channel music center system. We strongly recommend that you carefully study the operating instructions before attempting to operate the unit and that you note the listed safety information.

Safety information

1. This unit can be used only where the power supply is in accordance with the notes on the rear panel of the speaker system. It can't be used elsewhere.
2. To reduce the risk of fire or electric shock, do not expose this unit to rain or moisture.
3. When the unit is not being used, turn the unit off.
4. Do not open covers and repair by yourself. Refer all servicing to qualified personnel.
5. After turning off the unit, if you don't start the unit again in 24 hours, the time would return to the factory reset. When the unit is on, you can adjust the time, please take the operation instruction in the owner's manual for reference.
6. remote control battery:
The button battery has been installed in the remote control. When you use it for the first time, just pull out the insulation layer, and you could use it now.

System Connection

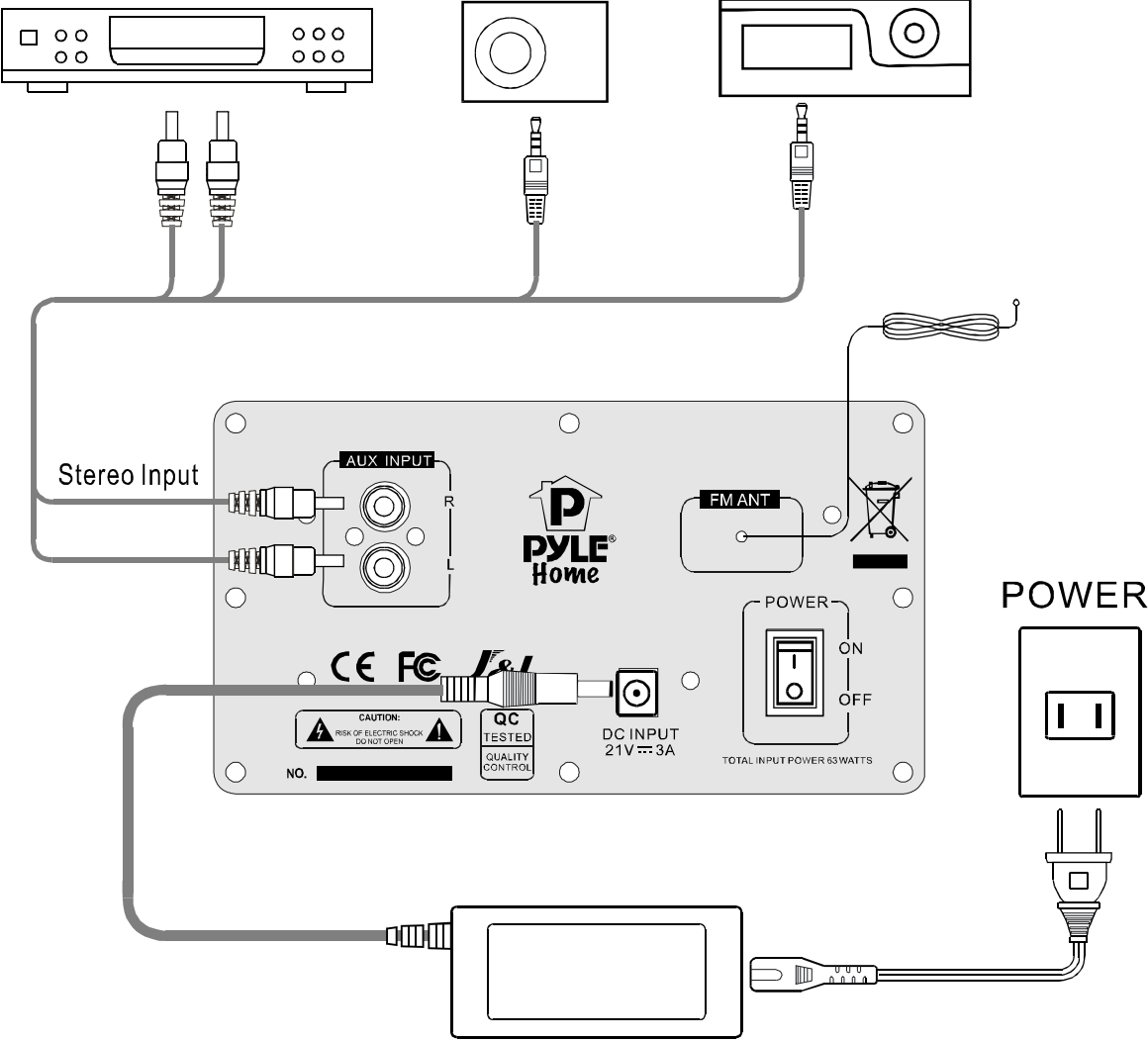
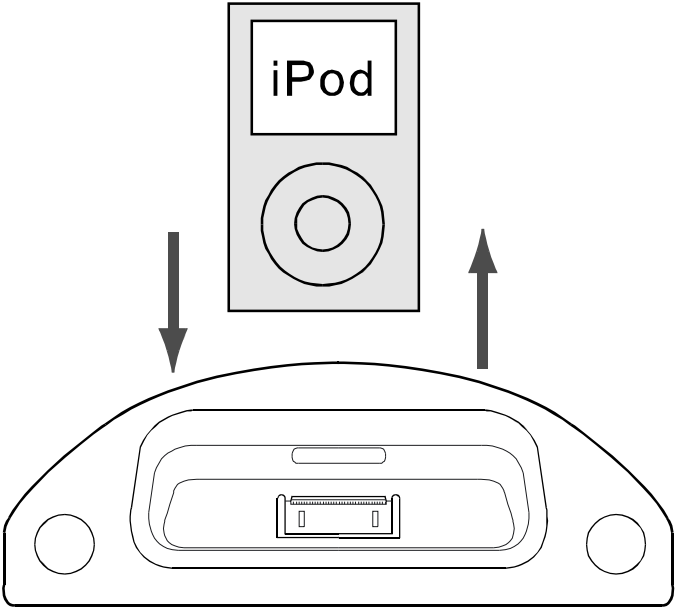

Remote Control

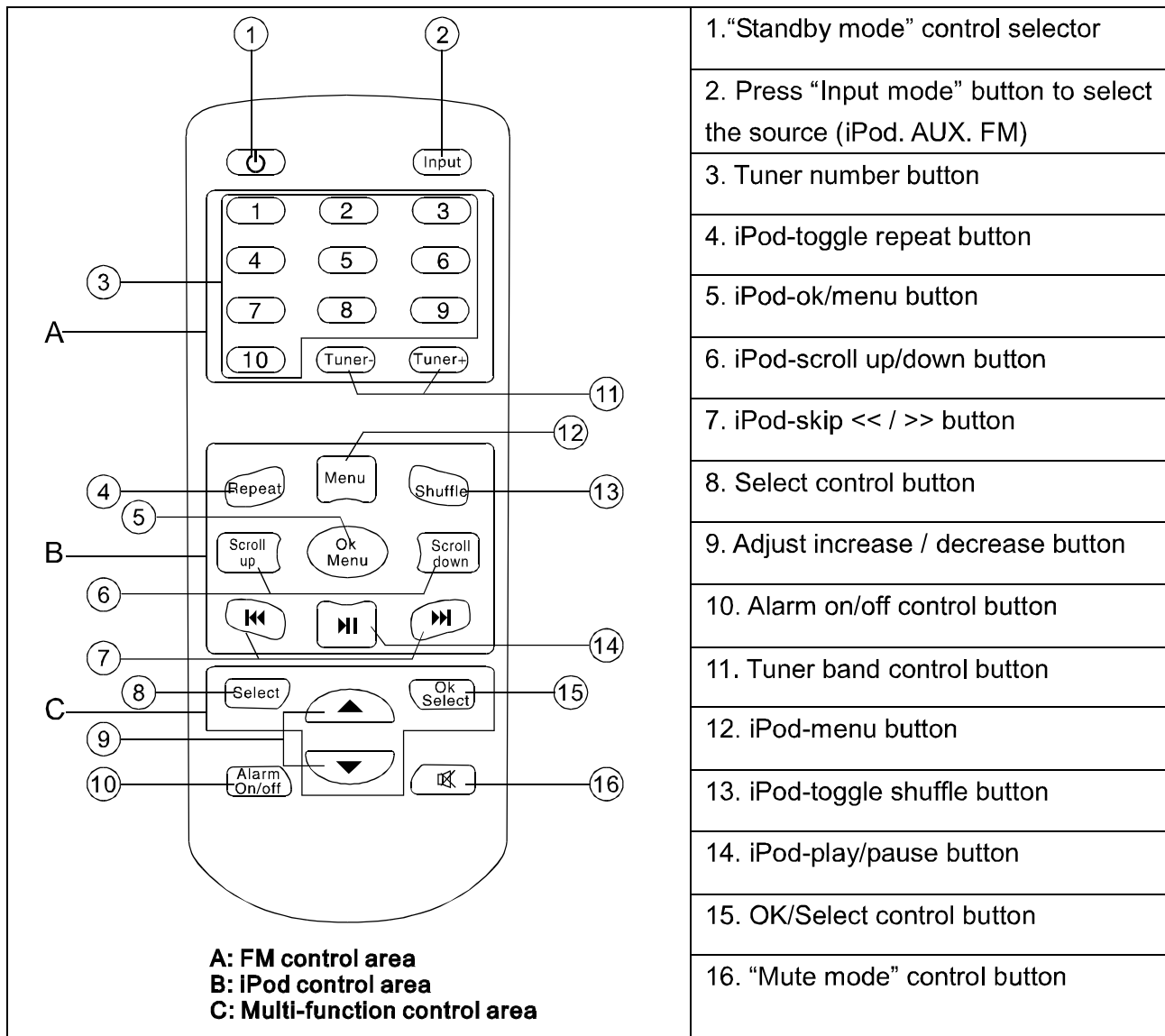

Touch Key Control

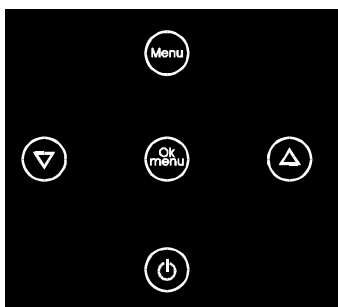

- “Menu” : Touch “Menu” to return to the previous menu.
- “Ok menu” : Touch “OK.menu” to enter to the menu and the operation key of the submenu.
- “▽ △” : Touch “▽ △” to scroll up or scroll down in different function interfaces.
- “⏻” : Touch “⏻” to control the power on/off.

Specifications

- | | |
|------------------|---|
| 1. Output power: | L/R(150W x 1), Subwoofer (300W x 1) |
| 2. Frequency: | L,R 150Hz-20kHz, Subwoofer 50Hz-280Hz |
| 3. Drive unit: | L/R channel 3.5 inch x 2 + dome tweeter
Subwoofer 8 inch |
| 4. S/N: | 85dB |
| 5. THD: | 0.1% |
| 6. Size(DxWxH): | 460mm x 150mm x 1000mm |

LCD Display System

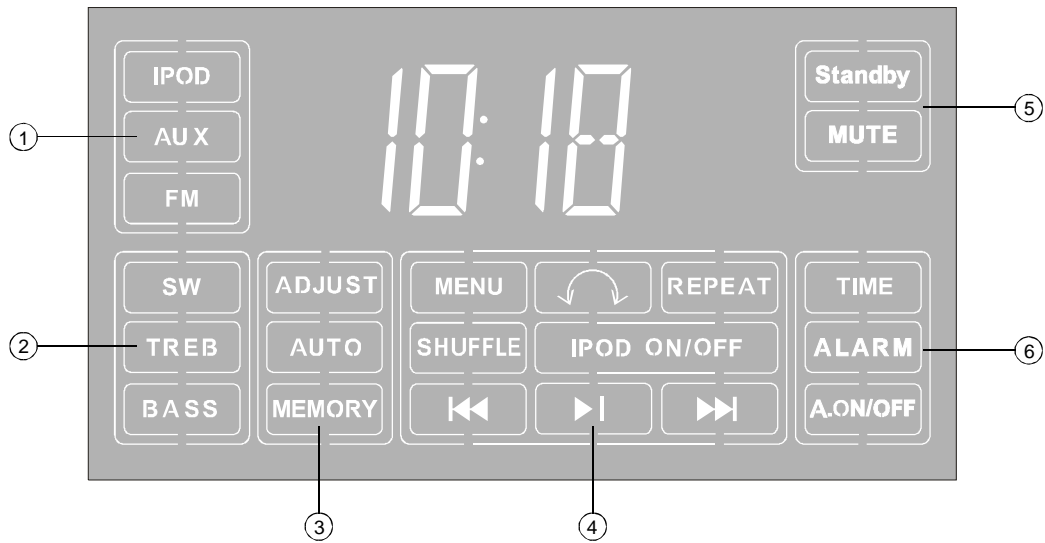

Default main interface

- 1. Input control area
- 2. Volume control area
- 3. Tuner control area

- 4. iPod control area
- 5. System control area
- 6. Time and Alarm control area



First-level subpage



Second-level subpage



Third-level subpage

Operation instructions

● How to open the system

When the "POWER" in the back panel is on, the system will have 5 seconds of self-checking. You can press "⏻" key on the remote control or touch the "⏻" key on the front panel to start this system.

● How to play stereo audio

Press "iPod, AUX, TUNER" input mode on the remote control.

(1) Operations of the remote control

- a. "Alarm on/off": control the on/off of alarm.
- b. Press "Select" key on the remote control, you can select the following three submenu :< time>, <volume>, <alarm>.
- c. Press "OK.Select", you can enter into the next submenu, in which the <volume> includes three group volume adjusters:< treb>< bass>< sw>.
- d. When you want to reset time, you can first enter "time" interface, press "▽, △" to reset the figures of hours, then press the "OK.Select" key to reset the figures of minutes, after that, press "OK.Select" key again, the time on the screen will flicker continuously for 6 times to show the success of time setup.
- e. When you want to set "Alarm", you can first enter "Alarm" interface, then take the method of resetting the time for reference, After the setting of "Alarm", press the " Alarm on/off" key to make the alarm on.

● How to play iPod

- a. Insert iPod into the socket of iPod.
- b. Press the "iPod".
- c. In the middle of remote control, are specially designed for iPod player (iPod control area).

"⏻": Can control the play and pause function of the iPod player.

"⏮, ⏭": Press and hold 2 seconds, you can control iPod player fastforward and fastreverse.

"⏮, ⏭": Can control iPod player to play the previous or the next song.

"Scroll up" Can control the previous catalogue of the iPod player.

"Scroll down" Can control the next catalogue of the iPod player.

"Menu" Can control the iPod player to return to the previous submenu.

 "Ok Menu" Can control the iPod player to enter to the next submenu.

 "Repeat" Can control the iPod player to play repeatedly.

 "Shuffle" Can control the iPod player to play randomly.

● How to play FM tuner

- Press "FM tuner" for radio mode, LCD will show "87.50mHZ".
- "Tuner+/-" controls the increase and decrease of the FM frequency.
- 1-10 number keys separately belong to 10 channels extract or save control keys. If you want to save one channel, press and hold any one of the 10 number keys for about 2 seconds, you will save the channel on the selected number key. When you want to play the channel you saved, just press the number key you have saved.

(2) Operations of Touch Key Control System

- The default main interface of this system shows current time. Touch "▽, △" to up/down for the +/- of the system master volume. Touch "OK.menu" to enter the first-level subpage (control panel). On the control panel interface, Touch "▽, △", you can enter into different control partitions.
- When cursor points to the first-level subpage (control panel), you can touch "OK.menu" again to enter the second-level subpage or touch "▽, △" for the switch of different entrance options. Also, you can touch "OK.menu" to enter the third-level subpage to choose the function you need.
- If you want to return to the previous subpage, you can touch "Menu". And if no any operation is done, the system will return to the default main interface in 5 seconds.

● How to setup clock and alarm by touch key control system

- When cursor points to the clock and alarm control interface, touch "OK.menu" enter the options interface of clock, alarm and alarm on/off, which is the second-level subpage. Then, touch "▽, △" for needed operation or touch "OK.menu" again to enter the third-level subpage. At this moment, you can touch "▽, △" to adjust the figures of hour or minute. After adjustment, touch "OK.menu" again, the clock icon on the LCD will flicker continuously for 6 times to show the success of time setup.
- When setup alarm, choose alarm option on the second-level subpage, the operation is similar to the clock setup. After finish the alarm setup, touch "OK.menu" and hold for 2 seconds to return the third-level subpage for the on/off option of alarm.

● How to play FM tuner by touch key control system

When the cursor points to the "tuner control area", touch "OK.menu" key to enter "ADJUST" option, you can change the needed option through "▽, △" key, then touch the "OK.menu" key to enter "ADJUST" status, then touch "▽, △" to up or to down and the tuner will search manually; choose and enter "AUTO" status, and then touch "▽, △" to up or down once (to up, the FM frequency will decrease, otherwise opposite), the tuner will search automatically. If you want to save the program, just enter the "MEMORY" status, then Press "▽, △" to choose the channel you want to save. At last, press the "OK.menu" once again.

Installing battery in the remote control

Since the remote control will be used for many units to control operations, you should begin by installing the supplied battery:

1. Turn the remote control over and pull out the battery compartment cover.
2. Insert the battery according to the battery compartment.
3. Close the battery compartment cover.

Notes about the remote control

1. If you find that the remote control can not be used at a normal distance to the main unit, then the battery could be weak, so you need to replace the battery with a new one.
2. Remove the battery if the remote control is not used for an extended period of time.
3. If battery leak, remove it immediately, and properly dispose it. Avoid touching the leaked material and splashing it to clothing, etc. Clean the battery compartment thoroughly before installing new battery.

Trouble shooting

Problem	Possible Reasons/solutions
Can't get through power supply. Display can't be turned on.	<ul style="list-style-type: none">• The plug is not inserted properly; the socket has no power; the fuse is broken.• "POWER" button has not been pressed.
No sound at all.	<ul style="list-style-type: none">• Incorrect selection of input signal.• The wire and lead are not connected correctly.• If mute state is turned on.• Sound source machine is not powered
Neither of the main channels have sound.	<ul style="list-style-type: none">• The speaker line is not connected properly.• The signal plug is connected wrongly or lines are short-circuited.
Can't operate or display normally	<ul style="list-style-type: none">• Be affected by exterior strong disturbance, turn off first and then turn on again.• Avoid direct sunlight/heat.



CAUTION
RISK OF ELECTRIC SHOCK
DO NOT OPEN



CAUTION: DO NOT REMOVE BACK OR COVER OF UNIT DUE TO THE POSSIBILITY OF ELECTRICAL SHOCK. THERE ARE NO USER SERVICEABLE PARTS INSIDE THIS UNIT. PLEASE REFER SERVICING TO QUALIFIED SERVICE PERSONNEL.

The lightning flash with arrowhead symbol within an equilateral triangle is intended to alert the user to the presence of uninsulated "dangerous voltage" within the product's enclosure that may be of sufficient magnitude to constitute a risk of electric shock to persons.

The exclamation point within an equilateral triangle is intended to alert the user to the presence of important operating and maintenance (servicing) instructions in the literature accompanying the appliance.

WARNING: TO REDUCE THE RISK OF FIRE OR ELECTRIC SHOCK DO NOT EXPOSE THIS APPLIANCE TO RAIN OR MOISTURE

1. READ INSTRUCTIONS-All safety and operating instructions should be read before the appliance is operated.
2. RETAIN INSTRUCTIONS-Safety and operating instructions should be retained for future reference.
3. HEED WARNINGS-All warnings on the appliance and in the operating instructions should be followed.
4. FOLLOW INSTRUCTIONS-All operating and use instructions should be followed.
5. WATER AND MOISTURE-The appliance should not be used near water, near a bathtub, kitchen sink, laundry tub, in a wet basement, near a swimming pool, etc.
6. CARTS AND STANDS - Do not place this product on an unstable cart, stand, tripod, bracket or table.
7. VENTILATION - The appliance should be situated so that its location and position does not interfere with proper ventilation. The appliance should not be situated on a bed, sofa, rug, or any surface that may obstruct cabinet openings.
8. HEAT - The appliance should be situated away from heat sources such as radiators, heat registers, stoves or other devices (including amplifiers) that produce heat.
9. POWER SOURCES - The appliance should be connected only to a power supply of the type described in the operating instructions or on the appliance. Do not overload wall outlets, extension cords, or integral convenience outlets as this can result in a risk of fire or electric shock.
10. POWER CORD PROTECTION - Power supply cords should be routed so that they are not likely to be walked upon or pinched by items placed upon or against them, paying particular attention to cords at plugs, convenience receptacles, and the point where they exit from the appliance.
11. POLARIZED PLUG - This appliance is equipped with a polarized line plug (a plug having one blade wider than the other). This plug will fit into the power outlet only one way. This is a safety feature. If you are unable to insert the plug fully into the outlet, try reversing the plug. If the plug still fails to fit, contact your electrician to replace your obsolete outlet. Do not attempt to defeat this safety feature.
12. CLEANING - The appliance should be cleaned only as recommended by the manufacturer. Do not use chemical cleaners.
13. LIGHTNING STORMS & NO USE PERIODS - The power cord should be unplugged from the outlet during lightning storms or during long periods of non-use.
14. OBJECT AND LIQUID ENTRY - Care should be taken that objects do not fall onto and liquids are not spilled on the amplifier or speaker.
15. DAMAGE REQUIRING SERVICE - The appliance should be serviced by qualified service personnel when:
 - A. The power supply cord or plug has been damaged; or
 - B. Objects have fallen on or liquid has been spilled into the appliance, or
 - C. The appliance has been exposed to rain or
 - D. The appliance does not appear to operate normally or exhibits a marked change in performance; or
 - E. The appliance has been dropped or the enclosure damaged.
16. SERVICING - The user should not attempt to service the appliance. If parts are replaced during service, be sure the parts meet factory specification. Inappropriate substitution can result in fire or a risk of electric shock. Upon completion of service, ask the technician to perform safety checks on the product. For service and warranty information.

CAUTION
TO PREVENT ELECTRIC SHOCK DO NOT USE THIS (POLARIZED) PLUG WITH AN EXTENSION CORD, RECEPTACLE OR OTHER OUTLET UNLESS THE BLADES CAN BE FULLY INSERTED TO PREVENT BLADE EXPOSURE.



www.pyleaudio.com

Free Manuals Download Website

<http://myh66.com>

<http://usermanuals.us>

<http://www.somanuals.com>

<http://www.4manuals.cc>

<http://www.manual-lib.com>

<http://www.404manual.com>

<http://www.luxmanual.com>

<http://aubethermostatmanual.com>

Golf course search by state

<http://golfingnear.com>

Email search by domain

<http://emailbydomain.com>

Auto manuals search

<http://auto.somanuals.com>

TV manuals search

<http://tv.somanuals.com>