



63-1420

## Worldwide Atomic Clock

Thank you for purchasing your Worldwide Atomic Clock from RadioShack. It receives signals from atomic clock generators so you will always know the exact time. Your clock automatically updates to the current local time when you travel, and you can set it to automatically update for Daylight Savings Time. The clock's display shows your home time, the local time (wherever you are currently located), time zone, temperature, and day of the week.



### installing batteries

Your clock requires two AAA batteries (not supplied) for power.

1. Remove the battery compartment cover.
2. Insert two AAA batteries.
3. Replace the cover.

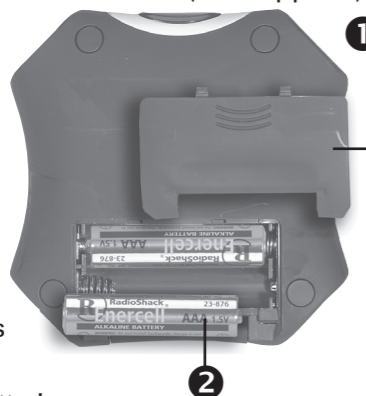

#### Battery Notes:

- Dispose of old batteries promptly and properly.
- Do not burn or bury batteries.
- Use only fresh batteries of the required size and recommended type.
- Do not mix old and new batteries, or batteries with different capacities or different chemistries.
- If you do not plan to use the clock for a month or more, remove the batteries. Batteries can leak chemicals that can damage electronic parts.

### setting the clock

Depending on your location, you may or may not receive an atomic clock signal. If you install batteries and the signal strength indicator (📶) does not appear, you are in an area that does not receive a signal from an atomic clock. See "in regions not receiving an atomic clock signal".

#### in regions receiving an atomic clock signal

The sequence for setting your clock in a region receiving an atomic clock signal generator is:

- 1) automatic signal detection
- 2) select a city or time zone
- 3) set the home time

#### automatic signal detection

1. After batteries are installed, the clock starts searching for an atomic clock signal and 📶 flashes.
2. In about 10 minutes, one of the following abbreviations appears momentarily to indicate the atomic clock from which you are receiving a signal:

Region	Abbreviation
USA	US
UK	UK
North Japan	JP
Europe	EU
South Japan	JP

3. The local time, date, month and year are automatically set and briefly appear on the display.

#### Notes:

- During automatic signal detection, you cannot manually set the time. To override signal detection and manually set the time, hold down **MODE**, **ON/OFF** and **SNOOZE** until 📶 stops flashing.
- For best reception, keep the clock away from equipment that emits RF or microwave signals, such as TVs, radios, or microwaves.
- You may need to position your clock near a window for best reception.
- The most dependable and clear signal is received at night, between midnight and 4am local time.
- The clock receives an atomic signal update every 24 hours and will update accordingly for your location.

Note: Actual product may vary from the images found in this document.

#### select a city or time zone

There are 32 cities and four US time zones stored in your clock. Each city is represented by an abbreviated name, and it's GMT (Greenwich Mean Time). GMT refers to that city or region's time relative to the International Date Line. For example, Honolulu is ten hours behind (-10), and Tokyo is nine hours ahead (+9) of the International Date Line.

1. Press **MODE** three times. An abbreviation flashes.
2. Press **UP** to scroll until you see your home city. If your home city is not listed, select the city listed that is in your time zone.

Abbrev	GMT	City	Abbrev	GMT	City
HNL	-10	Honolulu	LON	0	London
THR	+3.5	Tehran	HKG	+8	Hong Kong
ANC	-9	Anchorage	PAR	+1	Paris
DXB	+4	Dubai	PEK	+8	Beijing
PST	-8	Pacific (USA)	AMS	+1	Amsterdam
KBL	+4.5	Kabul	TPE	+8	Taipei
MST	-7	Mountain (US)	FRA	+1	Frankfurt
KHL	+5	Karachi	TYO	+9	Tokyo
CST	-6	Central (USA)	CAI	+2	Cairo
DEL	+5.5	New Delhi	ADL	+9.5	Adelaide
EST	-5	Eastern (USA)	JRS	+2	Jerusalem
DAC	+6	Dhaka	SYD	+10	Sydney
CCS	-4	Caracas	JED	+3	Jeddah
RGN	+6.5	Yangon	NOU	+11	Noumea
RIO	-3	Rio de Janeiro	MCW	+3	Moscow
BKK	+7	Bangkok	WLG	+12	Wellington

3. Press **SET** to confirm. The time, day, month, date and year are automatically set.

#### set the home time

1. Press **MODE** four times. The time zone (GMT) digits flash.
2. Press **UP** to scroll until your home time zone (GMT) digits appear. For example, if you are from Texas, which is on CST, you will scroll until -6 appears.
3. Press **SET** to confirm.

#### in regions not receiving an atomic clock signal

If your clock starts searching for a signal, you can disable it by holding down **ON/OFF**, **SNOOZE**, and **MODE** until 📶 stops flashing. The sequence for setting your clock in regions not receiving an atomic clock signal is:

- 1) select a city or time zone
- 2) manually set the current time
- 3) set the home time

#### select a city or time zone

Follow steps 1-3 as if you were in an area receiving an atomic clock signal.

#### manually set the current time

1. Hold down **MODE** until the hour digits flash.
2. Press **UP** to scroll through the hours.
3. Press **SET** to confirm the correct hour. The minute digits flash.
4. Press **UP** to scroll through the minutes.
5. Press **SET** to confirm the correct minutes. The second digits flash.
6. Press **UP** to reset the seconds to zero (00).
7. Press **SET** to confirm the seconds.
8. Press **UP** to toggle between **12** or **24** hour time format.
9. Press **SET** to confirm the time format.
10. Press **MODE** once to view the day, month, year and date information.
11. Hold down **MODE** until the year digits flash.
12. Press **UP** to scroll through the years.
13. Press **SET** to confirm the year. The month digits flash.
14. Press **UP** to scroll through the months.
15. Press **SET** to confirm the month. The date digits flash.
16. Press **UP** to scroll through the dates.
17. Press **SET** to confirm the date.

#### Daylight Saving Time (DST)

1. When in time mode, press **MODE** three times.
2. Press **ON/OFF** to enable or disable DST. Your clock will automatically adjust to DST on the appropriate date.

#### set the home time

Follow steps 1-3 as if you were in an area receiving an atomic clock signal.

### what's included

clock      user's guide

Please read this user's guide before installing, setting up and using your new product  
[www.radioshack.com](http://www.radioshack.com)

## using your clock

Press **SNOOZE** (except when the alarm is ringing), to light the backlight for about five seconds.

### view temperature and humidity

1. When in time mode, press **UP** repeatedly to toggle between viewing the temperature or humidity.
2. When the temperature appears, press **SET** to toggle between Celsius and Fahrenheit degrees.

### Notes:

- Temperature and humidity readings are updated every 30 seconds.
- It takes about four minutes for the clock to detect and display the temperature and humidity when it is powered on.
- You cannot view the temperature or humidity while the clock is first receiving (detecting) an atomic clock signal.

### resetting your clock

If your clock stops operating properly, press **RESET** on the back of the clock.

## using the alarm

### setting the alarm

1. Press **MODE** twice. The currently set alarm time and *A1* appear.
2. Hold down **MODE** until the alarm hour digits flash.
3. Press **UP** to scroll until the desired hour appears.
4. Press **SET** to confirm the alarm hour. The alarm minute digits flash.
5. Press **UP** to scroll until the desired minute appears.
6. Press **SET** to confirm the alarm minutes.
7. Press **UP** to toggle between *A1* (alarm 1) and *A2* (Alarm 2).
7. Press **SET** to confirm the alarm.
8. Repeat the above steps to set a second alarm time.

### viewing alarm times

1. Press **MODE** twice. The currently set alarm time and *A1* appear.
2. Press **UP**. *A2* and the second alarm time appear.

If no key is pressed for 10 seconds, the display returns to normal time mode.

### activating and deactivating alarms

1. Press **MODE** twice. The currently set alarm time and *A1* appear.
2. Press **UP** to toggle between *A1* and *A2*.
3. When desired alarm number appears, hold down **ON/OFF** until the alarm icon (🔔) appears for activation, or disappears for deactivation.

### turning off the alarm

1. When the alarm sounds, press **ON/OFF** to turn it off. The alarm will sound again at the set time unless you deactivate it.
2. To temporarily silence the alarm, press **SNOOZE** when the alarm sounds. The alarm sounds again in eight minutes. Press **SNOOZE** again to temporarily silence the alarm, or press **ON/OFF** to turn the alarm off.

## the FCC wants you to know

### FCC Declaration of Conformity

This device complies with Part 15 of the *FCC Rules*. Operation is subject to the following two conditions: (1) this device may not cause harmful interference, and (2) this device must accept any interference received, including interference that may cause undesired operation.

Product: Worldwide Atomic Clock  
Model: 63-1420  
Responsible Party: RadioShack  
100 Throckmorton  
Fort Worth, TX 76102  
Phone: 817-415-3200

### The FCC Wants You to Know

This equipment has been tested and found to comply with the limits for a Class B digital device, pursuant to Part 15 of the *FCC Rules*. These limits are designed to provide reasonable protection against harmful interference in a residential installation. This equipment generates, uses and can radiate radio frequency energy and, if not installed and used in accordance with the instructions, may cause harmful interference to radio communications.

However, there is no guarantee that interference will not occur in a particular installation. If this equipment does cause harmful interference to radio or television reception, which can be determined by turning the equipment off and on, the user is encouraged to try to correct the interference by one or more of the following measures:

- Reorient or relocate the receiving antenna.
- Increase the separation between the equipment and receiver.
- Connect the equipment into an outlet on a circuit different from that to which the receiver is connected.
- Consult your local RadioShack store or an experienced radio/TV technician for help.

If you cannot eliminate the interference, the FCC requires that you stop using your clock.

Changes or modifications not expressly approved by RadioShack may cause interference and void the user's authority to operate the equipment.

## frequently asked questions

- Q** - How far into Eastern Europe is the Continental Europe atomic clock signal detected?
- A** - The atomic clock at Mainflingen transmits within an area of about 1500km radius. The coverage area varies with weather conditions and time of day (coverage increases up to 2500km radius at night).
- Q** - Is signal detection affected by physical barriers?
- A** - Not usually. Long wave frequency is used for atomic clock signal transmission, which is less affected by physical barriers. Major barriers, such as steel reinforced concrete, may cause interference.
- Q** - How long do the batteries last?
- A** - Battery life depends on how often the backlight is used, since the backlight draws a lot of power. If the backlight is used once a day, the batteries will last approximately 9-12 months.
- Q** - If you are in an area covered by two atomic clock signals, such as Western Europe, which signal will be received?
- A** - The first signal the clock receives will be used to set the time. If this does not correspond to your current location, you can select your current city so the time is adjusted relative to GMT.

## specifications

Atomic Radio Signal Transmitters that can be detected:

WWVB ..... Colorado (US)  
DCF-77 ..... Frankfurt (EU)  
MSF-60 ..... Rugby (UK)  
JJ-40 ..... Fukushima (Japan)  
JJY-60 ..... Kyushu (Japan)

Signal Detection Type: ..... TruBit  
Temperature Range: ..... 0°C to 50°C  
Temperature Resolution: ..... ±0.1°C or 0.2°F  
Humidity Range: ..... 30% to 90%  
Humidity Accuracy: ..... ±8% at 25°C / 77°F  
(humidity resolution: 1%)

## limited one-year warranty

This product is warranted by RadioShack against manufacturing defects in material and workmanship under normal use for one (1) year from the date of purchase from RadioShack company-owned stores and authorized RadioShack franchisees and dealers. For complete warranty details and exclusions, check with your local RadioShack store.

RadioShack Customer Relations  
200 Taylor Street, 6th Floor, Fort Worth, TX 76102  
04/04

## Free Manuals Download Website

<http://myh66.com>

<http://usermanuals.us>

<http://www.somanuals.com>

<http://www.4manuals.cc>

<http://www.manual-lib.com>

<http://www.404manual.com>

<http://www.luxmanual.com>

<http://aubethermostatmanual.com>

Golf course search by state

<http://golfingnear.com>

Email search by domain

<http://emailbydomain.com>

Auto manuals search

<http://auto.somanuals.com>

TV manuals search

<http://tv.somanuals.com>