

tc

2010

QUICK
REFERENCE
GUIDE

GET INFORMED.
ROLL.



what moves you

2010 Scion tC

This *Quick Reference Guide* is a summary of basic vehicle operations. It contains brief descriptions of fundamental operations so you can locate and use the vehicle's main equipment quickly and easily.

The *Quick Reference Guide* is not intended as a substitute for the *Owner's Manual* located in the vehicle's glove box. We strongly encourage you to review the *Owner's Manual* and supplementary manuals so you will have a better understanding of the vehicle's capabilities and limitations.

Your dealership and the entire staff of Scion, a marque of Toyota Motor Sales, U.S.A., Inc., wish you many years of satisfied driving in your new SCION tC.

! A word about safe vehicle operations

This *Quick Reference Guide* is not a full description of SCION tC operations. Every SCION tC owner should review the *Owner's Manual* that accompanies this vehicle.

Pay special attention to the boxed information highlighted in color throughout the *Owner's Manual*. Each box contains safe operating instructions to help you avoid injury or equipment malfunction.

All information in this *Quick Reference Guide* is current at the time of printing. Toyota reserves the right to make changes at any time without notice.

INDEX

OVERVIEW

Engine maintenance	7
Fuel tank door opener and cap	6
Hood release	7
Indicator symbols	5
Instrument cluster	4
Instrument panel	2-3
Keyless entry	6

FEATURES/OPERATIONS

Air Conditioning/Heating	14
Automatic Transmission	8
AUX audio jack	14
Clock	14
Cruise control	10
Cup holders	8
iPod jack	15
Light control-Instrument panel	13
Lights & turn signals	11
Panorama moonroof	12
Parking brake	8
Power outlet	13
Seat adjustments-Front	9
Seat adjustments-Rear	9
Seats-Head restraints	9
Steering wheel switches	15
Tilt steering wheel	10
Windows	13
Windshield wipers & washers	12

SAFETY AND

EMERGENCY FEATURES

Door locks	16
Seatbelts	16
Spare tire & tools	17
Tire Pressure Monitoring (warning) System	16

OVERVIEW

Instrument panel

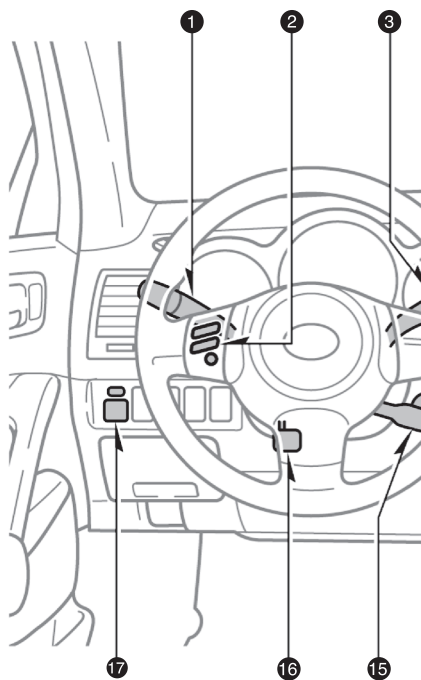

- ① Headlight and turn signal controls
- ② Steering wheel audio controls*
- ③ Wiper and washer controls
- ④ Emergency flasher switch
- ⑤ Clock, Air Conditioning and outside temperature display
- ⑥ Air Conditioning controls
- ⑦ Rear window defogger switch
- ⑧ Outside temperature display switch

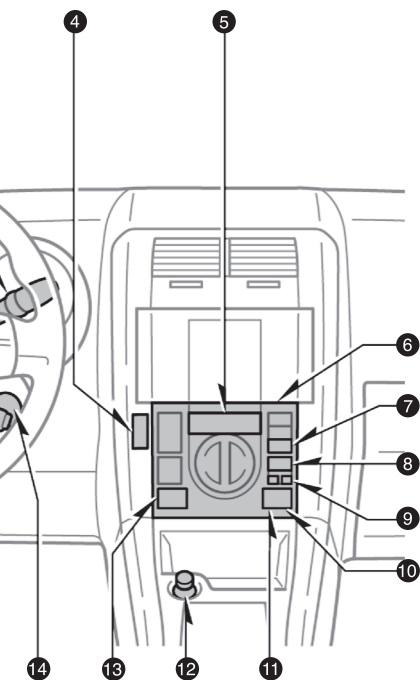

- 9 Clock adjustment buttons
- 10 Front passenger seatbelt reminder light
- 11 Front passenger occupant classification indicator
- 12 Cigarette lighter
- 13 Engine immobilizer system indicator
- 14 Engine switch
- 15 Cruise control
- 16 Tilt steering lock release
- 17 Power outside rearview mirror controls





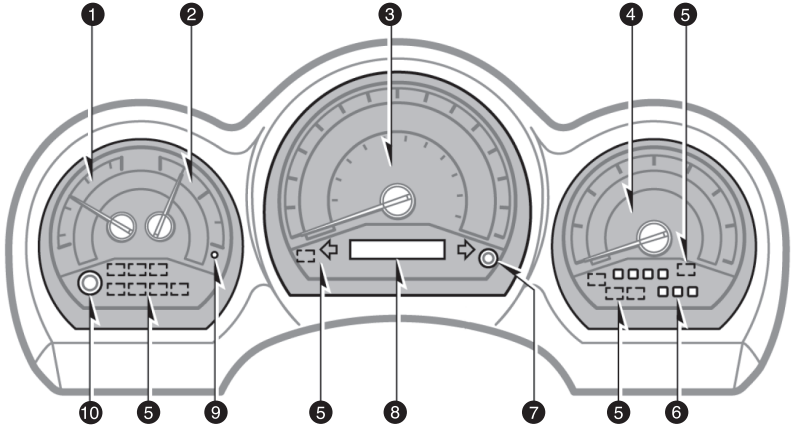





* For details, refer to the "SCION Audio System Owner's Manual" or "SCION Navigation System Owner's Manual."

Instrument cluster



- ① Engine coolant temperature
- ② Fuel gauge
- ③ Speedometer
- ④ Tachometer
- ⑤ Service indicator and reminder
- ⑥ Automatic Transmission shift position indicator
- ⑦ Trip meter reset knob
- ⑧ Odometer and two trip meters
- ⑨ Low fuel level warning
- ⑩ Instrument panel light control knob

Indicator symbols

BRAKE	Brake system warning ¹
	Driver seatbelt reminder ¹ (alarm will sound if speed is over 9 mph)
PASSENGER	Front passenger seatbelt reminder ¹ (alarm will sound if speed is over 9 mph)
	
	Charging system warning ¹
	Malfunction/Check Engine indicator ¹
	Low engine oil pressure warning ¹
	Open door warning ¹
	Airbag SRS warning ¹
	Low Tire Pressure Warning ¹
MAINT REQD	Engine oil replacement reminder ¹
	Turn signal indicators
	Headlight high beam indicator
PRND 3 2 L	Automatic Transmission indicator
CRUISE	Cruise control indicator ²
ABS	Anti-lock Brake System warning ¹

¹ For details, refer to "Service reminder indicators and warning buzzers," Section 1-6, 2010 Owner's Manual.

² If this light flashes, refer to "Cruise control," Section 1-7, 2010 Owner's Manual.

Fuel tank door opener and cap

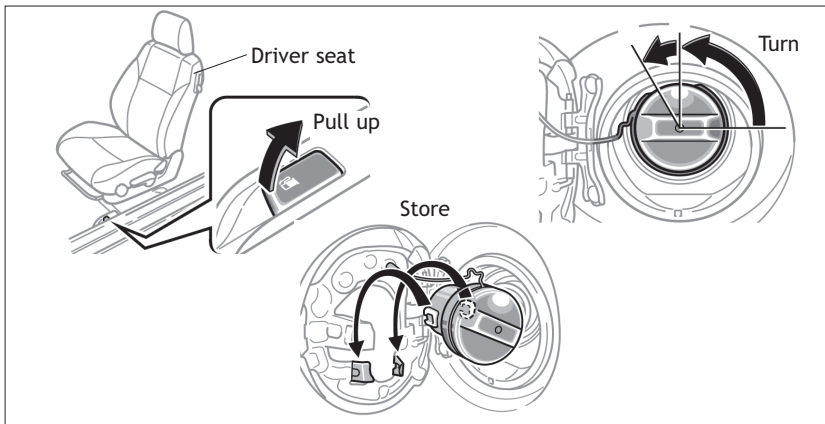

NOTE: Tighten cap until one click is heard. If the cap is not tightened enough, Check Engine "CHECK" indicator may illuminate.

Keyless entry

Locking operation

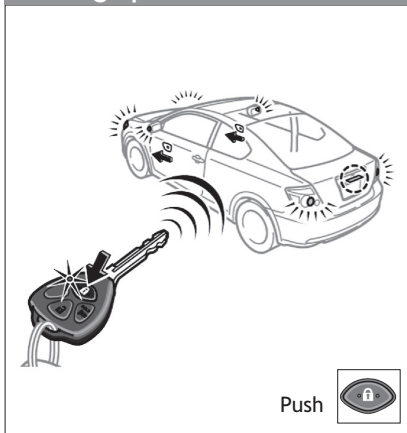

Unlocking operation

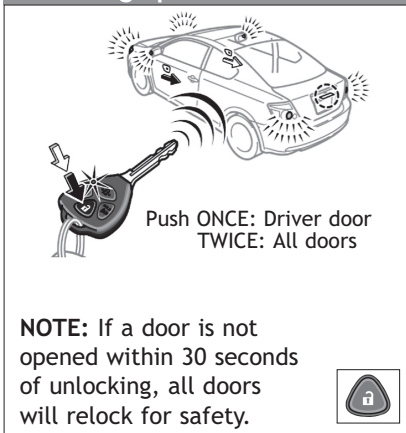

Panic button



Hood release

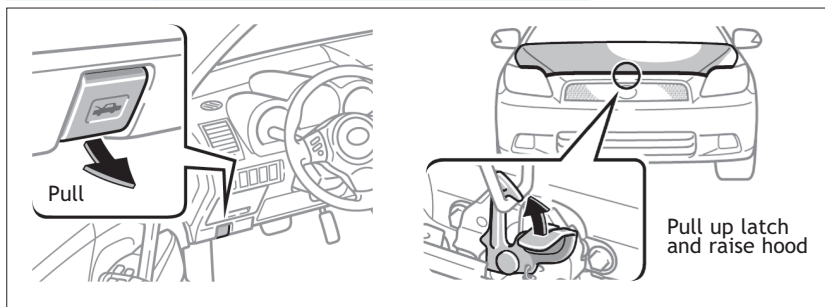

Engine maintenance

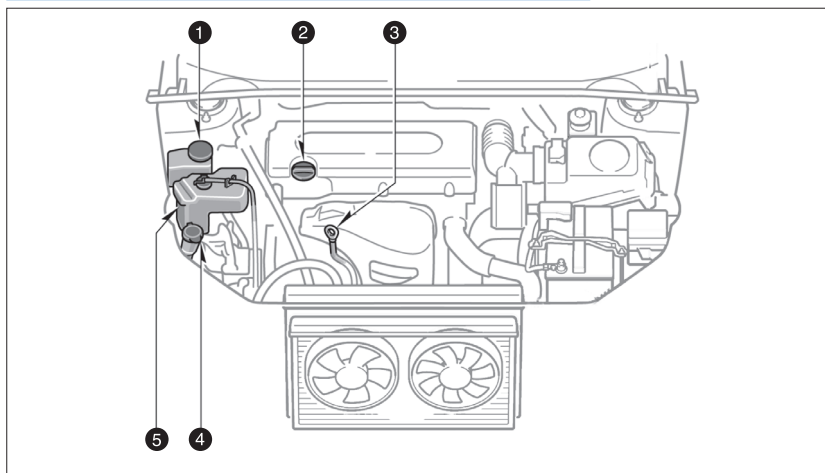

- ① Power steering fluid reservoir
- ② Engine oil filler cap
- ③ Engine oil level dipstick
- ④ Windshield washer fluid tank
- ⑤ Engine coolant reservoir

Note: Regularly scheduled maintenance, including oil changes, will help extend the life of your vehicle and maintain performance. Please refer to the "Warranty Maintenance Guide."

FEATURES/OPERATIONS

Automatic Transmission (if equipped)

- | | |
|----------|-------------|
| P | Park* |
| R | Reverse |
| N | Neutral |
| D | Drive |
| 3 | Third gear |
| 2 | Second gear |
| L | First gear |

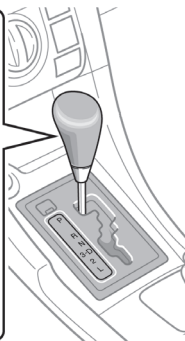

* The engine switch must be "ON" and the brake pedal depressed to shift from Park.

Downshifting increases power going uphill, or provides engine braking downhill. For best fuel economy during normal driving conditions, always drive with the shift lever in the "D" position.

Parking brake

Set

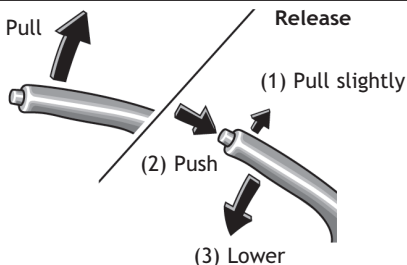

BRAKE

Cup holders

Front

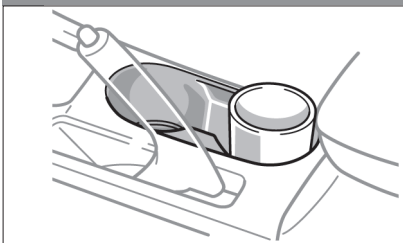

Rear

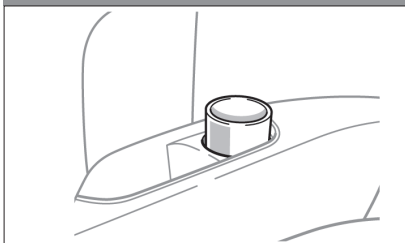

Seat adjustments-Front



- ① Position (forward/backward)
- ② Cushion angle (if equipped)
- ③ Height crank (driver side only)
- ④ Seatback angle
- ⑤ Seatback lock release (if equipped)

Seat adjustments-Rear

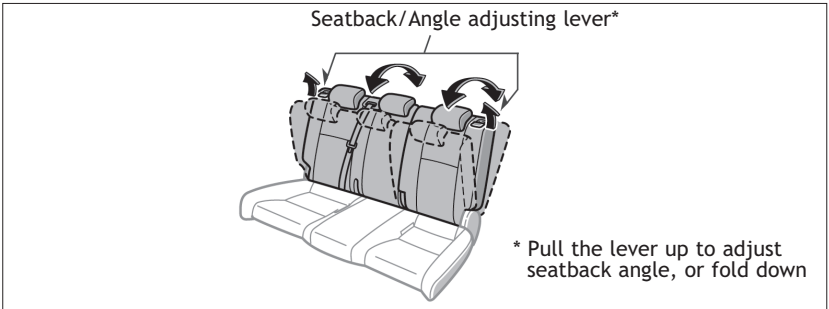

Seats-Head restraints

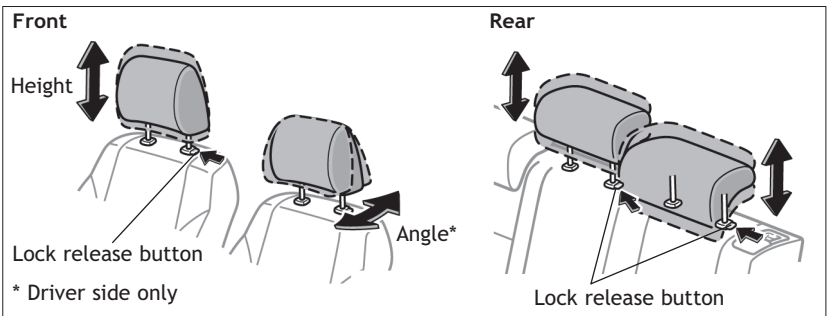

Tilt steering wheel

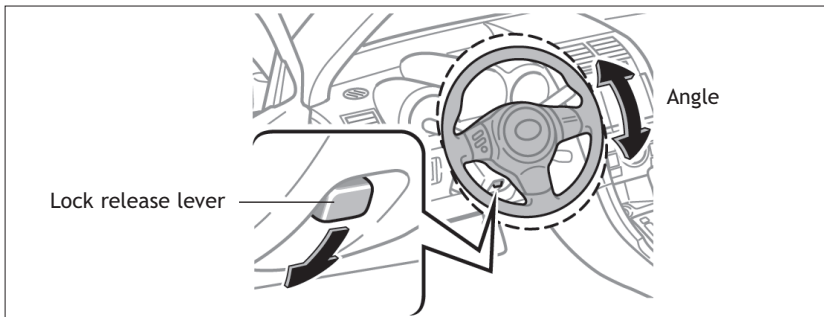

Hold wheel, push lever down, set angle, and return lever.

Note: Do not attempt to adjust while the vehicle is in motion.

Cruise control

Turning system ON/OFF

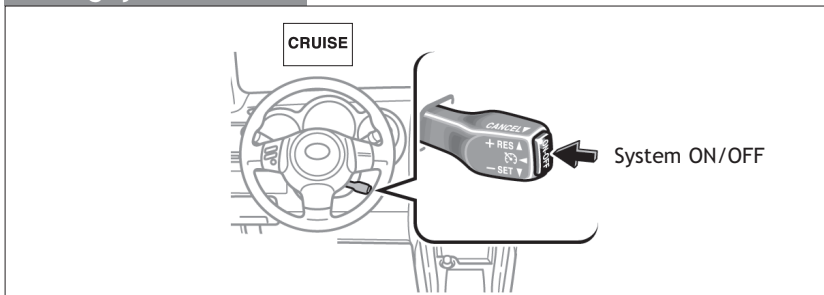

Functions

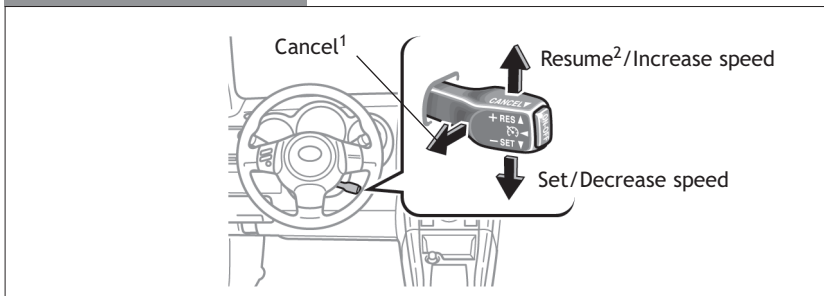

¹ The set speed may also be cancelled by depressing the brake pedal.

² The set speed may be resumed once vehicle speed reaches 25 mph.

Lights & turn signals

Headlights

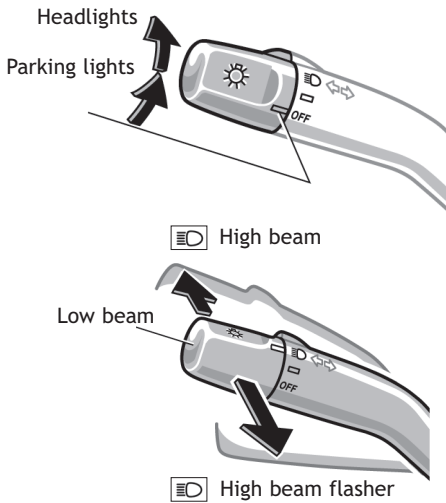

Automatic light cutoff system Automatically turns lights off when driver's door is opened with the engine off.

Turn signals

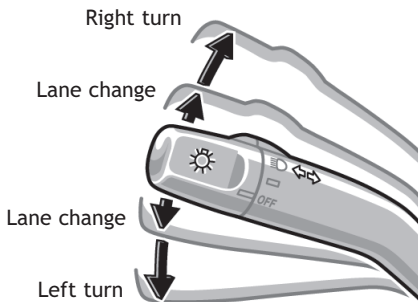

Windshield wipers & washers

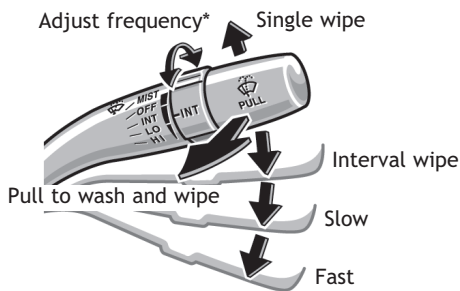

* Intermittent windshield wiper frequency adjustment
 Rotate to increase/decrease wiper frequency (if equipped).

Panorama moonroof

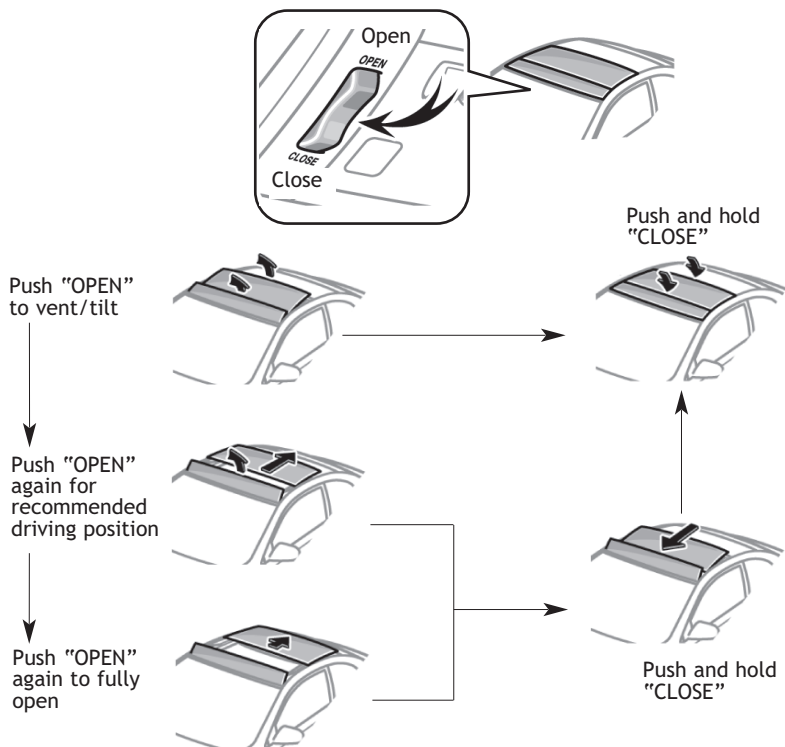

NOTE: If battery is disconnected, the moonroof needs to be reinitialized. Refer to the *Owner's Manual* for more details.

Windows

Driver door window controls

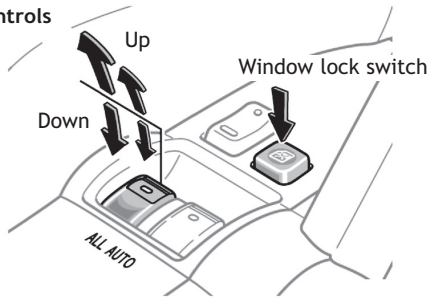

Automatic operation (all windows) Push the switch completely down or pull it completely up and release to fully open or close. To stop window midway, lightly push the switch in the opposite direction.

Window lock switch Deactivates all passenger windows. Driver's window remains operable.

NOTE: If battery is disconnected, the windows need to be reinitialized. Refer to the *Owner's Manual* for more details.

Light control-Instrument panel

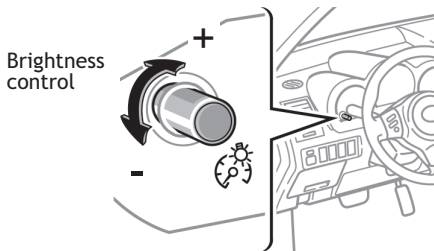

Brightness control

Power outlet (if equipped)

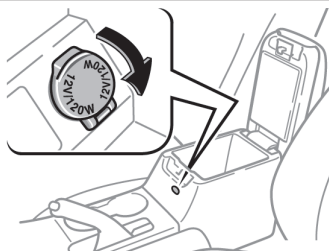

Designed for car accessories. Key must be in the "ACC" or "ON" position to use.

Air Conditioning/Heating

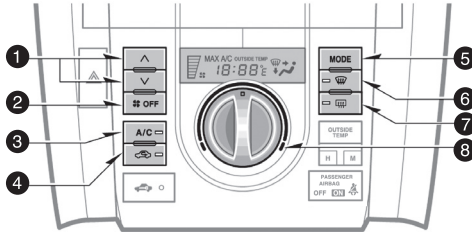

- 1 Fan speed
- 2 Air Conditioning/Heating system "OFF"
- 3 Air Conditioning ON/OFF
- 4 Fresh or recirculated cabin air
- 5 Airflow vent
In "☀️" mode, use fresh air ("🚗" indicator OFF) to reduce window fogging.
- 6 Windshield airflow
- 7 Rear window defogger
- 8 Temperature selector

AUX audio jack

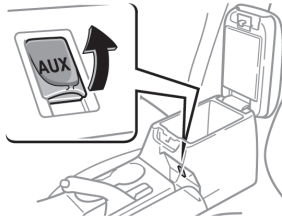

By inserting a mini plug into the AUX jack, you can listen to music from a portable audio device through the vehicle's speaker system while in AUX mode. If you do not have a SCION genuine audio system, you will not be able to use the AUX jack.

Refer to the *SCION Audio System Owner's Manual* or the *SCION Navigation System Owner's Manual* for more details.

Clock

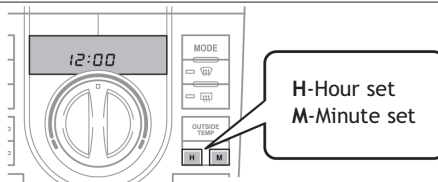

Steering wheel switches

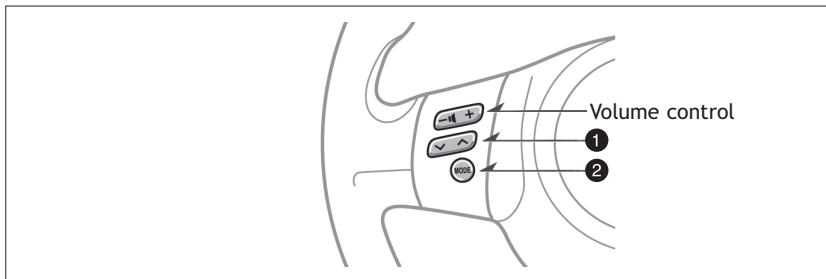

1 "V ▲"

-In **radio mode** Push to select a preset station; push and hold to seek the next strong station.

-In **CD mode** Push to skip up or down to a next/previous track.

2 "MODE"

Push to turn audio ON and select an audio mode. Push and hold to turn audio system OFF.

Refer to the *SCION Audio System Owner's Manual* or the *SCION Navigation System Owner's Manual* for more details.

iPod jack



By inserting the standard iPod connector cable into the iPod jack, you can charge the iPod battery, control the iPod functions using the car audio unit and listen to music from your iPod through the vehicle's speaker system.

If you do not have a SCION genuine audio system, you will not be able to use the iPod jack.

Refer to the *SCION Audio System Owner's Manual* or the *SCION Navigation System Owner's Manual* for more details.

SAFETY AND EMERGENCY FEATURES

Door locks

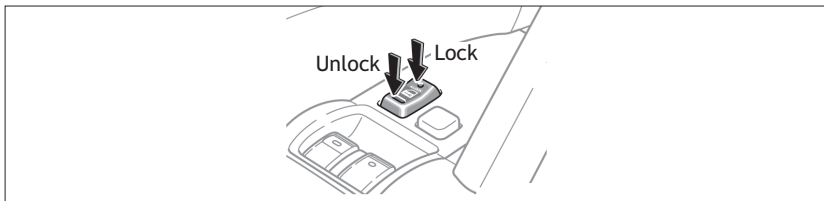

Seatbelts

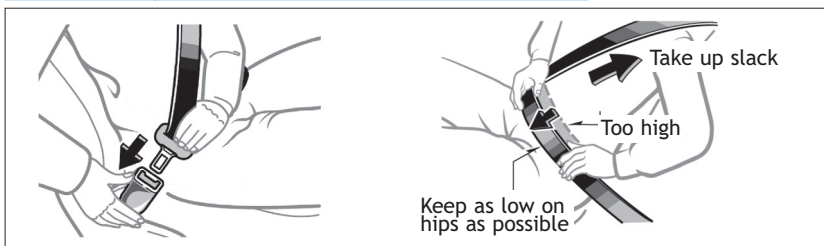

If belt is fully extended, then retracted even slightly, it cannot be re-extended beyond that point, unless fully retracted again. This feature is used to help hold child restraint systems securely.

To find more information about seatbelts, and how to install a child restraint system, refer to the *Owner's Manual*.

Tire Pressure Monitoring (warning) System

If tire pressure indicator light is on, check/adjust each tire.

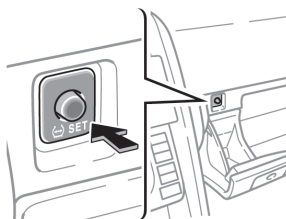

After adjusting tire pressures, or after tires have been rotated or replaced, turn the ignition switch to "ON" and press and hold the "SET" button until indicator blinks three times. Then allow the vehicle to sit for a few minutes to allow initialization to complete.

Refer to the load label on the door jamb or the *Owner's Manual* for tire inflation specifications.

If the tire pressure indicator flashes for more than 60 seconds and then remains on, take the vehicle to your local Toyota dealer.

Spare tire & tools

Tool location

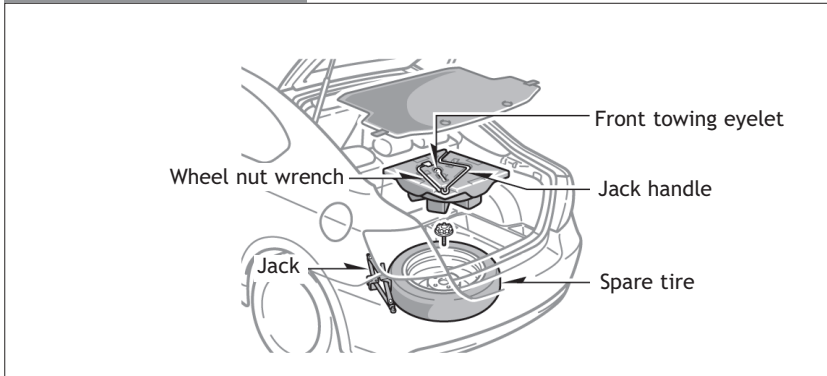

Removing the spare tire

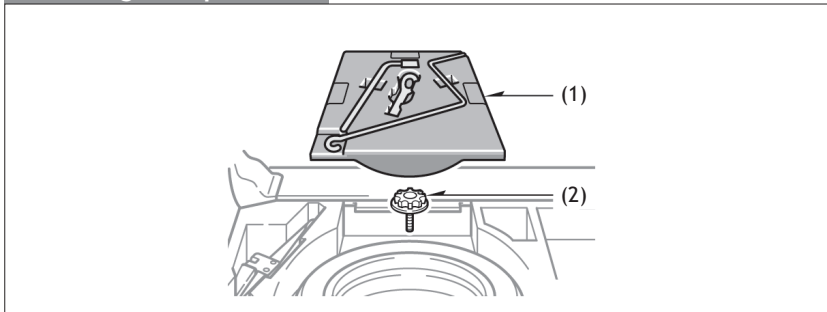

- (1) Remove the spare tire cover.
- (2) Loosen and remove the bolt.

Refer to the *Owner's Manual* for jack positioning and tire changing procedures.

EMAIL

www.scion.com

→ Contact

-

CHAT

www.scion.com

→ Have a Question?

→ Contact

-

PHONE

1.866.70.SCION

-

MAIL

SCION

19001 S. Western Ave.

D102, P.O. Box 2742

Torrance, CA 90509-2742

USA

-

WEB

www.scion.com

-



Mixed Sources

Product group from well-managed
forests, controlled sources and
recycled wood or fiber

www.fsc.org Cert no. SGS-COC-005612
© 1996 Forest Stewardship Council



©2009 Scion, a marque of Toyota Motor Sales, U.S.A., Inc.

Printed in U.S.A. 4/09

08-TCS-03076

00505-QRG10-TC

Free Manuals Download Website

<http://myh66.com>

<http://usermanuals.us>

<http://www.somanuals.com>

<http://www.4manuals.cc>

<http://www.manual-lib.com>

<http://www.404manual.com>

<http://www.luxmanual.com>

<http://aubethermostatmanual.com>

Golf course search by state

<http://golfingnear.com>

Email search by domain

<http://emailbydomain.com>

Auto manuals search

<http://auto.somanuals.com>

TV manuals search

<http://tv.somanuals.com>