

AM/FM STEREO CASSETTE PLAYER

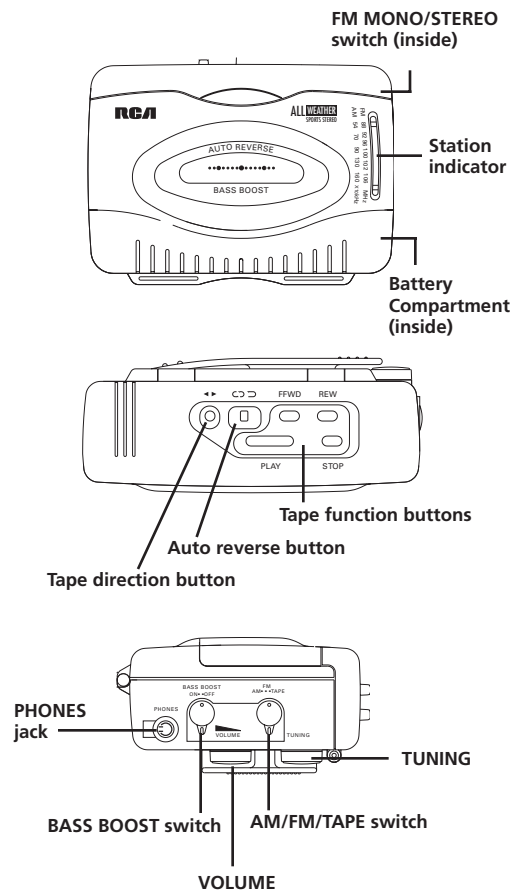

RCA
RP-1510



FEDERAL COMMUNICATIONS COMMISSION (FCC) INFORMATION

This device complies with Part 15 of the FCC Rules. Operation is subject to the following two conditions: (1) This device may not cause harmful interference, and (2) This device must accept any interference received, including interference that may cause undesired operation.

In accordance with FCC requirements, changes or modifications not expressly approved by Thomson Consumer Electronics could void the user's authority to operate this product.

BATTERY INSTALLATION

The battery compartment is located behind the cassette compartment door. To access it, lift up the top of the unit and pull the cassette compartment door open.

1. Open battery compartment by gently squeezing the tab in and pulling up the cover.
2. Install the two "AA" renewable alkaline batteries included.
3. Replace battery door.

IMPORTANT BATTERY INFORMATION

- Alkaline or alkaline renewable batteries are recommended.
- Rechargeable batteries may result in shorter playing time.
- Remove batteries if storing the unit for a month or more to avoid leakage.
- Dispose of batteries in the proper manner, according to federal, state and local regulations.
- Any battery may leak electrolyte if mixed with a different battery type; if inserted incorrectly; if all batteries are not replaced at the same time; if disposed of in fire; or if an attempt is made to charge a battery not intended to be recharged.
- Discard leaky batteries immediately to avoid possible skin burns or other personal injury.

ANTENNAS

The headphone cord serves as the FM antenna. Because this antenna is directional, repositioning can improve reception. The built-in AM antenna is somewhat directional. It may be necessary to slightly rotate the unit to strengthen weak AM signals.

ALL WEATHER DESIGN

This unit is splash-resistant and not designed to be used underwater. DO NOT SUBMERGE.

- Avoid exposing the unit to saltwater or salt spray.
- To ensure watertight seal of battery compartment, check to make sure the cabinet area around the compartment is free of dirt and water before opening. Be sure to close battery compartment cover firmly after installing batteries.

The in-ear headphones are not water-resistant and are not intended for use under water. DO NOT SUBMERGE.

CAUTION/CARE

Do not expose the unit to extreme temperatures, such as those caused by a hot stove or the inside of a car parked in the summer sun. Such conditions can damage the unit. Always clean with a soft cloth, dampened with water only.

RADIO USE

1. Plug headphones into jack. Set volume to minimum level.
- NOTE:** Always set volume to minimum level, turn radio on and put headphones in place before adjusting to desired volume.
2. Slide AM/FM/TAPE switch to the either AM or FM.
 3. Use the TUNING dial on side of the unit to tune in radio stations.
 4. Put BASS BOOST on and adjust VOLUME to desired level.
 5. Slide AM/FM/TAPE switch to TAPE to turn radio off.

WEAK RECEPTION

If the reception of an FM station transmitting in stereo is weak, adjusting the headphone cord may help. If not, slide the FM MONO/STEREO switch to MONO to improve reception. In doing so, realize that you will no longer be listening to that station in stereo.

TAPE USE

1. Lift top cover, open cassette door and insert tape, exposed side up. Close door and put down top cover.
2. Plug headphones into jack and set VOLUME to minimum level.
3. Slide AM/FM/TAPE switch to TAPE.
4. Press PLAY to start tape play. When tape ends, the unit will automatically reverse direction and play the other side. To manually reverse tape and play other side while in continuous play mode, press (◀▶) button.
5. Set BASS BOOST and VOLUME at desired level.
6. Press STOP to end tape play. Always stop tape play before opening cassette door.
7. Use FAST FORWARD button to quickly advance tape and REWIND button to quickly move tape backward. Always stop tape play before and after fast forwarding or rewinding.

Cleaning the Heads: Iron oxide particles eventually build up on parts that touch the tape. This can cause a muffled sound. Use liquid head cleaner or a head cleaning tape to clean the heads.

USING AUTO REVERSE/CONTINUOUS PLAY

To continuously play both sides of the tape, set the auto reverse switch to .

To play each side of the tape once, set the auto reverse switch to .

LIMITED WARRANTY

What your warranty covers:

- Any defect in materials or workmanship.

For how long after your purchase:

- One year. (The warranty period for rental units begins with the first rental or 45 days from date of shipment to the rental firm, whichever comes first.)

What we will do:

- Provide you with a new or, at our option, a refurbished unit.
- The exchange unit is under warranty for the remainder of the original product's warranty period.

How to make a warranty claim:

- Properly pack your unit. Include any cables, etc., which were originally provided with the product. We recommend using the original carton and packing materials.
- Include in the package evidence of purchase date such as the bill of sale. Also print your name and address and a description of the defect. Send standard UPS or its equivalent to:

Thomson Consumer Electronics, Inc.
Product Exchange Center
32 Spur Drive
El Paso, Texas 79906

- Insure your shipment in case of loss or damage. Thomson accepts no liability in case of damage or loss.
- Pay any charges billed to you by the Exchange Center for service not covered by the warranty.
- A new or refurbished unit will be shipped to you prepaid freight.

What your warranty does not cover:

- Customer instruction. (Your Owner's Manual provides information regarding operating instructions and user controls. For additional information, ask your dealer.)
- Installation and setup service adjustments.
- Batteries.
- Damage from misuse or neglect.
- Products which have been modified or incorporated into other products.
- Products purchased or serviced outside the USA.
- Acts of God, such as but not limited to lightning damage.

How state law relates to this warranty:

- This warranty gives you specific legal rights, and you may have other rights which vary from state to state.

If you purchased your product outside the USA:

- This warranty does not apply. Contact your dealer for warranty information.

SERVICE

This product should be serviced only by those specially trained in appropriate servicing techniques. For instructions on how to obtain service, refer to the warranty in this guide. Attach your sales receipt for future reference, or write down the date you purchased/received this product as a gift. This information will be valuable if service should be required during the warranty period.

Purchase Date _____

Name of Store _____

HAVE A BLAST - JUST NOT IN YOUR EARDRUMS!

Make sure you turn down the volume on the unit before you put on the headphones. Increase the volume to the desired level only after headphones are in place.



THOMSON CONSUMER ELECTRONICS

©1997 Thomson Consumer Electronics, Inc.
Trademark(s) © Registered
Marca(s) © Registradas

Model RP-1510
20734880 (Rev. 1, E/S)

97-46
Printed in China

Free Manuals Download Website

<http://myh66.com>

<http://usermanuals.us>

<http://www.somanuals.com>

<http://www.4manuals.cc>

<http://www.manual-lib.com>

<http://www.404manual.com>

<http://www.luxmanual.com>

<http://aubethermostatmanual.com>

Golf course search by state

<http://golfingnear.com>

Email search by domain

<http://emailbydomain.com>

Auto manuals search

<http://auto.somanuals.com>

TV manuals search

<http://tv.somanuals.com>