

RadioShack™



- n Automatic Power Save
- n Lighted Display
- n Monitor Feature
- n Channel Search Feature
- n Clear Communications Up to Several Miles
- n No License Required!

FRS-108

Family Radio

Owner's Manual
Cat. No. 21-1808

RadioShack
A Division of Tandy Corporation
Fort Worth, Texas 76102
Printed in Japan 1A7

Specifications are typical; individual units might vary. Specifications are subject to change and improvement without notice.

Channel	Frequency (MHz)	Channel	Frequency (MHz)
1	462.5625	8	467.5625
2	462.5875	9	467.5875
3	462.6125	10	467.6125
4	462.6375	11	467.6375
5	462.6625	12	467.6625
6	462.6875	13	467.6875
7	462.7125	14	467.7125

Frequencies:

- Channels 14
- Output Power 300 mW ERP
- Battery Life (Alkaline) 120 Hours
- (at stand-by)
- Battery Power (Alkaline) 4.5 VDC
- @ 300 mAh

SPECIFICATIONS

WELCOME TO FRS

RadioShack welcomes you to the next generation of personal communications — the Family Radio Service (FRS). FRS is a new two-way, short-range, voice radio service that lets families and groups keep in touch on specific reserved channels. And, you don't need a license to use an FRS radio.

Your RadioShack FRS-108 is a lightweight, palm-sized radio that you can carry almost anywhere. Use it at shopping malls, amusement parks, or sports events to contact family and friends, or in a neighborhood watch for vital communications.

You can talk with another person who has an FRS radio if both radios are tuned to the same *channel*. Each channel is a specific *frequency*. If someone else is using the channel you selected and you do not want to hear that person, you can select another channel. Your radio has 14 channels.

© 1996 Tandy Corporation.
All Rights Reserved.

RadioShack is a trademark used by Tandy Corporation.

PUTTING BATTERIES IN YOUR RADIO

Your radio uses three AA batteries (not supplied) for power. We recommend alkaline batteries, such as Cat. No. 23-552.

Caution: Do not mix old and new batteries or different types of batteries.

Note: Rechargeable batteries do not provide as much battery life as alkaline batteries. We do not recommend using rechargeable batteries in this radio.

Be sure the radio is off, then press down the tab on the battery compartment cover and lift the cover. Install the batteries as shown, then replace the cover.

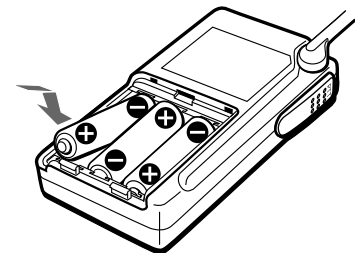
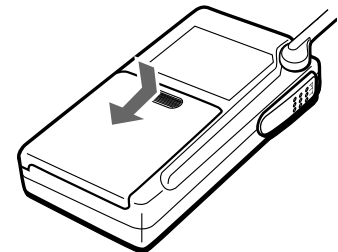

USING YOUR RADIO

For maximum range, flip up the **antenna** before you press **PTT** to talk.

You can operate the radio without flipping up the antenna, but its range is best with the antenna up.

To talk, hold down **PTT** (push to talk), wait about 1 second, then speak into the microphone. TX/RX above the display lights red. When you finish speaking, release **PTT**.

To select a channel, quickly press and release **▼** or **▲**.

To search the channels for transmissions, hold down **▼** or **▲** for about 1 second. The radio stops if it finds a transmission, and the channel number flashes. When the transmission stops, the radio begins searching again.

To break off a transmission and continue searching, press **▼** or **▲** again. To stop searching and listen to a channel, press **MONITOR** or **PTT**.

To turn the radio on and off, hold this down for about 1 second.

To control the volume

TX/RX (transmit/receive) lights red when you talk. It lights green when you receive and when you hold down **MONITOR**.

Display

To check the battery's capacity, look at the display. The battery indicator changes from **F**(ull) to **E**(mpty) as battery power is used.

The automatic power save feature automatically extends battery life by reducing the power the radio uses until it receives a signal or you press a key. Because the receiving radio might be in power save mode, wait about 1 second after pressing **PTT** to give the other radio time to come to full power before speaking into the microphone.

You normally don't hear anything on a channel unless someone is transmitting nearby on the same channel (this is called *auto-squelch*). To hear everything happening on a channel, including weak transmissions, hold down **MONITOR**. TX/RX lights green. Release **MONITOR** to turn auto-squelch back on.

To light the display, quickly press **LIGHT/LOCK**.

You can lock **▼** and **▲** so you can't change the channel until you unlock them. To lock and unlock **▼** and **▲**, hold down **LIGHT/LOCK** for about 1 second. **Ⓛ** appears on the display when **▼** and **▲** are locked.

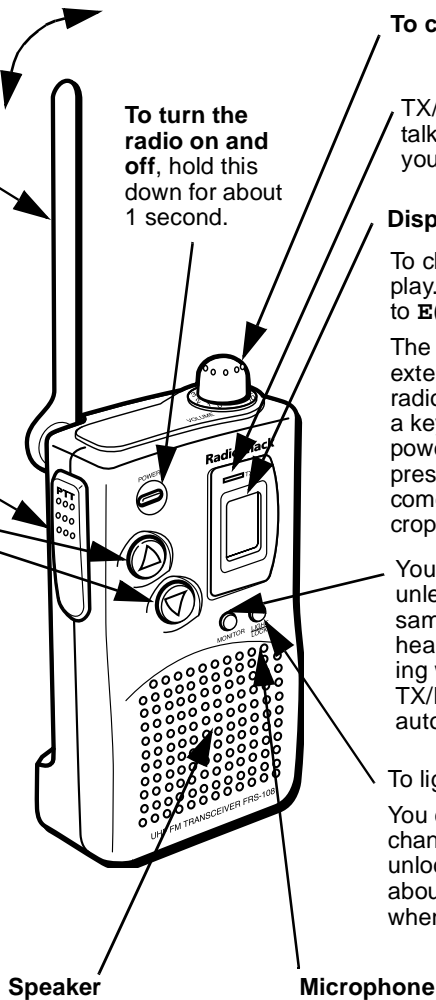

FCC INFORMATION

Important: Do not open your radio to make any internal adjustments. Your radio is set up to transmit a regulated signal on an assigned frequency. It is against the law to alter or adjust the settings inside the radio to exceed those limitations. Any adjustments to your radio must be made by a qualified technician using the proper test equipment. To be safe and sure:

- Never open your radio's case.
- Never change or replace anything in your radio except the batteries.

This equipment complies with the limits for a Class B digital device as specified in Part 15

of *FCC Rules*. These limits provide reasonable protection against radio and TV interference in a residential area. However, your equipment might cause TV or radio interference even when it is operating properly. To eliminate interference, you can try one or more of the following corrective measures:

- Reorient or relocate the receiving antenna
- Increase the distance between the transceiver and the radio or TV

Consult your local RadioShack store if the problem still exists.

RADIO CARE

To enjoy your radio for a long time:

- Handle it gently.
- Keep it away from dust, moisture, and temperature extremes.
- Clean it with a damp cloth. Do not use harsh chemicals.

Modifying or tampering with the radio's internal components can cause a malfunction and might invalidate the radio's warranty and void your FCC authorization to operate it. If your radio is not performing as it should, take it to your local RadioShack store for assistance.

Free Manuals Download Website

<http://myh66.com>

<http://usermanuals.us>

<http://www.somanuals.com>

<http://www.4manuals.cc>

<http://www.manual-lib.com>

<http://www.404manual.com>

<http://www.luxmanual.com>

<http://aubethermostatmanual.com>

Golf course search by state

<http://golfingnear.com>

Email search by domain

<http://emailbydomain.com>

Auto manuals search

<http://auto.somanuals.com>

TV manuals search

<http://tv.somanuals.com>