

# RCA

u  
s  
e  
r  
m  
a  
n  
u  
a  
l

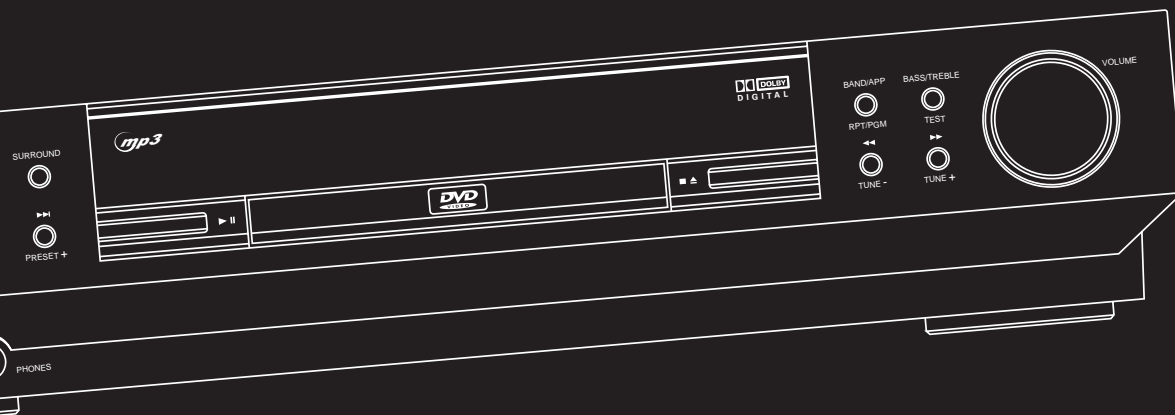

## RTDVD1

It is important to read this instruction book prior to using your new product for the first time.  
Es importante leer este manual antes de usar por vez primera su equipo.

**IMPORTADOR**

Comercializadora Thomson de Mexico, S.A. de C.V.  
Miguel de Cervantes Saavedra No. 57  
Col. Granada  
Mexico D.F. C.P. 11520  
Telefono: 52 54 53 73  
R.F.C.: CTM-980723-KS5



Thomson multimedia Inc.  
10330 N. Meridian St.  
Indianapolis, IN 46290  
© 2001 Thomson multimedia Inc.  
Trademark(s) © Registered  
Marca(s) © Registrada(s)  
Marque(s) © Déposée  
55179020 (EN/F/E)  
[www.rca.com](http://www.rca.com)



*RCA is among the first Consumer Electronics companies to have adopted the MP3 format, starting with the release of its MP3 player, Lyra, into the market. ([www.rca.com](http://www.rca.com) and [www.lyrazone.com](http://www.lyrazone.com)). RCA is proud of its initial success and has developed the competencies to enlarge its offering to other products like Discman and this System. RCA thanks you for your purchase of this System which aims at giving you tremendous pleasure while listening to your favorite music. In addition to this great System, RCA is proud to offer you the Music Match CD-ROM, which will assist you in managing your MP3 music library!*

## **The MusicMatch Jukebox**

This music management software, to be installed on your PC, allows you to compress music files recorded from your audio CDs into MP3 format and stores them on your PC.

- It makes the search and download of Internet music easier,
- It allows for the management of compressed music and the creation of your own playlist,
- The Jukebox is a true audio player installed on your PC,
- It gives access to thousands of net radios available on the web today.

You can download music files encoded in MP3 from several Internet sites like [www.mp3.com](http://www.mp3.com), [www.thomson-music.com](http://www.thomson-music.com).

## **PLAYING MP3**

- Use .mp3 as the extension when converting audio files into MP3 for saving onto CD-R(W) or CD-ROM, e.g. Rocky08.mp3. Do not use any other extension e.g. .doc, .pdf.
- Do not use the .mp3 extension for other text or non-audio data files as this may result in serious malfunction and harmful noise interference.

# FCC Information

This device complies with Part 15 of the FCC Rules. Operation is subject to the following two conditions: (1) This device may not cause harmful interference, and (2) this device must accept any interference received, including interference that may cause undesired operation.

This equipment has been tested and found to comply with the limits for a Class B digital device, pursuant to Part 15 of the FCC Rules. These limits are designed to provide reasonable protection against harmful interference in a residential installation. This equipment generates, uses and radiates radio frequency energy and, if not installed and used in accordance with the instruction, may cause harmful interference to radio communications. However, there is no guarantee that interference will not occur in a particular installation.

In accordance with FCC requirements, changes or modifications not expressly approved by Thomson multimedia Inc. could void the user's authority to operate this product.

This device generates and uses radio frequency (RF) energy, and if not installed and used properly, this equipment may cause interference to radio and television reception.

If this equipment does cause interference to radio or television reception (which you can determine by unplugging the unit), try to correct the interference by one or more of the following measures:

- Re-orient the receiving antenna (that is, the antenna for the radio or television that is "receiving" the interference).
- Move the unit away from the equipment that is receiving interference.
- Plug the unit into a different wall outlet so that the unit and the equipment receiving interference are on different branch circuits.

If these measures do not eliminate the interference, please consult your dealer or an experienced radio/television technician for additional suggestions.

Also, the Federal Communications Commission has prepared a helpful booklet, "How To Identify and Resolve Radio TV Interference Problems." This booklet is available from the U.S. Government Printing Office, Washington, DC 20402. Please specify stock number 004-000-00345-4 when ordering copies.

This product complies with DHHS Rules 21 CFR Subchapter J. Applicable at the date of manufacture.

**WARNING: TO PREVENT FIRE OR ELECTRICAL SHOCK HAZARD, DO NOT EXPOSE THIS PRODUCT TO RAIN OR MOISTURE.**

## For Your Safety

The AC power plug is polarized (one blade is wider than the other) and only fits into AC power outlets one way. If the plug won't go into the outlet completely, turn the plug over and try to insert it the other way. If it still won't fit, contact a qualified electrician to change the outlet, or use a different one. Do not attempt to bypass this safety feature.

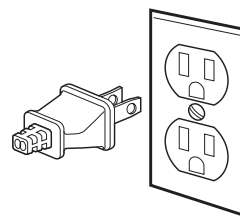

**CAUTION: TO PREVENT ELECTRIC SHOCK, MATCH WIDE BLADE OF PLUG TO WIDE SLOT, FULLY INSERT.**

## For Your Records

In the event that service should be required, you may need both the model number and the serial number. In the space below, record the date and place of purchase, and the serial number:

Model No.

Remote Control No. CRK76AF1

Date of Purchase

Place of Purchase

Serial No.

## Service Information

This product should be serviced only by those specially trained in appropriate servicing techniques. For instructions on how to obtain service, refer to the warranty included in this Guide.

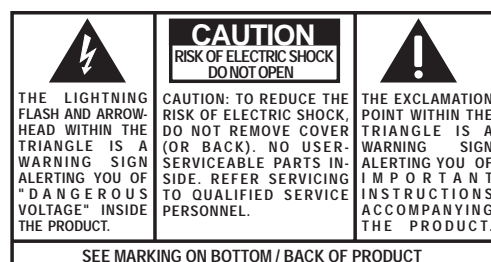

# Table of Content

EN

## **FCC Information**

---

### **Getting Started**

---

Unpacking the DVD Receiver	.2
Unpacking the Speakers	.2
Inserting Batteries into Remote Control	.3
Set Up and Maintenance of the Receiver	.3
Protect your Components from Overheating	.3

Connecting to Audio-Visual Components	.4
Digital Connection	.5
Connecting Antennas	.5
Connecting the Speakers	.6
Connecting the Subwoofer	.6
Positioning your Speaker	.7
Front Speaker Placement	.7
Preferred Surround Placement	.8
Advanced Surround Setting	.8
Test Tone / Channel Balance	.9
Connecting for Power	.9
Using Headphones	.9
Factory Setting	.9

### **Operating your Receiver**

---

Receiver Controls	.10
Your Remote Control	.11
Display	.12
Switching On/Off	.13
Selection of Audio/Video Source	.13
Using the Remote to Control Additional Components	.14

### **Advanced Sound Control**

---

Sound Enhancement Systems	.15
Fine Setting of Components	.16
Fine Setting of the Speakers	.17
Advanced Setting	.17

### **DVD Player**

---

Basic Playback Features	.19
Quick Search	.19
Freeze Frame and Frame Advance	.19
Slow Motion Playback (DVD only)	.20
On-Screen Banner Display	.20
Setup Menu	.25

### **CD/MP3 Player**

---

MP3 Recommendations	.30
Loading and Playing an Audio CD	.30
On-Screen Banner Display for CD Playback	.32
On-Screen Display for MP3 playback	.35

### **Radio**

---

Operating the Radio	.37
---------------------	-----

### **Troubleshooting Tips** .39

### **Care and Maintenance** .41

### **Remote Codes**

---

Cable Codes	.42
VCR Codes	.42
TV Codes	.43
Satellite Receivers	.44
Audio (RCA only)	.44
Laser disc Players	.44

### **Language Codes** .45

### **Limited Warranty (US)** .46

### **Limited Warranty (Canada)** .47

# Getting Started

## Unpacking the DVD Receiver

You should receive the following items:

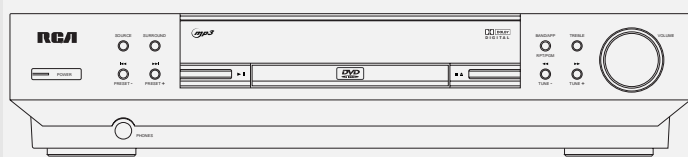

One DVD receiver unit

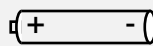

One pair of "AA" batteries

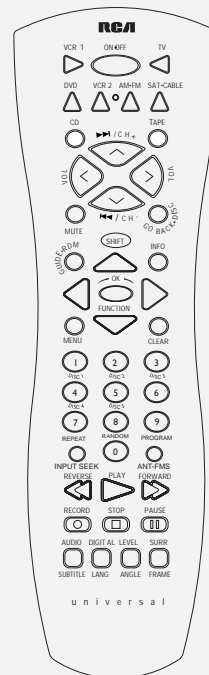

One RCA Universal Remote Control (CRK76AF1)



One Pig-Tail antenna wire



One external AM loop antenna

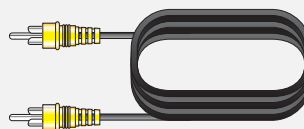

one video cable (single wire) with yellow RCA connectors;

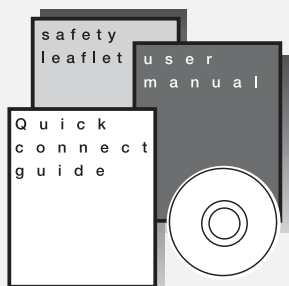

- one instruction book;
- one safety leaflet;
- one Quick Connection Guide
- MusicMatch™ Software CD

## Unpacking The Speakers

- one set of speakers including 1 set of left and right front speakers, 1 centre speaker, 1 subwoofer and 1 set of left and right rear speakers.

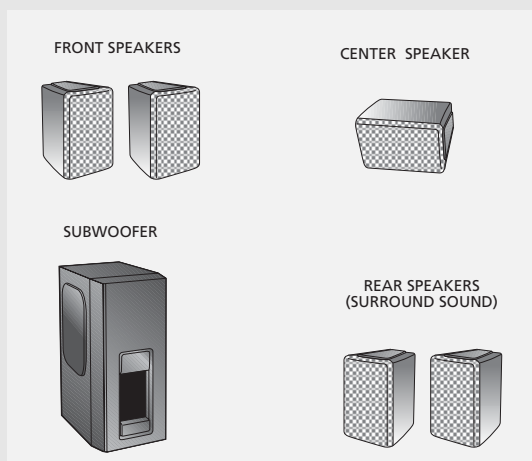

- 6 speaker cables including:



1 X blue/black cable for center speaker



2 X red/black cable for front speakers



2 X grey/black cable for rear speakers



1 X brown/black cable for subwoofer

## Inserting Batteries into Remote Control

Insert two AA(R6) batteries according to the + and - signs on the battery compartment. To use the remote control, point it directly at your receiver.

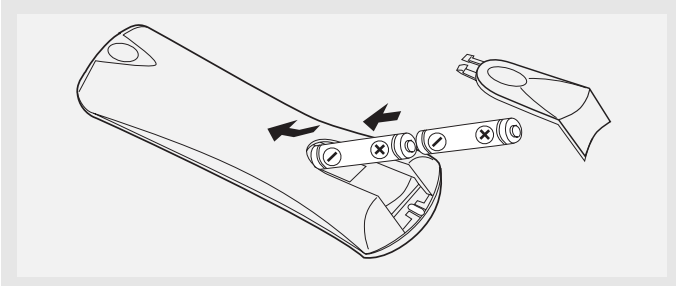

## Set up and Maintenance of the Receiver



### IMPORTANT NOTE

- Provide spaces for sufficient ventilation as indicated below. If the space is insufficient, the unit may overheat resulting in malfunction and shorter life time.

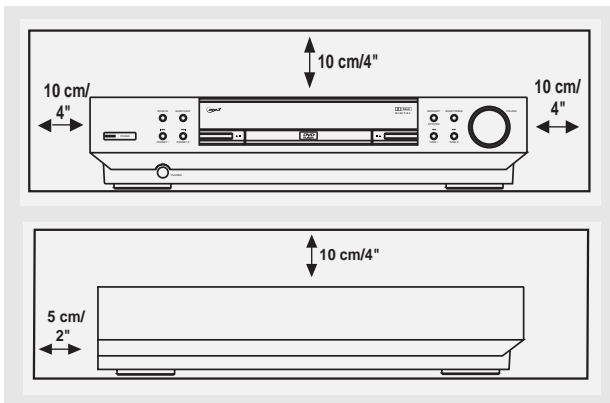

- Do not connect to the AC power cords until all connections are completed.
- Do not use your set immediately after transferring it from a cold place to a warm place: there is risk of condensation.
- Do not expose your set to water and excessively high temperatures.
- After having disconnected your set, clean the case with a soft cloth, or with a slightly damp leather chamois. Never use strong solvents.



## Protect your Components from Overheating

- Do not block ventilation holes in any component. Arrange the components so that air can circulate freely.
- Do not stack components directly on top of each other.
- Allow adequate ventilation when placing your components in a stand.
- Place the receiver near the top shelf of the stand so heated air rising from it will not affect other components.

### About CDR, CDRW, Audio MP3, Compact Disk Audio (CDA), DVD Video, DVD Audio

*This model RTDVD1 is compatible to play CDR, CDRW, Audio MP3, Compact Disk Audio (CDA), Video Compact Disk (VCD) and DVD Audio.*

*When playback a DVD-Audio disk, this model is able to play any Dolby Digital 5.1 (AC3) Surround mix content only, but not the DVD-Audio Advanced Resolution Surround sound (6 channels) or Stereo sound (2 channels) content.*

*Please watch the format of your disk and read the disk information for further contents information.*

## NOTES ON CD-R/RW DISC

*This unit is compatible with CD-RW/ CD-R discs for playback.*

- Do not affix any type of labels to either side (recordable or labeled side) of a CD-R/RW disc as this may result in the unit malfunctioning.
- To avoid damages to the CD-R/RW disc, do not open the disc compartment door while the disc is being read.
- Do not load an unrecorded CD-R/RW disc into the unit. This may take a longer time to read the disc.
- **Playback capability for CD-RW discs may vary due to variations in the quality of the CD-RW disc and the recorder used to create the disc.**

# Getting Started

## Connecting to Audio-Visual Components

### ANALOG INPUT

Alternatively, if you have no VCR or SAT, you can connect any other compatible components like TAPE player, TV to your DVD receiver via the VCR/SAT input.

### DIGITAL INPUT

Connect components capable of outputting Dolby Digital (e.g. SAT) or standard PCM (CD) format digital signals. Read section on "Input Signal Setting" under "Advanced Sound Control" carefully to adjust the matching input settings.

### DIGITAL OUTPUT

Connect components capable of recording digital signals (e.g. MD, CD recorder player) equipped with a optical input.

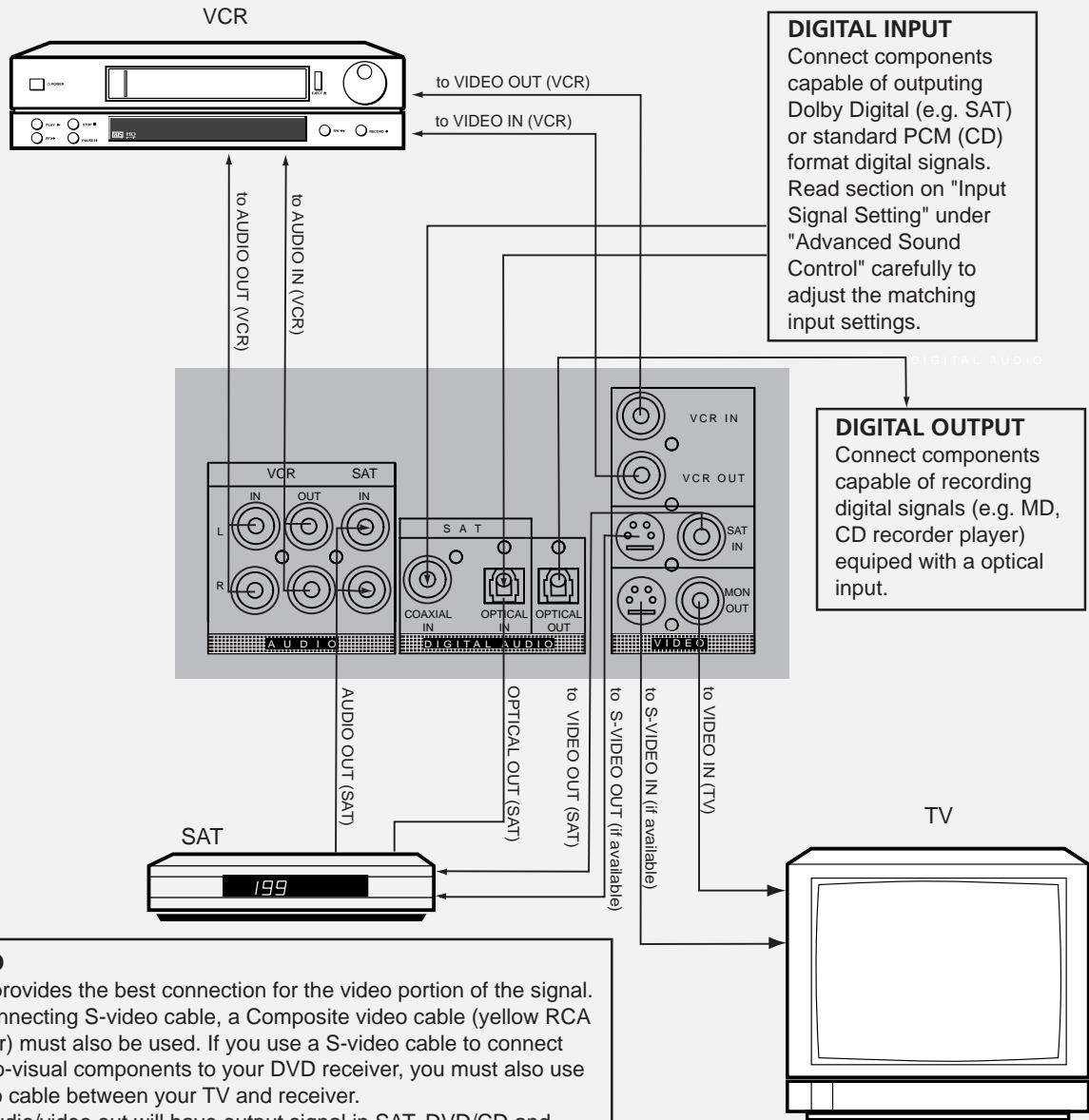

### S-VIDEO

S-video provides the best connection for the video portion of the signal. When connecting S-video cable, a Composite video cable (yellow RCA connector) must also be used. If you use a S-video cable to connect any audio-visual components to your DVD receiver, you must also use a S-video cable between your TV and receiver.

¥ VCR audio/video out will have output signal in SAT, DVD/CD and TUNER modes. When VCR (source) is selected, there will be no audio/video signal from VCR audio/video out.



## Digital Connections

If you have a SAT receiver DVD player or CD player with a digital output, you can make use of an optical digital connecting cord (not supplied) or coaxial digital connecting cord (not supplied) to carry the audio portion of the signal and enjoy Dolby Digital or digital stereo sound quality. One optical or coaxial cable is needed for each SAT receiver, DVD player or CD player. When optical or coaxial cable is used, the analog audio cables are still needed if recording through a tape or VCR is desired. This receiver provides one optical and one coaxial digital input for the connection of your components. Please connect your components (e.g. DVD, SAT or CD) to the appropriate digital inputs and select the appropriate source (see below).

### NOTE

Optical and coaxial cables carry only the audio portion of the signal. A video connection must also be established by connecting a video cable to the (SAT) video input.

Read instructions carefully when connecting components to the receiver.

Digital In Jacks can accept Dolby Digital (AC-3), or PCM signals when compatible components are connected.

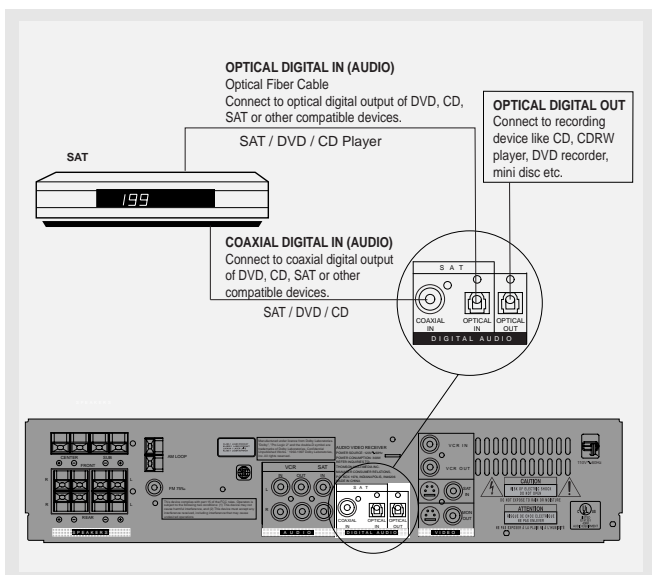

## Connecting the Antennas

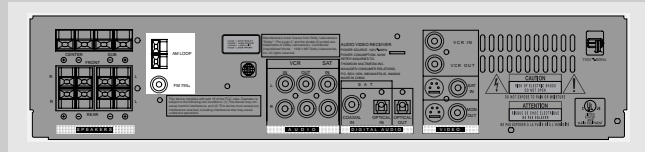

The AM and FM antennas connect to the AM and FM terminals on the system's back panel.

They must be hooked up in order to receive clear reception.

### AM Loop Antenna and FM Indoor Antenna

1. Uncoil the AM Antenna wire.
2. Press down on the Antenna tab to open the terminal (Refer to the illustration on the bottom of page 6)

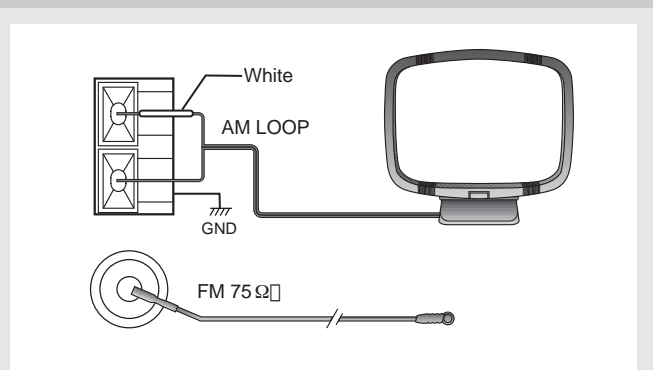

### HINT

- For FM reception, extend antenna to its full length and arrange the Antenna at different parts of the room until the reception is optimized.
- For AM reception, rotate the antenna horizontally to get better reception.

# Getting Started

## Connecting the Speakers

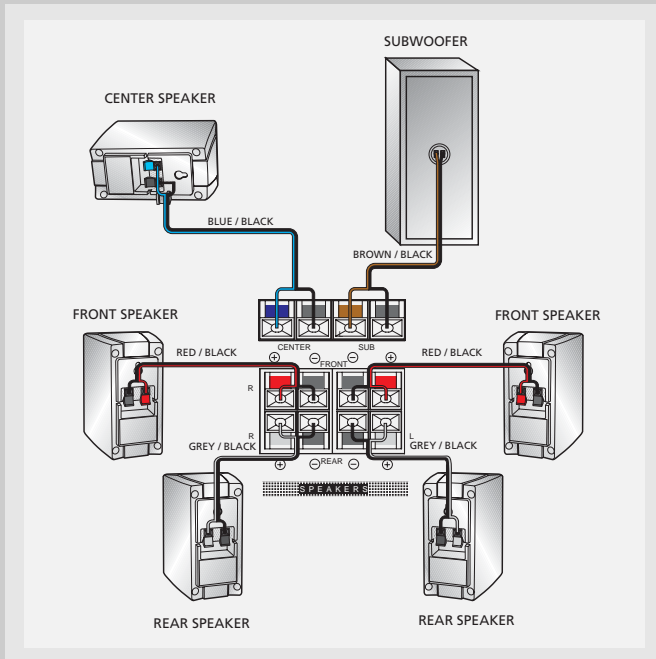

### Speakers

There are 6 speakers equipped with the unit (2 front, 1 center, 2 rear, 1 subwoofer). In order to enjoy good surround effects all six speakers need to be connected to the receiver

For better sound quality, Center speaker, rear speakers and Subwoofer should also be connected. Adding center and rear speakers will enhance surround effects. Adding a Subwoofer will increase bass response.

If you want to enjoy full range of sound effects, it is a must to use the subwoofer with the speakers to maintain adequate bass signal.

### Speaker cords

1 for each speaker, is needed for connection. Twist the stripped ends of speaker cord about 2/3 inch (15 mm). Press down on the tab to open the terminal and insert the wire. Snap the tab closed.

#### Antenna and Speaker Wire Connection

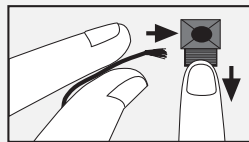

Push Speaker terminal tab down to insert wire.

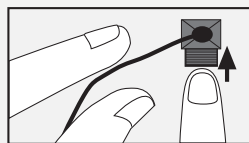

Release tab to lock wire in the terminal.

NOTE: Make sure the insulation is completely removed from the ends of the Antenna and speaker wires at all connection points.

To ease speaker connections, the speaker cords and the terminals are color-coded.

- Red/Black (Front Speakers),
- Blue/Black (Center Speaker)
- Grey/Black (Rear Speakers).
- Brown/Black (Subwoofer)

Connect the speaker wire (red/black wire) to the back of L, R front speakers (red / black terminals) and to the corresponding color terminals on the rear of the receiver. Do the same for center speaker (with blue/black terminal), rear speakers (with grey/black terminals) and the subwoofer (with brown/black terminal).

### Speaker Polarity

When connecting the speakers, make sure the polarities ("+" speaker wire to "+" on the receiver) of speaker wires and terminals are matched. If the cords are reversed, the sound will be distorted and will lack bass ("out of phase" effect).

### Connecting the Subwoofer

Connect the subwoofer with the speaker wire (brown/black) provided.

## Positioning your speaker

### 1 Left, Right (Front Speakers)

They carry primarily music and sound effects

### 2 Center

In surround mode, the center speaker carries much of the dialogue as well as music and effects. It should be set between the left and right speakers.

### 3 Surround (Rear Speakers)

Their overall sound balance should be as close as possible to the front speakers. Proper placement is vital to establish an evenly distributed sound field.

## Subwoofer

A subwoofer is designed to reproduce powerful low bass effects (explosions, the rumble of spaceships, etc.) which dramatically heightens involvement with the action on the screen. It is therefore recommended to connect subwoofers when small speakers are used.

## Magnetic shielding

Speakers placed less than two feet from the TV set must be magnetically shielded in order to prevent picture distortion. Front and center speakers provided with RTDVD1 are magnetically shielded to protect your TV set.

It is not recommended to place the rear speakers near the TV set.

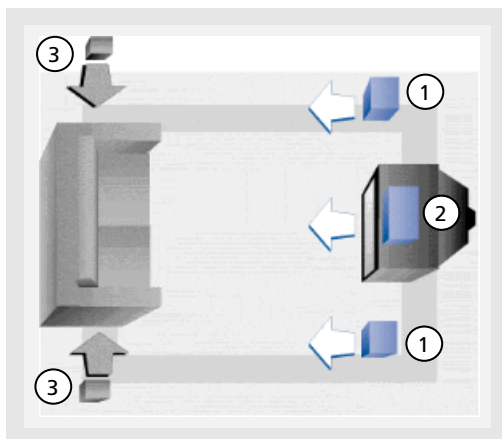

Courtesy Dolby Laboratories

## Front Speaker Placement

Even if you can't duplicate this ideal home theater setup exactly, the suggestions for speaker placement that follow will help you get good results.

## Alignment

Align the center speaker evenly with (A), or slightly behind (B), the left and right speakers, but not ahead of them.

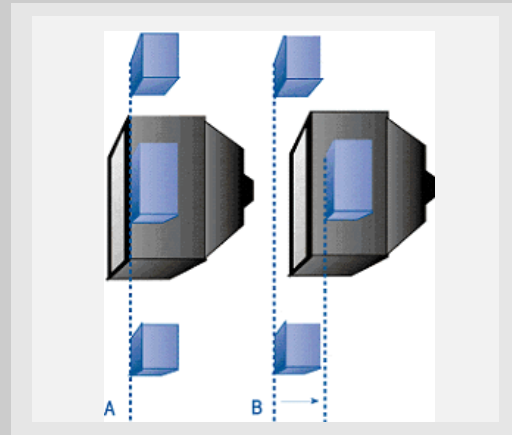

Courtesy Dolby Laboratories

## Advanced Setting

### Angle

Placing the left and right speakers to form a 45-degree angle with your favorite viewing position will duplicate the soundtrack mixer's perspective.

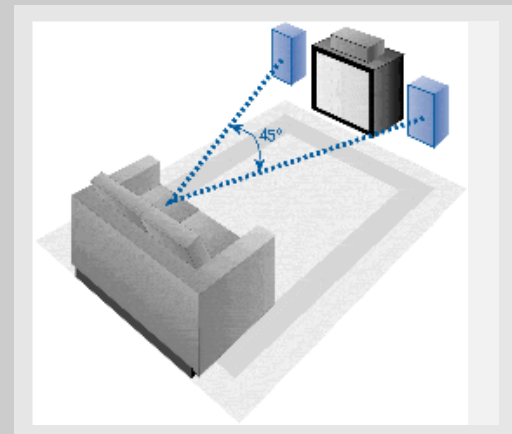

Courtesy Dolby Laboratories

### Height

The mid- and high-frequency drivers of the three front speakers should be as close as possible to the same height. This often requires placing the center speaker directly atop (A) or beneath (B) the TV set.

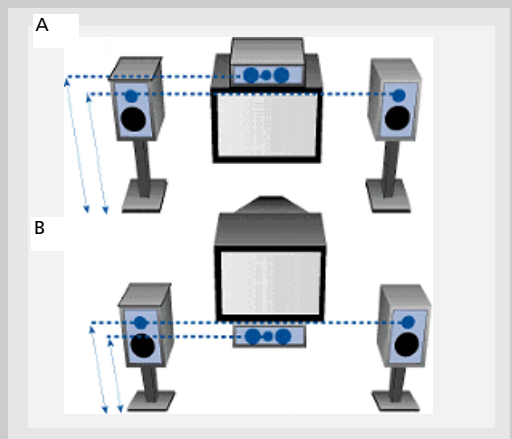

Courtesy Dolby Laboratories

# Getting Started

## Preferred surround placement

### Location

If possible, place surround speakers to either side of the listening area, not behind it.

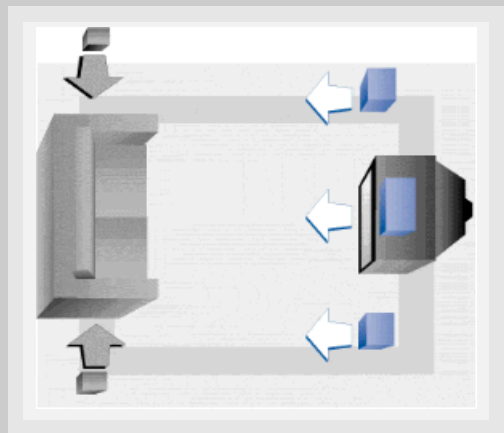

Courtesy Dolby Laboratories

### Height

If space permits, install surrounds 2-3 feet above viewers. This helps to minimize localization effects.

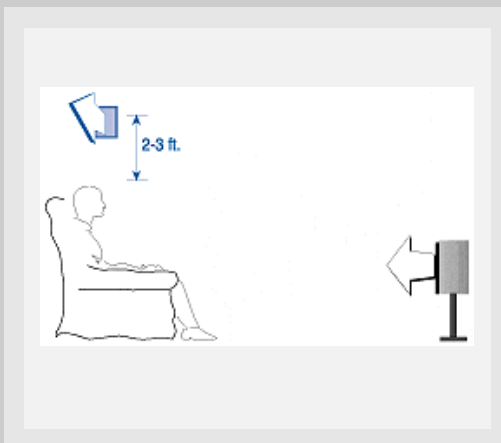

Courtesy Dolby Laboratories

### Aiming

Aiming surrounds straight across the room, not down at viewers, helps create a more open, spacious surround sound field.

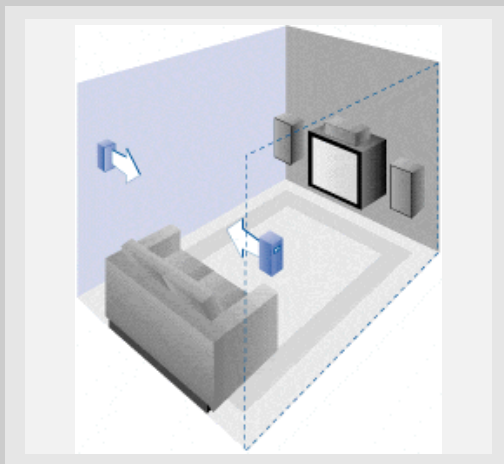

Courtesy Dolby Laboratories

## Advanced Setting

### Alternative Surround Placement

#### Rear wall

If rear wall mounting is the only choice, aim the speakers at each other (A), towards the front (B) or even towards the sidewalls (C, D). Experiment with placement until surround sounds seem to envelop you, rather than coming from behind you.

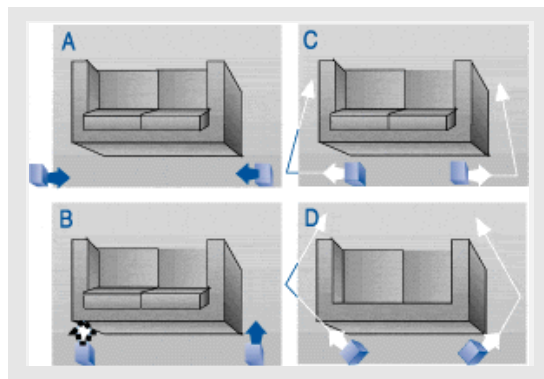

Courtesy Dolby Laboratories

#### No adjacent walls

Surrounds can go on stands facing each other to approximate the preferred sidewall mounting (A), or to the sides or rear of the viewing area aimed upwards. In the latter case, they can go right on the floor, or preferably, a few feet off the floor such as on end tables (B).

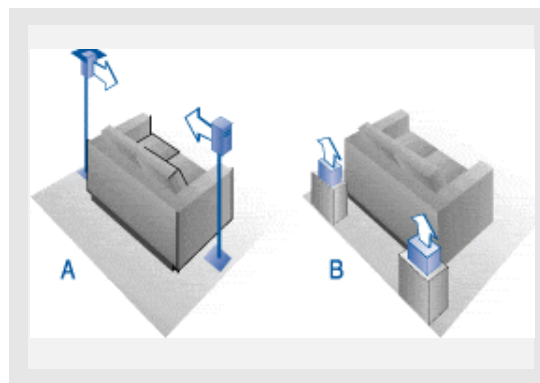

Courtesy Dolby Laboratories

## Test Tone / Channel balance

### Channel balance

Your receiver is equipped with a test signal generator for balancing the channels. As the signal "travels" from channel to channel, adjust the level controls until each channel plays at the same loudness level. (details see operation of test/setup)

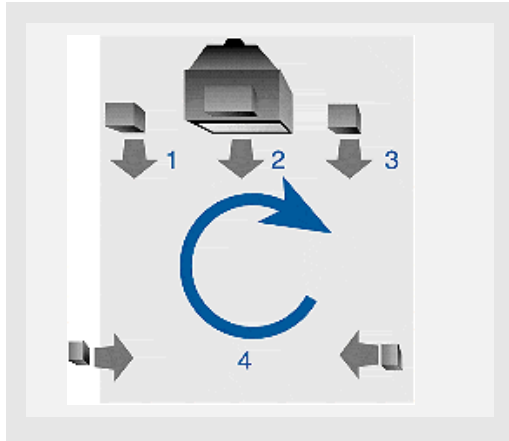

Courtesy Dolby Laboratories

### Level adjustment & surround channel level expectation

Even though you adjust the surround channel to be as loud as the others on the test signal, you'll find that on actual program material the surround channel is usually much lower than the front. Don't be tempted to readjust the surround level; program producers use surround mostly for subtle atmospherics and ambience, and only rarely for special effects. A good surround mix doesn't call attention to itself; if it did, it would soon become distracting.

## NOTE

*The system is equipped with Dolby Digital, and manufactured under License from Dolby Laboratories.*



Dolby Digital  
Manufactured under  
license from Dolby  
Laboratories. "Dolby",  
"Pro Logic", "Pro Logic II"

and the double-D symbol are trademarks of Dolby Laboratories. Copyright 1992-1997 Dolby Laboratories, Inc. All Rights Reserved.

## Connecting for Power

Make sure you connect all your other electronic components and the speakers before plugging your receiver into the outlet. Plug the power cord in the wall outlet, matching the wide blade of the plug with the wide slot in the outlet. Be sure to insert the plug completely.

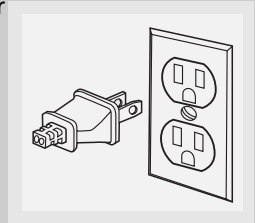

## Using Headphones

To listen privately through your audio system, use the PHONES jack on the receiver. However, make sure you turn down the volume before you put on the headphones. Increase the volume to the desired level after headphones are in place.

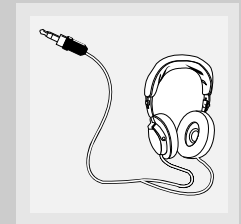

Once headphones are connected, "HEADPHONE DOWNMIX 2 CHANNEL" will scroll on display. This feature automatically converts multi-channel outputs to 2 channel stereo for your listening pleasure.

## Hearing Comfort & Well-Being

- Do not play your headset at a high volume. Hearing experts advise against continuous extended play.
- If you experience a ringing in your ears, reduce volume or discontinue use.

## Factory Setting

The RTDVD1 is preset to the following setting when you first turn on the power  
Source = DVD/CD  
Volume setting = 45 dB  
Bass & Treble = 0 dB

## Restore to Factory Settings

You can always restore all settings back to its original state. When the receiver is in STANDBY mode, press accordingly on the main unit to restore all settings back to factory default :

PRESET - → PRESET + → BASS/TREBLE

## NOTE

*All preset radio stations and surround sound setting will be lost after factory setting is restored.*

# Operating Your Receiver

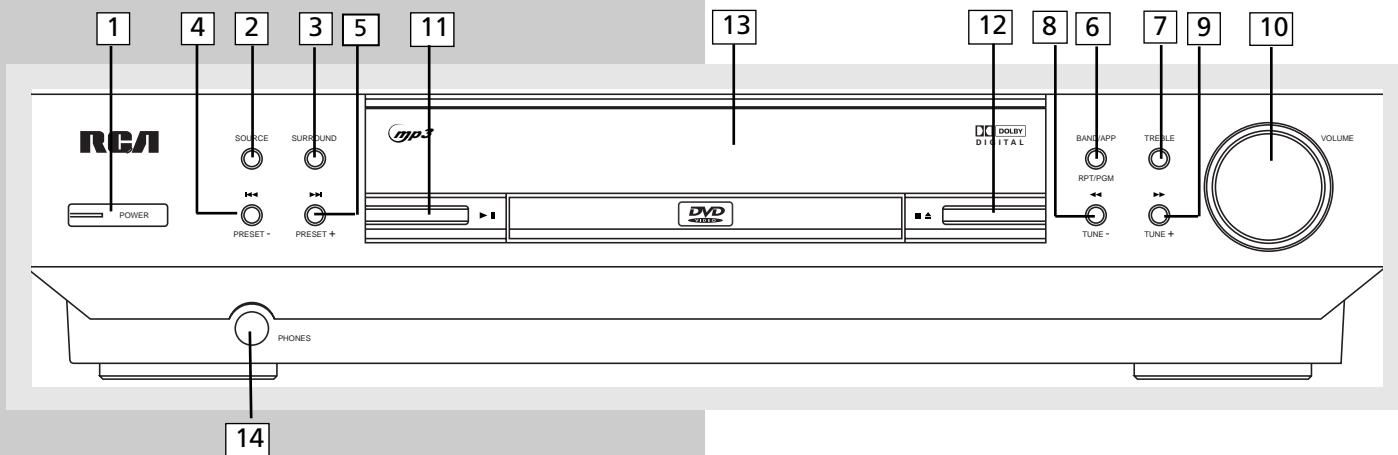

## Receiver Controls

### 1. POWER / STANDBY

- To turn the unit on/ off. When the system is turned on, the unit will go to Standby mode, then press the SOURCE button on the unit to power the unit up in the last mode used.
- When the unit is in standby mode, press the Source button to power on the unit.

### 2. Source Buttons

- To select input source. For example, DVD/CD, VCR1 etc.
- Press and hold for delay settings.

### 3. SURROUND

- Press repeatedly to select the surround sound setting or Digital Sound Processor (DSP) mode you want. Refer to "Advanced Sound Control" on page 16.)
- Press and hold to activate speaker Test Tone, use the Adjustment buttons on the remote to adjust the settings.

### 4. PRESET - / SKIP REVERSE

- To move back to the beginning/previous preset memory location in tuner mode.
- To skip to the beginning/previous track in CD mode and the beginning/previous chapter in DVD mode (only while playing).

### 5. PRESET + / SKIP FORWARD

- To go to the next preset memory location in tuner mode.
- To skip to the next track in CD mode and the next chapter in DVD mode (only while playing).

### 6. BAND / APP / RPT / PGM

- In Tuner mode, press to select between radio BANDS or press and hold to enter AUTO PROGRAM mode.
- In DVD/CD mode, press to select among REPEAT options (only while playing) or press and hold to enter **PROGRAM** mode (only in stop mode).

### 7. TREBLE

- To adjust TREBLE, press this button and turn the volume knob to adjust level.
- Press and hold for Random function in CD/MP3 playback.

### 8. TUNE - / FAST REVERSE

- In tuner mode, press to tune down on the radio frequency or press and hold to search down .
- In CD and DVD mode, press to fast reverse. Press repeatedly to vary the speed of fast reverse.
- In pause mode, press for slow reverse.

### 9. TUNE + / FAST FORWARD

- In tuner mode, press to tune up the radio frequency or press and hold to search down.
- In CD and DVD mode, press to fast forward. Press repeatedly to vary the speed of fast forward.
- In pause mode, press for slow forward.

### 10. VOLUME

Turn the knob to adjust volume level.

### 11. PLAY/PAUSE

To play and pause DVD/CD playback.

### 12. STOP/ EJECT

To stop DVD/CD playback. Press to eject disc tray.

### 13. Display

To display current status of the receiver.

### 14. PHONES

Plug your headphones (not supplied) into it for your private enjoyment. Speakers will be off when phones are inserted.



## Your Remote Control

Please be sure you have inserted the batteries into the remote control (see relevant section on page 3.) You can test it by pressing any button. If it works, the red LED will light.

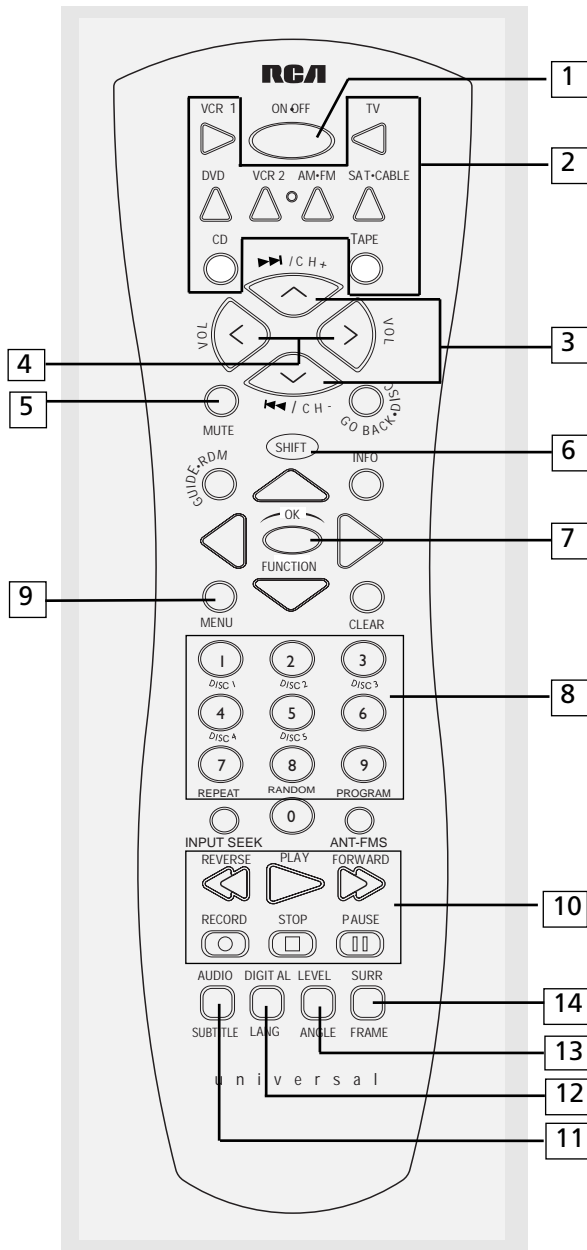

### NOTE

The remote button INPUT•SEEK does not work.

#### 1. ON/OFF

To turn on or off the receiver and other auxiliary components (see page 14 "Using the Remote to Control Additional Components").

#### 2. Source Buttons

To turn on and select various audio/ video sources.

#### 3. CH+, CH- (Channel Buttons)

To select programmed stations in TUNER mode.  
To skip to the next or previous chapter or track in DVD, CD & MP3 mode.

#### 4. VOL (Volume Buttons)

To adjust the volume.

#### 5. MUTE

To mute all audio outputs.

#### 6. SHIFT

To access second function features. (Function features controlled by the SHIFT key are colour coded to have the same colour as the word "SHIFT".)

#### 7. Adjustment Buttons

Press SHIFT then OK/FUNCTION, the display will toggle among:

**NOTE:** Do not press the SHIFT key when in Tuner mode.

- Preset EQ (Stereo only),
- SLEEP Mode
- DIM Mode
- NIGHT Mode (Dolby Digital Only).

When the display shows the setup you want to change, press the left and right arrow buttons beside OK button to make changes, then press OK to finalize your choice.

#### 8. Number Buttons

- In Tuner mode, to select a preset station.
- In DVD/CD mode, to select a track to be played (Audio CD only).
- For separate RCA 5 disc CD Player, to select track or DISC. (Must use the SHIFT button to select Disc)

#### 9. MENU

- In Tuner mode:
  - Press AM/FM
  - Press to store desired frequency in memory. The flashing word MEMORY in red will appear in display. Input your desired channel number while the word is still flashing and the frequency will be stored. (For details, refer to "Storing Radio Stations" under "Manual Preset" on page 38)
- In DVD mode, press for menu setup for DVD title.

#### 10. Operation Buttons

- TUNER, press AM/FM on the remote to enter tuner mode. Press REVERSE and FORWARD keys to tune down or up the radio frequency.
- DVD/CD, press DVD to enable PLAY, RECORD, STOP and PAUSE keys. The remote control currently operates most Thomson, RCA and GE products, but it can be programmed to operate devices from other manufacturers (For details, refer to "Using the Remote to Control Additional Components" on page 14).

#### 11. AUDIO/SUBTITLE

- Press AUDIO/SUBTITLE To select between left, right and stereo channel when playing VCD.
- Press SHIFT then AUDIO/SUBTITLE to turn on or off the subtitle function or press and hold AUDIO/SUBTITLE to access the subtitle menu for DVD mode.

#### 12. DIGITAL/LANG

- Select the way your SAT external audio/video devices are connected to the receiver (Analog, Optical or Coaxial) through the SAT audio input.
- Press SHIFT then DIGITAL/LANG to access the title language selection menu.

#### 13. LEVEL/ANGLE

- Press to adjust the volume of individual speaker. Press repeatedly and the display will toggle among different channels (Left front speaker, Right front speaker, Center speaker, Left rear speaker, Right rear speaker, and Subwoofer). Press the left and right arrow buttons beside OK button for adjustment.
- Press SHIFT then LEVEL/ANGLE to select different screen display angles.

#### 14. SURR (Surround Sound Control)/FRAME

- Press to change the surround sound settings. The display will toggle among any stereo modes (DOLBY DIGITAL, DOLBY PL II MOVIE, DOLBY PL II MUSIC, DOLBY PRO LOGIC, DOLBY 3 STEREO, ARENA, JAZZ, THEATER, STADIUM, DISCO, STEREO)
- Press SHIFT then SURR/FRAME to activate STILL step backward. (For details, refer to section "Advanced Sound Control" on page 15.)

**After using AUDIO, DIGITAL, LEVEL or SURR keys on the remote control in DVD/CD function mode, you must press the DVD/CD or SHIFT key to use other DVD keys.**

# Operating Your Receiver

## Display

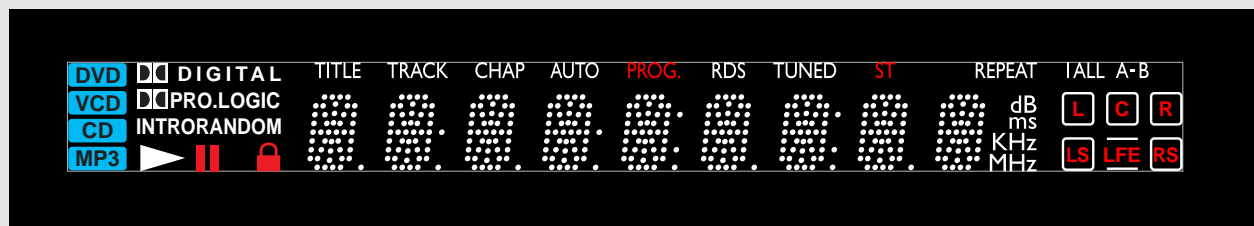

### DVD / VCD / CD / MP3

- Unit in DVD, VCD, CD or MP3 mode.

### DIGITAL

- Audio output is in Dolby Digital mode. (For DVD and SAT coaxial / optical inputs only)

### PRO.LOGIC

- Audio output is in Dolby PL II Movie, Dolby PL II Music or Dolby Prologic mode.

### INTRO

- Track sampling activated.

### RANDOM

- Random playback mode activated.



- Currently in playback mode.



- Currently in pause mode.

### PARENTAL LOCK

- Parental lock is on and a password is required to view DVDs above a specific rating level.

### TITLE

- Title number for DVD playback.

### TRACK

- Track number being played.

### CHAP

- Chapter location at which DVD is currently at.

### AUTO

- Auto programming in tuner mode is activated

### PROG.

- Program mode is activated.

### TUNED

- Tuner station detected.

### ST

- Tuner stereo signal detected.

### REPEAT / REPEAT 1 / REPEAT ALL REPEAT FOLDER (MP3 only)

- CD, MP3 and DVD in repeat mode.

### KHz / MHz

- Tuner frequency unit.



- Speaker Icons.



## Switching on /off

- To switch on the receiver, press **POWER** button on the receiver once to enter standby mode. Press **SOURCE** button on the receiver or one of the source buttons on the remote control to power on the receiver. (See illustration below)

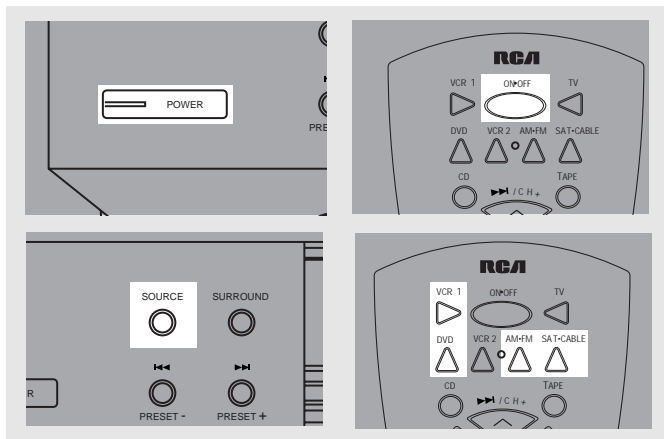

- Standby: when the receiver is on, press the **ON/OFF** on the remote to return to standby mode.
- To switch off the unit completely, press the **POWER** button on the receiver.

## NOTE

Your receiver has a back up memory to keep your settings like preset radio station for about 2 weeks in case electricity cut occurs. If the receiver is unplugged for more than 2 weeks, all the settings will be lost and re-setting will be necessary.

## Selection of Audio/Video source

When one of the audio/video source is selected, the audio and video input corresponding to the name will be activated.

The receiver acts as a switching device between all the sources that are plugged into it.

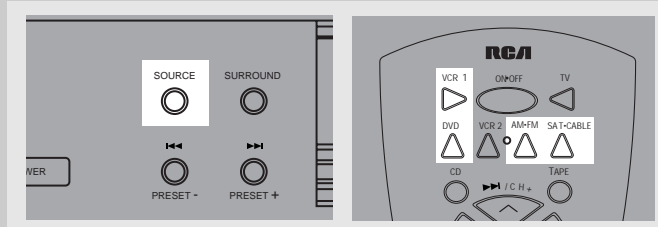

### Example 1:

If you connect a VCR player to the VCR input (audio + video) on the receiver and press the **SOURCE** button until VCR1/ANL shows on the display. You will be able to have the sound and image transmitted by the VCR.

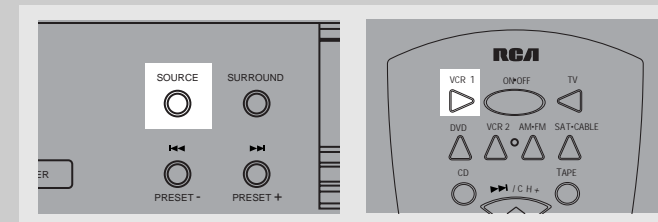

### Example 2:

Based on example 1, the VCR input is selected. If SAT is selected, image and sound from the SAT receiver source will replace the VCR.

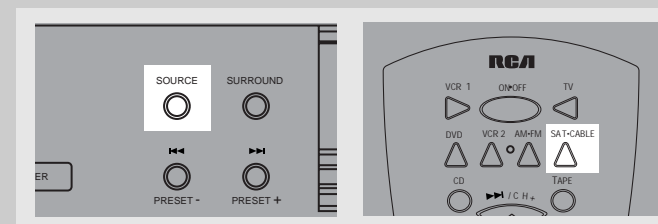

# Operating your Receiver

You can connect up to 2 audio/video sources to this amplifier:

Source button (remote control)	Corresponding connector (receiver back panel)
- DVD/CD	built-in
- FM/AM	built-in
- SAT	SAT IN (audio / video)
- VCR	VCR IN (audio / video)

When a source is selected, the source name will be shown on the display.

Example: Press **VCR** to select VCR as the source to the amplifier.



## NOTE

1. Your receiver has a built in tuner. Just connect the appropriate antenna on the back of the receiver and you will be able to listen to radio stations. (See details in Tuner section)
2. The receiver is also equipped with DVD/CD player. Press the SOURCE button on the main unit or DVD button on the remote to activate the feature.
3. Other sources can be connected to this unit (VCR, SAT etc).
4. Refer to the "Connecting To Audio-Visual Components" section for details on connection.

## Using the Remote to Control Additional Components

You can set your remote to control other components (like TV, VCR, etc.). What you need is to encode them in advance (not necessary for recent RCA & Proscan models).

1. Turn on the component to be programmed.
2. Look up the brand and corresponding code number in the code list from page 42 to 44.

3. Press and hold the corresponding Source Button (like **VCR1, SAT/CABLE, TV**) on the remote while entering the code from the code list using the Number Buttons.

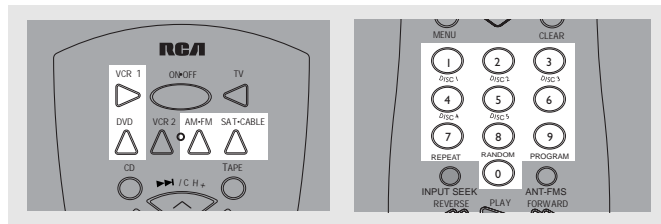

4. Release the component button, then press **ON•OFF** to see if the component will turn off.

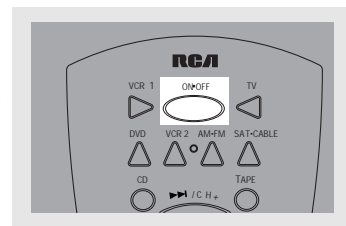

5. If this does not work, repeat steps 3 and 4 by trying to use the next code (if available) listed for the brand of your component until the component responds to the remote command.

## NOTE

Once your remote is encoded, you can press ON/OFF on the remote once to turn off the component and then followed by the second time quickly to turn off the receiver (i.e. this unit). If you only want the receiver to be turned off, select FM/AM while the unit is ON before pressing ON/OFF.

## HINT

This remote may not operate all models of the brands shown.

If batteries are removed from the battery compartment of the remote control, all memory will be lost. You need to re-enter all previously programmed codes again.

The buttons on the remote may not work correspondingly with those on other brand components. Experiment with the remote and your components to see which buttons work. If only a few functions operate, check to see if another code set will work with more buttons.

## Sound Enhancement Systems

This receiver is equipped with several built-in sound enhancement systems.

### Dolby Pro Logic II and Dolby 3 Stereo

The Pro Logic II mode uses the built-in circuit to steer the Left, Center, Right and Surround left and right channel audio signals and uses all five speakers to play both stereo and Dolby Pro Logic program source, such as TV and VCR. Dolby Pro Logic II includes Dolby Pro Logic II Movie, Dolby Pro Logic II Music and Dolby Pro Logic.

Use this mode to suit the type of program (such as VCR).

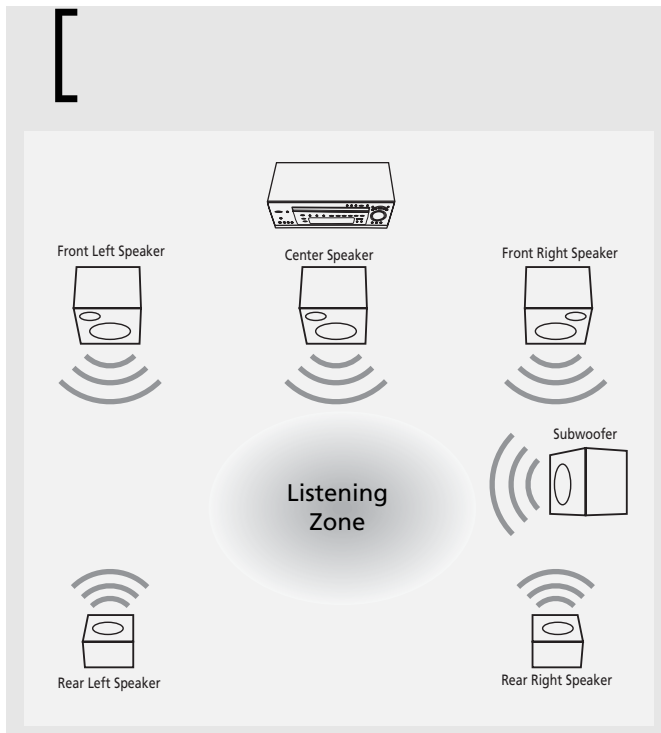

This surround system reproduces theater-like surround sound from Dolby-encoded software.

The 3 Stereo mode will redirect the Surround signals to the front left and right speakers when only the front and center speakers are used.

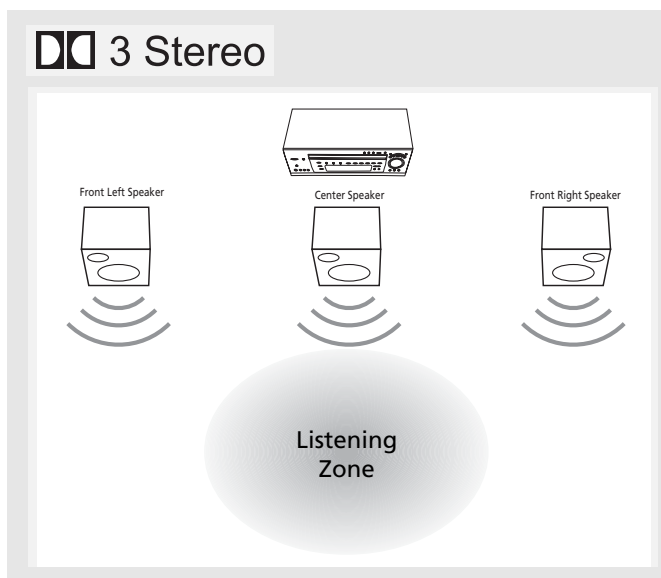

### Dolby Digital

The Dolby Digital mode lets you enjoy full digital surround from software processed in the Dolby Digital format. Dolby Digital provides better sound quality and more powerful presence than conventional Dolby Surround.

This unit is equipped with Dolby Digital 5.1-channel so that you can enjoy enhanced full digital surround sound. Being different from Dolby Pro Logic in which only four channels ( Front Left, Front Right, Centre and Rear ) are used, the new system provides stereo separation of the rear speakers (Rear-Right, Rear-Left ). These 5 channels, together with the subwoofer channel for bass sounds ( counted as 0.1 channel ), constitute as 5.1-Channel ( or 6 Channels ) Input for Dolby Digital that brings you the most sophisticated sound enjoyment.

# Advanced Sound Control

## Stereo

The Stereo mode uses the two main channel outputs from the front speakers.

## DSP (Digital Sound Processor)

These digital sound effects resemble sounds in a real environment such as Arena, Jazz, Theater, Stadium and Disco. DSP automatically converts analog audio signals to digital ones which enables you to adjust the sound without degrading the sound quality. Different modes will give you different feel of size and type of listening environment. (Not available in Dolby Digital (DVD))

## Night Mode

By using Dynamic Range Compression technology (pressing SHIFT and OK), you can enjoy enhanced Dolby Digital sound quality at night without interrupting your roommates or neighbors. Night Mode will compress the difference in volume between normal voices and sound like explosions, while still enjoying a Dolby Digital enable component (DVD, SAT). Night Mode can be activated by pressing the **SHIFT** button then the **OK** button repeatedly until NORMAL appears on the display. While Normal is still on the display, press the **LEFT** or **RIGHT** Adjustment buttons on the remote control, around the OK button, on the remote control until you select the desired mode. Night mode can also be activated by pressing the **AUDIO** button, then **OK** button repeatedly then **LEFT** or **RIGHT** Adjustment buttons. There are three modes (NORMAL, SOFT, SOFTER) for you to choose the extents of compression.

## Fine Setting of the Components

The receiver has pre-selected the best surround mode for you once you turn on the unit by pressing the **SOURCE** Buttons (like DVD/CD, SAT) directly. The default surround modes for different components are as tabled below. If you decide to change the surround mode, you can press the **SURROUND** repeatedly to toggle among the different surround mode choices and select the one you want.

### For Digital Signal (2ch PCM), or analog signal, VCR1, Tuner:

Dolby PL II Movie ➤ Dolby PL II Music ➤ Dolby PL ➤  
Dolby 3 Stereo ➤ Arena ➤ Jazz ➤ Theater ➤  
Stadium ➤ Disco ➤ Stereo

### For Digital Signal (Dolby Digital)

Dolby Digital ➤ Dolby 3 Stereo ➤ Stereo

## Default Settings

Source/ Source/ Input	If Digital Input (optical or coaxial) is selected	If PCM bitstream	If Analog Input selected
DVD/CD	Dolby Digital	PRO-LOGIC II MOVIE	PRO-LOGIC 2 MOVIE
SAT	Dolby Digital/	PRO-LOGIC II MOVIE	PRO-LOGIC 2 MOVIE
VCR TUNER	N/A N/A	N/A N/A	PRO-LOGIC 2 MOVIE PRO-LOGIC 2 MOVIE

The receiver will keep the last selection in memory as long as it doesn't enter standby mode.

## Input Signal Setting

The receiver defaults to the most convenient settings for your easiest use (see table).

By default, SAT (satellite) is set to analog input. If you wish to change the input formats, follow the steps below:

1. Press **SOURCE** on the main unit until SAT appears on the display or press the **SAT** source buttons on the remote control.
2. Press **DIGITAL** on the remote control to toggle among optical/ coaxial/ analog to match your connection. Your selection will be stored automatically.

Every time you press the source button, the input setting (e.g. SAT/ ANL) will be shown on display for a few seconds.

SOURCE	DEFAULT INPUT (as seen on display)
SAT	Analog (SAT/ ANL)
VCR1	Analog (VCR1/ ANL)
FM/AM	Built-in Tuner

## NOTE

*Only SAT input setting can be changed to coaxial or optical.*

SOURCE	AVAILABLE INPUT
SAT	ANL/Optical/Coaxial
DVD/CD	Built-in
VCR1	ANL / - / -

## Digital Input: Coaxial (COAX) / Optical (OPT)

Select this setting to play digital signals from a DVD, CD, LD player, or SAT. (SAT mode only)



### CAUTION!

DO NOT CONNECT A LD PLAYER WITH RF COAXIAL OUTPUT TO YOUR COAXIAL INPUT.

## Analog Input

Select this setting to play analog signals from a cassette deck, VCR or SAT.

## NOTE

*SAT and VCR are just generic names. You can connect other compatible audio/video components to these inputs like TV, TAPE, MINI DISC, CD-RW player, etc.*

## Fine Setting of the Speakers

If you use all the speakers provided, all the basic settings have been set.

However, to make the surround sound more effective and suit the acoustic conditions in your listening room, you need to delay the signal from some of the speakers. Such channel delay compensates for center or surround speakers that are closer to listening position than the front speakers. You can make use of the **SOURCE** button to adjust the speakers' relative loudness.

### The TEST button

Recommend to set the surround to one of the Dolby setting so that all speakers will be selected. To activate the Test Tone, press and hold the **SURROUND** button. A short noise will be heard in each speaker one by one. The speaker producing the noise at that moment will flash on the Speaker icon and be displayed on the VFD. The speaker being displayed can then be adjusted by using the LEFT or RIGHT arrows on the remote to desired level. To get out of Test Tone, just press **SURROUND** button and the setting will be saved.

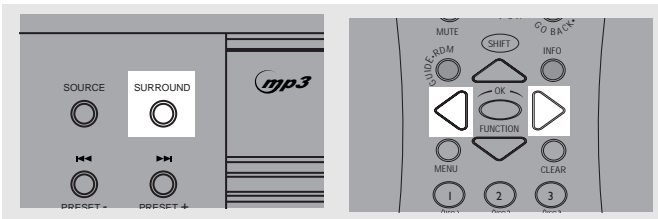

## Advanced Setting

### Factory Default Setting

The receiver speaker distance default settings are the following:

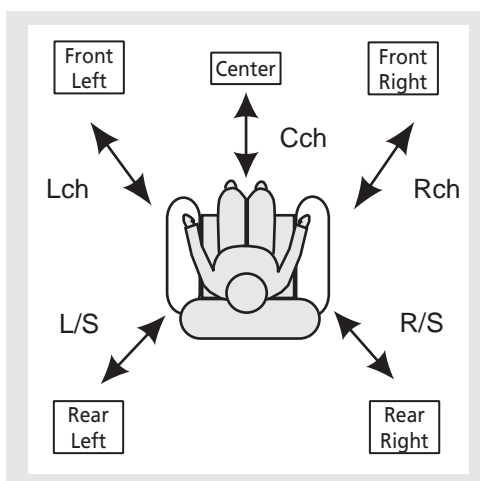

Front speakers (L/R)	15 ft
Center speaker (Cch)	15 ft
Rear speaker (SUR)	10 ft

## Speaker Configurations

You can also change the delay of the speakers by pressing and holding the **SOURCE** button.

Available Selections:

Front Speaker distance	3-40 ft
Center Speaker distance	0-40 ft
Rear Speaker distance	0-40 ft

Pressing **SOURCE** repeatedly while the display is still showing speaker distance setup. Set speaker selections or speakers' distance by pressing **PRESET +/- PRESET -** on the main unit or the **LEFT / RIGHT** arrows on the remote control.

## NOTE

- Always use the subwoofer for optimum sound quality.

# Advance Sound Control

• **Speaker distance:** For optimum surround experience measure the distance between the speaker and your favorite listening position.

1. Press and hold **SOURCE** for 3 seconds

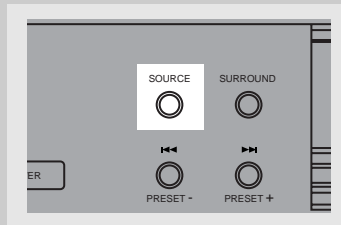

2. While the Display is showing FRNT 15 FT, press **PRESET +** or **PRESET -** on the main unit or **LEFT** or **RIGHT** arrow on the remote control to adjust the delay setting.

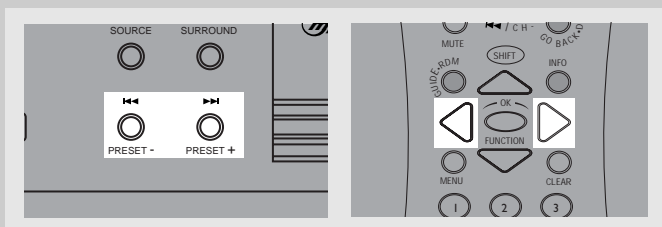

3. Press **SOURCE** once to move to the next delay setting.

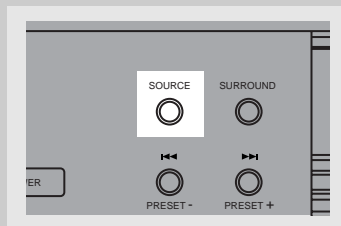

4. Repeat step 2 to set up the next speaker

5. When set up is done, wait for 5 seconds to automatically save your settings or press any source key to save your selection and set up mode.

## Speaker Icons

The receiver shows you the speakers' settings on the display with the following icons:

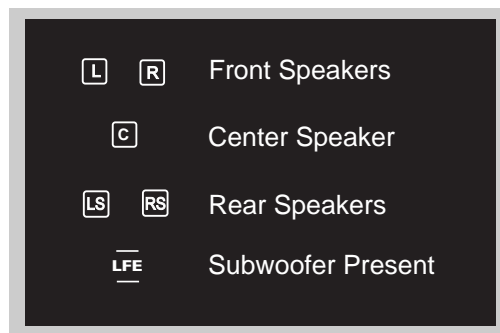

## Displaying Program Formats

When a digital source is playing, the receiver will automatically switch to the proper surround mode and indicates on the speaker icons on the right-hand side of the display. (See diagram)

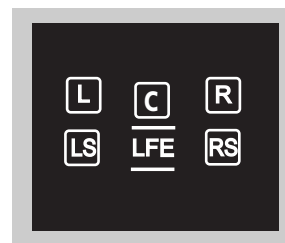

It is important to note, however, that not all Dolby Digital sources are encoded with the full complement of five channels plus LFE\*. Speaker icons show how many and which speaker you have enabled (See "Fine Setting of the Speakers") and the letters inside the speaker icons show which channel is present in the source information. For example, the diagram shown means you have all the five speakers and subwoofer enabled and the digital sources you played have five channels plus LFE complemented. (Dolby Digital 5.1 Channels)

\* LFE stands for Low Frequency Effect. The indication "LFE" appears if the digital source contains LFE information. In this case, the bass signal will be delivered to the subwoofer, offering more dynamic deep bass sound effects. If the letter is flashing, the signal is either too weak or just gone.

## Basic Playback Features

1. Press **SOURCE** on the main unit until "DVD/CD" appears on the display or **DVD** source key on the remote to select DVD/CD input source.

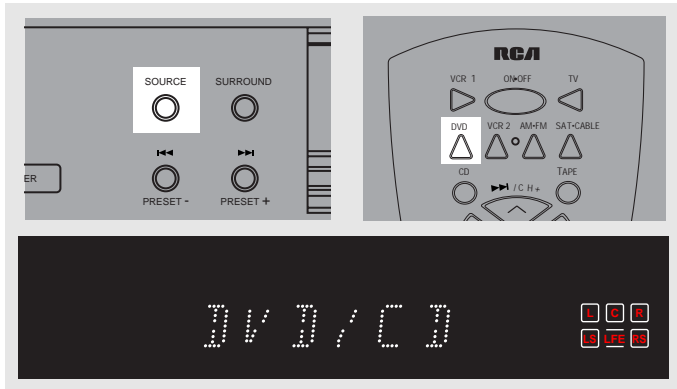

2. Open disc tray for loading discs with label side facing up. Press again to close it.

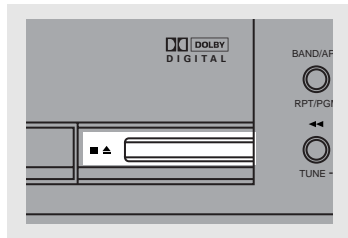

3. Press **PLAY/PAUSE** on the unit or **PLAY** on the remote control to start playback

• Press **PLAY/PAUSE** on the unit or **PAUSE** to pause playing during playback. Press **PLAY/PAUSE** on the main unit or **PLAY** on the remote to resume normal playback.

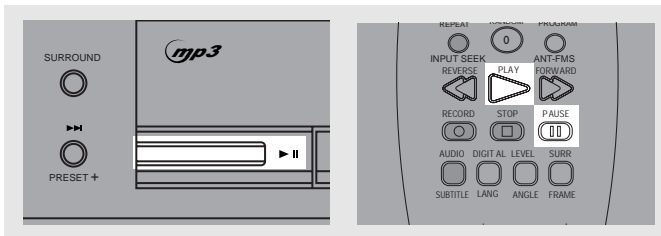

• Press **SKIP REVERSE** to go back to the previous chapter or **SKIP FORWARD** to move to the next chapter.

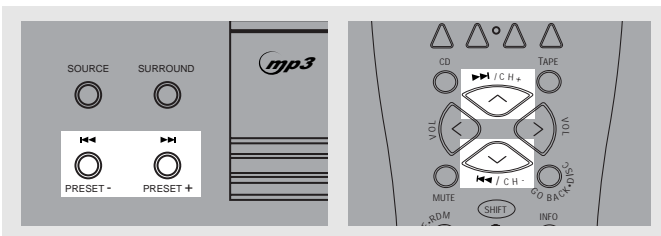

• Press **STOP** once to stop playback and go into resume mode.

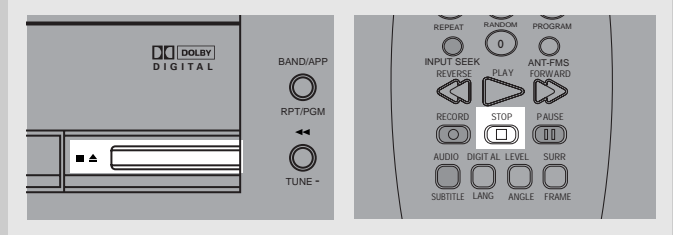

## NOTE

### RESUME MODE:

The next time **PLAY** is pressed, the unit will begin playback at the location where it was last stopped. Press **STOP** on the remote control to cancel the resume mode.

## Quick search

1. While playing a disc, press **REVERSE** on the remote control to scan backwards through the disc. Press **FORWARD** on the remote for scanning forward.

Press repeatedly to change searching speed to 1,2 or 3 times for VCD and 1,2,3 or 4 for DVD.

2. Press **PLAY** at any time to resume normal playback.

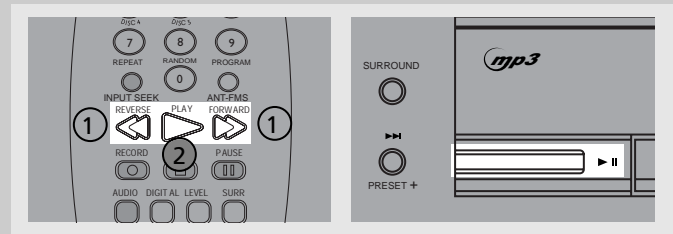

## Freeze frame, frame advance and frame backward

1. Press **PAUSE** to freeze picture during playback. Each time you press again, the picture advances one frame.

2. Press **PAUSE** repeatedly to move forward in still frame.

3. Press **SHIFT** then press **SURR/FRAME** repeatedly to move backward in still frame. (DVD only)

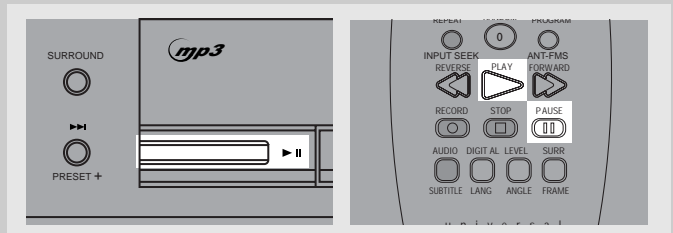

4. Press **PLAY** to resume normal playback.



# DVD Player

## Slow motion playback

1. Press **PLAY/PAUSE** on the main unit or **PAUSE** in the remote control to freeze the picture during playback.

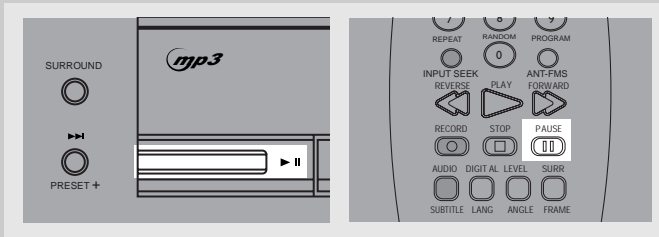

2. Advance picture in slow motion. Press **FAST FORWARD** on the unit or **FORWARD** on the remote control for slow motion in forward direction and **FAST REVERSE** or **REVERSE** (DVD only) in reverse direction. Press repeatedly to change speed to 1/16 times, 1/8 times, 1/4 times and 1/2 times.

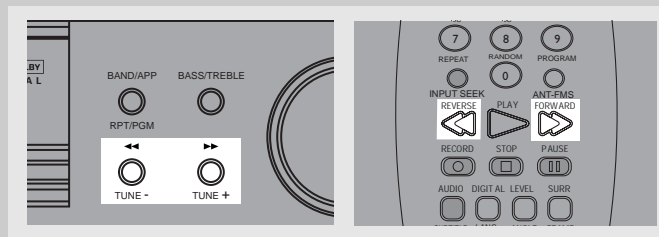

3. Press **PLAY/PAUSE** on the main unit or **PLAY** on the remote control to resume normal playback.

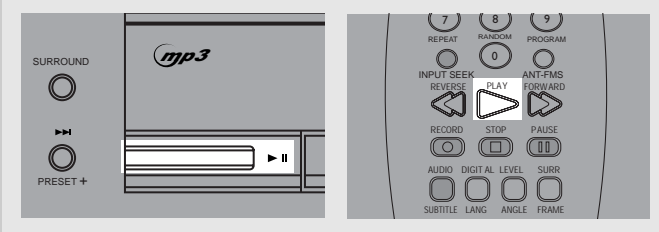

## On-screen banner display

You can access the on-screen banner display during playback to select many playback features. Each feature is illustrated with an icon. However, each banner display feature is available only if the disc was created with that particular feature.

An invalid icon appears on the screen when you select an icon that does not function. Also, the icon is "grayed out" to tell you so. 

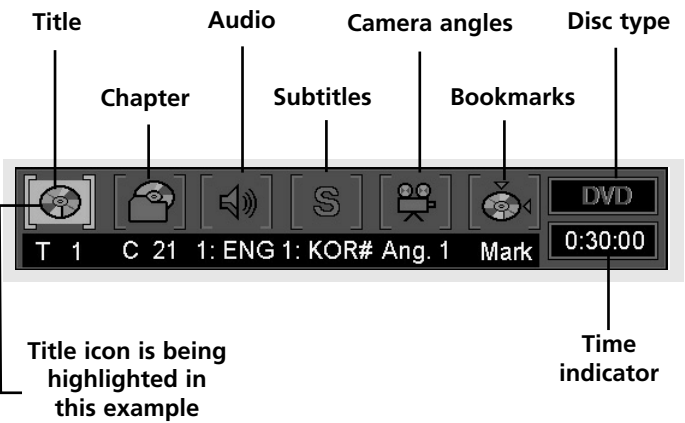

## General use

1. Press **INFO** on the remote control during playback to show on-screen banner.

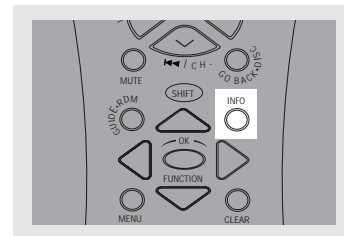

2. Use the **LEFT** or **RIGHT** arrows on the remote control to move cursor on the banner. Selected feature icon will be highlighted.

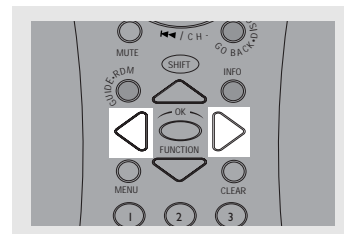

3. Press **OK** to open menu under selected feature.

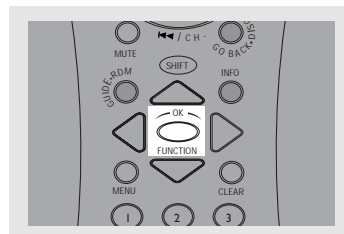



## Selecting a title

1. Refer to previous page "General use" to open the title menu.
2. Enter title number using the number keys on the remote control. Add 0 in front of single-digit title number (e.g. 9 = 09).

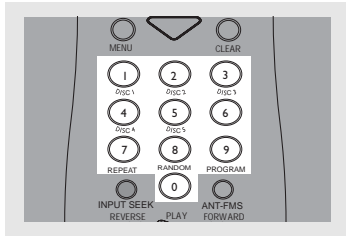

### NOTE

*Some discs have one title only.*

## Selecting a chapter

1. Refer to previous page "General use" to open the title menu.
2. Enter chapter number using the number keys on the remote control. Add 0 in front of single-digit chapter number (e.g. 9 = 09)

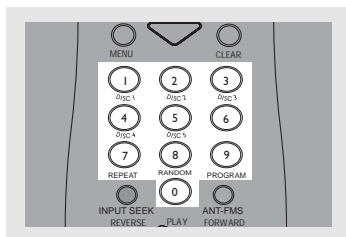

### NOTE

*The chapter feature will not work if the disc is not formatted with separate chapters.*

## Selecting audio language

1. Refer to the previous page "General use" to open the title menu.



2. Press **SHIFT** and **DIGITAL/LANG** or **OK** repeatedly until the audio language you want appears on the banner.

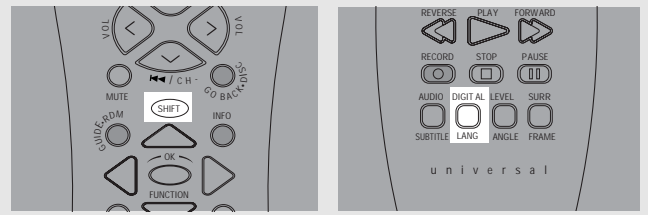

3. Press **INFO** to exit.

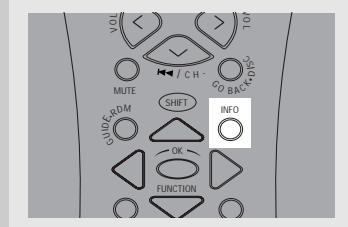

### NOTE

*This feature only works if the disc was created with multiple audio tracks.*

## Selecting subtitle language

1. Refer to previous page "General use" to open the subtitle menu.



2. Press **OK** to select and confirm subtitle language.

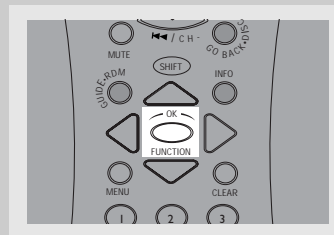

3. Press **SHIFT** and **AUDIO/SUBTITLE** repeatedly to turn subtitle on or off.

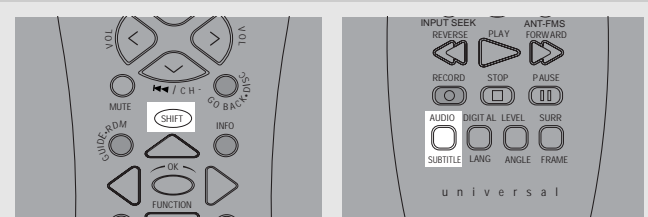

4. Press **INFO** to exit.

### NOTE

*This feature only works if the disc was created with subtitles.*

# DVD Player

## Selecting camera angle

1. Refer to page 20 "General use" to open the camera angle menu.



2. Press **SHIFT** and **LEVEL/ANGLE** to select the camera angle you want.

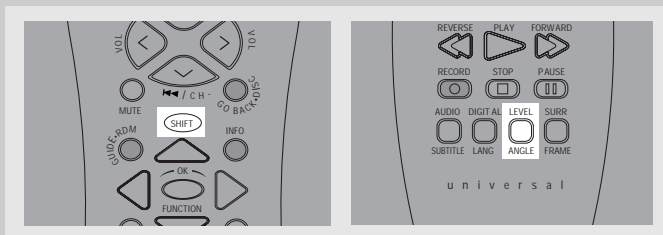

3. Press **INFO** to exit.

## NOTE

*This feature only works if the disc was created with multiple angles.*

## Using bookmarks

The bookmark feature allows you to mark a point on the disc that you can go to quickly. You can store up to 9 bookmarks.

### Adding bookmarks

1. Refer to Page 20 "General use" to open the bookmark menu.

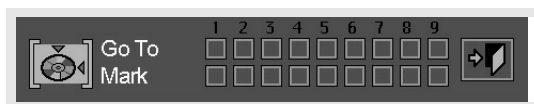

2. Use the arrows on the remote to move the cursor (yellow frame) to the "Mark" check line, then press **OK** to add bookmark when you reach the scene you want to do so.

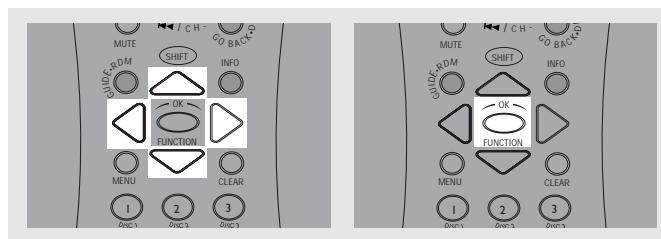

3. To add another bookmark, move the cursor to the right with arrow button and then press **OK** when you reach another scene you want to do so.

4. Move cursor to the door icon and then press **OK** to exit menu.



### Recalling bookmarks

1. Refer to page 20 "General use" to open the bookmark menu.

2. Use the arrows on the remote to move cursor (yellow frame) to the "Go To" check line and to the bookmarked scene you want to recall.

3. Press **OK** to recall bookmarked scene.

4. Move cursor by using the arrows to the door icon and then press **OK** to exit menu.



### Clearing bookmarks

The bookmarks are cleared each time a disc is removed from the player or when the power is turned off completely.

If all 9 bookmarks are in use, you can still mark new scenes but the previous bookmarks will be erased starting from the earliest one.

## Repeat (During Playback Only)

1. During playback, press the **RPT/PGM** button on the main unit or **SHIFT** and **7/REPEAT** repeatedly on the remote control to select among the repeat modes - **Repeat Disc** > **Repeat Title** > **Repeat Chapter** > **Repeat Off** > **(Repeat Disc)**. Selected mode is displayed in the banner display on screen.

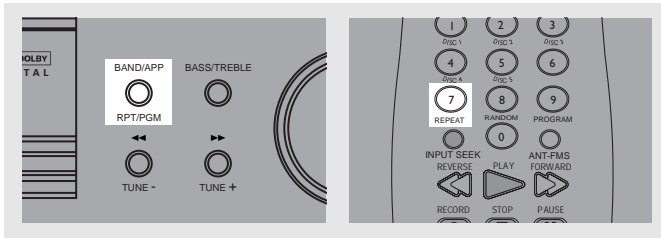

## NOTE

Random playback is not available in DVD mode.

## Program playback

### Edit program

1. In stop mode, press and hold **RPT / PGM** on the main unit or **SHIFT** and **9/PROGRAM** to display program edit playlist.

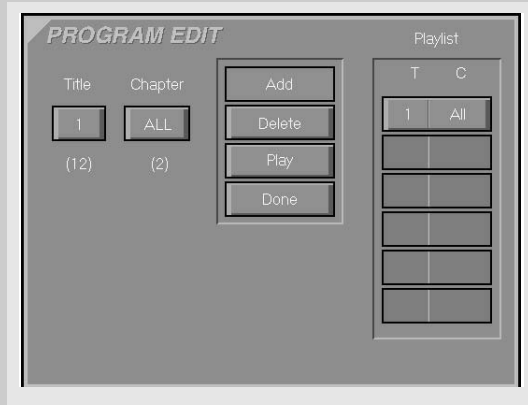
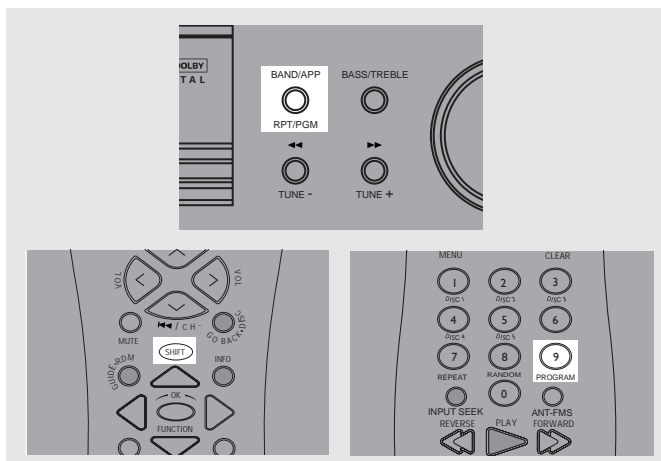

2. The box under "Title" will be highlighted automatically. Use the arrows on the remote to select title and chapter.

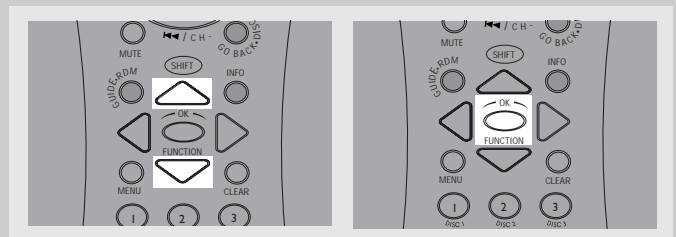

3. "Add" will be highlighted automatically after chapter is selected. Press **OK** to add selected track and chapter(s) onto playlist.

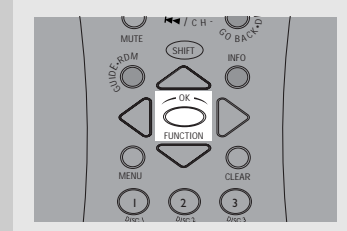

4. Move to highlight "Play" (start program playback) or "Done" (return normal playback with program saved), then press **OK** to start program playback or return to stop mode.

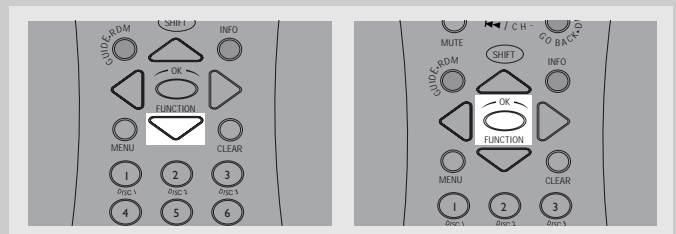

## NOTE

You can select at maximum 32 items by repeating steps 2 - 3.

# DVD Player

## Delete program

1. In stop mode, press and hold **RPT / PGM** on the main unit or **SHIFT** and **9/PROGRAM** to display program edit playlist.
2. Use the arrows on the remote to select and highlight the programmed item you want to delete on the playlist.

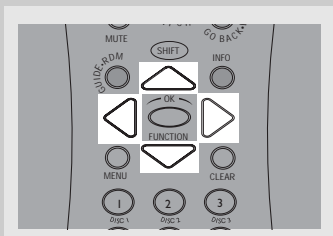

3. Highlight "Delete" and then press **OK** to delete item.

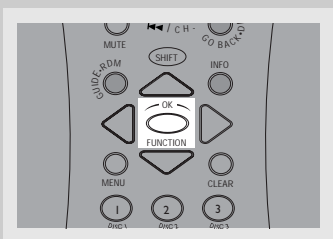

4. Repeat steps 2 and 3 to delete additional items.
5. Use the arrows to select and highlight "Play" (start program playback) or "Done" (return to normal playback with program saved) and then press **OK**.

## Insert chapter

1. In stop mode, press and hold **RPT / PGM** on the main unit or **SHIFT** and **9/PROGRAM** to display program edit playlist.

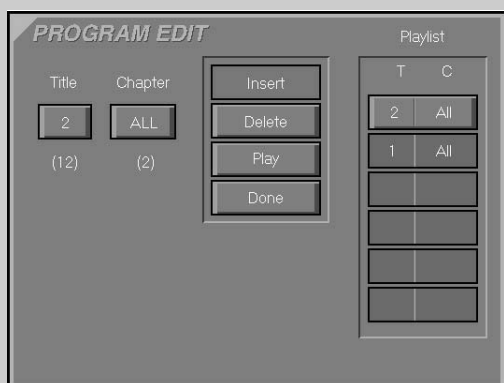

2. Use the **UP** or **DOWN** arrows to select and highlight item on the playlist where you want to insert a chapter before it.

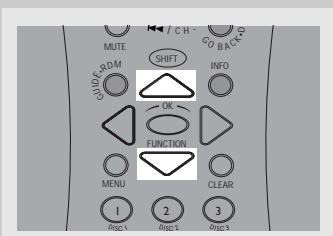

3. Use the **LEFT** and **RIGHT** arrows to select Title or Chapter, then the **UP** and **DOWN** arrows to select the number.

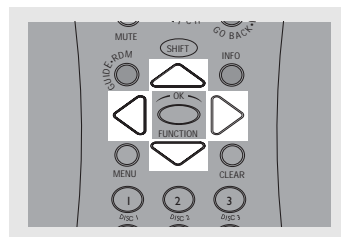

4. Use the **LEFT** and **DOWN** arrows to highlight "Insert" and then press **OK**.

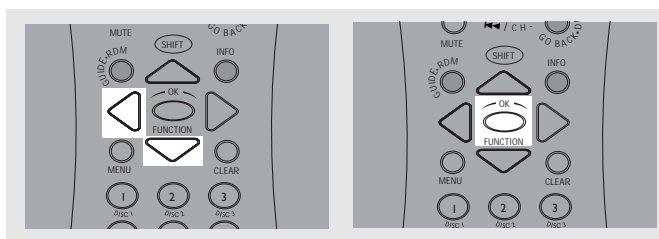

5. Use the arrow buttons to highlight "Play" (start program playback) or "Done" (return to normal playback with program saved) and then press **OK**.

## Cancel program

Program will be cancelled when;

1. disc tray is opened;
2. power is turned off;
3. **STOP** is pressed twice. The red PGM indicator will disappear on display and player will resume normal playback mode. Nevertheless, the program will remain in memory and can be recalled by pressing **PROGRAM** again.

## Set up menu

### NOTE

After using **AUDIO**, **DIGITAL**, **LEVEL** or **SURR** keys on the remote control in DVD/CD function mode, press the **DVD/CD** or the **SHIFT** key to use other DVD keys.

## General use

1. Press **MENU** in stop mode to display the set up menu on screen. The menu shows current settings.

### NOTE

if you press during disc playback, the disc's own menu will be displayed.

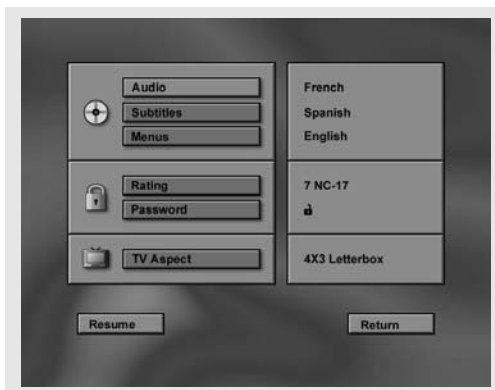
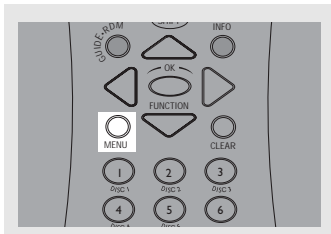

2. Use arrow buttons to highlight options and press **OK** to open selected menu.

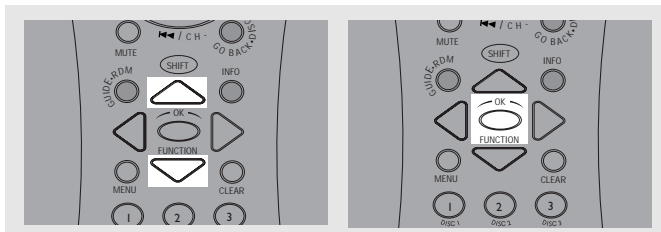

3. Press **LEFT** arrow to go back to the previous menu or press **GO BACK•DISC** to exit the setup menu completely.

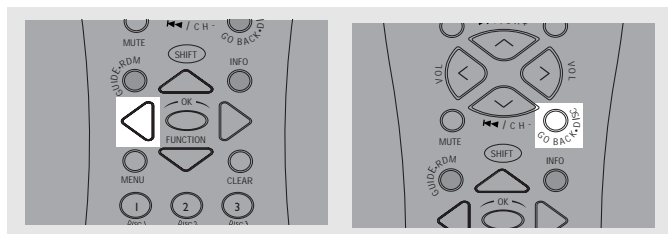

## Audio language

This step will define the default audio language. Choosing an audio language from the on-screen banner display will only overwrite this setting temporarily.

### NOTE

If language selected is not available on disc, the language designated as default by each disc will be selected..

1. Refer to "General use" to open audio language menu.

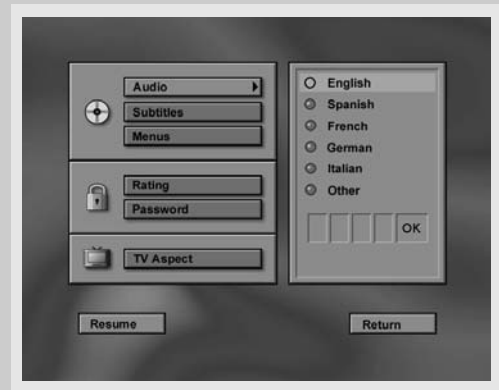

2. Use **UP** and **DOWN** arrows to select language and then press **OK**.

### For languages other than options available:

3. Press **DOWN** to select "Other" and then press **OK**.

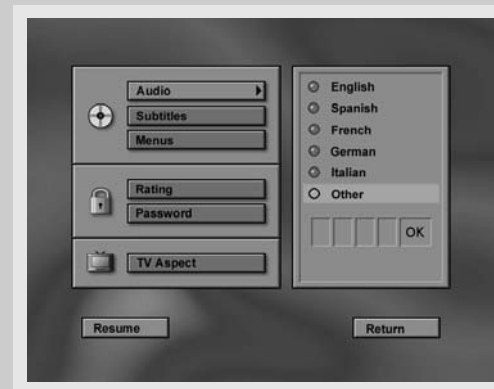

4. Enter language code into boxes and then select **OK** to return to main menu. Press **OK** on the remote.

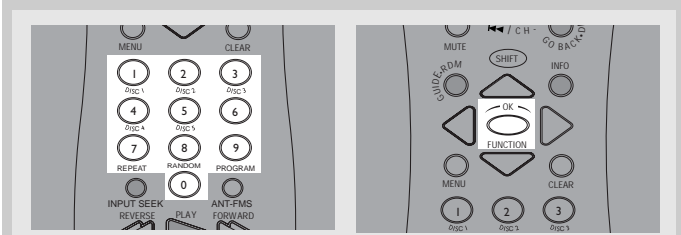

# DVD Player

## Subtitle language

This step will define the default subtitle language. Choosing a subtitle language from the on-screen banner display will only overwrite this setting temporarily.

### NOTE

*If language selected is not available on disc, the language designated by each disc as default will be selected.*

1. Refer to page 25 "General use" to open subtitle language menu.



2. Press **UP** and **DOWN** arrow to select language and then press **OK**.

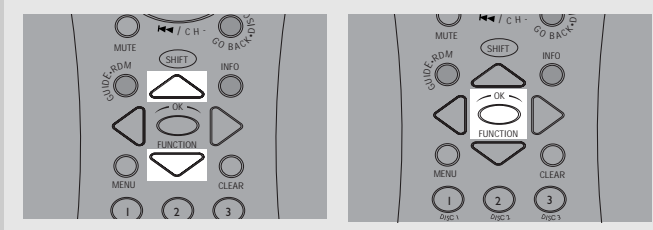

### For languages other than options available:

3. Move down and select "Other" and then press **OK**.

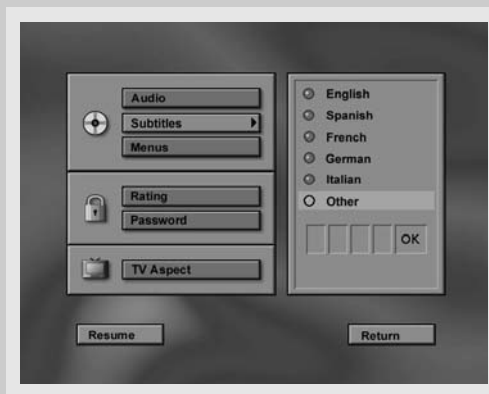

4. Enter language code into boxes and then select **OK** to return to main menu. Press **OK** button on the remote.

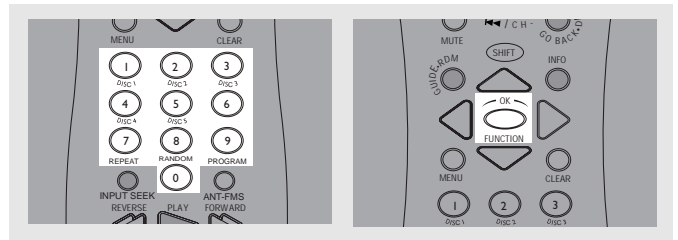

## Menu language

This step will define the language of menus and other short messages shown on screen.

1. Refer to page 25 "General use" to open menu language menu.

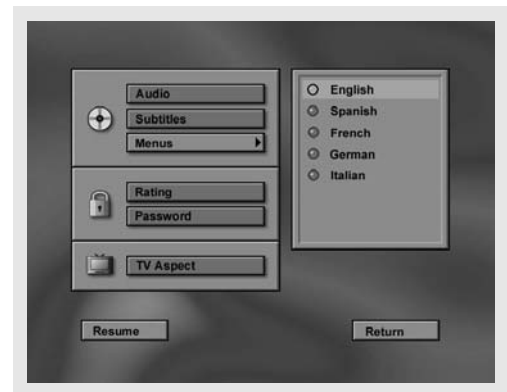

2. Use the **UP** and **DOWN** arrows to scroll the selections and select the language and then press **OK** to return to main menu.

## Rating (Parental control)

This step will disable the playing of some DVDs (especially U.S. type) which are not suitable for some audience, e.g. children. Such kind of DVDs is encoded with a specific rating level. If the rating level of the disc is higher than the preset level (to be set in this step), the playing will be prohibited unless the password (see next step) is entered.

1. Refer to page 25 "General use" to open the rating menu.

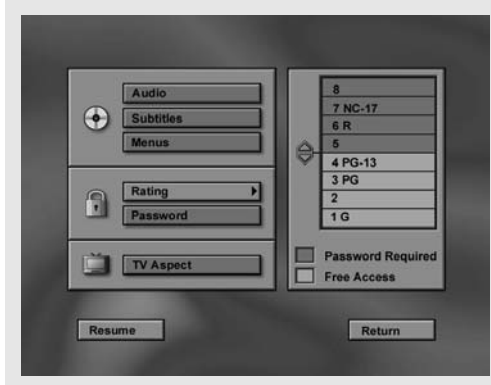

2. Use the **UP** or **DOWN** arrows to highlight the rating that would require a password to play. Press **OK** to return to main menu. Ratings highlighted in blue require password.

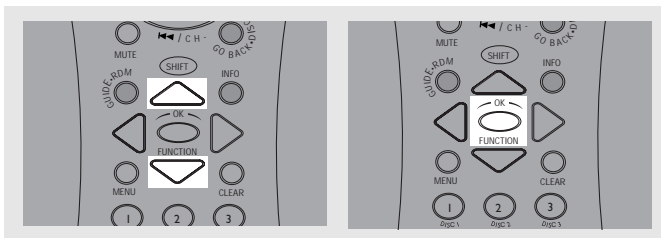

The rating systems is based on information encoded on the DVD disc being played, so movies may carry a rating symbol, the disc may or may not contain that rating in its software. In addition to the five standard (MPAA) rating symbols of "G" (level 2), "PG" (Parental Guidance, level 4), "PG13" (Parental Guidance and 13 years old, level 4), "R" (Restricted, level 6) and "NC17" (from 17 years old, level 7), the DVD will accommodate a total of 8 rating steps, as set by the DVD makers. These additional steps allows for more critical control of program playback for all audiences.

- Level 8: All DVDs can be played (Factory preset).
- Level 7 to 2: DVDs for general audiences/ children can be played.
- Level 1: DVDs for children can be played, DVDs for adults/ general audiences are prohibited.

## Password

### Set password

To disable the viewing of rated DVDs, a four-digit password must be selected.

1. Refer to page 25 "General use" to open the "Set Password" menu.

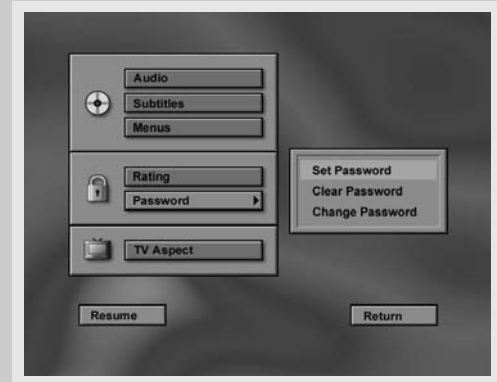

2. Select "Set Password" and press **OK**.

3. Use the number buttons to enter password and then press **OK**.



4. Repeat step 3 to confirm password.

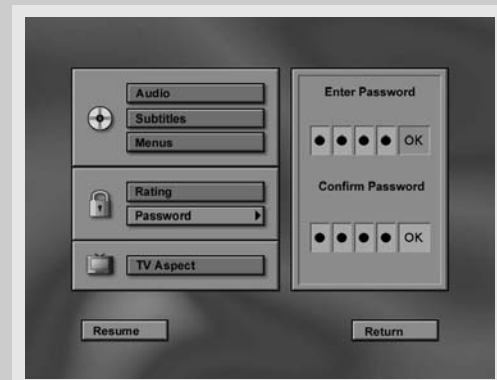



# DVD Player

## NOTE

- When incorrect password is entered, new password menu appears and you can enter and confirm password again.
- A lock icon shows on unit display when password is required to view rated discs.

**Important:** keep the password in a safe place or remember it reliably as access to rated discs or rating/ password menus requires the correct password.

## Change password

Current password must be entered first to change password.

1. Refer to page 25 "General use" to open the password menu.

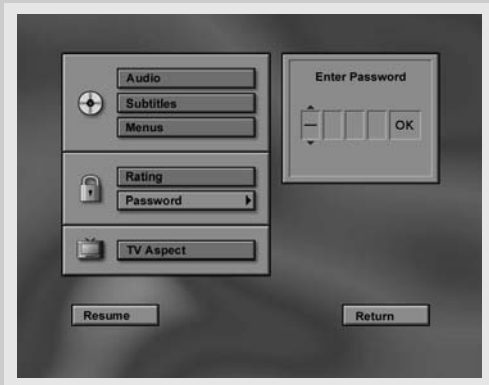

2. Use the number buttons to enter password and then press **OK**.

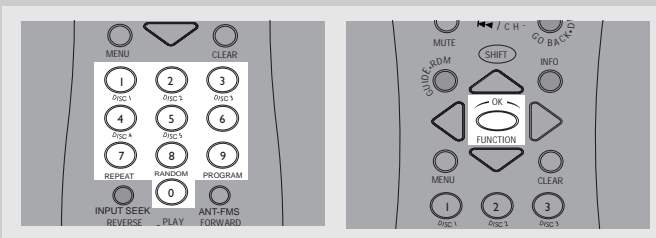

3. Use the **UP** and **DOWN** arrows to select "Change Password" and then press **OK**.

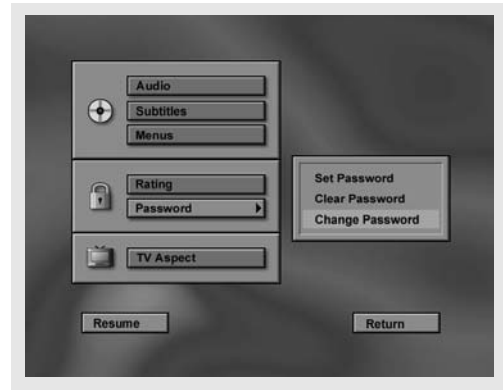
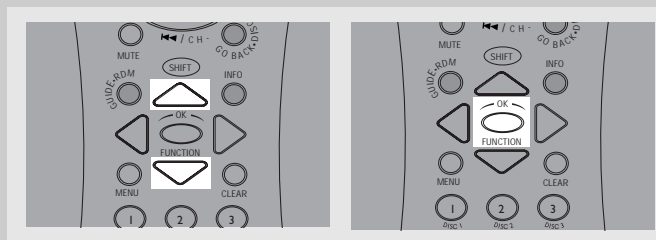

4. Use the number buttons to enter new password and then press **OK**.

5. Repeat the above step to confirm password and return to password menu. Use the **LEFT** arrow to return to the main menu.

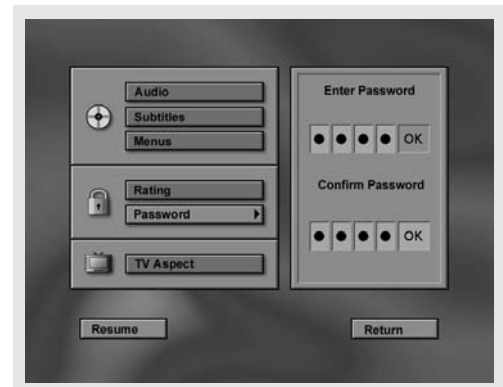

## Clear password

1. Refer to page 25 "General use" to open the password menu.

2. Use the number buttons to enter password and then press **OK**.

3. Move up or down the menu using the **UP** or **DOWN** arrows and select "Clear Password". Press **OK** to clear password. Use the **LEFT** arrow to return to the main menu.

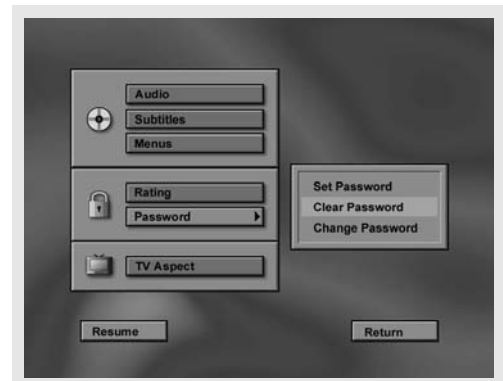



## TV aspect

This step selects the TV aspect, wide-screen (16:9) or conventional (4:3).

1. Refer to page 25 "General use" to open the TV aspect menu.

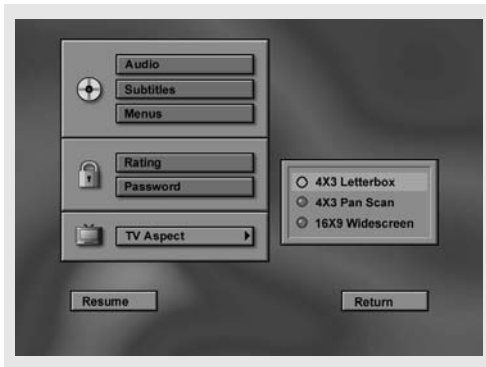

2. Use the **UP** or **DOWN** arrows to select TV aspect and then press **OK** to return to main menu.

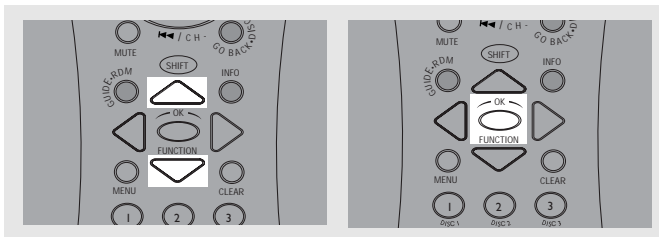

If you have a wide-screen (16:9) TV, choose "16:9 Widescreen".

- For 16:9 movie you will get

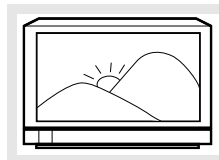

- For 4:3 movie you will get

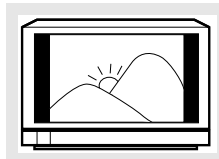

If you have a conventional (4:3) TV,  
- if you select 4:3 letterbox for 16:9 movie, you will get

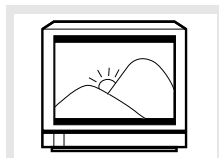

- if you select 4:3 Pan Scan for 16:9 movie, you will get (the left and right edges are hidden)

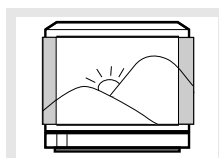

- for 4:3 movie, for both selections, you will get

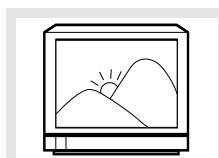

# CD / MP3 Player

## MP3 Recommendations

- Use *.mp3* as the extension when converting audio files into MP3 for saving onto CD-R(W) or CD-ROM, e.g. *Rocky08.mp3*. Do not use any other extension e.g. *.doc*, *.pdf*.
- Do not use the *.mp3* extension for other text or non-audio data files as this may result in serious malfunction and harmful noise interference.
- Many common CD creator softwares can make files compatible for the system but do not forget to finalize your disc after creation. This set cannot read DirectCD recordings.
- In order to get audio CD quality, you need to record your MP3 CD at 128 kbps. You can record up to 256 kbps. Beyond 256 kbps, the unit might not read the CD.
- Do not combine CD Audio and MP3 tracks onto a CD-R(W) or CD-ROM. The player will only playback CD audio tracks from mixed CD formats.

## NOTE

- ID3 tag (Album, song, artist name) is not supported.
- If over 400 items (songs/folders) are on the disc, only the first 400 songs can be played.
- Resume function does not operate in MP3 mode.

The CD/MP3 playback function works in a similar way as the features available for DVD.

Press **SOURCE** on the main unit or **DVD** source key on the remote to select DVD/CD input source.

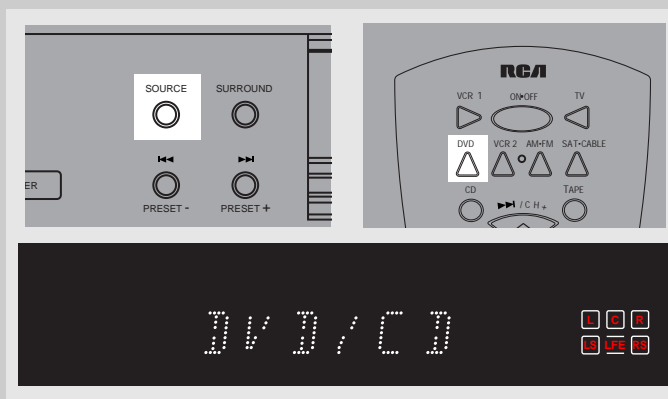

## Loading and playing an audio CD

1. Press **STOP/EJECT** button on the front panel to open the disc tray. Place disc on the disc tray with the label side facing up. Press **STOP/EJECT** again to close disc tray.

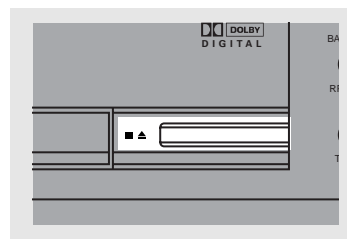

The disc will be read to detect whether an audio CD or MP3 CD has been inserted.

## NOTE

If the CD is a MP3 audio CD, reading may take up to 2 minutes.

2. Playback begins automatically after the disc has been read. An audio CD **CD** or MP3 icon **MP3** will show on the left of the display.
3. Press **PLAY/PAUSE** on the main unit or **PAUSE** on the remote control to pause playback. Press **PLAY/PAUSE** again on the main unit or **PLAY** on the remote to resume normal playback.

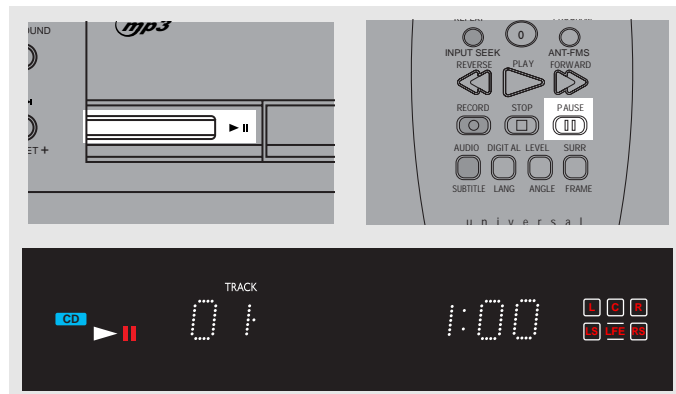

# CD / MP3 Player

4. Press **SKIP REVERSE** on the main unit or CH- on the remote to return to the previous track. Press **SKIP FORWARD** on the main unit or CH + on the remote to go to the next track.

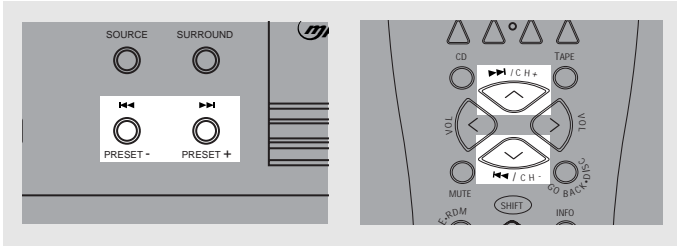

5. Press **STOP/EJECT** on the main unit or **STOP** on the remote control to end playback.

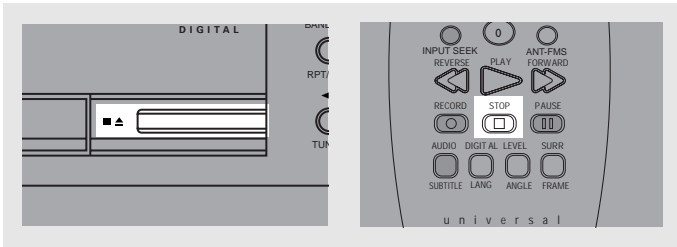

## NOTE

When playback is interrupted, the location at which it stopped will be memorized. Playback will resume at the position it was last stopped. Resume playback does not work on MP3 music.

## Quick scan

1. Press and hold **FAST FORWARD** or **FAST REVERSE** on the main unit or **FORWARD** or **REVERSE** on the remote to scan through a track quickly during playback. To change speed to 1, 2 or 3 times, press repeatedly during scan. Quick scan does not work on MP3 music.

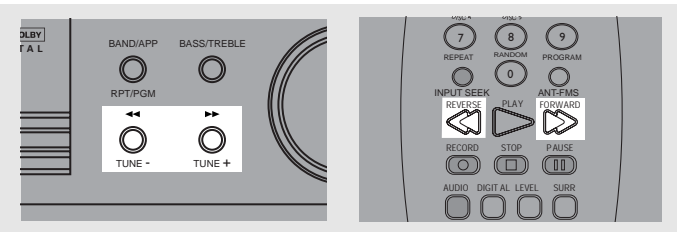

2. Press **PLAY** on the main unit or the remote to resume normal playback.

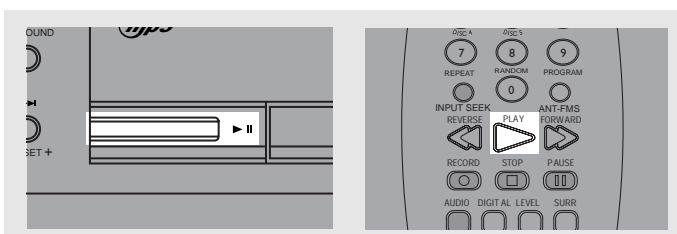

## Repeat

There are 3 repeat options for CD playback.

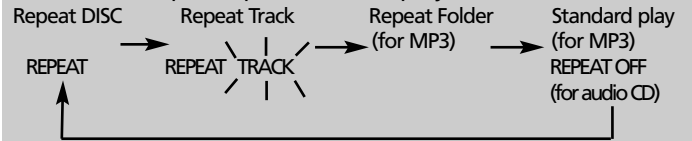

The corresponding icon will be shown on the top of the display.

1. Press **RPT/PGM** on the main unit or **SHIFT** and number **7 / REPEAT** repeatedly to toggle among repeat options. When playing an audio CD Repeat can only be activated while playing.

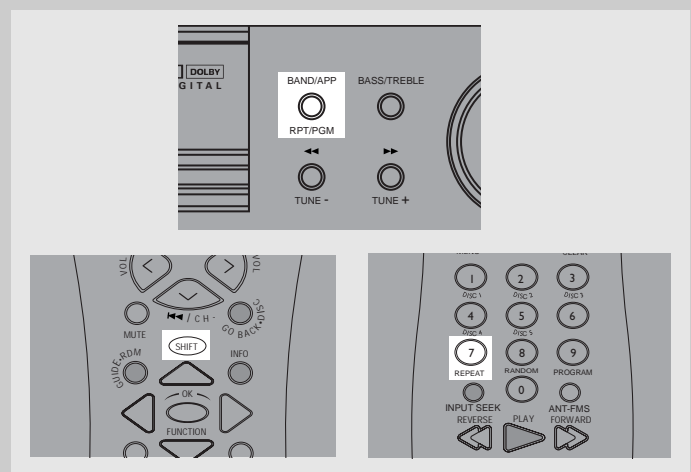

## Random

1. Press and hold **TREBLE** on the main unit or press **SHIFT** and number **8 / RANDOM** for random playback.

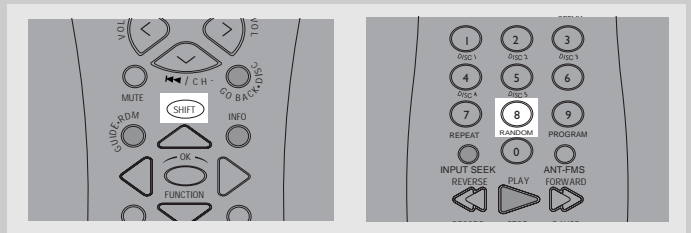

EN

# CD / MP3 Player

## On- screen banner display for CD playback

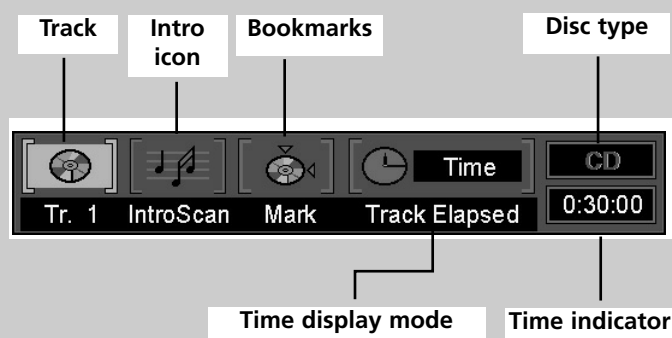

## General use

1. Press **INFO** on the remote control to hide and show on- screen banner. (Only audio CD banner)

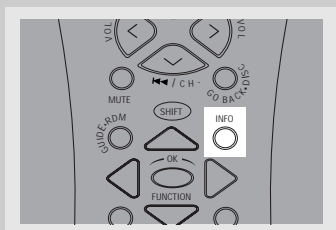

2. Use the **LEFT / RIGHT** arrow keys to move cursor on the banner. Selected feature icon will be highlighted.

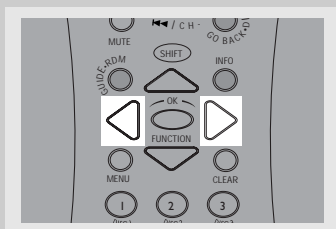

3. Press **OK** to open menu under selected feature.

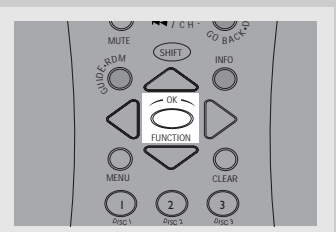

## Selecting a track

1. Refer to "General use" to open the track menu.
2. Enter track number. Add 0 in front of single-digit track number (e.g. 9 = 09).

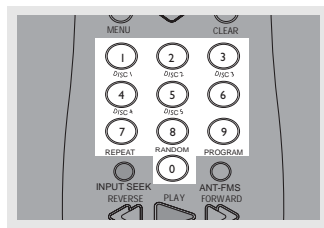

## NOTE

You must be in playback mode for track selection.

**Shortcut:** enter track number directly using number buttons to select a track during playback.

## IntroScan (Only for audio CDs)

IntroScan plays the first few seconds of each track.

1. Refer to "General use" to open the IntroScan menu. IntroScan will start automatically after you have pressed **OK**.
2. Press **OK** again, **PLAY** or **PLAY/PAUSE** on the main unit to end IntroScan. The track that you stopped at will be played normally.

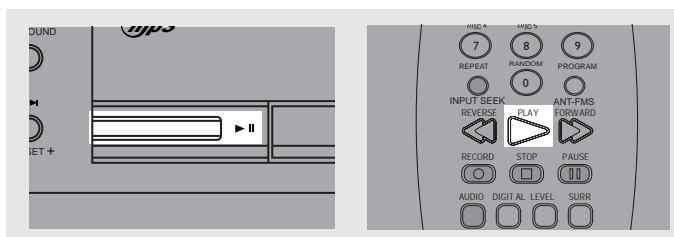

## NOTE

IntroScan ends when all the tracks have been played.

## Bookmarks (Audio CDs Only)

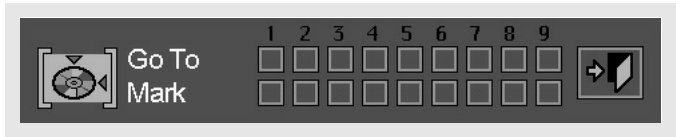

The bookmark feature allows you to select certain points on the disc where you want to jump to quickly. 9 bookmarks can be selected.

### Adding Bookmarks (Audio CDs Only)

1. Refer to "General use" on page 32 to open the bookmark menu.



2. Use the arrow keys to move the cursor (green frame) to the "Mark" check line, then press **OK** to add bookmark when you reach the point you want to do so.

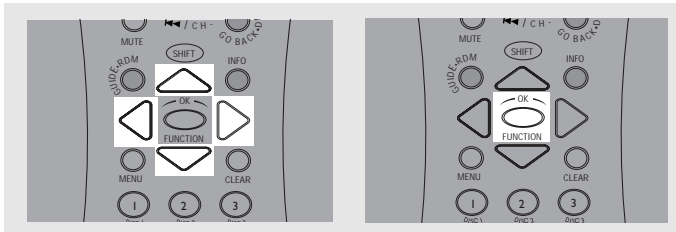

3. To add another bookmark, move the cursor to the right and then press **OK** when you reach another point you want to do so.

4. Move cursor to the door icon and then press **OK** to exit menu.



### Recalling bookmarks

1. Refer to "General use" on page 32 to open the bookmark menu.

2. Use the **UP** arrow to move the cursor (green frame) to the "Go To" check line and use the **LEFT** or **RIGHT** arrow to the bookmarked point you want to recall.

3. Press **OK** to recall bookmarked point.

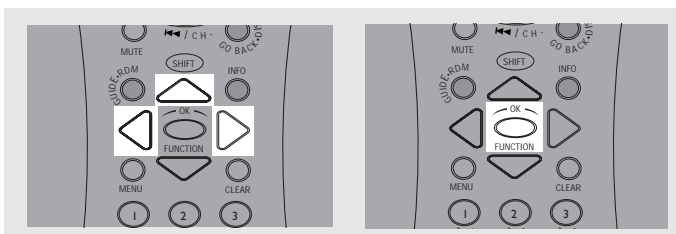

4. Use the arrow buttons to move cursor to the door icon and then press **OK** to exit menu.



### Clearing bookmarks

The bookmarks are cleared each time a disc is removed from the player or when the power is turned off completely.

If all 9 bookmarks are in use, you can still mark new points but the previous bookmarks will be erased.

### Time display (Audio CDs Only)

1. Refer to "General use" on page 32 to open the time display menu.

2. Press **OK** repeatedly to switch among "Track Elapsed", "Track Remain", "Disc Elapsed" and "Disc Remain" time during playback. Selected mode shows on banner.

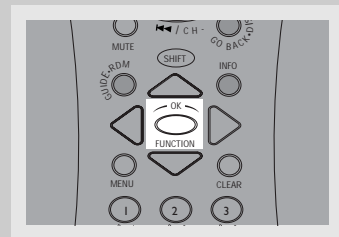

### Repeat and random features

There are 5 options for this feature.

1. **Repeat Track** – plays one track over repeatedly.
2. **Repeat Disc** – plays the disc you have selected or being played at the moment over repeatedly.
3. **Random** - plays tracks randomly on one disc. (Audio CD only)
4. **Random Repeat Disc** - plays tracks randomly and over repeatedly on disc. (Audio CD only)
5. **Repeat Off** – Ends the repeat function.

Press **SHIFT** and **7 / REPEAT** for repeat modes.

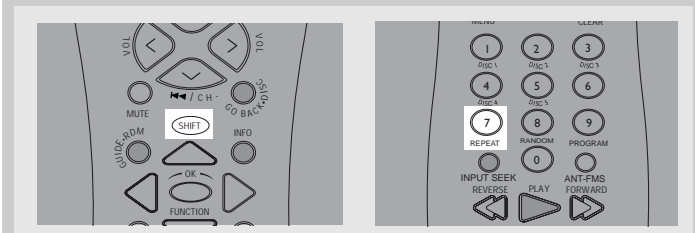

Press **SHIFT** and **8 / RANDOM** for random modes.

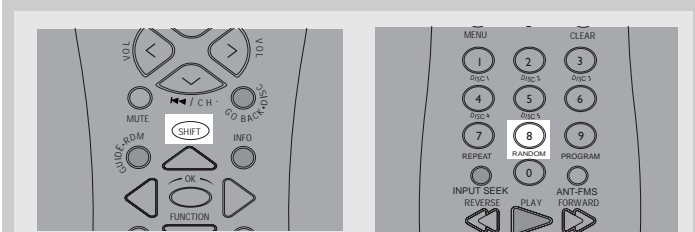

## NOTE

Select among the 5 options until the desired one shows on banner.

# CD / MP3 Player

## Program playback

### Edit program

1. In stop mode, press and hold **RPT / PGM** on the main unit or **SHIFT 9 / PROGRAM** on the remote control to display program edit playlist.

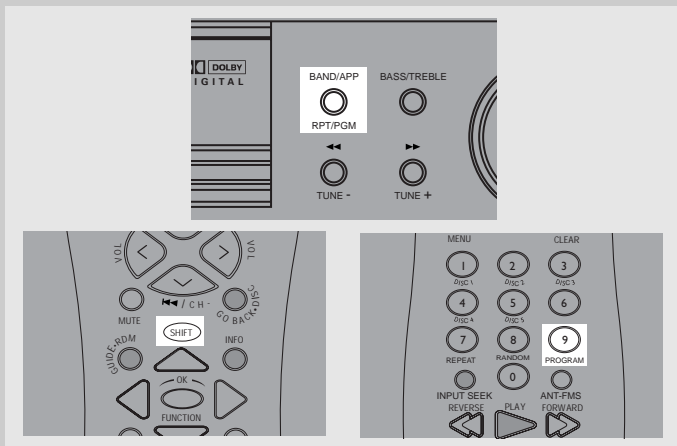

2. The box under "TRACK" will be highlighted. Press **UP** or **DOWN** arrow buttons or number buttons to select track. Press **OK**.

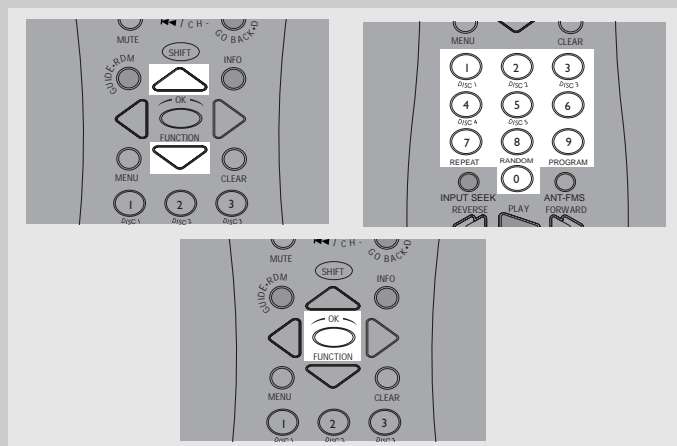

3. "Add" will be highlighted automatically after track is selected. Press **OK** to add selected track onto playlist.

4. Repeat steps 2 and 3 to add additional tracks to the program.

5. Move to highlight "Play" (start program playback) or "Done" (return to normal playback with program saved) and then press **OK** to confirm program playback.

## NOTE

You can select at maximum 32 items by repeating steps 2 - 3.

### Delete Program

1. In stop mode, press and hold **RPT / PGM** on the main unit or **SHIFT 9 / PROGRAM** on the remote control to display program edit playlist.

2. Use the **LEFT** or **RIGHT** arrow to select Playlist, then use the **UP** or **DOWN** arrows to select and highlight the programmed track you want to delete on the playlist.

3. Use the arrow buttons to highlight "Delete" and then press **OK** to delete track.

4. Highlight "Play" (to start program playback) or "Done" (to return to normal playback with program saved) and then press **OK**.

### Insert track

1. In stop mode, press and hold **RPT / PGM** on the main unit or **SHIFT 9 / PROGRAM** on the remote control to display program edit playlist.

2. Use the arrows to highlight item on the playlist where you want to insert a track before it.

3. Refer to "Edit program" to select a track to be inserted.

4. Highlight "Insert" and then press **OK**

5. Highlight "Play" (start program playback) or "Done" (return to normal playback with program saved) and then press **OK**.

### Cancel program

Program will be cancelled when;

1. disc tray is opened;
2. power is turned off;
3. **STOP** is pressed twice. The red PGM indicator will disappear on display and player will resume normal playback mode. Nevertheless, the program will remain in memory and can be recalled by pressing PROGRAM again.

## On- screen display for MP3 playback

Refer to "General Use" on page 32 for basic operations.

### Normal Play

#### File mode

1. Use the **UP** or **DOWN** arrow buttons on the remote to select the file you wish to begin playing.

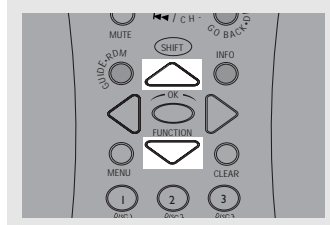

2. Press **PLAY** on the main unit or on the remote control to start playback. If you are currently playing, then press **OK** button to select a different MP3 to play. All the files or folders will be played starting with the one you have selected.

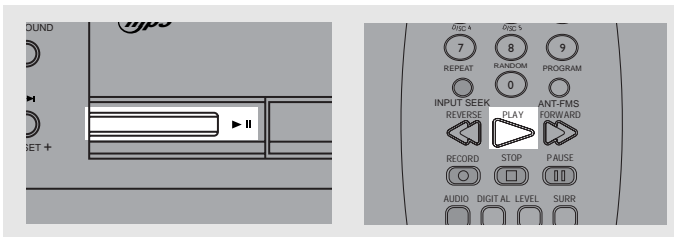

Playback stops when all files have been played.

### Folder mode

1. Use the arrow buttons on the remote to select the folder you wish to play.

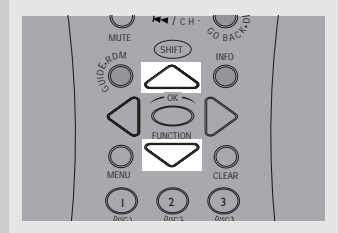

2. Press **OK** to enter the folder and **PLAY** when in stop mode or **OK** when currently playing to begin playback of all the files in the folder.

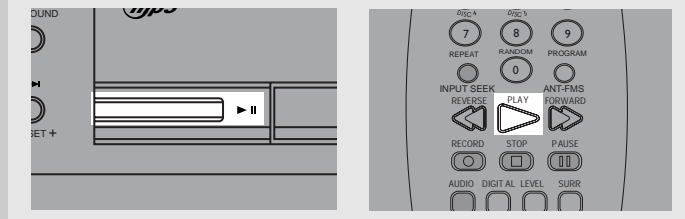

Playback stops when all files have been played.

3. To exit a folder, use the arrow buttons to select the **RETURN** arrow then press **OK**.



# CD / MP3 Player

## Program Play

1. In stop mode, press and hold **RPT / PGM** on the main unit or **SHIFT** and **9/PROGRAM** on the remote to access the program display.

The "PROG." icon will show on the display.

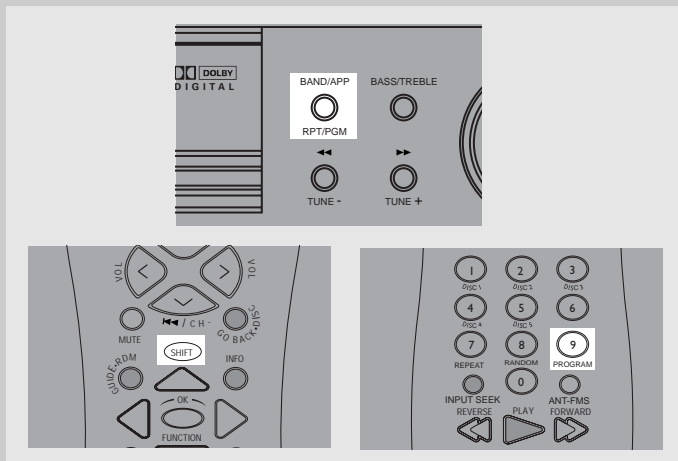

2. Use the **UP** and **DOWN** arrows on the remote to select the folder on the left that you wish to add to the program list.

3. Press **OK** to move the file or folder to the right programming list.

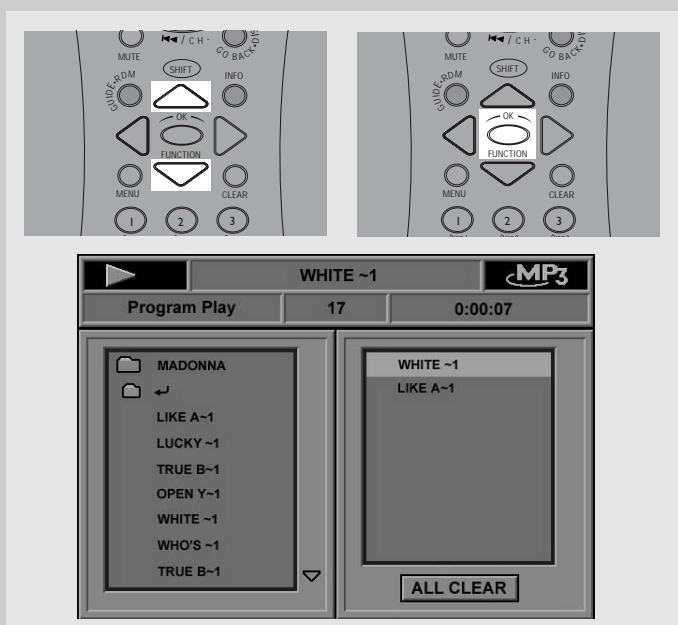

4. Once all the files or folders have been selected, Press **PLAY** to being program playback.

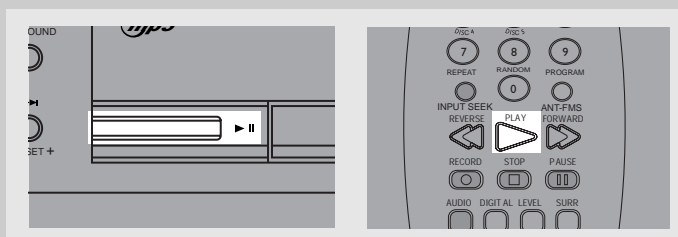

5. Press **STOP** or **RPT / PGM** on the main unit or **STOP** or **SHIFT 9/PROGRAM** to end program playback.

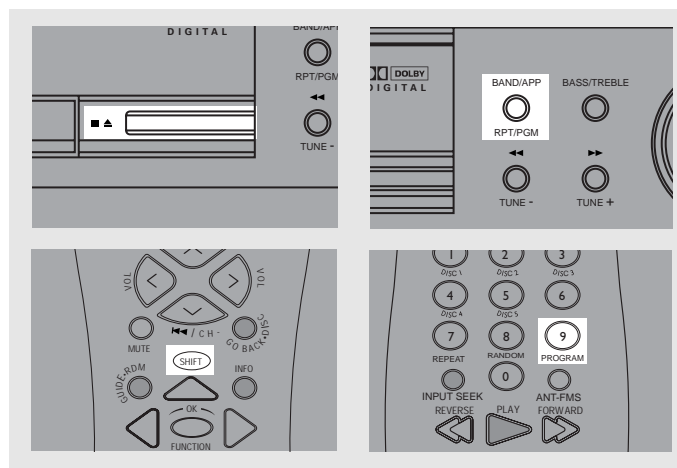

6. To play program again, press and hold **RPT / PGM** on the main unit or **SHIFT 9/PROGRAM** while in stop mode to reactivate program playback. Press **PLAY** to begin.

## Delete a specific File or Folder from Program List

1. In stop mode, use the **LEFT** or **RIGHT** arrows to select program list, then use the **UP** or **DOWN** arrows to select file to be deleted and press **CLEAR** to delete.

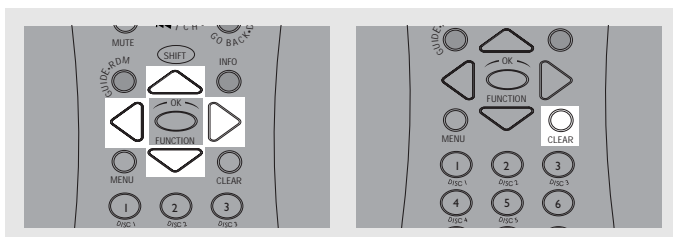

## Delete All

1. In stop mode, use the **LEFT** or **RIGHT** arrows to select "ALL CLEAR" icon and press **OK** to clear all.

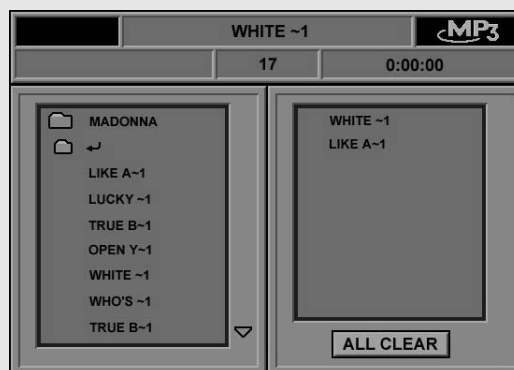
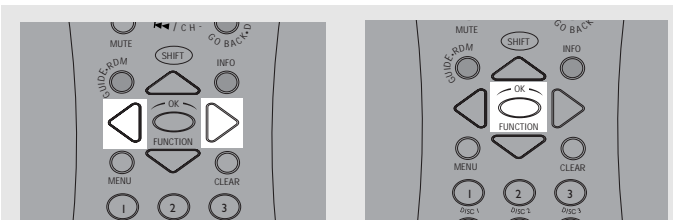



## Operating the Radio

The receiver has a built-in tuner that allows for AM/FM radio function.

### Manual tuning

1. Connect the FM and AM antenna accordingly (see "Connecting the Antenna" on page 5 section for details)

2. Press **POWER** on the main unit.

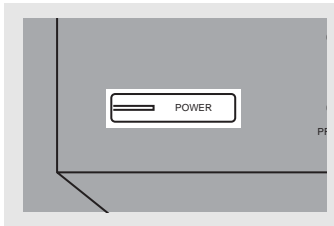

3. Press **SOURCE** until tuner mode is selected or press **AM/FM** on the remote control.

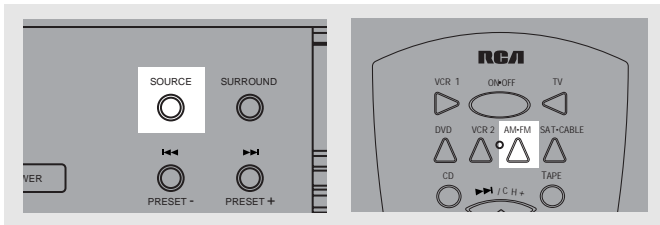

4. To select band, press the **BAND/APP** on the main unit or **AM/FM** button on the remote again to toggle between AM/FM mode.

When an FM station broadcast Stereo sound, ST is displayed.

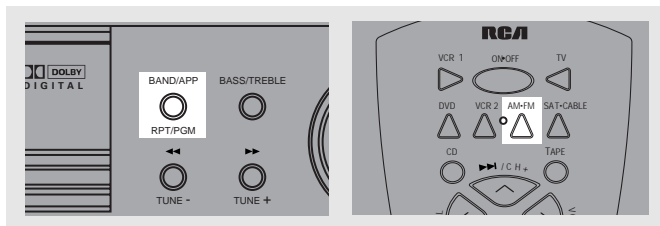

5. Tune the stations by pressing **TUNING +** or **-** on the main unit or **FAST FORWARD** or **FAST REVERSE** on the remote control repeatedly until the desired station is found.

Alternatively, you can press and hold the respective buttons for about one second to activate the automatic **SEARCH** function. In this mode the receiver will automatically tune frequencies until it finds a station



6. Repeat steps 5 to tune another radio station.

Select sound effect if needed by pressing **SURROUND** or **SURR/FRAME** sound (see "Advance sound section" on page 15 and 16 for details)

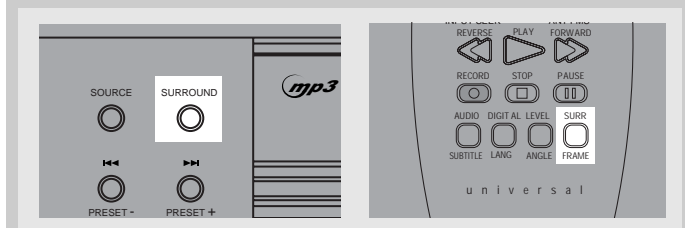

## NOTE

1. If there is interference, modify the location of the antenna until the optimal sound is heard. TV and other electronic devices could be the cause of interferences so try to position the antenna away from them.

2. Weak signal can affect the "auto Search function". Adjust the antenna for better reception for more efficient search.

# Radio

## Storing radio stations:

The receiver can store up to 30 radio stations in memory. You can enter every single radio station yourself or the receiver can store all available radio station automatically in an ascending order.

### Automatic preset storing :

1. Press **BAND/APP** on the main unit or **AM/FM** repeatedly on the remote control to select the FM band.

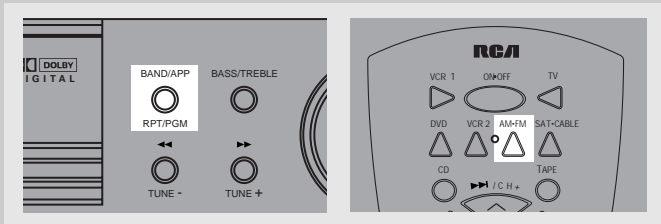

2- Press and hold **BAND/APP/RPT/PGM** for 3 seconds to start automatic preset programming. "AUTO" will be flashing during the automatic storing process.

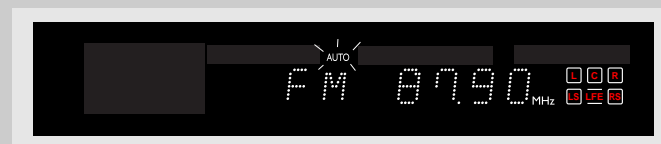
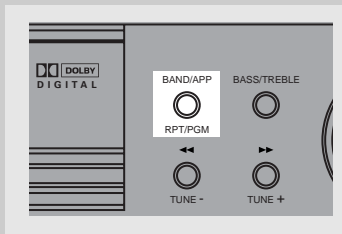

Radio frequencies will be browsed and radio stations stored automatically. When all available radio stations are stored or if all 30 memory locations are full, the auto preset will stop.

## NOTE

*Weak signal can affect the "Automatic Preset Storing function" efficiency. Adjust the antenna for the best reception for more efficient search.*

### Manual preset

1. Select the band by pressing **AM/FM** repeatedly
2. Tune to a radio station (see "Manual tuning" on page 37 above for details)

3. Press **MENU** on the remote control. "PROG" will appear on the display

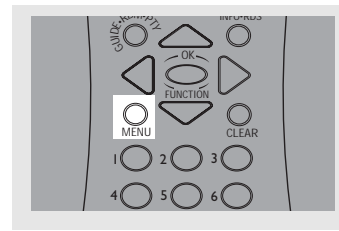

4. While the word "PROG" is still flashing, input your desired preset number (1-30) using the numeric keys on the remote control to store the radio station.

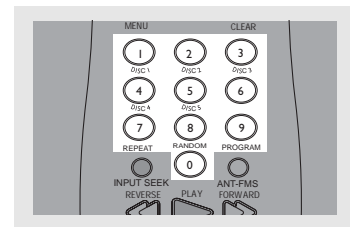

### Retrieving preset stations

1. Press **SOURCE** on the unit or **AM/FM** on the remote control to enter tuner mode
2. Press **PRESET +** or **PRESET -** on the unit or **CH+** or **CH -** on the remote control to tune up or down preset channels.

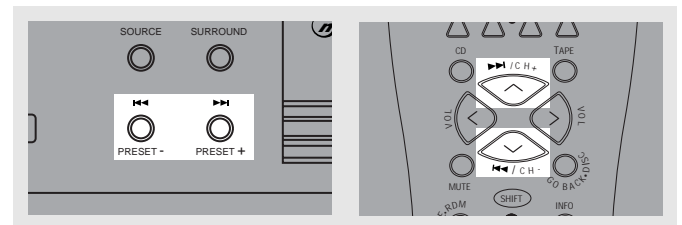

## Power

### No power ?

- Correctly connect the AC Power Cord to an AC Outlet.

### Power is switching off automatically ?

- If the player is not used, i.e. no key pressed for 30 minutes, it automatically switches to standby (Auto Power Off). Press the SOURCE key to switch the player on again.

### The keys do not activate the functions they control (unit and / or remote control).

- Set the STANDBY key to OFF (light on) and back to ON again. Alternatively, turn off the power, disconnect the power plug and then re-connect it (The player may not be operating properly due to lightning, static electricity or some other external factors).
- If keys still do not activate the functions they control even when the above mentioned corrective actions are taken, contact your RCA retailer.

## Video and audio

### There is no picture ?

- Turn on the TV set.
- Check connections.
- Make the correct input selection on the TV set.

### The picture is distorted or shakes during search, forward or reverse.

- Search, forward or reverse playback generates a slight distortion, but this is not a malfunction.

### There is no sound or it can hardly be heard ?

- Make sure the speakers are connected.
- Make sure the MUTE button is not on.
- Check connections.
- Make the correct audio input selection and volume adjustment on the TV set or hifi system (e.g. AV selector).
- There is no sound during a pause (still picture), still picture advance, or slow playback.
- Disc is defaulted to DTS.

### No "Surround" sound ?

- Check speaker configuration in the menu.

### Noise interference appears on the TV, while watching a TV program and the DVD player is left on ?

- Turn off DVD player.
- The TV is too close to the audio system.

### Volume level differences playing different disc types (DVDs, audio / video CDs).

- Adjust the master volume .

### No audio from one channel.

- Check the speaker level setting.
- Check the speaker wire or cable connections.

## Remote control

### The remote control does not work ?

- Load the batteries with their polarities (+ and -) aligned correctly.
- Batteries are low. Replace with new ones.
- Point the remote control to the front of the player.
- Operate the remote control within an 26 ft range from the player.
- Remove any obstacles between the remote control and the red LED on the player.

### The invalid icon appears on-screen ?

- When invalid icon appears on-screen, it indicates that you have pressed the wrong key, because :

1. The DVD's does not allow it.
2. The DVD's does not propose this option /e.g., angles.
3. The function is not available on that part of the disc. 
4. You have requested a title or chapter number or search time that is not available.

### TV or video recorder cannot be operated with the remote control.

- Not all models can be operated with the supplied universal remote control.

### No picture or the picture shown is not that of the DVD player.

- Switch off the other video device connected to the AV jack of the player.

## Playback

### Playback does not start when the PLAY key is pressed ?

- Make sure that the disc (single sided) is loaded correctly with the title label facing up.
- Make sure you are in the proper source mode.

### Playback stops immediately after the PLAY key is pressed ?

- This player can play DVDs, Video CDs and Audio and MP3 CDs only, check that your disc corresponds to one of these formats.
- If the disc is dirty, wipe it with a soft and clean cloth.
- Condensation occurred inside the player. Leave it at room temperature for 1 to 2 hours.

### Disc cannot be played.

- Wipe the disc clean.
- Use a RCA lens cleaner.
- The disc's region No. differs from your player's region No.

### Search forward & reverse playback does not work ?

- Some DVDs have segments where search forward & reverse playback functions do not work.

# Troubleshooting Tips

## Subtitle, language, camera angle etc.

Disc menu operation and contents may differ from disc to disc. Please refer to the instructions accompanying the disc.

### ***There are no subtitles ?***

- Check that the subtitle is recorded on the disc.
- Subtitles disappear from the TV screen. See page 21 to display subtitles.

### ***Subtitle (or language) setting cannot be changed ?***

- The disc being played has been recorded in only one language.
- Depending on the type of DVD, some segments limit language selection.

### ***The picture is not displayed in the correct format on the TV (4 x 3 or 16 x 9)***

- According to your TV, make the correct "TV Screen" setting in the set-up menu (page 29).

### ***The camera angle cannot be changed with the angle button ?***

- This function does not work when a DVD has not been recorded with a multi-camera angle system. Some DVDs use a multi-camera angle system only in certain portions of the DVD.

### ***The menu language is not the one you want ?***

- The menu language for your player has not been set during set-up.
- Your preferred menu language on a DVD disc (if available) has not been set during set up.

### ***Audio (spoken) and / or subtitle language is not the one selected during the initial player set-up ?***

- If the audio or subtitle language is not available on the DVD disc, the language selected during initial player set-up will not be heard or seen. The disc's priority language (default language) is selected automatically. If you want another language, press menu during playback, if the disc has its own language selection menu (Refer to page 21).

## Radio

### ***STEREO indicator is off.***

- Adjust the antenna.

### ***The signal is Mono. Severe hum or noise.***

- The signal is too weak. Connect an external antenna.

## Equipment Specifications RTDVD1:

### **AMPLIFIER SECTION:**

All 5 channels:  
RTDVD1: each 32W at 6 ohm. 010% THD @1 kHz  
Subwoofer channel: 40w at 6Ω  
Muting Attenuation: 65dB  
Frequency Response: 40Hz to 20kHz +/-3dB  
Signal to Noise Ratio: 65dB (Bypass mode)

### **VIDEO SECTION:**

Input ( Sensitivity/ Impedance ):1Vp-p/ 75ohm  
Output (Level/ Impedance): 1Vp-p/ 75 ohm  
Frequency Response: 10Hz to 6MHz at +/- 3dB  
Signal to noise ratio: 40dB  
Crosstalk @3.58MHz: 40dB

### **AM TUNER SECTION:**

Frequency Response: 80Hz – 2kHz +/-6dB  
Usable Sensitivity: 800uV/m @ S/N 20dB  
Signal to Noise: 38dB  
Image Ratio: 27dB @ 1000kHz  
IF Rejection: 35dB

### **FM TUNER SECTION:**

Frequency Response: 40Hz – 15kHz +/-3dB  
Quieting: 24dBu  
Signal to Noise: 60dB(stereo) / 65dB(mono)  
Image Ratio: 40dB  
IF Rejection: 50dB

Disconnect the audio system from the power source before performing any maintenance.

## Cleaning

Clean the exterior of the system using a soft dust cloth.

## The player

**CAUTION!** This system operates with a laser. It must be opened by only a qualified technician.

- Never move the player during playback.
- Never put more than one disc on a tray or put a disc slipping out of the guide area.

## Handling discs

- Do not touch the signal surfaces.
- Hold discs by the edges, or by one edge and the hole.
- Do not affix labels or adhesive tapes to the label surfaces.
- Do not scratch or damage the label. Discs rotate at high speeds inside the player.
- Do not use damaged (cracked or warped) discs.

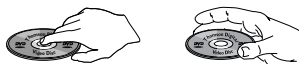

## Cleaning discs

- Dirty discs can cause poor sound and visual quality. Always keep discs clean by wiping them gently with a soft cloth from the inner edge toward the outer perimeter. Never wipe the disc in a circular motion since circular scratches are likely to occur and could cause noise during playback.
- If a disc becomes dirty, wet a soft cloth in water, wring it out well, wipe the dirt away gently, and then remove any water drops with a dry cloth.
- Do not use record cleaning sprays or antistatic agents on discs. Also, never clean discs with benzene, thinner, or other volatile solvents which may cause damage to disc surface



## Disc lens care

- When your disc lens gets dirty it can also cause the system to output poor sound and visual quality. To clean the lens you will need to purchase a disc lens cleaner which can maintain the output sound and visual quality of your system. For instructions on cleaning the disc lens, refer to the ones accompanying the lens cleaner.

## Important battery information

- Remove the batteries to avoid leakage if you do not use your remote control for more than one month.
- Discard leaky batteries immediately as leaking batteries may cause skin burns or other personal injuries.
- Dispose of batteries in the proper manner, according to provincial and local regulations.
- Any battery may leak electrolyte if mixed with a different battery type, if inserted incorrectly, if all batteries are not replaced at the same time, if disposed of in fire, or if an attempt is made to charge a battery not intended to be recharged.

## Safety precautions

- Never open the cabinet under any circumstances. Any repairs or internal adjustments should be made only by a trained technician.
- Never operate this product with the cabinet removed.
- Do not touch the player with wet hands. If any liquid enters the player cabinet, take the player to a trained technician for inspection.
- This player uses a laser to read the data on the disc. The laser mechanism corresponds to the cartridge and stylus of a record player. Although this product incorporates a laser pick-up lens, it is completely safe when operated according to directions.
- Discs rotate at high speed inside the player. Do not use damaged, warped, or cracked discs.
- Do not touch the pick-up lens which is located inside the disc compartment. Also, to keep dust from collecting on the pick-up lens do not leave the compartment door open for an extended period of time. If the lens becomes dirty, clean it with a soft brush, or use an air blower brush designed for camera lenses.

## Headset safety

- Do not play your headset at a high volume. Hearing experts warn against extended high-volume play.
- If you experience a ringing in your ears, reduce volume or discontinue use.
- You should use extreme caution or temporarily discontinue use in potentially hazardous situations.
- Even if your headset is an open-air type designed to let you hear outside sounds, don't turn up the volume so high that you are unable to hear what is around you.

## Don't infringe

This product should only be used for the purposes for which it is sold, that is, entertainment, violating no copyright law. Any attempts to use this product for which it is not intended is unlawful and therefore not condoned by Thomson multimedia Inc.

The descriptions and characteristics given in this document are given as a general indication and not as a guarantee. In order to provide the highest quality product possible, we reserve the right to make any improvement or modification without prior notice. The English version serves as the final reference on all products and operational details should any discrepancies arise in other languages.

# Remote Codes

## CABLE CODES

ABC	5002, 5003, 5004, 5005, 5006, 5009, 5053
ANTRONIX	5008, 5009
ARCHER	5008, 5009, 5010, 5011
CABLETENNA	5008
CABLEVIEW	5008
CENTURY	5011
CITIZEN	5011
COLOUR VOICE	5012, 5013
COMTRONICS	5014, 5015
CONTEC	5016
EASTERN	5017
GARRARD	5011
GC ELECTRONICS	5009
GEMINI	5018, 5019, 5049
GENERAL INSTRUMENT	5003
HAMLIN	5020, 5021, 5022, 5035, 5045
HITACHI	5003
HYTEX	5002
JASCO	5011
JERROLD	5003, 5005, 5007, 5018, 5023, 5024, 5046, 5053
MAGNAVOX	5025
MEMOREX	5026
MOVIE TIME	5002, 5027, 5028
NSC	5002, 5027, 5028
OAK	5002, 5016, 5029
PANASONIC	5048, 5052
PARAGON	5026
PHILIPS	5011, 5012, 5013, 5019, 5025, 5030, 5031, 5032
PIONEER	5033, 5034
PULSAR	5026
RCA	5047, 5049, 5052
REALISTIC	5009, 5049
REGAL	5022, 5035
REGENCY	5017
REMBRANDT	5003
RUNCO	5026
SAMSUNG	5014, 5034
SCIENTIFIC ATLANTA	5006, 5036, 5037, 5038
SIGNAL	5014, 5018
SIGNATURE	5003
SL MARX	5014
SPRUCER	5052
STARCOM	5007, 5018, 5053
STARGATE	5014, 5018
STARQUEST	5018
TANDY	5040
TELEVIEW	5014
TOCOM	5004, 5023, 5041
TOSHIBA	5026
TUSA	5018
TV86	5027
UNIKA	5008, 5009, 5011
UNITED ARTISTS	5002
UNITED CABLE	5053
UNIVERSAL	5008, 5009, 5010, 5011
VIDEOWAY	5044
VIEWSTAR	5015, 5025, 5027, 5040
ZENITH	5026, 5050, 5051

## VCR CODES

ADMIRAL	2131
ADVENTURA	2026
AIKO	2027
AIWA	2002, 2026
AKAI	2003, 2004, 2005, 2007, 2008, 2111, 2112, 2113
AMERICAN HIGH	2021
ASHA	2013
AUDIO DYNAMICS	2009, 2010
AUDIOVOX	2014
BELL & HOWELL	2011
BEAUMARK	2013
BROKSONIC	2012, 2025
CALIX	2014
CANDLE	2013, 2014, 2015, 2016, 2017, 2018, 2019
CANON	2021, 2022, 2114
CAPEHART	2020, 2110
CARVER	2062
CCE	2027, 2061
CITIZEN	2013, 2014, 2015, 2016, 2017, 2018, 2019, 2027
COLORTYME	2009
COLT	2061
CRAIG	2013, 2014, 2023, 2061
CURTIS-MATHES	2000, 2002, 2009, 2013, 2016, 2018, 2021, 2022, 2024, 2115
CYBERNEX	2013
DAEWOO	2015, 2017, 2019, 2025, 2026, 2027, 2028, 2110
DAYTRON	2110
DBX	2009, 2010
DIMENSIA	2000
DYNATECH	2002, 2026
ELECTROHOME	2014, 2029
ELECTROPHONIC	2014
EMERSON	2002, 2012, 2014, 2015, 2021, 2024, 2025, 2026, 2029, 2030, 2032, 2033, 2034, 2035, 2036, 2037, 2038, 2039, 2040, 2041, 2042, 2044, 2045, 2047, 2065, 2105, 2113, 2116, 2117, 2130
FISHER	2011, 2023, 2048, 2049, 2050, 2051, 2052, 2118
FUJI	2021, 2119
FUNAI	2002, 2026
GARRARD	2026
GE	2000, 2001, 2013, 2021, 2022, 2053, 2115, 2120
GOLDSTAR	2009, 2014, 2018, 2054, 2121
GRADIENTE	2026
HARLEY DAVIDSON	2026
HARMAN KARDON	2009
HARWOOD	2061
HEADQUARTER	2011
HITACHI	2002, 2055, 2056, 2057, 2107, 2111, 2120, 2122
HI-Q	2023
INSTANT REPLAY	2021
JCI	2021
JC PENNEY	2009, 2010, 2011, 2013, 2014, 2021, 2022, 2055, 2056, 2058, 2059, 2060, 2107, 2118
JENSEN	2055, 2056, 2111
JVC	2009, 2010, 2011, 2018, 2058, 2111, 2123
KENWOOD	2009, 2010, 2011, 2016, 2018, 2058, 2111, 2123
KLH	2061
KODAK	2014, 2021
LLOYD	2002, 2026
LOGIK	2061
LXI	2014
MAGNAVOX	2021, 2022, 2062, 2063, 2104, 2108, 2124
MAGNIN	2013
MARANTZ	2009, 2010, 2011, 2016, 2018, 2021, 2058, 2062, 2064
MARTA	2014
MASUSHITA	2021
MEI	2021

MEMOREX	2002, 2011, 2013, 2014, 2021, 2023, 2026, 2104, 2131
MGA	2029, 2065, 2113
MGN TECHNOLOGY	2013
MIDLAND	2053
MINOLTA	2055, 2056, 2107
mitsubishi	2029, 2055, 2056, 2065, 2066, 2067, 2069, 2070, 2071, 2072, 2073, 2074, 2106, 2113, 2123
MONTGOMERY WARD	2075, 2131
MOTOROLA	2021, 2131
MTC	2002, 2013, 2026
MULTITECH	2002, 2013, 2016, 2026, 2053, 2061
NEC	2009, 2010, 2011, 2016, 2018, 2058, 2064, 2076, 2078, 2079, 2111, 2123
NIKKO	2014
NOBLEX	2013
OLYMPUS	2021
OPTIMUS	2014, 2131
OPTONICA	2096
ORION	2035
PANASONIC	2021, 2022, 2109, 2125, 2126, 2127
PENTAX	2016, 2055, 2056, 2107, 2120
PENTEX RESEARCH	2018
PHILCO	2021, 2022, 2062, 2063
PHILIPS	2021, 2062, 2096, 2124
PILOT	2014
PIONEER	2010, 2055, 2080, 2081, 2123
PORTLAND	2016, 2017, 2019, 2110
PROSCAN	2000, 2001
PROTEC	2061
PULSAR	2104
QUARTER	2011
QUARTZ	2011
QUASAR	2021, 2022, 2125
RCA	2000, 2001, 2003, 2013, 2021, 2055, 2056, 2082, 2083, 2084, 2085, 2086, 2087, 2088, 2089, 2090, 2091, 2107, 2115, 2120, 2125
RADIOSHACK/REALISTIC	2002, 2011, 2013, 2014, 2021, 2022, 2023, 2026, 2029, 2049, 2050, 2096, 2131
RADIX	2014
RANDEX	2014
RICOH	2128
RUNCO	2104
SAMSUNG	2005, 2013, 2015, 2033, 2053, 2112
SANKY	2104, 2131
SANSUI	2010, 2092, 2111, 2123
SANYO	2011, 2013, 2023
SCOTT	2012, 2015, 2025, 2032, 2035, 2038, 2065, 2093, 2116
SEARS	2011, 2014, 2021, 2023, 2048, 2049, 2050, 2051, 2055, 2056, 2107, 2118
SHARP	2002, 2017, 2029, 2094, 2095, 2096, 2131
SHINTOM	2004, 2056, 2061, 2098
SHOGUN	2013
SIGNATURE	2002, 2131
SINGER	2021, 2061, 2128
SONY	2002, 2004, 2098, 2099, 2119, 2128
STS	2021, 2107
SYLVANIA	2002, 2021, 2022, 2026, 2062, 2063, 2065, 2124
SYMPHONIC	2002, 2026
TANDY	2002, 2011
TASHIKO	2014
TATUNG	2058, 2111
TEAC	2002, 2026, 2058, 2085, 2111
TECHNICS	2021, 2109
TEKNIKA	2002, 2014, 2021, 2026, 2100, 2129
TMK	2013, 2024, 2047
TOSHIBA	2015, 2049, 2051, 2055, 2065, 2093, 2116
TOTEVISION	2013, 2014
UNITECH	2013
VECTOR RESEARCH	2009, 2010, 2015, 2016
VICTOR	2010
VIDEO CONCEPTS	2009, 2010, 2015, 2016, 2113
VIDEOSONIC	2013
WARDS	2002, 2013, 2014, 2015, 2021, 2023, 2026, 2029, 2055, 2056, 2061, 2096, 2101, 2102, 2103, 2107, 2116, 2131
XR-1000	2021, 2026, 2061
YAMAHA	2009, 2010, 2011, 2018, 2058, 2111
ZENITH	2004, 2098, 2104, 2119, 2128

## TV CODES

ABEX	1172
ADMIRAL	1001, 1173
ADVENTURA	1174
AIKO	1016
AKAI	1002
ALLERON	1046
AMTRON	1038
ANAM NATIONAL	1003, 1038
AOC	1004, 1005, 1006, 1007, 1175, 1176
AUDIOVOX	1038
BELCOR	1004
BELL & HOWELL	1001, 1083, 1162
BRADFORD	1038
BROKWOOD	1004
CANDLE	1004, 1006, 1008, 1174
CAPEHART	1175
CELEBRITY	1002
CENTURION	1009
CITIZEN	1004, 1006, 1008, 1016, 1038, 1105, 1171, 1174, 1177
CLAIRTONE	1176
COLORTYME	1004, 1006
CONCERTO	1004, 1006
CONTEC/CONY	1012, 1013, 1014, 1038, 1176
CRAIG	1038
CROWN	1038, 1171
CURTIS MATHES	1000, 1004, 1006, 1015, 1105, 1162, 1171
CXC	1038
DAEWOO	1004, 1005, 1006, 1016, 1017, 1018, 1127, 1171
DAYTRON	1004, 1006, 1171
DIMENSIA	1000
DUMONT	1004, 1151
DYNATECH	1178
ELECTROBAND	1002, 1176
ELECTROHOME	1003, 1004, 1006, 1019, 1022
EMERSON	1004, 1006, 1012, 1014, 1023, 1024, 1025, 1026, 1027, 1028, 1029, 1030, 1031, 1032, 1033, 1034, 1035, 1036, 1037, 1038, 1039, 1041, 1042, 1043, 1044, 1046, 1047, 1123, 1124, 1162, 1171, 1176, 1177, 1179, 1191
ENVISION	1004, 1006
FISHER	1048, 1049, 1050, 1051, 1162, 1180
FUJITSO	1046
FUNAI	1038, 1046
FUTURETEC	1038
GE	1000, 1003, 1004, 1006, 1022, 1052, 1054, 1055, 1087, 1164, 1165, 1166, 1167, 1168, 1181
GIBRALTER	1004, 1151
GOLDSTAR	1004, 1005, 1006, 1012, 1019, 1056, 1057, 1058, 1155, 1156, 1171, 1172
GRUNDY	1038, 1046, 1171
HALLMARK	1004, 1006
HARVARD	1038
HITACHI	1004, 1006, 1012, 1013, 1059, 1060, 1061, 1135, 1136, 1137, 1138, 1139, 1140, 1141, 1142, 1143, 1144, 1145, 1146, 1148, 1150, 1179
IMA	1038
INFINITY	1062
JANEIL	1174
JBL	1062
JCB	1002
JC PENNY	1000, 1004, 1005, 1006, 1008, 1022, 1052, 1054, 1058, 1063, 1064, 1072, 1087, 1105, 1128, 1171, 1172, 1181
JENSEN	1004, 1006
JVC	1012, 1013, 1054, 1060, 1065, 1066, 1067, 1089, 1157, 1158, 1159, 1182



# Remote Codes

KAWASHO	2002, 1004, 1006
KAYPANI	1175
KENWOOD	1004, 1006, 1019
KLOSS NOVABEAM	1068, 1069, 1174, 1183
KTV	1038, 1070, 1171, 1176, 1177
LOEWE	1062
LOGIK	1083
LUXMAN	1004, 1006
LXI	1000, 1006, 1049, 1062, 1071, 1072, 1073, 1162, 1181
MAGNAVOX	1004, 1006, 1008, 1019, 1062, 1068, 1069, 1074, 1075, 1076, 1077, 1088, 1089, 1130, 1131, 1132, 1133, 1134, 1183, 1184
MAJESTIC	1083
MARANTS	1062
MARANTZ	1004, 1006, 1062, 1078
MEGATRON	1006, 1059
MEI	1176
MEMOREX	1001, 1006, 1082, 1083, 1162
MGA	1004, 1005, 1006, 1019, 1022, 1051, 1079, 1080, 1082
MIDLAND	1054, 1151, 1171, 1172, 1181
MINUTZ	1052
MITSUBISHI	1004, 1005, 1006, 1019, 1022, 1051, 1079, 1080, 1081, 1082, 1082, 1083, 1125
MONTGOMERY WARD	1083
MOTOROLA	1003, 1173
MTC	1004, 1005, 1006, 1105, 1176, 1178
MULTITECH	1038, 1178
MULTIVISION	1084
NAD	1006, 1071, 1072, 1185
NEC	1003, 1004, 1005, 1006, 1089
NIKKO	1006, 1016
NTC	1016
ONWA	1038
OPTIMUS	1185
OPTONICA	1095, 1173
ORION	1035, 1191
PANASONIC	1003, 1054, 1062, 1170
PHILCO	1003, 1004, 1005, 1006, 1008, 1012, 1019, 1062, 1068, 1069, 1074, 1075, 1077, 1183, 1184
PHILIPS	1003, 1004, 1008, 1012, 1019, 1062, 1068, 1069, 1074, 1075, 1076, 1086, 1087, 1088, 1089
PILOT	1004, 1171
PIONEER	1004, 1006, 1090, 1091, 1092, 1179, 1185
PORTLAND	1004, 1005, 1006, 1016, 1171
PRICE CLUB	1105
PRISM	1054
PROSCAN	1000, 1181
PROTON	1004, 1006, 1012, 1093, 1175
PULSAR	1151
PULSER	1004
QUASAR	1003, 1054, 1070, 1094
RADIO SHACK/REALISTIC	1000, 1004, 1006, 1012, 1038, 1049, 1095, 1162, 1171, 1172
RCA	1000, 1003, 1004, 1005, 1006, 1007, 1019, 1096, 1098, 1099, 1100, 1101, 1102, 1103, 1129, 1179, 1181, 1187, 1188, 1190
RHAPSODY	1176
RUNCO	1151
SAMPO	1004, 1006, 1171, 1172, 1175
SAMSUNG	1004, 1005, 1006, 1012, 1015, 1019, 1104, 1105, 1106, 1171, 1172
SAMSUX	1171
SANSUI	1191
SANYO	1004, 1048, 1049, 1050, 1080, 1107, 1108, 1162, 1169, 1180, 1189
SCOTCH	1006
SCOTT	1004, 1006, 1012, 1024, 1035, 1038, 1046
SEARS	1000, 1004, 1006, 1013, 1019, 1046, 1048, 1049, 1050, 1051, 1066, 1071, 1072, 1109, 1110, 1162, 1180, 1181, 1189
SHARP	1004, 1006, 1012, 1029, 1095, 1111, 1112, 1113, 1122, 1171, 1173
SHOGUN	1004
SIGNATURE	1001, 1083, 1115

SIMPSON	1008
SONIC	1176
SONY	1002
SOUNDESIGN	1004, 1006, 1008, 1038, 1046
SQUAREVIEW	1189
SSS	1004, 1038
STARLITE	1038
SUPRE-MACY	1174
SUPREME	1002
SYLVANIA	1004, 1006, 1008, 1019, 1062, 1068, 1069, 1074, 1075, 1076, 1077, 1088, 1116, 1161, 1183, 1184
SYMPHONIC	1033, 1038, 1189
TANDY	1173
TATUNG	1003, 1178
TECHNICS	1054
TECHWOOD	1004, 1006, 1054
TEKNIKA	1004, 1005, 1006, 1008, 1012, 1013, 1016, 1038, 1046, 1076, 1082, 1083, 1105, 1170, 1171
TELECAPTION	1117
TMK	1004, 1006
TOSHIBA	1049, 1071, 1072, 1089, 1105, 1109, 1117, 1118, 1160, 1162
TOTEVISION	1171
UNIVERSAL	1052, 1087
VICTOR	1066, 1182
VIDTECH	1004, 1005, 1006
VIKING	1174
WARDS	1000, 1001, 1004, 1005, 1006, 1019, 1024, 1033, 1046, 1052, 1062, 1069, 1074, 1075, 1076, 1083, 1087, 1088, 1095, 1119, 1120, 1184
YAMAHA	1004, 1005, 1006, 1019
ZENITH	1004, 1083, 1151, 1152, 1153, 1154

## Satellite Receivers

CHAPPARAL	5056, 5057
DRAKE	5058, 5059
GE SATELLITE RECEIVER	5000, 5001
GENERAL INSTRUMENTS	5060, 5061, 5062
PANASONIC SATELLITE RECEIVER	
5075	
PRIMESTAR DBS	5076
PROSCAN SATELLITE RECEIVER	
5000, 5001	
RCA SATELLITE RECEIVER	5000, 5001
REALISTIC	5063
SONY SATELLITE RECEIVER	5072
STS1	5064
STS2	5065
STS3	5066
STS4	5067
TOSHIBA	5068
TOSHIBA SATELLITE RECEIVER	5073
UNIDEN SATELLITE RECEIVER	5069

## Audio (RCA/Dimensia only)

AM/FM	4003
AUX	4004
PHONO	4005
CD	4007
TAPE	4006

## Laser disc Players

PROSCAN	2001
RCA	2001

For audio track and subtitle selection, see p.25,26.

Abkhazian	6566	Kashmiri	7583	Tatar	8484
Afar	6566	Kazakh	7575	Telugu	8469
Afrikaans	6570	Kanyarwanda	8287	Thai	8472
Albanian	8381	Kirghiz	7589	Tibetan	6679
Amehanie	6577	Kirundi	8278	Tigrinya	8473
Arabic	6582	Korean	7579	Tonga	8479
Armenian	7289	Kurdish	7585	Tsonga	8483
Assamese	6583	Laothian	7679	Turkish	8482
Aymara	6588	Latin	7665	Turkmen	8475
Azerbaijani	6590	Latvian, Leltish	7684	Twi	8487
Bashkir	6665	Lingala	7678	Ukrainian	8575
Basque	6985	Lithuanian	7684	Urdu	8582
Bengali, Bangla	6678	Macedonian	7775	Uzbek	8590
Bhutani	6890	Malagasy	7771	Vietnamese	8673
Bihari	6672	Malay	7783	Volapuk	8679
Bislama	6673	Malayalam	7776	Welsh	6789
Breton	6682	Maltese	7784	Wolaf	8779
Bulgarian	6671	Maori	7773	Xhosa	8872
Burmese	7789	Marathi	7782	Yiddish	7473
Byelorussian	6669	Moldavian	7779	Yoruba	8979
Cambodian	7577	Mongolian	7778	Zulu	9085
Catalan	6765	Naru	7865		
Chinese	9072	Nepali	7869		
Corsican	6779	Norwegian	7879		
Croatian	7282	Occitan	7967		
Czech	6783	Oriya	7982		
Danish	6865	Oroma (Atan)	7977		
Dutch	7876	Punjabi	8065		
English	6978	Pashto, Pushao	8083		
Esperanto	6979	Persian	7065		
Estonian	6984	Polish	8075		
Faeroese	7079	Portuguese	8084		
Fiji	7074	Quechua	8185		
Finnish	7073	Ahaero- Romance	8277		
French	7082	Romanian	8279		
Frisian	7089	Russian	8285		
Galiean	7176	Samoan	8377		
Georgian	7565	Sangbo	8371		
German	6869	Sanskrit	8365		
Greek	6976	Sents Gaelic	7168		
Greenland	7576	Serbian	8382		
Guarani	7178	Servo-Croatian	8372		
Gujarati	7185	Sesotho	8384		
Hausa	7265	Setswana	8478		
Hebrew	7387	Sindhi	8368		
Hindi	7273	Singhalese	8373		
Hungarian	7285	Siswati	8383		
Icelandic	7383	Slovak	8375		
Indonesian	7378	Slovenian	8376		
Interlingua	7365	Somali	8379		
Interlingue	7369	Spanish	6983		
Inupiaic	7375	Sudanese	8385		
Irish	7165	Swahili	8387		
Italian	7384	Swedish	8386		
Japanese	7465	Tagalog	8476		
Javanese	7487	Tajik	8471		
Kannada	7578	Tamil	8465		

# Limited Warranty (US)

## What your warranty covers:

- Defects in materials or workmanship.

## For how long after your purchase:

- One year from date of purchase for labor and parts
- The warranty period for rental units begins with the first rental or 45 days from date of shipment to the rental firm, whichever comes first.

## What we will do:

- Pay any Authorized RCA Audio Service Center the labor charges to repair your unit.
- Pay any Authorized RCA Audio Service Center for the new or, at our option, refurbished replacement parts required to repair your unit.

## How you get service:

- Take your unit to any Authorized RCA Audio Service Center. To identify your nearest Authorized RCA Audio Service Center, ask your dealer, look in the Yellow Pages, or call 1-800-336-1900.
- Show the Authorized Service Center Representative your evidence of purchase date or first rental.
- Pick up your unit when repairs are completed.
- Proof of purchase in the form of a bill of sale or receipted invoice which is evidence that the product is within the warranty period must be presented to obtain warranty service. For rental firms, proof of first rental is also required.

## What your warranty does not cover:

- Customer instruction. (Your Owner's Manual describes how to install, adjust, and operate your unit. Any additional information should be obtained from your dealer.)
- Installation and related adjustments.
- Signal reception problems not caused by your unit.
- Damage from misuse or neglect.
- Cleaning of audio heads.
- Batteries.
- A unit that has been modified or incorporated into other products or is used for institutional or other commercial purposes.
- A unit purchased or serviced outside the U.S.A.
- Acts of nature, such as but not limited to lightning damage.

## Product Registration:

- Please complete and mail the Product Registration Card packed with your product. It will make it easier to contact you should it ever be necessary. The return of the card is not required for warranty coverage.

## Limitation of Warranty:

- **THE WARRANTY STATED ABOVE IS THE ONLY WARRANTY APPLICABLE TO THIS PRODUCT. ALL OTHER WARRANTIES, EXPRESS OR IMPLIED (INCLUDING ALL IMPLIED WARRANTIES OF MERCHANTABILITY OR FITNESS FOR A PARTICULAR PURPOSE) ARE HEREBY DISCLAIMED. NO VERBAL OR WRITTEN INFORMATION GIVEN BY THOMSON MULTIMEDIA INC., ITS AGENTS OR EMPLOYEES SHALL CREATE A WARRANTY OR IN ANY WAY INCREASE THE SCOPE OF THIS WARRANTY.**
- **REPAIR OR REPLACEMENT AS PROVIDED UNDER THIS WARRANTY IS THE EXCLUSIVE REMEDY OF THE CONSUMER. THOMSON MULTIMEDIA INC. SHALL NOT BE LIABLE FOR INCIDENTAL OR CONSEQUENTIAL DAMAGES RESULTING FROM THE USE OF THIS PRODUCT OR ARISING OUT OF ANY BREACH OF ANY EXPRESS OR IMPLIED WARRANTY ON THIS PRODUCT. THIS DISCLAIMER OF WARRANTIES AND LIMITED WARRANTY ARE GOVERNED BY THE LAWS OF THE STATE OF INDIANA. EXCEPT TO THE EXTENT PROHIBITED BY APPLICABLE LAW, ANY IMPLIED WARRANTY OF MERCHANTABILITY OR FITNESS FOR A PARTICULAR PURPOSE ON THIS PRODUCT IS LIMITED TO THE APPLICABLE WARRANTY PERIOD SET FORTH ABOVE.**

## How State Law relates to warranty:

- Some states do not allow the exclusion nor limitation of incidental or consequential damages, or limitations on how long an implied warranty lasts, so the above limitations or exclusions may not apply to you.
- This warranty gives you specific legal rights, and you also may have other rights that vary from state to state.

## If you purchased your unit outside the United States:

- This warranty does not apply. Contact your dealer for warranty information.

**Service calls which do not involve defective materials or workmanship are not covered by this warranty. Costs of such service calls are the sole responsibility of the purchaser.**

**What your warranty covers:**

- Defects in materials or workmanship.

**For how long after your purchase:**

- One year from date of purchase for labor and parts
- The warranty period for rental units begins with the first rental or 45 days from date of shipment to the rental firm, whichever comes first.

**What we will do:**

- Pay any Authorized RCA Audio Service Center the labor charges to repair your unit.
- Pay any Authorized RCA Audio Service Center for the new or, at our option, refurbished replacement parts required to repair your unit.

**How you get service:**

- Take your unit to any Authorized RCA Audio Service Center. To identify your nearest Authorized RCA Audio Service Center, ask your dealer, look in the Yellow Pages, or call 1-800-336-1900.
- Show the Authorized Service Center Representative your evidence of purchase date or first rental.
- Pick up your unit when repairs are completed.
- Proof of purchase in the form of a bill of sale or receipted invoice which is evidence that the product is within the warranty period must be presented to obtain warranty service. For rental firms, proof of first rental is also required.

**What your warranty does not cover:**

- Customer instruction. (Your Owner's Manual describes how to install, adjust, and operate your unit. Any additional information should be obtained from your dealer.)
- Installation and related adjustments.
- Signal reception problems not caused by your unit.
- Damage from misuse or neglect.
- Cleaning of audio heads.
- Batteries.
- A unit that has been modified or incorporated into other products or is used for institutional or other commercial purposes.
- A unit purchased or serviced outside Canada.
- Acts of nature, such as but not limited to lightning damage.

**Product Registration:**

- Please complete and mail the Product Registration Card packed with your product. It will make it easier to contact you should it ever be necessary. The return of the card is not required for warranty coverage.

**Limitation of Warranty:**

- **THE WARRANTY STATED ABOVE IS THE ONLY WARRANTY APPLICABLE TO THIS PRODUCT. NO VERBAL OR WRITTEN INFORMATION GIVEN BY THOMSON MULTIMEDIA LTD., ITS AGENTS OR EMPLOYEES SHALL CREATE A WARRANTY OR IN ANY WAY INCREASE THE SCOPE OF THIS WARRANTY.**
- **REPAIR OR REPLACEMENT AS PROVIDED UNDER THIS WARRANTY IS THE EXCLUSIVE REMEDY OF THE CONSUMER. THOMSON MULTIMEDIA LTD. SHALL NOT BE LIABLE FOR INCIDENTAL OR CONSEQUENTIAL DAMAGES RESULTING FROM THE USE OF THIS PRODUCT. EXCEPT TO THE EXTENT PROHIBITED BY APPLICABLE PROVINCIAL LAW, ANY IMPLIED WARRANTY OF MERCHANTABILITY OR FITNESS FOR A PARTICULAR PURPOSE ON THIS PRODUCT IS LIMITED TO THE APPLICABLE WARRANTY PERIOD SET FORTH ABOVE.**

**How Provincial Laws relates to warranty:**

- This warranty gives you specific legal rights which are in addition to statutory warranties that may vary from Province to Province.

**If you purchased your unit outside Canada:**

- This warranty does not apply. Contact your dealer for warranty information.

**Service calls which do not involve defective materials or workmanship are not covered by this warranty. Costs of such service calls are the sole responsibility of the purchaser.**

## Free Manuals Download Website

<http://myh66.com>

<http://usermanuals.us>

<http://www.somanuals.com>

<http://www.4manuals.cc>

<http://www.manual-lib.com>

<http://www.404manual.com>

<http://www.luxmanual.com>

<http://aubethermostatmanual.com>

Golf course search by state

<http://golfingnear.com>

Email search by domain

<http://emailbydomain.com>

Auto manuals search

<http://auto.somanuals.com>

TV manuals search

<http://tv.somanuals.com>