

Revolabs FLX USB Audio Connector Kit



01-USBAUD35-KIT

To connect the Revolabs FLX to your computer use the Revolabs FLX USB Audio Connector Kit (01-USBAUD35-KIT).

Plug the Stereo side of the cables into the USB audio dongle, and the mono side into the FLX Base Station. Ensure that the Headset output of the Dongle is connected to the IN port of the FLX Base Station, and the Microphone input of the dongle to the OUT port of the FLX Base Station.

Once you connect the dongle to your computer, the operating system should automatically detect the dongle as an audio device, and load the required drivers. No software should need to be installed on the computer.

On the FLX Dialer go to Menu—Setup—Advanced Setup—Advanced Audio—Aux Audio and ensure that Aux Out is set to LINE. Both Aux In and Aux Out have to be set to ON in this menu for the audio to work.

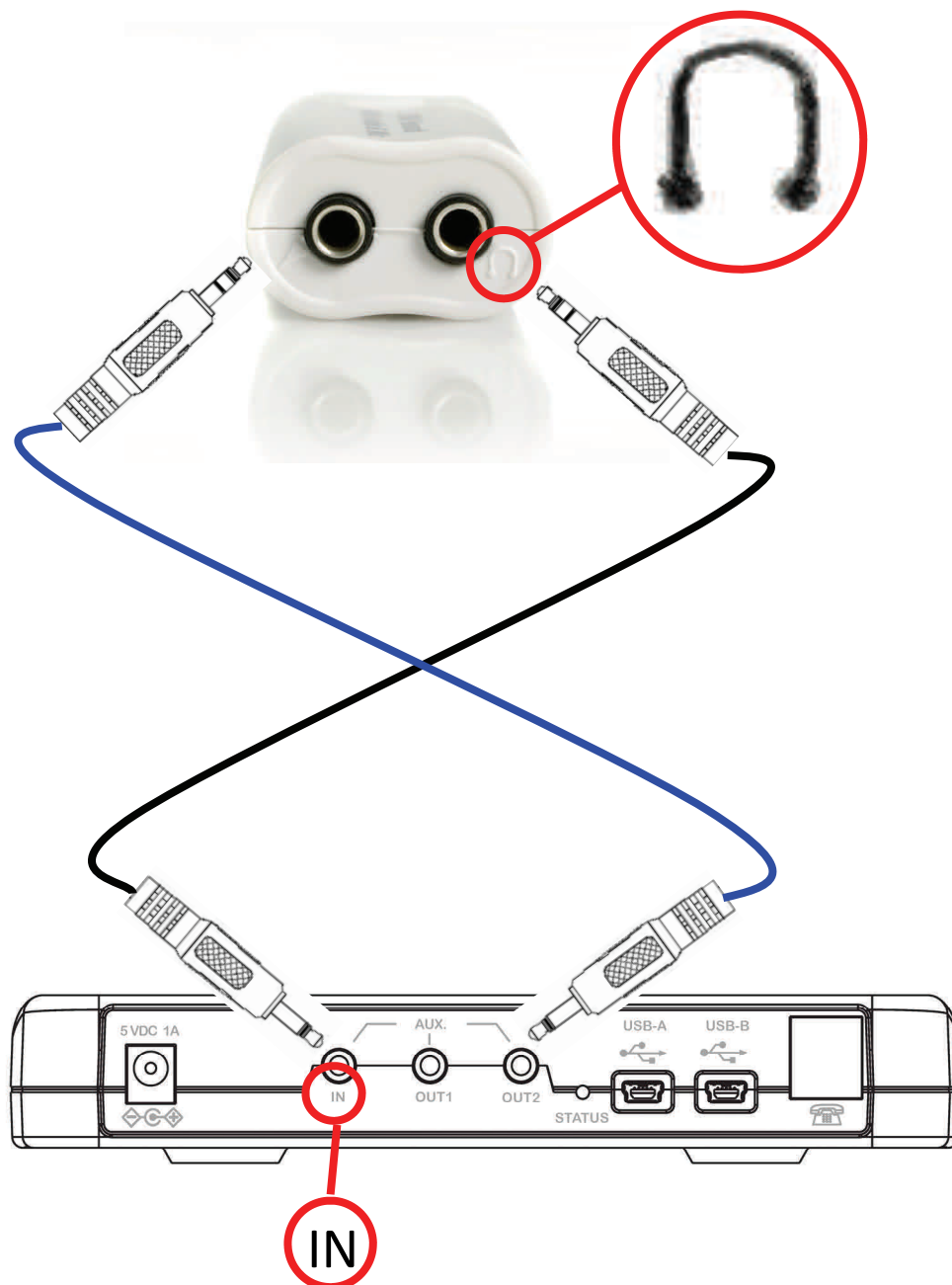

Free Manuals Download Website

<http://myh66.com>

<http://usermanuals.us>

<http://www.somanuals.com>

<http://www.4manuals.cc>

<http://www.manual-lib.com>

<http://www.404manual.com>

<http://www.luxmanual.com>

<http://aubethermostatmanual.com>

Golf course search by state

<http://golfingnear.com>

Email search by domain

<http://emailbydomain.com>

Auto manuals search

<http://auto.somanuals.com>

TV manuals search

<http://tv.somanuals.com>