

# Rowenta

LOVELY

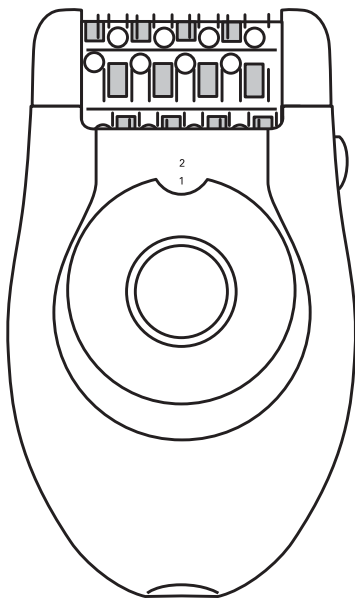

Gebrauchsanweisung  
Instruction for use  
Notice d'emploi  
Istruzioni per l'uso  
Modo de empleo  
Modo de utilização

Инструкция по использованию  
Kullanma talimatı

087839/50-04

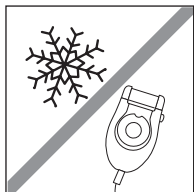
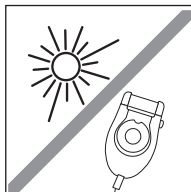
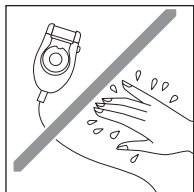
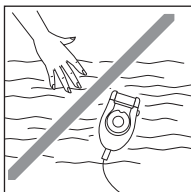
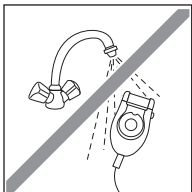
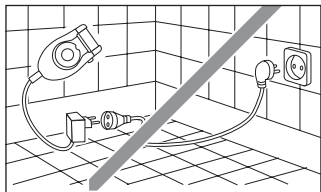
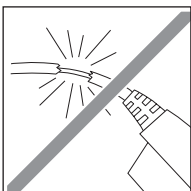
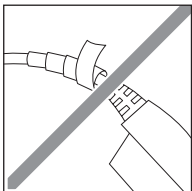
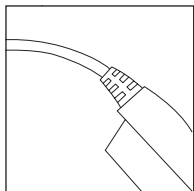
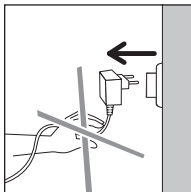
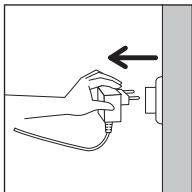

## 1- DESCRIPTION OF YOUR APPLIANCE

- 1- Cap (EP4630)
- 2- Depilator head
- 3- Massaging beads
- 4- Tweezers
- 5- Release button for removable head
- 6- 2-speed and stop switch
- 7- Adaptor
- 8- Cleaning brush
- 9- Exfoliator head (EP4630)
- 10- 2 exfoliating bands
- 11- Sensitive Area accessory (EP4630)

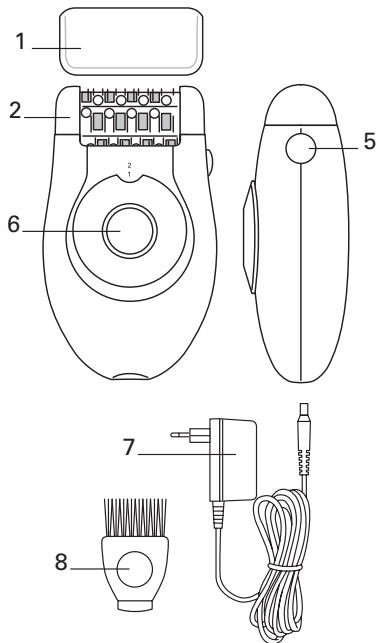
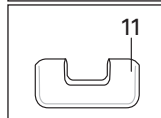
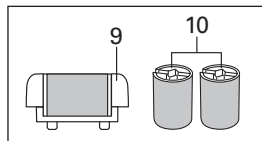
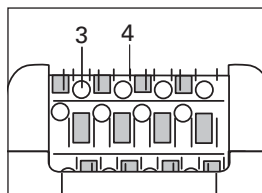

### Pain-free function:

Your appliance is equipped with a roller beads massaging system integrated into the depilation head. The roller beads massage the skin to reduce the sensation of pain linked to depilation.

## 2 - SAFETY



Voltage : Ensure that this voltage corresponds to that of your mains supply. Incorrect connection may cause irreparable damage which is not covered by the guarantee.

This appliance is intended for personal domestic use only.

It must only be used with the enclosed adaptor EM2A2.

Never use if the appliance (depilator or adaptor) is damaged or in the event of any damage caused by dropping the appliance (invisible damage may be dangerous).

This appliance can only be repaired using special tools. In the event of any after sales problem (depilator, adaptor), please consult an approved service agent (see enclosed leaflet).

We decline any responsibility for damage arising from incorrect use of the appliance or use of the appliance in any way other than that specified in these instructions.

When the depilator is in use, it must not come into contact with eye-lashes, hair, clothes or any other objects, in order to avoid any danger of injury or blockage.

Keep a careful eye on the appliance if used on, or in the presence of children or invalids.

Do not use the depilator:

- on your face
- on broken, burnt or sore skin
- on sensitive areas (varicose veins, moles, birthmarks, warts...)
- if you suffer from skin complaints, (eczema, inflammations, acne...)For hygiene reasons, it is advised that you do not allow anyone else to use your appliance.

When in use, the wall socket must be readily accessible.

Remove adapter from the wall outlet to disconnect from the supply.

For use indoor only.

## 3- PREPARATION OF THE SKIN

Your skin must be clean and dry.

- Do not apply either cream or hydrating milk before depilation.
- If you previously used a razor for depilation:
  - the first few times you use the depilator, your skin may feel more sensitive, as shaving has made your hair thicker and stronger. This sensation will lessen the more you use your depilator : the hair will grow back less quickly and become thinner.
- Your depilator will be much more effective and easier to use if you use it regularly.

---

We advise you to use your depilator as soon as your hair starts to grow back.

---

## 4. CONNECTION

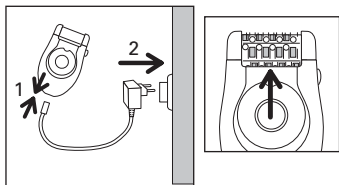

## 5. STOPPING THE APPLIANCE

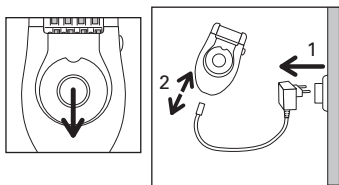

## 6. PEELING

Peeling will enable you to:

- 
- Limits growth of subcutaneous hair if practised regularly.

We strongly recommend that you use the Exfoliator Head 2 days before using your epilator to avoid irritating your skin.

- And not to use a peeling gel or cream at the same time.
  - Never carry out peeling on sensitive areas (armpits / bikini line / face).
-

- After peeling, we advise you to wipe over the area with a moist flannel to remove any dead skin. Dry the skin thoroughly afterwards.

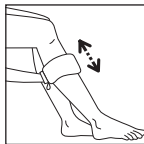

GB

#### • Method :

- Press the release button to remove the epilator head.
- Clip the Exfoliator Head to the epilator.
- Set the switch to "1"
- Start exfoliating with a slow, gentle up and down movement.

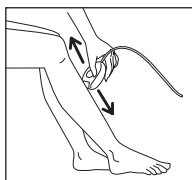
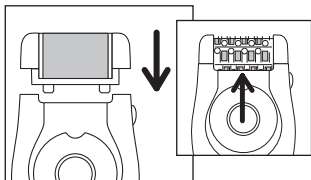
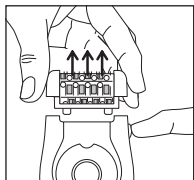

When using the Micro-Peeling function for the first time or if your skin is very delicate, we recommend:

1. skin is wet before peeling, use cotton wool or a flannel to do this
2. making slow and gentle rotating movements when using the appliance
3. not to use the appliance more than twice on the same area.

#### • Replacing the exfoliating band

- Press the release button to remove the Exfoliator Head from the epilator.
- Using the plastic end of the cleaning brush unclip the band as follows:

1. Turn the Exfoliator Head over and hold it in place by gripping the edges between your thumb and forefinger.
2. Turn the band so that its groove comes round to the central position.
3. Insert the end of the cleaning brush in the groove and push to eject the band.
4. Insert the new band by slotting the fins (b) of the exfoliator unit in the groove of the band and pushing until it clicks!

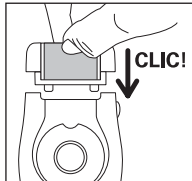
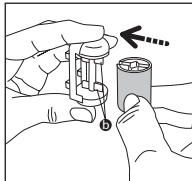
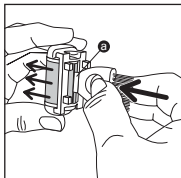
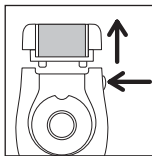

## 7. LEG HAIR REMOVAL

For optimum epilating, we recommend that you tilt the epilator slightly towards your skin in the direction of epilating, as shown in the diagram.

- Move the switch to the on position "2"

- The switch must always remain visible during use.

- Shave against the lie of the hair, slowly and without pressing, with the shaver perpendicular to your skin.

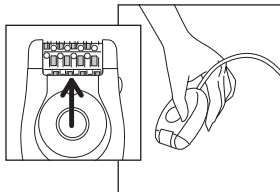
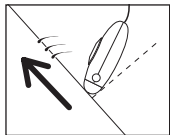

## 8. HAIR REMOVAL FROM SENSITIVE AREAS (EP4630)

For optimum epilating, we recommend that you tilt the epilator slightly

towards your skin in the direction of epilating, as shown in the diagram.

• Preparing the area where you want to remove hair:

- If the hairs are long trim to approximately 1cm.
- Dry the area thoroughly to ensure any trace of deodorant or perspiration are removed.
- If you are not used to epilating your underarms and bikini line with an epilator, we recommend you use the Sensitive Area accessory.
- Push the Sensitive Area accessory onto the epilator head until it clicks.
- Move the switch to the on position "1"

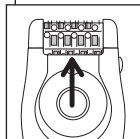

Shave against the lie of the hair, slowly and without pressing, with the shaver perpendicular to your skin.

### For the armpits:

First from bottom to top ...  
... Then from top to bottom.

Important :

- a) Keep your arm raised and stretched throughout the hair removal process.
- b) Stretch the skin to make it easier.



**Important:**

Make sure the skin is stretched properly.

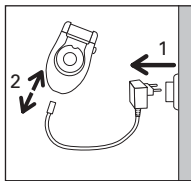
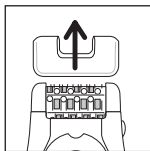
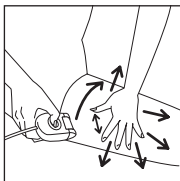

Remove the Sensitive Area accessory and unplug your epilator after each use.

## 9. CLEANING THE APPLIANCE

• **Cleaning the epilator head:**

1. Unplug the epilator.
2. Press the release button on the head and remove the epilator head.
3. Rinse the epilator head under cold running water by turning it for 5 to 10 seconds.

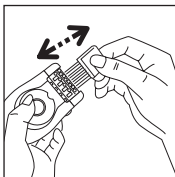
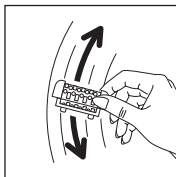
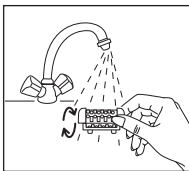
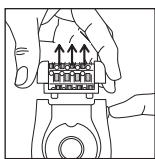
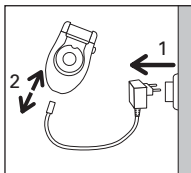

- 4. Shake the epilator head vigorously and dry it with a towel before fitting it to the epilator again.** You can also use the small cleaning brush supplied.

• **Cleaning the sensitive area accessory (EP4630):**

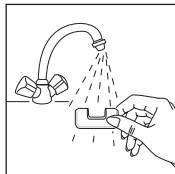
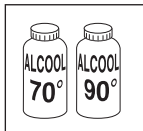





#### • **Cleaning the Exfoliator Head.**

We recommend that you change the exfoliating band after three sessions of exfoliation or when it is worn out.

GB



Do not clean the band under running water.

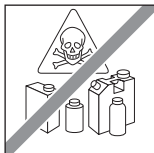
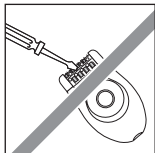

- Do not apply alcohol to the body of the appliance to avoid its colours changing.

## 10. SKIN CARE

Small red spots may appear. They will disappear quickly. For s preferable to use your depilator in the evening.

**If necessary, apply calming cream after depilation.**

## 11. ENVIRONNEMENT PROTECTION FIRST

Your appliance contains valuable materials which can be recovered or recycled. Leave it at a collection point.



## Free Manuals Download Website

<http://myh66.com>

<http://usermanuals.us>

<http://www.somanuals.com>

<http://www.4manuals.cc>

<http://www.manual-lib.com>

<http://www.404manual.com>

<http://www.luxmanual.com>

<http://aubethermostatmanual.com>

Golf course search by state

<http://golfingnear.com>

Email search by domain

<http://emailbydomain.com>

Auto manuals search

<http://auto.somanuals.com>

TV manuals search

<http://tv.somanuals.com>