

# Rowenta

Professional

Instructions for use

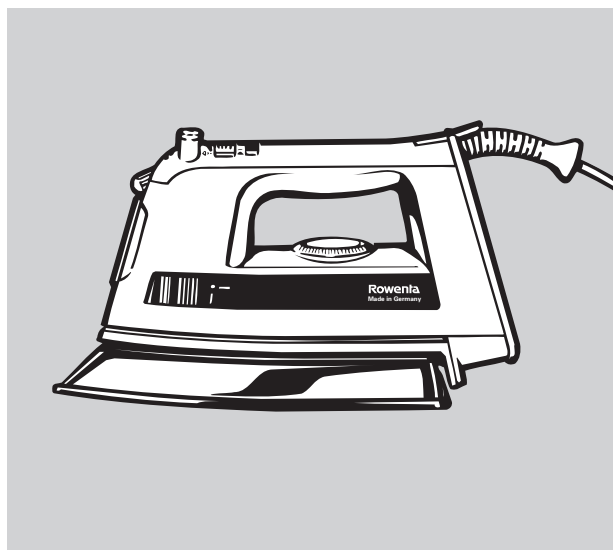

## IMPORTANT SAFEGUARDS

When using your iron, basic safety precautions should always be followed, including the following:

Read all instructions before using the iron.

1. Use iron only for its intended use.
2. To protect against a risk of electric shock, **do not** immerse the iron in water or other liquids.
3. The iron should always be turned to Minimum (Min) before plugging or unplugging from outlet. Never yank cord to disconnect from outlet, instead grasp plug and pull to disconnect.
4. Do not allow cord to touch hot surfaces. Let iron cool completely before putting away. Loop cord loosely around iron when storing.
5. Always disconnect iron from electrical outlet when filling iron with water or emptying and when not in use.
6. Do not operate iron with a damaged cord or if the iron has been dropped or damaged. To avoid the risk of electric shock, do not disassemble the iron, take it to the nearest authorized Rowenta Appliance Service Center for examination and repair. Incorrect reassembly can cause a risk of electric shock when the iron is used.
7. Close supervision is necessary for any appliance being used by or near children. Do not leave iron unattended while connected or on an ironing board.
8. Burns can occur from touching hot metal parts, hot water or steam. Use caution when you turn a steam iron upside down – there may be hot water in the reservoir.
9. The use of accessory attachments is not recommended by Rowenta Appliance Company and may result in fire, electric shock or personal injury.

## **SPECIAL INSTRUCTIONS**

1. This is a 1200 watt or 1400 watt appliance (check rating on iron heel). To avoid a circuit overload, do not operate another high wattage appliance on the same circuit.
2. If an extension cord is absolutely necessary, a 12-ampere cord should be used. Cords rated for less amperage may overheat. Care should be taken to arrange the cord so that it can not be pulled or tripped over.
3. After the iron has cooled, wrap the cord loosely around the handle.
4. Your Rowenta appliance is intended for household use only.

## **SAVE THESE INSTRUCTIONS**

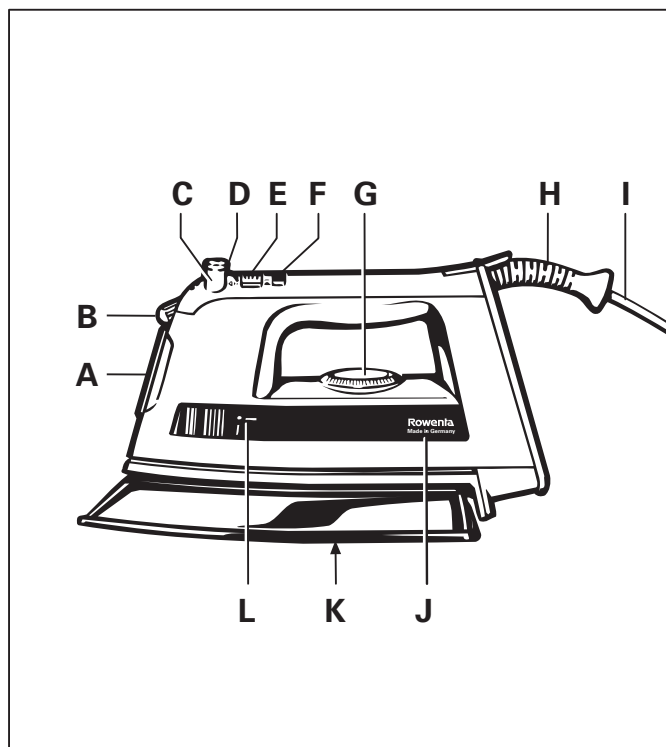

■ **Description:**

- A Water filling inlet
- B Spray nozzle
- C Burst of steam button
- D Spray button
- E Variable steam control
- F Indicator light
- G Temperature control dial
- H Swivelling cord protector
- I Supply cord
- J Transparent water tank
- K Soleplate according to model
  - Stainless steel
  - Titan Plus
- L Water level indicator

Features vary by model. Check packaging or markings on iron for exact features

## BEFORE USE

- Please read the instructions for use and the Important Safeguards carefully.
- Slowly peel the protective cover off the soleplate.
- It is normal for a small amount of smoke to be produced the first time the iron is used. This will quickly disappear.

## 3-WAY AUTO-OFF (NOT ON ALL MODELS)

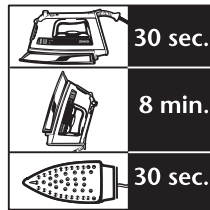

- If the iron is not moved while it is switched on, an internal safety switch will turn it off. It will turn off in 8 minutes if left vertically or in 30 seconds if left on its soleplate or tipped over.
- A red flashing light indicates that the auto-off has been activated. To switch the iron on again, move the iron or gently shake it.

Wait until iron is fully reheated before use.

## STEAM IRONING



### Filling with water:

- Ensure the iron is unplugged.
- Slide the variable steam control completely to the left.
- Hold the appliance upright so that the water filling inlet is horizontal.
- Fill the iron with tap water to the maximum level mark (see water usage for more informations).

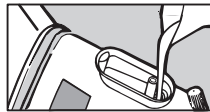

### Adding water:

- If you need to add water during ironing, **unplug** the iron and repeat above steps.
- Ensure iron is fully reheated after filling (temperature indicator light goes out) before ironing.

## SELECTING THE TEMPERATURE

To avoid damage to clothes from dust or dirt that may collect in the iron, we recommend that for the first use or after the iron has been stored for some time that you first iron an old cloth, testing both the steam and burst of steam feature.

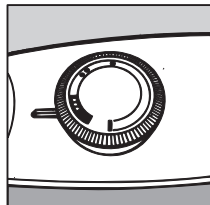

Set the temperature control dial according to the type of fabric you are ironing. Check the fabric's label for appropriate setting.

- |     |                                 |
|-----|---------------------------------|
| ●   | Synthetics (low temperature)    |
| ●●  | Silk/wool (medium temperature)  |
| ●●● | Cotton/linen (high temperature) |

To avoid automatic switch off while the iron is heating up, always keep the iron on its heel. Start at low temperature and graduate to high temperature. For delicate fabrics we recommend carrying out a test on an unobtrusive part of the garment (inner seam).

### SETTING VARIABLE STEAM CONTROL

Set the variable steam control to required steam volume. Steam can only be produced when the thermostat is in the red cotton/linen zone. Allow iron to heat up (light goes out) before activating the variable steam control. Reduce or set variable steam to min when ironing at low temperatures to avoid water leakage or spitting.

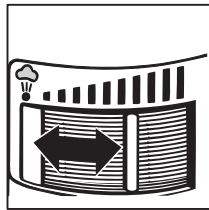

#### Iron ready for steam ironing:

Steam is produced as soon as the iron is held horizontally.

#### Steam off:

Steam generation can be interrupted by standing the iron on its heel or sliding the variable steam control fully to the left.

### SPRAY SETTING

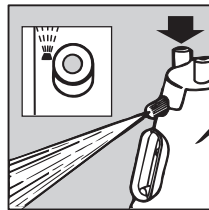

- Ensure there is water in the tank.
- Moistening the fabric with the spray will make wrinkle removal easier.
- Press the spray button down slowly for a jet or quickly and strongly for a mist.
- Do not spray silk, etc.

### BURST OF STEAM

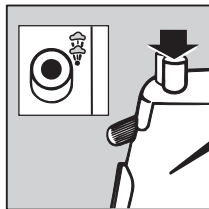

- To remove stubborn wrinkles or press in a sharp crease, use the burst of steam button.
- Press the button firmly, a strong burst of steam penetrates deep into the fabric.
- Leave an interval of at least four seconds between pressing the burst of steam button.
- With water in the tank, the burst of steam

button can be used as soon as the steam ironing temperature has been reached (●●●)

### VERTICAL STEAM (NOT ON ALL MODELS)



- The iron can also be used vertically. This is especially useful for getting wrinkles out of hanging clothes, curtains, tapestries, etc.
- Hold iron vertical, close to but not touching fabric.
- Hold hem and pull gently downward on the fabric.

- Press burst of steam button, a strong burst of steam penetrates deep into the fabric.

**WARNING:**  
Never iron clothes while they are being worn!

### DRY IRONING

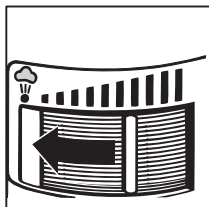

- Sliding the variable steam control fully to the left, dry ironing can be performed either with or preferably without water in the tank.

### AFTER IRONING

- Unplug the iron. Slide the variable steam control completely to the left and empty any water left in the tank. Leave the iron to cool down.

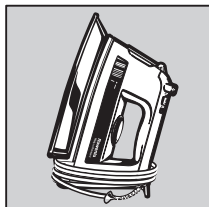

#### Integrated cord wrap:

- For easy storage, the cord can be wound loosely around the cord wrap once the iron has cooled off completely.
- To protect the soleplate always store the iron on its heel.

### WATER TO USE IN ROWENTA IRONS

#### TAP WATER:

Rowenta irons are designed to be used with REGULAR TAP WATER (up to 12 grains of hardness). If your water is harder than this, Rowenta recommends mixing half tap water with half distilled water which reduces the hardness; or inexpensive spring water. **Never use 100% distilled water since this can cause the iron to spit and leak.**

#### **SOFTENED WATER:**

There are many types of household water softeners and the water from many of them is perfectly acceptable for use in an iron. However, some types of softeners, particularly those that use chemicals such as salt, can cause the iron to leak or spit during use. If you experience this type of problem, we recommend that you try using inexpensive bottled spring water or untreated tap water. **Never use 100% pure distilled water.**

Once you have changed water it will take several uses to correct the problem. Rowenta recommends trying the steam function for the first time on an old towel or cloth to avoid damaging your clothes.

#### **IRON AND OTHER IMPURITIES:**

If your water supply contains large amounts of iron or organic matter, these minerals can collect inside the iron and eventually appear as brown stains. If you experience these problems Rowenta recommends using inexpensive bottled spring water. **Never use 100% pure distilled water.**

### **CLEANING AND MAINTENANCE**

#### **Vapodur Valve:**

The patented Vapodur valve ensures that the opening which allows the water to drip from the water tank into the steam chamber of your iron remains unaffected by hard water deposits. To ensure your iron continues to steam efficiently the valve **MUST** be opened and closed a few times. This is done by moving the variable steam control left to right a few times each time you finish ironing.

When cold and unplugged, the iron can be cleaned with a damp cloth and wiped dry. Never use household cleaners or solvents.

#### **Cleaning the Soleplate (depending on model):**

- Rowenta stainless steel and Titan Plus soleplates have excellent non-stick properties and can be simply wiped clean when cold.
- In normal use a draggy coating may build up on the soleplate (starch, detergent buildup, burnt synthetic fibers). This can be easily removed by using the Rowenta Soleplate Cleaning Kit or a quality hot iron soleplate cleaner available at most stores.
- Do not use abrasive household cleaners or abrasive cleaning pads.
- The soleplate of your iron makes ironing easier. To prevent scratching of the soleplate, do not iron over sharp objects (zippers, etc.). Do not place the iron on rough surfaces, e.g. metal iron support, which may scratch the soleplate.



## Free Manuals Download Website

<http://myh66.com>

<http://usermanuals.us>

<http://www.somanuals.com>

<http://www.4manuals.cc>

<http://www.manual-lib.com>

<http://www.404manual.com>

<http://www.luxmanual.com>

<http://aubethermostatmanual.com>

Golf course search by state

<http://golfingnear.com>

Email search by domain

<http://emailbydomain.com>

Auto manuals search

<http://auto.somanuals.com>

TV manuals search

<http://tv.somanuals.com>