

17. WARRANTY

Royal Sovereign International warrants the equipment sold is free from defects in material and workmanship for a period of One (1) year for Parts and Labor from the date of installation, excluding lamination rollers which are warranted for Six (6) months. This warranty is extended only to the original purchaser. This warranty is the only warranty made by Royal Sovereign International and cannot be modified or amended. Royal Sovereign's sole and exclusive liability and the customer's sole and exclusive remedy under this warranty shall be, at Royal Sovereign's option, to repair or replace any such defective part or product. These remedies are only available if Royal Sovereign's examination of the product discloses to Royal Sovereign's satisfaction that such defects actually exist and were not caused by misuse, neglect, attempt to repair, unauthorized alternation or modification, incorrect line voltage, fire, accident, flood or other hazard.

The warranty made herein is in lieu of all other warranties, expressed or implied, including any warranty or merchantability or fitness for a particular purpose. Royal Sovereign will not be liable for personal damage or personal injury (unless primarily caused by its negligence), loss of profit, or other incidental or consequential damages arising out of the use or inability to use this equipment.

LIMITED WARRANTY

This warranty specifically does not cover damage to laminating rollers caused by knives, razor blades, or any sharp objects or abrasives, or failure caused by adhesives, or damage caused by lifting, tilting and/or any attempt to position the machine other than rolling on the installed castors or feet on even surfaces, or improper use of the machine. Warranty repair or replacement by Royal Sovereign or its authorized Reseller(s) does not extend the warranty beyond the initial one year period from the date of installation. Unauthorized customer alterations will void this warranty.

CORPORATE HEADQUARTERS

Royal Sovereign International Inc.

2 Volvo Drive, Rockleigh, NJ 07647 U.S.A.

TEL : +1) 800-397-1025 FAX : +1) 201-750-1022

E-mail : info@royalsovereign.com

RS Holland B.V.

Columbusstraat 25 - 3165 AC Rotterdam,
The Netherlands

E-mail : paulchoi@royalsovereign.com

henryabrahamian@royalsovereign.com

Royal Sovereign Inc. <Oversea Sales Office>

1001, World Meridian II, 426-5, Gasan-dong,
Geumcheon-gu, Seoul, 153-759, KOREA

TEL : +82)2-2025-8800 FAX : +82)2-2025-8830

E-mail : sales@royalsovereign.com

RS Canada Inc.

164 Oakdale Road, Toronto, Ontario M3N 2S5
CANADA

TEL : +1) 416-741-8400 FAX : +1) 416-741-8185

E-mail : info@royalsovereign.com

RS International Australia PTY. LTD.

30 Prime Drive, Seven Hills, NSW 2147, Australia

TEL : +61) 2-9674-2127

FAX : +61) 2-9674-2027

E-mail : salesaust@royalsovereign.com

OWNER'S MANUAL

RSC-1400C/1400H Laminators



Read all instructions carefully before use.

For any Customer Support needs please choose the
Customer Support tab on www.royalsovereign.com

Royal Sovereign International Inc.
www.royalsovereign.com

TABLE OF CONTENTS

TOPIC	PAGE
1. Introduction.....	2
2. Safety Precautions	2
3. Installation	3
4. Included with Laminator	4
5. Product Identification.....	5
6. Control Panel.....	6
7. Speed Settings	7
8. Roller Nip Settings.....	7
9. Using Foot Pedal and Remote Control	8
10. Using Cross Cutter	9
11. Loading Film.....	10
12. Threading Film	
12.1. Decaling	11
12.2. Mounting.....	13
13. Installation of the Front Feed and Rear Rewind Options	15
14. Maintenance.....	17
15. Troubleshooting	17
16. Specifications	18
17. Warranty.....	19

1. INTRODUCTION

Thank you for choosing a Royal Sovereign laminator. It has been designed and manufactured to provide years of continuous service. For complete operating and maintenance information please read this manual thoroughly. Upon receipt of your laminator, please inspect the box, the machine and all other contents for shipping damage. Damage should be brought to the immediate attention of the delivering carrier (See page 4 for list of shipment elements).

2. SAFETY PRECAUTIONS

Failure to comply with any of the following safety procedures could result in serious injury. Please read the instructions carefully and keep for future reference.

1. Only a licensed electrician should install wiring and outlet for the laminator.
2. Ensure the unit is plugged into a properly grounded outlet with the correct voltage.
3. Keep hands and clothing (i.e. Neckties) away from rollers. The rollers have pinch points that can trap body parts or clothing and cause serious injury.
4. Keep flammable and wet objects away from the machine.
5. Place machine on a level surface.
6. Avoid excessive sunlight, humidity and extreme temperatures.
7. Ensure the unit is turned off, cooled, and unplugged from the outlet prior to moving and/or repairing.
8. Keep out of reach of children.
9. Only Royal Sovereign authorized maintenance and service technicians should make repairs.
10. Do not attempt to laminate items that exceed total recommended material thickness for the unit
11. When cleaning the machine, don't use flammable sprays or materials.
12. Do not touch the rollers when they are hot or place foreign objects inside the machine.
13. Do not cover the surface of the machine until the machine has completely cooled.

3. INSTALLATION

Note: The laminator should be installed by a trained service technician.

The laminator comes fully assembled, except for the feed table and paper guide to avoid shipping damage. Upon arrival, thoroughly inspect the unit. It is imperative that any shipping damage is reported and a claim is filed with the delivering carrier immediately upon receipt.

The laminator should be located in an area with adequate work space for feeding graphics and lamination materials.

Avoid placing the laminator in a dusty area or near sources of extreme heat or cold.

Once the laminator is in place, lock the casters into position ("ON" position). Always unlock the casters ("OFF" position) when moving to a different location.

ELECTRICAL REQUIREMENTS

Royal Sovereign recommends that a licensed electrician ensures proper power installation to your laminator in accordance with electrical codes in your area.

The laminator should have a dedicated power line.

MODEL	RSC-1400C		RSC-1400H	
Power Supply	220-240V 50/60HZ	120V 50/60HZ	220-240V 50/60HZ	120V 50/60HZ
	single phase			



120V UL



230V UL

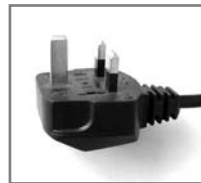

240V UK



220V EU



220V AU

4. INCLUDED WITH LAMINATOR

Thoroughly inspect the parts and the unit. It is imperative that any missing parts are reported and a claim is filed with the reseller immediately upon receipt of shipment.

Part Name	Quantity	Picture
Laminator	1	
Owner's Manual	1	
3" (76mm) / 2" (57mm) Auto Grip	6/4	
Registration Card	1	
L-wrench (2.5)	1	
Dust Cover	1	
Spare Motor Fuse - FUSE(50T) (6.3A)	1	
Spare Main Power Fuse - FUSE(65TS) (5A)	1	
8 - 1/4" Hexa head Bolt (M6 * 20mm) 8 - Spring Washer(\varnothing 6.1) (Included with option only)	10/10	
12 - 3/16" screw (M5 * 10mm). 12 - Spring Washer(\varnothing 5.1) (Included with option only)	12/12	
Front Feeder and Rear Rewinder Kit (Included with option only)	2/2	
4 - 1/3" Hexa head Bolt (M8 * 70mm) 4 - Spring Washer(\varnothing 8.5) (Included with option only)	4	
4 - 1/3" screw (M8 * 60mm). 4 - Spring Washer(\varnothing 8.5) (Included with option only)	4	
NUT (M8)	4	

5. PRODUCT IDENTIFICATION

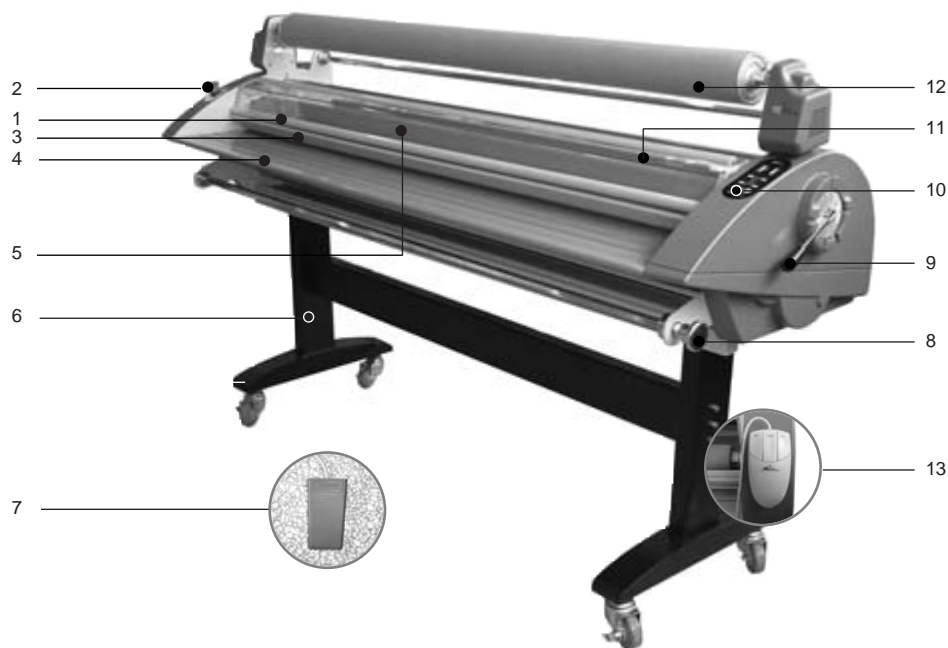

NO.	PART NAME	RSC-1400C	RSC-1400H
1	SAFETY COVER	○	○
2	EMERGENCY SWITCH	○	○
3	FRAME-PAPER GUIDE	○	○
4	FEED TABLE	○	○
5	MAIN ROLLER	○	○
6	ASSEMBLY STAND	○	○
7	FOOT PEDAL	○	○
8	TENSION CONTROL KNOBS	○	○
9	PRESSURE LEVER	○	○
10	CONTROL PANEL	○	○
11	UPPER IDLE BAR	○	○
12	RELEASE LINER TAKE UP	○	○
13	REMOTE CONTROL	○	○

6. CONTROL PANEL

When the machine is initially turned on, the LED display window will show the speed and temperature set at 1. (RSC-1400C and RSC-1400H).

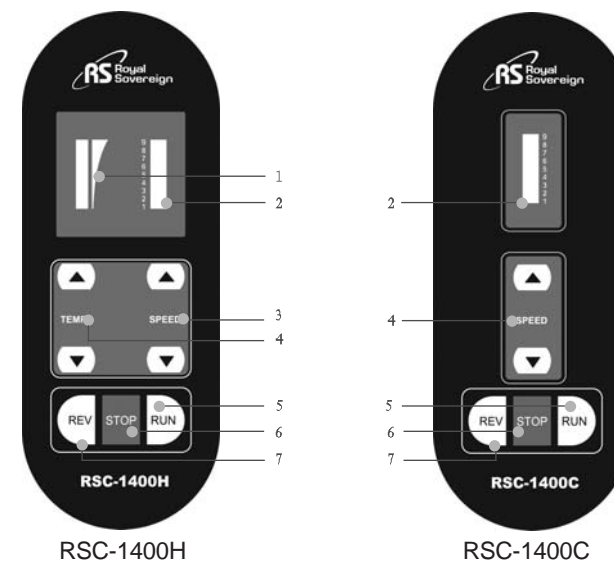

Control Buttons

- TEMPERATURE DISPLAY:** Display's current temperature (RSC-1400C and RSC-1400H)
- SPEED DISPLAY:** Display's current Speed.
- TEMPERATURE BUTTON- (RSC-1400C and RSC-1400H):** To change the temperature (max. RSC-1400H: 122°F, 50°C) of the upper roller, press up or down arrow button.
- SPEED BUTTON:** Adjusting the speed of the rollers. To change the speed of the rollers, press the up or down arrow button.
- RUN:** To start the rollers.
- STOP:** To stop the rollers.
- REV:** To reverse the rollers, press and hold the REVERSE button.

7. SPEED AND TEMPERATURE SETTINGS

RSC-1400C/H		RSC-1400H	
Speed#	Speed(Ft/min,M/min)	Temp.#	Temperature(° F, ° C)
1	4(1.2)	1	No Heating
2	6(1.7)	2	No Heating
3	7(2.2)	3	91(33)
4	9(2.6)	4	97(36)
5	10(3.1)	5	104(40)
6	12(3.6)	6	111(44)
7	14(4.2)	7	115(46)
8	15(4.5)	8	117(47)
9	16(5.0)	9	124(51)

8. ROLLER NIP SETTING

It is important to adjust the roller nip settings to the appropriate thickness of the board being used. Use the guide below to adjust to the correct position.

NO.	Inches	Metric (mm)
1	Lamination	Lamination
2	1/25"	1
3	3/16"~1/4"	5-7
4	3/8"~1/2"	10-13
5	3/5"	15

NOTE: If you don't want to laminate, please place the pressure lever to the "Open position(NO.5)".

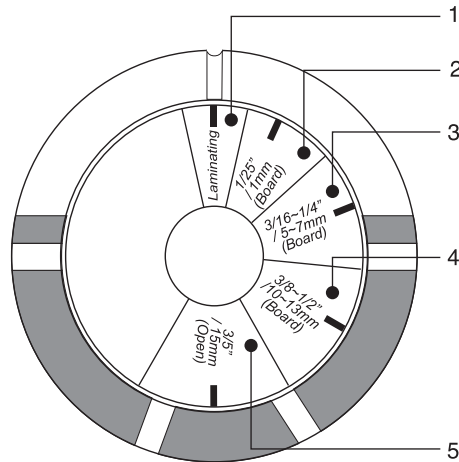

9. USING FOOT PEDAL AND REMOTE CONTROL

USING FOOT PEDAL

Place the foot pedal on the floor in front of the machine. Once all correct settings are displayed, you may use the foot pedal to operate the laminator for "Hands Free Operation." To activate the machine, press the foot pedal once and then release. Repeat to stop the rollers.



USING REMOTE CONTROL

Located on the rear left side of the laminator.

1. **PRESS RUN** – To activate the rollers.
2. **PRESS STOP** – To stop the rollers from turning.
3. **PRESS REV** – To reverse the rollers. Press and hold the button (useful for jams or misted media).



10. USING CROSS CUTTER

The cross cutter is located on the rear exit table of the machine.

1. After lamination, move the cutter approximately to the center of the completed application at the desired point of detachment (Figure 1).

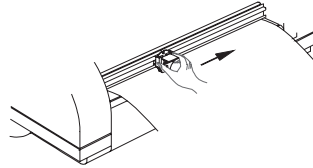

Figure 1

2. Grasp film with one hand, press the cutter downward into the application and slide it from one end to the other. (Figure 2 & 3).

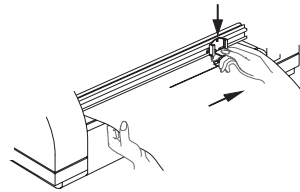

Figure 2

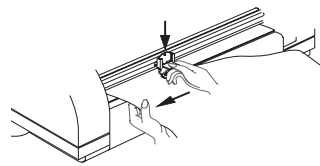

Figure 3

11. LOADING FILM

Royal Sovereign films are wound with the adhesive side facing the inside of the roll (adhesive in).

Loading films to upper and lower film shafts:
(See page 5 for assistance with parts identification.)

1. Adjust the auto grip to fit to the film and tighten the auto grip screw (Figure 1).



Figure 1

2. Remove the upper and lower film shafts from the machine and load the films (Center the upper and lower films on the shaft). Note the direction of the adhesives on the lower and upper films (Figure 2).

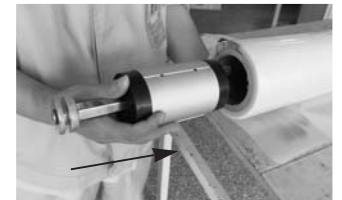

Figure 2

3. Load the upper and lower film shafts on the machine (Figure 3).



Figure 3

12. THREADING FILM

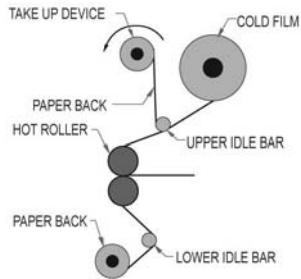

12.1. Decaling

1. Turn the power switch on ("I" position). The Power switch is located on the rear left side of the unit.
2. Complete the steps as in the "LOADING FILM" section (see page 10).
3. Set the top roller to the desired temperature (RSC-1400C)
4. Take off the Frame-Paper Guide and the Feed Table.
5. Pull the top film down over the Safety Cover to the bottom of the craft paper / Mounting film.
6. Align and center the craft paper / Mounting film to the top film and tighten the two lower core screws (Figure 1).
7. Thread the top film underneath the Upper Idle Bar.(Figure 2)
8. Tape the top film on to the Release Liner Take-Up.(Figure 2)



Figure 1



Figure 2

9. Cut and separate the release liner and the film. (Figure 3)



Figure 3

10. Thread the craft paper behind the Lower Idle Bar to the top film that is resting on the main roller (do not use the Lower Idle Bar for Mounting). (Figure 4)



Figure 4

11. Reinstall the Feed Table and the Frame-Paper Guide, and close the Safety Cover.
12. Adjust the nip setting to appropriate gap.
13. Insert and push the leader board until they reach the front nip point.
14. Push the Run button.
15. Push the leader board into the rollers. (Figure 5)



Figure 5

16. Adjust the top and bottom tension knob by rotating it clockwise or counterclockwise. Turn it until the top and bottom roll films have some resistance varies (the tension depending on the film thickness; the thicker the film the more tension is required). (Figure 6)



Figure 6

17. Press the Stop button when the leader board has completely exited from the rollers.
18. Use the Cross Cutter to cut the leader board from the web (see page 9).
19. Set the nip setting to the appropriate position for the Over-lamination / Decaling application.

12.2. Mounting

1. Lay the decaled image face down on a flat surface. Carefully peel back and put a crease along the edge of the release liner (Approximately 1 in or 25mm, Figure 1).



Figure 1

2. With the image facing up, align the image onto the board. Press firmly from the center out (Figure 2).



Figure 2

3. Adjust the pressure lever to ensure the proper opening (Figure 3).



Figure 3

4. Flip the image over the top roller and hold on to the release liner (Figure 4).



Figure 4

5. Press the foot pedal once, and then let it go while slowly pulling the release liner as the board enters the main roller nip (Figure 5)



Figure 5

6. Press the foot pedal once again when the board has completely exited from the rear of the unit. Trim the board if necessary.

13. INSTALLATION OF FRONT FEEDER and REAR REWINDER OPTIONS

Note: Below options are to be installed by an authorized RS reseller.

Installation of the Front Feeder Option (Includes 2 brackets, one spindle, and mounting hardware).

1. Install the Front Feeder to the inside of the front frames using four 1/4" (M6) hexagon bolts on each side (Figure 1)



Figure 1

Installing the Rear Rewinder Option (Includes motorized winder, bracket, one spindle, and mounting hardware).

1. Remove the left and right covers by using a Phillips screwdriver (four screws on each side cover) (Figures 2 & 3).



Figure 2 Figure 3

2. Remove the lever knob screw and lever (Figure 4).



Figure 4

3. Remove the rear cover by removing all 10 screws (4 top, 4 bottom, and 1 on each side) (Figure 5 & 6).



Figure 5



Figure 6

4. Disassemble the power switch bracket and place the left rewriter outside of the frame; fasten with round head 3/16" (M5) screws (included in the option kit). Then, reinstall the power switch bracket (Figure 7).



Figure 7

5. Install the right rewriter on the outside of the frame and connect the motor wire connector to the rear wire (Figures 8 & 9).

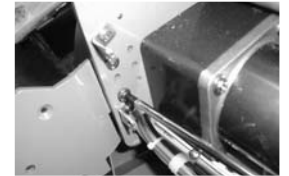

Figure 8

6. Reinstall the rear cover.

7. Reinstall the side covers.

8. Reinstall the lever knob and screw.



Figure 9

14. MAINTENANCE

Cleaning the Body of the laminaor

1. To clean the machine body, dampen a cloth with water only and gently wipe the machine clean.

Removing Adhesive Build Up

1. Remove the film from the laminator.
2. Use a damp (water only) cloth and a rubber gum eraser to remove the adhesive on the Teflon (metal) and silicone rollers.

Note: Rub firmly but do not scrub the rollers vigorously as this may scratch the surface. Do not use sharp metal objects, steel wool, or abrasives, as these may also damage the rollers.

Lubrication

1. Drive chain and sprockets should be lubricated with either a light coat of gear lube or heavy grease (lithium grease) after 6 months or 1000 hours of operation, whichever comes first.

15. TROUBLESHOOTING

Problem	Cause	Solution
Machine will not turn on:	<ol style="list-style-type: none"> a. Power plug is not plugged in. b. Power switch is in "0" (Off) position. c. Tripped circuit breaker. d. Blown main power fuse. 	<ol style="list-style-type: none"> a. Plug the power cord into appropriate outlet. b. Put the power switch to the "I" (On) position. c. Reset the circuit breaker. d. Replace the fuse.
There is power, but the rollers are not turning after the "RUN" button is pressed:	<ol style="list-style-type: none"> a. Emergency switch (es) is (are) engaged. b. Paper guide is not installed correctly. c. Blown motor fuse. 	<ol style="list-style-type: none"> a. Disengage the emergency switch (es). b. Properly install the paper guide so that the micro switch is activated. c. Replace the motor fuse.
The unit is not heating up:	<ol style="list-style-type: none"> a. Did not raise the temperature. 	<ol style="list-style-type: none"> a. Raise the temperature.
Curled lamination:	<ol style="list-style-type: none"> a. Upward curl. b. Downward curl. 	<ol style="list-style-type: none"> a. Loosen the top roll film tension. b. Loosen the bottom roll film tension.

16. SPECIFICATIONS

Description	RSC-1400H	RSC-1400C
Power supply	AC 100, 200, 220-240V	50/60Hz 120V 60Hz
Power consumption	1650W, 800W	100W
Max laminating width	1400mm / 55"	
Film thickness	25~250 mic / 1~10mil	
Max laminating speed	5m/min / 16.4ft/min	
Ready time	10min	Not applicable
Heating method	Hot Roller	None
Driving motor	DC geared	
Max Temperature control	50 °C / 22 ° F	Not applicable
Speed control	9 settings	
Transport type	2 Roller	
Film core size	Auto grip (2", 3")	
Cross cutter	Yes	Yes
Hot lamination	Yes	No
Cold lamination	Yes	
Mounting thickness	15mm / 0.6"	
Take up system	Chain link to mai motor	
Reverse	Yes	Yes
Remote control	Yes	Yes
Foot pedal	Yes	Yes
Unit dimensions (w x d x h)	1710 × 650 × 1210 (mm) 67.5" × 21.5" × 47.5"	
Unit weight	164kg / 361lbs	
Carton dimensions (w x d x h)	1960 × 900 × 850(mm) 77" × 35.5" × 33.5"	
Gross Weight	270kg / 595lbs	

Free Manuals Download Website

<http://myh66.com>

<http://usermanuals.us>

<http://www.somanuals.com>

<http://www.4manuals.cc>

<http://www.manual-lib.com>

<http://www.404manual.com>

<http://www.luxmanual.com>

<http://aubethermostatmanual.com>

Golf course search by state

<http://golfingnear.com>

Email search by domain

<http://emailbydomain.com>

Auto manuals search

<http://auto.somanuals.com>

TV manuals search

<http://tv.somanuals.com>