



# **Slimline Dishwasher Instruction Manual**



**Model Number: RHSLDW1**

Please read these instructions carefully and keep them for future reference

For Customer Services, Spare Parts & Manufacturer's Warranty Information, please call **01204 664 084**

Opening times: Monday – Friday 9am – 5pm

Saturday: 9am – 1pm

## **Contents**

<b>Components</b> .....	<b>4</b>
<b>Control Panel</b> .....	<b>5</b>
<b>Technical Specification</b> .....	<b>6</b>
EC declaration of conformity .....	6
<b>Safety Information</b> .....	<b>6</b>
Recycling .....	6
Safety information .....	7
When installing your machine .....	7
Daily Use .....	7
Items not suitable for dishwashing .....	8
<b>Installing the machine</b> .....	<b>8</b>
Positioning the machine .....	8
Water Connection .....	9
Water inlet hose .....	9
Water outlet hose .....	9
Electrical Connection .....	10
<b>Before using the machine</b> .....	<b>11</b>
Water .....	11
Filling with salt .....	11
Testing Strip .....	12
Adjusting salt consumption .....	13
Detergent Use .....	14
Filling the detergent compartment .....	14
Combined Detergents .....	15
Rinse Aid .....	15
<b>Loading your dishwasher</b> .....	<b>16</b>
Dish rack .....	16
Top basket height adjustment .....	16
Examples of loading .....	17
Lower Basket .....	17



Upper Basket.....	17
Incorrect Loads.....	17
<b>Standard Loading.....</b>	<b>18</b>
Capacity.....	18
Programme Options.....	19
<b>Using the machine .....</b>	<b>20</b>
Switching on the machine .....	20
Selecting a programme.....	20
Monitoring your wash cycle .....	20
Changing a programme .....	20
Resetting during a cycle .....	20
Switching the machine off.....	21
Important information.....	21
<b>Maintenance and cleaning.....</b>	<b>22</b>
Oil and lime accumulation.....	22
Machine door seal .....	22
Cleaning the machine .....	22
Filters.....	22
Spray arms .....	23
Hose filter .....	23
Programme monitor light is on and Start/Pause light is flashing.....	24
The programme won't start.....	24
'Wash/Dry' and 'End' keep flashing .....	24
Control lamps illuminated after cycle has finished .....	25
Detergent residues are left in the detergent compartment.....	25
Water will not drain .....	25
The machine stops during cycle .....	25
Unexpected noise .....	25
Dishes are still dirty.....	25
White stains present .....	25
Dishes won't dry .....	26
Rust stains are present on dishes .....	26

# Components

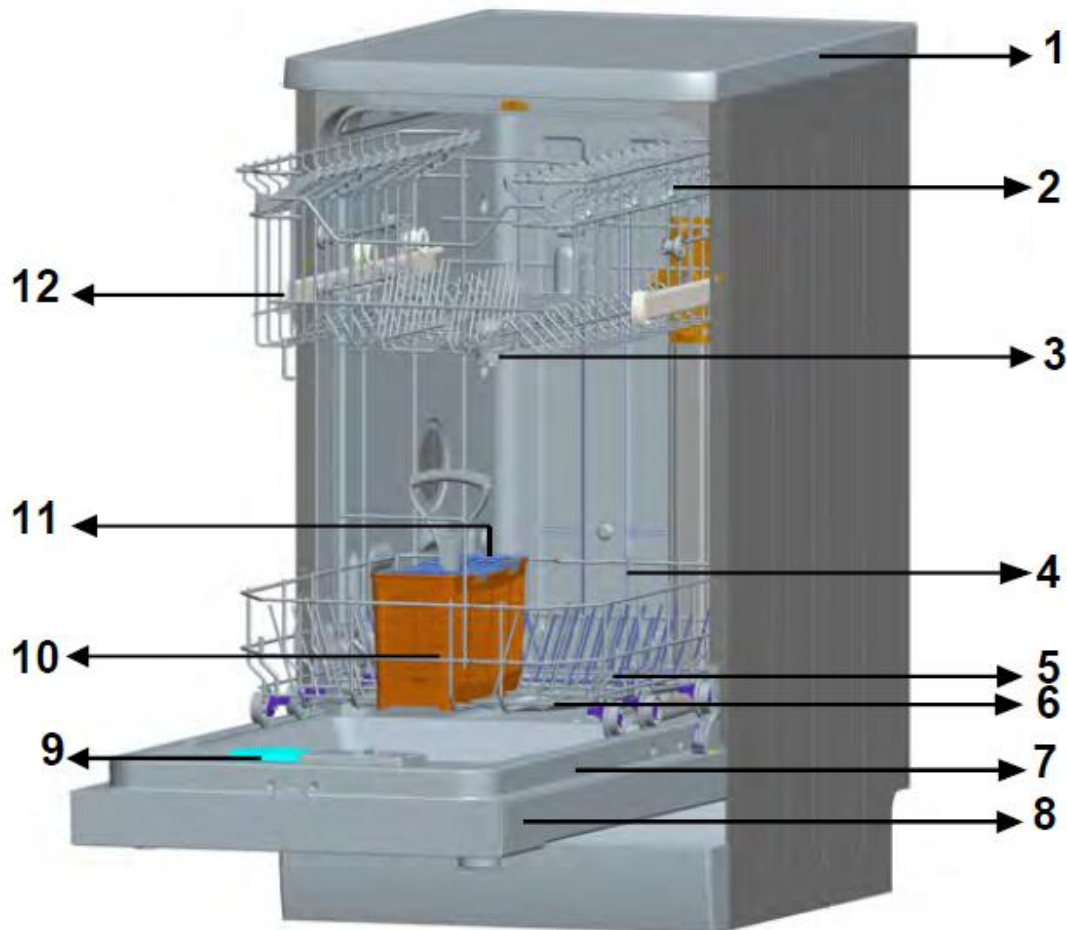

- |                    |                                      |
|--------------------|--------------------------------------|
| 1. Worktop         | 7. Rating Plate                      |
| 2. Upper Basket    | 8. Control Panel                     |
| 3. Upper Spray Arm | 9. Detergent and rinse aid dispenser |
| 4. Lower Basket    | 10. Cutlery Basket                   |
| 5. Lower Spray Arm | 11. Salt Dispenser                   |
| 6. Filters         | 12. Upper Basket Track Latch         |

# Control Panel

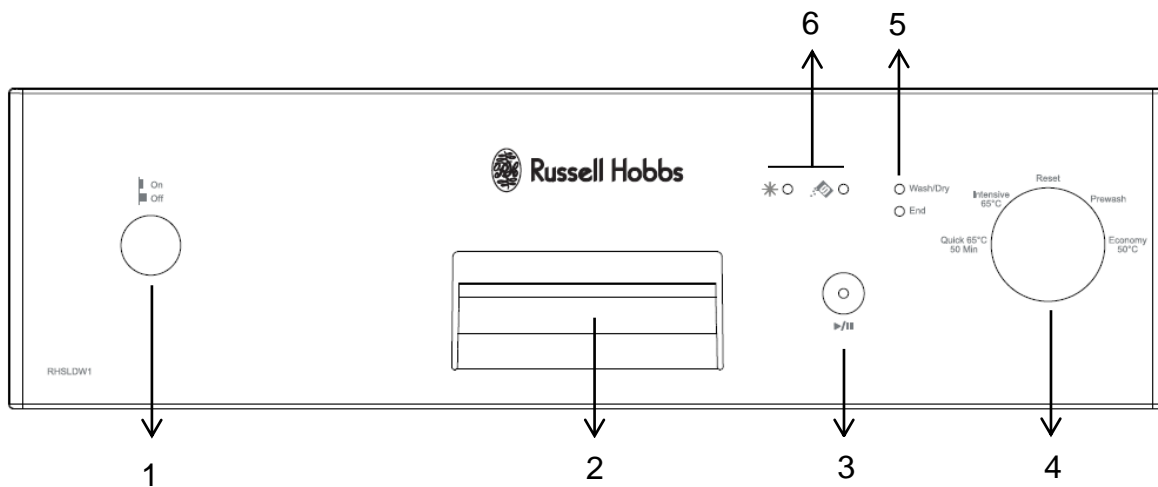

1. **Power on/off**  
When the power on/off button is pressed, the light on the Start/Pause button will illuminate.
2. **Door Handle**  
The door handle is used to open/close the door.
3. **Start/Pause Button**  
Once you press the Start/Pause button, the programme you selected with the selector button will start running and the indicator lamp 'wash/dry' will illuminate. If the programme is paused, the LED light will flash repeatedly.
4. **Programme selector knob**  
With the programme selector knob, you can select your desired programme by turning clockwise and anti-clockwise.
5. **Status indicator**  
You can monitor the current status of your programme by using the indicator light shown above (5). There are two progression states, 'wash/dry' and 'End'.
6. **Low salt indicator**  
If the low salt indicator light is illuminated, ensure to replenish the salt supply in your dishwasher.



# Technical Specification

Capacity	10 Place Settings
Height	845mm
Width	450mm
Depth	598mm
Net Weight	40 Kg
Electricity Input	220 - 240 V, 50 Hz
Total Power	1900 W
Heating Power	1800 W
Pump Power	100 W
Drain Pump Power	30 W
Water Supply Pressure	0,03MPa (0,3 bar) - 1MPa (10)
Current	10A

## EC declaration of conformity

All stages related to the machine are executed in accordance with the safety rules provided in all relevant directive of the European Community.  
2004/108/EC, 2006/95/EC, IEC 436/DIN 44990, EN50242

# Safety Information

## Recycling

- Certain components and the packaging of your machine have been produced from recyclable materials.
- Plastic parts are marked with international abbreviations.
- Cardboard parts have been produced from recycled paper and they should be disposed of into relevant disposal area.

## Safety information

- When you receive your machine, check for damage to the packaging and unit.
- Never start a machine that is damaged. Contact **01204 664 084** for advice if your machine is received in a damaged state.

## When installing your machine

- Ensure you choose a suitable, safe and level place to install your machine.
- This machine should always be installed by a qualified engineer.
- Only original spare parts should be used with this machine.
- Before installing, ensure the machine is unplugged.
- All electrical values must match the values indicated on the rating plate.
- Ensure the machine does not stand on the electricity supply cable.
- Never use an extension cable or multiple power point cable when using the appliance.
- Before using the machine, run a full cycle with the machine empty.

## Daily Use

- This machine is for domestic use only. Commercial use of the washer will void the manufacturer's warranty.
- Do not overload the machine. Only place dishwasher safe items in the machine.
- Only use detergents and rinse aids specifically designed for dishwashers. Use of other detergents will void the manufacturer's warranty.
- Do not drink water out of the machine.
- Do not use chemical dissolving agents such as solvents – this may cause an explosion.
- Check that plastic items are heat resistant before placing them in the machine.
- Do not overfill the machine – this can cause damage.
- Do not open the door while it is in operation. The machine will stop but there is still a risk of burning.
- Do not leave the dishwasher door open. This could lead to injury.
- Always place knives and other sharp object face down in the dishwasher to minimise risk of injury.
- This machine is not designed to be used by children and should only be used by capable individuals.
- Ensure the appliance is only used by persons with sufficient capabilities, experience and knowledge. The instructions in this manual should be followed at all times.

- Children should not use this machine as this may result in injury.

## Items not suitable for dishwashing

- Do not allow cigarette ashes, candle remains, polish, chemical substances to enter the dishwasher.
- Cutlery with bone, ivory or nacre coated handles, glued items or items soiled with abrasive chemicals.
- Plastic items that are not heat resistant.
- Aluminium and silver objects – these may discolour.
- Some delicate glass types, porcelains with printed patterns as they fade even after the first wash.
- Crystal items should not be put in the dishwasher as these will lose transparency over time.
- Adhered cutlery that is not heat resistant.
- Lead crystal glasses.
- Cutting boards.
- Items manufactured with synthetic fibre.
- Absorbent items such as sponges and kitchen cloths.

# Installing the machine

## Positioning the machine

When determining the place to put your machine, ensure there is sufficient room to fully open the dishwasher door.

Do not install the machine where the room temperature is likely to drop below 0°C.

Before positioning, remove the machine from its packaging taking care to follow warning instructions attached.

Position the machine close to a water tap or drain.

When moving the machine ensure you do not grip the door or panel.

Ensure there is sufficient room around the machine to allow it to be moved for cleaning purposes.



Ensure that the water inlet hose does not become compressed while positioning the machine. Also, make sure that the machine does not stand on the electrical cable.

Ensure the machine is level when placed on the surface. Adjust the feet by twisting clockwise to raise the height of the machine, and anti-clockwise to reduce the height of the machine. Failure to ensure the machine is level may result in the door not closing properly.

## Water Connection

Ensure the machine is connected to a clean, cold running water supply.

### Water inlet hose



Only use the water inlet hose supplied with this machine. Do not re-use old inlet hoses. Connect the water inlet hose directly to the water inlet tap. The pressure supplied by the tap should be a minimum of 0.03Mpa and a maximum of 1Mpa. If the water pressure is above 1Mpa, a pressure release valve should be fitted. After the connection is made, the tap should be turned on fully and checked for water tightness. For the safety of your machine, make sure you always turn off the water after each cycle.

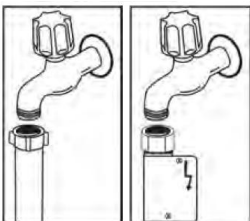

**Note:** Aquastop water spouts are used in some models. In case of using aqua stop, a dangerous tension exists. Do not cut an Aquastop water spout. Do not allow an aqua stop spout to become twisted.

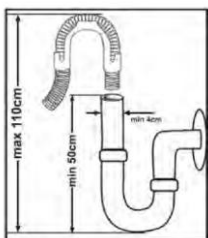

### Water outlet hose

The water drain hose can be connected either directly to the water drain hole or to the sink outlet spigot. Using a special bent pipe, the water can be drained directly into the sink via hooking the pipe over the edge of the sink. This connection should be a minimum of 50cm and at a maximum of 110 cm from the floor plane. If a drain hose longer than 4m is used dishes may remain dirty and warranty will be void.

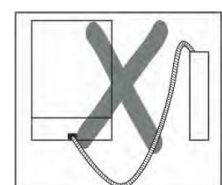
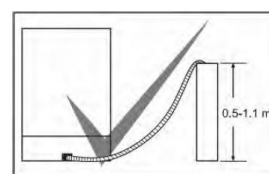

## Electrical Connection

The earthed plug of your machine should be connected to an earthed outlet supplied by a suitable voltage and current. Ensure a qualified engineer is appointed to install the machine to ensure that the machine is correctly earthed. If the machine is installed and not properly earthed, the warranty will be void.

The indoor fuse current value should be 10-16 A.

Your machine is set according to 220 – 240 V.

Always use the coated plug supplied with your machine.

The machine's electric cable should be replaced by a qualified electrician only. Failure to do so may result in injury.

Always unplug the machine when a wash cycle has finished. Do not unplug with wet hands. Always ensure you pull the plug, and not the cable leading into the plug.

# Before using the machine

## Water

To maximise cleaning quality, the machine requires soft water – ie low calcareous water. Lime scale may form on dishes and the interior of the machine in hard water areas. This will reduce the performance of the machine.

## Filling with salt

Use softener salt specifically produced for dishwashers – do not use table salt. To insert softener salt, remove the lower basket and open the salt compartment cap by turning it anti clockwise (see image 1). Fill the salt compartment by mixing 1kg salt with water (picture 3), for the first time only. For refilling, only insert salt without using water using a funnel to make this easier (see image 4). Once this is filled, replace the cap twisting clockwise. When the salt indicator light is illuminated, add more salt to the machine.

Immediately after inserting salt, run the machine empty on a short cycle in order to prevent corrosion.

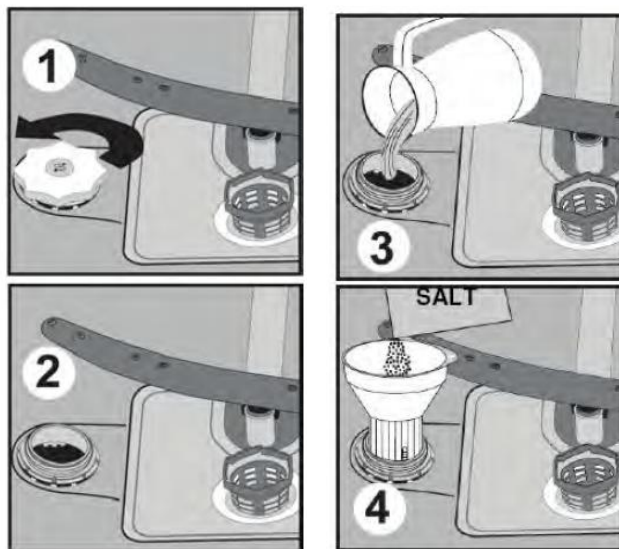

## Testing Strip

The washing effectiveness of your machine depends on the softness of the tap water. For this reason, your machine is equipped with a system that reduces the hardness in the mains water supply. To find out the hardness of water in your area, contact your local water board who can determine the hardness of water in your area using a testing strip.

When you receive a testing strip, dip this into a cup of water for 1 second, remove from the water and shake. Wait for 1 minute and assess the hardness of your water using the below table.

Level											Lime Content
Level 1											No Lime
Level 2										■	Very Low Lime
Level 3								■		■	Low Lime
Level 4						■		■		■	Medium Lime
Level 5				■		■		■		■	Lime
Level 6		■		■		■		■		■	High Lime

## Adjusting salt consumption

Water Hardness Level	British Hardness dE	Hardness Level Indicator
1	0 - 6	● Wash/Dry Lamp is on ○ End lamp is off ○ Start/Pause Lamp is off
2	7 - 14	○ Wash/Dry Lamp is on ● End lamp is off ○ Start/Pause Lamp is off
3	15 - 21	○ Wash/Dry Lamp is on ○ End lamp is off ● Start/Paus Lamp is off
4	22 - 28	● Wash/Dry Lamp is on ● End lamp is off ○ Start/Pause Lamp is off
5	29 - 42	● Wash/Dry Lamp is on ○ End lamp is off ● Start/Pause Lamp is off
6	43 - 63	○ Wash/Dry Lamp is on ● End lamp is off ● Start/Pause Lamp is off

Please note: Hardness setting is set to level 3 as a factory setting.

## Adjusting salt consumption

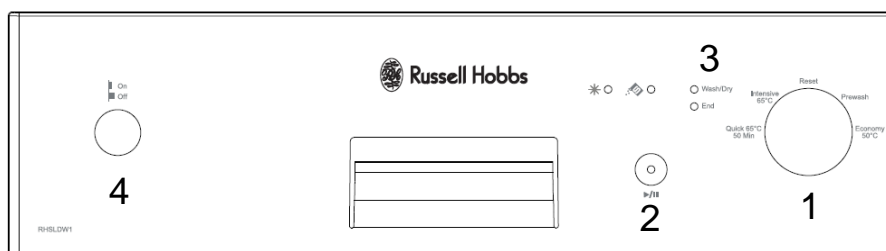

Move the programme selector knob to the 0 position (1) while the power button is off.



After switching the programme dial to 0, press the Start/Pause button and hold it down.



While the start button is held down, press the On/Off button to switch the machine on (2).



Keep Start/Pause keys held down until the monitor lights illuminate (2).



After lights 'Wash/Dry/End' have flashed (3), release the Start/Pause button (2).

Your machine displays the latest entered water setting.



You can adjust the levels by pressing the Start/Pause button (2) according to the table of hardness settings above.



After adjusting the water hardness level, press on/off to save the settings in memory

## Detergent Use

Only use a detergent that is specifically designed for domestic dish washers. Detergent should be put into the compartment located on the inside of the door in prior to starting the machine. Do not overfill the detergent department or this may damage your dishes. For more information regarding the use of detergent, contact the detergent manufacturer.

## Filling the detergent compartment

Push the latch to open the detergent container as shown in image 1. Insert either a dishwasher tablet or powder detergent into the larger of the 2 compartments (b). If you are washing

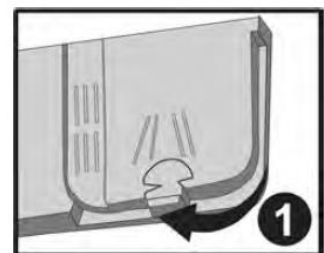



heavily soiled items, pour a small amount (5cm<sup>3</sup>) into the prewash section of the tablet dispenser (a).



### Combined Detergents

Detergent manufacturers also manufacture combined detergents that are called '2 in 1', '3 in 1' and '5 in 1'.

This dishwasher is suitable for use of 3 in 1 or less only and must be used on a setting of 65°C or more.

When using such detergents, always place them into the detergent compartment in the door of the machine and not directly into the interior of the machine. Using these detergents will reduce the need for salt input into your machine as they are made up of a combination of salt and detergent.

Contact the detergent manufacturer if you are not achieving the required standard of cleanliness.

### Rinse Aid

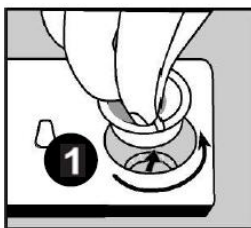

Rinse aid is used to prevent white water drops forming on dishes. To add rinse aid to your machine, remove the rinse aid compartment lid by twisting anti clockwise (1), Fill the rinse aid compartment until the rinse aid indicator becomes dark (b).

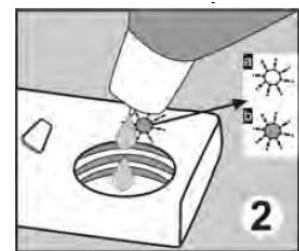

As the rinse aid is used over time, the rinse aid indicator will become lighter (a). The rinse aid level adjuster can be set between positions 1 and 6. The higher the number, the more rinse aid will be used. The factory setting for the rinse aid indicator is position 3.



**Please note:** If you can see water stains forming on your dishes you will need to increase the rinse aid level, if you see blue stains on your dishes you will need to decrease the amount of rinse aid used.

# Loading your dishwasher

Ensure dishes are placed in the machine with sufficient space for water to flow around the dishes. This will allow optimum energy efficiency.

There are two baskets provided with this machine, the upper basket is designed for cups, glasses, shallow dishes and tea plates. The lower basket is designed for larger plates and cooking pans and dishes.

For washing cutlery, ensure you use the cutlery basket provided. When washing knives, ensure these are placed point down on in the basket.

Ensure that you do not balance glasses against each other as these may not remain stable during the wash cycle may break which could result in injury.

**Caution:** Place items in the machine in a way which will not cause the upper spray arms to be obstructed. This will stop the machine functioning correctly.

## Dish rack

Dish racks are located on the upper basket of the machine. When these are in the open position (a), they can be used for placing cups and long knives on. When in the closed position (b), long glasses can be placed in the upper basket.

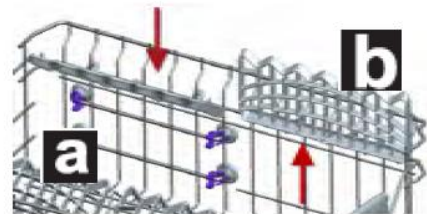

## Top basket height adjustment

The top basket of the machine is adjustable to allow more room in the bottom basket for bigger items. To adjust your basket, open the basket retaining parts at the end of the basket rails by turning them to the sides, then take the basket out. Change the position of the wheels and replace the basket onto the rail. Ensure you close the retainers at the end of the basket hold. This will allow you to raise and lower the basket as desired.

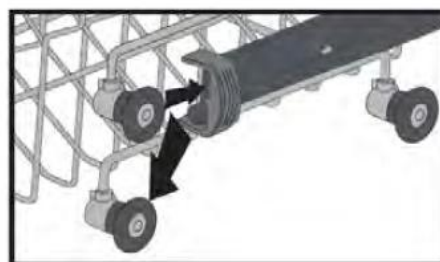
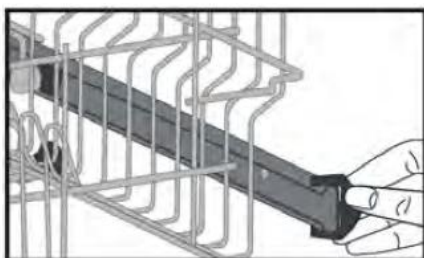



## Examples of loading

### Lower Basket

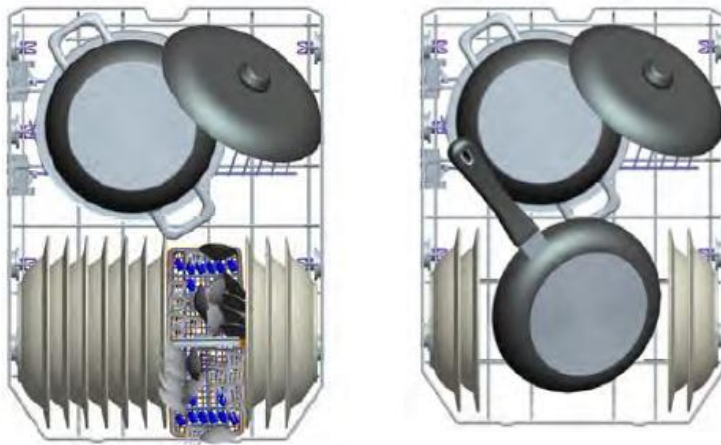

### Upper Basket



### Incorrect Loads

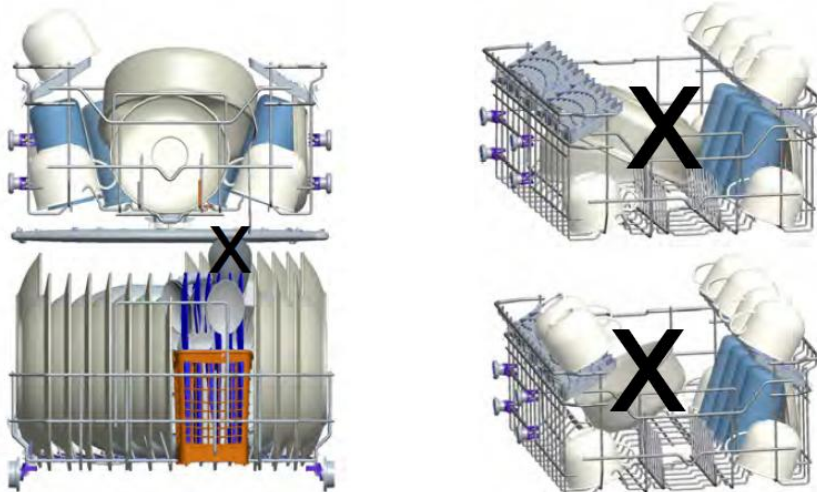

# Standard Loading

## Capacity

Upper and lower baskets: 10 place settings. The upper basket should be adjusted to the lower position.

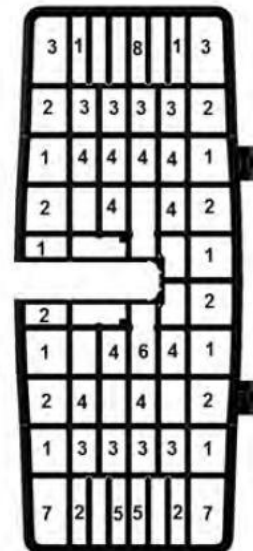
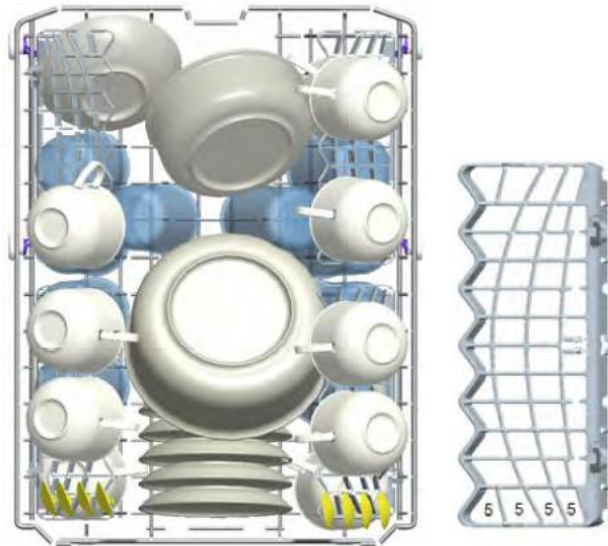

## Programme Options

### Programme items

Programme No	Prewash	Economic	Super Wash 50 min.	Intensive
Programme names and temperatures	-	50°C	65°C	65°C
Type of food waste	Pre-wash to rinse and loosen residue- awaiting full load- then select a programme	cold meats, vegetables, not kept for long	soups, sauces, pasta, eggs, pilaf, potato and oven dishes, fried foods	soups, sauces, pasta, eggs, pilaf, potato and oven dishes, fried foods
Level of soil	-	medium	medium high	high
Detergent amount A: 25 cm <sup>3</sup> / 15 cm <sup>3</sup> B: 5 cm <sup>3</sup>	-	A+B	A+B	A+B

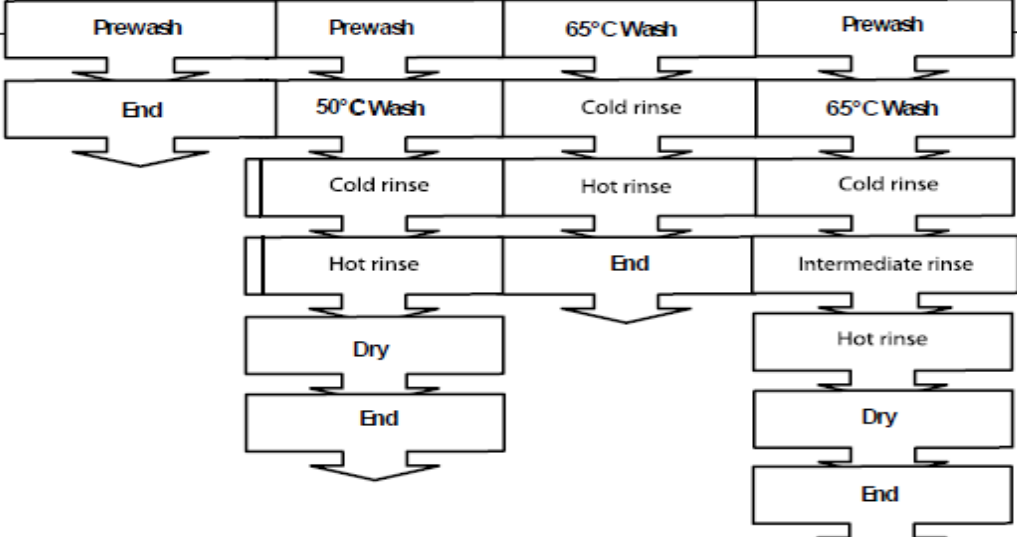
Programme duration (min.)	15	160	50	115
Electricity consumption (kW hours)	0,02	0,93	1,31	1,45
Water consumption (liters)	3,8	13,6	10,5	17,6

# Using the machine

## Switching on the machine

To switch on the machine, press the 'On/Off' button



## Selecting a programme

To select a programme, twist the programme knob to the desired position

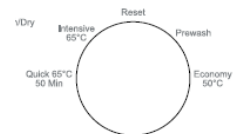

## Monitoring your wash cycle

You can monitor the progress of the wash cycle by using the programme follow up bulbs. While the programme is running, the top light will illuminate. Once the programme has finished, the bottom light will illuminate.

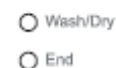

## Changing a programme

To reselect a programme during a cycle, press the play/pause button once. Wait until you hear the cycle has stopped. This will allow you to reselect a different cycle using the instructions above. The cycle will continue from the point it was stopped at but will continue as the new selected cycle.

## Resetting during a cycle

To reset the machine during a cycle to allow you to reselect a programme from the start, press the 'Play/Pause' button once. Twist the programme knob to the 'Reset' position. Press the 'Play/Pause' button once and wait 30 seconds for the water to be drained from the machine. Once the finish light is illuminated (lower LED bulb), you can reselect a new cycle.

## Switching the machine off

To switch the machine off after a cycle, wait until the finish light is illuminated (lower LED). Then press the 'On/Off' button.



## Important information

Once a wash cycle has finished, the drying process can be sped up by opening the machine door slightly.

If the machine door is opened during a cycle, the power is cut. Once the door is closed, the programme will continue. User should not open the door during a cycle as this can result in burn injuries.

If the power is cut during a cycle, the program is terminated. The machine will be ready to select a new cycle.

# Maintenance and cleaning

Cleaning the machine regularly will prolong the machines service life.

## Oil and lime accumulation

If oil and lime accumulate in the machine, run the machine empty while ensuring the use of a dishwasher tablet/detergent.

## Machine door seal

Use a damp cloth to wipe residues on the door seals regularly. This will prolong the life of the door seal.

## Cleaning the machine

Unplug the machine before cleaning. Clean the filters and spray arms at least once a month to prevent blockages. Do not use strong detergents when cleaning your machine, wipe with a mild detergent and damp cloth.

## Filters

Check the fine filters for potential food waste deposits. If any food waste is present, remove the filter and rinse thoroughly under a tap.

- a. Micro Filter
- b. Coarse Filter
- c. Metal/Plastic filter

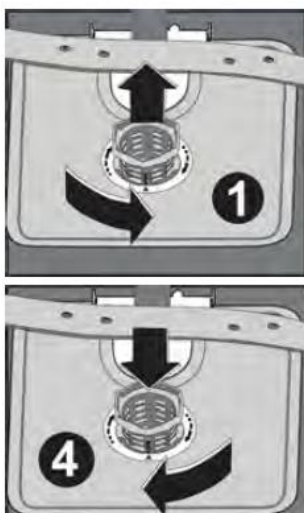
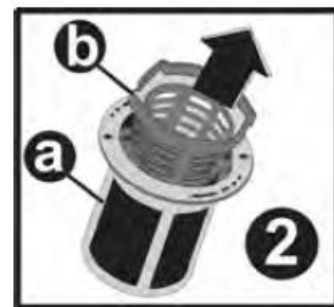

To remove and clean the filter, turn anti-clockwise and take it out by lifting upwards (1).

Pull and remove the metal/plastic filter (3). Then pull the coarse filter out of the micro filter (2). Rinse this with water under a tap and refit the metal filter. Insert the coarse filter into the micro

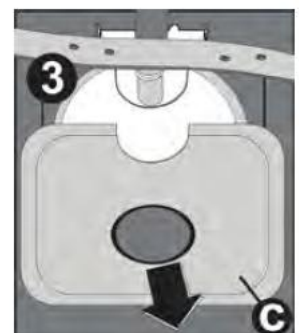

filter and line up the corresponding markings. Lock the micro filter into the metal/plastic filter and turn in the direction of the arrow (4) .

- Never use the dishwasher without the filter present. Incorrectly fitting the filter will reduce the washing effectiveness of the machine.

## Spray arms

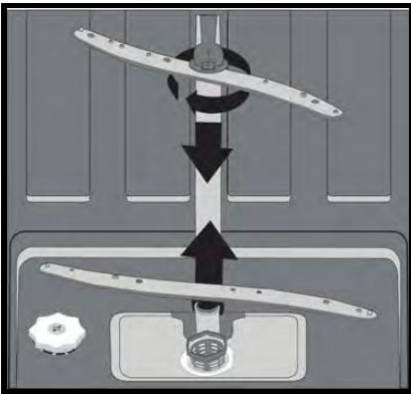

Always check the spray arm water outlet to ensure they are not clogged. If these are clogged, ensure they are cleaned.











The lower spray arm can be removed by pulling it upwards, while the upper spray arm nut can be removed by turning the nut to the left. Ensure the nut is tightened sufficiently when refitting the upper spray arm.

## Hose filter

The inlet hose contains a filter to prevent potential water debris entering the machine. Check the filter hose from time to time and clean if necessary. To clean the filter, first turn the tap off and then remove the hose. After removing the filter from the hose, clean this under the tap. Insert the cleaned filter back into its place inside the hose and refit the hose.



# Error Codes

ERROR CODE			ERROR DESCRIPTION	CONTROL
Wash/Dry	End	Start/Pause		
			Inadequate water supply	<ul style="list-style-type: none"> <li>• Make sure the water input tap is totally open and that there is no water cut.</li> <li>• Close the water input tap, separate the water input hose from the tap and clean the filter at the connection end of the hose.</li> <li>• Restart your machine, contact the service if the error resumes.</li> </ul>
			Error of continuous water input	<ul style="list-style-type: none"> <li>• Close the tap.</li> <li>• Contact the service.</li> </ul>
			The waste water in the machine cannot be discharged.	<ul style="list-style-type: none"> <li>• Water discharge hose is clogged.</li> <li>• The filters of your machine might be clogged.</li> <li>• Power off-on your machine and activate the program cancellation command.</li> <li>• If the error continues, contact the service.</li> </ul>
			Intended water temperature could not be reached faulty heater and heater sensor	Contact the service.
			Alarm is active against water overflow	<ul style="list-style-type: none"> <li>• Power off your machine and close the tap.</li> <li>• Contact the service.</li> </ul>
			Faulty electronic card	Contact the service.

## Programme monitor light is on and Start/Pause light is flashing

Your machine door is open. Shut the door.

## The programme won't start

- Check the machine is plugged in.
- Check the indoor fuses.
- Ensure the water inlet hose is turned on.
- Ensure the machine door is closed.
- Ensure the machine is switched on.
- Ensure the water inlet filters are not clogged.

## 'Wash/Dry' and 'End' keep flashing

- Water overflow alarm is active.
- Turn off the tap and contact the number at the bottom of this page.



## **Control lamps illuminated after cycle has finished**

The 'On/Off' button has not been released.

## **Detergent residues are left in the detergent compartment**

Detergent has been added when the detergent compartment is wet. Wipe dry the detergent compartment before using the machine again.

## **Water will not drain**

- The water drain hose is clogged or twisted.
- The filters are clogged.
- The programme has not yet finished.

## **The machine stops during cycle**

- Power failure.
- Water inlet failure.
- Program may be in standby.

## **Unexpected noise**

- Dishes are placed incorrectly inside the machine.
- The spray arm is hitting the dishes.

## **Dishes are still dirty**

- Dishes are not placed correctly in the machine – spray water is not hitting them.
- Basket is overloaded.
- Not enough detergent is added.
- An unsuitable programme has been selected.
- Spray arm has become clogged.
- Filters are clogged.
- Filters are incorrectly fitted.
- Water drain pump is clogged,

## **White stains present**

- Not enough detergent is being used.
- Rinse aid setting is too low.
- Salt is needed due to hard water
- Water softener setting at low level.
- Salt compartment cap not closed properly.

### **Dishes won't dry**

- A programme without a dry operation has been selected.
- Rinse aid dosage set too low.
- Dishes unload too fast.

### **Rust stains are present on dishes**

- High rate of salt in water.
- Salt compartment cap not closed properly.
- Too much salt spilt into the sides and into the machine while filling with salt.
- Unhealthy mains grounding.

**If you having continuing issues after exploring possible solutions given please contact the number at the bottom of the page for further advise.**



Russell Hobbs

For manufacturer's warranty  
information please call

**01204 664 084**

Opening times:

Monday - Friday

9am until 5pm

Saturday: 9am – 1pm

Alternatively, write to the following address:

PO Box 2235  
Bolton  
BL6 9AJ

Revision 3

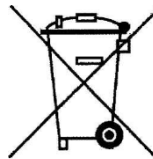

This symbol is known as the 'Crossed-out wheelee bin Symbol'. When this symbol is marked on a product/batteries, it means that the product/batteries should not be disposed of with your general household waste. Only discard electrical/electronic/battery items in separate collection schemes, which cater for the recovery and recycling of materials contained within. Your co-operation is vital to make sure the success of these schemes and for the protection of the environment. For your nearest disposal facility, visit [www.recycle-more.co.uk](http://www.recycle-more.co.uk) or ask in store for details.

We reserve the right due to possible changes to design to alter the instruction manual without prior notice.

## Free Manuals Download Website

<http://myh66.com>

<http://usermanuals.us>

<http://www.somanuals.com>

<http://www.4manuals.cc>

<http://www.manual-lib.com>

<http://www.404manual.com>

<http://www.luxmanual.com>

<http://aubethermostatmanual.com>

Golf course search by state

<http://golfingnear.com>

Email search by domain

<http://emailbydomain.com>

Auto manuals search

<http://auto.somanuals.com>

TV manuals search

<http://tv.somanuals.com>