



LCD TV

LA26R7

LA32R7

LA40R7

Contact SAMSUNG WORLD-WIDE

If you have any questions or comments relating to Samsung products, please contact the SAMSUNG customer care centre.

Country	Customer Care Centre ☎	Web Site
AUSTRALIA	1300 362 603	www.samsung.com/au
CHINA	800-810-5858 , 010- 6475 1880	www.samsung.com.cn
HONG KONG	3698 - 4698	www.samsung.com/hk
INDIA	3030 8282 1800 1100 11	www.samsung.com/in
INDONESIA	0800-112-8888	www.samsung.com/id
JAPAN	0120-327-527	www.samsung.com/jp
MALAYSIA	1800-88-9999	www.samsung.com/my
PHILIPPINES	1800-10-SAMSUNG (7267864)	www.samsung.com/ph
SINGAPORE	1800-SAMSUNG (7267864)	www.samsung.com/sg
THAILAND	1800-29-3232 02-689-3232	www.samsung.com/th
TAIWAN	0800-329-999	www.samsung.com/tw
VIETNAM	1 800 588 889	www.samsung.vn
SOUTH AFRICA	0860 7267864 (SAMSUNG)	www.samsung.com/za
U.A.E	800SAMSUNG (7267864) 8000-4726	www.samsung.com/mea

Owner's Instructions

Before operating the unit, please read this manual thoroughly, and retain it for future reference.

ON-SCREEN MENUS
PC DISPLAY
PICTURE IN PICTURE (PIP)
TELETEXT

Register your product at www.samsung.com/global/register
Record your Model and Serial number here for future reference.

• Model _____ • Serial No. _____

BN68-01200C-00

Precautions When Displaying a Still Image

A still image may cause permanent damage to the TV screen.

- Do not display a still image on the LCD panel for more than 2 hours as it can cause screen image retention.

This image retention is also known as "screen burn".

To avoid such image retention, reduce the degree of brightness and contrast of the screen when displaying a still image.

-  Watching the LCD TV in 4:3 format for a long period of time may leave traces of borders displayed on the left, right and center of the screen caused by the difference of light emission on the screen.
Playing a DVD or a game console may cause a similar effect to the screen.
Damages caused by the above effect are not covered by the Warranty.
- Displaying still images from Video games and PC for longer than a certain period of time may produce partial after-images.
To prevent this effect, reduce the 'brightness' and 'contrast' when displaying still images.

© 2007 Samsung Electronics Co., Ltd. All rights reserved.

Contents

CONNECTING AND PREPARING YOUR TV		SETTING THE TIME	
◆ List of Parts	2	◆ Setting and Displaying the Current Time	24
◆ Installing the Stand	2	◆ Setting the Sleep Timer	24
◆ Installing the Wall Mount Kit	2	◆ Switching the Television On and Off Automatically	25
◆ Viewing the Control Panel	3		
◆ Viewing the Connection Panel	4		
◆ Viewing the Remote Control	7		
◆ Installing Batteries in the Remote Control	8		
◆ Switching On and Off	8		
◆ Placing Your Television in Standby Mode	8		
◆ Plug & Play	9		
SETTING THE CHANNELS		FUNCTION DESCRIPTION	
◆ Storing Channels Automatically	10	◆ Choosing Your Language	26
◆ Storing Channels Manually	11	◆ Using Game Mode	26
◆ Setting the Channel Lists	12	◆ Setting the Blue Screen Mode / Selecting the Melody	27
◆ Activating the Child Lock	12	◆ Using the Energy Saving Feature	28
◆ Sorting the Stored Channels	13	◆ HDMI Black Level	28
◆ Assigning Channels Names	13	◆ Selecting the Source	29
◆ Fine Tuning Channel Reception	14	◆ Editing the Input Source Names	29
◆ Changing the Picture Standard	14		
SETTING THE PICTURE		USING THE TELETEXT FEATURE	
◆ Adjusting the Custom Picture	15	◆ Teletext Decoder	30
◆ Changing the Colour Tone	15	◆ Displaying the Teletext Information	30
◆ Changing the Picture Size	16	◆ Selecting a Specific Teletext Page	31
◆ Freezing the Current Picture	17	◆ Using Fastext to Select a Teletext Page	31
◆ Digital NR / DNle	17		
◆ Resetting the Picture Settings to the Factory Defaults	18		
◆ Viewing the Picture In Picture (PIP)	18		
SETTING THE SOUND		SETTING THE PC	
◆ Changing the Sound Standard	20	◆ Setting up Your PC Software (Based on Windows XP)	32
◆ Adjusting the Sound Settings	20	◆ Display Modes	32
◆ Setting the TruSurround XT (SRS TS XT)	21	◆ Setting the PC	33
◆ Adjusting the Volume Automatically	21		
◆ Selecting the Internal Mute	22		
◆ Listening to the Sound of the Sub Picture	22		
◆ Resetting the Sound Settings to the Factory Defaults	23		
◆ Connecting Headphones (LA32R7, LA40R7)	23		
◆ Selecting the Sound Mode	23		
		RECOMMENDATIONS FOR USE	
		◆ Wall-Mount Adjustment (LA40R7) (Sold Separately)	34
		◆ Using the Anti-Theft Kensington Lock	35
		◆ Troubleshooting: Before Contacting Service Personnel	35
		◆ Technical and Environmental Specifications	36



Symbol



Press



Important



Note

One-Touch
Button

List of Parts

Please make sure the following items are included with your LCD TV.
If any items are missing, contact your dealer.

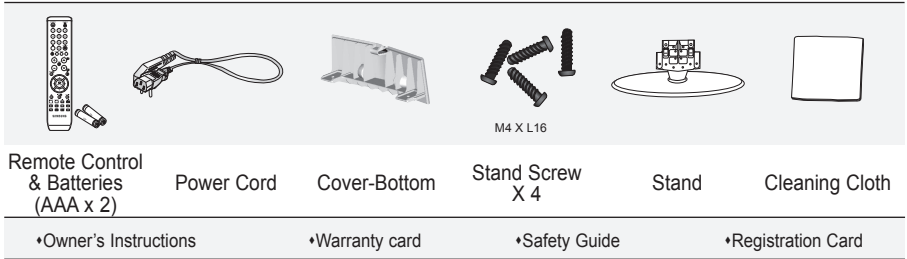

- > Warranty card / Safety Guide / Registration Cards (Not available in all locations)
- > The stand and stand screw may not be included depending on the model.

Installing the Stand

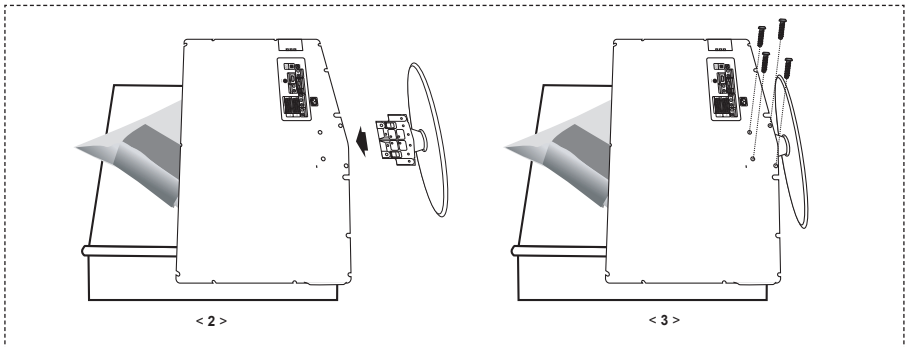

1. Place the TV faced down on a soft cloth or cushion on a table.
 2. Put the stand into the hole at the bottom of the TV.
 3. Insert screw into the hole indicated and tighten.
- > The stand is installed for models with the screen size of 37 inch and above.

Installing the Wall Mount Kit

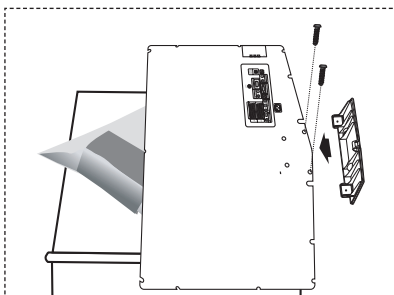

Wall mount items (sold separately) allow you to mount the TV on the wall.
For detailed information on installing the wall mount, see the instructions provided with the Wall Mount items. Contact a technician for assistance when installing the wall mounted bracket.
Samsung Electronics is not responsible for any damage to the product or injury to yourself or others if you elect to install the TV on your own.

- > Remove the stand and cover the bottom hole with a cap and fasten with two screws.

Viewing the Control Panel

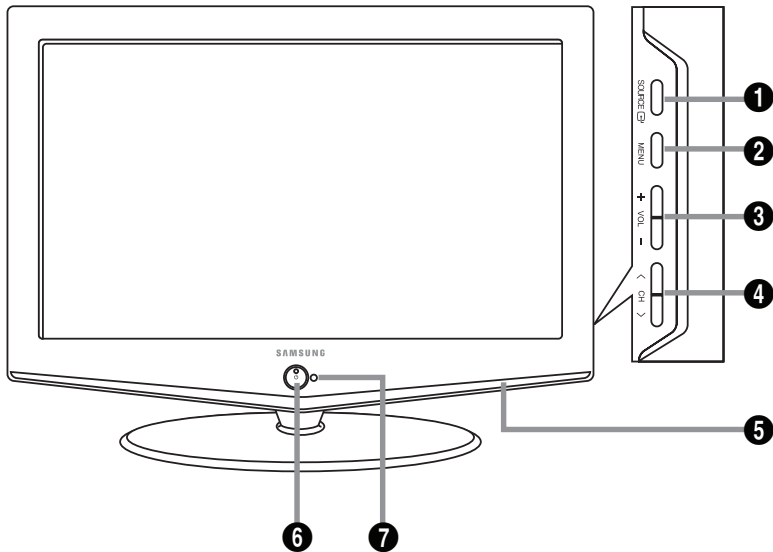

> The product colour and shape may vary depending on the model.

1 SOURCE

Toggles between all the available input sources (TV, AV.1, AV.2, S-Video, Component1, Component2, PC, HDMI1, HDMI2).
In the on-screen menu, use this button as you use the **ENTER** button on the remote control.

2 MENU

Press to see an on-screen menu of your TV's features.

3 + VOL -

Press to increase or decrease the volume.
In the on-screen menu, use the **+ VOL -** buttons as you use the **<** and **>** buttons on the remote control.

4 < CH >

Press to change channels.
In the on-screen menu, use the **< CH >** buttons as you use the **▲** and **▼** buttons on the remote control.
(Without the Remote Control, you can turn on the TV by using the Channel buttons.)

5 Speakers

6 (POWER)

Press to turn the TV on and off.

Power Indicator

Blinks and turns off when the power is on and lights up in stand-by mode.

7 Remote Control Sensor

Aim the remote control towards this spot on the TV.

Viewing the Connection Panel

LA26R7

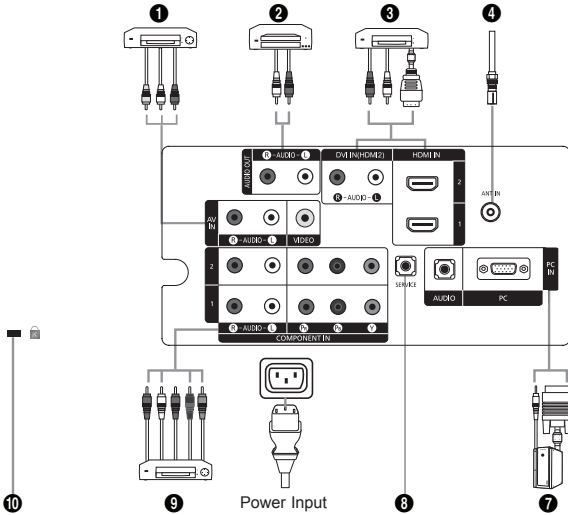

LA32R7, LA40R7

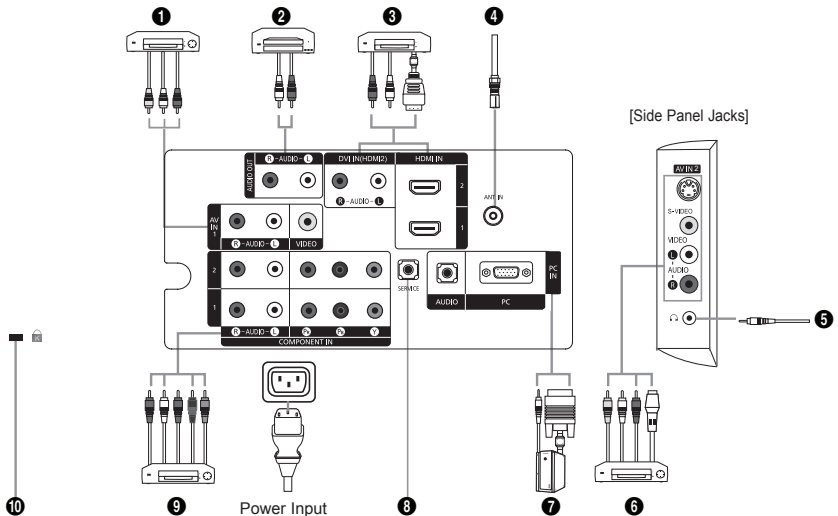

- > Whenever you connect an external device to your TV, make sure that power on the unit is turned off.
- > When connecting an external device, match the colour of the connection terminal to the cable.

1 Connecting External A/V Devices (AV IN/AV IN 1)

- Connect RCA cable to an appropriate external A/V device such as VCR, DVD or Camcorder.
- Connect RCA audio cables to "R - AUDIO - L" on the rear of your set and the other ends to corresponding audio out connectors on the A/V device.

2 Connecting AUDIO

- Connect RCA audio cables to "R - AUDIO - L" on the rear of your set and the other ends to corresponding audio in connectors on the Amplifier or DVD Home Theater.

3 HDMI IN 1, HDMI IN 2

- Supports connections between HDMI-connection-enabled AV devices (Set-Top Boxes, DVD players)
- No additional Audio connection is needed for an HDMI to HDMI connection.

➤ What is HDMI?

- "High Definition Multimedia interface" allows the transmission of high definition digital video data and multiple channels of digital audio (5.1 channels).
- The HDMI/DVI terminal supports DVI connection to an extended device with the appropriate cable (not supplied). The difference between HDMI and DVI is that the HDMI device is smaller in size, has the HDCP (High Bandwidth Digital Copy Protection) coding feature installed, and supports multi - channel digital audio.

DVI IN(HDMI 2)(AUDIO R/L)

- When connecting this product via HDMI or DVI to a Set Top Box, DVD Player or Games Console etc, make sure that it has been set to a compatible video output mode as shown in the table below. Failure to observe this may result in picture distortion, image breakup or no picture.
- When using an HDMI/DVI cable connection, it is only possible from the HDMI IN 2 terminal.
- You should use the DVI-to-HDMI cable or DVI-HDMI Adapter for the connection, and the "R - AUDIO - L" terminal on DVI for sound output.
- Supported modes for HDMI/DVI and Component

	480i	480p	576i	576p	720p	1080i
HDMI/DVI 50Hz	X	X	X	O	O	O
HDMI/DVI 60Hz	X	O	X	X	O	O
Component	O	O	O	O	O	O

4 Connecting an Aerial or Cable Television Network

To view television channels correctly, a signal must be received by the set from one of the following sources:

- An outdoor aerial / A cable television network / A satellite network

6 Connecting External A/V Devices

- Connect RCA or S-VIDEO cable to an appropriate external A/V device such as VCR, DVD or Camcorder.
- Connect RCA audio cables to "R - AUDIO - L" on the rear of your set and the other ends to corresponding audio out connectors on the A/V device.
- Headphone may be connected to the headphone output (5) on the side of your set. While the head phone is connected, the sound from the built-in speakers will be disabled.

7 Connecting Computer

- Connect the D- Sub cable (optional) to "PC (PC IN)" on the rear of your set and the other end to the Video Card of your computer.
- Connect the stereo audio cable (optional) to "AUDIO (PC IN)" on the rear of your set and the other end to "Audio Out" of the sound card on your computer.

8 SERVICE

- Service connection for qualified service engineer.
- Auto Wall-Mount (Refer to page 34)

9 Connecting Component Devices (DVD)

- Connect component video cables (optional) to component connector ("PR", "PB", "Y") on the rear of your set and the other ends to corresponding component video out connectors on the DVD.
- If you wish to connect both the Set-Top Box and DVD, you should connect the Set-Top Box to the DVD and connect the DVD to component connector ("PR", "PB", "Y") on your set.
- The PR, PB and Y connectors on your component devices DVD are sometimes labeled Y, B-Y and R-Y or Y, Cb and Cr.
- Connect RCA audio cables (optional) to "R - AUDIO - L" on the rear of your set and the other ends to corresponding audio out connectors on the DVD.
- This LCD TV displays its optimum picture resolution in 720p mode.
- This LCD TV displays its maximum picture resolution in 1080i mode.

10 Kensington Lock

- The Kensington lock (optional) is a device used to physically fix the system when used in a public place.
- If you want to use a locking device, contact the dealer where you purchased the TV.
- The place of the Kensington Lock may be different depending on its model.

Viewing the Remote Control

- 1 Television Standby button
 - 2 Number buttons for direct channel access
 - 3 One/Two-digit channel selection
 - 4 Selects the TV mode directly
 - 5 Used to display Channel Lists on the screen.
 - 6 \oplus Volume increase
 \ominus Volume decrease
 - 7 Temporary sound switch-off
 - 8 Menu display and change confirmation
 - 9 Sound mode selection
 - 10 Returns to the previous menu.
 - 11 Picture effect selection
 - 12 Adjusts screen brightness to save energy.
 - 13 Sound effect selection
 - 14 SRS TS XT selection
 - 15 Available source selection
 - 16 Previous channel
 - 17 Selects the HDMI mode directly.
 - 18 Automatic Power-off
 - 19 P \ominus : Next channel
P \oplus : Previous channel
 - 20 Exit the OSD
 - 21 Control the cursor in the menu
 - 22 Use to see information on the current broadcast
 - 23 Picture freeze
 - 25 Picture size selection
 - 26 PIP: Picture-In-Picture On/Off
SOURCE: Input source selection
POSITION: PIP position selection
P \square : Next channel
P \square : Previous channel
- ### Teletext Functions
- 4 Exit from the teletext display
 - 8 Teletext index
 - 15 Teletext mode selection (LIST/FLOF)
 - 16 Teletext sub page
 - 19 P \ominus : Teletext next page
P \oplus : Teletext previous page
 - 20 Teletext cancel
 - 22 Teletext reveal
 - 24 Alternately select Teletext, Double, or Mix.
 - 9 11 23 25 Fasttext topic selection
 - 26 PIP: Teletext Hold
 - 26 SOURCE: Teletext Store
 - 26 POSITION: Teletext size selection

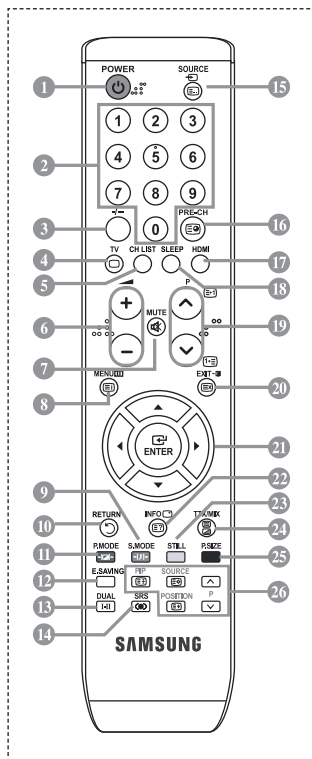

- > The performance of the remote control may be affected by bright light.
- > This is a special remote control for the visually impaired, and has Braille points on the Power, Channel and Volume buttons.

Installing Batteries in the Remote Control

1. Lift the cover at the back of the remote control upward as shown in the figure.
 2. Install two AAA size batteries.
 - > Make sure to match the "+" and "-" ends of the batteries with the diagram inside the compartment.
 3. Replace the cover.
 - > Remove the batteries and store them in a cool, dry place if you won't be using the remote control for a long time. The remote control can be used up to about 23 feet from the TV.
(Assuming typical TV usage, the batteries last for about one year.)
- > If the remote control doesn't work, check the following:
1. Is the TV power on?
 2. Are the plus and minus ends of the batteries reversed?
 3. Are the batteries drained?
 4. Is there a power outage, or is the power cord unplugged?
 5. Is there a special fluorescent light or neon sign nearby?

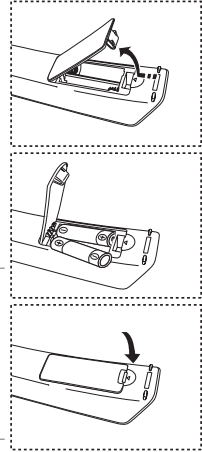

Switching On and Off

The mains lead is attached to the rear of your set.

1. Plug the mains lead into an appropriate socket.
 - > The standby indicator lights up on the front of the set.
2. Press the ϕ button on the front of the set.
 - > You also can press the **POWER** ϕ button or the **TV** button on the remote control to turn the TV on.
 - > The programme that you were watching last is reselected automatically.
3. Press the numeric button (0~9) or channel up/down (\odot/\ominus) button on the remote control or **< CH >** button on the right side of the set.
 - > When you switch the set on for the very first time, you will be asked to choose language in which the menus are to be displayed.
4. To switch your set off, press the **POWER** ϕ button again.

Placing Your Television in Standby Mode

Your set can be placed in standby mode in order to reduce the power consumption. The standby mode can be useful when you wish to interrupt viewing temporarily (during a meal, for example).

1. Press the **POWER** ϕ button on the remote control.
 - > The screen is turned off and a red standby indicator appears on the front of your set.
2. To switch your set back on, simply press the **POWER** ϕ , numeric buttons (**0~9**), **TV** button or channel up/down (\odot/\ominus) button again.
 - > Do not leave your set in standby mode for long periods of time (when you are away on holiday, for example). It is best to unplug the set from the mains and aerial.

Plug & Play

When the TV is initially powered on, several basic settings proceed automatically and subsequently. The following settings are available.



1. Press the **POWER** button on the remote control.
The message "Start Plug & Play" is displayed with "OK" selected.
2. Select the appropriate language by pressing the **▲** or **▼** button.
Press the **ENTER** button to confirm your choice.
3. Press the **◀** or **▶** buttons to select "Shop" or "Home", then the **ENTER** button.
 - > We recommend setting the TV to Home mode for the best picture in your home environment.
 - > Shop mode is only intended for use in retail environments.
 - > If the unit is accidentally set to Shop mode and you want to return to Dynamic (Home) mode, press the Volume button and then hold down the **MENU** button for five seconds on the side panel of the TV.
4. The message "Check antenna input." is displayed with "OK" selected.
Press the **ENTER** button.
 - > Please check that the antenna cable is connected correctly.
5. Select the appropriate Area by pressing the **▲** or **▼** button.
Press the **ENTER** button to confirm your choice.
6. The "Auto Store" menu is displayed with the "Start" selected. Press the **ENTER** button.
 - > The channel search will start and end automatically.
 - > After all the available channels are stored, the "Clock Set" menu appears.
 - > Press the **ENTER** button at any time to interrupt the memorization process.
7. Press the **ENTER** button.
Select the "Month", "Day", "Year", "Hour", "Minute" and "am/pm" by pressing the **◀** or **▶** button..
Set the "Month", "Day", "Year", "Hour", "Minute" and "am/pm" by pressing the **▲** or **▼** button.
 - > You can also set the hour and minute by pressing the number buttons on the remote control.When you have finished, press the **ENTER** button
The message "Enjoy your viewing" is displayed.
8. Press the **ENTER** button to confirm your setting.

- ♦ **Language:** Select your language.
- ♦ **Area :** Select your country.
- ♦ **Auto Store:** Automatically scans for and stores channels available in the local area.
- ♦ **Clock Set:** Sets the current time for the TV clock.

If you want to reset this feature...

1. Press the **MENU** button to display the menu.
Press the **▲** or **▼** button to select "Setup", then press the **ENTER** button.
2. Press the **ENTER** button again, to select "Plug & Play".
3. The message to "Start Plug & Play" is displayed.
(On page 9)

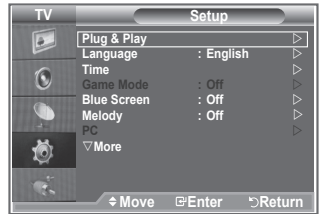

- Storing Channels Automatically
- Storing Channels Manually



Storing Channels Automatically

You can scan for the frequency ranges available to you (and availability depends on your country). Automatically allocated programme numbers may not correspond to actual or desired programme numbers. However, you can sort numbers manually and clear any channels you do not wish to watch.

1. Press the **MENU** button to display the menu.
Press the **▲** or **▼** button to select "Channel", then press the **ENTER** button.
2. Press the **ENTER** button to select "Area".
3. Select the appropriate area by pressing the **▲** or **▼** button.
Press the **ENTER** button to confirm your choice.
4. Press the **▲** or **▼** button to select "Auto Store" then press the **ENTER** button.
5. Press the **ENTER** button.
 - The TV will begin memorizing all of the available channels.
 - Press the **ENTER** button at any time to interrupt the memorization process and return to the "Channel" menu.
6. After all the available channels are stored, the "Sort" menu appears.

Storing Channels Manually

You can store up to 100 channels, including those received via cable networks. When storing channels manually, you can choose:

◆ Whether or not to store each of the channels found.

◆ The programme number of each stored channel which you wish to identify.

1. Press the **MENU** button to display the menu. Press the **▲** or **▼** button to select "Channel", then press the **ENTER** button.
2. Press the **▲** or **▼** button to select "Manual Store", then press the **ENTER** button.
3. Press the **ENTER** button to select "Programme".
4. To assign a programme number to a channel, find the correct number by pressing the **▲** or **▼** button and then press the **ENTER** button.
 - > You can also set a programme number by pressing number buttons on the remote control.
5. Press the **▲** or **▼** button to select "Colour System", then press the **ENTER** button.
6. Select the colour standard required by pressing the **▲** or **▼** button then, press the **ENTER** button.
7. Press the **▲** or **▼** button to select "Sound System", then press the **ENTER** button.
8. Select the sound standard required by pressing the **▲** or **▼** button, then press the **ENTER** button.
 - > If there is an abnormal sound or no sound, re-select the sound system required.
9. If you know the number of the channel to be stored, press the **▲** or **▼** button to select "Channel". Press the **ENTER** button. Select **C** (Air channel) or **S** (Cable channel) by pressing the **▲** or **▼** button. Press the **►** button to select channel. Select the required number by pressing the **▲** or **▼** button and then press the **ENTER** button.
 - > Channel mode: **P** (Programme mode), **C** (Air channel mode), **S** (Cable channel mode)
 - > You can also set a channel number by pressing number buttons on the remote control.
10. If you do not know the channel numbers, press the **▲** or **▼** button to select "Search". Press the **ENTER** button. Search by pressing the **▲** or **▼** button and then press the **ENTER** button.
11. Press the **▲** or **▼** button to select "Store". Press the **ENTER** button to select "OK".
12. Repeat steps **3** to **11** for each channel to be stored.

- ◆ **Programme:** Selects a program number for the channel.
- ◆ **Colour System:** Sets the colour supporting system.
- ◆ **Sound System:** Sets the sound supporting system.
- ◆ **Channel:** Selects a channel.
- ◆ **Search:** Scans for the frequency value for the channel.
- ◆ **Store:** Saves your settings.

Setting the Channel Lists

Set the channels according to your preference.
You can easily delete, add, or lock the channel you want.

1. Press the **MENU** button to display the menu.
Press the **▲** or **▼** button to select "Channel", then press the **ENTER** button.
2. Press the **▲** or **▼** button to select "Channel Manager", then press the **ENTER** button.
3. Press the **ENTER** button again, to select "Channel List".
4. Press the **▶** button to select "⊕" line.
5. Press the **▲** or **▼** button to select the undesired channel, then press the **ENTER** button to cancel.
6. Repeat steps 5 for each channel to be selected or canceled
7. Press the **EXIT** button to exit.
➤ "🔒" is active when "Child Lock" is selected to "On".

 You can select these options by simply pressing the **CH LIST** button on the remote control.

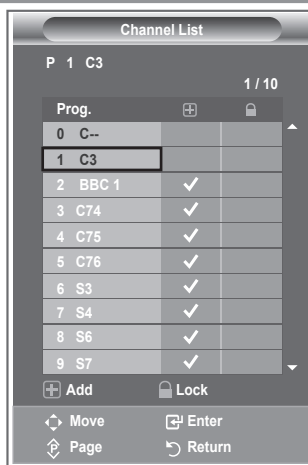

Activating the Child Lock

This feature allows you to prevent unauthorized users, such as children, from watching unsuitable programmes by muting out video and audio.

Child Lock cannot be released using the buttons on the side. Only the remote control can release the Child Lock setting, so keep the remote control away from children.

1. Press the **MENU** button to display the menu.
Press the **▲** or **▼** button to select "Channel", then press the **ENTER** button.
2. Press the **▲** or **▼** button to select "Channel Manager", then press the **ENTER** button.
3. Press the **▲** or **▼** button to select "Child Lock", then press the **ENTER** button.
4. Press the **▲** or **▼** button to select "On" or "Off". Press the **ENTER** button.
5. Press the **▲** or **▼** button to select "Channel List", then press the **ENTER** button.
6. Press the **▶** button to select "🔒" line.
7. Press the **▲** or **▼** button to select the channels you want to lock, then press the **ENTER** button.
8. Repeat steps 7 for each channel to be locked or unlocked.
9. Press the **EXIT** button to exit.
➤ Select "On" or "Off" in "Child Lock" to easily turn the channels which selected on "🔒" to be active or inactive.

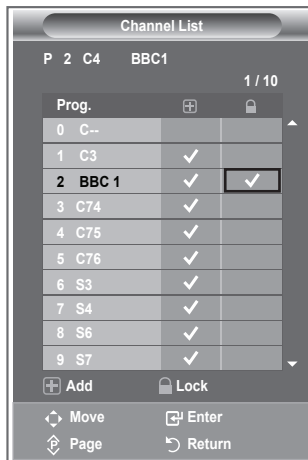

Sorting the Stored Channels

You can exchange the numbers of two channels, in order to:

- ◆ **Modify the numeric order in which the channels have been automatically stored.**
 - ◆ **Give easily remembered numbers to the channels that you watch most often.**
1. Press the **MENU** button to display the menu. Press the **▲** or **▼** button to select "Channel", then press the **ENTER** button.
 2. Press the **▲** or **▼** button to select "Sort", then press the **ENTER** button.
 3. Select the channel number that you wish to change by pressing the **▲** or **▼** button repeatedly. Press the **ENTER** button.
 - The selected channel number and name are moved to right side.
 4. Press the **▲** or **▼** button to move to the position in which you would like to change and then press the **ENTER** button.
 - The selected channel is exchanged with the one previously stored to the chosen number.
 5. Repeat steps **3** to **4** for another channel to be sorted.
 6. Press the **EXIT** button to exit.

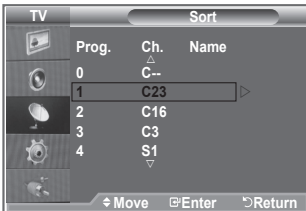

Assigning Channels Names

Channel names will be assigned automatically when channel information is broadcast. These names can be changed, allowing you to assign new names.

1. Press the **MENU** button to display the menu. Press the **▲** or **▼** button to select "Channel", then press the **ENTER** button.
2. Press the **▲** or **▼** button to select "Name", then press the **ENTER** button.
3. If necessary, select the channel to be assigned to a new name by pressing the **▲** or **▼** button. Press the **ENTER** button.
 - The selection bar is displayed around the name box.

4. To...	Then...
Select a letter, number or symbol	Press the ▲ or ▼ button
Move on the next letter	Press the ▶ button
Move back the previous letter	Press the ◀ button
Confirm the name	Press the ENTER button

- The characters available are : Letters of the alphabet (A~Z) / Numbers (0~9) / Special characters (+, -, *, / , Blank)
5. Repeat steps **3** to **4** for each channel to be assigned to a new name.
 6. Press the **EXIT** button to exit.

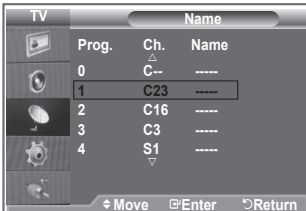

Fine Tuning Channel Reception

Use fine tuning to manually adjust a particular channel for optimal reception.

1. Use the number buttons to directly select the channel that you want to fine tune.
2. Press the **MENU** button to display the menu. Press the **▲** or **▼** button to select "Channel", then press the **ENTER** button.
3. Press the **▲** or **▼** button to select "Fine Tune", then press the **ENTER** button.
4. Press the **◀** or **▶** button to adjust the fine tuning. Press the **ENTER** button.
5. Press the **EXIT** button to exit.
 - Fine tuned channels that have been saved are marked with an asterisk "*" on the right-hand side of the channel number in the channel banner. And the channel number turns red.
 - To reset the fine-tuning, select "Reset" by pressing the **▲** or **▼** button and then press the **ENTER** button.



Changing the Picture Standard

You can select the type of picture which best corresponds to your viewing requirements.

1. Press the **MENU** button to display the menu. Press the **ENTER** button to select "Picture".
2. Press the **ENTER** button again, to select "Mode".
3. Press the **▲** or **▼** button to select the desired picture effect. Press the **ENTER** button.
4. Press the **EXIT** button to exit.

- **Dynamic:** Selects the picture for high-definition in a bright room.
- **Standard:** Selects the picture for optimum display in a normal environment.
- **Movie:** Selects the picture for comfortable display in a dark room.

- The Picture mode must be adjusted separately for each input source.
- You can return to the factory defaults picture settings by selecting the "Reset". (Refer to "Resetting the Picture Settings to the Factory Defaults" on page 18)

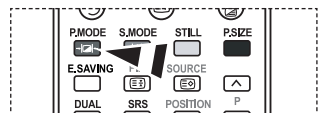
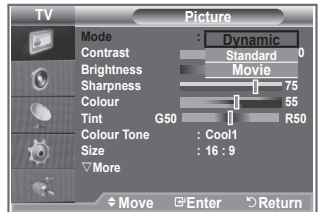
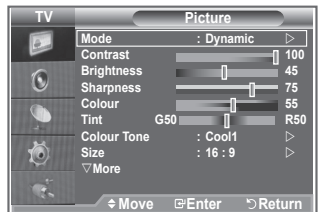

You can also press the **P.MODE** button on the remote control to select one of the picture settings.

Adjusting the Custom Picture

Your set has several settings which allow you to control picture quality.

1. To select the desired picture effect, follow the "Changing the Picture Standard" instructions number 1 to 3.
2. Press the ▲ or ▼ button to select a particular item. Press the **ENTER** button.
3. Press the ◀ or ▶ button to decrease or increase the value of a particular item. Press the **ENTER** button.
4. Press the **EXIT** button to exit.

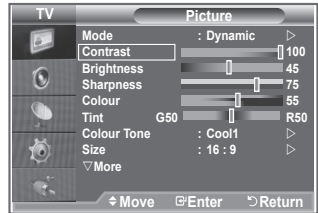

- ♦ **Contrast:** Adjusts the lightness and darkness between objects and the background.
- ♦ **Brightness:** Adjusts the brightness of the whole screen.
- ♦ **Sharpness:** Adjusts the outline of objects to either sharpen them or make them more dull.
- ♦ **Colour:** Adjusts the colours, making them lighter or darker.
- ♦ **Tint:** Adjusts the colour of objects, making them more red or green for a more natural look.

- The adjusted values are stored according to the selected Picture mode.
- In PC Mode, Only "Contrast", "Brightness" can be adjusted.
- In TV, AV, S-Video modes of the PAL system, you cannot use the Tint function.

Changing the Colour Tone

You can select the most comfortable colour tone to your eyes.

1. To select the desired picture effect, follow the "Changing the Picture Standard" instructions number 1 to 3. (on page 14)
2. Press the ▲ or ▼ button to select "Colour Tone", then press the **ENTER** button.
3. Press the ▲ or ▼ button to select the desired colour tone setting. Press the **ENTER** button.
4. Press the **EXIT** button to exit

- ♦ **Cool2:** Makes the colour temperature bluer than "Cool1" menu.
- ♦ **Cool1:** Makes whites bluish.
- ♦ **Normal:** Keeps whites white.
- ♦ **Warm1:** Makes whites reddish.
- ♦ **Warm2:** Makes the colour temperature redder than "Warm1" menu.

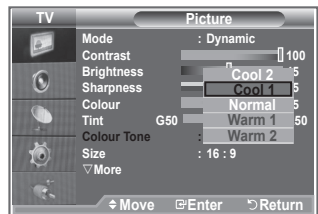
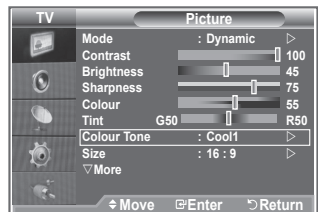



- The adjusted values are stored according to the selected Picture mode.
- When the picture mode is set to Dynamic or Standard, Warm1 and Warm2 cannot be selected.

Changing the Picture Size

You can select the picture size which best corresponds to your viewing requirements.

1. Press the **MENU** button to display the menu.
Press the **ENTER** button, to select "Picture".
2. Press the **▲** or **▼** button to select "Size", then press the **ENTER** button.
3. Select the required option by pressing the **▲** or **▼** button.
Press the **ENTER** button.
4. Press the **EXIT** button to exit.

- ♦ **16:9**: Adjusts the picture size to 16:9 appropriate for DVDs or wide broadcasting.
- ♦ **Wide Zoom**: Magnify the size of the picture more than 4:3.
- ♦ **Zoom**: Magnifies the 16:9 wide picture (in the vertical direction) to fit the screen size.
- ♦ **4:3**: This is the default setting for a video movie or normal broadcasting.
- ♦ **Just Scan (HDMI only)**: Displays the input scenes as they are without any cutoff when 720p, 1080i signals are input.

- > "Wide Zoom" function is available only in "TV", "AV1", "AV2", and "S-Video" mode.
- > In PC Mode, only "16:9" and "4:3" mode can be adjusted.
- > Zoom: Select  by pressing the **◀** or **▶** buttons.
Use the **▲** or **▼** button to move the picture up and down. After selecting , use the **▲** or **▼** button to magnify or reduce the picture size in the vertical direction.
- > Wide Zoom : Move the screen up/down using the **▲** or **▼** buttons after selecting the  by pressing the **▶** or **ENTER** button.

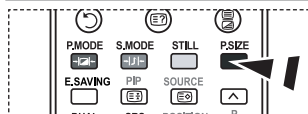
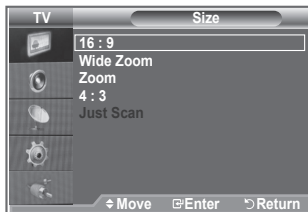
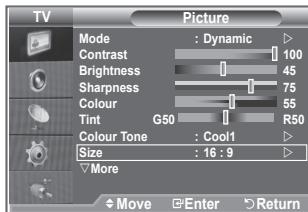

You can select these options by simply pressing the **P.SIZE** button on the remote control.

Freezing the Current Picture

Press the **STILL** button to freeze a moving picture into a still one. Press again to cancel.

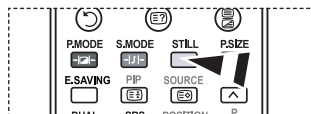

Digital NR / DNle

If the broadcast signal received by your TV is weak, you can activate the Digital Noise Reduction feature to help reduce any static and ghosting that may appear on the screen.

1. Press the **MENU** button to display the menu. Press the **ENTER** button, to select "Picture".
2. Select the required option by pressing the **▲** or **▼** button, then press the **ENTER** button.
Available options: Digital NR, DNle.
3. When you are satisfied with your setting, press the **ENTER** button.
4. Press the **EXIT** button to exit.

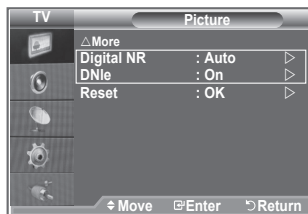

◆ Digital NR: Off/Low/Medium/High/Auto

If the signal received by the television is weak, you can activate this feature to reduce any static and ghosting that may appear on the screen.

- This function is not available in PC mode.

◆ DNle : Off/Demo/On

This TV includes the DNle function so as to provide a high visual quality. If you set DNle to on, you can view the screen with the DNle feature activated. If you set the DNle to Demo, you can view the applied DNle and normal pictures on the screen, for demonstration purposes. Using this function, you can view the difference in the visual quality.

- DNle™ (Digital Natural Image engine) **DNle™**

This feature brings you more detailed image with 3D noise reduction, detail enhancement, contrast enhancement and white enhancement. New image compensation Algorithm gives brighter, clearer, more detailed image to you. DNle™ technology will fit every signal into your eyes.

- This function is not available in PC mode.
- This function is not available in Movie mode

Resetting the Picture Settings to the Factory Defaults

You can return to the factory defaults picture settings.

1. To select the desired picture effect, follow the "Changing the Picture Standard" instructions number 1 to 3 (on page 14.)
2. Press the ▲ or ▼ button to select "Reset", then press the **ENTER** button.
3. Press the ▲ or ▼ button to select "OK", "Cancel", then press the **ENTER** button.
4. Press the **EXIT** button to exit.
 - > The "Reset" will be set for each picture mode.

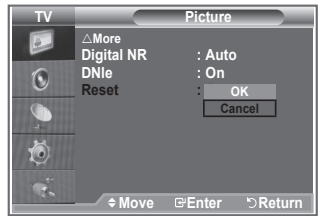

Viewing the Picture In Picture (PIP)

You can display a sub picture within the main picture of set programme or video input. In this way, you can watch the picture of set programme or video input from any connected equipment while watching the main picture.

1. Press the **MENU** button to display the menu. Press the ▲ or ▼ button to select "Setup", then press the **ENTER** button.
2. Press the ▲ or ▼ button to select "PIP", then press the **ENTER** button.
3. Press the **ENTER** button again. Press the ▲ or ▼ button to select "On", then press **ENTER** button.
4. Press the ▲ or ▼ button to select "Source", then press **ENTER** button. Select a source of the sub picture by pressing the ▲ or ▼ button and press the **ENTER** button.
 - > The sub picture can serve different source selections based on what the main picture is set to.
5. Press the ▲ or ▼ button to select "Size" of the sub picture and then press the **ENTER** button. Select a size of the sub picture by pressing the ▲ or ▼ button and then press the **ENTER** button.
 - > If main picture is in "Component" and "PC" mode, "Size" is not available.

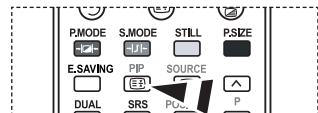
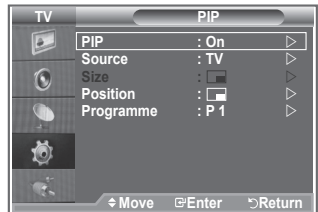
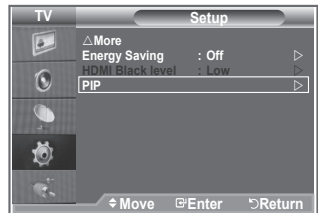

Press the **PIP** button on the remote control repeatedly to activate or deactivate the "PIP".

6. Press the ▲ or ▼ button to select "Position", then press the **ENTER** button.
Select the position of the sub picture by pressing the ▲ or ▼ button and then press the **ENTER** button.
 7. Press the ▲ or ▼ button to select "Programme" and then press the **ENTER** button.
You can select the channel that you want to view through sub picture by pressing the ▲ or ▼ button. Press the **ENTER** button.
➢ The "Programme" can be active when the sub picture is set to TV.
 8. Press the **EXIT** button to exit.
- You may notice that the picture in the PIP window becomes slightly unnatural when you use the main screen to view a game or karaoke.

- ♦ **Source:** Used to select a source of the sub picture.
- ♦ **Size:** Used to select a size of the sub picture.
- ♦ **Position:** Used to move the sub picture.
- ♦ **Programme:** Used to Change the sub picture.

PIP Settings

O: PIP operates, **X:** PIP doesn't operate

Main \ Sub	TV	AV1	AV2	S-Video	Component1,2	PC	HDMI1,2
Component	O	O	O	X	X	X	X
HDMI	O	O	O	X	X	X	X
PC	O	O	O	X	X	X	X

Changing the Sound Standard

You can select the type of the special sound effect to be used when watching a given broadcast.

1. Press the **MENU** button to display the menu.
Press the **▲** or **▼** button to select "Sound", then press the **ENTER** button.
2. Press the **ENTER** button again, to select "Mode".
3. Select the required sound effect by pressing the **▲** or **▼** button repeatedly and then press the **ENTER** button.
4. Press the **EXIT** button to exit.

- ♦ **Standard:** Selects the normal sound mode.
- ♦ **Music:** Emphasizes music over voices.
- ♦ **Movie:** Provides live and full sound for movies.
- ♦ **Speech:** Emphasizes voices over other sounds.
- ♦ **Custom:** Selects your custom sound settings.
(Refer to "Adjusting the Sound Settings")

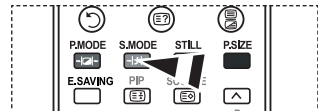
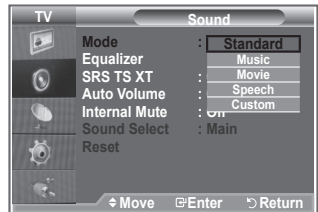
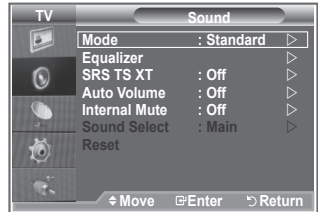

You can also select these options by simply pressing the **S.MODE** button on the remote control.

Adjusting the Sound Settings

The sound settings can be adjusted to suit your personal preferences.

1. Press the **MENU** button to display the menu.
Press the **▲** or **▼** button to select "Sound", then press the **ENTER** button.
 2. Press the **▲** or **▼** button to select "Equalizer", then press the **ENTER** button.
 3. Press the **◀** or **▶** button to select a particular item.
Press the **ENTER** button.
 4. Press the **▲** or **▼** button to reach the required setting.
Press the **ENTER** button.
 5. Press the **EXIT** button to exit.
- If you make any changes to these settings, the Sound Mode is automatically switched to "Custom".

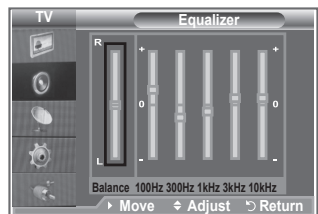
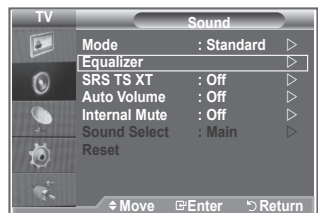

Setting the TruSurround XT (SRS TS XT)

TruSurround XT is a patented SRS technology that solves the problem of playing 5.1 multichannel content over two speakers. TruSurround delivers a compelling, virtual surround sound experience through any two-speaker playback system, including internal television speakers. It is fully compatible with all multichannel formats.

1. Press the **MENU** button to display the menu. Press the **▲** or **▼** button to select "Sound", then press the **ENTER** button.
2. Press the **▲** or **▼** button to select "SRS TS XT", then press the **ENTER** button.
3. Press the **▲** or **▼** button to select "On" or "Off". Press the **ENTER** button.
4. Press the **EXIT** button to exit.



TruSurround XT, SRS and  symbol are trademarks of SRS Labs, Inc. TruSurround XT technology is incorporated under license from SRS Labs, Inc.

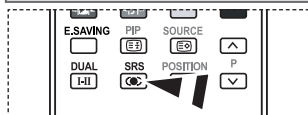
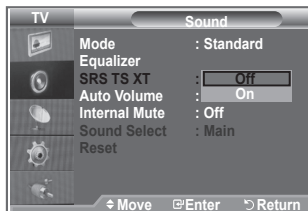
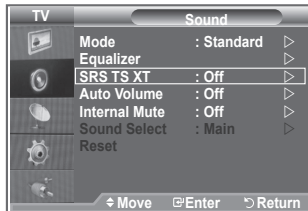

You can also set these options simply by pressing the **SRS** button on remote control.

Adjusting the Volume Automatically

Each broadcasting station has its own signal conditions, and so it is not easy for you to adjust the volume every time the channel is changed. This feature allows you to automatically adjust the volume of the desired channel by lowering the sound output when the modulation signal is high or by raising the sound output when the modulation signal is low.

1. Press the **MENU** button to display the menu. Press the **▲** or **▼** button to select "Sound", then press the **ENTER** button.
2. Press the **▲** or **▼** button to select "Auto Volume", then press the **ENTER** button.
3. Press the **▲** or **▼** button to select "On" or "Off". Press the **ENTER** button.
4. Press the **EXIT** button to exit.

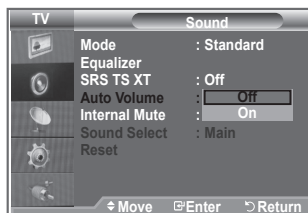
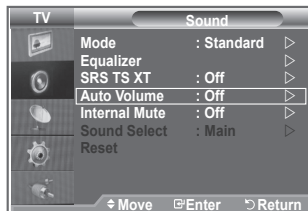

Selecting the Internal Mute

If you want to hear the sound through separate speakers, cancel the internal amplifier.

1. Press the **MENU** button to display the menu.
Press the **▲** or **▼** button to select "Sound", then press the **ENTER** button.
2. Press the **▲** or **▼** button to select "Internal Mute", then press the **ENTER** button.
3. Press the **▲** or **▼** button to select "On" or "Off". Press the **ENTER** button.
4. Press the **EXIT** button to exit.
 - > When "Internal Mute" is set to "On", the Sound menus except for "Sound Select" (in PIP mode) cannot be adjusted.

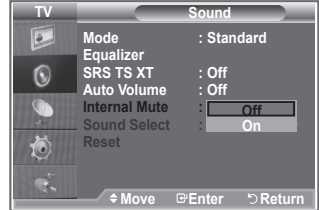
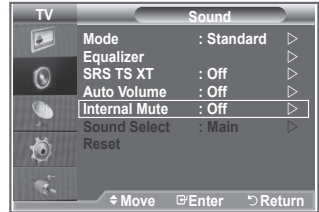

Listening to the Sound of the Sub Picture

During the PIP features activation, you can listen to the sound of the sub picture.

1. Press the **MENU** button to display the menu.
Press the **▲** or **▼** button to select "Sound", then press the **ENTER** button.
2. Press the **▲** or **▼** button to select "Sound Select", then press the **ENTER** button.
3. Press the **▲** or **▼** button to select "Main".
Press the **ENTER** button.
4. Press the **EXIT** button to exit.

- **Main** : Used to listen to the sound of the main picture.
- **Sub** : Used to listen to the sound of the sub picture.

> You can select this option when the "PIP" is set to "On".

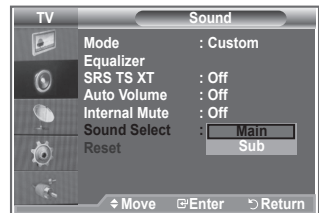
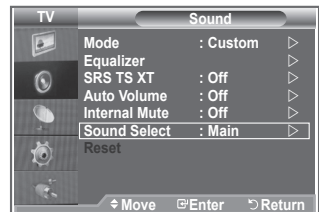

Resetting the Sound Settings to the Factory Defaults

If Game Mode is On, the Reset Sound function is activated. Selecting the Reset function after setting the equalizer resets the equalizer setting to the factory defaults.

1. Press the **MENU** button to display the menu.
Press the **▲** or **▼** button to select "Sound", then press the **ENTER** button.
2. Press the **▲** or **▼** button to select "Reset", then press the **ENTER** button.
3. Press the **EXIT** button to exit.
 - > You can select this option when the "Game Mode" is set to "On".

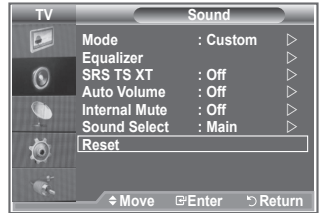

Connecting Headphones (LA32R7, LA40R7)

You can connect a set of headphones to your set if you wish to watch a TV programme without disturbing the other people in the room.

- > When you insert the head set jack into the corresponding port, you can operate only "Auto Volume" in Sound menu.
- > Prolonged use of headphones at a high volume may damage your hearing.
- > You will not receive sound from the speakers when you connect headphones to the system.
- > The headphone volume and TV volume are adjusted differently.



Selecting the Sound Mode

You can set the sound mode by pressing the "DUAL" button. When you press it, the current sound mode is displayed on the screen.

	Audio Type	DUAL 1/2	Default
A2 Stereo	Mono	MONO	Automatic change
	Stereo	STEREO ↔ MONO	
	Dual	DUAL 1 ↔ DUAL 2	DUAL 1
NICAM Stereo	Mono	MONO	Automatic change
	Stereo	MONO ↔ STEREO	
	Dual	MONO ↔ DUAL 1 DUAL 2 ↔	DUAL 1

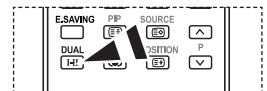

- > You can also set these options simply by pressing the **DUAL** button on remote control.

- > If the stereo signal is weak and an automatic switching occurs, then switch to the Mono.
- > This function is only activated in stereo sound signal. It is deactivated in mono sound signal.

Setting and Displaying the Current Time

You can set the TV's clock so that the current time is displayed when you press the INFO button. You must also set the time if you wish to use the automatic On/Off timers.

1. Press the **MENU** button to display the menu. Press the **▲** or **▼** button to select "Setup", then press the **ENTER** button.
2. Press the **▲** or **▼** button to select "Time", then press the **ENTER** button.
3. Press the **ENTER** button to select "Clock Set".

To...	Press the...
Move to Month, Day, Year, Hour, Minute or am/pm	◀ or ▶ button.
Set the Month, Day, Year, Hour Minute or am/pm	▲ or ▼ button.
Press the ENTER button.	

5. Press the **EXIT** button to exit.
 - If you disconnect the power cord, you have to set the clock again.
 - You can also set Year, Month, Day, Hour and Minute by pressing the number buttons on the remote control.

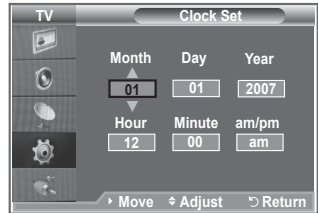
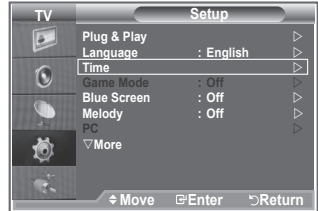

Setting the Sleep Timer

You can select a time period of between 30 and 180 minutes after which the television automatically switches to standby mode.

1. Press the **MENU** button to display the menu. Press the **▲** or **▼** button to select "Setup", then press the **ENTER** button.
2. Press the **▲** or **▼** button to select "Time", then press the **ENTER** button.
3. Press the **▲** or **▼** button to select "Sleep Timer", then press the **ENTER** button.
4. Press the **▲** or **▼** button dly until the desired time appears (Off, 30, 60, 90, 120, 150, 180). Press the **ENTER** button.
5. Press the **EXIT** button to exit.
 - The TV automatically switches to standby mode when the timer reaches 0.

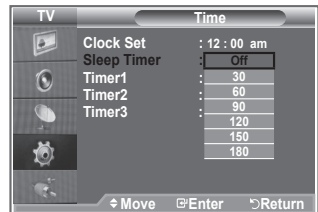

Switching the Television On and Off Automatically

1. Press the **MENU** button to display the menu.
Press the **▲** or **▼** buttons to select "Setup", then press the **ENTER** button.
Press the **▲** or **▼** buttons to select "Time", then press the **ENTER** button.
2. Press the **▲** or **▼** buttons to select "Timer 1,Timer 2,Timer 3", then press the **ENTER** button.
3. Press the **▲** or **▼** buttons to adjust "Hour", then press the **▶** button to move to the next step.
Set other items using the same method as above.

	Yes/No	Press the ▲ or ▼ button
Repeat	Select a Once, Everyday, Mon~Fri, Mon~Sat, Sat~Sun	Press the ▲ or ▼ button
Volume	Adjust a 0~100	Press the ▲ or ▼ button
Programme	Adjust a Programme	Press the ▲ or ▼ button

➤ When finished, press the **RETURN** button to return.

- The current time will appear every time you press the **INFO** button.
- You can set the hour, minute directly by pressing the number buttons on the remote control.
Press the **EXIT** button to exit.

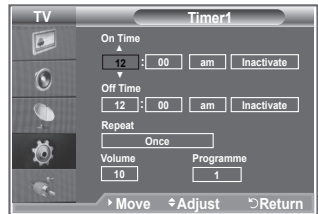
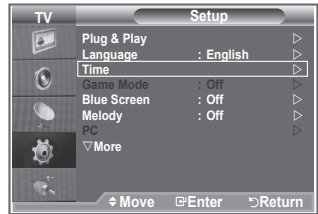

Choosing Your Language

When you start using your set for the first time, you must select the language which will be used for displaying menus and indications.

1. Press the **MENU** button to display the on-screen menu. Press the **▲** or **▼** button to select "Setup", then press the **ENTER** button.
2. Press the **▲** or **▼** button to select "Language", then press the **ENTER** button.
3. Select a particular language by pressing the **▲** or **▼** button repeatedly. Press the **ENTER** button.
 - > You can choose one of 5 languages.
4. Press the **EXIT** button to exit.

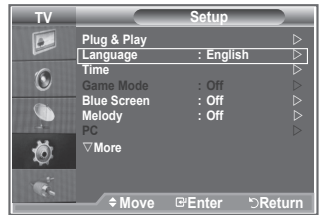

Using Game Mode

When connecting to a game console such as PlayStation™ or Xbox™, you can enjoy a more realistic gaming experience by selecting game menu.

1. Press the **MENU** button to display the menu. Press the **▲** or **▼** button to select "Setup", then press the **ENTER** button.
2. Press the **▲** or **▼** button to select "Game Mode", then press the **ENTER** button.
3. Press the **▲** or **▼** button to select "On" or "Off". Press the **ENTER** button.
4. Press the **EXIT** button to exit.
 - > To disconnect the game console and connect another external device, cancel game mode in the setup menu.
 - > If you display the TV menu in Game mode, the screen shakes slightly.
 - > Game Mode is not available in TV mode.
 - > If Game Mode is On:
 - Picture Mode changes to Standard and Sound Mode changes to Custom automatically. The user cannot change these to other modes.
 - Sound Mode in the Sound menu is deactivated. Adjust the sound using the equalizer.
 - The Reset Sound function is activated. Selecting the Reset function after setting the equalizer resets the equalizer setting to the factory defaults.

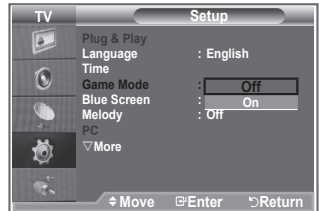
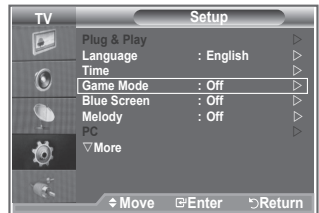

Setting the Blue Screen Mode / Selecting the Melody

Blue Screen:

If no signal is being received or the signal is very weak, a blue screen automatically replaces the noisy picture background. If you wish to continue viewing the poor picture, you must set the "Blue Screen" mode to "Off".

Melody:

You can hear melody sound when the television is powered on or off.

1. Press the **MENU** button to display the menu.
Press the **▲** or **▼** button to select "Setup", then press the **ENTER** button.
2. Press the **▲** or **▼** button to select "Blue Screen" or "Melody".
Press the **ENTER** button.
3. When you are satisfied with your setting, press the **ENTER** button.
 - ◆ **Blue Screen: Off/On**
 - ◆ **Melody: Off/Low/Medium/High**
4. Press the **EXIT** button to exit.

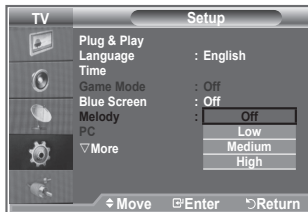
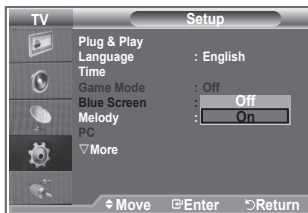

Using the Energy Saving Feature

This function adjusts the brightness of the TV so as to reduce power consumption. When you watching TV at night, set the "Energy Saving" mode option to "High" so as to reduce the dazzling of your eyes as well as the power consumption.

1. Press the **MENU** button to display the on-screen menu. Press the **▲** or **▼** button to select "Setup", then press the **ENTER** button.
2. Press the **▲** or **▼** button to select "Energy Saving", then press the **ENTER** button.
3. Select the required option (Off, Low, Medium, High, Auto) by pressing the **▲** or **▼** button. Press the **ENTER** button.
4. Press the **EXIT** button to exit.

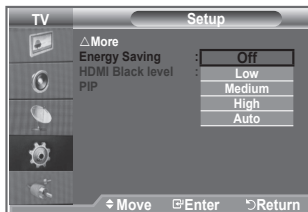
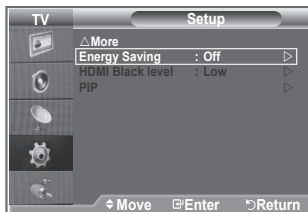

HDMI Black Level

You can directly select the black level on the screen to adjust the screen depth.

1. Press the **MENU** button to display the menu. Press the **▲** or **▼** buttons to select "Setup", then press the **ENTER** button.
2. Press the **▲** or **▼** buttons to select "HDMI Black Level", then press the **ENTER** button.
3. Press the **▲** or **▼** buttons to select "Normal" or "Low", then press the **ENTER** button.
4. Press the **EXIT** button to exit.
 - This function is active only when the external input connects to HDMI(RGB signals).

- **Normal:** The screen gets brighter.
- **Low:** The screen gets darker.

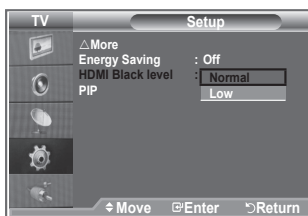
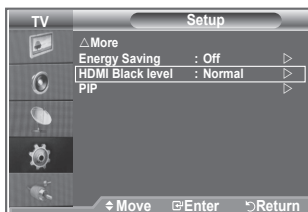

Selecting the Source

You can select among external sources connected to your TV's input jacks.

1. Press the **MENU** button to display the menu.
Press the **▲** or **▼** button to select "Input", then press the **ENTER** button.
2. Press the **ENTER** button again, to select "Source List".
➤ When no external device is connected to your set, only "TV" are activated in the "Source List".
"AV1", "AV2", "S-Video", "Component1", "Component2", "PC", "HDMI1", "HDMI2" are activated only when they are connected to your set.
3. Select the required device by pressing the **▲** or **▼** button.
Press the **ENTER** button.

-  Press the **SOURCE** button on the remote control to toggle between all the available source.
TV mode can be selected by pressing the **TV** button, number buttons (0-9), and the **P** (with a TV icon) button on the remote control. But it cannot be selected using the **SOURCE** button.

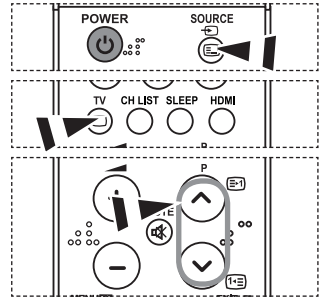
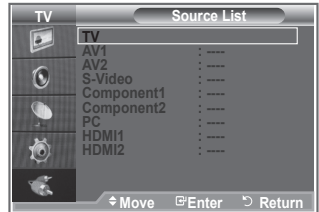
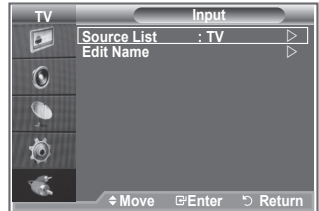

Editing the Input Source Names

Name the device connected to the input jacks to make your input source selection easier.

1. Press the **MENU** button to display the menu.
Press the **▲** or **▼** button to select "Input", then press the **ENTER** button.
2. Press the **▲** or **▼** button to select "Edit Name", then press the **ENTER** button.
3. Press the **▲** or **▼** button to select the device that you wish to edit.
Press the **ENTER** button.
4. Press the **▲** or **▼** button to select the required device.
Press the **ENTER** button.
5. Press the **EXIT** button to exit.

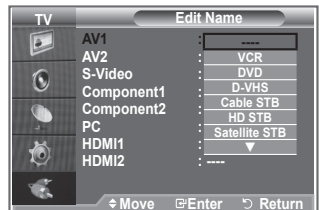
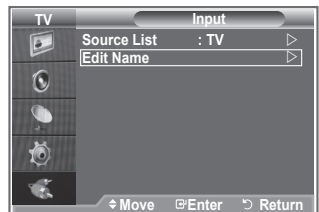

Teletext Decoder

Most set channels carry "teletext", pages of written information that provide information such as:

- ◆ Television programme times.
- ◆ News bulletins and Weather forecasts.
- ◆ Sports results.
- ◆ Subtitles for the hard of hearing.

The teletext pages are organized according to six categories:

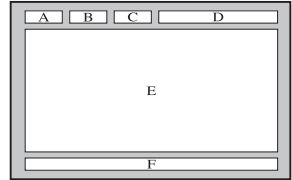

Part	Contents
A	Selected page number.
B	Broadcasting station identity.
C	Current page number or search status.
D	Date and time.
E	Text.
F	Status information.

Displaying the Teletext Information

You can display teletext information at any time, but signal reception must be good. Otherwise:

- ◆ Information may be missing.
- ◆ Some pages may not be displayed.

To activate the teletext mode and display the contents page:

1. Using the **P** (P) or **P** (P) button, select the channel providing the teletext service.
2. Press the **TTX/MIX** (TTX/MIX) button to activate the teletext mode.
 - > The contents page is displayed. It can be redisplayed at any time by pressing the **MENU** (MENU) button.
3. Press the **TTX/MIX** (TTX/MIX) button again.
 - > The actual broadcast will be displayed with "Teletext", "Double", and "Mix" in order on the screen.
4. Press the **TV** button to exit from the Text display.

- > If any broken character appears while Text is being viewed, make sure that the Text language is identical with the language in the "Setup" menu mode. If both languages are different, select the same language with the Text language on the "Setup" menu.

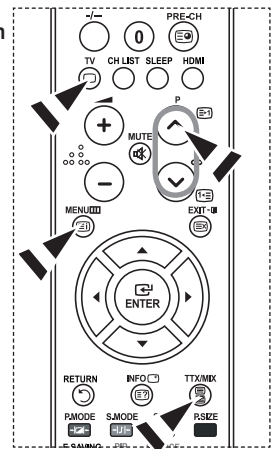

Selecting a Specific Teletext Page

Press the number buttons on the remote control to enter the page number directly:

1. Enter the three-digit page number listed in the contents by pressing the corresponding numeric buttons.
2. If the selected page is linked with several secondary pages, the secondary pages are displayed in sequence. To freeze the display on a given page, press the **PIP** (E3). Press the **PIP** (E3) button again to resume.
3. Using the various display options:

To display...	Press the...
Both teletext information and the normal broadcast	TTX/MIX (E1/E2)
Hidden text (answers to quiz games, for example)	INFO (E2)
The normal screen	INFO (E2)
A secondary page, by entering its 4-digit number	PRE-CH (E9)
The next page	P (E1)
The previous page	P (E2)
Double-size letters in the: <ul style="list-style-type: none"> • Upper half of the screen • Lower half of the screen 	POSITION (E3) <ul style="list-style-type: none"> • Once • Twice
Normal screen	• Three times

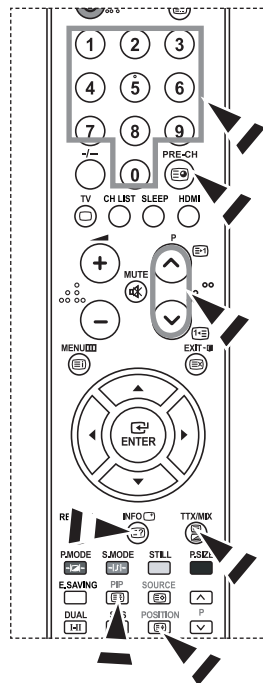

Using Fastext to Select a Teletext Page

The various topics included in the teletext pages are colour-coded, and can be selected by pressing the coloured buttons on the remote control.

1. Display the teletext contents page by pressing the **TTX/MIX** (E1/E2) button.
2. Press the coloured button corresponding to the topic that you wish to select (The available topics are listed on the status information line).
3. Press the Red button to display the previous page.
Press the Green button to display the next page.
4. Press the **TV** button to exit from the Text display.

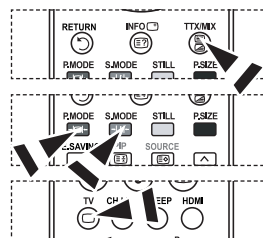

Setting up Your PC Software (Based on Windows XP)

The Windows display-settings for a typical computer are shown below. The actual screens on your PC may be different depending upon your particular version of Windows and your particular video card. Even if your actual screens look different, the same, basic set-up information will apply in almost all cases. (If not, contact your computer manufacturer or Samsung Dealer.)

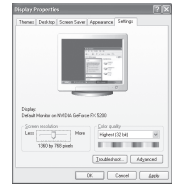

1. First, click on "Control Panel" on the Windows start menu.
2. When the control panel window appears, click on "Appearance and Themes" and a display dialog-box will appear.
3. When the control panel window appears, click on "Display" and a display dialog-box will appear.
4. Navigate to the "Settings" tab on the display dialog-box.
The correct size setting (resolution): Optimum- 1360 X 768
If a vertical-frequency option exists on your display settings dialog box, the correct value is "60" or "60 Hz". Otherwise, just click "OK" and exit the dialog box.

Display Modes

Both screen position and size will vary depending on the type of PC monitor and its resolution. The resolutions in the table are recommended. (All resolutions between the supported limits are supported)

> D-Sub Input

Mode	Resolution	Horizontal Frequency (kHz)	Vertical Frequency (Hz)	Pixel Clock Frequency (MHz)	Sync Polarity (H/V)
IBM	640 x 350	31.469	70.086	25.175	+ / -
	640 x 480	31.469	59.940	25.175	- / -
	720 x 400	31.469	70.087	28.322	- / +
VESA	640 x 480	37.861	72.809	31.500	- / -
	640 x 480	37.500	75.000	31.500	- / -
	800 x 600	37.879	60.317	40.000	+ / +
	800 x 600	48.077	72.188	50.000	+ / +
	800 x 600	46.875	75.000	49.500	+ / +
	1024 x 768	48.364	60.000	65.000	- / -
	1024 x 768	56.476	70.069	75.000	- / -
	1024 x 768	60.023	75.029	78.750	+ / +
	1360 x 768	47.712	60.015	85.800	+ / +

> HDMI/DVI Input

Mode	Resolution	Horizontal Frequency (kHz)	Vertical Frequency (Hz)	Pixel Clock Frequency (MHz)	Sync Polarity (H/V)
IBM	640x350	31.469	70.086	25.175	+/-
	720x400	31.469	70.087	28.322	-/+
	640x480	31.469	59.940	25.175	-/-
VESA	800x600	37.879	60.317	40.000	+/+
	1024x768	48.364	60.000	65.000	-/-
	1360x768	47.712	60.015	85.800	+/+

- > The interlace mode is not supported.
- > The set might operate abnormally if a non-standard video format is selected.
- > Separate and Composite modes are supported. SOG is not supported.

Setting the PC

Coarse and Fine Tuning of the Image (Image Lock):

The purpose of picture quality adjustment is to remove or reduce picture noise.

If the noise is not removed by Fine-tuning alone, then adjust the frequency as best as possible (coarse) and Fine-tune again. After the noise has been reduced, re-adjust the picture so that it is aligned on the center of screen.

1. Preset: Press the **SOURCE** button to select PC mode.
2. Press the **MENU** button to display the menu. Press the **▲** or **▼** button to select "Setup", then press the **ENTER** button.
3. Press the **▲** or **▼** button to select "PC", then press the **ENTER** button.
4. Press the **ENTER** button to select "Image Lock".
5. Press the **▲** or **▼** button to select "Coarse" or "Fine", then press the **ENTER** button.
6. Press the **◀** or **▶** button to adjust the screen quality. Press the **ENTER** button.
7. Press the **EXIT** button to exit.

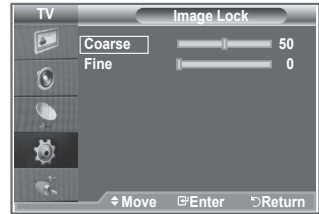
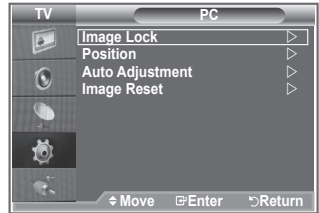

Changing the Image Position:

Adjust the PC's screen positioning if it does not fit the TV screen.

1. Follow the "Coarse and Fine Tuning of the Image (Image Lock)" instructions number 1 to 3.
2. Press the **▲** or **▼** button to select "Position", then press the **ENTER** button.
3. Press the **▲** or **▼** button to adjusting the Vertical-Position. Press the **◀** or **▶** button to adjust the Horizontal-Position. Press the **ENTER** button.
4. Press the **EXIT** button to exit.

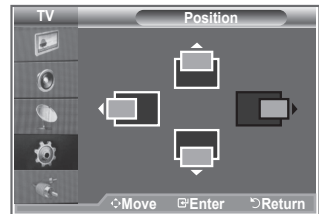

Adjusting the PC Screen Automatically (Auto Adjustment):

Auto adjustment allows the PC screen of set to self-adjust to the incoming PC video signal. The values of fine, coarse and position are adjusted automatically.

1. Follow the "Coarse and Fine Tuning of the Image (Image Lock)" instructions number 1 to 3.
2. Press the **▲** or **▼** button to select "Auto Adjustment", then press the **ENTER** button.
3. Press the **EXIT** button to exit.

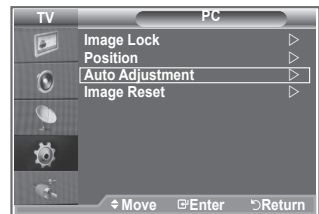

Initializing the Image Settings (Image Reset):

You can replace all image settings with the factory default values.

1. Follow the "Coarse and Fine Tuning of the Image (Image Lock)" instructions number 1 to 3.
2. Press the **▲** or **▼** button to select "Image Reset", then press the **ENTER** button.
3. Press the **EXIT** button to exit.

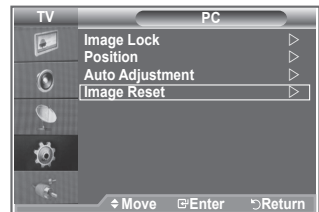

Wall-Mount Adjustment (LA40R7)(Sold separately)

Once the wall mount is installed, the position of your TV can be easily adjustable.

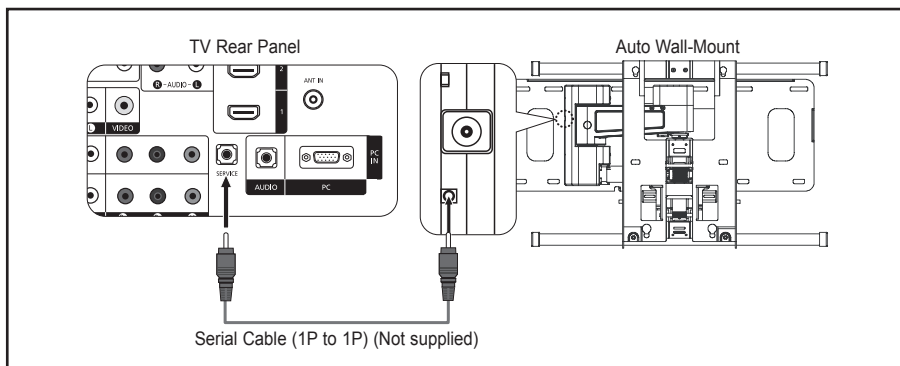

Entering the menu

1. Press the **MENU** button to display the menu.
Press the **▲** or **▼** button to select "Setup", then press the **ENTER** button.
 2. Press the **▲** or **▼** buttons to select "Wall-Mount Adjustment", then press the **ENTER** button.
 3. Adjust to the desired position using the **▲, ▼, ◀, ▶** buttons.
 4. Press the **EXIT** button to exit.
- If you press an arrow button when no OSD is displayed on the TV screen, the Adjustment screen appears.
 - When you turn the power off, your TV moves to the initial installation position.
When you turn the power on, your TV moves to the last remembered position you adjusted.



Using the Remote Control Buttons

Button	Operations	
	Wall-mount angle adjustment	Tilt Up, Tilt Down, Move right, Move left
	Reset	Moves to the initial installation position
	Remembering the position and moving to the remembered position	Remembers 3 positions with the Red, Green and Yellow buttons. Moves to the remembered position using these 3 color buttons.

- For installation, refer to the Installation Manual provided.
- For product installation and the installation and moving of the wall mount, make sure to consult a specialized installation company.
- This installation manual is to be used when attaching the wall mount to a wall.
When attaching to other building materials, please contact your nearest dealer



Using the Anti-Theft Kensington Lock

The Kensington lock is a device used to physically fix the system when using it in a public place. The locking device has to be purchased separately. The appearance and locking method may differ from the illustration depending on the manufacturer. Please refer to the manual provided with the Kensington lock for proper use.

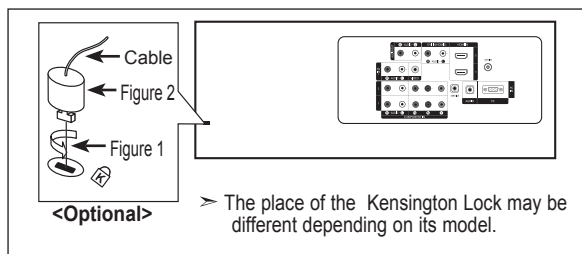
1. Insert the locking device into the Kensington slot on the LCD TV (Figure 1), and turn it in the locking direction (Figure 2).
2. Connect the Kensington lock cable.
3. Fix the Kensington lock to a desk or a heavy stationary object.



Troubleshooting: Before Contacting Service Personnel

No sound or picture	<ul style="list-style-type: none"> • Check that the mains lead has been connected to a wall socket. • Check that you have pressed the POWER  button on the front of the set. • Check the picture contrast and brightness settings. • Check the volume.
Normal picture but no sound	<ul style="list-style-type: none"> • Check the volume. • Check whether the MUTE  button has been pressed on the remote control. • Check if "Internal Mute" is off
No picture or black and white picture	<ul style="list-style-type: none"> • Adjust the colour settings. • Check that the broadcast system selected is correct.
Sound and picture interference	<ul style="list-style-type: none"> • Try to identify the electrical appliance that is affecting the set and move it further away. • Plug your set into a different mains socket.
Blurred or snowy picture, distorted sound	<ul style="list-style-type: none"> • Check the direction, location and connections of your aerial. This interference is often due to the use of an indoor aerial.
Remote control malfunctions	<ul style="list-style-type: none"> • Replace the remote control batteries. • Clean the upper edge of the remote control (transmission window). • Check the battery terminals.
"Check signal cable." message is displayed.	<ul style="list-style-type: none"> • Check that the signal cable is firmly connected to the PC or video sources. • Check that the PC or video sources are turned on.
On PC mode, "Not Supported Mode." message is displayed.	<ul style="list-style-type: none"> • Check the maximum resolution and the frequency of the video adaptor. • Compare these values with the data in the Display Modes.

The TFT LCD panel uses a panel consisting of sub pixels (3,133,440) which require sophisticated technology to produce. However, there may be few bright or dark pixels on the screen. These pixels will have no impact on the performance of the product.

Technical and Environmental Specifications

Model Name	LA26R7	LA32R7	LA40R7
Screen Size (Diagonal)	26 inch	32 inch	40 inch
PC Resolution	1360 x 768 @ 60 Hz	1360 x 768 @ 60 Hz	1360 x 768 @ 60 Hz
Sound Output	5W x 2	10W x 2	10W x 2
Dimension (WxDxH)			
Body	675 X 75 X 476 mm	800 X 80 X 549 mm	991 X 87 X 659 mm
With stand	675 X 216 X 530 mm	800 X 252 X 603 mm	992 X 326 X 713 mm
Weight			
With stand	10 kg	15 kg	23 kg
Environmental Considerations			
Operating Temperature	10 °C to 40 °C (50 °F to 104 °F)	10 °C to 40 °C (50 °F to 104 °F)	10 °C to 40 °C (50 °F to 104 °F)
Operating Humidity	10 % to 80 %, non-condensing	10 % to 80 %, non-condensing	10 % to 80 %, non-condensing
Storage Temperature	-20 °C to 45 °C (-4 °F to 113 °F)	-20 °C to 45 °C (-4 °F to 113 °F)	-20 °C to 45 °C (-4 °F to 113 °F)
Storage Humidity	5 % to 95 %, non-condensing	5 % to 95 %, non-condensing	5 % to 95 %, non-condensing

Stand Swivel (Left / Right) (LA32R7, LA40R7)

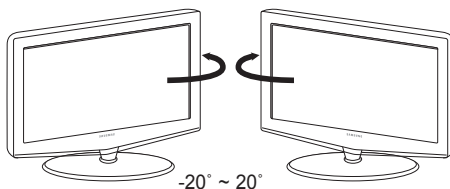

- Design and specifications are subject to change without prior notice.
- This device is a Class B digital apparatus.
- For the power supply and Power Consumption, refer to the label attached to the product.

Free Manuals Download Website

<http://myh66.com>

<http://usermanuals.us>

<http://www.somanuals.com>

<http://www.4manuals.cc>

<http://www.manual-lib.com>

<http://www.404manual.com>

<http://www.luxmanual.com>

<http://aubethermostatmanual.com>

Golf course search by state

<http://golfingnear.com>

Email search by domain

<http://emailbydomain.com>

Auto manuals search

<http://auto.somanuals.com>

TV manuals search

<http://tv.somanuals.com>