

**SAMSUNG**

# DIGITAL HOME THEATER SYSTEM **HT-DL100**

QUESTO APPARECCHIO È PRODOTTO DA:

**SAMSUNG**  
ELECTRONICS

## Instruction Manual

---

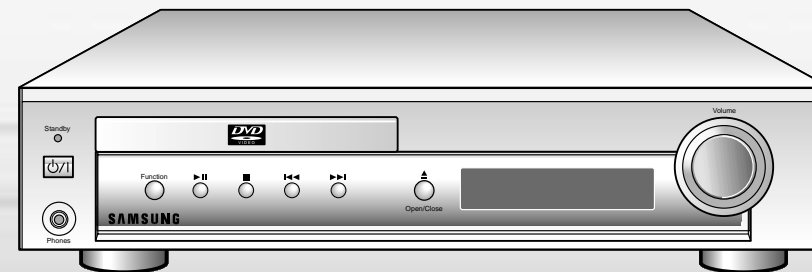

AH68-00987B

**DOLBY**  
DIGITAL

**dts**

**DVD**  
VIDEO

COMPACT  
**disc**  
DIGITAL AUDIO

COMPACT  
**disc**  
DIGITAL VIDEO

# Safety Warnings

CLASS 1 LASER PRODUCT  
 KLASSE 1 LASER PRODUKT  
 LUOKAN 1 LASER LAITE  
 KLASSE 1 LASER APPARAT  
 PRODUCTO LASER CLASE 1



**CAUTION:**  
 TO REDUCE THE RISK OF ELECTRIC SHOCK, DO NOT REMOVE REAR COVER. NO USER SERVICEABLE PARTS INSIDE. REFER SERVICING TO QUALIFIED SERVICE PERSONNEL.

CLASS 1 LASER PRODUCT  
 This Compact Disc player is classified as a CLASS 1 LASER product.

## Wiring the Main Power Supply Plug(UK Only)

### IMPORTANT NOTICE

The main lead on this equipment is supplied with a moulded plug incorporating a fuse. The value of the fuse is indicated on the pin face of the plug and if it requires replacing, a fuse approved to BS1362 of the same rating must be used.

Never use the plug with the fuse cover removed. If the cover is detachable and a replacement is required, it must be of the same colour as the fuse fitted in the plug. Replacement covers are available from your dealer.

If the fitted plug is not suitable for the power points in your house or the cable is not long enough to reach a power point, you should obtain a suitable safety approved extension lead or consult your dealer for assistance.

However, if there is no alternative to cutting off the plug, remove the fuse and then safely dispose of the plug. Do not connect the plug to a main socket as there is a risk of shock hazard from the bared flexible cord.

Never attempt to insert bare wires directly into a main socket. A plug and fuse must be used at all times.

### IMPORTANT

The wires in the main lead are coloured in accordance with the following code:-

BLUE = NEUTRAL      BROWN = LIVE

As these colours may not correspond to the coloured markings identifying the terminals in your plug, proceed as follows:-

The wire coloured BLUE must be connected to the terminal marked with the letter N or coloured BLUE or BLACK.  
 The wire coloured BROWN must be connected to the terminal marked with the letter L or coloured BROWN or RED.

**WARNING: DO NOT CONNECT EITHER WIRE TO THE EARTH TERMINAL WHICH IS MARKED WITH THE LETTER E OR BY THE EARTH SYMBOL  $\perp$ , OR COLOURED GREEN OR GREEN AND YELLOW.**

Use of controls, adjustments or performance of procedures other than those specified herein may result in hazardous radiation exposure.

### CAUTION-INVISIBLE LASER RADIATION WHEN OPEN AND INTERLOCKS DEFEATED, AVOID EXPOSURE TO BEAM.



This symbol indicates that dangerous voltage which can cause electric shock is present inside this unit.



This symbol alerts you to important operating and maintenance instructions accompanying the unit.

**WARNING:** To reduce the risk of fire or electric shock, do not expose this appliance to rain or moisture.

**CAUTION:** TO PREVENT ELECTRIC SHOCK, MATCH WIDE BLADE OF PLUG TO WIDE SLOT, FULLY INSERT.

# Precautions

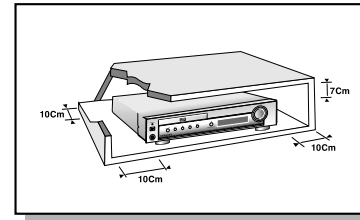

Ensure that the mains supply in your house complies with that indicated on the identification sticker located at the back of your play. Install your player horizontally, on a suitable base (furniture), with enough space around it for ventilation (7-10cm). Make sure the ventilation slots are not covered. Do not stack other, or heavy devices on top over the player. Do not place the player on amplifiers or other equipment which may become hot. Before moving the player ensure the disc tray empty. This player is designed for continuous use. Switching off the DVD player to the stand-by mode does not disconnect the electricity supply. In order to separate the player completely from the mains, it has to be disconnected by unplugging the main plug, especially when left unused for a long period of time.

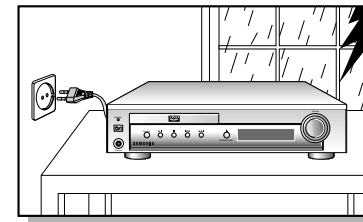
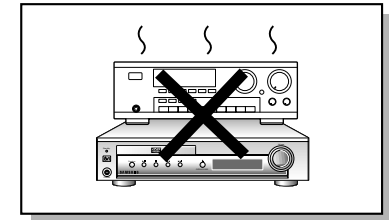

During thunderstorms, disconnect the main plug from the socket.  
 Main voltage peaks due to lightning could damage the unit.

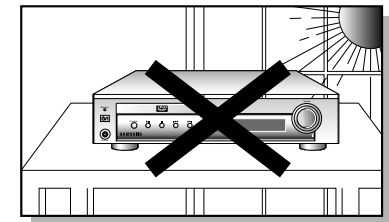

Do not expose the unit to direct sun radiation or other heat sources.  
 This could lead to overheating and malfunction of the unit.

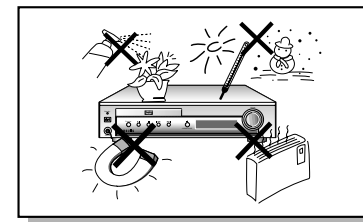

Protect the player from moisture (dripping or splashing and that no objects filled with liquids, such as vases, shall be placed on the player), and excess heat (e.g. fireplace) or equipment creating strong magnetic or electric fields (i.e. speakers...) disconnect the power cable from the mains electricity supply if the player malfunctions. Your player is not intended for industrial use but for domestic purposes only. Use of this product is for personal use only. Condensation If your player or disc have been stored in a cold atmosphere, as for example during transportation in the winter, wait for approximately 2 hours until they have reached room temperature.

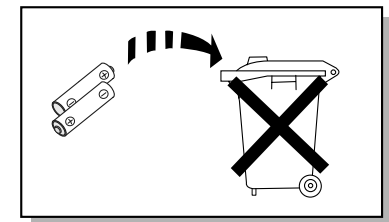

The battery used in this product contains the chemicals that are harmful to the environment.  
 Do not dispose of batteries in the general household waste. It is recommended that the replacement of the battery should be done by a technician.



# Contents



**DVD (Digital Versatile Disc)** offers fantastic audio and video, thanks to Dolby Digital surround sound and MPEG-2 video compression technology. Now you can enjoy these realistic effects in the home, as if you were in a movie theater or concert hall.



DVD players and the discs are coded by region. These regional codes must match in order for the disc to play. If the codes do not match, the disc will not play.

The Region Number for this player is given on the rear panel of the player. (Your DVD player with the same regional code will only play DVDs that are labeled with identical region codes.)

Manufactured under license from Dolby Laboratories.  
 "Dolby" and the double-D symbol are trademarks of Dolby Laboratories.  
 © 1992-1997 Dolby Laboratories Inc. All rights reserved.

### Copy Protection

⚠ Many DVD discs are encoded with copy protection. Because of this, you should only connect your DVD player directly to your TV, not to a VCR. Connecting to a VCR results in a distorted picture from copy-protected DVD discs.

⚠ This product incorporates copyright protection technology that is protected by methods claims of certain U.S. patents and other intellectual property rights owned by Macrovision Corporation and other rights owners. Use of this copyright protection technology must be authorized by Macrovision Corporation, and is intended for home and other limited viewing uses only unless otherwise authorized by Macrovision Corporation. Reverse engineering or disassembly is prohibited.

Safety Warnings .....	1
Precautions .....	2
Description .....	5
Remote Control Unit .....	7
Place and Connect Speakers .....	9
Connections .....	11
Before using the DVD Player .....	12
DVD Playback .....	13
Forward/Reverse Searching .....	15
Slow Playback/checking the Remaining Time .....	16
Repeat Playback .....	17
Using Disc Menu/Title .....	18
Program Playback .....	19
Selecting the Audio Language/ Subtitle Language .....	21
Various DVD Functions .....	22
⚠ To enlarge an image .....	22
⚠ Selecting the desired Screen Angle .....	22
⚠ To move directly to a title, chapter, or time .....	22
System Setup .....	23
Setting up the Language Features .....	25
Controlling a TV with the Remote .....	26
Speaker Setup .....	27
Listening to the Radio .....	31
Presetting stations .....	32
About RDS broadcasting .....	33
DSP/Sleep Functions .....	35
Troubleshooting .....	36
Cautions on Handling and Storing Discs .....	38
Disc Type and Protection .....	39
Specification .....	40
Reference .....	41

# Description

## Front Panel

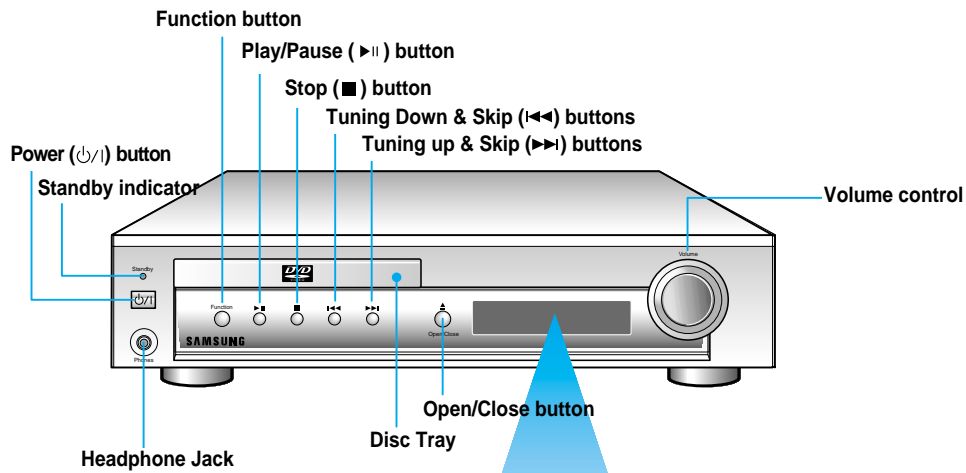

## Display

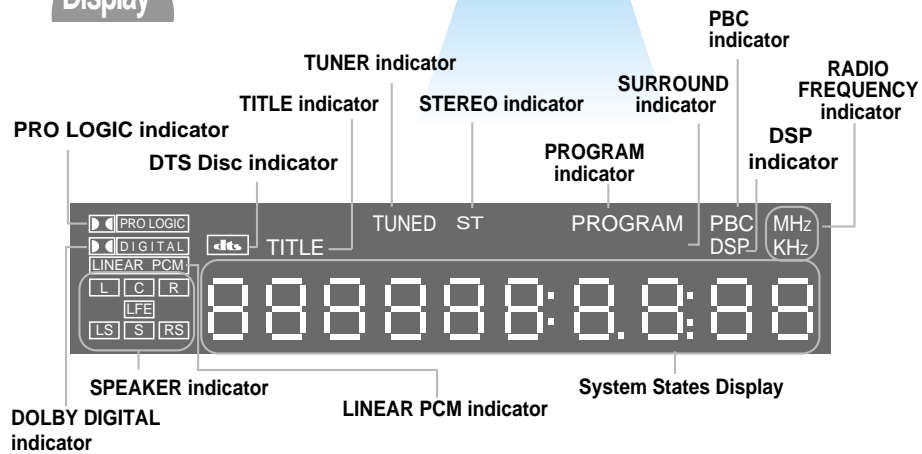

## Rear Panel

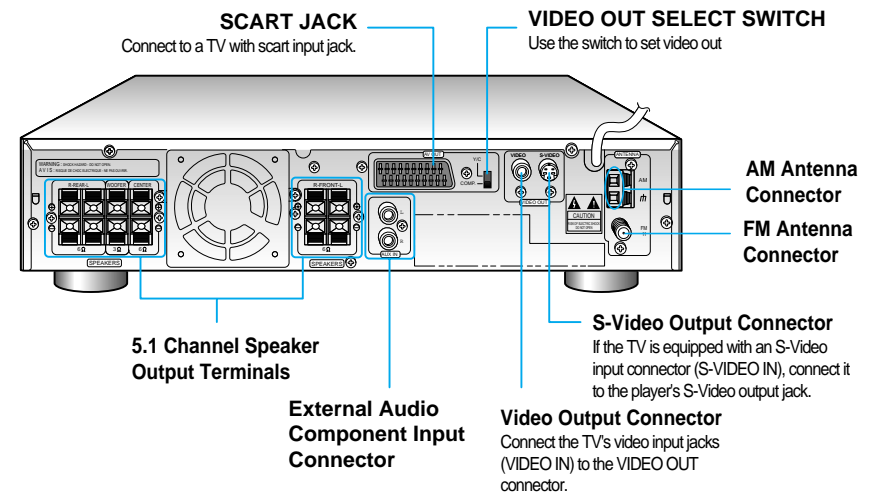

## Accessories

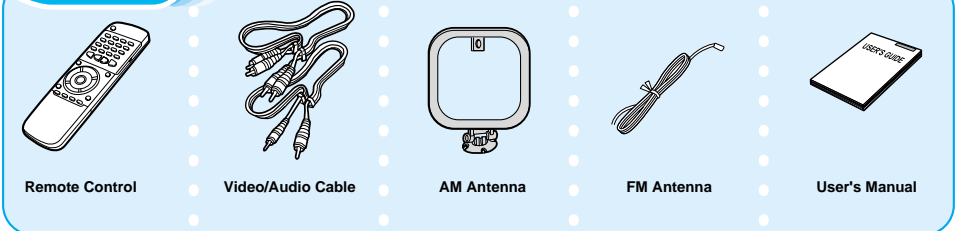

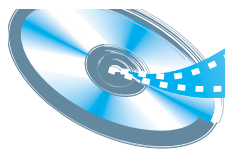

# Remote Control Unit

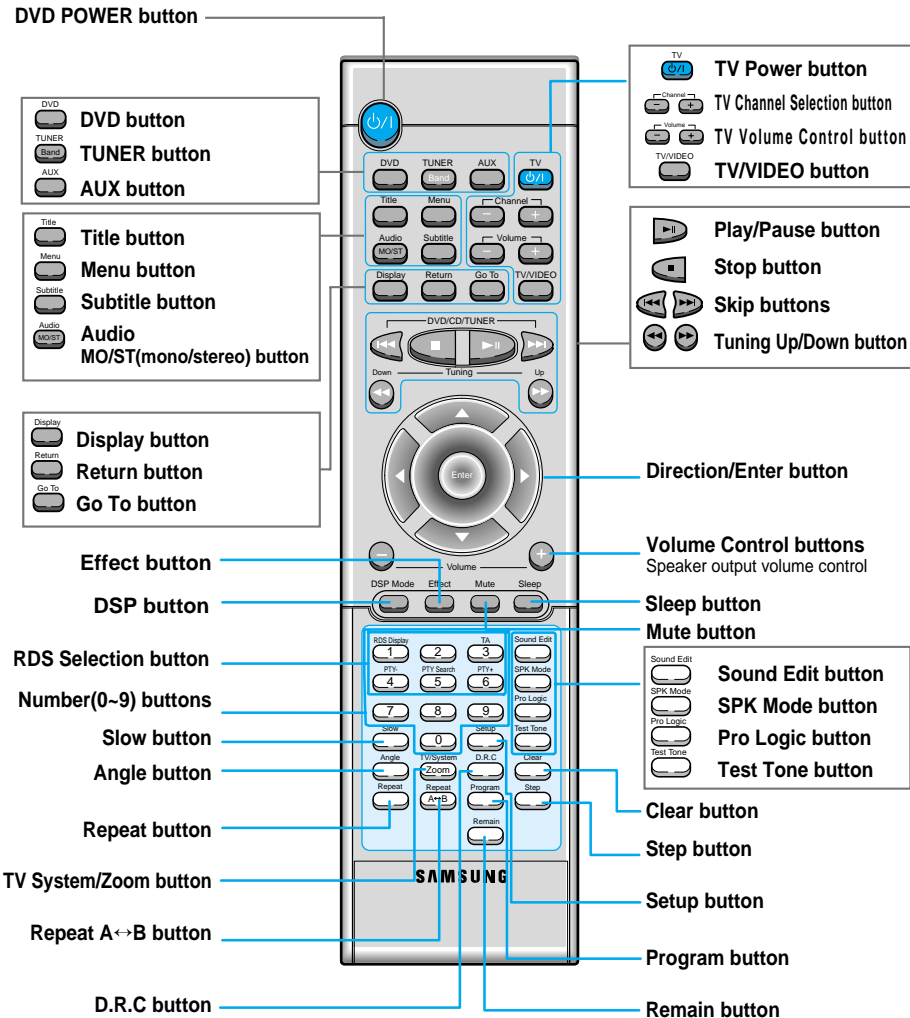

## Insert Remote Batteries

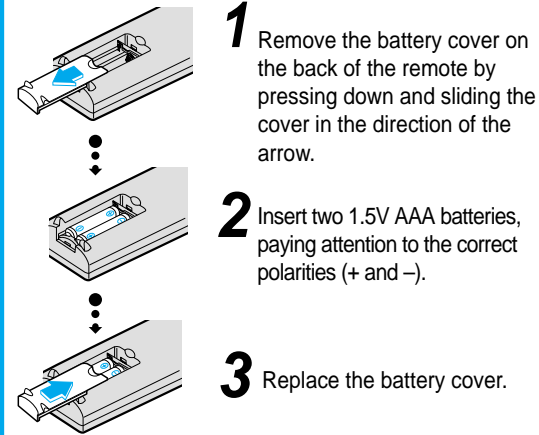

## Range of Operation of the Remote Control

The remote control can be used up to approximately 23 feet/7 meters in a straight line. It can also be operated at a horizontal angle of up to 30° from the remote control sensor.

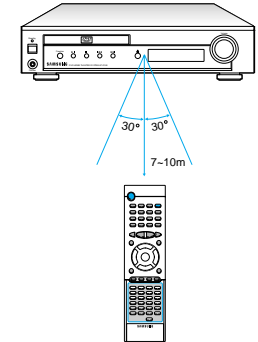

## Connect Video to TV

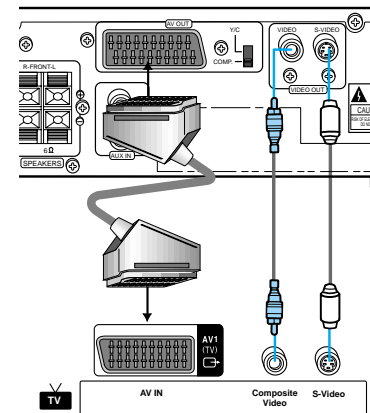

### Composite Video (Good Quality)

Connect the supplied video cable from the VIDEO OUT jack on the back panel of the system to the VIDEO IN jack on your television.

### S-Video (Better Quality)

If your television is equipped with an S-Video input, connect an S-Video cable (not supplied) from the S-VIDEO OUT jack on the back panel of the system to the S-VIDEO IN jack on your television.

### Scart (Best Quality)

If your television is equipped with an SCART input, connect an Scart Jack (not supplied) from the AV OUT jack on the back panel of the system to the SCART IN jack on your television.

If your TV SCART terminal with Y/C-COMP. selector, you can get a better picture quality by setting Y/C-COMP.selector to Y/C . in this case , you need to set Y/C-COMP. selector of the center unit to Y/C.

# Place and Connect Speakers

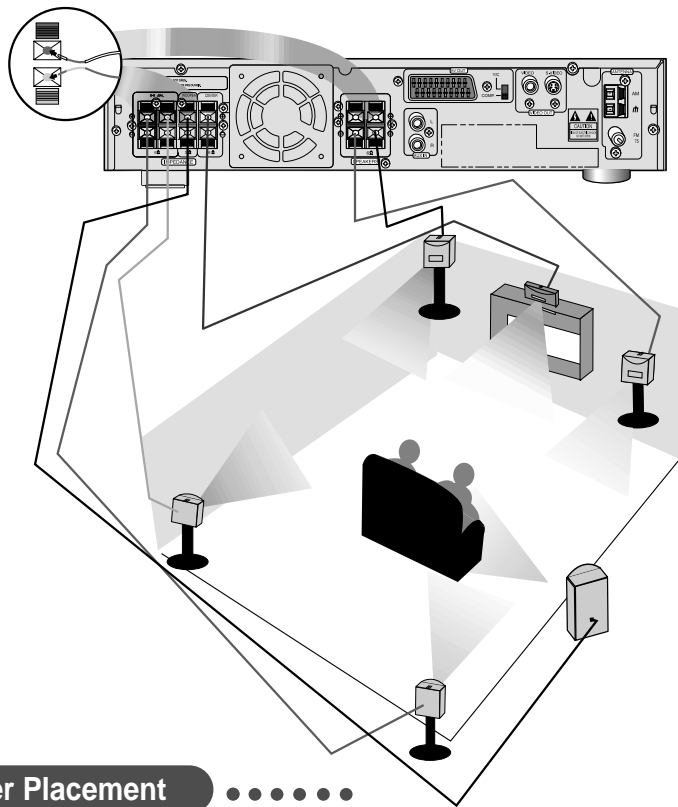

## Speaker Placement

Arrange the 6 speakers as shown in your listening area.

- **Front Speakers** : Set the front speakers so that they are aligned at ear level and at a horizontal angle of 45 degrees to the primary listening area.
- **Rear Speakers** : Set the surround speakers further back, parallel to the walls, at 2 to 3 feet above the ear level of the primary listening area. If the space behind the listening area is limited (i.e., close to the wall), place the rear speakers facing each other on either side.
- **Center Speaker** : The center speaker should be positioned with its top surface flush with the front speakers. However, you may place the speaker either on top of or next to your TV set.
- **Subwoofer** : Place the subwoofer at any convenient location within the vicinity of the listening area.

## Speaker Connections

1. Make sure the power is turned off before connecting the speakers to prevent possible damage to the speakers.
2. Connect each red and black speaker wire to the system's back panel as shown, being careful to connect each speaker to its correctly labeled output.
3. To insert each color-coded wire, press down on the red and black thumb levers and then release them to lock the wires in place.

## Connect Antenna

### Connecting the AM (MW/LW) Aerial

1. Complete assembly of the supplied AM loop antenna by rotating the base and snapping it into place.
2. Connect the two wires from the AM loop antenna to the AM ANTENNA connector on the back panel. Press down on the thumb lever to insert each wire, and then release to lock the wires in place.

### Connecting the FM Aerial

Connect the supplied FM antenna to the "FM 75Ω COAXIAL" connector on the back panel. If noise or interference occurs, use an external antenna with a 75Ω coaxial cable (not supplied).

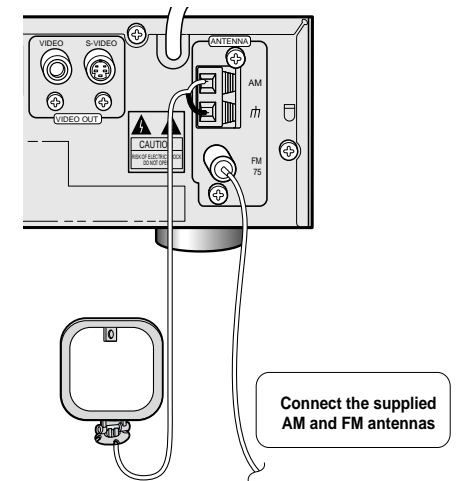

## Connecting your System to the Power Supply

### The main lead must be plugged into an appropriate socket.

Before plugging your system into a main socket, you must check the voltage.

1. Plug the main lead (marked AC Cord on the rear of the system) into an appropriate socket.
2. Press the On/Standby button to switch your DVD Player system on.

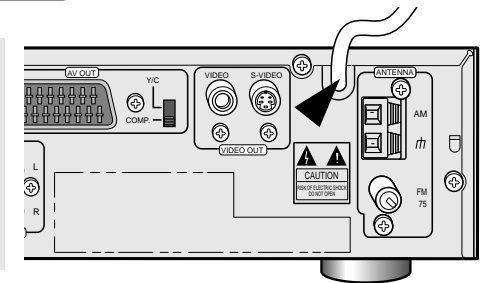

## Listening on headphones

Use headphones for private listening pleasure (not supplied).

Connect the headphones to the HEADPHONES jack of the front panel.

- No sound is produced from the speakers.
- To prevent hearing damage, do not raise the volume level excessively when using headphones.



# Connections

# Before Using the DVD Player

## AUX Connections

Use these connections if necessary. ●●●●●●●●●●

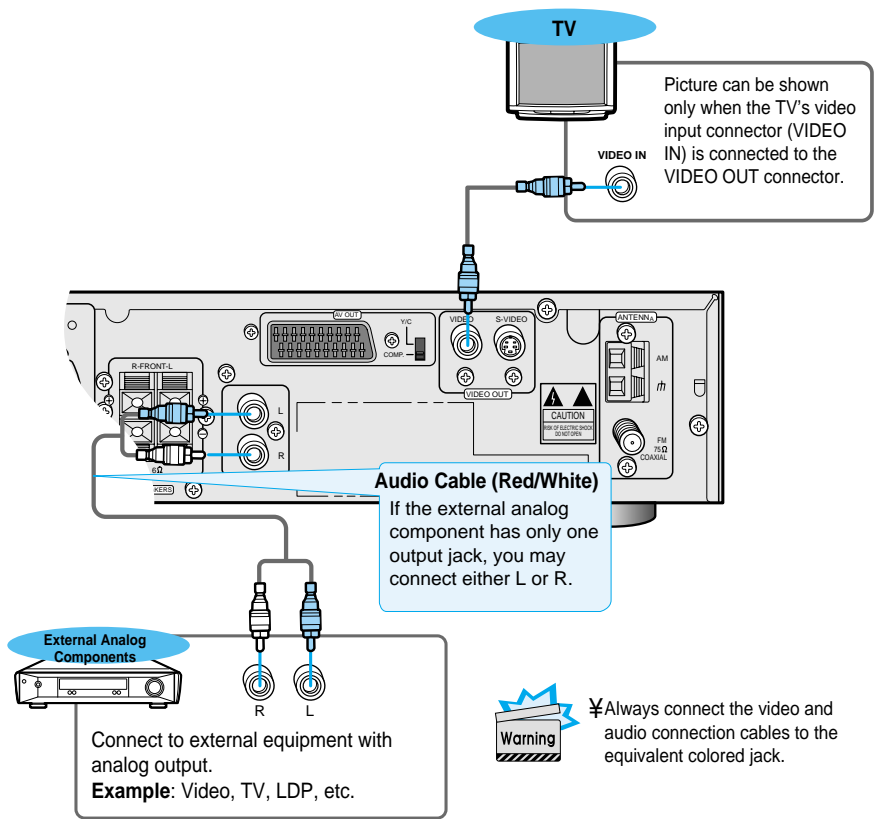

### Making Digital/Analog Selection

- Remote Control** → Press the **AUX** button and select **AUX IN**.
- Main Unit** → Press the **Function** button and select **AUX IN**.

## Before Using the DVD Player

Your DVD player is capable of playing DVD, VCD, and CD discs. User instructions may vary depending on the type of disc. Read the instructions carefully before use.

- 1**

Preparations before use

Turn on the power to your DVD player and TV.
- 2**

Select a video mode by pressing the TV/VIDEO button.
- 3**

Press the DVD button to select the DVD input function.

**Note** ⚠ The word **INVALID** appears on screen!  
If this message appears on the TV screen while buttons are being operate, the operation is not possible with that particular disc.

⚠ If your TV model is not SAMSUNG, refer to "Remote Control Unit Setup" on page 26.

**TV System Selection** ●●●

**Press the TV System button while in stop mode.**  
⚠ Each time the TV System button is pressed, "NTSC, PAL" are selected in this order.

※ Different countries use different types of TV broadcast systems, video, audio and channel systems.  
**Example :** The player cannot playback PAL-encoded DVD with NTSC-TV.

**CD-R/RW playback compatibility**

⚠ Your DVD player can also play CD-R and CD-RW discs recorded in digital audio format. When recording your own CD-R or CD-RW discs, make sure that the recording session is properly terminated, or they will not be playable. (Depending on disc properties and recording quality, some CD-R/RW may not be playable.)

⚠ CD-RW has a lower reflection rate than CD-R media and consequently it will take a longer to read CD-R discs.

⚠ CD-RW discs recorded at high speed tend to be difficult for the DVD player to read. If the recording speed for the CD-RW disc is not predetermined, write it at low speed.

# DVD Playback

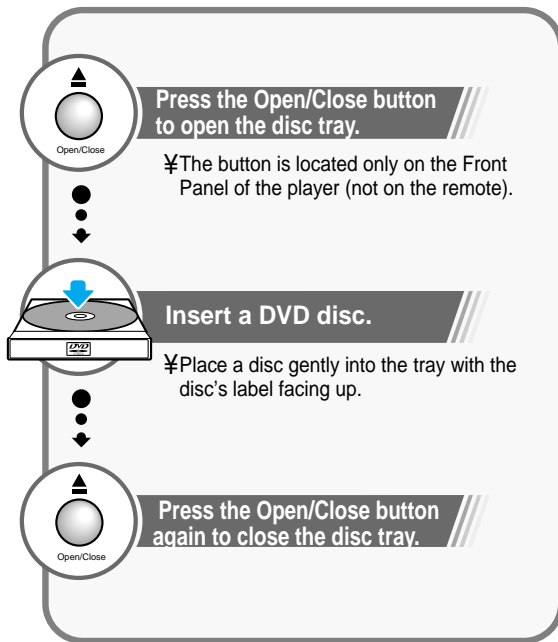

Playback starts automatically.

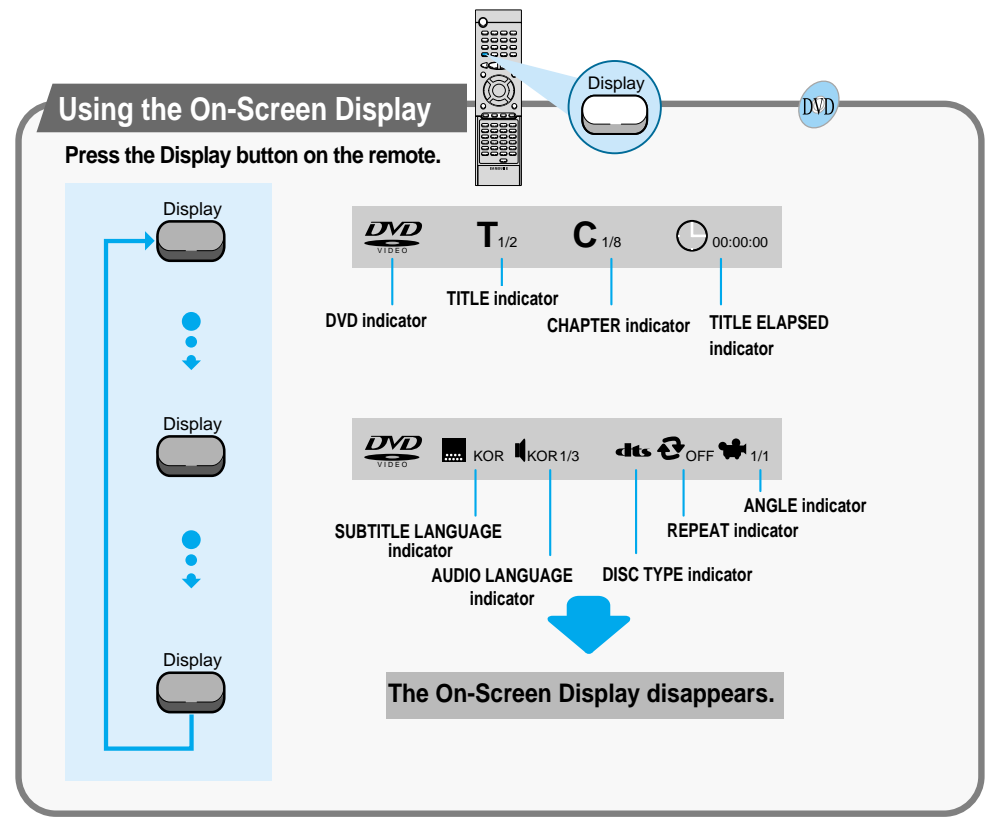

## Pausing Playback



Press the Play/Pause (▶||) button during playback.

✚To resume, press the Play/Pause (▶||) button again.

**Note** ✚Depending on the disc, the initial disc information screen may look disc to disc.  
 ✚When playing a DVD containing MPEG format, video may not be reproduced correctly and you may get picture distortion.

## Stopping Playback



Press the Stop (■) button during playback.

✚During playback, when the Stop (■) button is pressed, the position is stored in the memory, and ■ STOP is shown on the display.

When the Play/Pause (▶||) button or Return button is pressed subsequently, playback resumes from the position at which it was stopped.

✚If the Stop (■) button is pressed a second time, the 'resume play' memory function is canceled, and ■ STOP is shown on the display. When the Play/Pause (▶||) button is pressed, playback starts from the beginning.

### What is a Title?

A movie contained in a DVD disc.

### What is a Chapter?

Each Title on a DVD disc is divided into several smaller sections called "chapters".

## Turning the sound off temporarily?



Press the Mute button during playback.

✚This operation may be useful when you need to greet the guests or answer the telephone.

**Note** If the player is left for more than 5 minutes in pause mode, it will stop.



# Forward/Reverse Searching

During playback, you can search quickly through a chapter or track for a specific scene or tune.

## High-Speed Playback

Press the ◀◀ and ▶▶ button.

Each time the ◀◀ button is pressed

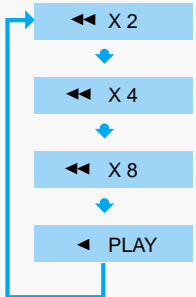

Each time the ▶▶ button is pressed



⚠ ◀◀ playback (reverse playback) is possible on DVDs.

## Skipping through a Chapter

Press the ◀◀ and ▶▶ button.

⚠ Each time the button is pressed during playback, it moves to the next or previous chapter and plays it.

⚠ However, you cannot skip forward or backward through consecutive chapters.

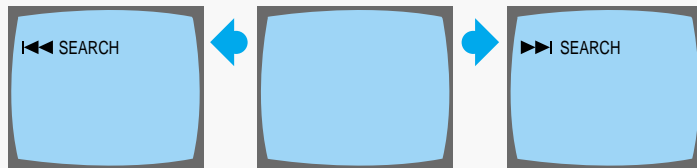

## Playing Frame by Frame

Press the Step button.

⚠ The picture moves forward one frame each time the button is pressed.

**Note** No sound is heard during high-speed playback, slow playback, and step motion.

# Slow Playback/Checking the Remaining Time

## Playing Slowly

Press the Slow button.

Each time the Slow button is pressed

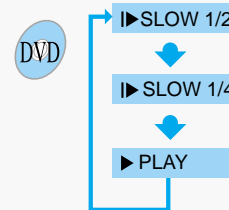

The slow playback speed changes and the selections (1/2X, 1/4X, 1/8X, 1/16X and normal play) are repeated.

## Checking the Remaining Time

Press the Remain button.

⚠ For checking check the total time and the remaining time of a title or chapter being played.

Each time the Remain button is pressed

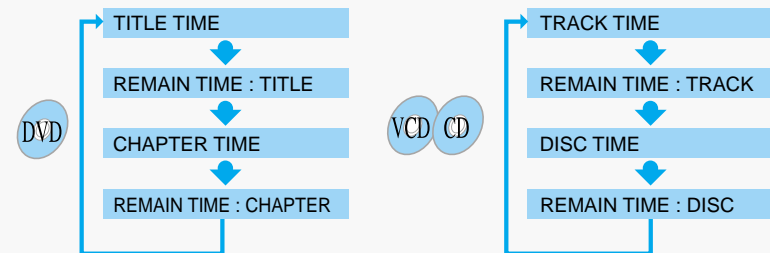

**Note** When playing a VCD or CD, the reverse slow playback will not work.

# Repeat Playback

Repeat playback allows you to repeat a chapter, title, or track.

## Playing Repeatedly

Press the Repeat button.

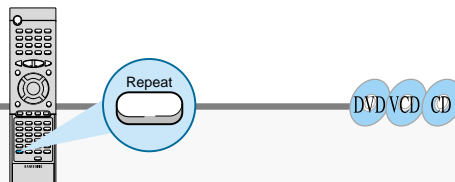

Each time the Repeat button is pressed

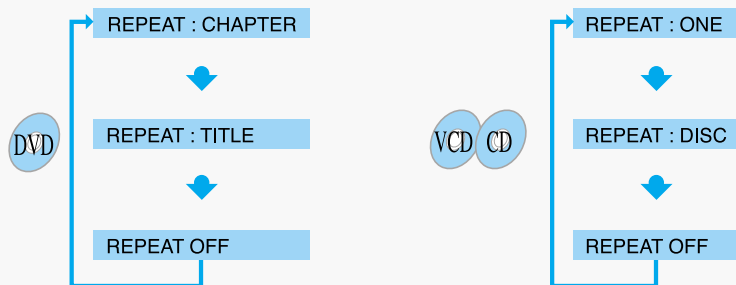

**Note** Repeat playback operation is not possible with version 2.0 VCD discs if PBC is turned on. To operate this feature, press the MENU button, and then select "PBC OFF".

## A↔B Repeat Playback

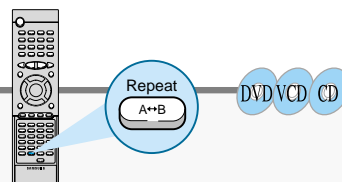

- 1 Press the **Repeat A↔B** button at the beginning (A) of the segment you want to review.
- 2 Press the **Repeat A↔B** button again at the end (B) of the segment you want to review.  
 ¥The segment will begin repeating.

### To return to normal playback

Press the Repeat A↔B button again.

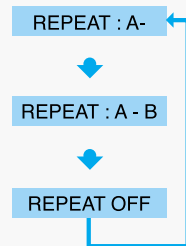

# Using Disc Menu/Title

## To Select the Disc Menu

You can use the menus for the audio language, subtitle language, profile, etc. DVD menu contents differ from disc to disc.

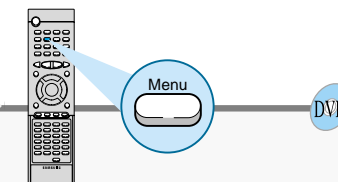

**1**

Press the **Menu** button during playback.

**2**

Use the **Up/Down** (▲ / ▼) or **Left/Right** (◀ / ▶) button to access the different features.

**3**

Press the **Enter** button.

¥The Menu Screen appears.  
 ¥When playing a VCD version 2.0, you can operate it using PBC On/Off function.

¥The selected item will play.

## Using the Title Menu

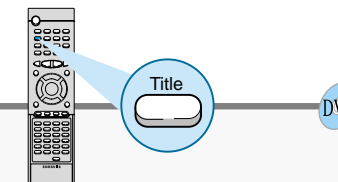

For DVDs containing multiple titles, you can view the title of each movie. Depending on the disc, this function may either not work at all, or may work differently.

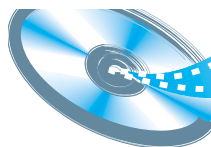

# Program Playback

Use this function with video and music CDs to play the tracks in a particular order.

## To Program Tracks in a particular order



DVD

1

Press the **Program** button.

2

Press the **Enter** button then use the **Number** buttons to select the desired title.

3

Press the **Enter** button, then use the **Number** buttons to select the desired chapter.

✚ You can use also just the **Left/Right** (◀/▶/▲/▼) button.

✚ You can use also just the **Left/Right** (◀/▶/▲/▼) button.

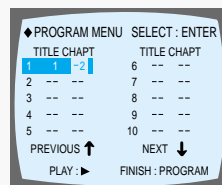
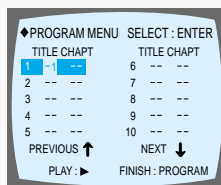
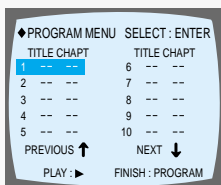

4

Press the **Enter** button.

5

At this time, you can continue programming if you want to.

✚ The selected track number is programming and the cursor moves to the next number.

✚ When programming more than 10 tracks, select **NEXT**↓ and then press the **Enter** button. The program selection screen where you can program up to 10 additional tracks appears.

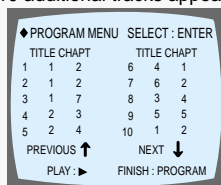

To Playback the Tracks in the Programmed Order



Press the **Play/Pause** (▶||) button.

## To Change the Program

DVD

1

Press the **Up/Down** (▲/▼) button to select the track number to be changed.

2

Press the **Enter** button to select the title and chapter to be changed.

3

Press the **Clear** button and then press the **Number** buttons.

✚ The cursor moves to the next number when the **Enter** button is pressed again.

✚ You can use also just the **Left/Right** (◀/▶) button.

4

Press the **Enter** button.

5

Repeat steps 1-4 above to change the program.

✚ The cursor moves to the number below.

## To delete the entire Program

✚ Press the **Stop** (■) button twice during playback.

✚ Press the **Stop** (■) button once when in the Stop mode.

✚ Press the **Open/Close** (▲) button on the main unit. The disc tray will open and then close. The program will then be deleted.

When you have entered a wrong number



Press the **Clear** button.

✚ When you want to delete a selection during programming, select the track (or chapter, or title) to be deleted and then press the **Clear** button.



You can program or change particular tracks for VCD or CD discs in the same manner.

## To Cancel the Programming

Press either the **Program** button or **Stop** (■) button.

# Selecting the Audio Language/Subtitle Language

## Selecting the Audio Language

Press the Audio button.

Depending on the number of languages recorded on a DVD disc, a different audio language (KOREAN, ENGLISH, JAPANESE, etc.) is selected each time the button is pressed.

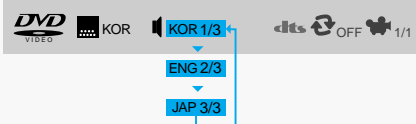

**Note** Depending on the disc, DTS or DIGITAL PRO LOGIC can be selected.

## Selecting the Subtitle Language

Press the Subtitle button.

Depending on the number of languages recorded on a DVD disc, a different subtitle language (KOREAN, ENGLISH, JAPANESE, etc.) is selected each time the button is pressed.  
To make the subtitles disappear, select "OFF".

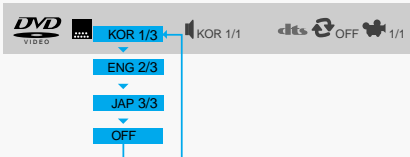

**Note** The word INVALID appears on the TV screen!  
If this message appears on the TV screen while buttons are being operated, that operation is not possible with that particular disc.  
Depending on the disc, the audio or subtitle language function may not work.

# Various DVD Functions

## To enlarge an image

Press the Zoom button.

Images can be enlarged 2x and 4x.  
During DVD playback, press the ZOOM button to zoom in 2X/4X/normal, in that order.

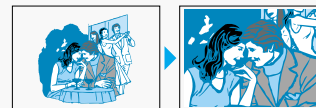

**Note** Only 2X zoom operation is possible during VCD playback.

## Selecting the desired Screen Angle

Press the Angle button.

This function only works with discs on which multiple angles have been recorded.  
During playback, press the Angle button to select the desired angle in 1/3, 2/3, 3/3, normal, in that order.

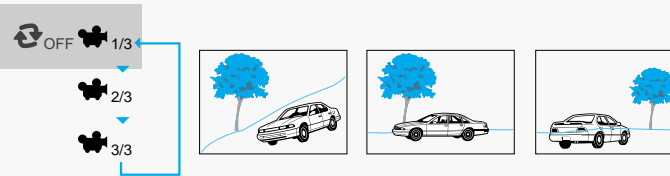

## To move directly to a title, chapter, or time

1

Press the Go To button.

2

Press Number(0-9) button or the Left/Right (◀/▶) button.

Each time the button is pressed, it repeats as shown below.

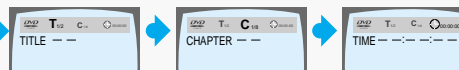

Each The desired scene is located and then played.  
Depending on the disc, the Title function may not work.

# System Setup

You can use the DVD player's Setup function to select the TV screen ratio, rating limit, or digital output mode.

## To Set up the System



Setup

DVD

1

From the stop mode, press the **Setup** button.



2

Press the **Left/Right** (◀/▶) button to select the system.

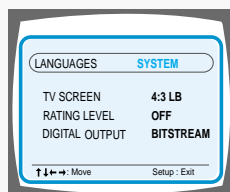

3

Press the **Up/Down** (▲/▼) button to select the desired item.

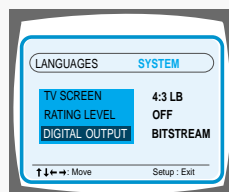

4

Press the **Enter** button or **Right** (▶) button.

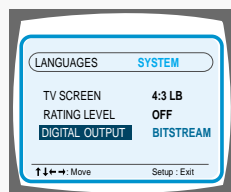

5

Press the **Up/Down** (▲/▼) button to select the desired sub-item and then press the **Enter** button.

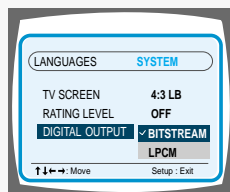

⌘ Move to the detailed items.  
⌘ Then press the **Left** (◀) button to return to the previous step.

## To End the System Setup

Setup

⌘ Press the **Setup** button again.

## TV SCREEN(TV SCREEN RATIO)

Select when you want to watch a 16:9 screen ratio DVD movie on a TV with a 4:3 ratio screen.

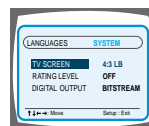

- 4:3LB** You can see the full 16:9 picture, but black bars will appear at the top and bottom of the screen.
- 4:3PS** You can only view the central portion of the 16:9 screen.
- 16:9** You can view in wide screen but the top and bottom of the picture will be cut off.

⌘ However if the movie is recorded in 4:3 ratio, you cannot view the full 16:9 picture with the above functions.

## RATING LEVEL

The Rating Level function works in conjunction with DVDs which have been assigned a rating, to help control the type of DVD that your family watches.

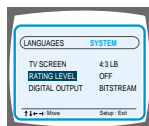

1. Select **RATING LEVEL**, then press the **Enter** button.

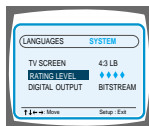

2. Use the number(0-9) buttons to input a **4-digit password**.

⌘ The player's password is set to "7890" by default.

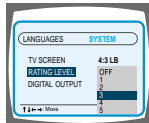

3. Use the **Up/Down** (▲/▼) button to select either **RATING LEVEL** or **NEW PASSWORD**, and then press the **Enter** button.

⌘ There are up to 8 rating levels on a disc.

⌘ If LEVEL 6 is selected, a disc which contains rating LEVEL 7 and above cannot be played.

⌘ If you select **NEW PASSWORD**, the screen changes and enables you to enter the new password.

### When the rating level password has been forgotten

While the player is in the stop mode, hold the **Stop** (■) button down on the main unit for more than 5 seconds.

⌘ "INITIAL" appears on the display and all default settings will return to Factory Preset.

# Setting up the Language Features

Using the DVD player's Setup function, you can customize the Menu Language, Subtitle Language, and Disc Menu Language.

**To set up the language feature**

- Press the **Setup** button from the stop mode.

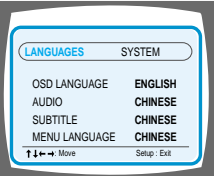
- Press the **Up/Down** (▲/▼) button to select the desired item.

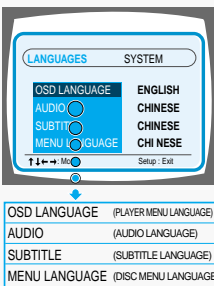
- Press the **Enter** button or **Right** (▶) button.

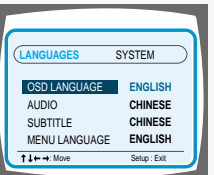
- Press the **Up/Down** (▲/▼) button to select the desired language and then press the **Enter** button.

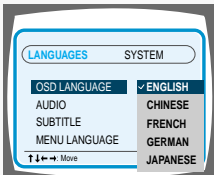

**To End the Language Features Setup**

Press the **Setup** button again.

25

# Controlling a TV with the Remote

The remote can also be set up to control most TVs. To program the remote, use the code that corresponds to your brand.

- Turn on the TV.
- Point the DVD's remote at the TV.
- While holding the **TV** button down, enter the code for your brand.

Code	Brand	Code	Brand
01	SAMSUNG 1	16	SHARP 3
02	SHARP 2	17	ZENITH
03	SONY	18	LG 3
04	MAGNAVOX	19	DAEWOO 8
05	SANYO 1	20	SANYO 2
06	LG 2	21	EMERSON
07	RCA	22	SHARP 3
08	LG 1	23	SAMSUNG 4
09	TOSHIBA	24	MATSUSHITA
10	HITACHI	25	NOBLEX
11	JVC	26	TELEFUNKEN
12	PANASONIC 1	27	NEWSAN
13	MITSUBISHI 2	28	LOEWE
14	SAMSUNG 2	29	RCA2
15	SAMSUNG 3		

**example** : For SAMSUNG 1TVs  
While holding down the **TV** button, enter 0 + 1 .

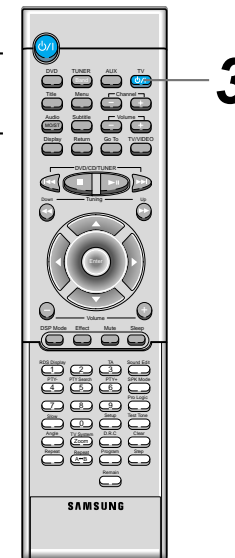

**Note** ✎ If your TV does not switch from VIDEO mode to TV mode, press the TV POWER button twice.

- If the TV turns off, setup is complete.

## Dynamic range compression (DRC) function

This function allows for fullness of sound with Dolby Digital effect even when playing at low volumes during night time listening.

**Press the D.R.C button.**

✎ The selection switches back and forth between "D.R.C. ON" and "D.R.C. OFF" each time the button is pressed.

✎ This function only works when in the Dolby Digital mode.

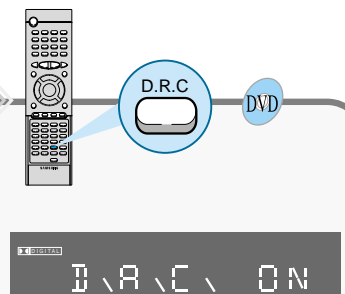

# Speaker Setup

## To set up Speaker Balance

1

Press the **Sound Edit** button.

2

Use the **Left/Right** ( ◀ / ▶ ) button to make adjustment.

¥Each time the button is pressed the selection switches as shown below.

### Example: 5.1CH Sound Setup

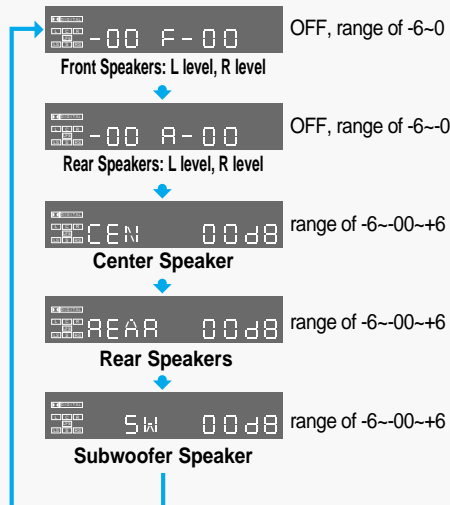

**Note**

The display changes depending on the current audio output mode (DSP, PROLOGIC, 3-STEREO, STEREO, etc.).

## Speaker Setting Methods

Press the **TEST TONE** button.

¥Depending on the number of languages recorded on a DVD disc, a different audio language (KOREAN, ENGLISH, JAPANESE, etc.) is selected each time the button is pressed.

To End the Language Features Setup

¥Press the **Test Tone** button again.

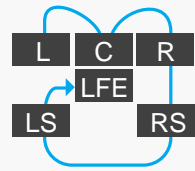

**Note**

While in DSP or PRO LOGIC mode, TEST TONE may operate differently for VCDs or CDs

## Selecting Dolby Pro Logic

Press the **Pro Logic** button.

Converts encoded Dolby Pro Logic 2 channel sound (example: external input received by Stereo VCR is Dolby Digital 2 channel) to 4 channel sound. This feature is unavailable in DVD mode.

1

Press the Function Selection button to select the desired function.

¥Select from FM, AM, AUX IN.

¥You can also press the **Stop** ( ■ ) button on the front panel of the main unit.

2

Press the **PRO LOGIC** button.

¥Each time the Pro Logic button is pressed

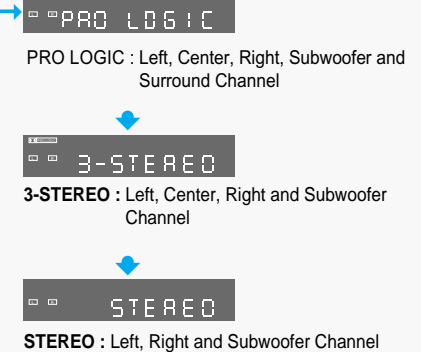

# Speaker Setup

## Setting up Speaker Mode and Delay Time

Press the SPK Mode button.

Each time the button is pressed, a different mode selection is displayed on the front panel display as shown below.

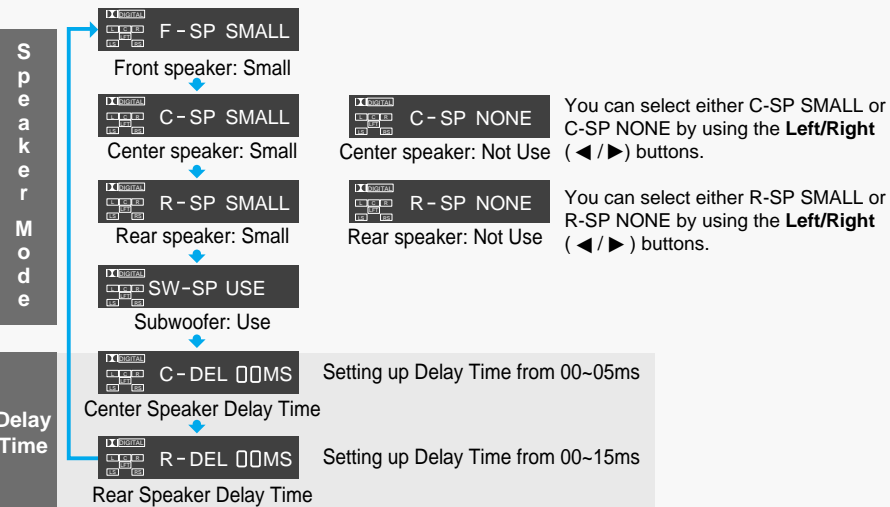

**Note**

The display changes depending on the current audio output mode (DSP, PROLOGIC, 3-STEREO, STEREO, etc.).

## To set the delay time

When 5.1 Channel Surround Sound is played, you can enjoy the best sound if the distance between you and each speaker is the same. You can set Delay Time in the Center/Rear Speaker to customize the sound to the acoustics of your room.

**Setting Center Speaker**  
If the distance of Dc is equal to or longer than the distance of Df in the figure, set the mode as 0ms. Otherwise, change the setting according to the table on the table.

**Setting Rear Speakers**  
If the distance of Df is equal to the distance of Ds in the figure, set the mode as 0ms. Otherwise, change the setting according to the table.

(A)=Df-Dc

Distance of (A)	Value(ms)
50	1.3
100	2.6
400	3.9
200	5.3

(B)=Df-Ds

Distance of (B)	Value(ms)
200	5.3
400	10.6
600	15.9

Dc: Distance from center speaker to listening position  
Df: Distance from front speakers to listening position  
Ds: Distance from rear speakers to listening position

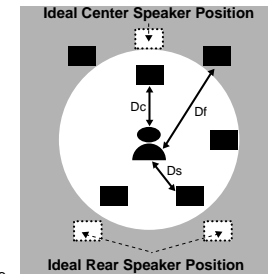

Arrange all speakers within a circle as shown in the figure.

## Speaker Setting Methods

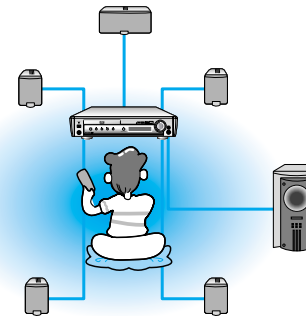

### Front Speakers ● ● ●

Set the front speakers so that their tweeters (high-range) are aligned at about ear level and at a horizontal angle of 45° to the prime listening position.

### Center Speaker ● ● ●

Ideally the center speaker should be positioned with its top surface flush with the front speakers. However, you may place the speaker either on top or near the bottom of your TV set.

### Rear Speakers ● ● ●

Set the rear speakers further back parallel to the walls, at 60 to 90 centimeters (2 to 3 feet) above prime listening position ear level.

If the space behind the listening position is insufficient (i.e., too close to the wall), place the rear speakers facing each other on either side.

### Subwoofer Speaker ● ● ●

Place the subwoofer at any convenient location within the vicinity of the listening position.





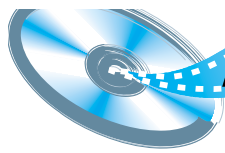

# About RDS broadcasting

## Using the RDS (Radio Data System) to receive FM stations

RDS allows FM stations to send an additional signal along with their regular program signals. For example, the stations send their station names, as well as information about what type of program they broadcast, such as sports or music, etc.

When tuned to an FM station which provides the RDS service, the RDS indicator lights up on the display.

¥Description on RDS function

- 1. PTY (Program Type)** : Displays the type of programme currently being broadcast
- 2. PS NAME (Program Service Name)** : Indicates the name of broadcasting station and is composed of 8 characters.
- 3. RT (Radio Text)** : Decodes the text broadcast by a station (if any) and is composed of maximum 64 characters.
- 4. CT (Clock Time)** : Decodes the real time clock from the FM frequency.  
¥Some stations may not transmit PTY, RT or CT information therefore this may not be displayed in all cases.
- 5. TA (Traffic Announcement)** : When this symbol flashes it shows that the traffic announcement is in progress.

- Note** ¥RDS is not available for AM (MW) broadcasts.  
¥RDS may not operate correctly if the station tuned is not transmitting RDS signal properly or if the signal strength is weak.

## What information can RDS signals provide?

You can see the RDS signals the station sends on the display.

### TO show the RDS signals

Press RDS DISPLAY while listening to an FM station.

Each time you press the button, the display change to show you the following information:

→ PS NAME → PTY → RT → CT → Frequency

- PS (Program Service)** : While searching, "PS" appears and then the station names will be displayed. "NO PS" appears if no signal is sent.
- PTY (Program Type)** : while searching, "PTY" appears and then the type of the broadcast program will be displayed. "NO PTY" appears if no signal is sent.
- RT (RadioText)** : while searching, "RT" appears and then text messages the station sends will be displayed. "NO RT" appears if no signal is sent.
- Frequency** : station frequency (non-RDS service)

### About characters shown in the display

When the display shows PS, PTY, or RT signals, the following characters are used.

- ¥The display window cannot differentiate upper case and lower case letters and always uses upper case letters.
- ¥The display window cannot show accented letters, "A," for instance, may stand for accented "A's" like "Ä, Å, Æ, Å and Ä."

**Note** If searching finishes at once, "PS", "PTY", and "RT" will not appear on the display.

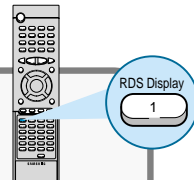

## PTY (Program Type) indication and PTY-SEARCH function

One of the advantages of the RDS service is that you can locate a particular kind of program from the preset channels by specifying the PTY codes.

### To search for a program using the PTY codes

Before you start, remember...

- ¥The PTY Search is only applicable to preset stations.
- ¥To stop searching any time during the process, press PTY SEARCH while searching.
- ¥There is a time limit in doing the following steps. If the setting is cancelled before you finish, start from step 1 again.
- ¥When pressing the buttons on the primary remote control, make sure that you have selected the FM station using the primary remote control.

- 1** Press PTY SEARCH while listening to an FM station.
- 2** Press and hold PTY or until the PTY code you want appears on the display window, while "PTY SELECT" is flashing.  
¥The display gives you the PTY codes described to the right.
- 3** Press PTY SEARCH again, while the PTY code selected in the previous step is still on the display.  
¥The center unit searches 15 preset FM stations, stops when it finds the one you have selected, and tunes in that station.

Display	Program Type
NEWS	• News including an announced opinion and report
AFFAIRS	• Several matters including a current incident, documentary, discussion and analysis.
INFO	• Information including weights and measures, returns and forecast matters interesting the customer, medical information, etc.
SPORT	• Sports
EDUCATE	• Education
DRAMA	• Drama-Radio serial, etc.
CULTURE	• Culture-national or local culture including the religious problem, social science, language, theater, etc.
SCIENCE	• Natural science and technology
VARIED	• Other-Speech, amusing program (quiz, game), interview, comedy and satirical play, etc.
POP M	• Pop music
ROCK M	• Rock music
EASY M	• Current contemporary music considered to be "easy-listening".
LIGHT M	• Light classical music-Classical music and instrumental and chorus music
CLASSICS	• Heavy classical music-Orchestra music, symphony, chamber music and opera
OTHER M	• Other music - Jazz, R & B country music
WEATHER	• Weather
FINANCE	• Finance
CHILDREN	• Children's programmes
SOCIAL	• Social affairs
RELIGION	• Religion
PHONE IN	• Phone in
TRAVEL	• Travel
LEISURE	• Leisure
JAZZ	• Jazz Music
COUNTRY	• Country Music
NATION	• National Music
OLDIES	• Oldies Music
FOLK M	• Folk Music
DOCUMENT	• Documentary

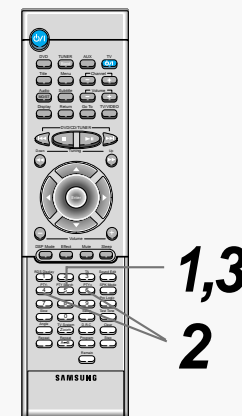

# DSP/Sleep Function

## To Select a DSP

Press the DSP Mode button.

✧The DSP mode toggles in the following order each time the DSP button is pressed:  
HALL → THEATER → PAVILION →  
DANCE CLUB → LIVE CLUB.

What is a DSP?

DSP synthetically recreates the sound field to achieve a more realistic, powerful sound.

Note

✧DSP mode cannot be selected when a microphone is connected.  
✧When playing a DVD containing MPEG format, video may not be reproduced correctly and you may get picture distortion.

## To increase Effect level

Press the Effect button.

✧The effect level can be set in steps from 1 to 4  
EFFECT1 → EFFECT2 → EFFECT3 →  
OFF(DEFAULT).

Each time the button is pressed the selection moves to the next effect.

✧The higher the number, the stronger the DSP surround effect will be.

What is a Effect?

This sets the strength of the DSP mode.

## To set up Sleep

Press the Sleep button.

✧Each time the button is pressed the selection toggles as follows: SLEEP 10 → SLEEP 20 → SLEEP 30 → SLEEP 60 → SLEEP 90 → SLEEP 120 → SLEEP 150 → OFF.

### To Review Sleep Setting

✧The remaining time for the selected Sleep time is displayed.

✧Pressing the button once again changes the Sleep time from the last setting.

What is the Sleep function?

You can set the delay time so that the unit powers off automatically after a preset period of time.

# Troubleshooting

Problem	Check
<b>The disc tray does not open.</b>	<ul style="list-style-type: none"> <li>✧Is the disc installed with the label side facing up?</li> <li>✧Is the power cord plugged securely into the power outlet?</li> <li>✧Turn off the power to the unit by pressing the <b>Power</b> (⏻) button and turn it back on.</li> </ul>
<b>Disc does not play.</b>	<ul style="list-style-type: none"> <li>✧Check the region number of the DVD.</li> <li>✧DVD discs purchased abroad may not be playable.</li> <li>✧This player cannot play CD-ROMs, DVD-ROMs, etc.</li> <li>✧Check the rating level of the DVD.</li> </ul>
<b>Playback does not start immediately when the Play/Pause button is pressed.</b>	<ul style="list-style-type: none"> <li>✧Check whether the disc has any scratch marks or is deformed?</li> </ul>
<b>No sound is produced.</b>	<ul style="list-style-type: none"> <li>✧Is the power cord plugged securely into the power outlet?</li> <li>✧No sound is heard during high-speed playback, slow playback, and step motion playback modes.</li> <li>✧Are the speakers properly connected? Is the speaker Setup correctly customized?</li> <li>✧Is the disc installed with the label side facing up?</li> <li>✧Is the disc severely damaged? The disc may be dirty. Wipe off fingerprints or dirt.</li> </ul>
<b>Picture does not appear; sound is not produced; the disc tray opens 2-5 seconds later.</b>	<ul style="list-style-type: none"> <li>✧Was the player moved suddenly from a cold place to a warm one? When condensation forms inside the player, remove the disc and let the player stand for 1 or 2 hours with the power on. (You can use the player after the condensation disappears.)</li> </ul>
<b>Sound quality is irregular.</b>	<ul style="list-style-type: none"> <li>✧Are the speaker cables loose?</li> <li>✧Is there any dirt or debris at the end of the speaker connector?</li> </ul>
<b>Dolby Digital 5.1 Channel Surround Sound is not being reproduced.</b>	<ul style="list-style-type: none"> <li>✧Does the disc being played show the "Dolby Digital 5.1CH" mark? 5.1-channel sound is reproduced only if the disc is recorded with 5.1 channel sound.</li> <li>✧Is the DVD player connected to the proper speakers?</li> </ul>

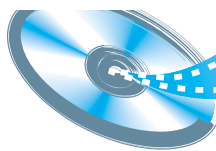

## Cautions on Handling and Storing Discs

Small scratches on the disc may reduce sound and picture quality or cause breaks in playback. Be especially careful not to scratch discs when handling them.

Problem	Check
<p>¥The disc revolves but no picture appears.</p> <p>¥Picture shows interference and quality is poor.</p>	<p>¥Is the TV power turned on?</p> <p>¥Are the video cables properly connected?</p> <p>¥Is it the player in PAUSE mode?</p> <p>¥Is your TV's video format (NTSC/PAL) set correctly? Press the NTSC/PAL button once again to change the current selection.</p> <p>¥Is there any dirt on the disc, or is the disc damaged?</p> <p>¥It may not be possible to play some DVD discs due to poor manufacture.</p> <p>¥When a dark scene changes to a bright scene during playback, the screen may flicker vertically. Some disturbance is normal.</p>
<p>Remote control unit does not operate.</p>	<p>¥Is the remote control being used within the appropriate distance and angle of operation for the unit?</p> <p>¥Are there any obstacles between the remote control unit and the remote control sensor?</p> <p>¥Are the batteries dead? Is it time to replace the batteries with new ones?</p>
<p>Audio or subtitle language does not operate.</p>	<p>¥The audio or subtitle language features does not operate with DVDs that do not include multiple audio or subtitle languages.</p>
<p>The Menu button is pressed but the Menu screen does not appear.</p>	<p>¥Is the remote control being used within the appropriate distance and angle of operation for the unit?</p> <p>¥Are the batteries dead?</p> <p>¥Does the disc have a Menu?</p>
<p>The screen ratio cannot be changed.</p>	<p>¥You can play 16:9 wide DVDs in 16:9 WIDE mode or 4:3 LETTER BOX mode or 4:3 PAN-SCAN mode; but 4:3 encoded DVDs only show in 4:3 ratio. Refer to the DVD disc jacket and then select the appropriate function.</p>
<p>The desired radio station cannot be tuned in.</p>	<p>¥Is the antenna installed properly?</p> <p>¥When the antenna's input signal is weak, install an external FM antenna in an area with good reception quality.</p>
<p>¥The password for the rating level has been forgotten.</p> <p>¥The DVD player is malfunctioning.</p>	<p>¥While the player is in the stop mode, hold the Stop (■) button down on the main unit for over 5 seconds. "INITIAL" appears on the display and all settings will return to the Factory Preset condition.</p> <p><b>The RESET function erases all settings; do not use this function unless necessary.</b></p>

### Handling and Storing Discs



**When you get fingerprints or dirt on the disc, clean it with a mild detergent diluted in water and wipe with a soft cloth.**

¥When cleaning, wipe gently from the inside to the outside of the disc.



Condensation may form if warm air comes into contact with cold parts inside the player. When condensation forms inside the player, the player may not operate correctly. If this occurs, remove the disc and let the player stand for 1 or 2 hours with the power on.

### Disc Storage

**Do not keep in direct sunlight**

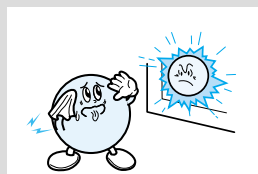

**Keep in a cool ventilated area**

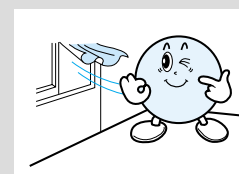

**Keep in a clean Protection jacket. Store vertically.**

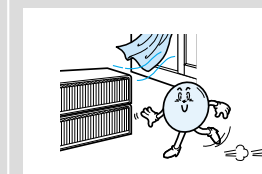



¥Do not allow the discs to become contaminated with dirt.

¥Do not load cracked discs or discs that are scratched.

# Disc Type and Protection

## Usable Discs

Disc Types	Marks	Recording Types	Disc Size	Max. Playing Time
DVD		Audio + Video	12cm	Approx. 240 min. (Single-sided)
				Approx. 480 min. (Double-sided)
			8cm	Approx. 160 min. (Single-sided)
				Approx. 160 min. (Double-sided)
VIDEO-CD		Audio + Video	12cm	74 min.
			8cm	20 min.
AUDIO-CD		Audio	12cm	74 min.
			8cm	20 min.



Dolby Digital disc



DTS Disc



Digital Audio disc

STEREO

Stereo disc

NTSC

NTSC broadcast system in USA, Canada, Japan, South Korea, etc..

PAL

PAL broadcast system in U.K, France, Germany, etc.

## Do not use the following types of disc!

✖ LD, CDG, CD-I, CD-ROM and DVD-ROM cannot be played on this player.





✖ DVD discs purchased abroad may not play on this player.

If such discs are played, a "WRONG REGION CODE" message appears on the TV screen.

# Specification

GENERAL	Power Consumption	120W		
	Weight	6.5Kg		
	Dimensions	W 370mm x D 300mm x H 80mm		
	Operating Temperature Range	+5°C~+35°C		
	Operating Humidity Range	10%~75%		
FM TUNER	Usable Sensitivity	10dB		
	S/N Ratio	60dB		
	Distortion	0.5%		
AM TUNER	Usable Sensitivity	54dB		
	S/N Ratio	40dB		
	Distortion	2%		
VIDEO OUTPUT	Composite Video	1.0Vp-p(75Ω load)		
	Scart Jack	Compositive Video : 1.0Vp-p(75Ω load)		
		Luminance signal : 1.0Vp-p(75Ω load)		
		Color Signal : 0.286Vp-p(75Ω load)		
	S-VIDEO	Luminance Signal: 1.0Vp-p(75Ω load)		
Color Signal: 0.286Vp-p(75Ω load)				
AMPLIFIER	Front speaker output	40W x 2(6Ω)		
	Center speaker output	40W(6Ω)		
	Rear speaker output	40W x 2(6Ω)		
	Subwoofer speaker output	70W(3Ω)		
	Frequency range	20Hz~25KHz		
	S/N Ratio	75dB		
	Channel separation	50dB		
	Input sensitivity	(AUX)500mV		
	SPEAKER	Speaker system	5.1ch speaker system	
Front/Center/Rear speaker			Subwoofer speaker	
Impedance		6Ω x 5	3Ω	
Frequency range		150Hz~18KHz	45Hz~250Hz	
Output sound pressure level		87dB/W/M	86dB/W/M	
Rated input		40W	70W	
Maximum input		80W	140W	
Dimensions		Front/Rear	103mm x 150mm x 120mm	250mm x 403mm x 335mm
		Center	197mm x 103mm x 120mm	
Weights	Front/Rear	0.73Kg	6.8Kg	
	Center	0.80Kg		

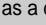
## Note on Terminology

<b>ANGLE</b>	Recorded onto some DVD discs are scenes which have been simultaneously shot from a number of different angles (the same scene is shot from the front, from the left, from the right, etc.). With such discs, the Angle button can be used to change the angle of view for specific scenes.
<b>CHAPTER NUMBER</b>	These numbers are recorded on DVD discs. A Title is subdivided into many sections, each of which is numbered, and specific parts of the video can be searched quickly using these numbers.
<b>DVD</b>	A high-density optical disc on which high-quality pictures and sound have been recorded by means of digital signals. Incorporating a new video compression technology (MPEG-2) and high-density recording technology, a DVD disc comprises two 0.6 mm thick discs bonded together.
<b>PCM</b>	An acronym for Pulse Code Modulation - another name for digital audio.
<b>PBC (PLAYBACK CONTROL)</b>	This is recorded on a video CD (version 2.0). Selected scenes or information can be chosen from the menu displayed on the TV monitor.
<b>REGION NUMBER</b>	Both the DVD player and DVD discs are encoded with a region number. If the region number on the DVD disc does not correspond to the region number of the DVD player, the player cannot play the disc.
<b>SUBTITLES</b>	Translated appearing at the bottom of the screen. A DVD disc can contain up to 32 subtitle languages.
<b>TITLE NUMBER</b>	These numbers are recorded on DVD discs. When a disc contains two or more movies, these movies are numbered as Title 1, Title 2, etc.
<b>TRACK NUMBER</b>	These numbers are assigned to the tracks which are recorded on video and audio CDs. They enable specific tracks to be located quickly.
<b>VIDEO CD</b>	Contains recordings of pictures and sound whose quality is roughly comparable to that of video tape. This player also supports video CDs with playback control (version 2.0).
	You can enjoy 5.1 (or 6) channels of high fidelity digital sound from various digital input sources such as laser discs, DVD, CD etc. DTS provides a realistic, clear surround sound that has not previously been available from conventional surround sound.
	5.1 (or 6) Channel Digital Surround sound reproduced from DVDs and LDs recorded as a digital signals (with  disc marking). With better sound quality, dynamic range, and directionality than the traditional Dolby surround technology, you can enjoy the dynamic realistic sound.
	A 4 channel analog sound reproduced from a program source such as a videotape or LP with the  mark. You can enjoy a more realistic, robust sound unavailable from regular stereo sources.

## Free Manuals Download Website

<http://myh66.com>

<http://usermanuals.us>

<http://www.somanuals.com>

<http://www.4manuals.cc>

<http://www.manual-lib.com>

<http://www.404manual.com>

<http://www.luxmanual.com>

<http://aubethermostatmanual.com>

Golf course search by state

<http://golfingnear.com>

Email search by domain

<http://emailbydomain.com>

Auto manuals search

<http://auto.somanuals.com>

TV manuals search

<http://tv.somanuals.com>