



OWNER'S INSTRUCTIONS

Register your product at www.samsung.com/global/register

DA99-01220J REV(0.2)

FEATURES

Environment-friendly fridge/freezer using R600a refrigerant and cyclopentane blowing agent.

- This products protects the environment by using the R600a refrigerant and the cyclopentane blowing agent.
- Properties:
 - ODP (Ozone Depletion Potential): 0
 - GWP (Global Warming Potential): Lowest

High-energy efficiency (A+) (Optional)

- Optimized power consumption when using R600a and cyclopentane.

SUPER fast freezing function

- Food can be stored in fresh conditions by cooling it quickly via the "Super Freeze" freezing function.

Fresh compartment, just above 0°C

- Drawer for dry or wrapped food.
- Drawer for fresh salades, vegetables and fruits.

Fridge at the top, drawer type freezer at the bottom

- The highly ergonomic vegetable compartment is placed at waist height as it is frequently used.
- The drawer-type freezer minimizes temperature variations and stores food cleanly and conveniently.

Operation

- The operation switch is handy to switch the appliance on and off without pulling out the main plug.

Digital temperature control display (Optional)

- The display shows all functions of the appliance, so that you can easily control them.

Vacation (Optional)

- Save on energy consumption by switching off the fridge and maintaining only the freezer running when you take a long vacation or are away for any reason.

Easy Handle (Optional)

- Doors can be easily and smoothly opened with this "Easy Handle"

CoolSelect Zone Drawer (Optional)

- Drawer for set temperature in the fridge.
- Drawer for Quick Cool funtion.



Note

These operating instructions cover various models. The characteristics of your appliance may differ slightly from those described in this instructions.

R600a or R134a is used as a refrigerant. Check the compressor label on the rear of the appliance and the rating label inside the fridge to see which refrigerant is used for your refrigerator.

CONTENTS

FEATURES	2
SAFETY INSTRUCTIONS	3
INSTALLING THE FRIDGE / FREEZER	6
PREPARING THE FRIDGE / FREEZER	7
USING THE CONTROL FEATURES	7
STORING FOOD IN THE REFRIGERATOR OR FREEZER ..	11
MAKING ICE	13
USING THE WATER DISPENSER (OPTIONAL)	14
CoolSelect Zone™ DRAWER GUIDE (OPTIONAL)	16
REMOVING AND CLEANING THE ACCESSORIES	17
CLEANING THE WATER DISPENSER	18
REPLACING THE INTERIOR LIGHT	19
HOW TO INSTALL DOOR HANDLES	19
REVERSING THE DOOR SWING	21
PROBLEMS AND SOLUTIONS	27
USAGE PRECAUTIONS	28
VIEW OF YOUR FRIDGE / FREEZER	29

SAFETY INSTRUCTIONS

IMPORTANT SAFETY INFORMATION. READ ALL INSTRUCTIONS BEFORE USING.



- Use this appliance only for its intended purpose as described in this Owner's Instructions. We strongly recommend that any servicing be performed by a qualified individual.

SAFETY PRECAUTIONS

- When using electrical appliances, basic safety precautions should be followed, including the following:

CAUTION / WARNING SYMBOLS USED

 WARNING	Indicates that a danger of death or serious injury exists.
 CAUTION	Indicates that a risk of personal injury or material damage exists.

OTHER SYMBOLS USED

	Represents something you must NOT do.
	Represents something you must NOT disassemble.
	Represents something you must NOT touch.
	Represents something you must follow.
	Indicates that you must disconnect the power plug from the socket.
	Represents a ground is needed to prevent electric shock.
	It is recommended that this symbol be handled by service man.

- This refrigerator must be properly installed and located in accordance with the Installation Instructions before it is used.
- ⊘ Do not install the refrigerator in a damp place or a place where it may come in contact with water.
 - Deteriorated insulation of electrical parts may cause an electric shock or fire.
- Do not allow children to climb, stand or hang on the shelves or doors in the refrigerator. They could damage the refrigerator and seriously injure themselves.
- ⊘ The appliance is not intended for use by children or infirm persons without supervision. Children should be supervised to ensure that they do not play with the appliance.
- ⊘ If the refrigerator will not be used for vacation or a long period of time, ensure the refrigerator is empty and disconnect the plug from the mains.
 - Most power failures that are corrected in an hour or two will not affect your refrigerator temperatures. However, you should minimize the number of door openings whilst the power is off. But Should the power failure last more than 24hours, remove all frozen food.
- Allow sufficient space to install the refrigerator on a flat surface.
 - If your refrigerator is not level, the internal cooling system may not work correctly.
 - Do not disassemble or repair the refrigerator by yourself. You run the risk of causing a fire, malfunctions and/or personal injury.
 - The appliance must be positioned so that the plug is accessible after installation.

Do not place this refrigerator in direct sunlight or expose to the heat from stoves, room heaters or other appliance.

If you smell pharmaceutical or smoke, pull out the power plug immediately and contact your Samsung Electronics service center.

R600a or R134a is used as a refrigerant. Check the Compressor label on the rear of the appliance and the rating label inside the fridge to see which refrigerator is used for your refrigerator.



This appliance contains a small amount of isobutane refrigerant (R600a), a natural gas with high environmental compatibility that is, however, also combustible. When transporting and installing the appliance, care should be taken to ensure that no parts of the refrigerating circuit are damaged.

Refrigerant squirting out of the pipes could ignite or cause an eye injury. If a leak is detected, avoid any naked flames or potential sources of ignition and air the room in which the appliance is standing for several minutes.

Refrigerant squirting out of the pipes could ignite or cause an eye injury. If a leak is detected, avoid any naked flames or potential sources of ignition and air the room in which the appliance is standing for several minutes.

- In order to avoid the creation of a flammable gas-air mixture if a leak in the refrigerating circuit occurs, the size of the room in which the appliance may be sited depends on the amount of refrigerant used. The room must be 1m³ in size for every 8 g of R600a refrigerant inside the appliance. The amount of refrigerant in your particular appliance is shown on the identification plate inside the appliance.
- Never start up an appliance showing any signs of damage. If in doubt, consult your dealer.

SAFETY INSTRUCTIONS

PROPER DISPOSAL OF THE REFRIGERATOR

Before you throw away your old refrigerator or freezer

- When disposing of this or other refrigerators, remove the door/door seals, door latch so that small children or animals cannot get trapped inside.
- Leave the shelves in place so that children may not easily climb inside.
- R600a or R134a is used as a refrigerant. Check the compressor label on the rear of the appliance or the rating label inside the fridge to see which refrigerant is used for your refrigerator. when this product contains flammable gas (Refrigerant R600a) contact your local authority with regard to safe disposal of this product.
- Cyclopentane used as a insulation blowing gas.
The gases in the insulation material require special disposal procedure. Please dispose of the packaging material for this product in an environmentally friendly manner. Please contact your local authorities in regard to the environmentally safe disposal of this product. This product contains flammable insulation blowing gas.
- Please dispose of the packaging material for this product in an environmentally friendly way.



CAUTIONS

- The refrigerant used in the refrigerator/freezer and the gases in the insulation material require special disposal procedures. Ensure that none of the pipes on the back of the appliance are damaged prior to disposal.



WARNING

HOW TO CONNECT ELECTRICITY

- The refrigerator should always be plugged into its own individual electrical outlet which has a voltage rating that matches the rating plate. This provides the best performance and also prevents overloading house wiring circuits, which could cause a fire hazard from overheated wires.
- Never unplug your refrigerator by pulling the power cord. Always grip plug firmly and pull straight out from the outlet.
- Make sure that the power plug is not squashed or damaged by the back of the refrigerator. Do not bend the power cord excessively or place heavy articles on it.
Have the power cord repaired or replaced immediately by the manufacturer or its service agent if the power cord has become frayed or damaged. Do not use a cord that shows cracks or abrasion damage along its length or at either end. If the power cord is damaged, have it replaced immediately by the manufacturer or its service agent.
- When moving the refrigerator, be careful not to roll over or damage the power cord.
- Do not insert the power cord with wet hands.
- Unplug the refrigerator before cleaning and making repairs.
Do not use a wet or damp cloth when cleaning the plug. Remove any foreign matter or dust from the power plug pins. Otherwise there is a risk of fire. If the refrigerator is disconnected from the power supply, you should wait for at least five minutes before plugging it back.
- Unplug the appliance from the power supply before changing the interior light of the refrigerator. Otherwise, there is a risk of electric shock.
If you experience difficulty when changing the light, contact your service center.
In case of LED lamp, don't change the interior light of the refrigerator at your own risk, ask the service agent.
- If the wall socket is loose, do not insert the power plug. There is a risk of electric shock or fire.
- The appliance must be located where the plug is easily accessible.

SAFETY INSTRUCTIONS

FOOD KEEPING & TREATMENT CAUTION

- ⊘ Do not overfill the refrigerator with food.
 - When you open the door, an item may fall out and cause personal injury or material damage.
- Do not put bottles or glass containers in the freezer.
- When the contents freeze, the glass may break and cause personal injury.
 - Bottle should be stored tightly together in the refrigerator so that they do not fall out.
- Do not spray inflammable gas near the refrigerator.
- There is a risk of explosion or fire.
- Do not directly spray water inside or outside the refrigerator.
- There is a risk of fire or electric shock.
- Do not touch the inside walls of the freezer or products stored in the freezer with wet hands.
- This may cause frostbite.
- Do not store volatile or flammable substances in the refrigerator.
- The storage of benzene, thinner, alcohol, ether, LP gas and other such products may cause explosions.
- Do not refreeze frozen foods that have thawed completely.
- Do not store pharmaceuticals products, scientific materials or temperature-sensitive products in the refrigerator.
- Products that require strict temperature controls must not be stored in the refrigerator.
- Do not put a container filled with water on the refrigerator.
- If spilled, there is a risk of fire or electric shock.
- This product is intended only for the storage of food in a domestic environment.

CLEANING CAUTION

- ⊘ Do not insert your hands into the bottom area under the appliance.
 - Any sharp edges may cause personal injury.
- Never put fingers or other objects into the dispenser hole. It may cause personal injury or material damage
- Do not use a wet or damp cloth when cleaning the plug, remove any foreign material or dust from the power cord pins.
- Otherwise there is a risk of fire.

INSTALLATION CAUTION

- ⊘ Do not store articles on the top of the appliance.
- When you open or close the door, the articles may fall and cause personal injury and/or material damage.

GROUNDING CAUTION

- ⚡ The refrigerator must be grounded.
- You must ground the refrigerator to prevent any power one word or electric shocks caused by current leakage from the refrigerator.

Never use gas pipes, telephone lines or other potential lightning rods as ground.

- Improper use of the ground plug can result in electric shock.



WARNING

- Keep ventilation openings in the appliance enclosure or mounting structure clear of obstruction.
- Do not use mechanical devices or any other means to accelerate the defrosting process, other than those recommended by the manufacturer.
- Do not damage the refrigerant circuit.
- Do not place or use electrical appliances inside the refrigerator/ freezer, unless they are of a type recommended by the manufacturer.

Before operating the appliance, please read this manual thoroughly and retain it for your reference.

INSTALLING THE FRIDGE/FREEZER

- 1 Allow an adequate space and install the fridge/freezer on a firm, level floor.**
 - If the appliance is not level, there may be unusual noises and poor cooling.
 - Wait for at least one hour before plugging the appliance in.
- 2 Clean the fridge/freezer.**
 - Wipe and clean the appliance inside and outside with a damp cloth.
- 3 Plug the fridge/freezer into a wall socket used exclusively by this appliance.**
 - This appliance must be properly grounded.
- 4 Place the food in the fridge/freezer.**
 - It is recommended that you wait for the appliance to cool for 2-3 hours before storing food in it.



Warning

Use of an grounded socket exclusively for the appliance:

- If you are using a socket with an earthing terminal, you do not require a separate earthing connection.

Use of a non-grounded socket:

- Connect the "earthing wire" to the copper plate and bury it at a depth of at least 25 cm in the ground.

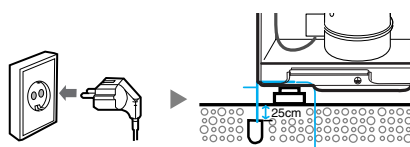

LEVELLING

If the front of the appliance is slightly higher than the rear, the door can be closed more easily.

- 1 The appliance tilts down to the left.**

Turn the left adjusting leg in the direction of the arrow with a flat head screwdriver until the appliance is level.

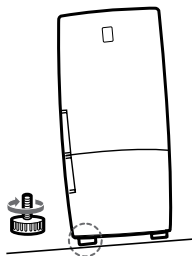

- 2 The appliance tilts down to the right.**

Turn the right adjusting leg in the direction of the arrow with a flat head screwdriver until the appliance is level.

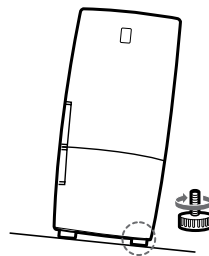

- 3 Allow the enough space for opening drawers.**

Drawers can be easily opened with this condition.

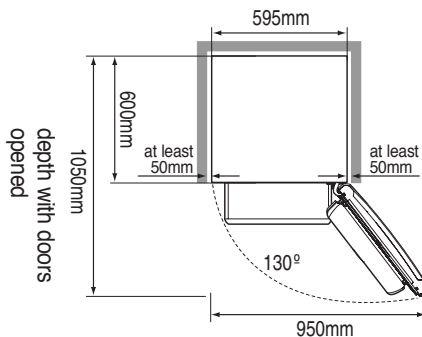

PREPARING THE FRIDGE/FREEZER

To prepare your appliance for use and to check that it is running correctly, take the following steps.

- 1** Install all shelves and compartments removed during transport in the correct positions.
- 2** Clean the fridge/freezer and accessories to remove any dust that accumulated during packing and shipping.
- 3** The interior light of the appliance will light up when fridge door is open.
- 4** Set the temperature control to the coldest temperature and let the refrigerator operate for one hour. The freezer should get slightly chilled and the motor should run smoothly with soft hum.
- 5** Your fridge/freezer is operated by a compressor which switches "Operation" to maintain the internal temperature. For the first five minutes after initial start-up, it may be slightly noisy. This is quite normal and does not represent a fault.
Store food once the temperature in the refrigerator is sufficiently low. It takes a few hours after starting the refrigerator to reach the proper temperature.
- 6** If the appliance does not operate correctly, check the electricity supply. If the problem persists, contact your dealer.

USING THE CONTROL FEATURES

A. Basic Model

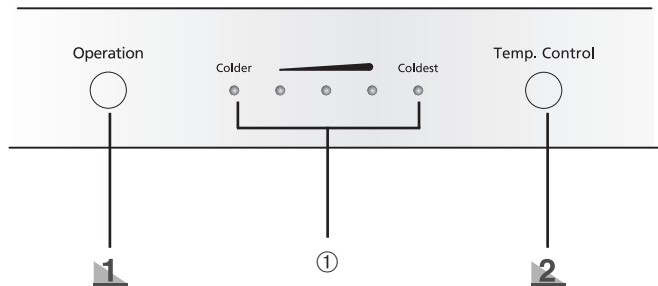
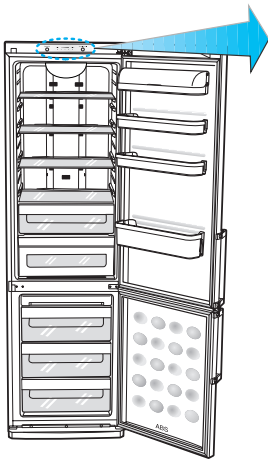

1 Operation Button

- If you want to turn off, keep pressing for 3 seconds.



Note

- Do not disassemble the refrigerator with unit turned on.
- It may cause electric shocks or other damages.

2 Temp. Control button

- Press the Temp. Control button to control the refrigerator temperature.
- Initially, the mid-point temperature is selected.
- There are five temperature settings, represented by five indicator lights (①).
When all lights are on, the temperature is at its coldest.
- Press the Temp. Control button one or more times until the required temperature is set.
- The freezer temperature will be adjusted automatically according to the refrigerator temperature.

USING THE CONTROL FEATURES

B. Model with Digital Display

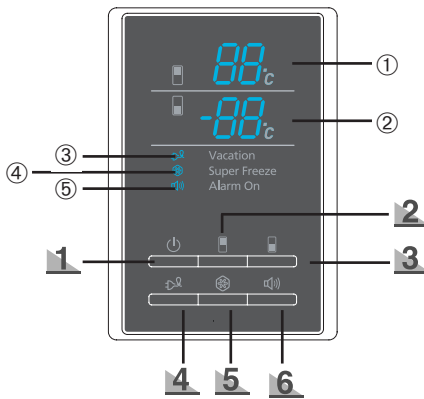
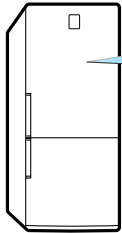

1 Operation Button

- If you want to turn off, keep pressing for 3 seconds.



Note Do not disassemble the refrigerator with unit turned on.
- It may cause electric shocks or other damages.

2 Fridge temp Button

- To change the refrigerator temperature:
 - Press the REF.TEMP button.
 - The current setting temperature is displayed (①).
 - Press the REF.TEMP button one or more times until the required temperature is displayed (①).
 - When you complete the setting of refrigerator temperature, the refrigerator temperature display (①) flashes 5 times.
- The temperature changes in sequence. After +7°C, the display returns to +1°C.
- Refrigerator temperature range: +1°C to +7°C.

3 Freezer temp Button

- In the normal model, the temperature displayed (②) is the setting temperature of the freezer.
- To change the freezer temperature:
 - Press the FRE.TEMP button.
 - The current setting temperature is displayed (②).
 - Press the FRE.TEMP button one or more times until the required temperature is displayed (②).
- The temperature changes in sequence. After -25°C, the display returns to -14°C again.
- Freezer temperature range: -14°C to -25°C.

USING THE CONTROL FEATURES

4 Vacation Button

- If you are going on a long vacation or business trip or you do not need to use the refrigerator, press the Vacation button.
- The refrigerator is switched off but the freezer remains on.
- The Vacation indicator (③) remains on while the Vacation function is operating.



Caution

- You must empty the refrigerator before pressing the Vacation button (③).
- There is no need to disconnect the refrigerator from the power supply if you will be away for less than three weeks. But remove all the food if you are going away for three weeks or more, unplug the refrigerator and clean, rinse and dry it.

5 Super Freeze Button

- Switch for the fast freeze function on or off.
- Use when you wish to freeze foods quickly.
- The Super Freeze indicator (④) remains on while the fast freeze function is running.
- While this function is selected, the refrigerating device remains switched on continuously and produces a very low temperature inside the freezer.
- The super freeze function switches off automatically. When the fast freeze process is completed, the Super Freeze indicator (④) switches off and the freezer switches back to the previous setting temperature.
- To release Super freezer function, press the button again.



Note

- If you need to freeze large amount of food stuff, set the temperature of freezer compartment as the coldest temperature before you turn on the Super Freeze Button.

6 Alarm On Button

- When you press the Alarm on button, it's activated and displayed (⑤). Alarm will go off after a certain period of time when the refrigerator door is kept open.
- If you want to turn off the Alarm when it is set to Alarm On, press the button one more time to cancel the alarm.



Note

- The freezer door does not have an alarm function to indicate that the door is open or closed.



Note

- If the Super Freeze, Vacation mode is already selected and you press one of the other buttons, the current mode is cancelled and the mode corresponding to the button pressed is selected.

USING THE CONTROL FEATURES

C. Model with LCD Display

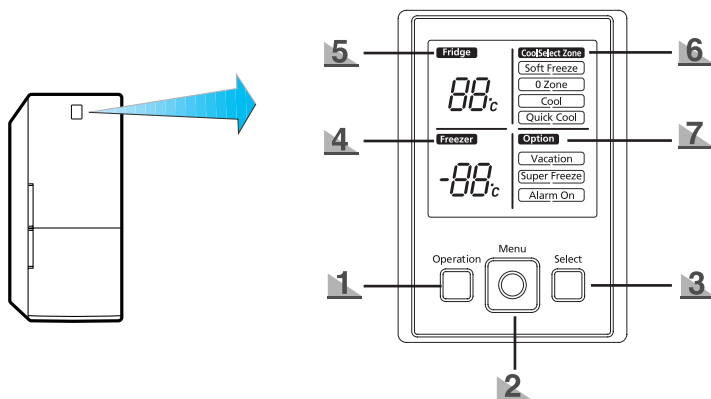

1 Operation Button

- If you want to turn off, keep pressing for 3 seconds.



Note Do not disassemble the refrigerator with unit turned on.
- It may cause electric shocks or other damages.

2 Menu Button

- Display the sub functions of the main menu (Freezer/Fridge/Coolselect Zone/Option) and option so that they can be selected in clockwise direction.



Note If you need to freeze large amount of food stuff, set the temperature of freezer compartment as the coldest temperature before you turn on the Super Freeze Button.

3 Select Button

- Select the details of the zone with the menu button.

4 Freezer

- Temperature setting range for freezer → -14°C ~ -25°C

5 Fridge

- Temperature setting range for refrigerator → 7°C ~ 1°C

6 CoolSelect Zone : Temperature setting range

- Soft freeze (-5°C)
- 0 zone (0°C)
- Cool (3°C)
- Quick cool (60 minutes, continuous operation)

7 Option

- Vacation - Refrigerator off (Operate the freezer only)
- Super Freeze - Super freezing function (Continuous operation for 2 hours and 30 minutes)
- Alarm On - Alarm ON/OFF control function when door is open

STORING FOOD IN THE FRIDGE OR FREEZER

When storing food in the appliance, follow the recommendations below.

- Allow warm food and beverages to cool down before storing them in the appliance.
- Ensure that food is well-wrapped or covered with airtight containers before it is stored. This will prevent food from dehydrating, deteriorating in colour or losing flavor and will help maintain freshness. It will also prevent cross-flavouring.
- Never let any oil or grease come into contact with the plastic fittings or door seals, as these materials easily become porous.
- Never store any explosive substances inside the appliance. High-proof alcohol should only be stored upright in tightly sealed containers.

A. Fridge

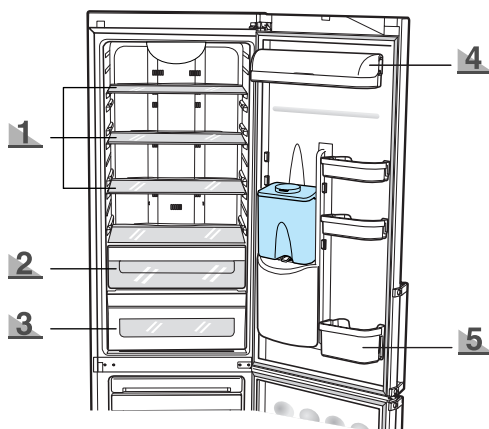

1 Transparent, safety glass shelf (Optional)

- Place food in storage containers and lay the items out at suitable intervals.
- The storage shelf is of an unbreakable, transparent material, so that you can use it safely.



Glass can explode when the contents freeze.

Note



2 Fresh safe drawer (Optional)

- Vegetable and fruit can be stored in this compartment.
- If you require more space to store fruit and vegetables, it is possible to remove the drawers.
- A declared storage volume of fresh food storage compartment is calculated when the fresh safe drawers are removed.

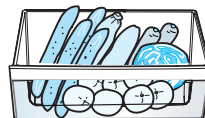

3 Optional

CoolSelect Zone Drawer

- Help to preserve the taste of food and prolong its freshness. Use this to store cheese, meat, poultry fish or any other foods.
- Ideal for storing fish, meat and sausage.
- Temperature in this compartment are lower than in the refrigerator compartment. Temperatures below 0 °C may also occur.
- A declared storage volume of fresh food compartment is calculated with Chiller Compartment removed.



Not suitable for lettuce, vegetables or produce sensitive to cold.

Note

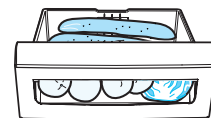

4 Dairy and Variety guard

- Store fatty foods, like butter and cheese.
- Store small, packed foods, like milk, yogurt and beverages.

5 Bottle guard

- Store small bottles and cartons (1 litre) of beer, milk, juice in the upper part and large bottles and cartons (1.5 litres) in the lower part.

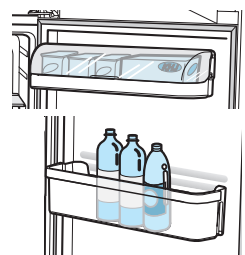

STORING FOOD IN THE REFRIGERATOR OR FREEZER

B. Freezer

Top freezer drawer

- Store packed frozen foods, like ice cream, bacon and pizza.
- Place the ice tray in this drawer in order to achieve optimal ice freezing.

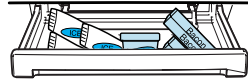

Middle/lower freezer drawer

- Store fresh meat and fish or dried foods, which are divided into suitably sized portions.
- Do not store food which goes bad easily at low temperature, such as bananas, melons.
- Do not put any newly introduced food for freezing near to frozen food.
- Do not place carbonated or fizzy drinks in the freezer compartment.

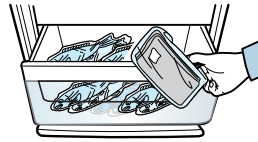

Wrapping food

Note

Pack the food in suitably sized portions for your household.

Vegetable and fruit portions should be no heavier than 1 kg, while meat portions can be up to 2.5 kg. Smaller portions freeze thoroughly more quickly and the quality is therefore maintained when defrosting and preparing the food.

It is important to seal food in airtight bags or containers before freezing to prevent it from losing flavour or dehydrating.

Wrap the food, press out any air and seal it airtight.

Please observe maximum storage period and expiry date of frozen goods.

Suitable wrapping materials: Plastic bags, cling film, aluminium foil and freezer containers.

Unsuitable wrapping materials:

Wrapping paper, greaseproof paper, cellophane, bin bags or used carrier bags.

Suitable sealing materials:

Rubber bands, plastic clips, string, freezer tape or similar.

Plastic film and bags may be heat-sealed using a special sealing iron or press.

Before placing a package in the freezer, it should be clearly labelled with the contents and date of freezing.



Note

- Your appliance is frost free, which means there is no need to manually defrost your appliance, as this will be carried out automatically.
- Temperature rising during the defrost can comply with ISO requirement, But if you want to prevent on undue rise in the temperature of the frozen food while defrosting the appliance. Please wrap the frozen food in several layers of newspaper.
- The appliance may not operate consistently (possibility of defrosting the contents or the temperature becoming too warm in the frozen food compartment) when sited for an extended period of time below the cold end of the range of temperatures for which the refrigerating appliance is designed.

STORING FOOD IN THE REFRIGERATOR OR FREEZER



Note

- To get more space, you can remove top and a middle freezer drawers since it does not affect thermal and mechanical characteristics. A declared storage volume of frozen food storage compartment is calculated with these drawers removed.



Note

The temperature of the refrigerator inside depends on:

- Room temperature.
- The location of the refrigerator.
- Door-opening frequency.
- Setting temperature of each compartment.

MAKING ICE

1 Pour water into the ice cube maker.

- Fill the ice maker up to about 80% with water.



2 Place the ice cube maker in the top freezer drawer.

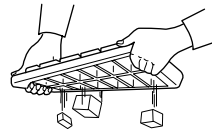

3 To take out the ice cubes:

- Twist the ice cube maker slightly.



Danger of explosion

Warning

- The coldest parts of the refrigerator is the rear panel. This is the best place to store delicate foodstuffs.
- Glass bottles containing liquids that can freeze should never be stored in the freezer as the glass can explode when the contents freeze.



Making ice quickly

Note

To make a large quantity of ice quickly, press the "Super Freeze" button to select the fast freeze function.

USING THE WATER DISPENSER (OPTIONAL)

With the water dispenser, you can obtain chilled water easily without opening the refrigerator door. In addition, you can save electricity by more than 30% reducing the number of times the door is open.

Overview

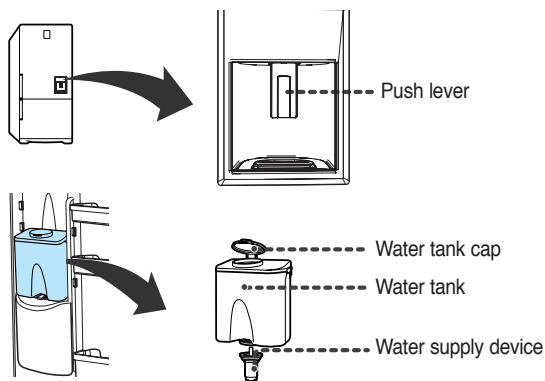

WHEN THE WATER DISPENSER IS NOT USED, THE FOLLOWINGS ARE RECOMMENDED

1

Fix the water supply device tightly into the fixing hole.

- The door will not be closed automatically when the water supply device is pulled out for a long time because of cold leaking.

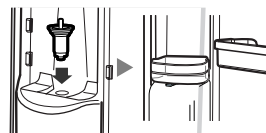

2

Place a separate spare beverage bottle in the location of the exclusive water tank.

- Two 1.5 litre bottles can be placed.



FILLING THE WATER TANK

1

Open the round cap and fill the water tank up with drinking water.

- Don't fill up the water tank too much (just over 4.2 litres). It can cause overflow when the door is opening and closing.



2

Close the round cap by pushing down on it until it clicks into proper place.

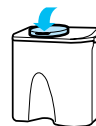

3

Push the water dispenser lever with a cup.

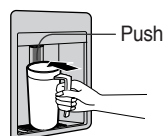

USING THE WATER DISPENSER (OPTIONAL)



INSTALLING A REGULAR BOTTLE

- 1** Press the fixing lever, lift the exclusive water tank upwards, then remove it.



- 2** Remove the water supply device from the exclusive water tank, then set the inner groove of the water supply device in a regular mineral water bottle and fix-it in position by turning it.

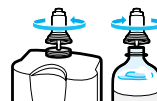

- 3** Turn the water supply device over, then fix-it in position in the fixing hole.



Note

- Gurgling sounds may be heard when air enters the water bottle from regular mineral water or beverage bottles.
- Some regular mineral water or beverage bottles may not fit the water supply device, depending on their size.
- If water does not come out satisfactorily when you press the “push” lever, press it again.
- Do not use carbonated drinks, such as coke, cider or sodas. When you press the button, the beverage may spurt out due to the pressure of carbonic gas accumulated in the upper part of beverage bottle.
- For better hygiene, beverages with a high sugar content (juice, soft drinks) are not recommended.
- You can use bottled mineral water or boiled tap water unless it does contain any particles.

CoolSelect Zone™ Drawer GUIDE (OPTIONAL)

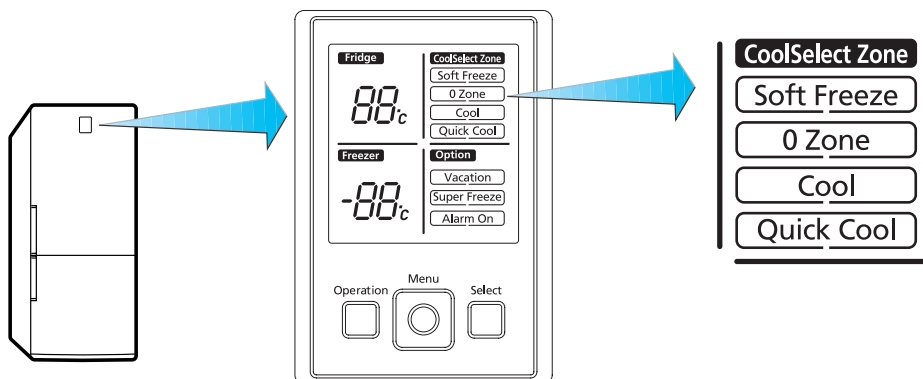

1 Cool, Zero Zone, Soft Freeze function

- When you select Cool, Zero Zone or Soft Freeze function, 3°C, 0°C and -5°C is selected.
- Set by the Select button with the Menu button.

2 Quick Cool

- Set by the Select button with the Menu button.
- When the Quick Cool function is completed, the CoolSelect Zone drawer comes to cool.

REMOVING AND CLEANING THE ACCESSORIES

Before cleaning the appliance, you must always switch it off and unplug it from the wall socket. Do not use a steam cleaner. The hot steam could damage the surface of the appliance or the electrical components, causing a risk of electric shock.

1 Bottle guard

- Hold the bottle guard in both hands, then remove it by lifting it slightly and pulling it towards you.
- Wash it in water.

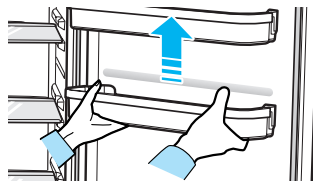

2 Transparent, safety glass shelf (Optional)

- Remove the shelf, then clean it using water and detergent.

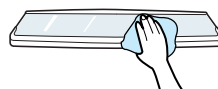

Note

When handling the shelves, hold the shelf by the glass and the trim to prevent accidents.

3 Fresh Safe Drawer (Optional)

- Holding the freezer drawer with both hands, pull it out as far as it will go, then remove it by lifting it up slightly and pulling it towards you.
- Wipe it with a damp cloth.

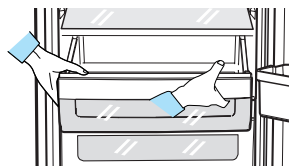

4 CoolSelect Zone Drawer (Optional)

- Holding the freezer drawer with both hands, pull it out as far as it will go, then remove it by lifting it up slightly and pulling it towards you.
- Wipe it with a damp cloth.

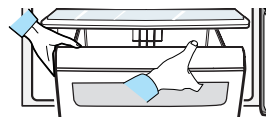

5 Freezer drawer

- Holding the freezer drawer with both hands, pull it out as far as it will go, then remove it by lifting it up slightly and pulling it towards you.
- Wipe it with a damp cloth.

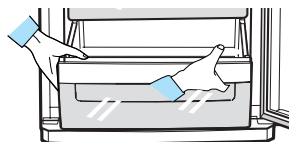

6 Rubber door seals

- If the rubber door seals are dirty, the door will not close properly and the refrigerator and freezer will be unable to function efficiently. Clean them with a mild detergent and a damp cloth. Then wipe them with a dry cloth.

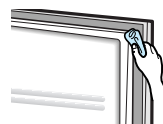

CLEANING THE WATER DISPENSER

Dispenser Tray

1 Pull out the tray with fingers.

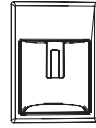

2 Empty the water in the dispenser tray, then clean it using warm water and detergent.

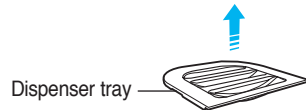

Connection path

Wipe out the connection path and surrounding area with a clean damp cloth.

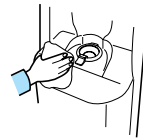

Water Tank / Supply Device

1 Pull upward and disassemble the hooks on both sides of the large-sized cap.

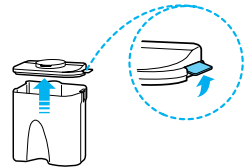

2 Loosen the water supply device by turning it in the direction of the arrow and removing it.

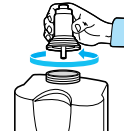

3 Wipe the large-sized cap and the exclusive water tank with warm water and detergent.

- Hold the cap and pull it upwards to remove it. Clean the cap.



4 After cleaning the water supply device with a soft brush, press the water supply device operation lever, then wash it in running water.

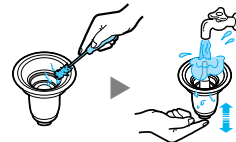

- Clean the water tank frequently if it used to dispense tea or other such beverages. Only use filtered tea. For better hygiene, beverages with a high sugar content (juice, soft drinks) are not recommended.
- Deposits can be cleaned by wiping the tank with a cloth dampened in vinegar or salt water.
- Check that the rubber seal on the water supply device has not slipped off or is not damaged by a sharp-edged object. Otherwise, it may leak.

REPLACING THE INTERIOR LIGHT (OPTIONAL)

Always unplug the appliance when replacing the refrigerator light. Otherwise, there is the danger of electric shock.

1 Push the both ends of the cover and pull it toward you.

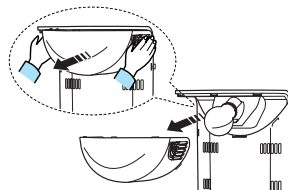

2 **Incandescent light**
• Turn the interior light to pull it out and replace it with a new one.

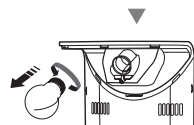

Push the cover forward.

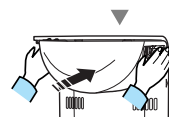

For LED lamp, please contact service engineer to replace it.

Note

HOW TO INSTALL DOOR HANDLES

- NORMAL HANDL

1. Unpack an "ASSY HANDLES INSTALL", taking out it from the inside of the freezer.



2. Remove "CAP HOLE DOOR"s on the side of the fridge which you want to install on.



HOW TO INSTALL DOOR HANDLES

3. Attach an "ASSY HANDLE" on the door with special screws inside.

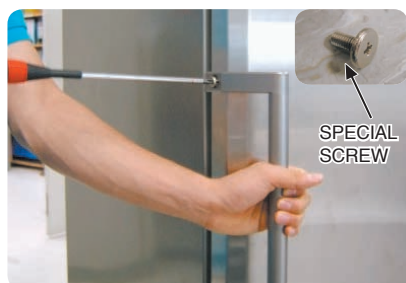

4. Attach Cover screws with "CAP HANDLE SCREW"s.

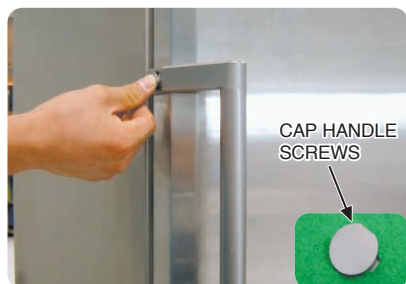

When attaching the other "ASSY HANDLE", follow the same order as mentioned. When you disassemble them, just follow the reverse order.



- EASY HANDLE

1. Unpack an "ASSY HANDLES INSTALL", taking out it from the inside of the freezer.



2. Remove 'CAP HOLE DOOR's on the side of the fridge which you want to install on.



3. Detach "COVER SLIDER HANDLE"s as shown.



HOW TO INSTALL DOOR HANDLES

4. Attach an 'ASSY HANDLE'on the door with special screws.



5. Cover screws with "COVER SLIDER HANDLE"s.



When attaching the other "ASSY HANDLE", follow the same order as mentioned. When you disassemble them, just follow the reverse order.



REVERSING THE DOOR SWING

- Read these instructions completely and carefully



- Before reversing the door, ensure first that the refrigerator is disconnect by the plug from the mains. You should take out contents and accessories like door guard from the doors. Be careful not to drop the doors during dissembling or assembling.

1. Handle parts carefully to avoid scratching the paint.
2. Lay out all the screws by their related parts to avoid using them in the wrong places.
3. Provide a non-scratching work surface for the doors. (ex:blanket)
4. During door reversing, refrigerator should not be stained with oil.

- TOOLS YOU WILL NEED



screwdriver



7/16" inch wrench

- ADDITIONAL PARTS

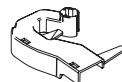

Cover Wire Hinge, R

REVERSING THE DOOR SWING

- DISASSEMBLY OF THE FRIDGE DOOR

1. After removing screws, disassemble the CAP CABI.



2. Disconnect electric wires inside of the CAP CABI.

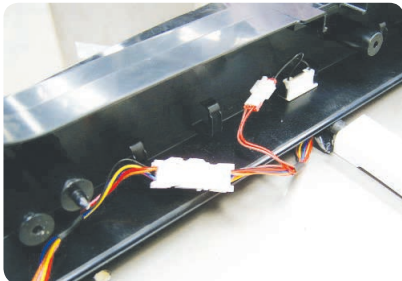

3. With a 7/16 inch wrench, remove bolts on the top of the refrigerator.

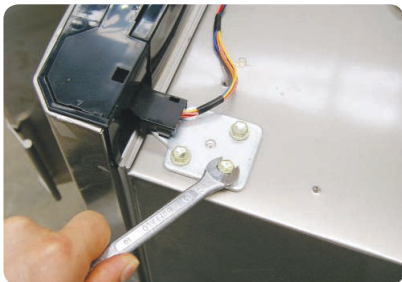

4. Disassemble the Fridge door by lifting it upward. Be careful not to drop and scratch the face of the Fridge door.



5. Disassemble the COVER WIRE DOOR on the top of the fridge door with a flat-head screw driver by putting it into the indicated position (Δ).

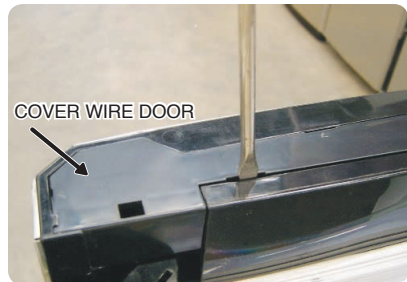

6. Disjoin the COVER WIRE HINGE, R from the ASSY HINGE UPP as shown. Take out the electric wire from the COVER WIRE HINGE, R.

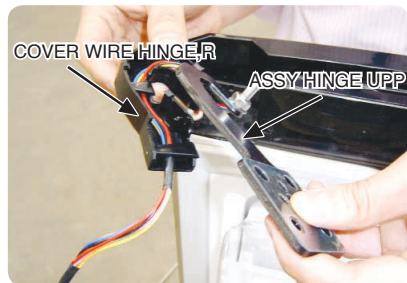

REVERSING THE DOOR SWING

7. Switch the direction of the electric wire as below.
Take out the COVER WIRE HINGE, L from the inside of the CAB CABI, and rejoin it with the electric wire. Make sure the length of the electric wire is more than 150mm.

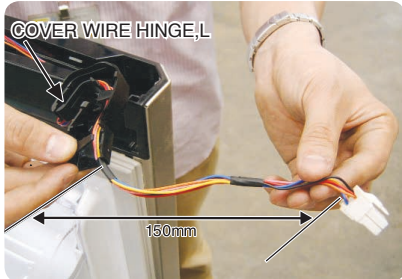

8. Switch the position of the SHAFT upside down on the other side of the ASSY HINGE UPP. After detaching the SHIM, reattach it on the other side of the HINGE UPP

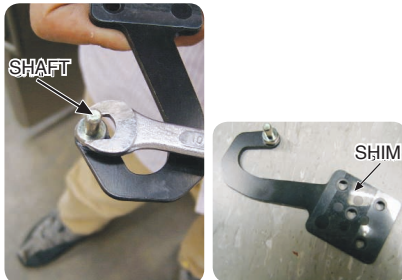

9. After rejoining the COVER WIRE HINGE, L and the ASSY HINGE UPP and switching the position of the GROMMET HINGE and the CAP SPACE DOOR reposition the ASSY HINGE UPP and cover the COVER WIRE DOOR as shown. (The electric wire should be inside of the COVER WIRE DOOR)

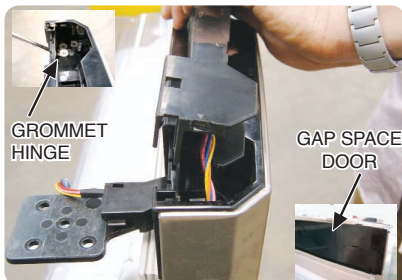

10. Switch the position of the STOPPER DOOR and the GROMMET HINGE as shown.

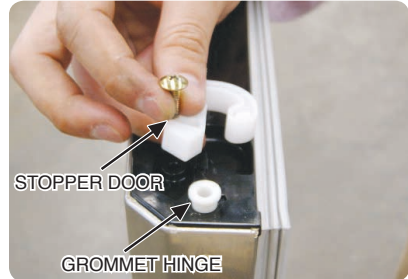

- DISASSEMBLY OF THE FREEZER DOOR

11. After unscrewing and removing two bolts, disassemble the ASSY HINGE MID.



12. Disassemble the Freezer Door by lifting it upward. Be careful not to drop and scratch the Freezer Door.



REVERSING THE DOOR SWING

13. Remove the COVER LEG FRONT COVER by removing the screws.

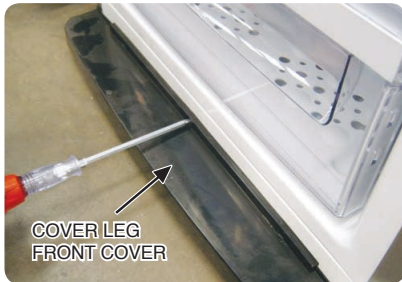

14. After tilting backward the refrigerator slightly for the convenience of the operation, disassemble the ASSY HINGE LOW as shown and put the AUTO GUIDE upside down, switch the position of the SHAFT.

 **Note** When joining, tighten a screw not to make unpredicted noise.

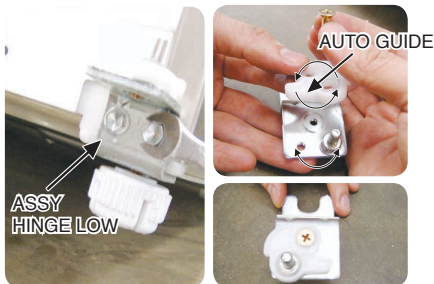

- ASSEMBLY OF THE FRIDGE DOOR

15. Switch the position of the CAP HOLE HINGE MID and a screw.

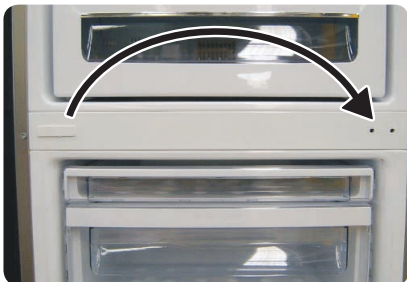

16. Assemble the ASSY HINGE MID with a screw and two bolts.



17. Fit the Fridge door into the ASSY HINGE MID.



18. Secure the ASSY HINGE UPP with bolts as shown. Be careful not to drop the Fridge Door.



REVERSING THE DOOR SWING

19. Switch the position of the CAP HOLE HINGE UPP.

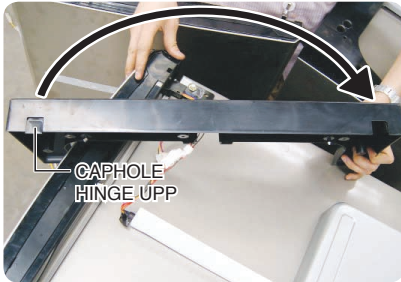

20. Reconnect the electric wires and reposition the wires inside of the CAP CABI as shown below.

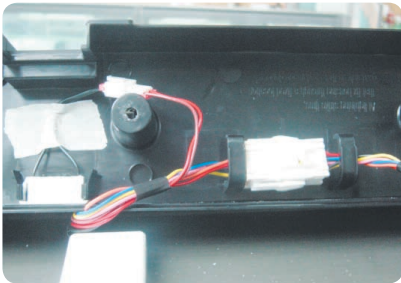

21. Reassemble the CAP CABI, after assuring the position of Wires.

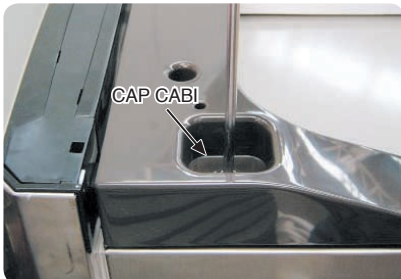

- ASSEMBLY OF THE FREEZER DOOR

22. Switch the position of the GROMMET HINGE and the CAP HINGE HOLE.

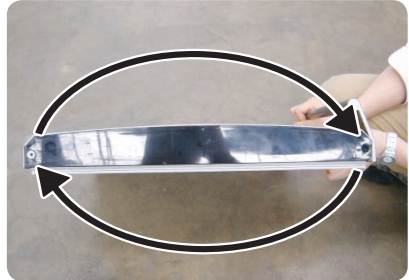

23. Exchange the positions of a bolt and the ASSY HINGE LOW.



24. Fit the Freezer Door into the ASSY HINGE MID.



REVERSING THE DOOR SWING

25. Unfasten the FOOT FRONT to fit the ASSY HINGE LOW.



26. Assemble the ASSY HINGE LOW as shown below with a wrench.



27. After switching the position of the CAP HOLE HINGE LOW, reassemble the COVER LEG FRONT with the door open.



28. Confirm the opening and closing of the Fridge and the Freezer Doors.



- REVERSING THE HANDLE BAR

29. Detach the CAP SCREW HANDLE with flat screwdriver and disassemble the HANDLE BAR with unscrewing.



30. Switch the position of the CAP HOLE DOORS, pulling out and pushing them in.

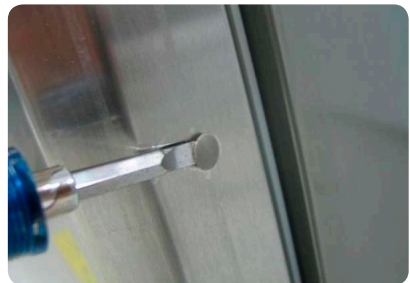

REVERSING THE DOOR SWING

31. Reattach the HANDLE BARS on the other side of doors in reverse order.



PROBLEMS AND SOLUTIONS

The appliance is not operating at all or the temperature is too high

- Check that the power plug is correctly connected.
- Is the temperature control on the front panel correctly set?
- Does sun shine on the appliance or are there heat sources nearby?
- Is the back of the appliance too near to the wall?

The food in the refrigerator is frozen

- Is the temperature control on the front panel set to the coldest temperature?
- Is the surrounding temperature too low?
- Did you put the hot food in the refrigerator?

There are unusual noises

- Check that the appliance is installed on a stable, level floor.
- Is the back of the appliance too near to the wall?
- Have any foreign objects fallen behind or under the appliance?
- Is there noise coming from the compressor in the appliance?
- A ticking sound may be heard inside the appliance; this is normal. This sound occurs when the various accessories contract or expand.

The front corners and sides of the appliance are warm and condensation starts to form

- Heat-proof pipes are installed in the front corners of the appliance to prevent condensation from forming. When the surrounding temperature rises, this may not always be effective. However, this is not abnormal.
- In very humid weather, condensation may form on the outer surface of the appliance when the moisture in the air comes into contact with the cool surface of the appliance.

PROBLEMS AND SOLUTIONS

You can hear a liquid babbling in the appliance

- This is the refrigerant, which cools the inside of the appliance.

There is a bad smell inside the appliance

- You did not seal the food.
- Check food are covered and ensure the cold inlet is clean.

There is a layer of frost on the appliance's walls

- Is the air outlet on the appliance plugged up?
- Space the food out as much as possible to improve ventilation.
- Is the door fully closed?

If condensation forms on the inside wall of the appliance and around vegetables

- Can occur if food with a high water content is stored uncovered with a high humidity level or the door has been left open for a-long time.
- Store the food with a cover or in sealed containers.

USAGE PRECAUTIONS

Store food with a high water content at the front of a refrigerator shelf.

Store hot food in the appliance after it has cooled.

- If you store cold food, you save on electricity and improve refrigeration.



Power Saving Tips

- Install the appliance in a cool, dry room with adequate ventilation. Ensure that it is not exposed to direct sunlight and never put it near a direct source of heat (radiator, for example).
- Never block any vents or grilles on the appliance.
- Allow warm food to cool down before placing it in the appliance.
- Put frozen food in the refrigerator to thaw. You can then use the low temperatures of the frozen products to cool food in the refrigerator.
- Do not keep the door of the appliance open for too long when putting food in or taking food out. The shorter time for which the door is open, the less ice will form in the freezer.

VIEW OF YOUR FRIDGE / FREEZER

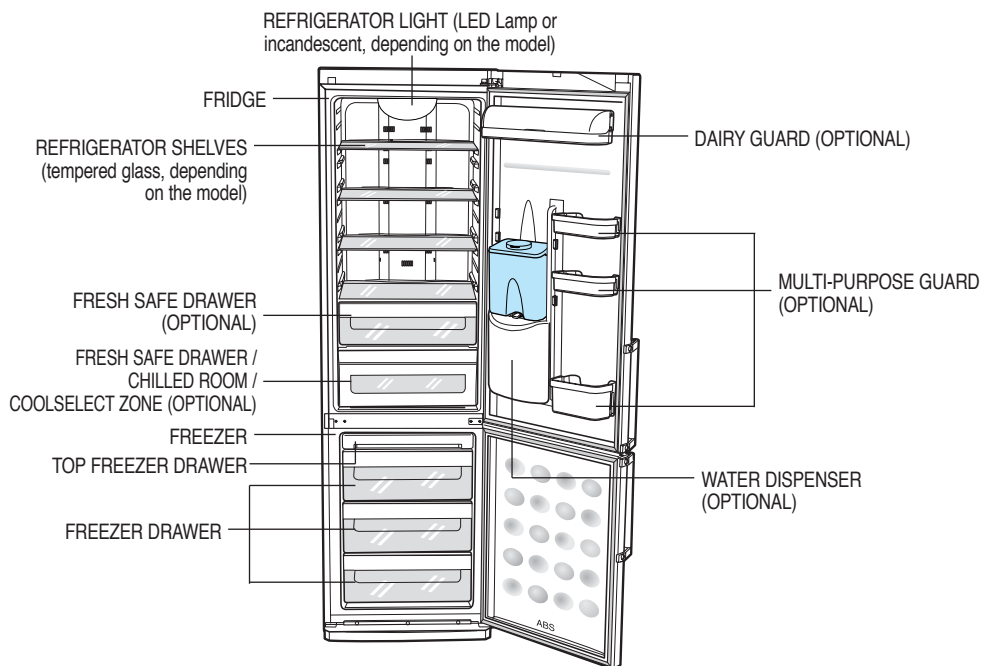

Ambient Room Temperature Limits

This fridge/freezer is designed to operate in ambient temperatures specified by its temperature class marked on the rating plate.

Temperature Class	Symbol	Ambient Temperature	
		Maximum	Minimum
Extended Temperate	SN	32°C (90°F)	10°C (50°F)
Temperate	N	32°C (90°F)	16°C (61°F)
Subtropical	ST	38°C (100°F)	18°C (64°F)
Tropical	T	43°C (109°F)	18°C (64°F)

NOTE: Internal temperatures may be affected by such factors as the location of the fridge/freezer, ambient temperature and the frequency with which you open the-door. Adjust the temperature as required to compensate for these factors.

English



Correct Disposal of This Product (Waste Electrical & Electronic Equipment) (Applicable in the European Union and other European countries with separate collection systems)

This marking shown on the product or its literature, indicates that it should not be disposed with other household wastes at the end of its working life. To prevent possible harm to the environment or human health from uncontrolled waste disposal, please separate this from other types of wastes and recycle it responsibly to promote the sustainable reuse of material resources.

Household users should contact either the retailer where they purchased this product, or their local government office, for details of where and how they can take this item for environmentally safe recycling. Business users should contact their supplier and check the terms and conditions of the purchase contract. This product should not be mixed with other commercial wastes for disposal.

Contact SAMSUNG WORLD WIDE

If you have any questions or comments relating to Samsung products, please contact the SAMSUNG customer care center.

Samsung Electronics America, Inc.
105 Challenger Road
Ridgefield Park, NJ 07660-0511
1-800-SAMSUNG (7267864)
www.samsung.com

Free Manuals Download Website

<http://myh66.com>

<http://usermanuals.us>

<http://www.somanuals.com>

<http://www.4manuals.cc>

<http://www.manual-lib.com>

<http://www.404manual.com>

<http://www.luxmanual.com>

<http://aubethermostatmanual.com>

Golf course search by state

<http://golfingnear.com>

Email search by domain

<http://emailbydomain.com>

Auto manuals search

<http://auto.somanuals.com>

TV manuals search

<http://tv.somanuals.com>