



INSTRUCTION MANUAL **CLT-OHE40**

**2.4 GHz Expansion
Cordless Handset
with Charging Cradle**



IMPORTANT

Charge the handset battery pack a full 15-20 hours before using your cordless handset for the first time.

SANYO Canada Inc.
www.sanyocanada.com

Welcome

Congratulations on your purchase of the SANYO CLT-OHE40 handset and charger. This expansion handset is for use with the CLT-E40/42. Each main base model in this series can support up to four handsets. You can place a fully-featured cordless handset anywhere as long as there is AC power to connect the handset charging cradle.

IMPORTANT

The CLT-OHE40 expansion handset will not operate unless it has been registered to your main base. This manual describes how to set up and connect your new handset; for instructions on operating your new handset, refer to the owner's manual supplied with your main base.

Backward / Forward Compatibility

Your phone is compatible with SANYO CLT-E23 and CLT-E30/32/33 2.4 GHz Digital Expandable Systems.

Checking the Package Contents

Make sure you have received the following items in the package.

- Cordless Handset
- Charging Cradle
- Battery Pack (BT-0001) (pre-installed)
(Capacity: 650 mAh, 3.7V)
- AC Adapter (AD-708)
(INPUT: 120V AC 60Hz) (OUTPUT: 9V DC 210 mA)
- Audio Recording Cable
- Holster
- This Owner's Manual
- Other Printed Material

Step 1: Connect the Charger

- 1** Connect the AC adapter to the **DC IN 9V** jack and to a standard 120V AC wall outlet.
- 2** Set the charger on a desk or tabletop, and place the handset in the charger with the keypad facing forward.
- 3** Make sure the **CHARGE LED** illuminates. If the LED does not illuminate, check to see that the AC adapter is plugged in and that the handset makes good contact with the charger charging contacts.

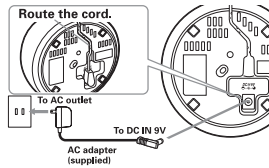

Notes:

- Use only the supplied AD-708 AC adapter. Do not use any other AC adapter.
 - Place the charger close to the AC outlet so that you can unplug the AC adapter easily.
- 4** Charge the handset for 15-20 hours before using. Recharge your handset on a regular basis by returning the handset to the charger after each phone call.

Step 2: Register the Handset

YOU NEED TO REGISTER THE CLT-OHE40 TO A MAIN BASE BEFORE USE!

- 1 Be sure the handset battery is fully charged.
- 2 With the main base in standby mode (i.e., not being used), place the handset in the main base to begin registration.

For compatible models in the CLT-E23 and CLT-E30/32/33 series:

- 1) Disconnect the AC adapter.
- 2) While holding the **find handset** key, connect the AC Adapter:

Keep pressing the key until the **CHARGE** LED starts to blink.

3) On the handset, press and hold **#** until you hear beep.

- 3 Handset Registering will appear in the LCD. Once Registration Complete is displayed, the extra handset is registered to the base. If Registration Failed appears, please try these steps again.

De-register the handset

- 1) Press and hold **END** and **#** for more than 5 seconds.
- 2) Select the handset ID to be de-registered from the list. The phone will ask you to confirm the deregistration. Select Yes.

Using Your Expansion Handset

Now that your new handset is registered, it can perform all the same functions as the handsets originally included with your phone. With your new handset, you can

- Transfer calls or intercom between handsets
- Use two handsets as 2-way radios in Walkie-Talkie mode
- Use two handsets as a baby/room monitor
- Hold 3 or 4 way conference calls (depends on the model)
- Send Text Messages between Handsets (CLT-E40/42 Series Only)
- Record Distinctive Ringer Tones
- Customize Handset with Animations and Wall Paper Displays
- Customize Reminder Displays using Calendar

See the owner's manual that came with your main base for complete instructions on operating your new expanded digital phone.

Using the joystick

The joystick makes it easy to use your phone. The five most commonly used functions are accessible just by moving the joystick:

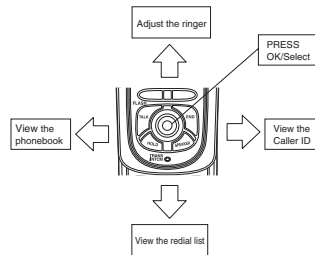

Upward	Adjust the ringer
Downward	View the redial list
Towards the right	View the Caller ID
Towards the left	View the phonebook
Press centre	OK/Select

You will also use the joystick to make menu selections.

To enter the menu, press the center of the joystick inwards or press the **MENU** soft key.

To highlight the option you want, move the joystick up, down, right or left. This will move the cursor to your selection, which will appear in reverse text or icon.

To select the highlighted option, press the center of the joystick inward (You can also press the **OK** soft key).

To go back to the previous menu at any time, press the **BACK** soft key. To exit the MENU and return to standby, press **END** or return the handset to the charging cradle.

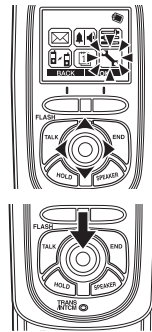

Using your handset with compatible CLT-E23 and CLT-E30/32/33 series phones

Note:

Not all features are available when this handset is used with the CLT-E23 and CLT-E30/32/33 series main base. If you want to use all of this handset's features, use it with a CLT-E40/42 series base.

The CLT-OHE40 has many new features. You can record a ringer from any audio source, select animation on the display, and set alarms to remind you of important events.

Record Ringer Tones

1) Connect the audio recording cable to the handset and sound source (e.g. stereo or CD player). Insert one end of the audio recording cable into the handset's headset jack and the other end into the sound source.

You can also simply use the handset's microphone by holding the handset close to the sound source.

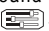
2) Select menu option .

3) Go to Record Ringer.

4) To start recording, press the **RECORD** soft key. The message counter starts at 60 and then begins to count down.

5) To end recording, press the **STOP** soft key.

The phone will play the recorded ringer.

6) Press the center of the joystick or the **SAVE** soft key to store the ringer tone.

7) Enter the title of this ringer. If you don't enter a title, the phone will store it as "Recorded ring."

8) Press the center of the joystick.

Set Animation Displays

1) Select menu option .

2) Scroll to **Animations** and select.

3) To preview Animations press the **VIEW** soft key.

4) Press the **OK** soft key.

Set Wallpaper Displays

1) Select menu option .

2) Scroll to **Themes** and select.

3) To preview wallpaper press the **VIEW** soft key.

4) Press the **SELECT** soft key.

Set Keypad Lock

1) Select menu option .

2) Scroll to **Keypad Lock** and select.

3) Select **Lock**, and press the **OK**.

You'll hear a confirmation tone, and your keypad is locked.

To unlock the keypad temporarily, press any key on the upper part of the handset, and press ***/TONE** in 5 seconds.

To release the keypad lock, press any key on the upper part of the handset, and press the **#** key.

Set Backlight Display Color

1) Select menu option .

2) Scroll to **Backlight Color** and select.

3) Press the **OK** soft key.

Scheduling Reminders

1) Select menu option .

2) Press the **SKDL** soft key, then press the **OPTION** soft key.

3) Scroll to **New Entry** and select.

4) Press the center of the joystick inwards. Use the number keypad or ***/TONE** to select the date and time of this reminder.

5) Press the center of the joystick.

6) To set reminder tone, go to the second line and select.

7) To enter a name or reminder text, go to the third line and enter. You can enter up to 32 characters.

8) Press the center of the joystick when you're finished.

9) Press the **DONE** soft key.

Editing/Deleting Reminders

- 1) Select menu option .
- 2) Press the **SKDL** soft key.
- 3) To edit reminder, select the reminder. Edit the date, time, reminder tone, and text the same way you entered them for a new entry.
To delete reminder, highlight the reminder and press the **OPTION** soft key, and select **Delete entry**. To delete all reminders, select **Delete All**. Press the **OK** soft key.

Creating and Editing Phonebook Entries

To go to the phonebook, slide the joystick to the left. Press the **OPTION** soft key and select **New Entry**. Enter the name, number, unique ring, unique display, phonebook group, and speed dial as you want. Press the center of the joystick to enter each entry and confirm the selection. When you're finished, press the **DONE** soft key to save this phonebook entry.

Battery Information

Low battery alert

When the batteries are very low and need to be charged, the phone is programmed to eliminate functions in order to save power.

The batteries need to be charged when:

- The empty battery icon  appears.
- **Low Battery** appears in the display.

If the phone is in standby mode, none of the keys will operate.

If you are on a call, complete your conversation as quickly as possible, and return the handset to the charging cradle.

Cleaning the battery charging contacts

To maintain a good charge, clean the charging contacts on the handset once a month. Use a clean pencil eraser or superfine steel wool. Avoid touching the cabinet area of the phone or scratches may occur.



Caution: Do not use paint thinner, benzene, alcohol, or other chemical products. Doing so may discolor the surface of the telephone and damage the finish.

Installing a Replacement Battery

Follow the steps if you need to replace a battery.

- 1** Press down on the handset battery case cover (use the finger indention for a better grip) and slide the cover downward to remove.
- 2** Remove the existing battery and unplug the connector from the jack.
- 3** Plug the battery pack connector (red, black, and white wires) into the jack inside the battery compartment. (The connector notches fit into the grooves of the jack only one-way.) Match the wire colors to the polarity label in the battery compartment, and push the connector in until you hear a click.
- 4** Make sure you have a good connection by slightly pulling on the battery wires. If the connection is secure, the battery jack will remain in place.
- 5** Place the battery case cover back on the handset by sliding it upwards until it clicks into place.

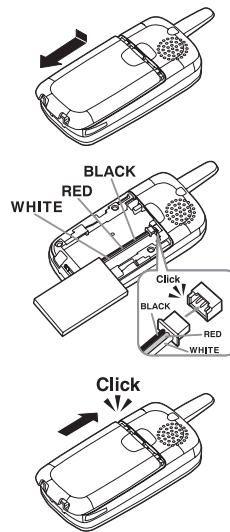

Notes:

- Use only the SANYO battery (BT-0001) supplied with your phone.
- Don't place the charger in direct sunlight or subject it to high temperatures. The battery may not charge properly.

Rechargeable Lithium Ion Batteries
Must Be Recycled or Disposed of Properly



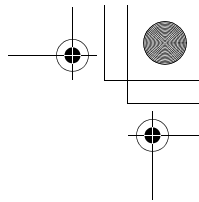
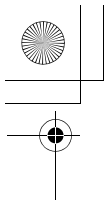

I.C. Notice

TERMINAL EQUIPMENT

NOTICE: This equipment meets the applicable Industry Canada Terminal Equipment Technical Specifications. This is confirmed by the registration number. The abbreviation, IC, before the registration number signifies that registration was performed based on a Declaration of Conformity indicating that Industry Canada technical specifications were met. It does not imply that Industry Canada approved the equipment.

NOTICE: The Ringer Equivalence Number (REN) for this terminal equipment is marked on the equipment itself. The REN assigned to each terminal equipment provides an indication of the maximum number of terminals allowed to be connected to a telephone interface. The termination on an interface may consist of any combination of devices subject only to the requirement that the sum of the Ringer Equivalence Numbers of all the devices does not exceed five.

RADIO EQUIPMENT

The term "IC:" before the radio certification number only signifies that Industry Canada technical specifications were met.

Operation is subject to the following two conditions: (1) this device may not cause interference, and (2) this device must accept any interference, including interference that may cause undesired operation of the device. "Privacy of communications may not be ensured when using this telephone."

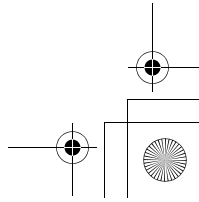
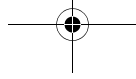
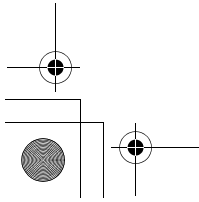
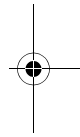
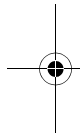

THE SANYO COMFORT WARRANTY

WARRANTY APPLICATION

Sanyo Communications products purchased new, unused in Canada through a Sanyo Authorized Dealer are warranted against manufacturing defects in materials and workmanship for **ONE YEAR** covering parts and labour, from the date of purchase by the original retail purchaser. This warranty only applies in favour of the original retail purchaser of the warranted product.

SANYO CANADA INC.'S RESPONSIBILITY

During the warranty period, SANYO Canada Inc. will repair, or at our option, replace a Communications product which shows evidence of a manufacturing defect in materials or workmanship. Replacement PARTS are warranted for the remaining portion of the warranty period.

WHAT IS NOT COVERED

- (a) Communications products purchased outside Canada.
- (b) Communications products purchased in a used condition.
- (c) Communications products purchased from non Sanyo-authorized dealer.
- (d) Communications products not intended for Canadian usage or products without appropriate Canadian regulatory approvals.
- (e) Problems due to product set-up and installation.
- (f) Adjustments that are outlined in the Operating Manual.
- (g) Accessory items including antenna, and batteries,
- (h) Damage in or due to transportation.
- (i) Damage due to improper maintenance, accident, abuse, misuse or negligence.
- (j) Damage caused by lightning and power surges.

ORIGINAL RETAIL PURCHASER'S RESPONSIBILITY

You, the original retail purchaser, must present your original, dated bill-of-sale together with this warranty to SANYO Canada Inc. or to an authorized Sanyo Service Depot when you make a claim under this warranty.

You, the original retail purchaser, are responsible for any costs of TRANSPORTING the product to and from SANYO Canada Inc. or an authorized Sanyo Service Depot. You also are responsible for the cost of any MAINTENANCE necessary in respect of the product.

WARRANTY BECOMES VOID

This warranty becomes void if the product's serial numbers are altered or removed or if any repair to the product is made other than by SANYO Canada Inc. or by an authorized Sanyo Service Depot.

LIMITATIONS

- (a) SANYO Canada Inc. reserves the right to change or improve the design of the model of the product warranted hereunder without incurring any obligation to make any modifications to or to install any improvement in or on the product.
- (b) In no event shall SANYO Canada Inc. or any of its Authorized Dealers be liable for special or consequential damage arising from the use of this product.

STATUTORY WARRANTIES

The above provisions do not preclude the operation of any applicable provincial statute which in certain circumstances may not allow some of the limitations and exclusions described in this Warranty. Where any terms of this Warranty are prohibited by such a statute, they shall be deemed null and void but the remainder of this warranty shall remain in effect.

HOW TO OBTAIN WARRANTY SERVICE

Please contact the Sanyo Authorized Dealer from whom the product was purchased, or contact us directly at:

SANYO Canada Inc.
1-300 Applewood Cres.
Concord, Ont. L4K 5C7
(905) 760-9944
1-800-263-2244

SOS HELP LINE

At Sanyo, fulfilling the needs of our customers is a priority. That's why we created our SOS customer service program that guarantees satisfaction.

NATIONWIDE CUSTOMER SUPPORT

SOS is there to help you. Our friendly and knowledgeable product specialists will quickly answer your questions about setup and use of Sanyo telephone products. Simply call toll free from anywhere in Canada to connect to our no-charge, SOS support and service network:

1-800-263-2244
between 8:30 am – 7:00 pm EST

Or visit our website at www.sanyoservice.com, and click the **Customer Relations** button to get access to our FAQ's (Frequently Asked Questions) and other helpful features.

STAY-AT-HOME CONVENIENCE

It's a nuisance making another trip to the store when you're stuck. Now with SOS, all that's necessary is a quick call from your home for product assistance.

HASSLE-FREE EXCHANGE

Should your Sanyo telephone require servicing due to a manufacturing defect during the warranty period, SANYO Canada will ship prepaid a replacement unit* within two business days after receiving your defective unit. **Consumers are responsible for the shipping costs of the unit back to Sanyo.**

- * For older, non-current models, replacement units may not be available, in which case our regular warranty conditions will apply.

GUARANTEED QUALITY

All SOS replacement sets are checked and serviced by factory-authorized technicians before being sent out.

SOS means you never have to worry.

C.O.D. and/or Collect shipments will not be accepted.

Unit must be returned to Sanyo in its original box with all accessories, i.e.: owner's manual, battery, adaptor, telephone cord, etc.

Covered under one or more of the following U.S. patents:

4,797,916	5,381,460	5,426,690	5,434,905	5,491,745	5,493,605
5,533,010	5,574,727	5,581,598	5,650,790	5,660,269	5,661,780
5,663,981	5,671,248	5,696,471	5,717,312	5,732,355	5,754,407
5,758,289	5,768,345	5,787,356	5,794,152	5,801,466	5,825,161
5,864,619	5,893,034	5,912,968	5,915,227	5,929,598	5,930,720
5,960,358	5,987,330	6,044,281	6,070,082	6,125,277	6,253,088
6,314,278	6,418,209	6,618,015	6,671,315	6,714,630	6,782,098
6,788,920	6,788,953				

All rights reserved

SANYO

SANYO Canada Inc.
Printed in China
UUZZ01438DZ(0)

Free Manuals Download Website

<http://myh66.com>

<http://usermanuals.us>

<http://www.somanuals.com>

<http://www.4manuals.cc>

<http://www.manual-lib.com>

<http://www.404manual.com>

<http://www.luxmanual.com>

<http://aubethermostatmanual.com>

Golf course search by state

<http://golfingnear.com>

Email search by domain

<http://emailbydomain.com>

Auto manuals search

<http://auto.somanuals.com>

TV manuals search

<http://tv.somanuals.com>