

Owner's Manual

Please read before using this system.

SYLVANIA

DVD/CD Player with AV Receiver HT6051F / HT6051FB

5 inch
Disc ONLY

INSTRUCCIONES EN
ESPAÑOL INCLUIDAS.

Supplied Accessory

- Remote control with two AA batteries (Silver: NB140UD) (Black: NB144UD)
- Audio/Video cables (WPZ0102TM015/ WPZ0102LTE01/ WPZ0102CAB01)
- Owner's Manual (1VMN21407)
- AV Receiver (Silver: X6000UD) (Black: X6003UD)
- Speaker Unit (Silver: USPUSPKHYE07) (Black: USPUSPKHYE09)

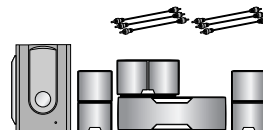
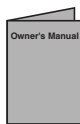
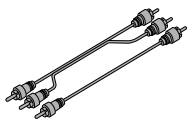

- BUS cables (8 Pin: (WX1X6000-007) and 10 Pin: (WX1X6000-006))
- Foot x 2 (1VM421328)
- Stand x 2 (Silver: 1VM422542) (Black: 1VM422733)
- FM wire antenna (WX1E9000-081)
- AM loop antenna (UANTAMALH002)

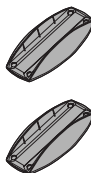
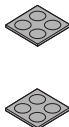
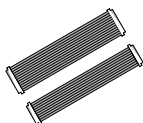

Table of Contents

Precautions

Laser Safety	2
■ IMPORTANT SAFEGUARDS	3
Avoid the Hazards of Electrical Shock and Fire	4
Moisture Condensation Warning	4
Installation Location	4
About Copyright	4
Notice for Progressive Scan Outputs	4
Symbols Used in This Manual	4
Maintenance	4
■ About the Discs	5
Playable Discs	5
Unplayable Discs	5

Setup

■ Functional Overview	6
Front / Rear Panel Controls	6
Setting the DVD/CD Player (the AV Receiver)	7
Speaker Setup	7
■ About the Remote Control	7
Installing the Batteries for the Remote Control	7
Remote Control Operation for the DVD/CD Player	8
Remote Control Operation for the AV Receiver	8
■ Connections	9
Connection to the AV Receiver and the Speaker Unit	9
Connection to a TV	10
RF Modulator Connection (If Your TV Does Not Have A/V Input Jacks.)	11

Functions

■ Playback	12
■ MP3/WMA Playback	13
■ Search Function	13
Using Track Search	13
Using Title / Chapter Search	13
Using Time Search	13
■ On-Screen Display	14
■ Marker Setup	14
■ Repeat / Random / Programmed Playback	15
Repeat Playback	15
Random Playback	15
Programmed Playback	15

■ Special Settings	16
Subtitle Language	16
Audio Language	16
Camera Angles	16
Black Level Setting	16
Stereo Sound Mode	16
Dolby Pro Logic II	16
■ DVD Setup	17
SETUP Menu	17
LANGUAGE Setting	18
DISPLAY Setting	18
AUDIO Setting	19
PARENTAL Setting	20
OTHERS Setting	20

AV Receiver

■ AM/FM Radio	21
To Connect AM/FM Antenna	21
Preset Radio Stations	21
Selecting Radio Stations	21
■ Sound Setting	22
Digital Sound	22
Bass Boost	22
Surround Sound	22

Information

■ Specifications	22
■ Troubleshooting Guide	23
■ Language Code List	24
■ Limited Warranty	24
Español	25
Quick Use Guide	27

If you need additional operating assistance after reading this owner's manual, please call
TOLL FREE : 1-800-968-3429
 or visit our web site at
<http://www.SylvaniaConsumerElectronics.com>

Precautions

WARNING: TO REDUCE THE RISK OF FIRE OR ELECTRIC SHOCK, DO NOT EXPOSE THIS APPLIANCE TO RAIN OR MOISTURE.



CAUTION
RISK OF ELECTRIC SHOCK
DO NOT OPEN



The lightning flash with arrowhead symbol, within an equilateral triangle, is intended to alert the user to the presence of uninsulated "dangerous voltage" within the product's enclosure that may be of sufficient magnitude to constitute a risk of electric shock to persons.



The exclamation point within an equilateral triangle is intended to alert the user to the presence of important operating and maintenance (servicing) instructions in the literature accompanying the appliance.

CAUTION:

TO REDUCE THE RISK OF ELECTRIC SHOCK, DO NOT REMOVE COVER (OR BACK). NO USER SERVICEABLE PARTS INSIDE. REFER SERVICING TO QUALIFIED SERVICE PERSONNEL.

Precautions

Laser Safety

This unit employs a laser. Only a qualified service person should remove the cover or attempt to service this device, due to possible eye injury.

CAUTION: USE OF CONTROLS OR ADJUSTMENTS OR PERFORMANCE OF PROCEDURES OTHER THAN THOSE SPECIFIED HEREIN MAY RESULT IN HAZARDOUS RADIATION EXPOSURE.

CAUTION: VISIBLE AND INVISIBLE LASER RADIATION WHEN OPEN AND INTERLOCK DEFEATED. DO NOT STARE INTO BEAM.

LOCATION: INSIDE, NEAR THE DECK MECHANISM.

FCC WARNING- This equipment may generate or use radio frequency energy. Changes or modifications to this equipment may cause harmful interference unless the modifications are expressly approved in the manual. The user could lose the authority to operate this equipment if an unauthorized change or modification is made.

RADIO-TV INTERFERENCE

This equipment has been tested and found to comply with the limits for a Class B digital device, pursuant to Part 15 of the FCC Rules. These limits are designed to provide reasonable protection against harmful interference in a residential installation. This equipment generates, uses, and can radiate radio frequency energy and, if not installed and used in accordance with the instructions, may cause harmful interference to radio communications. However, there is no guarantee that interference will not occur in a particular installation. If this equipment does cause harmful interference to radio or television reception, which can be determined by turning the equipment off and on, the user is encouraged to try to correct the interference by one or more of the following measures:

- 1) Reorient or relocate the receiving antenna.
- 2) Increase the separation between the equipment and receiver.
- 3) Connect the equipment into an outlet on a circuit different from that to which the receiver is connected.
- 4) Consult the dealer or an experienced radio/TV technician for help.

This Class B digital apparatus complies with Canadian ICES-003.

Cet appareil numérique de la classe B est conforme à la norme NMB-003 du Canada.

CAUTION: TO PREVENT ELECTRIC SHOCK, MATCH WIDE BLADE OF PLUG TO WIDE SLOT, FULLY INSERT.

ATTENTION: POUR ÉVITER LES CHOC ÉLECTRIQUES, INTRODUIRE LA LAME LA PLUS LARGE DE LA FICHE DANS LA BORNE CORRESPONDANTE DE LA PRISE ET POUSSER JUSQU'AU FOND.

A NOTE ABOUT RECYCLING

This product's packaging materials are recyclable and can be reused. Please dispose of any materials in accordance with your local recycling regulations.

Batteries should never be thrown away or incinerated but disposed of in accordance with your local regulations concerning chemical wastes.

Make your contribution to the environment!!!

- Used up batteries do not belong in the dust bin.
- You can dispose of them at a collection point for used up batteries or special waste. Contact your council for details.



For Customer Use:

Read carefully the information located at the bottom of this unit and enter below the Serial No. Retain this information for future reference.

Model No. _____

Serial No. _____

IMPORTANT SAFEGUARDS

- 1) Read Instructions - All the safety and operating instructions should be read before the product is operated.
- 2) Retain Instructions - The safety and operating instructions should be retained for future reference.
- 3) Heed Warnings - All warnings on the product and in the operating instructions should be adhered to.
- 4) Follow Instructions - All operating and use instructions should be followed.
- 5) Cleaning - Unplug this product from the wall outlet before cleaning. Do not use liquid cleaners or aerosol cleaners. Use a damp cloth for cleaning.
- 6) Attachments - Do not use attachments not recommended by the product manufacturer as they may cause hazards.
- 7) Water and Moisture - Do not use this product near water - for example, near a bath tub, wash bowl, kitchen sink, or laundry tub; in a wet basement; or near a swimming pool; and the like.
- 8) Accessories - Do not place this product on an unstable cart, stand, tripod, bracket, or table. The product may fall, causing serious injury to a child or adult, and serious damage to the product. Use only with a cart, stand, tripod, bracket, or table recommended by the manufacturer, or sold with the product. Any mounting of the product should follow the manufacturer's instructions, and should use a mounting accessory recommended by the manufacturer.

PORTABLE CART WARNING
(Symbol provided by RETAC)



S3125A
- 9) A product and cart combination should be moved with care. Quick stops, excessive force, and uneven surfaces may cause the product and cart combination to overturn.
- 10) Ventilation - Slots and openings in the cabinet are provided for ventilation and to ensure reliable operation of the product and to protect it from overheating, and these openings must not be blocked or covered. The openings should never be blocked by placing the product on a bed, sofa, rug, or other similar surface. This product should not be placed in a built-in installation such as a bookcase or rack unless proper ventilation is provided or the manufacturer's instructions have been adhered to.
- 11) Power Sources - This product should be operated only from the type of power source indicated on the marking label. If you are not sure of the type of power supply to your home, consult your product dealer or local power company. For products intended to operate from battery power, or other sources, refer to the operating instructions.
- 12) Grounding or Polarization - This product may be equipped with a polarized alternating-current line plug (a plug having one blade wider than the other). This plug will fit into the power outlet only one way. This is a safety feature. If you are unable to insert the plug fully into the outlet, try reversing the plug. If the plug should still fail to fit, contact your electrician to replace your obsolete outlet. Do not defeat the safety purpose of the polarized plug.
- 13) Power-Cord Protection - Power-supply cords should be routed so that they are not likely to be walked on or pinched by items placed upon or against them, paying particular attention to cords at plugs, convenience receptacles, and the point where they exit from the product.
- 14) Lightning - For added protection for this product during a lightning storm, or when it is left unattended and unused for long periods of time, unplug it from the wall outlet. This will prevent damage to the product due to lightning and power-line surges.
- 15) Power lines - An outside antenna system should not be located in the vicinity of overhead power lines or other electric light or power circuits, or where it can fall into such power lines or circuits. When installing an outside antenna system, extreme care should be taken to keep from touching such power lines or circuits as contact with them might be fatal.
- 16) Overloading - Do not overload wall outlets, extension cords, or integral convenience receptacles as this can result in a risk of fire or electric shock.
- 17) Object and Liquid Entry - Never push objects of any kind into this product through openings as they may touch dangerous voltage points or short-out parts that could result in a fire or electric shock. Never spill liquid of any kind on the product.
- 18) Servicing - Do not attempt to service this product yourself as opening or removing covers may expose you to dangerous voltage or other hazards. Refer all servicing to qualified service personnel.
- 19) Damage Requiring Service - Unplug this product from the wall outlet and refer servicing to qualified service personnel under the following conditions:
 - a) When the power-supply cord or plug is damaged,
 - b) If liquid has been spilled, or objects have fallen into the product,
 - c) If the product has been exposed to rain or water,
 - d) If the product does not operate normally by following the operating instructions. Adjust only those controls that are covered by the operating instructions as an improper adjustment of other controls may result in damage and will often require extensive work by a qualified technician to restore the product to its normal operation,
 - e) If the product has been dropped or damaged in any way.
 - f) When the product exhibits a distinct change in performance - this indicates a need for service.
- 20) Replacement Parts - When replacement parts are required, be sure the service technician has used replacement parts specified by the manufacturer or have the same characteristics as the original part. Unauthorized substitutions may result in fire, electric shock, or other hazards.
- 21) Safety Check - Upon completion of any service or repairs to this product, ask the service technician to perform safety checks to determine that the product is in proper operating condition.
- 22) Heat - The product should be situated away from heat sources such as radiators, heat registers, stoves, or other products (including amplifiers) that produce heat.

Avoid the Hazards of Electrical Shock and Fire

- Do not handle the power cord with wet hands.
- Do not pull on the power cord when disconnecting it from AC wall outlet. Grasp it by the plug.
- If, by accident, water is spilled on this unit, unplug the power cord immediately and take the unit to our Authorized Service Center for servicing.

Moisture Condensation Warning

Moisture condensation may occur inside the unit when it is moved from a cold place to a warm place, or after heating a cold room or under conditions of high humidity. Do not use this unit at least for 2 hours until its inside gets dry.

Installation Location

For safety and optimum performance of this unit:

- Do not place anything directly on top of the unit. Do not place the unit directly on top of the TV.
- Shield it from direct sunlight and keep it away from sources of intense heat. Avoid dusty or humid places. Avoid places with insufficient ventilation for proper heat dissipation. Avoid locations subject to strong vibration or strong magnetic fields.
- Be sure to remove the disc and unplug the AC power cord from the outlet before carrying the unit.

About Copyright

Unauthorized copying, broadcasting, public performance and lending of discs are prohibited.

This product incorporates copyright protection technology that is protected by U.S. patents and other intellectual property rights. Use of this copyright protection technology must be authorized by Macrovision, and is intended for home and other limited viewing uses only unless otherwise authorized by Macrovision. Reverse engineering or disassembly is prohibited.

Notice for Progressive Scan Outputs

Consumers should note that not all high definition television sets are fully compatible with this product and may cause artifacts to be displayed in the picture. In case of picture problems with 525 progressive scan output, it is recommended that the user switch the connection to the 'standard definition' output. If there are questions regarding your TV set compatibility with this 525p DVD player, please contact our customer service center.

Symbols Used in This Manual

The following symbols appear in some headings in this manual.



: Description refers to playback of DVD-Video discs.



: Description refers to playback of Audio CDs.



: Description refers to playback of MP3 files.



: Description refers to playback of discs formatted with WMA.

Maintenance

SERVICING

- Please refer to relevant topics on the "Troubleshooting Guide" on page 23 before returning the product.
- If this unit becomes inoperative, do not try to correct the problem by yourself. There are no user-serviceable parts inside. Turn off, unplug the power plug, and please call our help line mentioned on the front page to locate an Authorized Service Center.

CLEANING THE CABINET

- Use a soft cloth slightly moistened with a mild detergent solution. Do not use a solution containing alcohol, spirits, ammonia or abrasive.

CLEANING DISCS

- When a disc becomes dirty, clean it with a cleaning cloth. Wipe the disc from the center out. Do not wipe in a circular motion.
- Do not use solvents such as benzene, thinner, commercially available cleaners, detergent, abrasive cleaning agents or antistatic spray intended for analog records.

CLEANING THE DISC LENS

- If this unit still does not perform properly although you refer to the relevant sections and to "Troubleshooting Guide" in this Owner's Manual, the laser optical pickup unit may be dirty. Consult your dealer or an Authorized Service Center for inspection and cleaning of the laser optical pickup unit.

DISC HANDLING

- When you handle a disc hold it by its edge and try not to touch the surface of the disc.
- Always store a disc in its protective case when it is not used.
- If the disc's peripheral edge is rough, rub it with pen or pencil stem in order to fine the rough completely. If not, the disc may not be inserted correctly, or the plastic fragments may stick on the disc and cause skips of playback.

"WMA" (Windows Media Audio) is a new audio codec developed by Microsoft® in the United States of America.

Manufactured under license from Dolby Laboratories.

"Dolby", "Pro Logic II" and the double-D symbol are trademarks of Dolby Laboratories.

About the Discs

Playable Discs

Playable discs	Mark (logo)	Region code	Recorded signals	Disc size	Disc types
DVD-Video * 1, 2, 4, 6, 10			Digital video (MPEG2)	5 inches (12 cm)	 Example: Title 1, Title 2 Chapter 1, Chapter 2, Chapter 3, Chapter 4, Chapter 1, Chapter 2
DVD-RW DVD-R * 1, 3, 4, 5, 6, 7, 9, 10		-			
DVD+RW DVD+R * 1, 3, 4, 5, 6, 8, 9, 10		-			
Audio CD * 4, 6, 10		-	Digital audio	5 inches (12 cm)	 Example: Track 1, Track 2, Track 3, Track 4, Track 5, Track 6
CD-RW CD-R * 4, 5, 6, 9, 10		-	Digital audio or MP3/WMA *11		 Example: Group 1, Group 2 Track 1, Track 2, Track 3, Track 4, Track 5, Track 6

DVD is a trademark of DVD Format/Logo Licensing Corporation.

If you cannot play back a disc which bears one of the marks above, check the following notes.

- *1: This player conforms to the NTSC color system. Discs recorded in other color systems such as PAL cannot be played back.
- *2: Certain DVD-Video discs do not operate as described in this manual due to the intentions of the disc's producers.
- *3: Discs recorded in the VR (Video Recording) format cannot be played back.
- *4: Scratched or stained discs may not be played back.
- *5: Some discs cannot be played back because of incompatible recording conditions, characteristics of the recorder or special properties of discs.
- *6: You can play back discs which bear the marks above. If you use nonstandardized discs, this player may not play them back. Even if they are played back, the sound or video quality will be compromised.
- *7: You may play back the unfinalized DVD-R/RW disc recorded in the video format on our brand's DVD recorder. However, depending on the recording status of a disc, the disc may not be played back at all or normally (the picture or sound may not be smooth, etc.). In this case, you need to finalize the disc with the DVD recorder. Refer to the manual accompanying the DVD recorder.
- *8: Only the discs recorded in the video format and finalized can be played back. Unfinalized discs cannot be played back. Depending on the recording status of a disc, the disc may not be played back at all or normally (the picture or sound may not be smooth, etc.).
- *9: If there is too much recording space left on a disc (the used portion is less than 2 3/16 inches (55 mm) across), it may not play back properly.
- *10: Do not glue paper or put stickers on to the disc. These may damage the disc and the unit may not read it correctly.
- *11: This player cannot playback the disc contents protected by Windows Media Digital Rights Management (DRM).



Windows Media and the Windows logo are trademarks or registered trademarks of Microsoft Corporation in the United States and/or other countries.
This unit is not compatible with Multiple Bit Rate (MBR: a file that contains the same content encoded at several different bit rates).

Unplayable Discs

- **NEVER play back the following discs. Otherwise, malfunction may result!**
 DVD-RAM/CD-I/Photo CD/Video CD / DVD with region codes other than 1 or ALL
 DTS-CD / DVD-ROM for personal computers / CD-ROM for personal computers
 - Never insert a disc which is broken or whose form is abnormal (other than 5 inch (12 cm) round disc).
 NOTE: Do not use any CD adaptor which covers 3 inch (8 cm) round disc to standard size.
- **On the following disc, the sound MAY NOT be heard.**
 Super Audio CD
NOTE: Only the sound recorded on the normal CD layer can be delivered.
 The sound recorded on the high density Super Audio CD layer cannot be delivered.
- *Any other discs without compatibility indications*

Setup

Functional Overview

Front / Rear Panel Controls

Front Panels:

Progressive scan indicator
Lights up when the "PROGRESSIVE" mode is selected.

Power indicator
Lights up when power is on.

POWER button
To turn the player on or off.

STOP button
To stop playback.

PLAY button
To begin disc playback.

EJECT button
To remove a disc from the player.

Disc tray

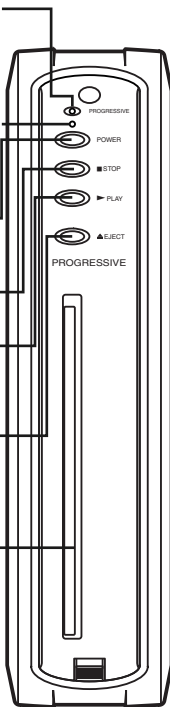

DVD/CD Player

POWER button
To turn the receiver on or off.

Sound mode indicator
Selected sound mode will light up.

BASS BOOST indicator
Lights up when BASS BOOST is selected.

VOLUME knob
To adjust the volume.

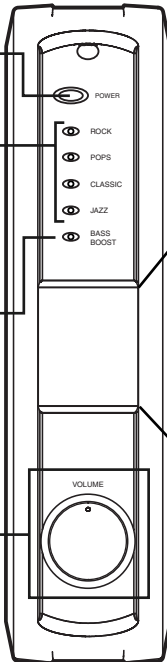

AV Receiver

AUDIO status display
Displays the audio information of an inserted disc.

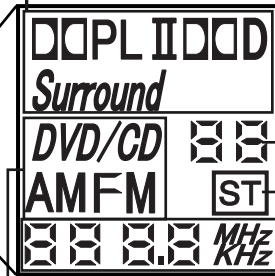

Displays the preset number of the radio station.

Indicates a stereo broadcast. (FM)

Displays the radio frequency or the volume level.

Displays the mode of the receiver (DVD/CD, AM or FM).

Rear Terminals:

AUDIO OUT jacks
Use to connect an audio equipment with standard audio cables (supplied).

VIDEO OUT jack
Use to connect a video equipment with a standard video cable (supplied).

BUS 1, 2 connectors
Connect the AV Receiver with the 8 pin and the 10 pin bus cables (supplied).

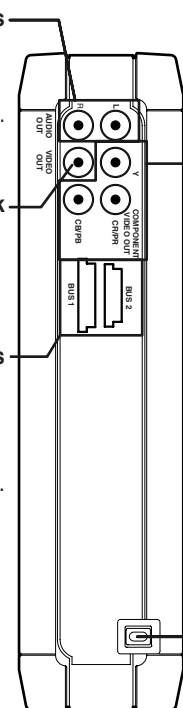

DVD/CD Player

AM jack
Connect the AM antenna (supplied).

COMPONENT VIDEO OUT jacks
Use to connect a video equipment with a component video cable (not supplied).

Speaker jacks
Connect the supplied Subwoofer.

AC outlet
Connect the AC power cord of the player.

AC power cord

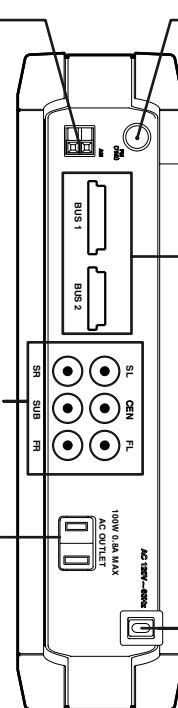

AV Receiver

FM jack
Connect the FM antenna (supplied).

BUS 1, 2 connectors
Connect the DVD/CD Player with the 8 pin and the 10 pin bus cables (supplied).

AC power cord

Setting the DVD/CD Player (the AV Receiver)

You can install the DVD/CD Player horizontally or vertically. Attach the Foot to the bottom of the player (for Horizontal installation) or bottom of the Stand (for Vertical installation).

The AV Receiver can be used in standing position only. Setup the receiver by following "Vertical installation" below.

Vertical installation (standing position):

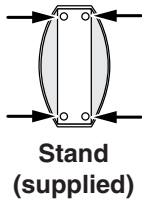

Place the player (the receiver) as its dent matches the catch of the Stand. Place the player (the receiver) as the POWER button is at the top.

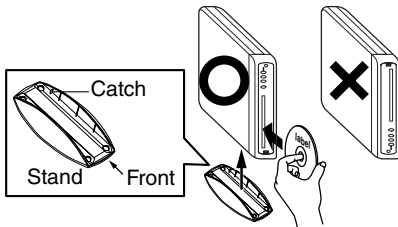

Hint

- Insert a disc with its label facing to the left.

Horizontal installation (laying position):

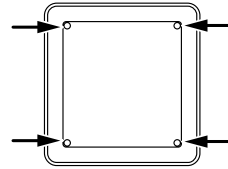

Place the player as the POWER button comes on your right.

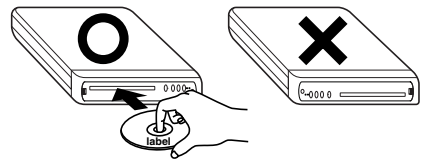

Hint

- Insert a disc with the label facing up.

Speaker Setup

Connect all the speakers and set up the system properly in order to enjoy the Home Cinema experience.

- 1 Place the FRONT Left and Right speakers at equal distances from the TV and at a 45-degree angle from the listening position.
- 2 Place the CENTER speaker above or below the TV to localize the sound.
- 3 Place the REAR (Wireless) speakers at normal listening ear level behind the listening position.
- 4 Place the Subwoofer on the floor, near the TV.

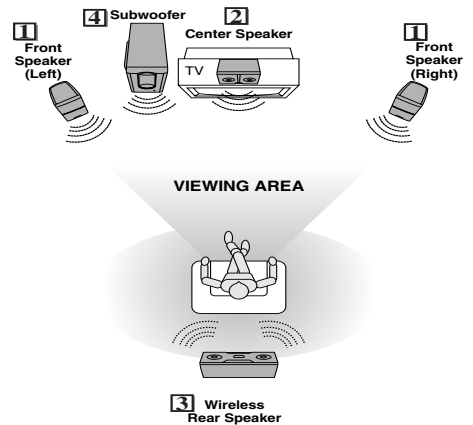

About the Remote Control

Installing the Batteries for the Remote Control

Install two AA batteries (supplied) matching the polarity indicated inside battery compartment of the remote control.

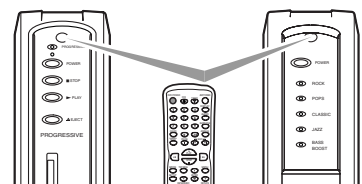
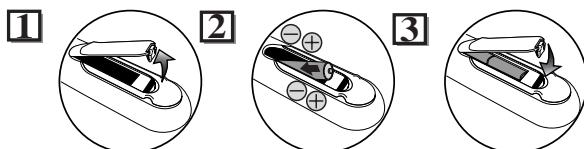

Keep in mind the following when using the remote control:

- Make sure that there is no obstacle between the remote control and the remote sensor on the player (the receiver).
- The maximum operable ranges from the player (the receiver) are as follows.
 - **Beeline:** approx. 23 feet (7m)
 - **Either side of the center:** approx. 16 feet (5m) within 30°
 - **Above:** approx. 16 feet (5m) within 15°
 - **Below:** approx. 10 feet (3m) within 30°

Remote Control Operation for the DVD/CD Player

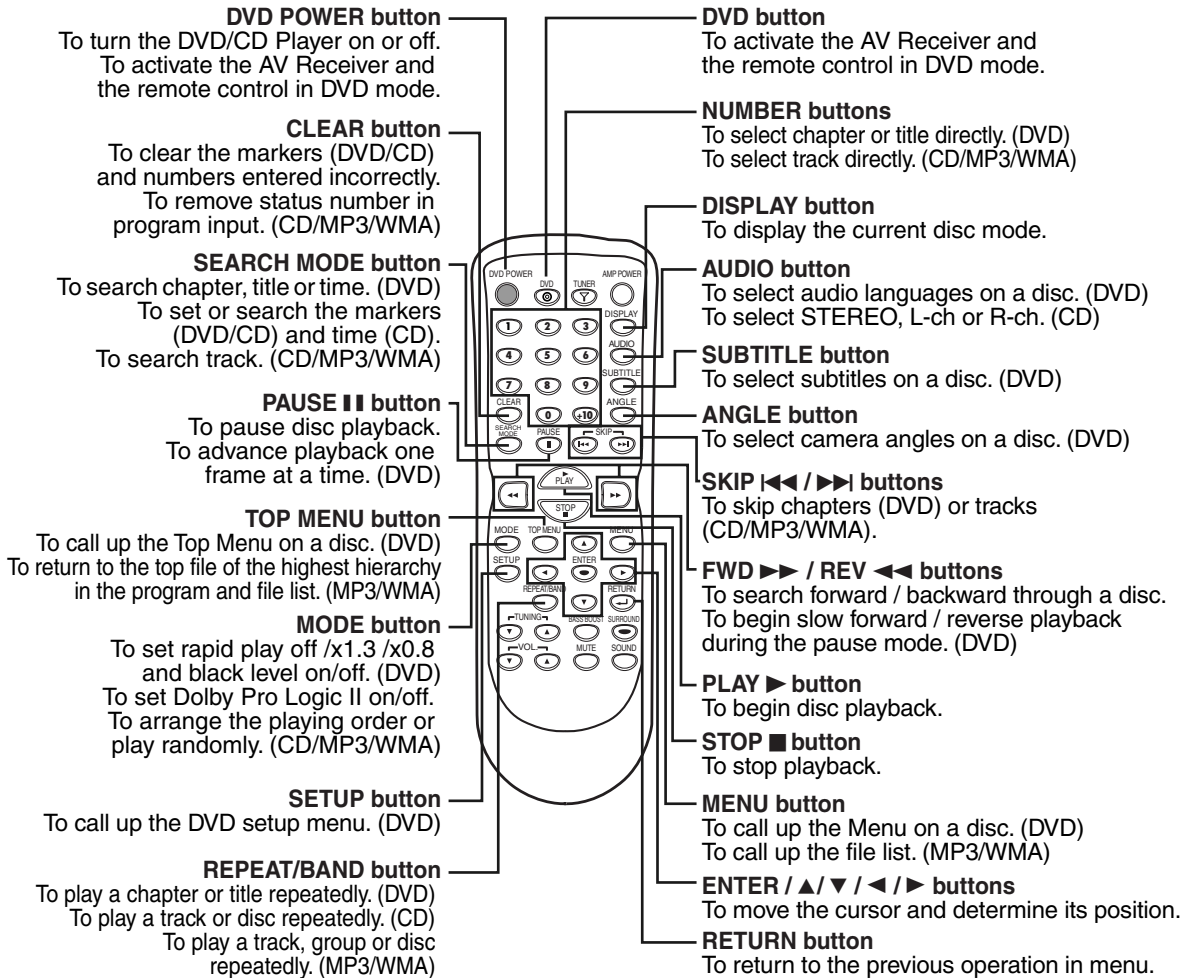

Remote Control Operation for the AV Receiver

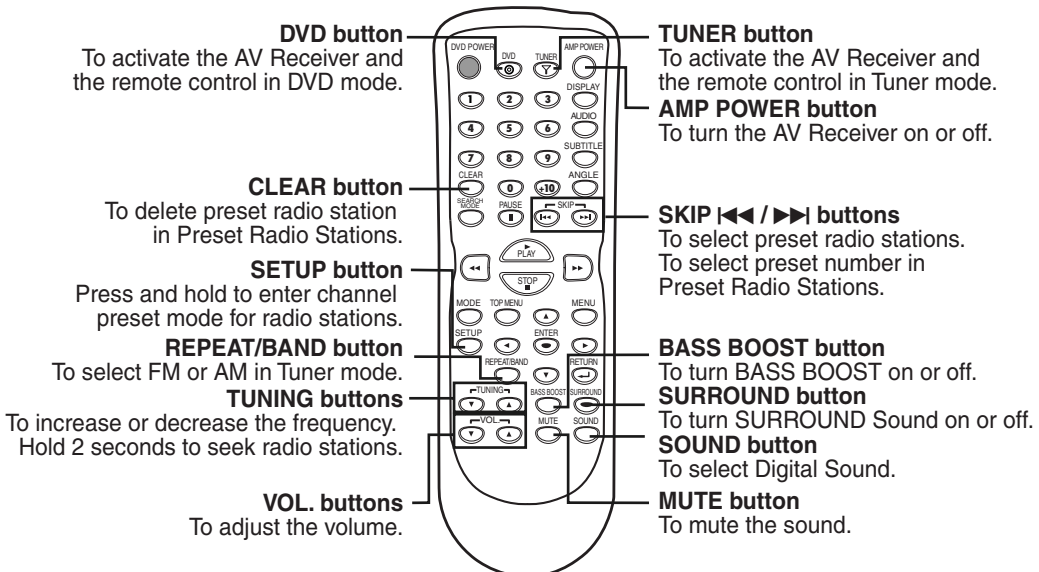

Connections

Connection to the AV Receiver and the Speaker Unit

See the illustration below and connect the DVD/CD Player, the AV Receiver and the Speaker Unit by following the steps 1 to 5.

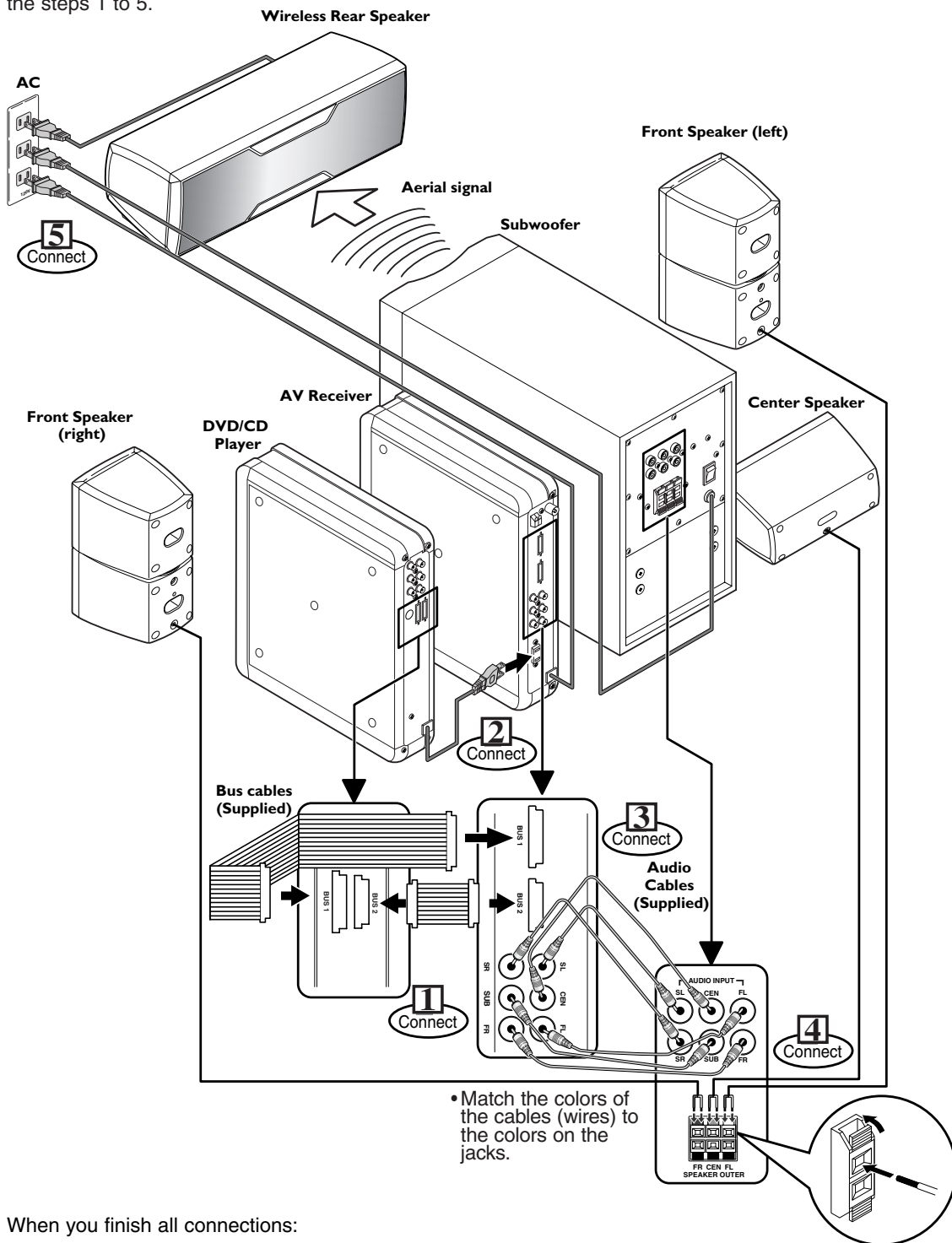

When you finish all connections:

- 1) Turn on the switches of the Subwoofer (back of the unit) and the Wireless Rear speaker (back of the unit).
- 2) Press **[AMP POWER]** to turn on the AV Receiver. The DVD/CD Player should turn on and off along with the AV Receiver.

Hint

- Be sure to remove the disc from the player and unplug the AC power cords from the outlets before connecting the system.

Connection to a TV

If your TV has AUDIO/VIDEO input jacks, see the following instructions.

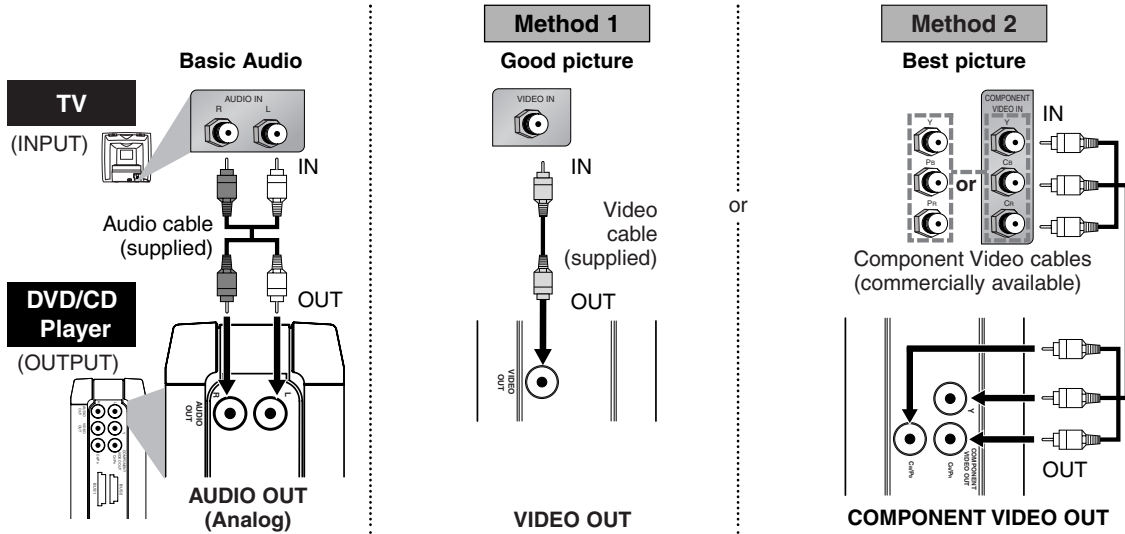

Hint

- Connect this player directly to the TV. If the Audio/Video cables are connected to a VCR, pictures may be distorted due to the copy protection system.
- When progressive scanning mode is selected, no video signal will be output from the VIDEO OUT jack.

If your TV is compatible with 525p (480p) progressive scanning and you want to enjoy that high quality picture;

You must select the connection Method 2 above and progressive scanning mode. To set the mode, press and hold [PLAY ►] on the front panel of the player for more than 5 seconds, so that PROGRESSIVE indicator will light up.

If your TV is not compatible with progressive scanning;

Use this player in interlace mode. Make sure that PROGRESSIVE indicator is off. If not, press and hold [PLAY ►] on the front panel of the player for more than 5 seconds, so that PROGRESSIVE indicator will light off.

[DVD/CD Player]

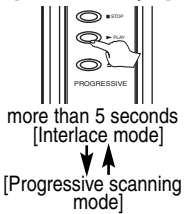

After you have completed connections

- Press the input selector button (usually TV/VIDEO, INPUT or AUX) on your TV to switch an appropriate external input channel (usually near channel 0) for viewing the picture from this player. If the picture does not appear, also refer to the manual accompanying your TV.

INPUT MODES FOR COMMON TV BRANDS (Example)

- Listed below are inputs for common brand name TV's.

Admiral: AUX
 Curtis Mathis: LINE1, LINE2, 00, 90, 91, 92, 93
 GE: INPUT, TV/VCR, 00, 90, 91, 92, 93
 Hitachi: INPUT, AUX
 JVC: VIDEO, VIDEO1, VIDEO2, VIDEO3
 Kenwood: AUX
 LXI-Series: 00
 Magnavox: AUX CHANNEL

Panasonic: TV/VIDEO
 RCA: INPUT, TV/VCR, 00, 90, 91, 92, 93
 Samsung: TV/VIDEO
 Sanyo: VIDEO
 Sharp: 00
 Sony: VIDEO1, VIDEO2, VIDEO3
 Toshiba: TV/GAME
 Zenith: 00

RF Modulator Connection (If Your TV Does Not Have A/V Input Jacks.)

If your TV has Antenna in jack only, it is still possible to connect this player to your TV by using a **STEREO AUDIO/VIDEO RF Modulator (commercially available)**. In this case, follow the instructions below.

- 1) Connect the AUDIO/VIDEO output jacks of this player to the AUDIO/VIDEO input jacks of your RF Modulator by audio and video cables.
- 2) The antenna input jack of your TV may have been already occupied. If so, disconnect the RF cable from your TV, and then connect the RF cable to your RF Modulator (usually marked "ANT IN").
- 3) Connect your RF modulator to your TV by another RF cable.
- 4) Set your RF modulator's channel 3/4 switch to either 3 or 4, whichever the TV channel is least used in your area. If your RF modulator has a Modulator/Antenna switch, set it according to your RF modulator's manual.
- 5) Turn on your TV and choose the same channel as you set the RF modulator's channel 3/4 switch to. For more details, follow the instructions supplied with the RF Modulator.

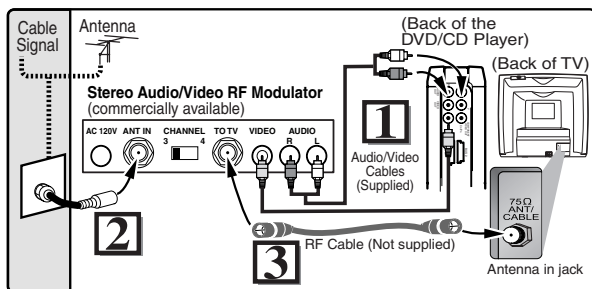

Hint

- The quality of picture may become poor if the player is connected to an RF Modulator.

Functions

Operations described in this section are mainly based on the remote control use. Some operations can be carried out on the front panel.

Playback

Before: Turn on the TV, the Subwoofer, the Wireless rear speaker and other equipment which are connected to the DVD/CD Player. Make sure the TV is set to the correct channel.

Normal Playback



- 1 Press **[DVD POWER]** to turn on the DVD/CD Player.
- 2 Insert a disc with label facing to the left (facing up for horizontal installation).
- 3 Press **[PLAY ►]** to start playback.
- 4 Press **[STOP ■]** to stop playback.

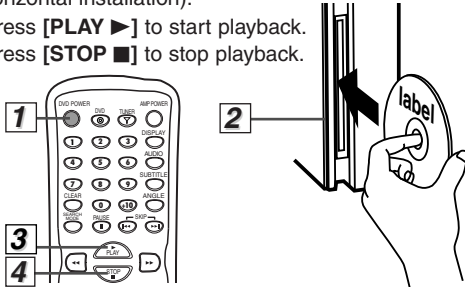

Hint

- For playing back an MP3/WMA file, see page 13.
- A "prohibited icon" may appear at the top-right on the TV screen when the operation is prohibited by the disc or this player.
- Some DVDs may start playback from title 2 or 3 due to specific programs.
- During the playback of a two-layered disc, pictures may stop for a moment. This happens while the 1st layer is being switched to the 2nd layer. This is not a malfunction.
- Don't leave the disc exiting halfway from the slot.

TIP:

You can change the On-Screen language in "PLAYER MENU" setting. (Refer to pages 17-18.)

DVD menu

Some discs contain menus which allow you to customize DVD playback. Use **[▲ / ▼ / ◀ / ▶]** to select an item, then press **[ENTER]** (or **[PLAY ►]**), to select.

Calling Up a Menu Screen During Playback

- Press **[MENU]** to call up the DVD menu.
- Press **[TOP MENU]** to call up the title menu.

Hint

- Menu operations may vary depending on the disc. Refer to the manual accompanying the disc for more details.

Resume



Press **[STOP ■]**. Resume message will appear on the TV screen.

Press **[PLAY ►]**, playback will resume from the point at which playback was stopped.

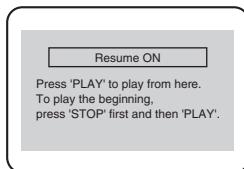

<Example : DVD>

Hint

- To cancel resume, press **[STOP ■]** one more time during the stop mode.
- For MP3/WMA, playback will resume from the beginning of the track at which playback was stopped.
- The resume information will be kept even when the power is turned off.

Paused and Step-by-Step Playback



Press **[PAUSE II]** during playback. To continue playback, press **[PLAY ►]**.



The disc goes forward by one frame each time **[PAUSE II]** is pressed during the pause mode. To continue playback, press **[PLAY ►]**.

Hint

- On DVDs, set "STILL MODE" to "FIELD" in the Display menu if pictures in the pause mode are blurred. (Refer to pages 17-18.)

Fast Forward/Reverse Search



Press **[FWD ►►]** or **[REV ◀◀]** repeatedly during playback to select the required forward or reverse speed.

To continue playback, press **[PLAY ►]**.

Hint

- For DVDs, fast forward or reverse search speed is different depending on the disc. Approximate speed is 1(x2), 2(x8), 3(x20), 4(x50) and 5(x100).
- For Audio CDs, approximate speed is 1(x2), 2(x8) and 3(x30).
- For MP3/WMA, approximate speed is 1(x2), 2(x8) and 3(x30).

Slow Forward/Slow Reverse



Press **[FWD ►►]** or **[REV ◀◀]** repeatedly during the pause mode to select the required forward or reverse speed.

To continue playback, press **[PLAY ►]**.

Hint

- Slow forward or reverse speed is different, depending on the disc. Approximate speed is 1(1/16), 2(1/8) and 3(1/2).
- Set "STILL MODE" to "FIELD" in the Display menu if pictures in the slow playback mode are blurred. (Refer to pages 17-18.)

Rapid Play



Rapid Play function is available only during playback.

Available only on discs recorded in the Dolby Digital format, Rapid Play plays back in a slightly faster/ slower speed while keeping the sound quality just as normal playback.

- Press **[MODE]** during the normal playback.
- Use **[ENTER]** or **[◀ / ▶]** to switch among (x1.3), (x0.8) and OFF.

- : Plays back approximately at 0.8 times of normal playback.
- : Plays back approximately at 1.3 times of normal playback.
- OFF : No effects.

- Press **[PLAY ►]** to continue the normal playback.

Hint

- Audio (language) setting cannot be changed while using this mode.
- Dolby Pro Logic II and Black Level settings cannot be changed while using this mode.
- This feature may not work at some point in a disc.

MP3/WMA Playback

MP3/WMA are methods of compressing files. You can copy MP3/WMA files on CD-R/RWs from the computer and play the files on this player.



Insert an MP3/WMA-format disc, then press **[MENU]** to call up the file list on the TV screen.

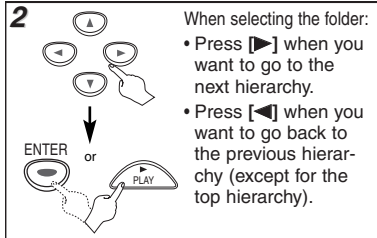
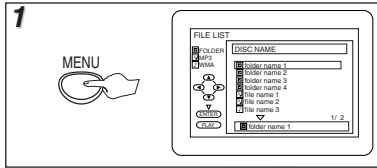

When selecting the folder:
 • Press **[▶]** when you want to go to the next hierarchy.
 • Press **[◀]** when you want to go back to the previous hierarchy (except for the top hierarchy).

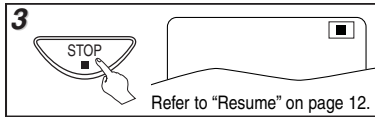

Hint

- Some selections may take a while to be recognized.
- Press **[TOP MENU]** to return to the first item.
- Folders are known as Groups; files are known as Tracks.
- MP3 files are accompanied by icon.
- WMA files are accompanied by icon.
- Folders are accompanied by icon.
- A maximum of 255 folders can be recognized.
- A maximum of 999 files can be recognized.
- Up to 8 hierarchies can be created. This player recommends the files recorded under the following circumstances:
 - Sampling frequency: 44.1kHz or 48kHz (MP3/WMA)
 - Constant bit rate: 32kbps ~ 320kbps (MP3) 48kbps ~ 192kbps (WMA)
- For MP3/WMA file recorded in Variable Bit Rate(VBR), the player may not display the actual elapsed time.
- Copyright protected WMA files will not play on this player.

Search Function

Using Track Search

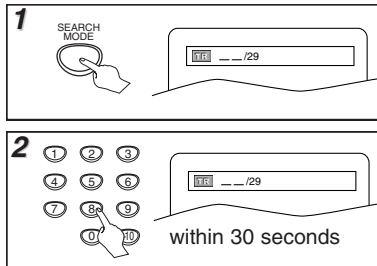

- For the disc with less than 10 tracks, press the track number directly.
- For discs with more than 10 but less than 99 tracks, to play single-digit track, press **[0]** first, then the track number (e.g. for track 3, press **[0]**, **[3]**). To play a double-digit track, press the track number.
- For discs with more than 100 tracks, to play a single or a double-digit track, press **[0]** first, then the track number (e.g. for track 3, press **[0]**, **[0]**, **[3]**, and for track 26, press **[0]**, **[2]**, **[6]**). To play a triple-digit track, press the track number.

Using [SKIP ◀◀ / ▶▶]

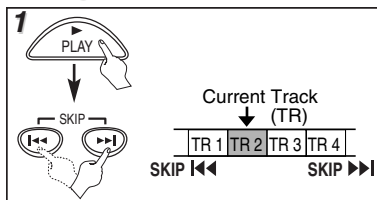

Hint

- **[+10]** button can also bring the Track Search display, except for the disc with less than 10 tracks. For such a disc, track search can be done by just pressing the track number.

Using Title / Chapter Search

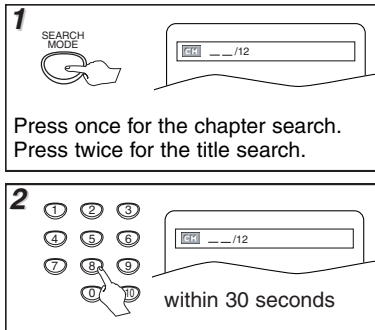

Using [SKIP ◀◀ / ▶▶]

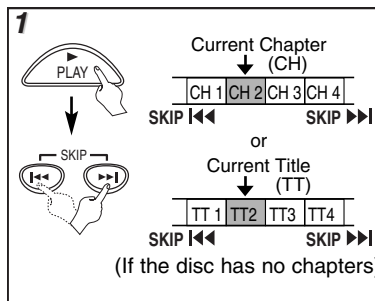

Hint

- Depending on the disc being played, this function can also be performed by directly entering the desired chapter number with **the Number buttons**. Refer to the manual accompanying the disc.
- For CDs and MP3/WMA, Track Search is not available for Programmed or Random Playback.

Using Time Search

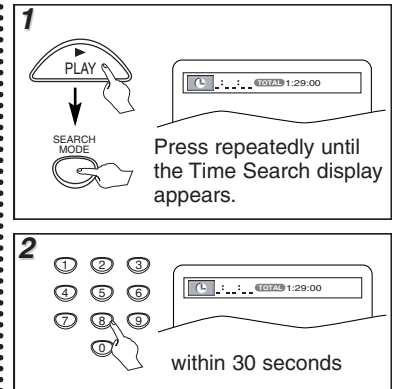

Hint

- When there is no need to enter a number, "0" appears automatically. For example, "0 : 0 : ..." appears in the Time Search display if the total time of the title or track is less than 10 minutes.
- Press **[CLEAR]** to erase the incorrect input at step 2.

On-Screen Display

You can check the information about the current disc by pressing **[DISPLAY]** on the remote control.

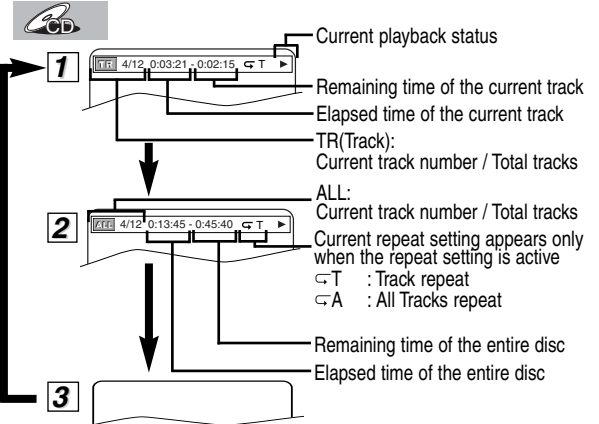
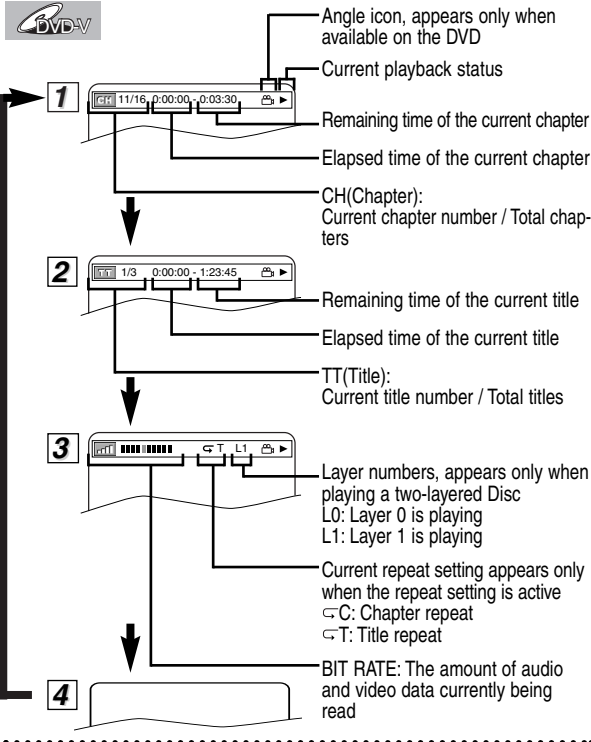

Hint

- When you are playing a disc in PROGRAM or RANDOM mode, **PROGRAM** (or **RANDOM**) will be displayed instead of **2**.

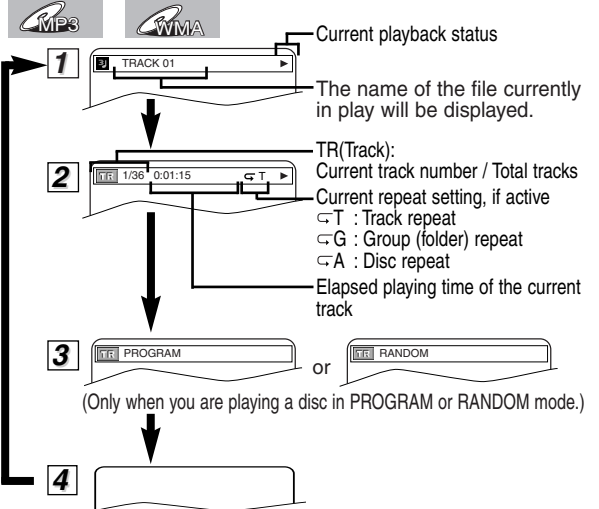

NOTE: For WMA files, **1-A** and **1-B** will be displayed after **1**.

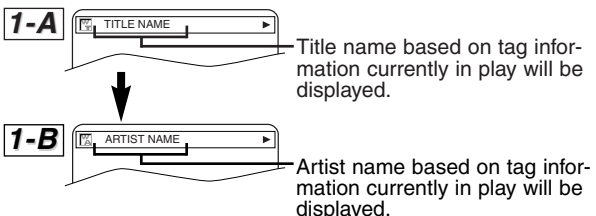

Functions

Marker Setup

DVD **CD**

This feature allows you to assign a specific point on a disc to be called back later.

To set a marker

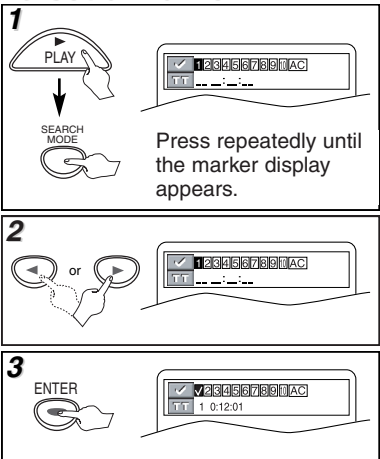

To return to the marker later

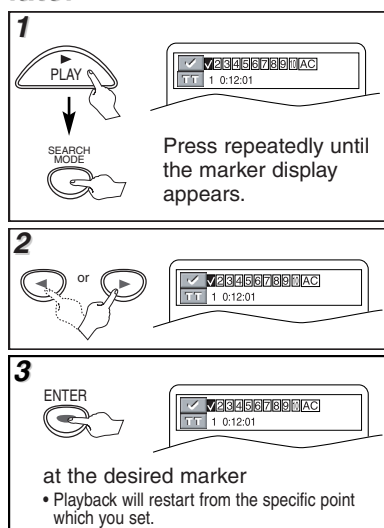

To exit the marker display

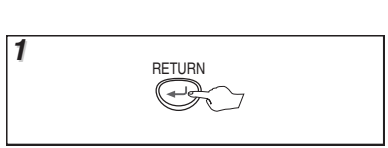

Hint

- The Marker display will disappear in about 30 seconds when there is no output.
- To clear a marker, select the marker to be cleared at step 2 in the section "To set a marker" or "To return to the marker later" and then press **[CLEAR]**.
- Removing the disc or turning off the power will erase all markers.
- Selecting "AC" at step 2 in the section "To set a marker" or "To return to the marker later" will also erase all markers.

Repeat / Random / Programmed Playback

Repeat Playback



Repeat function is available only during playback.

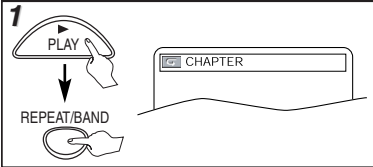

Each time you press [REPEAT/BAND], repeat function changes as example below.



- [REPEAT/BAND] CHAPTER (current chapter repeat)
- [REPEAT/BAND] TITLE (current title repeat)
- [REPEAT/BAND] OFF (repeat off)



- [REPEAT/BAND] TRACK (current track repeat)
- [REPEAT/BAND] ALL (entire disc repeat)
- [REPEAT/BAND] OFF (repeat off)



- [REPEAT/BAND] TRACK (current track repeat)
- [REPEAT/BAND] GROUP (current group repeat)
- [REPEAT/BAND] ALL (entire disc repeat)
- [REPEAT/BAND] OFF (repeat off)

Hint

- Repeat setting will be cleared when moving to another title, chapter, track or group.
- Repeat playback may not function with some discs.

Random Playback

This function shuffles the playing order of tracks instead of playback in the sequence.

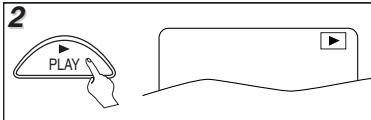
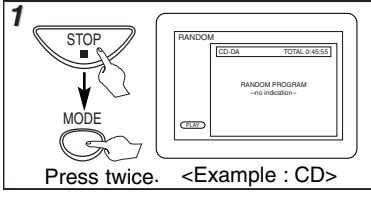

Hint

- To repeat the current track in the random selections, press [REPEAT/BAND] repeatedly until "TRACK" appears during playback.
- To repeat the entire random selections, press [REPEAT/BAND] repeatedly until "ALL" appears during playback.

Programmed Playback



You may determine the order in which tracks will play.

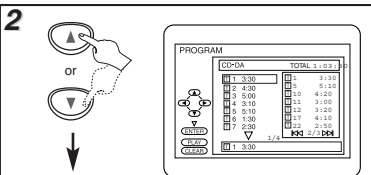
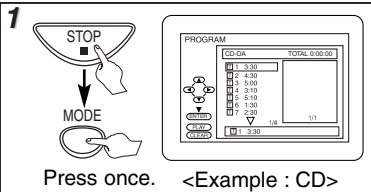

- Up to 99 tracks can be ordered.
- If eight or more tracks were in a program, use [SKIP << / >>] to see all the tracks.
- While an MP3/WMA folder is open:
 - Press [▶] when you want to go to the next hierarchy.
 - Press [◀] when you want to go back to the previous hierarchy (except for the top hierarchy).

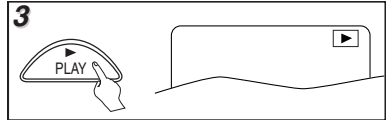

Hint

- Press [CLEAR] at step 2 to erase the most recently entered track.
- To erase all programmed tracks at once, select "ALL CLEAR" and press [ENTER] at step 2.
- While a program is being played back, [STOP ■] works as follows:
 - ⇒ Press [STOP ■] and [PLAY ▶] next, so that the programmed playback restarts. (CD playback restarts from the current point. MP3/WMA playback restarts from the beginning of the current track.)
 - ⇒ Press [STOP ■] twice and [PLAY ▶] next, so that playback restarts from the first track in the original order. However, your programmed playback can be restarted when you follow the above steps. (Your programs are still stored until either the disc is removed or power is turned off.)
- To repeat the current track in the program, press [REPEAT/BAND] repeatedly until "[REPEAT/BAND] TRACK" appears during playback.
- To repeat the entire program, press [REPEAT/BAND] repeatedly until "[REPEAT/BAND] ALL" appears during playback.

Special Settings

Subtitle Language



This player allows you to select a subtitle language (if available) during DVD playback.

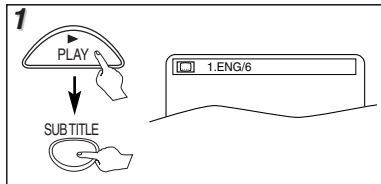

Each time you press **[SUBTITLE]**, subtitle language changes as example below.

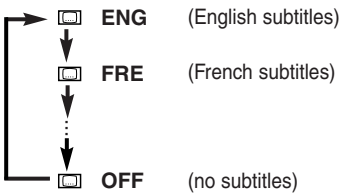

To set subtitle ON/OFF

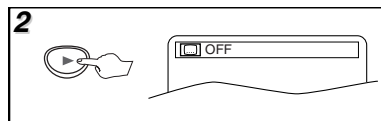
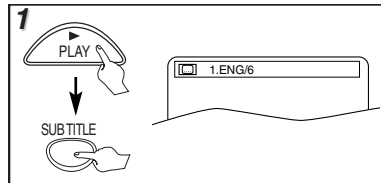

Hint

- If your language is not shown after pressing **[AUDIO]** or **[SUBTITLE]** several times, the disc may not have that language. However, some discs allow audio language or subtitle language setting on the disc menu. (Operation varies depending on the disc, so refer to the manual along with the disc.)
- When "NOT AVAILABLE" appears on the TV screen, it means no subtitle is recorded on the scene.
- If you choose a language that has a three-letter-language code, the code will be displayed every time you change the subtitle language setting. If you choose any other languages, "----" will be displayed instead. (Refer to page 24.)
- Some discs will only allow you to change the subtitle from the disc menu. Refer to the manual accompanying the discs for details.

Audio Language



This player allows you to select an audio language (if multiple languages are available on disc) during DVD playback.

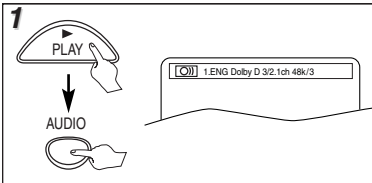

Each time you press **[AUDIO]**, audio language changes as example below.

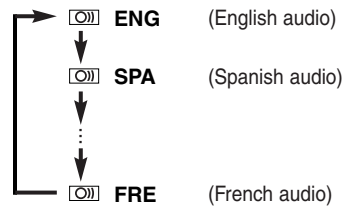

Hint

- Some discs will only allow you to change the audio setting from the disc menu. Refer to the manual accompanying the discs for details.
- Audio language selection cannot be made during Rapid play.

Camera Angles



Some DVD discs may contain scenes which have been shot simultaneously from various angles. You can change the camera angle if the (ANGLE ICON) icon appears on the screen. If the "ANGLE ICON" setting is "OFF" in the OTHERS menu, the (ANGLE ICON) icon will not appear. (Refer to pages 17-20.)

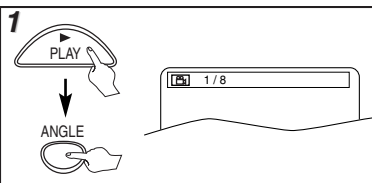

Black Level Setting



Adjust the Black Level Setting to make the dark areas of the TV picture brighter.

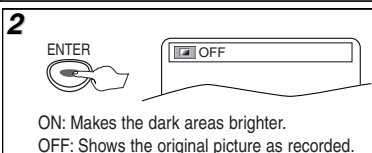
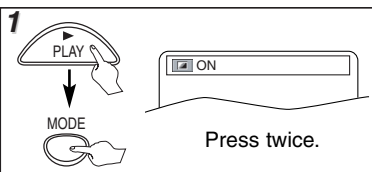

Stereo Sound Mode



This player allows you to select a sound mode during CD playback.

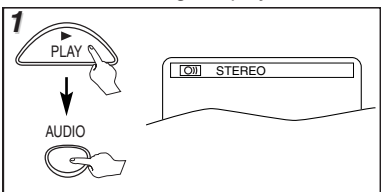

Each time you press **[AUDIO]**, sound mode changes as example below.

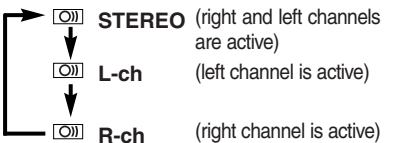

Hint

- Dolby Pro Logic II cannot be changed when the sound mode is set to either L-ch. or R-ch.

Dolby Pro Logic II



Dolby Pro Logic II creates five full-bandwidth output channels from two-channel sources. This is done using an advanced, high-purity matrix surround decoder that extracts the spatial properties of the original recording without adding any new sounds or tonal colorations.

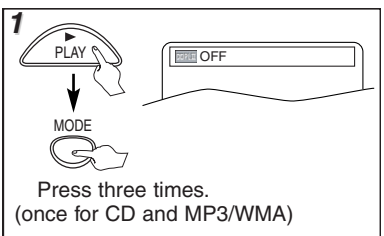

Press three times.
(once for CD and MP3/WMA)

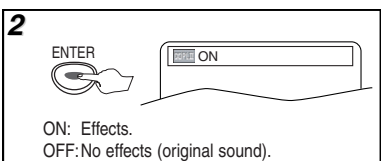

ON: Effects.
OFF: No effects (original sound).

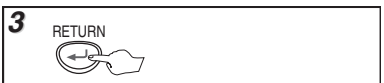

Hint

- Dolby Pro Logic II is effective for only the 2 channel stereo system running.
- On CDs, Dolby Pro Logic II will not be effective if the sound mode is set to something other than STEREO. Refer to "Stereo Sound Mode".
- This function cannot be used during Rapid play.

DVD Setup

SETUP Menu

QUICK SETUP Menu

You can select the "PLAYER MENU" or "TV ASPECT" from the QUICK SETUP menu quickly.

1

<SETUP MENU>
Confirm that "QUICK" is selected.

2

Select the desired item.

ENTER

P18 **A** Step 5
P18 **B** Step 5

• Refer to the sections "PLAYER MENU", "TV ASPECT" on page 18.

CUSTOM Menu

You can change the settings of the player.

- **QUICK** on page 18 indicates DVD Setup menus also accessible from the QUICK SETUP menu.

1

<SETUP MENU>

2

Select "CUSTOM".

ENTER

3

Select the desired item.

ENTER

LANGUAGE menu DISPLAY menu AUDIO menu PARENTAL menu OTHERS menu

LANGUAGE menu: AUDIO, SUBTITLE, DISC MENU, PLAYER MENU, ORIGINAL, OFF, ENGLISH, ENGLISH

DISPLAY menu: TV ASPECT, 4:3 LETTER BOX, STILL MODE, AUTO

AUDIO menu: IBC, DELAY TIME, BALANCE, ON

PARENTAL menu: PARENTAL LEVEL, ALL

OTHERS menu: ANGLE LOCK, ON, AUTO POWER OFF, ON

page 18 **A** page 18 **B** page 19 **C** page 20 **D** page 20 **E**

INITIALIZE Menu

You can reset the default setting of the player. (Except PARENTAL Setting.)

1

<SETUP MENU>

2

Select "INITIALIZE".

ENTER

3

Select "YES".

ENTER

4 To exit the menu. SETUP

Press twice.

Hint

- When you cancel to initialize at step 3, select "NO".

A LANGUAGE Setting

Follow steps 1 to 3 in the "CUSTOM Menu" section on page 17.

4 Select the desired item.

LANGUAGE menu

5 Select the desired language.

AUDIO: *1 *2
(Default: ORIGINAL)
Sets the audio language.

SUBTITLE: *1 *2
(Default: OFF)
Sets the subtitle language.

DISC MENU: *1
(Default: ENGLISH)
Sets the language in DVD menu.

PLAYER MENU: QUICK
(Default: ENGLISH)
Sets the language for the On-Screen Display.

6 To exit the menu.

Hint

*1

- Language options are not available with some discs.
- If OTHER is selected in the AUDIO, SUBTITLE or DISC MENU screen, press four-digit number to enter the code for the desired language. (Refer to the language code list on page 24.)
- Only the languages supported by the disc can be selected.

*2

- Language setting for Audio and Subtitle are not available with some discs. Then press [AUDIO] and [SUBTITLE]. Details are on page 16.

B DISPLAY Setting

You can change the display functions. Follow steps 1 to 3 in the "CUSTOM Menu" section on page 17.

4 Select the desired item.

DISPLAY menu

5

TV ASPECT: QUICK
(Default: 4:3 LETTER BOX)
See Hint on the right.

STILL MODE:
(Default: AUTO)
See Hint on the right.

6 To exit the menu.

Hint

TV ASPECT:

- Select "4:3 LETTER BOX", so that black bars may appear on the top and bottom of the screen.
- Select "4:3 PAN & SCAN" for a full height picture with both sides adjusted.
- Select "16:9 WIDE" if a wide-screen TV is connected to this player.

STILL MODE:

- Select "AUTO" usually.
- If you select AUTO, automatically select the best resolution setting (FRAME or FIELD) based on the data characteristics of the pictures. (default)
- If you select "FIELD", the picture in the still mode will be stabilized.
- If you select "FRAME", the picture in the still mode will be highly defined.
- An individual picture on TV screen is called a "frame", which consists of two separate images called a "field". Some pictures may be blurred at the AUTO setting in still mode due to their data characteristics.

C AUDIO Setting

Choose the appropriate audio settings for your equipment. It only affects during the playback of DVD discs. Follow steps 1 to 3 in the "CUSTOM Menu" section on page 17.

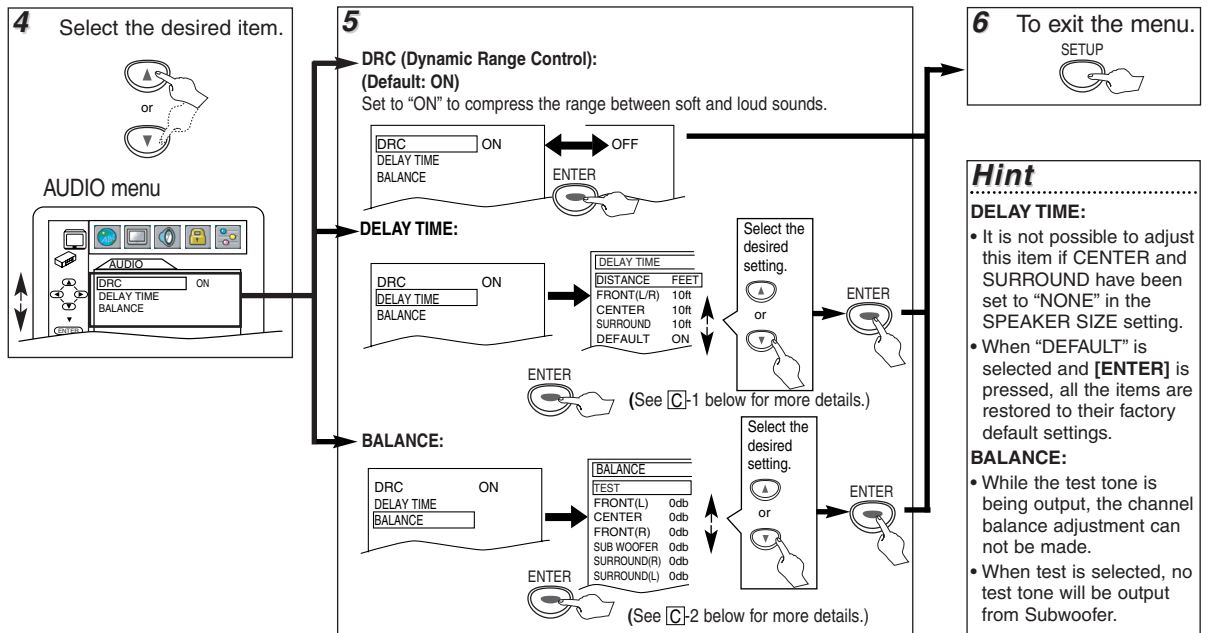

C-1 : DELAY TIME

With 5.1-channel surround sound, ideally the distance between the listening position and all the speakers (exclude Subwoofer). The delay time setting can be used to make the sound from the different speakers reach the listening position at the same time.

Use [▲ / ▼] to select the setting item, then press [ENTER].
• Using [▲ / ▼] select the speaker to set, then press [ENTER].

DISTANCE (Default :FEET):

- METERS** (when [ENTER] is pressed):
The Speaker Unit of distance is set to meters ("m").
- FEET** (when [ENTER] is pressed):
The Speaker Unit of distance is set to feet ("ft").

FRONT(L/R), CENTER, SURROUND (DEFAULT : 10FT):

- FRONT(L/R):**
The distance can be set within the range of 0 to 60 feet.
- CENTER, SURROUND:**
These are depends on the setting value of FRONT (L/R).

Hint

- The wireless transfer time of the rear speaker may affect the delay time setting.

C-2 : BALANCE

When the channel level differs from each speaker, the adjustment can be made in the player of dB (-12dB to 0dB).

TEST:

- Use [▲ / ▼] to select "TEST", then press [ENTER]. The test tone will output from each speaker in turn.

TEST	
FRONT(L)	0db
CENTER	0db
FRONT(R)	-1db
SUB WOOFER	0db
SURROUND(R)	-2db
SURROUND(L)	-5db

CHANNEL LEVEL:

- Use [▲ / ▼] to select the speaker to set, then press [ENTER].
- Use [▲ / ▼] to select the desired level for each to select the desired level for each speaker, then press [ENTER].

FRONT(L)	
0db	
-1db	
-2db	
-3db	
-4db	
-5db	

« DELAY TIME setting for Dolby Digital »

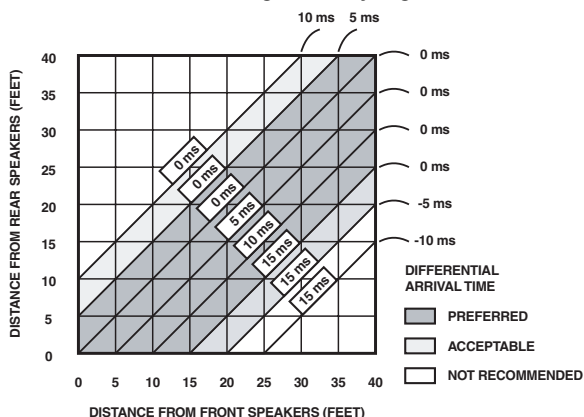

« DELAY TIME setting for Dolby Pro Logic II »

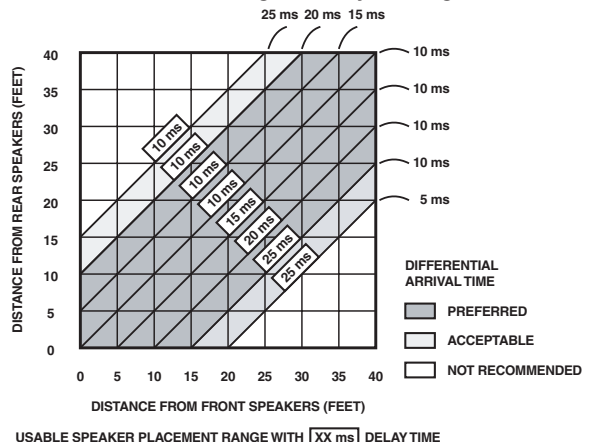

D PARENTAL Setting

Parental Control limits the disc viewing that exceed your settings. (An incorrect password will be not acceptable.) This feature prevents your children from viewing inappropriate materials.

Parental Levels

Parental Level allows you to set the rating levels of your DVD discs. Playback will stop if the ratings exceed the levels you set. Follow steps 1 to 3 in the "CUSTOM Menu" section on page 17.

4 Enter your desired four-digit password (except for 4737).

PARENTAL menu

Please enter a 4-digit password.

or

If you have set a password already, enter the current four-digit password.

Enter current password.

5 Select "PARENTAL LEVEL".

PARENTAL LEVEL ALL PASSWORD CHANGE

6 Select the desired level.

PARENTAL LEVEL

ALL

8

7 [NC-17]

6 [R]

7 To exit the menu.

SETUP

CONTROL LEVELS

- ALL: All parental locks are cancelled.
- Level 8: DVD softwares of any grades (adult/general/children) can be played back.
- Levels 7 to 2: Only DVD softwares intended for general use and children can be played back.
- Level 1: Only DVD softwares intended for children can be played back, with those intended for adult and general use prohibited.

TIPS FOR LEVELS

- 7 [NC-17]: No one under 17 admitted
- 6 [R]: Restricted; under 17 requires accompanying parent or adult guardian
- 4 [PG13]: Unsuitable for children under 13
- 3 [PG]: Parental Guidance suggested
- 1 [G]: General Audience

Hint

- DVD-Video discs may not respond to the parental lock settings. Make sure this function works with your DVD-Video discs.

To Change the Password for Parental Controls

You can change your password for parental controls. Follow steps 1 to 3 in the "CUSTOM Menu" section on page 17.

4 Enter your desired four-digit password (except for 4737).

PARENTAL menu

Enter current password.

5 Select "PASSWORD CHANGE".

PARENTAL LEVEL ALL PASSWORD CHANGE

6 Enter your new four-digit password (except for 4737).

PARENTAL menu

Please enter a 4-digit password.

7 To exit the menu.

SETUP

Hint

- Record the password in case you forget it.
- If you forget the password, press [4], [7], [3], [7] at step 4, then enter your new password.
- Password will be cleared and parental levels will be set to "ALL".

E OTHERS Setting

You can change the other functions. Follow steps 1 to 3 in the "CUSTOM Menu" section on page 17.

4 Select the desired item.

OTHERS menu

ANGLE ICON ON

AUTO POWER OFF ON

5

ANGLE ICON: (Default: ON)
Set to "ON" to show the angle icon when multiple camera angles are available during DVD playback.

ANGLE ICON ON OFF

AUTO POWER OFF ON

AUTO POWER OFF: (Default: ON)
Set to "ON" to turn this player off automatically after 30 minutes of no use.

ANGLE ICON ON OFF

AUTO POWER OFF ON OFF

6 To exit the menu.

SETUP

AM / FM Radio

To Connect AM/FM Antenna

To connect AM Antenna:

- 1 Fix the antenna holder as shown.

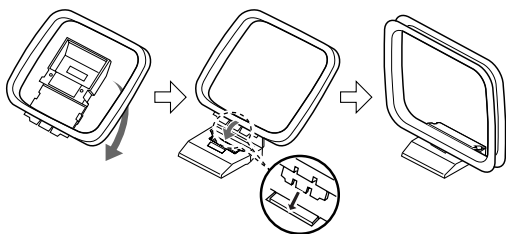

- 2 Connect the supplied AM antenna to the AM jack on back of the AV Receiver, then position it to receive the clearest sound.

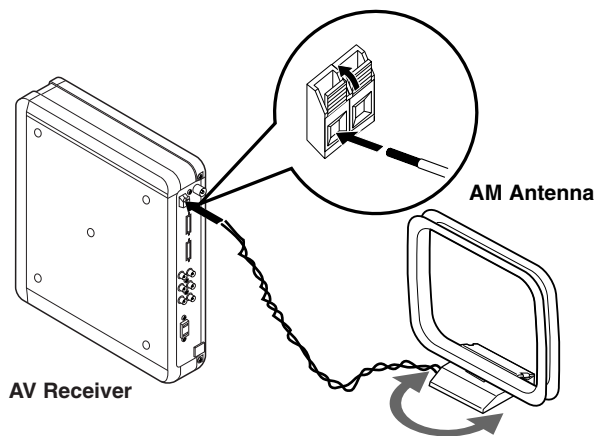

To connect FM Antenna:

- 1 Connect the supplied FM antenna to the FM jack on back of the AV Receiver. Extend the FM antenna wire and fix its end to the wall.

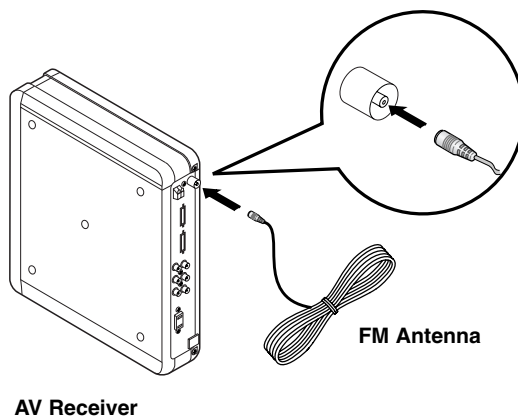

Hint

- Do not place the AM antenna on top of the player, the receiver or the speakers. Keep it as far as possible from other equipment.
- For better FM reception, connect an outdoor FM antenna (not supplied) to the FM jack (75Ω).

Preset Radio Stations

- 1 Press [AMP POWER] to turn on the AV Receiver.
- 2 Press [TUNER] to select Tuner mode. The current radio frequency (station number) will appear on the display of the AV Receiver.
- 3 Press [REPEAT/BAND] to select FM or AM.
- 4 Use [TUNING ▲ / ▼] to select the station you want to preset.
- 5 Press [SETUP] for 1 second. Preset number will flash.
- 6 Use [SKIP ◀◀ / ▶▶] and select a preset number, then press [SETUP].



Hint

- You can store up to 40 preset radio stations.
- If you want to delete a preset radio station, use [SKIP ◀◀ / ▶▶] to select the preset number, press and hold [SETUP]. When the preset number flashes, press [CLEAR].
- If the sound is distorted during AM reception, use [TUNING ▲ / ▼] on the remote control to reduce the noise. This is effective only for the current AM station. This does not work for every situation. There may be interference from other electrical appliance or weak AM signals.

Selecting Radio Stations

- 1 Press [AMP POWER] to turn on the AV Receiver.
- 2 Press [TUNER] to select Tuner mode. The current radio frequency (station number) will appear on the display.
- 3 Press [REPEAT/BAND] to select FM or AM.
- 4 Use [SKIP ◀◀ / ▶▶] to select a preset radio station.
- 5 Use [TUNING ▲ / ▼] to change the radio frequency.
- 6 Press and hold [TUNING ▲ / ▼] for 2 seconds for search mode. The next available station will be tuned.



Hint

- [SKIP ◀◀ / ▶▶] will not function if there is no preset radio station.

Sound Setting

Digital Sound

Digital Sound lets you enjoy special sound effects that have preset equalizer settings, providing the best music reproduction.

1 Press **[SOUND]** repeatedly to select ROCK, POPS, CLASSIC, JAZZ or off. The selected Digital Sound indicator will light up on front of the AV Receiver.

Bass Boost

You can emphasize the bass sound.

1 Press **[BASS BOOST]** to set Bass boost to on or off. When Bass boost is on, the Bass boost indicator will light up on front of the AV Receiver.

Surround Sound

For proper Surround Sound, connect the speakers and Subwoofer correctly. Details are on page 9. The Center and Rear speakers only operate when Surround is on. The Discs or TV programs must be recorded or broadcast in Surround Sound.

1 Press **[SURROUND]** to set Surround to on or off. When Surround is on, the "Surround" will be displayed on the display of the AV Receiver. When Surround is off, the "Surround" will disappear.

Programs broadcast in Stereo will produce some surround sound effects when played in a surround mode. However, non-Stereo programs will not have any sound at the Rear speakers.

The following Surround Sound modes may be broadcast by DVDs or TV stations. You cannot alter these Surround Sound options at the receiver.

Surround Sound Display

2ch:



Dolby 2ch:



Dolby 5.1ch:



Dolby Pro Logic II:



Dolby 2ch Pro Logic II:



Information

Specifications

DVD/CD Player :

Output signal format:

NTSC color

Power source:

120 V AC +/- 10%,

60 Hz +/- 0.5%

Power consumption:

10 W (standby: 0.8 W)

Operating temperature:

41°F (5°C) to 104°F (40°C)

Dimensions (Vertical installation):

W : 2 1/2" (62 mm)

H : 9 13/16" (249 mm)

D : 9 7/16" (239 mm)

Weight : Approx 2.9 lbs. (1.3 kg)

AV Receiver :

Power source:

120 V AC +/- 10%,

60 Hz +/- 0.5%

Power consumption:

4 W (standby: 0.9 W)

Operating temperature:

41°F (5°C) to 109°F (40°C)

Dimensions:

W : 2 1/2" (62 mm)

H : 9 13/16" (249 mm)

D : 9 7/16" (239 mm)

Weight : Approx 1.9 lbs. (0.9 kg)

Speaker Unit :

Amplifier

Output Power (8Ω, 1kHz, 10%THD)

100W total

Front Speakers : 12W/ch

Rear Speakers : 12W/ch

Center Speaker: 12W/ch

Subwoofer : 40W/ch (4Ω)

Frequency Response

20Hz - 20kHz

Signal -to- Noise Ratio

80db (One channel driven Sat Power =

10w at 1kHz, WF Power = 30W at

100HZ)

.....

.....

.....

.....

.....

.....

.....

.....

.....

.....

.....

.....

.....

.....

.....

.....

.....

.....

Center Speaker:

7 1/8" x 4 3/16" x 4 9/16"

180 x 105 x 115 mm

1.6 lbs. (0.7 kg)

Subwoofer:

6 1/8" x 10 1/8" x 12 13/16"

155x 257 x 325 mm

11.5 lbs. (5.2 kg)

.....

.....

.....

.....

.....

.....

.....

.....

.....

.....

.....

.....

.....

.....

.....

.....

NOTE: Designs and specifications are

subject to change without notice.

.....

.....

.....

.....

.....

.....

.....

Troubleshooting Guide

If the system does not perform properly when operated as instructed in this Owner's Manual, check the system consulting the following checklist.

Problem	Solution
No picture.	<ul style="list-style-type: none"> –Check if the TV is switched on. –Check the video connection. –Check the Video cable connection to the TV (See “Connection to a TV”). –Set progressive scanning mode correctly. Set it on only if your TV is compatible with Progressive Scan and you are using the Component Video connections.
Distorted picture.	<ul style="list-style-type: none"> –Sometimes a small amount of picture distortion may appear. This is not a malfunction. –Connect the player directly to the TV.
Completely distorted picture or black/white picture with DVD.	<ul style="list-style-type: none"> –Connect the player directly to the TV. –Make sure the disc is compatible with the player. –Check if the INTERLACE/PROGRESSIVE mode is set correctly. (See page 10.)
Picture freezes momentarily during playback.	<ul style="list-style-type: none"> –Check the disc for fingerprints, scratches and clean with a soft cloth wiping from center to edge.
No sound or distorted sound.	<ul style="list-style-type: none"> –Adjust the volume. –Check that the AV Receiver and the Speaker Unit are connected correctly.
No audio at digital output.	<ul style="list-style-type: none"> –Check the digital connections. –Check if the audio format of the selected language matches your receiver capabilities.
No DTS audio is output.	<ul style="list-style-type: none"> –This system does not support DTS audio. This is not a malfunction.
Low hum or buzz sound.	<ul style="list-style-type: none"> –Place speakers as far away as possible from electrical devices that may be causing interference.
There is no sound from the center and rear speakers.	<ul style="list-style-type: none"> –Make sure the center and rear speakers are connected correctly. –Press [SURROUND] to select a correct surround setting. –Make sure the source you are playing is recorded or broadcast in surround sound (Dolby Pro Logic II, Dolby Digital, etc.).
Radio reception is poor.	<ul style="list-style-type: none"> –Tune in to the correct frequency. –If the signal is too weak, adjust the antenna or connect an external antenna for better reception. –Place the antenna farther away from any equipment that may be causing the noise.
No power.	<ul style="list-style-type: none"> –Check if the AC power cord is properly connected. –Unplug outlets once and wait for 5-10 seconds and then plug in again.
Disc cannot be played.	<ul style="list-style-type: none"> –Clean the disc. –Ensure the disc is inserted correctly. –Check if the disc is defective by trying another disc. –Cancel the parental lock or change the control level. –Insert a correct disc that plays on this player. –Handle a disc with special care so that it does not have fingerprints, scratches or dusts on its surface.
No return to start-up screen when disc is removed.	<ul style="list-style-type: none"> –Reset the player by switching off, then turn on again.
The player/receiver does not respond to the remote control.	<ul style="list-style-type: none"> –Aim the remote control directly at the sensor on the front of the player/receiver. –Reduce the distance to the player/receiver. –Replace the batteries in the remote control. –Re-insert the batteries with their polarities (+/- signs) as indicated. –Tune your radio to an empty AM station so that you hear a lot of noises. Then, turn the volume up. If you hear some signal sound from the radio by pressing buttons on the remote control, the remote control is working.
Buttons do not work or the player/receiver stops responding.	<ul style="list-style-type: none"> –Unplug the AC cord from the AC outlet for 5-10 seconds to reset the system completely.
The player cannot read CDs/DVDs.	<ul style="list-style-type: none"> –Use a commonly available CD/DVD cleaner and clean the lens before sending the player for repair.
Angle does not switch.	<ul style="list-style-type: none"> –The angle cannot be switched which do not contain multiple angles. In some cases multiple angles are only recorded for specific scenes.
Playback does not start when the title is selected.	<ul style="list-style-type: none"> –Check the “PARENTAL” setting.
Forgot the password for the parental lock.	<ul style="list-style-type: none"> –Enter the default password “4737”. Your forgotten password will be cleared.
Disc cannot be inserted.	<ul style="list-style-type: none"> –Check if any disc is already in.
Disc cannot be taken out.	<ul style="list-style-type: none"> –Press and hold [EJECT ▲] on the front panel for more than 5 seconds.
The player cannot operate with the front panel buttons. The front panel of the DVD/CD Player came off.	<ul style="list-style-type: none"> –Follow the illustration below and attach the panel correctly.

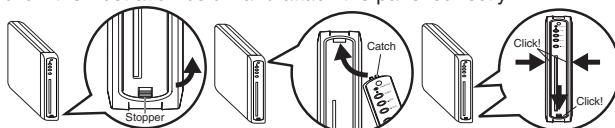

NOTES:

- Some functions are not available in specific modes, but this is not a malfunction. Read the description in this Owner's Manual for more details on correct operations.
- Playback from a desired track and random playback are not available during program playback.
- Some functions are prohibited on some discs.

Language Code List

Language	Code	Language	Code	Language	Code	Language	Code
	A-B						
Abkhazian	4748	French [FRE]	5264	Macedonian	5957	Siswat	6565
Afar	4747	Frisian	5271	Malagasy	5953	Slovak	6557
Afrikaans	4752	Galician	5358	Malay	5965	Slovenian	6558
Albanian	6563	Georgian	5747	Malayalam	5958	Somali	6561
Amharic	4759	German [GER]	5051	Maltese	5966	Spanish [SPA]	5165
Arabic	4764	Greek [GRE]	5158	Maori	5955	Sundanese	6567
Armenian	5471	Greenlandic	5758	Marathi	5964	Swahili	6569
Assamese	4765	Guarani	5360	Moldavian	5961	Swedish [SWE]	6568
Aymara	4771	Gujarati	5367	Mongolian	5960		T
Azerbaijani	4772	Hausa	5447	Nauru	6047	Tagalog	6658
Bashkir	4847	Hebrew	5569	Nepali	6051	Tajik	6653
Basque	5167	Hindi	5455	Norwegian [NOR]	6061	Tamil	6647
Bengali; Bangla	4860	Hungarian [HUN]	5467			Tatar	6666
Bhutani	5072		I-K	Occitan	6149	Telugu	6651
Bihari	4854	Icelandic [ICE]	5565	Oriya	6164	Thai	6654
Bislama	4855	Indonesian	5560	Oromo (Afan)	6159	Tibetan	4861
Breton	4864	Interlingua	5547	Panjabi	6247	Tigrinya	6655
Bulgarian	4853	Interlingue	5551	Pashto; Pushto	6265	Tonga	6661
Burmese	5971	Inupiak	5557	Persian	5247	Tsonga	6665
Byelorussian	4851	Irish [IRI]	5347	Polish	6258	Turkish [TUR]	6664
	C-E	Italian [ITA]	5566	Portuguese [POR]	6266	Turkmen	6657
Cambodian	5759	Japanese [JPN]	5647	Quechua	6367	Twi	6669
Catalan	4947	Javanese	5669	Rhaeto-Romance	6459		U-Z
Chinese [CHI]	7254	Kannada	5760	Romanian [RUM]	6461	Ukrainian	6757
Corsican	4961	Kashmiri	5765	Russian [RUS]	6467	Urdu	6764
Croatian	5464	Kazakh	5757			Uzbek	6772
Czech	4965	Kinyarwanda	6469	Samoan	6559	Vietnamese	6855
Danish [DAN]	5047	Kirghiz	5771	Sangho	6553	Volapuk	6861
Dutch [DUT]	6058	Kirundi	6460	Sanskrit	6547	Welsh	4971
English [ENG]	5160	Korean [KOR]	5761	Scots Gaelic	5350	Wolof	6961
Esperanto	5161	Kurdish	5767	Serbian	6564	Xhosa	7054
Estonian	5166		L-N	Serbo-Croatian	6554	Yiddish	5655
	F-H	Laothian	5861	Sesotho	6566	Yoruba	7161
Faroese	5261	Latin	5847	Setswana	6660	Zulu	7267
Fiji	5256	Latvian; Lettish	5868	Shona	6560		
Finnish [FIN]	5255	Lingala	5860	Sindhi	6550		
		Lithuanian	5866	Singhalese	6555		

If you choose a Language that has a 3 letter language code, the code will be displayed every time you change the Audio or Subtitle language setting on page 16. If you choose any other languages, '---' will be displayed instead. (3 letter language code is written in bracket.)

SYLVANIA LIMITED WARRANTY

FUNAI CORP. will repair this SYLVANIA product, free of charge in the USA in the event of defect in materials or workmanship as follows:

DURATION:

PARTS: FUNAI CORP. will provide parts to replace defective parts without charge for one (1) year from the date of original retail purchase. Certain parts are excluded from this warranty.

LABOR: FUNAI CORP. will provide the labor without charge for a period of ninety (90) days from the date of original retail purchase.

LIMITS AND EXCLUSIONS:

This warranty is extended only to the original retail purchaser. A purchase receipt or other proof of original retail purchase will be required together with the product to obtain service under this warranty.

This warranty shall not be extended to any other person or transferee.

This warranty is void and of no effect if any serial numbers on the product are altered, replaced, defaced, missing or if service was attempted by an unauthorized service center. This SYLVANIA Limited warranty does not apply to any product not purchased and used in the United States.

This product is produced for home use and this warranty only covers failures due to defects in material or workmanship which occurs during normal use. It does not cover damage which occurs in shipment, or failures which are caused by repairs, alterations or product not supplied by FUNAI CORP., or damage which results from accident, misuse, abuse, mishandling, misapplication, alteration, faulty installation, improper maintenance, commercial use such as hotel, rental or office use of this product or damage which results from fire, flood, lightning or other acts of God.

THIS WARRANTY DOES NOT COVER PACKING MATERIALS, ANY ACCESSORIES (EXCEPT REMOTE CONTROL), ANY COSMETIC PARTS, COMPLETE ASSEMBLY PARTS, DEMO OR FLOOR MODELS.

FUNAI CORP. AND ITS REPRESENTATIVES OR AGENTS SHALL IN NO EVENT BE LIABLE FOR ANY GENERAL, INDIRECT OR CONSEQUENTIAL DAMAGES ARISING OUT OF OR OCCASIONED BY THE USE OF OR THE INABILITY TO USE THIS PRODUCT. THIS WARRANTY IS MADE IN LIEU OF ALL OTHER WARRANTIES, EXPRESS OR IMPLIED, AND OF ALL OTHER LIABILITIES ON THE PART OF FUNAI, ALL OTHER WARRANTIES INCLUDING THE WARRANTY OF MERCHANTABILITY, AND FITNESS FOR A PARTICULAR PURPOSE, ARE HEREBY DISCLAIMED BY FUNAI AND ITS REPRESENTATIVES IN THE UNITED STATES. ALL WARRANTY INSPECTIONS AND REPAIRS MUST BE PERFORMED BY A FUNAI AUTHORIZED SERVICE CENTER. THIS WARRANTY IS VALID WHEN THE UNIT IS CARRIED-IN TO A FUNAI AUTHORIZED SERVICE CENTER.

IMPORTANT:

THIS LIMITED WARRANTY GIVES YOU SPECIFIC LEGAL RIGHTS. YOU MAY HAVE OTHER RIGHTS THAT VARY FROM STATE TO STATE. IF, AT ANY TIME DURING THE WARRANTY PERIOD, YOU ARE UNABLE TO OBTAIN SATISFACTION WITH THE REPAIR OF THIS PRODUCT, PLEASE CONTACT FUNAI CORP.

ATTENTION:

FUNAI CORP. RESERVES THE RIGHT TO MODIFY ANY DESIGN OF THIS PRODUCT WITHOUT PRIOR NOTICE.

To locate your nearest AUTHORIZED SERVICE CENTER or for general service inquiries, please contact us at :

FUNAI CORPORATION
Customer Service

Tel :1-800-968-3429

<http://www.SylvaniaConsumerElectronics.com>

19900 Van Ness Avenue, Torrance, CA 90501

1 Conexiones

Si su televisor tiene entradas de AUDIO/VIDEO vea la sección "Connection to a TV" en la página 10 en el Manual de Manejo. En caso contrario, vea la sección "RF Modulator Connection" en la página 11 en el Manual de Manejo.

2 Ajustes de altavoz

Conecte todos los altavoces y ajuste correctamente el sistema para disfrutar de la experiencia del Cine en el Hogar.

- 1 Coloque los altavoces DELANTEROS Izquierdo y Derecho a las mismas distancias del TV y a un ángulo de 45 grados de la posición de escucha.
- 2 Coloque el altavoz CENTRAL encima o debajo del TV para localizar el sonido.
- 3 Coloque los altavoces TRASEROS (Inalámbricos) al nivel de escucha normal detrás de la posición de escucha.
- 4 Coloque el altavoz de subgraves en el piso, cerca del TV.

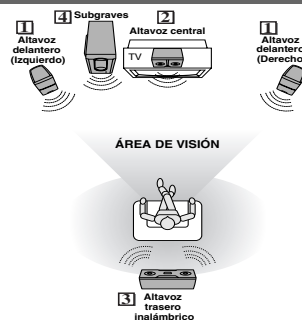

3 Para cambiar el idioma en la pantalla

4 Reproducción

Antes:

- Encienda el televisor, amplificador y otros equipos conectados a esta reproductor. Asegúrese que el televisor y el sintonizador de audio (de venta en los comercios) están en el canal correcto.



- 1 Presione [DVD POWER] para encender el reproductor de DVD/CD.
- 2 Coloque un disco con la etiqueta mirando a la izquierda (arriba si la instalación es horizontal).
- 3 Presione [PLAY ►] para empezar a reproducir.
- 4 Presione [STOP ■] para parar la reproducción.

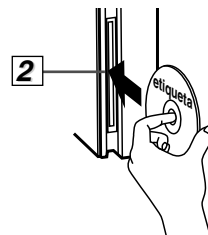
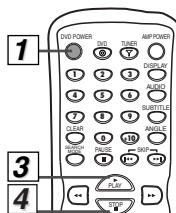

5 Radio AM/FM

Prefijado de estaciones de radio

- 1 Presione [AMP POWER] para activar el sintamplificador AV.
- 2 Presione [TUNER] para seleccionar el modo de sintonizador. La frecuencia de radio actual (número de emisora) aparecerá en la pantalla.
- 3 Presione [REPEAT/BAND] para seleccionar FM o AM.
- 4 Utilice [TUNING ▲ / ▼] para seleccionar la emisora que desea prefijar.
- 5 Presione [SETUP] durante 1 segundo. Destellará el número prefijado.
- 6 Utilice [SKIP ◀◀ / ▶▶] y seleccione un número prefijado y presione [SETUP]. (Vea la página 21 para más detalles.)

Selección de emisoras de radio

- 1 Presione [AMP POWER] para activar el sintamplificador AV.
- 2 Presione [TUNER] para seleccionar el modo de sintonizador. La frecuencia de radio actual (número de emisora) aparecerá en la pantalla.
- 3 Presione [REPEAT/BAND] para seleccionar FM o AM.
- 4 Utilice [SKIP ◀◀ / ▶▶] para seleccionar una emisora de radio prefijada.
- 5 Utilice [TUNING ▲ / ▼] para cambiar la frecuencia de radio.
- 6 Mantenga presionado [TUNING ▲ / ▼] para durante 2 segundos para el modo de búsqueda. Se sintonizará la siguiente emisora disponible. (Vea la página 21 para más detalles.)

6 Funcionamiento con el control remoto para DVD/CD Player

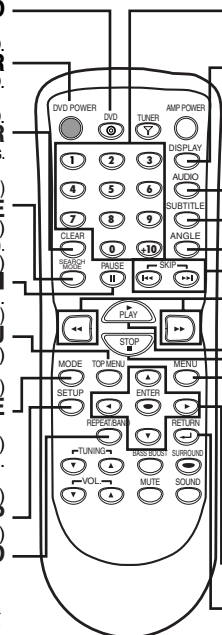

Botón DVD
Para activar el sintonizador AV y el control remoto en el modo DVD.

Botón DVD POWER
Para activar y desactivar el reproductor de DVD. Para activar el sintonizador AV y el control remoto en el modo DVD.

Botón CLEAR
Para borrar los marcadores (DVD/CD) y los números mal entrados. Para eliminar el Nº de estado en la entrada de programa. (CD/MP3/WMA)

Botón SEARCH MODE
Para buscar un capítulo, título o tiempo. (DVD)
Para colocar o buscar los marcadores (DVD/CD) y tiempo (CD).
Para buscar una canción. (CD/MP3/WMA)

Botón PAUSE II
Para hacer una pausa en la reproducción. Para avanzar la reproducción un cuadro cada vez. (DVD)

Botón TOP MENU
Para llamar el menú inicial en un disco. (DVD)
Para volver al archivo superior de la jerarquía más alta en el programa y en la lista de archivo. (MP3/WMA)

Botón MODE
Para desactivar /x1,3 /x0,8 el reproducción rápida y el nivel del negro. (DVD)
Para activar/desactivar el Dolby Pro Logic II. Para disponer el orden de reproducción o la reproducción aleatoria. (CD/MP3/WMA)

Botón SETUP
Para llamar el menú de ajustes de DVD. (DVD)

Botón REPEAT/BAND
Para reproducir repetidamente un capítulo o título. (DVD)
Para reproducir repetidamente una canción o disco. (CD)
Para reproducir repetidamente una canción, grupo o disco. (MP3/WMA)

Botones NUMBER
Para seleccionar directamente el capítulo o título. (DVD)
Para seleccionar directamente la canción. (CD/MP3/WMA)

Botón DISPLAY
Para mostrar el modo de disco actual.

Botón AUDIO
Para seleccionar idiomas de audio en un disco. (DVD)
Para seleccionar ESTEREO L-ch o R-ch. (CD)

Botón SUBTITLE
Para seleccionar subtítulos en un disco. (DVD)

Botón ANGLE
Para seleccionar los ángulos de cámara en un disco. (DVD)

Botones SKIP <<</>>>
Para saltar capítulos. (DVD) o canciones. (CD/MP3/WMA).

Botones FWD >>> / REV <<<
Para buscar en avance/retroceso por un disco. Para empezar la reproducción en avance lento/retroceso durante el modo de pausa. (DVD)

Botón PLAY >
Para empezar la reproducción del disco.

Botón STOP ■
Para parar la reproducción.

Botón MENU
Para llamar el Menú en un disco. (DVD)
Para llamar la lista de archivo. (MP3/WMA)

Botones ENTER / ▲ / ▼ / ◀ / ▶
Para mover el cursor y determinar la posición.

Botón RETURN
Para volver a la operación anterior en el menú.

7 Funcionamiento con el control remoto para AV Receiver

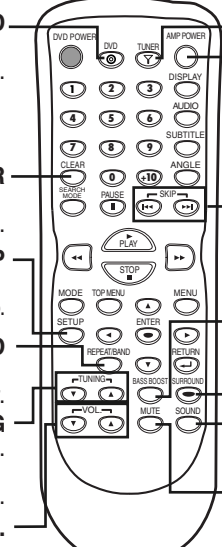

Botón DVD
Para activar el sintonizador AV y el control remoto en el modo DVD.

Botón CLEAR
Para borrar emisoras de radio prefijadas en el Prefijado de emisoras de radio.

Botón SETUP
Mantenga presionado para entrar en el modo de prefijado de canal para las emisoras de radio.

Botón REPEAT/BAND
Para seleccionar FM o AM en el modo de sintonizador.

Botones TUNING
Para subir o bajar la frecuencia. Mantenga presionado 2 segundos para buscar emisoras de radio.

Botones VOL.
Para ajustar el volumen.

Botón TUNER
Para activar el sintonizador AV y el control remoto en el modo de sintonizador.

Botón AMP POWER
Para activar o desactivar el sintonizador AV.

Botones SKIP <<</>>>
Para seleccionar emisoras de radio prefijadas. Para seleccionar el número prefijado en el Prefijado de emisoras de radio.

Botón BASS BOOST
Para activar o desactivar el refuerzo de graves.

Botón SURROUND
Para activar o desactivar el sonido envolvente.

Botón SOUND
Para seleccionar el sonido digital.

Botón MUTE
Para silenciar el sonido.

8 Instalación de las pilas para el mando a distancia

Instale dos pilas AA (entregadas) de forma que las polaridades coincidan con las indicadas dentro del compartimiento de pilas del mando a distancia.

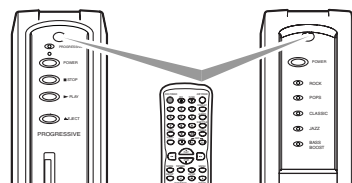
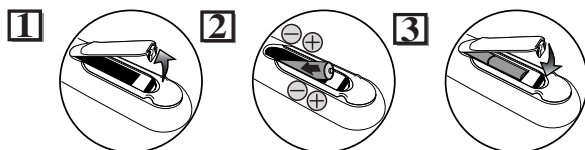

Recuerde lo siguiente cuando utilice el mando a distancia:

- Asegúrese que no haya obstáculos entre el mando a distancia y el sensor remoto en la unidad.
- Las máximas distancias de funcionamiento de la unidad son las siguientes.
 - Línea directa: aprox. 7m (23 pies)
 - A un lado del centro: aprox. 5m (16 pies) ángulo de menos de 30°
 - Arriba: aprox. 5m (16 pies) en un ángulo de menos de 15°
 - Abajo: Aprox. 3m (10 pies) en un ángulo de menos de 30°

Quick Use Guide

1 Connections

If your TV has AUDIO/VIDEO input jacks, see the section "Connection to a TV" on page 10 of the Owner's Manual. If not, see the section "RF Modulator Connection" on page 11 of the Owner's Manual.

2 Speaker Setup

Connect all the speakers and set up the system properly in order to enjoy the Home Cinema experience.

- 1 Place the FRONT Left and Right speakers at equal distances from the TV and at a 45-degree angle from the listening position.
- 2 Place the CENTER speaker above or below the TV to localize the sound.
- 3 Place the REAR (Wireless) speakers at normal listening ear level behind the listening position.
- 4 Place the Subwoofer on the floor, near the TV.

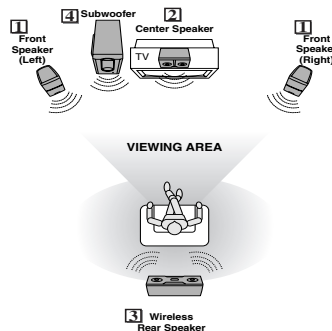

3 To Change the On-Screen Language

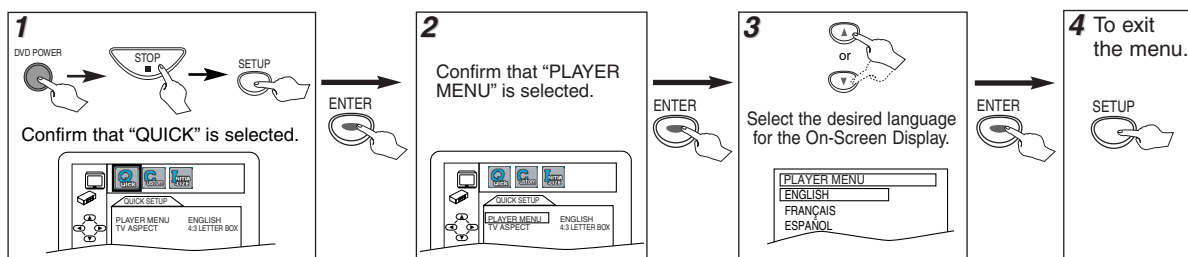

4 Playback

Before:

- Turn on the TV, amplifier and any other equipment which are connected to this player. Make sure the TV and audio receiver (commercially available) are set to the correct channel.



- 1 Press [DVD POWER] to turn on the DVD/CD Player.
- 2 Insert a disc with label facing to the left (facing up for horizontal installation).
- 3 Press [PLAY ►] to start playback.
- 4 Press [STOP ■] to stop playback.

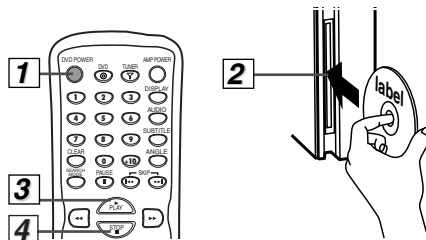

5 AM /FM Radio

Preset Radio Stations

- 1 Press [AMP POWER] to turn on the AV Receiver.
- 2 Press [TUNER] to select Tuner mode. The current radio frequency (station number) will appear on the display.
- 3 Press [REPEAT/BAND] to select FM or AM.
- 4 Use [TUNING ▲ / ▼] to select the station you want to preset.
- 5 Press [SETUP] for 1 second. Preset number will flash.
- 6 Use [SKIP ◀◀ / ▶▶] and select a preset number, then press [SETUP].
(See page 21 for more details.)

Selecting Radio Stations

- 1 Press [AMP POWER] to turn on the AV Receiver.
- 2 Press [TUNER] to select Tuner mode. The current radio frequency (station number) will appear on the display.
- 3 Press [REPEAT/BAND] to select FM or AM.
- 4 Use [SKIP ◀◀ / ▶▶] to select a preset radio station.
- 5 Use [TUNING ▲ / ▼] to change the radio frequency.
- 6 Press and hold [TUNING ▲ / ▼] for 2 seconds for search mode. The next available station will be tuned.
(See page 21 for more details.)

6 Remote Control operation for the DVD/CD Player

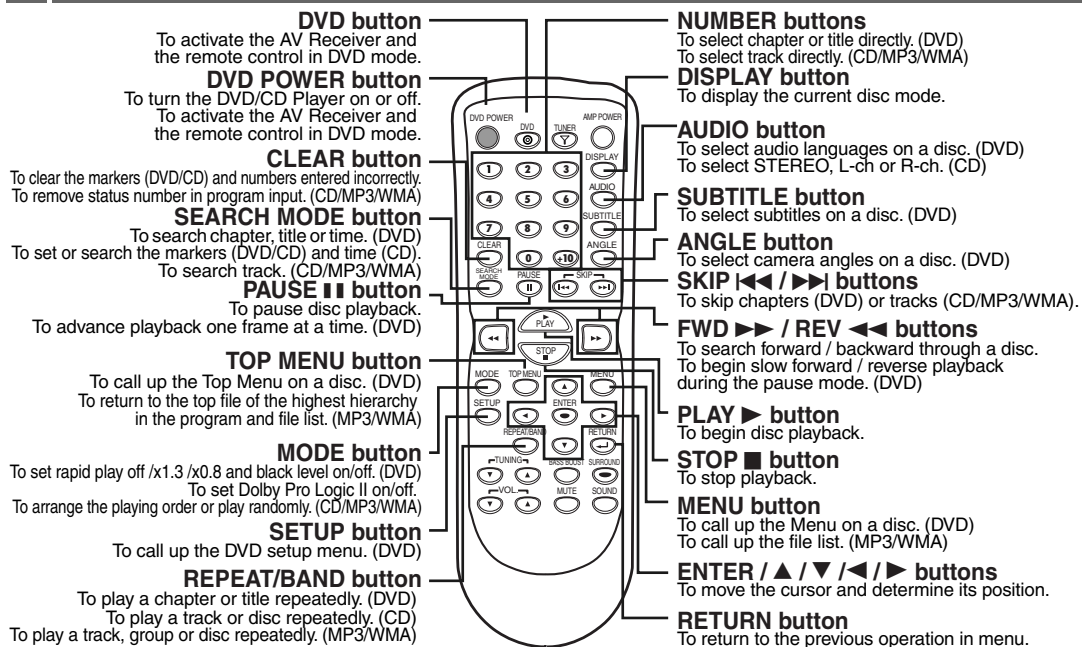

7 Remote Control operation for the AV Receiver

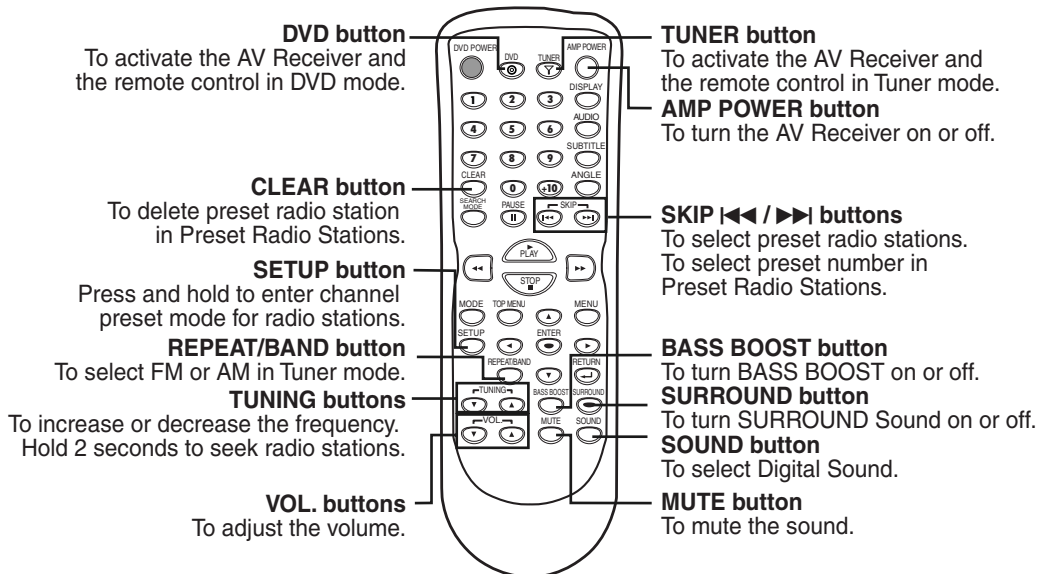

8 Installing the Batteries for the Remote Control

Install two AA batteries (supplied) matching the polarity indicated inside battery compartment of the remote control.

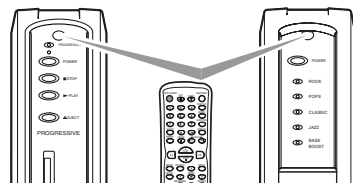
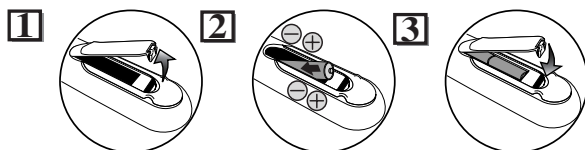

Keep in mind the following when using the remote control:

- Make sure that there is no obstacle between the remote control and the remote sensor on the player (the receiver).
- The maximum operable ranges from the player (the receiver) are as follows.
 - **Beeline:** approx. 23 feet (7m)
 - **Either side of the center:** approx. 16 feet (5m) within 30°
 - **Above:** approx. 16 feet (5m) within 15°
 - **Below:** approx. 10 feet (3m) within 30°

Free Manuals Download Website

<http://myh66.com>

<http://usermanuals.us>

<http://www.somanuals.com>

<http://www.4manuals.cc>

<http://www.manual-lib.com>

<http://www.404manual.com>

<http://www.luxmanual.com>

<http://aubethermostatmanual.com>

Golf course search by state

<http://golfingnear.com>

Email search by domain

<http://emailbydomain.com>

Auto manuals search

<http://auto.somanuals.com>

TV manuals search

<http://tv.somanuals.com>