

Symphonic

32 inch Digital / Analog
LCD TV

Owner's Manual
WF32L6



HDTV
HIGH-DEFINITION TELEVISION

HDMI
HIGH-DEFINITION MULTIMEDIA INTERFACE

DOLBY
DIGITAL

**TO RECEIVE DIGITAL/ANALOG SIGNAL,
YOU MUST CONNECT ANTENNA.**

IF YOU NEED ADDITIONAL ASSISTANCE WITH SET-UP OR OPERATING AFTER
READING OWNER'S MANUAL, PLEASE CALL TOLL FREE **1-800-605-8453**, OR
VISIT OUR WEB SITE AT **<http://www.Symphonic.us>**

WARNING:

TO REDUCE THE RISK OF FIRE OR ELECTRIC SHOCK, DO NOT EXPOSE THIS APPLIANCE TO RAIN OR MOISTURE.



CAUTION: TO REDUCE THE RISK OF ELECTRIC SHOCK, DO NOT REMOVE COVER (OR BACK). NO USER SERVICEABLE PARTS INSIDE. REFER SERVICING TO QUALIFIED SERVICE PERSONNEL.

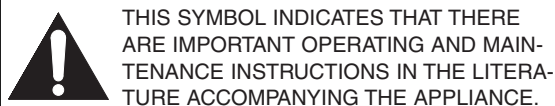
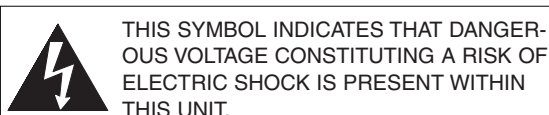

The important note is located on the rear of the cabinet.

IMPORTANT SAFEGUARDS

- 1. READ INSTRUCTIONS** - All the safety and operating instructions should be read before the appliance is operated.
- 2. RETAIN INSTRUCTIONS** - The safety and operating instructions should be retained for future reference.
- 3. HEED WARNINGS** - All warnings on the appliance and in the operating instructions should be adhered to.
- 4. FOLLOW INSTRUCTIONS** - All operating and use instructions should be followed.
- 5. CLEANING** - Unplug TV from the wall outlet before cleaning. Do not use liquid cleaners or aerosol cleaners. Use a damp cloth for cleaning. EXCEPTION: A product that is meant for uninterrupted service and, that for some specific reason, such as the possibility of the loss of an authorization code for a CATV converter, is not intended to be unplugged by the user for cleaning or any other purpose, may exclude the reference to unplugging the appliance in the cleaning description otherwise required in item 5.
- 6. ATTACHMENTS** - Do not use attachments not recommended by the TV manufacturer as they may cause hazards.
- 7. WATER AND MOISTURE** - Do not use this TV near water, for example, near a bath tub, wash bowl, kitchen sink, or laundry tub, in a wet basement, or near a swimming pool, and the like.
- 8. ACCESSORIES** - Do not place this TV on an unstable cart, stand, tripod, bracket, or table. The TV may fall, causing serious injury to someone, and serious damage to the appliance. Use only with a cart, stand, tripod, bracket, or table recommended by the manufacturer, or sold with the TV.
- 10. POWER SOURCES** - This TV should be operated only from the type of power source indicated on the marking label. If you are not sure of the type of power supply to your home, consult your appliance dealer or local power company. For TVs intended to operate from battery power, or other sources, refer to the operating instructions.
- 11. GROUNDING OR POLARIZATION** - This TV is equipped with a polarized alternating-current line plug (a plug having one blade wider than the other). This plug will fit into the power outlet only one way. This is a safety feature. If you are unable to insert the plug fully into the outlet, try reversing the plug. If the plug should still fail to fit, contact your electrician to replace your obsolete outlet. Do not defeat the safety purpose of the polarized plug.
- 12. POWER-CORD PROTECTION** - Power-supply cords should be routed so that they are not likely to be walked on or pinched by items placed upon or against them, paying particular attention to cords at plugs, convenience receptacles, and the point where they exit from the appliance.
- 13. OUTDOOR ANTENNA GROUNDING** - If an outside antenna or cable system is connected to the TV, be sure the antenna or cable system is grounded so as to provide some protection against voltage surges and built-up static charges. Article 810 of the National Electrical Code, ANSI/NFPA No. 70, provides information with respect to proper grounding of the mast and supporting structure, grounding of the lead-in wire to an antenna discharge unit, size of grounding conductors, location of antenna-discharge unit, connection to grounding electrodes, and requirements for the grounding electrode. (Fig. A)

Any mounting of the appliance should follow the manufacturer's instructions and should use a mounting accessory recommended by the manufacturer. An appliance and cart combination should be moved with care. Quick stops, excessive force, and uneven surfaces may cause the appliance and cart combination to overturn.

AMEUBLES - Cet appareil ne doit être placé que sur un meuble (avec ou sans roulettes) recommandé par le fabricant. Si vous l'installez sur un meuble à roulettes, déplacez les deux ensembles avec précaution. Un arrêt brusque, l'utilisation d'une force excessive et des surfaces irrégulières risquent de déstabiliser l'ensemble et de le renverser.

- 9. VENTILATION** - Slots and openings in the cabinet and the back or bottom are provided for ventilation and to ensure reliable operation of the TV and to protect it from overheating, these openings must not be blocked or covered. The openings should never be blocked by placing the TV on a bed, sofa, rug, or other similar surface. This TV should never be placed near or over a radiator or heat register. This TV should not be placed in a built-in installation such as a bookcase or rack unless proper ventilation is provided or the manufacturer's instructions have been adhered to.

PORTABLE CART WARNING



S3126A

SYMBÔLE D'AVERTISSEMENT POUR LES COMPOSANTES APPAREIL ET MEUBLE À ROULETTES



S3126A

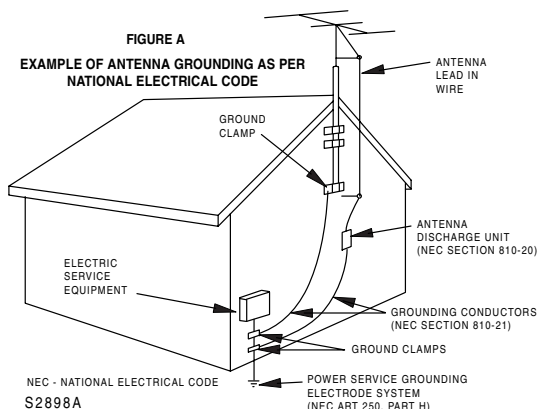

- 14. LIGHTNING** - For added protection for this TV receiver during a lightning storm, or when it is left unattended and unused for long periods of time, unplug it from the wall outlet and disconnect the antenna or cable system. This will prevent damage to the TV due to lightning and power-line surges.

- 15. **POWER LINES** - An outside antenna system should not be located in the vicinity of overhead power lines or other electric light of power circuits, or where it can fall into such power lines or circuits. When installing an outside antenna system, extreme care should be taken to keep from touching such power lines or circuits as contact with them might be fatal.
- 16. **OVERLOADING** - Do not overload wall outlets and extension cords as this can result in a risk of fire or electric shock.
- 17. **OBJECT AND LIQUID ENTRY** - Never push objects of any kind into this TV through openings as they may touch dangerous voltage points or short out parts that could result in a fire or electric shock. Never spill liquid of any kind on the TV.
- 18. **SERVICING** - Do not attempt to service this TV yourself as opening or removing covers may expose you to dangerous voltage or other hazards. Refer all servicing to qualified service personnel.
- 19. **DAMAGE REQUIRING SERVICE** - Unplug this TV from the wall outlet and refer servicing to qualified service personnel under the following conditions:
 - a. When the power supply cord or plug is damaged or frayed.
 - b. If liquid has been spilled, or objects have fallen into the TV.
 - c. If the TV has been exposed to rain or water.
- d. If the TV does not operate normally by following the operating instructions. Adjust only those controls that are covered by the operating instructions, as improper adjustment of other controls may result in damage and will often require extensive work by a qualified technician to restore the TV to its normal operation.
- e. If the TV has been dropped or damaged in any way.
- f. When the TV exhibits a distinct change in performance, this indicates a need for service.
- 20. **REPLACEMENT PARTS** - When replacement parts are required, be sure the service technician uses replacement parts specified by the manufacturer that have the same characteristics as the original part. Unauthorized substitutions may result in fire, electric shock, injury to persons or other hazards.
- 21. **SAFETY CHECK** - Upon completion of any service or repairs to this TV, ask the service technician to perform routine safety checks to determine that the TV is in proper operating condition.
- 22. **HEAT** - This TV product should be situated away from heat sources such as radiators, heat registers, stoves, or other products (including amplifiers) that produce heat.

PRECAUTIONS

- Place your TV in a room with adequate ventilation.
- Keep your TV set away from sources of direct heat, such as heat registers or direct sunlight.
- Do not place your TV on soft surfaces, such as rugs or blankets.
- Leave enough room for air to circulate around the bottom, top and back of the set.

FCC WARNING: This equipment may generate or use radio frequency energy. Changes or modifications to this equipment may cause harmful interference unless the modifications are expressly approved in the owner's manual. The user could lose the authority to operate this equipment if an unauthorized change or modification is made.

CAUTION: TO PREVENT ELECTRIC SHOCK, MATCH WIDE BLADE OF PLUG TO WIDE SLOT, FULLY INSERT.

ATTENTION: POUR ÉVITER LES CHOC ÉLECTRIQUES, INTRODUIRE LA LAME LA PLUS LARGE DE LA FICHE DANS LA BORNE CORRESPONDANTE DE LA PRISE ET POUSSER JUSQU'AU FOND.

Note to CATV system installer:

This reminder is provided to call the CATV system installer's attention to Article 820-40 of the NEC that provides guidelines for proper grounding and, in particular, specifies that the cable ground should be connected to the grounding system of the building as close to the point of cable entry as practical.

The serial number of this product may be found on the back of the TV. No others have the same serial number as yours. You should record the number and other vital information here and retain this book as a permanent record of your purchase to aid identification in case of theft.

Model No.		Date of Purchase	
Serial No.		Dealer Phone No.	
Dealer Purchase from		Dealer Address	

A NOTE ABOUT RECYCLING:

This product's packaging materials are recyclable and can be reused. Please dispose of any materials in accordance with your local recycling regulations. Batteries should never be thrown away or incinerated but disposed of in accordance with your local regulations concerning chemical wastes.

SUPPLIED ACCESSORIES

- Owner's Manual
(1EMN21951)

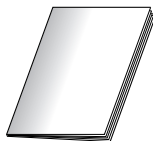

- Remote control unit
(NF006UD)

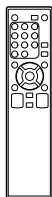

- Batteries
("AA" x 2)



- If you need to replace these accessories, please refer to the PART NO. with the illustrations and call our help line mentioned on the front page.
- Depending on your antenna system, you may need different types of Combiners (Mixer) or Separator (Splitter). Contact your local electronics store for these items.

FEATURES

- **DTV/TV/CATV**

This TV lets you easily switch TV(NTSC) and DTV(ATSC) with the remote control. This feature enables you to simply view from conventional analog TV to Standard Definition TV, High Definition TV. You can also connect this TV to CATV if you have a CATV box.

- **Program Information Display (DTV)**

You can display the title, contents and other information of the current DTV program on the screen.

- **Autoscan**

This TV can automatically scan and memorize the channels receivable in your residential area. This feature eliminates the need of a difficult setting procedure.

- **V-CHIP**

This feature lets you set the viewing limitations to prevent your children from watching inappropriate programs.

- **Closed Caption Decoder**

This TV contains the built-in Closed Caption Decoder that displays text across the screen. It allows you to read the dialogue of a TV program or other information in the Closed Caption-supported programs.

- **MTS/SAP Tuner**

This feature allows you to select with the remote control your desired audio language.

- **Auto Shut Off Function**

If there is no signal input from the antenna terminal and no operation for 15 minutes, the unit will turn itself off automatically.

- **On-Screen Function Display (English / Spanish / French)**

This feature lets you select the language displayed in the setup screen from English, Spanish or French.

- **Stereo Sound Function**

- **Full-Function Remote Control**

- **PLL Frequency Synthesized Tuning**

- **HDMI Input**

This TV accepts 480i / 480p / 720p / 1080i video signals and 32kHz / 44.1kHz / 48kHz audio signals.

- **Component VIDEO Input**

This TV accepts 480i / 480p / 720p / 1080i video signals.

- **S-VIDEO Input**

- **AV Input**

- **Analog Audio Output**

- **Digital Audio Output (Coaxial)**

- **Resume**

This feature will automatically memorize settings if a power failure occurs.

CONTENTS

IMPORTANT SAFEGUARDS	2
PRECAUTIONS	3
SUPPLIED ACCESSORIES	4
FEATURES	4
FUNCTIONS	6
REMOTE CONTROL, TOP AND REAR PANEL FUNCTION	6
INSTALLING THE BATTERIES	7
BATTERY PRECAUTIONS	7
PREPARATION FOR USE	8
CONNECTION	8
ANTENNA CABLE CONNECTION	8
CONNECTION TO CABLE/SATELLITE BOX	8
EXTERNAL CONNECTION	9
HDMI CONNECTION	9
COMPONENT CONNECTION	10
S-VIDEO CONNECTION	10
ANALOG AUDIO/VIDEO CONNECTION	11
AUDIO OUTPUT CONNECTION	11
INITIAL SETTINGS	12
INITIAL SETTINGS	12
CHANNEL SETTINGS	13
AUTOSCAN	13
CHANNEL LIST	14
MANUAL REGISTER	15
ANTENNA CONFIRMATION	16
LANGUAGE SELECTION	17
WATCHING TV	18
CHANNEL SELECTION	18
VOLUME ADJUSTMENT	18
STILL MODE	19
SWITCHING AUDIO	19
SWITCHING EXTERNAL INPUT	20
CHANGING THE SCREEN DISPLAY MODE	21
SCREEN INFORMATION	22
SLEEP TIMER	23
OPTIONAL SETTINGS	23
SETUP SCREEN	23
PICTURE ADJUSTMENT	24
CLOSED CAPTION	25
DTV CLOSED CAPTION	26
CLOSED CAPTION STYLE	26
V-CHIP	28
HDMI AUDIO	31
MISCELLANEOUS	32
TROUBLESHOOTING GUIDE	32
GLOSSARY	34
MAINTENANCE	34
SPECIFICATIONS	35
WARRANTY	BACK COVER

SYMBOLS USED IN THIS MANUAL

The following is the description for the symbols used in this manual.

 : Settings only for the analog mode

 : Settings only for the digital mode

- If there is no symbol under the function heading, those are common settings for the analog mode and digital mode.

FUNCTIONS

REMOTE CONTROL, TOP AND REAR PANEL FUNCTION

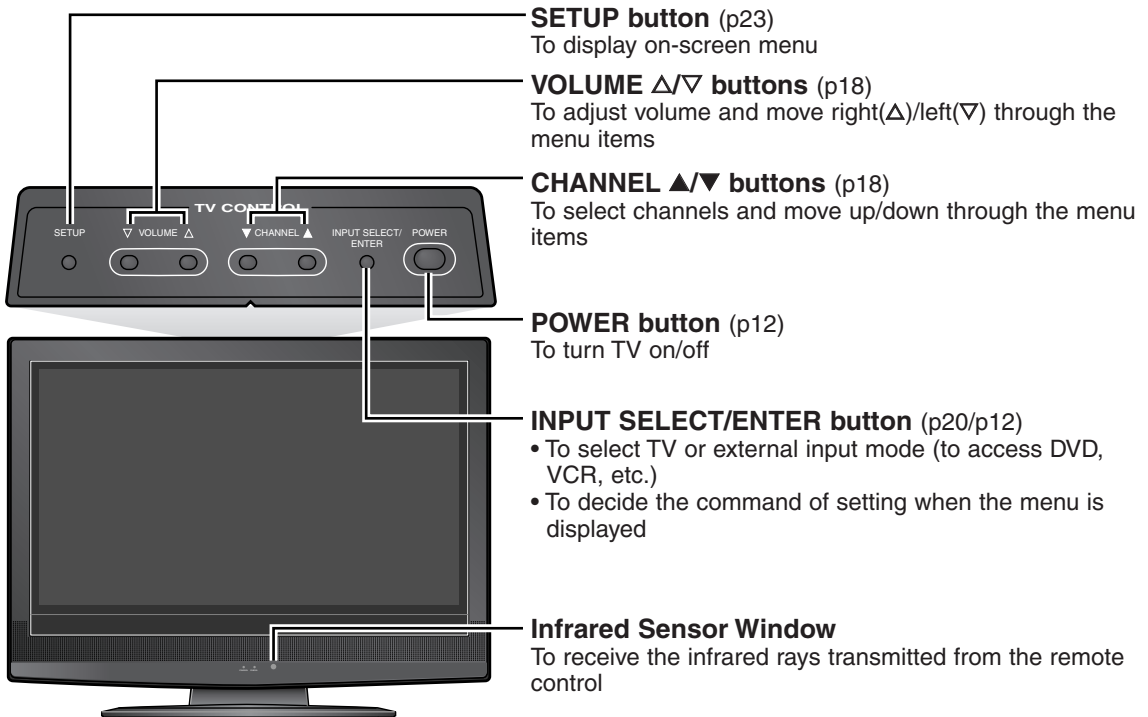
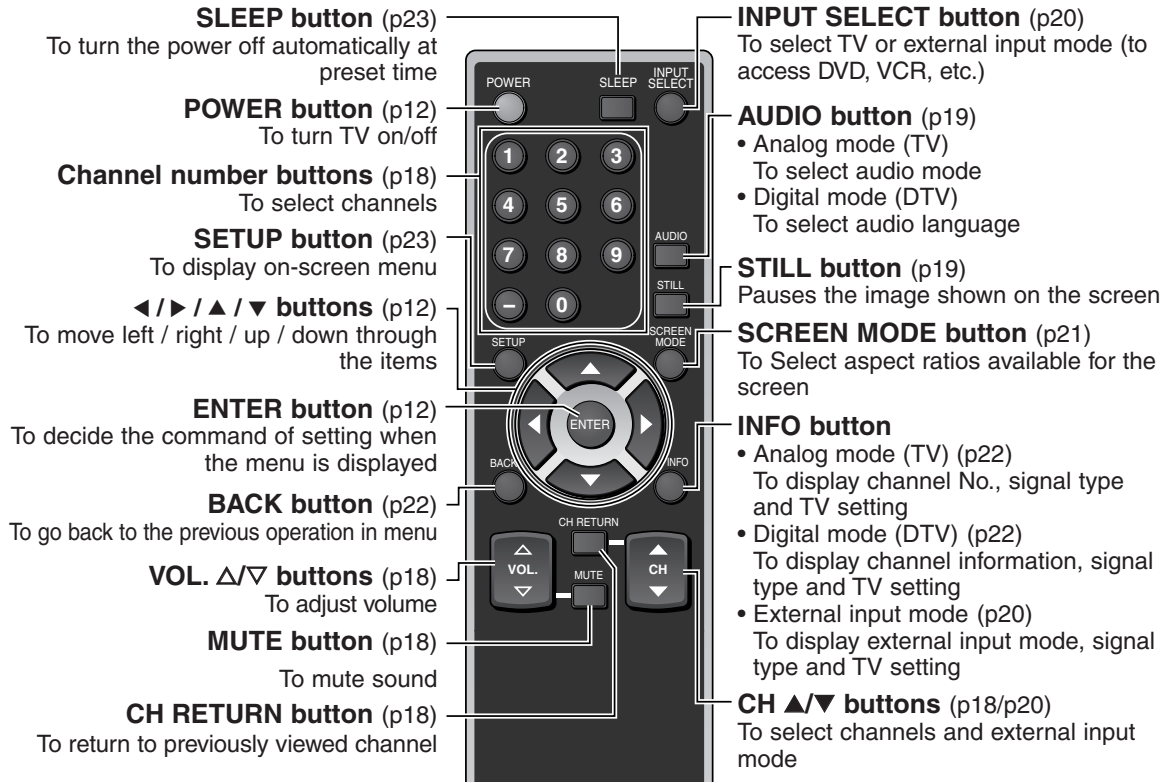

NOTE:

• With buttons [VOL. ▲/▼] or [MUTE], you can only adjust the volume of the main unit. You cannot adjust the volume of the external devices with these buttons.

ANT. IN jack

Connect your antenna or cable box here.

DIGITAL AUDIO OUT (COAXIAL) jack

Connect an optional coaxial digital audio cable here through the coaxial digital audio in jack of a decoder or audio receiver.

AUDIO OUT jacks

Connect audio cable here through the audio in jacks of audio equipment.

HDMI IN jacks

Connect HDMI cable and audio cable coming from the HDMI and audio out jacks of external devices.

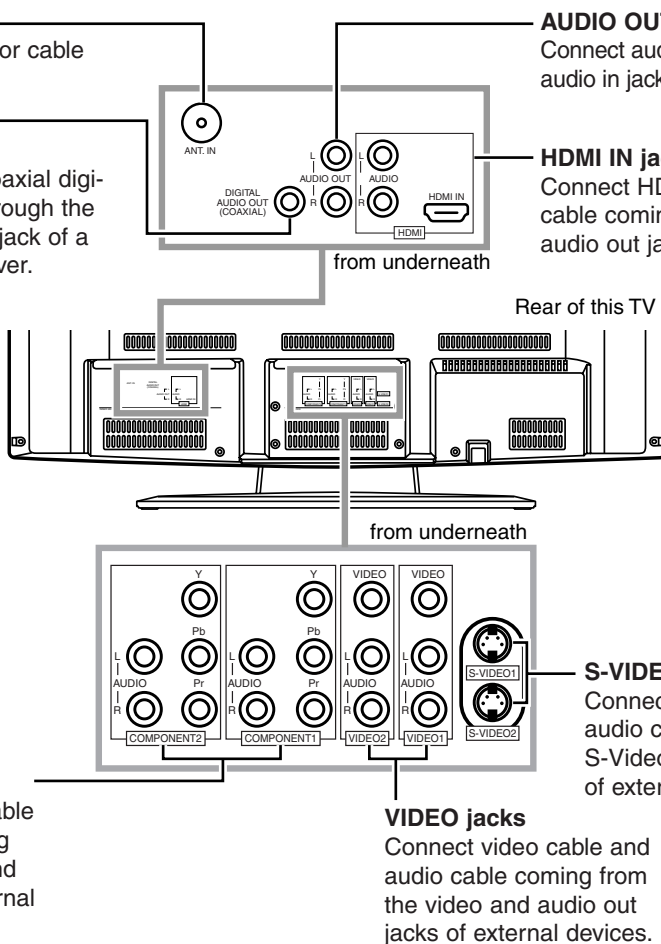
**COMPONENT jacks**

Connect component cable and audio cable coming from the component and audio out jacks of external devices.

S-VIDEO jacks

Connect S-Video cable with audio cable coming from the S-Video and audio out jacks of external devices.

VIDEO jacks

Connect video cable and audio cable coming from the video and audio out jacks of external devices.

INSTALLING THE BATTERIES

Install two AA batteries (supplied) matching the polarity indicated inside battery compartment of the remote control.

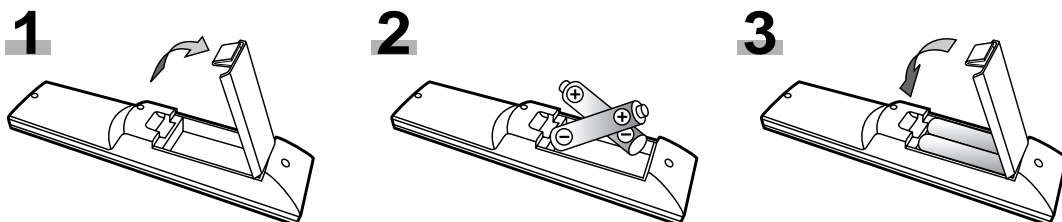
**[BATTERY PRECAUTIONS]**

- Be sure to follow the correct polarity as indicated in the battery compartment. Reversed batteries may cause damage to the device.
- Do not mix different types of batteries together (e.g. Alkaline and Carbon-Zinc) or old batteries with fresh ones.
- If the device is not to be used for a long period of time, remove the batteries to prevent damage or injury from possible battery leakage.
- Do not try to recharge batteries not intended to be recharged; they can overheat and rupture.

PREPARATION FOR USE

CONNECTION

This section describes how to connect this TV to reception and other sources.

MAKE SURE YOU HAVE AN ANTENNA.

As DTV is only available over the air, you need an antenna to receive a digital signal.

NOTE:

- Be sure that antenna or cable is connected properly **before** plugging the power cord.

[ANTENNA CABLE CONNECTION]

1) When connecting TV to antenna

Connect the RF cable or antenna cable on your home outlet to the ANT. IN jack of this TV.

2) When connecting TV to RF/Incoming cable (without box)

Connect the RF cable or incoming cable on your home outlet to the ANT. IN jack of this TV.

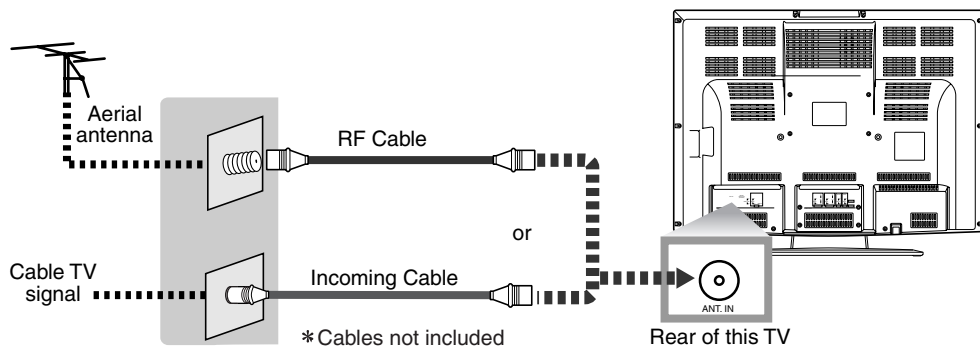

NOTES:

- For your safety and to avoid damages to the unit, unplug the antenna cable from the ANT. IN jack before moving the unit.
- If you use an antenna in order to receive analog TV, the same antenna generally will work for DTV reception. Outdoor or attic antennas will be more effective than set-top versions.
- To easily switch between antenna and cable wires, you can purchase "Antenna Selector" commercially available.
- If you connect cable system directly, contact the CATV installer.

*Once connections are completed, turn on the TV and begin initial setup.

Channel scanning is necessary for the TV to memorize all available channels in your area if using antenna or RF/Incoming cable. (Refer to "INITIAL SETTINGS" on page 12.)

[CONNECTION TO CABLE/SATELLITE BOX]

1) Connect the antenna cable on your home outlet to the input jack of the CABLE/SATELLITE box.

2) Use the corresponding cable to connect the ANT. IN jack of this TV and the output jack of the CABLE/SATELLITE box.

*Required cables in 2) and connecting methods differ depending on the CABLE/SATELLITE box. For more information, please contact the cable/satellite provider.

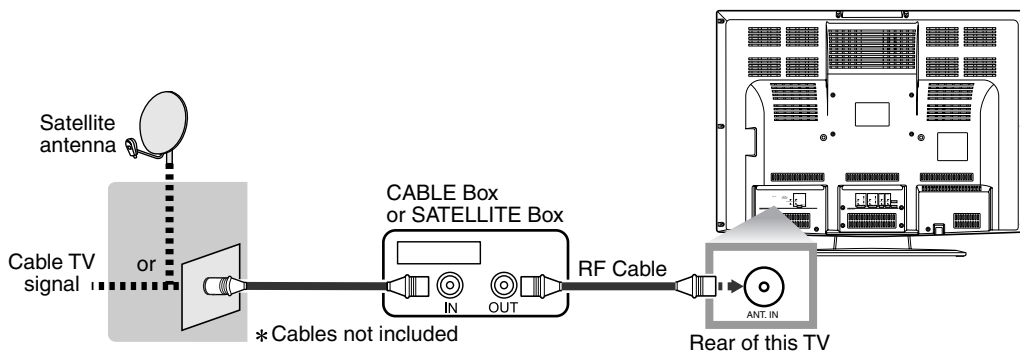

EXTERNAL CONNECTION

[HDMI CONNECTION]

1) This is the best method to connect this TV to video devices with the HDMI output jack, such as DVD player with HDMI output jack, etc. It can minimize the deterioration of image quality. Use the HDMI cable (commercially available) for connection.

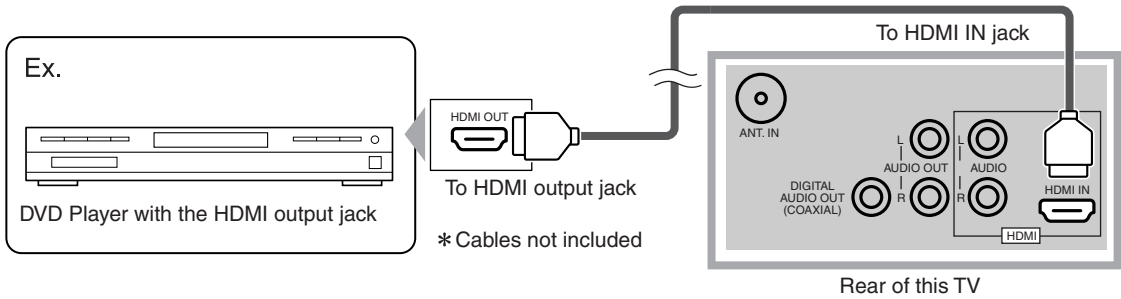

NOTES:

- This TV accepts 480i / 480p / 720p / 1080i video signals, and 32kHz / 44.1kHz / 48kHz audio signals.
- This TV accepts only 2 channel audio signal (LPCM).
- You need to select "PCM" for the digital audio output of the device you connect or the HDMI audio setting. Audio sometimes makes no sound if you select "Bitstream", etc.
- This TV only accept signals corresponding EIA861.

2) When your video device has the DVI output jack, use the HDMI conversion cable from DVI output jack (commercially available) for connection as illustrated below.

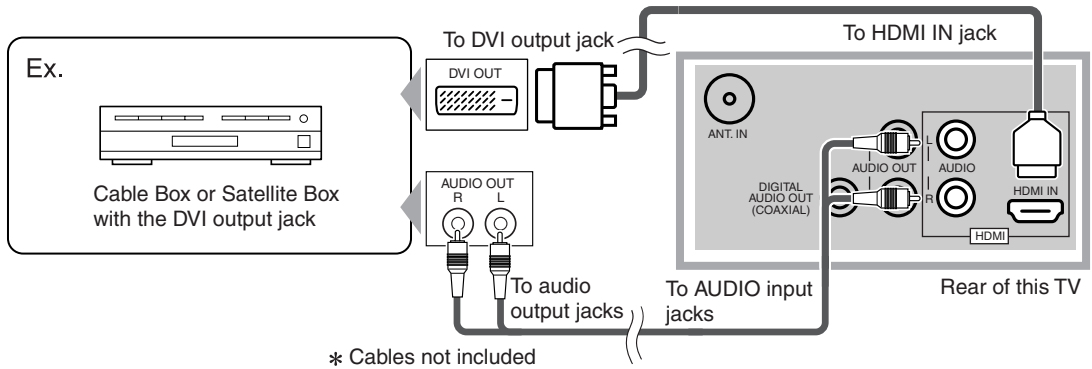

NOTES:

- This TV accepts 480i / 480p / 720p / 1080i video signals.
- Audio signals are converted to an analog signal from the digital if you make a connection above.
- DVI does not show image if the 480i does not accept EIA/CEA-861/861B.

"HDMI, the HDMI logo and High-Definition Multimedia Interface are trademarks or registered trademarks of HDMI Licensing LLC."

[COMPONENT CONNECTION]

1) This is a better method to connect this TV to video devices with the Component output jack, such as a DVD player, etc.

Use the Component cable (commercially available) for connection.

If you connect component output jacks to COMPONENT1 input jack, connect an audio cable to AUDIO L/R jacks of COMPONENT1.

If you connect component output jacks to COMPONENT2 input jack, connect an audio cable to AUDIO L/R jacks of COMPONENT2.

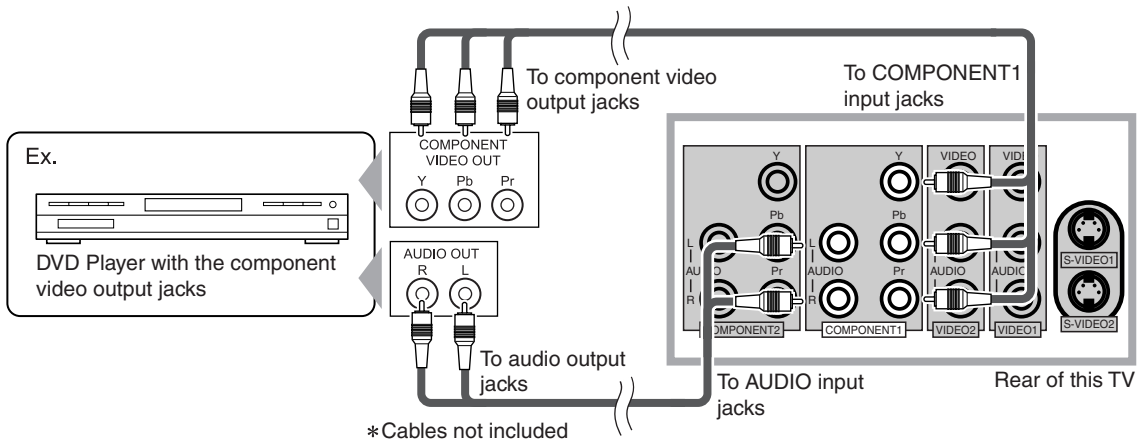

NOTE:

• This TV accepts 480i / 480p / 720p / 1080i video signals.

[S-VIDEO CONNECTION]

1) This is a good method to connect this TV to the video devices with the S-Video output jack. You can expect better picture quality than the normal video cable connection.

Use the S-Video cable (commercially available) for connection.

If you connect S-Video output jack to S-VIDEO1 input jack, connect an audio cable to AUDIO L/R jacks of VIDEO1.

If you connect S-Video output jack to S-VIDEO2 input jack, connect an audio cable to AUDIO L/R jacks of VIDEO2.

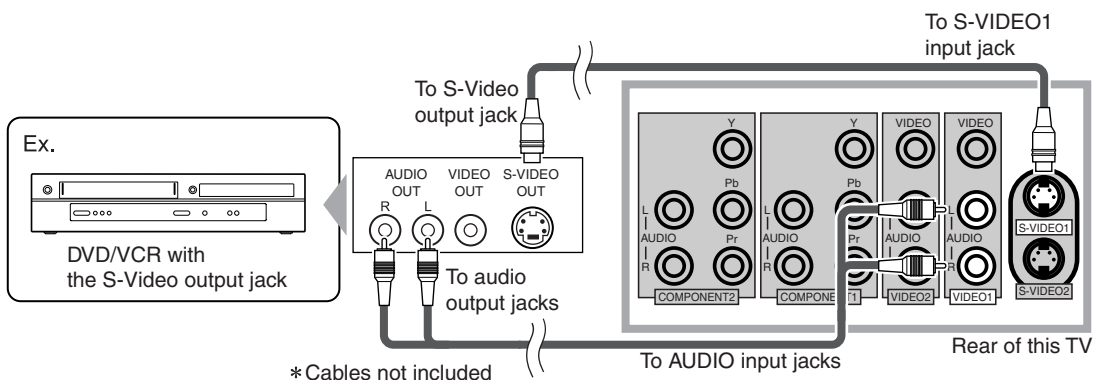

NOTE:

• If you connect to the S-VIDEO jack and the VIDEO jack at the same time, S-Video connection will have priority.

[ANALOG AUDIO/VIDEO CONNECTION]

1) This is the general method to connect this TV to video devices with the video and audio output jacks, such as VCR, Camcorder, Video Game, etc.

When the audio jack of video devices is monaural, connect this TV to the AUDIO L jack.

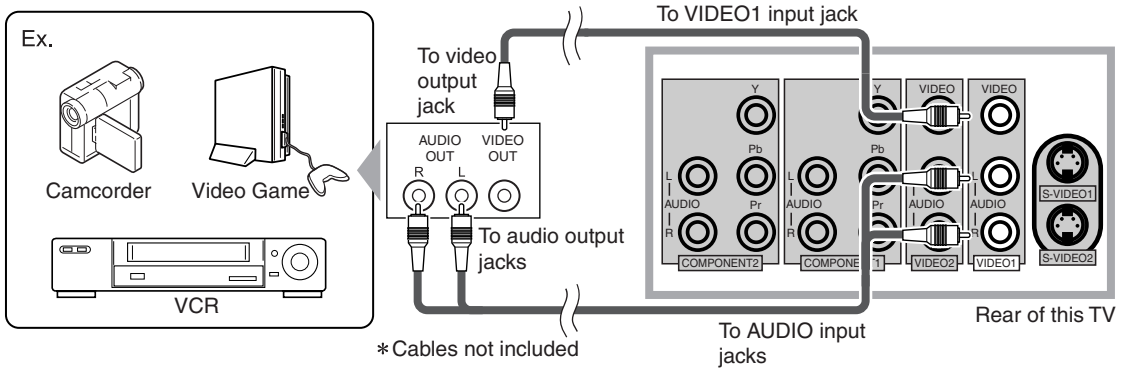

[AUDIO OUTPUT CONNECTION]

1) If you connect this TV to an external audio device, you can enjoy multi-channel audio like 5.1ch digital broadcasting sound.

Use the Digital Audio Coaxial cable or Audio cable (commercially available) for connection.

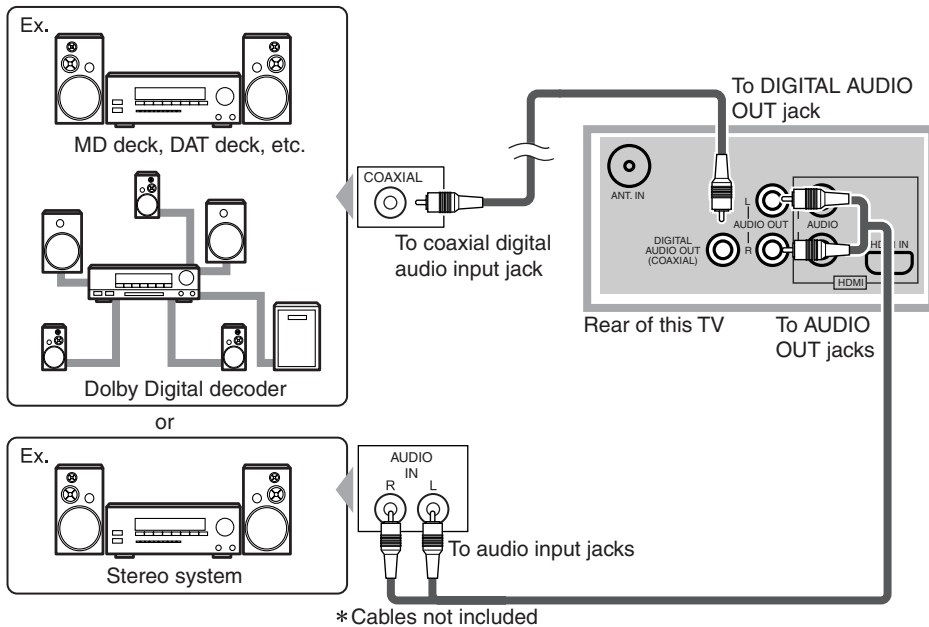

Manufactured under license from Dolby Laboratories. "Dolby" and the double-D symbol are trademarks of Dolby Laboratories.

INITIAL SETTINGS

Hint: Before starting initial setup you must connect antenna.

INITIAL SETTINGS

This section describes the initial settings when you first turn on the power after purchase. The initial setting items are shown below.

• LANGUAGE SELECTION

You can select the menu language displayed on the screen among English, Spanish and French.

• AUTOSCAN (TV/DTV) (Select "Air" when using antenna)

The channels broadcasted in TV and DTV are automatically scanned and memorized. Only the receivable channels in the area where this TV is used will be memorized.

• AUTOSCAN (CATV) (Select "Cable" when using RF/Incoming cable)

The channels broadcasted in CATV are automatically scanned and memorized.

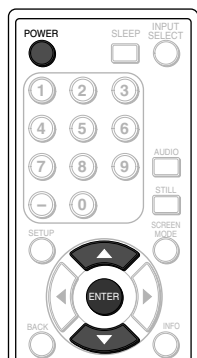

1 After making all the necessary connections, turn on this TV.

2 Press **[POWER]**. Initial Setup menu will appear.

- This operation may take a few moments.
- If Initial Setup menu does not appear, press and hold **[ENTER]** for 3 seconds, initial setup will appear then proceed to step 3. If you have already turned on this TV before, refer to "LANGUAGE SELECTION" on page 17 to select a language for the on-screen displays.

3 Select your language using **[▲/▼]**, press **[ENTER]**.

When you first turn on the power, the following screen is displayed.

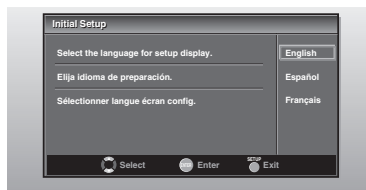

The Antenna Confirmation will be displayed in the selected language after you press **[ENTER]**.

4 Select source of ANT. IN jack using **[▲/▼]**, press **[ENTER]**.

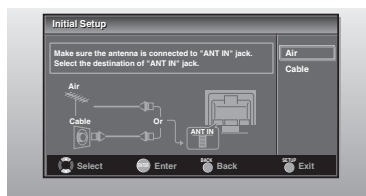

5 Autoscan will start automatically.

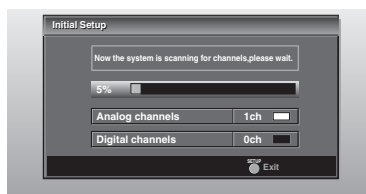

- When scanning has completed, the lowest memorized channel will be displayed.

NOTES:

- The initial Autoscan function can be executed for either "Air" or "Cable" only once. When you change the connection (Air/Cable), set the "Autoscan" again. (Refer to page 13.)
- If you connect cable system directly, contact the CATV installer.
- When the scanning is not completed, Helpful Hint will be displayed every time you turn on the power. If you have previously registered channels when this screen appears you can select a channel with number buttons.

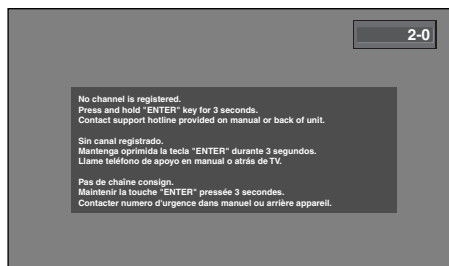

- Support hotline is provided on the front page of this manual.

CHANNEL SETTINGS

AUTOSCAN

If you switch wires (e.g. between antenna and CATV) or if you move the TV to a different area after the initial setting, you need to perform Autoscan again. This function lets you easily select the receivable channels with [CH ▲/▼] and the TV memorizes them even if you switch wires.

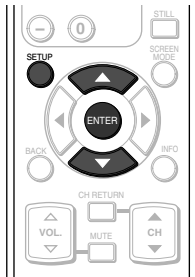

NOTE:

- Make sure if the TV is connected to antenna or cable.

1 Display the setup screen.

- Press [SETUP].
The following setup screen is displayed.



2 Select "CHANNEL" and press [ENTER] to confirm.

- Using [▲/▼], select "Autoscan".



- Press [ENTER].

3 For TV channels, using [▲/▼], select "Air".
For CATV channels, select "Cable".

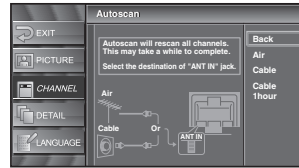

- Press [ENTER].
Scanning and memorizing the channels automatically starts.

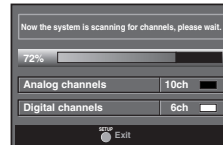

- When the scanning and memorizing are completed, the lowest memorized channel in the broadcasting will be displayed.

NOTES:

- If you connect a cable system directly, contact the CATV installer.
- If you press [POWER] or [SETUP] during Autoscan, this setting will be canceled.
- If there is no reception connected or poor signal is detected, a Hint will appear on screen once scanning stops.

CHANNEL LIST

The Channel List function lets you skip the unnecessary channels from the Channel registration list.

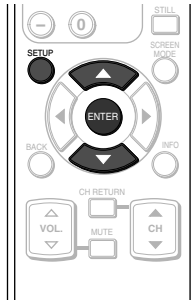

1 Display the setup screen.

- Press **[SETUP]**.
The following setup screen is displayed.



2 Select "CHANNEL" and press **[ENTER]** to confirm.

- Using **[▲/▼]**, select "Channel List".



- Press **[ENTER]**.

3 Select the channel you want to skip.

- Using **[▲/▼]**, select the channel.

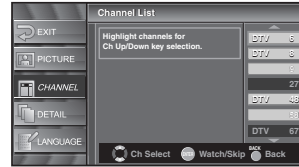

- Press **[ENTER]**, and the highlight on the selected channel disappears, then the channel is set as skip. With **[CH ▲/▼]**, you cannot select the channel set as skip.
- If you want to receive the skipped channel, select your desired channel and press **[ENTER]**.
- If you skip a major channel, you skip the minor channels too.

NOTE:

- The channel with "DTV" indicated on the display is ATSC, otherwise the channel is NTSC.

4 To exit the setup, press **[SETUP]**.

MANUAL REGISTER

You can register the remainder of channels that were not scanned by the Autoscanner function due to the bad reception status at the initial setting.



1 Display the setup screen.

- Press **[SETUP]**.
The following setup screen is displayed.



2 Select "CHANNEL" and press **[ENTER]** to confirm.

- Using **[▲/▼]**, select "Manual Register".

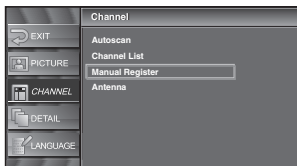

- Press **[ENTER]**.

3 Select the channel you want to add.

- Using **Channel number** buttons, select your desired channel.

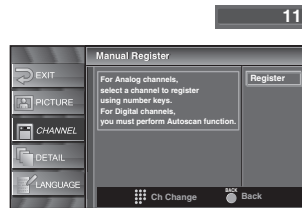

- Select "Register" with **[ENTER]**.

4 To exit the setup, press **[SETUP]**.

NOTES:

- If the setup is completed successfully, "Registered to the channel list." is shown on the screen.
- If "Video1" is being used, set up will not be completed successfully. "Unavailable" will be shown on screen.

ANTENNA CONFIRMATION

You can verify the signal strength of each channel to get a clearer picture.



- If the channel is set to external input, you cannot confirm the antenna situation.

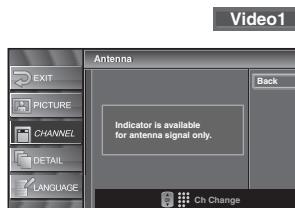

- 3 To exit the setup, press **[SETUP]**.

- 1 Display the setup screen.

- Press **[SETUP]**.
The following setup screen is displayed.



- 2 Select "CHANNEL" and press **[ENTER]** to confirm.

- Using **[▲/▼]**, select "Antenna".

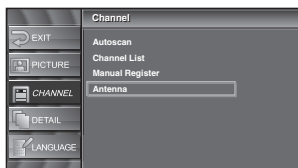

- Press **[ENTER]**.
- Using **Channel number** buttons or **[CH ▲/▼]**, select the channel you want to confirm the antenna situation.

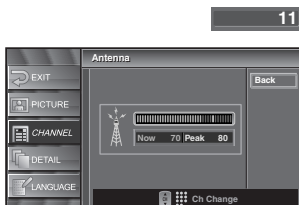

11

LANGUAGE SELECTION

You can choose your on screen language from one of the following English, Spanish or French.

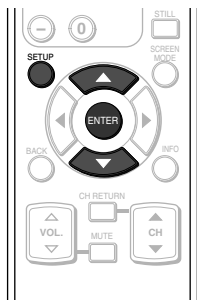

1 Display the setup screen.

- Press **[SETUP]**.
The following setup screen is displayed.



2 Select "LANGUAGE" and press **[ENTER]** to confirm.

- Using **[▲/▼]**, select "English", "Español" or "Français".



- Press **[ENTER]**.

3 To exit the setup, press **[SETUP]**.

CHANNEL SELECTION

You can select the channel by using either [CH ▲/▼] or **Channel number** buttons. How to select the channel in each way is shown below.



1 Using [CH ▲/▼], or **Channel number** buttons and pressing [ENTER].

- Using [CH ▲/▼], change the channel.
- Same operation is available with [CHANNEL ▲/▼] on the top panel of the main unit.
- When you select a channel, press the channel number you want to view with **Channel number** buttons. The selected channel will be displayed.
 - When selecting analog channel 12

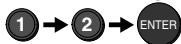

- When selecting digital channel 12-1
Be sure to press [-] before entering the minor-channel number.



- If the channel broadcasts NTSC and ATSC both and you don't press [-], then you will receive the NTSC channel only. The moment you press [-], the lowest memorized digital channel will be displayed.
- When you press [CH RETURN], the previously selected channel will be selected.

NOTE:

- In the DTV broadcasting, one channel sometimes broadcasts multiple programs depending on the air time. In this case, the main channel is called major channel and the minor-channel is called minor channel.

About minor-channel broadcasting:

There may be different programs being broadcast on minor-channels through a single channel from ATSC. You can watch each minor-channel program being broadcast by selecting one of the minor-channels.

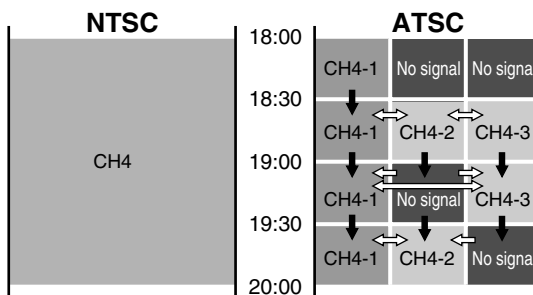

- ➔ : change automatically
- ⇔ : change manually by pressing [CH ▲ / ▼] on your remote control

NOTE:

- "No Signal" will appear on the screen after the minor-channel broadcast is over. You will need to change the channel to continue watching another TV program.

VOLUME ADJUSTMENT

This section describes how to adjust the volume when viewing TV. The Mute function, which is useful when you have a visitor or a phone call, will be also described.

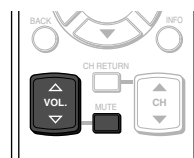

1 Using [VOL. ▲/▼] or [MUTE].

[VOL. ▲/▼]

- You can adjust the audio volume with [VOL. ▲/▼].
- The volume bar is displayed at the bottom of the screen when adjusting the volume.
- Same operation is available with [VOLUME ▲/▼] on the top panel of the main unit.



- The volume bar display will automatically disappear in a few seconds.

[MUTE]

- Press [MUTE] on the remote control to mute the sound.
- To release the Mute status, press [MUTE] again or press [VOL. ▲/▼].



- "Mute" is displayed on the screen for a few seconds.

STILL MODE

You can freeze the image shown on the screen.

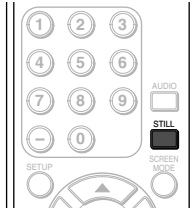

1 Pause the image.

- When you press **[STILL]**, the image shown on the screen is paused.



- The audio is not paused and keeps on reading out.
- If the digital signal is gone or protected, the image will remain paused and the audio will be muted.
- The Still function will be released after 5 minutes.

2 Canceling Still function.

- The Still function will be canceled by pressing any button while Still function is working.

NOTE:

- Press any key except **[POWER]** to cancel still mode.

SWITCHING AUDIO

This section describes how to switch the audio in the analog mode and how to switch the audio language in the digital mode.



TV

1 Switch the audio.

- Every time you press **[AUDIO]**, the audio will be switched as below.



When the broadcasting has all audio...



When the broadcasting has SAP and stereo audio...



When the broadcasting has SAP and monaural audio...



When the broadcasting is having only monaural audio...

MONO

(cannot be switched.)

STEREO : Outputs stereo-audio

SAP : Outputs second audio program

MONO : Outputs mono-audio

DTV

1 Switch the audio language.

- When you press **[AUDIO]**, the currently selected language and the number of received languages will be displayed on the screen.
- Every time you press **[AUDIO]**, the language will be switched.

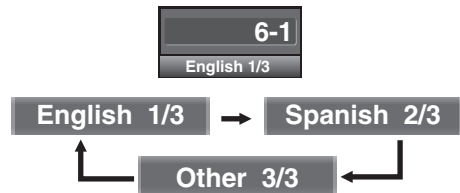

"Other" is indicated when the language is not English, Spanish or French.

* For international stations audio language will still be displayed as English.

- Languages you can switch differ depending on the receiving broadcast.
- The information display will automatically disappear in one minute.

NOTE:

- The **[AUDIO]** feature does not affect external source sound.

SWITCHING EXTERNAL INPUT

When you connect external devices including a DVD player and home audio system, you can easily switch the input mode with the remote control.

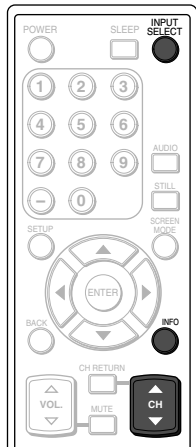

1 Switch the input mode.

- When you press **[INPUT SELECT]** or **[CH ▲/▼]** on the remote control, the input mode will be switched as below.

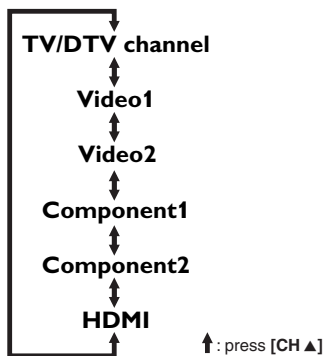

- To use the VIDEO1 or S-VIDEO1 input jack on the TV, select "Video1".
- To use the VIDEO2 or S-VIDEO2 input jack on the TV, select "Video2".
- To use the COMPONENT1 input jacks on the TV, select "Component1".
- To use the COMPONENT2 input jacks on the TV, select "Component2".
- To use the HDMI IN jack on the TV, select "HDMI".

- When you press **[INFO]**, the current external input mode, the type of resolutions for video signal, TV aspect ratio, CC and TV rating will be displayed at the top-right of the screen.

1) When using VIDEO1 or S-VIDEO1 input jack



2) When using VIDEO2 or S-VIDEO2 input jack



3) When using COMPONENT1 input jacks



4) When using COMPONENT2 input jacks



5) When using HDMI IN jack



- The information display will automatically disappear in one minute.

CHANGING THE SCREEN DISPLAY MODE

Each 4 types of display mode can be selected in the screen mode in both 4:3 and 16:9 TV aspect ratio.

You can select your favorite screen mode and enjoy the program.

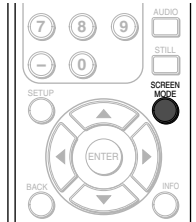

1 Switch the Screen mode.

- Every time you press **[SCREEN MODE]**, the TV aspect ratio will be switched alternately.

2 To press **[SCREEN MODE]** repeatedly until the normal screen displays.

NOTE:

- You may not switch the display mode depending on the program.

When the broadcast is sending 4:3 video signal...

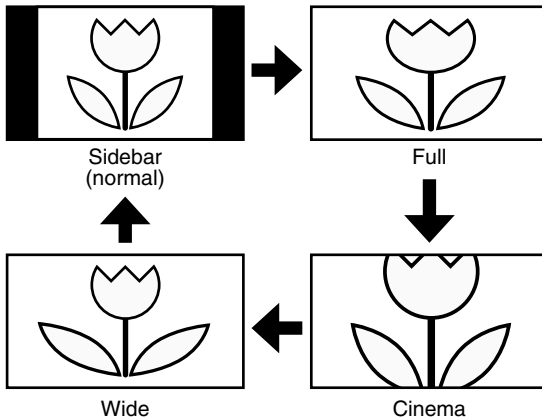

[Sidebar]

Sidebar will display a 4:3 picture at its standard 4:3 size. Sidebars will be displayed on the right and left edges of the screen.

[Full]

Full will display a 4:3 picture at a 16:9 size, with horizontal elongation necessary to fill the screen.

[Cinema]

Cinema will display a 4:3 picture at a 16:9 size, with less horizontal elongation necessary to fill the screen because a little bit of the top and bottom edge of the screen will be cut off.

[Wide]

Wide will display the center of the picture as original size and the either side of the picture will be elongation. The size of the picture will depend on the original signal.

When the broadcast is sending 16:9 video signal...

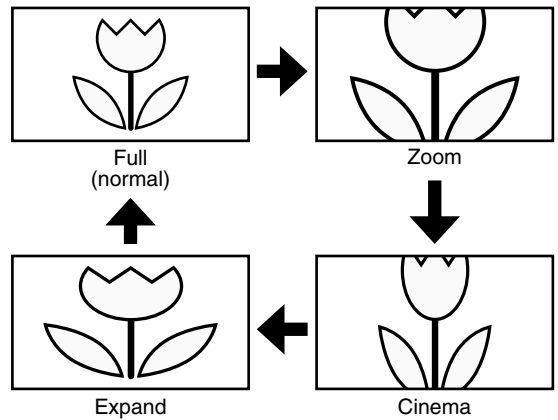

[Full]

A picture will be displayed at 16:9 size as it is.

[Zoom]

Zoom will display a 16:9 picture without changing its horizontal to vertical ratio, at its maximum size.

[Cinema]

Cinema will display a 16:9 picture with vertical elongation.

[Expand]

Expand will display a 16:9 picture with horizontal elongation.

SCREEN INFORMATION

You can display the currently selected channel number or other information such as the audio mode on the screen for checking.

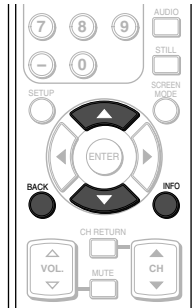

TV

In the analog mode, the currently selected channel number and the audio mode are displayed.

1 Display the channel number and the audio mode.

- Press **[INFO]** on the remote control. The currently selected channel number, the audio mode, the type of resolutions for video signal, TV aspect ratio, CC and TV rating are displayed at the top-right of the screen.



- To clear the display, press **[BACK]** or **[INFO]** again.

DTV

In the digital mode, the detailed information for the currently selected channel such as the Program guide is displayed.

1 Display the detailed information for the channel.

- Press **[INFO]** on the remote control. The currently selected program details are displayed on the screen.
- The following information is displayed.
 - (1) Program title
 - (2) Broadcast station
 - (3) Program guide (max. 4 lines displayed)
 - (4) Channel number
 - (5) Audio language ("Other" is displayed when the audio language cannot be acquired, or the acquired languages are other than English, Spanish or French.)
 - (6) Effective scanning lines and scan mode
 - (7) Program definition
 - (8) Program aspect ratio
 - (9) Program rating
 - (10) CC (Not available if the CC set to "Off")

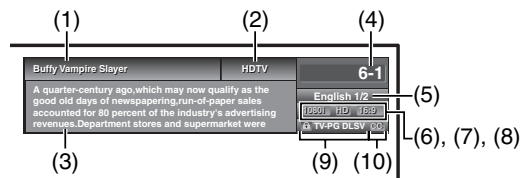

NOTES:

- When the program guide is displayed in more than 5 lines, use **[▲/▼]** and scroll for reading.
- "No description provided" is displayed when the program guide is not provided.

- The following screen is displayed when connecting to external devices:
e.g.) When using VIDEO1 INPUT jack for connection



SLEEP TIMER

The Sleep Timer function will automatically turn off the power of the unit at a preset time.



1 Use Sleep Timer.

- Press **[SLEEP]** on the remote control.
- The setting display for Sleep Timer is shown on the screen.



2 Set the timer.

- You can select 10, 20, 30, 40, 50, 60, 70, 80 and 90 minutes by pressing **[SLEEP]**. (You cannot set the timer per one minute.)
- You can set the timer up to 90 minutes.
- After setting, you can check the remained time per 1 minute by pressing **[SLEEP]**.
- To cancel the sleep timer, press **[SLEEP]** repeatedly until "Sleep Off" is displayed.
- The Sleep Timer setting display will automatically disappear in a few seconds.



NOTE:

- When you disconnect the unit from the AC outlet or when a power failure occurs, the sleep timer setting will be cancelled.

SETUP SCREEN

This section describes the overview of the setup screen displayed when you press **[SETUP]**. For more details, see the reference page for each item.

The setup screen consists of the function setting items below.



To exit settings.



You can adjust the picture quality (Picture Mode, Brightness, Contrast, Color, Tint, Sharpness, Color Temp., and Energy Saving). (Refer to "PICTURE ADJUSTMENT" on page 24.)



You can automatically scan the receivable channels and watch or skip the channel as necessary. (Refer to "AUTOSCAN" on page 13.)



You can change the display format for Closed Caption as well as varied font styles, which displays the dialogue of a TV program or other information across the screen. (Refer to "CLOSED CAPTION" on page 25.)

Also, can set the viewing limitations such as V-Chip of the MPAA rating and the TV rating. (Refer to "V-CHIP" on page 28.)

HDMI Audio if the TV is connected to a digital external device such as DVD player. (Refer to "HDMI AUDIO" on page 31.)



You can change the language (English, Spanish, French) displayed in the setup screen.

(Refer to "LANGUAGE SELECTION" on page 17.)

NOTE:

- To move to the normal screen, press **[SETUP]**.

PICTURE ADJUSTMENT

You can enjoy your favorite picture mode selecting from five picture default settings that will adjust colors to enhance your viewing experience. Also, the brightness, contrast, color, tint, sharpness color temperature, and energy saving setting can be changed.



1 Display the setup screen.

- Press **[SETUP]**.
The following setup screen is displayed.



2 Select "PICTURE", and press **[ENTER]** to confirm.

- Using **[▲/▼]**, select the your desired item and press **[ENTER]** to confirm.

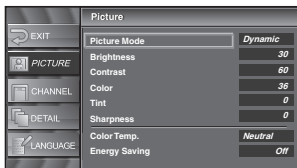

3 Adjust the picture quality.

- Using **[▲/▼]**, select the picture quality item you want to adjust.

Picture Mode

Using **[▲/▼]**, adjust Picture Mode from the selection, then press **[ENTER]**. (Standard, Dynamic, Movie, News and Manual)

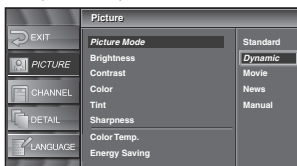

Brightness

Using **[◀ / ▶]**, adjust until the darkest parts of the picture are as bright as you prefer.

- ◀: To decrease brightness
- ▶: To increase brightness



Contrast

Using **[◀ / ▶]**, adjust to increase or decrease contrast.

- ◀: To decrease contrast
- ▶: To increase contrast



Color

Using **[◀ / ▶]**, adjust to be brilliant or pale color.

- ◀: To pale
- ▶: To brilliant



Tint

Using **[◀ / ▶]**, adjust to obtain natural skin tones.

- ◀: To red
- ▶: To green



Sharpness

Using **[◀ / ▶]**, adjust the detail of the picture.

- ◀: To soft
- ▶: To clear



Color Temp.

Using **[▲/▼]**, adjust Color Temperature from the selection, then press **[ENTER]**. (Cool, Neutral and Warm)

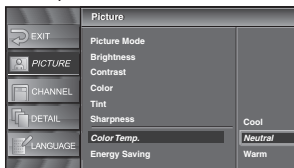

Energy Saving

Using **[◀ / ▶]**, adjust brightness of backlight.

- ◀: To bright
- ▶: To dark



- The adjustment bar for picture quality item is displayed on the screen.

NOTE:

- To move to the normal screen, press **[SETUP]**.

4 To exit the setup, press **[SETUP]**.

CLOSED CAPTION

You can view specially labeled (cc) TV programs, movies, news and prerecorded tapes, etc. with either a dialogue caption or text display added to the program.

You can also change the font size and the font style by selecting options in the “Conventional CC”.

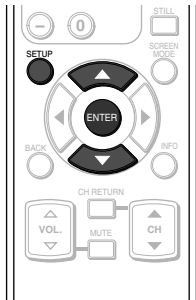

1 Display the setup screen.

- Press **[SETUP]**.
The following setup screen is displayed.



2 Select “DETAIL” and press **[ENTER]** to confirm.

- Using **[▲/▼]**, select “Closed Caption” and press **[ENTER]** to confirm.

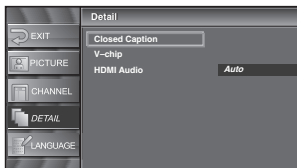

3 Select “Conventional CC” and press **[ENTER]** to confirm.

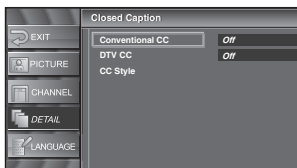

4 Switch the Closed Caption mode.

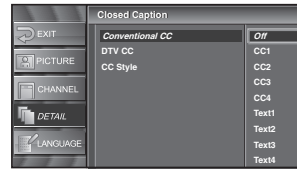

- Using **[▲/▼]**, select the desired closed caption, then press **[ENTER]**.

[Caption Mode]

CC1 and Text1:

are the primary caption and text services. The captioning or text is displayed in the same language as the program’s dialogue (up to 4 lines of script on the screen, where it does not obstruct relevant parts of the picture).

CC3 and Text3:

serve as the preferred data channels. The captioning or text is often a secondary language translation, simplified English or displayed at a slower rate.

CC2, CC4, Text2 and Text4:

are rarely available and broadcasters use them only in special conditions, such as when CC1 and CC3 are not available or Text1 and Text3 are not available.

- There are three display modes according to programs:

Paint-on mode: Displays input characters on the screen immediately.

Pop-on mode : Once characters are stored in memory, they are displayed all at once.

Roll-up mode : Displays the characters continuously by scrolling (max. 4 lines).

5 To exit the setup, press **[SETUP]**.

NOTES:

- If the closed caption is not broadcasted, nothing is displayed.
- The closed caption is not displayed when you use HDMI connection.
- When your TV receives a special effects playback signal (i.e., Search, Slow and Still) from a VCR’s video output channel (CH3 or CH4), the TV may not display the correct caption or text.
- Captions and texts may not match the TV voice exactly.
- Interference may cause the closed caption system not to function properly.
- The caption or text characters will not be displayed while the menu display or functions display is shown.
- If a black box appears on the screen, this means that the TV is set to TEXT mode. To clear screen, select CAPTION “CC1”, “CC2”, “CC3”, “CC4” or “Off”.

DTV CLOSED CAPTION

DTV

Apart from closed captions, DTV has its own closed captions called DTV CC. Use this menu to change the settings for DTV CC.

1 Display the setup screen.

- Press **[SETUP]**.
The following setup screen is displayed.



2 Select "DETAIL" and press **[ENTER]** to confirm.

- Using **[▲/▼]**, select "Closed Caption" and press **[ENTER]** to confirm.



3 Select "DTV CC" and press **[ENTER]** to confirm.

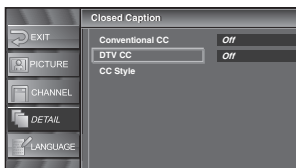

4 Switch the DTV Closed Caption mode.

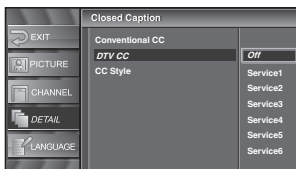

- Using **[▲/▼]**, select the desired DTV Closed Caption, then press **[ENTER]**.

Off:

Select if you do not want DTV CC. This is the default.

Service 1 to Service 6:

Select one of these before changing any other item in the Closed Caption menu. Choose Service 1 under normal circumstances.

5 To exit the setup, press **[SETUP]**.

CLOSED CAPTION STYLE

1 Display the setup screen.

- Press **[SETUP]**.
The following setup screen is displayed.



2 Select "DETAIL" and press **[ENTER]** to confirm.

- Using **[▲/▼]**, select "Closed Caption" and press **[ENTER]** to confirm.

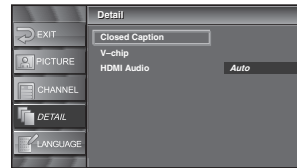

3 Select "CC Style" and press **[ENTER]** to confirm.

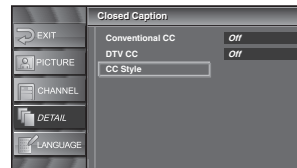

4 Switch the Closed Caption Style.

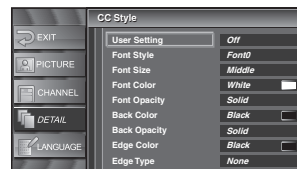

- Using **[▲/▼]**, select the desired Closed Caption Style.

5 Use "User Setting".

- The "User Setting" function lets you change CC style.
- Using **[▲/▼]**, select "User Setting".
- Press **[ENTER]** and set "User Setting" to "On".

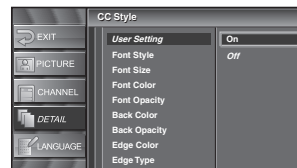

6 Set each item.

- When “User Setting” is set to “On”, you can set the following items.
- CC style set by “User Setting” will be displayed.
- Using [▲/▼], select the item you want to set.
- You can switch the setting for each item with [▲/▼].

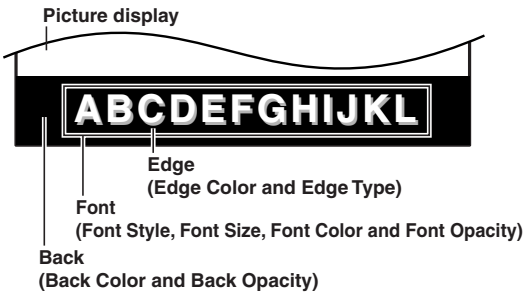

- The setting description for each item is shown below.

[Font Style]

Font style of the displayed caption can be switched as below.

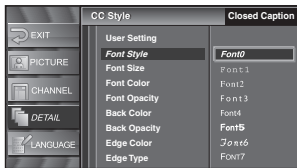

[Font Size]

Font size of the displayed caption can be switched as below.

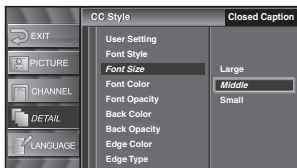

[Font Color]

Font color of the displayed caption can be switched as below.

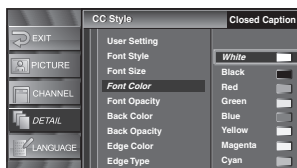

[Font Opacity]

Font opacity of the displayed caption can be switched as below.



[Back Color]

Background color of the displayed caption can be switched as below.

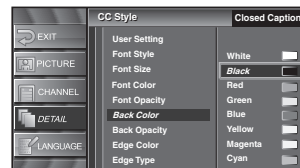

[Back Opacity]

Background opacity of the displayed caption can be switched as below.

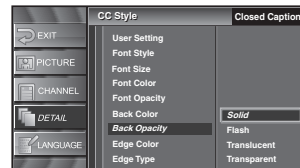

[Edge Color]

Edge color of the displayed caption can be switched as below.

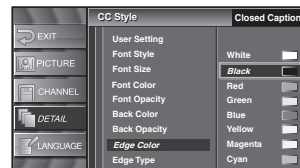

[Edge Type]

Edge type of the displayed caption can be switched as below.

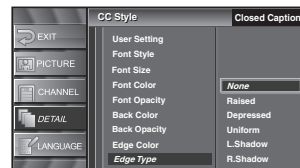

7 To exit the setup, press [SETUP].

V-CHIP

You can set the viewing limitations to prevent your children from watching inappropriate programs including disagreeable expression and description. The viewing limitations set for the program can be released by entering the password.



1 Display the setup screen.

- Press **[SETUP]**.
The following setup screen is displayed.



2 Select "DETAIL" and press **[ENTER]** to confirm.

- Using **[▲/▼]**, select "V-chip".

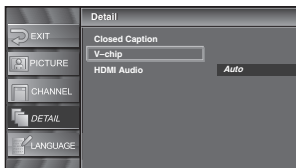

- Press **[ENTER]**.
The password entry screen is displayed.

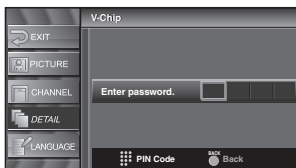

3 Enter the password.

- Use **Channel number** buttons and enter the 4-digit number.



- When you have not set up your password, enter 0000.
- When the password is correct, the following "V-Chip" screen is displayed.

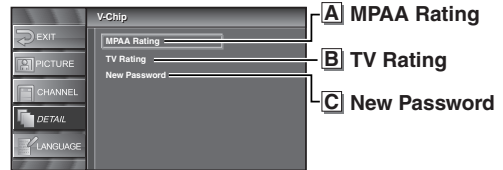

See the following description for setting each item.

A MPAA Rating

4 Display the "MPAA Rating" screen.

- Using **[▲/▼]**, select "MPAA Rating".



- Press **[ENTER]**.

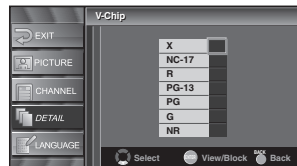

5 Set “MPAA Rating”.

- Using the [▲/▼], select the rating.
- Press [ENTER] and set to “View” or “Block”.

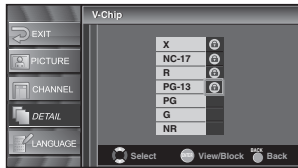

6 To exit the setup, press [SETUP].

<Selection>	<Rating Category Explanations>
X :	Mature audience only
NC-17 :	No one under 17 admitted
R :	Restricted; under 17 requires accompanying parent or adult guardian
PG-13 :	Unsuitable for children under 13
PG :	Parental Guidance suggested
G :	General Audience
NR :	No Rating

NOTES:

- When you select a rating and set it to “Block”, the higher ratings will be blocked automatically. The lower ratings will be available for viewing.
- When you set X to “View”, all ratings turn to “View” automatically.

B TV Rating

4 Display the “TV Rating” screen.

- Using [▲/▼], select “TV Rating”.



- Press [ENTER].

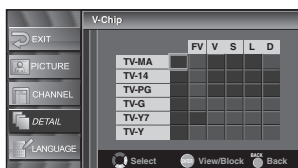

5 Set “TV Rating”.

- Using [▲/▼], select the rating.
- Press [ENTER] and set to “View” or “Block” for the rating without sub categories.

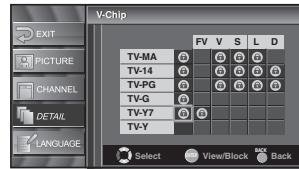

- For the rating with sub categories, press [▲/▼ / ◀ / ▶] and select the rating. Then press [ENTER] and set to “View” or “Block”.

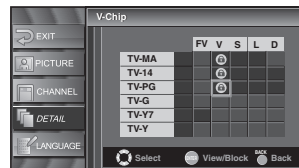

6 To exit the setup, press [SETUP].

<Selection>	<Rating Category Explanations>
TV-MA :	Mature audience only
TV-14 :	Unsuitable for children under 14
TV-PG :	Parental Guidance suggested
TV-G :	General Audience
TV-Y7 :	Appropriate for children seven and older
TV-Y :	Appropriate for all children

<Selection>	<Rating Sub Category Explanations>
FV :	Fantasy Violence
V :	Violence
S :	Sexual Situation
L :	Coarse Language
D :	Suggestive Dialogue

NOTES:

- When you select a rating and set it to “Block”, the higher ratings will be blocked automatically. The lower ratings will be available for viewing.
- When you set TV-MA to “View”, all ratings turn to “View” automatically.

C New Password

4 Display the “New Password” screen.

- Using [**▲▼**], select “New Password”.



- Press [**ENTER**].
-

5 Change the password.

- Use **Channel number** buttons on the remote control and enter the NEW 4-digit password.
- Enter password again in “Confirm password” space.

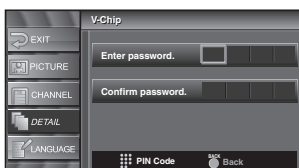

6 To exit the setup, press [**SETUP**].

NOTES:

- Make sure to enter the exact same new password in the “Confirm password.” space as one in the space. If they are different, the space is cleared for reentering.
- Your password will be erased and return to the default (0000) when a power failure occurs or when you turn off the power using a wall switch. If you forget the password, unplug the power cord for 10 seconds to restore the password to 0000.

HDMI AUDIO

Set the method of sound input for HDMI jack.

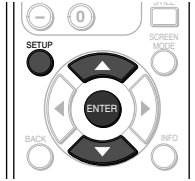

1 Display the setup screen.

- Press **[SETUP]**.
The following setup screen is displayed.



2 Select "DETAIL" and press **[ENTER]** to confirm.

- Using **[▲/▼]**, select "HDMI Audio" and press **[ENTER]** to confirm.

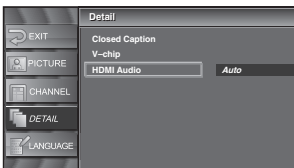

3 Switch the HDMI Audio.

- Using **[▲/▼]**, select the desired HDMI Audio, then press **[ENTER]**.

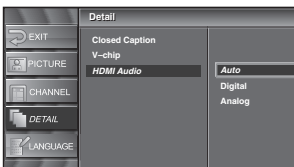

- Select "Auto" if you connected to both digital device with HDMI jack and analog device for audio sources. Digital audio input signal has priority in this setting.
- Select "Digital" if you connected to digital device with HDMI jack for digital audio input signal.
- Select "Analog" if you connected to analog device with analog jacks for analog audio input signal.

4 To exit the setup, press **[SETUP]**.

TROUBLESHOOTING GUIDE

Before calling for service, check the following chart again.

Symptom	Remedy
No power	<ul style="list-style-type: none"> • Be sure the Power cord is connected to outlet. • If a power failure occurs, unplug the power cord for 30 minutes to allow the unit to reset itself.
No picture or sound	<ul style="list-style-type: none"> • Check if the power is on. • Check the outlet connection. • Check the antenna or cable connection to the main unit. • When the outside antenna is used, check the wire condition and connection. • Try to view other channels. It may be the problem on the broadcasting station. • Turn off the power and wait for about 1 minute, then turn it on again.
No color	<ul style="list-style-type: none"> • Check the antenna or cable connection to the main unit. • When the outside antenna is used, check the wire condition and connection. • Try to view other channels. It may be the problem on the broadcasting station. • Adjust the Color in the setup screen.
Sound OK, picture poor	<ul style="list-style-type: none"> • Check the antenna or cable connection to the main unit. • When the outside antenna is used, check the wire condition and connection. • Electric waves may be interfered due to the electric appliances, etc. nearby. • Adjust Contrast and Brightness in the setup screen. • Try to view other channels. It may be the problem on the broadcasting station.
Picture distorted	<ul style="list-style-type: none"> • When the outside antenna is used, check the wire condition and connection. • Try to view other channels. It may be the problem on the broadcasting station.
Weak picture	<ul style="list-style-type: none"> • Check the antenna or cable connection to the main unit. • When the outside antenna is used, check the wire condition and connection. • Adjust Contrast and Brightness in the setup screen. • Try to view other channels. It may be the problem on the broadcasting station.
Lines or streaks in picture	<ul style="list-style-type: none"> • When the outside antenna is used, check the wire condition and connection. • Electric waves may be interfered due to the electric appliances, etc. nearby. • Try to view other channels. It may be the problem on the broadcasting station.
Picture blurred	<ul style="list-style-type: none"> • When the outside antenna is used, check the wire condition and connection. • Try to view other channels. It may be the problem on the broadcasting station.
Ghosts in picture	<ul style="list-style-type: none"> • Check the antenna or cable connection to the main unit. • When the outside antenna is used, check the wire condition and connection. • Electric waves may be interfered due to the electric appliances, etc. nearby. • Try to view other channels. It may be the problem on the broadcasting station.
Bars on screen	<ul style="list-style-type: none"> • When the outside antenna is used, check the wire condition and connection. • Electric waves may be interfered due to the electric appliances, etc. nearby.

Symptom	Remedy
Picture rolls vertically	<ul style="list-style-type: none"> • When the outside antenna is used, check the wire condition and connection. • Electric waves may be interfered due to the electric appliances, etc. nearby. • Try to view other channels. It may be the problem on the broadcasting station.
Different color marks on screen	<ul style="list-style-type: none"> • Move the TV apart from electric appliances nearby. Turn off the power and wait for about 30 minutes, then turn it on again. • Try to view other channels. It may be the problem on the broadcasting station.
Poor reception on some channels	<ul style="list-style-type: none"> • Check the antenna or cable connection to the main unit. • When the outside antenna is used, check the wire condition and connection. • Electric waves may be interfered due to the electric appliances, etc. nearby. • Try to view other channels. It may be the problem on the broadcasting station.
Picture OK, sound poor	<ul style="list-style-type: none"> • Electric waves may be interfered due to the electric appliances, etc. nearby. • Try to view other channels. It may be the problem on the broadcasting station.
No reception of digital signals	<ul style="list-style-type: none"> • Make sure that Autoscanner in setup screen has been completed. It will be required when you setup TV for the first time or when TV is moved to a location where other channels are broadcast. • The selected channel does not exist at that time. There are not always minor-channels being broadcast. • When Autoscanner is interrupted and not completed, some channels will not be received. Make sure to complete Autoscanner in the setup screen.
The entered channel number changes automatically	<ul style="list-style-type: none"> • Many digital channels have alternate channel numbers. TV changes the numbers automatically to the ones signifying the broadcasting stations. These are the numbers used for analog broadcasts.
Remote control doesn't work	<ul style="list-style-type: none"> • Check the antenna or cable connection to the main unit. • Check the battery life of the remote control. • Check if there is an obstacle between the sensor and the remote control. • Test the signal output. If OK, then possible remote sensor trouble. (Refer to "IR SIGNAL CHECK" on page 34.)

Problems on Closed Caption

Misspelled captions are displayed.	<ul style="list-style-type: none"> • Closed captioning production companies may broadcast programs without correcting the misspelling in a live broadcast.
Captions are not entirely displayed, or captions are delayed behind the dialogue.	<ul style="list-style-type: none"> • Captions that are delayed a few seconds behind the actual dialogue are common for live broadcasts. Most captioning production companies can display a dialogue to a maximum of 220 words per minute. If a dialogue exceeds that rate, selective editing is used to insure that the captions remain up-to-date with the current TV screen dialogue.
Captions are displayed as a white box. No caption is displayed in the Closed Caption-supported program.	<ul style="list-style-type: none"> • When electric waves are interfered due to buildings, weather conditions etc., incomplete captions may be displayed. • Broadcasting station may shorten the program to insert the advertisement. The closed caption decoder cannot read the information of the shortened program.
No caption is displayed when playing the videotape containing captions.	<ul style="list-style-type: none"> • The videotape may be illegally copied, or the caption signal may fail to be read while copying.
Black box is displayed in the screen.	<ul style="list-style-type: none"> • "Text" mode is selected for caption. Select "CC1", "CC2", "CC3", "CC4" or "Off".

The LCD panel is manufactured to provide many years of useful life. Occasionally a few non active pixels may appear as a fixed point of blue, green or red. This is not to be considered a defect in the LCD screen.

GLOSSARY

ATSC

Acronym that stands for Advanced Television Systems Committee and the name of the digital broadcasting standards.

Aspect ratio

The width of a TV screen relative to its height. Conventional TVs are 4:3 (in other words, the screen is almost square); widescreen models are 16:9 (the screen is almost twice as wide as its height).

Component video

This is a video signal format that conveys each of three principal colors of light (red, blue and green) through different signal lines. This allows the viewers to experience picture colors as original as it is. There are several signal formats, including Y / Pb / Pr and Y / Cb / Cr.

Dolby Digital

The system developed by Dolby Laboratories to compress digital sound. It offers you sound of stereo (2ch) or multi-channel audio (up to 5.1ch).

HDMI (High-Definition Multimedia Interface)

Interface that supports all uncompressed, digital audio/video formats including set-top box, DVD player or digital television, over a single cable.

High Definition TV (HDTV)

Ultimate digital format that produces high resolution and high picture quality.

LPCM

(Linear Pulse Code Modulation)

LPCM is a format that can have up to 8 channels of audio. It is mainly used in music production. The format samples and captures analog signals and transforms them into digital signals without compressing the sound data.

NTSC

Acronym that stands for National Television Systems Committee and the name of the current analog broadcasting standards.

Password

A stored 4-digit number that you must provide in order to make settings for V-CHIP.

SAP

(Secondary Audio Program)

Second-audio channel delivered separately from main-audio channel. This audio channel is used as an alternate in bilingual broadcasting.

Standard Definition TV (SDTV)

Standard digital format that is similar to the NTSC picture quality.

S-Video

It delivers independently each signal of color(C) and luminance (Y) to TV as video signals, so that higher-quality picture will be gained.

MAINTENANCE

CABINET CLEANING

- Wipe the front panel and other exterior surfaces of the TV with a soft cloth immersed in lukewarm water and wrung dry.
- Never use a solvent or alcohol. Do not spray insecticide liquid near the TV. Such chemicals may cause damage and discoloration to the exposed surfaces.

LCD CLEANING

Wipe the LCD of the TV with a soft cloth. Before cleaning the LCD, disconnect the power cord.

SERVICING

Should your unit become inoperative, do not try to correct the problem by yourself. There are no user serviceable parts inside. Turn off, unplug the power cord and please call our help line mentioned on the front page, to locate an Authorized Service Center.

IR SIGNAL CHECK

If the remote control doesn't work properly, You can test if the remote control sends out the infrared signal with an AM radio or a digital camera (including built-in camera of cellular phone). It will help to define the cause of malfunction.

• With an AM radio:

Tune an AM radio to a station with no broadcasting. Press any button on remote control toward the radio. Sound will be fluttering when you press any button and the radio receives the signal. This means the remote control unit is working.

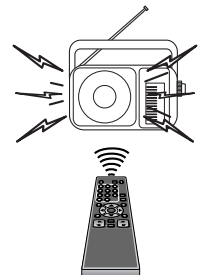

• With a digital camera (including built-in camera of cellular phone):

Direct a digital camera to remote control, press and hold any button on remote control. If infrared light appears through digital camera, the remote control unit is working.



SPECIFICATIONS

GENERAL SPECIFICATIONS

Television system:	ATSC NTSC-M TV Standard
Closed Caption System:	§15.119/FCC (Analog CC) §15.122/FCC (Digital CC)
Channel coverage (ATSC/NTSC)	
VHF:	2 ~ 13
UHF:	14 ~ 69
CATV:	2 ~ 13, A ~ W, W+1 ~ W+94, A-5 ~ A-1, 5A
Tuning System:	Channel frequency synthesized tuning system
Channel access:	Direct access keyboard, Programmable scan, and Up/down
Terminals	
Antenna input:	VHF/UHF/CATV 75 ohm unbalanced (F-type)
S-Video input:	Mini DIN 4-pin jack x 2
Video input:	RCA jack x 2
Audio input:	RCA jack (L/R) x 4
Component Video/Audio input:	One pin jack (Y) / 1Vpp x 2 Two pin jacks (Pb/Pr) / 700mVpp x 4 RCA jack (L/R) x 4
HDMI / Audio input:	HDMI jack RCA jack (L/R) x 2
Coaxial digital audio output:	One pin jack, 500mVpp
Analog Audio output:	RCA jack (L/R) x 2
Stereo Sound System Speaker	

ELECTRICAL SPECIFICATION

Sound output: 5W, 8 ohm x 2

OTHER SPECIFICATIONS

Remote control:	Digital encoded infrared light system
Operating temperature:	5°C to 40°C (41°F to 104°F)
Power requirements:	AC120V, 60Hz
Power consumption (Maximum):	160W
LCD:	32" wide XGA panel (1,366 x 768 pixels)
Dimensions:	<Without stand> H : 23-7/16" (595mm) W : 32-3/16" (818mm) D : 4-9/16" (115mm) <With stand> H : 25-3/8" (644mm) W : 32-3/16" (818mm) D : 10-13/16" (275mm)
Weight:	30.4 lbs. (13.8kg)

- Designs and specifications are subject to change without notice and without our legal obligation.
- If there is a discrepancy between languages, the default language will be English.

FUNAI CORPORATION LIMITED WARRANTY

FUNAI CORP. will repair this product, free of charge in the USA in the event of defect in materials or workmanship as follows:

DURATION:

PARTS: FUNAI CORP. will provide parts to replace defective parts without charge for one (1) year from the date of original retail purchase. Certain parts and LCD image burn-in are excluded from this warranty.

LABOR: FUNAI CORP. will provide the labor without charge for a period of ninety (90) days from the date of original retail purchase.

LIMITS AND EXCLUSIONS:

THIS WARRANTY IS EXTENDED ONLY TO THE ORIGINAL RETAIL PURCHASER. A PURCHASE RECEIPT OR OTHER PROOF OF ORIGINAL RETAIL PURCHASE WILL BE REQUIRED TOGETHER WITH THE PRODUCT TO OBTAIN SERVICE UNDER THIS WARRANTY.

This warranty shall not be extended to any other person or transferee.

This warranty is void and of no effect if any serial numbers on the product are altered, replaced, defaced, missing or if service was attempted by an unauthorized service center. This limited warranty does not apply to any product not purchased and used in the United States.

This warranty only covers failures due to defects in material or workmanship which occurs during normal use. It does not cover damage which occurs in shipment, or failures which are caused by repairs, alterations or product not supplied by FUNAI CORP., or damage which results from accident, misuse, abuse, mishandling, misapplication, alteration, faulty installation, improper maintenance, commercial use such as hotel, rental or office use of this product or damage which results from fire, flood, lightning or other acts of God.

THIS WARRANTY DOES NOT COVER PACKING MATERIALS, ANY ACCESSORIES (EXCEPT REMOTE CONTROL), ANY COSMETIC PARTS, COMPLETE ASSEMBLY PARTS, DEMO OR FLOOR MODELS.

FUNAI CORP. AND ITS REPRESENTATIVES OR AGENTS SHALL IN NO EVENT BE LIABLE FOR ANY GENERAL, INDIRECT OR CONSEQUENTIAL DAMAGES ARISING OUT OF OR OCCASIONED BY THE USE OF OR THE INABILITY TO USE THIS PRODUCT. THIS WARRANTY IS MADE IN LIEU OF ALL OTHER WARRANTIES, EXPRESS OR IMPLIED, AND OF ALL OTHER LIABILITIES ON THE PART OF FUNAI, ALL OTHER WARRANTIES INCLUDING THE WARRANTY OF MERCHANTABILITY AND FITNESS FOR A PARTICULAR PURPOSE, ARE HEREBY DISCLAIMED BY FUNAI AND ITS REPRESENTATIVES IN THE UNITED STATES.

ALL WARRANTY INSPECTIONS AND REPAIRS MUST BE PERFORMED BY AN AUTHORIZED SERVICE CENTER. THIS WARRANTY IS ONLY VALID WHEN THE UNIT IS CARRIED-IN TO AN AUTHORIZED SERVICE CENTER.

THE PRODUCT MUST BE ACCOMPANIED BY A COPY OF THE ORIGINAL RETAIL PURCHASE RECEIPT. IF NO PROOF OF PURCHASE IS ATTACHED, THE WARRANTY WILL NOT BE HONORED AND REPAIRS COSTS WILL BE CHARGED.

IMPORTANT:

THIS LIMITED WARRANTY GIVES YOU SPECIFIC LEGAL RIGHTS. YOU MAY HAVE OTHER RIGHTS THAT VARY FROM STATE TO STATE. IF, AT ANY TIME DURING THE WARRANTY PERIOD, YOU ARE UNABLE TO OBTAIN SATISFACTION WITH THE REPAIR OF THIS PRODUCT, PLEASE CONTACT FUNAI CORP.

ATTENTION:

FUNAI CORP. RESERVES THE RIGHT TO MODIFY ANY DESIGN OF THIS PRODUCT WITHOUT PRIOR NOTICE.

WARRANTY STATEMENT REGARDING NON AUTHORIZED REPAIRS:

To obtain warranty service, you must take the product, or deliver the product freight prepaid, in either its original packaging or packaging affording an equal degree of protection, to any AUTHORIZED SERVICE CENTER. FUNAI CORP. will not reimburse you for any service done by unauthorized service providers without prior written approval.

To locate your nearest AUTHORIZED SERVICE CENTER or for general service inquiries, please contact us at :

FUNAI CORPORATION
Customer Service

Tel :1-800-605-8453

<http://www.Symphonic.us>

19900 Van Ness Avenue, Torrance, CA 90501

Free Manuals Download Website

<http://myh66.com>

<http://usermanuals.us>

<http://www.somanuals.com>

<http://www.4manuals.cc>

<http://www.manual-lib.com>

<http://www.404manual.com>

<http://www.luxmanual.com>

<http://aubethermostatmanual.com>

Golf course search by state

<http://golfingnear.com>

Email search by domain

<http://emailbydomain.com>

Auto manuals search

<http://auto.somanuals.com>

TV manuals search

<http://tv.somanuals.com>