



# OPERATING INSTRUCTIONS



## ST-4108

- ST-4108F/R
  - ST-4108C
- ASW-4108

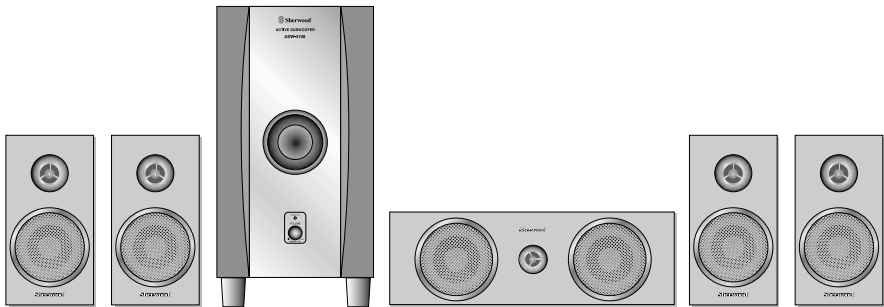

HOME THEATER SPEAKER SYSTEM

# Introduction

## UNPACKING AND INSTALLATION

### **Congratulations on Your Purchase!**

Your new speaker-system is designed to deliver maximum enjoyment and years of trouble free service. Please take a few moments to read this manual thoroughly. It will explain the features and operation of your unit and help ensure a trouble free installation.

Please unpack your unit carefully. We recommend that you save the carton and packing material. they will be helpful if you ever need to move your unit and may be required if you ever need to return it for service. Your unit is designed to be placed in an upright position and it is important to allow at least four inches of space behind your unit for adequate ventilation and cabling convenience.

To avoid interference with the TV picture, place this unit apart from the TV set.

To avoid damage, never place the unit near radiators, in front of heating vents, in direct sunlight, or in excessively humid or dusty locations. Connect your complementary components as illustrated in the following section.

## READ THIS BEFORE OPERATING YOUR UNIT

FOR U.S.A. AND CANADA .....120V

### FOR YOUR SAFETY

Units shipped to the U.S.A. and Canada are designed for operation in 120V AC only.

Observe all, safety precaution with use of a polarized AC plug.  
However, some products may be supplied with a nonpolarized plug.

**CAUTION :** To prevent electric shock, match wide blade of plug to wide slot, fully insert.

**ATTENTION :** Pour eviter les choc electriques, introduire la lame la plug large de la borne correspondante de la prise et poussez jusqu'au fond.



This symbol is intended to alert the user to the presence of uninsulated "dangerous voltage" within the product's enclosure that may be of sufficient magnitude to constitute a risk of electric shock to persons.



This symbol is intended to alert the user to the presence of important operating and maintenance (servicing) instructions in the literature accompanying the appliance.

### **WARNING**

To reduce the risk of fire or electric shock, do not expose this appliance to rain or moisture.

**Caution: Do not block ventilation openings and fan.**

# Rear Panel Controls

A S W-4108

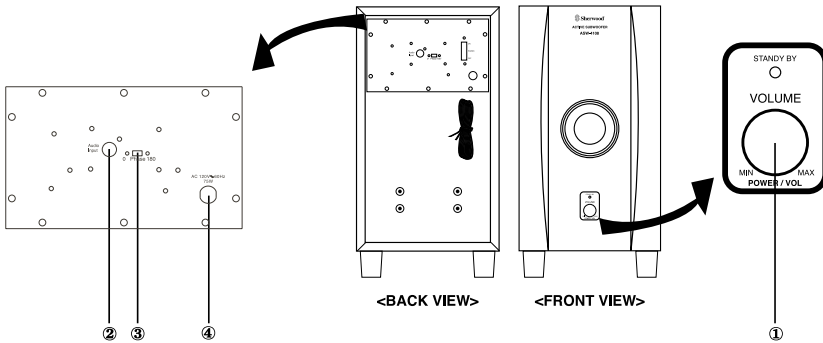

## POWER/VOLUME KNOB

- Turn this knob to turn the power on, then this unit enters the operating mode. The color of LED turns green.
- To turn the power off, press this switch again, then the power is cut off and this unit enters the power off mode.

## VOLUME CONTROL

Use this knob to adjust the volume level of the subwoofer

- Increasing the volume level of the subwoofer excessively may impair the sound quality or damage the unit.  
For safe operation, set this knob to center position in general use.

## Low level Input

Please connect low level input to Subwoofer input of receiver or amplifier.

## Control of Phase

According to phase, control it from 0 to 180. If it does not match, low sound range would be decreased.

## AC INPUT CORD

AC 120V/60Hz. Please check the voltage of yours. Plug this cord into a wall AC outlet.

S T-4108F/R

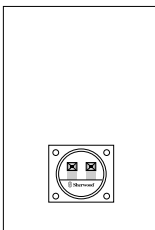

<BACK VIEW>

S T-4108C

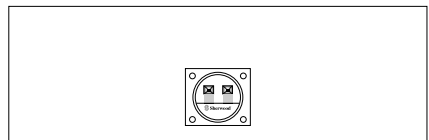

<BACK VIEW>

# System Connections

- This ST-4108 is designed to use together with Sherwood's products.(amplifier/DVD receiver/etc) Doing so will allow you to operate easily and conveniently.  
In case of connecting other amplifier or receiver to this unit, contact your dealer or our service organization.
- For proper connections, refer to the operating instructions of the component connected.

## Notes :

- Do not connect this unit to the wall AC outlet when plugging and unplugging connection cords.
- Be sure to connect the RCA cord to Audio Input jack of active subwoofer when making connections.

- Never short circuit the + and - speaker cords.
- Be sure to connect speakers firmly and correctly according to the channel (left and right) and the polarity (+ and -).
- Be sure to use the main speakers with the impedance of over 6 .
- When this unit is placed next to the record player, etc., the howling noise may be heard. In this case, place this unit apart from the record player, etc.
- Because the low frequencies produced by this subwoofer are non-directional, the placement of this unit is not critical. Place this unit by a wall or corner of the room, etc. as desired.

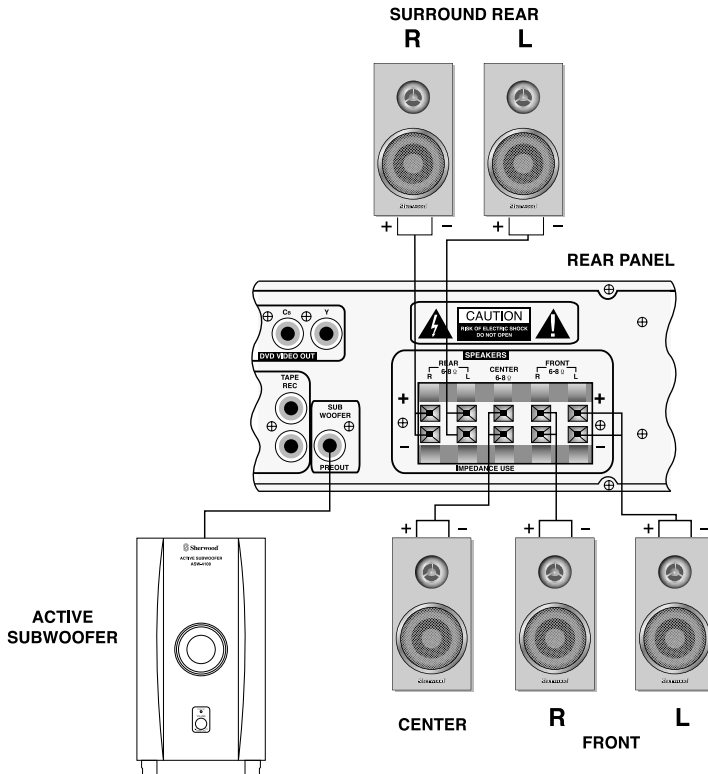

# Troubleshooting Guide

If this unit does not perform as expected, consult the table below to see if the problem can be corrected before seeking help from your dealer or our service organization.

PROBLEM	POSSIBLE CAUSE	REMEDY
No Power	<ul style="list-style-type: none"> <li>· The AC input cord is disconnected.</li> <li>· The POWER switch on the rear panel is not pressed.</li> </ul>	<ul style="list-style-type: none"> <li>· Connect the cord securely.</li> <li>· Turn the POWER knob to ON.</li> </ul>
No sound	<ul style="list-style-type: none"> <li>· Incorrect connection between the components.</li> <li>· Incorrect operation of the component connected.</li> </ul>	<ul style="list-style-type: none"> <li>· Make connections correctly.</li> <li>· Operate the component correctly.</li> </ul>
Distorted sound	<ul style="list-style-type: none"> <li>· The unit runs at excessively high volume level.</li> </ul>	<ul style="list-style-type: none"> <li>· Decrease the volume level.</li> </ul>
Less bass and poor imaging	<ul style="list-style-type: none"> <li>· The PHASE switch is set to the opposite position.</li> </ul>	<ul style="list-style-type: none"> <li>· Set the PHASE switch correctly.</li> </ul>

## Specifications

### ASW-4108

• Frequency Response	45~300Hz
• Power, Impedence 4 Ω	75 W
• Sound Pressure Level	80dB/W/m
• Power Supply	120V/60Hz
• Power Consumption	75W

### ST-4108F/R

• RMS Power	35W
• Max Power	70W
• Impedence	6 Ω
• Power Pressure Level	86dB/W/m

### ST-4108C

• RMS Power	35W
• Max Power	70W
• Impedence	6 Ω
• Power Pressure Level	86dB/W/m

Note : Specifications are subject to change without notice.

## Free Manuals Download Website

<http://myh66.com>

<http://usermanuals.us>

<http://www.somanuals.com>

<http://www.4manuals.cc>

<http://www.manual-lib.com>

<http://www.404manual.com>

<http://www.luxmanual.com>

<http://aubethermostatmanual.com>

Golf course search by state

<http://golfingnear.com>

Email search by domain

<http://emailbydomain.com>

Auto manuals search

<http://auto.somanuals.com>

TV manuals search

<http://tv.somanuals.com>