

Compact Disc Player

Operating Instructions
CDP-CE500



WARNING

To reduce the risk of fire or electric shock, do not expose this apparatus to rain or moisture.

Do not install the appliance in a confined space, such as a bookcase or built-in cabinet.

To reduce the risk of fire, do not cover the ventilation opening of the apparatus with newspapers, tablecloths, curtains, etc. Do not place the naked flame sources such as lighted candles on the apparatus.

To reduce the risk of fire or electric shock, do not expose this apparatus to dripping or splashing, and do not place objects filled with liquids, such as vases, on the apparatus.

Do not expose batteries or apparatus with battery-installed to excessive heat such as sunshine, fire or the like.

CAUTION

The use of optical instruments with this product will increase eye hazard.

- The unit is not disconnected from the mains as long as it is connected to the AC outlet, even if the unit itself has been turned off.
- As the main plug is used to disconnect the unit from the mains, connect the unit to an easily accessible AC outlet. Should you notice an abnormality in the unit, disconnect the main plug from the AC outlet immediately.



This symbol is intended to alert the user to the presence of uninsulated "dangerous voltage" within the product's enclosure that may be of sufficient magnitude to constitute a risk of electric shock to persons.



This symbol is intended to alert the user to the presence of important operating and maintenance (servicing) instructions in the literature accompanying the appliance.



Disposal of Old Electrical & Electronic Equipment (Applicable in the European Union and other European countries with separate collection systems)

Owner's Record

The model and serial numbers are located at the rear exterior of the control unit. Record the serial number in the space provided below. Refer to them whenever you call upon your Sony dealer regarding this product.

Model No. CDP-CE500

Serial No. _____

The following FCC statement applies only to the version of this model manufactured for sale in the U.S.A. Other versions may not comply with FCC technical regulations.

NOTE:

This equipment has been tested and found to comply with the limits for a Class B digital device, pursuant to Part 15 of the FCC Rules. These limits are designed to provide reasonable protection against harmful interference in a residential installation. This equipment generates, uses, and can radiate radio frequency energy and, if not installed and used in accordance with the instructions, may cause harmful interference to radio communications. However, there is no guarantee that interference will not occur in a particular installation. If this equipment does

cause harmful interference to radio or television reception, which can be determined by turning the equipment off and on, the user is encouraged to try to correct the interference by one or more of the following measures:

- Reorient or relocate the receiving antenna (aerial).
- Increase the separation between the equipment and receiver.
- Connect the equipment into an outlet on a circuit different from that to which the receiver is connected.
- Consult the dealer or an experienced radio/TV technician for help.

CAUTION

You are cautioned that any changes or modifications not expressly approved in this manual could void your authority to operate this equipment.

Important Safety Instructions

- 1) Read these instructions.
- 2) Keep these instructions.
- 3) Heed all warnings.
- 4) Follow all instructions.
- 5) Do not use this apparatus near water.
- 6) Clean only with dry cloth.
- 7) Do not block any ventilation openings. Install in accordance with the manufacturer's instructions.
- 8) Do not install near any heat sources such as radiators, heat registers, stoves, or other apparatus (including amplifiers) that produce heat.
- 9) Do not defeat the safety purpose of the polarized or grounding-type plug. A polarized plug has two blades with one wider than the other. A grounding type plug has two blades and a third grounding prong. The wide blade or the third prong are provided for your safety. If the provided

plug does not fit into your outlet, consult an electrician for replacement of the obsolete outlet.

- 10) Protect the power cord from being walked on or pinched particularly at plugs, convenience receptacles, and the point where they exit from the apparatus.
- 11) Only use attachments/ accessories specified by the manufacturer.
- 12) Use only with the cart, stand, tripod, bracket, or table specified by the manufacturer, or sold with the apparatus. When a cart is used, use caution when moving the cart/ apparatus combination to avoid injury from tip-over.



- 13) Unplug this apparatus during lightning storms or when unused for long periods of time.
- 14) Refer all servicing to qualified service personnel. Servicing is required when the apparatus has been damaged in any way, such as power-supply cord or plug is damaged, liquid has been spilled or objects have fallen into the apparatus, the apparatus has been exposed to rain or moisture, does not operate normally, or has been dropped.

Note on DualDiscs

A DualDisc is a two-sided disc which combines DVD recorded material on one side with digital audio material on the other side. However, since the audio material side does not conform to the Compact Disc (CD) standard, playback on this product is not guaranteed.

Music discs encoded with copyright protection technologies

This product is designed to play discs that conform to the Compact Disc (CD) standard. Please be aware that there are some discs that do not conform to the CD standard and may not be playable by this product.

Note on copyright-protected content

Transferred music is limited to private use only. Use of the music beyond this limit requires permission of the copyright holders.

License and Trademark Notice

- MPEG Layer-3 audio coding technology and patents licensed from Fraunhofer IIS and Thomson.
- Windows Media is a registered trademark of Microsoft Corporation in the United States and/or other countries.

About These Operating Instructions

- The instructions in these Operating Instructions describe the controls on the remote. You can also use the controls on the player if they have the same or similar names as those on the remote.
- In these Operating Instructions, “disc” is used as a general reference for CDs or MP3 discs unless otherwise specified by the text or illustrations.

Table of Contents

WARNING	2
About These Operating Instructions	3

Getting Started

Parts and Controls	5
Front panel	5
Display	6
Rear panel.....	7
Remote	8
Connecting the Player	9

Playback

Playing a CD/MP3 Disc	10
Replacing discs while playing a disc	11
Enjoying Music Using a USB Device.....	12
Playing a file on a USB device	12
Transferring music from a disc to a USB device	13
Erasing audio files or folders from the USB device	15
Enjoying Music in Various Play Modes	16
Selecting tracks/files to be played.....	16
Playing tracks/files in random order	17
Creating your own program	17
Playing tracks/files repeatedly	19

Additional Information

Precautions	20
Notes on Discs.....	21
Troubleshooting	21
Specifications	24

Parts and Controls

For more information, refer to the pages indicated in parentheses.

Front panel

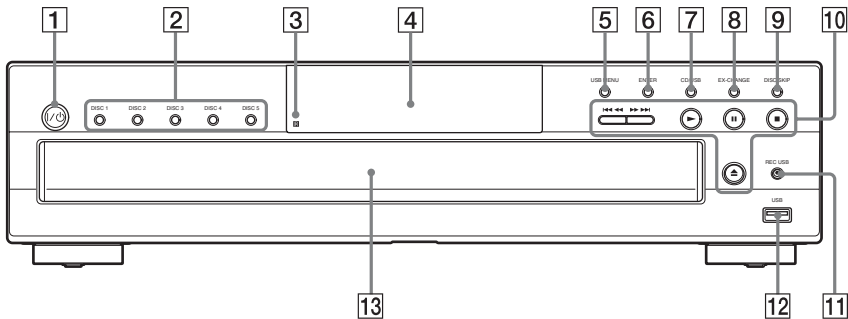

- | | |
|---|--|
| <p>1 I/O (on/standby)
Turns on the player, or sets it to standby mode.</p> <p>2 DISC 1-5
Selects the disc directly.</p> <p>3 (remote sensor)</p> <p>4 Display</p> <p>5 USB MENU
Enters the option menu for a USB device.</p> <p>6 ENTER
Enters settings.</p> <p>7 CD/USB (pages 10, 12, 16)
Selects CD or USB mode.</p> <p>8 EX-CHANGE (page 11)
Replaces discs while playing a disc.</p> | <p>9 DISC SKIP
Selects the disc.</p> <p>10 Playback operation buttons
◀◀/▶▶ (fast reverse/fast forward)
◀◀/▶▶ (previous/next)
▶ (play)
 (pause)
■ (stop)
▲ (open/close)</p> <p>11 REC USB (page 13)
Transfers music from a disc to a USB device.</p> <p>12 USB port (page 12)
Used for connecting a USB device.</p> <p>13 Disc tray (page 10)</p> |
|---|--|

Display

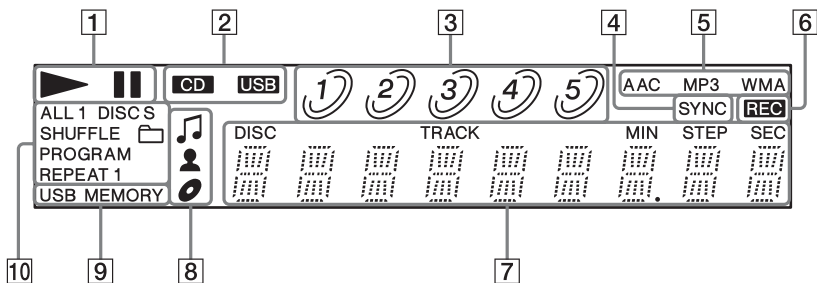

- 1** Displays the player's playing status.
- 2** Displays the device mode (CD or USB) (pages 10, 12).
- 3** Displays the disc number (pages 10, 16).
- 4** Lights up when using CD SYNC (page 13).
- 5** Displays the file format of an MP3 disc or a USB device (pages 10, 12).
- 6** Lights up when transferring music from a disc to a USB device (page 13).
- 7** Displays track/file information such as track number, time information, etc.
While playing an MP3 disc or USB device, also displays the song title, artist name, and album title, when available.
- 8** Lights up when displaying the song title (🎵), artist name (👤), or album title (📀).
- 9** Lights up when a USB device is connected (page 12).
- 10** Displays the player's playback mode (page 16).

Notes on the disc number indications

- The red circle around a disc number indicates the disc is ready to be played.
- When all the tracks on a disc have been played, the semicircle around the disc number disappears.
- When a disc compartment is recognized as empty, the disc number disappears.

Notes on the display information

- Characters that cannot be displayed appear as underscores.
- The following are not displayed:
 - total playing time for an MP3 disc/USB device
 - remaining playing time for a file
- The following are not displayed correctly:
 - elapsed playing time of an MP3 file encoded at a VBR (variable bit rate)
 - folder and file names that do not follow either ISO 9660 Level 1, Level 2, or the Joliet extension format
- The following are displayed:
 - remaining playing time for a track
 - ID3 tag information for MP3 files when ID3 version 1 or version 2 tags are used (ID3 version 2 tag information has priority when both ID3 version 1 and version 2 tags are used in a single MP3 file)
 - up to 15 characters of an ID3 tag, WMA, or AAC tag information using uppercase letters (A to Z), numbers (0 to 9), and symbols (\$ % ' " () * + , - . / < = > @ [\] _ ` { | } ! ? ^)

Rear panel

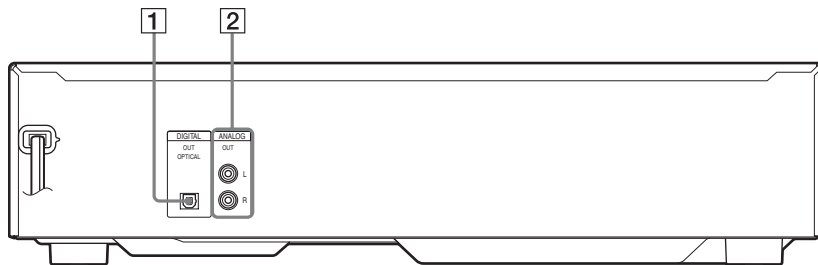

- 1 DIGITAL OUT OPTICAL jack (page 9)
- 2 ANALOG OUT (L/R) jack (page 9)

Remote

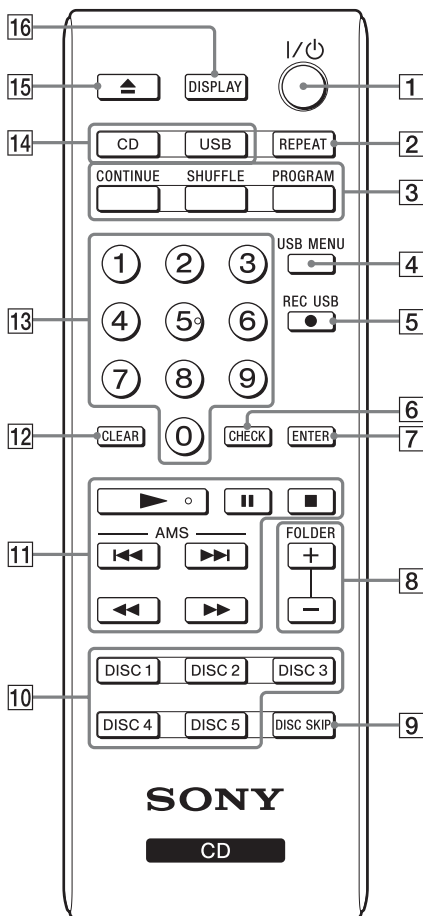

Number 5 and ► buttons have a tactile dot. Use the tactile dot as a reference when operating the remote.

- 1 I/⏻ (on/standby) (pages 10, 12)**
Turns on the player, or sets it to standby mode.
- 2 REPEAT (page 19)**
- 3 CONTINUE (page 16)**
Resumes normal playback (continuous playback) from Shuffle Play or Program Play modes.
- SHUFFLE (page 17)**
- PROGRAM (page 17)**
- 4 USB MENU (page 12)**
Selects the memory to use or audio file/folder to erase.
- 5 ● REC USB (page 13)**
Transfers music from a disc to a USB device.
- 6 CHECK (page 17)**
Checks the programmed order.
- 7 ENTER (pages 12, 17)**
Enters the selected setting or item.
- 8 FOLDER +/- (pages 10, 12, 16)**
Selects a folder when playing an MP3 disc or USB device.
- 9 DISC SKIP (pages 10, 16)**
Selects the disc.
- 10 DISC 1-5 (pages 10, 16)**
Selects a disc directly.
- 11 Playback operation buttons (pages 10, 12, 16)**
 - (play)
 - ⏸ (pause)
 - (stop)
 - AMS ◀◀/▶▶ (previous/next) (AMS: Automatic Music Sensor)
 - ◀◀/▶▶ (fast reverse/fast forward)
- 12 CLEAR (page 17)**
Deletes a programmed track/file number.
- 13 Number buttons (pages 10, 12, 17)**
Enters the track/file numbers, etc. Press ENTER after entering the numbers.
- 14 CD (pages 10, 16)**
USB (pages 12, 16)
Selects CD or USB mode.
- 15 ▲ (open/close) (pages 10, 13)**
- 16 DISPLAY**
Shows the following information when pressed repeatedly:
 - For a CD**
playing time of the track → remaining time of the track → remaining time of the disc
 - For an MP3 disc/USB device**
playing time of the file → song title (🎵)* → artist name (👤)* → album title (🎵)*

* When a file lacks these ID3 tags, the file name, "NO ARTIST," and the folder name are displayed instead.

To insert the batteries

Insert two R6 (size AA) batteries (supplied) by matching the ⊕ and ⊖ ends on the batteries to the markings inside the compartment.

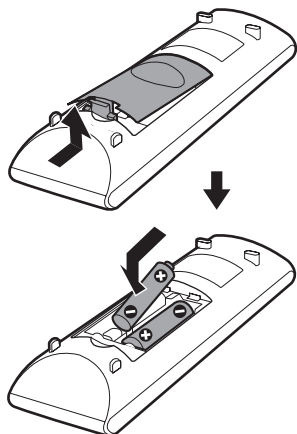

Note

- Do not leave the remote in an extremely hot or humid place.
- Do not use a new battery with an old one.
- Do not drop any foreign object into the remote casing, particularly when replacing the batteries.
- If you do not intend to use the remote for an extended period of time, remove the batteries to avoid possible damage from battery leakage and corrosion.

Connecting the Player

Connections

Be sure to turn off the power of each component before making the connections.

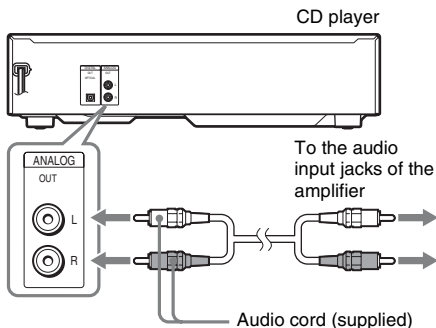

To make digital connections

If you have a digital component such as a digital amplifier, D/A converter, DAT, or MD, connect the component via the DIGITAL OUT OPTICAL jack using a digital optical cord (not supplied).

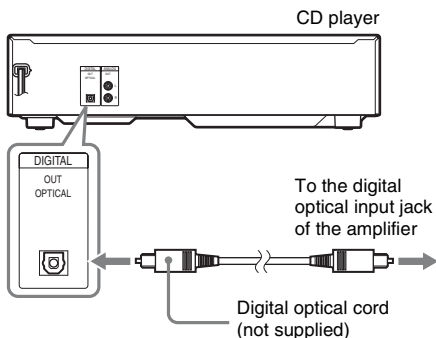

Playback

Playing a CD/MP3 Disc

1 Press **I/⏏**.

2 Press **CD**.

For operation via the player, press CD/USB repeatedly to select the CD mode.

3 Press **▲**, and place a disc on the disc tray.

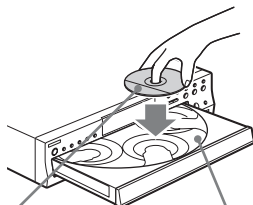

With the label side up

Disc number

4 To load other discs, press **DISC SKIP** repeatedly and place the discs in the order you want to play them.

Each time you press the button, the disc tray turns and you can place a disc in an empty disc compartment. The player plays the disc in front of you first.

5 Press **▲** to close the disc tray.

6 Press **▶**.

Playback starts.

Other operations

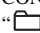
To	Press
Pause playback	II . To resume playback, press the button again.
Stop playback	■ .
Select a folder on an MP3 disc	CONTINUE repeatedly to display “  ,” and then FOLDER +/- repeatedly.
Select a track/file	◀◀/▶▶ . To select a track/file directly, press the number button(s), and then press ENTER .
Find a point in a track/file	Hold down ◀◀/▶▶ during playback, and release the button at the desired point.
Change the playback mode	SHUFFLE (page 17), PROGRAM (page 17), REPEAT (page 19), or CONTINUE (page 16). For details, see the pages in parentheses.
Select a disc	DISC 1-5 (or DISC SKIP repeatedly).
Go to the next disc	DISC SKIP .
Switch to the CD function from the USB function	DISC 1-5 .
Exchange other discs while playing	EX-CHANGE on the player. For details, see “Replacing discs while playing a disc” (page 11).
Eject discs	▲ .

Auto standby

The player enters standby mode automatically when playback is paused or stopped without any operation for more than about 30 minutes.

“**AUTO STBY**” flashes on the display for 2 minutes before the player enters standby mode.

Notes on playing MP3 discs

- Do not save other types of files or unnecessary folders on a disc that has MP3 files.
- Folders that have no MP3 files are skipped.
- MP3 files are played back in the order that they are recorded onto the disc.
- The player can only play MP3 files that have a file extension of “.mp3.”
- Even when a file name has the “.mp3” file extension, if the actual file format differs, playing this file may generate a loud noise which could damage the speaker system and the player may malfunction.
- The maximum number of recognizable:
 - folders is 255 (including the root folder).
 - MP3 files is 512.
 - folder levels (the tree structure of files) is 8.
- Compatibility with all MP3 encoding/writing software, recording devices, and recording media cannot be guaranteed. Incompatible MP3 discs may produce noise or interrupted audio or may not play at all.

Notes on playing CD-Rs/CD-RWs

- A disc of low recording quality, a disc that has scratches or is dirty, or a disc recorded with an incompatible recording device cannot be played on this player.
- A disc which is finalized incorrectly may not be playable on this player.

Notes on playing multisession discs

- If the first session on the disc is a CD-DA session, the other sessions on the disc cannot be recognized regardless of the session format; only CD-DA tracks in the first session can be played back.
- If the session format for the first session is CD-ROM and the following sessions are recorded in the same format, the player will continue to play MP3 files across multiple sessions until the player encounters another session recorded in a different format.

Replacing discs while playing a disc

You can open the disc tray while playing a disc so that you can check what discs are to be played next and replace discs without interrupting playback of the current disc.

1 Press EX-CHANGE on the player.

The disc tray opens and two disc compartments appear. Even if the player is playing a disc, it does not stop playback.

2 Replace discs in the compartments with different ones.

The player plays the disc on the left side compartment after the current disc, and then the one on the right side compartment.

3 Press DISC SKIP.

The disc tray turns and other two disc compartments appear.

4 Replace discs in the compartments with different ones.

5 Press EX-CHANGE on the player.

The disc tray closes.

Note

- Do not push the disc tray to close it in Step 5, as you may damage the player.

While the disc tray is open by pressing EX-CHANGE on the player

- In ALL DISCS SHUFFLE mode (page 17), tracks/files are reshuffled on the current disc.
- In Program Play mode (page 17), the program is erased and the player returns to normal play mode.
- If the playback of the current disc ends, the player stops playing. However, in Repeat All mode (page 19), the current disc starts playing again.

Enjoying Music Using a USB Device

You can play music on a USB device, or transfer music from a disc to a USB device. Also, you can erase audio files/folders on a USB device.

Note

- This player supports only USB flash memory devices that meet the following requirements:
 - The device is a Sony Mass Storage Class Device complying with Universal Serial Bus Specification Revision 1.1 or later.
 - The file system is FAT16/32.
- Some USB flash memory devices are not compatible with this player.

Playing a file on a USB device

You can listen to music stored on a USB device. The audio formats that can be played back on this player are MP3/WMA/AAC.

Note

- The file formats that this player can play are as follows:
 - MP3: file extension “.mp3”
 - WMA: file extension “.wma”
 - AAC: file extension “.m4a,” “.mp4,” or “.3gp”
- Note that even when file names have the above file extensions, if the actual file formats differ, playing these files may generate a loud noise which could damage the speaker system and the player may malfunction.
- Files with DRM (Digital Rights Management) copyright protection cannot be played back on this player.
- Files downloaded from an online music store may not be playable on this player.

1 Press I/⏏.

2 Press USB.

For operation via the player, press CD/USB repeatedly to select the USB mode.

3 Connect a USB device to the USB port.

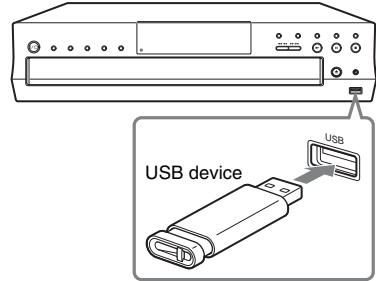

When the USB device is connected, the display changes as follows:
 “READING” → Volume label*
 * Only when the volume label exists on the connected USB device.

4 Press ▶.

Playback starts.

Notes on connecting a USB device

- When a USB cable connection is necessary, connect with the USB cable supplied with the USB device. See the operating instructions supplied with the USB device for details on the operation method.
- It may take about 10 seconds before “READING” appears depending on the type of USB device connected.

Other operations

To	Press
Pause playback	⏏. To resume playback, press the button again.
Stop playback	■ twice. When you press ■ once, playback pauses; to resume playback, press ▶.
Select a folder	CONTINUE repeatedly to display “,” and then FOLDER +/- repeatedly.
Select a file	⏏/▶. To select a file directly, press the number button(s), and then press ENTER.
Find a point in a file	Hold down ◀/▶ during playback, and release the button at the desired point.
Change the playback mode	SHUFFLE (page 17), PROGRAM (page 17), REPEAT (page 19), or CONTINUE (page 16). For details, see the pages in parentheses.

Notes on resume playback of a USB device

- When playing a VBR MP3 file, the player may resume playback from a different point.
- While paused, if
 - you change to CD mode, and then return to USB mode, or
 - the player enters standby mode,
 the action when resuming playback differs depending on the playback mode as follows:
 While in normal playback or Shuffle Play mode
 - The player resumes playback from the beginning of the paused track, instead of the pause point.
 While in Program Play mode
 - The resume play is canceled, and the player plays from the first programmed track.
- When you change the playback mode, the resume play is canceled.

Notes on using a USB device

- The following situations can increase the time it takes to start playback:
 - The USB device is recorded with a complicated tree structure.
 - The memory capacity is excessive.
- This player does not necessarily support all the functions provided in a connected USB device.
- Resume play is canceled when you turn off the player.
- Files and folders are displayed in the order of their creation on the USB device.
- The playback order for the player may differ from the folder structure of the connected USB device.
- Folders that have no audio files are skipped.
- With some connected USB devices, after an operation is entered, there may be a delay before it is performed by this player.
- Compatibility with all encoding/writing software cannot be guaranteed. If audio files on the USB device were originally encoded with incompatible software, those files may produce noise or interrupted audio, or may not play at all.
- This player cannot play audio files on the USB device in the following cases:
 - The number of audio files in a folder exceeds 999.
 - The total number of audio files exceeds 5,000.
 - The number of folders exceeds 255 (including the “ROOT” and “MUSIC” folders, and excluding empty folders).
 - The folder depth exceeds 8 folders.
 These numbers may vary depending on the file and folder structure. Do not save other types of files or unnecessary folders on a USB device that has audio files.

To select the memory on the USB device

If the USB device has more than one memory (for example, internal memory and a memory card), you can select which memory to use and then start playback or transfer.

- 1 Press USB.**
- 2 Connect a USB device to the USB port.**
- 3 Press USB MENU in stop mode.**
“MEM SEL” appears. If an audio file or a folder is selected, “ERASE” appears instead. Press **◀◀/▶▶** repeatedly to select “MEM SEL.”
- 4 Press ENTER.**
- 5 Press ◀◀/▶▶ repeatedly to select a memory number.**
Proceed to Step 6 if only one memory can be selected.
To cancel this operation, press **■**.
- 6 Press ENTER.**

Note on selecting the playback source or transferring destination

You cannot select a memory during playback or transfer. Make sure to select a memory before starting playback or transfer.

Transferring music from a disc to a USB device

You can connect an optional USB device to the USB port and transfer music from a disc to the USB device.

The format of files transferred by this player is MP3.

The amount of free space required on the USB device is about 1 MB per minute when transferring music from a CD. Required free space may be larger when transferring music from an MP3 disc.

You can easily transfer all the music on a disc to a USB device (CD SYNC). You can also transfer a track or MP3 file that is currently being played back (REC1).

1 Connect the USB device to the USB port.

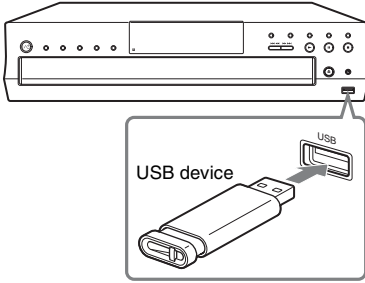

2 Press CD.

For operation via the player, press CD/USB repeatedly to select the CD mode.

3 Press ▲, and place a disc on the disc tray.

4 Press ▲ to close the disc tray.

5 Set the USB device to standby for transferring.

Synchronized transfer (CD SYNC):

Press ● REC USB (or REC USB on the player). To transfer only your favorite CD tracks or MP3 files, create your own program beforehand (page 17).

To transfer only MP3 files that are stored in a specific folder on the MP3 disc, press CONTINUE repeatedly until “” appears while the player is stopped, and then press FOLDER +/- repeatedly to select the desired folder before starting the transfer.

REC1:

Start playback of the track/file you want to transfer, and then press ● REC USB (or REC USB on the player).

“REC” flashes, and the display cycles through “CD SYNC (or “REC1”),” “FREExxxM” or “FREExxxG” (free space, in megabytes or gigabytes, on the USB device) and “PUSH ENTER.”

The USB device stands by for transferring and playback pauses.

6 Press ENTER.

Transferring starts.

Do not remove the USB device during transfer operations. Doing so may corrupt the data on the USB device or damage the USB device itself. Wait until “REC” on the display disappears.

When using CD SYNC

When the transfer is completed, access to the USB device and the disc stops automatically.

When using REC1

When the transfer is completed, access to the USB device stops automatically and the player continues playback.

To stop transferring

Press ■.

Folder and file generation rules

When first transferring music to a USB device, a “MUSIC” folder is created below the “ROOT” folder and a transfer mode-oriented folder (“CD-DA,” “CD-MP3,” “REC1” or “PROGRAM”) is created within the “MUSIC” folder.

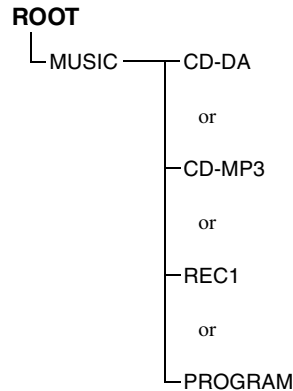

Folders and files are generated within any of the transfer mode-oriented folders as follows:

CD SYNC¹⁾

Music source	Folder name	File name
MP3	Same as the music source ²⁾	
CD-DA	“CDDA001” ³⁾	“TRACK001” ⁴⁾

REC1

Music source	Folder name	File name
MP3	“REC1” ⁵⁾	Same as the music source ²⁾
CD-DA		“TRACK001” ⁴⁾

- 1) In Program Play mode, the folder name is “PGM_xxx,” and the file name depends on the music source (CD-DA disc or MP3 disc).
- 2) Up to 32 characters of the name are assigned.
- 3) Folder numbers are assigned serially thereafter up to the maximum 999.
- 4) File numbers are assigned serially thereafter.
- 5) A new file is created in the “REC1” folder each time REC1 is performed.

Note

- When transferring music from a CD, the tracks are transferred as 128 kbps MP3 files. When transferring music from an MP3 disc, MP3 files are transferred with the same bit rate as the original MP3 files.
- If you start transferring in Shuffle Play mode, Repeat Play mode, or in Program Play mode (when no tracks or MP3 files are programmed), the selected playback mode is automatically canceled and the playback mode switches to normal playback mode.
- While transferring music from an MP3 disc, no sound is output and “HI-SPEED” appears.
- CD text information is not transferred in the created MP3 files.
- If you cancel the transfer partway, an MP3 file is created up to the point when the transfer was stopped.
- Transferring stops automatically if:
 - the USB device runs out of space during the transfer process.
 - the number of audio files on the USB device reaches the limit for the number that the player can recognize.
- If a folder or file that you are trying to transfer already exists on the USB device with the same name, a sequential number is added after the name without overwriting the original folder or file.
- This player cannot transfer music from an MP3 disc when the number of audio files in a folder exceeds 999. The number may vary depending on the file and folder structure. Do not save other types of files or unnecessary folders on a disc that has audio files.

Erasing audio files or folders from the USB device

You can erase audio files or folders from the USB device. Note that you cannot erase audio files and folders in Shuffle Play mode or Program Play mode.

- 1** Connect the USB device to the USB port.
- 2** Press **USB**.
- 3** Press **◀/▶** or **FOLDER +/-** repeatedly to select the audio file or folder you want to erase.
- 4** Press **USB MENU** in stop mode.
- 5** Make sure that “ERASE” is selected, and then press **ENTER**.
 “TRACK ERASE” or “FOLDER ERASE” appears in the display.
 To cancel the erase operation, press **■**.
- 6** Press **ENTER**.

The selected audio file or folder is erased.

Do not remove the USB device during erase operations. Doing so may corrupt the data on the USB device or damage the USB device itself.

Note

- If the folder to be erased contains non-MP3/WMA/AAC format files or sub folders, these are not erased.

Enjoying Music in Various Play Modes

You can use various playback modes to play tracks/files. Some playback modes are available simultaneously.

Selecting tracks/files to be played

In normal playback mode, you can play tracks/files in sequential order. The tracks/files to be played can be selected.

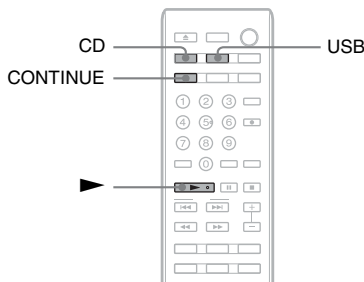

1 Press CD or USB.

For operation via the player, press CD/USB repeatedly to select the CD or USB mode. Before you change the playback mode, be sure to stop playback.

2 Press CONTINUE repeatedly.

The tracks/files to be played change as follows:

For a CD

Plays all tracks/files on all discs (ALL DISCS).¹⁾

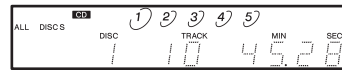

Plays all tracks/files on the current disc (1 DISC).¹⁾²⁾

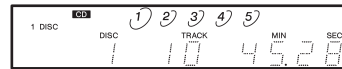

Plays all files in the current folder (FOLDER).³⁾⁴⁾



For a USB device

Plays all files on the USB device (USB MEMORY).

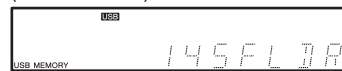

Plays all files in the current folder (FOLDER USB MEMORY).⁴⁾



1) The display for an MP3 disc differs.

2) To select the disc, press DISC 1-5 (or DISC SKIP repeatedly).

3) For a CD, functions the same as 1 DISC play.

4) To select the folder, press FOLDER +/-.

3 Press ►.

Playback starts.

Playing tracks/files in random order

In Shuffle Play mode, you can play tracks/files in random order. You can select whether to play tracks/files on all discs (or a USB device), on a specific disc, or in a specific folder.

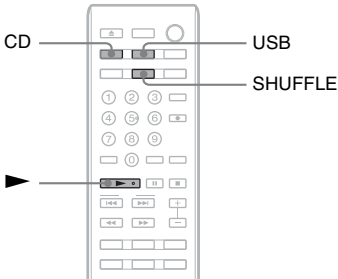

1 Press CD or USB.

For operation via the player, press CD/USB repeatedly to select the CD or USB mode. Before you change the playback mode, be sure to stop playback.

2 Press SHUFFLE repeatedly.

Shuffle Play mode changes as follows:

For a CD

Plays all tracks/files on all discs in random order (ALL DISCS SHUFFLE).¹⁾

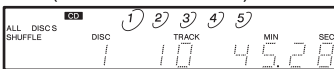

Plays all tracks/files on the current disc in random order (1 DISC SHUFFLE).¹⁾²⁾



Plays all files in the current folder in random order (SHUFFLE).³⁾⁴⁾



For a USB device

Plays all files on the USB device in random order (USB MEMORY SHUFFLE).



Plays all files on the current folder in random order (USB MEMORY SHUFFLE).⁴⁾



- 1) The display for an MP3 disc differs.
- 2) To select the disc, press DISC 1-5 (or DISC SKIP repeatedly).
- 3) For a CD, functions the same as 1 DISC SHUFFLE play.
- 4) To select the folder, press FOLDER +/-.

3 Press ►.

Shuffle Play starts.

To cancel Shuffle Play mode

Press CONTINUE.

Creating your own program

You can pick out the tracks/files you like and specify the playback order in a program containing up to 32 items.

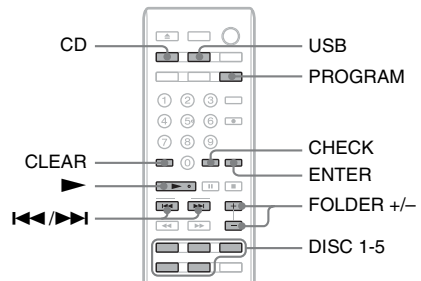

1 Press CD or USB.

For operation via the player, press CD/USB repeatedly to select the CD or USB mode. Before you change the playback mode, be sure to stop playback.

2 Press PROGRAM.

If a program is already stored, the last item of the program appears in the display. To erase the whole program, hold down CLEAR until "ALL CLEAR" appears in the display.

3 Select the disc/folder.

For a CD

Press DISC 1-5 (or DISC SKIP repeatedly) to select the disc.

The selected disc number appears in the display.

For an MP3 disc containing folders, press FOLDER +/- repeatedly to select the desired folder after selecting the disc.

For a USB device

Press FOLDER +/- repeatedly to select the desired folder. If the desired file is in root folder in your USB device, go to Step 4.

4 Press ◀◀/▶▶ to select the track/file.

You can also select the track/file directly by pressing the number buttons.

5 Press ENTER.

The track/file number that you programmed, the playing order, and the total playing time of the program appear in the display.

If you entered the wrong track/file number

Press CLEAR. Then repeat Steps 4 and 5 to enter the correct track/file number.

6 Repeat Steps 3 through 5 to enter other tracks/files.

Each time you enter a track/file, the total number of program items appears in the display.

7 Press ▶.

Program Play starts.

To cancel Program Play mode

Press CONTINUE.

Tip

- The program remains stored in the player even after program play ends. Press ▶ to play from the beginning of the program again. The program also remains even if you stop playback.

Note

- If you disconnect the power cord, press ▲, or press EX-CHANGE, the program will be erased.
- The total playing time does not appear when:
 - the total playing time of the program exceeds 99 minutes and 59 seconds.
 - you programmed an MP3/WMA/AAC file.

To check the contents of the program

While the player is in stop mode, press CHECK repeatedly.

Each time you press the button, the disc and track/file numbers will appear in the display in the programmed order.

To change the contents of the program

You can change the contents of the program in stop mode.

To	Do the following:
Erase a track/file	1 Press CHECK repeatedly until the track/file number you want to erase appears. 2 Press CLEAR.
Erase from the last track/file in the program	Press CLEAR. Each time you press the button, the last track/file of the program is erased.
Add tracks/files to the end of the program	Perform Steps 3 through 5 in "Creating your own program" (page 17).

Playing tracks/files repeatedly

You can play track(s)/file(s) repeatedly. Repeat Play mode can be used with other playback modes.

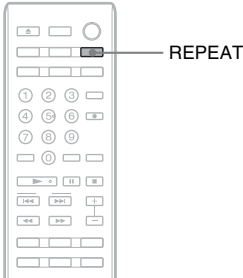

While playing or in stop mode, press REPEAT repeatedly until “REPEAT” or “REPEAT 1” appears in the display.

REPEAT (Repeat All): Plays all tracks/files on the disc(s)/USB device repeatedly.

REPEAT 1: Plays a single track/file repeatedly.

When “REPEAT” is selected, Repeat Play mode changes according to the selected playback mode. For example, while in ALL DISCS SHUFFLE mode (page 17), the player plays all tracks/files on all discs repeatedly in random order. While in Program Play mode (page 17), the player plays the programmed tracks/files repeatedly.

To cancel repeat play

Press REPEAT repeatedly to turn off “REPEAT” or “REPEAT 1.”

Note

- If you disconnect the power cord, Repeat Play is canceled.

Precautions

On safety

- Caution – The use of optical instruments with this product will increase eye hazard.
- Should any solid object or liquid fall into the cabinet, unplug the player and have it checked by qualified personnel before operating it any further.
- The AC power cord (mains lead) must be changed only at a qualified service shop.
- The player is not disconnected from the AC power source as long as it is connected to the wall outlet (mains), even if the player itself has been turned off.
- Do not put any object other than a disc on the disc tray.
- Do not put a vase or candle, etc., in front of the disc tray. When the disc tray opens, it might fall.

On power sources

- Before operating the player, check that the operating voltage of the player is identical with your local power supply. The operating voltage is indicated on the nameplate at the rear of the player.
- If you are not going to use the player for a long time, be sure to disconnect the player from the wall outlet (mains). To disconnect the AC power cord (mains lead), grasp the plug itself; never pull the cord.

On placement

- Place the player in a location with adequate ventilation to prevent heat build-up in the player.
- Do not place the player on a soft surface such as a rug that might block the ventilation holes on the bottom.
- Do not place the player in a location near heat sources, or in a place subject to direct sunlight, excessive dust or mechanical shock.

On operation

- If the player is brought directly from a cold to a warm location, or is placed in a very damp room, moisture may condense on the lenses inside the player. Should this occur, the player may not operate properly. In this case, remove the disc and leave the player turned on for about an hour until the moisture evaporates.
- While the player is turning on, some noise may be heard as the disc is being loaded into the player. This is not a malfunction.

On adjusting the volume

Do not turn up the volume too much while listening to a portion with very low level inputs or no audio signals. If you do, the speakers may be damaged when a peak level portion is played.

On inserting a disc

You may hear a transmission or a mechanical sound from the player. This indicates that the player is automatically adjusting its internal mechanisms according to the inserted disc.

You may also hear the mechanical sound from the player when you insert a warped disc.

On cleaning

Clean the cabinet, panel, and controls with a soft cloth slightly moistened with a mild detergent solution. Do not use any type of abrasive pad, scouring powder, or solvent such as alcohol or benzene.

On transportation

- Be sure to remove all discs from the disc tray.
- Be sure to close the disc tray.

If you have any questions or problems concerning your player, please consult your nearest Sony dealer.

Notes on Discs

On handling discs

- To keep the disc clean, handle the disc by its edge. Do not touch the surface.
- Do not stick paper or tape on the disc.



- Use only round-shaped discs. If you use a special shaped disc (e.g., star-shaped, heart-shaped, or square-shaped, etc.), the player may be damaged.
- Do not use discs with a seal attached; such seals are often attached to used and rental discs.

On keeping discs

- Do not expose the disc to direct sunlight or heat sources such as hot air ducts.
- After playing, store the disc in its case. If you put it on top of another disc without the case, the disc may be damaged.

On placing discs on the disc tray

Make sure the disc is positioned securely on the tray. If not, the player or the disc may be damaged.

On cleaning

- If the disc is dirty with fingerprints or dust, it may lessen the quality of the audio out.
- Before playing, clean the disc with a cleaning cloth. Wipe the disc from the center out.



- Clean the disc with a soft cloth slightly moistened with water, and remove moisture with a dry cloth.
- Do not use solvents such as benzine, thinner, record cleaners, or anti-static spray.

Troubleshooting

If you experience any of the following difficulties while using the player, use this troubleshooting guide to help you remedy the problem. Should any problem persist, consult your nearest Sony dealer.

General

There is no sound.

- Check that the player is connected securely.
- Make sure you operate the amplifier correctly.

The remote does not function.

- Remove any obstacles in the path of the remote and the player.
- Point the remote at the remote sensor on the player.
- If the batteries in the remote are weak, replace them with new ones.

“ERROR” appears in the display.

- Turn off the player, and then turn it on. If “ERROR” appears again, please consult your nearest Sony dealer.

The player enters standby mode automatically.

- The player enters standby mode automatically when playback is paused or stopped without any operation for more than about 30 minutes (Auto standby) (page 10). “AUTO STBY” flashes on the display for 2 minutes before the player enters standby mode.

CD/MP3 player

The disc does not play.

- There is no disc inside the player.
- Place the disc on the disc tray with the label side up.
- The disc is placed at an angle. Reload the disc.
- Clean the disc (page 21).
- Moisture has condensed inside the player. Remove the disc and leave the player turned on for about an hour.
- There is an incompatible disc on the tray (page 11).

A disc cannot be ejected and “LOCKED” appears in the display.

- Contact your Sony dealer or local authorized Sony service facility.

USB device

You cannot start transferring to a USB device.

- The following problems may have been encountered:
 - The USB device is full.
 - The number of files and folders on the USB device has reached the upper limit.
 - The USB device is write-protected.
-

Transferring is stopped before it is finished.

- You are using an unsupported USB device.
 - The USB device is not formatted correctly. Refer to the USB device operating instructions for how to format it.
 - Turn off the player and remove the USB device. If the USB device has a power switch, turn the USB device off, and then on again after removing it from the player. Then perform the transfer again.
 - If the transfer and erase operations are repeated multiple times, the file structure within the USB device becomes fragmented. Refer to the USB device operating instructions for how to deal with this problem. If the problem persists, contact your nearest Sony dealer.
-

Transferring music to a USB device results in an error.

- You are using an unsupported USB device.
 - Turn off the player and remove the USB device. If the USB device has a power switch, turn the USB device off and then on again after removing it from the player. Then perform the transfer again.
 - The USB device was disconnected or the power was turned off during the transfer process. Delete the partially-transferred file, and perform the transfer again. If this does not fix the problem, the USB device may be broken. Refer to the USB device operating instructions for how to deal with this problem. If the problem persists, contact your nearest Sony dealer.
-

Files or folders on the USB device cannot be erased.

- Check if the USB device is write-protected.
 - The USB device was disconnected or the power was turned off during the erase operation. Delete the partially-erased file. If this does not fix the problem, the USB device may be broken. Refer to the USB device operating instructions for how to deal with this problem. If the problem persists, contact your nearest Sony dealer.
-

Are you using a supported USB device?

- If you connect an unsupported USB device, the following problems may occur:
 - The USB device is not recognized.
-

- File or folder names are not displayed on this player.
 - Playback is not possible.
 - The sound skips.
 - There is noise.
 - A distorted sound is output.
-

“OVER CURRENT” appears.

- A problem has been detected with the level of electrical current from the USB port. Turn off the player and remove the USB device from the USB port. Make sure there is no problem with the USB device. If this display pattern persists, contact your nearest Sony dealer.
-

There is no sound.

- The USB device is not connected correctly. Turn off the player and reconnect the USB device, and then turn on the player and check if “USB MEMORY” appears in the display.
-

There is noise, skipping, or distorted sound.

- Turn off the player and reconnect the USB device, and then turn on the player.
 - The music data itself contains noise, or the sound is distorted. Noise may have entered during the transfer process. Delete the file, and try transferring again.
 - The bit rate used when encoding the files was low. Send files encoded with higher bit rates to the USB device.
-

The USB device cannot be connected into the USB port.

- The USB device is being connected upside-down. Connect the USB device in the correct orientation.
-

“READING” is displayed for an extended time, or it takes a long time before playback starts.

- The reading process can take a long time in the following cases:
 - There are many folders or files on the USB device.
 - The file structure is extremely complex.
 - The memory capacity is excessive.
 - The internal memory is fragmented.
- Thus, we recommend following these guidelines:
- Total folders on the USB device: 100 or less
 - Total files per folder: 100 or less
-

Erroneous characters are displayed.

- Send the music data to the USB device again, as the data stored in the USB device may have been corrupted.
 - The character codes that can be displayed by this player are numbers and alphabet only. Other characters are not displayed correctly.
-

The USB device is not recognized.

- Turn off the player and reconnect the USB device, and then turn on the player.
- You are using an unsupported USB device.
- The USB device does not work properly. Refer to the USB device operating instructions for how to deal with this problem.

Playback does not start.

- Turn off the player and reconnect the USB device, and then turn on the player.
- Press ► to start playback.

Files cannot be played back.

- The audio file does not have the extension “.mp3,” “.wma,” “.m4a,” “.mp4,” or “.3gp.”
- The audio file is a multiple track audio file.
- The file is a video file.
- The data is not stored in MP3/WMA/AAC format.
- The data is stored in WMA lossless/AAC lossless format.
- USB storage devices formatted with file systems other than FAT16 or FAT32 are unsupported*.
- If you use a partitioned USB storage device, only files on the first partition can be played.
- Playback is possible up to 8 levels.
- The number of folders has exceeded 255.
- The number of files has exceeded 5,000.
- Files that are encrypted or protected by passwords, etc., cannot be played back.

* This player supports FAT16 and FAT32, but some USB storage devices may not support these file systems. For details, see the operating instructions of the USB storage device or contact the manufacturer.

After you have attempted the prescribed corrective actions

If the player still does not operate properly, or if other problems not described above occur, turn off the player, disconnect the AC power cord (mains lead) from the wall outlet (mains) for a few minutes, and then reconnect the AC power cord (mains lead) to the wall outlet (mains).

Specifications

CD player section

Laser	Semiconductor laser ($\lambda = 780 \text{ nm}$) Emission duration: continuous
Frequency response	2 Hz to 20 kHz \pm 0.5 dB
Dynamic range	More than 90 dB
Harmonic distortion	Less than 0.006%
Laser Diode Properties	Emission Duration: Continuous Laser Output: Less than 44.6 μ W

* This output is the value measurement at a distance of 200 mm from the objective lens surface on the optical pick-up block with 7 mm aperture.

USB section

Supported bit rate	MP3 (MPEG 1 Audio Layer 3): 32 kbps – 320 kbps, VBR WMA: 48 kbps – 192 kbps AAC: 48 kbps – 320 kbps
Sampling frequencies	MP3 (MPEG 1 Audio Layer 3): 32 kHz/44.1 kHz/48 kHz WMA: 44.1 kHz AAC: 44.1 kHz
USB port	Maximum current: 500 mA

Outputs

	Jack type	Maximum output level	Load impedance
ANALOG OUT	Phono jacks	2 V (at 50 kilohms)	Over 10 kilohms
DIGITAL OUT	Optical output jack	-18 dBm	Wave length: 660 nm

General

Power requirements	120 V AC, 60 Hz
Power consumption	16 W
Dimensions (approx.) (w/h/d)	430 mm \times 110 mm \times 400 mm (17 in \times 4 3/8 in \times 15 3/4 in) incl. projecting parts
Mass (approx.)	5.2 kg (11 lbs 1 oz)

Supplied accessories

Audio cord	Red and white (1)
Remote commander	RM-ASU100 (1)
Battery	R6 (size-AA) (2)

Design and specifications are subject to change without notice.

- Standby power consumption: 0.3 W
- Halogenated flame retardants are not used in the certain printed wiring boards.



* 4 2 0 9 0 8 9 1 1 * (1)

Free Manuals Download Website

<http://myh66.com>

<http://usermanuals.us>

<http://www.somanuals.com>

<http://www.4manuals.cc>

<http://www.manual-lib.com>

<http://www.404manual.com>

<http://www.luxmanual.com>

<http://aubethermostatmanual.com>

Golf course search by state

<http://golfingnear.com>

Email search by domain

<http://emailbydomain.com>

Auto manuals search

<http://auto.somanuals.com>

TV manuals search

<http://tv.somanuals.com>