

Stereo Cassette Deck

Operating Instructions

TC-TX595

This system is equipped with the Dolby* B-type noise reduction system.

* Manufactured under license from Dolby Laboratories.
“Dolby” and the double-D symbol are trademarks of Dolby Laboratories.

The TC-TX595 tape deck is designed for the stereo systems listed below

- DHC-MD313
- DHC-MD333
- DHC-MD373
- DHC-MD595

Connect the tape deck to DHC-MD373/595 using audio connecting cords and the system cable adapter (see page 4).

Connect the tape deck to DHC-MD313/333 using audio connecting cords and the AU BUS connecting cable (see page 5).

The illustrations in these operating instructions describe the tape deck connections based on the DHC-MD333/373.

Auto Power On/Off

The tape deck power is tied with the stereo system (see page 11).

CD-TAPE Synchro Recording

You can easily record a CD onto a tape (see page 10). However, you cannot perform Fade Synchro recording with the DHC-MD373/595 (see page 11).

One Touch Play (DHC-MD313/333 only)

Pressing ▷ or ◁ on the tape deck when the tape deck is off automatically turns on the tape deck and the stereo system, and starts playing a tape if a cassette is inserted (see page 9).

Automatic Source Selection

You can switch from another source to the tape deck and start playing a tape just by pressing ▷ or ◁ on the tape deck (see page 9).

Timer

You can wake up to music or record a radio programme at a preset time. For details, refer to “Waking up to music” and “Timer recording radio programmes” in the stereo system operating instructions.

Remote Control

If the remote supplied with the stereo system has buttons with the same names as the controls on the tape deck, you can also operate the tape deck using these buttons.

Table of Contents

Getting Started

Hooking up the system 4

Operations

Playing a tape 8

Recording a CD

— CD-TAPE Synchro Recording 10

Recording manually 11

Additional Information

Precautions 12

Troubleshooting 14

Specifications 15

Hooking up the system

The stereo systems with the tape control jack (DHC-MD373/595)

Complete steps **1** to **3**, **5** to **7** below to hook up your system using the supplied cords.

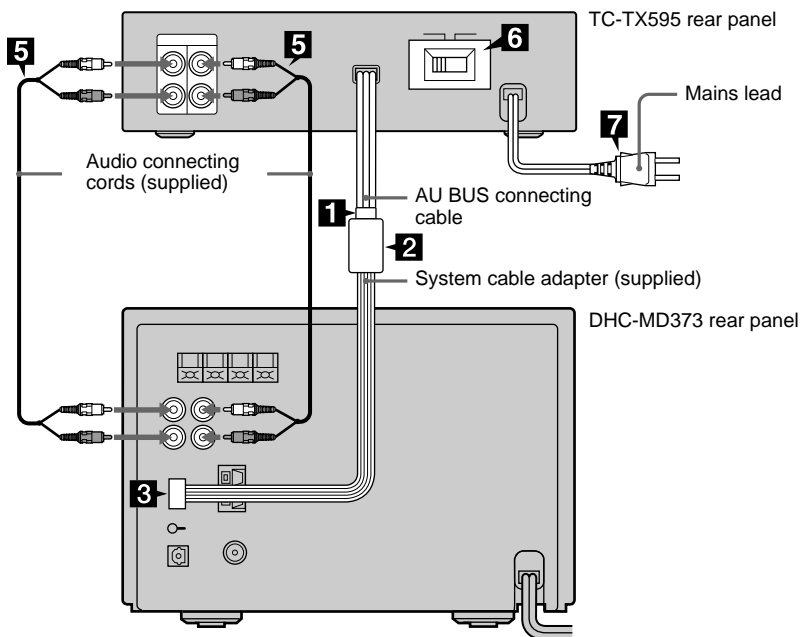

The stereo systems with the AU BUS jack (DHC-MD313/333)

Complete steps **4** to **7** below to hook up your system using the supplied cords.

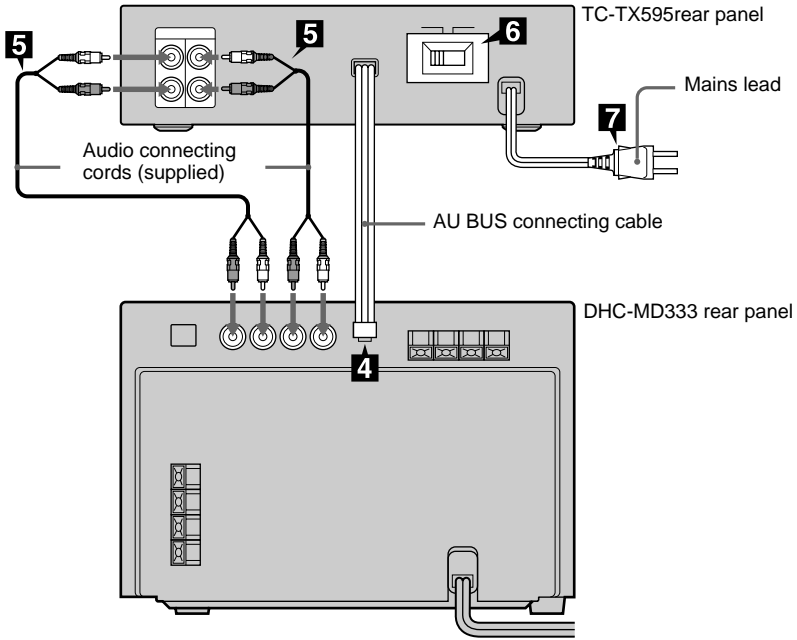

Connection to the DHC-MD373/595

- 1** Firmly connect the AU BUS connecting cable to the system cable adapter.

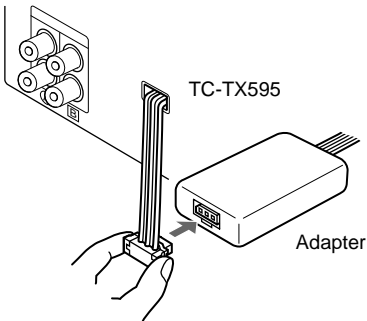

- 2** Peel away the seal paper from the back of the system cable adapter and secure the adapter to the DHC-MD373/595.

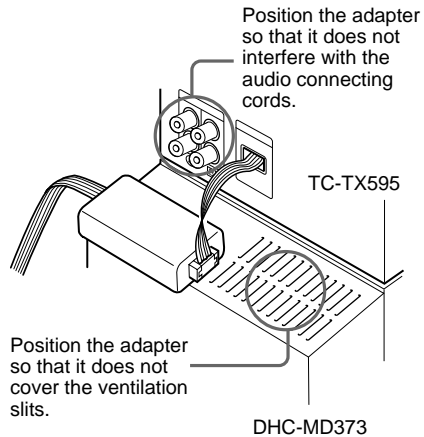

continued

Hooking up the system (continued)

- 3** Firmly connect the system cable adapter to the tape control jack on the DHC-MD373/595.

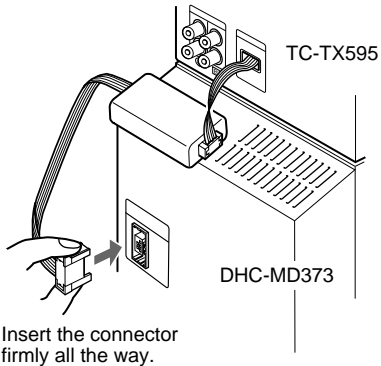

Note

The system cable adapter is used to connect the AU BUS connecting cable for exchanging signals between the tape deck and the DHC-MD373/595. If you do not connect the system cable adapter and the AU BUS connecting cable firmly, the tape deck and DHC-MD373/595 may not operate correctly.

Connection to the DHC-MD313/333

- 4** Firmly connect the AU BUS connecting cable to the AU BUS jack on the DHC-MD313/333.

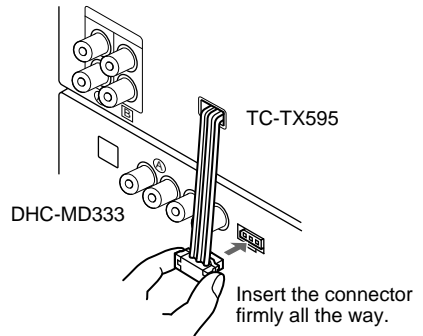

Note

The AU BUS connecting cable is used for exchanging signals between the tape deck and the DHC-MD313/333. If you do not connect the cable firmly, the tape deck and DHC-MD313/333 may not operate correctly.

- 5** Connect **(A)** to **(A)**, and **(B)** to **(B)** using the audio connecting cords. Insert the plugs into jacks of the same colour. The two audio connecting cords are the same, so you can connect **(A)** or **(B)** using either cord.

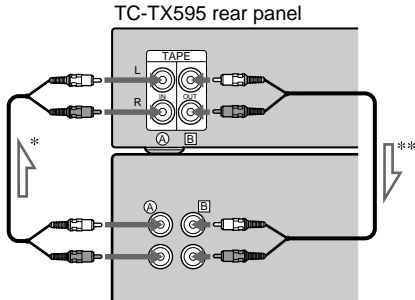

DHC-MD373 rear panel

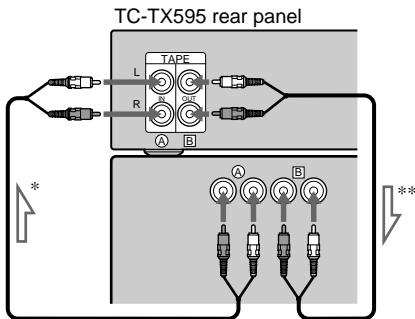

DHC-MD333 rear panel

: sound flow

* **(A)** **(A)**

The sound signals of the CD, MD and TUNER flow through the stereo system to the tape deck when you record to tape.

** **(B)** **(B)**

The sound signal of the tape deck flows to the stereo system when you play a tape.

How to insert the plugs

Insert the plugs firmly into the jacks.

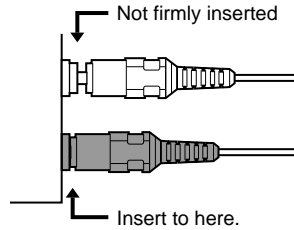

- 6** For models with a voltage selector, set **VOLTAGE SELECTOR** to the position of your local power line voltage.

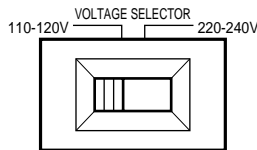

- 7** Connect the mains lead to a mains after you complete all the connections.

If the plug on this tape deck does not fit your mains, detach the supplied adapter from the plug (only for models equipped with an adapter).

If there is no sound or the tape does not record at first operation

Make sure the plugs are inserted into the jacks firmly.

- If the plugs are not inserted into both the **(A)** jacks firmly, you may not be able to record the sound of the CD, MD and TUNER onto a tape.
- If the plugs are not inserted into both the **(B)** jacks firmly, you may not be able to listen to the sound of the tape deck.

The plugs of the audio connecting cords may be tight. Insert the plugs at the point shown in “How to insert the plugs” in step **5**.

Playing a tape

You can use any type of tape, TYPE I (normal), TYPE II (CrO₂) or TYPE IV (metal), since the tape deck automatically detects the tape type (ATS¹⁾).

¹⁾ ATS: Automatic Tape Selection.

Tape deck TC-TX595

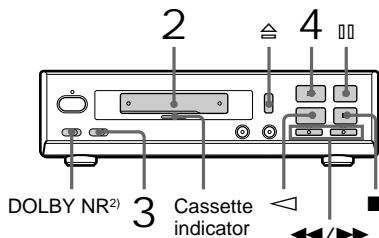

²⁾ This tape deck is equipped with the Dolby B-type noise reduction system.

- 1 Press **I/⏻** (power) on the stereo system to turn on the stereo system.
The tape deck turns on automatically.

- 2 Insert a recorded tape.

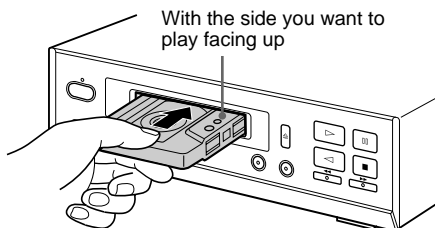

- 3 Set **DIRECTION** to **↔** to play one side. Set it to **↻**³⁾ to play both sides.

- 4 Press **▷**.
Press **◁** to play the bottom side.
FUNCTION switches to "TAPE" automatically, then the tape starts playing.

³⁾ The tape deck stops automatically after repeating the sequence five times.

To play a tape using the stereo system

Do the following operation in step 4;

- 1 Switch the function of the stereo system to tape.
- 2 Press (TAPE) **▷** or (TAPE) **▶** on the remote.

To play the bottom side, press (TAPE) **▷** or (TAPE) **▶** again. For DHC-MD313/333, press **◁**.

Other operations

To	Do this
Stop playing	Press ■.
Pause	Press ▢. Press again to resume playing.
Fast-forward	Press ■, then ►► for the top side. Press ■, then ◀◀ for the bottom side.
Rewind	Press ■, then ◀◀ for the top side. Press ■, then ►► for the bottom side.
Find the succeeding track* (AMS**)	Press ►► for the top side during playback. Press ◀◀ for the bottom side during playback.
Find the preceding track* (AMS**)	Press ◀◀ for the top side during playback. Press ►► for the bottom side during playback.
Remove the cassette	Press ⏏ on the tape deck.
Adjust the volume	Turn VOLUME on the stereo system.

* You cannot use the remote supplied with DHC-MD595.

** The Automatic Music Sensor (AMS) feature detects a blank space of more than four seconds between tracks to locate tracks quickly.

Tips

- When you press I/⏻ (power) on the tape deck, only the tape deck turns on. Press I/⏻ (power) on the stereo system to turn on the stereo system.
- The cassette indicator lights up in red when a cassette is inserted and goes off when no cassette is inserted.
- Pressing ▷ or ◁ when the tape deck is off automatically turns on the tape deck and starts playing a tape if there is a cassette inserted (**One Touch Play**) (DHC-MD313/333 only).
- Inserting the tape when the power is off automatically turns on the tape deck only. Press I/⏻ (power) on the stereo system to turn on the stereo system.
- You can switch from another source to the tape deck just by pressing ▷ or ◁ (**Automatic Source Selection**).
- To start playing automatically from the beginning of the tape after fast winding (**Auto Play**), press ▷ while holding down ◀◀ (for the top side) or press ◁ while holding down ►► (for the bottom side).
- To listen to a tape recorded with the Dolby noise reduction system, set DOLBY NR to ON.
- Using the timer function on the stereo system, you can wake up to music at a preset time. For details, refer to "Wake up to music" in the stereo system operating instructions. When you set the Wake-up timer, DOLBY NR must be set on the tape deck.

Note

The AMS feature may not work in the following cases:

- the blank space between tracks is four seconds or less.
- the sound source recorded on the right channel is different from that on the left channel as with a KARAOKE tape.
- low volume or low sound continues for a long time.
- the TV is too close to the tape deck.

Recording a CD

— CD-TAPE Synchro Recording

The CD SYNC button lets you record from a CD to a tape easily. You can use TYPE I (normal) or TYPE II (CrO₂) tape, since the tape deck automatically detects the tape type.

Tape deck TC-TX595

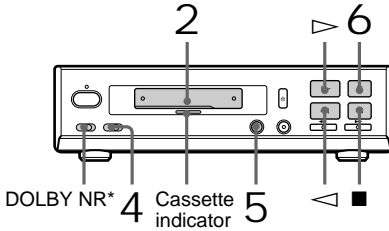

* This tape deck is equipped with the Dolby B-type noise reduction system.

- 1 Press **I/⏻** (power) on the stereo system to turn on the stereo system.

The tape deck turns on automatically.

- 2 Insert a blank tape.

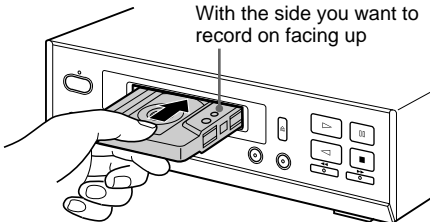

- 3 Place a CD on the disc tray of the CD player of the stereo system.

- 4 Set **DIRECTION** to **↔** to record on one side. Set it to **↶↷** to record on both sides.

If you select both sides recording and the tape reaches the end of the top side part-way through a track, the entire track is recorded again from the beginning of the bottom side.

- 5 Press **CD SYNC** on the tape deck.

The tape deck stands by for recording and the CD player stands by for playback. The indicators on the **CD SYNC**, **●REC**, **▷** (for the top side) and **◁** buttons light up.

If you want to record starting from the bottom side, press **◁** (for the bottom side) so the indicator on the **◁** button lights up.

- 6 Press **■** on the tape deck.

Recording starts.

If the tape reaches the end of the top side part-way through a track, the tape rewinds and the track is recorded again from its start. After that, recording starts with that track from the beginning of the bottom side during both sides recording, or recording stops during one side recording.

To stop recording

Press **■** on the tape deck.

Tips

- When you press **I/⏻** (power) on the tape deck, only the tape deck turns on. Press **I/⏻** (power) on the stereo system to turn on the stereo system.
- Inserting the tape when the power is off automatically turns on the tape deck only. Press **I/⏻** (power) on the stereo system to turn on the stereo system before recording.
- The cassette indicator lights up in red when a cassette is inserted and goes off when no cassette is inserted.
- When you want to reduce the hiss noise in low-level high-frequency signals, set DOLBY NR to ON before step 5.
- If the tape reaches the end of the top side during both sides recording, the fadeout feature prevents the track from ending abruptly at the end of the tape (**Fade Synchro**) (DHC-MD313/333 only). The track is recorded again from the beginning of the bottom side.

Notes

- You cannot listen to other sources while recording.
- When you record on both sides, be sure to start from the top side. If you start from the bottom side, recording stops at the end of the bottom side.

Recording manually

With manual recording, you can record just the songs you like from a CD, or start recording from the middle of the tape. You can also record a radio programme or MD.

Tape deck TC-TX595

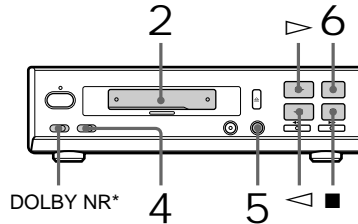

* This tape deck is equipped with the Dolby B-type noise reduction system.

1 Press **I/⏻** (power) on the stereo system to turn on the stereo system.
The tape deck turns on automatically.

2 Insert a blank tape.

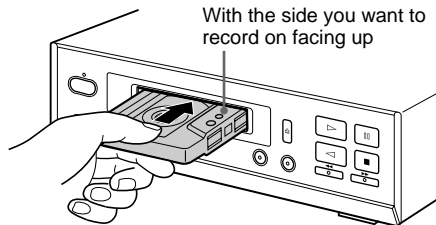

continued

Recording manually (continued)

3 Switch the function of the stereo system to the desired sound source (e.g. “CD,” “MD,” “AM” or “FM”).

4 Set DIRECTION to \rightleftarrows to record on one side. Set it to \rightleftarrows to record on both sides.

5 Press **●REC** on the tape deck.
The tape deck stands by for recording. The indicators on the **●REC**, \triangleright (for the top side) and \square buttons light up.
If you want to record starting from the bottom side, press \triangleleft (for the bottom side) so the indicator on the \triangleleft button lights up.

6 Press \square on the tape deck.
Recording starts.
You can also start recording by pressing the \triangleright or \triangleleft button that is lit.

7 Start playing on the source component.

To	Press
Stop recording	■ on the tape deck.
Pause recording	\square on the tape deck.

Tips

- The cassette indicator lights up in red when a cassette is inserted and goes off when no cassette is inserted.
- When you want to reduce the hiss noise in low-level high-frequency signals, set DOLBY NR to ON before step 5.
- Using the timer function on the stereo system, you can record radio programmes at a preset time. For details, refer to “Timer recording radio programmes” in the stereo system operating instructions. When you set the timer recording, DOLBY NR and DIRECTION mode must be set on the tape deck.

Precautions

On operating voltage
(for models with a voltage selector)

Before operating the tape deck, check that the operating voltage of your tape deck is identical with the voltage of your local power supply.

On safety

- The unit is not disconnected from the AC power source (mains) as long as it is connected to the wall outlet (mains), even if the unit itself has been turned off.
- Unplug the tape deck from the wall outlet (mains) if it is not to be used for an extended period of time. To disconnect the cord (mains lead), pull it out by the plug. Never pull the cord itself.
- Should any solid object or liquid fall into the component, unplug the tape deck and have it checked by qualified personnel before operating it any further.
- The AC power cord (mains lead) must be changed only at a qualified service shop.

On placement

- Place the tape deck in a location with adequate ventilation to prevent heat build-up in the tape deck.
- Do not place the unit in an inclined position.
- Do not place the unit in locations where it is:
 - Extremely hot or cold
 - Dusty or dirty
 - Very humid
 - Subject to vibration
 - Subject to direct sunlight

Before placing a cassette in the tape deck

Take up any slack in the tape. Otherwise, the tape may get entangled in the parts of the tape deck and become damaged.

When using a tape longer than 90 minutes

The tape is very elastic. Do not change the tape operations such as play, stop, and fast-winding frequently. The tape may get entangled in the tape deck.

To save a tape permanently

To prevent a tape from being accidentally recorded over, break off the cassette tab from side A or B as illustrated.

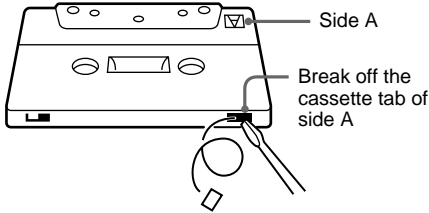
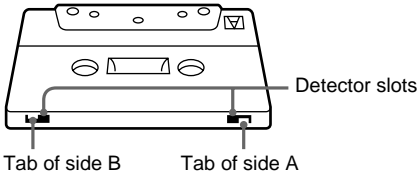

If you later want to reuse the tape for recording, cover the broken tab with adhesive tape. However, be careful not to cover the detector slots which allow the tape player to automatically detect the type of tape.

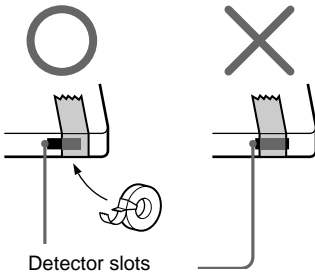

Cleaning the tape heads

Clean the tape heads after every 10 hours of use.

When the tape heads become dirty

- the sound is distorted
- there is a decrease in sound level
- the sound drops out
- the tape does not erase completely
- the tape does not record.

Be sure to clean the tape heads before you start an important recording or after playing an old tape.

Use a separately sold dry-type or wet-type cleaning cassette. For details, refer to the instructions of the cleaning cassette.

Demagnetising the tape heads

Demagnetise the tape heads and the metal parts that has contact with the tape after every 20 to 30 hours of use with a separately sold demagnetising cassette.

For details, refer to the instructions of the demagnetising cassette.

Cleaning the cabinet

Use a soft cloth slightly moistened with mild detergent solution.

Never use strong solvents, such as thinner or benzene, since they may damage the finish.

If you have any questions or problems concerning your tape deck, please consult your nearest Sony dealer.

Troubleshooting

If you run into any problem using this tape deck, use the following checklist.

First, check that the mains lead is connected firmly and the speakers are connected correctly and firmly.

Should any problem persist, consult your nearest Sony dealer.

The operation buttons on the tape deck do not work.

- Press any of the operation buttons after $\square\square$ stops flashing. (The buttons on the tape deck do not work for about two seconds after the tape deck turns on.)
 - No cassette is inserted. Insert a cassette.
-

The tape does not play or record.

- There is slack in the tape. Take up any slack in the tape.
 - The heads are dirty. Clean them.
 - Make sure the audio connecting cords are connected correctly (see page 7).
-

The tape does not record.

- No cassette is inserted. Insert a cassette.
 - The tab has been removed from the cassette. Cover the broken tab with adhesive tape (see page 13).
 - The tape has wound to the end.
-

The tape does not record or play, or there is a decrease in sound level.

- The heads are dirty. Clean them.
 - The record/playback heads are magnetised. Demagnetise them.
-

The tape does not erase completely.

- The record/playback heads are magnetised. Demagnetise them.
-

There is excessive wow or flutter, or the sound drops out.

- The capstans in the tape deck are dirty. Clean them using a cleaning cassette.
-

Noise increases or the high frequencies are erased.

- The record/playback heads are magnetised. Demagnetise them (see page 13).
 - Move the tape deck away from the TV or VCR.
-

The sound is distorted.

- Set DOLBY NR to the same setting in which the tape was recorded.
 - Move the tape deck away from the TV or VCR.
-

There is no sound.

- The mains lead is disconnected from the mains.
 - Make sure the audio connecting cords are connected correctly (see page 7).
-

The remote supplied with the stereo system does not function.

- The function of the stereo system is not set to "TAPE."
 - Make sure the system cable adapter/AU BUS connecting cable is connected correctly (see page 5 or 6).
-

Automatic Source Selection or One Touch Play (DHC-MD313/333 only) does not work.

- Make sure the system cable adapter/AU BUS connecting cable is connected correctly (see page 5 or 6).
-

The functions tied with the stereo system, such as CD-TAPE Synchro Recording, do not work.

- Make sure the system cable adapter/AU BUS connecting cable is connected correctly (see page 5 or 6).
-

The inserted tape will not eject.

- I/C (power) of the tape deck is OFF. Press I/C (power) to turn on the tape deck, then press E .
-

The cassette indicator flashes.

- Press I/C (power) to turn off the tape deck, then press I/C (power) again to turn on the tape deck.
-

Specifications

Recording system	4-track 2-channel stereo
Frequency response	(DOLBY NR OFF) 50 – 14,000 Hz (± 3 dB), using Sony TYPE I cassettes 50 – 15,000 Hz (± 3 dB), using Sony TYPE II cassettes
Wow and flutter	$\pm 0.13\%$ W. Peak (IEC) 0.07% W. RMS (NAB) $\pm 0.2\%$ W. Peak (DIN)
Input	TAPE IN (phono jacks): impedance 47 kilohms
Output	TAPE OUT (phono jacks): voltage 550 mV impedance 47 kilohms

General

Power requirements

European countries model:

220 – 230 V AC, 50/60 Hz

Other models:
110 – 120 V or 220 – 240 V AC,
50/60 Hz

Adjustable with the voltage
selector

Power consumption 12 W

Dimensions Approx. 215 × 60 × 230 mm
(w/h/d) incl. projecting parts and
controls

Mass Approx. 2.5 kg

Supplied accessories: Audio connecting cords (2)
System cable adapter (1)

Design and specifications are subject to change
without notice.

Sony  line

<http://www.world.sony.com/>

Sony Corporation Printed in China

Download from [Www.Somanuals.com](http://www.Somanuals.com). All Manuals Search And Download.

Free Manuals Download Website

<http://myh66.com>

<http://usermanuals.us>

<http://www.somanuals.com>

<http://www.4manuals.cc>

<http://www.manual-lib.com>

<http://www.404manual.com>

<http://www.luxmanual.com>

<http://aubethermostatmanual.com>

Golf course search by state

<http://golfingnear.com>

Email search by domain

<http://emailbydomain.com>

Auto manuals search

<http://auto.somanuals.com>

TV manuals search

<http://tv.somanuals.com>