

Cassette-Corder

Operating Instructions Manual de instrucciones Manual de instruções

TCS-600DV

Sony Corporation © 2003 Printed in China

http://www.sony.net/

A

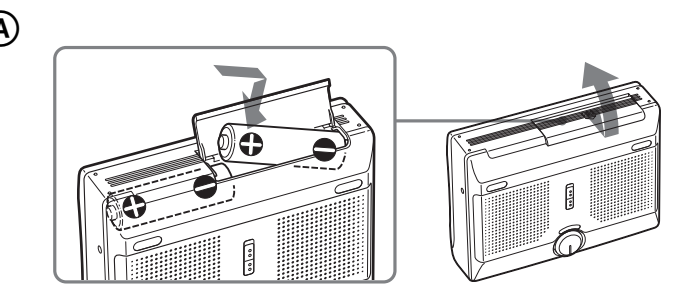

B

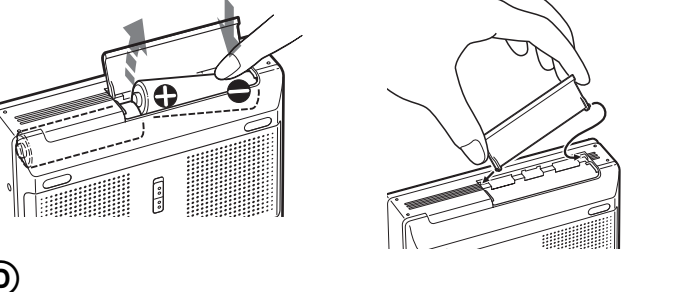

When batteries are new
Si las pilas son nuevas
Quando as pilhas são novas

BATT lights brightly
se ilumina
acende-se com uma
luz brilhante

When batteries become weak
Si las pilas disponen
de poca energia
Quando as pilhas ficam fracas

BATT lights dimly
se ilumina débilmente
acende-se com uma
luz esbatida

Replace batteries
Sustituya las pilas
Substituir as pilhas

BATT flashes
parpadea
pisca

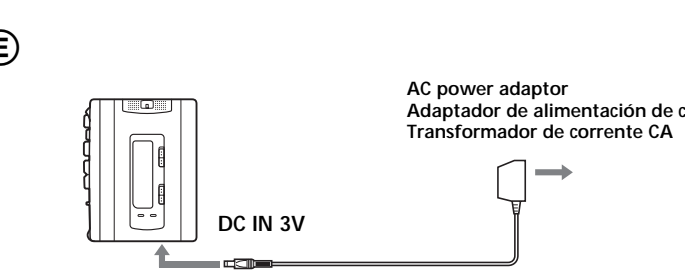

E

B

A

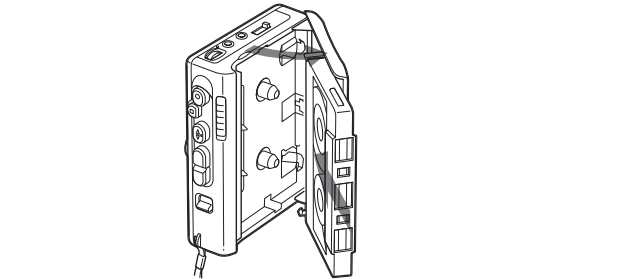

B

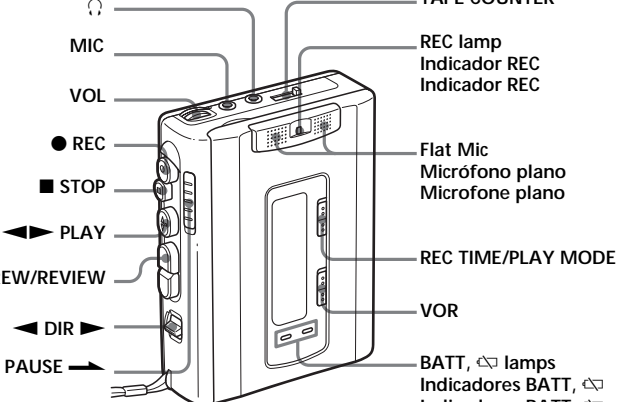

C

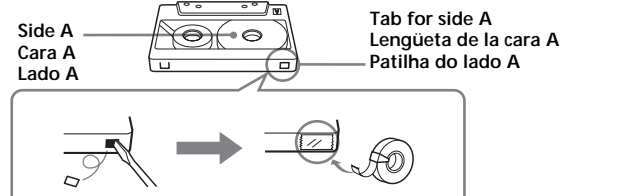

D



E

Thank you for purchasing the Sony Cassette-Corder. This Cassette-Corder is equipped with a REC TIME/PLAY MODE switch that lets you record double the normal length on any cassette.

Note
Tapes recorded with the REC TIME/PLAY MODE switch in the DOUBLE position cannot be played properly on a tape recorder without the REC TIME/PLAY MODE switch function.

▶ Getting Started

Preparing a Power Source
Choose one of the following power sources.

Dry Batteries (see Fig. A-②)
Make sure that nothing is connected to the DC IN 3V jack.

- Open the battery compartment lid.
- Insert two R6 (size AA) batteries (not supplied) with correct polarity and close the lid.

Notes

- Do not charge a dry battery.
- Do not use a new battery with an old one.
- Do not use different types of batteries.
- When you do not use the unit for a long time, remove the batteries to avoid any damage caused by battery leakage and subsequent corrosion.
- Dry batteries will not be drained when another power source is connected.

When to replace the batteries (see Fig. A-③)
Replace the batteries with new ones when the lamp flashes. The BATT and lamps change as illustrated.

Notes

- During FF(CUE) or REV(REVIEW), the lamp may flash. Only when the tape does not run properly, replace the batteries.
- After the batteries have been used for a while, the BATT and lamps may flicker during playback if the volume is turned up. This is, however, not an indication for the batteries to be replaced.
- The unit will play back normally for a while even after the lamp flashes. You should, nonetheless, replace the batteries as soon as possible. Otherwise, the built-in speaker may emit a loud noise and recordings may not be made correctly.
- The lamp may flash momentarily at beginning of playback or the end of the tape. If the flashing stops right away, you do not need to replace the batteries.

English

Welcome!

Thank you for purchasing the Sony Cassette-Corder. This Cassette-Corder is equipped with a REC TIME/PLAY MODE switch that lets you record double the normal length on any cassette.

Note
Tapes recorded with the REC TIME/PLAY MODE switch in the DOUBLE position cannot be played properly on a tape recorder without the REC TIME/PLAY MODE switch function.

▶ Getting Started

Preparing a Power Source

Choose one of the following power sources.

Dry Batteries (see Fig. A-②)

Make sure that nothing is connected to the DC IN 3V jack.

- Open the battery compartment lid.
- Insert two R6 (size AA) batteries (not supplied) with correct polarity and close the lid.

- Notes**
- Do not charge a dry battery.
 - Do not use a new battery with an old one.
 - Do not use different types of batteries.
 - When you do not use the unit for a long time, remove the batteries to avoid any damage caused by battery leakage and subsequent corrosion.
 - Dry batteries will not be drained when another power source is connected.

When to replace the batteries (see Fig. A-③)
Replace the batteries with new ones when the lamp flashes. The BATT and lamps change as illustrated.

Notes

- During FF(CUE) or REV(REVIEW), the lamp may flash. Only when the tape does not run properly, replace the batteries.
- After the batteries have been used for a while, the BATT and lamps may flicker during playback if the volume is turned up. This is, however, not an indication for the batteries to be replaced.
- The unit will play back normally for a while even after the lamp flashes. You should, nonetheless, replace the batteries as soon as possible. Otherwise, the built-in speaker may emit a loud noise and recordings may not be made correctly.
- The lamp may flash momentarily at beginning of playback or the end of the tape. If the flashing stops right away, you do not need to replace the batteries.

English

Battery life* (approx. hours)

	Sony alkaline LR6 (SG)**	Sony R6P (SR)
Playback	10	2.5
Recording	15	4.5

* Measured value by the standard of JEITA (Japan Electronics and Information Technology Industries Association). (Using a Sony HF series cassette tape on which music has been recorded is played at volume setting 7)
** When using Sony LR6 (SG) "STAMINA" alkaline dry batteries (produced in Japan)

▶ Getting Started

Preparing a Power Source

Choose one of the following power sources.

Dry Batteries (see Fig. A-②)

Make sure that nothing is connected to the DC IN 3V jack.

- Open the battery compartment lid.
- Insert two R6 (size AA) batteries (not supplied) with correct polarity and close the lid.

- Notes**
- Do not charge a dry battery.
 - Do not use a new battery with an old one.
 - Do not use different types of batteries.
 - When you do not use the unit for a long time, remove the batteries to avoid any damage caused by battery leakage and subsequent corrosion.
 - Dry batteries will not be drained when another power source is connected.

When to replace the batteries (see Fig. A-③)
Replace the batteries with new ones when the lamp flashes. The BATT and lamps change as illustrated.

Notes

- During FF(CUE) or REV(REVIEW), the lamp may flash. Only when the tape does not run properly, replace the batteries.
- After the batteries have been used for a while, the BATT and lamps may flicker during playback if the volume is turned up. This is, however, not an indication for the batteries to be replaced.
- The unit will play back normally for a while even after the lamp flashes. You should, nonetheless, replace the batteries as soon as possible. Otherwise, the built-in speaker may emit a loud noise and recordings may not be made correctly.
- The lamp may flash momentarily at beginning of playback or the end of the tape. If the flashing stops right away, you do not need to replace the batteries.

English

- Set REC TIME/PLAY MODE to the desired mode.
NORMAL (4.8cm/s): for optimum sound. Recommended for normal recordings.
DOUBLE (2.4cm/s): for double recording time (for example, 120 minutes using both sides of a 60-minute cassette). Suitable for recording conferences, dictations, etc. Not recommended for recording music.

- Choose recording sides.
To record on both sides: Slide DIR to FWD. Recording will start from the side facing the cassette holder window (forward side) and switches automatically to the reverse side at the end of the side (Auto Reverse).

▶ Getting Started

Preparing a Power Source

Choose one of the following power sources.

Dry Batteries (see Fig. A-②)

Make sure that nothing is connected to the DC IN 3V jack.

- Open the battery compartment lid.
- Insert two R6 (size AA) batteries (not supplied) with correct polarity and close the lid.

- Notes**
- Do not charge a dry battery.
 - Do not use a new battery with an old one.
 - Do not use different types of batteries.
 - When you do not use the unit for a long time, remove the batteries to avoid any damage caused by battery leakage and subsequent corrosion.
 - Dry batteries will not be drained when another power source is connected.

When to replace the batteries (see Fig. A-③)
Replace the batteries with new ones when the lamp flashes. The BATT and lamps change as illustrated.

Notes

- During FF(CUE) or REV(REVIEW), the lamp may flash. Only when the tape does not run properly, replace the batteries.
- After the batteries have been used for a while, the BATT and lamps may flicker during playback if the volume is turned up. This is, however, not an indication for the batteries to be replaced.
- The unit will play back normally for a while even after the lamp flashes. You should, nonetheless, replace the batteries as soon as possible. Otherwise, the built-in speaker may emit a loud noise and recordings may not be made correctly.
- The lamp may flash momentarily at beginning of playback or the end of the tape. If the flashing stops right away, you do not need to replace the batteries.

English

To monitor the sound
Connect headphones or earphones (not supplied) firmly to the (headphones) Jack. Adjust monitoring volume with VOL. The recording level is not affected.

Notes

- Do not use a High-position (TYPE II) or metal (TYPE IV) tape. If you do so, the sound may be distorted when you play back the tape, or the previous recording may not be erased completely.
- The SPEED CONTROL switch (see reverse side) works in the playback mode only. Recording will be made independent of this control.

▶ Getting Started

Preparing a Power Source

Choose one of the following power sources.

Dry Batteries (see Fig. A-②)

Make sure that nothing is connected to the DC IN 3V jack.

- Open the battery compartment lid.
- Insert two R6 (size AA) batteries (not supplied) with correct polarity and close the lid.

- Notes**
- Do not charge a dry battery.
 - Do not use a new battery with an old one.
 - Do not use different types of batteries.
 - When you do not use the unit for a long time, remove the batteries to avoid any damage caused by battery leakage and subsequent corrosion.
 - Dry batteries will not be drained when another power source is connected.

When to replace the batteries (see Fig. A-③)
Replace the batteries with new ones when the lamp flashes. The BATT and lamps change as illustrated.

Notes

- During FF(CUE) or REV(REVIEW), the lamp may flash. Only when the tape does not run properly, replace the batteries.
- After the batteries have been used for a while, the BATT and lamps may flicker during playback if the volume is turned up. This is, however, not an indication for the batteries to be replaced.
- The unit will play back normally for a while even after the lamp flashes. You should, nonetheless, replace the batteries as soon as possible. Otherwise, the built-in speaker may emit a loud noise and recordings may not be made correctly.
- The lamp may flash momentarily at beginning of playback or the end of the tape. If the flashing stops right away, you do not need to replace the batteries.

Español

Grabadora portátil
POR FAVOR LEA DETALLADAMENTE ESTE MANUAL DE INSTRUCCIONES ANTES DE CONECTAR Y OPERAR ESTE EQUIPO.
RECUERDE QUE UN MAL USO DE SU APARATO PODRÍA ANULAR LA GARANTÍA.

¡Bienvenido!

Gracias por la adquisición de la grabadora de cassettes de Sony. Esta grabadora de cassettes está equipada con un interruptor REC TIME/PLAY MODE que permite grabar el doble de la longitud normal en cualquier cassette.

▶ Getting Started

Preparing a Power Source

Choose one of the following power sources.

Dry Batteries (see Fig. A-②)

- Open the battery compartment lid.
- Insert two R6 (size AA) batteries (not supplied) with correct polarity and close the lid.

- Notes**
- Do not charge a dry battery.
 - Do not use a new battery with an old one.
 - Do not use different types of batteries.
 - When you do not use the unit for a long time, remove the batteries to avoid any damage caused by battery leakage and subsequent corrosion.
 - Dry batteries will not be drained when another power source is connected.

When to replace the batteries (see Fig. A-③)
Replace the batteries with new ones when the lamp flashes. The BATT and lamps change as illustrated.

Notes

- During FF(CUE) or REV(REVIEW), the lamp may flash. Only when the tape does not run properly, replace the batteries.
- After the batteries have been used for a while, the BATT and lamps may flicker during playback if the volume is turned up. This is, however, not an indication for the batteries to be replaced.
- The unit will play back normally for a while even after the lamp flashes. You should, nonetheless, replace the batteries as soon as possible. Otherwise, the built-in speaker may emit a loud noise and recordings may not be made correctly.
- The lamp may flash momentarily at beginning of playback or the end of the tape. If the flashing stops right away, you do not need to replace the batteries.

Español

Grabadora portátil
POR FAVOR LEA DETALLADAMENTE ESTE MANUAL DE INSTRUCCIONES ANTES DE CONECTAR Y OPERAR ESTE EQUIPO.
RECUERDE QUE UN MAL USO DE SU APARATO PODRÍA ANULAR LA GARANTÍA.

¡Bienvenido!

Gracias por la adquisición de la grabadora de cassettes de Sony. Esta grabadora de cassettes está equipada con un interruptor REC TIME/PLAY MODE que permite grabar el doble de la longitud normal en cualquier cassette.

▶ Getting Started

Preparing a Power Source

Choose one of the following power sources.

Dry Batteries (see Fig. A-②)

- Open the battery compartment lid.
- Insert two R6 (size AA) batteries (not supplied) with correct polarity and close the lid.

- Notes**
- Do not charge a dry battery.
 - Do not use a new battery with an old one.
 - Do not use different types of batteries.
 - When you do not use the unit for a long time, remove the batteries to avoid any damage caused by battery leakage and subsequent corrosion.
 - Dry batteries will not be drained when another power source is connected.

When to replace the batteries (see Fig. A-③)
Replace the batteries with new ones when the lamp flashes. The BATT and lamps change as illustrated.

Notes

- During FF(CUE) or REV(REVIEW), the lamp may flash. Only when the tape does not run properly, replace the batteries.
- After the batteries have been used for a while, the BATT and lamps may flicker during playback if the volume is turned up. This is, however, not an indication for the batteries to be replaced.
- The unit will play back normally for a while even after the lamp flashes. You should, nonetheless, replace the batteries as soon as possible. Otherwise, the built-in speaker may emit a loud noise and recordings may not be made correctly.
- The lamp may flash momentarily at beginning of playback or the end of the tape. If the flashing stops right away, you do not need to replace the batteries.

Español

Grabadora portátil
POR FAVOR LEA DETALLADAMENTE ESTE MANUAL DE INSTRUCCIONES ANTES DE CONECTAR Y OPERAR ESTE EQUIPO.
RECUERDE QUE UN MAL USO DE SU APARATO PODRÍA ANULAR LA GARANTÍA.

¡Bienvenido!

Gracias por la adquisición de la grabadora de cassettes de Sony. Esta grabadora de cassettes está equipada con un interruptor REC TIME/PLAY MODE que permite grabar el doble de la longitud normal en cualquier cassette.

▶ Getting Started

Preparing a Power Source

Choose one of the following power sources.

Dry Batteries (see Fig. A-②)

- Open the battery compartment lid.
- Insert two R6 (size AA) batteries (not supplied) with correct polarity and close the lid.

- Notes**
- Do not charge a dry battery.
 - Do not use a new battery with an old one.
 - Do not use different types of batteries.
 - When you do not use the unit for a long time, remove the batteries to avoid any damage caused by battery leakage and subsequent corrosion.
 - Dry batteries will not be drained when another power source is connected.

When to replace the batteries (see Fig. A-③)
Replace the batteries with new ones when the lamp flashes. The BATT and lamps change as illustrated.

Notes

- During FF(CUE) or REV(REVIEW), the lamp may flash. Only when the tape does not run properly, replace the batteries.
- After the batteries have been used for a while, the BATT and lamps may flicker during playback if the volume is turned up. This is, however, not an indication for the batteries to be replaced.
- The unit will play back normally for a while even after the lamp flashes. You should, nonetheless, replace the batteries as soon as possible. Otherwise, the built-in speaker may emit a loud noise and recordings may not be made correctly.
- The lamp may flash momentarily at beginning of playback or the end of the tape. If the flashing stops right away, you do not need to replace the batteries.

Español

Grabadora portátil
POR FAVOR LEA DETALLADAMENTE ESTE MANUAL DE INSTRUCCIONES ANTES DE CONECTAR Y OPERAR ESTE EQUIPO.
RECUERDE QUE UN MAL USO DE SU APARATO PODRÍA ANULAR LA GARANTÍA.

¡Bienvenido!

Gracias por la adquisición de la grabadora de cassettes de Sony. Esta grabadora de cassettes está equipada con un interruptor REC TIME/PLAY MODE que permite grabar el doble de la longitud normal en cualquier cassette.

▶ Getting Started

Preparing a Power Source

Choose one of the following power sources.

Dry Batteries (see Fig. A-②)

- Open the battery compartment lid.
- Insert two R6 (size AA) batteries (not supplied) with correct polarity and close the lid.

- Notes**
- Do not charge a dry battery.
 - Do not use a new battery with an old one.
 - Do not use different types of batteries.
 - When you do not use the unit for a long time, remove the batteries to avoid any damage caused by battery leakage and subsequent corrosion.
 - Dry batteries will not be drained when another power source is connected.

When to replace the batteries (see Fig. A-③)
Replace the batteries with new ones when the lamp flashes. The BATT and lamps change as illustrated.

Notes

- During FF(CUE) or REV(REVIEW), the lamp may flash. Only when the tape does not run properly, replace the batteries.
- After the batteries have been used for a while, the BATT and lamps may flicker during playback if the volume is turned up. This is, however, not an indication for the batteries to be replaced.
- The unit will play back normally for a while even after the lamp flashes. You should, nonetheless, replace the batteries as soon as possible. Otherwise, the built-in speaker may emit a loud noise and recordings may not be made correctly.
- The lamp may flash momentarily at beginning of playback or the end of the tape. If the flashing stops right away, you do not need to replace the batteries.

Português

Grabadora portátil
POR FAVOR LEA DETALLADAMENTE ESTE MANUAL DE INSTRUCCIONES ANTES DE CONECTAR Y OPERAR ESTE EQUIPO.
RECUERDE QUE UN MAL USO DE SU APARATO PODRÍA ANULAR LA GARANTÍA.

¡Bienvenido!

Gracias por la adquisición de la grabadora de cassettes de Sony. Esta grabadora de cassettes está equipada con un interruptor REC TIME/PLAY MODE que permite grabar el doble de la longitud normal en cualquier cassette.

▶ Getting Started

Preparing a Power Source

Choose one of the following power sources.

Dry Batteries (see Fig. A-②)

- Open the battery compartment lid.
- Insert two R6 (size AA) batteries (not supplied) with correct polarity and close the lid.

- Notes**
- Do not charge a dry battery.
 - Do not use a new battery with an old one.
 - Do not use different types of batteries.
 - When you do not use the unit for a long time, remove the batteries to avoid any damage caused by battery leakage and subsequent corrosion.
 - Dry batteries will not be drained when another power source is connected.

When to replace the batteries (see Fig. A-③)
Replace the batteries with new ones when the lamp flashes. The BATT and lamps change as illustrated.

Notes

- During FF(CUE) or REV(REVIEW), the lamp may flash. Only when the tape does not run properly, replace the batteries.
- After the batteries have been used for a while, the BATT and lamps may flicker during playback if the volume is turned up. This is, however, not an indication for the batteries to be replaced.
- The unit will play back normally for a while even after the lamp flashes. You should, nonetheless, replace the batteries as soon as possible. Otherwise, the built-in speaker may emit a loud noise and recordings may not be made correctly.
- The lamp may flash momentarily at beginning of playback or the end of the tape. If the flashing stops right away, you do not need to replace the batteries.

Português

Grabadora portátil
POR FAVOR LEA DETALLADAMENTE ESTE MANUAL DE INSTRUCCIONES ANTES DE CONECTAR Y OPERAR ESTE EQUIPO.
RECUERDE QUE UN MAL USO DE SU APARATO PODRÍA ANULAR LA GARANTÍA.

¡Bienvenido!

Gracias por la adquisición de la grabadora de cassettes de Sony. Esta grabadora de cassettes está equipada con un interruptor REC TIME/PLAY MODE que permite grabar el doble de la longitud normal en cualquier cassette.

▶ Getting Started

Preparing a Power Source

Choose one of the following power sources.

Dry Batteries (see Fig. A-②)

- Open the battery compartment lid.
- Insert two R6 (size AA) batteries (not supplied) with correct polarity and close the lid.

- Notes**
- Do not charge a dry battery.
 - Do not use a new battery with an old one.
 - Do not use different types of batteries.
 - When you do not use the unit for a long time, remove the batteries to avoid any damage caused by battery leakage and subsequent corrosion.
 - Dry batteries will not be drained when another power source is connected.

When to replace the batteries (see Fig. A-③)
Replace the batteries with new ones when the lamp flashes. The BATT and lamps change as illustrated.

Notes

- During FF(CUE) or REV(REVIEW), the lamp may flash. Only when the tape does not run properly, replace the batteries.
- After the batteries have been used for a while, the BATT and lamps may flicker during playback if the volume is turned up. This is, however, not an indication for the batteries to be replaced.
- The unit will play back normally for a while even after the lamp flashes. You should, nonetheless, replace the batteries as soon as possible. Otherwise, the built-in speaker may emit a loud noise and recordings may not be made correctly.
- The

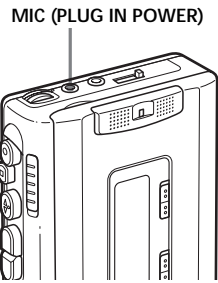
C**English**

Recording from Various Sound Sources

Connect headphones or earphones (not supplied) to monitor the recorded sound. Set VOR to suit the recording condition before recording.

Recording with an External Microphone (see Fig. C)

Connect a microphone (not supplied) to the MIC jack. There is a tactile dot beside the MIC jack.

Use a microphone of low impedance (less than 3 kΩ). When using a plug-in-power system microphone, the power to the microphone is supplied from this unit.

Note
When recording with an external microphone, the VOR system may not work properly due to difference in sensitivity.

Recording from Another Equipment

Connect another equipment to the MIC jack using a connecting cord such as the RK-G64HG (not supplied).

Playing a Tape (see Fig. D)

- 1 Insert a cassette with the side to be played facing the cassette holder.
- 2 Set REC TIME/PLAY MODE to the same position as that used for recording. To playback commercially available music tape, etc., select NORMAL.
- 3 Press **▶▶** PLAY and then adjust the volume. The **◀▶** PLAY button has a tactile dot on it and the VOL control also has a tactile dot beside it to show the direction to turn up the volume.

Playback will start from the forward side and switches automatically to the reverse side at the end of the side (Auto Reverse).

- 4 Set DPC to ON to adjust playback sound pitch (tone) automatically according to the playback speed.

Set DPC to OFF to play back with normal sound pitch.

- 5 Adjust the tape playback speed. Turn SPEED CONTROL to: SLOW (slow) to play back at a slower speed. Center position to play back at normal speed. FAST (fast) to play back at a faster speed.

At the end of the reverse side, playback stops and the unit turns off automatically.

Stop playback/stop fast forward or rewind

Pause playback

Search forward during playback (CUE)

Search backward during playback (REVIEW)

Fast forward**

Rewind**

Switch playback side

Take out a cassette

* PAUSE **⏸** will also be automatically released when **■** STOP is pressed (stop-pause-release function).

** If you leave the unit after the tape has been wound or rewound, the batteries will be consumed rapidly. Be sure to press **■** STOP.

Note on REVIEW/CUE
Playback may not start automatically even if you release **REW/REVIEW** or **FF/CUE** at the end of the tape. To start playback again, press **■** STOP, then press **◀▶** PLAY.

Notes on DPC (Digital Pitch Control)

Notes on DPC (Digital Pitch Control)

Additional Information

Precautions

On power

On the unit

- Should any solid object or liquid fall into the unit, remove the batteries or disconnect the AC power adaptor, and have the unit checked by qualified personnel before operating it any further.
- Keep personal credit cards using magnetic coding or spring-wound watches, etc. away from the unit to prevent possible damage from the magnet used in the speaker.
- If the unit has not been used for a long time, set it in the playback mode to warm it up for a few minutes before inserting a tape.

On tapes longer than 90 minutes

We do not recommend the use of tape longer than 90 minutes. They are very thin and tend to be stretched easily. This may cause malfunction of the unit or sound deterioration.

If you have any questions or problems concerning your unit, please consult your nearest Sony dealer.

Maintenance (see Fig. E)

To clean the tape heads and path

Press **◀▶** PLAY. Clean the tape head and tape path using a cotton swab and commercially available cleaning solvent after every 10 hours of use.

To clean the exterior

Use a soft cloth slightly moistened in water. Do not use alcohol, benzine or thinner.

Troubleshooting

Should any problem persist after you have made these checks, consult your nearest Sony dealer.

You cannot press ● REC.

The unit does not operate.

No sound comes from the speaker.

Tape speed is too fast or too slow in the playback mode.

Recording cannot be made.

The sound drops out or comes with excessive noise.

Recording is interrupted.

Recording cannot be erased completely.

Recording is interrupted.

Recording cannot be erased completely.

There is a clicking noise during tape operation.

Specifications

Recording system

Tape speed

Frequency range

Speaker

Power output

Input

Output

Variable range of the tape speed

Power requirements

Dimensions (w/h/d) (incl. projecting parts and controls)

Mass (main unit only)

Supplied accessory

Design and specifications are subject to change without notice.

Español

Grabación de distintas fuentes de sonido

Conecte los auriculares o los cascos (no suministrados) para supervisar el sonido grabado. Ajuste VOR en función de las condiciones en que vaya a realizar la grabación antes de comenzar a grabar.

Grabación con un micrófono externo (consulte la figura C)

Conecte un micrófono (no suministrado) a la toma MIC. Existe un punto táctil al lado de la toma MIC.

Use un micrófono de baja impedancia (inferior a 3 kΩ). Si utiliza un micrófono con sistema de alimentación por enchufe, esta unidad suministrará la alimentación al micrófono.

Nota
Al grabar con un micrófono externo, es posible que el sistema VOR no funcione correctamente debido a la diferencia en la sensibilidad.

Grabación desde otro equipo

Conecte otro equipo a la toma MIC mediante el cable de conexión, como el RK-G64HG (no suministrado).

Reproducción de una cinta (consulte la figura D)

- 1 Inserte una cinta con la cara que desee reproducir orientada hacia el portacassetes.
- 2 Ajuste REC TIME/PLAY MODE en la misma posición que la utilizada para grabar. Para reproducir cintas de música comerciales, etc., seleccione NORMAL.
- 3 Pulse **▶▶** PLAY y, a continuación, ajuste el volumen. El botón **◀▶** PLAY tiene un punto táctil justo encima y el control VOL tiene un punto táctil al lado que muestra la dirección para subir el volumen.

Playback will start from the forward side and switches automatically to the reverse side at the end of the side (Auto Reverse).

Set DPC to ON to adjust playback sound pitch (tone) automatically according to the playback speed.

Set DPC to OFF to play back with normal sound pitch.

Adjust the tape playback speed. Turn SPEED CONTROL to: SLOW (slow) to play back at a slower speed. Center position to play back at normal speed. FAST (fast) to play back at a faster speed.

At the end of the reverse side, playback stops and the unit turns off automatically.

Stop playback/stop fast forward or rewind

Pause playback

Search forward during playback (CUE)

Search backward during playback (REVIEW)

Fast forward**

Rewind**

Switch playback side

Take out a cassette

* PAUSE **⏸** will also be automatically released when **■** STOP is pressed (stop-pause-release function).

** If you leave the unit after the tape has been wound or rewound, the batteries will be consumed rapidly. Be sure to press **■** STOP.

Note on REVIEW/CUE
Playback may not start automatically even if you release **REW/REVIEW** or **FF/CUE** at the end of the tape. To start playback again, press **■** STOP, then press **◀▶** PLAY.

Notes on DPC (Digital Pitch Control)

Notes on DPC (Digital Pitch Control)

Notes on DPC (Digital Pitch Control)

Notes on DPC (Digital Pitch Control)

Notes on DPC (Digital Pitch Control)

Notes on DPC (Digital Pitch Control)

Notes on DPC (Digital Pitch Control)

Notes on DPC (Digital Pitch Control)

Notes on DPC (Digital Pitch Control)

Notes on DPC (Digital Pitch Control)

Notes on DPC (Digital Pitch Control)

Notes on DPC (Digital Pitch Control)

Notes on DPC (Digital Pitch Control)

Notes on DPC (Digital Pitch Control)

Notes on DPC (Digital Pitch Control)

Notes on DPC (Digital Pitch Control)

Notes on DPC (Digital Pitch Control)

Notes on DPC (Digital Pitch Control)

Notes on DPC (Digital Pitch Control)

Notes on DPC (Digital Pitch Control)

Notes on DPC (Digital Pitch Control)

Notes on DPC (Digital Pitch Control)

Notes on DPC (Digital Pitch Control)

Notes on DPC (Digital Pitch Control)

Notes on DPC (Digital Pitch Control)

Notes on DPC (Digital Pitch Control)

Notes on DPC (Digital Pitch Control)

Notes on DPC (Digital Pitch Control)

Notes on DPC (Digital Pitch Control)

Notes on DPC (Digital Pitch Control)

Notes on DPC (Digital Pitch Control)

Notes on DPC (Digital Pitch Control)

Notes on DPC (Digital Pitch Control)

Notes on DPC (Digital Pitch Control)

Notes on DPC (Digital Pitch Control)

Notes on DPC (Digital Pitch Control)

Notes on DPC (Digital Pitch Control)

Notes on DPC (Digital Pitch Control)

Notes on DPC (Digital Pitch Control)

Notes on DPC (Digital Pitch Control)

Notes on DPC (Digital Pitch Control)

Notes on DPC (Digital Pitch Control)

Notes on DPC (Digital Pitch Control)

Notes on DPC (Digital Pitch Control)

Notes on DPC (Digital Pitch Control)

Notes on DPC (Digital Pitch Control)

Notes on DPC (Digital Pitch Control)

Notes on DPC (Digital Pitch Control)

Notes on DPC (Digital Pitch Control)

Notes on DPC (Digital Pitch Control)

Notes on DPC (Digital Pitch Control)

Notes on DPC (Digital Pitch Control)

Notes on DPC (Digital Pitch Control)

Notes on DPC (Digital Pitch Control)

Notes on DPC (Digital Pitch Control)

Notes on DPC (Digital Pitch Control)

Notes on DPC (Digital Pitch Control)

Notes on DPC (Digital Pitch Control)

Notes on DPC (Digital Pitch Control)

Notes on DPC (Digital Pitch Control)

Notes on DPC (Digital Pitch Control)

Notes on DPC (Digital Pitch Control)

Notes on DPC (Digital Pitch Control)

Notes on DPC (Digital Pitch Control)

Notes on DPC (Digital Pitch Control)

Notes on DPC (Digital Pitch Control)

Notes on DPC (Digital Pitch Control)

Notes on DPC (Digital Pitch Control)

Notes on DPC (Digital Pitch Control)

Notes on DPC (Digital Pitch Control)

Notes on DPC (Digital Pitch Control)

Notes on DPC (Digital Pitch Control)

Notes on DPC (Digital Pitch Control)

Notes on DPC (Digital Pitch Control)

Notes on DPC (Digital Pitch Control)

Notes on DPC (Digital Pitch Control)

Notes on DPC (Digital Pitch Control)

Notes on DPC (Digital Pitch Control)

Notes on DPC (Digital Pitch Control)

Notes on DPC (Digital Pitch Control)

Notes on DPC (Digital Pitch Control)

Notes on DPC (Digital Pitch Control)

Notes on DPC (Digital Pitch Control)

Notes on DPC (Digital Pitch Control)

Notes on DPC (Digital Pitch Control)

Notes on DPC (Digital Pitch Control)

Notes on DPC (Digital Pitch Control)

Notes on DPC (Digital Pitch Control)

Notes on DPC (Digital Pitch Control)

Notes on DPC (Digital Pitch Control)

Notes on DPC (Digital Pitch Control)

Notes on DPC (Digital Pitch Control)

Notes on DPC (Digital Pitch Control)

Notes on DPC (Digital Pitch Control)

Notes on DPC (Digital Pitch Control)

Notes on DPC (Digital Pitch Control)

Notes on DPC (Digital Pitch Control)

Notes on DPC (Digital Pitch Control)

Notes on DPC (Digital Pitch Control)

Notes on DPC (Digital Pitch Control)

Notes on DPC (Digital Pitch Control)

Notes on DPC (Digital Pitch Control)

Notes on DPC (Digital Pitch Control)

Notes on DPC (Digital Pitch Control)

Notes on DPC (Digital Pitch Control)

Notes on DPC (Digital Pitch Control)

Notes on DPC (Digital Pitch Control)

Notes on DPC (Digital Pitch Control)

Notes on DPC (Digital Pitch Control)

Notes on DPC (Digital Pitch Control)

Notes on DPC (Digital Pitch Control)

Notes on DPC (Digital Pitch Control)

Notes on DPC (Digital Pitch Control)

Notes on DPC (Digital Pitch Control)

Notes on DPC (Digital Pitch Control)

Notes on DPC (Digital Pitch Control)

Notes on DPC (Digital Pitch Control)

Notes on DPC (Digital Pitch Control)

Notes on DPC (Digital Pitch Control)

Notes on DPC (Digital Pitch Control)

Notes on DPC (Digital Pitch Control)

Notes on DPC (Digital Pitch Control)

Notes on DPC (Digital Pitch Control)

Notes on DPC (Digital Pitch Control)

Notes on DPC (Digital Pitch Control)

Notes on DPC (Digital Pitch Control)

Notes on DPC (Digital Pitch Control)

Notes on DPC (Digital Pitch Control)

Notes on DPC (Digital Pitch Control)

Notes on DPC (Digital Pitch Control)

Notes on DPC (Digital Pitch Control)

Notes on DPC (Digital Pitch Control)

Notes on DPC (Digital Pitch Control)

Notes on DPC (Digital Pitch Control)

Notes on DPC (Digital Pitch Control)

Notes on DPC (Digital Pitch Control)

Notes on DPC (Digital Pitch Control)

Notes on DPC (Digital Pitch Control)

Notes on DPC (Digital Pitch Control)

Notes on DPC (Digital Pitch Control)

Notes on DPC (Digital Pitch Control)

Notes on DPC (Digital Pitch Control)

Notes on DPC (Digital Pitch Control)

Notes on DPC (Digital Pitch Control)

Notes on DPC (Digital Pitch Control)

Notes on DPC (Digital Pitch Control)

Notes on DPC (Digital Pitch Control)

Notes on DPC (Digital Pitch Control)

Notes on DPC (Digital Pitch Control)

Notes on DPC (Digital Pitch Control)

Free Manuals Download Website

<http://myh66.com>

<http://usermanuals.us>

<http://www.somanuals.com>

<http://www.4manuals.cc>

<http://www.manual-lib.com>

<http://www.404manual.com>

<http://www.luxmanual.com>

<http://aubethermostatmanual.com>

Golf course search by state

<http://golfingnear.com>

Email search by domain

<http://emailbydomain.com>

Auto manuals search

<http://auto.somanuals.com>

TV manuals search

<http://tv.somanuals.com>