

Radio Cassette Player

Operating Instructions

WALKMAN

WALKMAN is a registered trademark of Sony Corporation.

WM-FX487/FX485/FX483

Sony Corporation © 1998 Printed in Malaysia

For the customers in the U.S.A.

OWNER'S RECORD

The model number is located at the bottom and the serial number is located inside the cassette holder. Record the model and serial numbers in the spaces provided below. Refer to these numbers whenever you call upon your Sony dealer regarding this product.

Model No. _____ Serial No. _____

INFORMATION

This equipment has been tested and found to comply with the limits for a Class B digital device, pursuant to Part 15 of the FCC Rules. These limits are designed to provide reasonable protection against harmful interference in a residential installation. This equipment generates, uses, and can radiate radio frequency energy and, if not installed and used in accordance with the instructions, may cause harmful interference to radio communications. However, there is no guarantee that interference will not occur in a particular installation. If this equipment does cause harmful interference to radio or television reception, which can be determined by turning the equipment off and on, the user is encouraged to try to correct the interference by one or more of the following measures:

- Reorient or relocate the receiving antenna.
- Increase the separation between the equipment and receiver.
- Connect the equipment into an outlet on a circuit different from that to which the receiver is connected.
- Consult the dealer or an experienced radio/TV technician for help.

This device complies with Part 15 of the FCC Rules. Operation is subject to the following two conditions:

- (1) This device may not cause harmful interference, and
- (2) this device must accept any interference received, including interference that may cause undesired operation.

You are cautioned that any changes or modifications not expressly approved in this manual could void your authority to operate this equipment.

About This Manual

The instructions in this manual are for WM-FX487, WM-FX485 and WM-FX483. Before you start reading, check your model number. WM-FX487 is the model used for illustration purposes. Any differences in operation are clearly indicated in the text, for example, "FX487 only".

▶ Getting Started

Preparing a Power Source

Dry Battery

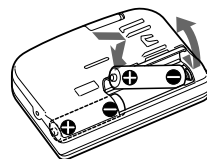

Open the battery compartment lid, and insert two size AA (R6) dry batteries with correct polarity.

If the battery compartment lid comes off

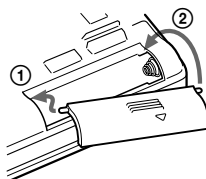

When to replace the batteries

Replace the batteries when "□" flashes in the display. The battery remainder mark has 3 steps to show the remaining battery power.

The battery power is full.



The battery power is decreasing.



The batteries are exhausted. Replace them with new ones.



Notes

- The battery remainder mark may temporarily show a lower level during fast forwarding or rewinding or use in extremely low temperatures.
- When replacing batteries, replace both batteries within 30 seconds; otherwise all the memories including the preset radio stations will be canceled.

Battery life (Approx. hours)	(EIAJ*)	
	Tape playback	Radio reception
Sony alkaline LR6 (SG)	24	38
Sony R6P (SR)	7.5	14

* Measured value by the standard of EIAJ (Electronic Industries Association of Japan). (Using a Sony HF series cassette tape)

Note

- The battery life may shorten depending on the operation of the unit.

For maximum performance we recommend that you use alkaline batteries.

House Current

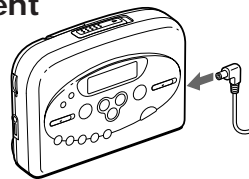

Connect the AC power adaptor AC-E30HG (not supplied) to the DC IN 3 V jack and to the mains. Do not use any other AC power adaptor. Specifications for AC-E30HG varies for each area. Check your local voltage and the shape of plug before purchasing.



To use the belt clip

With the supplied belt clip, you can wear your Walkman on a belt for convenient use.

To remove the belt clip

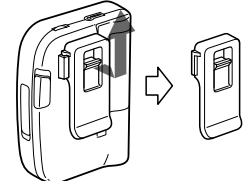

To attach the belt clip

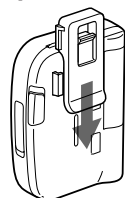

Connecting the Headphones/ Earphones

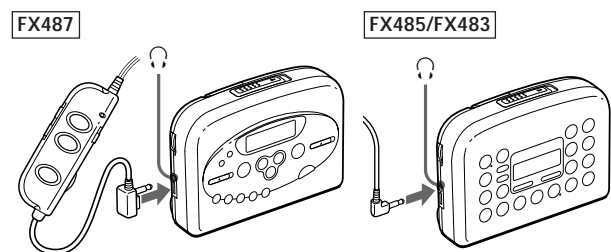

1 Connect the headphones/earphones to .

2 Wear the "L" marked side to the left ear and the "R" marked side to the right ear. If the earphones do not fit to your ears or the sound is unbalanced, turn round the earphones a little to fit to your ears firmly.

▶ Operating the Walkman

Playing a Tape

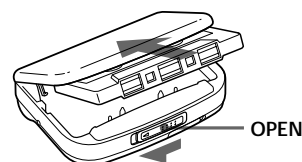

1 Open the cassette holder and insert a cassette.

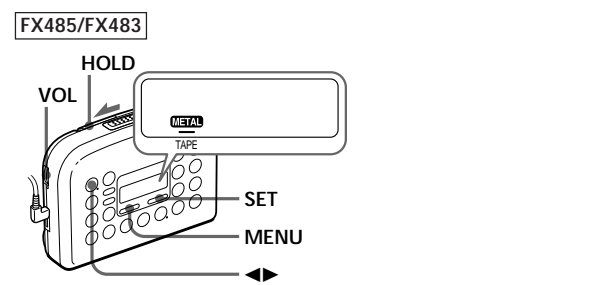
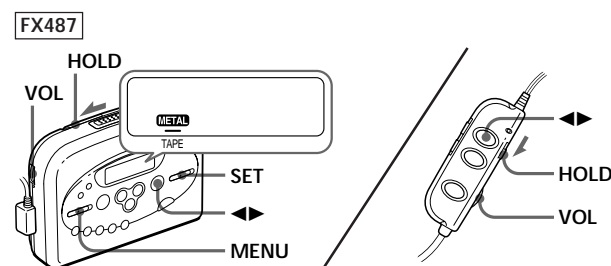

2 Make sure the HOLD function is turned off. If it is on, slide the HOLD switch to turn it off.

3 Press MENU repeatedly to set the cursor to TAPE in the display. Then press SET to select the tape type. No message: normal (TYPE I) METAL: CrO₂ (TYPE II) or metal (TYPE IV)

4 Press (play) to start playing then adjust the volume.

When adjusting the volume on the Walkman (FX487 only)

Set the VOL control on the remote control at maximum.

When adjusting the volume on the remote control (FX487 only)

Set the VOL control on the Walkman slightly above the appropriate level.

Note on the cassette holder

When opening the cassette holder, press the (stop) button and make sure the tape is stopped by checking through the cassette window, then slide the OPEN switch. If the cassette holder is opened before the tape is stopped, the tape may loosen and be damaged.

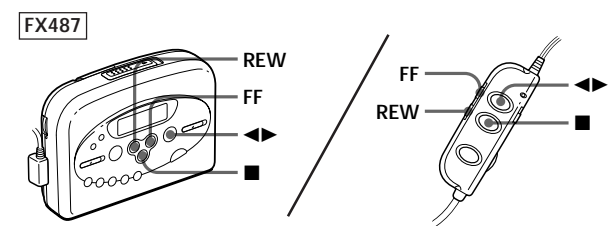

FX485/FX483

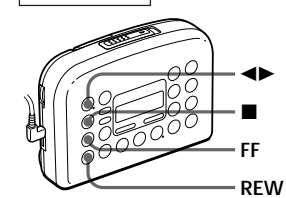

To	Press
play the other side	(play) during playback
stop playback	
fast forward	FF during stop
rewind	REW during stop
play the same side from the beginning (Rewind Auto Play function)	REW during playback
play the other side from the beginning (Skip Reverse function)	FF during playback

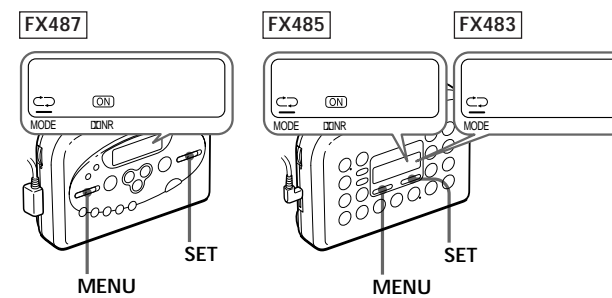

To select playback mode

Press MENU repeatedly to set the cursor to MODE in the display. Then press SET to select the desired mode.

To play	Select
Both sides repeatedly	
Both sides once from the side facing the cassette holder	

To play a tape recorded with Dolby* NR system (FX487/FX485 only)

Press MENU repeatedly to set the cursor to NR (Dolby noise reduction) in the display. Then press SET to show "ON".

* Dolby noise reduction manufactured under license from Dolby Laboratories Licensing Corporation. "DOLBY" and the double-D symbol are trademarks of Dolby Laboratories Licensing Corporation.

Listening to the Radio

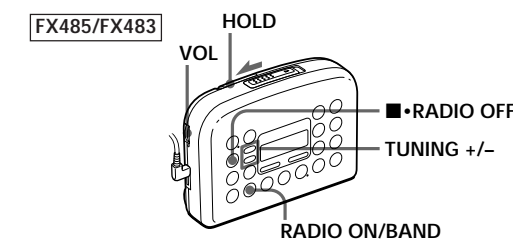
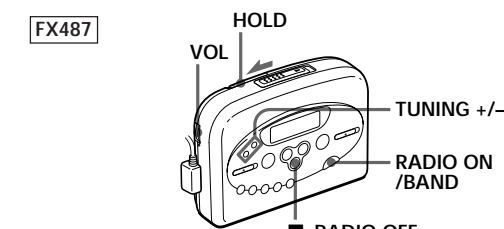

1 Make sure the HOLD function is turned off. If it is on, slide the HOLD switch to turn it off.

2 Press RADIO ON/BAND to turn on the radio.

3 Press RADIO ON/BAND repeatedly to select FM1, FM2, FM3 or AM.

4 Press TUNING+/- to tune in to the desired station. If you keep pressing TUNING+/- for a few seconds, the Walkman will start tuning to the stations automatically.

To turn off the radio

Press •RADIO OFF .

To improve the broadcast reception

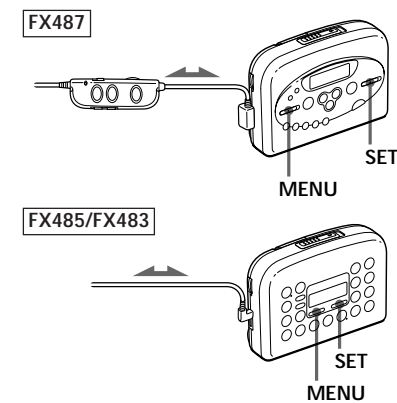

• For FM: Extend the cord of the remote control, the aerial (FX487 only). Extend the headphones/earphones cord, the aerial (FX485/FX483 only). If the reception is still not good, press MENU repeatedly to set the cursor to FM MODE or FM SENS in the display. Then press SET to choose the mode for best reception.

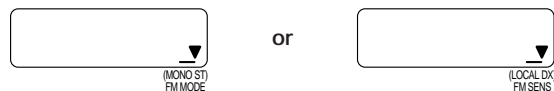

• For AM: The Walkman has a built-in antenna. Reorient the Walkman horizontally to obtain optimum AM reception.

Note

• Do not remove the power sources while listening to the radio, or the received stations may not be stored.

Presetting Radio Stations

You can store radio stations into the unit's memory. You can preset up to 20 radio stations, 5 for each FM1, FM2, FM3 or AM bands.

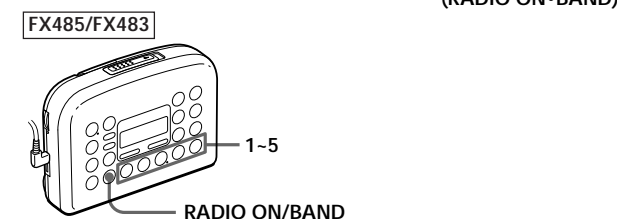
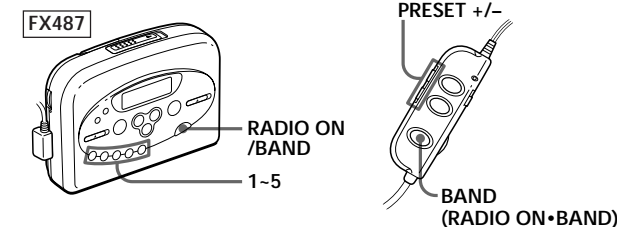

1 Tune in the station you wish to store. (Follow steps 1-4 in "Listening to the Radio".)

2 Press and hold one of the 1-5 buttons for more than 2 seconds. The display flashes twice with a beep sound, and the station is preset. If a station is already stored, and the new station replaces the old one.

To play the preset radio stations

- 1 Press RADIO ON/BAND to select the band.
- 2 Press the corresponding button (1-5) on the unit. Or press PRESET+/- on the remote control (FX487 only).

Receiving Stations Outside Your Country (Excluding models for Europe and Saudi Arabia)

The frequency range differs depending on the area (see the chart "Area indication and frequency range"). If you listen to the radio in an area of different frequency range, change the area indication in the display.

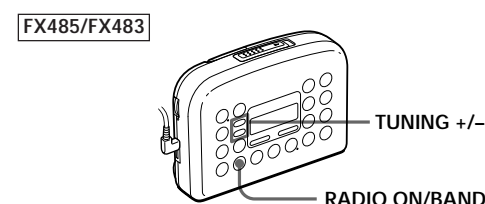
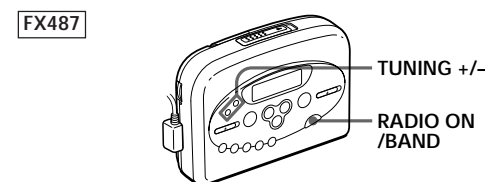

1 Turn on the radio and press RADIO ON/BAND for more than 10 seconds until the area indication flashes in the display.

2 While the display is flashing, press TUNING+/- to select either "U" or "E" indication.

3 Press RADIO ON/BAND to set the area indication.

Note

• If you change the frequency range, all the preset stations will be canceled.

Area indication and frequency range

Area*	Frequency range FM (MHz)	AM (kHz)
E	87.5-108	531-1,602
U	87.5-108	530-1,710

* E: European and other countries

U: USA, Canada, and Central and South America

Using Other Functions

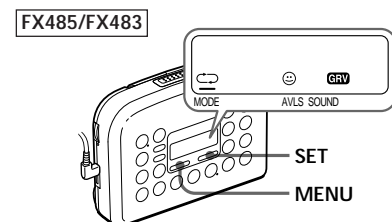
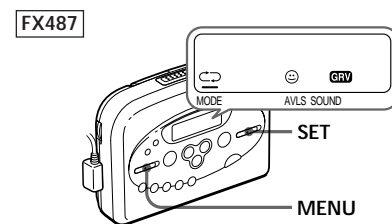

To emphasize bass sound

Press MENU repeatedly to set the cursor to SOUND in the display. Then, press SET to select the desired mode. With each press, the indications change as follows. MB (MEGA BASS) : emphasizes bass sound GRV (GROOVE) : emphasizes deeper bass sound No message: off (normal)

Notes

- If the sound is distorted with the mode "GRV", select the mode "MB" or no message.
- Bass emphasis may not show great effect if the volume is turned up too high.

To protect your hearing—AVLS (Automatic Volume Limiter System)

When you set the AVLS function to active, the maximum volume is kept down to protect your ears.

Press MENU repeatedly to set the cursor to AVLS in the display. Then press SET to show "☺".

Notes

- If the sound is distorted when you listen to the bass-boosted sound with the AVLS function, turn down the volume.
- The AVLS setting may be canceled when you replace the batteries.

To lock the controls

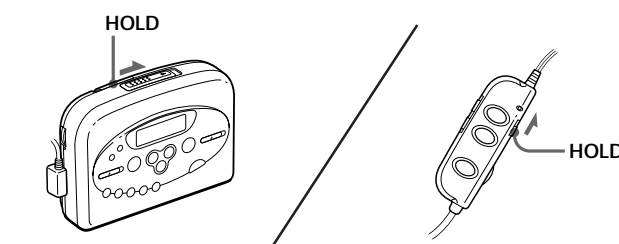

Set the HOLD switch to the direction of the arrow to lock the controls.

►Additional Information

Precautions

On batteries

- Do not charge a dry battery.
- Do not carry the dry or rechargeable batteries with coins or other metallic objects. It can generate heat if the positive and negative terminals of the batteries are accidentally contacted by a metallic object.
- When you do not use the Walkman for a long time, remove the battery to avoid any damage caused by battery leakage and subsequent corrosion.

On the unit

- Do not drop the unit or give a shock to the unit, or it may cause a malfunction.
- Do not leave the unit in a location near heat sources, or in a place subject to direct sunlight, excessive dust or sand, moisture, rain, mechanical shock, or in a car with its windows closed.
- The LCD display may become hard to see or slow down when using the unit at high temperatures (above 40°C/104°F) or at low temperatures (below 0°C/32°F). At room temperature, the display will return to its normal operating condition.
- If the unit has not been used for long, set it in the playback mode and warm it up for a few minutes before inserting a tape.

On tapes longer than 90 minutes

We do not recommend the use of tapes longer than 90 minutes except for a long continuous playback. They are very thin and tend to be stretched easily.

On the remote control (FX487 only)

Use the supplied remote control only with this unit.

On headphones/earphones

Road safety

Do not use headphones/earphones while driving, cycling, or operating any motorized vehicle. It may create a traffic hazard and is illegal in some areas. It can also be potentially dangerous to play your headphones/earphones at high volume while walking, especially at pedestrian crossings. You should exercise extreme caution or discontinue use in potentially hazardous situations.

Preventing hearing damage

Do not use headphones/earphones at high volume. Hearing experts advise against continuous, loud and extended play. If you experience a ringing in your ears, reduce volume or discontinue use.

Caring for others

Keep the volume at a moderate level. This will allow you to hear outside sounds and to be considerate to the people around you.

If you have any questions or problems concerning your unit, please consult your nearest Sony dealer.

Troubleshooting

The volume cannot be turned up.

- If "☺" appears for AVLS display, press SET so that "☺" disappears.

The sound is unstable or no audio.

- Insert two R6 (size AA) batteries properly.
- Replace all batteries if they are weak.

The display shows incorrect information.

- The batteries are weak. Replace the batteries with new ones.

Specifications

Radio section

Frequency range

- FM: 65-74/87.5-108 MHz (Eastern Europe) 87.5-108 MHz (other countries)
- AM: 530-1,710 kHz (North, Central and South America) 531-1,602 kHz (other countries)

Tape section

Frequency response (Dolby NR off)

Playback: 30-14,000 Hz

Output

Headphones/earphones (⌀ jack)
Load impedance 8-300 ohms

General

Power requirements

3 V
Two size AA (R6) batteries

Dimensions (w/h/d)

FX487:
Approx. 115.5 x 83.5 x 35.5 mm (4 5/8 x 3 3/8 x 1 1/16 inches) incl. projecting parts and controls
FX485/FX483:
Approx. 115.5 x 83.5 x 34.0 mm (4 5/8 x 3 3/8 x 1 3/8 inches) incl. projecting parts and controls

Mass

Approx. 150 g (5.3 oz)/Approx. 230 g (8.2 oz) incl. batteries and a cassette

Supplied accessories

Stereo headphones or Stereo earphones with remote control (1) (FX487 only)
Stereo headphones or Stereo earphones (1) (FX485/FX483 only)
Belt clip (1)

Design and specifications are subject to change without notice.

Maintenance

To clean the tape head and path

Use the cleaning cassette CHK-1 (not supplied) every 10 hours of use.

Note

- Use only the recommended cleaning cassette.

To clean the exterior

Use a soft cloth slightly moistened with water. Do not use alcohol, benzine or thinner.

Note

- Clean the headphones/earphones plug periodically.

For the customers in the U.S.A.

Free Manuals Download Website

<http://myh66.com>

<http://usermanuals.us>

<http://www.somanuals.com>

<http://www.4manuals.cc>

<http://www.manual-lib.com>

<http://www.404manual.com>

<http://www.luxmanual.com>

<http://aubethermostatmanual.com>

Golf course search by state

<http://golfingnear.com>

Email search by domain

<http://emailbydomain.com>

Auto manuals search

<http://auto.somanuals.com>

TV manuals search

<http://tv.somanuals.com>