

## A

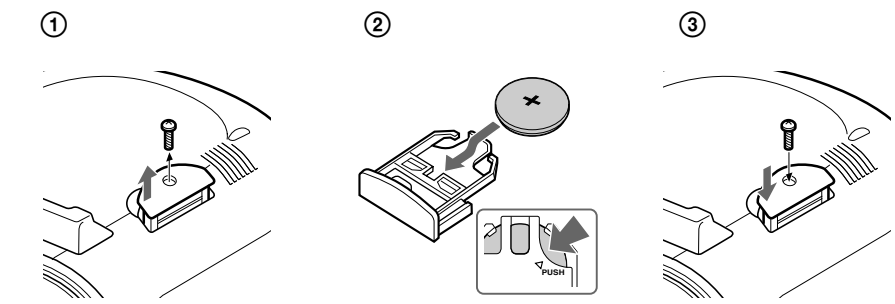

## About the backup battery

To keep good time, as backup power source, this unit has one CR2032 battery inside of the unit in addition to the house current. The battery keeps the clock and the alarm operating in the event of a power interruption.

## Knowing when to replace the battery

When the battery becomes weak, "⏻" indicator appears in the display. In the event of a power interruption when the battery is weak, current time and alarm functions will be initialized.

## Installing and replacing the backup battery

- 1 Keep the AC plug connected to the AC outlet, remove the screw that secures the battery compartment at the bottom of the unit using a screwdriver, and remove the battery compartment. (See Fig. A-①)
- 2 Insert a new battery in the battery compartment with the + side facing up. To remove the battery from the battery compartment, push it out from the side marked PUSH. (See Fig. A-②)
- 3 Insert the battery compartment back into the unit and secure it with the screw. (See Fig. A-③)
- 4 When you are replacing the battery, press **RADIO ON** to turn "⏻" indicator off in the display.

**Note**  
If you replace the battery, do not disconnect AC plug from AC outlet. Otherwise, current time and alarm will be initialized.

- NOTES ON LITHIUM BATTERY**
- Dispose of used battery promptly. Keep the lithium battery out of the reach of children. Should the battery be swallowed, immediately consult a doctor.
  - Wipe the battery with a dry cloth to assure a good contact.
  - Be sure to observe the correct polarity when installing the battery.
  - Do not hold the battery with metallic tweezers, otherwise a short-circuit may occur.
  - Do not expose the battery to excessive heat such as direct sunlight, fire or the like.

**Battery Warning**  
When the unit will be left unplugged for a long time, remove the battery to avoid undue battery discharge and damage to the unit from battery leakage.

## Setting the clock for the first time

This unit is preset to the current date and time at the factory, and is powered by the back up battery. All you need to do the first time is just plug it in and select your time zone.

- 1 Plug in the unit. "month and date" (about 1 second) → "year" (about 1 second) → "the current EST/EDT (Eastern Standard/Daylight Time)" appears in the display.
- 2 Press **TIME ZONE**. Area number "2" appears in the display. If you live in the Eastern Time zone, you do not need to adjust the area setting.

Area number	Time zone
1	Atlantic Standard/Daylight Time
2	Eastern Standard/Daylight Time (default)
3	Central Standard/Daylight Time
4	Mountain Standard/Daylight Time
5	Pacific Standard/Daylight Time
6	Yukon Standard/Daylight Time
7	Hawaiian Standard/Daylight Time

- 3 Press **TIME ZONE** repeatedly until the desired number appears. The display returns to the clock about 4 seconds after the operation is complete.

**Note**  
During the shipment and your first use, a clock error may occur. In this case, refer to "Setting the clock and date" to set the correct time.

## When daylight saving time (summer time) begins

The following models employ the Automatic Daylight Saving Time/Summer Time adjustment. The DST indicator in the display appears in the display at the beginning of the daylight saving time (summer time), and disappears at the end of it.

- Daylight saving time begins at: 2:00 AM on the second Sunday of March.
- Standard time begins at: 2:00 AM on the first Sunday of November.

## To cancel the Automatic DST/ Summer Time adjustment and to set DST display manually

The Automatic DST/Summer Time adjustment can be cancelled. Press and hold **DST** for more than 3 seconds while the clock is displayed. A beep sounds, and "Aut → OFF" appears in the display to show that the Automatic DST/Summer Time adjustment is cancelled. The display returns to the clock.

- Notes**
- The change timing of Automatic DST/Summer Time adjustment employed by the unit (see above) is subjected to variation by circumstances and the law in each country/region. In such a case, cancel the Automatic DST/Summer Time adjustment and set DST display manually as necessary. The customer who lives in the country/region that has not introduced the daylight saving time (summer time) must cancel Automatic DST/Summer Time adjustment before using the set.
  - To activate the Automatic DST/Summer Time adjustment again, press and hold **DST** for more than 3 seconds. A beep sounds, and "Aut → On" appears in the display to show that the Automatic DST/Summer Time adjustment is activated. The display returns to the clock.
  - To change the display to the daylight saving time (summer time) manually, see "To change the display to the daylight saving time (summer time) indication."

## Setting the clock and date

To change the setting manually, follow the procedure from step 1.

- 1 Press **CLOCK** for more than 2 seconds. You will hear a beep and the year will start to flash in the display.
- 2 Press + or - until the correct year appears in the display.
- 3 Press **CLOCK**.
- 4 Repeat steps 2 and 3 to set the month, day and time. After setting the time, two short beep sound and the clock starts from 0 seconds.

- Pressing and holding + or - changes the year, month or day rapidly. When setting the current time, time changes rapidly by 1 minute-increments up to 10 minutes, and then by 10 minute-increments.
- While setting the clock, you must perform each step within 65 seconds, or the clock setting mode will be cancelled.

## To display the year and date

Press **SNOOZE/DATE/SLEEP OFF** once for the date, and within about 3 seconds press it again for the year. The display shows the date or year for about 3 seconds and then changes back to the current time. If you connect the AC plug to AC outlet while this unit is powered from the backup power source, the current date and time appears in the following order. (It is same as when the unit is powered on after the power failure.) "month and date" (about 1 second) → "year" (about 1 second) → "current time"

## To change the display to the daylight saving time (summer time) indication

Change the daylight saving time (summer time) adjustment setting according to the following procedures if you have cancelled the Automatic DST/Summer Time adjustment.

Press **DST**. DST indicator appears in the display and the time indication changes to the daylight saving time (summer time). To deactivate the daylight saving time (summer time) adjustment, press **DST** again.

## Setting the brightness of the display

Three levels of brightness are available by pressing **BRIGHTNESS**.

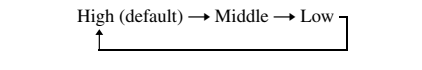

## Playing the radio

- 1 Press **RADIO ON** to turn on the radio.
- 2 Adjust volume using **VOLUME**.
- 3 Select **BAND**.
- 4 Tune in to a station using **TUNING**.

## To turn off the radio

Press **RADIO OFF/ALARM RESET**.

## Improving the reception

**FM:**  
The AC power cord functions as an FM antenna. Extend the AC power cord fully to increase reception sensitivity.

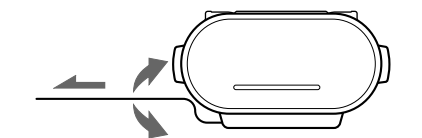

**AM:**  
Rotate the unit horizontally for optimum reception. A ferrite bar AM antenna is built-in to the unit.

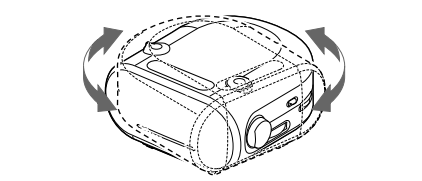

Do not operate the unit over a steel desk or metal surface, as this may lead to interference of reception.

## Setting the alarm

The dual alarm function allows you to set two alarm programs (ALARM A and ALARM B). The alarm time can be set for each program and the alarm sound is selectable from RADIO or BUZZER.

- Notes**
- Before setting the alarm, make sure to set the clock (see "Setting the clock and date").
  - The factory setting alarm time is "PM 12:00".
  - To set the radio alarm, first tune in to a station and adjust the volume (see "Playing the radio").
  - When you set the buzzer alarm, set **ALARM VOLUME** to **LOW** or **HIGH**.

## To set the alarm time

- 1 Set **ALARM A (or B)** to the desired alarm sound (**RADIO** or **BUZZER**). The alarm time appears for a few seconds, and then the **ALARM** A (or B) indicator lights up in the display. (It does not appear when the switch is set to **OFF**.)
- 2 Turn **ALARM TIME SET A (or B) +** or **-** to set the desired time. Each turn of **ALARM TIME SET A (or B) +** or **-** changes the indication by 1 minute. If you turn and hold **ALARM TIME SET A (or B) +** or **-**, the alarm time goes forward (or backward) by 1 minute up to 10 minutes, and then by 10 minutes increments. While setting the alarm time, the **ALARM** A (or B) indicator flashes in the display. The following example is when setting the ALARM A.

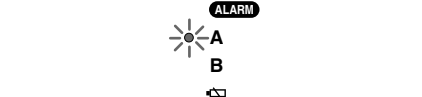

When the alarm time setting operation is complete, the display returns to the clock after a few seconds and the **ALARM** A (or B) indicator changes from flashing to fully lit.

- While **ALARM A (or B)** is set to **RADIO** or **BUZZER**, the alarm time setting can be changed by **ALARM TIME SET A (or B)**. One turn of **ALARM TIME SET A (or B)** displays the alarm time for about 4 seconds. By turning **ALARM TIME SET A (or B)** while the alarm time appears in the display, the alarm time will be changed.
- The **ALARM** A (or B) indicator flashes in the display while:
  - The alarm time appears in the display.
  - The alarm sounds.
  - Snooze function is turned on.
- The alarm time setting cannot be changed if **ALARM A (or B)** is set to **OFF**. If **ALARM TIME SET A (or B)** is turned, "OFF" appears in the display for about 0.5 seconds.
- If a second alarm sounds during a first (or the snooze function is active), the second alarm takes priority.

- **CLOCK**, **DST**, and **TIME ZONE** are unavailable while the alarm sounds or snooze function is turned on.
- The **ALARM VOLUME** setting works together with the beep sound volume. If the **ALARM VOLUME** is set to **LOW**, the beep sound will be also set to low.
- The alarm function works as usual at the beginning and end day of the daylight saving time (summer time). While the Automatic DST/Summer Time adjustment is set, as a result, if the alarm is set at a time skipped when the daylight saving time (summer time) begins, the alarm is skipped, or if the alarm is set at a time overlapped when the daylight saving time (summer time) ends, the alarm sounds twice.
- If the same alarm time is set for both alarm (ALARM A and B), the ALARM A takes priority.

## To doze for a few more minutes

Press **SNOOZE/DATE/SLEEP OFF**. The sound turns off but will automatically come on again after about 10 minutes. Each time you press **SNOOZE/DATE/SLEEP OFF**, the snooze time changes as follows:

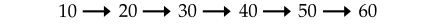

The maximum length of the snooze time is 60 minutes. The display shows the snooze time for about 4 seconds and returns to show the current time. When you press **SNOOZE/DATE/SLEEP OFF** after the current time appears, the snooze time starts from 10 minutes again.

## To stop the Alarm

Press **RADIO OFF/ALARM RESET** to turn off the alarm. The alarm will come on again at the same time the next day. If **RADIO OFF/ALARM RESET** is not pressed, the alarm sounds continuously for about 60 minutes, and then it will be stop automatically.

## To deactivate the Alarm

Turn **ALARM A (or B)** to **OFF**. **ALARM** A (or B) indicator disappears from the display.

## Note on alarm in the event of a power interruption

In the event of a power interruption, alarm functions work until the battery is empty. But following functions are different:

- Display will disappear.
- When the alarm sound is set to RADIO, it will change to BUZZER automatically.
- If the power returns while the alarm sounds, the alarm sounds continuously for about 60 minutes when the power returns.
- The alarm buzzes for about one minute, stops temporarily, and will buzz again after about five minutes if neither **SNOOZE/DATE/SLEEP OFF** or **RADIO OFF/ALARM RESET** are pressed while the alarm is buzzing. If the alarm buzzes and stops (either automatically after 1 minute or by pressing **SNOOZE/DATE/SLEEP OFF**) five times, the alarm is automatically reset in the case of a power interruption. The alarm will buzz for 30 minutes after power is resumed if the power is resumed within 60 minutes from the alarm time.
- If you press **SNOOZE/DATE/SLEEP OFF** while the alarm sounds, snooze time is set to 10 minutes. During a power failure, snooze time cannot be set to more than 10 minutes.
- If "⏻" indicator appears in the display, the alarm will not work in the event of power interruption. Replace the battery if "⏻" indicator appears.

## Setting the sleep timer

You can fall asleep to the radio using the built-in sleep timer that turns off the radio automatically after a preset duration.

Press **SLEEP**. The radio turns on. You can set the sleep timer to durations of 90, 60, 30, or 15 minutes. Each press changes the display as follows:

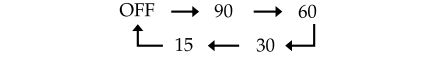

Two short beeps sound when the display returns to "90". The radio will play for the duration you set, then shut off.

## To turn off the radio before the preset time

Press **RADIO OFF/ALARM RESET** or **SNOOZE/DATE/SLEEP OFF**.

## To use both sleep timer and alarm

You can fall asleep to the radio and also be awakened by the radio or buzzer alarm at the preset time.

- 1 Set the alarm. (See "Setting the alarm".)
- 2 Set the sleep timer. (See "Setting the sleep timer".)

## Free Manuals Download Website

<http://myh66.com>

<http://usermanuals.us>

<http://www.somanuals.com>

<http://www.4manuals.cc>

<http://www.manual-lib.com>

<http://www.404manual.com>

<http://www.luxmanual.com>

<http://aubethermostatmanual.com>

Golf course search by state

<http://golfingnear.com>

Email search by domain

<http://emailbydomain.com>

Auto manuals search

<http://auto.somanuals.com>

TV manuals search

<http://tv.somanuals.com>