

# Personal Audio Docking System

## Operating Instructions

RDP-X80iP



©2010 Sony Corporation Printed in China

<http://www.sony.net/>



### WARNING

To reduce the risk of fire or electric shock, do not expose this apparatus to rain or moisture.

To reduce the risk of fire, do not cover the ventilation of the apparatus with newspapers, tablecloths, curtains, etc. And do not place lighted candles on the apparatus.

To reduce the risk of fire or electric shock, do not expose this apparatus to dripping or splashing, and do not place objects filled with liquids, such as vases, on the apparatus.

Do not install the appliance in a confined space, such as a bookcase or built-in cabinet.

Do not expose the batteries (battery pack or batteries installed) to excessive heat such as sunshine, fire or the like for a long time.

As the main plug is used to disconnect the unit from the mains, connect the unit to an easily accessible AC outlet. Should you notice an abnormality in the unit, disconnect the main plug from the AC outlet immediately.

The unit is not disconnected from the AC power source (mains) as long as it is connected to the wall outlet, even if the unit itself has been turned off.

The nameplate and important information concerning safety are located on the bottom exterior of main unit and on the surface of AC power adaptor.

#### CAUTION

Danger of explosion if battery is incorrectly replaced. Replace only with the same type.

**Notice for customers: the following information is only applicable to equipment sold in countries applying EU directives**

The manufacturer of this product is Sony Corporation, 1-7-1 Konan Minato-ku Tokyo, 108-0075 Japan. The Authorized Representative for EMC and product safety is Sony Deutschland GmbH, Hedelfinger Strasse 61, 70327 Stuttgart, Germany. For any service or guarantee matters please refer to the addresses given in separate service or guarantee documents.

The validity of the CE marking is restricted to only those countries where it is legally enforced, mainly in the countries EEA (European Economic Area).

### Features

- Compatible with iPod/iPhone
- Rechargeable battery for portable use
- Audio in function
- Wireless remote commander supplied

### Precautions

- Operate the unit on the power source specified in "Specifications."
- To disconnect the AC power cord (mains lead), pull it out by the plug, not the cord.
- Since a strong magnet is used for the speaker, keep personal credit cards using magnetic coding or spring-wound watches away from the unit to prevent possible damage from the magnet.
- Do not leave the unit in a location near a heat source such as a radiator or a duct, or in a place subject to direct sunlight, excessive dust, mechanical vibration, or shock.
- Allow adequate air circulation to prevent internal heat build-up. Do not place the unit on a surface (a rug, a blanket, etc.) or near materials (a curtain) which might block the ventilation holes.
- Should any solid object or liquid fall into the unit, unplug the unit and have it checked by qualified personnel before operating it any further.
- To clean the casing, use a soft cloth dampened with a mild detergent solution.

#### NOTES ON LITHIUM BATTERY

- Wipe the battery with a dry cloth to assure a good contact.
- Be sure to observe the correct polarity when installing the battery.
- Do not hold the battery with metallic tweezers, otherwise a short-circuit may occur.



Disposal of Old Electrical & Electronic Equipment (Applicable in the European Union and other European countries with separate collection systems)

This symbol on the product or on its packaging indicates that this product shall not be treated as household waste. Instead it shall be handed over to the applicable collection point for the recycling of electrical and electronic equipment. By ensuring this product is disposed of correctly, you will help prevent potential negative consequences for the environment and human health, which could otherwise be caused by inappropriate waste handling of this product. The recycling of materials will help to conserve natural resources. For more detailed information about recycling of this product, please contact your local Civic Office, your household waste disposal service or the shop where you purchased the product.

Applicable accessory: Remote Commander.



Disposal of waste batteries (applicable in the European Union and other European countries with separate collection systems)

This symbol on the battery or on the packaging indicates that the battery provided with this product shall not be treated as household waste. On certain batteries this symbol might be used in combination with a chemical symbol. The chemical symbols for mercury (Hg) or lead (Pb) are added if the battery contains more than 0.0005% mercury or 0.004% lead.

By ensuring these batteries are disposed of correctly, you will help prevent potentially negative consequences for the environment and human health which could otherwise be caused by inappropriate waste handling of the battery. The recycling of the materials will help to conserve natural resources.

In case of products that for safety, performance or data integrity reasons require a permanent connection with an incorporated battery, this battery should be replaced by qualified service staff only.

To ensure that the battery will be treated properly, hand over the product at end-of-life to the applicable collection point for the recycling of electrical and electronic equipment.

For all other batteries, please view the section on how to remove the battery from the product safely. Hand the battery over to the applicable collection point for the recycling of waste batteries.

For more detailed information about recycling of this product or battery, please contact your local Civic Office, your household waste disposal service or the shop where you purchased the product.

If you have any questions or problems concerning your unit, please consult your nearest Sony dealer.

### Power sources

#### Preparing a power source

Charge the rechargeable battery before using this unit for the first time, or when the battery is depleted. You can operate the unit while charging.

- 1 Connect the AC power cord (supplied) to the AC power adaptor (supplied).
- 2 Connect the AC power adaptor to the DC IN 20V jack on the back of this unit firmly and plug it into a wall outlet.

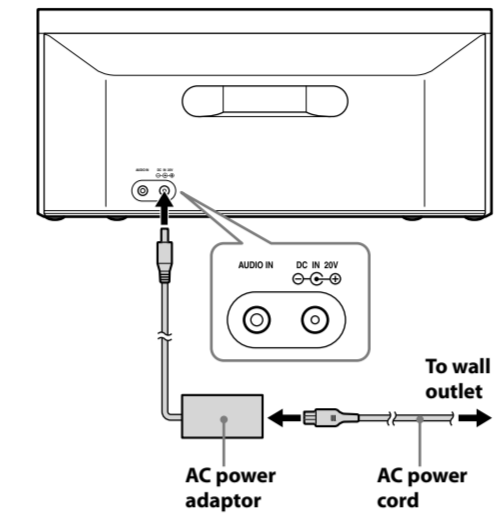

**Note on the AC power adaptor**

- Use the Sony supplied AC power adaptor only. The polarity of the plugs of other manufactures may be different. Failure to use the supplied AC power adaptor may cause the unit to malfunction.



- 3 Confirm that charging has started.

When charging start, the battery indicator appears. While charging, the charging indicator animation loops.

**When the unit is turned off**



When charging completes, the full battery indicator appears for a while, and then disappears.



#### Notes

- If you connect the AC power adaptor when the battery is fully charged, the full battery indicator appears for a while, and then disappears.
- If you connect the AC power adaptor when the battery power is low, charging starts and the low battery and charging indicator animation loops.

The unit cannot perform operations without the AC power adaptor while the low battery indicator appears.



**When the unit is turned on**



When charging completes, the full battery indicator appears.



#### Note

- It will take approximately 7 hours to charge the battery.

#### Using the rechargeable battery

You can operate the unit with the rechargeable battery instead of the AC power adaptor.

#### Note

- The maximum output will be lower when the AC power adaptor is disconnected.

#### To check the remaining power of the battery

The remaining power of the battery will be indicated when the unit is turned on. As the remaining battery power depletes, the battery indicator decreases.

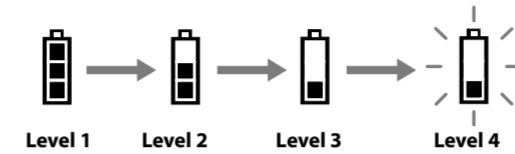

When the battery becomes almost fully depleted, "LOW BATT" flashes and the unit will turn off. To charge the battery, connect the AC power adaptor. (See "Preparing a power source.")



#### Notes

- The remaining battery power will not be indicated when the unit is turned off.
- The unit requires at least 30 minutes to charge the battery if "LOW BATT" appears.
- The battery indicator shows approximate remaining battery power.
- Operating conditions will affect the rate of battery depletion.

#### Battery life

When	Battery life
Playback of iPod	approx. 7hours*

Measured in accordance with the JEITA (Japan Electronics and Information Technology Industries Association) standard.

\* Playback time measured using a fully charged rechargeable battery with a fully charged iPod classic.

#### When to replace the rechargeable battery pack

Repeated recharging causes the capacity of the rechargeable battery power to decrease over time. Replace the rechargeable battery pack when its capacity becomes half the usual time, even after charging the battery fully.

#### Note

- The rechargeable battery pack is not a commercially available product. To purchase a rechargeable battery pack (NH - 2000 RDP), consult with your nearest Sony dealer.

#### Replacing the rechargeable battery pack

- 1 Slide the latch to **UNLOCK**, and slide **RELEASE** in the direction of the arrow on the bottom of this unit. The battery compartment cover opens, then remove the cover.
- 2 Use a coin, etc., to pull out the rechargeable battery pack.
- 3 Remove the rechargeable battery pack and disconnect the lead from the jack inside the battery compartment.
- 4 Connect the lead of a new rechargeable battery pack to the jack and insert the battery in the unit.
- 5 Close the battery compartment cover and slide the latch to **LOCK**.

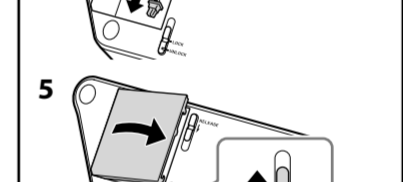
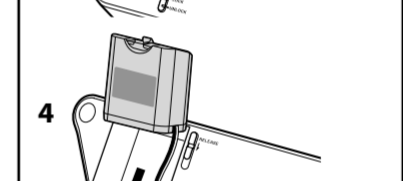
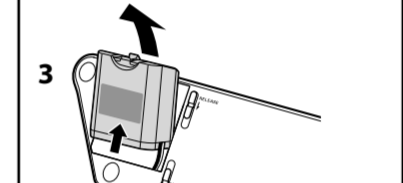
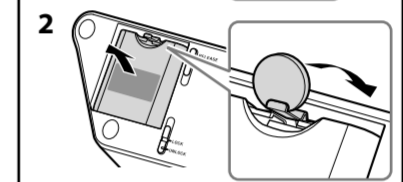
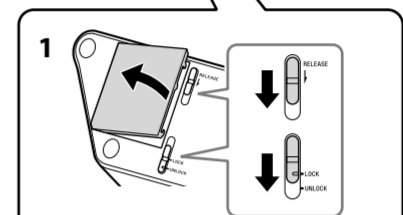
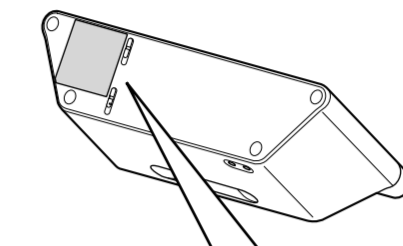

#### Notes

- Charge a new battery pack before use. See "Preparing a power source" for details.
- Turn off the unit, before replacing the rechargeable battery pack.
- When replacing the rechargeable battery pack, place a soft cloth, etc., under the unit.

#### Preparing the remote commander

Before using the remote commander for the first time, remove the insulation film.

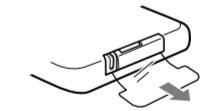

#### To know when to replace the battery

With normal use, the battery (CR2025) should last for about 6 months. When the remote commander no longer operates the unit, replace the battery with a new one.

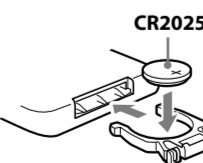
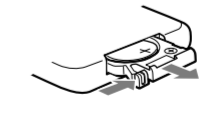

#### Notes

- Do not attempt to charge the battery.
- If you are not going to use the remote commander for a long time, remove the battery to avoid any damage that may be caused by leakage and corrosion.

# Operations

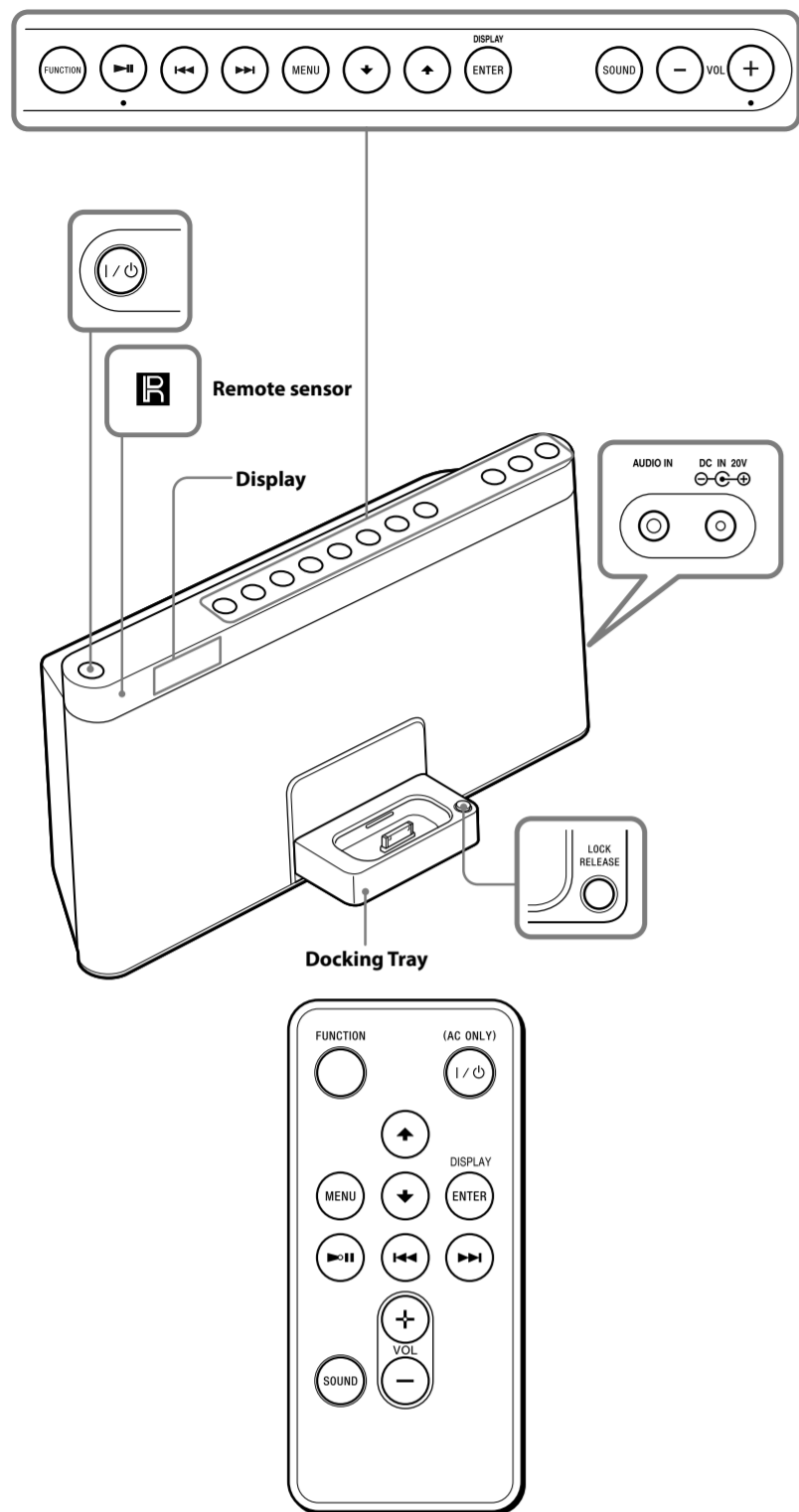

VOL + and ►II on the unit and the remote commander have a tactile dot.

## Before using the unit

### To turn on/off the power

Press I/⏻ (power).  
I/⏻ (power) button indicator will light up in green when the unit is turned on.

### To adjust the volume

Press VOL +/-.

#### Notes

- While the unit is turned off, only the I/⏻ (power) button will function.

### Power management system

After playback of the iPod (or component connected to AUDIO IN jack) has finished, if no operation is performed for about 20 minutes, the unit will automatically turn off.

#### Notes

- While the unit is turned on, if no operation is performed for more than about 30 seconds, the display turns off. In this case, press DISPLAY to turn on the display again.
- The unit cannot be turned on with the remote commander when the AC power adaptor is disconnected.

### Power off hold function

You can set the power off hold function in order to avoid unintentional powering on while carrying the unit.

### To set the power off hold function

Press and hold I/⏻ (power) when the AC power adaptor is disconnected.

“HOLD” flashes 2 times and the display turns off. The unit cannot be turned on by pressing I/⏻ (power) while the power off hold function is set.

### To cancel the power off hold function

Press and hold I/⏻ (power).  
“RELEASE” flashes 2 times and the power off hold function is canceled. The unit will turn on automatically.

#### Tip

- The power off hold function will be canceled if you connect the AC power adaptor to the unit.

## Opening/closing the Docking Tray

You can enjoy audio from iPod by setting it in the Docking Tray of this unit.

When setting an iPod in the unit, be sure to use the supplied universal dock adapter with your iPod or commercially available products from Apple Inc. If you are using an iPhone, iPhone 3G, iPhone 3GS or iPhone 4, attach the supplied universal dock adapter for iPhone, iPhone 3G, iPhone 3GS or iPhone 4 before connecting.

The adapter number, ⑫, ⑬ or ⑭, is shown on the underside of the supplied universal dock adapters. ⑫ is for the iPhone, ⑬ is for the iPhone 3G & iPhone 3GS and ⑭ is for the iPhone 4. Check the adapter number before use.

### Universal Dock Adapter



#### Notes

- To use an iPod, refer to the user's guide of your iPod.
- The connector of the unit is exclusively for use with an iPod. If you use a device that does not match the connector, connect it to the AUDIO IN jack of this unit with the supplied audio connecting cable.
- Sony cannot accept responsibility in the event that data recorded on an iPod is lost or damaged when using an iPod connected to this unit.
- For details of environmental conditions for operating your iPod, check the website of Apple Inc.

## To set the iPod

- Press **PUSH OPEN** on the Docking Tray at the front of this unit to open.  
The tray clicks to lock at the open position.

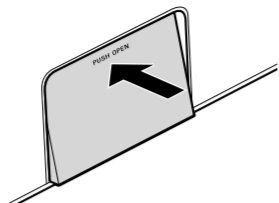

- Attach the adapter for your iPod/iPhone.

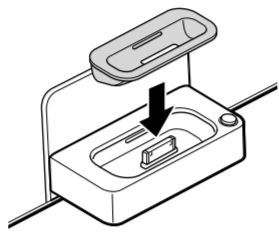

- Set your iPod/iPhone in the tray.

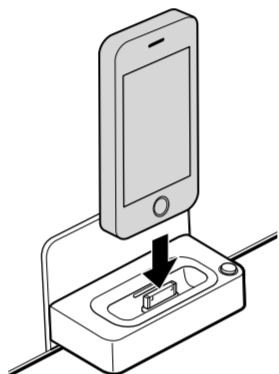

#### Tip

- Remove the case or cover from your iPod before setting it in the tray to ensure a stable connection.

## To close the Docking Tray

Press and hold **LOCK RELEASE** on the corner of the Docking Tray and close the tray.

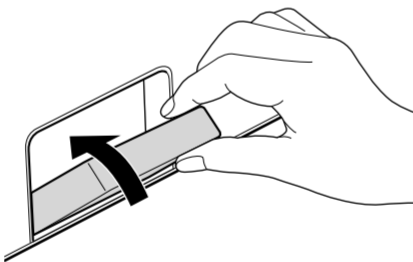
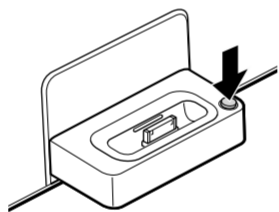

## Operating an iPod

- Press I/⏻ (power).
- Press **FUNCTION** repeatedly until “iPod” appears in the display.



- Press ►II.

The iPod begins to play back.

You can operate the connected iPod by this unit or the buttons on iPod.

To	Press
Turn off the iPod	Press and hold ►II.
Pause playback	►II To resume play, press again.
Go to the next track	►►I (forward)
Go back to the previous track	◄◄I (backward)*
Locate a point while listening to the sound	►►I (forward) or ◄◄I (backward) while playing and hold until you find the point.
Locate a point while observing the display on iPod	►►I (forward) or ◄◄I (backward) in pause and hold until you find the point.
Go back to the previous menu	<b>MENU</b>
Select a menu item or a track for playback	♦ (up)/♦ (down)
Execute the selected menu item or begin playback	<b>ENTER</b>

\* During playback, this operation returns you to the beginning of the current track. To go back to the previous track, press twice.

#### Notes

- When placing or removing the iPod, hold the iPod at the same angle as that of the connector on this unit, and do not twist or bend the iPod as connector damage may result.
- Do not carry the unit with an iPod set on the connector. Doing so may cause a malfunction.
- When placing or removing the iPod, hold the Docking Tray securely.
- Before disconnecting the iPod, pause playback.

### On copyrights

iPhone, iPod, iPod classic, iPod nano, and iPod touch are trademarks of Apple Inc., registered in the U.S. and other countries.

“Made for iPod,” and “Made for iPhone” mean that an electronic accessory has been designed to connect specifically to iPod or iPhone, respectively, and has been certified by the developer to meet Apple performance standards. Apple is not responsible for the operation of this device or its compliance with safety and regulatory standards. Please note that the use of this accessory with iPod or iPhone may affect wireless performance.

## To use this unit as a battery charger for your iPod

You can use the unit as a battery charger for your iPod. Charge your iPod when the AC power adaptor is connected.

The charging status appears in the display of iPod. For details, see the user's guide of your iPod.

#### Tip

- You can also charge your iPod without the AC power adaptor by pressing **FUNCTION** to select “iPod” when the battery indicator shows Level 1 or Level 2.

# Troubleshooting

## General

**The power will not turn on when the AC power adaptor is connected.**

- Make sure the AC power adaptor is connected to the wall outlet firmly.

**The power will not turn on when the AC power adaptor is disconnected.**

- The power off hold function may be set. In this case, cancel the power off hold function. (See “Power off hold function.”)
- The rechargeable battery may be depleted. In this case, connect to the AC power adaptor to charge the battery. (See “Preparing a power source.”)

**The buttons on the unit do not function.**

- When the unit is turned off, only the I/⏻ (power) button functions. Turn on the unit before operation.

**The rechargeable battery is depleted.**

- Connect to the AC power adaptor to charge the battery.

**There is no audio.**

- Adjust the VOL +/-.

**Noise is heard.**

- Ensure that the unit is not in the vicinity of in-use portable phones, etc.

**The display turns off.**

- If no operation is performed for more than 30 seconds, the display turns off. Press **DISPLAY** to turn on the display again.

**“ERROR” appears in the display and the unit turns off automatically.**

- If this symptom occurs frequently, consult your nearest Sony dealer.

## iPod

**There is no audio.**

- Make sure the iPod is connected firmly.

**Operation is not performed.**

- Make sure the iPod is connected firmly.

**The iPod cannot be charged when the AC power adaptor is disconnected.**

- You cannot charge the iPod when the battery power of the unit is low.

**The Docking Tray cannot be closed.**

- Press and hold the **LOCK RELEASE** while closing the Docking Tray.

## Remote

**The remote does not function.**

- The unit cannot be turned on with the remote commander when the AC power adaptor is disconnected. In this case, press I/⏻ (power) on the unit to turn on.
- Replace the battery in the remote commander with a new one if it is weak.
- Make sure that you are pointing the remote at the remote sensor on the unit.
- Remove any obstacles in the path of the remote and the unit.
- Make sure the remote sensor is not exposed to strong light such as direct sunlight or fluorescent lamp light.
- Move closer to the unit when using the remote.

If the problem persists, consult your nearest Sony dealer.

## Connecting optional components

You can enjoy the sound from an optional component such as a portable digital music player through the speakers of this unit. Be sure to turn off the power of each component before making any connections. For details, refer to the instruction manual of the component to be connected.

- Connect the **AUDIO IN** jack on the back of the unit to the line output jack of the portable digital music player or other component using an audio connecting cable.

- Press I/⏻ (power) to turn on the unit.

- Turn the connected component on.

- Press **FUNCTION** repeatedly until “AUDIO IN” appears in the display.

The sound from the connected component is output from the speakers of this unit.

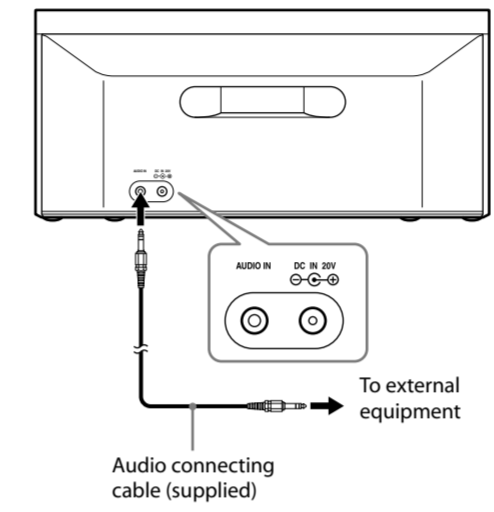

#### Notes

- Refer also to the connected equipment's manual.
- The supplied audio connecting cable may not be usable with some external equipment. In this case, use a cord suitable for the external equipment you are using.
- If you listen to the radio with external equipment connected, turn off the connected equipment to prevent noise. If noise occurs, even when the equipment is turned off, disconnect and place the external equipment away from the unit.

## Selecting audio emphasis (equalization)

You can adjust the emphasis of the sound. Press **SOUND** repeatedly to select the desired audio emphasis.



# Specifications

## Section for iPod

DC out: 5V  
MAX: 500mA

## General

### Speaker

Approx. 7.6 cm dia. 4 Ω

### Input

AUDIO IN jack (ø 3.5 mm stereo minijack)

### Power output

20 W + 20 W (at 1% harmonic distortion)

(With the AC power adaptor)

### Power requirements

Rechargeable battery pack:

NH - 2000 RDP

### Battery life

See “Battery life” of “Using the rechargeable battery” for details.

### External power source

DC IN 20V

### Dimensions

Approx. 356.0 mm × 162.8 mm × 119.7 mm (w/h/d)

### Mass

Approx. 1.9 kg

### Supplied accessories

Remote commander (1)

AC power adaptor (1)

AC power cord (1)

Audio connecting cable (1)

Universal Dock Adapter for iPhone (1)

Universal Dock Adapter for iPhone 3G & iPhone 3GS (1)

Universal Dock Adapter for iPhone 4 (1)

Design and specifications are subject to change without notice.

## Compatible iPod/iPhone models

Compatible iPod/iPhone models are as follows. Update your iPod/iPhone to use the latest software before you use it.

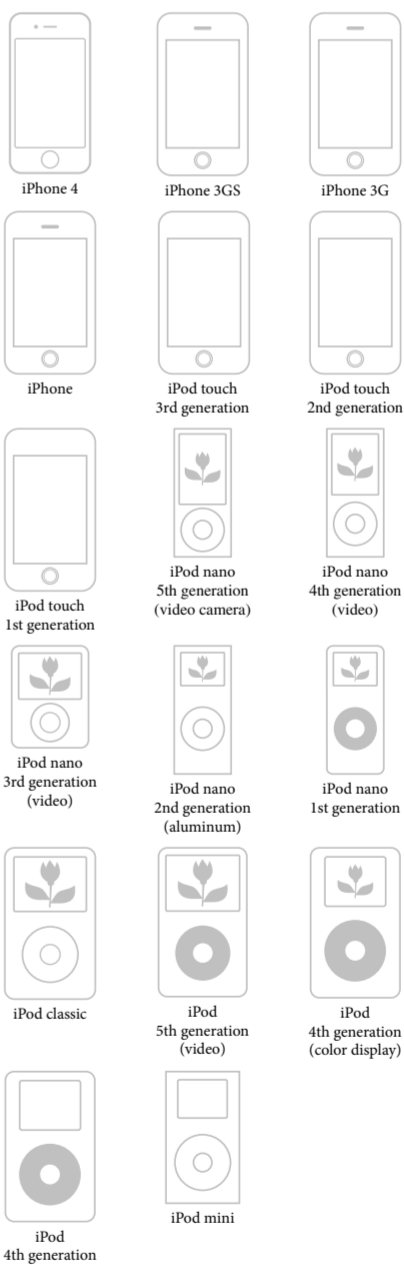

#### Notes

- In these Operating Instructions, “iPod” is used as a general reference to iPod functions on an iPod or iPhone, unless otherwise specified by the text or illustrations.
- The connector of the unit is solely for use with an iPod. If you use devices that do not have the same connector, connect to the **AUDIO IN** jack of this unit with the supplied audio connecting cable.
- Sony cannot accept responsibility in the event that data recorded to an iPod is lost or damaged when using an iPod connected to this unit.

## Free Manuals Download Website

<http://myh66.com>

<http://usermanuals.us>

<http://www.somanuals.com>

<http://www.4manuals.cc>

<http://www.manual-lib.com>

<http://www.404manual.com>

<http://www.luxmanual.com>

<http://aubethermostatmanual.com>

Golf course search by state

<http://golfingnear.com>

Email search by domain

<http://emailbydomain.com>

Auto manuals search

<http://auto.somanuals.com>

TV manuals search

<http://tv.somanuals.com>